

HEARTLAND COMMUNITY SCHOOLS
EMPOWERING EXCELLENCE - Every Student, Every Day

Minutes for
Board of Education Regular Meeting

Monday, February 9, 2026 7:00 PM
Conference Room
1501 Front St
Henderson, NE 68371-8929

Notice of the meeting was posted in the Henderson News on February 5, 2026.

Attendance

Lacey Gloystein: Present
Ryan Goertzen: Present
Jen Hiebner: Present
Jeb Mierau: Present
Tyler Newton: Present
Tammy Ott: Absent

1. **Preliminary Procedures**

1.1. **Call to Order**

1.2. **Recognize Notice of Meeting**

1.3. **Recognize Open Meetings Act Posting**

1.4. **Roll Call**

Motion to Excuse the absence of Tammy Ott. Passed with a motion by Ryan Goertzen and a second by Jen Hiebner.

Lacey Gloystein: Yea, Ryan Goertzen: Yea, Jen Hiebner: Yea, Jeb Mierau: Yea, Tyler Newton: Yea

2. **Public Comments On Agenda Items**

Public comment will be limited to items on the current agenda. Public comment may be limited to a total of 30 minutes, individuals will be limited to 5 minutes each.

Nebraska Revised Statute 84-1412 requires members of the public desiring to provide comments to the board to identify himself or herself, including an address, and the name of any organization represented by such person. A form is provided at the meeting for individuals to complete and to submit to the superintendent prior to speaking for the purposes of efficiently providing this information.

3. **Reports**

3.1. **Superintendent's Report**

3.2. **Principals' Reports**

3.3. **Huskie Happenings: FBLA Year-In-Review**

FBLA representatives Sam Friesen and Will Regier presented the year in review to the board.

4. **Discussion Items**

- 4.1. **Building / Construction Update**
- 4.2. **26-27 School Calendar**
- 4.3. **Scheduled Vehicle Replacement - 2022 Equinox**
- 4.4. **2-Year Facilities Projects Recommendations**
- 4.5. **Summer 2026 Track Resurfacing**
- 4.6. **Potential K-6 Playground Renovation**
President declared recess at 9:10. Meeting resumed at 9:20
- 4.7. **Board Retreat**

5. **Action Items**

5.1. **Approve Certified Contracts**

5.1.1. *Noah Jones (7-12 Social Studies)*

Approve the 2026-2027 teaching contract for Noah Jones as presented. Passed with a motion by Lacey Gloystein and a second by Ryan Goertzen.

Lacey Gloystein: Yea, Ryan Goertzen: Yea, Jen Hiebner: Yea, Jeb Mierau: Yea, Tyler Newton: Yea

5.2. **Approve Authorized Signatories**

5.2.1. *Cornerstone Bank*

1) Approve the designation and listing of Tyler Newton, Ryan Goertzen, Lacey Gloystein, and Jeremy Klein as authorized signatories on all Heartland Community Schools' bank accounts held with Cornerstone Bank. AND 2) Approve the removal of Tammy Ott as an authorized signatory on all Heartland Community Schools' bank accounts held with Cornerstone Bank. Passed with a motion by Jen Hiebner and a second by Ryan Goertzen.

Lacey Gloystein: Yea, Ryan Goertzen: Yea, Jen Hiebner: Yea, Jeb Mierau: Yea, Tyler Newton: Yea

5.2.2. *Henderson State Bank*

1) Approve the designation and listing of Tyler Newton, Ryan Goertzen, Lacey Gloystein, and Jeremy Klein as authorized signatories on all Heartland Community Schools' bank accounts held with Henderson State Bank. AND 2) Approve the removal of Tammy Ott as an authorized signatory on all Heartland Community Schools' bank accounts held with Henderson State Bank. Passed with a motion by Ryan Goertzen and a second by Jeb Mierau.

Lacey Gloystein: Yea, Ryan Goertzen: Yea, Jen Hiebner: Yea, Jeb Mierau: Yea, Tyler Newton: Yea

5.3. **Approve Vehicle Purchase**

Approve the purchase of a 2026 Chevy Equinox from Friesen Chevrolet at a net-cost not to exceed \$16,315. Passed with a motion by Lacey Gloystein and a second by Tyler Newton.

Jeb Mierau: Nay, Lacey Gloystein: Yea, Ryan Goertzen: Yea, Jen Hiebner: Yea, Tyler Newton: Yea

6. **Future Agenda Items**

6.1. **Regular Meeting: Monday, March 9th @ 7 PM**

6.2. **Board Retreat: Monday, March 23rd @ TBD**

5:30pm

7. **Consent Agenda**

7.1. **Approval of Minutes**

7.1.1. *Minutes: Regular - January 12, 2026*

7.2. **Approval of Claims**

7.3. **Financial Reports**

Approval of the Consent Agenda will include approval of financial reports as presented. Passed with a motion by Ryan Goertzen and a second by Jeb Mierau.

Lacey Gloystein: Yea, Ryan Goertzen: Yea, Jen Hiebner: Yea, Jeb Mierau: Yea, Tyler Newton: Yea

8. **Closed Session**

8.1. **Property Purchasing**

President Tyler Newton restated the purpose of the Closed Session and the Board entered Closed Session at 9:59 PM.

The Board was declared to be out of Closed Session at 10:45 PM.

Motion to enter into closed session for the purpose of a strategy session regarding purchase of property. Passed with a motion by Ryan Goertzen and a second by Jen Hiebner.

Lacey Gloystein: Yea, Ryan Goertzen: Yea, Jen Hiebner: Yea, Jeb Mierau: Yea, Tyler Newton: Yea

9. **Adjournment**

The meeting was adjourned at 10:47 PM.

Motion to adjourn. Passed with a motion by Ryan Goertzen and a second by Jen Hiebner.

Lacey Gloystein: Yea, Ryan Goertzen: Yea, Jen Hiebner: Yea, Jeb Mierau: Yea, Tyler Newton: Yea

Board President

Board Secretary

HEARTLAND ***COMMUNITY SCHOOLS***

**1501 Front Street
Henderson, Nebraska 68371**

**Phone: (402) 723-4434
Fax: (402) 723-4431**

February 9, 2026

TO: Heartland Community Schools Board of Education
FROM: Jeremy Klein, Superintendent
RE: Board Report (February 2026)

Regular February Board Meeting Reminder

Our regular February board meeting is scheduled for Monday, February 9, 2026, at 7 PM in the Conference Room.

There are no committee meetings scheduled prior to the board meeting.

Please let Tyler or I know if you need to be absent.

Board Meeting Reminders

- Monday, February 9th @ 7 PM: Regular February Meeting
- Monday, March 9th @ 7 PM: Regular March Meeting

Committee Meeting Reminders

- Tuesday, February 10th @ 3 PM – RE: Playground Renovation

Consent Agenda: Minutes

Approval of the Consent Agenda will include approval of the minutes from the following meetings:

- Regular Meeting (January 12, 2026)

Consent Agenda: Claims

Approval of the month's claims are included in the Consent Agenda. Let me know if you have any questions on any claims prior to the meeting - I can either answer your question or bring an answer to the meeting.

Consent Agenda: Construction Claims

There are no certified construction claims to be paid this month. Our current balance to finish is \$50,000.

Organizational Meeting Reminder

January was our annual organizational meeting. Officers were elected and committee assignments were reviewed. You should let me know if I did not correctly record the committee memberships.

Officers

President: Tyler Newton

Vice President: Ryan Goertzen

Secretary: Lacey Gloystein

Committee on American Civics

Lacey Gloystein

Jen Hiebner

Jeb Mierau

Cooperative Sponsorship Committee

Jen Hiebner

Tyler Newton

Tammy Ott

Early-Childhood Building Management Committee

Ryan Goertzen

Jen Hiebner

Lacey Gloystein

Facilities / Building Committee

Jen Hiebner

Jeb Mierau

Tyler Newton

Finance / Negotiations Committee

Ryan Goertzen

Tyler Newton

Tammy Ott

FBLA Report

Mrs. Yantzie requested that a small group of FBLA students present to the Board during our February meeting. The group would review some of the things that our FBLA students / chapter have done over the past year. The opportunity is also helpful to a qualification that the chapter is seeking to earn. The brief presentation will occur during the Reports section of the agenda.

Career & Technical Education

We visited this past week with Cheryl Brown, CEO at Henderson Health Care for the purpose of gaining insight about their immediate and long-term workforce development needs. This is part of a process of looking at local workforce development needs for the purpose of contextualizing and focusing CTE opportunities for our students. We'll have similar conversations with other local, workforce stakeholders. Largely we wanted to get a sense of what their needs were and what collaborative opportunities might exist for providing our students with career and career education opportunities through the context of their organization's established workforce and their workforce needs. The conversation was quite fruitful in touching upon some high-quality opportunities for our students. The diversity of HHC's workforce and their location make them a great potential partner for broadening CTE opportunities for our students whether formal or informal. Going forward, I'll work with my team and Cheryl Brown to examine what practical, meaningful, and sustainable steps can be taken to partner with HHC based upon that conversation. Among others, I anticipate having an ongoing conversation with HHC in this regard.

Legislative Items

Like all years, there are a number of items to examine and engage in relating to potential school-related legislation being contemplated in the Unicameral. I have attached the most recent NRCSA bill summary to this report. Two items of note that recently went through their hearings were LB 1038 (Hughes) and LB 765 (Holdcroft).

LB 1038 relates to significant changes in TEEOSA and school finance. I have concerns with the potential impacts of 1038 for our district as it is likely to negatively impact our district's taxpayers due to the funding mechanism and formulary determinations in the bill. There are a lot of details to yet be understood. Senator Hughes provided modeling a couple of weeks ago and NDE was only able to provide modeling in the past week. I'll keep you informed, but early indications point to a potential negative impact for the patrons of districts like Heartland. I anticipate that approximately one-fourth of Nebraska's districts could face the same potential impacts. I have discussed my concerns with Senator Hughes. As my understanding around the mechanics improves I will keep you informed.

LB 765 is aimed at creating more restrictions around bond elections. The central change would be a requirement that at least 50.1% of all voters participate in the election.

NRCSA Legislative Forum

Let me know if you'd like me to get you registered for the NRCSA Legislative Forum. It takes place at the Cornhusker Hotel in Lincoln. It will be held on Thursday, February 26th and will begin at 8:20 AM.

Dates / Events Of Note

February 9: Regular February board meeting @ 7 PM
February 13: No School
March 6: No School – Professional Development
March 9: Parent-Teacher Conferences @ 4:30 PM - 8:30 PM
March 9: Regular March board meeting @ 7 PM
March 10: Parent-Teacher Conferences @ 4:30 PM - 8:30 PM
March 11: Last Day 3rd Quarter
March 12: No School – Professional Development
March 13: No School
April 3: No School - Spring Break
April 6: No School - Spring Break
April 13: Regular April Board Meeting @ 7 PM
April 14: No School - HS Track Invitational
May 10: Graduation
May 11: Regular May Board Meeting @ 7 PM

EMPOWERING EXCELLENCE - Every Student, Every Day

| THIS WEEK | NEXT WEEK | | | | | | |
|----------------------|--------------|----------------|---|----------------|--------------|-----------------------------|--------|
| BILL | SENATOR | COMMITTEE | DESCRIPTION | NRCSA POSITION | HEARING DATE | TESTIFY? | STATUS |
| LB11 | Hughes | Appropriations | Appropriate funds to NDE, State College System, University System, and Community Colleges for purposes of the Nebraska Statewide Workforce and Education Reporting System Act. \$130,893 in 2025-26 and \$179,795 in 2026-27. | | 2/15 | | |
| LB14 | M. Cavanaugh | Education | Hunger Free Schools Act. Intent of the Legislature would be to provide each student with the best opportunity for educational success by ensuring that public schools offer meals during the school day at no cost to every student. Fully paid breakfast or lunch would mean a meal served to a student who does not qualify for a free or reduced meal. Qualified schools must: (1) offer meals at not cost to all students, (2) Submit information regarding the number of eligible breakfasts and eligible lunches served in a manner prescribed by the department, and (3) maximize federal reimbursement for eligible breakfasts and eligible lunches by operating under the community eligibility provision if such school has an identified student percentage greater than or equal to 62.5 percent. NDE shall make disbursements annually to each qualified school that complies with the requirements of the Hunger-Free Schools Program. Legislature to appropriate from General Fund to pay for program. | support | 2/25 | letter (not part of record) | |

| THIS WEEK | NEXT WEEK | | | | | | |
|----------------------|-----------|-----------|--|----------------|--------------|---|--------------|
| BILL | SENATOR | COMMITTEE | DESCRIPTION | NRCSA POSITION | HEARING DATE | TESTIFY? | STATUS |
| LB31 | Conrad | Education | <p>Requires the State Board of Education to create a model policy governing school districts' use of student surveillance technology by December 1, 2025. This policy will require schools to transparently inventory such technologies, including costs, vendors, and privacy protections, and make this information publicly available. The bill cites concerns about student privacy, parental rights, and the responsible use of taxpayer funds. School boards must then adopt compliant policies by May 1, 2026, ensuring that the use of surveillance technology aligns with the state's model policy and protects students' rights. The bill emphasizes the importance of balancing security and efficiency goals with the protection of personal liberty and transparency. Requires the State Board of Education to develop and distribute a model policy regarding student surveillance, monitoring, and tracking technology by December 1, 2025. Each school board must then adopt a written policy consistent with the model policy by May 1, 2026. This policy will be implemented at the start of the 2026-2027 school year. The minimum requirements for the policies are: (1) School districts must identify and inventory all types of surveillance tools and student surveys that gather personal information. This inventory must include: (a) The name and contact information for each private company, vendor, or government entity that provides the technology, (b) The cost to purchase and maintain each surveillance, monitoring, and tracking technology tool, (c) A description of each student surveillance, monitoring, and tracking technology tool, including a description of privacy protection measures for each tool and data collection, data sharing, and usage activities, (d) Whether or not parents may opt their student out of being subjected to a student surveillance, monitoring, and tracking tool, (e) If and how the data will be shared with law enforcement or implicate punitive actions under the Student Discipline Act, (f) How student surveillance, monitoring, and tracking technology tools ensure proper accommodations for students with disabilities or individualized education programs, (g) How biometric or personally identifiable information is stored, shared, or sold with the private companies, vendors, or governmental entities providing such tools, (h) What remedies are available to students and parents for violations of personal privacy related to surveillance, monitoring, and tracking technology tools, including under the Consumer Protection Act, the Political Subdivisions Tort Claims Act, and state statute.</p> <p>School districts must post the inventory and information related to surveillance, monitoring, and tracking technology on the school district's website and ensure that it is available in hard copy upon request.</p> <p>School boards may include additional provisions in their policies that conform to the spirit and intent of the law.</p> | oppose | 2/4 | NCSA testified on behalf of several groups, including NRCSA | General File |

| THIS WEEK | NEXT WEEK | | | | | | |
|----------------------|-----------|----------------|---|----------------|--------------|----------|--|
| BILL | SENATOR | COMMITTEE | DESCRIPTION | NRCSA POSITION | HEARING DATE | TESTIFY? | STATUS |
| LB34 | Hunt | Government | Year round Daylight Savings Time. | | 1/31 | | General File. Advanced to Enrollment and Review for Engrossment (3/11) |
| LB49 | McKinney | Education | Ban and Bar. State Board required to establish a model policy on the subject of ban and bar. The model policy must (i) Specify that a ban and bar action by a school district shall only be used in response to an immediate and significant threat of harm to a student, school official, or other individual or to facilitate the enforcement of a court order; (ii) Specify that any ban and bar action shall be limited in scope and duration in such a manner to accommodate the right of parents and family members to be involved in their child's education and, in no event exceed one calendar year unless otherwise required by court order; (iii) Protect the right of parents to be involved in the education of their children and their right to contest, appeal, or otherwise challenge a ban and bar action; (iv) Not discriminate or be applied in a discriminatory manner against any family members on the basis of race, color, religion, sex, disability, or national origin; (v) Provide that any individual subject to a ban and bar action shall be given written notice of such action that includes the term of the ban and bar action, a description of the conduct giving rise to the ban and bar action and the evidence the school district has of such conduct, and instructions on how to appeal such ban and bar action; and (vi) Not be used against a student of the school district. Any individual who is subject to a ban and bar action by the school may appeal to the Board of Education. Local Board of Education must adopt a policy on or before July 1, 2026. | | 3/10 | | |
| LB 81 | Hardin | | Deals the Nebraska Property Tax Incentive Act. For taxable years beginning or deemed to begin during calendar year 2024, the department shall set the credit percentage so that the total amount of credits for such taxable years shall be the maximum amount of credits allowed in the prior year increased by the allowable growth percentage. Allowable growth percentage is the percentage increase, if any, in the total assessed value of all real property in the state from the prior year to the current year, as determined by the department. The intent of LB 81 is to address the gap year for the Property Tax Credit Fund that was created by LB 34 in the 108th Legislature, 1st Special Session. | | | | |
| LB94 | McKinney | Business/Labor | Digital Skills Empowerment Act. | | 2/3 | | |

| THIS WEEK | NEXT WEEK | | | | | | |
|-----------------------|------------|-----------|---|----------------|--------------|----------|--------|
| BILL | SENATOR | COMMITTEE | DESCRIPTION | NRCSA POSITION | HEARING DATE | TESTIFY? | STATUS |
| LB122 | Meyer | Education | Require display of the national motto and state motto in classrooms. | | 2/24 | | |
| LB131 | Sorrentino | Revenue | <p>LB 131 would conform Nebraska to the federal changes regarding "529 Plans" under the College Savings Plan Program. The federal changes allow for contributions to a plan to be used to pay tuition at an elementary or secondary school of choice. Would allow certain types of income to be excluded when determining taxable income. One type of income this bill would exclude from taxation are funds associated with the Nebraska educational savings plan trust, referred to in the act as the "Nebraska educational savings plan." This includes interest, earnings, and state contributions. The bill also makes contributions to an account established under the achieving a better life experience program tax deductible. This deduction is limited to \$5,000 per married filing separate return or \$10,000 for any other return. Additionally, employer contributions to the Nebraska educational savings plan are excluded, with a limit of \$5,000 per married filing separate return and \$10,000 for any other return. If a participant cancels their participation agreement, or obtains a distribution for nonqualified expenses, the amount distributed will be considered taxable income. Amended into LB 647.</p> | | 2/27 | | |

| THIS WEEK | NEXT WEEK | | | | | | |
|-----------------------|-----------|------------|--|----------------|--------------|-----------|---|
| BILL | SENATOR | COMMITTEE | DESCRIPTION | NRCSA POSITION | HEARING DATE | TESTIFY? | STATUS |
| LB135 | Holdcroft | Government | <p>Bond or levy override elections must be held in conjunction with state-wide elections. An emergency clause is provided for a special election in emergency situations.LB135 removes the option for school districts to hold special elections for bond issues. Instead, these questions must now be placed on the ballot during either the statewide primary, the statewide general election, or a regularly scheduled general election of a political subdivision held in an odd-numbered year. This change aims to increase voter participation and potentially reduce election costs.</p> <p>LB 135, school district elections in Nebraska may be held at the following times:</p> <ul style="list-style-type: none"> •In conjunction with the statewide primary or general election. The school board must file the order or certify the question for the issue to be on the ballot by March 1 for the statewide primary election or September 1 for the statewide general election. •In an odd-numbered year in conjunction with a regularly scheduled general election of a political subdivision. The school board must file the order or certify the question for the issue to be on the ballot by the eighth Friday prior to the general election of a political subdivision. •At a special election if the purpose of the election is to address an emergency due to circumstances beyond the control of the school board, such as the destruction of a facility or other infrastructure by fire, flood, tornado, or other emergency circumstance. The election commissioner or county clerk of the county having the greatest number of electors entitled to vote on the question will designate the polling places and election officials. <p>A school district election may not be held within 10 months after the same question has been defeated at any election.</p> <p>AM 99 was introduced to provide a little more flexibility in odd-numbered (non election for most districts) years. Special elections would be allowed : (a) In an odd-numbered year, in conjunction with a regularly scheduled general election of a political subdivision; (b) In an odd-numbered year, on the first Tuesday after the second Monday in May; or (C) In an odd-numbered year, on the first Tuesday after the first Monday in November.</p> <p>LB 447 was added. A school shall not hold another bond election within 10 months after its failure unless the school district's student enrollment has grown by an average of at least three percent and by at least one hundred fifty students over the preceding three years".</p> <p>AM 779 was introduced that would eliminate the 10-month wait.</p> | oppose | 1/22/25 | testified | General File with AM 99. Advanced to Enrollment and Review Initial with AM 447 (3/12). Select File (3/25). Failed to advance (3/28) |

| THIS WEEK | NEXT WEEK | | | | | | | |
|-----------------------|-----------|----------------|--|----------------|--------------|--------------------------|----------------------|--|
| BILL | SENATOR | COMMITTEE | DESCRIPTION | NRCSA POSITION | HEARING DATE | TESTIFY? | STATUS | |
| LB142 | Hughes | Education | Removes the 1.1 multiplier of the federal Community Eligibility Provision (CEP) for purposes of calculating free lunch and free milk students under TEEOSA. A recent analysis of the CEP multiplier by the Nebraska Department of Education as part of an interim study, LR 419, determined that it was no longer needed for purposes of calculating free lunch and free milk students under TEEOSA. | | 3/3 | | | |
| LB149 | Hansen | Education | Eliminate the prohibition regarding suspending a student who is in grades PK-2. Likely coupled with LB 440. | support | 3/17 | letter | | |
| LB156 | Conrad | Judiciary | The Political Subdivisions Tort Claims Act would not exempt schools officials from cases rising out of a sexual assault of a child that occurred (a) On school grounds; (b) In a vehicle owned, leased, or contracted by a school and being used for a school purpose; (c) In a vehicle being driven for a school purpose by a school employee or person designated by the school; or (d) At a school-sponsored activity or athletic event | | 3/26 | | Conrad priority bill | |
| LB161 | Juarez | Education | Redefine formula student under TEEOSA. PK students counted 100% instead of 60%. | support | 2/10 | letter | | |
| LB162 | Juarez | HHS | Standards for emergency preparedness and response for child care and early education programs need to be aligned with such standards in elementary and secondary schools. The Child Care Safety and Security Fund is created. Subject to available appropriations, the department shall award grants to educational service units on a competitive basis on behalf of designees (can be schools) for emergency response notification systems, training, and materials related to safety and reunification procedures. An educational service unit may apply to the State Department of Education for a grant, using forms and in a manner prescribed by the department, to provide funding to designees operating within the boundaries of an educational service unit. To receive funding, a designee shall enter into a memorandum of understanding with the appropriate educational service unit in the designee's geographic area for the purpose of funding qualifying projects as described. A designee is assigned, through a memorandum of understanding, to coordinate, administer, or provide for safety and reunification procedure training to child care and early education programs. shall not exceed one thousand dollars per year | | 1/29 | | | |
| LB173 | Prokop | Appropriations | Appropriates funding to support dual enrollment programs in Nebraska, which allow high school students to earn college credits and industry-recognized credentials, to support workforce development and career pathways. \$13 million for 2025-26 and \$14 million for 2026-27. Amended into LB261 via AM832 | support | 2/27 | letter (included STANCE) | | |

| THIS WEEK | NEXT WEEK | | | | | | |
|-----------------------|--------------|-----------------|--|----------------|--------------|----------|---------------------------------|
| BILL | SENATOR | COMMITTEE | DESCRIPTION | NRCSA POSITION | HEARING DATE | TESTIFY? | STATUS |
| LB213 | Holdcroft | Education | <p>On or before March 1, 2026, the State Board of Education shall adopt measurable academic content standards for human embryology under the science education standards. Such standards shall be integrated into each school's curriculum no later than the start of the 2026-27 school year and shall include:(A) Instruction on human development that accurately portrays the biological science of human embryology, including the Carnegie Stages of Human Embryonic Development, in the curriculum of elementary, middle school, and high school students; and (B) High-definition visual recordings which are of at least four dimensional quality, commonly referred to as 4D. The visual recordings shall show the development of the brain, heart, sex organs, and other vital organs throughout fetal development. A parent, guardian, or educational decisionmaker may opt such parent's, guardian's, or educational decisionmaker's student out of the instruction provided .</p> <p>AM 645 added. Instead of saying "including the Carnegie....." it will read "such as the Carnegie....."</p> | oppose | 2/24 | letter | General File with AM 213 (3/18) |
| LB220 | M. Cavanaugh | Executive Board | <p>Legislature shall provide for the creation of a developmental and intellectual disability impact note for proposed legislation that uses data and research to estimate the potential effects of a legislative bill on disparities described in the bill for persons with developmental and intellectual disabilities within this state, including a statement of whether the legislation is likely to increase or decrease such disparities, to assist legislators in identifying and evaluating the anticipated or potential impact the legislative bill may have on persons with developmental and intellectual disabilities. A request may be made by a member of the Legislature who introduces a legislative bill that is expected to have an impact on persons with developmental and intellectual disabilities or then chairperson of a committee that is preparing to schedule a hearing for a legislative bill that may have an impact on persons with developmental and intellectual disabilities. Executive Board can approve or deny the request.</p> | | 3/6 | | |
| LB236 | Conrad | Judiciary | <p>Allow for tort claims when the harm caused by child abuse or sexual assault of a child is a proximate result of the failure of a political subdivision or an employee of the political subdivision to exercise reasonable care to either:(i) Control a person over whom it has taken charge; or (ii) Protect a person who is in the political subdivision's care, custody, or control from harm caused by a non-employee actor</p> | | 3/26 | | |

| THIS WEEK | NEXT WEEK | | | | | | |
|-----------------------|-----------|-----------|--|----------------|--------------|----------|--------|
| BILL | SENATOR | COMMITTEE | DESCRIPTION | NRCSA POSITION | HEARING DATE | TESTIFY? | STATUS |
| LB242 | Riepe | Revenue | <p>Allowable growth rate is amended to include any increase in valuation due to annexation of real property by the political subdivision, (iv) a change in the use of real property, (v) and any ncrease in personal property valuation over the prior year, and (vi) the increase in excess valuation over the redevelopment project valuation described in section 18-2147 for redevelopment projects within the governmental unit, provided the accumulated excess valuation which exists as of July 1, 2025, shall be included in the calculation of the increase in excess valuation for the governmental unit's first fiscal year beginning on or after July 1, 2025. In addition to the preliminary property tax request authority, the political subdivision's property tax request authority may be increased by (a) The product of (i) the amount of property taxes levied in the prior year less the sum of exceptions utilized in the prior year pursuant to subdivisions (1) and (2) of section 13-3404 and (ii) the political subdivision's growth percentage; and (b) The product of (i) the amount of property taxes levied in the prior year, less the sum of exceptions utilized in the prior year pursuant to subdivisions (1) and (2) of section 13-3404 and (ii) the greater of zero or the inflation percentage. Additional allowances are added for a political subdivision to increase its property tax request authority over the amount determined under section 13-3403. Added are: (a) the amount of property taxes budgeted for substance abuse prevention, behavioral health, and opioid use prevention; (b) The amount of property taxes budgeted for matching state and federal grants; and (c) The amount of property taxes needed to replace any revenue stream collected in the prior year that was eliminated or reduced through legislative action.</p> <p>LB242 Amended into LB647 via AM1202</p> | | 3/5 | | |

| THIS WEEK | NEXT WEEK | | | | | | | |
|-----------------------|-----------|-----------|---|----------------|--------------|----------|--------|--|
| BILL | SENATOR | COMMITTEE | DESCRIPTION | NRCSA POSITION | HEARING DATE | TESTIFY? | STATUS | |
| LB243 | Sanders | | <p>Would change a provision relating to special sidewalk assessments. AM 1038 was added to provide an addition to a method of notice required (required notice in newspaper), such notice may also be provided by any other appropriate method designated by such public body or such advisory committee. Each public body shall record the methods and dates of such notice in its minutes. Such notice shall contain an agenda of subjects known at the time of the publicized notice or a statement that the agenda, which shall be kept continually current, shall be readily available for public inspection at the principal office of the public body during normal business hours. Agenda items shall be sufficiently descriptive to give the public reasonable notice of the matters to be considered at the meeting. Except for items of an emergency nature, the agenda shall not be altered later than (i) twenty-four hours before the scheduled commencement of the meeting or (ii) forty-eight hours before the scheduled commencement of a meeting of a city council or village board scheduled outside the corporate limits of the municipality. The public body shall have the right to modify the agenda to include items of an emergency nature only at such public meeting.</p> | | | | | |
| LB249 | Sanders | Education | Military impact funding. | | 1/28 | | | |
| LB282 | Prokop | Education | Beginning with the 2025-26 school year, a teacher employed at an approved or accredited public, private, denominational, or parochial school in this state teaching kindergarten through twelfth grade may apply to the State Department of Education on forms and in a manner prescribed by the department to receive up to three hundred dollars in reimbursement for school supplies paid for by such teacher. A teacher shall be required to show receipts for such supplies in order to receive reimbursement. State Board of Ed would develop a policy and rules. | support | 1/27 | testify | | |

| THIS WEEK | NEXT WEEK | | | | | | |
|-----------------------|-------------|------------|---|----------------|--------------|----------|--|
| BILL | SENATOR | COMMITTEE | DESCRIPTION | NRCSA POSITION | HEARING DATE | TESTIFY? | STATUS |
| LB300 | Murman | Education | <p>Amends the Superintendent Pay Transparency Act. On and after the effective date of this act, no school district or educational service unit may enter into any contract with a superintendent for services to be rendered to a school district or an administrator for services to be rendered to an educational service unit if the contract will cause, by the terms of the contract or in combination with existing contracts, the school district or educational service unit to pay compensation for any contract year to or on behalf of the superintendent or administrator in excess of five times the compensation for a beginning teacher in such school district or educational service unit for the same contract year. Compensation means a reasonable estimate of the total amount of salary and benefits to be paid by a school district or educational service unit in exchange for personal services performed during a contract year.</p> <p>AM 168 changes the bill to say: Beginning with school year 2027-28, the school board of any school district or the board of any educational service unit shall pay compensation for a beginning teacher for the first contract year in an amount that is at least twenty percent of the compensation of the Superintendent or administrator of such school district or educational service unit for such contract year and that this section does not apply if the superintendent or administrator of the school district has been employed as a certified employee by the contracting school district for more than twenty years.</p> | oppose | 1/27 | testify | General File w/ AM 168. FA 18 |
| LB302 | Murman | Government | Eliminate Daylight Savings Time | | 1/31 | | Select file (2/26). Advanced to Enrollment and Review for Engrossment (3/11). Placed on final reading: 3/17. |
| LB304 | DeBoer | | LB304 eliminates the sunset provision on the expanded eligibility for the childcare subsidy. | | | | Sen. DeBoer priority for 2026 |
| LB329 | von Gillern | Judiciary | Expands the offense of sexual abuse by a school employee to also include school contract workers. School contract workers are defined as a person nineteen years of age or older who, as part of such person's employment, spends time working at a public, private, denominational, or parochial school approved or accredited by the State Department of Education but is not employed by such a school, including, but not limited to, a school resource officer, a construction worker, or a school consultant or independent contractor. | | 3/26 | | |

| THIS WEEK | NEXT WEEK | | | | | | |
|-----------------------|-----------|--------------------|---|----------------|--------------|----------|---|
| BILL | SENATOR | COMMITTEE | DESCRIPTION | NRCSA POSITION | HEARING DATE | TESTIFY? | STATUS |
| LB352 | Ballard | Education | The State Board of Education shall make a database for the public that contains all student discipline data, de-identified. The database shall be searchable by school district, school building, offense, type of discipline imposed, type of school resource officer or other law enforcement involvement, type of restraint, if any, and type of seclusion,. The state board shall cause each school district to track and to annually report to the State Board of Education, by individual student, (a) every act resulting in suspension, reassignment to an alternative school, (b) the use of any physical intervention by an employee of the school district with such student, or any the restraint or seclusion of such student, (c) Offense by a student constituting grounds for a long-term suspension, an expulsion, or a mandatory reassignment, of (d) act by a student resulting in school resource officer or other law enforcement involvement. The State Board of Education shall cause each school district to designate at least one discipline data coordinator, whose contact information shall be listed on the school's website. | | 1/28 | | |
| LB353 | Lonowski | Business and Labor | A labor organization representing public school employees or employers of public school employees shall not, as part of any membership contract entered into or renewed after the effective date of this act, place any restriction on when a public school employee may join or terminate membership in a labor organization. | | 2/3 | | General File (3/6). Passed over (1/27,26) |
| LB384 | Storer | Revenue | At least a majority of the BOE would need to attend joint public hearings under the Property Tax Request Act. AM 703 changes from majority of BOE to at least one elected member. | oppose | 2/13 | letter | General File with AM 703 (3/20). Advanced to Enrollment and Review for Engrossment. Advanced to Final Reading (1-30-26) |
| LB389 | Murman | Revenue | Eliminates budget authority of ESU's beginning with the 2028-29 school year. Beginning in 2029, funds shall be distributed by the state to ESUs as provided in the bill in order to offset the funds lost by ESUs due to the elimination of their levy authority. For 2029, the amount to be distributed to each ESU shall be equal to the amount of property taxes levied by such ESU for tax year 2027 a increased by three and one-half percent. In ensuing years, the amount of state funds shall be increased by 3.5% annually. | oppose | 2/7 | testify | |

| THIS WEEK | NEXT WEEK | | | | | | |
|-----------------------|-----------|-----------|--|----------------|--------------|----------------------------|--------|
| BILL | SENATOR | COMMITTEE | DESCRIPTION | NRCSA POSITION | HEARING DATE | TESTIFY? | STATUS |
| LB408 | Dungan | Education | Special Education Teacher Forgivable Loan Program Act. assist individuals studying to become special education teachers by supporting forgivable loans to those individuals who commit to teaching in Nebraska following their certification as a teacher with a special education endorsement. Must attend state college or University of Nebraska. 25 loans per year per college/university. Must begin teaching SPED in Nebraska within one year of graduation for five consecutive years, with 20% of loan forgiven per year. Not fulfilling the forgivable loan program will require loan to be repaid at 5% interest per year. | support | 2/11 | NCSA (on behalf of others) | |
| LB411 | Dungan | Education | Amends the Nebraska Teacher Recruitment and Retention Act. Previously provided \$2,500 grants after an eligible teachers 1st, 3rd, 5th years upon signing contract for the coming year. Beginning in July, 2025, retention grants would be provided annually as such: (a) 1st through 6th year--\$2,500, (b) 7th through 15th year--\$3,00, and (c) 16th year through all remaining years as a full time teacher--\$4,000 per year. A one time high need retention grant would be provided for anyone who btains an endorsement in special education, mathematics, science, technology, or dual-credit. | support | 3/10 | letter | |
| LB424 | Andersen | Revenue | The property tax bill for any parcel of real property shall not exceed the prior year's property tax bill by more than the allowable growth percentage. The Allowable Growth Percentage shall be the lesser of the inflation rate or 3%. The is the percentage change in the Consumer Price Index for All Urban Consumers, as prepared by the United States Department of Labor, Bureau of Labor Statistics, for the twelve-month period ending on August 31 of the year in which the property tax bill is determined; | oppose | 2/27 | letter | |

| THIS WEEK | NEXT WEEK | | | | | | |
|-----------------------|-----------|-----------|--|----------------|--------------|----------|--------------------|
| BILL | SENATOR | COMMITTEE | DESCRIPTION | NRCSA POSITION | HEARING DATE | TESTIFY? | STATUS |
| LB426 | Andersen | Education | <p>All public, private, denominational, and parochial schools may, as a part of the social studies curriculum, engage students between fifth grade and the completion of eighth grade in a one hour American flag education program that includes, but need not be limited to, the United States Flag Code, the thirteen folds of the American flag, proper flag etiquette and conduct in the presentation of the flag, and the historical background of the flag. Such flag education program may be developed and presented in consultation and partnership with a local recognized veterans organization. As part of such program, each student shall receive one American flag that is three feet by five feet and a flag etiquette booklet. The costs of such program shall be funded using lottery funds or private donations.</p> <p>AM 586 requires the ESUCC to develop a grant fund to provide funds to schools for the purpose of providing flags to students. The American Flag Education Grant Cash Fund is created to provide funding from the state. The Educational Service Unit Coordinating Council shall, in consultation and partnership with a statewide recognized veterans organization, develop and make available online for use by schools, an educational video and learning materials relating to the American flag for purposes of an American flag education program provided. It is the intent of the Legislature to appropriate five thousand dollars for fiscal year 2025-26 from the General Fund to the State Department of Education to carry out this section.</p> | | 2/24 | | Genral File (3/14) |

| THIS WEEK | NEXT WEEK | | | | | | |
|-----------------------|-----------|-----------|--|----------------|--------------|----------|------------------------------------|
| BILL | SENATOR | COMMITTEE | DESCRIPTION | NRCSA POSITION | HEARING DATE | TESTIFY? | STATUS |
| LB427 | Andersen | Education | Require the State Treasurer to establish an educational savings account for K-12 students enrolled in an approved or accredited public, private, denominational, or parochial school for use on qualified educational expenses. Under the Student Savings Account Support Fund, parents/guardians may apply annually for a \$1,500 grant per student for qualified educational expenses: (A) Tuition and fees; (B) Textbooks, software, and required course materials; (C) Fees or payments for educational therapies, including tutoring or cognitive skills training; (D) Educational materials and support services, including the cost of paraprofessionals and assistants, for enrolled students with a disability as defined in section 79-1118.01 or an enrolled student receiving services under a plan pursuant to the requirements of section 504 of the federal Rehabilitation Act of 1973, 29 U.S.C. 794; and (E) Any other academic or learning material approved by the State Board of Education. Qualified educational expenses does not include: (A) Transportation costs for the enrolled student; (B) The cost of food or refreshments consumed by the enrolled student; (C) The cost of clothing for the enrolled student; or (D) The cost of disposable materials, including, but not limited to, paper, notebooks, pencils, pens, and art supplies. State Board will adopt list of allowable expenses. Parents/guardians will be annually notified about need to apply. An account would be created for every qualified student and remains with that student until end of enrollment. Unexpended funds would then go back into State General Fund. | | 2/25 | | |
| LB429 | Murman | Education | A school board shall not grant access by a professional employees' organization to the physical or electronic mailbox of any school employee without giving equal access to any other professional employees' organization which requests such access. | | 2/18 | | advanced to General File (1-29-26) |
| LB430 | Murman | Education | Under the Student Discipline Act, additional requirements on written notice of punishment to parents must be provided. Also required are the following: (1) The actions made by the school to try to discontinue or alleviate the behavior of the student prior to considering suspension; (2) Resources the school can provide or recommend to assist the student; (3) How the school plans to handle such behavior moving forward, including an actionable plan aimed at maximizing strategies to keep the student in school. The bill would allow for the suspension of K-2 students if the student engages in violent behavior capable of causing physical harm to another student or school employee. | support | 3/17 | letter | |

| THIS WEEK | NEXT WEEK | | | | | | |
|-----------------------|-----------|-----------|---|----------------|--------------|----------|-----------------------|
| BILL | SENATOR | COMMITTEE | DESCRIPTION | NRCSA POSITION | HEARING DATE | TESTIFY? | STATUS |
| LB440 | Spivey | Education | Education Leave and Support Act. Beginning January 1, 2026, a payroll fee of thirty-five hundredths of one percent shall be levied on the taxable wages of covered employees in the state. Employers shall collect the fee from covered employees and remit it quarterly to the State Treasurer. Employers shall also contribute an amount equal to the total payroll fee collected from their covered employees as an employer match and remit this contribution quarterly to the State Treasurer. All fees and contributions collected under this section shall be credited to the State Education Leave Fund. The fund shall be used solely to reimburse school districts for the cost of hiring substitute teachers for the first six weeks of a covered employee's FMLA leave. Reimbursements under this section shall be made from the fund in an amount not to exceed the actual daily cost of hiring a substitute teacher, as determined by the department. Any covered employee for whom reimbursement is provided under this section shall not be required to use any accrued personal or sick leave for the first six weeks of FMLA leave. | | 3/10 | | Spivey priority bill. |
| 450 | Suarez | | A BILL FOR AN ACT relating to government; to amend section 59-1608.04, Revised Statutes Cumulative Supplement, 2024; to create the Nebraska Council on Economic Education Cash Fund; to state intent regarding appropriations; to provide for a transfer from the State Settlement Cash Fund; to repeal the original section; and to declare an emergency. | | | | |

| THIS WEEK | NEXT WEEK | | | | | | |
|-----------------------|-----------|------------------------------|--|----------------|--------------|----------|--|
| BILL | SENATOR | COMMITTEE | DESCRIPTION | NRCSA POSITION | HEARING DATE | TESTIFY? | STATUS |
| LB463 | Ballard | Health/ Human Services | <p>School districts are required to develop and adopt a cardiac emergency response plan. The plan must: (a) the establishment of a school cardiac emergency response team; (b) detail the activation of the team when an individual experiences sudden cardiac arrest on school grounds or at school-sponsored activities; (c) ensure the placement and maintenance of automated external defibrillators (AEDs) on school grounds; (d) stipulate appropriate personnel to receive training in first aid, cardiopulmonary resuscitation (CPR), and AED use; include annual practice drills for faculty and students; (e) ensure coordination with local emergency medical services providers; and (f) undergo annual review and evaluation by the school board. Schools must place AEDs on school grounds and at each school athletic venue when a school-sponsored activity or athletic event is taking place. The AEDs must be easily accessible, in unlocked locations, and identifiable with appropriate signage. They must be able to be retrieved and placed on an individual within three minutes. NDE will provide training for members of cardiac emergency response teams. NDE will create a grant program to help school districts with costs related to developing and implementing cardiac emergency response plans. The grants will be funded using the Medicaid Managed Care Excess Profit Fund, and priority will be given to school districts that receive Title I funds. The total amount of grants will not exceed \$1.5 million.</p> <p>AM1717 was introduced by Sen. Ballard to add to the original bill the following: (1) Establishing, in consultation with experts, including, but not limited to, nationally recognized cardiac emergency care and other emergency care experts, a cardiac emergency response plan template for use by schools in developing a plan to respond in the event of a sudden cardiac arrest on school grounds or at any school sponsored activity or event. Such template shall include recommended training; and (12) (11) Carrying out the department's responsibilities under the School Safety and Security Reporting System Act. Sec. 2. The Cardiac Emergency Response Plan Cash Fund is created. The fund shall be administered by the State Department of Education and shall be used to provide training and devices for use in response to a cardiac event recommended by the cardiac emergency response plan template established by the state school security director pursuant to section 79-2,144. Any money in the fund available for investment shall be invested by the state investment officer pursuant to the Nebraska Capital Expansion Act and the Nebraska State Funds Investment Act.</p> | | 2/27 | | General File (3/19). Voted to E&R Initial (1/16/26). |

| THIS WEEK | NEXT WEEK | | | | | | |
|-----------------------|-----------|-----------|--|----------------|--------------|----------|--------|
| BILL | SENATOR | COMMITTEE | DESCRIPTION | NRCSA POSITION | HEARING DATE | TESTIFY? | STATUS |
| LB481 | Ballard | HHS | Establishes the Foster Child Scholarships Act, creating the HOPE Scholarship Program to provide scholarships for Nebraska's foster children and their biological siblings. These scholarships will enable students to attend approved nonprofit private schools in Nebraska. The Department of Health and Human Services (DHHS) will oversee scholarship distribution and ensure compliance with eligibility requirements. Eligible students include foster children currently in the Nebraska foster care system and their biological siblings (even if not in foster care) if they were eligible to attend public school in the prior semester or are starting school for the first time. Students must attend an approved nonprofit private school that meets state accreditation and health/safety standards. Scholarship recipients will remain eligible until they graduate high school or reach the age of twenty-one, regardless of changes in foster care placement. DHHS will submit annual reports to the Governor and Legislature detailing program participation, scholarships awarded, and recipient demographics. The bill appropriates two hundred thousand dollars annually for fiscal years 2025-26 and 2026-27 to fund the program. | | 2/12 | | |
| LB492 | Conrad | Judiciary | Change provisions relating to juvenile court jurisdiction relating to habitual truancy. Habitually truant from school means that a child thirteen years of age or older and younger than seventeen years of age who is enrolled in a public or private school has accrued 20 or more of unexcused absences from school during a school year and has a documented loss of educational attainment as a result of such absences. It shall be a defense to adjudication of a petition alleging that a juvenile is a juvenile as described in the amendment, if, after subtracting any absences that are excludable under the amendment of this section, the child has accrued less than twenty days of unexcused absences from school during the school year. An absence shall not be counted as unexcused if such absence was caused by: (A) A lack of adequate transportation; (B) Failure by the school to coordinate necessary interventions or attendance supports agreed upon by the school and the child's family; or (C) Physical or mental illness excused by a parent or guardian, with or without a note from a doctor or physician; | | 3/27 | | |

| THIS WEEK | NEXT WEEK | | | | | | |
|-----------------------|-----------|-----------|---|----------------|--------------|----------|--------|
| BILL | SENATOR | COMMITTEE | DESCRIPTION | NRCSA POSITION | HEARING DATE | TESTIFY? | STATUS |
| LB494 | Dorn | Revenue | Adjusts the distribution of funds to provide property tax relief while also managing state reserves. If the difference between actual and estimated receipts is positive and the difference between the current year's actual receipts and 103% of the prior year's actual receipts is negative, the positive difference is transferred to the Cash Reserve Fund. If both differences are positive, and the actual vs. estimated difference is greater than the difference between the current and 103% prior year receipts, the difference between these two differences is transferred to the Cash Reserve Fund, and the amount representing the difference between the current and 103% of the prior year's receipts is transferred to the School District Property Tax Relief Credit Fund. If both differences are positive, and the actual vs. estimated difference is less than the difference between the current and 103% of the prior year's receipts, the actual vs. estimated difference is transferred to the School District Property Tax Relief Credit Fund. | | 3/6 | | |
| LB497 | Murman | Education | A school board shall admit a student who is also enrolled (a) in a private, denominational, or parochial school or (b) in a home school setting, without charge for part-time enrollment in the school district for purposes of participation in extracurricular activities if the school district where the student or the student's parent resides does not offer the extracurricular activity in which the student desires to participate through part-time enrollment and the school district in which the student is attempting to attend part-time is the closest school district to where the student or the student's parent resides that offers such extracurricular activity. In order to participate, the district not require enrollment for more than five credit hours, but may not prohibit a student from enrolling in more than five credit hours. | oppose | 3/3 | letter | |
| LB498 | Murman | Education | Changes provisions related to foundation aid. For school fiscal year 2025-26 and each succeeding school fiscal year, the foundation aid to be paid to each school district in each school fiscal year shall equal (i) the amount of foundation aid paid per formula student in the immediately preceding school fiscal year, increased by the percentage increase in the Consumer Price Index for All Urban Consumers published by the Federal Bureau of Labor Statistics for the previous calendar year, multiplied by (ii) the number of formula students for the school district. | | 2/10 | | |

| THIS WEEK | NEXT WEEK | | | | | | |
|-----------------------|-----------|-----------|---|----------------|--------------|----------|--------|
| BILL | SENATOR | COMMITTEE | DESCRIPTION | NRCSA POSITION | HEARING DATE | TESTIFY? | STATUS |
| LB500 | DeBoer | Education | Creates the School Finance Review Commission. Commissioner of Ed or his designee shall chair the Commission. Membership is outlined, but does not specifically identify representation from Class 1 or Class II districts. Outlines the issues to be examined by the Commission. Final report to be presented to the Legislative Council by November, 2025. The Commission will reconvene every even numbered year. AM 123 provides for representation from Class I and Class II schools. | support | 2/10 | letter | |
| LB507 | Hunt | Education | Change provisions for providing transportation for students with disabilities. Provide for the transportation expenses within the school district of any child with a disability enrolled in the school district who is enrolled in a special educational program of the district when either (i) the child is required to attend a facility other than what would be the normal school or attendance facility of the child to receive appropriate special educational services or (ii) the nature of the child's disability is such that special transportation is required. | | 2/11 | | |

| THIS WEEK | NEXT WEEK | | | | | | |
|-----------------------|------------|-----------|--|----------------|--------------|----------|--------|
| BILL | SENATOR | COMMITTEE | DESCRIPTION | NRCSA POSITION | HEARING DATE | TESTIFY? | STATUS |
| LB509 | Sorrentino | Revenue | <p>Opportunity Scholarships Act. Very similar to LB 753 from two years ago. Scholarship granting organization awards scholarships that will limit scholarship amounts awarded to students in a manner that assures that the average of the scholarship amounts awarded per student does not exceed 75% of the statewide average general fund operating expenditures per formula student for the most recently available complete data year.</p> <p>An individual taxpayer who makes one or more cash contributions to one or more scholarship-granting organizations during a tax year shall be eligible for a credit against the income tax due under the Nebraska Revenue Act of 1967. Except as otherwise provided in the Opportunity Scholarships Act, the amount of the credit shall be equal to whichever of the following amounts is the lowest: (a) The total amount of such contributions made during the tax year; (b) 50% of the income tax liability of such taxpayer for the tax year; or (c) \$100,000. The tax credit allowed shall be a nonrefundable credit. Any amount of the credit that is unused may be carried forward and applied against the taxpayer's income tax liability for the next five years immediately following the tax year in which the credit is first allowed.</p> <p>The annual limit on the total amount of tax credits for calendar years 2025, 2026, and 2027 shall be \$25 million. The annual limit on the total amount of tax credits for calendar year 2028 and each calendar year thereafter shall be calculated by taking the annual limit from the prior calendar year and then multiplying such amount by (a) 125% if the intended tax credit amounts in the prior calendar year exceeded 90% of the annual limit applicable to that calendar year or (b) 100% if the intended tax credit amounts in the prior calendar year did not exceed 90% of the annual limit applicable to that calendar year. The annual limit may be increased until it reaches \$100 million.</p> <p>In order for a scholarship-granting organization to remain certified under the Opportunity Scholarships Act, the scholarship granting organization shall allocate at least 90% of its revenue for education scholarships and no more than 10% of its revenue shall be used or reserved for administrative costs.</p> | oppose | 2/6 | testify | |

| THIS WEEK | NEXT WEEK | | | | | | |
|-----------------------|-----------|-----------|--|----------------|--------------|----------|--------|
| BILL | SENATOR | COMMITTEE | DESCRIPTION | NRCSA POSITION | HEARING DATE | TESTIFY? | STATUS |
| LB517 | Juarez | Education | Included in school security plans provided to the state school security director shall be annual inspection information of protective door assemblies, door-locking systems, and double-entry doors of school buildings within the school district. Standards shall be established related to protective door assemblies in each school building that is used for the instruction of students, which shall include requiring that every school board cause an annual inspection of all applicable protective door assemblies to be conducted by a trained inspector with appropriate knowledge, training, and experience relating to door assemblies and building security. For purposes of the bill, protective door assemblies means (a) doors with panic hardware or fire exit hardware, (b) door assemblies in exit enclosures, (c) electronically controlled egress doors, and (d) door assemblies with special locking arrangements, such as delayed egress, sensor-released egress doors, and elevator-lobby doors. | | 2/18 | | |
| LB523 | Juarez | Education | Student Teacher Compensation Act. NDE would be required to develop a stipend program to provide financial compensation to student teachers as provided in this section. The department shall provide a stipend of four thousand dollars per student-teaching semester to any student teacher that applies for a stipend. A student teacher would be required to show financial need to be eligible. The Legislature would appropriate funds each year for the program. | support | 3/11 | letter | |
| LB524 | Juarez | Education | Authorizes paraeducator grants under the Nebraska Teacher Recruitment and Retention Act. Would allow paraeducators to receive retention grants. If a paraeducator signs a contract to work an average 28 hours per week or more, they would receive a \$1,000 grant. If a paraeducator works less than an average of 28 hours per week, they would receive a grant proportional to their average work hours per week. | support | 3/11 | letter | |

| THIS WEEK | NEXT WEEK | | | | | | |
|-----------------------|-----------|-----------|--|----------------|--------------|----------|--|
| BILL | SENATOR | COMMITTEE | DESCRIPTION | NRCSA POSITION | HEARING DATE | TESTIFY? | STATUS |
| LB528 | Jacobson | Education | Transfers control of the learning platform grant from the Department of Education to the Department of Economic Development. Changes also include clarifying language regarding use of the grant funds, an emphasis on teaching chemistry or physical science standards, and requires applicants to meet minimum data security and implementation experience standards. Department of Economic Development shall establish a grant program to procure or purchase an annual license for a preexisting learning platform for use in schools to engage students in coursework and careers in science, technology, and engineering. The grant shall be funded using lottery funds. Grant funds shall only be used to procure or purchase an annual license and shall not be awarded for the purpose of research and development of a learning platform. The Dept. of Economic Development will set the criteria to prioritize grant applications. The learning platform must align with the academic content standards established by the State Board of Education. A grant application approved by the Department of Economic Development shall be awarded from the State Department of Education Improvement Grant Fund administered by the State Department of Education. | | 3/3 | | |
| LB538 | Hardin | Education | School boards required to adopt a policy relating to discrimination and antisemitism. The school board shall include antisemitism awareness training as part of other trainings on harassment provided by such school district to students and employees. Each school district shall formally report any incident or complaint of antisemitic discrimination and harassment to NDE. The Commissioner of Education shall designate a Title VI coordinator within NDE. The Title VI coordinator shall monitor discrimination and harassment in school districts, including antisemitic discrimination. If, after a reasonable investigation, the coordinator determines that a school district has engaged in, allowed, or not sufficiently prohibited discrimination or harassment, including antisemitic discrimination, in violation of such policy or the federal Civil Rights Act of 1964, the coordinator shall give written notice to the school board and require the school board to address the violation and comply with such policy and act. If the school board does not comply within 30 days after written notice by the coordinator, the coordinator shall report its finding to the United States Department of Education and the United States Department of Justice by making a complaint under Title VI of the Civil Rights Act of 1964. Antisemitic discrimination or antisemitism has the same meaning as the International Holocaust Remembrance Alliance's working definition of antisemitism as adopted in 2016. The bill also extends to University of Nebraska, State Colleges, and community colleges. CONRAD'S AMENDMENT | | 2/3 | | Strommen priority. Placed on General File with AM1385 (5/20). Advanced to Enrollment and Review Initial (1/30/26). Hardin priority |

| THIS WEEK | NEXT WEEK | | | | | | |
|-----------------------|------------|-----------|---|----------------|--------------|----------|--------|
| BILL | SENATOR | COMMITTEE | DESCRIPTION | NRCSA POSITION | HEARING DATE | TESTIFY? | STATUS |
| LB549 | Lippincott | Education | A school board may employ a chaplain, including in a volunteer capacity, to perform various duties at the school including providing academic, career, emotional, and behavioral health supports to students. A chaplain employed within the bill shall not be required to hold a certificate to teach, administer, or perform special services in this state. A school board shall, prior to employment of a chaplain, develop a policy relating to employment of an uncertified individual to perform various duties at the school as described in subdivision (2)(a) of this section. The policy shall include provisions relating to the employment, discipline, continued education, and termination of employment of a chaplain. No school shall be required to hire a chaplain. | oppose | 2/24 | letter | |
| LB550 | Lippincott | Education | Requires each school district shall adopt a policy that excuses any student of the school district to attend a released time course for at least one class period per week. The policy shall require: (a) parent or guardian written approval, (b) the sponsoring entity to maintain attendance records and make such records available to the school district the student attends (c) the sponsoring entity, parent or guardian, to provide transportation to and from the place of instruction, and (d) the sponsoring entity to make provision and assume liability for each student that attends its released time course while under the control of the sponsoring entity. The district may adopt a policy providing earned credit for such courses. | oppose | 3/3 | letter | |
| LB551 | Lippincott | Education | Prohibits the practice of academic tenure at postsecondary educational institutions governed by the Board of Regents of the University of Nebraska, the Board of Trustees of the Nebraska State Colleges, or a community college board of governors. | | | | |
| LB557 | Armendariz | Education | A parent or legal guardian of a student whose option enrollment application is rejected by the school district shall be eligible to receive two thousand five hundred dollars to support the student's education during the applicable school year in which the option enrollment application was denied. The parent or guardian may apply to NDE to receive the educational support payment. Upon evidence of the rejected application, NDE shall provide the educational support payment to the parent or legal guardian of the student. The payment shall be used at the parent's or legal guardian's discretion for the educational support of the student. Such payment shall not be considered taxable income. The option enrollment program is radically changed so that a local Board of Education would find it very difficult to set standards for denial of option enrollment applications. | oppose | 2/25 | testify | |

| THIS WEEK | NEXT WEEK | | | | | | |
|-----------------------|--------------|-----------------|--|----------------|--------------|---------------------------------------|--------|
| BILL | SENATOR | COMMITTEE | DESCRIPTION | NRCSA POSITION | HEARING DATE | TESTIFY? | STATUS |
| LB564 | Brandt | Revenue | Beginning in 2025-26 and each year following, the amount transferred from the General Fund to the School District Property Tax Relief Credit Fund shall be equal to the total amount transferred in the preceding fiscal year increased by one hundred fifty million dollars. This changes from the 3% increase under current statute. | | 3/6 | | |
| LB567 | Quick | Education | On or before December 1, 2025, the State Board of Education may develop and adopt a model policy for use in school districts relating to community engagement to increase engagement between schools, students and their families, and surrounding communities. A school district may adopt a policy relating to engagement between schools, students and their families, and surrounding communities. The policy shall be consistent with NDE's model policy. | support | 2/4 | letter | |
| LB572 | Hughes | Education | Authorizes a school district to exceed its budget authority for the general fund budget of expenditures for expenditures for stipends paid to a student teacher or intern. | support | 3/3 | letter | |
| LB575 | Hallstrom | Revenue | Changes the dates for a joint public hearing under the "pink postcard bill" to between July 14 and July 24 (from the current Sept. 14 and Sept 24). If the total taxable valuation of property in a political subdivision exceeds the total taxable valuation from the prior year, then the political subdivision's levy shall be no more than the levy necessary to raise the exact same amount of property taxes as was raised by the political subdivision in the prior year. A political subdivision may exceed the levy limit provided in this subsection upon the affirmative vote of at least two-thirds of the members of the governing body of such political subdivision. | oppose | 2/20 | GNSA testify (including others NRCSA) | |
| LB579 | M. Cavanaugh | Executive Board | Prohibit charging a fee for public records requests by members of the Legislature | | 2/18 | | |
| LB589 | Conrad | Education | The allowable and reimbursable costs for special education and support services shall include substitute service costs directly associated with special education programs. Each school district shall provide special education staff with four days of professional leave per year, supported by substitute personnel. Such leave shall be used onsite for the sole purpose of completing essential documentation for students receiving special education services on such staff's caseload. | support | 2/11 | letter | |

| THIS WEEK | NEXT WEEK | | | | | | |
|-----------------------|-----------|-----------|--|----------------|--------------|----------|--------|
| BILL | SENATOR | COMMITTEE | DESCRIPTION | NRCSA POSITION | HEARING DATE | TESTIFY? | STATUS |
| LB597 | DeBoer | Education | <p>For school fiscal year 2025-26 and each school fiscal year following, the foundation aid to be paid to each school district in each school fiscal year shall equal the greater of:(i) One thousand five hundred dollars multiplied by the number of formula students for such school district; or (ii) 7.5% of the basic funding calculated pursuant to section 79-1007.16 for such school district.</p> <p>Beginning with school fiscal year 2025-26 and for each school fiscal year thereafter: (a) For state aid certified pursuant to section 79-1022, the local effort rate shall be the maximum levy, for the school fiscal year for which aid is being certified, authorized pursuant to subdivision less ten cents; (b) for the final calculation of state aid pursuant to section 79-1065, the local effort rate shall be the rate which, when multiplied by the total adjusted valuation of all taxable property in local systems receiving equalization aid pursuant to the Tax Equity and Educational Opportunities Support Act,,will produce the amount needed to support the total formula need of such local systems when added to state aid appropriated by the Legislature and other actual receipts of local systems described in section 79-1018.01; and (c) the local effort rate yield for such school fiscal years shall be determined by multiplying each local system's total adjusted valuation by the local effort rate.</p> <p>For the adjusted valuation on ag land and horticultural land used for the calculation of aid for school fiscal year 2025-26 and each school fiscal year thereafter, 65% of actual value, down from 72%.</p> <p>AM 183 filed by Sen. DeBoer.</p> | | 2/10 | | |

| THIS WEEK | NEXT WEEK | | | | | | |
|-----------------------|-----------|----------------|---|----------------|--------------|----------|--------|
| BILL | SENATOR | COMMITTEE | DESCRIPTION | NRCSA POSITION | HEARING DATE | TESTIFY? | STATUS |
| LB598 | DeBoer | Education | <p>Provides state funding to school districts to cover extraordinary increases in limited English proficiency student expenditures. A school district with expected expenditures for limited English proficiency students that total (a) at least \$50,000 annually or (b) one-half percent or more of such school district's annual budget, whichever is greater, may submit an application as prescribed by the Commissioner of Education to the State Department of Education for a payment from the Education Future Fund to cover an extraordinary increase in limited English proficiency student expenditures pursuant to the requirements in the bill. Each applicant school district shall qualify for a maximum payment equal to the difference of the limited English proficiency student expenditures for the current school fiscal year submitted pursuant to subsection (1) of this section minus the amount calculated pursuant to subsection (3) of this section for such school district for such school fiscal year.</p> <p>An elementary attendance site that provides at least sixty minutes of planning time per school day to its elementary school teachers shall qualify for an additional funding allowance as part of the elementary site allowance equal to one hundred percent of the statewide average general fund operating expenditures per formula student multiplied by the ratio of the fall membership attributed to the elementary attendance site divided by eight.</p> | support | 2/11 | letter | |
| LB599 | DeBoer | Education | <p>The State Board of Education shall adopt a policy that may be used in approved or accredited public, private, denominational, and parochial schools and educational service units relating to cybersecurity. The creation of a cybersecurity team that would act to assist schools and educational service units with cybersecurity needs and addresses cybersecurity issues from a statewide perspective to prevent and respond to cybersecurity threats. The policy would provide for a funding mechanism to assist in purchasing necessary cybersecurity controls and facilitating the acquisition of cybersecurity projects.</p> | support | 3/11 | letter | |
| LB624 | Dover | Appropriations | <p>State appropriation of \$10 million from the state General Fund annually to the State Treasurer to contract to provide education scholarships to low-income and at-risk elementary and secondary students to increase their access to educational choice and opportunities at approved or accredited private, denominational, or parochial schools. The appropriation shall only be used for such purpose.</p> | oppose | 2/24 | letter | |

| THIS WEEK | NEXT WEEK | | | | | | | |
|-----------------------|-----------|-----------|--|----------------|---------------------------------|---------------------------|---------------------|--|
| BILL | SENATOR | COMMITTEE | DESCRIPTION | NRCSA POSITION | HEARING DATE | TESTIFY? | STATUS | |
| LB625 | Dover | Education | The Department of Revenue shall develop, maintain, and make available for public inspection on its website a database of financial information from all school districts in the state. The information required shall include, but not be limited to, revenue sources, expenditures, and a balance sheet that contains all assets and liabilities, which reflects all committed and uncommitted funds. School districts shall provide to the department such information as is necessary to develop and maintain the database. School districts shall provide updated information to the department on an annual basis, and the department shall update the database no later than thirty days after receiving any such information. AM | | 2/3 | | General File (2/24) | |
| LB631 | Hansen | Education | Changes the amount to be transferred from the General Fund to the School Emergency Response Mapping Fund for fiscal year 2025-26 from \$525,000 to \$4 million. One time expenditure. | | 2/18 | | | |
| LB633 | Hansen | Education | Creates the Nebraska Option Enrollment Tuition Account Program. If a student is denied option enrollment in a public school, the parent/guardian may apply for a scholarship to attend a private school. The amount shall be: (a) an amount equal to the adjusted average per pupil cost of the preceding year; and (b) for an eligible student who has a disability an additional amount of funds equal to the reimbursement rate of the eligible student's resident school district. | oppose | 2/25 | testify (included STANCE) | | |
| LB652 | Hansen | Education | The Board of Educational Lands and Funds would be terminated on July 23 1, 2027. The Department of Administrative Services would assume control of all school lands that had been under the general management and control of the board immediately prior to the board's termination. The department shall sell such lands as the leases for the lands expire. The person who was leasing the land most recently shall have the right of first refusal to purchase the land. If such person does not purchase the land, the department shall sell the land at public auction. The proceeds of the sales of such lands shall be remitted to the State Treasurer for credit to the permanent school fund of the state. In addition, any funds placed into the temporary school fund of the state by the board that remain in such fund on July 1, 2027, shall be distributed to the school districts of the state. | oppose | 3/10/2025. combined with LR28CA | NSEA (including NRCSA) | | |

| THIS WEEK | NEXT WEEK | | | | | | |
|-----------|-----------|-----------|--|----------------|--------------|----------|--|
| BILL | SENATOR | COMMITTEE | DESCRIPTION | NRCSA POSITION | HEARING DATE | TESTIFY? | STATUS |
| LB653. | Murman | Education | <p>AM1701, filed in the 2026 session, would strike all sections and amendments from the 2025 bill. AM653 would require that a school shall automatically accept applications to siblings of option students enrolled in the option school district without regard to capacity limitations.</p> <p>The Student Discipline Act would also be amended to add requirements to the district in a short-term suspension to include notice to the parents of the actions made by the school to try to discontinue or alleviate the behavior of the student prior to considering suspension; Resources the school is able to provide or recommend to assist the student; and How the school plans to handle such behavior in the future, including an actionable plan aimed at maximizing strategies to keep the student in school. This must be done within 48 hours. In the case of a long-term suspension, additional requirements on the part of the school that are added to the communication to the parents include resources the school is able to provide or recommend to assist the student; and how the school plans to handle such behavior in the future, including an actionable plan aimed at maximizing strategies to keep the student in school. This must be part of the rights of the student communicated to the parents within 2 school days of the decision.</p> <p>The prohibition on school districts from suspending pre-school through 2nd grade student to allow for a suspension in the case of the student bringing a deadly weapon on school property or at a school event, as well as for engaging in violent behavior capable of causing physical harm to another student or school employee. AM1701 ADDED (2026)</p> | | | | <p>Education Committee priority bill. Advanced to General File w/ AM 995 (4/15/25). Advanced to Enrollment and Review Initial with AM1701. (1/23/26)</p> |

| THIS WEEK | NEXT WEEK | | | | | | |
|-----------------------|---------------------|----------------|---|----------------|--------------|----------|--------|
| BILL | SENATOR | COMMITTEE | DESCRIPTION | NRCSA POSITION | HEARING DATE | TESTIFY? | STATUS |
| LB670 | Murman | Education | <p>Each school board of a school district and each governing board of a nonpublic school shall adopt and maintain a safety plan and may use the model safety plan developed by the state school security director as a guide. Such plan shall be updated annually and shall at a minimum include: (a) Fire drills and instruction on fire dangers and methods of fire prevention; (b) Tornado or other weather-related preparedness drills and instruction; (c) Vehicle safety and emergency evacuation drills and instruction; and (d) Any other safety and emergency drills or instruction deemed appropriate by the school board or governing board. (2) Each school district shall provide the school district's safety plan to the state school security director every three years. (3) The state school security director may provide suggestions and offer training or other resources relating to safety plans to any school.</p> <p>The State Board of Education shall not adopt and promulgate rules and regulations that require more than four hours of annual inservice training for (i) teachers, (ii) paraeducators, or (iii) home visitors who have regular contact with children in prekindergarten programs.(b) A school board may elect to require additional training for the employees of such school district.</p> | | 2/4 | | |
| LB671 | Murman | Education | NDE technical cleanup bill. | | 3/18 | | |
| LB677 | Hansen | Gen'l Affairs | Change provisions of the Nebraska Medical Cannabis Regulation Act an | | | | |
| LB678 | Hardin | Appropriations | There is hereby appropriated (1) \$XXX from the General Fund for FY2025-26 and (2) \$XXX from the General Fund for FY2026-27 to the Board of Trustees of the Nebraska State Colleges, for Program 48, for salary increases required by negotiated agreements with the Nebraska Association of Public Employees, the State College Education Association, and the Nebraska State College System Professional Association, for minimum wage increases required by the Wage and Hour Act, and for increases in health insurance premiums. | | | | |
| LB680 | Education Committee | Education | shell bill on ESUs | | 3/18 | | |
| LB681 | Education Committee | Education | shell bill | | | | |

| THIS WEEK | NEXT WEEK | | | | | | |
|-----------------------|---------------------|-----------|---|----------------|--------------|----------|--------|
| BILL | SENATOR | COMMITTEE | DESCRIPTION | NRCSA POSITION | HEARING DATE | TESTIFY? | STATUS |
| LB682 | Education Committee | Education | <p>Updates terminology related to an individualized education program (from individualized education plan) for a student for provisions regarding a certificate of attendance at a school district or participation in high school graduation.</p> <p>AM 566 says that any contract for employment as a superintendent of a school district entered into or renewed on or after the effective date of this act shall include a provision prohibiting the superintendent from receiving employment income other than such individual's employment income from the school district for employment as the superintendent and any income specifically stipulated in the contract during such contract term. Employment income means income paid or otherwise provided to an employee by an employer in the education field resulting from the employer-employee relationship or income resulting from a contract as an independent contractor for certain contracted education-related work, such as (i) work on any education-related foundation, board, commission, or similar entity or (ii) consulting or advising on education-related matters.</p> | oppose AM 566 | 3/17 | letter | |

| THIS WEEK | NEXT WEEK | | | | | | |
|-----------------------|-----------|-----------|---|----------------|--------------|----------|--------|
| BILL | SENATOR | COMMITTEE | DESCRIPTION | NRCSA POSITION | HEARING DATE | TESTIFY? | STATUS |
| LB683 | Raybould | Revenue | <p>Each county assessor shall transmit assessed valuation notices to the Department of Administrative Services for printing by the state. Notices shall be delivered given by first-class mail addressed to the owner's last-known address. It shall identify the item of real property and display a column for the prior tax year and the current tax year. Under the column for the prior tax year, the notice shall display the valuation of the parcel in the prior year and the amount each political subdivision levied against the parcel in the prior year. Under the column for the current tax year, the notice shall display the valuation of the parcel in the current year and the time and place when each political subdivision levying a tax against the parcel is convening the budget hearing of each political subdivision. The notice shall state the following, in a font size larger than any other font appearing on the notice: "KNOW YOUR RIGHTS: If you believe the valuation of the parcel described in this notice to be in error, you may file a protest of this valuation with the county clerk on or before June 30, and your protest shall be heard and decided by the county board of equalization. If you are concerned about the effect your valuation may have on how much tax will be levied against your parcel, you are encouraged to attend any and all of the budget hearings for the above-listed political subdivisions. Please be advised that the same levy rate from the prior year applied to an increased valuation in the current year will result in a higher levy of taxes; a levy rate higher than the prior year applied to the same valuation in the current year will also result in a higher levy of taxes." The notice shall also state the old and new valuation, the date of convening of the county board of equalization , and the dates for filing a protest. The notice shall also state the following: "The time and place of the budget hearings have been reported to the county assessor by each political subdivision. Such time and place can change based on unforeseen circumstances. You are encouraged to verify with each political subdivision that the time and place of the budget hearings has not changed." On or before May 15, each political subdivision levying a tax against property shall inform the county assessor of every county in which the political subdivision has the authority to levy a tax against property of the time and place such political subdivision's budget hearing will convene.</p> | support | 3/20 | letter | |

| THIS WEEK | NEXT WEEK | | | | | | | |
|-----------------------|-----------|------------|--|----------------------|--------------|---------------------|---|--|
| BILL | SENATOR | COMMITTEE | DESCRIPTION | NRCSA POSITION | HEARING DATE | TESTIFY? | STATUS | |
| LB685 | Lonowski | Education | The school board or governing body of each approved or accredited public, private, denominational, or parochial school shall have one exterior secure master key box that meets Underwriters Laboratories Standard 1037 installed at each school building to permit emergency access from the exterior of a school building to law enforcement. The school board or governing body shall work with local law enforcement authorities in the school district on the precise location of the secure master key box required pursuant to this section. The school board or governing body shall adopt a policy consistent with this section. The department shall establish a subaccount for the \$1 million transferred from the Cash Reserve Fund on or after the effective date of this act. The money in the subaccount shall be used to provide grants for the exterior secure master key boxes. | | 2/18 | | | |
| LB689 | Lonowski | Retirement | Changes definition for "intermittent basis" from not more than 8 days in a calendar month to simply mean "work provided on a day-to-day basis". AM 734 (Lonowski) would change 8 days per month to 40 days in a semester. IRS concerns could cause issues for the sub, district, and possibly the State Retirement System. | opposed to amendment | 3/28 | Ed Coalition letter | Lonowski may ask to not move bill forward | |
| LB691 | Murman | Education | School board of a public school district and each governing board of an approved or accredited private, denominational, or parochial school that receives state funds shall display the Ten Commandments in each classroom. The nature of the Ten Commandments display shall be determined by each school board or governing board, but shall at a minimum: (a) Focus on the text of the Ten Commandments in an easy-to-read font; (b) Be displayed on a poster or framed document that is at least eleven inches by fourteen inches in size. Mandates specific language for the Ten Commandments. May take donations to pay for the displays. | oppose | 2/24 | letter | | |

| THIS WEEK | NEXT WEEK | | | | | | |
|------------------------|-------------------------|-------------------------------|--|----------------|--------------|------------------------------------|--------------------|
| BILL | SENATOR | COMMITTEE | DESCRIPTION | NRCSA POSITION | HEARING DATE | TESTIFY? | STATUS |
| LB692 | Murman | Revenue | <p>Under current law, a school district's property tax request authority is the school district's property tax request from the prior year shall be added to the non-property-tax revenue from the prior year minus any investment income from special building funds from the prior year, and the total shall be increased by the school district's base growth percentage. That amount is then decreased by the amount of total non-property-tax revenue for the current year and adjusted for any known or documented errors in documentation received by the department from the school district.</p> <p>If passed, a school district's property tax request authority is the school district's property tax request from the prior year, minus the amount, if any, the property tax request exceeded the school district's property tax request authority in the prior year would be added to the non-property-tax revenue from the prior year minus any investment income from special building funds from the prior year, and the total shall be increased by the school district's base growth percentage. That amount is then decreased by the amount of total non-property-tax revenue for the current year and adjusted for any known or documented errors in documentation received by the department from the school district.</p> | oppose | 2/13 | GNSA (included NRCSA in testimony) | |
| LB711 | Hunt | Education | In reference to formula needs in TEEOSA, a district may apply to the department for a two year new schools (changed from school) adjustment. provides for additional funding for high growth school districts based on estimated additional student capacity. | | 3/11 | | |
| LB713 | Ballard | Retirement | Retirement shell bill. | | 3/28 | | |
| LB714 | Clements | Transportation/Communications | Changes the percentage allocation from motor vehicle taxes for government subdivisions. School districts would be reduced from 60% to 37%. | oppose | 3/4 | | |
| LR12CA | Kauth | | | | | | Anderson priority. |
| LR16CA | Urban Affairs Committee | Government | Constitutional Amendment: The Legislature shall not impose responsibility for a program created after the year 2026 or an increased level of service required under an existing program after the year 2026 on any political subdivision of the state unless the political subdivision is fully reimbursed by the state for the cost of such program or increase in level of service. Reimbursement by the state shall be in the form of a specific appropriation or an increase in state distribution of revenue to such political subdivision. | support | 2/27 | testify | |

| THIS WEEK | NEXT WEEK | | | | | | |
|------------------------|------------|------------|--|----------------|-----------------------------|------------------------|---|
| BILL | SENATOR | COMMITTEE | DESCRIPTION | NRCSA POSITION | HEARING DATE | TESTIFY? | STATUS |
| LR18CA | Government | Government | The Legislature shall not impose responsibility for a program created after the year 2026 or an increased level of service required under an existing program after the year 2026 on any political subdivision of the state unless the political subdivision is fully reimbursed by the state for the cost of such program or increase in level of service. Reimbursement by the state shall be in the form of a specific appropriation or an increase in state distribution of revenue to such political subdivision. | support | 2/27 | testify | Placed on General File (3/11). Not advanced (1/16/26) |
| LR28CA | Hansen | | A constitutional amendment to eliminate provisions creating the Board of Educational Lands and Funds and providing for management of certain land owned by the state. | oppose | 3/11, combined with LB 652. | NSEA (including NRCSA) | |
| | | | | | | | |
| | | | | | | | |
| 2026 BILLS | | | | | | | |

| THIS WEEK | NEXT WEEK | | | | | | |
|-----------------------|-----------|------------|---|----------------|--------------|----------|----------------|
| BILL | SENATOR | COMMITTEE | DESCRIPTION | NRCSA POSITION | HEARING DATE | TESTIFY? | STATUS |
| LB730 | Kauth | Government | <p>The governing body of a public school shall designate each group restroom within each school building as one of the following: For use by females, for use by males, single occupancy, or for use by families. Except as provided, the governing body of a public school shall not (i) Allow a male to use a restroom designated for use by females; or (ii) Allow a female to use a restroom designated for use by males. This subsection shall not apply to: (i) An individual entering a restroom under the following circumstances: (A) Entrance for custodial, maintenance, or inspection purposes so long as such individual takes reasonable steps to ensure that no individual of the opposite sex is in a state of undress prior to entering the restroom; or (B) Entrance to render emergency assistance; or (ii) A parent or caregiver bringing a minor child or an individual with a disability that is of the opposite sex of such parent or caregiver into a restroom designated for such parent's or caregiver's sex.</p> <p>Except as provided, the governing body of a public school shall not: (i) Allow a male to enter or use a locker room designated for and being used at such time by one or more females; or (ii) Allow a female to enter or use a locker room designated for and being used at such time by one or more males. This subsection shall not apply to an individual entering a locker room under the following circumstances: (i) Entrance for custodial, maintenance, or inspection purposes so long as such individual takes reasonable steps to ensure that no individual of the opposite sex is in a state of undress prior to entering the locker room; (ii) Entrance to render emergency assistance; or (iii) Entrance by a coach, athletic trainer, or other authorized official or school employee so long as such individual takes reasonable steps to ensure that no individual of the opposite sex is in a state of undress prior to entering the locker room.</p> <p>The governing body of each public school shall adopt a policy implementing this section. Such policy shall include provisions regarding the conduct of visitors and the public. The governing body of a public school or any official or employee of a public school shall not retaliate against any individual for reporting in good faith a violation of this section or related rules, regulations, or policies.</p> <p>The same regulations apply to post-secondary schools and state agencies.</p> | monitor | 1/28 | | Kauth priority |

| THIS WEEK | NEXT WEEK | | | | | | |
|-----------------------|------------|-----------|--|----------------|--------------|----------|----------------------------------|
| BILL | SENATOR | COMMITTEE | DESCRIPTION | NRCSA POSITION | HEARING DATE | TESTIFY? | STATUS |
| LB742 | McKinney | Education | <p>Allows for 7th and 8th graders to compete in high school sports under the following conditions: (i) The student possesses the appropriate skill level as approved by the appropriate coach or athletic director at such school on a sport specific level with additional scrutiny given in relation to skill and safety if the student is requesting to participate or compete in a high school contact sport; (ii) The student has had a documented physical or evaluation by a health care professional to ensure safe participation with additional scrutiny given if the student is requesting to participate and compete in a high school contact sport; (iii) The student has provided written consent from the student's parent, legal guardian, or educational decisionmaker, (iv) Such participation by a seventh or eighth grade student in the high school sport requested is not prohibited by an athletic association</p> <p>such school is a member of, any state or federal law, or any rules and regulations adopted and promulgated by the State Board of Education. A student authorized to participate or compete in a high school sport pursuant to this section shall no longer be eligible to participate in such sport at the seventh or eighth grade level.</p> <p>A student's participation in a high school sport shall not impact the student's eligibility to participate or compete in such sport while the student is in high school.</p> <p>The State Board of Education may adopt and promulgate rules and regulations to carry out the bill.</p> | oppose | 2/2 | letter | |
| LB745 | Juarez | Education | <p>Removes the minimum age at which the Commissioner of Education may issue a diploma of high school equivalency. Also removes the requirement that it be at least one year that his/her high school class would have been graduated before the diploma may be awarded.</p> <p>Maintains the qualifications that the person is and has been a resident of Nebraska for at least 30 days immediately preceding application or if his or her final period of high school attendance during which credit was earned toward graduation was in a Nebraska high school; (2) On the basis of such person's achievements in approved tests and other criteria deemed pertinent by the Commissioner of Education, there is reasonable certainty that he or she has attained the educational development and abilities of the typical high school graduate; and (3) Such person is unable to secure a diploma from the high school he or she last attended</p> | | 1/26 | | Placed on General File (1-29-26) |
| LB748 | Sorrentino | Education | Education Savings Plan Administrative Fund | | | | Placed on General File (1-29-26) |

| THIS WEEK | NEXT WEEK | | | | | | |
|-----------------------|----------------------|------------|---|----------------|--------------|----------------------|--------|
| BILL | SENATOR | COMMITTEE | DESCRIPTION | NRCSA POSITION | HEARING DATE | TESTIFY? | STATUS |
| LB765 | Holdcroft | Government | <p>Number of voters in a school bond election must be 50.1% of total voters in the school district.</p> <p>Public funds, including building funds, cash funds, and discretionary funds, shall not be used in any way to support or advocate for any campaign meant to influence potential voters in a school district bond election. Funds donated or raised privately, including from sources such as concession sales, booster clubs, and parent-teacher organizations are not considered public funds for purposes of this subsection and are not subject to such prohibition.</p> <p>No employee of any school district or educational service unit shall devote any paid work time to support or advocate for, any campaign meant to influence potential voters in a school district bond election. Such employees may provide general information to patrons regarding a school district bond issue, such as subject matter, the amount of the bond, and the date of the election.</p> <p>Campaign materials, including, but not limited to, fliers, literature, signage, or apparel supporting or advocating for a proposed school district bond shall not be distributed or posted in or on any facility, grounds, or mode of conveyance connected to or associated with any school district or educational service unit properties. Informational materials that do not advocate for a proposed school district bond but simply provide generic information about such bond are allowed. The bill also applies to joint entities that include either public school districts or ESU's.</p> | oppose | 2/11 | NCSA (include NRCSA) | |
| LB814 | Brandt | Revenue | Beginning on Jan. 1, 2027, lowers the valuation percentage of agricultural and horticultural land for property tax purposes from 75% to 50% of actual value, and the special valuation from 75% to 50% of special value. It also adjusts the acceptable range for these valuations used by the Tax Equalization and Review Commission, reducing the range from 69-75% to 44-50% of actual or special value. These changes will decrease the property tax burden on qualifying landowners. | oppose | 2/28 | letter | |
| LB820 | Retirement Committee | Retirement | In regards to NPERS, requires all public employees and employers to maintain and produce at least one type of 'approved identification document' for citizenship/lawful presence verification. The types of approved identification documents are spelled out in the bill. | | | | |

| THIS WEEK | NEXT WEEK | | | | | | |
|-----------------------|--------------|------------|---|----------------|--------------------|-------------------|---------------------------------|
| BILL | SENATOR | COMMITTEE | DESCRIPTION | NRCSA POSITION | HEARING DATE | TESTIFY? | STATUS |
| LB824 | Lenowski | Retirement | Redefines 'termination of employment' for school retirement system purposes, shortens the required waiting period before a retired or separated employee may return to work for a participating employer from 180 days to 120 days. Removes exceptions that previously allowed intermittent or volunteer work during the waiting period. It also clarifies that a bona fide separation from service must occur, and that prearranged returns to work or compensation for unfulfilled contract periods do not constitute termination. Policies limiting volunteer or substitute work within the waiting period may still be adopted by employers but are no longer specified in statute. | support | 1/30 | | Placed on General File (2-2-26) |
| LB833 | Kauth | Education | Removes the requirement that all baccalaureate and baccalaureate transfer programs in agriculture and natural resources initiated after July 1, 1978, solely as it relates to Agricultural Education, at Nebraska State Colleges shall be conducted in cooperation with the University of Nebraska. LB 833 also provides that doctoral degrees in education may be offered at Nebraska State Colleges and prioritizes that the development of new baccalaureate degree programs at Nebraska State Colleges be based on the needs of rural Nebraska. | support | 1/26 | letter of support | |
| LB841 | Rountree | Education | No school district shall implement a change to an individualized education program without consent from the student's parent, legal guardian, educational decisionmaker, or surrogate. Without such consent, the school district may obtain approval to implement such change through a hearing conducted by a hearing officer appointed by NDE. The school district shall have the burden of proof and the burden of production. The hearing officer will then have 45 days to produce a decision. | oppose | 1/20 | letter | |
| LB848 | J. Cavanaugh | Revenue | Identifies items are exempted from state and local sales and use taxes during a three-day period beginning at 12:01 a.m. on the first Friday in August and ending at midnight on the following Sunday. Applies to clothing and school supplies (which are defined). | | 1/22 (with LB 865) | | |

| THIS WEEK | NEXT WEEK | | | | | | |
|-----------------------|-----------|---------------------------|--|----------------|---------------------------|----------|--------|
| BILL | SENATOR | COMMITTEE | DESCRIPTION | NRCSA POSITION | HEARING DATE | TESTIFY? | STATUS |
| LB855 | McKinney | Education | <p>Establishes the Youth Early Intervention and Support Act. NDE, in consultation with the Department of Health and Human Services, shall develop and administer an early support system to be implemented in all Nebraska public school districts. The early support system shall identify students who exhibit two or more of the identified early warning indicators. The goal of the early support system is to facilitate early, compassionate, trauma-informed interventions through collaborative planning and service coordination.</p> <p>Each school district shall convene a youth support coordination team to implement the early support system. Each youth support coordination team shall: (a) Develop protocols for reviewing flagged student data; (b) conduct trauma-informed needs assessments; (c) engage families in support planning; (d) coordinate referrals to mental health, academic, and basic needs resources; and (e) document and monitor interventions using secure systems.</p> <p>Each school district shall submit an annual implementation report to the State Department of Education.</p> | | 2/10 | | |
| LB860 | Bostar | Health and Human Services | No later than January 1, 2027, the Department of Health and Human Services shall establish a program that provides access and services for individuals under twenty-one years of age who are experiencing complex behavioral health care needs. (2) The department shall ensure that: (a) The program addresses the behavioral health care of individuals under twenty-one years of age who have complex, multisystem needs, with the goals of supporting families in the community and preventing institutionalization and out-of-home care placement; and (b) care management under the program is delivered according to the needs of the individual and the individual's family. | | | | |
| LB862 | Prokop | Appropriations | Extends the annual appropriation of \$2 million from the Education Future Fund to NDE for regional coaches and job-embedded training in evidence-based reading instruction. The new end date for appropriations is fiscal year 2029-30, replacing the previous end date of 2026-27. All other provisions regarding the professional learning system, teacher training, and reporting requirements remain unchanged. | support | 2/3 | letter | |
| LB865 | Prokop | Revenue | Similar to LB 848, the bill Identifies items are exempted from state and local sales and use taxes during a three-day period beginning at 12:01 a.m. on the first Friday in August and ending at midnight on the following Sunday. Applies to clothing and school supplies (which are defined). Also includes child care products. | | 1/22/2026 (with LB868) | | |
| LB870 | Andersen | Education | Eliminates in-state tuition for unlawfully present students by repealing the language implemented by LB239 in 2006. | | 1/26/2026. (with LB 1061) | | |

| THIS WEEK | NEXT WEEK | | | | | | |
|-----------------------|---------------------|------------|---|----------------|--------------|----------|----------------------------------|
| BILL | SENATOR | COMMITTEE | DESCRIPTION | NRCSA POSITION | HEARING DATE | TESTIFY? | STATUS |
| LB893 | Storm | Education | Replaces the requirement for substitute teacher applicants to complete human relations training with an option to instead complete a newly created interpersonal relations training course and test. NDE will create and offer the online course and test, which will cover topics similar to those in the human relations training. NDE may charge a fee for the course and test, not to exceed the cost of providing them. | | 1/27 | | |
| LB898 | Lonowski | Government | Revises the Nebraska Open Meetings Act to broaden the ability of public bodies to conduct meetings via virtual conferencing. It removes the list of public bodies previously allowed to use virtual conferencing and instead allows all public bodies to utilize this option, subject to new standardized requirements. Following are conditions/requirements for use of virtual conferencing: (a) must have a physical site(s), with appropriate seating for members of the public to attend, (b) at least one member of the public body must be at the physical site, (c) a period of public comment is provided, (d) at least one hard copy of all documents considered must be available at each physical site, (e) an electronic copy of the agenda and documents considered in the meeting must be available. | | 2/5 | | |
| LB924 | Andersen | Education | Revises how learning communities in Nebraska may use property tax levies, allowing both leasing and purchasing of elementary learning center facilities, not just leases and remodeling. It also permits levy funds to be used for administrative staff of the learning community (capped at 10%), rather than only elementary learning center employees. The learning community coordinating council's powers are expanded to include partnering with public and private entities to increase high school graduation rates. Existing sections are harmonized to reflect these changes, and the bill reorganizes the order of certain council authorities. | | 1/20 | | placed on General File (1-29-16) |
| LB937 | Education Committee | Education | Technical clean up bill. | | 1/20 | | |
| LB940 | Murman | Education | On or after August 1, 2026, no public elementary or secondary school shall offer or make available to any student any food served as a part of a school meal that contains any of the following color additives as referred to by the United States Food and Drug Administration in the federal Regulatory Status of Color Additives as such list existed on January 1, 2026: (a) Blue No. 1; (b) Blue No. 2; (c) Green No. 3; (d) Red No. 40; (e) Yellow No. 5; or (f) Yellow No. 6. | | 1/20 | | Placed on General File (1-29-26) |

| THIS WEEK | NEXT WEEK | | | | | | |
|-----------------------|-----------|---------------------------|--|----------------|--------------|----------|--------|
| BILL | SENATOR | COMMITTEE | DESCRIPTION | NRCSA POSITION | HEARING DATE | TESTIFY? | STATUS |
| LB959 | Riepe | Health and Human Services | HHS shall establish a youth afterschool credential for individuals who are sixteen or seventeen years of age and who are seeking employment in school-age child care programs or temporarynonresidential child care programs. To obtain a youth afterschool credential, an applicant shall: (a) Complete all registry checks required for licensed child care staff, including the child abuse and neglect and sex offender registries, and any additional registry checks required by the department; (b) Submit all background check documentation required by tNDE; and (c) Complete a minimum seven-hour new staff orientation for schoolage programs approved by the department. Upon completion of the requirements, NDE shall issue a youth afterschool credential. The credential shall be valid for one year after the date of issuance and may be renewed through an expedited process established by the department. A licensed child care program or youth-serving program approved by NDE may accept a valid youth afterschool credential as verification that the holder has met the initial background check and training requirements. | | 1/28 | | |
| LB960 | McKinney | Education | Each school board would be required to include student school board members on the school board in a number equal to the number of elected school board members on such school board.If the school district has only one high school, all student school board members shall be selected from the high school. Each school board shall adopt procedures to select student school board members from the high school. The selection procedures may include, but are not limited to, student elections, principal nominations, or applications and interviews. Each student school board member shall: (a) Attend all public meetings of the school board; (b) Receive meeting materials and agendas for all public meetings of the school board; (c) Be seated with the school board at all public meetings of the school board and be included in all public discussions of the school board; (d) Serve as a liaison between the student body and the school board; and (e) Be permitted to introduce and advocate for agenda items except that a school board may, as part of the school board's policies and procedures, require sponsorship from an elected school board member for the introduction of an agenda item. No student school board member shall: (a) Vote on matters before the school board; (b) Attend or participate in closed or executive sessions of the school board; or (c) Access confidential student, personnel, or legal information. On or before January 1, 2027, each school board shall adopt policies and procedures for student school board members to serve on the school board. | | | | |

| THIS WEEK | NEXT WEEK | | | | | | |
|-----------------------|--------------|---------------------------|---|----------------|--------------|----------|--------|
| BILL | SENATOR | COMMITTEE | DESCRIPTION | NRCSA POSITION | HEARING DATE | TESTIFY? | STATUS |
| LB966 | M. Cavanaugh | Education | Adopt the Hunger Free Schools Act. To comply with the Hunger-Free Schools Program, a qualified school shall: (1) Serve eligible meals through any school breakfast program or school lunch program operated by such school during the school day; and (2) Submit information regarding the number of eligible meals served in a manner prescribed by the department. NDE shall annually reimburse each qualified school a portion of the cost of each eligible meal served by such school during the second preceding school fiscal year in an amount equal to the difference between the federal reimbursement rate for a free meal and the federal reimbursement rate for a reduced-price meal for each eligible meal. The calculation of the reimbursement for each eligible meal shall be based on the federal reimbursement rates for a school breakfast or a school lunch as applicable to the eligible meal. The Legislature would be required to appropriate money from the General Fund to the State Department of Education to carry out the Hunger-Free Schools Act. | | | | |
| LB970 | Guereca | Health and Human Services | On or before October 1, 2026, the Dept. of Health and Human Services shall seek approval for federal matching funds from the federal Centers for Medicare and Medicaid Services through a state plan amendment to expand the services covered under the early and periodic screening, diagnosis, and treatment services program to include a program of early literacy promotion and intervention during well-child visits for children from birth through five years of age. The early literacy promotion and intervention program shall include evidence-based screening, referral, and provision of materials and guidance related to age-appropriate literacy development for children enrolled in the medical assistance program as an extension of standard well-child care. | | | | |
| LB990 | Dover | Revenue | Renames the School District Property Tax Relief Credit Fund the Live Here Thrive Here Credit Fund. Beginning in tax year 2027 and for each tax year thereafter, property tax credits granted under the act shall only be granted to real property owners that are resident individuals. | | | | |

| THIS WEEK | NEXT WEEK | | | | | | |
|------------------------|-----------|----------------|--|----------------|--------------|----------|--------|
| BILL | SENATOR | COMMITTEE | DESCRIPTION | NRCSA POSITION | HEARING DATE | TESTIFY? | STATUS |
| LB991 | Dover | Transportation | <p>A school district may: (a) Install a stop-signal-arm camera system on any school bus owned by the school district; (b) Operate a stop-signal-arm camera system on any school bus owned by the school district; or (c) Enter into a contract with a private vendor to provide any of the following services: (i) Installation of a stop-signal-arm camera system on any school bus owned by the school district; (ii) Operation of a stop-signal-arm camera system on any school bus owned by the school district; or (iii) Support for the installation or operation of a stop-signal-arm camera system on any school bus owned by the school district. (3) The date, time, and location of any data collected by a stop signal-arm camera system under the bill shall be imprinted on or embedded within the data. (4) Any school bus that has a stop-signal-arm camera system installed on such school bus shall include a warning on such school bus. Such warning shall: (a) Indicate that a stop-signal-arm camera system is installed on the school bus; and (b) Be clearly readable from a distance of one hundred feet from the warning. (5) A school district may provide any data, or a copy of such data, collected by a stop-signal-arm camera system if such camera system was installed on a school bus owned by the school district at the time that such data was collected.</p> <p>A violation of this section may be enforced through the use of a stop-signal-arm camera system if a peace officer has reviewed the data as defined in section 1 of this act and chooses to issue a citation. (b) A citation that is issued under this subsection shall be mailed to the registered owner of the motor vehicle not later than six days after the alleged violation occurred. (c) Such registered owner may appeal the citation to the law enforcement agency that employed the peace officer at the time of the citation. Such appeal shall occur no later than thirty days after delivery of the citation. Such registered owner may provide evidence to the law enforcement agency that the registered owner was not the driver of the motor vehicle at the time of the alleged violation. Such law enforcement agency shall rescind the citation if the agency finds adequate evidence to rescind the citation.</p> | | 2/2 | | |
| LB1008 | Brandt | Revenue | <p>Changes how the minimum amount of property tax relief is calculated under the School District Property Tax Relief Act. Starting in tax year 2030 the relief will be the prior year's minimum plus a percentage increase matching the increase in total state real property assessment, and an additional \$75 million. For 2031 and beyond, the relief increases by the assessment percentage change only, eliminating the previous fixed 3% increase. These changes aim to tie relief amounts more closely to property value growth.</p> | | | | |

| THIS WEEK | NEXT WEEK | | | | | | |
|------------------------|-----------|-----------|--|----------------|--------------|----------|----------------------------------|
| BILL | SENATOR | COMMITTEE | DESCRIPTION | NRCSA POSITION | HEARING DATE | TESTIFY? | STATUS |
| LB1022 | Murman | Education | Eliminates the human relations training requirement for obtaining a certificate or permit to teach, provide special services, or education administration. | | 1/27 | | Placed on General File (1-29-26) |
| LB1024 | Murman | Education | Beginning with school year 2027-28, each school district, in consultation with the State Department of Education, shall include instruction on the history of communism within the social studies curriculum. The instruction shall include: (a) The history of communism in the United States, including domestic communist movements and their associated histories and tactics; (b) Atrocities committed in foreign countries in the name of communism; (c) Comparative discussion of political ideologies, such as communism and totalitarianism, that conflict with the principles of freedom and democracy essential to the founding principles of the United States' representative republic system; (d) The increasing threat of communism in the United States and its allies through the 20th century, the events of the Cultural Revolution in the People's Republic of China, the history of the Soviet Union, and the mass killings that have occurred under communist regimes; (e) The suppression and persecution of various religious faiths under communist regimes; and (f) The economic, industrial, and political events that have preceded communist revolutions. | oppose | 1/27 | letter | |
| LB1034 | Dungan | Education | No school employee, contractor, or agent of a school district shall permit access to students, school employees, school grounds, or school facilities by a federal immigration enforcement officer for the purpose of immigration enforcement unless such officer presents a valid judicial warrant. Nothing in this section shall be construed to prohibit a school employee from complying with a valid judicial warrant or court order or from responding to exigent circumstances involving an immediate threat to the health or safety of a student or school employee. | | | | |

| THIS WEEK | NEXT WEEK | | | | | | |
|------------------------|-----------|-----------|---|----------------|--------------|----------|--------|
| BILL | SENATOR | COMMITTEE | DESCRIPTION | NRCSA POSITION | HEARING DATE | TESTIFY? | STATUS |
| LB1038 | Hughes | Education | <p>Makes large changes to Nebraska school finance laws. Reduces property tax levy limits for school districts, eliminates the Property Tax Credit Act and School District Property Tax Relief Credit Fund after 2025, and terminates related funds. State aid calculations for schools are revised, with new formulas for equalization aid and adjustments to how property valuations are used in funding calculations. The bill also provides a mechanism for school districts to levy additional property taxes if state aid is insufficient, and sets new limits for special building fund levies. Appropriations and transfers to the Education Future Fund are restructured, with future intent language for substantial state funding commitments. The bill takes effect immediately upon passage.</p> <p>From Sen. Hughes office: Goal: Make changes to TEEOSA in order to: <ul style="list-style-type: none"> • Drop the maximum levy cap for public schools to lessen the reliance of school funding on local property taxes • To increase the number of equalized school districts • To narrow the statewide difference between school districts levy rates Method: <ul style="list-style-type: none"> • Utilizing existing dollars allocated to property tax credits to buy down school districts ability to levy property taxes. • The concept also envisions some changes to both the Resources and Needs sides of TEEOSA in order to maximize the maximum levy buy down, narrow the range of levies between school districts statewide, and to maximize the number of school districts that receive equalization aid. • Institute a .30 base levy adjustment Outcome: <ul style="list-style-type: none"> • Maximum levy cap dropped from the current level of \$1.05 to \$0.50. • The Local Effort Rate (LER) will drop from \$1.00 to \$0.45 resulting in 242 out of 245* school districts being equalized (currently only 50 school districts will receive equalization aid in 2025/26). • All school districts levies would be between \$0.30-\$0.50, significantly narrowing the current range of \$0.32 - \$1.05. Resource and Needs Change: <ul style="list-style-type: none"> • Change adjusted valuation inside TEEOSA to: <ul style="list-style-type: none"> ◦ Agland from 72% to 42% ◦ Other real property (commercial and residential) from 96% to 86% • Eliminate the system averaging adjustment Funding: <ul style="list-style-type: none"> • Repurpose both property tax credit funds (approx \$1.2B) • Repurpose foundation aid support from the Education future fund (approx \$110M) Benefits: <ul style="list-style-type: none"> • With the tax credits now being used to “buy down” the levy - this money will be recognized for going to property tax and Nebraska will NO LONGER be the “5th highest property tax” state! • With levies closer together it eliminates the argument for not potentially combining districts to provide students better opportunities and efficiencies • If the state at some point decides to pull some funding from schools - the legislature will have to vote to increase the max cap (LER) thereby acknowledging that they are in effect directly raising property taxes. </p> | support | 2/2 | testify | |

| THIS WEEK | NEXT WEEK | | | | | | |
|-------------------------|-----------|-----------|--|----------------|--------------|----------|--------|
| BILL | SENATOR | COMMITTEE | DESCRIPTION | NRCSA POSITION | HEARING DATE | TESTIFY? | STATUS |
| LB 1039 | Dungan | Education | Prohibits any school resource officer or security guard from subjecting any student to corporal punishment as described in section 79-295. | | 2/9 | | |
| LB1046 | McKinney | Education | On or before January 1, 2027, the State Board of Education shall adopt a model policy relating to name, image, and likeness rights of student-participants. The policy shall allow a student-participant to (i) Engage in commercial name, image, and likeness activities individually or with assistance from agents, attorneys, or representatives; and (ii) Retain eligibility to participate in interscholastic athletics or activities at such high school, as long as the commercial NIL activity complies with school policy and the policies of any athletic or activities association of which such student participant's school is a member. Beginning with school year 2027-28, each school board of a school district that provides school-sponsored interscholastic athletics or activities and is a member of an athletic or activities association shall adopt a policy consistent with the model policy developed by the State Board of Education pursuant to this section. The bill prohibits schools and athletic associations from penalizing students for participating in compliant NIL activities. | oppose | 2/2 | letter | |

| THIS WEEK | NEXT WEEK | | | | | | |
|------------------------|-----------|-----------|---|----------------|--------------|----------|--------|
| BILL | SENATOR | COMMITTEE | DESCRIPTION | NRCSA POSITION | HEARING DATE | TESTIFY? | STATUS |
| LB1050 | Murman | Education | <p>At request of the Governor. On or before October 1, 2026, NDE shall establish and make public a threshold level of performance for the statewide assessment of reading for grade three administered and for each alternate assessment of reading for grade three administered identify students who are able to read at or above grade level. By January 1, 2027, NDE shall establish and make public a test-based student portfolio option to demonstrate mastery of grade three reading standard. The department shall set criteria for the test-based student portfolio and a threshold level of performance to identify students who are able to read at or above grade level. For purposes of retention pursuant to section 5 of this act, any student identified as having a reading deficiency at the end of grade three shall be identified as having a persistent reading deficiency unless such student performs at or above (a) the threshold level determined on the statewide assessment of reading for grade three or any alternate assessment of reading for grade three or (b) the threshold level determined on a test-based student portfolio. Each student identified as having a persistent reading deficiency pursuant to this subsection shall remain identified as having a reading deficiency until the student performs at or above the threshold level on an approved eading assessment for grade three, the statewide assessment of reading or grade three or any alternate assessment of reading for grade three, or a test-based student portfolio. Beginning with the 2027-28 school year, except as otherwise provided in this section, a school board shall not promote a student identified as having a persistent reading deficiency to grade four and shall retain such student in grade three. This shall not apply to: (a) Any student who is exempt from the administration of an approved reading assessment; (b) Any student receiving special education services or services under a plan pursuant to the requirements of section 504 of the federal Rehabilitation Act of 1973, 29 U.S.C. 794, or Title II of the federal Americans with Disabilities Act of 1990, 42 U.S.C. 12131 to 12165, as those acts and sections existed on January 1, 2026, who has participated in a supplemental reading intervention program pursuant to section for at least two school years and who was previously retained in kindergarten, grade one, grade two, or grade three for at least one school year; or (c) Any student who has participated in a supplemental reading intervention program pursuant to section 79-2605 for at least two school years and who was previously retained in kindergarten, grade one, grade two, or grade three for a cumulative total of two school years. No student shall be retained in grade three pursuant to this section more than once. Beginning with the 2027-28 school year, each school district shall provide an intensive acceleration class for any student identified as having a persistent reading deficiency and retained in grade three. The requirements for each intensive acceleration class are identified, including lower student-teacher ratios.</p> | oppose | 1/27 | testify | |

| THIS WEEK | NEXT WEEK | | | | | | |
|------------------------|---------------------|----------------|--|----------------|--------------------|------------------------------|--------|
| BILL | SENATOR | COMMITTEE | DESCRIPTION | NRCSA POSITION | HEARING DATE | TESTIFY? | STATUS |
| LB1052 | Education Committee | Education | Makes a slight change to the Student Discipline Act to state: The school board or board of education may authorize the emergency exclusion, short-term or long-term suspension, expulsion, or mandatory reassignment of any student (changed from pupil) from school for conduct prohibited by the board's rules or standards established pursuant to the Student Discipline Act if such emergency exclusion, short-term or long term suspension, expulsion, or mandatory reassignment complies with the procedures required by the act. | | | | |
| LB1053 | Education Committee | Education | Eliminates the statutory restriction that previously prevented the suspension of students in pre-kindergarten through second grade. By repealing section 79-265.01 and removing references to it in other sections, the bill allows school administrators to apply suspension, expulsion, or other disciplinary measures to students of all grades under the Student Discipline Act. The changes also harmonize related statutes to reflect the repeal. | support | 1/27 | letter | |
| LB1054 | DeBoer | Appropriations | Provides for a \$250,000 appropriation from the General Fund for FY2026-27 to the State Department of Education to be used to develop and administer a program to provide grants to school districts, ESU's, and approved or accredited private, denominational, or parochial schools for the purchase of cybersecurity products and services. | support | 2/3 | NSEA testify (include NRCSA) | |
| LB1061 | Murman | Education | Would repeal in-state tuition benefits at public universities and colleges for aliens not lawfully present in the United States. | | 1/26 (with LB 870) | | |
| LB1071 | Arch | Appropriations | Budget and appropriations bill for the State of Nebraska for fiscal years 2025-26 and 2026-27. Department of Education begins on page 18. | | | | |
| LB1072 | Arch | Appropriations | Provides for the transfer of many state funds to the state's General Fund. OTHER ITEMS IN THE BILL: Beginning July 1, 2026, any investment earnings from investment of money in the State Lottery Operation Trust Fund, the State Lottery Operation Cash Fund, or the State Lottery Prize Trust Fund shall be credited to the Education Future Fund. Transfers may be made from the State Department of Education Trust Fund to the General Fund at the direction of the Legislature. Transfers may be made from the Excellence in Teaching Cash Fund to the Education Future Fund at the direction of the Legislature. | | | | |
| LB1075 | Sanders | Government | Proposes several changes to Nebraska election laws. One change would require a political subdivision that calls off a special election prior to the election shall be liable for all costs involved with cancelling the special election. | | | | |

| THIS WEEK | NEXT WEEK | | | | | | |
|------------------------|-----------|----------------|--|----------------|--------------|----------|--------|
| BILL | SENATOR | COMMITTEE | DESCRIPTION | NRCSA POSITION | HEARING DATE | TESTIFY? | STATUS |
| LB1081 | G. Meyer | Government | Beginning January 1, 2027, a state agency or political subdivision, including school districts, shall not use public funds to purchase a flag of the United States or the State of Nebraska unless the flag has been one hundred percent manufactured in the United States from articles, materials, or supplies that have been grown or one hundred percent produced or manufactured in the United States. This shall not apply to the purchase of a hand-held flag or a flag with dimensions of less than eight inches wide and six inches high. | | | | |
| LB1097 | Conrad | Judiciary | Declares that the state, state agencies, and political subdivisions shall be liable in a similar manner and to a similar extent as a private individual or entity under like circumstances for tort claims arising out of sexual abuse of children and individuals with developmental disabilities. victims of child sexual abuse and individuals with developmental disabilities who are victims of sexual abuse to bring tort claims against state agencies and political subdivisions. Waives sovereign immunity for such claims and exempts them from the procedural and substantive limitations of the State Tort Claims Act and the Political Subdivisions Tort Claims Act, such as damage caps, jury trial limits, notice requirements, and statutes of limitations. The statute of limitations is removed for direct perpetrators, and a new extended limit applies to other defendants. Amendments to existing statutes redefine key terms and clarify that actions under this Act are not considered regular tort claims under existing state law. | | 2/12 | | |
| LB1112 | McKinney | Education | Creates the Statewide Standardized Grading System Act. Establishes a statewide grading system and for such statewide grading system to be applied uniformly in all public, private, parochial, and denominational schools. By December 31, 2026, NDE shall establish a statewide grading system for grades 3-12. Sets standards that must be met in the grading system. All schools, public and private, must adopt the grading system for the 2027–2028 school year. Each school district shall report student grades to NDE in a standardized format to support statewide comparability and public reporting. NDE shall provide training and technical assistance to school districts, teachers, and administrators for implementation of the statewide grading system, including evidence-based grading practices and equity-focused assessment strategies. | oppose | 2/9 | letter | |
| LB1140 | Spivey | Appropriations | Creates a State appropriation for a pilot program for FY2026-27 \$500,000 General Funds to be used for a multi-trade preapprenticeship pilot program serving young adults and preparing them for registered apprenticeships and entry-level construction employment within Omaha. | | 2/3 | | |

| THIS WEEK | NEXT WEEK | | | | | | |
|------------------------|-----------|------------|---|----------------|--------------|----------|--------|
| BILL | SENATOR | COMMITTEE | DESCRIPTION | NRCSA POSITION | HEARING DATE | TESTIFY? | STATUS |
| LB1145 | Lonowski | Government | <p>Each public body shall give reasonable advance publicized notice of the time and place of each meeting by a method designated by each public body and recorded in its minutes. This notice shall be provided at least twice a year of the regular meeting schedule, location, and the method designated by the public body to provide reasonable advance publicized notice. Such notice shall be given by publication in a legal newspaper of general circulation within the public body's jurisdiction.</p> <p>STATEMENT OF INTENT: This bill would amend Nebraska Revised Statute § 84-1411 of the Open Meetings Act to require public bodies subject to the Act to provide "reasonable advance publicized notice of the time and place of each meeting by a method designated by each public body and recorded in its minutes." Although some political subdivisions publish the notice in a newspaper, most post the notice in three public places. The bill repeals provisions in § 84-1411 that are confusing and have proven to be problematic for political subdivisions since the passage of LB 148 in 2020. Notice provided by political subdivisions also shall be given "at least twice a year of the regular meeting schedule, location, and the method designated by the public body to provide reasonable advance publicized notice. Such notice shall be given by publication in a legal newspaper of general circulation within the public body's jurisdiction." This publication requirement does not apply to cities of the second class, villages, and rural or suburban protection fire districts since they typically post notice of their meetings in three public places. The bill also outlines procedures for a public body that decides to publish notice in a newspaper of general circulation within the public body's jurisdiction to meet the notice requirement in case of refusal, neglect, or inability of the newspaper to publish notice.</p> | support | 2/5 | letter | |
| LB1146 | Conrad | Education | <p>Revises the process by which Nebraska school districts report excessive student absences to the county attorney. States that only unexcused absences count toward the threshold for referral and excludes various types of absences, such as: (i) Absences excused by a parent, guardian, or educational decisionmaker for physical or mental illness; or been absent more than twenty days per school year, (ii) Absences (A) By pregnant or parenting students, (B) By students (I) who have an individualized family service plan, (II) who have an individualized education program under IDEA, (III) receiving special accommodations or services under section 504 of the federal Rehabilitation Act of 1973, 29 U.S.C. 794, (IV) receiving special education as defined in section 79-1125, or (V) who are eligible for services under the McKinney-Vento Homeless Assistance Act,</p> | | 2/2 | | |

| THIS WEEK | NEXT WEEK | | | | | | |
|------------------------|-----------|-----------|--|----------------|--------------|----------|--------|
| BILL | SENATOR | COMMITTEE | DESCRIPTION | NRCSA POSITION | HEARING DATE | TESTIFY? | STATUS |
| LB1154 | Riepe | Revenue | Revises section 13-3403 to alter the calculation of a political subdivision's preliminary property tax request authority. Previously, only exceptions under subdivision (1) of section 13-3404 were subtracted. The amendment expands this to include exceptions under subdivisions (1), (2), (4), (5), (6), and (7) of section 13-3404. The rest of the calculation and additional factors for increasing property tax request authority remain unchanged. Exceptions 2, 4, 5, 6, and 7 include: (2) The amount of property taxes needed to respond to an emergency declared in the preceding year, as certified to the auditor; (4) The amount of property taxes budgeted in support of (a) a service relating to an imminent and significant threat to public safety that (i) was not previously provided by the political subdivision and (ii) is the subject of an agreement or a modification of an existing agreement executed after August 21, 2024, whether provided by one of the parties to the agreement or by an independent joint entity or joint public agency or (b) an interlocal agreement relating to public safety; (5) The increase in property tax request authority approved by the legal voters as provided in section 13-3405; (6) The amount of property taxes budgeted for public safety services as defined in section 13-320; and (7) The amount of property taxes budgeted for county attorneys and public defenders. | | 2/6 | | |
| LB1164 | Lonowski | Education | Creates the Prior Learning Act. By September 1, 2026, the Coordinating Commission for Postsecondary Education (the Commission) shall approve a list of prior learning examinations and the cut score for each such examination. The list shall include commonly recognized prior learning examinations, including, but not limited to: (a) Prior learning examinations that are associated with participation in high school courses specifically designed to prepare students for such examinations; (b) Prior learning examinations that are associated with participation in high school courses using international curriculum frameworks; and (c) Prior learning examinations that are not associated with high school courses endorsed by the provider of the prior learning examination. The commission shall set cut scores in a manner consistent with national practices. By October 1, 2026, each Nebraska public postsecondary institution shall develop and implement written policies and procedures for awarding academic credit based on prior learning examinations. | | 2/3 | | |

| THIS WEEK | NEXT WEEK | | | | | | |
|------------------------|------------|------------|---|----------------|--------------|----------|--------|
| BILL | SENATOR | COMMITTEE | DESCRIPTION | NRCSA POSITION | HEARING DATE | TESTIFY? | STATUS |
| LB1166 | Juarez | Retirement | Revises how the employee contribution rate for the School Employees Retirement Fund is calculated, when it is applied, and clarifies timing and thresholds for contribution rates based on funding ratios. The employee contribution rate that is calculated as of July 1, 2025, shall apply beginning July 1, 2025, and prior to July 1, 2026. The employee contribution rate that is calculated as of July 1, 2026, shall apply beginning July 1, 2026, and prior to September 1, 2027. Beginning in 2027 and each year thereafter, the employee contribution rate that is calculated as of July 1 of such year shall apply beginning September 1 of such year and prior to September 1 of the next year after such year. NOTE: Some ESU's are currently on a July 1-June 20 fiscal year. | support | 2/6 | | |
| LB1182 | Lippincott | Education | Commencing with the 2027-28 school year, the annual minimum base salary for any certificated teacher employed on a full-time basis by a public school district in Nebraska shall be \$50,000. Nothing in the bill shall prevent a school district from paying a teacher more than the minimum base salary established or from establishing salary schedules that reward experience, advanced education, or performance above this minimum. Beginning with the 2029-30 school year, and biennially thereafter, the minimum base salary established in subsection (1) of this section shall be adjusted by the percentage change in Nebraska's total state General Fund receipts for the two-year period ending on December 31 of the preceding year, with a minimum adjustment of zero percent. The base salary shall not be reduced below the previous year's base salary. The adjusted minimum base salary shall be rounded to the nearest \$1,000. NDE shall annually publish the adjusted minimum base salary by March 1. The Legislature will establish a public education funding system based on block grant funding for foundation aid and salary support and to adjust the education funding system provided in TEEOSA to incorporate this block grant funding. The newly established funding system shall provide each public school district with a quarterly block grant beginning July 1, 2027. The amount of each district's quarterly block grant shall be determined by a formula established by the Legislature based on factors including, but not limited to, student enrollment and the minimum base salary for certificated teachers established. | oppose | 2/9 | letter | |

| THIS WEEK | NEXT WEEK | | | | | | |
|------------------------|------------|-----------|---|----------------|--------------|----------|--------|
| BILL | SENATOR | COMMITTEE | DESCRIPTION | NRCSA POSITION | HEARING DATE | TESTIFY? | STATUS |
| LB1183 | Lippincott | Revenue | <p>LB1183 is aimed at reducing the tax burden on property owners by establishing that property shall be valued at 50% of its actual value for taxation purposes. For agricultural and horticultural land, the bill lowers the current assessment from 75% to 37.5% of its actual value. Real property in Nebraska, not expressly exempt therefrom, shall be subject to taxation and shall be valued at 50% of its actual value. Agricultural land and horticultural land shall be valued at 37.5% of its actual value. School district taxes levied to pay the principal and interest on bonds that are approved by a vote of the people on or after January 1, 2027 ag land and horticultural land shall be valued at 25% of its actual value. An acceptable range is the percentage of variation from a standard for valuation as measured by an established indicator of central tendency of assessment. Acceptable ranges are: (a) For ag land and horticultural land 34.5% to 37.5% of actual value, except that for school district taxes levied to pay the principal and interest on bonds that are approved by a vote of the people on or after January 1, 2027, the acceptable range is 22% to 25% of actual value; (b) for lands receiving special valuation, 34.5% to 37.5% of special valuation as defined in section 77-1343, except that for school district taxes levied to pay the principal and interest on bonds that are approved by a vote of the people on or after January 1, 2027, the acceptable range is 22% to 25% of special valuation and (c) for all other real property, 46% to 50% of actual value.</p> | oppose | 2/5 | testify | |

| THIS WEEK | NEXT WEEK | | | | | | |
|------------------------|-----------|-----------|--|----------------|--------------|----------|--------|
| BILL | SENATOR | COMMITTEE | DESCRIPTION | NRCSA POSITION | HEARING DATE | TESTIFY? | STATUS |
| LB1201 | Guereca | Education | Establishes a pilot program, the Nebraska Reading Improvement Act. For the 2026-27 and 2027-28 school years and subject to available appropriations, NDE shall develop and administer a grant program to provide high-quality, age-appropriate classroom libraries and monthly parent or caregiver engagement materials in cooperation with a Nebraska-based nonprofit organization with at least ten years of experience in book distribution. Priority for grants shall be given to any application from a school district: (a) That is in the lowest performance classification under the state accountability system; (b) In which forty percent of the students are poverty students; or (c) In which a higher than average percentage of students in kindergarten through grade five are identified as having a reading deficiency. NDE shall provide a recommended list of high-quality books, covering a variety of topics, subjects, and genres in at least English and Spanish, for each participating elementary classroom. Each participating elementary classroom shall track: (i) Book circulation totals; (ii) Available books, including the title, author, publisher, and International Standard Book Number for each book; (iii) Student enrollment numbers; and (iv) The total number of books taken home by each student. NDE shall also assist school districts in selecting or developing parent or caregiver engagement materials for each student in a participating classroom to take home each month. NDE shall report to the Education Committee to the extent possible, quantitative and qualitative metrics based on statewide assessments administered pursuant, assessments administered under the Nebraska Reading Improvement Act, and classroom assessments of reading proficiency, reading skills, or literacy acquisition. Calls for an appropriation of up to \$1,000,000 dollars from the Education Future Fund each fiscal year of the pilot program. | support | 2/10 | letter | |
| LB1206 | Juarez | Revenue | This bill allows certificated teachers and paraprofessionals to exclude 100% of income earned from public or private elementary and secondary schools from Nebraska taxable income to the extent the income is included in federal adjusted gross income. The exclusion applies to taxable years beginning on or after January 1, 2027. | | | | |
| LB1207 | Juarez | Education | Would require school districts to give each full-time employee five mental health leave days each fiscal year without documentation from a medical or mental health provider. The employee shall be paid at the employee's usual salary in full for any mental health leave used by the employee. Mental health leave shall not count against any other leave the employee accrues as a result of working for the school district. A school district shall not require or request any documentation from a medical or mental health provider to justify the use of mental health leave. | | | | |

| THIS WEEK | NEXT WEEK | | | | | | |
|------------------------|-----------|---------------------------|---|----------------|--|----------|--------|
| BILL | SENATOR | COMMITTEE | DESCRIPTION | NRCSA POSITION | HEARING DATE | TESTIFY? | STATUS |
| LB1208 | Juarez | Education | Amends TEEOSA to require that, beginning with the 2026-27 school year, each local school system in Nebraska must allocate at least 50% of its general fund budget to teacher salaries and benefits. | oppose | 2/2 | testify | |
| LB1217 | Hardin | Health and Human Services | Authorizes NDE to permit accredited or approved public, private, denominational, or parochial schools to maintain epinephrine (in any FDA-approved form) for use in providing emergency first aid to students experiencing allergic reactions. | | | | |
| LB1219 | Brandt | Revenue | The total amount of property taxes that may be levied by a political subdivision in any year shall not exceed the total amount levied in the prior year by more than the allowable growth percentage. The allowable growth percentage would be a percentage equal to the sum (i) two percent plus (ii) the political subdivision's real growth percentage. Real growth value means the increase in a political subdivision's total property valuation from the prior year to the current year due to (i) improvements to real property as a result of new construction and additions to existing buildings, (ii) any other improvements to real property which increase the value of such property, (iii) annexation of real property by the political subdivision, (iv) a change in the use of real property, and (v) any increase in personal property valuation over the prior year. | oppose | 2/5 combined hearing with LR317CA | testify | |
| LB1224 | Hunt | Education | Intent is to protect children experiencing, abuse or neglect by preventing cases in which abuse is exacerbated or perpetuated when a child victim is withdrawn from public school, therefore losing regular contact with mandatory reporters and opportunity for intervention from school personnel. Under LB 1224, parents/guardians under active investigation for child abuse or neglect would be temporarily prohibited from withdrawing a child from public school into a home school. Further, adults who have been convicted of domestic assault, child abuse, or a sex-related crime would be prohibited from teaching or providing supervision at a home school. The bill does not impact families who are already home schooling, or those who intend to home school and are not under investigation for child abuse or neglect. | | 2/3 | | |
| LB1241 | Murman | Education | Seeks to ensure that school employee applicants are screened for ever being disciplined or separated from employment while under pending investigations of child abuse, neglect, or sexual misconduct at places of former employment. Requires the school to go back 20 years when considering employment. | | 2/3 | | |
| LB1243 | Murman | Education | Seeks to increase opportunities for homeschool and non-accredited students by ensuring they are not required to be enrolled in a minimum number of credits to participate in an extracurricular activity not regulated by an athletics or activities association. | oppose | 2/2 | letter | |

| THIS WEEK | NEXT WEEK | | | | | | |
|-----------|-----------|-----------|--|----------------|--------------|----------|--------|
| BILL | SENATOR | COMMITTEE | DESCRIPTION | NRCSA POSITION | HEARING DATE | TESTIFY? | STATUS |
| LB 1257 | Hansen | Revenue | <p>Provides for comprehensive changes to Nebraska's sales and use tax system, repeals or phases out numerous sales tax exemptions, adds taxation of most services, modifies property tax levy limits for schools, establishes the New School Relief Fund, and alters state aid and funding mechanisms for school districts. The bill: (1) Broadly expands the sales and use tax base by eliminating most existing sales tax exemptions (including for many goods and services) effective January 1, 2027, and imposes sales tax on most services unless specifically exempted; (2) narrows the definition of 'occasional sale,' modifies related exemptions, and clarifies definitions for retailers and sellers (including candy and soft drinks); (3) phases out the School District Property Tax Relief Act and associated credit fund, replacing them with the New School Relief Fund and a new formula for distributing state aid to schools; (4) lowers school district property tax levy limits over several years, with some limited exceptions and override provisions; (5) increases state funding for schools to offset reduced property tax levies, particularly via additional foundation aid from the New School Relief Fund; (6) creates new reporting and fund transfer requirements to direct increased sales tax revenues to school funding; The bill includes appropriations and fund transfer provisions for the new school funding structure.</p> <p>School districts and multiple-district school systems may levy a maximum levy of: (i) For fiscal years prior to fiscal year 2027-28, \$1.05 per one hundred dollars of taxable valuation of property subject to the levy; (ii) For fiscal year 2027-28, \$0.85 per one hundred dollars of taxable valuation of property subject to the levy; and (iii) For fiscal year 2028-29 and each fiscal year thereafter, \$0.60 per one hundred dollars of taxable valuation of property subject to the levy.</p> <p>The School District Property Tax Relief Credit Fund terminates on July 1, 2027, and the State Treasurer shall transfer any money in the fund on that date to the New School Relief Fund. For fiscal year 2027-28 and every fiscal year thereafter, the State Treasurer shall transfer the amount certified to the New School Relief Fund.</p> <p>For school fiscal year 2027-28 and each school fiscal year thereafter, the department shall determine an amount of additional foundation aid to be paid per formula student out of funds available in the New School Relief Fund. This amount shall be equal to the total amount available in the New School Relief Fund divided by the total number of formula students in all school districts in the state. A school district may exceed its property tax request authority without the approval of the voters by an amount equal to six percent of the school district's prior year property tax request authority. This increase shall be used to pay for teacher salaries, wages, and benefits.</p> <p>The New School Relief Fund is created. The fund shall be used to provide additional foundation aid to school districts. \$838,000,000 will be transferred into the New School Relief Fund dollars from the General Fund on or before September 1, 2027, and on or before September 1 of each year thereafter. If the state fails to use all funds available in the New School Relief Fund for the additional foundation aid, any amount not used by the end of the school year shall be</p> | oppose | 2/11 | | |

| THIS WEEK | NEXT WEEK | | | | | | |
|-------------------------|--------------|------------------|--|----------------|--|----------|-------------------|
| BILL | SENATOR | COMMITTEE | DESCRIPTION | NRCSA POSITION | HEARING DATE | TESTIFY? | STATUS |
| LR292CA | Andersen | Revenue | Proposed Constitutional amendment. Except as otherwise provided in or permitted by this Constitution, real property shall all be taxed in accordance with Article VIII, section 14, of the Constitution and there shall be two valuations for each parcel of real property: Fair market value and taxable market value. Fair market value shall be dynamic and determined by the assessor of the property. Taxable market value shall be used to establish the baseline valuation for tax liability for the individual property owner. Fair market value shall be assessed uniformly and proportionately upon all real property and franchises as defined by the Legislature. Beginning January 1, 2027, (a) Real property shall be valued, for property tax purposes, at its taxable market value unless such property is exempt from tax pursuant to this Constitution; and (b) The property taxes levied on any parcel of real property shall not increase, from one year to the next, by more than the allowable growth percentage, except in those cases when the taxable market value is adjusted pursuant to subdivision (2)(e) of this section. The allowable growth percentage means the percentage change in the Consumer Price Index for All Urban Consumers, or its successor index, as published by the United States Department of Labor, Bureau of Labor Statistics, for the twelve-month period ending on June 30 of the year in which the relevant property taxes are determined. | | 2/12 | | Anderson priority |
| LR303CA | M. Cavanaugh | Business & Labor | Constitutional Amendment that states: All employers in the State of Nebraska shall provide a minimum of six weeks paid family medical leave for all employees no later than October 1, 2027, and twelve weeks no later than October 1, 2028. | | | | |
| LR317CA | Brandt | Revenue | LR317CA is a constitutional amendment that simply limits the total amount of property taxes that may be levied by any political subdivision to 2% plus real growth. | | 2/6/2026. combined hearing with LB1219 | | |
| LR318 | Hughes | | Legislature recognizes January 25, 2026, through January 31, 2026, as School Board Member Week. | | | | |

February 2026 Principal's Report

1. York County Spelling Contest- Grades 7 and 8 were represented by Tori Buzek, Grace Goertzen, Avery Hiebner, Taylor Schmidt, and Cole Eberle (Alternate)
 - a. Tori placed 3rd
 - b. Avery placed 4th

2. ACT Prep for all juniors has been ongoing since the fall. We've been utilizing the John Baylor Test Prep Sessions. The ACT test will be given as part of NSCAS (Nebraska Student-Centered Assessment System) March 24, 2026 at the Living Hope Church in Henderson.

3. FFA
 - a. Proficiency Award results:
 - i. Gold State
 1. Kaleb Ostrander - Automotive Technology
 2. Weston Panko - Beef Production Placement
 3. Andrew Onnen - Diversified Livestock
 4. Miles Kliewer - Residential Construction
 5. Emma Ott - Swine Production Entrepreneurship
 - ii. Gold
 1. Lexi Ingsbee - Ag Sales
 2. David Hiebner - Poultry Production
 3. Nevada Gloystein - Ag Services
 4. Lane Farrall - Diversified Crop Production
 - iii. Silver
 1. Maddie Janzen - Beef Production Entrepreneurship
 2. Braden Janzen - Diversified Ag Production Placement
 3. David Hiebner - Beef Production Entrepreneurship
 - b. State Degrees
 - i. 11 candidates were interviewed on February 4. One candidate will interview at a later date.
 - ii. 11 candidates were approved
 - iii. FFA board of directors will need to officially accept each candidate.

4. FBLA
 - a. UNK Business Invitational
 - i. Individual Results
 1. Accounting: Tara Buzek - 1st Place
 2. Accounting: Mia Hiebner - 5th Place

Elementary Principal's Report February, 2026

York County Spelling Bee

February 4, 2026

Participants:

7th / 8th: Taylor Schmidt, Tori Buzek, Grace Goertzen, Avery Hiebner, Cole Eberle (Alternate)

5th / 6th: Ryker Lewis, Elliot Buller, James Janzen, Easton Siebert, Ella Eckman (Alternate)

3rd / 4th: Luke Schultz, Timothy Janzen, Isaac Bearinger, Slate Wolfe (Alternate)

Results:

7th / 8th Division: Tori Buzek - 3rd Place / Avery Hiebner - 4th Place

5th / 6th Division: Ryker Lewis - 3rd Place



Group Photo



Tori Buzek - 3rd / Avery Hiebner - 4th



Ryker Lewis - 3rd

100th Day of School

Elementary students celebrated the 100th day of school on January 29. Kindergarten to second grade students participated in station activities in the afternoon focusing on the number 100! It was another fun day of learning and growing together at Heartland Elementary!



Kindergarten



Second Grade

| Project Budget(E): Starting June 20, 2024 | | | | |
|---|------------------------|------------------------|-----------------------------|-----------------|
| | Budgeted | Expended | Category | Expensed |
| Comprehensive Project: | \$12,307,364.00 | \$12,160,519.17 | | |
| Construction: General Contractor | \$10,700,500.00 | \$10,818,928.24 | Hausmann PC + C&COs | \$10,818,928.24 |
| | | | Contingency & Change Orders | \$637,428.24 |
| Owner Direct: | \$1,026,000.00 | \$837,503.75 | Weight Room | \$355,718.48 |
| | | | Training Room | \$16,797.10 |
| | | | Cameras | \$88,205.25 |
| | | | PA & Bells | \$3,792.36 |
| | | | Doors & Security | \$57,856.77 |
| | | | IT Server Room | \$48,245.50 |
| | | | Classroom Phones | \$2,625.00 |
| | | | Classroom Furn. & Equip. | \$82,613.40 |
| | | | Office Furn. & Equip. | \$10,486.65 |
| | | | Other Furn. & Equip. | \$10,149.64 |
| | | | PK Outdoor | \$3,173.00 |
| | | | PK Furn. & Equip. | \$17,645.66 |
| | | | Displays & Sound | \$4,263.08 |
| | | | Misc. | \$458.51 |
| | | | Supplemental | \$135,473.35 |
| | | | Overage | |
| Related Services: | \$492,464.00 | \$417,977.27 | Architectural & Engineering | \$379,154.27 |
| | | | Legal | \$0.00 |
| | | | Insurance | \$8,917.00 |
| | | | Other | \$0.00 |
| | | | Asbestos Abatement | \$29,906.00 |
| Borrowing Costs: | \$88,400.00 | \$86,109.91 | Rating Agency | \$20,000.00 |
| | | | Bond Counsel | \$13,700.00 |
| | | | Paying Agent | \$750.00 |
| | | | Underwriters Discount | \$47,950.00 |
| | | | Election | \$3,709.91 |

\$12,160,519.17

\$10,818,928.24
\$50,000.00

| | |
|---|-------------------------|
| | General Contract |
| | PC |
| | Gross PCCO |
| | Adjusted Gross Amount |
| Adjusted Gross Amount Paid minus retainage | |
| Remaining Adjusted Gross Amount minus retainage | |
| Adjusted Gross Retainage | |
| Balance To Finish | |
| Balance To Finish | |

| Change Order | Owner's Contingency |
|--------------|---------------------|
| 59 | 8 |
| \$637,428.24 | \$75,000.00 |

Project Budget(O): Starting June 20, 2024

| | Budgeted | Obligated | Category | Obligated |
|---|------------------------|------------------------|-----------------------------|-----------------|
| Comprehensive Project: | \$12,307,364.00 | \$12,220,147.90 | | |
| Construction: General Contractor | \$10,700,500.00 | \$10,868,928.24 | Hausmann PC + C&COs | \$10,868,928.24 |
| | | | Contingency & Change Orders | \$637,428.24 |
| Supplemental Work: Owner Direct | | \$135,473.35 | Painting: North Gym 1 | \$24,933.00 |
| | | | Painting: Gym Floors | \$23,800.00 |
| | | | Exterior Lighting | \$4,667.35 |
| | | | Soffit Replacement (Green) | \$44,300.00 |
| | | | Painting: Exterior 1 | \$37,773.00 |
| Pre-Planned Work: Owner Direct | \$1,026,000.00 | \$702,030.40 | Weight Room | \$355,718.48 |
| | | | Training Room | \$16,797.10 |
| | | | Cameras | \$88,205.25 |
| | | | PA & Bells | \$3,792.36 |
| | | | Doors & Security | \$57,856.77 |
| | | | IT Server Room | \$48,245.50 |
| | | | Classroom Phones | \$2,625.00 |
| | | | Classroom Furn. & Equip. | \$82,613.40 |
| | | | Office Furn. & Equip. | \$10,486.65 |
| | | | Other Furn. & Equip. | \$10,149.64 |
| | | | PK Outdoor | \$3,173.00 |
| | | | PK Furn. & Equip. | \$17,645.66 |
| | | | Displays & Sound | \$4,263.08 |
| | | | Misc. | \$458.51 |
| | | | Overage | |
| Related Services: | \$492,464.00 | \$427,606.00 | Architectural & Engineering | \$388,783.00 |
| | | | Legal | \$0.00 |
| | | | Insurance | \$8,917.00 |
| | | | Other | \$0.00 |
| | | | Asbestos Abatement | \$29,906.00 |
| Borrowing Costs: | \$88,400.00 | \$86,109.91 | Rating Agency | \$20,000.00 |
| | | | Bond Counsel | \$13,700.00 |
| | | | Paying Agent | \$750.00 |
| | | | Underwriters Discount | \$47,950.00 |
| | | | Election | \$3,709.91 |

\$12,220,147.90

HEARTLAND COMMUNITY SCHOOLS 2026 - 2027 SCHOOL CALENDAR

| August 2026 | | | | | | |
|-------------|----|----|----|----|----|----|
| Su | Mo | Tu | We | Th | Fr | Sa |
| | | | | | | 1 |
| 2 | 3 | 4 | 5 | 6 | 7 | 8 |
| 9 | 10 | 11 | 12 | 13 | 14 | 15 |
| 16 | 17 | 18 | 19 | 20 | 21 | 22 |
| 23 | 24 | 25 | 26 | 27 | 28 | 29 |
| 30 | 31 | | | | | |

| September 2026 | | | | | | |
|----------------|----|----|----|----|----|----|
| Su | Mo | Tu | We | Th | Fr | Sa |
| | | 1 | 2 | 3 | 4 | 5 |
| 6 | 7 | 8 | 9 | 10 | 11 | 12 |
| 13 | 14 | 15 | 16 | 17 | 18 | 19 |
| 20 | 21 | 22 | 23 | 24 | 25 | 26 |
| 27 | 28 | 29 | 30 | | | |

| October 2026 | | | | | | |
|--------------|----|----|----|----|----|----|
| Su | Mo | Tu | We | Th | Fr | Sa |
| | | | | 1 | 2 | 3 |
| 4 | 5 | 6 | 7 | 8 | 9 | 10 |
| 11 | 12 | 13 | 14 | 15 | 16 | 17 |
| 18 | 19 | 20 | 21 | 22 | 23 | 24 |
| 25 | 26 | 27 | 28 | 29 | 30 | 31 |

| November 2026 | | | | | | |
|---------------|----|----|----|----|----|----|
| Su | Mo | Tu | We | Th | Fr | Sa |
| 1 | 2 | 3 | 4 | 5 | 6 | 7 |
| 8 | 9 | 10 | 11 | 12 | 13 | 14 |
| 15 | 16 | 17 | 18 | 19 | 20 | 21 |
| 22 | 23 | 24 | 25 | 26 | 27 | 28 |
| 29 | 30 | | | | | |

| December 2026 | | | | | | |
|---------------|----|----|----|----|----|----|
| Su | Mo | Tu | We | Th | Fr | Sa |
| | | 1 | 2 | 3 | 4 | 5 |
| 6 | 7 | 8 | 9 | 10 | 11 | 12 |
| 13 | 14 | 15 | 16 | 17 | 18 | 19 |
| 20 | 21 | 22 | 23 | 24 | 25 | 26 |
| 27 | 28 | 29 | 30 | 31 | | |

| | |
|-------------|---|
| Aug. 7 | New Teacher Orientation |
| Aug. 10-112 | Teacher Inservice |
| Aug. 13 | K-12 Classes Begin (11:40 Dismissal) |
| Sept. 7 | No School - Labor Day |
| Sept. 14 | No School - Professional Development |
| Oct. 9 | Last Day - 1st Quarter |
| Oct. 12 | First Day - 2nd Quarter |
| Oct. 19 | No School - Professional Development |
| Oct. 19 | PTC 4:30 PM - 8:30 PM |
| Oct. 20 | PTC 4:30 PM - 8:30 PM |
| Nov. 25-27 | No School - Thanksgiving Break |
| Dec. 18 | Last Day - 1st Semester (Regular Dismissal) |
| Dec. 21 | No School - Professional Development |
| Dec. 22-31 | No School - Holiday Break |
| Dec. 23-27 | NSAA Moratorium |

| | |
|----------|---|
| Jan. 1 | No School - Holiday Break |
| Jan. 4-5 | No School - Professional Development |
| Jan. 6 | Classes Resume / 1st Day - 2nd Semester |
| Jan. 15 | No School - Mid-Winter Break |
| Feb. 12 | No School - Mid-Winter Break |
| Mar. 5 | No School - Professional Development |
| Mar. 8 | PTC 4:30 PM - 8:30 PM |
| Mar. 9 | PTC 4:30 PM - 8:30 PM |
| Mar. 10 | Last Day - 3rd Quarter |
| Mar. 11 | No School - Professional Development |
| Mar. 12 | No School - Winter Break |
| Mar. 15 | First Day - 4th Quarter |
| Mar. 26 | No School - Spring Break |
| Mar. 29 | No School - Spring Break |
| Apr. 13 | No School - Staff Workday (HS Track Invite) |
| May 5 | Seniors' Last Day |
| May 9 | Graduation |
| May 14 | Last Day - 2nd Semester (11:30 Dismissal) |
| May 17 | Teacher Inservice |

| January 2027 | | | | | | |
|--------------|----|----|----|----|----|----|
| Su | Mo | Tu | We | Th | Fr | Sa |
| | | | | | 1 | 2 |
| 3 | 4 | 5 | 6 | 7 | 8 | 9 |
| 10 | 11 | 12 | 13 | 14 | 15 | 16 |
| 17 | 18 | 19 | 20 | 21 | 22 | 23 |
| 24 | 25 | 26 | 27 | 28 | 29 | 30 |

| February 2027 | | | | | | |
|---------------|----|----|----|----|----|----|
| Su | Mo | Tu | We | Th | Fr | Sa |
| | 1 | 2 | 3 | 4 | 5 | 6 |
| 7 | 8 | 9 | 10 | 11 | 12 | 13 |
| 14 | 15 | 16 | 17 | 18 | 19 | 20 |
| 21 | 22 | 23 | 24 | 25 | 26 | 27 |

| March 2027 | | | | | | |
|------------|----|----|----|----|----|----|
| Su | Mo | Tu | We | Th | Fr | Sa |
| | 1 | 2 | 3 | 4 | 5 | 6 |
| 7 | 8 | 9 | 10 | 11 | 12 | 13 |
| 14 | 15 | 16 | 17 | 18 | 19 | 20 |
| 21 | 22 | 23 | 24 | 25 | 26 | 27 |
| 28 | 29 | 30 | 31 | | | |

| April 2027 | | | | | | |
|------------|----|----|----|----|----|----|
| Su | Mo | Tu | We | Th | Fr | Sa |
| | | | | 1 | 2 | 3 |
| 4 | 5 | 6 | 7 | 8 | 9 | 10 |
| 11 | 12 | 13 | 14 | 15 | 16 | 17 |
| 18 | 19 | 20 | 21 | 22 | 23 | 24 |
| 25 | 26 | 27 | 28 | 29 | 30 | |

| May 2027 | | | | | | |
|----------|----|----|----|----|----|----|
| Su | Mo | Tu | We | Th | Fr | Sa |
| | | | | | | 1 |
| 2 | 3 | 4 | 5 | 6 | 7 | 8 |
| 9 | 10 | 11 | 12 | 13 | 14 | 15 |
| 16 | 17 | 18 | 19 | 20 | 21 | 22 |
| 23 | 24 | 25 | 26 | 27 | 28 | 29 |

| |
|---|
| Beginning/End of Term |
| No School - Professional Development |
| No School - Break |
| Parent-Teacher Conferences |
| Early Dismissal |
| Event |
| Curriculum Development |

| | | |
|--------------|-----|--------------|
| 1st Quarter | 40 | Student Days |
| | 44 | Teacher Days |
| 2nd Quarter | 46 | Student Days |
| | 49 | Teacher Days |
| 3rd Quarter | 43 | Student Days |
| | 47 | Teacher Days |
| 4th Quarter | 42 | Student Days |
| | 45 | Teacher Days |
| 1st Semester | 86 | Student Days |
| | 93 | Teacher Days |
| 2nd Semester | 85 | Student Days |
| | 92 | Teacher Days |
| School Year | 171 | Student Days |
| | 185 | Teacher Days |

| NSAA DATES | |
|---------------------------|------------------|
| Start of Fall Practices | Aug. 10 |
| District Golf | Oct. 5-6 |
| State Golf | Oct. 12-13 |
| State Football 1st Rd. | Oct. 30 |
| State Volleyball | Nov. 4-5-6-7 |
| Start of Winter Practices | Nov. 16 |
| District One-Act | Week of Nov. 30 |
| NSAA Moratorium | Dec. 23-27 |
| Girls State Basketball | Mar. 3-4-5-6 |
| Boys State Basketball | Mar. 10-11-12-13 |
| Start of Spring Practices | Mar. 1 |
| District Music | Week of Apr. 19 |
| District Track | May 13 |
| District Golf | May 17-18 |
| State Track | May 21-22 |
| State Golf | May 25-26 |

Additional days for students and/or staff will be added to the end of the year if it is determined to be necessary.



Heartland Community Schools
1501 Front Street
Henderson, NE 68371
Phone: 402-723-4434
www.heartlandschools.org

Scheduled Vehicle Replacement: 2022 Equinox (Feb. 2026)

| | February 2026 | | | Spring 2022 | |
|---|-------------------|-------------------------------|----------|---|--|
| | 2026 Equinox Base | 2026 Equinox w/ Safety Pkg | | 2022 Equinox | |
| Purchase Price by Gov Contract | \$34,545 | \$35,815 | \$31,490 | Purchase Price by Gov Contract | |
| Trade-In Mileage | 40,000 | 40,000 | 31,000 | Trade-In Mileage | |
| Trade-In | \$18,000 | \$18,000 | | Trade-In | |
| Additional Discount | \$1,500 | \$1,500 | | Additional Discount | |
| Total Credit | \$19,500 | \$19,500 | \$18,000 | Total Credit | |
| Purchase Price | \$15,045 | \$16,315 | \$13,490 | Purchase Price | |



2026 EQUINOX LT AWD

EXTERIOR: SUMMIT WHITE
INTERIOR: BLACK

1.5L TURBO DOHC ENGINE
8-SPEED AUTO TRANSMISSION

◀ PULL THIS STRIP TO EXPOSE ADHESIVE



Visit us at www.chevy.com

STANDARD EQUIPMENT

ITEMS FEATURED BELOW ARE INCLUDED AT NO EXTRA CHARGE IN THE STANDARD VEHICLE PRICE SHOWN

OWNER BENEFITS

- 3 YEAR/36,000 MILE* BUMPER-TO-BUMPER LIMITED WARRANTY
- 5 YEAR/60,000 MILE* POWERTRAIN LIMITED WARRANTY, ROADSIDE ASSISTANCE & COURTESY TRANSPORTATION
- FIRST MAINTENANCE VISIT *WHICHEVER COMES FIRST SEE CHEVROLET.COM OR DEALER FOR TERMS, DETAILS & LIMITS

PERFORMANCE & MECHANICAL

- 17" GRAZEN METALLIC MACHINED-FACE ALUMINUM WHEELS
- 17" STEEL SPARE WHEEL

CONNECTIVITY & TECHNOLOGY

- 8 YEARS ONSTAR BASICS SEE ONSTAR.COM FOR TERMS

- 11.3" DIAGONAL LCD DISPLAY WITH GOOGLE BUILT-IN WITH WIRELESS APPLE CARPLAY AND ANDROID AUTO FOR COMPATIBLE PHONES
- 11" DIAGONAL DRIVER INFORMATION CENTER
- SIRIUSXM AUDIO W/TRIAL SEE SIRIUSXM.COM/TERMS
- KEYLESS OPEN AND START
- REMOTE START
- ACTIVE NOISE CANCELLATION

INTERIOR

- HEATED FRONT BUCKET SEATS
- HEATED STEERING WHEEL
- USB PORTS
- EXPRESS UP/DOWN DRIVER WINDOW, ALL EXPRESS DOWN
- PASS-THROUGH CONSOLE
- ILLUMINATED VISOR VANITY MIRRORS

EXTERIOR

- OUTSIDE HEATED MIRRORS
- LED HEADLAMPS
- LED TAIL LAMPS
- REAR DEEP-TINTED WINDOWS

SAFETY & SECURITY

- ENHANCED AUTOMATIC EMERGENCY BRAKING
- FRONT PEDESTRIAN AND BICYCLIST BRAKING
- ENHANCED LANE KEEP ASSIST WITH LANE DEPARTURE WARNING
- FOLLOWING DISTANCE INDICATOR
- FORWARD COLLISION ALERT
- INTELLIBEAM, AUTO HIGH BEAM
- INTERSECTION AUTOMATIC EMERGENCY BRAKING
- REAR CROSS TRAFFIC BRAKING
- REVERSE AUTOMATIC BRAKING
- REAR PARK ASSIST
- BLIND ZONE STEERING ASSIST
- SAFETY ALERT SEAT

- ADAPTIVE CRUISE CONTROL

MANUFACTURER'S SUGGESTED RETAIL PRICE

STANDARD VEHICLE PRICE \$30,700.00

OPTIONS & PRICING

OPTIONS INSTALLED BY THE MANUFACTURER (MAY REPLACE STANDARD EQUIPMENT SHOWN)

- CONVENIENCE PACKAGE II 2,050.00
- EVOTEX SEATING SURFACES
- 8-WAY POWER DRIVER SEAT ADJUSTER
- 2-WAY POWER LUMBAR DRIVER SEAT ADJUSTER
- AUTONSENSE POWER LIFTGATE
- DUAL ZONE AUTO CLIMATE CONTROL
- RAIN SENSING FRONT WINDSHIELD WIPERS
- HEATED WIPER PARK
- WIRELESS DEVICE CHARGING
- UNIVERSAL HOME REMOTE

- CABIN HUMIDITY AND WINDSHIELD TEMPERATURE SENSOR
- SUNGLASS STORAGE
- SAFETY AND TECHNOLOGY PACKAGE 945.00
- HD SURROUND VISION
- REAR PEDESTRIAN ALERT
- TRAFFIC SIGN RECOGNITION
- FRONT FOG LAMPS
- REAR CAMERA MIRROR
- REAR CAMERA MIRROR WASHER
- FLOOR LINER PACKAGE (DEALER INSTALLED) 325.00
- ALL-WEATHER FLOOR LINERS
- ALL-WEATHER CARGO MAT

TOTAL OPTIONS \$3,320.00
TOTAL VEHICLE & OPTIONS \$34,020.00
DESTINATION CHARGE 1,795.00

TOTAL VEHICLE PRICE* \$35,815.00

EPA DOT Fuel Economy and Environment

Gasoline Vehicle

Fuel Economy
26 MPG
combined city/hwy
25 city
29 highway
3.8 gallons per 100 miles

EQUINOX AWD
Small SUVs range from 14 to 125 MPG.
The best vehicle rates 146 MPGe.

You spend
\$1,000
more in fuel costs
over 5 years
compared to the
average new vehicle.

Annual fuel cost
\$1,900

Fuel Economy & Greenhouse Gas Rating (tailpipe only)



This vehicle emits 342 grams CO₂ per mile. The best emits 0 grams per mile (tailpipe only). Producing and distributing fuel also create emissions; learn more at fuelconomy.gov.

Smog Rating (tailpipe only)

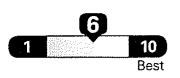

Actual results will vary for many reasons, including driving conditions and how you drive and maintain your vehicle. The average new vehicle gets 28 MPG and costs \$9,500 to fuel over 5 years. Cost estimates are based on 15,000 miles per year at \$3.30 per gallon. MPGe is miles per gasoline gallon equivalent. Vehicle emissions are a significant cause of climate change and smog.

fuelconomy.gov

Calculate personalized estimates and compare vehicles



GOVERNMENT 5-STAR SAFETY RATINGS

This vehicle has not been rated by the government for overall vehicle score, frontal crash, side crash or rollover risk.

Source: National Highway Traffic Safety Administration (NHTSA)
www.safercar.gov or 1-888-327-4236

PARTS CONTENT INFORMATION

FOR VEHICLES IN THIS CARLINE:
U.S./CANADIAN PARTS CONTENT: 11%
MAJOR SOURCES OF FOREIGN PARTS CONTENT: MEXICO 55%

NOTE: PARTS CONTENT DOES NOT INCLUDE FINAL ASSEMBLY, DISTRIBUTION, OR OTHER NON-PARTS COSTS.

FOR THIS VEHICLE:
FINAL ASSEMBLY POINT:
SAN LUIS POTOSI, MEXICO
COUNTRY OF ORIGIN:
ENGINE: MEXICO
TRANSMISSION: MEXICO

This label has been applied pursuant to Federal law - Do not remove prior to delivery to the ultimate purchaser. *Includes Manufacturer's Recommended Pre-Delivery Service. Does not include dealer installed options and accessories not listed above, local taxes or license fees.

© 2009 General Motors LLC
GMLBL_PROD_0044 - 11/01/2025



Better drives start with OnStar®
Activate today

Learn more at onstar.com, or scan the QR code

onstar.com/privacy





2026 EQUINOX LT AWD

EXTERIOR: STERLING GRAY METALLIC
INTERIOR: BLACK

1.5L TURBO DOHC ENGINE
8-SPEED AUTO TRANSMISSION

◀ PULL THIS STRIP TO EXPOSE ADHESIVE



Visit us at www.chevy.com

STANDARD EQUIPMENT

ITEMS FEATURED BELOW ARE INCLUDED AT NO EXTRA CHARGE IN THE STANDARD VEHICLE PRICE SHOWN

OWNER BENEFITS

- 3 YEAR/36,000 MILE* BUMPER-TO-BUMPER LIMITED WARRANTY
- 5 YEAR/60,000 MILE* POWERTRAIN LIMITED WARRANTY, ROADSIDE ASSISTANCE & COURTESY TRANSPORTATION
- FIRST MAINTENANCE VISIT *WHICHEVER COMES FIRST SEE CHEVROLET.COM OR DEALER FOR TERMS, DETAILS & LIMITS

PERFORMANCE & MECHANICAL

- 17" GRAZEN METALLIC MACHINED-FACE ALUMINUM WHEELS
- 17" STEEL SPARE WHEEL

CONNECTIVITY & TECHNOLOGY

- 8 YEARS ONSTAR BASICS SEE ONSTAR.COM FOR TERMS

- 11.3" DIAGONAL LCD DISPLAY WITH GOOGLE BUILT-IN WITH WIRELESS APPLE CARPLAY AND ANDROID AUTO FOR COMPATIBLE PHONES
- 11" DIAGONAL DRIVER INFORMATION CENTER
- SIRIUSXM AUDIO W/TRIAL SEE SIRIUSXM.COM/TERMS
- KEYLESS OPEN AND START
- REMOTE START
- ACTIVE NOISE CANCELLATION

INTERIOR

- HEATED FRONT BUCKET SEATS
- HEATED STEERING WHEEL
- USB PORTS
- EXPRESS UP/DOWN DRIVER WINDOW, ALL EXPRESS DOWN
- PASS-THROUGH CONSOLE
- ILLUMINATED VISOR VANITY MIRRORS

EXTERIOR

- OUTSIDE HEATED MIRRORS
- LED HEADLAMPS
- LED TAIL LAMPS
- REAR DEEP-TINTED WINDOWS

SAFETY & SECURITY

- ENHANCED AUTOMATIC EMERGENCY BRAKING
- FRONT PEDESTRIAN AND BICYCLIST BRAKING
- ENHANCED LANE KEEP ASSIST WITH LANE DEPARTURE WARNING
- FOLLOWING DISTANCE INDICATOR
- FORWARD COLLISION ALERT
- INTELLIBEAM, AUTO HIGH BEAM
- INTERSECTION AUTOMATIC EMERGENCY BRAKING
- REAR CROSS TRAFFIC BRAKING
- REVERSE AUTOMATIC BRAKING
- REAR PARK ASSIST
- BLIND ZONE STEERING ASSIST
- SAFETY ALERT SEAT

- HD REAR VISION CAMERA
- ADAPTIVE CRUISE CONTROL

MANUFACTURER'S SUGGESTED RETAIL PRICE

STANDARD VEHICLE PRICE \$30,700.00

OPTIONS & PRICING

OPTIONS INSTALLED BY THE MANUFACTURER (MAY REPLACE STANDARD EQUIPMENT SHOWN)

- CONVENIENCE PACKAGE II 2,050.00
- EVOTEX SEATING SURFACES
- 8-WAY POWER DRIVER SEAT ADJUSTER
- 2-WAY POWER LUMBAR DRIVER SEAT ADJUSTER
- AUTONSENSE POWER LIFTGATE
- DUAL ZONE AUTO CLIMATE CONTROL
- RAIN SENSING FRONT WINDSHIELD WIPERS
- HEATED WIPER PARK
- WIRELESS DEVICE CHARGING

- UNIVERSAL HOME REMOTE
- CABIN HUMIDITY AND WINDSHIELD TEMPERATURE SENSOR
- SUNGLASS STORAGE

| | |
|-------------------------|-------------|
| TOTAL OPTIONS | \$2,050.00 |
| TOTAL VEHICLE & OPTIONS | \$32,750.00 |
| DESTINATION CHARGE | 1,795.00 |

TOTAL VEHICLE PRICE* \$34,545.00

EPA DOT Fuel Economy and Environment

Gasoline Vehicle

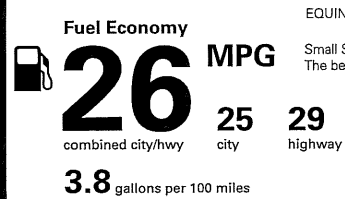

EQUINOX AWD

Small SUVs range from 14 to 125 MPG. The best vehicle rates 146 MPG.

You spend **\$1,000** more in fuel costs over 5 years compared to the average new vehicle.

Annual fuel cost **\$1,900**

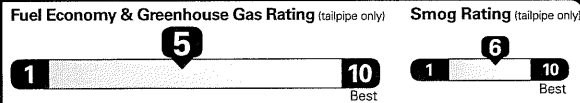

This vehicle emits 342 grams CO₂ per mile. The best emits 0 grams per mile (tailpipe only). Producing and distributing fuel also create emissions; learn more at fuelconomy.gov.

Actual results will vary for many reasons, including driving conditions and how you drive and maintain your vehicle. The average new vehicle gets 29 MPG and costs \$9,500 to fuel over 5 years. Cost estimates are based on 15,000 miles per year at \$3.30 per gallon. MPG is miles per gasoline gallon equivalent. Vehicle emissions are a significant cause of climate change and smog.



fuelconomy.gov
Calculate personalized estimates and compare vehicles



GOVERNMENT 5-STAR SAFETY RATINGS

This vehicle has not been rated by the government for overall vehicle score, frontal crash, side crash or rollover risk.

Source: National Highway Traffic Safety Administration (NHTSA)
www.safercar.gov or 1-888-327-4236

PARTS CONTENT INFORMATION

FOR VEHICLES IN THIS CARLINE:
U.S./CANADIAN PARTS CONTENT: 11%
MAJOR SOURCES OF FOREIGN PARTS CONTENT: MEXICO 55%

NOTE: PARTS CONTENT DOES NOT INCLUDE FINAL ASSEMBLY, DISTRIBUTION, OR OTHER NON-PARTS COSTS.

FOR THIS VEHICLE:
FINAL ASSEMBLY POINT:
SAN LUIS POTOSI, MEXICO
COUNTRY OF ORIGIN:
ENGINE: MEXICO
TRANSMISSION: MEXICO

This label has been applied pursuant to Federal law - Do not remove prior to delivery to the ultimate purchaser. *Includes Manufacturer's Recommended Pre-Delivery Service. Does not include dealer installed options and accessories not listed above, local taxes or license fees.

© 2025 General Motors LLC
GMLBL_PROD_0044 - 11/01/2025



Better drives start with OnStar®
Activate today

Learn more at onstar.com, or scan the QR code

onstar.com/privacy



Heartland Community Schools 2-Year Facilities Plan

| Project | | TOTAL FUNDING | Special Building Fund | Depreciation Fund | General Fund | Other |
|---|-----------|--------------------|-----------------------|---------------------------------|------------------------------|--------------------------|
| Bathrooms Project Summer 2027 | | | | | | |
| 1B: Elementary Bathroom #1 (B) | \$75,000 | | | | | |
| 1G: Elementary Bathroom #1 (B) | \$75,000 | \$150,000 | | | | |
| 2B: Elementary Bathroom SLR (B) | \$75,000 | | | | | |
| 2G: Elementary Bathroom SLR (G) | \$75,000 | \$150,000 | | | | |
| 3B: HS Bathroom (B) | \$75,000 | | | | | |
| 3G: HS Bathroom (G) | \$75,000 | \$150,000 | | | | |
| 4B: JH Bathroom (B) | \$75,000 | | | | | |
| 4G: JH Bathroom (G) | \$75,000 | \$150,000 | | | | |
| Project Total | | \$600,000 | \$0 | \$600,000 | \$300,000 | \$300,000 |
| | | | | \$0 | | \$0 |
| Playground Project Summer 2026 | | | | | | |
| Elementary Playground Renovation | \$600,000 | \$600,000 | | | | |
| Project Total | | \$600,000 | \$0 | \$600,000 | \$530,000 | \$70,000 |
| Parking Lot Project Summer 2027 | | | | | | |
| Parking Lot Expansion | \$700,000 | \$700,000 | | | | |
| Project Total | | \$700,000 | \$0 | \$700,000 | \$700,000 | \$0 |
| Hallways Project Summer 2026 | | | | | | |
| Finish Carpet Replacement HS/JH | \$25,000 | | | | | |
| Finish Carpet Replacement Elementary | \$20,000 | \$45,000 | | | | |
| Finish Ceiling Grid & Tile Replacement HS/JH | \$25,000 | \$25,000 | | | | |
| Project Total | | \$70,000 | \$0 | \$70,000 | \$25,000 | \$45,000 |
| | | | | | \$0 | \$0 |
| Track Project Summer 2026 | | | | | | |
| Track Resurface | \$185,000 | \$185,000 | | | | |
| Project Total | | \$185,000 | \$0 | \$185,000 | \$0 | \$185,000 |
| | | | | | \$0 | \$0 |
| Remaining Windows Project Summer 2026 | | | | | | |
| Windows Classroom/Courtyard East | \$60,000 | | | | | |
| Windows Classroom/Courtyard West | \$90,000 | \$150,000 | | | | |
| Project Total | | \$150,000 | \$0 | \$150,000 | \$75,000 | \$75,000 |
| | | | | | \$0 | \$0 |
| South Gym Locker Masonry Restoration Project TBD | | | | | | |
| Windows Classroom/Courtyard East | \$100,000 | \$100,000 | | | | |
| Project Total | | \$100,000 | \$0 | \$100,000 | \$100,000 | \$0 |
| | | | | | \$0 | \$0 |
| Cumulative Total | | \$2,405,000 | \$0 | \$2,405,000 | \$1,730,000 | \$605,000 |
| | | | | | \$0 | \$70,000 |
| | | | | TOTAL FUNDING | Special Building Fund | Depreciation Fund |
| | | | | | | General Fund |
| | | | | | | Other |
| | | | | 100% Net-Balance | \$2,000,000 | \$1,100,000 |
| | | | | | | - |
| | | | | | | \$70,000 |
| | | | | Capped Balance | \$1,800,000 | \$990,000 |
| | | | | | | - |
| | | | | | | \$70,000 |
| | | | | Funding Requirement | \$1,730,000 | \$605,000 |
| | | | | | | - |
| | | | | | | \$70,000 |
| | | | | Remaining Capped Balance | \$70,000 | \$385,000 |
| | | | | | | - |
| | | | | | | \$0 |
| | | | | Remaining 100% Balance | \$270,000 | \$495,000 |
| | | | | | | - |
| | | | | | | \$0 |

COSTS

FUNDING

CLARK &
ENERSEN

**Heartland Community Schools
East Playground Design**

January 22, 2026



CONCEPTS & COSTS

RECOMMENDED PLAY EQUIPMENT

▶ **Lhotse with Roof (22)**



▶ **Universal Carousel (8)**



▶ **Bloqx 2 Climber (10)**

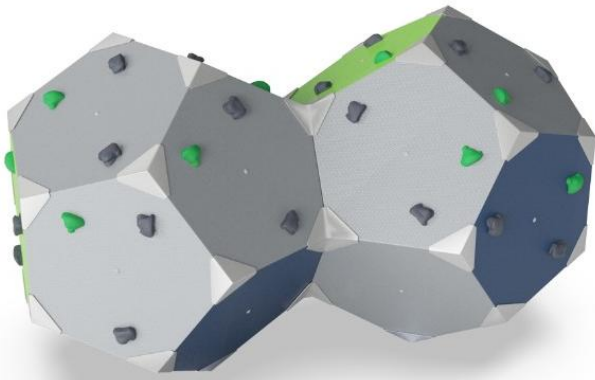

▶ **6 Seat, 8' Ht. Swing (6 standard swings & 1 inclusive swing available to substitute) (6)**



CONCEPT 3.0 - remove existing playground & locate basketball to the north

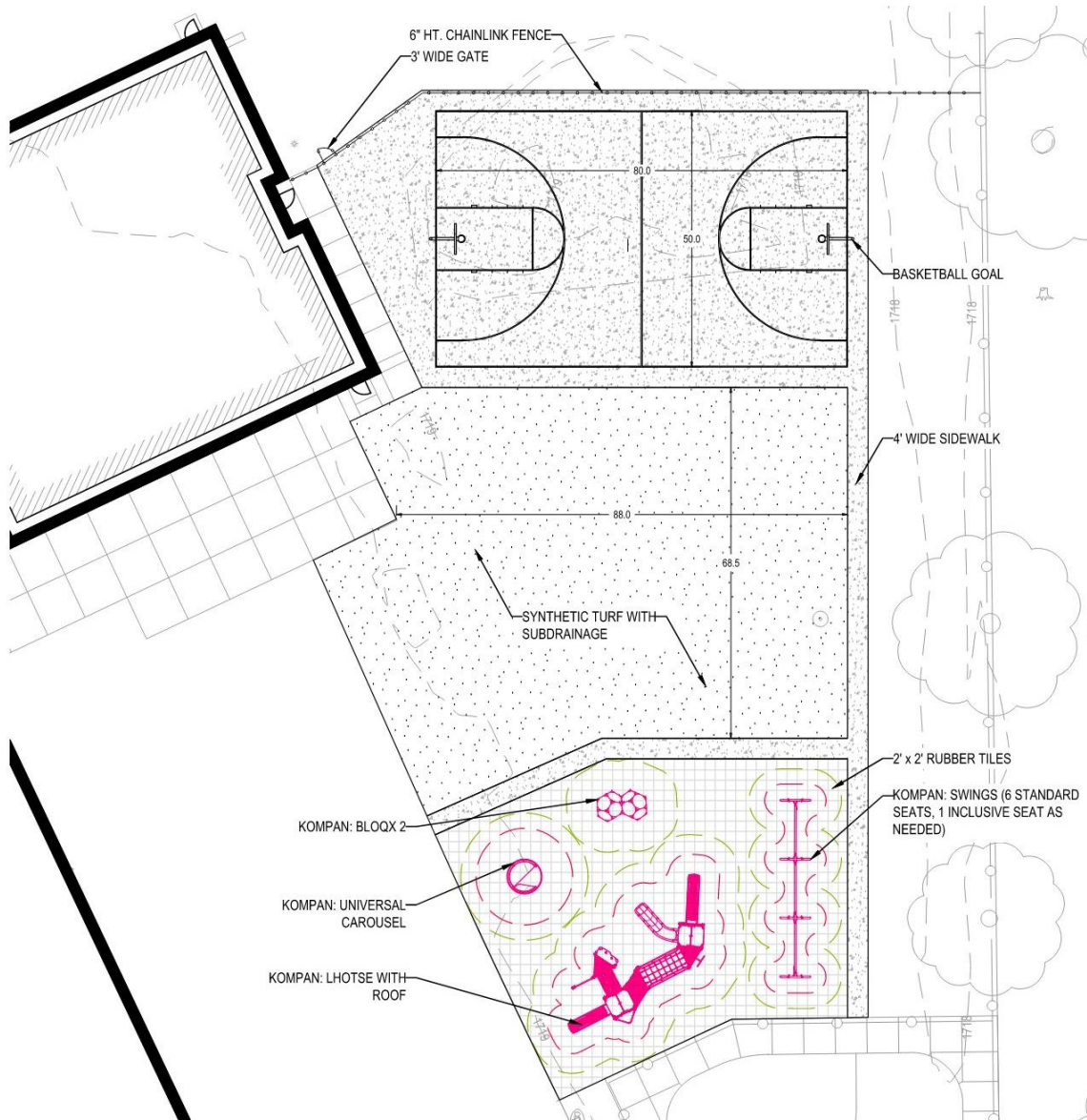

| | Quantity | Units | Rate | Cost |
|---|----------|-------|-------------|---------------------|
| Crouch Recreation Direct Purchase | | | | \$201,011.30 |
| 1 Kompan Equipment | 1 | EA | \$75,010.00 | \$75,010.00 |
| 2 Kompan Freight | 1 | EA | \$9,001.30 | \$9,001.30 |
| 3 2' x 2' Rubber Tiles | 3,900 | SF | \$30.00 | \$117,000.00 |
| Competitive Bid | | | | \$278,450.00 |
| 4 Mobilization | 1 | LS | \$5,500.00 | \$5,500.00 |
| 5 Demolition | 1 | LS | \$10,000.00 | \$10,000.00 |
| 6 Site Prep/Earthwork | 1 | LS | \$20,000.00 | \$20,000.00 |
| 7 Playground Install | 1 | LS | \$75,000.00 | \$75,000.00 |
| 8 5" Concrete Walk | 6,500 | SF | \$7.00 | \$45,500.00 |
| 9 Synthetic Turf with Subdrainage | 6,800 | SF | \$15.50 | \$105,400.00 |
| 10 Basketball Goal | 2 | EA | \$5,000.00 | \$10,000.00 |
| 11 6' Ht. Chainlink Fence | 141 | LF | \$50.00 | \$7,050.00 |
| 12 Final Cleaning/Restoration | 1 | LS | \$4,250.00 | \$4,250.00 |
| General Contractor General Conditions (10%) | 10% | | | \$27,845.00 |
| Contractor Overhead and Profit (4%) | 4% | | | \$9,745.75 |
| | | | Subtotal | \$316,040.75 |
| Inflation / Estimate Contingency (6%) | 6% | | | \$18,962.45 |
| Competitive Bid Total | | | | \$335,003.20 |
| Option 3.0 PROJECT COST | | | | \$536,014.50 |

CONCEPT 3.1 - remove existing playground & centrally locate basketball

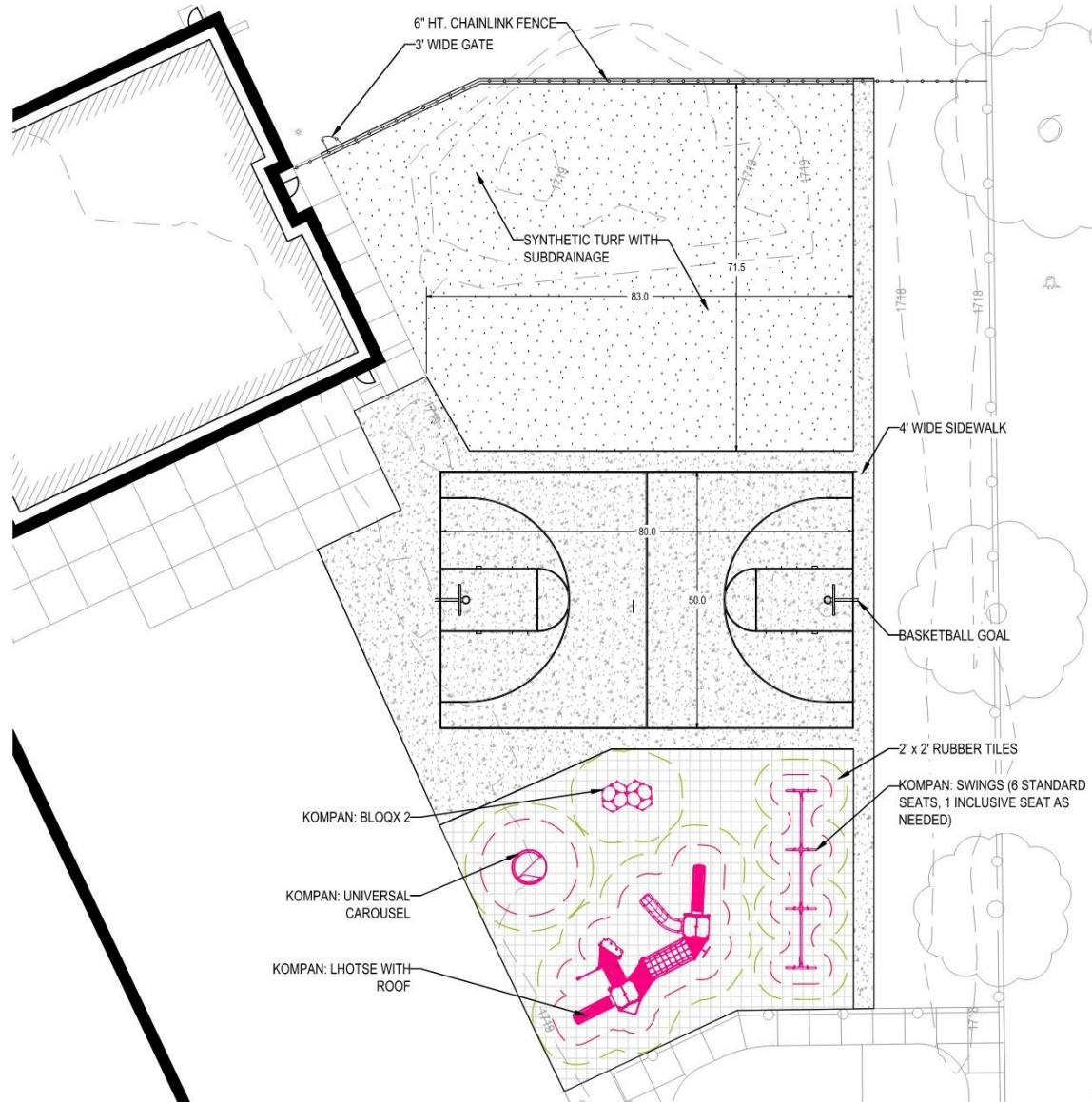

| | Quantity | Units | Rate | Cost |
|---|----------|-------|-------------|---------------------|
| Crouch Recreation Direct Purchase | | | | \$201,011.30 |
| 1 Kompan Equipment | 1 | EA | \$75,010.00 | \$75,010.00 |
| 2 Kompan Freight | 1 | EA | \$9,001.30 | \$9,001.30 |
| 3 2' x 2' Rubber Tiles | 3,900 | SF | \$30.00 | \$117,000.00 |
| Competitive Bid | | | | \$275,475.00 |
| 4 Mobilization | 1 | LS | \$5,500.00 | \$5,500.00 |
| 5 Demolition | 1 | LS | \$10,000.00 | \$10,000.00 |
| 6 Site Prep/Earthwork | 1 | LS | \$20,000.00 | \$20,000.00 |
| 7 Playground Install | 1 | LS | \$75,000.00 | \$75,000.00 |
| 8 5" Concrete Walk | 6,800 | SF | \$7.00 | \$47,600.00 |
| 9 Synthetic Turf with Subdrainage | 6,450 | SF | \$15.50 | \$99,975.00 |
| 10 Basketball Goal | 2 | EA | \$5,000.00 | \$10,000.00 |
| 11 6' Ht. Chainlink Fence | 148 | LF | \$50.00 | \$7,400.00 |
| 12 Final Cleaning/Restoration | 1 | LS | \$4,250.00 | \$4,250.00 |
| General Contractor General Conditions (10%) | 10% | | | \$27,547.50 |
| Contractor Overhead and Profit (4%) | 4% | | | \$9,641.63 |
| | | | Subtotal | \$312,664.13 |
| Inflation / Estimate Contingency (6%) | 6% | | | \$18,759.85 |
| Competitive Bid Total | | | | \$331,423.97 |
| Option 3.1 PROJECT COST | | | | \$532,435.27 |

CONCEPT 3.2 - preserve existing playground & locate basketball to the west

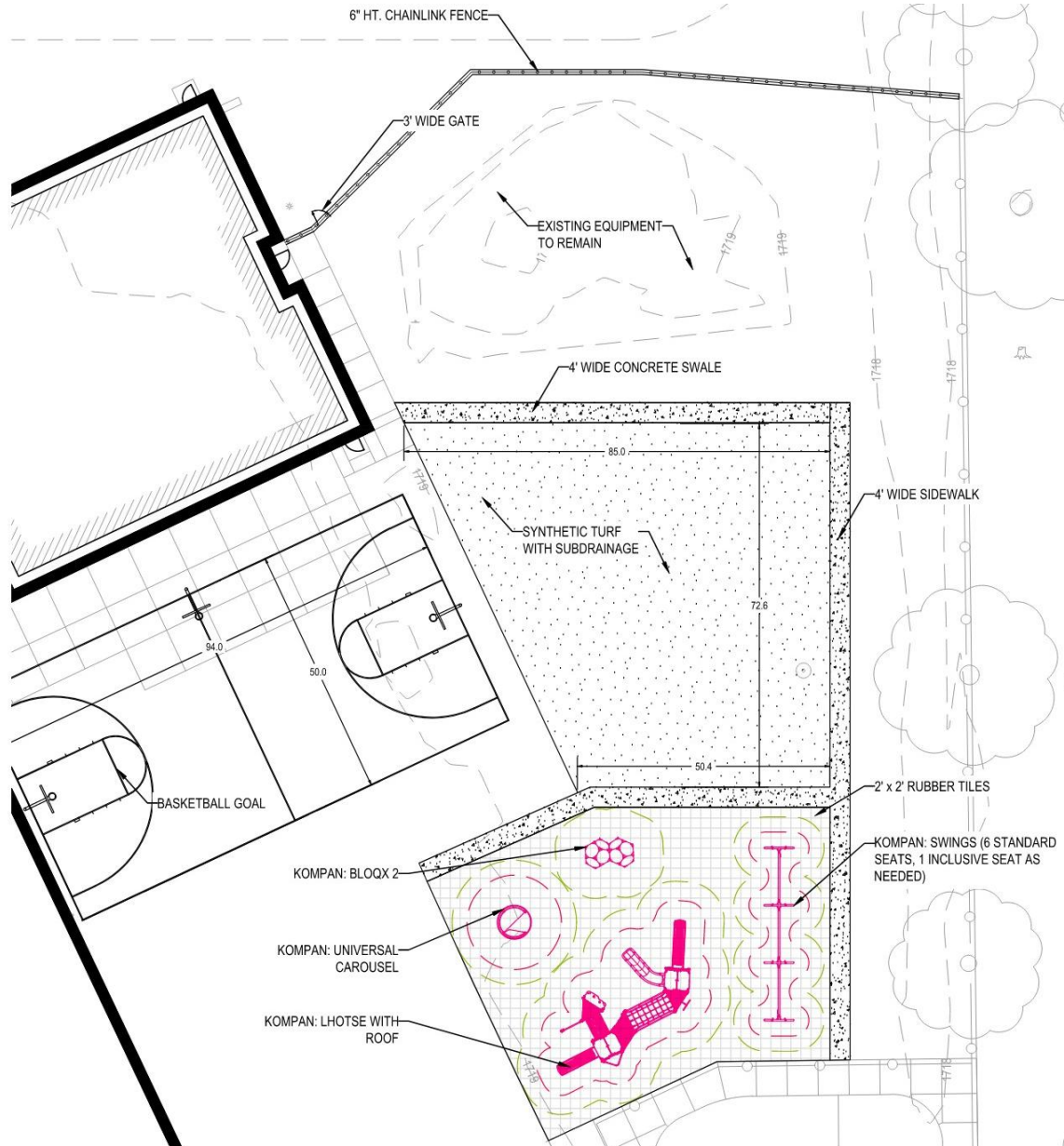

| | Quantity | Units | Rate | Cost |
|---|----------|-------|-------------|---------------------|
| Crouch Recreation Direct Purchase | | | | \$201,011.30 |
| 1 Kompan Equipment | 1 | EA | \$75,010.00 | \$75,010.00 |
| 2 Kompan Freight | 1 | EA | \$9,001.30 | \$9,001.30 |
| 3 2' x 2' Rubber Tiles | 3,900 | SF | \$30.00 | \$117,000.00 |
| Competitive Bid | | | | \$203,088.00 |
| 4 Mobilization | 1 | LS | \$5,500.00 | \$5,500.00 |
| 5 Demolition | 1 | LS | \$7,500.00 | \$7,500.00 |
| 6 Site Prep/Earthwork | 1 | LS | \$7,500.00 | \$7,500.00 |
| 7 Playground Install | 1 | LS | \$75,000.00 | \$75,000.00 |
| 8 5" Concrete Walk | 1,209 | SF | \$7.00 | \$8,463.00 |
| 9 Synthetic Turf with Subdrainage | 4,950 | SF | \$15.50 | \$76,725.00 |
| 10 Basketball Goal | 3 | EA | \$5,000.00 | \$15,000.00 |
| 11 6' Ht. Chainlink Fence | 148 | LF | \$50.00 | \$7,400.00 |
| 12 Final Cleaning/Restoration | 1 | LS | \$4,250.00 | \$4,250.00 |
| General Contractor General Conditions (10%) | 10% | | | \$20,308.80 |
| Contractor Overhead and Profit (4%) | 4% | | | \$7,108.08 |
| | | | Subtotal | \$230,504.88 |
| Inflation / Estimate Contingency (6%) | 6% | | | \$13,830.29 |
| Competitive Bid Total | | | | \$244,335.17 |
| Option 3.2 PROJECT COST | | | | \$445,346.47 |

QUESTIONS & NEXT STEPS

HEARTLAND COMMUNITY SCHOOLS

Certificated Employment Contract

This agreement is made by and between the Heartland Community Schools, District No. 0096 in the County of York, in the state of Nebraska, hereinafter referred to as the District and **Noah Jones**, hereinafter referred to as the Employee.

1. The terms hereinafter enumerated in this contract shall take effect on August 1, 2026.
2. The salary of the Employee shall be payable in equal installments. The first installment shall be payable on or about the 20th day of September and the remaining installments shall be payable on or about the 20th day of each month thereafter.

INITIAL CONTRACT PLACEMENT

FTE: 1.0

BA Step 1 Index: 1.00

Future amendments or additions to indexed salary resulting from extra duty assignment or allowable advancement shall established through written memoranda of understanding and attached hereto.

3. The Employee hereby agrees to be governed by the policies of the Board of Education of the District and the duties to be performed by the Employee under this contract shall be subject to assignment of the Superintendent of the District.
4. The Employee agrees to devote full time, during days of employment, to his/her position in all respects, to diligently and faithfully perform the assigned duties to the best of his/her professional ability.
5. In addition to the duties set forth herein, the Employee may be assigned such "extra duty" assignments as defined from time to time by the parties of this agreement which shall be upon such terms and conditions and at such additional stated rate of compensation as outlined in the collective bargaining agreement or between the parties of this agreement.
6. This contract may be cancelled or amended by a majority of the members of the school board during the school year for any of the following reasons: (a) upon cancellation, termination, revocation or suspension of the professional certificate or licensure by the State Board of Education; (b) breach of any of the material provisions of this contract; (c) for any reason set forth in this contract; (d) incompetence; (e) neglect of duty; (f) unprofessional conduct; (g) insubordination; (h) immorality, or (i) physical or mental incapacity. Cancellation or amendment under this contract shall be governed by the provisions of 79-12, 110, R.R.S. (1982 Supp.)
7. That upon the termination of this contract for just cause, or upon the release of the Employee from this contract, the compensation paid or to be paid hereunder shall be an amount that bears the same ratio to the yearly salary herein specified as the number of days of service to the date of such termination bears to 185 days of service. Any unearned fractional portion of an installment paid, but not earned prior to termination of the contract, shall be refunded by the Employee.



HEARTLAND COMMUNITY SCHOOLS

Certificated Employment Contract

8. There shall be no penalty for release or resignation by the Employee from this contract, provided no resignation shall become effective until the close of the school year unless accepted by the Board of Education of the District, and the Board shall fix the time at which the resignation is to take effect.
9. This contract shall conform to the regulations governing deductions from the above stated compensation with reference to withholding tax, social security, and Employee's retirement. Other deductions may be withheld as agreed to by the parties to this contract.
10. The Employee hereby affirms that he/she is not under contract with another Board of Education within the state of Nebraska during the term(s) of employment covered by this contract.
11. It is understood and agreed that this contract is not valid until the Employee's professional certificate is registered in the office of the Superintendent and that the Employee shall not be compensated for any services performed prior to the date of registration of this certificate.
12. Terms and conditions set forth in this agreement shall be subject to such wages and conditions of employment as may, from time to time, be mutually agreed upon by and between the Board and Employees or a duly recognized collective bargaining agent for said Employees, and said agreement, when reduced to writing, and executed by the parties, shall be deemed to be included herein by reference and shall become a part hereof.
13. Hereafter, renewal, amendment, termination, or cancellation of this agreement shall be subject to the requirements of Section 79-824 through 79-842 R.R.S. and any other applicable state statutes.

Employee Signature

Date

Executed this _____ day of _____, 20____ by

Board President

Board Secretary



Noah Jones



Education:

University of Nebraska-Lincoln, Pursuing a Bachelor's Degree, September 2022 - Current

- Three years into a Bachelor's Degree in Secondary Education - Social Studies
 - Expected Graduation: May 2026
- 3.8 GPA

York High School, High School Diploma, August 2018 - May 2022

- 4.0 GPA
- 31 ACT
- Graduated with 25 college credit hours from Southeast Community College and Peru State College

Teaching Experience:

Mickle Middle School - Practicum Teacher - **November 2025 - December 2025**

- Helped with classroom management
- Assisted in lesson planning
- Planned and led multiple bell-to-bell lessons

Lincoln Northwest High School - Practicum Teacher - **September 2025 - October 2025**

- Led openers and formative assessments
- Helped with classroom management
- Planned and led a bell-to-bell lesson

Coaching Experience:

H&H Basketball - Assistant Coach/Freshman Head Coach - **June 2025 - Present**

- Lead players/groups through drills
- Assistant for varsity, junior varsity, and reserve teams
- Freshman team head coach

Hampton High School Football - Assistant Coach - **June 2023 - Present**

- Coached Quarterbacks, Wide Receivers, and Defensive Backs
- Led position drills
- Helped design offensive playbook

Aurora Legion Baseball - Assistant Juniors Coach - **May 2024 - Present**

- 1st base coach for Junior and Senior teams
- Ran practice drills

Hampton High School Basketball - Assistant Coach/JV Head Coach - **November 2024 - February 2025**

- Head Junior Varsity Coach
- Assistant Varsity Coach
 - Helped with in-game decisions
- Ran practice drills

Scheduled Vehicle Replacement: 2022 Equinox (Feb. 2026)

| | February 2026 | | | Spring 2022 | |
|---|-------------------|-------------------------------|----------|---|--|
| | 2026 Equinox Base | 2026 Equinox w/ Safety Pkg | | 2022 Equinox | |
| Purchase Price by Gov Contract | \$34,545 | \$35,815 | \$31,490 | Purchase Price by Gov Contract | |
| Trade-In Mileage | 40,000 | 40,000 | 31,000 | Trade-In Mileage | |
| Trade-In | \$18,000 | \$18,000 | | Trade-In | |
| Additional Discount | \$1,500 | \$1,500 | | Additional Discount | |
| Total Credit | \$19,500 | \$19,500 | \$18,000 | Total Credit | |
| Purchase Price | \$15,045 | \$16,315 | \$13,490 | Purchase Price | |



2026 EQUINOX LT AWD

EXTERIOR: SUMMIT WHITE
INTERIOR: BLACK

1.5L TURBO DOHC ENGINE
8-SPEED AUTO TRANSMISSION

◀ PULL THIS STRIP TO EXPOSE ADHESIVE



STANDARD EQUIPMENT

ITEMS FEATURED BELOW ARE INCLUDED AT NO EXTRA CHARGE IN THE STANDARD VEHICLE PRICE SHOWN

OWNER BENEFITS

- 3 YEAR/36,000 MILE* BUMPER-TO-BUMPER LIMITED WARRANTY
- 5 YEAR/60,000 MILE* POWERTRAIN LIMITED WARRANTY, ROADSIDE ASSISTANCE & COURTESY TRANSPORTATION
- FIRST MAINTENANCE VISIT *WHICHEVER COMES FIRST SEE CHEVROLET.COM OR DEALER FOR TERMS, DETAILS & LIMITS

PERFORMANCE & MECHANICAL

- 17" GRAZEN METALLIC MACHINED-FACE ALUMINUM WHEELS
- 17" STEEL SPARE WHEEL

CONNECTIVITY & TECHNOLOGY

- 8 YEARS ONSTAR BASICS SEE ONSTAR.COM FOR TERMS

- 11.3" DIAGONAL LCD DISPLAY WITH GOOGLE BUILT-IN WITH WIRELESS APPLE CARPLAY AND ANDROID AUTO FOR COMPATIBLE PHONES
- 11" DIAGONAL DRIVER INFORMATION CENTER
- SIRIUSXM AUDIO W/TRIAL SEE SIRIUSXM.COM/TERMS
- KEYLESS OPEN AND START
- REMOTE START
- ACTIVE NOISE CANCELLATION

INTERIOR

- HEATED FRONT BUCKET SEATS
- HEATED STEERING WHEEL
- USB PORTS
- EXPRESS UP/DOWN DRIVER WINDOW, ALL EXPRESS DOWN
- PASS-THROUGH CONSOLE
- ILLUMINATED VISOR VANITY MIRRORS

EXTERIOR

- OUTSIDE HEATED MIRRORS
- LED HEADLAMPS
- LED TAIL LAMPS
- REAR DEEP-TINTED WINDOWS

SAFETY & SECURITY

- ENHANCED AUTOMATIC EMERGENCY BRAKING
- FRONT PEDESTRIAN AND BICYCLIST BRAKING
- ENHANCED LANE KEEP ASSIST WITH LANE DEPARTURE WARNING
- FOLLOWING DISTANCE INDICATOR
- FORWARD COLLISION ALERT
- INTELLIBEAM, AUTO HIGH BEAM
- INTERSECTION AUTOMATIC EMERGENCY BRAKING
- REAR CROSS TRAFFIC BRAKING
- REVERSE AUTOMATIC BRAKING
- REAR PARK ASSIST
- BLIND ZONE STEERING ASSIST
- SAFETY ALERT SEAT

- ADAPTIVE CRUISE CONTROL

MANUFACTURER'S SUGGESTED RETAIL PRICE

STANDARD VEHICLE PRICE \$30,700.00

OPTIONS & PRICING

OPTIONS INSTALLED BY THE MANUFACTURER (MAY REPLACE STANDARD EQUIPMENT SHOWN)

- CONVENIENCE PACKAGE II 2,050.00
- EVOTEX SEATING SURFACES
- 8-WAY POWER DRIVER SEAT ADJUSTER
- 2-WAY POWER LUMBAR DRIVER SEAT ADJUSTER
- AUTONSENSE POWER LIFTGATE
- DUAL ZONE AUTO CLIMATE CONTROL
- RAIN SENSING FRONT WINDSHIELD WIPERS
- HEATED WIPER PARK
- WIRELESS DEVICE CHARGING
- UNIVERSAL HOME REMOTE

Visit us at www.chevy.com

- CABIN HUMIDITY AND WINDSHIELD TEMPERATURE SENSOR
- SUNGLASS STORAGE
- SAFETY AND TECHNOLOGY PACKAGE 945.00
- HD SURROUND VISION
- REAR PEDESTRIAN ALERT
- TRAFFIC SIGN RECOGNITION
- FRONT FOG LAMPS
- REAR CAMERA MIRROR
- REAR CAMERA MIRROR WASHER
- FLOOR LINER PACKAGE (DEALER INSTALLED) 325.00
- ALL-WEATHER FLOOR LINERS
- ALL-WEATHER CARGO MAT

TOTAL OPTIONS \$3,320.00
TOTAL VEHICLE & OPTIONS \$34,020.00
DESTINATION CHARGE 1,795.00

TOTAL VEHICLE PRICE* \$35,815.00

EPA DOT Fuel Economy and Environment

Gasoline Vehicle

Fuel Economy
26 MPG
combined city/hwy
25 city
29 highway
3.8 gallons per 100 miles

EQUINOX AWD
Small SUVs range from 14 to 125 MPG.
The best vehicle rates 146 MPGe.

You spend
\$1,000
more in fuel costs
over 5 years
compared to the
average new vehicle.

Annual fuel cost
\$1,900

Fuel Economy & Greenhouse Gas Rating (tailpipe only)



This vehicle emits 342 grams CO₂ per mile. The best emits 0 grams per mile (tailpipe only). Producing and distributing fuel also create emissions; learn more at fuelconomy.gov.

Smog Rating (tailpipe only)

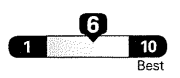

Actual results will vary for many reasons, including driving conditions and how you drive and maintain your vehicle. The average new vehicle gets 28 MPG and costs \$9,500 to fuel over 5 years. Cost estimates are based on 15,000 miles per year at \$3.30 per gallon. MPGe is miles per gasoline gallon equivalent. Vehicle emissions are a significant cause of climate change and smog.

fuelconomy.gov
Calculate personalized estimates and compare vehicles



GOVERNMENT 5-STAR SAFETY RATINGS

This vehicle has not been rated by the government for overall vehicle score, frontal crash, side crash or rollover risk.

Source: National Highway Traffic Safety Administration (NHTSA)
www.safercar.gov or 1-888-327-4236

PARTS CONTENT INFORMATION

FOR VEHICLES IN THIS CARLINE:
U.S./CANADIAN PARTS CONTENT: 11%
MAJOR SOURCES OF FOREIGN PARTS CONTENT: MEXICO 55%

NOTE: PARTS CONTENT DOES NOT INCLUDE FINAL ASSEMBLY, DISTRIBUTION, OR OTHER NON-PARTS COSTS.

FOR THIS VEHICLE:
FINAL ASSEMBLY POINT:
SAN LUIS POTOSI, MEXICO
COUNTRY OF ORIGIN:
ENGINE: MEXICO
TRANSMISSION: MEXICO

This label has been applied pursuant to Federal law - Do not remove prior to delivery to the ultimate purchaser. Includes Manufacturer's Recommended Pre-Delivery Service. Does not include dealer installed options and accessories not listed above, local taxes or license fees.

© 2025 General Motors LLC
GMLBL_PROD_0044 - 11/01/2025



Better drives start with OnStar®
Activate today

Learn more at onstar.com, or scan the QR code
onstar.com/privacy





2026 EQUINOX LT AWD

EXTERIOR: STERLING GRAY METALLIC
INTERIOR: BLACK

1.5L TURBO DOHC ENGINE
8-SPEED AUTO TRANSMISSION

◀ PULL THIS STRIP TO EXPOSE ADHESIVE



Visit us at www.chevy.com

STANDARD EQUIPMENT

ITEMS FEATURED BELOW ARE INCLUDED AT NO EXTRA CHARGE IN THE STANDARD VEHICLE PRICE SHOWN

OWNER BENEFITS

- 3 YEAR/36,000 MILE* BUMPER-TO-BUMPER LIMITED WARRANTY
- 5 YEAR/60,000 MILE* POWERTRAIN LIMITED WARRANTY, ROADSIDE ASSISTANCE & COURTESY TRANSPORTATION
- FIRST MAINTENANCE VISIT *WHICHEVER COMES FIRST SEE CHEVROLET.COM OR DEALER FOR TERMS, DETAILS & LIMITS

PERFORMANCE & MECHANICAL

- 17" GRAZEN METALLIC MACHINED-FACE ALUMINUM WHEELS
- 17" STEEL SPARE WHEEL

CONNECTIVITY & TECHNOLOGY

- 8 YEARS ONSTAR BASICS SEE ONSTAR.COM FOR TERMS

- 11.3" DIAGONAL LCD DISPLAY WITH GOOGLE BUILT-IN WITH WIRELESS APPLE CARPLAY AND ANDROID AUTO FOR COMPATIBLE PHONES
- 11" DIAGONAL DRIVER INFORMATION CENTER
- SIRIUSXM AUDIO W/TRIAL SEE SIRIUSXM.COM/TERMS
- KEYLESS OPEN AND START
- REMOTE START
- ACTIVE NOISE CANCELLATION

INTERIOR

- HEATED FRONT BUCKET SEATS
- HEATED STEERING WHEEL
- USB PORTS
- EXPRESS UP/DOWN DRIVER WINDOW, ALL EXPRESS DOWN
- PASS-THROUGH CONSOLE
- ILLUMINATED VISOR VANITY MIRRORS

EXTERIOR

- OUTSIDE HEATED MIRRORS
- LED HEADLAMPS
- LED TAIL LAMPS
- REAR DEEP-TINTED WINDOWS

SAFETY & SECURITY

- ENHANCED AUTOMATIC EMERGENCY BRAKING
- FRONT PEDESTRIAN AND BICYCLIST BRAKING
- ENHANCED LANE KEEP ASSIST WITH LANE DEPARTURE WARNING
- FOLLOWING DISTANCE INDICATOR
- FORWARD COLLISION ALERT
- INTELLIBEAM, AUTO HIGH BEAM
- INTERSECTION AUTOMATIC EMERGENCY BRAKING
- REAR CROSS TRAFFIC BRAKING
- REVERSE AUTOMATIC BRAKING
- REAR PARK ASSIST
- BLIND ZONE STEERING ASSIST
- SAFETY ALERT SEAT

- HD REAR VISION CAMERA
- ADAPTIVE CRUISE CONTROL

MANUFACTURER'S SUGGESTED RETAIL PRICE

STANDARD VEHICLE PRICE \$30,700.00

OPTIONS & PRICING

OPTIONS INSTALLED BY THE MANUFACTURER (MAY REPLACE STANDARD EQUIPMENT SHOWN)

- CONVENIENCE PACKAGE II 2,050.00
- EVOTEX SEATING SURFACES
- 8-WAY POWER DRIVER SEAT ADJUSTER
- 2-WAY POWER LUMBAR DRIVER SEAT ADJUSTER
- AUTONSENSE POWER LIFTGATE
- DUAL ZONE AUTO CLIMATE CONTROL
- RAIN SENSING FRONT WINDSHIELD WIPERS
- HEATED WIPER PARK
- WIRELESS DEVICE CHARGING

- UNIVERSAL HOME REMOTE
- CABIN HUMIDITY AND WINDSHIELD TEMPERATURE SENSOR
- SUNGLASS STORAGE

| | |
|-------------------------|-------------|
| TOTAL OPTIONS | \$2,050.00 |
| TOTAL VEHICLE & OPTIONS | \$32,750.00 |
| DESTINATION CHARGE | 1,795.00 |

TOTAL VEHICLE PRICE* \$34,545.00

EPA DOT Fuel Economy and Environment

Gasoline Vehicle

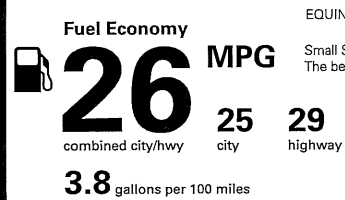

EQUINOX AWD

Small SUVs range from 14 to 125 MPG. The best vehicle rates 146 MPG.

You spend **\$1,000** more in fuel costs over 5 years compared to the average new vehicle.

Annual fuel cost **\$1,900**

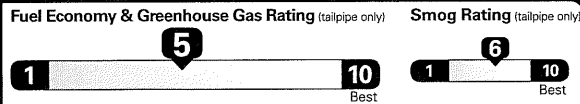

This vehicle emits 342 grams CO₂ per mile. The best emits 0 grams per mile (tailpipe only). Producing and distributing fuel also create emissions; learn more at fuelconomy.gov.

Actual results will vary for many reasons, including driving conditions and how you drive and maintain your vehicle. The average new vehicle gets 29 MPG and costs \$9,500 to fuel over 5 years. Cost estimates are based on 15,000 miles per year at \$3.30 per gallon. MPG is miles per gasoline gallon equivalent. Vehicle emissions are a significant cause of climate change and smog.



fuelconomy.gov
Calculate personalized estimates and compare vehicles



GOVERNMENT 5-STAR SAFETY RATINGS

This vehicle has not been rated by the government for overall vehicle score, frontal crash, side crash or rollover risk.

Source: National Highway Traffic Safety Administration (NHTSA)
www.safercar.gov or 1-888-327-4236

PARTS CONTENT INFORMATION

FOR VEHICLES IN THIS CARLINE:
U.S./CANADIAN PARTS CONTENT: 11%
MAJOR SOURCES OF FOREIGN PARTS CONTENT: MEXICO 55%

NOTE: PARTS CONTENT DOES NOT INCLUDE FINAL ASSEMBLY, DISTRIBUTION, OR OTHER NON-PARTS COSTS.

FOR THIS VEHICLE:
FINAL ASSEMBLY POINT:
SAN LUIS POTOSI, MEXICO
COUNTRY OF ORIGIN:
ENGINE: MEXICO
TRANSMISSION: MEXICO

This label has been applied pursuant to Federal law - Do not remove prior to delivery to the ultimate purchaser. *Includes Manufacturer's Recommended Pre-Delivery Service. Does not include dealer installed options and accessories not listed above, local taxes or license fees.

© 2025 General Motors LLC
GMLBL_PROD_0044 - 11/01/2025



Better drives start with OnStar®
Activate today

Learn more at onstar.com, or scan the QR code

onstar.com/privacy



HEARTLAND COMMUNITY SCHOOLS
EMPOWERING EXCELLENCE - Every Student, Every Day

Minutes for
Board of Education Regular Meeting

Monday, January 12, 2026 7:00 PM
Conference Room
1501 Front St
Henderson, NE 68371-8929

Notice of the meeting was posted in the Henderson News on January 8, 2026.

Attendance

Lacey Gloystein: Present
Ryan Goertzen: Present
Jen Hiebner: Present
Jeb Mierau: Present
Tyler Newton: Present
Tammy Ott: Present

1. Preliminary Procedures

1.1. Call to Order

1.2. Recognize Notice of Meeting

1.3. Recognize Open Meetings Act Posting

1.4. Roll Call

2. Election / Appointment Of Officers For 2026

2.1. President

Tyler Newton nominated for Board President. Passed with a motion by Jen Hiebner and a second by Ryan Goertzen.

Tyler Newton: Abstain (With Conflict), Lacey Gloystein: Yea, Ryan Goertzen: Yea, Jen Hiebner: Yea, Jeb Mierau: Yea, Tammy Ott: Yea

2.2. Vice President

Ryan Goertzen nominated by Lacey Gloystein. Yea: 5. Abstain: Ryan Goertzen.

2.3. Secretary

Lacey Gloystein nominated by Tammy Ott. Yea: 5. Abstain: Lacey Gloystein.

3. Public Comments On Agenda Items

Public comment will be limited to items on the current agenda. Public comment may be limited to a total of 30 minutes, individuals will be limited to 5 minutes each.

Nebraska Revised Statute 84-1412 requires members of the public desiring to provide comments to the board to identify himself or herself, including an address, and the name of any organization represented by such person. A form is provided at the meeting for individuals to complete and to submit to the superintendent prior to speaking for the purposes of efficiently providing this information.

4. Reports

4.1. Superintendent's Report

4.2. Principals' Reports

5. Discussion Items

5.1. Committee Assignments

Board decision for committee assignments to stay as listed.

5.2. American Civics Committee Report

5.3. Huskie Branch - School Savings Program

5.4. Scheduled Vehicle Replacement - 2022 Equinox

5.5. Board Retreat

5.6. Building / Construction Update

5.7. K-6 Playground Renovation

6. Action Items

6.1. Approve Certified Contracts

6.1.1. Kelsey Linaberry (K-12 Vocal Music)

Approve the 2026-2027 teaching contract for Kelsey Linaberry as presented. Passed with a motion by Jen Hiebner and a second by Tammy Ott.

Lacey Gloystein: Yea, Ryan Goertzen: Yea, Jen Hiebner: Yea, Jeb Mierau: Yea, Tyler Newton: Yea, Tammy Ott: Yea

6.2. Authorize School Savings Program Bank Account

Authorize the establishment of a two-signature checking account with Henderson State Bank, owned by Heartland Community Schools, for the purposes of participating with Henderson State Bank in the In School Savings Program with approved signatories to be Tyler Newton, Ryan Goertzen, Lacey Gloystein, and Jeremy Klein. Passed with a motion by Ryan Goertzen and a second by Jen Hiebner. Tammy Ott: Abstain (With Conflict), Lacey Gloystein: Yea, Ryan Goertzen: Yea, Jen Hiebner: Yea, Jeb Mierau: Yea, Tyler Newton: Yea

7. Future Agenda Items

7.1. Regular Meeting: Monday, February 9th @ 7 PM

7.2. Board Retreat

8. Consent Agenda

Approve consent agenda. Passed with a motion by Ryan Goertzen and a second by Tammy Ott.

Lacey Gloystein: Yea, Ryan Goertzen: Yea, Jen Hiebner: Yea, Jeb Mierau: Yea, Tyler Newton: Yea, Tammy Ott: Yea

8.1. Approval of Minutes

8.1.1. *Regular: Monday, December 8, 2025*

8.2. Approval of Claims

8.3. Financial Reports

8.4. Approval Of Construction Claims

8.5. Appoint At-Will Board Treasurer

8.6. Appoint Superintendent As Non-Discrimination Compliance Coordinator

8.7. Appoint Superintendent As Authorized Representative For All Federal, State, and Inter-Local Programs

9. **Adjournment**

Motion to Adjourn. Passed with a motion by Jen Hiebner and a second by Ryan Goertzen.

Lacey Gloystein: Yea, Ryan Goertzen: Yea, Jen Hiebner: Yea, Jeb Mierau: Yea, Tyler Newton: Yea,
Tammy Ott: Yea

Board President

Board Secretary

NEW BOARD REPORT

| <u>Check #</u> | <u>Vendor Name</u> | <u>Vendor Description</u> | <u>Amount</u> |
|-----------------|---|------------------------------|---------------|
| Checking | 1 | | |
| Checking | 1 | Fund: 01 GENERAL FUND | |
| 32663 | A-MAY-ZING CONSTRUCTION & PLUMBING SERVICES LLC | | 600.00 |
| 32661 | AED SUPERSTORE | SUPPLIES | 621.00 |
| 32662 | AGTAC SERVICES LLC | JANITORIAL SERVICES | 13,888.00 |
| 32664 | AMAZON CAPITAL SERVICES | SUPPLIES | 811.46 |
| 32665 | BLACK HILLS ENERGY | NATURAL GAS | 5,269.93 |
| 32666 | BURTON ENTERPRISES | TRASH REMOVAL | 220.00 |
| 32667 | CENGAGE LEARNING | SUPPLIES | 489.00 |
| 32668 | CENTRAL VALLEY AG | SERVICES | 6,227.51 |
| 32669 | CHEMSEARCH | SUPPLIES | 188.75 |
| 32709 | CITY OF HENDERSON | WATER/SEWER | 612.99 |
| 32670 | DAS STATE ACCT-CENTRAL FINANCE | STATE REPORTING | 317.87 |
| 32671 | DIETZE MUSIC HOUSE | SUPPLIES | 180.80 |
| 32672 | ELECTRONIC SYSTEMS | SUPPLIES | 420.00 |
| 32673 | ESU 6 | SERVICES | 400.72 |
| 32674 | ESU 9 | SERVICES | 302.90 |
| 32675 | FIBER PLATFORM LLC | SERVICES | 429.58 |
| 32676 | FILLMORE COUNTY HOSPITAL | SERVICES | 6,125.00 |
| 32677 | FIVE STAR TRUCK CENTER | BUS WASH | 31.50 |
| 32678 | GO PHYSICAL THERAPY | SERVICES | 5,387.25 |
| 32679 | GRAINGER | SUPPLIES | 690.48 |
| 32680 | HD SUPPLY | SUPPLIES | 64.94 |
| 32681 | HENDERSON MOTORS | SERVICES | 1,904.46 |
| 32682 | HOMETOWN LEASING | COPY MACHINE LEASE | 681.06 |
| 32683 | INSPIRA FINANCIAL | CAFETERIA 125 PLAN | 150.00 |
| 32684 | J.W. PEPPER & SON | SUPPLIES | 147.49 |
| 32685 | KROEKER GRAIN & LUMBER | SUPPLIES | 869.10 |
| 32686 | MAINSTAY COMMUNICATIONS | TELEPHONE | 746.75 |
| 32687 | MATHESON TRI GAS INC | SUPPLIES | 241.16 |
| 32688 | MCI | TELEPHONE | 176.90 |
| 32689 | MENARDS | SUPPLIES | 770.01 |
| 32690 | NASB | REGISTRATION | 4,426.00 |
| 32691 | NEBRASKA PIANO TUNING | | 300.00 |
| 32692 | PAPER TIGER SHREDDING | SERVICES | 70.00 |
| 32711 | PERENNIAL PUBLIC POWER DISTRICT | ELECTRICITY | 6,025.74 |
| 32694 | PRESTIGE GROUP INC | | 3,650.00 |
| 32695 | QUILL | SUPPLIES | 554.43 |
| 32696 | RASMUSSEN MECHANICAL SERVICES | LABOR | 1,771.67 |
| 32697 | RETIREMENT PLAN CONSULTANTS | | 500.00 |
| 32698 | S & Y INVESTMENTS | | 960.00 |
| 32699 | SERVICE PRESS | SERVICES | 934.25 |
| 32700 | STEINGARD, LAURA | | 300.00 |
| 32701 | TIME MANAGEMENT SYSTEMS | SERVICES | 127.72 |
| 32702 | TRI COUNTY AUTO | SERVICES | 774.79 |
| 32703 | U.S. BANK | SUPPLIES | 305.98 |
| 2137 | UNITED STATES POSTAL SERVICE | NEWSLETTER | 225.19 |

NEW BOARD REPORT

| <u>Check #</u> | <u>Vendor Name</u> | <u>Vendor Description</u> | <u>Amount</u> |
|----------------|------------------------|---------------------------|---------------|
| 32704 | VERIZON WIRELESS | TELEPHONE | 195.99 |
| 32705 | VOSS LIGHTING | SUPPLIES | 1,083.00 |
| 32712 | WATSON, PAUL | SERVICES | 405.07 |
| 32706 | WINN HEAVY DUTY REPAIR | | 947.18 |
| 32707 | YORK ACE HARDWARE | SUPPLIES | 219.62 |

Fund Total: 72,743.24

Checking Account Total: 72,743.24

Checking 2

| <u>Checking</u> | <u>2</u> | <u>Fund: 02</u> | <u>DEPRECIATION RESERVE FUND</u> | |
|-----------------|-------------------------------|-----------------|----------------------------------|----------|
| 1171 | CHAMPION TEAMWEAR | | | 4,807.26 |
| 1170 | HARCO ATHLETIC RECONDITIONING | | HELMET RECONDITIONING | 5,104.00 |

Fund Total: 9,911.26

Checking Account Total: 9,911.26

Checking 6

| <u>Checking</u> | <u>6</u> | <u>Fund: 06</u> | <u>SCHOOL LUNCH/MILK FUND</u> | |
|-----------------|--------------------------|-----------------|-------------------------------|----------|
| 4383 | HENDERSON MEAT PROCESSOR | | SUPPLIES | 1,306.20 |
| 4384 | HILAND DAIRY | | SUPPLIES | 1,194.22 |
| 4385 | SYSCO | | SYSCO | 6,615.44 |
| 4386 | US FOODS | | SUPPLIES | 2,588.60 |

Fund Total: 11,704.46

Checking Account Total: 11,704.46

Checking 8

| <u>Checking</u> | <u>8</u> | <u>Fund: 08</u> | <u>SPECIAL BUILDING FUND</u> | |
|-----------------|----------------------------------|-----------------|------------------------------|------------|
| 1175 | CLARK & ENERSEN | | SERVICES | 145,450.00 |
| 1176 | SORINEX EXERCISE EQUIPMENT, INC. | | | 977.16 |

Fund Total: 146,427.16

Checking Account Total: 146,427.16

FUND BALANCE REPORT

as of JANUARY 31, 2026

| | | | | | |
|-----------------|----------------------------------|-------------------|------------|------------|----------------|
| Fund: 01 | GENERAL FUND | Beginning Balance | Debits | Credits | Ending Balance |
| | | 1,690,327.14 | 593,776.33 | 793,632.51 | 1,890,183.32 |
| Fund: 02 | DEPRECIATION RESERVE FUND | Beginning Balance | Debits | Credits | Ending Balance |
| | | 1,133,164.35 | 13,742.66 | 0.00 | 1,119,421.69 |
| Fund: 03 | UNEMPLOYMENT FUND | Beginning Balance | Debits | Credits | Ending Balance |
| | | 3,160.86 | 0.00 | 0.00 | 3,160.86 |
| Fund: 06 | SCHOOL LUNCH/MILK FUND | Beginning Balance | Debits | Credits | Ending Balance |
| | | 76,979.40 | 23,005.38 | 20,979.01 | 74,953.03 |
| Fund: 07 | BOND FUND | Beginning Balance | Debits | Credits | Ending Balance |
| | | 104,141.45 | 0.00 | 134,566.36 | 238,707.81 |
| Fund: 08 | SPECIAL BUILDING FUND | Beginning Balance | Debits | Credits | Ending Balance |
| | | 2,820,710.80 | 80,743.01 | 3,569.25 | 2,743,537.04 |

Activity Fund Balance Report - Summary - Exclude Encumbrances

09/2025 - 02/2026

Regular; Beginning Month 09/2025; Processing Month 02/2026; Accounts to Include Accounts with Activity; Fund Number 05

Fund: 05 ACTIVITIES FUND

| <u>Chart of Account Number</u> | <u>Chart of Account Description</u> | <u>Beginning Balance</u> | <u>Expenses</u> | <u>Revenues</u> | <u>Balance Change</u> | <u>Balance</u> |
|--------------------------------|-------------------------------------|--------------------------|-----------------|-----------------|-----------------------|----------------|
| 05 704 0101 | Football | (800.00) | 2,745.00 | 3,841.00 | 0.00 | 296.00 |
| 05 704 0102 | Volleyball | 0.00 | 4,957.00 | 2,129.12 | 0.00 | (2,827.88) |
| 05 704 0103 | Boys Basketball | 0.00 | 2,582.80 | 4,532.25 | 0.00 | 1,949.45 |
| 05 704 0104 | Girls Basketball | 0.00 | 2,193.50 | 793.10 | 0.00 | (1,400.40) |
| 05 704 0105 | Track | 0.00 | 2,090.00 | 0.00 | 0.00 | (2,090.00) |
| 05 704 0107 | General Athletics | (153.00) | 5,172.47 | 0.00 | (31.54) | (5,357.01) |
| 05 704 0110 | Jh Football | 0.00 | 241.25 | 37.32 | 0.00 | (203.93) |
| 05 704 0111 | Jh Volleyball | 0.00 | 1,985.00 | (390.00) | 0.00 | (2,375.00) |
| 05 704 0112 | Jh Boys Basketball | 0.00 | 1,000.00 | 1,067.65 | 0.00 | 67.65 |
| 05 704 0113 | Jh Girls Basketball | 0.00 | 0.00 | (325.00) | 0.00 | (325.00) |
| 05 704 0114 | Jh Track | 394.22 | 0.00 | 0.00 | 0.00 | 394.22 |
| 05 704 0116 | Season Pass | 2,130.00 | 0.00 | 460.00 | 0.00 | 2,590.00 |
| 05 704 0117 | Girls Golf | (90.00) | 2,236.50 | 480.00 | 0.00 | (1,846.50) |
| 05 704 0118 | Boys Golf | 0.00 | 126.97 | 1,733.35 | 0.00 | 1,606.38 |
| 05 704 0129 | Coach - Fb | 209.37 | 60.00 | 0.00 | 0.00 | 149.37 |
| 05 704 0130 | Coach - Vb | 94.87 | 0.00 | 0.00 | 0.00 | 94.87 |
| 05 704 0131 | Coach - Girls Bb | 4,511.88 | 566.40 | 0.00 | 0.00 | 3,945.48 |
| 05 704 0132 | Coach - Boys Bb | 996.08 | 0.00 | 0.00 | 0.00 | 996.08 |
| 05 704 0133 | Coach - Jh Bb | 555.00 | 806.76 | 0.00 | 0.00 | (251.76) |
| 05 704 0135 | Coach - Girls Golf | 456.91 | 0.00 | 0.00 | 0.00 | 456.91 |
| 05 704 0136 | Coach - Boys Golf | 981.36 | 0.00 | 0.00 | 0.00 | 981.36 |
| 05 704 0137 | Coach - Track | 1,349.16 | 0.00 | 0.00 | 0.00 | 1,349.16 |
| 05 704 0138 | Coach - Jh Vb | 867.26 | 143.34 | 0.00 | 0.00 | 723.92 |
| 05 704 0200 | Band Uniforms | 262.11 | 0.00 | 0.00 | 0.00 | 262.11 |
| 05 704 0201 | Band | 1,748.28 | 345.00 | 353.75 | 0.00 | 1,757.03 |
| 05 704 0202 | Chorus | 2,119.64 | 0.00 | 0.00 | 0.00 | 2,119.64 |
| 05 704 0203 | Marching Shoes | (747.96) | 0.00 | 0.00 | 0.00 | (747.96) |
| 05 704 0204 | Vocal Clinic | 2,438.47 | 1,700.65 | 1,440.00 | 0.00 | 2,177.82 |
| 05 704 0207 | District Music | 4,287.09 | 0.00 | 0.00 | 0.00 | 4,287.09 |
| 05 704 0301 | Art | 2,617.83 | 326.46 | 0.00 | 0.00 | 2,291.37 |
| 05 704 0304 | All School Play | 6,162.23 | 643.63 | 0.00 | 0.00 | 5,518.60 |
| 05 704 0305 | One Act | 0.00 | 1,938.19 | 537.25 | (160.00) | (1,560.94) |
| 05 704 0403 | Fbla | (2,024.30) | 1,352.90 | 2,721.01 | (180.19) | (836.38) |
| 05 704 0404 | Ind Tech/ag Projects | 94.71 | 311.99 | 537.00 | (224.86) | 94.86 |
| 05 704 0405 | Ffa | 555.31 | 8,678.73 | 16,772.61 | (6,776.60) | 1,872.59 |
| 05 704 0407 | Science Club | 1,229.12 | 0.00 | 0.00 | 0.00 | 1,229.12 |

Activity Fund Balance Report - Summary - Exclude Encumbrances

09/2025 - 02/2026

Regular; Beginning Month 09/2025; Processing Month 02/2026; Accounts to Include Accounts with Activity; Fund Number 05

Fund: 05 ACTIVITIES FUND

| <u>Chart of Account Number</u> | <u>Chart of Account Description</u> | <u>Beginning Balance</u> | <u>Expenses</u> | <u>Revenues</u> | <u>Balance Change</u> | <u>Balance</u> |
|--------------------------------|-------------------------------------|--------------------------|-----------------|-----------------|-----------------------|----------------|
| 05 704 0408 | Biology/english Trip | 367.20 | 0.00 | 0.00 | 0.00 | 367.20 |
| 05 704 0409 | Quiz Bowl/math Club | 98.39 | 480.00 | 0.00 | (200.00) | (581.61) |
| 05 704 0410 | Coach - Jh Robotics | 983.23 | 0.00 | 0.00 | 0.00 | 983.23 |
| 05 704 0411 | Coach - Hs Robotics | 702.15 | 0.00 | 0.00 | 0.00 | 702.15 |
| 05 704 0450 | Jh Robotics | 1,957.59 | 1,599.80 | 1,599.80 | 0.00 | 1,957.59 |
| 05 704 0451 | Hs Robotics | 0.00 | 129.43 | 0.00 | 0.00 | (129.43) |
| 05 704 0503 | Class Of 2023 | 40.53 | 0.00 | 0.00 | 0.00 | 40.53 |
| 05 704 0506 | Class Of 2026 | 1,397.09 | 1,498.50 | 687.95 | 0.00 | 586.54 |
| 05 704 0507 | Class Of 2027 | 4,764.86 | 0.00 | 1,994.63 | 0.00 | 6,759.49 |
| 05 704 0508 | Class Of 2028 | 7,372.11 | 0.00 | 0.00 | 0.00 | 7,372.11 |
| 05 704 0509 | Class Of 2029 | 0.00 | 0.00 | 356.37 | 164.75 | 521.12 |
| 05 704 0601 | National Honor Society | 175.09 | 1,350.11 | 2,422.00 | 0.00 | 1,246.98 |
| 05 704 0701 | Hcs Customs | 732.79 | 4,342.97 | 4,492.72 | (468.61) | 413.93 |
| 05 704 0709 | Yearbook | 1,748.42 | 4,586.57 | 4,983.00 | 0.00 | 2,144.85 |
| 05 704 0801 | Student Council | 0.00 | 590.10 | 778.32 | (102.89) | 85.33 |
| 05 704 0802 | Concessions | 8,131.82 | 26,030.07 | 21,832.66 | 0.00 | 3,934.41 |
| 05 704 0804 | Interest On Act Acct | 478.06 | 0.00 | 0.00 | 0.00 | 478.06 |
| 05 704 0806 | Elem Student Council | 2,975.18 | 0.00 | 399.20 | 0.00 | 3,374.38 |
| 05 704 0913 | Revolving - Secondary | (224.58) | 0.00 | 0.00 | 0.00 | (224.58) |
| 05 704 0914 | Revolving - Elementary | 2,726.06 | 0.00 | 0.00 | 0.00 | 2,726.06 |
| 05 704 0915 | Student Supplies | 851.50 | 0.00 | (161.92) | 0.00 | 689.58 |
| 05 704 0918 | John Baylor Test Prep | 2,200.00 | 0.00 | 0.00 | 0.00 | 2,200.00 |
| 05 704 0924 | Ott Scholarship | 27,096.21 | 1,000.00 | 0.00 | 0.00 | 26,096.21 |
| 05 704 0936 | Field Trip Grant | 4,273.89 | 0.00 | 0.00 | 0.00 | 4,273.89 |
| 05 704 0937 | Circle Of Friends Autism Grant | 828.84 | 0.00 | 0.00 | 0.00 | 828.84 |
| 05 704 0938 | If Kids Could Cure Grant | 6,518.63 | 0.00 | 0.00 | 0.00 | 6,518.63 |
| 05 704 0939 | Girls On The Run | 584.58 | 0.00 | 0.00 | 0.00 | 584.58 |
| 05 704 0941 | Early Intervention | 121.64 | 0.00 | 0.00 | 0.00 | 121.64 |
| 05 704 0950 | Computer Deposits | 26,559.65 | 99.96 | 89.00 | 0.00 | 26,548.69 |
| 05 704 0951 | Staff Lounge Account | 118.17 | 0.00 | 0.00 | 0.00 | 118.17 |
| 05 704 0952 | Eha Elevate Program | 2,419.06 | 2,280.55 | 3,000.00 | (252.79) | 2,885.72 |
| 05 704 0953 | Stuhr | 141,291.38 | 0.00 | 934.16 | 0.00 | 142,225.54 |
| Fund Total: 05 | | 277,535.18 | 86,192.60 | 80,128.30 | (8,232.73) | 263,238.15 |

| Function Part 3 | Revised Budget | Activity During Month | Activity to Date | Balance at EOM | % of Budget | |
|-----------------|---------------------------------------|-----------------------|------------------|----------------|--------------|--------|
| 9 | | | | | | |
| | | | | | | |
| 01 | | | | | | |
| | | | | | | |
| 1100 | REGULAR INSTRUCTION | 3,070,107.00 | 4,255.89 | 1,203,498.01 | 1,866,608.99 | 39.27 |
| 1200 | SPED - SA | 1,079,000.00 | 380.33 | 302,391.29 | 776,608.71 | 28.03 |
| 1290 | 1290 | 68,112.00 | 0.00 | 26,816.53 | 41,295.47 | 39.74 |
| 1300 | SUMMER SCHOOL | 3,526.00 | 0.00 | 0.00 | 3,526.00 | 0.00 |
| 2110 | ATTENDANCE & SOCIAL WORK SVCS | 0.00 | 0.00 | 1,900.00 | (1,900.00) | 0.00 |
| 2120 | GUIDANCE SERVICES | 110,258.00 | 0.00 | 40,205.87 | 70,052.13 | 36.51 |
| 2130 | HEALTH SERVICES - GEN ED | 11,351.00 | 621.00 | 2,649.80 | 8,701.20 | 41.11 |
| 2140 | PSYCHOLOGICAL SVCS - GEN ED | 190,000.00 | 6,125.00 | 57,702.89 | 132,297.11 | 30.37 |
| 2150 | SPEECH PATH & AUDIOLOGY SVCS - GEN ED | 124,848.00 | 767.25 | 58,624.14 | 66,223.86 | 46.96 |
| 2160 | OCCUPATIONAL THERAPY SVCS - GEN ED | 73,000.00 | 3,733.10 | 23,850.81 | 49,149.19 | 32.67 |
| 2170 | PHYSICAL THERAPY SVCS - GEN ED | 40,000.00 | 886.90 | 8,129.20 | 31,870.80 | 20.32 |
| 2180 | VISION SERVICES - GEN ED | 11,060.00 | 302.90 | 1,682.76 | 9,377.24 | 15.21 |
| 2210 | 2210 | 32,957.00 | 80.00 | 1,473.86 | 31,483.14 | 5.32 |
| 2220 | LIBRARY/MEDIA SERVICES | 192,987.00 | 0.00 | 73,057.62 | 119,929.38 | 37.96 |
| 2230 | INSTRUCTION-RELATED TECHNOLOGY | 39,567.00 | 0.00 | 23,160.35 | 16,406.65 | 58.53 |
| 2240 | ACADEMIC STUDENT ASSESSMENT | 26,450.00 | 0.00 | 2,527.80 | 23,922.20 | 9.56 |
| 2310 | BOARD OF EDUCATION | 77,000.00 | 4,473.77 | 18,778.47 | 58,221.53 | 26.91 |
| 2320 | EXECUTIVE ADMINISTRATION | 410,333.00 | 0.00 | 166,167.02 | 244,165.98 | 40.50 |
| 2330 | DISTRICT LEGAL SERVICES | 15,000.00 | 0.00 | 880.50 | 14,119.50 | 5.87 |
| 2410 | OFFICE OF THE PRINCIPAL | 434,757.00 | 0.00 | 172,919.05 | 261,837.95 | 39.77 |
| 2490 | SCHOOL ADMINISTRATION - OTHER | 36,009.00 | 0.00 | 7,890.22 | 28,118.78 | 21.91 |
| 2510 | FISCAL SERVICES | 39,200.00 | 777.72 | 31,858.15 | 7,341.85 | 81.27 |
| 2560 | PUBLIC INFORMATION SERVICES | 118,200.00 | 2,455.47 | 23,382.53 | 94,817.47 | 19.78 |
| 2580 | ADMINISTRATIVE TECHNOLOGY SERVICES | 64,631.00 | 320.72 | 22,154.94 | 42,476.06 | 34.28 |
| 2610 | OPERATION OF BUILDINGS | 906,538.00 | 33,525.57 | 431,504.01 | 475,033.99 | 47.60 |
| 2620 | MAINTENANCE OF BUILDINGS | 0.00 | 420.00 | 759.26 | (759.26) | 0.00 |
| 2710 | VEHICLE OPERATION & PURCH - GEN ED | 408,594.00 | 6,725.06 | 114,157.60 | 294,436.40 | 27.94 |
| 2730 | VEHICLE SERVICING & MAINT - GEN ED | 86,000.00 | 6,892.56 | 29,411.33 | 56,588.67 | 34.20 |
| 3300 | COMMUNITY SERVICES OPERATIONS | 20,723.00 | 0.00 | 0.00 | 20,723.00 | 0.00 |
| 3530 | 3530 | 8,000.00 | 0.00 | 10,285.06 | (2,285.06) | 128.56 |
| 6200 | TITLE IA | 79,726.00 | 0.00 | 29,368.82 | 50,357.18 | 36.84 |
| 6400 | 6400 | 125,020.00 | 0.00 | 47,105.24 | 77,914.76 | 37.68 |
| 6990 | OTHER FEDERAL PROGRAMS | 32,000.00 | 0.00 | 0.00 | 32,000.00 | 0.00 |
| 01 | GENERAL FUND | 7,934,954.00 | 72,743.24 | 2,934,293.13 | 5,000,660.87 | 37.07 |
| 9 | Expenditure | 7,934,954.00 | 72,743.24 | 2,934,293.13 | 5,000,660.87 | 37.07 |