



**Chase County Schools creates exceptional opportunities, fosters strong relationships, and empowers students to succeed.**

Board of Education Regular Meeting  
Monday, April 11, 2022 6:00 PM  
Conference Room, 520 E 9th Street, Imperial, NE 69033  
Posted Locations:

Imperial Republican

Posted Date: **4/07/2022**

- I. CALL MEETING TO ORDER
- II. APPROVAL OF AGENDA AND CHANGES TO AGENDA
- III. APPROVAL OF MINUTES
- IV. APPROVAL OF FINANCIAL REPORT
- V. PUBLIC COMMENT
- VI. INFORMATION AND PROPOSALS
  - VI.1. ACTIVITY DIRECTOR'S REPORT
  - VI.2. PRINCIPALS' REPORT
  - VI.3. SUPERINTENDENT'S REPORT
  - VI.4. BOARD COMMITTEE REPORT
- VII. ACTION ITEMS
  - VII.1. Discuss, consider, and take necessary action in regard to Haley Hixson's resignation as elementary teacher at the end of the '21-'22 school year.
  - VII.2. Discuss, consider, and take necessary action in the hiring of Brandi Dannatt as an elementary teacher for the '22-'23 school year.
  - VII.3. Discuss, consider and take necessary action in regard to updating the high school Science curriculum for the '22-'23 school year.
  - VII.4. Discuss, consider, and take necessary action for the purchase of new 7th-12th grade teacher computers for the '22-'23 school year.
  - VII.5. Discuss, consider, and take necessary action in regard to the updating of the hallway carpets.
  - VII.6. Discuss, consider, and take necessary action in regard to a Gallup survey.
  - VII.7. Discuss, consider, and take necessary action in regard to the purchase of an Edwards 55 Ton Ironworker for the Ag shop.

VII.8. Discuss, consider, and take necessary action in regard to the foundation work for the woods department project for the '22-'23 school year.

VIII. DISCUSSION ITEMS

IX. EXECUTIVE SESSION

IX.1. Move into executive session to discuss personnel.

IX.2. Move into executive session to discuss strategy, receive legal advice, and take necessary action related to pending, imminent or threatened litigation.

X. ADJOURN

---

Board President

---

Board Secretary



**Meeting the challenge, exceeding expectations and Continuing our legacy of excellence**

**Board of Education Regular Meeting**

Tuesday, March 8, 2022 6:00 PM

Conference Room

520 East 9th Street

Imperial, NE 69033

Meeting Posted: March 3rd, 2022 Imperial Republican

Attendance Taken at 6:01 PM.

Cindy Arterburn: Present

Linsey Foote: Present

Josh Fries: Present

Karl Meeske: Present

Jeff Olsen: Absent

Willy O'Neil: Absent

Dan Reeves: Present

Carrie Terryberry: Absent

Steve Wallin: Present

Attendance Update Taken at 6:03 PM.

Jeff Olsen: Present

**I. CALL MEETING TO ORDER**

President Meeske called meeting to order at 6:01 PM.

**II. APPROVAL OF AGENDA AND CHANGES TO AGENDA**

Motion to approve the agenda with change of moving discussion items to beginning of meeting.

Passed with a motion by Cindy Arterburn and a second by Josh Fries. Cindy Arterburn: Yea,

Linsey Foote: Yea, Josh Fries: Yea, Karl Meeske: Yea, Dan Reeves: Yea, Steve Wallin: Yea

**III. APPROVAL OF MINUTES**

Motion to approve the minutes as presented Passed with a motion by Jeff Olsen and a second by

Cindy Arterburn. Cindy Arterburn: Yea, Linsey Foote: Yea, Josh Fries: Yea, Karl Meeske: Yea,

Jeff Olsen: Yea, Dan Reeves: Yea, Steve Wallin: Yea

**IV. APPROVAL OF FINANCIAL REPORT**

Motion to approve the financial report in the amount of \$694,029.38. Passed with a motion by Josh Fries and a second by Linsey Foote. Cindy Arterburn: Yea, Linsey Foote: Yea, Josh Fries: Yea, Karl Meeske: Yea, Jeff Olsen: Yea, Dan Reeves: Yea, Steve Wallin: Yea

## **V. PUBLIC COMMENT**

## **VI. INFORMATION AND PROPOSALS**

### **VI.1. ACTIVITY DIRECTOR'S REPORT**

AD Hauxwell began his report congratulating Brayan Cazerres for qualifying for State Speech & Jaret Peterson for getting 3<sup>rd</sup> place at State Wrestling. He noted that SPVA Speech will be held here Monday, March 14<sup>th</sup>, at 8:00 AM M.T. He thanked David Rushing, Agnes Strand, Sandy O'Neil and others for helping out. Freedoms Foundation will leave March 9<sup>th</sup> and return the 16<sup>th</sup>. Hauxwell noted upcoming activities and that track practice had started with 51 students participating. He concluded his report mentioning Prom will be Saturday, March 19<sup>th</sup> with Promenade at 5:30 in the Longhorn Gym and the dinner and dance at Broken Arrow Cellar at 7:00 PM.

### **VI.2. PRINCIPALS' REPORT**

Principal Odens reported the K-4 staff and students celebrated Dr. Seuss last week with the first graders leading the celebration by having different themes for each day. The 5<sup>th</sup> and 6<sup>th</sup> grade teachers have started an incentive program to help with the amount of missing assignments. She noted Mr. Lambert, the SPED teachers and herself have been interviewing possible MS SPED teachers hoping to fill that position as well as the HS ELL position. She ended her report stating Mr. Sorensen and herself will attend the Region V Principal's Meeting in Sidney on Wednesday, March 23<sup>rd</sup>.

Principal Sorensen thanked Mr. Speck, officers and FFA chapter for a great week in celebrating National FFA Week. He also congratulated Jaret Peterson and Brayan Cazaes for their accomplishments. He noted state testing for Junior, Sophomores & grades 3-8 that will be upcoming. Sorensen mentioned that on March 23<sup>rd</sup>, the Career/College Fair for grades 10-12 will be in the Auxillary Gym from 8:00 AM to 11:00 AM and there will be a senior seminar at 1:00 PM focusing on financial advice from local bankers and business people. On Monday, April 4<sup>th</sup> National Honor Society inductions will take place at 6:30 PM in the auditorium. The Attendance Diversion after school program is off and running, students spent the full two hours getting work made up. There is a total of 17 students in the program, who will be in the program for 1 calendar year if they abide by the rules set by the county attorney's office. He concluded his report thanking staff for covering classes this past month.

### **VI.3. SUPERINTENDENT'S REPORT**

Mr. Lambert began his report summarizing what the principals stated in their reports. He mentioned that they RFP process for the lunchroom services was completed, the next step would be to have interested companies come out and tour the school, then pick what company we want to serve our school district's school lunch program. He also noted that Chase County students received rewards at the state capitol for their work in 4-H. He informed the board he met with the curriculum committee to go over the updated social studies and science curriculum and met with

the Americanism committee looking through the proposed social studies curriculum. Principal interviews have been conducted and discussion of potential candidates will take place this evening. Lambert noted that discussions with Dallas have started on all the projects in the school that need addressed over the summer. New playground equipment & maintenance truck was ordered. Also met with Samway to go over potential carpet projects within the building. Lambert concluded his report stating that work on the Perkins Grant was held with participating schools to fill out the necessary paperwork. Renewed our DUNS number in preparation for the new UEI number, applied for the REAP grant for next year and mentioned we currently have 12% savings after 7 months of bills and payroll. He ended stating the account balances as of 3/10/2022.

#### **VI.4. BOARD COMMITTEE REPORT**

#### **VII. ACTION ITEMS**

##### **VII.1. Discuss, consider, and take necessary action in regard to Michael Sorensen's resignation as 7-12 principal at the end of the '21-'22 school year.**

Move to accept Michael Sorensen's resignation as 7-12 principal at the end of the '21-'22 school year. Passed with a motion by Jeff Olsen and a second by Josh Fries. Cindy Arterburn: Yea, Linsey Foote: Yea, Josh Fries: Yea, Karl Meeske: Yea, Jeff Olsen: Yea, Dan Reeves: Yea, Steve Wallin: Yea

##### **VII.2. Discuss, consider, and take necessary action in approving Becky Odens' K-6 principals contract for the '22-'23 school year.**

Move to approve Becky Odens' K-6 principals' contract for the '22-'23 school year. Passed with a motion by Steve Wallin and a second by Linsey Foote. Cindy Arterburn: Yea, Linsey Foote: Yea, Josh Fries: Yea, Karl Meeske: Yea, Jeff Olsen: Yea, Dan Reeves: Yea, Steve Wallin: Yea

##### **VII.3. Discuss, consider and take necessary action in regard to the '22-'23 district calendar.**

Move to approve the '22-'23 district calendar as presented. Passed with a motion by Dan Reeves and a second by Cindy Arterburn. Cindy Arterburn: Yea, Linsey Foote: Yea, Josh Fries: Yea, Karl Meeske: Yea, Jeff Olsen: Yea, Dan Reeves: Yea, Steve Wallin: Yea

##### **VII.4. Discuss, consider and take necessary action in the hiring of Emma McConnell as the middle school art teacher for the '22-'23 school year.**

Move to accept hiring of Emma McConnell as the middle school art teacher for the '22-'23 school year. Passed with a motion by Dan Reeves and a second by Josh Fries. Cindy Arterburn: Yea, Linsey Foote: Yea, Josh Fries: Yea, Karl Meeske: Yea, Jeff Olsen: Yea, Dan Reeves: Yea, Steve Wallin: Yea

##### **VII.5. Discuss, consider, and take necessary action in the hiring of Beau McConnell as the 7th and 8th grade social studies teacher for the '22-'23 school year.**

Motion to accept the hiring of Beau McConnell as the 7th and 8th grade social studies teacher for the '22-'23 school year. Passed with a motion by Cindy Arterburn and a second by Linsey Foote. Cindy Arterburn: Yea, Linsey Foote: Yea, Josh Fries: Yea, Karl Meeske: Yea, Jeff Olsen: Yea, Dan Reeves: Yea, Steve Wallin: Yea

**VII.6. Discuss, consider, and take necessary action in the hiring of Misty Jaeger as the FCS teacher for the '22-'23 school year.**

Move to accept the hiring of Misty Jaeger as the FCS teacher for the '22-'23 school year. Passed with a motion by Linsey Foote and a second by Josh Fries. Cindy Arterburn: Yea, Linsey Foote: Yea, Josh Fries: Yea, Karl Meeske: Yea, Jeff Olsen: Yea, Dan Reeves: Yea, Steve Wallin: Yea

**VII.7. Discuss, consider, and take necessary action in the hiring of Jacci Paisley as the 7-12 guidance counselor for the '22-'23 school year.**

Move to accept the hiring of Jacci Paisley as the 7-12 guidance counselor for the '22-'23 school year. Passed with a motion by Dan Reeves and a second by Linsey Foote. Cindy Arterburn: Yea, Linsey Foote: Yea, Josh Fries: Yea, Karl Meeske: Yea, Jeff Olsen: Yea, Dan Reeves: Yea, Steve Wallin: Yea

**VII.8. Discuss, consider and take necessary action in regard to the curriculum cycle updates to policy 6121.**

Move to approve the curriculum cycle updates to policy 6121. Passed with a motion by Jeff Olsen and a second by Josh Fries. Cindy Arterburn: Yea, Linsey Foote: Yea, Josh Fries: Yea, Karl Meeske: Yea, Jeff Olsen: Yea, Dan Reeves: Yea, Steve Wallin: Yea

**VII.9. Discuss, consider, and take necessary action to the adoption of the new social studies curriculum as presented for the '22-'23 school year.**

Move to approve the adoption of the new social studies curriculum as presented for the '22-'23 school year. Passed with a motion by Jeff Olsen and a second by Steve Wallin. Cindy Arterburn: Yea, Linsey Foote: Yea, Josh Fries: Yea, Karl Meeske: Yea, Jeff Olsen: Yea, Dan Reeves: Yea, Steve Wallin: Yea

**VII.10. Discuss, consider, and take necessary action to the adoption of the new science curriculum as presented for the '22-'23 school year.**

Move to approve the adoption of the new science curriculum as presented for the '22-'23 school year. Passed with a motion by Jeff Olsen and a second by Josh Fries. Cindy Arterburn: Yea, Linsey Foote: Yea, Josh Fries: Yea, Karl Meeske: Yea, Jeff Olsen: Yea, Dan Reeves: Yea, Steve Wallin: Yea

**VII.11. Discuss, consider, and take necessary action on McConnell Psychological Solution's Special Education and Training Service contract for the '22-'23 school year.**

Move to approve the McConnell Psychological Solution's Special Education and Training Service contract for the '22-'23 school year. Passed with a motion by Dan Reeves and a second by Josh Fries. Cindy Arterburn: Yea, Linsey Foote: Yea, Josh Fries: Yea, Karl Meeske: Yea, Jeff Olsen: Yea, Dan Reeves: Yea, Steve Wallin: Yea

**VIII. DISCUSSION ITEMS**

**VIII.1. Lunchtime Solutions presentation.**

**VIII.2. PBiS presentation by Mrs. Odens.**

**VIII.3. Presentation from Gallup concerning a district wide climate survey, developing board goals and a mission statement.**

**IX. EXECUTIVE SESSION**

**IX.1. Move into executive session to evaluate principal candidates and discuss the 7-12 principal contract.** Motion to move into executive session at 7:41 PM to evaluate principal candidates and discuss the 7-12 principal contract. Passed with a motion by Cindy Arterburn and a second by Dan Reeves. Yea, Josh Fries, Yea, Linsey Foote, Yea Karl Meeske, Yea, Steve Wallin, yea, Jeff Olsen, Yea, Cindy Arterburn, Yea, Dan Reeves,

**X. ADJOURN**

President Meeske adjourned the meeting at 8:25 PM

---

Board President

---

Board Secretary



Meeting the challenge, exceeding expectations and Continuing our legacy of excellence

Board of Education Special Meeting  
Monday, March 14, 2022 4:30 PM  
Conference Room  
520 East 9th Street  
Imperial, NE 69033

Posted 3/09/2022 in the Imperial Republican and the McCook Gazette on 3/11/2022

Attendance Taken at 4:30 PM.

Cindy Arterburn: Present  
Linsey Foote: Absent  
Josh Fries: Present  
Karl Meeske: Present  
Jeff Olsen: Present  
Willy O'Neil: Present  
Dan Reeves: Absent  
Carrie Terryberry: Absent  
Steve Wallin: Absent

Attendance Update Taken at 4:32 PM.

Steve Wallin: Present

### **I. CALL MEETING TO ORDER**

President Meeske called the meeting to order at 4:30 PM

### **II. APPROVAL OF AGENDA AND CHANGES TO AGENDA**

Motion to approve agenda and changes to agenda Passed with a motion by Cindy Arterburn and a second by Josh Fries. Cindy Arterburn: Yea, Josh Fries: Yea, Karl Meeske: Yea, Jeff Olsen: Yea, Willy O'Neil: Yea

### **III. PUBLIC COMMENT**

### **IV. ACTION ITEMS**

**IV.1. Discuss, consider, and take necessary action in regard to the hiring of Christopher Barr as the 7-12 principal for the '22-'23 school year.** Move to approve the hiring of Christopher Barr as the 7-12 principal for the '22-'23 school year Passed with a motion by Josh Fries and a second by Cindy Arterburn. Cindy Arterburn: Yea, Josh Fries: Yea, Karl Meeske: Yea, Jeff Olsen: Yea, Willy O'Neil: Yea, Steve Wallin: Yea

**V. ADJOURN**

President Meeske adjourned meeting at 4:34 PM

---

Board President

---

Board Secretary

# CCS Activity Report- For the Year

Printed: 04/07/2022 10:48:13AM

Chase County Schools - Activity Accounting

Activities 1							
Group	0	Activity Groups					
Account Number	Description		Balance Forward	Cash In (Receipts)	Cash Out (Payments)	Adjustments	Balance
<b>Activity Groups</b>							
218		PBIS	3,311.00	740.00	(56.22)	0.00	3,994.78
	<b>0 Activity Groups</b>		<b>3,311.00</b>	<b>740.00</b>	<b>(56.22)</b>	<b>0.00</b>	<b>3,994.78</b>
							* Group
<b>Academic Clubs</b>							
300		Show Choir	(1,487.10)	0.00	(175.00)	1,487.10	(175.00)
302		Musical	1,174.62	3,616.00	(132.63)	0.00	4,657.99
303		CCES Music Resale	419.00	0.00	0.00	0.00	419.00
304		Band Instrument Rental	1,120.00	700.00	(1,897.28)	0.00	(77.28)
305		Band Resale	2,821.73	0.00	(1,498.95)	0.00	1,322.78
308		Drama	(488.10)	519.18	(124.46)	61.85	(31.53)
309		Fine Arts	5,190.60	1,160.00	(2,647.38)	0.00	3,703.22
310		Young Americans	270.00	0.00	0.00	0.00	270.00
311		Tri-M	1,116.00	0.00	0.00	0.00	1,116.00
400		Alumni Clearing	5,369.90	0.00	0.00	0.00	5,369.90
402		CCES Activity Fund	474.20	0.00	(603.41)	129.21	0.00
	<b>1 Academic Clubs</b>		<b>15,980.85</b>	<b>5,995.18</b>	<b>(7,079.11)</b>	<b>1,678.16</b>	<b>16,575.08</b>
							* Group
<b>Athletics</b>							
1-2		Youth Volleyball	0.00	0.00	0.00	0.00	0.00
9410		Weight Lifting	890.87	10.00	0.00	0.00	900.87
001		CCHS Athletics	114,204.46	31,100.84	(78,892.42)	(3,824.53)	62,588.35
002		CCHS Softball	0.00	0.00	0.00	0.00	0.00
003		CCHS Football	50.00	0.00	0.00	0.00	50.00
004		CCHS Volleyball	1,271.39	0.00	(119.85)	3,000.00	4,151.54
005		CCHS X-Country	0.00	200.00	0.00	0.00	200.00
006		CCHS Basketball - Girls	468.74	0.00	0.00	0.00	468.74
007		CCHS Basketball - Boys	222.21	0.00	0.00	0.00	222.21
008		CCHS Wrestling	0.00	500.00	0.00	0.00	500.00
009		CCHS Track - Girls	985.49	2,380.00	(2,132.00)	0.00	1,233.49
010		CCHS Track - Boys	1,005.59	2,380.00	0.00	0.00	3,385.59
011		CCHS Golf	0.00	200.00	0.00	0.00	200.00
013		JH Football	0.00	0.00	0.00	0.00	0.00
014		JH Volleyball	0.00	0.00	0.00	0.00	0.00
015		JH Basketball - Girls	0.00	0.00	0.00	0.00	0.00
016		JH Basketball - Boys	0.00	0.00	0.00	0.00	0.00
017		JH Wrestling	0.00	0.00	0.00	0.00	0.00
018		JH Girls Track	0.00	0.00	0.00	0.00	0.00
019		JH Boys Track	29.52	0.00	0.00	0.00	29.52
020		PE Uniform Resale	410.00	240.00	(650.00)	0.00	0.00
021		HS Milner Benefit Fund	250.00	0.00	0.00	0.00	250.00
023		AD Savings	1,805.75	0.00	(988.75)	0.00	817.00

# CCS Activity Report- For the Year

Printed: 04/07/2022 10:48:13AM

Chase County Schools - Activity Accounting

Activities 1								
Group	2	Athletics						
Account Number	Description		Balance Forward	Cash In (Receipts)	Cash Out (Payments)	Adjustments	Balance	
024	Youth Volleyball		3,906.66	15,382.75	(8,838.97)	(3,000.00)	7,450.44	
100	Cheerleaders		4,791.70	1,752.03	(5,047.22)	0.00	1,496.51	
<b>2 Athletics</b>			<b>130,292.38</b>	<b>54,145.62</b>	<b>(96,669.21)</b>	<b>(3,824.53)</b>	<b>83,944.26</b>	* Group
<b>Classes</b>								
515	Class of 2025		0.00	9,767.00	(5,703.95)	0.00	4,063.05	
508	Class of 2019		0.00	0.00	0.00	0.00	0.00	
509	Class of 2020		590.33	0.00	0.00	0.00	590.33	
510	Class of 2021		128.30	0.00	0.00	0.00	128.30	
511	Class of 2022		4,147.79	0.00	0.00	0.00	4,147.79	
1-3-513	Class of 2023		1,665.30	10,803.00	(10,230.37)	0.00	2,237.93	
514	Class of 2024		888.50	8,665.20	(2,343.00)	0.00	7,210.70	
<b>3 Classes</b>			<b>7,420.22</b>	<b>29,235.20</b>	<b>(18,277.32)</b>	<b>0.00</b>	<b>18,378.10</b>	* Group
<b>Clubs and Organizations</b>								
203	Art Club		0.00	150.00	0.00	0.00	150.00	
204	Multicultural Club		0.00	279.31	0.00	0.00	279.31	
416	Decals		120.00	0.00	0.00	0.00	120.00	
101	CCHS Annual		38,919.70	8,125.00	(24,858.33)	0.00	22,186.37	
102	CCES Yearbook		11,603.51	120.00	(2,699.61)	0.00	9,023.90	
103	Thespians - Speech		(904.55)	468.00	(1,137.96)	904.55	(669.96)	
104	Student Council		(1.48)	2,463.20	(2,013.22)	0.00	448.50	
106	CCS Flower Fund		245.88	0.00	(97.96)	0.00	147.92	
107	Technology		2,700.00	0.00	0.00	0.00	2,700.00	
108	Electric Car Project		493.76	0.00	0.00	0.00	493.76	
109	Inter Acct		500.00	0.00	0.00	0.00	500.00	
200	FBLA		19,654.22	745.00	(2,654.83)	0.00	17,744.39	
201	FBLA - Sponsor		(10.00)	0.00	(101.00)	40.00	(71.00)	
202	FBLA Bank		13,985.59	0.00	(498.49)	0.00	13,487.10	
205	FCCLA		1,758.22	4,331.00	(3,063.60)	0.00	3,025.62	
206	FCCLA - Sponsor		0.00	0.00	0.00	0.00	0.00	
207	Pro Start		(29.24)	0.00	0.00	29.24	0.00	
210	FFA		43,881.66	54,884.29	(63,360.85)	0.00	35,405.10	
211	FFA - Sponsor		0.00	0.00	0.00	0.00	0.00	
212	FFA-Farm Account		4,941.34	0.00	(4,941.34)	0.00	0.00	
213	FFA-Memorial		9,049.24	500.00	0.00	0.00	9,549.24	
<b>4 Clubs and Organizations</b>			<b>146,907.85</b>	<b>72,065.80</b>	<b>(105,427.19)</b>	<b>973.79</b>	<b>114,520.25</b>	* Group
<b>Miscellaneous</b>								
801	J & J Bernard Scholarship		1,500.00	1,500.00	0.00	0.00	3,000.00	
804	Alta Heir Scholarship		25,992.42	0.00	0.00	0.00	25,992.42	
805	Rod Markee Scholarship		1,000.00	0.00	0.00	0.00	1,000.00	

# CCS Activity Report- For the Year

Printed: 04/07/2022 10:48:13AM

Chase County Schools - Activity Accounting

Activities 1							
Group	9	Miscellaneous					
Account Number	Description		Balance Forward	Cash In (Receipts)	Cash Out (Payments)	Adjustments	Balance
806	Don Maucher Scholarship		0.00	215.00	0.00	0.00	215.00
807	Gary Adler Memorial Scholarship		0.00	5,000.00	0.00	0.00	5,000.00
214	I.A Resale		6,338.16	1,113.00	(7,563.40)	0.00	(112.24)
215	Building Construction		2,153.67	2,000.00	(1,570.94)	0.00	2,582.73
405	Art Resale		3,294.00	0.00	0.00	0.00	3,294.00
408	Library Book Sales		1,127.17	5.00	0.00	0.00	1,132.17
409	Defib Training/Flu Vac Fund		(1,172.58)	210.00	(242.18)	1,172.58	(32.18)
412	Special Projects		0.00	0.00	0.00	0.00	0.00
414	Staff/Student Appreciation		3,877.50	0.00	(142.99)	0.00	3,734.51
415	Monthly Interest		1,171.44	238.12	0.00	0.00	1,409.56
802	Gladys B & Les Smith Scholarship		23,044.16	0.00	0.00	0.00	23,044.16
900	CD		102,464.64	0.00	0.00	0.00	102,464.64
999	Activity Clearing		0.00	2,093.45	(1,993.67)	0.00	99.78
<b>9</b>	<b>Miscellaneous</b>		<b>170,790.58</b>	<b>12,374.57</b>	<b>(11,513.18)</b>	<b>1,172.58</b>	<b>172,824.55</b>
<b>1</b>	<b>Activities</b>		<b>474,702.88</b>	<b>174,556.37</b>	<b>(239,022.23)</b>	<b>0.00</b>	<b>410,237.02</b>
	<b>Report Total:</b>		<b>474,702.88</b>	<b>174,556.37</b>	<b>(239,022.23)</b>	<b>0.00</b>	<b>410,237.02</b>

\* Group  
Location

# Chase Cash Worksheet

Printed: 04/07/2022 12:17:38PM  
Chase County Schools

General 01					
Account Number	Description	Balance Forward	Current Year Activity	Account Balance	
01-901	Cash Account	3,162,768.98	16,978.52	3,179,747.50	
01-904	Payroll Account	6,718.05	24,038.59	30,756.64	
01-907	Clearing Account	17,096.95	3,419.39	20,516.34	
01-916	County Treasurer Balance	0.00	0.00	0.00	
01-905	Sect 125 Account	409.50	0.04	409.54	
01-805	CD-716	63,014.69	31.08	63,045.77	
01-807	CD-784	66,236.75	0.00	66,236.75	
01-824	CD701	15,326.79	7.56	15,334.35	
01-831	CD845	56,812.41	0.00	56,812.41	
	<b>01 General</b>	<u>3,388,384.12</u>	<u>44,475.18</u>	<u>3,432,859.30</u>	Fund
02-901	Cash Account	494,422.25	4.20	494,426.45	
02-814	CD136	13,095.76	0.00	13,095.76	
02-832	CD952	60,467.74	0.00	60,467.74	
	<b>02 Depreciation</b>	<u>567,985.75</u>	<u>4.20</u>	<u>567,989.95</u>	Fund
03-0-110-05	Unemployment Account	21,576.40	0.92	21,577.32	
	<b>03 Employee Benefit Fund</b>	<u>21,576.40</u>	<u>0.92</u>	<u>21,577.32</u>	Fund
05-901	Cash Account	281,502.13	969.87	282,472.00	
05-902	Checking	61,392.84	0.00	61,392.84	
05-806	CD-851	62,310.81	30.73	62,341.54	
05-810	CD383	12,456.95	0.00	12,456.95	
05-826	CD333	5,596.02	2.76	5,598.78	
05-827	CD703	5,625.49	2.77	5,628.26	
05-828	CD195	5,623.25	2.77	5,626.02	
05-829	CD196	10,988.27	5.42	10,993.69	
05-903	FBLA Bank Account	19,312.72	969.87	20,282.59	
	<b>05 Activities</b>	<u>464,808.48</u>	<u>1,984.19</u>	<u>466,792.67</u>	Fund
06-901	Cash Account	192,519.53	10,909.39	203,428.92	
	<b>06 School Nutrition</b>	<u>192,519.53</u>	<u>10,909.39</u>	<u>203,428.92</u>	Fund
07-913	Bond Fund	150,570.02	18.11	150,588.13	
	<b>07 Bond</b>	<u>150,570.02</u>	<u>18.11</u>	<u>150,588.13</u>	Fund
08-909	Building Fund	884,132.87	71,724.14	955,857.01	
08-918	Public Funds	0.00	0.00	0.00	
	<b>08 Special Building</b>	<u>884,132.87</u>	<u>71,724.14</u>	<u>955,857.01</u>	Fund
09-908	QCPUF	134,610.50	16.06	134,626.56	
09-910	Cash at County Treasurer	0.00	0.00	0.00	
	<b>09 Qualified Capital Purpose Undertaking</b>	<u>134,610.50</u>	<u>16.06</u>	<u>134,626.56</u>	Fund

# Chase Cash Worksheet

Printed: 04/07/2022 12:17:38PM  
Chase County Schools

Student Fee 12					
Account Number	Description		Balance Forward	Current Year Activity	Account Balance
12-901	Cash Account		5,001.03	0.21	5,001.24
	12 Student Fee		<u>5,001.03</u>	<u>0.21</u>	<u>5,001.24</u>
					Fund
	<b>Report Total:</b>		<u>5,809,588.70</u>	<u>129,132.40</u>	<u>5,938,721.10</u>

# Chase Revenue and Expenditure Report

Printed: 04/07/2022 12:13:56PM  
Chase County Schools

General 01								
Account Type	I	Revenue						
Source of Revenue/Functi								
Account	Description	M.T.D. Activity	Y.T.D. Activity	Open Encumb.	Current Budget	Budget Balance	% of Budget	State Account Number
<b>Revenue</b>								
01-1-01100-000-000	Taxes Levied/Assessed by the School District	191,356.55	3,460,917.01	0.00	7,375,154.00	3,914,236.99	46.93	01-1-01100-000-000
01-1-01115-000-000	Carline Taxes	0.00	330.05	0.00	1,000.00	669.95	33.01	01-1-01115-000-000
01-1-01125-000-000	Motor Vehicle Taxes	53,802.16	288,705.84	0.00	420,000.00	131,294.16	68.74	01-1-01125-000-000
01-1-01140-000-000	Penalties & Interest	661.27	15,439.75	0.00	0.00	(15,439.75)	0.00	01-1-01140-000-000
01-1-01322-000-000	Tuition from Other Government Sources Within the S	0.00	24,346.00	0.00	10,000.00	(14,346.00)	243.46	01-1-01322-000-000
01-1-01510-000-000	Interest	170.57	964.45	0.00	5,000.00	4,035.55	19.29	01-1-01510-000-000
01-1-01800-000-000	Revenue From Community Services Activities	0.00	0.00	0.00	7,500.00	7,500.00	0.00	01-1-01800-000-000
01-1-01910-000-000	Rentals of School Equipment, Property, and Facilit	0.00	0.00	0.00	5,000.00	5,000.00	0.00	01-1-01910-000-000
01-1-01911-000-000	Local License Fees	0.00	24,278.71	0.00	0.00	(24,278.71)	0.00	01-1-01911-000-000
01-1-01920-000-000	Contributions and Donations From Private Sources	0.00	9,099.48	0.00	0.00	(9,099.48)	0.00	01-1-01920-000-000
01-1-01980-000-000	Refund Of Prior Year's Expenditures	0.00	11,854.96	0.00	0.00	(11,854.96)	0.00	01-1-01980-000-000
01-1-01990-000-000	Miscellaneous Local Revenue	0.00	376.39	0.00	0.00	(376.39)	0.00	01-1-01990-000-000
01-1-02110-000-000	County Fines & License Fees	0.00	2,337.09	0.00	0.00	(2,337.09)	0.00	01-1-02110-000-000
01-1-02210-000-000	ESU Receipts	0.00	0.00	0.00	6,000.00	6,000.00	0.00	01-1-02210-000-000
01-1-03110-000-000	State Aid	23,061.00	161,427.00	0.00	310,475.00	149,048.00	51.99	01-1-03110-000-000
01-1-03120-000-000	SPED (School Age)	30,082.00	117,259.00	0.00	240,000.00	122,741.00	48.86	01-1-03120-000-000
01-1-03125-000-000	SPED Transportation (School Age)ents.	0.00	0.00	0.00	4,000.00	4,000.00	0.00	01-1-03125-000-000
01-1-03130-000-000	Homestead Exemption	8,496.55	8,496.55	0.00	0.00	(8,496.55)	0.00	01-1-03130-000-000
01-1-03131-000-000	Property Tax Credit	364,489.33	392,984.23	0.00	0.00	(392,984.23)	0.00	01-1-03131-000-000
01-1-03180-000-000	Pro-Rate Motor Vehicle	0.00	5,745.59	0.00	15,000.00	9,254.41	38.30	01-1-03180-000-000
01-1-03400-000-000	State Apportionment	0.00	69,945.85	0.00	82,000.00	12,054.15	85.30	01-1-03400-000-000
01-1-03512-000-000	Distance Education Incentive Payments	0.00	844.28	0.00	0.00	(844.28)	0.00	01-1-03512-000-000
01-1-03535-000-000	Payment for High Ability Learners	0.00	3,370.00	0.00	5,000.00	1,630.00	67.40	01-1-03535-000-000
01-1-04305-000-000	Title 8 (Impact Aid)	0.00	0.00	0.00	34,000.00	34,000.00	0.00	01-1-04305-000-000
01-1-04310-000-000	REAP	24,938.00	24,938.00	0.00	0.00	(24,938.00)	0.00	01-1-04310-000-000
01-1-04505-000-000	Title I, Part A ESSA Improving Basic Programs Oper	0.00	0.00	0.00	95,000.00	95,000.00	0.00	01-1-04505-000-000
01-1-04512-000-000	IDEA Part B (611) Base Allocation	0.00	0.00	0.00	144,000.00	144,000.00	0.00	01-1-04512-000-000
01-1-04516-000-000	IDEA Preschool (619) Base/IDEA Enrollment Poverty	0.00	4,490.00	0.00	0.00	(4,490.00)	0.00	01-1-04516-000-000

# Chase Revenue and Expenditure Report

Printed: 04/07/2022 12:13:56PM  
Chase County Schools

General 01								
Account Type	I	Revenue						
Source of Revenue/Functi								
Account	Description	M.T.D. Activity	Y.T.D. Activity	Open Encumb.	Current Budget	Budget Balance	% of Budget	State Account Number
01-1-04518-000-000	IDEA Part B (611) Base & Enrollment Poverty Alloca	0.00	123,678.00	0.00	0.00	(123,678.00)	0.00	01-1-04518-000-000
01-1-04521-000-000	IDEA Part B Proportionate Share	0.00	2,760.00	0.00	0.00	(2,760.00)	0.00	01-1-04521-000-000
01-1-04525-000-000	Federal Vocational & Applied Technology Education	0.00	7,257.00	0.00	0.00	(7,257.00)	0.00	01-1-04525-000-000
01-1-04530-000-000	Other Federal Categorical Receipts	0.00	66,225.60	0.00	15,000.00	(51,225.60)	441.50	01-1-04530-000-000
01-1-04708-000-000	Medicaid in Public Schools	924.82	2,159.94	0.00	5,500.00	3,340.06	39.27	01-1-04708-000-000
01-1-04997-000-000	Elementary & Secondary School Emergency Relief	0.00	246,953.00	0.00	0.00	(246,953.00)	0.00	01-1-04997-000-000
01-1-04998-000-000	Elementary & Secondary School Emergency Relief	26,174.00	124,095.00	0.00	0.00	(124,095.00)	0.00	01-1-04998-000-000
01-1-05300-000-000	Proceeds From the Disposal of Real or Personal Pro	2,425.00	3,271.58	0.00	0.00	(3,271.58)	0.00	01-1-05300-000-000
01-1-05301-000-000	Insurance Adjustments	0.00	25,000.00	0.00	0.00	(25,000.00)	0.00	01-1-05301-000-000
<b>I Revenue</b>		<b>726,581.25</b>	<b>5,229,550.35</b>	<b>0.00</b>	<b>8,779,629.00</b>	<b>3,550,078.65</b>	<b>59.56</b>	<b>* Account Type</b>
<b>Expense</b>								
01-2-01100-000-000	Regular Instruction	0.00	(593.64)	0.00	2,300.00	2,893.64	-25.81	01-2-01100-000-000
01-2-01100-111-001	Regular Instruction-Salaries of Regular Employees	46,557.96	620,533.67	0.00	1,250,000.00	629,466.33	57.20	01-2-01100-111-001
01-2-01100-111-002	Regular Instruction-Salaries of Regular Employees	104,468.82	724,676.95	0.00	1,250,000.00	525,323.05	66.29	01-2-01100-111-002
01-2-01100-112-002	Regular Instruction-Salaries of Regular Employees	6,316.86	45,185.17	0.00	107,640.00	62,454.83	48.12	01-2-01100-112-002
01-2-01100-122-002	Regular Instruction-Salaries of Temporary Employee	1,072.06	5,217.55	0.00	16,000.00	10,782.45	38.85	01-2-01100-122-002
01-2-01100-123-001	Regular Instruction-Salaries of Temporary Employee	3,689.72	28,884.96	0.00	65,000.00	36,115.04	48.84	01-2-01100-123-001
01-2-01100-123-002	Regular Instruction-Salaries of Temporary Employee	4,714.00	22,010.56	0.00	30,000.00	7,989.44	83.39	01-2-01100-123-002
01-2-01100-150-001	Regular Instruction-Additional Compensation Paid t	2,710.11	12,264.00	0.00	0.00	(12,264.00)	0.00	01-2-01100-150-001
01-2-01100-151-001	Regular Instruction-Additional Compensation Paid t	11,591.23	71,306.66	0.00	143,500.00	72,193.34	58.80	01-2-01100-151-001
01-2-01100-151-002	Regular Instruction-Additional Compensation Paid t	450.16	3,151.12	0.00	15,000.00	11,848.88	24.01	01-2-01100-151-002
01-2-01100-152-001	Regular Instruction-Additional Compensation Paid t	365.00	5,913.00	0.00	20,000.00	14,087.00	31.39	01-2-01100-152-001
01-2-01100-211-001	Regular Instruction-Group Insurance for Teachers/P	12,118.63	165,184.23	0.00	294,000.00	128,815.77	65.12	01-2-01100-211-001

# Chase Revenue and Expenditure Report

Printed: 04/07/2022 12:13:56PM  
Chase County Schools

General 01									
Account Type	X	Expense							
Source of Revenue/Functi									
Account	Description	M.T.D. Activity	Y.T.D. Activity	Open Encumb.	Current Budget	Budget Balance	% of Budget	State Account Number	
01-2-01100-211-002	Regular Instruction-Group Insurance for Teachers/P	24,154.56	170,072.27	0.00	294,000.00	123,927.73	66.09	01-2-01100-211-002	
01-2-01100-212-002	Regular Instruction-Salar (BCB	1,540.48	11,000.50	0.00	22,000.00	10,999.50	57.48	01-2-01100-212-002	
01-2-01100-213-001	Regular Instruction-Salar (BCB	156.25	1,231.16	0.00	1,500.00	268.84	88.65	01-2-01100-213-001	
01-2-01100-213-002	Regular Instruction-Salar (BCB	634.08	3,950.96	0.00	5,000.00	1,049.04	91.10	01-2-01100-213-002	
01-2-01100-219-001	Early Retirement -ES (BCBS-DBe	640.73	640.73	0.00	800.00	159.27	80.09	01-2-01100-219-001	
01-2-01100-219-002	Early Retirement -HS (BCBS-DBe	0.00	0.00	0.00	350.00	350.00	0.00	01-2-01100-219-002	
01-2-01100-220-001	Regular Instruction-Social Security Payments for N	207.32	938.18	0.00	0.00	(938.18)	0.00	01-2-01100-220-001	
01-2-01100-221-001	Regular Instruction-Social Security Payments for T	4,133.05	51,183.58	0.00	86,250.00	35,066.42	68.60	01-2-01100-221-001	
01-2-01100-221-002	Regular Instruction-Social Security Payments for T	7,738.78	53,660.71	0.00	88,250.00	34,589.29	69.52	01-2-01100-221-002	
01-2-01100-222-001	Regular Instruction-Addit (FIC	27.92	452.32	0.00	1,575.00	1,122.68	30.49	01-2-01100-222-001	
01-2-01100-222-002	Regular Instruction-Salar (FIC	480.27	3,247.12	0.00	8,575.00	5,327.88	43.59	01-2-01100-222-002	
01-2-01100-223-001	Regular Instruction-Social Security Payments for S	281.15	2,176.23	0.00	5,000.00	2,823.77	47.89	01-2-01100-223-001	
01-2-01100-223-002	Regular Instruction-Social Security Payments for S	319.17	1,433.40	0.00	2,000.00	566.60	81.38	01-2-01100-223-002	
01-2-01100-229-001	Early Retirement -ES (FICA)	223.37	223.37	0.00	200.00	(23.37)	111.69	01-2-01100-229-001	
01-2-01100-229-002	Early Retirement -HS (FICA)	0.00	0.00	0.00	100.00	100.00	0.00	01-2-01100-229-002	
01-2-01100-231-001	Regular Instruction-Retirement Contributions for T	7,804.84	53,965.78	0.00	88,375.00	34,409.22	69.74	01-2-01100-231-001	
01-2-01100-231-002	Regular Instruction-Retirement Contributions for T	7,714.46	53,313.50	0.00	88,375.00	35,061.50	69.01	01-2-01100-231-002	
01-2-01100-232-001	Regular Instruction-Addit (NPE	0.00	0.00	0.00	350.00	350.00	0.00	01-2-01100-232-001	
01-2-01100-232-002	Regular Instruction-Salar (NPE	464.47	3,322.34	0.00	9,000.00	5,677.66	42.32	01-2-01100-232-002	
01-2-01100-233-001	Regular Instruction-Retirement Contributions for S	46.95	307.42	0.00	350.00	42.58	96.64	01-2-01100-233-001	
01-2-01100-233-002	Regular Instruction-Retirement Contributions for S	91.64	524.92	0.00	750.00	225.08	82.82	01-2-01100-233-002	
01-2-01100-237-001	Regular Instruction-Increased Retirement Contrib	2,696.32	18,637.68	0.00	23,125.00	4,487.32	92.03	01-2-01100-237-001	
01-2-01100-237-002	Regular Instruction-Salar (NPE	2,840.17	19,621.16	0.00	26,125.00	6,503.84	85.95	01-2-01100-237-002	
01-2-01100-239-001	Early Retirement -ES	3,000.00	3,000.00	0.00	2,000.00	(1,000.00)	150.00	01-2-01100-239-001	
01-2-01100-239-002	Early Retirement -HS	0.00	0.00	0.00	1,000.00	1,000.00	0.00	01-2-01100-239-002	
01-2-01100-281-001	Regular Instruction-Health Benefits Paid for Teach	1,087.72	11,567.10	0.00	9,500.00	(2,067.10)	133.26	01-2-01100-281-001	
01-2-01100-281-002	Regular Instruction-Health Benefits Paid for Teach	798.79	6,955.13	0.00	8,000.00	1,044.87	96.84	01-2-01100-281-002	
01-2-01100-282-002	Regular Instruction-Salar (HSA	75.30	1,457.40	0.00	1,000.00	(457.40)	154.75	01-2-01100-282-002	

# Chase Revenue and Expenditure Report

Printed: 04/07/2022 12:13:56PM  
Chase County Schools

General 01								
Account Type	X	Expense						
Source of Revenue/Functi								
Account	Description	M.T.D. Activity	Y.T.D. Activity	Open Encumb.	Current Budget	Budget Balance	% of Budget	State Account Number
01-2-01100-283-001	Regular Instruction-Salar (HSA	4.93	91.51	0.00	500.00	408.49	18.94	01-2-01100-283-001
01-2-01100-283-002	Regular Instruction-Salar (HSA	91.37	553.53	0.00	500.00	(53.53)	126.90	01-2-01100-283-002
01-2-01100-289-001	Early Retirement -ES (HSA)	0.00	0.00	0.00	100.00	100.00	0.00	01-2-01100-289-001
01-2-01100-352-000	Regular Instruction-Other Technical Services	0.00	235.00	0.00	0.00	(235.00)	0.00	01-2-01100-352-000
01-2-01100-352-001	Regular Instruction-Other Technical Services	200.00	200.00	0.00	6,000.00	5,800.00	3.33	01-2-01100-352-001
01-2-01100-352-002	Regular Instruction-Other Technical Services	0.00	0.00	0.00	7,000.00	7,000.00	0.00	01-2-01100-352-002
01-2-01100-580-000	Regular Instruction-Travel	548.87	1,673.99	0.00	2,500.00	826.01	66.96	01-2-01100-580-000
01-2-01100-580-001	Regular Instruction-Travel	0.00	863.01	0.00	2,500.00	1,636.99	34.52	01-2-01100-580-001
01-2-01100-580-002	Regular Instruction-Travel	0.00	569.68	0.00	1,500.00	930.32	47.71	01-2-01100-580-002
01-2-01100-610-000	Regular Instruction-General Supplies	813.74	9,751.08	3,211.15	2,000.00	(10,962.23)	663.86	01-2-01100-610-000
01-2-01100-610-001	Regular Instruction-General Supplies	414.22	5,162.21	61.25	0.00	(5,223.46)	0.00	01-2-01100-610-001
01-2-01100-610-001-06	Regular Instruction-General Supplies-English 7-12	9.00	334.20	107.45	3,000.00	2,558.35	20.30	01-2-01100-610-001-06
01-2-01100-610-001-08	Regular Instruction-General Supplies-Math 7-12	0.00	249.50	0.00	3,000.00	2,750.50	8.32	01-2-01100-610-001-08
01-2-01100-610-001-10	Regular Instruction-General Supplies-Science 7-12	(1,830.90)	8,792.59	0.00	6,000.00	(2,792.59)	147.23	01-2-01100-610-001-10
01-2-01100-610-001-12	Regular Instruction-General Supplies-Social S 7-12	0.00	594.72	0.00	1,625.00	1,030.28	36.60	01-2-01100-610-001-12
01-2-01100-610-001-14	Regular Instruction-General Supplies-Art 7-12	249.51	249.51	2,624.56	6,000.00	3,125.93	47.90	01-2-01100-610-001-14
01-2-01100-610-001-16	Regular Instruction-General Supplies-Music 7-12	80.00	514.61	556.57	6,000.00	4,928.82	20.61	01-2-01100-610-001-16
01-2-01100-610-001-18	Regular Instruction-General Supplies-Band 7-12	0.00	3,511.26	197.56	3,000.00	(708.82)	128.98	01-2-01100-610-001-18
01-2-01100-610-001-20	Regular Instruction-General Supplies-PE 7-12	2,756.88	3,783.69	0.00	2,500.00	(1,283.69)	151.35	01-2-01100-610-001-20
01-2-01100-610-001-21	Regular Instruction-General Supplies-STEM	0.00	619.90	2,560.65	2,000.00	(1,180.55)	159.03	01-2-01100-610-001-21
01-2-01100-610-001-22	Regular Instruction-General Supplies-Family Consum	795.37	2,668.05	99.15	3,500.00	732.80	104.05	01-2-01100-610-001-22
01-2-01100-610-001-23	Regular Instruction-General Supplies-Woods	437.17	4,874.64	150.45	7,500.00	2,474.91	79.80	01-2-01100-610-001-23
01-2-01100-610-001-24	Regular Instruction-General Supplies-Ag	774.70	5,727.71	0.00	7,500.00	1,772.29	79.06	01-2-01100-610-001-24

# Chase Revenue and Expenditure Report

Printed: 04/07/2022 12:13:56PM  
Chase County Schools

General 01									
Account Type	X	Expense							
Source of Revenue/Functi									
Account	Description	M.T.D. Activity	Y.T.D. Activity	Open Encumb.	Current Budget	Budget Balance	% of Budget	State Account Number	
01-2-01100-610-001-25	Regular Instruction-General Supplies-Spanish	218.92	374.59	278.18	1,200.00	547.23	80.57	01-2-01100-610-001-25	
01-2-01100-610-001-26	Regular Instruction-General Supplies-Business	0.00	2,953.78	0.00	2,000.00	(953.78)	147.69	01-2-01100-610-001-26	
01-2-01100-610-001-27	Regular Instruction-General Supplies-Speech	0.00	0.00	0.00	1,000.00	1,000.00	0.00	01-2-01100-610-001-27	
01-2-01100-610-002	Regular Instruction-General Supplies	177.05	1,365.10	0.00	0.00	(1,365.10)	0.00	01-2-01100-610-002	
01-2-01100-610-002-00	Regular Instruction-General Supplies-Kindergarten	0.00	275.93	104.00	3,000.00	2,620.07	12.89	01-2-01100-610-002-00	
01-2-01100-610-002-01	Regular Instruction-General Supplies-First Grade	80.83	612.89	0.00	3,000.00	2,387.11	20.43	01-2-01100-610-002-01	
01-2-01100-610-002-02	Regular Instruction-General Supplies-Second Grade	405.90	981.09	0.00	3,000.00	2,018.91	32.70	01-2-01100-610-002-02	
01-2-01100-610-002-03	Regular Instruction-General Supplies-Third Grade	0.00	17.50	0.00	3,000.00	2,982.50	1.83	01-2-01100-610-002-03	
01-2-01100-610-002-04	Regular Instruction-General Supplies-Fourth Grade	0.00	417.92	289.79	3,000.00	2,292.29	25.56	01-2-01100-610-002-04	
01-2-01100-610-002-05	Regular Instruction-General Supplies-English 5-6	0.00	428.32	253.67	1,500.00	818.01	54.79	01-2-01100-610-002-05	
01-2-01100-610-002-07	Regular Instruction-General Supplies-Math 5-6	0.00	60.76	0.00	1,500.00	1,439.24	4.35	01-2-01100-610-002-07	
01-2-01100-610-002-09	Regular Instruction-General Supplies-Science 5-6	0.00	19.77	0.00	2,000.00	1,980.23	0.99	01-2-01100-610-002-09	
01-2-01100-610-002-11	Regular Instruction-General Supplies-Social St 5-6	0.00	0.00	0.00	1,500.00	1,500.00	0.00	01-2-01100-610-002-11	
01-2-01100-610-002-13	Regular Instruction-General Supplies-Art K-6	185.79	3,522.86	322.71	6,000.00	2,154.43	66.31	01-2-01100-610-002-13	
01-2-01100-610-002-15	Regular Instruction-General Supplies-Music K-6	559.97	2,493.23	0.00	3,000.00	506.77	88.02	01-2-01100-610-002-15	
01-2-01100-610-002-17	Regular Instruction-General Supplies-Band 5-6	0.00	7,630.32	0.00	6,675.00	(955.32)	114.70	01-2-01100-610-002-17	
01-2-01100-610-002-19	Regular Instruction-General Supplies-PE K-6	0.00	1,057.01	0.00	2,000.00	942.99	52.85	01-2-01100-610-002-19	
01-2-01100-640-000	Regular Instruction-Books and Periodical	0.00	124.70	0.00	1,000.00	875.30	12.47	01-2-01100-640-000	
01-2-01100-640-001	Regular Instruction-Books and Periodical	0.00	13,806.66	47,090.32	61,750.00	853.02	99.15	01-2-01100-640-001	
01-2-01100-640-002	Regular Instruction-Books and Periodical	858.96	4,900.68	13,804.03	61,750.00	43,045.29	33.24	01-2-01100-640-002	
01-2-01100-641-002	Regular Instruction-E-Books	0.00	0.00	0.00	3,500.00	3,500.00	0.00	01-2-01100-641-002	

# Chase Revenue and Expenditure Report

Printed: 04/07/2022 12:13:56PM  
Chase County Schools

General 01									
Account Type	X	Expense							
Source of Revenue/Functi									
Account	Description	M.T.D. Activity	Y.T.D. Activity	Open Encumb.	Current Budget	Budget Balance	% of Budget	State Account Number	
01-2-01100-642-000	Regular Instruction-Audio-Visual Materials	0.00	0.00	0.00	115,000.00	115,000.00	0.00	01-2-01100-642-000	
01-2-01100-643-000	Regular Instruction-Web/Cloud Based Software	0.00	15,823.00	0.00	30,000.00	14,177.00	52.74	01-2-01100-643-000	
01-2-01100-731-001-0-0-0-0	Machinery	0.00	0.00	0.00	12,000.00	12,000.00	0.00	01-2-01100-731-001	
01-2-01100-733-000	Invoice 00017734	0.00	2,063.49	0.00	10,000.00	7,936.51	20.63	01-2-01100-733-000	
01-2-01100-733-001	Regular Instruction-Furniture and Fixtures	0.00	0.00	492.55	10,000.00	9,507.45	4.93	01-2-01100-733-001	
01-2-01100-733-002	Regular Instruction-Furniture and Fixtures	0.00	0.00	0.00	10,000.00	10,000.00	0.00	01-2-01100-733-002	
01-2-01100-734-000	Regular Instruction-Technology-Related Hardware	11,603.77	24,860.21	14,598.60	100,000.00	60,541.19	54.37	01-2-01100-734-000	
01-2-01100-734-001	Regular Instruction-Technology-Related Hardware	0.00	1,386.00	0.00	39,038.00	37,652.00	3.55	01-2-01100-734-001	
01-2-01100-734-002	Regular Instruction-Technology-Related Hardware	0.00	2,466.00	0.00	5,000.00	2,534.00	49.32	01-2-01100-734-002	
01-2-01100-735-000	Regular Instruction-Technology Software	0.00	10,367.29	0.00	44,000.00	33,632.71	28.15	01-2-01100-735-000	
01-2-01100-735-001	Regular Instruction-Technology Software	0.00	1,060.00	0.00	6,500.00	5,440.00	16.31	01-2-01100-735-001	
01-2-01100-735-002	Regular Instruction-Technology Software	360.00	1,192.20	26,670.00	8,500.00	(19,362.20)	392.35	01-2-01100-735-002	
01-2-01100-810-000	Regular Instruction-Dues and Fees	204.00	266.00	0.00	6,000.00	5,734.00	4.43	01-2-01100-810-000	
01-2-01100-810-001	Regular Instruction-Dues and Fees	0.00	1,475.00	0.00	2,000.00	525.00	83.15	01-2-01100-810-001	
01-2-01100-810-002	Regular Instruction-Dues and Fees	0.00	693.00	0.00	500.00	(193.00)	168.60	01-2-01100-810-002	
01-2-01100-890-000	Regular Instruction-Miscellaneous Expenditures	276.62	5,649.70	0.00	1,500.00	(4,149.70)	376.65	01-2-01100-890-000	
01-2-01100-890-001	Regular Instruction-Miscellaneous Expenditures	0.00	7,254.00	0.00	25,000.00	17,746.00	29.02	01-2-01100-890-001	
01-2-01100-890-002	Regular Instruction-Miscellaneous Expenditures	0.00	4,851.15	0.00	0.00	(4,851.15)	0.00	01-2-01100-890-002	
01-2-01150-111-001	Limited English Proficiency Programs-Salaries of R	(22,736.45)	4,547.29	0.00	73,000.00	68,452.71	12.46	01-2-01150-111-001	
01-2-01150-111-002	Limited English Proficiency Programs-Salaries of R	5,642.29	39,496.03	0.00	97,000.00	57,503.97	46.53	01-2-01150-111-002	
01-2-01150-112-001	Limited English Proficiency Programs-Salaries of R	0.00	0.00	0.00	16,000.00	16,000.00	0.00	01-2-01150-112-001	

# Chase Revenue and Expenditure Report

Printed: 04/07/2022 12:13:56PM  
Chase County Schools

General 01								
Account Type	X	Expense						
Source of Revenue/Functi								
Account	Description	M.T.D. Activity	Y.T.D. Activity	Open Encumb.	Current Budget	Budget Balance	% of Budget	State Account Number
01-2-01150-122-000	Limited English Proficiency Programs-Salaries of T	0.00	0.00	0.00	250.00	250.00	0.00	01-2-01150-122-000
01-2-01150-123-000	Limited English Proficiency Programs-Salaries of T	255.00	1,077.00	0.00	11,000.00	9,923.00	9.93	01-2-01150-123-000
01-2-01150-211-001	Limited English Proficiency Programs-Group Insuran	(9,255.11)	1,922.95	0.00	23,000.00	21,077.05	16.45	01-2-01150-211-001
01-2-01150-211-002	Limited English Proficiency Programs-Group Insuran	680.49	4,785.18	0.00	16,015.00	11,229.82	34.15	01-2-01150-211-002
01-2-01150-212-001	Limited English Proficien (Inc	0.00	0.00	0.00	50.00	50.00	0.00	01-2-01150-212-001
01-2-01150-213-000	Limited English Proficien (BCB	4.75	8.42	0.00	25.00	16.58	45.44	01-2-01150-213-000
01-2-01150-221-001	Limited English Proficiency Programs-Social Securi	(1,708.68)	341.75	0.00	3,200.00	2,858.25	21.36	01-2-01150-221-001
01-2-01150-221-002	Limited English Proficiency Programs-Social Securi	424.64	2,972.30	0.00	9,010.00	6,037.70	37.70	01-2-01150-221-002
01-2-01150-222-000	Limited English Proficiency Programs-Social Securi	0.00	0.00	0.00	20.00	20.00	0.00	01-2-01150-222-000
01-2-01150-222-001	Limited English Proficien (FIC	0.00	0.00	0.00	1,100.00	1,100.00	0.00	01-2-01150-222-001
01-2-01150-223-000	Limited English Proficiency Programs-Social Securi	19.49	102.23	0.00	800.00	697.77	12.92	01-2-01150-223-000
01-2-01150-231-001	Limited English Proficiency Programs-Retirement Co	334.34	2,340.43	0.00	6,000.00	3,659.57	44.58	01-2-01150-231-001
01-2-01150-231-002	Limited English Proficiency Programs-Retirement Co	414.87	2,904.21	0.00	6,000.00	3,095.79	55.32	01-2-01150-231-002
01-2-01150-232-001	Limited English Proficien (NPE	0.00	0.00	0.00	1,500.00	1,500.00	0.00	01-2-01150-232-001
01-2-01150-233-000	Limited English Proficiency Programs-Retirement Co	1.11	3.30	0.00	5.00	1.70	87.80	01-2-01150-233-000
01-2-01150-237-000	Limited English Proficiency Programs-Increased Ret	0.38	1.14	0.00	0.00	(1.14)	0.00	01-2-01150-237-000
01-2-01150-237-001	Limited English Proficien (NPE	114.82	803.74	0.00	1,000.00	196.26	91.86	01-2-01150-237-001
01-2-01150-237-002	Limited English Proficien (NPE	142.47	997.35	0.00	1,500.00	502.65	75.99	01-2-01150-237-002
01-2-01150-281-000	Limited English Proficiency Programs-Health Benefi	0.00	450.00	0.00	500.00	50.00	90.00	01-2-01150-281-000
01-2-01150-281-001	Limited English Proficien (HSA	0.00	0.00	0.00	1,750.00	1,750.00	0.00	01-2-01150-281-001
01-2-01150-283-000	Limited English Proficien (HSA	0.67	0.67	0.00	0.00	(0.67)	0.00	01-2-01150-283-000
01-2-01150-610-000	Limited English Proficiency Programs-General Suppl	204.73	204.73	43.14	1,000.00	752.13	24.79	01-2-01150-610-000
01-2-01150-610-001	Limited English Proficiency Programs-General Suppl	0.00	273.14	0.00	350.00	76.86	78.04	01-2-01150-610-001
01-2-01150-610-002	Limited English Proficiency Programs-General Suppl	44.94	345.02	0.00	450.00	104.98	76.67	01-2-01150-610-002

# Chase Revenue and Expenditure Report

Printed: 04/07/2022 12:13:56PM  
Chase County Schools

General 01									
Account Type	X	Expense							
Source of Revenue/Functi									
Account	Description	M.T.D. Activity	Y.T.D. Activity	Open Encumb.	Current Budget	Budget Balance	% of Budget	State Account Number	
01-2-01150-640-000	Limited English Proficiency Programs-Books and Per	0.00	0.00	750.00	3,000.00	2,250.00	25.00	01-2-01150-640-000	
01-2-01150-642-000	Limited English Proficiency Programs-Audio-Visual	0.00	0.00	0.00	1,500.00	1,500.00	0.00	01-2-01150-642-000	
01-2-01150-890-000	Limited English Proficiency Programs-Miscellaneous	0.00	168.00	0.00	1,500.00	1,332.00	11.20	01-2-01150-890-000	
01-2-01200-111-001	Special Education Instructional Programs - School	6,802.82	49,370.90	0.00	85,500.00	36,129.10	65.70	01-2-01200-111-001	
01-2-01200-111-002	Special Education Instructional Programs - School	7,642.19	53,495.33	0.00	63,500.00	10,004.67	96.28	01-2-01200-111-002	
01-2-01200-112-001	Special Education Instructional Programs - School	9,284.32	65,790.20	0.00	100,000.00	34,209.80	76.05	01-2-01200-112-001	
01-2-01200-112-002	Special Education Instructional Programs - School	11,951.15	79,600.27	0.00	103,100.00	23,499.73	88.95	01-2-01200-112-002	
01-2-01200-122-001	Special Education Instructional Programs - School	90.00	834.00	0.00	3,000.00	2,166.00	42.40	01-2-01200-122-001	
01-2-01200-122-002	Special Education Instructional Programs - School	360.00	2,508.00	0.00	8,000.00	5,492.00	32.81	01-2-01200-122-002	
01-2-01200-123-001	Special Education Instructional Programs - School	360.00	480.00	0.00	1,900.00	1,420.00	25.26	01-2-01200-123-001	
01-2-01200-123-002	Special Education Instructional Programs - School	60.00	780.00	0.00	8,000.00	7,220.00	10.55	01-2-01200-123-002	
01-2-01200-211-001	Special Education Instructional Programs - School	1,170.62	8,636.75	0.00	13,000.00	4,363.25	76.01	01-2-01200-211-001	
01-2-01200-211-002	Special Education Instructional Programs - School	1,389.25	9,749.04	0.00	15,500.00	5,750.96	71.89	01-2-01200-211-002	
01-2-01200-212-001	ES-Aide SPED Health Ins	1,014.25	11,070.74	0.00	27,000.00	15,929.26	44.77	01-2-01200-212-001	
01-2-01200-212-002	HS-Aide SPED Health Ins	1,636.18	11,295.32	0.00	13,500.00	2,204.68	95.84	01-2-01200-212-002	
01-2-01200-213-001	Special Education Instruc (BCB	0.00	0.00	0.00	50.00	50.00	0.00	01-2-01200-213-001	
01-2-01200-213-002	Special Education Instruc (BCB	(2.65)	(14.62)	0.00	100.00	114.62	-17.84	01-2-01200-213-002	
01-2-01200-219-001	Special Education Instruc (BCB	0.00	0.00	0.00	150.00	150.00	0.00	01-2-01200-219-001	
01-2-01200-221-001	Special Education Instructional Programs - School	517.29	3,754.96	0.00	8,000.00	4,245.04	53.40	01-2-01200-221-001	
01-2-01200-221-002	Special Education Instructional Programs - School	560.61	3,924.03	0.00	8,000.00	4,075.97	56.06	01-2-01200-221-002	
01-2-01200-222-001	ES-Aide SPED SS	656.89	4,446.89	0.00	6,000.00	1,553.11	86.75	01-2-01200-222-001	
01-2-01200-222-002	HS-Aide SPED SS	828.48	5,498.11	0.00	7,500.00	2,001.89	84.26	01-2-01200-222-002	
01-2-01200-223-001	Special Education Instruc (FIC	27.54	36.72	0.00	70.00	33.28	52.46	01-2-01200-223-001	
01-2-01200-223-002	HS-Sub SPED SS	4.59	59.66	0.00	500.00	440.34	12.91	01-2-01200-223-002	
01-2-01200-229-001	Special Education Instruc (FIC	0.00	0.00	0.00	100.00	100.00	0.00	01-2-01200-229-001	

# Chase Revenue and Expenditure Report

Printed: 04/07/2022 12:13:56PM  
Chase County Schools

General 01								
Account Type	X	Expense						
Source of Revenue/Functi								
Account	Description	M.T.D. Activity	Y.T.D. Activity	Open Encumb.	Current Budget	Budget Balance	% of Budget	State Account Number
01-2-01200-231-001	Special Education Instructional Programs - School	500.20	3,630.16	0.00	9,500.00	5,869.84	43.48	01-2-01200-231-001
01-2-01200-231-002	Special Education Instructional Programs - School	561.90	3,933.48	0.00	10,500.00	6,566.52	42.81	01-2-01200-231-002
01-2-01200-232-001	ES-Aide SPED NPERS	682.64	4,824.55	0.00	8,000.00	3,175.45	69.74	01-2-01200-232-001
01-2-01200-232-002	HS-Aide SPED NPERS	878.74	5,852.84	0.00	9,000.00	3,147.16	74.92	01-2-01200-232-002
01-2-01200-233-001	Special Education Instruc (NPE	0.00	0.00	0.00	20.00	20.00	0.00	01-2-01200-233-001
01-2-01200-233-002	Special Education Instruc (NPE	0.00	0.00	0.00	10.00	10.00	0.00	01-2-01200-233-002
01-2-01200-237-001	Special Education Instruc (NPE	406.19	2,903.38	0.00	5,250.00	2,346.62	63.51	01-2-01200-237-001
01-2-01200-237-002	Special Education Instruc (NPE	494.73	3,360.70	0.00	6,250.00	2,889.30	61.75	01-2-01200-237-002
01-2-01200-239-001	Special Education Instruct (Early Retirement)	0.00	0.00	0.00	2,500.00	2,500.00	0.00	01-2-01200-239-001
01-2-01200-281-002	HS-Teach SPED HRA	0.00	450.00	0.00	0.00	(450.00)	0.00	01-2-01200-281-002
01-2-01200-282-001	ES-Aide SPED HRA	0.00	0.00	0.00	250.00	250.00	0.00	01-2-01200-282-001
01-2-01200-282-002	HS-Aide SPED HRA	86.59	1,045.49	0.00	250.00	(795.49)	453.25	01-2-01200-282-002
01-2-01200-320-000	Special Education Instructional Programs - School	3,625.00	25,375.00	0.00	0.00	(25,375.00)	0.00	01-2-01200-320-000
01-2-01200-540-000	Special Education Instructional Programs - School	0.00	99.60	0.00	3,000.00	2,900.40	3.32	01-2-01200-540-000
01-2-01200-562-002	SPED tuition to other schools	850.00	1,830.00	0.00	5,000.00	3,170.00	41.80	01-2-01200-562-002
01-2-01200-569-002	SPED tuition to other schools	0.00	0.00	0.00	1,000.00	1,000.00	0.00	01-2-01200-569-002
01-2-01200-580-001	Special Education Instructional Programs - School	0.00	0.00	0.00	600.00	600.00	0.00	01-2-01200-580-001
01-2-01200-580-002	Special Education Instructional Programs - School	59.25	111.83	0.00	750.00	638.17	14.91	01-2-01200-580-002
01-2-01200-591-000	Special Education Instructional Programs - School	560.00	3,913.88	0.00	40,000.00	36,086.12	11.01	01-2-01200-591-000
01-2-01200-610-000	Special Education Instructional Programs - School	0.00	0.00	0.00	50.00	50.00	0.00	01-2-01200-610-000
01-2-01200-610-001	Special Education Instructional Programs - School	117.47	2,552.96	0.00	2,000.00	(552.96)	157.28	01-2-01200-610-001
01-2-01200-610-002	Special Education Instructional Programs - School	96.90	2,149.37	0.00	6,000.00	3,850.63	36.32	01-2-01200-610-002
01-2-01200-640-000	Special Education Instructional Programs - School	0.00	0.00	0.00	200.00	200.00	0.00	01-2-01200-640-000
01-2-01200-640-001	Special Education Instructional Programs - School	0.00	0.00	0.00	200.00	200.00	0.00	01-2-01200-640-001
01-2-01200-640-002	Special Education Instructional Programs - School	0.00	0.00	0.00	3,000.00	3,000.00	0.00	01-2-01200-640-002
01-2-01200-733-000	Special Education Instructional Programs - School	0.00	892.71	0.00	4,000.00	3,107.29	22.32	01-2-01200-733-000

# Chase Revenue and Expenditure Report

Printed: 04/07/2022 12:13:56PM  
Chase County Schools

General 01									
Account Type	X	Expense							
Source of Revenue/Functi									
Account	Description	M.T.D. Activity	Y.T.D. Activity	Open Encumb.	Current Budget	Budget Balance	% of Budget	State Account Number	
01-2-01200-733-002	Special Education Instructional Programs - School	0.00	0.00	0.00	6,500.00	6,500.00	0.00	01-2-01200-733-002	
01-2-01200-734-001	Special Education Instructional Programs - School	0.00	0.00	0.00	3,000.00	3,000.00	0.00	01-2-01200-734-001	
01-2-01200-810-000	Special Education Instructional Programs - School	0.00	49.80	0.00	350.00	300.20	14.23	01-2-01200-810-000	
01-2-01200-810-001	Special Education Instructional Programs - School	0.00	0.00	0.00	25.00	25.00	0.00	01-2-01200-810-001	
01-2-01200-810-002	Special Education Instructional Programs - School	0.00	0.00	0.00	25.00	25.00	0.00	01-2-01200-810-002	
01-2-01200-890-000	Special Education Instructional Programs - School	0.00	0.00	0.00	300.00	300.00	0.00	01-2-01200-890-000	
01-2-02120-111-001	Guidance Services-Salaries of Regular Employees Pa	5,507.88	38,555.16	0.00	65,890.50	27,335.34	67.65	01-2-02120-111-001	
01-2-02120-111-002	Guidance Services-Salaries of Regular Employees Pa	5,505.42	38,537.93	0.00	65,890.50	27,352.57	66.84	01-2-02120-111-002	
01-2-02120-211-001	Guidance Services-Group Insurance for Teachers/Pro	1,516.31	12,185.74	0.00	19,059.00	6,873.26	73.27	01-2-02120-211-001	
01-2-02120-211-002	Guidance Services-Group Insurance for Teachers/Pro	1,366.03	9,694.73	0.00	19,059.00	9,364.27	58.15	01-2-02120-211-002	
01-2-02120-221-001	Guidance Services-Social Security Payments for Tea	396.25	2,747.67	0.00	4,775.00	2,027.33	66.56	01-2-02120-221-001	
01-2-02120-221-002	Guidance Services-Social Security Payments for Tea	418.76	2,930.96	0.00	4,775.00	1,844.04	70.15	01-2-02120-221-002	
01-2-02120-231-001	Guidance Services-Retirement Contributions for Tea	404.96	2,834.97	0.00	5,100.00	2,265.03	64.27	01-2-02120-231-001	
01-2-02120-231-002	Guidance Services-Retirement Contributions for Tea	404.82	2,833.62	0.00	5,100.00	2,266.38	63.50	01-2-02120-231-002	
01-2-02120-237-001	Guidance Services-Salarie (NPE)	139.07	973.54	0.00	1,500.00	526.46	75.04	01-2-02120-237-001	
01-2-02120-237-002	Guidance Services-Salarie (NPE)	139.01	973.07	0.00	1,500.00	526.93	74.14	01-2-02120-237-002	
01-2-02120-281-000	Guidance Services-Health Benefits Paid for Teacher	0.00	0.00	0.00	750.00	750.00	0.00	01-2-02120-281-000	
01-2-02120-580-000	Guidance Services-Travel	0.00	492.47	0.00	0.00	(492.47)	0.00	01-2-02120-580-000	
01-2-02120-610-000	Guidance Services-General Supplies	0.00	1,319.00	3,789.60	1,200.00	(3,908.60)	425.72	01-2-02120-610-000	
01-2-02120-734-000	Guidance Services-Technology-Related Hardware	0.00	0.00	0.00	4,000.00	4,000.00	0.00	01-2-02120-734-000	
01-2-02120-810-000	Guidance Services-Dues and Fees	0.00	0.00	0.00	1,000.00	1,000.00	0.00	01-2-02120-810-000	
01-2-02120-890-000	Guidance Services-Miscellaneous Expenditures	0.00	224.13	0.00	0.00	(224.13)	0.00	01-2-02120-890-000	

# Chase Revenue and Expenditure Report

Printed: 04/07/2022 12:13:56PM  
Chase County Schools

General 01									
Account Type	X	Expense							
Source of Revenue/Functi									
Account	Description	M.T.D. Activity	Y.T.D. Activity	Open Encumb.	Current Budget	Budget Balance	% of Budget	State Account Number	
01-2-02130-116-000	Health Services-Salaries of Regular Employees Paid	4,333.34	30,333.33	0.00	50,000.00	19,666.67	69.33	01-2-02130-116-000	
01-2-02130-120-000	Health Services-Salaries of Temporary Employees Pa	222.00	1,081.94	0.00	1,850.00	768.06	70.97	01-2-02130-120-000	
01-2-02130-210-000	Health Services-Group Insurance for Non-Instructio	0.57	0.99	0.00	0.00	(0.99)	0.00	01-2-02130-210-000	
01-2-02130-216-000	Health Services-Salaries (BCB	1,394.90	9,793.32	0.00	16,500.00	6,706.68	67.84	01-2-02130-216-000	
01-2-02130-220-000	Health Services-Social Security Payments for Non-I	16.98	82.76	0.00	250.00	167.24	40.17	01-2-02130-220-000	
01-2-02130-226-000	Health Services-Salaries (FIC	323.73	2,265.87	0.00	3,750.00	1,484.13	69.05	01-2-02130-226-000	
01-2-02130-230-000	Health Services-Retirement Contributions for Non-I	16.32	31.91	0.00	0.00	(31.91)	0.00	01-2-02130-230-000	
01-2-02130-236-000	Health Services-Salaries (NPE	318.63	2,230.35	0.00	4,000.00	1,769.65	63.72	01-2-02130-236-000	
01-2-02130-237-000	Health Services-Increased Retirement Contributions	115.04	776.92	0.00	1,200.00	423.08	74.10	01-2-02130-237-000	
01-2-02130-286-000	Health Services-Health Benefits Paid for Professio	0.00	130.00	0.00	400.00	270.00	32.50	01-2-02130-286-000	
01-2-02130-580-000	Health Services-Travel	0.00	139.95	0.00	1,500.00	1,360.05	9.33	01-2-02130-580-000	
01-2-02130-610-000	Health Services-General Supplies	0.00	232.98	216.10	1,500.00	1,050.92	33.97	01-2-02130-610-000	
01-2-02130-810-000	Health Services-Dues and Fees	0.00	0.00	0.00	350.00	350.00	0.00	01-2-02130-810-000	
01-2-02140-320-000	Psychological Services-Professional Educational Se	7,214.67	50,502.69	0.00	15,101.00	(35,401.69)	334.43	01-2-02140-320-000	
01-2-02141-591-000	Psych ESU - School Age	0.00	0.00	0.00	17,000.00	17,000.00	0.00	01-2-02141-591-000	
01-2-02142-320-000	Psych ESU - Ages 3 to 5 - Professional Educational	333.33	2,333.31	0.00	0.00	(2,333.31)	0.00	01-2-02142-320-000	
01-2-02151-591-000	Speech ESU - school age	11,149.38	70,316.35	0.00	28,000.00	(42,316.35)	256.06	01-2-02151-591-000	
01-2-02161-591-000	OT ESU - School Age	4,786.56	14,359.68	0.00	9,000.00	(5,359.68)	159.55	01-2-02161-591-000	
01-2-02213-330-000	Instructional Staff	(2,600.00)	0.00	9,000.00	17,000.00	8,000.00	52.94	01-2-02213-330-000	
01-2-02213-580-000	Training-Employee Training and Staff Dev Travel (mil,meals,hotel)	0.00	0.00	0.00	100.00	100.00	0.00	01-2-02213-580-000	
01-2-02220-111-000	Library/Media Services-Salaries of Regular Employe	3,122.14	18,478.29	0.00	30,000.00	11,521.71	70.93	01-2-02220-111-000	
01-2-02220-112-000	Library/Media Services-Salaries of Regular Employe	1,841.40	12,112.82	0.00	17,500.00	5,387.18	79.64	01-2-02220-112-000	
01-2-02220-122-000	Library/Media Services-Salaries of Temporary Emplo	156.00	336.00	0.00	400.00	64.00	84.00	01-2-02220-122-000	
01-2-02220-123-000	Library/Media Services-Salaries of Temporary Emplo	0.00	0.00	0.00	1,500.00	1,500.00	0.00	01-2-02220-123-000	
01-2-02220-211-000	Library/Media Services-Group Insurance for Teacher	796.80	5,423.41	0.00	15,500.00	10,076.59	40.05	01-2-02220-211-000	

# Chase Revenue and Expenditure Report

Printed: 04/07/2022 12:13:56PM  
Chase County Schools

General 01									
Account Type	X	Expense							
Source of Revenue/Functi									
Account	Description	M.T.D. Activity	Y.T.D. Activity	Open Encumb.	Current Budget	Budget Balance	% of Budget	State Account Number	
01-2-02220-212-000	Library/Media Services-Group Insurance for Instruc	3.55	23.98	0.00	40.00	16.02	68.80	01-2-02220-212-000	
01-2-02220-213-000	Library/Media Services-Sa (BCB	0.00	0.00	0.00	60.00	60.00	0.00	01-2-02220-213-000	
01-2-02220-221-000	Library/Media Services-Social Security Payments fo	173.04	965.83	0.00	2,900.00	1,934.17	38.46	01-2-02220-221-000	
01-2-02220-222-000	Library/Media Services-Social Security Payments fo	152.80	952.34	0.00	1,350.00	397.66	80.88	01-2-02220-222-000	
01-2-02220-223-000	Library/Media Services-Social Security Payments fo	0.00	0.00	0.00	120.00	120.00	0.00	01-2-02220-223-000	
01-2-02220-231-000	Library/Media Services-Retirement Contributions fo	229.56	1,358.58	0.00	3,350.00	1,991.42	46.70	01-2-02220-231-000	
01-2-02220-232-000	Library/Media Services-Retirement Contributions fo	135.39	890.61	0.00	1,600.00	709.39	64.04	01-2-02220-232-000	
01-2-02220-233-000	Library/Media Services-Sa (NPE	0.00	0.00	0.00	10.00	10.00	0.00	01-2-02220-233-000	
01-2-02220-237-000	Library/Media Services-Increased Retirement Contri	125.33	772.41	0.00	1,300.00	527.59	68.40	01-2-02220-237-000	
01-2-02220-283-000	Library/Media Services-Sa (HSA	0.00	0.00	0.00	20.00	20.00	0.00	01-2-02220-283-000	
01-2-02220-382-000	Library/Media Services-Distance Education & Teleco	0.00	0.00	0.00	24,000.00	24,000.00	0.00	01-2-02220-382-000	
01-2-02220-610-000	Library/Media Services-General Supplies	0.00	420.43	432.01	15,500.00	14,647.56	5.50	01-2-02220-610-000	
01-2-02220-640-000	Library/Media Services-Books and Periodical	0.00	183.83	0.00	15,000.00	14,816.17	1.23	01-2-02220-640-000	
01-2-02230-116-000	Instruction-Related Technology-Salaries of Regular	636.00	47,659.17	0.00	72,000.00	24,340.83	74.73	01-2-02230-116-000	
01-2-02230-216-000	Instruction-Related Techn (BCB	1,403.38	9,834.94	0.00	17,000.00	7,165.06	66.11	01-2-02230-216-000	
01-2-02230-226-000	Instruction-Related Techn (FIC	82.48	3,679.78	0.00	6,000.00	2,320.22	69.17	01-2-02230-226-000	
01-2-02230-236-000	Instruction-Related Techn (NPE	452.20	3,165.40	0.00	6,000.00	2,834.60	60.29	01-2-02230-236-000	
01-2-02230-237-000	Instruction-Related Technology-Increased Retiremen	155.29	1,087.03	0.00	1,750.00	662.97	70.99	01-2-02230-237-000	
01-2-02230-286-000	Instruction-Related Technology-Health Benefits Pai	0.00	545.69	0.00	0.00	(545.69)	0.00	01-2-02230-286-000	
01-2-02310-317-000	Board of Education-Contracted Legal Services	0.00	0.00	0.00	6,000.00	6,000.00	0.00	01-2-02310-317-000	
01-2-02310-580-000	Board of Education-Travel	0.00	0.00	0.00	2,000.00	2,000.00	0.00	01-2-02310-580-000	
01-2-02310-610-000	Board of Education-General Supplies	0.00	0.00	0.00	1,000.00	1,000.00	0.00	01-2-02310-610-000	
01-2-02310-810-000	Board of Education-Dues and Fees	0.00	4,620.00	0.00	6,000.00	1,380.00	77.00	01-2-02310-810-000	
01-2-02320-105-000	Executive Administration-Salaries Paid to Superint	12,916.67	90,416.67	0.00	161,500.00	71,083.33	63.98	01-2-02320-105-000	

# Chase Revenue and Expenditure Report

Printed: 04/07/2022 12:13:56PM  
Chase County Schools

General 01									
Account Type	X	Expense							
Source of Revenue/Functi									
Account	Description	M.T.D. Activity	Y.T.D. Activity	Open Encumb.	Current Budget	Budget Balance	% of Budget	State Account Number	
01-2-02320-110-000	Executive Administration-Salaries of Regular Emplo	3,173.87	20,460.44	0.00	38,000.00	17,539.56	63.10	01-2-02320-110-000	
01-2-02320-116-000	Executive Administration-Salaries of Regular Emplo	5,718.65	40,030.55	0.00	70,000.00	29,969.45	65.36	01-2-02320-116-000	
01-2-02320-210-000	Executive Administration-Group Insurance for Non-I	1,683.92	13,555.16	0.00	30,000.00	16,444.84	50.80	01-2-02320-210-000	
01-2-02320-215-000	Executive Administration-Group Insurance for Super	1,937.34	13,606.54	0.00	23,000.00	9,393.46	67.58	01-2-02320-215-000	
01-2-02320-216-000	Executive Administration- (BCB	97.19	687.88	0.00	1,500.00	812.12	52.34	01-2-02320-216-000	
01-2-02320-220-000	Executive Administration-Social Security Payments	236.19	1,518.96	0.00	3,000.00	1,481.04	59.38	01-2-02320-220-000	
01-2-02320-225-000	Executive Administration-Social Security Payments	988.13	6,315.49	0.00	12,000.00	5,684.51	60.86	01-2-02320-225-000	
01-2-02320-226-000	Executive Administration- (FIC	396.24	2,773.68	0.00	5,000.00	2,226.32	63.40	01-2-02320-226-000	
01-2-02320-230-000	Executive Administration-Retirement Contributions	189.25	1,416.19	0.00	3,000.00	1,583.81	54.36	01-2-02320-230-000	
01-2-02320-235-000	Executive Administration-Retirement Contributions	949.74	6,648.18	0.00	12,000.00	5,351.82	63.32	01-2-02320-235-000	
01-2-02320-236-000	Executive Administration- (NPE	420.48	2,943.36	0.00	5,200.00	2,256.64	64.69	01-2-02320-236-000	
01-2-02320-237-000	Executive Administration-Increased Retirement Cont	535.54	3,780.18	0.00	5,500.00	1,719.82	78.63	01-2-02320-237-000	
01-2-02320-280-000	Executive Administration-Health Benefits Paid for	231.48	1,620.36	0.00	1,000.00	(620.36)	185.18	01-2-02320-280-000	
01-2-02320-540-000	Executive Administration-Advertising	0.00	0.00	0.00	7,000.00	7,000.00	0.00	01-2-02320-540-000	
01-2-02320-580-000	Executive Administration-Travel	34.09	3,781.71	0.00	3,000.00	(781.71)	126.06	01-2-02320-580-000	
01-2-02320-610-000	Executive Administration-General Supplies	0.00	320.58	0.00	5,000.00	4,679.42	12.95	01-2-02320-610-000	
01-2-02320-733-000	Executive Administration-Furniture and Fixtures	0.00	0.00	0.00	1,300.00	1,300.00	0.00	01-2-02320-733-000	
01-2-02320-810-000	Executive Administration-Dues and Fees	650.00	7,727.00	0.00	12,000.00	4,273.00	69.57	01-2-02320-810-000	
01-2-02320-890-000	Executive Administration-Miscellaneous Expenditure	0.00	0.00	0.00	1,000.00	1,000.00	0.00	01-2-02320-890-000	
01-2-02330-317-000	Contracted Legal Services	4,730.00	18,214.13	0.00	35,000.00	16,785.87	60.30	01-2-02330-317-000	
01-2-02410-110-000	Office of the Principal-Salaries of Regular Employ	7,427.02	52,903.33	0.00	107,000.00	54,096.67	56.60	01-2-02410-110-000	

# Chase Revenue and Expenditure Report

Printed: 04/07/2022 12:13:56PM  
Chase County Schools

General 01									
Account Type	X	Expense							
Source of Revenue/Functi									
Account	Description	M.T.D. Activity	Y.T.D. Activity	Open Encumb.	Current Budget	Budget Balance	% of Budget	State Account Number	
01-2-02410-111-000	Office of the Principal-Salaries of Regular Employ	17,507.57	122,553.02	0.00	289,000.00	166,446.98	48.46	01-2-02410-111-000	
01-2-02410-122-000	Office of the Principal-Salaries of Temporary Empl	144.00	1,299.00	0.00	2,000.00	701.00	73.95	01-2-02410-122-000	
01-2-02410-210-000	Office of the Principal-Group Insurance for Non-In	2,243.36	15,687.36	0.00	31,000.00	15,312.64	57.84	01-2-02410-210-000	
01-2-02410-211-000	Office of the Principal-Group Insurance for Teache	2,046.81	14,351.48	0.00	45,000.00	30,648.52	36.44	01-2-02410-211-000	
01-2-02410-220-000	Office of the Principal-Social Security Payments f	558.60	3,980.11	0.00	7,500.00	3,519.89	60.75	01-2-02410-220-000	
01-2-02410-221-000	Office of the Principal-Social Security Payments f	1,312.47	9,187.32	0.00	21,500.00	12,312.68	48.84	01-2-02410-221-000	
01-2-02410-222-000	Office of the Principal-Social Security Payments f	11.02	99.37	0.00	125.00	25.63	90.51	01-2-02410-222-000	
01-2-02410-230-000	Office of the Principal-Retirement Contributions f	546.09	3,886.11	0.00	8,500.00	4,613.89	52.34	01-2-02410-230-000	
01-2-02410-231-000	Office of the Principal-Retirement Contributions f	1,287.30	9,011.10	0.00	23,075.00	14,063.90	44.63	01-2-02410-231-000	
01-2-02410-237-000	Office of the Principal-Increased Retirement Contr	629.59	4,428.92	0.00	8,000.00	3,571.08	63.30	01-2-02410-237-000	
01-2-02410-280-000	Office of the Principal-Health Benefits Paid for N	0.00	0.00	0.00	500.00	500.00	0.00	01-2-02410-280-000	
01-2-02410-281-000	00-Principal HRA	0.00	0.00	0.00	1,000.00	1,000.00	0.00	01-2-02410-281-000	
01-2-02410-580-000	Office of the Principal-Travel	0.00	700.58	0.00	50.00	(650.58)	1,401.16	01-2-02410-580-000	
01-2-02410-610-000	Office of the Principal-General Supplies	0.00	0.00	0.00	550.00	550.00	0.00	01-2-02410-610-000	
01-2-02410-735-000	Office of the Principal-Technology Software	0.00	0.00	0.00	2,000.00	2,000.00	0.00	01-2-02410-735-000	
01-2-02410-810-000	Office of the Principal-Dues and Fees	0.00	120.00	0.00	3,200.00	3,080.00	8.75	01-2-02410-810-000	
01-2-02490-111-000	School Administration - Other-Salaries of Regular	6,287.84	44,014.78	0.00	0.00	(44,014.78)	0.00	01-2-02490-111-000	
01-2-02490-211-000	School Administration - Other-Group Insurance for	1,732.48	12,143.94	0.00	0.00	(12,143.94)	0.00	01-2-02490-211-000	
01-2-02490-221-000	School Administration - Other-Social Security Paym	461.01	3,226.63	0.00	0.00	(3,226.63)	0.00	01-2-02490-221-000	
01-2-02490-231-000	School Administration - Other-Retirement Contribut	462.37	3,236.29	0.00	0.00	(3,236.29)	0.00	01-2-02490-231-000	
01-2-02490-237-000	School Administration-Increased Retirement Contrib	158.78	1,111.39	0.00	0.00	(1,111.39)	0.00	01-2-02490-237-000	

# Chase Revenue and Expenditure Report

Printed: 04/07/2022 12:13:56PM  
Chase County Schools

General 01								
Account Type	X	Expense						
Source of Revenue/Functi								
Account	Description	M.T.D. Activity	Y.T.D. Activity	Open Encumb.	Current Budget	Budget Balance	% of Budget	State Account Number
01-2-02510-315-000	Fiscal Services-Accounting/Auditing Services	0.00	12,020.00	0.00	16,000.00	3,980.00	75.13	01-2-02510-315-000
01-2-02510-320-000	Fiscal Services-Professional Educational Services	0.00	0.00	0.00	7,000.00	7,000.00	45.00	01-2-02510-320-000
01-2-02510-350-000	Fiscal Services-Technical Services	0.00	0.00	0.00	1,000.00	1,000.00	0.00	01-2-02510-350-000
01-2-02510-382-000	Fiscal Services-Distance Education & Telecommunica	6,353.23	13,318.56	0.00	12,000.00	(1,318.56)	113.79	01-2-02510-382-000
01-2-02510-440-000	Fiscal Services-Rentals	5,981.36	29,280.37	0.00	47,000.00	17,719.63	68.79	01-2-02510-440-000
01-2-02510-531-000	Fiscal Services-Postage	64.05	522.98	0.00	1,000.00	477.02	52.30	01-2-02510-531-000
01-2-02510-540-000	Fiscal Services-Advertising	1,113.11	4,417.36	0.00	10,000.00	5,582.64	44.17	01-2-02510-540-000
01-2-02510-610-000	Fiscal Services-General Supplies	511.19	2,431.63	0.00	10,000.00	7,568.37	24.40	01-2-02510-610-000
01-2-02510-626-000	Fiscal Services-Gasoline	0.00	341.19	0.00	2,000.00	1,658.81	360.22	01-2-02510-626-000
01-2-02510-810-000	Fiscal Services-Dues and Fees	40.00	773.89	0.00	8,000.00	7,226.11	19.76	01-2-02510-810-000
01-2-02510-890-000	Fiscal Services-Miscellaneous Expenditures	0.00	0.00	0.00	10,000.00	10,000.00	0.00	01-2-02510-890-000
01-2-02570-330-000	Personnel Services - Employee Training & Developme	0.00	250.00	0.00	1,000.00	750.00	25.00	01-2-02570-330-000
01-2-02610-110-000	Operation of Buildings-Salaries of Regular Employee	20,883.57	159,017.93	0.00	300,000.00	140,982.07	60.29	01-2-02610-110-000
01-2-02610-120-000	Operation of Buildings-Salaries of Temporary Empl	0.00	324.96	0.00	800.00	475.04	40.62	01-2-02610-120-000
01-2-02610-210-000	Operation of Buildings-Group Insurance for Non-Ins	9,487.64	66,620.72	0.00	122,000.00	55,379.28	62.37	01-2-02610-210-000
01-2-02610-220-000	Operation of Buildings-Social Security Payments fo	1,576.53	12,042.27	0.00	22,000.00	9,957.73	62.24	01-2-02610-220-000
01-2-02610-230-000	Operation of Buildings-Retirement Contributions fo	1,519.99	11,239.19	0.00	23,000.00	11,760.81	55.84	01-2-02610-230-000
01-2-02610-237-000	Operation of Buildings-Increased Retirement Contri	521.97	3,859.55	0.00	6,000.00	2,140.45	73.50	01-2-02610-237-000
01-2-02610-280-000	Operation of Buildings-Health Benefits Paid for No	0.00	450.00	0.00	1,200.00	750.00	37.50	01-2-02610-280-000
01-2-02610-382-000	Operation of Buildings-Distance Education & Teleco	0.00	0.00	0.00	5,000.00	5,000.00	0.00	01-2-02610-382-000
01-2-02610-410-000	Operation of Buildings-Utility Services	2,318.45	19,147.65	0.00	48,000.00	28,852.35	45.44	01-2-02610-410-000
01-2-02610-410-001	Operation of Buildings-Utility Services	0.00	0.00	0.00	10,000.00	10,000.00	0.00	01-2-02610-410-001
01-2-02610-410-002	Operation of Buildings-Utility Services	0.00	0.00	0.00	10,000.00	10,000.00	0.00	01-2-02610-410-002

# Chase Revenue and Expenditure Report

Printed: 04/07/2022 12:13:56PM  
Chase County Schools

General 01								
Account Type	X	Expense						
Source of Revenue/Functi								
Account	Description	M.T.D. Activity	Y.T.D. Activity	Open Encumb.	Current Budget	Budget Balance	% of Budget	State Account Number
01-2-02610-430-000	Operation of Buildings-Repairs and Maintenance Ser	245.13	19,114.48	0.00	50,000.00	30,885.52	38.84	01-2-02610-430-000
01-2-02610-431-001	Operation of Buildings-Repairs and Maintenance Ser	0.00	9,956.77	0.00	0.00	(9,956.77)	0.00	01-2-02610-431-001
01-2-02610-440-000	Operation of Buildings-Rentals	61.00	4,061.00	0.00	10,000.00	5,939.00	40.96	01-2-02610-440-000
01-2-02610-400-000	Other Purchased Property Service	1,130.69	42,898.36	0.00	150,000.00	107,101.64	29.35	01-2-02610-490-000
01-2-02610-580-000	Operation of Buildings-Travel	0.00	0.00	0.00	500.00	500.00	0.00	01-2-02610-580-000
01-2-02610-610-000	Operation of Buildings-General Supplies	4,897.19	32,594.78	1,157.06	100,000.00	66,248.16	38.22	01-2-02610-610-000
01-2-02610-610-001	Operation of Buildings-General Supplies	0.00	1,415.35	0.00	0.00	(1,415.35)	0.00	01-2-02610-610-001
01-2-02610-620-000	Other (Energy)	0.00	1,522.92	0.00	40,000.00	38,477.08	3.81	01-2-02610-620-000
01-2-02610-621-000	Operation of Buildings-Utility Energy Services	14,762.92	92,433.22	0.00	150,000.00	57,566.78	69.34	01-2-02610-621-000
01-2-02610-622-000	Operation of Buildings-Electricity	0.00	0.00	0.00	40,000.00	40,000.00	0.00	01-2-02610-622-000
01-2-02610-720-000	Operation of Buildings-Buildings	0.00	31,586.49	0.00	225,000.00	193,413.51	14.04	01-2-02610-720-000
01-2-02610-733-000	Operation of Buildings-Furniture and Fixtures	0.00	19,508.95	0.00	23,624.00	4,115.05	86.80	01-2-02610-733-000
01-2-02610-733-001	Operation of Buildings-Furniture and Fixtures	0.00	0.00	0.00	2,500.00	2,500.00	175.04	01-2-02610-733-001
01-2-02610-733-002	Operation of Buildings-Furniture and Fixtures	0.00	0.00	0.00	2,500.00	2,500.00	0.00	01-2-02610-733-002
01-2-02610-890-000	Operation of Buildings-Miscellaneous Expenditures	0.00	402.09	0.00	876.00	473.91	45.90	01-2-02610-890-000
01-2-02620-720-000	Maintenance of Buildings-Buildings	0.00	0.00	0.00	110,000.00	110,000.00	0.00	01-2-02620-720-000
01-2-02710-110-000	Vehicle Operation - Regular Education-Salaries of	25,529.84	179,907.73	0.00	252,000.00	72,092.27	81.98	01-2-02710-110-000
01-2-02710-120-000	Vehicle Operation - Regular Education-Salaries of	4,228.50	24,614.00	0.00	45,000.00	20,386.00	60.17	01-2-02710-120-000
01-2-02710-210-000	Vehicle Operation - Regular Education-Group Insura	1,145.78	7,828.23	0.00	18,200.00	10,371.77	49.33	01-2-02710-210-000
01-2-02710-220-000	Vehicle Operation - Regular Education-Social Secur	2,263.66	15,551.41	0.00	22,000.00	6,448.59	80.77	01-2-02710-220-000
01-2-02710-230-000	Vehicle Operation - Regular Education-Retirement C	1,737.32	11,843.16	0.00	18,500.00	6,656.84	73.54	01-2-02710-230-000
01-2-02710-237-000	Vehicle Operation - Increased Retirement Contribut	596.61	4,067.02	0.00	5,000.00	932.98	93.44	01-2-02710-237-000
01-2-02710-280-000	Vehicle Operation - Regular Education-Health Benef	0.00	450.00	0.00	750.00	300.00	60.00	01-2-02710-280-000

# Chase Revenue and Expenditure Report

Printed: 04/07/2022 12:13:56PM  
Chase County Schools

General 01									
Account Type	X	Expense							
Source of Revenue/Functi									
Account	Description	M.T.D. Activity	Y.T.D. Activity	Open Encumb.	Current Budget	Budget Balance	% of Budget	State Account Number	
01-2-02710-332-000	Vehicle Operation - Regular Education-Mileage Paid	0.00	0.00	0.00	50.00	50.00	0.00	01-2-02710-332-000	
01-2-02710-430-000	Vehicle Operation - Regular Education-Repairs and	0.00	4,715.80	(5.00)	40,000.00	35,289.20	12.38	01-2-02710-430-000	
01-2-02710-431-000	Vehicle Operation - Regular Education-Repairs and	0.00	25.00	0.00	0.00	(25.00)	0.00	01-2-02710-431-000	
01-2-02710-442-000	Vehicle Operation - Regular Education-Rentals of E	0.00	0.00	0.00	1,000.00	1,000.00	0.00	01-2-02710-442-000	
01-2-02710-580-000	Vehicle Operation - Regular Education-Travel	1,537.39	9,364.27	0.00	12,000.00	2,635.73	92.78	01-2-02710-580-000	
01-2-02710-610-000	Vehicle Operation - Regular Education-General Supp	270.86	4,520.64	0.00	9,000.00	4,479.36	61.79	01-2-02710-610-000	
01-2-02710-626-000	Vehicle Operation - Regular Education-Gasoline	402.24	24,778.86	1,878.82	75,000.00	48,342.32	38.05	01-2-02710-626-000	
01-2-02710-732-000	Vehicle Operation - Regular Education-Vehicles	0.00	0.00	0.00	105,125.00	105,125.00	0.00	01-2-02710-732-000	
01-2-02710-733-000	Vehicle Operation - Regular Education-Furniture an	0.00	3,718.26	0.00	0.00	(3,718.26)	0.00	01-2-02710-733-000	
01-2-02710-810-000	Vehicle Operation - Regular Education-Dues and Fee	0.00	1,035.40	0.00	1,000.00	(35.40)	115.99	01-2-02710-810-000	
01-2-02710-890-000	Vehicle Operation - Regular Education-Miscellaneous	150.00	744.24	0.00	500.00	(244.24)	148.85	01-2-02710-890-000	
01-2-02750-890-000	Pupil Trans-Misc	0.00	0.00	0.00	1,200.00	1,200.00	0.00	01-2-02710-890-000	
01-2-02712-110-000	Vehicle Operation - School Age SPED-Salaries of Re	2,154.05	13,903.35	0.00	8,500.00	(5,403.35)	189.79	01-2-02712-110-000	
01-2-02712-120-000	Vehicle Operation - School Age SPED-Salaries of Te	0.00	0.00	0.00	75.00	75.00	0.00	01-2-02712-120-000	
01-2-02712-210-000	Vehicle Operation - School Age SPED-Group Insuranc	286.53	2,050.09	0.00	900.00	(1,150.09)	258.85	01-2-02712-210-000	
01-2-02712-220-000	Vehicle Operation - School Age SPED-Social Securit	148.80	950.08	0.00	600.00	(350.08)	184.16	01-2-02712-220-000	
01-2-02712-230-000	Vehicle Operation - School Age SPED-Retirement Con	158.40	1,022.30	0.00	750.00	(272.30)	158.16	01-2-02712-230-000	
01-2-02712-237-000	Vehicle Operation - School Age SPED-Increased Retr	54.39	351.06	0.00	250.00	(101.06)	162.93	01-2-02712-237-000	
01-2-02712-280-000	Vehicle Operation - Schoo (HSA)	39.82	222.07	0.00	100.00	(122.07)	260.85	01-2-02712-280-000	
01-2-02712-626-000	Vehicle Operation - School Age SPED-Gasoline	0.00	211.12	0.00	500.00	288.88	60.91	01-2-02712-626-000	
01-2-02730-431-000	Vehicle Operation - Regular Education-Repairs and	3,519.83	17,021.71	1,664.41	0.00	(18,686.12)	0.00	01-2-02730-431-000	

# Chase Revenue and Expenditure Report

Printed: 04/07/2022 12:13:56PM  
Chase County Schools

General 01									
Account Type	X	Expense							
Source of Revenue/Functi									
Account	Description	M.T.D. Activity	Y.T.D. Activity	Open Encumb.	Current Budget	Budget Balance	% of Budget	State Account Number	
01-2-03535-810-000	High Ability Learners-Dues and Fees	0.00	392.00	0.00	0.00	(392.00)	0.00	01-2-03535-810-000	
01-2-06200-111-000	Federal Services - Title I, Part A ESSA Improving	3,726.04	26,082.28	0.00	101,450.00	75,367.72	29.27	01-2-06200-111-000	
01-2-06200-112-000	Federal Services - Title I, Part A ESSA Improving	0.00	0.00	0.00	5,000.00	5,000.00	0.00	01-2-06200-112-000	
01-2-06200-123-000	Federal Services - Title I, Part A ESSA Improving	0.00	0.00	0.00	3,000.00	3,000.00	0.00	01-2-06200-123-000	
01-2-06200-151-000	Federal Services - Title I, Part A ESSA Improving	0.00	0.00	0.00	3,000.00	3,000.00	0.00	01-2-06200-151-000	
01-2-06200-159-000	Federal Services - Title I, Part A ESSA Improving	80.00	80.00	0.00	3,000.00	2,920.00	2.67	01-2-06200-151-000	
01-2-06200-211-000	Federal Services - Title I, Part A ESSA Improving	9.46	66.22	0.00	40,000.00	39,933.78	0.19	01-2-06200-211-000	
01-2-06200-212-000	Title I - Para Salary Group Ins (LTD&Health)	0.00	0.00	0.00	2,000.00	2,000.00	0.00	01-2-06200-212-000	
01-2-06200-213-000	Federal Services - Title (BCB)	0.00	0.00	0.00	500.00	500.00	0.00	01-2-06200-213-000	
01-2-06200-221-000	Federal Services - Title I, Part A ESSA Improving	285.04	1,995.28	0.00	12,000.00	10,004.72	18.93	01-2-06200-221-000	
01-2-06200-222-000	Title I - Para Salary SS	0.00	0.00	0.00	2,000.00	2,000.00	0.00	01-2-06200-222-000	
01-2-06200-223-000	Federal Services - Title I, Part A ESSA Improving	0.00	0.00	0.00	1,000.00	1,000.00	0.00	01-2-06200-223-000	
01-2-06200-231-000	Federal Services - Title I, Part A ESSA Improving	273.97	1,917.79	0.00	12,000.00	10,082.21	18.20	01-2-06200-231-000	
01-2-06200-232-000	Title I - Para Salary NPERS	0.00	0.00	0.00	1,000.00	1,000.00	0.00	01-2-06200-232-000	
01-2-06200-233-000	Federal Services - Title I, Part A ESSA Improving	0.00	0.00	0.00	1,000.00	1,000.00	0.00	01-2-06200-233-000	
01-2-06200-237-000	Federal Services - Title (NPE)	94.08	658.56	0.00	2,000.00	1,341.44	37.49	01-2-06200-237-000	
01-2-06200-281-000	Federal Services - Title I, Part A ESSA Improving	0.00	0.00	0.00	4,000.00	4,000.00	0.00	01-2-06200-281-000	
01-2-06200-282-000	Title I - Para HRA	0.00	0.00	0.00	2,000.00	2,000.00	0.00	01-2-06200-282-000	
01-2-06200-610-000	Federal Services - Title I, Part A ESSA Improving	0.00	128.37	0.00	6,000.00	5,871.63	2.14	01-2-06200-610-000	
01-2-06200-890-000	Federal Services - Title I, Part A ESSA Improving	0.00	0.00	500.00	15,000.00	14,500.00	3.33	01-2-06200-890-000	
01-2-06404-591-000	Federal Services - IDEA Part B (611) Base Allocati	0.00	0.00	0.00	7,000.00	7,000.00	0.00	01-2-06404-591-000	
01-2-06406-591-000	Federal Services - IDEA Preschool (619) Base Alloc	0.00	0.00	0.00	8,000.00	8,000.00	0.00	01-2-06406-591-000	
01-2-06408-111-000	Federal Services - IDEA Enrollment/Poverty (611)-S	0.00	0.00	0.00	60,000.00	60,000.00	0.00	01-2-06408-111-000	

# Chase Revenue and Expenditure Report

Printed: 04/07/2022 12:13:56PM  
Chase County Schools

General 01								
Account Type	X	Expense						
Source of Revenue/Functi								
Account	Description	M.T.D. Activity	Y.T.D. Activity	Open Encumb.	Current Budget	Budget Balance	% of Budget	State Account Number
01-2-06408-211-000	Federal Services - IDEA Enrollment/Poverty (611)-S	0.00	0.00	0.00	15,000.00	15,000.00	0.00	01-2-06408-211-000
01-2-06408-591-000	Federal Services - IDEA Enrollment/Poverty (611)-S	0.00	0.00	0.00	65,000.00	65,000.00	0.00	01-2-06408-591-000
01-2-06408-610-000	Federal Services - IDEA Enrollment/Poverty (611)-G	1,209.10	1,209.10	1,070.00	0.00	(2,279.10)	0.00	01-2-06408-610-000
01-2-06410-110-000	Federal Services - IDEA Enrollment/Poverty (611)-S	0.00	0.00	0.00	6,000.00	6,000.00	0.00	01-2-06410-110-000
01-2-06412-320-000	Federal Services - IDEA Part B Proportionate Share	0.00	0.00	0.00	6,000.00	6,000.00	0.00	01-2-06412-320-000
01-2-06412-591-000	Federal Services - IDEA Part B Proportionate Share	0.00	0.00	0.00	6,000.00	6,000.00	0.00	01-2-06412-591-000
01-2-06700-650-001	Carl Perkins - Supplies - Technology Related	0.00	7,257.00	0.00	7,000.00	(257.00)	103.67	01-2-06700-650-001
01-2-06998-111-000	ESSER III-Salaries of Regular Employees Paid to Te	76,081.49	76,081.49	0.00	0.00	(76,081.49)	0.00	01-2-06998-111-000
01-2-06998-116-000	ESSER III-Salaries of Regular Employees Paid to Pr	5,514.00	5,514.00	0.00	0.00	(5,514.00)	0.00	01-2-06998-116-000
01-2-06998-211-000	ESSER III-Group Insurance for Teachers/Professiona	24,861.86	24,861.86	0.00	0.00	(24,861.86)	0.00	01-2-06998-211-000
01-2-06998-221-000	ESSER III-Social Security Payments for Teachers/Pr	5,860.92	5,860.92	0.00	0.00	(5,860.92)	0.00	01-2-06998-221-000
01-2-06998-226-000	ESSER III-Social Security Payments for Professiona	388.00	388.00	0.00	0.00	(388.00)	0.00	01-2-06998-226-000
01-2-06998-330-000	ESSER III-Employee Training & Developmental Servic	0.00	7,127.26	0.00	0.00	(7,127.26)	0.00	01-2-06998-330-000
01-2-06998-610-000	ESSER III-General Supplies (less than \$5,000 each)	7,032.00	60,803.50	0.00	550,000.00	489,196.50	11.06	01-2-06998-610-000
01-2-08000-000-000	Transfers (Outgoing)	0.00	0.00	0.00	30,648.00	30,648.00	0.00	01-2-08000-000-000
01-2-08000-913-000	Transfers (Outgoing)-Fund Transfers to Activities	0.00	0.00	0.00	250,000.00	250,000.00	0.00	01-2-08000-913-000
01-2-09000-000-000	Non-Program Expenditure	0.00	(13,341.63)	0.00	0.00	13,341.63	0.00	01-2-09000-000-000
<b>X Expense</b>		<b>681,049.31</b>	<b>4,862,838.79</b>	<b>133,968.78</b>	<b>10,536,751.00</b>	<b>5,539,943.43</b>	<b>53.64</b>	* Account Type
<b>01 General</b>		<b>(45,531.94)</b>	<b>(366,711.56)</b>	<b>133,968.78</b>	<b>1,757,122.00</b>	<b>1,989,864.78</b>	<b>24.03</b>	Fund

# Chase Revenue and Expenditure Report

Printed: 04/07/2022 12:13:56PM  
Chase County Schools

Depreciation 02								
Account Type	I	Revenue						
Source of Revenue/Functi								
Account	Description	M.T.D. Activity	Y.T.D. Activity	Open Encumb.	Current Budget	Budget Balance	% of Budget	State Account Number
<b>Revenue</b>								
02-1-01510-000-000	Interest	4.20	59.51	0.00	0.00	(59.51)	0.00	02-1-01510-000-000
02-1-05300-000-000	Proceeds from Disposal of Real or Personal Propert	0.00	11,772.00	0.00	0.00	(11,772.00)	0.00	02-1-05300-000-000
<b>I Revenue</b>		4.20	11,831.51	0.00	0.00	(11,831.51)	0.00	* Account Type
<b>Expense</b>								
02-2-02610-430-000	Operation of Buildings-Repairs and Maintenance Ser	0.00	7,872.67	0.00	0.00	(7,872.67)	0.00	02-2-02610-430-000
02-2-02620-720-000	Maintenance of Buildings-Buildings	0.00	58,353.06	0.00	0.00	(58,353.06)	0.00	02-2-02620-720-000
02-2-02620-733-000	Maintenance of Buildings-Furniture & Fixtures	0.00	14,951.36	0.00	0.00	(14,951.36)	0.00	02-2-02620-733-000
02-2-02710-732-000	Vehicle Operation - Regular Education-Vehicles	0.00	144,000.00	0.00	0.00	(144,000.00)	0.00	02-2-02710-732-000
<b>X Expense</b>		0.00	225,177.09	0.00	0.00	(225,177.09)	0.00	* Account Type
<b>02 Depreciation</b>		(4.20)	213,345.58	0.00	0.00	(213,345.58)	0.00	Fund

# Chase Revenue and Expenditure Report

Printed: 04/07/2022 12:13:56PM  
Chase County Schools

## Employee Benefit Fund 03

Account Type I Revenue  
Source of Revenue/Functi

Account	Description	M.T.D. Activity	Y.T.D. Activity	Open Encumb.	Current Budget	Budget Balance	% of Budget	State Account Number
<b>Revenue</b>								
03-1-01510-000-000	Interest Income	0.92	6.29	0.00	0.00	(6.29)	0.00	03-1-01510-000-000
	<b>I Revenue</b>	<u>0.92</u>	<u>6.29</u>	<u>0.00</u>	<u>0.00</u>	<u>(6.29)</u>	<u>0.00</u>	* Account Type
	<b>03 Employee Benefit Fund</b>	<u><u>0.92</u></u>	<u><u>6.29</u></u>	<u><u>0.00</u></u>	<u><u>0.00</u></u>	<u><u>(6.29)</u></u>	<u><u>0.00</u></u>	Fund

# Chase Revenue and Expenditure Report

Printed: 04/07/2022 12:13:56PM  
Chase County Schools

Activities 05								
Account Type	I	Revenue						
Source of Revenue/Functi								
Account	Description	M.T.D. Activity	Y.T.D. Activity	Open Encumb.	Current Budget	Budget Balance	% of Budget	State Account Number
<b>Revenue</b>								
05-1-01990-000-000	FBLA Receipts	969.87	6,430.52	0.00	0.00	(6,430.52)	0.00	05-1-01990-000-000
<b>Local Receipts</b>								
05-1-1510	Interest Income	44.45	2,639.88	0.00	0.00	(2,639.88)	0.00	05-1-1510-000-000
<b>1000</b>	<b>Local Receipts</b>	44.45	2,639.88	0.00	0.00	(2,639.88)	0.00	** Source of Revenue/Function
	<b>I Revenue</b>	1,014.32	9,070.40	0.00	0.00	(9,070.40)	0.00	* Account Type
<b>Expense</b>								
05-2-09000-950-000	Non-Program Expenditures - Special Items	0.00	18,243.21	0.00	0.00	(18,243.21)	0.00	05-2-09000-950-000
05-2-03200-890-000	Enterprise Operations	0.00	133.52	0.00	0.00	(133.52)	0.00	05-2-3200-890-000
	<b>X Expense</b>	0.00	18,376.73	0.00	0.00	(18,376.73)	0.00	* Account Type
<b>05</b>	<b>Activities</b>	(1,014.32)	9,306.33	0.00	0.00	(9,306.33)	0.00	Fund

# Chase Revenue and Expenditure Report

Printed: 04/07/2022 12:13:56PM  
Chase County Schools

School Nutrition 06								
Account Type	I	Revenue						
Source of Revenue/Functi								
Account	Description	M.T.D. Activity	Y.T.D. Activity	Open Encumb.	Current Budget	Budget Balance	% of Budget	State Account Number
<b>Revenue</b>								
06-1-01510-000-000	Interest	1.70	10.90	0.00	0.00	(10.90)	0.00	06-1-01510-000-000
06-1-01611-000-000	Daily Sales?School Lunch Program	10,252.63	76,225.61	0.00	0.00	(76,225.61)	0.00	06-1-01611-000-000
06-1-03150-000-000	State Reimbursement (of Nutrition Programs)	39,459.50	237,790.53	0.00	0.00	(237,790.53)	0.00	06-1-03150-000-000
<b>I Revenue</b>		<b>49,713.83</b>	<b>314,027.04</b>	<b>0.00</b>	<b>0.00</b>	<b>(314,027.04)</b>	<b>0.00</b>	* Account Type
<b>Expense</b>								
06-2-01100-352-000	Data Processing	128.00	742.20	0.00	0.00	(742.20)	0.00	06-2-03100-352-000
06-2-03100-570-000	Food Service Management	38,549.78	249,430.27	0.00	0.00	(249,430.27)	0.00	06-2-03100-570-000
06-2-03100-610-000	Food Service Supplies	126.66	478.42	0.00	0.00	(478.42)	0.00	06-2-03100-610-000
06-2-03100-733-000	Food Service Furniture and Fixtures	0.00	62,309.23	0.00	0.00	(62,309.23)	0.00	06-2-03100-733-000
<b>X Expense</b>		<b>38,804.44</b>	<b>312,960.12</b>	<b>0.00</b>	<b>0.00</b>	<b>(312,960.12)</b>	<b>0.00</b>	* Account Type
<b>06 School Nutrition</b>		<b>(10,909.39)</b>	<b>(1,066.92)</b>	<b>0.00</b>	<b>0.00</b>	<b>1,066.92</b>	<b>0.00</b>	Fund

# Chase Revenue and Expenditure Report

Printed: 04/07/2022 12:13:56PM  
Chase County Schools

Bond 07									
Account Type	I	Revenue							
Source of Revenue/Functi									
Account	Description		M.T.D. Activity	Y.T.D. Activity	Open Encumb.	Current Budget	Budget Balance	% of Budget	State Account Number
<b>Revenue</b>									
07-1-01510-000-000	Interest		18.11	134.02	0.00	0.00	(134.02)	0.00	07-1-01510-000-000
	<b>I Revenue</b>		<u>18.11</u>	<u>134.02</u>	<u>0.00</u>	<u>0.00</u>	<u>(134.02)</u>	<u>0.00</u>	* Account Type
<b>Expense</b>									
07-2-05000-831-000	Debt Service-Redemption of Principa		0.00	30,000.00	0.00	0.00	(30,000.00)	0.00	07-2-05000-831-000
07-2-05000-832-000	Debt Service-Interest on Long-Term Debt		0.00	2,483.75	0.00	0.00	(2,483.75)	0.00	07-2-05000-832-000
	<b>X Expense</b>		<u>0.00</u>	<u>32,483.75</u>	<u>0.00</u>	<u>0.00</u>	<u>(32,483.75)</u>	<u>0.00</u>	* Account Type
	<b>07 Bond</b>		<u>(18.11)</u>	<u>32,349.73</u>	<u>0.00</u>	<u>0.00</u>	<u>(32,349.73)</u>	<u>0.00</u>	Fund

# Chase Revenue and Expenditure Report

Printed: 04/07/2022 12:13:56PM  
Chase County Schools

Special Building 08								
Account Type	I	Revenue						
Source of Revenue/Functi								
Account	Description	M.T.D. Activity	Y.T.D. Activity	Open Encumb.	Current Budget	Budget Balance	% of Budget	State Account Number
<b>Revenue</b>								
08-1-01100-000-000	Taxes Levied/Assessed by the School District	24,291.14	437,980.56	0.00	0.00	(437,980.56)	0.00	08-1-01100-000-000
08-1-01115-000-000	Carline Taxes	0.00	42.03	0.00	0.00	(42.03)	0.00	08-1-01115-000-000
08-1-01510-000-000	Interest	7.78	42.22	0.00	0.00	(42.22)	0.00	08-1-01510-000-000
08-1-03130-000-000	Homestead Exemption	1,078.43	1,078.43	0.00	0.00	(1,078.43)	0.00	08-1-03130-000-000
08-1-03131-000-000	Property Tax Credit	46,262.57	49,537.48	0.00	0.00	(49,537.48)	0.00	08-1-03131-000-000
08-1-03180-000-000	Pro-Rate Motor Vehicle	0.00	694.47	0.00	0.00	(694.47)	0.00	08-1-03180-000-000
<b>Local Receipts</b>								
08-1-1140-000-000	Interest & Penalties	84.22	1,878.16	0.00	0.00	(1,878.16)	0.00	08-1-1140-000-000
<b>1000</b>	<b>Local Receipts</b>	<b>84.22</b>	<b>1,878.16</b>	<b>0.00</b>	<b>0.00</b>	<b>(1,878.16)</b>	<b>0.00</b>	** Source of Revenue/Function
<b>I</b>	<b>Revenue</b>	<b>71,724.14</b>	<b>491,253.35</b>	<b>0.00</b>	<b>0.00</b>	<b>(491,253.35)</b>	<b>0.00</b>	* Account Type
<b>Expense</b>								
08-2-05000-831-000	Debt Service-Redemption of Principa	0.00	266,998.74	0.00	0.00	(266,998.74)	0.00	08-2-05000-831-000
08-2-05000-832-000	Debt Service-Interest on Long-Term Debt	0.00	24,711.12	0.00	0.00	(24,711.12)	0.00	08-2-05000-832-000
<b>X</b>	<b>Expense</b>	<b>0.00</b>	<b>291,709.86</b>	<b>0.00</b>	<b>0.00</b>	<b>(291,709.86)</b>	<b>0.00</b>	* Account Type
<b>08</b>	<b>Special Building</b>	<b>(71,724.14)</b>	<b>(199,543.49)</b>	<b>0.00</b>	<b>0.00</b>	<b>199,543.49</b>	<b>0.00</b>	Fund

# Chase Revenue and Expenditure Report

Printed: 04/07/2022 12:13:56PM  
Chase County Schools

Qualified Capital Purpose Undertaking 09								
Account Type	I	Revenue						
Source of Revenue/Functi								
Account	Description	M.T.D. Activity	Y.T.D. Activity	Open Encumb.	Current Budget	Budget Balance	% of Budget	State Account Number
<b>Revenue</b>								
09-1-01100-000-000	Taxes Levied/Assessed by the School District	0.00	5,010.34	0.00	0.00	(5,010.34)	0.00	09-1-01100-000-000
09-1-01510-000-000	Interest	16.06	199.89	0.00	0.00	(199.89)	0.00	09-1-01510-000-000
09-1-03180-000-000	Pro-Rate Motor Vehicle	0.00	37.25	0.00	0.00	(37.25)	0.00	09-1-03180-000-000
<b>Local Receipts</b>								
09-1-1140-000-000	Interest & Penalties	0.00	80.28	0.00	0.00	(80.28)	0.00	09-1-1140-000-000
<b>1000</b>	<b>Local Receipts</b>	0.00	80.28	0.00	0.00	(80.28)	0.00	** Source of Revenue/Function
<b>I</b>	<b>Revenue</b>	16.06	5,327.76	0.00	0.00	(5,327.76)	0.00	* Account Type
<b>Expense</b>								
09-2-05000-831-000	Debt Service-Redemption of Principa	0.00	290,000.00	0.00	0.00	(290,000.00)	0.00	09-2-05000-831-000
09-2-05000-832-000	Debt Service-Interest on Long-Term Debt	0.00	6,272.50	0.00	0.00	(6,272.50)	0.00	09-2-05000-832-000
<b>X</b>	<b>Expense</b>	0.00	296,272.50	0.00	0.00	(296,272.50)	0.00	* Account Type
<b>09</b>	<b>Qualified Capital Purpose Undertaking</b>	(16.06)	290,944.74	0.00	0.00	(290,944.74)	0.00	Fund

# Chase Revenue and Expenditure Report

Printed: 04/07/2022 12:13:56PM  
Chase County Schools

Student Fee 12									
Account Type		Revenue							
Source of Revenue/Functi									
Account	Description	M.T.D. Activity	Y.T.D. Activity	Open Encumb.	Current Budget	Budget Balance	% of Budget	State Account Number	
<b>Revenue</b>									
12-1-01510-000-000	Interest	0.35	2.46	0.00	0.00	(2.46)	0.00	12-1-01510-000-000	
	<b>I Revenue</b>	<u>0.35</u>	<u>2.46</u>	<u>0.00</u>	<u>0.00</u>	<u>(2.46)</u>	<u>0.00</u>	* Account Type	
<b>Expense</b>									
12-2-01100-890-000	Regular Instruction-Miscellaneous Expenditures	0.00	2.00	0.00	0.00	(2.00)	0.00	12-2-01100-890-000	
	<b>X Expense</b>	<u>0.00</u>	<u>2.00</u>	<u>0.00</u>	<u>0.00</u>	<u>(2.00)</u>	<u>0.00</u>	* Account Type	
	<b>12 Student Fee</b>	<u>(0.35)</u>	<u>(0.46)</u>	<u>0.00</u>	<u>0.00</u>	<u>0.46</u>	<u>0.00</u>	Fund	
	<b>Report Total:</b>	<u><u>129,219.43</u></u>	<u><u>21,382.34</u></u>	<u><u>(133,968.78)</u></u>	<u><u>(1,757,122.00)</u></u>	<u><u>(1,644,535.56)</u></u>	<u><u>43.69</u></u>		

<b>April 2022 US Bank Report</b>	
Amazon-Splat the Cat Level 1 reading series	\$ 79.84
Imperial Super Foods-SPED groceries	\$ 8.22
OTC-4th grade retractable pens 48 pk	\$ 28.98
Imperial Superfoods-FCS groceries	\$ 55.30
Joann Stores-Fabric FCS	\$ 21.66
Imperial Super Foods-FCS groceries	\$ 34.17
Hills Family Foods-FCS groceries	\$ 14.23
Amazon-The Last 5th Grade series books	\$ 170.23
Amazon-plastic cups	\$ 35.99
Amazon-mints nurse office	\$ 24.48
Amazon-faucet sprayer	\$ 6.89
McDonalds-bus drivers meal (costume pickup)	\$ 16.90
Hills Family Foods-SPED groceries	\$ 64.05
Amazon-Splat the Cat series	\$ 97.84
orange recorder belts	\$ 8.90
yellow recorder belts	\$ 13.36
emerald green recorder belts	\$ 13.36
regal purple recorder belts	\$ 8.90
dragon blue recorder belts	\$ 8.90
royal red recorder belts	\$ 8.90
castle brown recorder belts	\$ 4.45
master black recorder belts	\$ 4.45
shipping	\$ 14.36
white recorder belts	\$ 13.37
Hills Family Foods-FCS Groceries	\$ 26.65
Imperial Super Foods- SPED groceries	\$ 112.80
Restroom Direct-Drinking fountain (water cooler)	\$ 997.03
Imperial Super Foods-FCS groceries	\$ 190.70
95 Percent Group-Phonics Booster Bundle	\$ 128.70
Owens True Value-Pressure Cook seal	\$ 14.90
Hills Family Foods-FCS groceries	\$ 34.54
Blick Art-watercolor paper/mixed media paper	\$ 78.65
Blick Art-watercolor paper/mixed media paper	\$ 39.16
AdaptedMind-SPED math	\$ 30.00
Imperial Super Foods- FCS groceries	\$ 18.69
Recognition Unlimited-Retirement clocks	\$ 326.80
SheetMusicDirect-Sheet music	\$ 10.63
Hal Leonard Corp-Sheet Music	\$ 13.77
UNC Online Career-Colorado Career Fair	\$ 271.00
TPT-Kindergarten Craft Book	\$ 6.71
TPT-Volume/Surface doodle notes	\$ 4.47
TPT-3rd grade math work	\$ 37.28
Cloudconvert-English PDF converter	\$ 9.00
NASSP-NHS honor cords	\$ 61.25
Activity Expenses	\$ 1,394.75
<b>US Bank Total</b>	<b>\$ 4,565.21</b>

Vendor_Name	Description	Amount
21st Century Equipment	Repair parts	\$ 161.91
A parts	IC Heater Temp, Control Actuator Detent repair	\$ 100.95
A T & T	LD Services March	\$ 78.84
Adams Lumber Co	Merchant coupling, 2x3 black nipple	\$ 22.48
Adams Lumber Co	plastic glass for kitchen salad bar	\$ 34.53
Adams Lumber Co	Garden tiller rental	\$ 35.00
Adams Lumber Co	Cement, parts for repairing drain	\$ 61.32
Adams Lumber Co	Metal folding sawhorse	\$ 85.98
Adams Lumber Co	foamboard for 3D landscaping	\$ 110.62
Allo Communications	Telephone services	\$ 490.04
AGiRepair, Inc.	IPad 6 repair	\$ 89.00
Amazon Capital Services	Promotions & Discounts	\$ (227.12)
Amazon Capital Services	Promotions & Discounts	\$ (150.00)
Amazon Capital Services	Credit for external DVD drive	\$ (27.66)
Amazon Capital Services	Paper Mate pink erasers 144 count	\$ 4.02
Amazon Capital Services	Felt Fabric Sheets assorted colors	\$ 4.98
Amazon Capital Services	Spanish Stickers	\$ 5.22
Amazon Capital Services	Fairy Garden bird bath	\$ 5.48
Amazon Capital Services	Miniature Fairy Garden kit	\$ 6.19
Amazon Capital Services	Helping hand faucet sprayer	\$ 6.89
Amazon Capital Services	Paper clips (central office supplies)	\$ 6.89
Amazon Capital Services	100 Zip Ties	\$ 7.49
Amazon Capital Services	Rubbermaid silverware tray organizer	\$ 7.85
Amazon Capital Services	Scotch Desktop Tape Dispenser	\$ 7.96
Amazon Capital Services	Timers set of 2	\$ 7.97
Amazon Capital Services	The Last Fifth Grade of Emerson Elementary	\$ 7.99
Amazon Capital Services	Mountain Dog	\$ 7.99
Amazon Capital Services	Spanish Stickers	\$ 7.99
Amazon Capital Services	0.7 mechanical pencil lead	\$ 8.44
Amazon Capital Services	Railway Train Model kit	\$ 8.49
Amazon Capital Services	Glitter foam sheet sparkles self adhesive sticker	\$ 8.97
Amazon Capital Services	HDMI cable	\$ 8.99
Amazon Capital Services	Flexible faucet spray aerator	\$ 9.00
Amazon Capital Services	5 Tab dividers/tags	\$ 9.14
Amazon Capital Services	Scissors (large)	\$ 9.99
Amazon Capital Services	Model Tree Train kit	\$ 10.99
Amazon Capital Services	Fairy Village model set	\$ 11.99
Amazon Capital Services	40 Pieces St. Patricks Day decor	\$ 12.55
Amazon Capital Services	Navajo	\$ 12.67
Amazon Capital Services	Brick Building dollhouse model kit	\$ 12.99
Amazon Capital Services	Magnetic clips, 24 pieces	\$ 12.99
Amazon Capital Services	Mixed Model Tree Train Scenery kit	\$ 13.50
Amazon Capital Services	Foam Sheet Crafts	\$ 13.99
Amazon Capital Services	Markerboard Erasers	\$ 13.99
Amazon Capital Services	12 piece color coded kitchen knife set	\$ 14.59
Amazon Capital Services	Elmers Glue (1 gallon)	\$ 14.98

Amazon Capital Services	Plastic Portion Cups With Lids	\$ 14.99
Amazon Capital Services	Flower Vegetation/Building model set	\$ 14.99
Amazon Capital Services	Flower Cluster model	\$ 14.99
Amazon Capital Services	Garden yard Lawn home model kit	\$ 14.99
Amazon Capital Services	Poetry for Kids- William Shakespeare	\$ 15.68
Amazon Capital Services	Garden accessories, landscape kit	\$ 16.99
Amazon Capital Services	HDMI Cable	\$ 17.99
Amazon Capital Services	The Navajo	\$ 18.73
Amazon Capital Services	Card Shuffler 2 deck (SPED)	\$ 18.99
Amazon Capital Services	Stackable Letter Trays	\$ 19.12
Amazon Capital Services	Sparkle Star Stickers	\$ 19.23
Amazon Capital Services	Silicone cooking kitchen tongs kit	\$ 19.91
Amazon Capital Services	HDMI Adapter	\$ 19.98
Amazon Capital Services	Playing Card holder tray rack	\$ 19.99
Amazon Capital Services	Dixon pencils Box of 144	\$ 20.30
Amazon Capital Services	Scissors bulk set	\$ 24.99
Amazon Capital Services	Tradition of Excellence Book 1-Trombone	\$ 25.90
Amazon Capital Services	Tradition of Excellence-Baritone	\$ 25.90
Amazon Capital Services	Silicone Spatulas	\$ 25.97
Amazon Capital Services	Classroom desk storage bins (7)	\$ 25.99
Amazon Capital Services	Flexible spray faucet supplies	\$ 26.32
Amazon Capital Services	The Gold Rush	\$ 27.80
Amazon Capital Services	Regular Instruction-Books and Periodical	\$ 27.80
Amazon Capital Services	A-Star Triangle Holder	\$ 29.24
Amazon Capital Services	Value Poster boards 22`x28 (50 sheets)	\$ 29.99
Amazon Capital Services	Seeking Freedom	\$ 31.80
Amazon Capital Services	Server Rack Cable management cover	\$ 31.91
Amazon Capital Services	3 Hole punch 2 pack	\$ 32.78
Amazon Capital Services	The Oregon Trail	\$ 33.00
Amazon Capital Services	Desk pencil holders (25 count)	\$ 34.99
Amazon Capital Services	Into the West	\$ 35.08
Amazon Capital Services	Tradition of Excellence Book-Clarinet	\$ 38.85
Amazon Capital Services	Server Rack Shelf	\$ 39.71
Amazon Capital Services	Apple Lightening Digital AV Adapter	\$ 41.51
Amazon Capital Services	Sharpie permanent markers black	\$ 42.22
Amazon Capital Services	Tequila Rustic Sculpture lawn ornament kit	\$ 44.99
Amazon Capital Services	No Dogs Allowed Sign for track	\$ 45.90
Amazon Capital Services	Classroom desk storage bins (14)	\$ 47.99
Amazon Capital Services	Crayola Classpack	\$ 49.98
Amazon Capital Services	4 Tier Letter Tray	\$ 51.80
Amazon Capital Services	Rackmount Surge Protector	\$ 63.42
Amazon Capital Services	Post it notes easel pad/chart paper	\$ 67.28
Amazon Capital Services	Wall Mount Single Pocket File Organizer	\$ 75.48
Amazon Capital Services	Wall mount pocket file organizer	\$ 75.48
Amazon Capital Services	Laptop replacement battery for MacBook	\$ 79.98
Amazon Capital Services	Rack Mount Cable Server shelf	\$ 82.61
Amazon Capital Services	Electric indoor grill (SPED)	\$ 83.11

Amazon Capital Services	Robert`s Rules of Order 12th Edition books	\$ 90.90
Amazon Capital Services	Cymbal Boom Stand/stand combo	\$ 95.95
Amazon Capital Services	Water Leak Detector shutoff valve	\$ 109.99
Amazon Capital Services	IT Network server	\$ 159.99
Amazon Capital Services	Open Frame Server Network relay rack	\$ 162.50
Amazon Capital Services	Smart UPS Battery back up	\$ 248.71
Amazon Capital Services	Shipping/handling	\$ 265.48
Amazon Capital Services	Magnetic LED Lightbulb kit	\$ 279.98
Amazon Capital Services	LED Wraparound Office Light	\$ 299.90
Amazon Capital Services	Business Prime Membership fee (annual)	\$ 499.00
Amazon Capital Services	Commercial DEF transfer pump kit	\$ 545.78
American Time	Tariff fee	\$ 0.92
American Time	Shipping	\$ 12.95
American Time	Wire Guard for Cameras	\$ 83.90
Avant Assessment LLC	Seal of Biliteracy Test Licenses	\$ 199.00
Black Hills Energy	505 E 9th gas usage 2/4-3/8	\$ 149.19
Bomgaars	Proties 50 pk	\$ 24.99
Brico Pest Control	regular monthly service	\$ 50.00
Brophy Electric	Bulb less 20% discount	\$ 153.60
Brophy Electric	1/4HP 1 PH 1075RPM Motor	\$ 245.24
Bruce Curtis	Reimbursement for a Vehicle jump start 4/4/22	\$ 65.00
Cambridge Schools	Music Contest Large, small and solos	\$ 188.00
Carolina Biological Suppl	freight/handling	\$ 12.07
Carolina Biological Suppl	Cupric Sulfate, Pentahydrate, Fine Crystal, R	\$ 29.15
Central Power Systems & Services	Output shaft/freight	\$ 23.89
City Of Imperial	Water Meter East Parking Lot-2/22-3/22	\$ 21.95
City Of Imperial	New Track water usage 2/22-3/22	\$ 33.65
City Of Imperial	New Track electric 2/22-3/22	\$ 38.20
City Of Imperial	New Bus Barn water/sewer 2/22-3/22	\$ 42.90
City Of Imperial	New Football Field Lights 2/23-3/22	\$ 62.00
City Of Imperial	505 East 9th (Pool) water/sewer 2/22-3/22	\$ 184.55
City Of Imperial	505 East 9th (Pool) Electric 2/22-3/22	\$ 280.02
City Of Imperial	520 East 9th water usage 2/23-3/22	\$ 377.60
City Of Imperial	New Bus Barn electric 2/22-3/22	\$ 489.72
City Of Imperial	520 E 9t St water/sewer 2/28-3/25	\$ 2,005.00
City Of Imperial	520 E 9th St electric 2/28-3/25	\$ 10,614.66
Cornhusker Cleaning Systems	Spray tip/wash brush	\$ 36.62
Cornhusker Cleaning Systems	Special Cleaner (1 gal.)	\$ 40.52
Cornhusker Internationl Trucks, Inc.	Vehicle repairs	\$ 61.73
Cornhusker Internationl Trucks, Inc.	Vehicle repair parts	\$ 135.99
Cornhusker Internationl Trucks, Inc.	Engine repairs (under warranty) Headlamp	\$ 177.68
Culligan	softener salt, replace pilot valve	\$ 343.95
DataShield	Shredding services	\$ 61.00
Decker Equipment	Desks, chairs	\$ 4,375.98
E D Enterprises	repair part	\$ 18.35
Eakes Office Solutions	CARD STOCK	\$ 16.99
Eakes Office Solutions	Cloth (microfiber) -12	\$ 27.84

Eakes Office Solutions	vacuum bags	\$ 64.55
Eakes Office Solutions	Gloves (6)	\$ 68.16
Eakes Office Solutions	Trash bags	\$ 84.69
Eakes Office Solutions	Baby wipes	\$ 104.96
Eakes Office Solutions	Kitchen supplies (FCS)	\$ 153.35
Eakes Office Solutions	Staples for copier MX-SCX1 (qty: 2)	\$ 196.00
Eakes Office Solutions	Tissues,bleach, trash bags, bathroom supplies	\$ 312.77
Eakes Office Solutions	Neutra-Rinse, towels, glass cleaner, tissues,	\$ 349.38
ESU #16	Audiology/Program Supervision	\$ 282.38
ESU Coordinating Council	Movie Licensing-1000	\$ 356.00
Fastenal	Parts for vehicle repair	\$ 129.98
Felker, Rex	Reimbursement for moving blankets	\$ 9.98
Frank Paxton	Freight fee	\$ 75.00
Frank Paxton	150 Board Ft. of Red Oak	\$ 577.20
Frenchman Valley Co-op	ADMN Fuel usage 2/1-2/28	\$ 69.97
Frenchman Valley Co-op	SPED fuel 2/1-2/28	\$ 93.42
Frenchman Valley Co-op	tire mount & disposal	\$ 240.00
Frenchman Valley Co-op	Pramitol spray	\$ 350.00
Frenchman Valley Co-op	437.1 gallon #1 fuel bus lot tank	\$ 1,883.41
Frenchman Valley Co-op	Other Pupil Fuel 2/1-2/28	\$ 6,793.16
Hegwood Trenching Inc	supplies for kitchen drain	\$ 60.75
HireRight Solutions, Inc.	Background screening services	\$ 308.06
Hometown Leasing	PMT 3 of copier lease	\$ 2,990.68
Ideal Linen Supply Inc	Uniforms/shop towels	\$ 45.14
Ideal Linen Supply Inc	shop towels, uniform	\$ 61.66
Ideal Linen Supply Inc	Shop towels, uniforms	\$ 61.66
Ideal Linen Supply Inc	Shop towels/uniform	\$ 61.66
Ideal Linen Supply Inc	Mats	\$ 202.78
Ideal Linen Supply Inc	Mats	\$ 202.78
Ideal Linen Supply Inc	Mats	\$ 202.78
Imperial NAPA	vehicle parts/repair 3/3-3/30	\$ 623.19
iTurity	iPad repairs	\$ 267.00
J W Pepper	Music	\$ 140.72
Jimmie L.Pankonin	Jetter usage, cleaned drain in Kitchen	\$ 275.00
KSB School Law	Contracted Legal Services 3/03-3/29	\$ 2,892.47
Lions Club-Imperial	Reimbursement (card was accidentally used)	\$ 38.23
Lisa Goodman	Deaf Education 2/25-3/30	\$ 81.34
Marriott Hotels and Resort	Hotel Room (AC)	\$ 146.02
McCook Gazette	Legal Ad	\$ 26.00
McGraw-Hill	Shipping & Handling	\$ 260.95
McGraw-Hill	Civics & Economics Student Textbooks	\$ 991.65
McGraw-Hill	Civics & Economics 7 year Digital Bundle	\$ 2,679.00
McGraw-Hill	Civics & Economics 7 year Digital Subscriptio	\$ 2,808.90
Miss Nebraska Scholarship Program	MNSP personal appearance fee	\$ 150.00
Myrtle Health	CDL exam	\$ 50.00
NASB	Board Leadership Online Survey fee	\$ 350.00
Nebraska Central Equipment	Cable, park,brake, handle, release assy	\$ 121.89

Nebraska Central Equipment	Pedal, brake, park assy, shipping	\$ 180.02
Nebraska Central Equipment	Stop Arm elec.	\$ 440.76
Occupational Therapy	OT services 2/1-3/29/22	\$ 4,786.56
Owens True Value	Bus Barn supplies	\$ 85.63
Owens True Value	Finish brushes	\$ 89.94
Owens True Value	Clear Coat - Gallon	\$ 131.98
Owens True Value	Maintenance supplies	\$ 152.08
Pivot Electric	Remodel Box with Tabs	\$ 10.74
Pivot Electric	remodel box w/tabs,port plate, stage lamp, etc.	\$ 764.33
Platinum Customs, LLC	Piped Polo for new staff	\$ 24.46
Platinum Customs, LLC	Piped Staff polo	\$ 24.46
PresenceLearning	Speech Service-March 2022	\$ 9,464.00
Prime Communications, Inc.	Genetec software install / upgrade	\$ 1,386.41
Prior`s New Generation Fabrics, LLC	Thread, snap fasteners snap setter (FCS)	\$ 10.60
Prior`s New Generation Fabrics, LLC	5 Card Stops (FCS)	\$ 13.45
Prior`s New Generation Fabrics, LLC	Thread-FCS	\$ 14.10
Prior`s New Generation Fabrics, LLC	Materials for FCS	\$ 39.87
Prior`s New Generation Fabrics, LLC	Needles FCS	\$ 47.85
Prior`s New Generation Fabrics, LLC	fabric for FCS	\$ 64.00
Prior`s New Generation Fabrics, LLC	FCS flannel and material	\$ 77.39
Rainbow Promise Preschool	SPED Tuition (3 students)	\$ 260.00
Region V	Leadership Day (8)	\$ 160.00
Rural Rehabilitation Services, LLC	Speech services	\$ 1,017.85
Sadlier School	Vocabulary/Grammar workshop	\$ 1,005.41
Sarah Morse	Reimbursement CDL license	\$ 59.50
Sheryl Curtis	Reimbursement for FCS groceries	\$ 4.94
Smartwave	ZoneDirector 1200 single AP license upgrade	\$ 277.80
Specialized Data Systems, Inc	Software Support	\$ 3,150.00
St. Joseph Institute For The Deaf	I Hear therapy srvcs. (2/7,9,14,16,22,23,28)	\$ 490.00
Stanek Fire Protection	Fire Control System service	\$ 157.00
Sterling Computers	Google OS Console Mgmt	\$ 1,512.10
Sterling Computers	Google OS Console Mgmt	\$ 2,199.43
Sterling Computers	HP Chromebook 11.6" G8 model	\$ 9,931.11
TPRS Books	Shipping	\$ 15.00
TPRS Books	La Casa Dividida - Level 3 Readers	\$ 48.00
TPRS Books	La Casa Dividida Teacher`s Guide Download	\$ 49.00
TPRS Books	La Guerra Sucia - Level 3 Readers	\$ 54.00
US Bank	Activity/General Expenses	\$ 4,565.21
Van Diest Supply Company	Ice Melt 49 bags	\$ 531.65
Viaero Wireless	Hot spots (3)	\$ 58.60
Viaero Wireless	Cellphone (Maintenance/Transportation)	\$ 107.20
Wilkins Architecture Design Planning LLC	contracted billing amount due	\$ 300.00
	<b>April General Fund Expenditures</b>	<b>\$ 98,335.77</b>
	<b>April General Payroll Expenditures</b>	<b>\$ 572,626.23</b>
	<b>April Total General Fund Expenditures</b>	<b>\$ 670,962.00</b>

CCS GENERAL FUND	Incorrect deposit into lunch (computer repair)	\$ 90.00
Lunchtime Solutions	Meals-March 2022	\$ 39,478.22
	<b>April Total Lunch Fund Expenditures</b>	<b>\$ 39,568.22</b>

# Chase County Schools Activity Report

**April 11, 2022-** Troy Hauxwell, Activities Director Chase County Schools

**HS Golf Meet at Enders on Monday, April 11th 9:00 AM.** We moved the High School Golf meet at Enders up this year due to the Easter weekend. We have 7 teams competing and 53 golfers participating this year.

**HS Track Meet on Tuesday April 19th** we will run this meet online, using athletic.net. The start time will be 9:00 AM for Field Events and Running Events beginning at 10:30 AM. Teams include Chase County, Dundy County Stratton, Garden County, Hershey, Ogallala, and Perkins County. Jayson Bishop of Perkins County will be running the meet on a Fully Automatic Timing System.

**District Music Competition on Friday April 22nd** here at Chase County. Mr. Rushing Mrs. Strand and Sand O'Neil have been preparing for this event.

**Chase County JH Track Meet on Thursday April 28th** starting at 9:00 AM.

**SPVA HS Track Meet at Perkins County April 29th** starting at 11:00 AM.

**SPVA JH Track Meet at Chase County on May 5th** starting at 9:00 AM.

**State Track and Field** schedule is complete on the NSAA website. A & B will compete Wednesday and Thursday this year, followed by C & D on Friday and Saturday May 20th and 21st.

**Transportation-** We have been busy covering routes. It has been extremely busy with all the activities going on state conferences going on the last two weeks.

**NSAA Activities Manuals and Proposals-** On April 8 at the NSAA Board Meeting and Representative Assembly they voted on 29 different Activities Manual and Proposals and 7 different Constitution and Bylaw Proposals. A couple that stood out was Class C Baseball passed 6 Districts and the Board passed it 8-0. Boys and Girls co-practice Exemption Failed Board 4-4. If you have a girls program girls would still have to wrestle girls in practice.

If you have any questions about my report, please email me at [thauxwell@chasecountyschools.org](mailto:thauxwell@chasecountyschools.org)



# Chase County

April, 2022

Sunday	Monday	Tuesday	Wednesday	Thursday	Friday	Saturday
						1 <b>10:00am</b> Track-JV/Varsity <b>Ogallala vs. Multiple Schools</b>
3 <b>6:00am</b> FCCLA @ Lincoln	4 FCCLA @ Lincoln <b>6:30pm</b> National Honors Society @ Auditorium	5 SPVA FCCLA @ Lincoln <b>9:00am</b> Golf-B/Varsity <b>Dundy County Stratton</b>	6 FFA @ Lincoln	7 FFA @ Lincoln <del>Track-JH (Postponed)</del>	8 6th-8th Music Contest @ Cambridge 12th Grade @ McCook College FFA @ Lincoln	9 FFA @ Lincoln <b>9:00am</b> Track-JV/Varsity <b>Cambridge vs. Multiple Schools</b>
10 FBLA @ Kearney <b>9:00am</b> Golf-B/Varsity <b>Chase County vs. Multiple Schools</b> <b>3:30pm</b> Track-JH <b>Perkins County</b> <b>6:00pm</b> Chase County School Board Meeting @ Board Room	11 FBLA @ Kearney <b>7:30am</b> Monthly Meeting @ Auditorium	12 FBLA @ Kearney <b>7:30am</b> Monthly Meeting @ Auditorium	13 FBLA @ Kearney	14 <b>9:00am</b> Track-JV/Varsity <b>Sutherland vs. Multiple Schools</b> <b>9:00am</b> Track-JH <b>Perkins County vs. Multiple Schools</b> <b>9:00am</b> Golf-B/Varsity <b>Medicine Valley vs. Multiple Schools</b> <b>9:00am</b> Golf-B/Varsity <b>Bridgeport Public Schools</b>	15 Easter Break	16
17 Easter Break	18 <b>9:00am</b> Golf-B/Varsity <b>Perkins County</b> <b>9:00am</b> Track-JV/Varsity <b>Chase County vs. Multiple Schools</b>	19 <b>9:00am</b> Track-JH <b>Sutherland vs. Multiple Schools</b>	20 <b>7:15am</b> Elementary	21 Teacher In-Service SPVA District Music	22 <b>9:00am</b> Track-JV/Varsity <b>Hershey vs. Multiple Schools</b>	23
24 <b>12:00pm</b> Track-JV/Varsity <b>McCook vs. Multiple Schools</b>	25 <b>6:00pm</b> TeamMates @ CCS Commons Area	26	27 <b>9:00am</b> Track-JH <b>Chase County vs. Multiple Schools</b> <b>4:00pm</b> ELL/PAC @ Cafeteria	28 SPVA <b>10:00am</b> Golf-B/Varsity <b>Bridgeport Public Schools</b> <b>11:00am</b> Track-JV/Varsity <b>Perkins County vs. Multiple Schools</b>	29 <b>6:00pm</b> FFA @ Auditorium	30

## May, 2022

Sunday	Monday	Tuesday	Wednesday	Thursday	Friday	Saturday					
1	<b>8:00am</b> Track-JV/Varsity <b>North Platte vs. Multiple Schools</b> <b>7:30pm</b> Spring Play	2	<b>2:00pm</b> Track-JV/Varsity <b>Sutherland vs. Multiple Schools</b>	3	4	<b>8:00am</b> Golf-B/Varsity <b>North Platte St. Pats</b> <b>9:00am</b> Track-JH TBA <b>7:30pm</b> Spring Play	5	<b>12:30pm</b> Track-JV/Varsity <b>Dundy County Stratton vs. Multiple Schools</b>	6	7	
8	<b>9:00am</b> Band	9	<b>7:30am</b> Monthly Meeting <b>6:00pm</b> Chase County School Board Meeting @ Board Room	10	11	<b>TBD</b> Track-JV/Varsity <b>TBA vs. Multiple Schools</b> <b>9:00am</b> Golf-B/Varsity <b>Ogallala</b>	12	Seniors Last Day <b>7:00pm</b> Show Choir @ Auditorium	13	<b>4:00pm</b> Band @ Auditorium <b>4:30pm</b> Graduation	14
15	<b>9:00am</b> Golf-B/Varsity <b>Bridgeport Public Schools</b> <b>6:30pm</b> K-5 Vocal @ Longhorn Gym	16	17	<b>12:00pm-3:00pm</b> Elementary @ Chase County Schools	18	<b>12:00pm-3:00pm</b> Elementary @ Chase County Schools	19	<b>TBD</b> Track-JV/Varsity <b>Omaha Burke vs. Multiple Schools</b> <b>8:00am-1:30pm</b> Last Day of School	20	<b>TBD</b> Track-JV/Varsity <b>Omaha Burke vs. Multiple Schools</b>	21
22	Teacher In-Service	23	<b>TBD</b> Golf-B/Varsity <b>Kearney</b> Teacher In-Service	24	<b>TBD</b> Golf-B/Varsity <b>Kearney</b>	25	FFA	26	FFA	27	28
29		30		31							

## Mrs. Odens' April, 2022 School Board Report

Lindsey Teply and I attended a Title Peer Review Meeting today in Trenton. We will travel there again tomorrow for an Early Childhood Meeting.

The Region V Elementary Principals group is again sponsoring the Fifth Grade Leadership Day. It will be held in Hershey on Friday, May 6th. Team Concepts from Kearney will be leading the day. Fifth grade students were voted on by their teachers to attend this day. We will be sending the following students to the Leadership Day: Sawyer Sauder, Addison Hauxwell, Zoey Kelley, Truman Olsen, Mia Fries, Taya Stromberger, Dayana Balderrama, and Bennett Kuenning. I will be sponsoring the trip to Hershey.

Kindergarten Round-Up is Friday, April 29th. We are anticipating about 53 students to attend that day. They will be here from 8:30-11:00. The teachers and I will meet with the teachers from the area preschools after Round-Up. Everyone involved will share what they have learned about the students to help me with making class lists for next year.

Kindergarten Graduation will be held on Friday, May 13th in the Longhorn Gym again this year.

K-5th grade spring concert is May 16th.

K-4 Field Day is scheduled for May 18th.

**7-12 Principal's Report**  
**Mr. Sorensen**  
**Apr 11, 2022**

**Testing Season is winding down.**

**Jrs. have completed the NSCAS ACT**

**Soph. have taken their first ACT**

**Freshmen will take Pre ACT Tuesday, April 12th**

**7th and 8th grade have completed NSCAS ELA, Math and 8th Science**

**\*Thank you to Mrs. Lambert and teachers for their hard work and dedication. We have seen growth with our 7th and 8th grade students in ELA and Math.**

**March 23rd - Mr. Herbert organized a career/college fair for grades 10-12. It was well attended by area businesses and 2 yr and 4 yr educational institutions.**

**March 30th - UNL Extension coordinated a career activity entitled Connect the Dots. Students in grades 10 & 11 participated. Students were introduced to the possible careers they may be interested in due to a survey that they had to take for this day. Professionals from Imperial were there to take part in this activity.**

**Congratulations to our students and sponsors that have or are participating in the FCCLA, FFA and FBLA state conferences. Chase County was and is being well represented at these conferences. I appreciate the time and dedication our students and sponsors have getting ready for these events.**

**The Attendance Diversion after school program continues to be a positive for the students that are in the program. Some of our students have encountered bumps in the road but are learning the importance of attending school (and being on time) and what accountability is like. The teachers that have been tutoring after school are: Emily Jones, Karli Hale, Joni Kirwan, Abby Almanza and Bruce Curtis.**

# Board Report

## April 11, 2022

Adam Lambert  
Superintendent of Schools

---

### Academics & Students

- Juniors prepared for and took the ACT as their state test
- State testing continues for grades 3-8. Once all of the tests are complete and the data collected, we will share the results with the board.
- Held a pre-proposal meeting for 2 food service programs interested in serving Chase County Schools lunch program. LSI and OPAA will both provide final bids by early May.
- Continue to try to recruit teachers. We currently have 7-12 ELL and Title opening. Contracts are due for current staff by April 15th.
- '22-'23 master schedule is projected to be completed by the beginning of May. Students will register for classes on April 21st.
- Shrek the musical was put on by the music department. The kids did a really nice job and the show was very entertaining.
- Talked to the city council concerning the 9th and Broadway crossing. I asked them to consider the installation of a Rapid Flashing Beacon. They requested some more information and I will work on getting that information for them.
- Brayon represented our school well at state speech. Parli Pro and Marketing team won state and got a bid to nationals. Track and golf are off and running and doing well.
- Met with the curriculum committee to discuss and review H.S. science curriculum that will be presented this evening.

## **Building & Grounds**

- Jeff Einspahr and I submitted our annual technology plan to NDE.
- Met with the technology committee to discuss the upgrading of teacher computers.
- Dallas worked on getting bids to install new carpet in our middle school and high school main hallways.
- Dallas also worked on getting bids for the foundation work for the visitors crows nest project that our industrial tech class will construc.

## **Budget & Finance**

- We currently have 13% savings after 8 months of bills and payroll
- Account Balances as of 4/11/2022
  - General Fund Balance \$3,027,868
  - Depreciation Fund Balance \$494,426
  - Lunch Fund Balance \$163,861
  - Special Building Fund Balance \$969,992
  - QCPUF Balance \$134,626
  - Bond Balance \$150,588



Mrs. April Lambert  
Curriculum Director  
Chase County Schools  
PO Box 577  
Imperial, NE 69033-0577  
United States

Quote Number: 185010-1  
Quote Creation Date: 03-29-2022  
Quote Expiration Date: 09-30-2022  
Quote Release: 1

Chase County Schools Chemistry and Physical Science 9-12  
Price Quote Summary

Solution	Base Amount	Free Amount	Total
Chemistry	\$ 3,302.00	\$ 167.50	\$ 3,302.00
Pearson Physical Science	\$ 2,526.00	\$ 128.50	\$ 2,526.00
<b>Solution Subtotal</b>	<b>\$ 5,828.00</b>	<b>\$ 296.00</b>	<b>\$ 5,828.00</b>
<b>Shipping &amp; Handling</b>			<b>\$ 466.24</b>
<b>Total</b>			<b>\$ 6,294.24</b>

Price Quote Detail

ISBN	Description	Price	Free Qty	Charged Qty	Free Amount	Total Charged
<b>Chemistry</b>						
<b>Savvas Chemistry ©2017</b>						
9781323205907	CHEMISTRY 2017 STUDENT EDITION GRADE 10/11	\$95.00	0	29	\$0.00	\$2,755.00
9781323213537	CHEMISTRY 2017 STUDENT EDITION PLUS DIGITAL COURSEWARE 1-YEAR STUDENT LICENSE	\$97.00	0	1	\$0.00	\$97.00
9780132525886	CHEMISTRY 2012 GUIDED READING AND STUDY WORKBOOK GRADE 11	\$15.00	0	30	\$0.00	\$450.00
9781323205914	CHEMISTRY 2017 TEACHERS EDITION (HARD COVER) GRADE 11	\$134.50	1	0	\$134.50	\$0.00
9780132525893	CHEMISTRY 2012 GUIDED READING AND STUDY WORKBOOK TEACHERS GUIDE GRADE 11	\$33.00	1	0	\$33.00	\$0.00
<b>Savvas Chemistry ©2017 Subtotal</b>					<b>\$ 167.50</b>	<b>\$ 3,302.00</b>

Chase County Schools

ISBN	Description	Price	Free Qty	Charged Qty	Free Amount	Total Charged
<b>Chemistry Subtotal</b>					<b>\$ 167.50</b>	<b>\$ 3,302.00</b>
<b>Pearson Physical Science</b>						
<b>Physical Science: Concepts in Action (2011)</b>						
9780133172119	HIGH SCHOOL PHYSICAL SCIENCE 2011 EARTH AND SPACE STUDENT EDITION (HARDCOVER) GRADE 9/10	\$101.00	0	24	\$0.00	\$2,424.00
9781418346478	HIGH SCHOOL PHYSICAL SCIENCE 2011 EARTH AND SPACE STUDENT EDITION + DIGITAL COURSEWARE 3-YEAR LICENSE GRADE 9/12 REALIZE	\$102.00	0	1	\$0.00	\$102.00
9780133172126	HIGH SCHOOL PHYSICAL SCIENCE 2011 EARTH AND SPACE TEACHER EDITION (HARDCOVER) GRADE 9/10	\$128.50	1	0	\$128.50	\$0.00
<b>Physical Science: Concepts in Action (2011) Subtotal</b>					<b>\$ 128.50</b>	<b>\$ 2,526.00</b>
<b>Pearson Physical Science Subtotal</b>					<b>\$ 128.50</b>	<b>\$ 2,526.00</b>
<b>Solution Subtotal</b>					<b>\$ 296.00</b>	<b>\$ 5,828.00</b>
<b>Shipping and Handling</b>						<b>\$ 466.24</b>
<b>Total</b>						<b>\$ 6,294.24</b>



# Quote

Inquiries: PASCO scientific  
 Customer Service  
 800-772-8700  
[custserv@pasco.com](mailto:custserv@pasco.com)

Quote Number	
QT122801	
Quote Date	Page
29-Mar-2022	1 of 2
Expire Date	Payment Terms
28-May-2022	NET 30

Billing Address	00006006	Shipping Address	6006-01
Chase Cty Schs		Attn: April Lambert	
Accounts Payable		Chase Cty Schs	
PO Box 577		520 E 9th Street	
520 E 9th St		Imperial, NE 69033	
Imperial, NE 69033		United States	
United States		Email: <a href="mailto:alambert@chasecountyschools.org">alambert@chasecountyschools.org</a>	
		Incoterms: 2020 DAP Imperial, United States	

LN	Item	Description	Qty	UM	Price	Extended Price
1	ST-2997	Greenhouse Kit	3	EA	\$ 549.00	\$ 1,647.00
	<u>Includes:</u>					
	ME-6667	Eco Chamber	1			
	PS-3232	Control Node	1			
	ST-2998-KIT	Greenhouse Kit W/O CTN & ECO CHAMBER	1			
	PS-3322	Greenhouse Sensor	1			
	PS-3324	Power Output Board	1			
	PS-3347	PASCO Grow Light	1			
	PS-3348	Greenhouse Accessory Kit	1			
	PS-6206	USB Fan	1			
	SE-6208	USB Water Pump	1			
2	ST-7840	PASCObot S&C KIT	3	EA	\$ 479.00	\$ 1,437.00
	<u>Includes:</u>					
	PS-3232	Control Node	1			
	ST-7841	PASCObot S&C Kit w/o CTN	1			



# Quote

Quote Number	
QT122801	
Quote Date	Page
29-Mar-2022	2 of 2
Expire Date	Payment Terms
28-May-2022	NET 30

---

Subtotal:	\$	3,084.00
Shipping and Handling	\$	22.00
Tax:	\$	0.00
Total:	\$	3,106.00

## Forms of Payment

**Purchase Orders:** PASCO accepts purchase orders from recognized public and private educational institutions. Terms are net 30 days from date of shipment for approved accounts and must be paid by cash, check, or ACH. Partial shipments are invoiced separately and are payable in 30 days. Late payments are subject to 1.5% per month service charge after 30 days.

**Credit Cards:** PASCO accepts MASTERCARD, VISA, American Express and Discover for payments made at time of shipment. PASCO does not accept credit card payments after net terms have been extended.



# Quote

Inquiries: PASCO scientific  
 Customer Service  
 800-772-8700  
[custserv@pasco.com](mailto:custserv@pasco.com)

Quote Number	
QT122892	
Quote Date	Page
4-Apr-2022	1 of 2
Expire Date	Payment Terms
3-Jun-2022	NET 30

Billing Address	00006006	Shipping Address	6006-01
-----------------	----------	------------------	---------

Chase Cty Schs  
 Accounts Payable  
 PO Box 577  
 520 E 9th St  
 Imperial, NE 69033  
 United States

Attn: April Lambert  
 Chase Cty Schs  
 520 E 9th Street  
 Imperial, NE 69033  
 United States  
 Email: [alambert@chasecountyschools.org](mailto:alambert@chasecountyschools.org)

Incoterms: 2020 DAP Imperial, United States

LN	Item	Description	Qty	Price	Disc %	Net Price	Extended Price
1	EP-6323	Student Textbook EP3	10	\$ 89.00		\$ 89.00	\$ 890.00
2	EP-6323-EB7	Student eBook Acc EP3 7Y	10	\$ 134.00		\$ 134.00	\$ 1,340.00
3	EP-6324-EB7	Teacher Resou Acc EP3 7Y	1	\$ 1,400.00	20.00	\$ 1,120.00	\$ 1,120.00
4	PA-1100A	PASCO Academy Physics	1	\$ 549.00	100.00	\$ 0.00	\$ 0.00
5	PS-2400-DIG	SPARKvue Site License Digital Download	1	\$ 249.00	100.00	\$ 0.00	\$ 0.00
6	EP-6490A	Comprehensive Physics Kit EP3	2	\$ 2,199.00		\$ 2,199.00	\$ 4,398.00
	<u>Includes:</u>						
	EM-3534	Wireless Current Sns Mod		1			
	EM-3536-Kit	Modular Circuits EP3		1			
	EP-3558-GTR	Optics Component Set EP3		1			
	EP-3560	WI Light Source EP3		1			
	EP-3562	Forces Accessories EP3		1			
	EP-3572	Tripod Stand, EP3		2			
	EP-3573	Tripod Track Bracket EP3		1			
	EP-3576-GTR	Forces & Motion Set, EP3		1			
	ME-1241	Smart Cart (Blue)		1			
	ME-6757A	Cart Mass (set of 2)		1			
	ME-8971	Dyn Track End Stop 2 Pk		1			
	ME-9448B	Super Pulley with Clamp		1			
	ME-9495A	Angle Indicator		1			

10101 Foothills Blvd., Roseville, CA 95747-7100 USA

[www.pasco.com](http://www.pasco.com) | Phone: 800-772-8700 or 916-786-3800 | Fax: 916-786-7565 | Email: [custserv@pasco.com](mailto:custserv@pasco.com) or [support@pasco.com](mailto:support@pasco.com)



# Quote

Quote Number	
QT122892	
Quote Date	Page
4-Apr-2022	2 of 2
Expire Date	Payment Terms
3-Jun-2022	NET 30

LN	Item	Description	Qty	Price	Disc %	Net Price	Extended Price	
6	EP-6490A	Comprehensive Physics Kit EP3	----- Continued from previous page-----					
	ME-9807	Friction Block -- IDS		1				
	EP-3577-GTR	Simple Machines Eng Kit		1				
	EP-3578-GTR	Oscil/Waves/Sound Set EP3		1				
	EP-3583	Crossrail for Tripod Std EP3		1				
	ME-1240	Smart Cart (Red)		1				
	ME-6825B	Mini Launcher		1				
	ME-8736	45 cm Stnless Steel Rod		1				
	ME-8972	Dyn Track Feet (Pair)		1				
	ME-8995	Table Clamp		1				
	ME-9493	1.2m Starter Dyn Track		1				
	PS-3211	Wireless Voltage Sensor		1				

Subtotal: \$ 7,748.00

Shipping and Handling \$ 308.00

Tax: \$ 0.00

Total: \$ 8,056.00

## Forms of Payment

**Purchase Orders:** PASCO accepts purchase orders from recognized public and private educational institutions.

Terms are net 30 days from date of shipment for approved accounts and must be paid by cash, check, or ACH. Partial shipments are invoiced separately and are payable in 30 days. Late payments are subject to 1.5% per month service charge after 30 days.

**Credit Cards:** PASCO accepts MASTERCARD, VISA, American Express and Discover for payments made at time of shipment.

PASCO does not accept credit card payments after net terms have been extended.



Because learning changes everything.\*

**QUOTE PREPARED FOR:**

Chase Co School  
520 E 9TH ST  
IMPERIAL, NE 69033-3136  
ACCOUNT NUMBER: 329993

**SUBSCRIPTION/DIGITAL CONTACT:**

April Lambert  
alambert@chasecountyschools.org  
(308) 882-4304

**CONTACT:**

April Lambert  
alambert@chasecountyschools.org  
(308) 882-4304

**SALES REP INFORMATION:**

Jenner Poppe  
jenner.poppe@mheducation.com

Section Summary	Value of All Materials	Free Materials	Product Subtotal
INSPIRE BIOLOGY © 2020	\$2,470.35	(\$422.10)	\$2,048.25
INSPIRE EARTH SCIENCE © 2020	\$2,470.35	(\$422.10)	\$2,048.25
Welsh's, Holes Essential's Anatomy & Physiology, ©2021, 2e	\$2,851.41	(\$261.66)	\$2,589.75
<b>PRODUCT TOTAL*</b>	<b>\$7,792.11</b>	<b>(\$1,105.86)</b>	<b>\$6,686.25</b>
<b>ESTIMATED S&amp;H**</b>			\$534.90
<b>ESTIMATED TAX**</b>			\$0.00
<b>GRAND TOTAL*</b>			<b>\$7,221.15</b>

\* Price firm for 45 days from quote date. Price quote must be attached to school purchase order to receive the quoted price and free materials.

\*\*Shipping and handling charges shown are only estimates. Actual shipping and handling charges will be applied at time of order. Taxes shown are only estimates. If applicable, actual tax charges will be applied at time of order.

Comments:

**PLEASE INCLUDE THIS PROPOSAL WITH YOUR PURCHASE ORDER**

**SEND ORDER TO:**

McGraw Hill LLC | PO Box 182605 | Columbus, OH 43218-2605  
Email: orders\_mhe@mheducation.com | Phone: 1-800-338-3987 | Fax: 1-800-953-8691

QUOTE DATE: 04/04/2022  
QUOTE NUMBER: AKING-04042022-008

ACCOUNT NAME: Chase Co School  
ACCOUNT #: 329993

EXPIRATION DATE: 05/19/2022  
PAGE #: 1



Because learning changes everything.\*

Product Description	ISBN	Qty	Unit Price	Free Materials	Line Subtotal
<b>INSPIRE BIOLOGY © 2020</b>					
INSPIRE SCIENCE BIOLOGY STUDENT EDITION	978-0-02-145262-0	25	\$81.93	\$0.00	\$2,048.25
<b>Teacher Materials</b>					
INSPIRE SCIENCE BIOLOGY GRADES 9-12 TEACHER EDITION	978-0-07-688434-6	1	\$189.00	\$189.00	*Free Materials
INSPIRE SCIENCE BIOLOGY GRADES 9-12 ONLINE TEACHER EDITION 7 YEAR SUBSCRIPTION	978-0-07-688707-1	1	\$233.10	\$233.10	*Free Materials
Teacher Materials Subtotal:				\$422.10	\$0.00
<b>INSPIRE BIOLOGY © 2020 Subtotal:</b>				<b>\$422.10</b>	<b>\$2,048.25</b>
<b>INSPIRE EARTH SCIENCE © 2020</b>					
INSPIRE SCIENCE EARTH STUDENT EDITION	978-0-02-145261-3	25	\$81.93	\$0.00	\$2,048.25
<b>Teacher Materials</b>					
INSPIRE SCIENCE EARTH GRADES 9-12 TEACHER EDITION	978-0-07-688465-0	1	\$189.00	\$189.00	*Free Materials
INSPIRE SCIENCE EARTH GRADES 9-12 ONLINE TEACHER EDITION 7 YEAR SUBSCRIPTION	978-0-07-692385-4	1	\$233.10	\$233.10	*Free Materials
Teacher Materials Subtotal:				\$422.10	\$0.00
<b>INSPIRE EARTH SCIENCE © 2020 Subtotal:</b>				<b>\$422.10</b>	<b>\$2,048.25</b>
<b>Welsh's, Holes Essential's Anatomy &amp; Physiology, ©2021, 2e</b>					
WELSH HOLES ESSNTLS HUM ANAT PHYSYLGY HS EDITION 2021 2E STD STDT WAPR 7YR SUB	978-0-07-904103-6	15	\$172.65	\$0.00	\$2,589.75
WELSH HOLES ESSNTLS OF ANTMY AND PHYSIO 2021 2E ONLN TE WAPR 7YR SUBSC	978-0-07-685916-0	1	\$261.66	\$261.66	*Free Materials
<b>Welsh's, Holes Essential's Anatomy &amp; Physiology, ©2021, 2e Subtotal:</b>				<b>\$261.66</b>	<b>\$2,589.75</b>

PLEASE INCLUDE THIS PROPOSAL WITH YOUR PURCHASE ORDER

SEND ORDER TO:

McGraw Hill LLC | PO Box 182605 | Columbus, OH 43218-2605  
 Email: orders\_mhe@mheducation.com | Phone: 1-800-338-3987 | Fax: 1-800-953-8691

QUOTE DATE: 04/04/2022

ACCOUNT NAME: Chase Co School

EXPIRATION DATE: 05/19/2022

QUOTE NUMBER: AKING-04042022-008

ACCOUNT #: 329993

PAGE #: 2



Because learning changes everything.®

**QUOTE PREPARED FOR:**

Chase Co School  
520 E 9TH ST  
IMPERIAL, NE 69033-3138  
ACCOUNT NUMBER: 329993

**CONTACT:**

April Lambert  
alambert@chasecountyschools.org  
(308) 882-4304

VALUE OF ALL MATERIALS	\$7,792.11
FREE MATERIALS	(\$1,105.86)
<b>PRODUCT TOTAL*</b>	<b>\$6,686.25</b>
ESTIMATED SHIPPING & HANDLING**	\$534.90
ESTIMATED TAX**	\$0.00
<b>GRAND TOTAL</b>	<b>\$7,221.15</b>

**SUBSCRIPTION/DIGITAL CONTACT:**

April Lambert  
alambert@chasecountyschools.org  
(308) 882-4304

Comments:

\* Price firm for 45 days from quote date. Price quote must be attached to school purchase order to receive the quoted price and free materials.

\*\*Shipping and handling charges shown are only estimates. Actual shipping and handling charges will be applied at time of order. Taxes shown are only estimates. If applicable, actual tax charges will be applied at time of order.

**Terms of Service:**

By placing an order for digital products (the 'Subscribed Materials'), the entity that this price quote has been prepared for ('Subscriber') agrees to be bound by the Terms of Service and any specific provisions required by Subscriber's state law, each located in the applicable links below. Subject to Subscriber's payment of the fees set out above, McGraw Hill LLC hereby grants to Subscriber a non-exclusive, non-transferable license to allow only the number of Authorized Users that corresponds to the quantity of Subscribed Materials set forth above to access and use the Subscribed Materials under the terms described in the Terms of Service and any specific provisions required by Subscriber's state law, each located in the applicable links below. The subscription term for the Subscribed Materials shall be as set forth in the Product Description above. If no subscription term is specified, the initial term shall be one (1) year from the date of this price quote (the 'Initial Subscription Term'), and thereafter the Subscriber shall renew for additional one (1) year terms (each a 'Subscription Renewal Term'), provided MHE has chosen to renew the subscription and has sent an invoice for such Subscription Renewal Term to Subscriber.

Terms Of Service

Provisions required by Subscriber State law

ATTENTION: In our effort to protect our customer's data, we will no longer store credit card data in any manner within in our system. Therefore, as of April 30, 2016 we will no longer accept credit card orders via email, fax, or mail/package delivery. Credit card orders may be placed over the phone by calling the number listed above or via our websites by visiting [www.mheducation.com](http://www.mheducation.com) (or [www.mhecoast2coast.com](http://www.mhecoast2coast.com)).

School Purchase Order Number: \_\_\_\_\_

\_\_\_\_\_  
Name of School Official (Please Print)

\_\_\_\_\_  
Signature of School Official

**PLEASE INCLUDE THIS PROPOSAL WITH YOUR PURCHASE ORDER**

SEND ORDER TO:

McGraw Hill LLC | PO Box 182605 | Columbus, OH 43218-2605  
Email: [orders\\_mhe@mheducation.com](mailto:orders_mhe@mheducation.com) | Phone: 1-800-338-3987 | Fax: 1-800-953-8691

QUOTE DATE: 04/04/2022  
QUOTE NUMBER: AKING-04042022-008

ACCOUNT NAME: Chase Co School  
ACCOUNT #: 329993

EXPIRATION DATE: 05/19/2022  
PAGE #: 3



# Apple Inc. Education Price Quote

**Customer:** Jeff Einspahr  
CHASE COUNTY SCHOOLS  
Phone: 3088824304  
email:  
jeinspahr@chasecountyschools.org

**Apple Inc:** Gram Swindler  
5505 W Parmer Lane  
Bldg 7  
Austin, TX 78727  
Phone: +1-512-6748155  
email: gswindler@apple.com

**Apple Quote:** 2211078499

**Quote Date:** Thursday, March 31, 2022

**Quote Valid Until:** Saturday, April 30, 2022

## Quote Comments:

Please reference Apple Quote number on your Purchase Order.

Row #	Details & Comments	Qty	Unit List Price	Extended List Price
1	<b>13-inch MacBook Air: Apple M1 chip with 8-core CPU and 7-core GPU, 128GB – Space Gray (Packaged in a 5-pack)</b> Part Number: MGNF3LL/A <b>Configuration:</b> <ul style="list-style-type: none"><li>065-C99J Apple M1 chip with 8-core CPU, 7-core GPU and 16-core Neural Engine</li><li>065-C99M 8GB unified memory</li><li>065-C99P 128GB SSD storage</li><li>065-C9CK Touch ID</li><li>065-C9CJ Two Thunderbolt / USB 4 ports</li><li>065-C9CH Force Touch trackpad</li><li>065-C9CL Retina display with True Tone</li><li>065-C171 None</li><li>065-C172 None</li><li>065-C9DG Backlit Magic Keyboard – US English</li><li>065-C9DN Accessory Kit</li></ul>	25	\$779.00	\$19,475.00
<b>Edu List Price Total</b>				<b>\$19,475.00</b>
– Additional Tax				\$0.00
– Estimated Tax				\$0.00
<b>Extended Total Price*</b>				<b>\$19,475.00</b>

\*In most cases Extended Total Price does not include Sales Tax

\*If applicable, eWaste/Recycling Fees are included.  
Standard shipping is complimentary

Complete your order by one of the following:

- This document has been created for you as Apple Quote ID 2211078499. Please contact your institution's Authorized Purchaser to submit the above quote online. For account access or new account registration, go to <https://ecommerce.apple.com>. Simply go to the Quote area of your Apple Education Online Store, click on it and convert to an order.
  - For registration assistance, call 1.800.800.2775
- If you are unable to submit your order online, please send a copy of this Quote with your Purchase Order via email to [institutionorders@apple.com](mailto:institutionorders@apple.com). **Be sure to reference the Apple Quote number on the PO to ensure expedited processing of your order.**
  - For more information, go to provision C below, for details.

THIS IS A QUOTE FOR THE SALE OF PRODUCTS OR SERVICES. YOUR USE OF THIS QUOTE IS SUBJECT TO THE FOLLOWING PROVISIONS WHICH CAN CHANGE ON SUBSEQUENT QUOTES:

- ANY ORDER THAT YOU PLACE IN RESPONSE TO THIS QUOTE WILL BE GOVERNED BY (1) ANY CONTRACT IN EFFECT BETWEEN APPLE INC. ("APPLE") AND YOU AT THE TIME YOU PLACE THE ORDER OR (2), IF YOU DO NOT HAVE A CONTRACT IN EFFECT WITH APPLE, CONTACT [contracts@apple.com](mailto:contracts@apple.com).
- ALL SALES ARE FINAL. PLEASE REVIEW RETURN POLICY BELOW IF YOU HAVE ANY QUESTIONS. IF YOU USE YOUR INSTITUTION'S PURCHASE ORDER FORM TO PLACE AN ORDER IN RESPONSE TO THIS QUOTE, APPLE REJECTS ANY TERMS SET OUT ON THE PURCHASE ORDER THAT ARE INCONSISTENT WITH OR IN ADDITION TO THE TERMS OF YOUR AGREEMENT WITH APPLE.
- YOUR ORDER MUST REFER SPECIFICALLY TO THIS QUOTE AND IS SUBJECT TO APPLE'S ACCEPTANCE. ALL FORMAL PURCHASE ORDERS SUBMITTED BY EMAIL MUST SHOW THE INFORMATION BELOW:
  - APPLE INC. AS THE VENDOR
  - BILL-TO NAME AND ADDRESS FOR YOUR APPLE ACCOUNT
  - PHYSICAL SHIP-TO NAME AND ADDRESS (NO PO BOXES)
  - PURCHASE ORDER NUMBER
  - VALID SIGNATURE OF AN AUTHORIZED PURCHASER
  - APPLE PART NUMBER AND/OR DESCRIPTION OF PRODUCT AND QUANTITY
  - TOTAL DOLLAR AMOUNT AUTHORIZED OR UNIT PRICE AND EXTENDED PRICE ON ALL LINE ITEMS
  - CONTACT INFORMATION: NAME, PHONE NUMBER AND EMAIL
- UNLESS THIS QUOTE SPECIFIES OTHERWISE, IT REMAINS IN EFFECT UNTIL Saturday, April 30, 2022 UNLESS APPLE WITHDRAWS IT BEFORE YOU PLACE AN ORDER, BY SENDING NOTICE OF ITS INTENTION TO WITHDRAW THE QUOTE TO YOUR ADDRESS SET OUT IN THE QUOTE.
  - APPLE MAY MODIFY OR CANCEL ANY PROVISION OF THIS QUOTE, OR CANCEL ANY ORDER YOU PLACE PURSUANT TO THIS QUOTE, IF IT CONTAINS A TYPOGRAPHIC OR OTHER ERROR.
- THE AMOUNT OF THE VOLUME PURCHASE PROGRAM (VPP) CREDIT SHOWN ON THIS QUOTE WILL ALWAYS BE AT UNIT LIST PRICE VALUE DURING REDEMPTION ON THE VPP STORE.
- UNLESS SPECIFIED ABOVE, APPLE'S STANDARD SHIPPING IS INCLUDED IN THE TOTAL PRICE.

Opportunity ID:  
<https://ecommerce.apple.com>  
Fax:

[Terms & Use](#) | [Privacy Policy](#) | [Return Policy](#)  
Copyright © 2018 Apple Inc. All rights reserved.

Samwayfloorcovering@gmail.com

2022-23  
School year  
carpet plan.

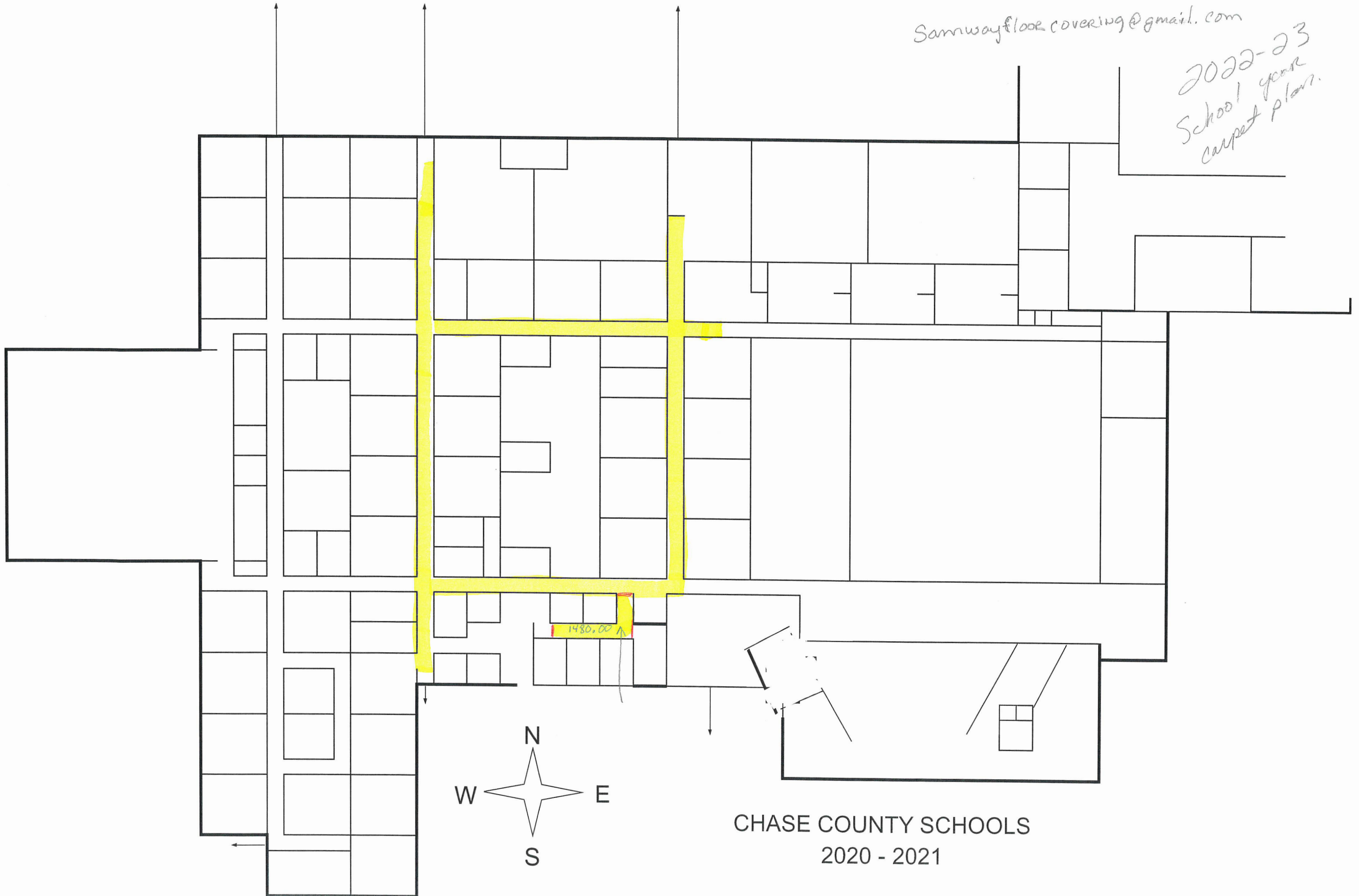

CHASE COUNTY SCHOOLS  
2020 - 2021

McCook Floor Covering, Inc.  
dba Sanway Floor Covering & Furniture  
1801 North Highway 83  
McCook, NE 68001

Quote

Invoice #: 00050608  
Date: 3/22/2022  
Ship Via:  
Page: 1

Bill To:

Chase County Schools  
520 E 9th  
PO Box 577  
Imperial, NE 68033

Ship To:

Chase County Schools  
520 E 9th  
PO Box 577  
Imperial, NE 68033

Description	Amount	Tx
Estimate for Office hallway Install Shaw Intermix carpet tile glue direct w/ adhesive No carpet removal is figured	\$1,480.00	
ANY FLOOR PREP \$60.00 AN HOUR PLUS MATERIALS		

Thank you!

Your Order #:

Shipping Date:

Terms: C.O.D.

Freight: \$0.00

Sales Tax: \$0.00

Total Amount: \$1,480.00

Amount Applied: \$0.00

Balance Due: \$1,480.00

McCook Floor Covering, Inc.  
 dba Samway Floor Covering & Furniture  
 1801 North Highway 83  
 McCook, NE 68001

Quote

Invoice #: 00050605  
 Date: 3/22/2022  
 Ship Via:  
 Page: 1

Bill To:

Ship To:

Chase County Schools  
 520 E 9th  
 PO Box 577  
 Imperial, NE 68033

Chase County Schools  
 520 E 9th  
 PO Box 577  
 Imperial, NE 68033

Chase County Schools  
 520 E 9th  
 PO Box 577  
 Imperial, NE 68033

Description	Amount	Tx
Estimate for Middle hallways Install Shaw Internix carpet tiles glue direct w/ adhesive	\$17,800.00	
6 Boxes of covebase w/ adhesive no labor	\$918.00	
No Carpet removal is figured		
ANY FLOOR PREP \$50.00 AN HOUR PLUS MATERIALS		

Thank you!

Freight: \$0.00

Sales Tax: \$0.00

Total Amount: \$18,718.00

Amount Applied: \$0.00

Balance Due: \$18,718.00

Your Order #:

Shipping Date:

Terms: C.O.D.

McCook Floor Covering, Inc.  
dba Samway Floor Covering & Furniture  
1801 North Highway 83  
McCook, NE 68001

Quote

Invoice #: 00050604  
Date: 3/22/2022  
Ship Via:  
Page: 1

Bill To:

Ship To:

Chase County Schools  
520 E 9th  
PO Box 577  
Imperial, NE 68033

Chase County Schools  
520 E 9th  
PO Box 577  
Imperial, NE 68033

Description	Amount	Tx
Estimate for Eastside hallways Install Shaw Intermix carpet tile glue direct w/ adhesive	\$14,400.00	
4 Boxes of covabase w/ adhesive no labor	\$615.00	
No carpet removal is figured ANY FLOOR PREP \$50.00 AN HOUR PLUS MATERIALS		

Thank you!

Freight: \$0.00

Sales Tax: \$0.00

Total Amount: \$15,015.00

Amount Applied: \$0.00

Balance Due: \$15,015.00

Your Order #:

Shipping Date:

Terms: C.O.D.

McCook Floor Covering, Inc.  
dba Samway Floor Covering & Furniture  
1801 North Highway 83  
McCook, NE 68001

Quote

Invoice #: 00050605  
Date: 3/22/2022  
Ship Via:  
Page: 1

Bill To:

Chase County Schools  
520 E 9th  
PO Box 577  
Imperial, NE 68033

Ship To:

Chase County Schools  
520 E 9th  
PO Box 577  
Imperial, NE 68033

Description	Amount	Tx
Estimate for Middle hallways Install Shaw Encrypt carpet tiles glue direct w/ adhesive	\$19,200.00	
6 Boxes of covebase w/ adhesive no labor	9918.00	
No Carpet removal is figured		
ANY FLOOR PREP \$50.00 AN HOUR PLUS MATERIALS		

Thank you!

Your Order #:  
Shipping Date:

Terms: C.O.D.

Freight:	\$0.00
Sales Tax:	\$0.00
Total Amount:	\$20,118.00
Amount Applied:	\$0.00
Balance Due:	\$20,118.00

McCook Floor Covering, Inc.  
dba Samway Floor Covering & Furniture  
1801 North Highway B3  
McCook, NE 69001

Quote

Invoice #: 00050604  
Date: 3/22/2022  
Ship Via:  
Page: 1

Bill To:

Chase County Schools  
520 E 9th  
PO Box 677  
Imperial, NE 69033

Ship To:

Chase County Schools  
520 E 9th  
PO Box 577  
Imperial, NE 69033

Description	Amount	Tx
Estimate for Eastside hallways Install Shaw Encrypt carpet tile glue direct w/ adhesive	\$15,400.00	
4 Boxes of covebase w/ adhesive no labor	\$815.00	
No carpet removal is figured ANY FLOOR PREP \$50.00 AN HOUR PLUS MATERIALS		

Thank you!

Freight: \$0.00

Sales Tax: \$0.00

Total Amount: \$16,015.00

Amount Applied: \$0.00

Balance Due: \$16,015.00

Your Order #:

Shipping Date:

Terms: C.O.D.



March 28, 2022

## Building a Culture of Employee Engagement at Chase County Schools

Submitted to:

**Adam Lambert**  
Superintendent

**Chase County Schools**

520 E 9TH ST  
IMPERIAL, NE, 69033  
United States

[adamlambert@chasecountyschools.org](mailto:adamlambert@chasecountyschools.org)

Submitted by:

**Emily Behling**  
Education Consultant

**Gallup, Inc.**

1001 Gallup Drive  
Omaha, NE 68102  
United States

402-938-6301

[emily\\_behling@gallup.com](mailto:emily_behling@gallup.com)



## Scope of Services

This Scope of Services (the "Services") is between Gallup, Inc. ("Gallup") and CHASE COUNTY SCHOOLS ("Client") entered into on 3/28/2022 ("Effective Date").

Modifications to the Services shall require a written Change Order. Such Change Order shall set forth in detail the changes, including, but not limited to, price and timeline adjustments required to modify the Services. Under no circumstances shall any Change Order be effective until executed by an authorized representative of each party.

This Scope of Services together with the General Business Terms attached hereto, constitutes the entire agreement between Gallup and Client and supersedes all other oral and written representations, understandings or agreements related to these Services.

*Client Project Manager(S): Adam Lambert . Gallup shall be responsible for reporting to Client Project Manager. Gallup will not make any changes to the Scope of Services without the written approval of Client Project Manager. Written approval may be in the form of email, fax or written Change Order.*

*Gallup Project Manager: Emily Behling. Client Project Manager shall make any request for changes to the Scope of Services to Gallup Project Manager. Gallup shall not be responsible for making any changes not directed to Gallup's Project Manager.*

## Project Term

The project term will run for 1 year(s) from the date of contract execution or 3/28/2022, whichever is later.

Gallup has relied on information provided by Client in defining the Services and determining the pricing for such Services. Gallup will rely on this information as being accurate and complete. Any discrepancy in the information provided by Client may change the Scope of Services and/or the pricing. Gallup will notify Client upon discovering a discrepancy in the information provided by Client and inform Client of the impact on the Scope of Services, timeline and pricing of the Services.

Should Client suspend or delay services for more than 60 days that is not caused by a Force Majeure event, Gallup shall be entitled to receive a fee up to 10% of the annual contract price to compensate Gallup for underutilized resources that have been planned for Client's work.

## Project Deliverables:

---

### **Products:**

#### **Gallup Access – Workplace Survey Subscription Basic**

- For 100 employees.

## Gallup Access Basic Workplace Survey Subscription

The subscription for Client includes Gallup's web-based Workplace survey platform for up to the designated number of employees. This subscription includes survey platform access with unlimited ad hoc Pulse capability through the term of the contract.

### Project Support and Resources

- Gallup will provide one orientation for Client Administrators per year, planned for one hour.
- Standard set of Workplace resources and recommendations for communication included.

### Platform Features

- Unlimited employee surveys for one year.
  - Q<sup>12</sup>® survey questions and Accountability Index.
  - Additional Gallup-validated questions and indices.
- Web only.
- Field period determined by Client.
- Survey set-up, management, distribution of survey links, creating the reporting structure and reading results managed 100% by Client.
  - Additional survey liaison or consulting support can be purchased as needed.
  - Reporting provided based on client set-up of variables.
- Reporting tools
  - Report Exports (ability to export report to PDF, PowerPoint, and Excel).
  - Heat Map (ability to compare results of multiple teams and variables).
  - Dynamic Recommendations (receive high and low-ranking question recommendations).
- Unlimited manager access to learning and advice resources.
- Unlimited use of the action planning and team monitoring tools.
- Unlimited use of companion mobile app.
- 2 System Administrator seats include the following functionality:
  - Ability to add and manage overall system users.
  - Ability to create and administer surveys.
  - Ability to manipulate survey data at the overall client level.
- Unlimited standard system-level roles that include the following:
  - Project Administrator (ability to edit and manage survey projects).
  - Manager/Delegate (ability to view and manage team reports, action plans and learning).
  - Individual (ability to view and manage action plans and learning).
- Technical (Help Desk) Support.
  
- English is the default language for survey questions and communications -- with the option to use other languages already programmed in Gallup Access. Gallup Access provides translations for multiple languages for standard survey text (Q<sup>12</sup>® survey questions and communications – invitation and reminder).
- Client will be responsible for survey translation of custom text areas. Custom text includes 1) survey title, 2) survey introduction text, 3) customized survey invitation, 4) customized survey reminder, 5) custom survey questions (not Gallup-validated questions and indices), and 6) reporting groups.

### Optional

- Single Sign-On functionality available for an additional charge.

# Investment Summary

---

**Products:**

- 100 - Gallup Access – Workplace Survey Subscription Basic \$3,000.00

**Sub-total:** **\$3,000.00**

**TOTAL:** **\$3,000.00**

All prices are expressed in USD.

## Project Billing Schedule:

---

\$3000.00 will be invoiced upon receipt of the signed Agreement

## Additional Clauses:

---

### Gallup Access Subscriptions:

The Service Fee for the Gallup Access Platform is based on a pre-paid annual subscription and no refunds will be given for cancellations of partial years.

Gallup monitors unique and individual email addresses of employees. As such, there will be a pro-rated charge per employee should the sample size exceed the contracted number of employees for the organization.

### Q12 Purchases:

You may not copy or republish Content from the website or Engagement Coaching Kit materials, except for those items included on the Engagement Coaching Kit portable media device (DVD or USB flash drive). In the event of any permitted copying, redistribution or publication of copyrighted material, no changes in or deletion of author attribution, trademark legend or copyright notice shall be made.

### Publication of Data:

Research data associated with the consulting services performed by Gallup is not for public dissemination outside of Client's organization including but not limited to press releases and paid advertising. Both Client and Gallup have a responsibility to ensure that any published research findings are not misleading. Client shall consult with Gallup prior to sharing any research findings with any third party. Any release approved by Gallup shall include sufficient technical information necessary to assess the validity of the published findings which may include the following: the exact question wording, dates of interview, interviewing method, sample size, definition of the survey population, and size of sampling error.

### Respondent Confidentiality:

Respondent-identifying information, without the express consent of respondents, is not part of the deliverables under this Scope of Services and does not constitute a "work made for hire". Gallup will not provide respondent level data with any demographic data appended to protect the confidentiality of participating respondents. To avoid non-compliance with local privacy laws, Gallup will not provide Client any taped surveys without informing the respondent and obtaining express consent that the recordings will be shared with Client.

Gallup, Inc.

CHASE COUNTY SCHOOLS on behalf of itself and its subsidiaries and/or affiliates

BY:

BY:

Name:

Name:

Date:

Date:



## 1. PAYMENT OF INVOICES.

1.1 Client shall pay Gallup the fees specified in the Scope of Services in accordance with the payment schedule.

1.2 Client shall further pay all pre-approved expenses including reasonable out-of pocket expenses of Gallup's personnel associated with client-approved postage, freight, respondent incentives, and travel (including transportation, lodging and meals).

1.3 Payment shall be due upon receipt of the invoice. If Client objects to all or any portion of any invoice, Client shall notify Gallup of its objection within fifteen (15) days from the date of Client's receipt of the invoice, give reasons for the objection, and pay only that portion of the invoice not in dispute. Balances not in dispute and unpaid in excess of 30 days shall bear interest at a rate of 8% per annum. In the event that Client is delinquent in payment of any undisputed invoice beyond 45 days, Gallup may, at its option, withhold deliverables or suspend any and all services until the account is made current.

1.4 Client shall be responsible for all Sales, Use, VAT or similar taxes imposed on the services.

## 2. CONFIDENTIALITY.

2.1 Each party has made and will continue to make available to the other party information that is not generally known to the public and at the time of disclosure is identified as, or would reasonably be understood by the receiving party to be, proprietary or confidential ("Confidential Information"). Confidential Information may be disclosed in oral, written, visual, electronic or other form. Confidential Information shall include all business plans, strategies, forecasts, projects, analyses, financial information, business processes, methods and models, all organizational information, system architecture, software, graphics, computer programs, design ideas, concepts, flow charts, diagrams, progress reports, methods research and any other personal or intellectual property relating to either party, its respective parent or subsidiaries and Personal Data. "Personal Data" shall mean any information related to any identified or identifiable natural or legal person, such as Client's employees, customers, partners or any other third party (including such third parties' employees) and any other additional data deemed as personal data under the applicable personal data protection laws, which are made available to Gallup for processing them on behalf of Client pursuant to this Agreement and all Statements of Work issued pursuant to said Agreement. Confidential Information as defined herein shall not include: (a) information in the public domain at the time of its communication; (b) information, which enters the public domain, through no fault of the receiving party, subsequent to the time of its communication to the receiving party; (c) information which is obtained in good faith by either party from a third party, provided such third party is not bound by a confidentiality agreement with Gallup or Client, as applicable; or (d) information independently developed by employees or agents of a party without access to the Confidential Information of the other party.

2.2 The receiving party shall, except as otherwise provided below (i) not use or reproduce the Confidential Information for any purpose other than as required to perform in connection with the applicable Scope of Services; (ii) protect the confidentiality of the Confidential Information with the same degree of care as receiving party uses for its own similar information, but in no event less than reasonable care; or (iii) not disclose the Confidential Information to any third party, without the prior written approval of the disclosing party. Notwithstanding the foregoing, the receiving party may disclose Confidential Information to the extent such information is required to be disclosed by law, including a subpoena, or to respond to a regulatory request; provided the receiving party promptly notifies the disclosing party in writing of such intention prior to any disclosure to allow the disclosing party to seek a protective order or similar relief in the disclosing party's sole

and absolute discretion. Each party shall immediately advise its employees and others to whom the Confidential Information is disclosed of their obligations under this Agreement and shall take reasonable steps to ensure that the Confidential Information is securely maintained its employees and agents.

2.3 Neither party shall disclose any terms or conditions of this Agreement without the prior written consent of the other party, except as required by applicable law; provided however, that either party may disclose the terms or conditions of this Agreement to a third party under an obligation of confidentiality to such party in connection with customary financial reporting, a proposed sale, merger, acquisition, change in control, consolidation, or other similar transaction.

2.4 Upon termination or expiration of this Agreement, Confidential Information shall be returned to the disclosing party or destroyed. Electronic copies of or containing Confidential Information that are automatically generated through data backup and/or archiving systems and which are not readily accessible to the receiving party's business personnel shall not be deemed to violate this Agreement, so long as such electronic copies are not disclosed or used in violation of this Agreement. Notwithstanding the foregoing, nothing in this Agreement shall prohibit the receiving party's legal department or counsel from retaining one (1) copy, including any electronic copy, of any of the Confidential Information as necessary to comply with regulatory recordkeeping requirements applicable to disclosing party.

2.5 Gallup agrees to the following as it relates to Personal Data:

2.5.1 To prevent unauthorized use, dissemination or publication of the Personal Data, and implement any technical and organizational measures to protect Personal Data which are required by the applicable law.

2.5.2 To implement appropriate technical and organizational measures to protect Personal Data against (i) accidental or unlawful destruction or loss, (ii) unauthorized disclosure or access, in particular where processing involves the transmission of Personal Data over a network, (iii) alteration, and (iv) all other unlawful forms of processing.

2.5.3 To inform Client promptly in writing if it becomes aware of any unauthorized use or disclosure of Personal Data by itself or others.

2.5.4 When collecting, using, storing, transferring and otherwise processing Personal Data, Gallup shall adhere to all applicable export and personal data laws, regulations and rules.

2.6 Client agrees to the following as it relates to Personal Data which is made available to Gallup pursuant to this Agreement and all Statements of Work issued pursuant to said Agreement:

2.6.1 To ensure that such Personal Data is collected and processed by Client and transferred to Gallup in accordance with applicable Data Protection laws, regulations and rules.

2.6.2 Prior to the transfer of such Personal Data to Gallup, to inform the respective data subjects of the processing of their Personal Data pursuant to this Agreement and their rights in accordance with applicable Data Protection laws, regulations and rules.

### **3. REPRESENTATIONS AND WARRANTIES.**

3.1 The parties represent and warrant that: (a) each has the full power and authority to enter into this Agreement; (b) this Agreement is duly authorized by all necessary action and has been duly executed and delivered; and (c) neither party has entered into any agreement with any other entity that contains restrictive provisions regarding confidentiality and/or non-competition that may impair their ability to perform their specific obligations under the terms of this Agreement.

3.2 Gallup represents and warrants that it or its personnel will perform the Services: (a) in a good, timely, efficient, professional and workmanlike manner; (b) with at least the same degree of accuracy, quality, efficiency, completeness, timeliness and responsiveness as are equal to the accepted industry standards applicable to the performance of the same or similar services; and (c) using personnel who are fully familiar with the technology processes, procedures and equipment to be used to deliver the Services.

3.3 Gallup is the lawful owner or licensee of all programs and materials used by it in the performance of the Services contemplated hereunder that have not been provided by Client; such programs and materials have been lawfully developed or acquired by Gallup and Gallup has the right to permit Client access to or use of such programs and materials. Gallup represents and warrants that none of the Services or deliverables provided under this Agreement will infringe on any patent, copyright, trademark, trade secret or other intellectual property right of any third party and agrees to defend and to indemnify and hold harmless Client, its parent, subsidiaries, affiliates, employees and representatives, for all costs and expenses associated with the defense or settlement of any claim that the Services infringe a patent, copyright, trademark, trade secret or other intellectual property right and shall pay any judgments or settlements based thereon.

3.4 In connection with the performance of services set forth in an applicable Scope of Services, Gallup shall comply, and shall cause Gallup's employees and consultants/subcontractors to comply, with all statutes, regulations, ordinances, judgments, permits and other governmental rules or restrictions, whether domestic or foreign, applicable to Gallup's execution of this Agreement.

3.5 EXCEPT AS SET FORTH IN THIS AGREEMENT OR IN ANY SCOPE OF SERVICES, NEITHER PARTY MAKES ANY OTHER REPRESENTATIONS AND WARRANTIES, INCLUDING THE IMPLIED WARRANTIES OF MERCHANTABILITY AND FITNESS FOR A PARTICULAR PURPOSE.

#### **4. TERM AND TERMINATION.**

4.1 This Agreement will commence on the Effective Date and will remain in effect until terminated in accordance with the terms and conditions set forth herein.

4.2 Either party may terminate this Scope of Services if the other party breaches any material obligation set forth herein or in the Scope of Services, which breach is incapable of cure or which, being capable of cure, has not been cured within thirty (30) days after receipt of written notice of such breach from the non-breaching party, or within such additional cure period as the non-breaching party may authorize in writing.

4.3 Either party may immediately terminate this Agreement or the Scope of Services by written notice to the other party if the other party becomes insolvent, makes a general assignment for the benefit of creditors, files a voluntary petition of bankruptcy, suffers or permits the appointment of a receiver for the its business or assets, or becomes subject to any proceeding under any bankruptcy or insolvency law, whether domestic or foreign, or has wound up or liquidated, voluntarily or otherwise. If any of the above events occurs, the affected party shall promptly notify the other party of its occurrence.

4.4 Client or Gallup may terminate this Agreement or any applicable Scope of Services without cause upon 60 days written notice. Notwithstanding any other terms and conditions of this Agreement, should Client cancel this Agreement without cause prior to completion of services, Gallup shall be entitled to the payment of fees for services completed prior to termination of this Agreement and 25% of the remaining balance of fees associated with contracted work yet to be performed. For example, if the contract is for a period of three years and Client terminates this agreement after Year 1, Client shall owe 25% of the remaining contract price for Years 2 and 3 in addition to any outstanding invoices for work completed prior to termination.

#### **5. INTELLECTUAL PROPERTY RIGHTS.**

5.1 Gallup Intellectual Property means any instructional materials, software programs, diagrams, copyrighted assessments or surveys and anything else that Gallup uses or distributes to Client in connection with this Agreement or an applicable Scope of Services that has been developed prior to or independent of this Agreement by Gallup (“Gallup Property”). Gallup Property is not considered work product or a “work for hire” under the terms of this Agreement.

5.2 For any Gallup Property used, incorporated into, required for use of, or provided with any Services provided to Client hereunder, Gallup hereby grants Client a worldwide, non-exclusive, nontransferable license to use Gallup Property as incorporated into or provided with the applicable Services within Client’s organization. Client may not make, have made, sell, offer for sale, execute, reproduce, display, perform, distribute externally to any third party copies of, or prepare derivative works of Gallup Property without the written permission of Gallup.

5.3 All products, reports, documents, compilations of data and other materials produced or developed by Gallup under a Scope of Services which are either: (a) created using the funds, expertise, facilities, personnel, time, material or proprietary information of Client; or (b) are derivatives of any Client proprietary information shall be the sole property of Client. These materials do not include any Gallup Property or derivatives thereof. Gallup agrees to assist Client, or its designee, at Client’s expense, in every proper way to secure Client’s rights in the materials.

## **6. GOVERNING LAW; DISPUTE RESOLUTION.**

6.1 This Agreement shall be construed and interpreted according to the laws of the State of Nebraska without regard to the conflicts of law principles in Nebraska.

6.2 In the event of any dispute, claim, question, or disagreement arising from or relating to this Agreement or the breach thereof, the parties hereto shall use their best efforts to settle the dispute, claim, question, or disagreement. To this effect, the parties shall consult and negotiate with each other in good faith and, recognizing their mutual interests, attempt to reach a just and equitable solution satisfactory to both parties.

## **7. RELATIONSHIP OF PARTIES.**

7.1 Gallup will act solely as an independent contractor rendering professional services.

7.2 Gallup will function as a non-exclusive consultant to Client. Client acknowledges that, during the term of this Agreement and thereafter, Gallup will offer, undertake, and continue to provide Consulting Services for organizations other than Client. In no event shall Gallup be relieved of its obligation to protect Confidential Information.

## **8. NOTICES.**

Any notice or other communication required or permitted to be made or given by either party pursuant to this Agreement shall be in writing delivered to the individual whose name appears on the signature block of the Scope of Services.

## **9. LIMITATION OF DAMAGES.**

Neither party shall be liable to the other party for any indirect, incidental, consequential, exemplary, punitive or special damages, including lost profits, regardless of the form of the action or theory of recovery, even if that party has been advised of the possibility of those damages.

## **10. USE OF NAME, TRADEMARKS OR LOGOS.**

Neither party shall originate any publicity, news release, or other announcement, written or oral, whether to the public press, the trade, any of the other party's customers, suppliers or otherwise, relating to this Agreement or any Scope of Services, or to the existence of an arrangement between the parties without the prior written approval of the other party. Without limiting the foregoing, neither party shall use any names, trademarks or logos of the other party without the prior written consent of such party.

#### **11. SEVERABILITY.**

The provisions of this Agreement shall be deemed severable, and the unenforceability of any one or more provisions shall not affect the enforceability of any other provisions. In addition, if any provision of this Agreement, for any reason, is declared to be unenforceable, the parties shall substitute an enforceable provision that, to the maximum extent possible and in accordance with applicable law, preserves the original intentions and economic positions of the parties.

#### **12. CONFLICT OF TERMS.**

If a term in a Scope of Services or Addendum conflicts with a term in this Agreement, the provisions of this Agreement will prevail unless the Scope of Services or Addendum specifically states that the conflicting term will prevail.

#### **13. WAIVER.**

No failure or delay by either party in exercising any right, power or remedy shall operate as a waiver of such right, power or remedy, and no waiver shall be effective unless it is in writing and signed by the waiving party. If either party waives any right, power or remedy, such waiver shall not waive any successive or other right, power or remedy the party may have under this Agreement.

#### **14. ASSIGNMENT.**

Neither party may assign any rights in nor delegate any obligations under this Agreement or any portion thereof without the written consent of the other. Any such attempt to transfer will be deemed null and void.

#### **15. FORCE MAJEURE.**

Neither party shall be liable for any losses arising out of the delay or interruption of its performance of its obligations under this Agreement due to any act of God, war, terrorism, civil disturbance, court order or natural disaster, or any other cause beyond the reasonable control of the affected party.

#### **16. SURVIVAL.**

Sections 2, 3, and 5 shall survive the termination or expiration of this Agreement.



## Price Quote for 55 Ton Ironworker Machine

1 message

**American Machine Tools - Michael** <michael@americanmachinetool.com>

Fri, Mar 18, 2022 at 1:55 PM

To: jspeck@chasecountyschools.org

Jason Speck  
Chase County Schools  
520 East 9th St, PO Box 577  
Imperial, NE 69033

Jason,  
Thank you for requesting this quotation from American Machine Tools Company for a brand new Edwards 55 ton Jaws 4 Ironworker Machine:

### MACHINE FEATURES:

- \* Hole Punching Assembly installed on the left side
- \* Extra Tool station on the right side
- \* Flat bar shear built in with blades included - low rake
- \* Angle shear built in with blades included
- \* Electronic Up and Down Stroke Control System
- \* (2) LED Worklights mounted above the shear
- \* Adjustable steel punch strippers
- \* Fast adjusting hold down bars
- \* Threaded holes in tables for jigs
- \* Pedestal Die Table (for punching angle iron 2" on center)
- \* Pipe coupling welded to back for optional back gauge
- \* Slots for gauge feeding tables
- \* Comfortable working heights
- \* Remote foot pedal operation
- \* Direct drive pump - no belts
- \* Fully Guarded \* Sound insulated
- \* Hydraulic system fully charged - ready to operate
- \* Made in USA

### CAPABILITIES:

#### PUNCHING:

Rated capacity: 55 Tons  
Throat: 7.5"  
Standard Punch: 1-1/16" diameter - 5/8" plate  
7/8" diameter in 3/4" plate  
Optional Oversize  
Punching assembly: 1-9/16" diameter in 3/8" plate

#### FLAT BAR SHEARING:

Max. width: 1/2" x 12" or 3/8" x 14"  
Max. thickness: 3/4" x 4"  
Max. round capacity: 7/8"  
Max. square capacity: 7/8"

#### ANGLE SHEARING:

Maximum Size: 4" x 4" x 1/4"  
Maximum thickness: 3" x 3" x 3/8"

#### GENERAL SPECIFICATIONS:

Open height: 8-1/8"  
Shut height: 6-7/8"  
Stroke: 1-1/4"  
Cycle time: 2 seconds to shear 1/2" x 2" steel flat bar  
Electric motor standard: 5 HP, 3 phase, 208/230 volts, 3450 RPM, 14 amps  
Electric motor options cost extra: 5 HP, 3 phase, 440/480 volts, or 575 volt, 7 amps  
(Extra cost), 5 HP, 1 phase, 208/230 volts, 3450 RPM, 26 amps (\$245 extra)  
Hydraulics: 3.5 gpm, 1 stage pump @ 2500psi. 2-1/2" cylinder  
Machine Dimensions: 36" x 42-1/2" x 57"High

#### PRICES:

Edwards 55 Ton Ironworker 208 or 230Volts, 3phase: \$14,550-

Edwards 55 Ton Ironworker 208 or 230Volts, 1phase: \$15,150.

Edwards 55 Ton Ironworker 460Volts, 3phase: \$15,150.

FOB Factory in Alberta Lea, Minnesota, USA.

\$845 SHIPPING to most of USA.

Weight: 2480 Lbs.

FREE Tool Box of 8 Round Punch & Die sets (Choose 8 sizes 3/16 to 1-1/16 Dia) or \$300 off.

Quote valid for 30 days.

POPULAR OPTIONS AVAILABLE:

Extra Punch & Die Sets up to 1-1/16":

Round \$59, Oblong \$239, Square up to 3/4" \$199.

Oversize 1-9/16" Punching Assembly: \$1129.

Oversize punches: Round \$129, Oblong \$239, Square up to 1-1/16" \$193,

Extra Large 4" capacity Punching Assembly: \$1969.

Punch & Die sets cost extra.

Optional Coper-Notcher \$1909. (2-1/2" x 4")

Gauging Table for coper-notcher: \$289.

Optional Vee Notcher: \$1699.

Optional Pipe Notcher:

\$559 housing + Die (1"\$949, 1-1/4"\$969, 1-1/2"\$1049, 2"\$1099)

Optional Press Brake (1/4" capacity):

8" long \$1,349., 10" long \$1,699.

Optional Back Gauge for press brake tooling: \$839.

Optional Rod Shear (cuts round sizes 1/4, 3/8, 1/2, 5/8, 3/4, 1"): \$2093.

Optional 2nd Hole Punching Assembly to use on the right side of the machine: \$969.

Optional Fence Picket Tooling:

\$695 (1/2", 5/8", or 3/4" square tube), \$895 (size 1")

Optional Manual Back Gauge: \$399.,

Automatic-Cut Back Gauge: \$1069.

Optional Punch Gaging Table for repeat setups:

3/8 thick \$349., 1" thick \$1,349.

Protractor Angle Gauge: \$59.,

Quick Change Punch Coupling: \$1019.

Stripper Reducer: \$129.

Urethane Stripper: \$909.

Extra Magnetic Light: \$119.

General Productivity Pack: \$1,129. - \$1,699.

Punching Productivity Pack: \$1699. Notching Productivity Pack: \$369.

Shearing Productivity Pack: \$459.

Ultimate Productivity Pack: \$2139.

Hydraulic Powerlink Connector to use Pipe Bender, Shop Press, Radius Roller, etc: \$1795.

Optional Pipe Bender \$4160.,

20 Ton Shop Press: \$4379.,

40 Ton Shop Press \$8749.,

60 Ton Shop Press: \$14,209.,

110 Ton Shop Press \$18,589.

PLC Extra: Quote on Request

Radius Rolling Machine: \$10,719.,

20 Ton Horizontal Press Brake Machine: \$12,139.

VIDEO: <https://www.youtube.com/watch?v=e0YYlwdVqSM>

Manufacturer's Warranty: Defective parts replaced for one year, labor not included.

Payment Terms: Check, credit card, bank wire transfer, leasing or financing. Net 30 days available to government agencies, most schools and very large corporations.

This offer includes Terms and Conditions of sale shown on our website.

Please contact me with questions about capabilities, shipping, or payment arrangements.

Bill Cichon

American Machine Tools Corp.

5862 N. Northwest Hwy

Chicago IL 60631

773-334-5000 Fax: 773-442-0314

[bill@americanmachinetool.com](mailto:bill@americanmachinetool.com)

[www.AmericanMachineTools.com](http://www.AmericanMachineTools.com)

Michael Desjardins

American Machine Tools Company  
5862 N. Northwest Hwy  
Chicago IL 60631  
773-334-5000 Fax:773-442-0314  
[michael@americanmachinetool.com](mailto:michael@americanmachinetool.com)  
[www.AmericanMachineTools.com](http://www.AmericanMachineTools.com)

\*Ironworkers and other metalworking machines are our business\*

---

**3 attachments**



**55\_ton\_front\_view.jpg**  
71K

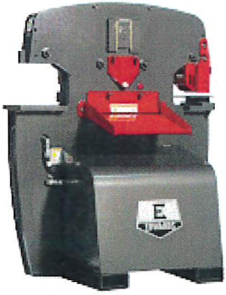

**55\_ton\_rear\_view.jpg**  
266K

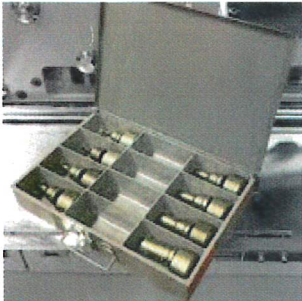

**Box\_Punches\_Dies.jpg**  
7K

Martin Doolittle

33390 Rd 758

Madrid, Ne 69150

# Estimate

Date	Estimate #
4/4/22	178

Name / Address	Project
Chase County Schools 520 E 9th St Imperial, Ne 69033	Foundation on East side of Football Field

Item	Description	Qty	Total
Stem Wall	Cost to pour 8" Stem wall on spread footing for 15' X 30' building..	90	6,120.00
Back Fill	Cost to pack fill dirt on both sides of stem wall and for floor aria of building.	56	1,008.00
5 in. Concrete	Cost to pour 5" concrete with rebar reinforcing for floor.	393	2,389.44
<b>Total</b>			<b>\$9,517.44</b>