



School District 622
NORTH ST. PAUL | MAPLEWOOD | OAKDALE

Ready for tomorrow

SCHOOL BOARD MEETING

Regular Meeting

**March 15, 2016
6:00 PM**

Board Members:

Caleb Anderson, Director
Theresa Augé, Director
Amy Coborn, Chair
Steve Hunt, Vice Chair
Nancy Livingston, Director
Becky Neve, Clerk
Michelle Yener, Treasurer

Superintendent:

Christine Osorio

622 Education Center
2520 East 12th Avenue
North St. Paul, Minnesota 55109

District Mission Statement:

A community collaborative dedicated to educating and empowering all learners to excel in our changing world.

**SCHOOL BOARD
INDEPENDENT SCHOOL DISTRICT 622
North St. Paul-Maplewood-Oakdale**

**Regular Meeting
March 15, 2016
6:00 PM**

District Education Center, 2520 East 12th Avenue, North St. Paul

A G E N D A

- I. Call to Order and Pledge of Allegiance**
- II. Approval of the Agenda**
- III. Achievement - Hunt**
 - A. Josh Heintz 10
- IV. Public Comment**

An opportunity for public to comment on items pertaining to the agenda. Speakers shall complete a registration card, state their name and address, and will have between two and four minutes, depending on the number of speakers, to speak on an agenda topic. The Public Comment section of the meeting shall last no longer than thirty minutes.
- V. Consent Agenda** 11

The Consent Agenda consists of routine items that are acted on in a single, consolidated motion without Board discussion. Board members have the option of pulling items off the Consent Agenda if they wish to discuss them or consider them individually.

****I recommend that the consent agenda items, listed below, be approved as presented.***

 - A. Minutes of February 23, 2016 Board Meeting 12
 - B. Routine Personnel 18
 - C. Bid Calendar 20
 - D. Contract Award - Strategic Plan Facilitator 21

| | |
|-----------------------|----|
| E. Bid Award | 22 |
| F. Disbursements | 26 |
| G. Pollinator Support | 30 |

Representative Leon Lillie is seeking endorsement from cities and school districts to support his campaign to become a pollinator friendly community. As you may be aware, there is concern and alarm that pesticides and neonicotinoids have severely reduced the bee population and thus pollination across the United States.

Endorsement of Representative Lillie's protection of pollinators aligns well with what we are currently doing in the District. We are working with the Ramsey-Washington Metro Watershed District constructing native prairie and rain gardens and have already been following the protocols for pollinator protection.

VI. Reports

A. Student School Board Representatives

B. Superintendent

| | |
|--------------------------|----|
| 1. Strategic Plan Update | 31 |
|--------------------------|----|

I will share information for the public on the contract award for our strategic plan facilitator, Transformation Systems, LTD. This contract award is proposed for action during the Consent Agenda portion of the meeting.

After interviewing four strategic planning consulting groups I will be recommending Transformation Systems, LTD to support us with our strategic planning in 622. Their proposal was less expensive than other options and most closely aligned to the principles the School Board and other stakeholder groups identified as most important for the process and product of strategic planning. They will provide the expertise we need as we lead the district and community into the future. Their proposal includes a mix of both consultant facilitated

and district facilitated community engagement sessions. They will support capacity building and leadership development so 622 staff can lead and ultimately sustain the implementation of the strategic plan into the future.

Our goal will be to ultimately present the completed strategic plan to the School Board by December 2016.

C. Business Office

1. 2016-2017 Capital Budget - R. Anderson 41

It's that time of year again when we start our budget planning - this time for 2016-2017. The first piece of the puzzle is the capital allocation for the District.

Attached are the various Building and District initial capital allocations. The Building and Athletic allocations are based on the projected building enrollment that is being used by Teaching and Learning for staffing. The allocation rate per student is the same as it is for the current 2015-2016 budget.

Curriculum and Technology replacement cycles have been restored for the 2016-2017 budgets since they were a one-time adjustment for 2015-2016. The 2016-2017 capital budget also reflects the one-time use of \$500,000 as part of our budget adjustments to balance the 2016-2017 General Fund budget.

D. Student Services

1. School Linked Mental Health Services - McIntyre 44

Cory will highlight the School Linked Mental Health (SLMH) model that we use in District 622. School Linked Mental Health (SLMH) services are available through three separate Department of Human Services State Grants to provide therapeutic mental health service for children and youth experiencing emotional and behavioral challenges which could be affecting their school work and/or

relationships at school. SLMH services provide accessible, coordinated, culturally and linguistically appropriate treatment to students in 622.

These school-connected clinical mental health treatments include interventions that increase accessibility for children and youth who are uninsured or underinsured; improve clinical and functional outcomes for children and youth with a mental health diagnosis; and improve identification of mental health issues for children and youth.

This initiative connects or co-locates effective mental health services with schools and students at the school level. This project has proven particularly effective in reaching children who have never accessed mental health services.

VII. Action Items

A. Business Office

1. Acknowledgment of Contributions - Neve 65

**I recommend that the list of contributions, with a year to date total of \$188,242.98 be accepted with appreciation.*

2. 2016-2017 Capital Budget 66

**I recommend that the 2016-2017 Capital Budget be approved as presented.*

3. Valley Crossing Tail Cost Letter of Agreement 67

The agreement outlines the actions to be taken by the member districts and Intermediate 916 and the ending costs ("tail costs") and actions necessary to help plan for a successful transition by the new owner South Washington. South Washington will take over running the elementary school on July 1, 2016.

The agreement spells out that all tail costs will be shared by the member districts by their percentage of ownership in Valley

Crossing. The tail costs will be deducted from the current fund balance of Valley Crossing with any remaining outstanding costs, if any, billed back to the member districts.

**I recommend that you approve the resolution for adopting the letter of agreement for the ending costs associated with the dissolution of Valley Crossing Community School.*

4. Meal Prices for School Year 2016-2017 73

Supervisor of Nutrition Services Paula Pohlkamp is proposing an increase in the school meal prices for the 2016-2017 school year. The new meal prices will meet the paid lunch equity requirements for the Healthy, Hunger-Free Kids Act (HHFKA) of 2010. Per the attached USDA/MDE calculator, the HHFRA recommended increase is \$.08 for lunch. The proposed increase is \$.05 for lunch and \$.10 for breakfast.

A majority of school districts are in the process of increasing meal prices for the upcoming school year. Attached are neighboring districts and their tentative prices for 2016-2017.

**I recommend that the proposed meal prices for the 2016-2017 school year be approved.*

B. Human Resources - Gray

1. Severance of Teacher & Extracurricular Assignments 75

Each year we sever extracurricular and added work assignments from the teacher contract effective at the end of the school year so we are protected from adverse costs if funding is reduced next year.

**I recommend that the Severance of Added Teacher and Extracurricular Assignments resolution be approved.*

2. Adopt Criteria for Discontinuance of Licensed Positions 76

This is another resolution we put before you for adoption each year. We review staffing needs and adjust certified staff through

termination or placement on unrequested leave of absence for those personnel we will not need due to program reductions, declining enrollment or lack of funds. This resolution formally establishes the aforementioned criteria.

**I recommend that the Discontinuance of Licensed Positions resolution be approved.*

C. Teaching & Learning

1. 2016-2017 Achievement & Integration Budget - Miller/Howley 77

The Minnesota Department of Education (MDE) requires school districts receiving Achievement and Integration dollars to submit a budget which includes both district and collaborative expenses. Our total dollar amount for the 2016-2017 school year, including both district dollars and collaborative dollars, is \$2,299,995.50. This budget will continue to support valuable programming designed to: support individual student growth and high achievement, increase the intercultural competency of staff, and increase cross-cultural interactions and opportunities to foster integrated learning environments.

The entire Achievement and Integration budget is quite lengthy and therefore we are attaching just the cover page as we have done in the past. The budget is always available for your review and can be sent to you from Tom Howley upon request.

**I recommend that the 2016-2017 Achievement and Integration Budget be approved.*

D. School Board

1. Set Time, Location & Agenda for April 12, 2016 Work Study Session
Our April 12 work study session date has been set, but we must take action on the time, location and agenda. Suggested items are: Ice Breaker; Superintendent Check In; Skyview Middle School World

Language Teacher Grant Boulanger's presentation on World Language in our District; Springsted's levy survey results; and the Ten Year Facility & Maintenance Plan by Randy Anderson.

**I recommend that the April 12 work study session begins at 4:30 p.m. in Conference Room 202 of the District Education Center and includes the following agenda items: 1)Ice Breaker; 2)Superintendent Check In; 3)World Language Presentation; 4)Springsted Survey Results; and 5)Ten Year Facility & Maintenance Plan.*

2. Set May 24, 2016 Work Study Session

Randy has asked for an opportunity in a study session format to present a budget overview for all budgets except general fund and community education. We are proposing adding a 45 minute work session prior to the start of our May 24 business meeting to accomplish the request.

**I recommend that a work study session begins at 5:00 p.m. in Conference Room 202 of the District Education Center and contains the following agenda items: 1) Ice Breaker; 2) Superintendent Check In; and 3)2016-2017 Budget Overview.*

3. Change June 28, 2016 Reflection Study Session to Work Study Session; Set Time, Agenda & Location

Randy would like to take an opportunity in June to present the remainder of the 2016-2017 budgets - specifically general fund and community education. Since we have a reflection study session scheduled for June 28 with a start time of 5:00 p.m., changing the reflection study session to a work study session would allow Randy to share the information.

**I recommend that the June 28, 2016 reflection study session be changed to a work study session and contain the following agenda items: 1)Ice Breaker; 2)Superintendent Check In; and 3)2016-2017*

General Fund & Community Education Budgets. The meeting will take place at 5:00 p.m. in Conference Room 202 of the District Education Center.

4. Set April Special Meeting

Because of an application deadline for E-rate which the fiber bid would qualify for, further discussion is necessary with the Board prior to taking action at the April 26 business meeting.

**I am proposing setting a brief special meeting prior to the start of the April 12 work study session for the purpose of discussing options and taking possible action on a fiber bid.*

VIII. Board Communications

IX. Future Board Meeting Dates

A. April 12, 2016 Work Study Session

B. April 26, 2016 Business Meeting 6:00 p.m. (Board Room)

III. A. ACHIEVEMENT AWARDS, *presented by: Augé*

The School Board of the North St. Paul-Maplewood-Oakdale School District is proud of its students, citizens, and staff who demonstrate service “above and beyond” the call of duty. We are proud to recognize the following individual(s):

- A. Next Step Student **Josh Heintz** is a wonderful worker. He cleans our Education Association office every week and takes great pride in his work. All of us at NSPMOEA are very proud to have Josh work at our office and we are so thankful to have him on our team.

Josh is nominated by Rory Sanders, NSPMOEA President.

V. CONSENT AGENDA

The Consent Agenda is designed to expedite the handling of routine and miscellaneous official business of the School Board. The entire agenda may be adopted by the Board in one motion. The motion for adoption is not debatable and must receive unanimous approval. By request of an individual Board member, an item can be removed from the Consent Agenda and placed upon the regular agenda for consideration and action.

Therefore, the following resolution is recommended:

BE IT RESOLVED by the School Board of Independent School District No. 622 that Consent Agenda Items, V.A. through V.G., be approved as written, and a copy of the agenda items is attached to the minutes.

MOTION:

SECOND:

**INDEPENDENT SCHOOL DISTRICT 622
NORTH ST. PAUL-MAPLEWOOD-OAKDALE SCHOOLS**

**REGULAR MEETING
SCHOOL BOARD
February 23, 2016**

Chair Coborn called the meeting to order at 6:00 p.m. with the following present: Chair Coborn, Vice Chair Hunt, Clerk Neve, Treasurer Yener, Directors Anderson, Augé, Livingston, Superintendent Osorio, and Student Representative Charlotte Zangs. Absent: Student Representative Phoebe Ato.

Others present were: Keith Gray, Director of Human Resources; Troy Miller, Assistant Superintendent; Randy Anderson, Director of Business Services; Cory McIntyre, Director of Student Services; and Kim Cavallaro, Administrative Assistant.

The meeting opened with the Pledge of Allegiance led by Martina Wagner.

Coborn noted that the District 916 report had been removed from the agenda. Hunt moved and Neve seconded the following motion, which carried:

THAT the agenda be approved as presented.

Yener moved and Livingston seconded the following resolution, which carried:

BE IT RESOLVED by the School Board of Independent School District No. 622 that the following Consent Agenda Items, IV.A. through IV.F., be approved as written, and a copy of the agenda items is attached to the minutes.

North High School Student Board Representative Charlotte Zangs reported on the following items: The second trimester is coming to a close; the Boys Basketball Team are co-champs for the Metro East Conference along with Tartan; Girls Basketball won last night; \$4,100 profit was raised in Coffee House Acts; a Book Drive is occurring and donated books will be given to local shelters; and 2nd trimester finals are coming up.

EL Supervisor Martina Wagner presented on improving student outcomes for English Learners through co-teaching and the Annual Measureable Achievement Objectives plan.

Osorio reported on the Strategic Plan and included an update on the search for a Strategic Planning Consultant through an interview process. She discussed the Quality Steering Committee and explained that it is a collaborative between district management and the teachers' union with the number one goal of improving communication. Osorio reported on recent high school activities and included that Tartan's Ce Ce Boyle competed at the Girls State Nordic Ski meet; North's Tori Gardner competed in vault at the state meet last

weekend placing 15th among the state’s best vaulters; Tartan’s Justin Burg and North’s Louie Varland both qualified for the State Individual Wrestling Tourney; and she echoed Zangs comments regarding Tartan and North’s Boys Basketball teams sharing the title as co-champs for the Metro East Conference. Osorio also recognized board members for School Board Recognition Week and thanked them for their service.

Osorio provided an overview of the budget reduction process and walked through a list of proposed reductions for the 2016-2017 budget that the Board would be taking action on later in the meeting.

Augé read the list of contributions. Livingston stepped out of the room for a short time. Augé moved and Anderson seconded the following resolution, which carried with Livingston not present for the vote:

BE IT RESOLVED by the School Board of Independent School District 622 that the School Board accept with appreciation the following contributions and permit their use as designated by the donors.

| <u>Donor</u> | <u>Item and/or Amount</u> | <u>Purpose</u> |
|--|--|------------------------------|
| City of Maplewood | \$1,260.00 | North High School Show Choir |
| North St. Paul - Maplewood - Oakdale Rotary Foundation | \$250.00 | North High School Show Choir |
| Silver Lake United Methodist Church | 48 sets of hats, gloves and mittens | Castle Elementary |
| Frank A. Orsello | Office supplies (valued at \$65.00) | Castle Elementary |
| Stephanie Mann | \$50.00 | Community Bridge |
| State Farm | Computer Monitors | ISD 622 |
| Jake Skifstad | \$100.00 | Harmony Pilot Program |
| Shirley Strum | \$15.00 | Gladstone Meals on Wheels |
| Jim and Sue Reibel | Children’s clothing (valued at \$100.00) | Cowern Elementary |
| Tom Mader | \$500.00 | Tartan Trap Team |
| House of Prayer Lutheran Church | Children’s clothing (valued at \$500.00) | Cowern Elementary |
| Mary and John Mills | National Geographic Magazines 1992-2015 (valued at \$700.00) | ISD 622 - multiple schools |
| Pam Norton | \$25.00 | Gladstone Meals on Wheels |

| | | |
|----------------------------|--|---------------------------|
| Johanna Perkins | Student board games; books; winter jackets; hats, gloves and scarves (valued at \$200.00) | Castle Elementary |
| Betty Motz | \$50.00 | Gladstone Meals on Wheels |
| Mary Lou & Walter Lindeman | \$200.00 | Gladstone Meals on Wheels |
| Christa Waymire | \$50.00 | Harmony Pilot Program |

(Livingston returned)

Budget reductions for 2016-2017 were considered. Augé asked that Budget Reduction Item #7, Budget Savings from Proposed Calendar Revision, be removed until the board considers action later in the evening on the 2016-2017 School Calendar. Augé amended the original motion and Yener seconded the following resolution, which carried:

BE IT RESOLVED by the School Board of Independent School District 622 that STAFFING CUT ITEM 1; AND DEPARTMENT, PROGRAM, NON-STAFF REDUCTIONS ITEMS 1 - 6 AND 8; from the list of general fund budget adjustments be approved for the 2016-2017 fiscal year.

The original motion was considered in which Hunt had moved and Anderson seconded the following motion; which failed, with all board members voting NO:

BE IT RESOLVED by the School Board of Independent School District 622, that the list of general fund budget adjustments be approved for the 2016-2017 fiscal year.

Yener Moved and Livingston seconded the following resolution, which carried:

BE IT RESOLVED by the School Board of Independent School District 622, that the School Board authorize the District Administration to initiate a procurement for student transportation services contract(s) commencing with school year 2016-17 for a period not to exceed (2) two years with an option for additional years and other terms, consistent with Minnesota Statutes 2015, Sec. 123B.52, Subds. 1. and 3.

Anderson moved and Augé seconded the following resolution, which carried:

BE IT RESOLVED by the School Board of Independent School District 622 that the 2015-2017 Local 12 Master Agreement be approved.

**Tentative Local 12 (EDUCATION ASSISTANTS)
Settlement Summary**

| | 2015-2016 | 2016-2017 |
|------------------------------------|---|---|
| Salary Schedule Improvement | Lump Sum Payment - Year 1 \$0.30 per hour based upon their assigned work schedules (No step movement increases and no increase to the salary schedule- Education Assistants only) | <p>Step movement restored Education Assistants hired on or before 1/15/2015 will advance TWO steps and Education Assistants hired between 1/16/2015 and 1/15/2016 will advance ONE step. Education Assistants hired on or after 1/15/2016 will remain on the same step in accordance with Article VII, Section 5 of the contract (not LPNs/Associate RNs).</p> <p>Lump Sum Payment -Year 2 Lump sum payments for the 2016-2017 contract year will be issued to Education Assistants that are not eligible for step movement \$0.22 per hour based upon their assigned work schedules.</p> <p>LPNs/Associate RNs - Year 2 Adjusted placements in lieu of lump sum payments.</p> |
| Health Insurance Caps | No Change | Single \$567.64/month Family \$1213.72/month |
| Total | | 2.60 |

Augé moved and Yener seconded the following resolution, which carried:

BE IT RESOLVED by the School Board of Independent School District 622 that the attached calendar be approved and adopted for the 2016-2017 school year, and that pursuant to Minnesota Statute 645.44, Subd. 5, the School Board of Independent School District No. 622 has determined that Columbus Day (October 10, 2016) is not a legal holiday, and therefore, public business, including school board and information meetings, may be transacted on that day. Additionally, school will be open on Veterans Day (November 11, 2016) and in accordance with state statute will have at least one hour of activities in observance of Veterans Day.

Upon approval of the 2016-2017 School Calendar, Budget Reduction Item #7, Budget Savings from Proposed Calendar Revision was considered. Livingston moved and Augé seconded the following motion which carried:

BE IT RESOLVED by the School Board of Independent School District 622, that Department, Program, Non-Staff Reductions Item 7 from the list of general fund budget adjustments be approved for the 2016-2017 fiscal year.

Augé moved and Neve seconded the following resolution, which carried:

BE IT RESOLVED by the School Board of Independent School District 622 that the 2016-2017 Student Services 321.17 iFTE be approved.

Neve moved and Livingston seconded the following resolution, which carried:

BE IT RESOLVED by the School Board of Independent School District 622 that the District 622 AMAO Plan be accepted as presented.

Anderson moved and Yener seconded the following resolution, which carried:

BE IT RESOLVED by the School Board of Independent School District 622 that the 2016-2017 Regular Education 369.53 iFTE be approved.

Coborn asked board members to set the time, location and agenda for the March 15, 2016 reflection study session. Augé moved and Neve seconded the following motion, which carried:

THAT the March 15, 2016 Reflection Study Session begin at 5:00 p.m. in the Board Room of the DEC and continue in Room #S292 at North High School and contain the following agenda items: 1)Check In & Ice Breaker; 2)Fab Lab Visit.

Coborn asked board members to set a community engagement session. Neve moved and Hunt seconded the following motion, which carried:

THAT a Community Engagement Meeting be set on April 19, 2016, from 6:30 - 8:30 p.m. in the Cowern Elementary Gym.

During Board Communications, the following items were shared:

- ✓ Livingston reported that she helped the North St. Paul-Maplewood-Oakdale Rotary Club distribute dictionaries to District 622 third grade classrooms. She thanked the Rotary Club and Sonya Czerepak for heading up the initiative that shows the importance of literacy and words for our students.

Livingston moved and Yener seconded the following motion, which carried:

THAT the meeting be adjourned.

The meeting adjourned at 7:40 p.m.

Clerk

Public notice for solicitation of bids, requests for quotes and requests for proposals are located on the ISD 622 website, www.isd622.org.

Employment

| First Name | Last Name | Employed as | Building | Effective | Pay Rate | Per |
|------------|-----------------|------------------------------|-----------------------|-----------|-------------|------|
| Lakenya | Austin | 1:1 SPED Para | Skyview Middle | 3/7/16 | \$15.55 | hour |
| Brian | Fidelis-Agwatu | Grant Support A | Tartan High School | 2/11/16 | \$15.00 | hour |
| Fnu | Husnia | Grant Support A | Tartan High School | 2/10/16 | \$15.00 | hour |
| Bushra | Kamran | CREED Para | Eagle Point | 2/26/16 | \$14.18 | hour |
| Lily | Khang | Water Safety Aid | District Wide | 2/26/16 | \$9.00 | hour |
| Aaron | Lende | Lunch/Playground Monitor | Cowern | 3/7/16 | \$13.35 | hour |
| Aaron | Lende | Adv. Conn. CC Para | Cowern | 3/4/16 | \$11.65 | hour |
| Lucero | Lopez | Adv. Conn. CC Para | Castle | 2/24/16 | \$11.65 | hour |
| Susan | Masterjohn | Care & Treatment Teacher | District Wide | 3/7/16 | \$21,413.41 | year |
| Sara | McCabe-Martinez | Parent Volunteer Coordinator | North High School | 1/20/16 | \$13.80 | hour |
| Malia | Moua | Grant Support A | Skyview Middle School | 2/22/16 | \$15.00 | hour |
| MaggieLynn | Norton | Night Custodian | Carver Elementary | 2/16/16 | \$17.08 | hour |
| Nicole | Powers | Parent Volunteer Coordinator | North High School | 1/20/16 | \$13.80 | hour |
| Hteemoo | Saw | Water Safety Aid | District Wide | 2/26/16 | \$9.00 | hour |
| Jessica | Simes | Breakfast Monitor | Webster | 2/16/16 | \$13.35 | hour |
| Jessica | Simes | Lunch/Playground Monitor | Webster | 2/16/16 | \$13.35 | hour |
| Jue | Xiong | SPED Bldg Para | Cowern | 2/22/16 | \$15.55 | hour |

Status Change

| First Name | Last Name | From | To | Effective | Pay Rate | Per |
|------------|-------------|------------------------------|--------------------------|-----------|-------------|------|
| Julie | Cambronne | Building EA .13 | Building EA .25 | 2/1/16 | \$13.82 | hour |
| Marie | Frank | ECSE OT .95 | ECSE OT .75 | 2/1/16 | \$43,192.80 | year |
| Brittany | Halverson | Math Intervention EA .15 | SPED Bldg Para .27 | 2/16/16 | \$14.18 | hour |
| Robert | Holmboe | PT School Bus Driver Trainee | PT School Bus Driver | 2/3/2016 | \$19.00 | hour |
| Laura | Kaschmitter | Math Intervention EA .21 | Math Intervention EA .25 | 2/19/16 | \$13.82 | hour |
| Kaylyn | Molitor | Para Sub | CID Teacher 1.0 | 1/25/16 | \$18,399.00 | year |

Leave of Absence

| First Name | Last Name | Assignment | Building | Leave Type | Dates |
|------------|-----------|-------------------------------|-------------------------|------------------|-----------------|
| Nicole | DeRusha | Kindergarten Teacher | Eagle Point Elementary | LOA - child care | 3/29/16-4/29/16 |
| Carrie | Eicher | Teacher - Instructional Coach | Maplewood Middle School | LOA - child care | 3/23/16-4/15/16 |

| Resignation | | | | |
|--------------------|------------------|---|--------------------|------------------|
| First Name | Last Name | Assignment | Building | Effective |
| Abigail | Akyigyina | CID Para | Eagle Point | 3/4/16 |
| Cyrus | Butler | Grant Support A | Tartan High School | 3/1/2016 |
| Steve | Carlson | Head Engineer | Webster Elementary | 2/22/2016 |
| Alejandro | Diez | Behavior Intervention Specialist | Castle Elementary | 3/17/2016 |
| Dwyn | Guse | Grant Support A | North High School | 3/1/2016 |
| Margaret | John | Breakfast Monitor | Richardson | 6/9/16 |
| Margaret | John | Lunch/Playground Monitor | Richardson | 6/9/16 |
| Margaret | John | Building EA | Richardson | 6/9/16 |
| Lauren | Joslin | FS III - Cafeteria Assistant (Short Hour) | North High School | 3/4/2016 |
| Brian | Kelly | Lunch/Playground Monitor | Castle | 2/26/16 |
| Elizabeth | Klein | Wold Language/Spanish Teacher | Tartan | 6/10/16 |
| Susanne | Legato | EL Teacher | Eagle Point | 6/10/16 |
| Cha'Rell | Lindgren | PT Bus Driver | Bus Garage | 2/18/2016 |
| Michelle | Noha | LSN - Health Services Lead | District Wide | 6/10/16 |
| Melissa | Ogden | Grade 4 Teacher | Castle | 6/10/16 |
| Valerie | Osmundson | Grade 3 Teacher | Skyview Elementary | 6/10/16 |
| Ashley | Redmon | CREED Para | Tartan | 3/4/16 |
| David | Retka | Tech Ed Teacher | Skyview Middle | 6/10/16 |
| Dianne | Sandberg | Teacher - World Language | North | 2/11/16 |
| Joshua | Young | CREED Para | Richardson | 3/3/16 |

| Termination | | | | |
|--------------------|------------------|-------------------|-----------------|------------------|
| First Name | Last Name | Assignment | Building | Effective |
| Michael | Napoli | PT Bus Driver | Bus Garage | 2/1/16 |
| Kim | Washington | PT Bus Driver | Bus Garage | 2/10/16 |

BID/RFP CALENDARS

| <u>NAME OF BID</u> | <u>BID OPENING</u> | <u>BOARD MEETING</u> |
|--|--|----------------------|
| DISTRICT WIDE ROOF REPAIR & REPLACEMENT WIDE – LONG TERM MAINTENANCE FACILITY PLAN | 3/8/2016 2:00 P.M. Room 101 Board Room/East | 3/15/2016 |
| BOILER REPLACEMENT – SKYVIEW COMMUNITY SCHOOL WIDE – LONG TERM MAINTENANCE FACILITY PLAN | 4/14/2016 2:00 P.M. Room 202 | 4/26/2016 |
| COWERN ELEMENTARY & JOHN GLENN MIDDLE SCHOOL DOMESTIC WATER PIPING REPLACEMENT WIDE-LONG TERM MAINTENANCE FACILITY PLAN | 4/14/2016 2:00 P.M. Room 202 | 4/26/2016 |
| FIBER OPTIC NETWORK & SERVICE – DISTRICT WIDE | 1/26/2016 1:00 P.M. Room 202 | 4/26/2016 |
| CRAWL SPACE ABATEMENT – COWERN ELEMENTARY SCHOOL | 4/14/16 10:00 A.M. Room 211A | 4/26/2016 |

| <u>NAME OF RFP</u> | <u>RFP DUE DATE/TIME</u> | <u>BOARD MEETING</u> (if applicable) |
|--|-----------------------------------|---|
| STUDENT TRANSPORTATION SERVICES FOR ISD 622 | 4/4/2016 9:30 A.M. Room 202 | 4/26/2016 |
| | | |

“Notice to Bidders” can be found on ISD 622 website at www.isd622.org. Click on “New Bid/RFP Posted” Quick Link to see a complete listing of Bids and RFPs.

Note: RFP’S have a due date/time only. There is not a formal opening or reading of the proposals unless noted. Bids have a due date/time and room location for the formal opening and reading of the bids.

V. D. CONTRACT AWARD - STRATEGIC PLAN CONSULTANT

The School Board intends on engaging internal and external stakeholders in a strategic planning process that results in a shared vision for the future, measurable outcomes, and clear strategies for improvement which all lead to aligned decision-making. Further, the School Board would like to approve a strategic plan by the end of 2016.

Therefore, the Assistant Superintendent recommends the following resolution:

BE IT RESOLVED by the School Board of Independent School District No. 622 that Transformation Systems, LTD be approved as the consultant to support the district's strategic planning process beginning March 2016.

IV. X. BID AWARDS

Sealed bids were solicited as required by law for goods and services listed below. The bids were opened and tabulated by the Business Office and are recommended for award to the lowest responsible bidders. Bid tabulations are on file in the Business Office.

Therefore, the Director of Business Services recommends the following resolution:

BE IT RESOLVED by the School Board of Independent School District No. 622 that contracts be awarded as follows:

| <u>For</u> | <u>Vendor</u> | <u>#Bids</u> | <u>Fund</u> | <u>Amount</u> |
|---|-------------------------|--------------|-------------|----------------|
| 2016-2017 Roof Replacement & Repair Projects – Base bid plus Add #1 and Add #2 | Berwald Roofing Company | 5 | 06 | \$2,272,000.00 |
| | | | | |
| | | | | |
| | | | | |



THE GARLAND COMPANY, INC.

HIGH PERFORMANCE BUILDING ENVELOPE SOLUTIONS

3800 EAST 91ST. STREET • CLEVELAND, OHIO 44105-2197

PHONE: (216) 641-7500 • FAX: (216) 641-0633

NATIONWIDE: 1-800-321-9336

BRIAN SKOOG Phone: (612) 810-4336

E-Mail: bskoog@garlandinc.com

March 8, 2016

Vicky Kornegor
Supervisor of Purchasing
ISD 622 School District
2520 East 12th Avenue
North St. Paul, MN 55109
RE: 2016 Districtwide Roof Project Letter of Recommendation

Dear Ms. Kornegor,

On Tuesday March 8th, 2016 at 2:00 PM sealed bids were opened for the 2016 districtwide roof project at ISD 622, N. St Paul Public School District.

After review of the bid results and a review of the districts' long term facility goals it is the recommendation to approve COMBINATION BID #1 which includes Line items #1, #2, #3 as well as ADD items #1 and #2 to the successful bidder. These projects are for re-roofing and wall remediation at North Senior High School, re-roofing at Beaver Lake Elementary and repair and maintenance at Webster Elementary and Weaver Elementary. (see attached roof diagram)

The low qualified bidding roof contractor for all roof areas is Berwald Roofing Company from N. St. Paul, MN. It is the recommendation to award the roofing project to Berwald Roofing Company for the **total bid amount of \$\$2,272,000. (Combination Bid #1)**

Berwald Roofing Company has submitted all of the required paperwork along with their bid form as required by the project specifications and the State of MN. Berwald Roofing Company is a long standing, qualified roofing contractor that has completed numerous successful installations for the N. St. Paul School District over many years.

If you have any further questions or require further assistance please feel free to contact me at 612-810-4336.

Thank you,

The Garland Company

ISD 622 - N. ST PAUL School District - 2016 Roof Project
Roof Bid Results
Tuesday March 8th, 2016 2:00 PM

| <u>COMPANY</u> | Line Item #1 - North High A,B,C,D,E,F,G,H | ADD#1 - North High Wall panels | Line Item #2 - Beaver Lake D,O | ADD#2 - Beaver Lake Section B | Line Item #3 - Repairs/Maintenance Weaver and Webster Elementaries | Combination Bid #1 - Line Item #1, #2, #3 and Add #1 and Add #2 | Combination Bid #2 - Line Item #1, #2, ## and Add #2 | Unit Price for Deck Repair sq ft | Man/Hr Rate | Unit Price Wet Insulation brd. ft. | Unit Price Drain Replacement | Bid Bond | Responsible Contractor/ Non-Collusion Form | Addendum Acknowledgment |
|--------------------------------|---|--------------------------------|--------------------------------|-------------------------------|--|---|--|----------------------------------|-------------|------------------------------------|------------------------------|----------|--|-------------------------|
| McPhillips Roofing | \$1,780,000 | \$77,000 | \$279,000 | \$112,000 | \$117,000 | \$2,363,000 | \$2,286,000 | \$10.00 | \$85.00 | \$2.50 | \$550 | X | X | X |
| Peterson Roofing | \$1,815,000 | \$74,100 | \$273,600 | \$109,200 | \$123,750 | \$2,395,000 | \$2,320,000 | \$9.00 | \$99.50 | \$2.25 | \$1,250 | X | X | X |
| John Dalsin Roofing | \$2,145,000 | \$113,600 | \$340,000 | \$148,000 | \$163,000 | \$2,909,600 | \$2,796,000 | \$9.00 | \$118.00 | \$2.25 | \$550 | X | X | X |
| Ettel and Franz Roofing | \$1,975,000 | \$84,600 | \$292,700 | \$116,000 | \$123,000 | \$2,590,000 | \$2,500,000 | \$16.00 | \$115.00 | \$1.70 | \$800 | X | X | X |
| Berwald Roofing | \$1,738,300 | \$68,600 | \$262,100 | \$102,700 | \$102,800 | <u>\$2,272,000</u> | \$2,203,000 | \$30.00 | \$100.00 | \$2.50 | \$700 | X | X | X |

2016 Roof Replacement & Maintenance Repairs

North Senior High School

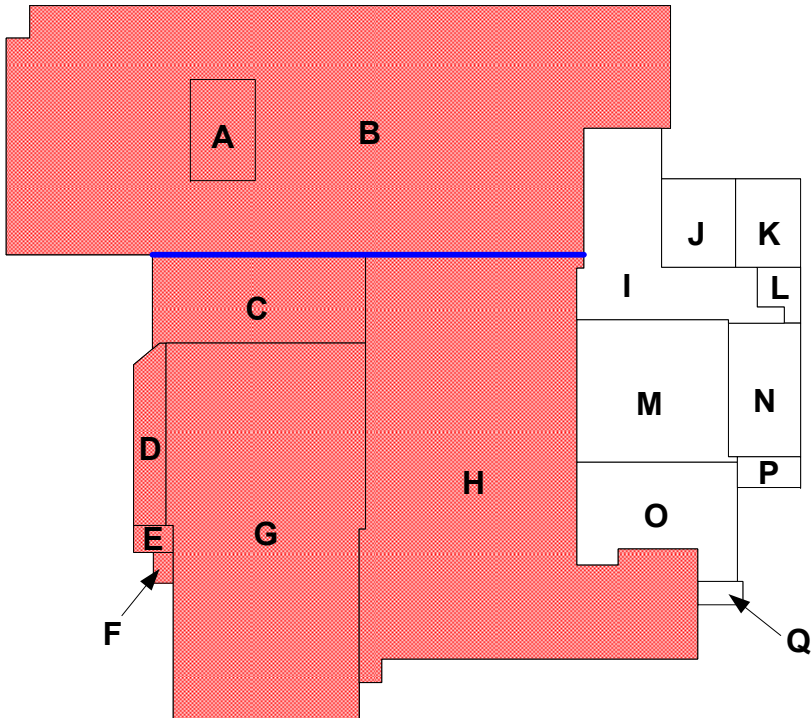

Line Item #1
Roof Replacement

Add #1
Wall Panels

Line Item #2
Roof Replacement

Line Item #3
Maintenance Repairs

Beaver Lake Elementary School

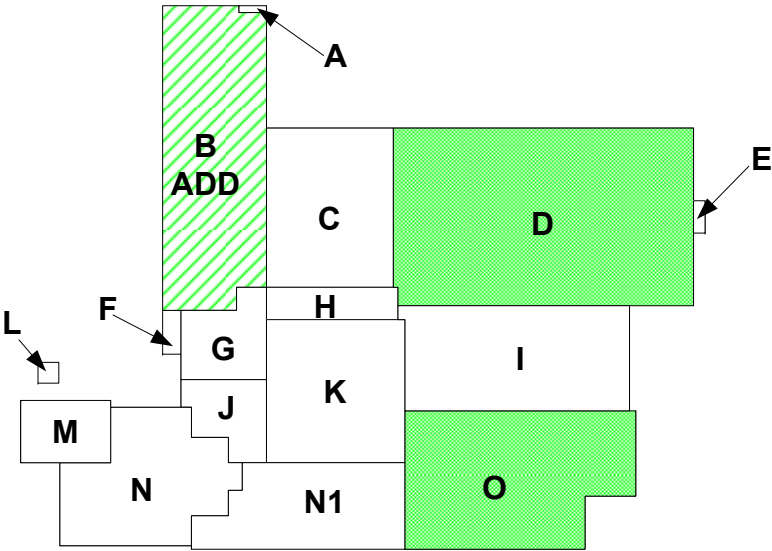

Webster Elementary School

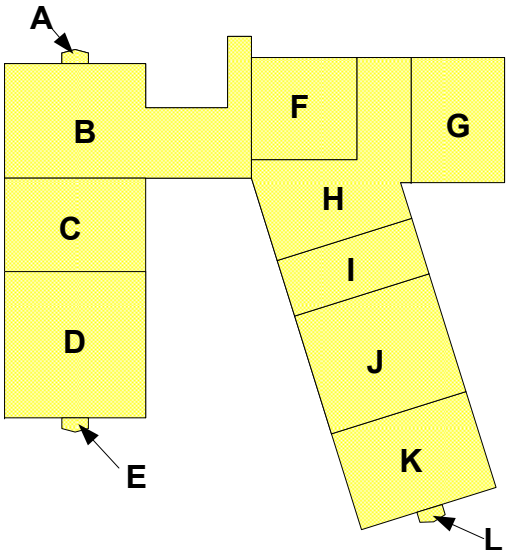

Weaver Elementary School

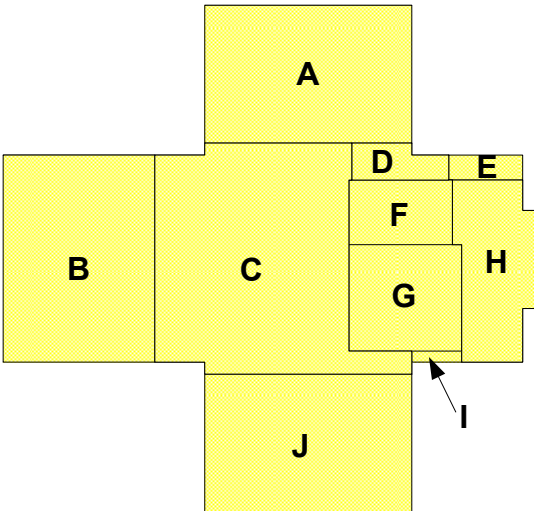

| | |
|---|--------|
| TITLE: 2016 Roof Replacement Project | |
| COMPANY: North St. Paul / Maplewood School District | |
| DATE: 2-22-16 | |
| DRAWING SCALE: | N.T.S. |

V. F. DISBURSEMENTS

State statutes require school boards to provide for payment of just claims and also require that a list of electronic fund transfers be submitted to the school board at its next regular meeting. This action will authorize payment of audited and allowable claims, purchase of investments, transfers to the payroll account, and transactions by electronic fund (wire) transfers.

Therefore, the Director of Business Services recommends the following resolution:

BE IT RESOLVED by the School Board of Independent School District No. 622 that the following disbursements and transfers be approved:

| | | |
|--|----|---------------|
| General Fund | \$ | 1,859,595.00 |
| Food Service | | 369,079.00 |
| Community Service | | 107,194.00 |
| Building | | 359,377.00 |
| Debt Redemption | | 0.00 |
| Trust | | 57,498.00 |
| Internal Service Fund Health Insurance | | 24,978.00 |
| OPEB Benefits Trust | | 13,402.00 |
| | | <hr/> |
| A/P Checks Disbursed (02-01-16 thru 02-29-16) | \$ | 2,791,123.00 |
| Payroll Disbursed - Net (02-01-16 thru 02-29-16) | \$ | 4,253,565.00 |
| Wire Transfers (02-01-16 thru 02-29-16) | \$ | 15,345,533.00 |
| Investments on 03-08-16 | \$ | 30,036,577.00 |

NORTH ST PAUL - MAPLEWOOD - OAKDALE SCHOOLS

INVESTMENTS

| DEPOSITORY | TYPE | RATE | PURCHASED | MATURES | AMOUNT |
|---------------------------------------|---------|-------|-----------------------|---------|------------------------|
| MSDLAF OTHER FUNDS | MM | 0.02% | (BALANCE AT 03-08-16) | | \$176,693.00 |
| P M A SECURITIES OPERATING FUNDS | VARIOUS | 0.04% | (BALANCE AT 03-08-16) | | \$15,092,010.00 |
| P M A SECURITIES OPEB BONDS | VARIOUS | 0.04% | (BALANCE AT 03-08-16) | | \$13,378,582.00 |
| ASSOCIATED BANK EQUITY INVESTMENTS | EQUITY | 1.30% | (BALANCE AT 03-08-16) | | \$1,389,292.00 |
| | | | | | <u>\$30,036,577.00</u> |

NORTH ST PAUL - MAPLEWOOD - OAKDALE SCHOOLS

WIRE TRANSFERS

02-01-16 thru 02-29-16

| DATE | FROM | TO | | REASON |
|----------|--------------|-------------------|------------------------|--------------------|
| 02/01/16 | PREMIER BANK | DELTA DENTAL | \$127,933.00 | MONTHLY PAYMENT |
| 02/01/16 | PREMIER BANK | HEALTH PARTNERS | \$234,317.00 | HEALTH CLAIMS |
| 02/01/16 | PREMIER BANK | STATE OF MINN. | \$126,096.00 | PAYROLL TAX |
| 02/04/16 | P M A | PREMIER BANK | \$1,000,000.00 | A/P - P/R* |
| 02/05/16 | PREMIER BANK | ANNUITY COMPANIES | \$712,201.00 | PAYROLL PAYABLES |
| 02/08/16 | PREMIER BANK | HEALTH PARTNERS | \$261,853.00 | HEALTH CLAIMS |
| 02/09/16 | PREMIER BANK | BANKCARD | \$6,256.00 | CREDIT CARD FEES |
| 02/11/16 | PREMIER BANK | PITNEY BOWES | \$3,000.00 | POSTAGE |
| 02/12/16 | P M A | PREMIER BANK | \$4,040,000.00 | A/P - P/R* |
| 02/12/16 | PREMIER BANK | CORPORATE HEALTH | \$10,744.00 | FLEX PROCESSING |
| 02/12/16 | PREMIER BANK | I R S | \$799,639.00 | PAYROLL TAX |
| 02/16/16 | P M A | HEALTH PARTNERS | \$234,041.00 | MEDICAL CLAIM FEES |
| 02/16/16 | PREMIER BANK | CORPORATE HEALTH | \$10,046.00 | FLEX PROCESSING |
| 02/16/16 | PREMIER BANK | HEALTH PARTNERS | \$181,772.00 | HEALTH CLAIMS |
| 02/16/16 | PREMIER BANK | STATE OF MINN. | \$124,681.00 | PAYROLL TAX |
| 02/19/16 | P M A | PREMIER BANK | \$1,000,000.00 | A/P - P/R* |
| 02/19/16 | PREMIER BANK | ANNUITY COMPANIES | \$737,572.00 | PAYROLL PAYABLES |
| 02/19/16 | PREMIER BANK | CORPORATE HEALTH | \$38,276.00 | FLEX PROCESSING |
| 02/22/16 | PREMIER BANK | CORPORATE HEALTH | \$13,440.00 | FLEX PROCESSING |
| 02/22/16 | PREMIER BANK | HEALTH PARTNERS | \$437,771.00 | HEALTH CLAIMS |
| 02/25/16 | P M A | PREMIER BANK | \$4,137,000.00 | A/P - P/R* |
| 02/29/16 | PREMIER BANK | ANNUITY COMPANIES | \$35,918.00 | PAYROLL PAYABLES |
| 02/29/16 | PREMIER BANK | CORPORATE HEALTH | \$10,642.00 | FLEX PROCESSING |
| 02/29/16 | PREMIER BANK | HEALTH PARTNERS | \$233,383.00 | HEALTH CLAIMS |
| 02/29/16 | PREMIER BANK | I R S | \$827,361.00 | PAYROLL TAX |
| 02/29/16 | PREMIER BANK | MISCELLANEOUS | \$1,591.00 | MISCELLANEOUS |
| | | TOTAL | <u>\$15,345,533.00</u> | |

* TO COVER ACCOUNTS PAYABLE OR PAYROLL CHECKS

NORTH ST PAUL - MAPLEWOOD - OAKDALE SCHOOLS

WIRE TRANSFERS

02-01-16 thru 02-29-16

| DATE | FROM | TO | | REASON |
|----------|--------------|-------------------|-----------------|--------------------|
| 02/16/16 | P M A | HEALTH PARTNERS | \$234,041.00 | MEDICAL CLAIM FEES |
| | P M A | MSDLAF | | A/P P-CARD |
| 02/04/16 | P M A | PREMIER BANK | \$1,000,000.00 | A/P - P/R* |
| 02/12/16 | P M A | PREMIER BANK | \$4,040,000.00 | A/P - P/R* |
| 02/19/16 | P M A | PREMIER BANK | \$1,000,000.00 | A/P - P/R* |
| 02/25/16 | P M A | PREMIER BANK | \$4,137,000.00 | A/P - P/R* |
| | P M A | WELLS FARGO | | DEBT SERVICE |
| | P M A | US BANK | | DEBT SERVICE |
| 02/05/16 | PREMIER BANK | ANNUITY COMPANIES | \$712,201.00 | PAYROLL PAYABLES |
| 02/19/16 | PREMIER BANK | ANNUITY COMPANIES | \$737,572.00 | PAYROLL PAYABLES |
| 02/29/16 | PREMIER BANK | ANNUITY COMPANIES | \$35,918.00 | PAYROLL PAYABLES |
| | PREMIER BANK | ANNUITY COMPANIES | | PAYROLL PAYABLES |
| 02/09/16 | PREMIER BANK | BANKCARD | \$6,256.00 | CREDIT CARD FEES |
| 02/12/16 | PREMIER BANK | CORPORATE HEALTH | \$10,744.00 | FLEX PROCESSING |
| 02/16/16 | PREMIER BANK | CORPORATE HEALTH | \$10,046.00 | FLEX PROCESSING |
| 02/19/16 | PREMIER BANK | CORPORATE HEALTH | \$38,276.00 | FLEX PROCESSING |
| 02/22/16 | PREMIER BANK | CORPORATE HEALTH | \$13,440.00 | FLEX PROCESSING |
| 02/29/16 | PREMIER BANK | CORPORATE HEALTH | \$10,642.00 | FLEX PROCESSING |
| | PREMIER BANK | CORPORATE HEALTH | | FLEX PROCESSING |
| 02/01/16 | PREMIER BANK | DELTA DENTAL | \$127,933.00 | MONTHLY PAYMENT |
| 02/01/16 | PREMIER BANK | HEALTH PARTNERS | \$234,317.00 | HEALTH CLAIMS |
| 02/08/16 | PREMIER BANK | HEALTH PARTNERS | \$261,853.00 | HEALTH CLAIMS |
| 02/16/16 | PREMIER BANK | HEALTH PARTNERS | \$181,772.00 | HEALTH CLAIMS |
| 02/22/16 | PREMIER BANK | HEALTH PARTNERS | \$437,771.00 | HEALTH CLAIMS |
| 02/29/16 | PREMIER BANK | HEALTH PARTNERS | \$233,383.00 | HEALTH CLAIMS |
| 02/12/16 | PREMIER BANK | I R S | \$799,639.00 | PAYROLL TAX |
| 02/29/16 | PREMIER BANK | I R S | \$827,361.00 | PAYROLL TAX |
| | PREMIER BANK | I R S | | PAYROLL TAX |
| | PREMIER BANK | I R S | | ACA TAX |
| | PREMIER BANK | JP MORGAN | | P-CARD PURCHASES |
| 02/29/16 | PREMIER BANK | MISCELLANEOUS | \$1,591.00 | MISCELLANEOUS |
| | PREMIER BANK | NSPMOEA | | UNION DUES |
| | PREMIER BANK | NSPMOEA | | UNION DUES |
| 02/11/16 | PREMIER BANK | PITNEY BOWES | \$3,000.00 | POSTAGE |
| | PREMIER BANK | PITNEY BOWES | | POSTAGE |
| | PREMIER BANK | PITNEY BOWES | | POSTAGE |
| 02/01/16 | PREMIER BANK | STATE OF MINN. | \$126,096.00 | PAYROLL TAX |
| 02/16/16 | PREMIER BANK | STATE OF MINN. | \$124,681.00 | PAYROLL TAX |
| | PREMIER BANK | STATE OF MINN. | | MSRS CONTRIBUTION |
| | PREMIER BANK | STATE OF MINN. | | UC TAX |
| | | TOTAL | \$15,345,533.00 | |

* TO COVER ACCOUNTS PAYABLE OR PAYROLL CHECKS

V. G. RESOLUTION ENDORSING THE PROTECTION OF POLLINATORS

Representative Leon Lillie is seeking endorsement from cities and school districts to support his campaign to become a pollinator friendly community. Endorsement of Representative Lillie’s protection of pollinators aligns well with what we are currently doing in the District. We are working with the Ramsey-Washington Metro Watershed District constructing native prairie and rain gardens and have already been following the protocols for pollinator protection.

**RESOLUTION ENDORSING THE PROTECTION OF POLLINATORS AND
ENHANCEMENT OF POLLINATOR HABITAT**

WHEREAS, bees and other pollinators are integral to a wide diversity of essential foods including fruits, nuts, and vegetables; and

WHEREAS, native bees and honey bees are threatened due to habitat loss, pesticide use, pathogens and parasites; and

WHEREAS, recent research suggests that there is a link between pesticides that contain neonicotinoids and the die-off of plant pollinators , including honey bees, native bees, butterflies , moths, and other insects; and

WHEREAS, neonicotinoids are synthetic chemical insecticides that are similar in structure and action to nicotine, a naturally occurring plant compound; and

WHEREAS, the School Board finds it is in the public interest to demonstrate its commitment to a safe and healthy school district environment through the implementation of pest management practices in the maintenance of the school grounds, open spaces and District property.

NOW, THEREFORE, BE IT RESOLVED BY THE SCHOOL BOARD OF INDEPENDENT SCHOOL DISTRICT #622 AS FOLLOWS:

1. The School District shall undertake its best efforts to become a pollinator friendly district by undertaking best management practices in the use of plantings and pesticides in all public places within the District.

2. The School District shall refrain from the use of systemic pesticides on District property including pesticides from the neonicotinoid family and will request commercial applications are free of systemic pesticides including neonicotinoids.

3. The School District shall undertake its best efforts to plant flowers favorable to bees and other pollinators in the District's public spaces.

4. The School District shall undertake best efforts to communicate to District residents, employees and students the importance of creating and maintaining a pollinator friendly habitat.

District 622 Strategic Planning Needs

Organizational Overview

District 622 serves the communities of North St. Paul, Maplewood, Oakdale, and Landfall, as well as portions of Woodbury, Lake Elmo, and Pine Springs. Approximately twenty percent of the households have school aged children. There are approximately 11,000 students enrolled and 1,500 staff members.

Our district includes two early childhood sites, nine elementary schools, three middle schools, two high schools, four special program sites, two ice arenas, a bus garage, and the district education center.

There is a strong sense of tradition and history among many groups in the community. The original North High School was established in 1905. There is a vibrant main street in North St. Paul akin to a small town main street. Many staff grew up in the district. At the same time, the communities have undergone tremendous change in the last twenty years. There is a rich mosaic of cultures and languages that bring opportunities for new traditions and history.

2014-2015 Student Demographics

| | |
|---------------|---|
| 10,603 | 2014-2015 student enrollment |
| 348 | Number of homeless students attending District 622 |
| 52% | Students in District 622 who qualify for Free/Reduced Lunch |
| 50% | Students of color in District 622 |
| 11% | English Language Learners in District 622 |
| 57 | Number of Languages other than English spoken in District homes |

English Learners in ISD 622

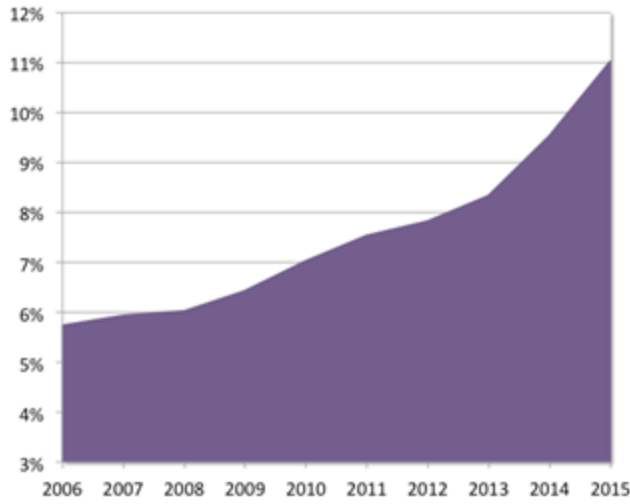

Students Receiving Free or Reduced Price Lunch in ISD 622

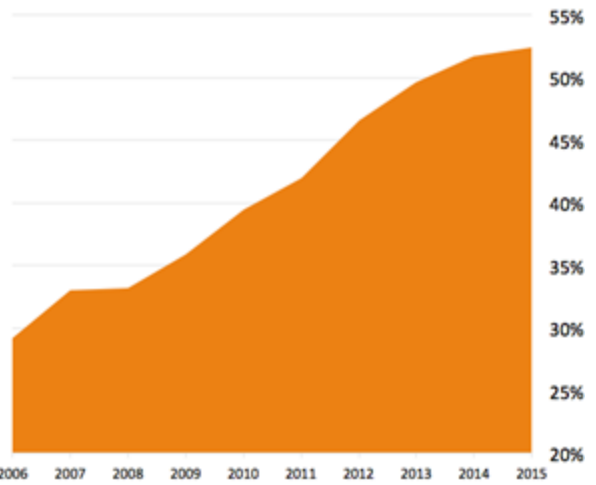

Student Groups in Neighboring Districts

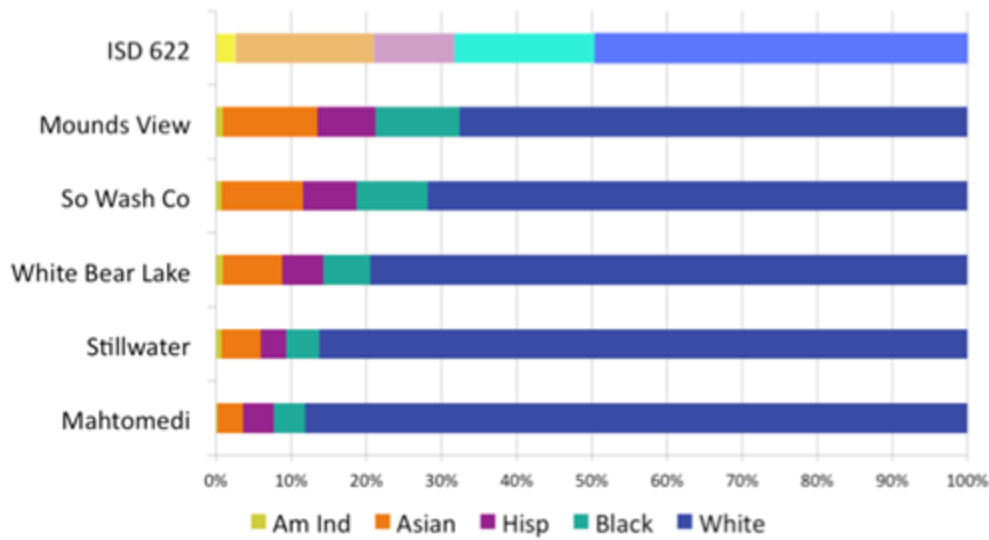

Student Achievement

Overall ISD 622 students performed better on the Minnesota Comprehensive Assessments (MCA) in math, reading and science in 2015 than they did in 2014.

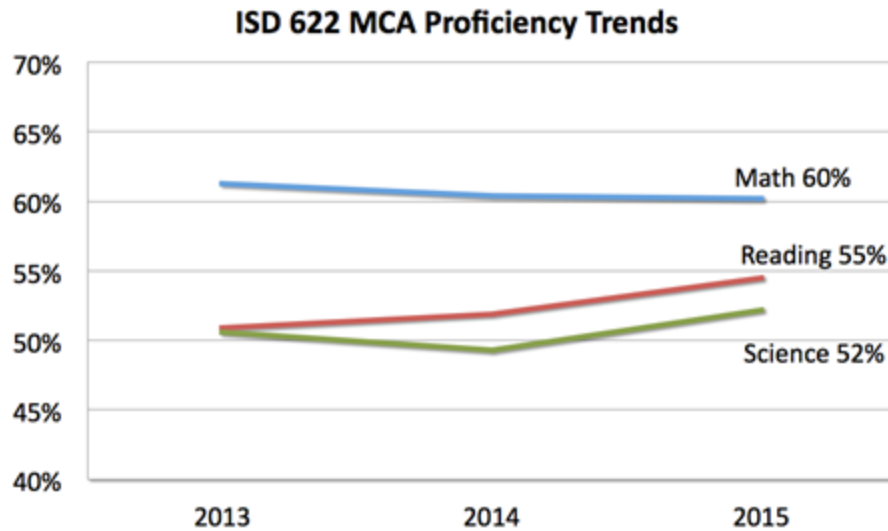

Math scores improved from 2014 to 2015 and overall proficiency in math was slightly better than the statewide average.

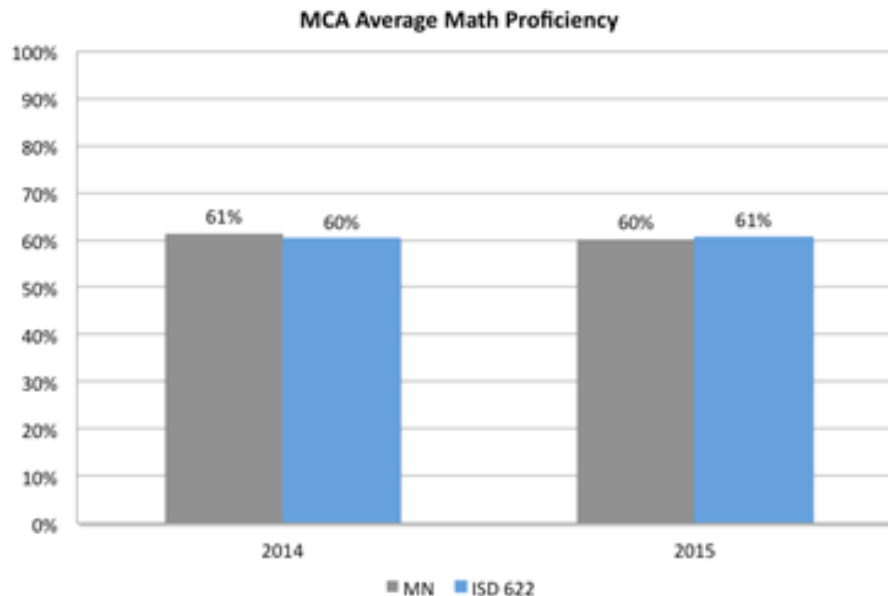

MCA Science proficiency increased three percent and came to within one percentage point of the statewide average in 2015.

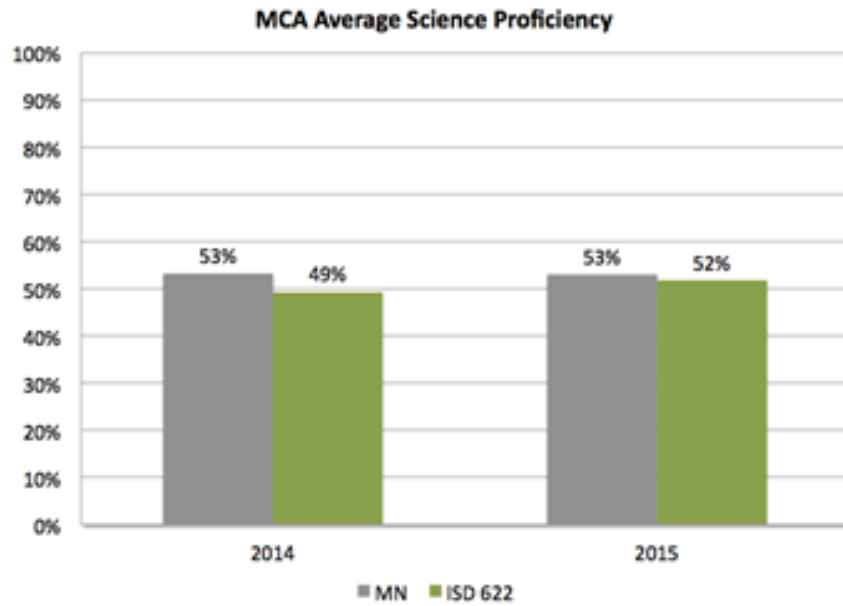

ISD 622 made a jump of three percentage points in reading while statewide results remained flat.

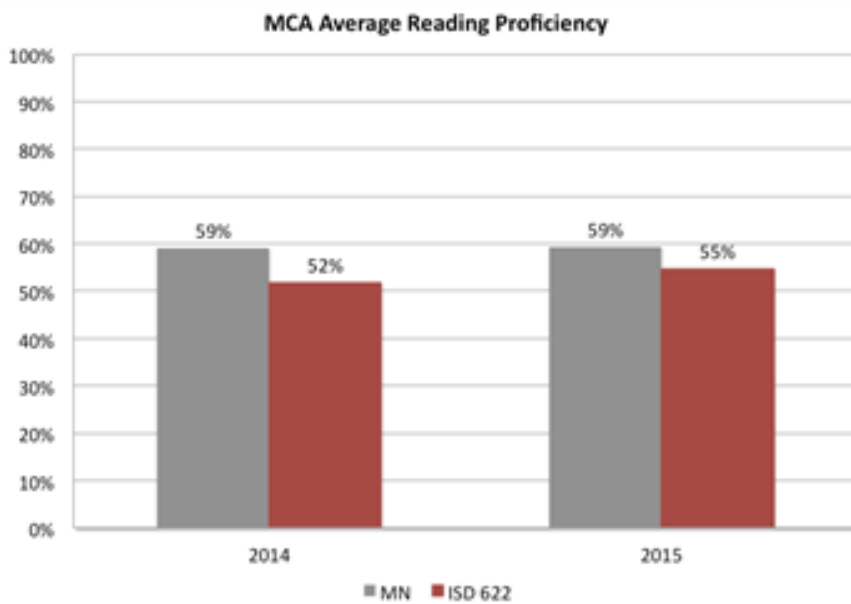

College and Career Ready

| % of 622 students with at least one college credit bearing experience | | | | |
|---|-------|-------|-------|-------|
| 2011 | 2012 | 2013 | 2014 | 2015 |
| 37.7% | 38.7% | 40.6% | 51.3% | 53.4% |

Achievement Gaps

The race-based achievement gap in the North St. Paul-Maplewood-Oakdale School District continues to remain significantly smaller than those experienced state-wide. The achievement gap is the difference in proficiency between white students and other race-based student groups.

In District 622, the achievement gap for students of color in Math is 17 percent and for the State of Minnesota the gap is 28 percent. In Reading, the achievement gap for students of color is 22 percent in District 622 and 28 percent in the State of Minnesota. And in Science, the achievement gap for students of color is 25 percent in District 622 and 31 percent in the State of Minnesota.

While the achievement gaps remain smaller than state levels, District 622 continues to work towards its goal of decreasing the gaps to no more than 10 percent by 2020.

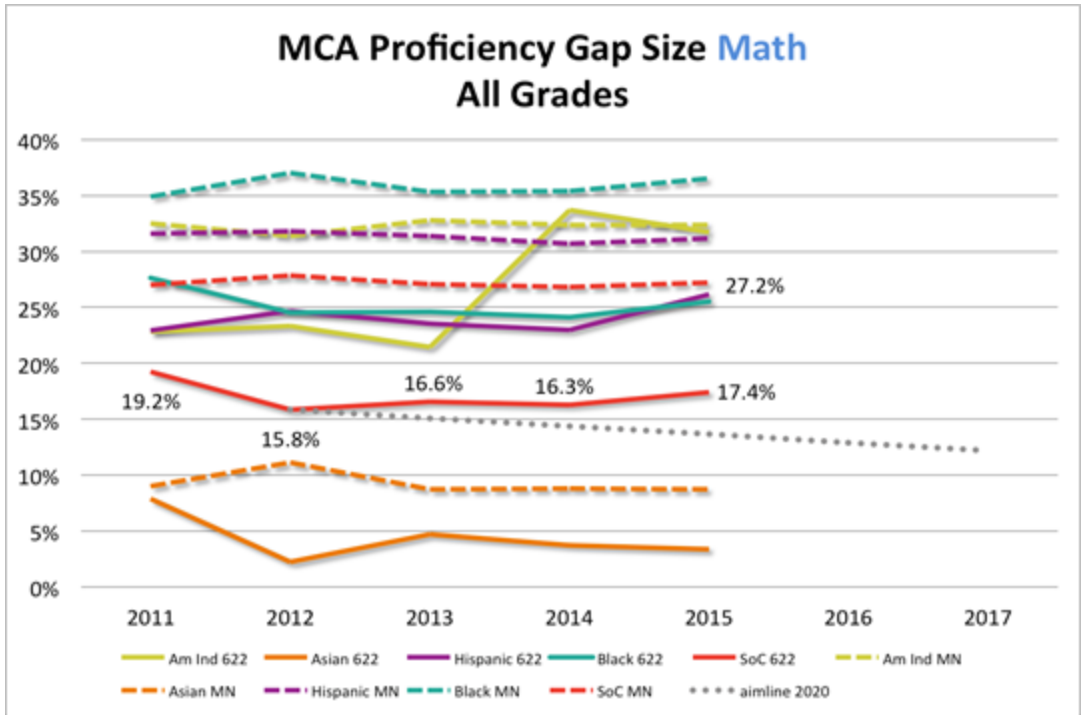

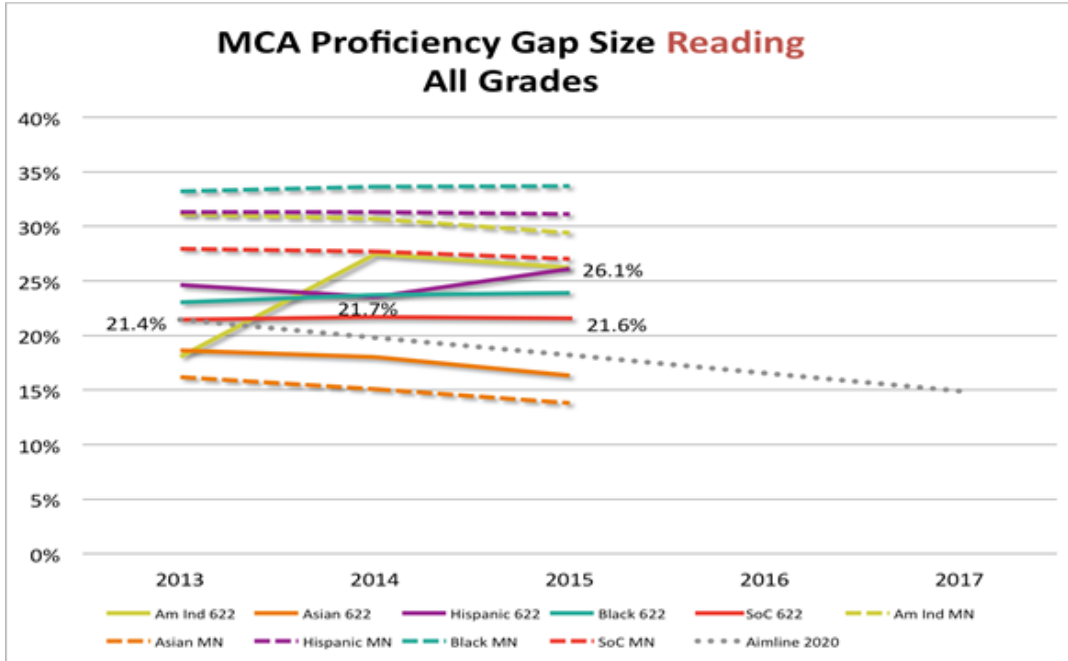

Graduation Rates

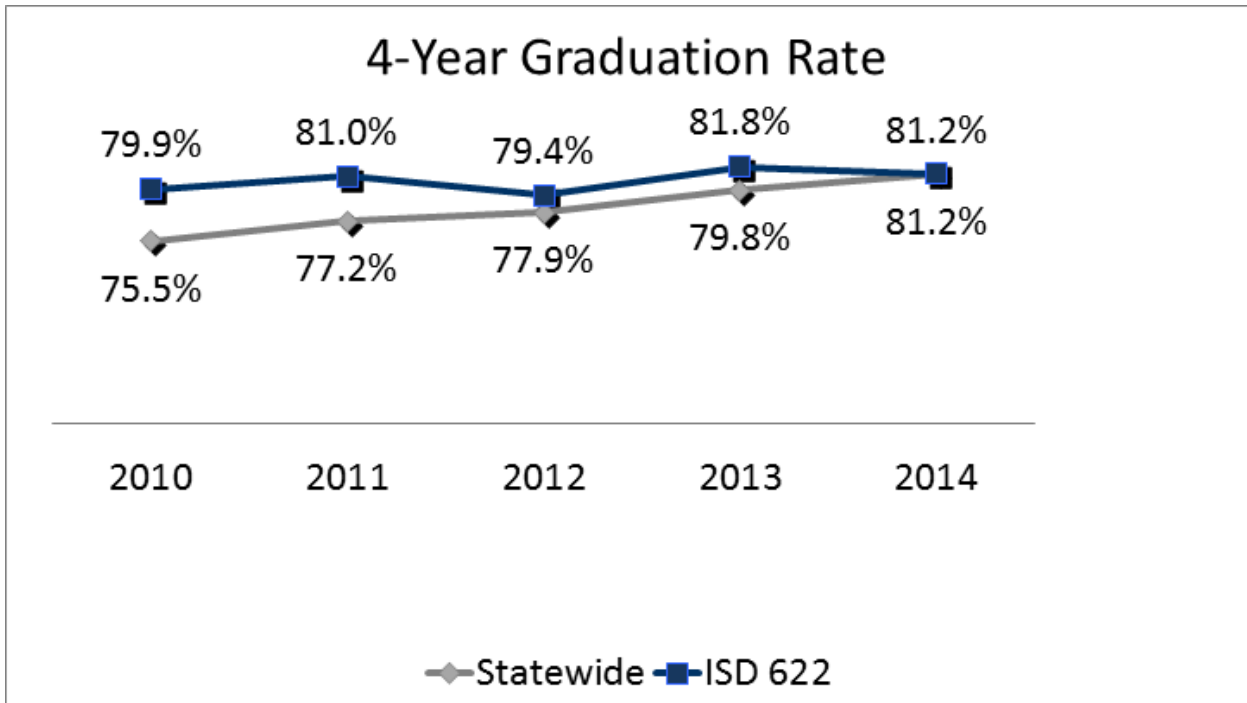

Financial Context

Over the past twelve years the North St. Paul, Maplewood, Oakdale School District has cut over 20 million dollars from its budget. Eight million was cut in the 2015-2016 budget alone.

District 622 has had to establish priorities and work extremely efficiently in order to maintain quality educational programming for students.

District 622 voters did not approve an operating levy referendum in November that would have increased the school district's per pupil referendum authority by \$900 to \$1813. A second question on the ballot related to technology was also not approved.

A Referendum Comparison

(2015 Referendum Authority per Pupil Unit)

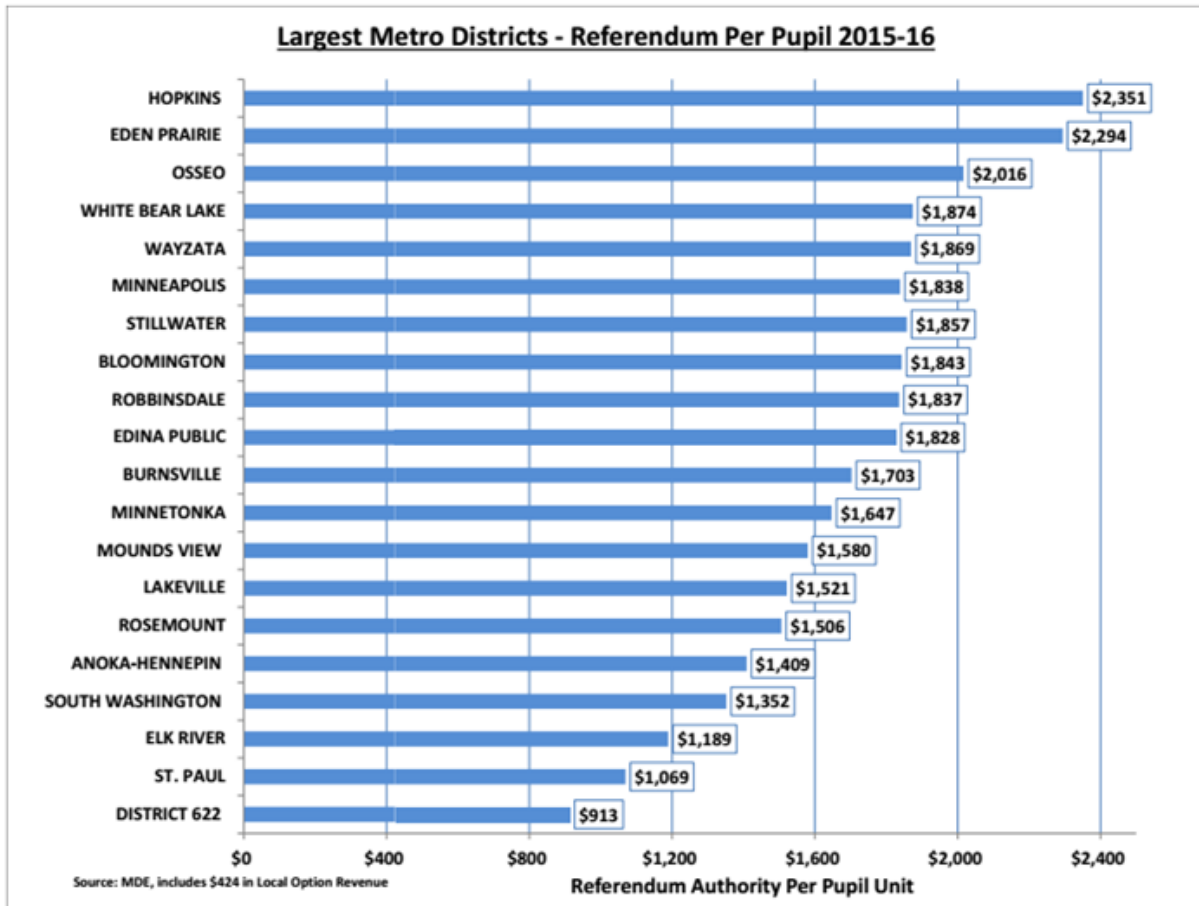

Purpose

District 622's current strategic plan was created in 2008 and renewed in 2011. Since that time the district has selected a new superintendent. We also face new financial challenges. The purpose of this strategic plan is to create a new vision for what the North St. Paul, Maplewood, Oakdale School District hopes to become in the next five years that reflects the needs and desires of our diverse community as well as our unique strengths.

The strategic plan will provide direction for the school board regarding governance and budget priorities. It will also guide the work of staff at the district, site, and team level.

Finally, the strategic plan will allow us to clearly communicate to our community and provide a tool for public accountability.

Principles

We expect the following principles to guide the work.

To Guide the Planning Process

- Engage multiple perspectives representative of our community population
- Ensure input from all staff within the work day; create safe spaces for authentic input
- Tap into informal leaders from all stakeholder groups
- Clear decision making process with roles of various stakeholders clearly communicated
- Recognize/celebrate success and what is working

To Guide the Strategic Plan Product

- Keep the focus narrow . . . we can't do it all
- Keep the focus on the needs of current and future students
- Unique to 622, capitalizing on our strengths, creating/reflecting our identity
- Measurable
- Can be used as a decision-making tool

To Guide Strategic Plan Implementation

- Action plans are aligned to the vision, goals, and strategies
- Continuous improvement – ongoing monitoring and adjusting of goals, strategies, and action plans
- Ongoing two way communication between stakeholders and decision makers
- Courage to release things we have done for years; "Let it go!"
- Clear roles and accountability

Goals and Objectives

- Creation of new vision that is measurable
- Creation of a new mission and values
- Clarity regarding our unique identity in the East Metro
- Paint a picture of success defined by attributes our students possess
- Develop a process and structure for the ongoing monitoring, adjusting, and communication of the plan including clear accountability for leadership and implementation

Deliverables

- Decision making process and clearly defined roles for various stakeholders in that process
- Needs assessment/Environmental scan
- Vision, mission, and values statements
- Statement of priorities
- 3-5 Measurable goals
- Strategies
- Template with detailed process for creating action plans that are aligned to the goals and strategies
- Interim briefings with an internal leadership team for monitoring and adjusting the process
- Plan for communication with internal and external stakeholders
- Plan for ongoing monitoring and adjusting the goals, strategies, and action plans

Scope of the Work

Goals will focus on the following areas:

- Learning for ALL - college and career pathways
- Climate, culture, and safety
- Equity
- Community/family partnerships
- Fiscal responsibility

Draft Timeline

| | |
|--------------------|--|
| February 8, 2016 | Needs statement distributed |
| Mid-late Feb, 2016 | Proposals accepted |
| Late Feb, 2016 | Consultant named |
| Early March, 2016 | Initial meeting with District 622 leadership |
| March-August, 2016 | Community and staff engagement |
| June-Oct, 2016 | Plan drafting and revision |
| Sept-Nov, 2016 | Draft communication and revision |
| December, 2016 | Plan adoption |
| Dec '16 - Aug '17 | 2017-2018 Action plan development |

| | |
|-------------------|--|
| 2017-2018 SY | Ongoing monitoring, adjusting, and communicating |
| Dec '17 - Aug '18 | 2018-2019 Action plan development |
| 2018-2019 SY | Ongoing monitoring, adjusting, and communicating |
| Dec '18 - Aug '19 | 2019-2020 Action plan development |
| 2019-2020 SY | Ongoing monitoring, adjusting, and communicating |
| Dec '19 - Aug '20 | 2020-2021 Action plan development |
| 2020-2021 SY | Ongoing monitoring, adjusting, and communicating |
| Dec '20 - Aug '21 | 2021-2022 Action plan development |
| 2021-2022 SY | Ongoing monitoring, adjusting, and communicating |

CAPITAL EXPENDITURE BUILDING ALLOCATIONS
BUILDING CAPITAL
2016-2017

| SCHOOL SITES | TOTAL ENROLLMENT | ALLOTMENT/ STUDENT | ALLOCATION | INITIAL 90% |
|-----------------------------|------------------|--------------------|------------------|------------------|
| ELEMENTARY SCHOOLS | | | | |
| ECSE - BEAVER LAKE | 100.00 | \$19.50 | \$1,950 | \$1,755 |
| CARVER | 493.00 | \$19.50 | \$9,614 | \$8,652 |
| CASTLE | 483.00 | \$19.50 | \$9,419 | \$8,477 |
| COWERN | 466.00 | \$19.50 | \$9,087 | \$8,178 |
| EAGLE POINT | 456.00 | \$19.50 | \$8,892 | \$8,003 |
| OAKDALE | 536.00 | \$19.50 | \$10,452 | \$9,407 |
| RICHARDSON | 481.00 | \$19.50 | \$9,380 | \$8,442 |
| SKYVIEW | 602.00 | \$19.50 | \$11,739 | \$10,565 |
| WEAVER | 522.00 | \$19.50 | \$10,179 | \$9,161 |
| WEBSTER | 401.00 | \$19.50 | \$7,820 | \$7,038 |
| TOTAL ELEMENTARY | | | \$88,530 | \$79,677 |
| MIDDLE SCHOOLS | | | | |
| JOHN GLENN | 733.00 | \$27.50 | \$20,158 | \$18,142 |
| MAPLEWOOD | 663.00 | \$27.50 | \$18,233 | \$16,409 |
| SKYVIEW | 816.00 | \$27.50 | \$22,440 | \$20,196 |
| ALC - M.S. | 82.00 | \$27.50 | \$2,255 | \$2,030 |
| TOTAL MIDDLE SCHOOLS | | | \$ 63,085 | \$ 56,777 |
| SENIOR HIGHS | | | | |
| NEXT STEP TRANSITION | 85.00 | \$27.50 | \$2,338 | \$2,104 |
| HARMONY | 85.00 | \$27.50 | \$2,338 | \$2,104 |
| NORTH | 1,780.00 | \$27.50 | \$48,950 | \$44,055 |
| TARTAN | 1,662.00 | \$27.50 | \$45,705 | \$41,135 |
| NORTH ATHLETICS | 1,780.00 | \$15.00 | \$26,700 | \$24,030 |
| TARTAN ATHLETICS | 1,662.00 | \$15.00 | \$24,930 | \$22,437 |
| TOTAL HIGH SCHOOLS | | | \$150,960 | \$135,864 |
| GRAND TOTAL | | | \$302,575 | \$272,318 |

CAPITAL EXPENDITURES
EQUIPMENT, TEXTBOOKS, TECHNOLOGY
2016-2017

| ORGANIZATION/PROGRAM | | ORIGINAL BUDGET 2015-2016 | REVISED BUDGET 2015-2016 | PROPOSED BUDGET 2016-2017 | \$ CHANGE |
|--|---|------------------------------|-----------------------------|------------------------------|-------------------|
| 005 | DISTRICT WIDE | | | | |
| | 020 Superintendent Office | 1,500 | 1,500 | 1,500 | 0 |
| | 030 Teaching & Learning | 1,500 | 1,500 | 1,500 | 0 |
| | 105 Human Resources | 1,500 | 1,500 | 1,500 | 0 |
| | 107 Communications - Emergency Calling System | - | - | - | 0 |
| | 108 Skyward Lease | - | - | - | 0 |
| | 108 Hardware Purchases | 40,000 | 40,000 | 40,000 | 0 |
| | 108 Software Licenses | 40,000 | 40,000 | 40,000 | 0 |
| | 108 Technology/Curriculum Replacement Cycle | 227,800 | 467,800 | 877,800 | 410,000 |
| | 108 Techs. From General to C.O. | 1,115,000 | 1,115,000 | 715,000 | (400,000) |
| | 108/810 Budget Adjustment - General to Capital Expenses | - | - | 500,000 | 500,000 |
| | 110 Business Office | 1,500 | 21,500 | 1,500 | (20,000) |
| | 110 Skyward Software | 4,500 | 4,500 | 25,000 | 20,500 |
| | 110 Purchasing Office - district-wide copier leases | 288,000 | 288,000 | 288,000 | 0 |
| | 258 Music/Instrumental | 11,250 | 11,250 | 15,000 | 3,750 |
| | 420 Student Services - General | 37,500 | 37,500 | 37,500 | 0 |
| | 610 Curriculum Development-Lang Arts Textbooks | - | - | - | 0 |
| | 620 Media Center Books/Materials | 24,000 | 24,000 | 32,000 | 8,000 |
| | 620 Educational Media | 10,500 | 10,500 | 14,000 | 3,500 |
| | 720 Health Services | 2,000 | 2,000 | 2,000 | 0 |
| | 810 Operations & Maint. - Building Repair | 88,740 | 88,740 | 110,000 | 21,260 |
| | 810 Classroom Furniture Replacement (CRS 016) | 45,900 | 45,900 | 60,000 | 14,100 |
| | 850 BL/Gladstone Overage/Trash Enclosure | - | - | - | 0 |
| | 850 Operations & Maint. Equipment | 27,000 | 27,000 | 36,000 | 9,000 |
| | 850 Operations & Maint. Site Improvement | 15,300 | 15,300 | 15,300 | 0 |
| | 110 Contingency | - | - | 24,444 | 24,444 |
| SUB-TOTALS - DISTRICT WIDE | | \$ 1,983,490 | \$ 2,243,490 | \$ 2,838,044 | \$ 594,554 |
| SCHOOLS | | | | | |
| | 026 ECSE | 1,560 | 1,560 | 1,950 | 390 |
| | 027 Carver | 10,101 | 10,101 | 9,614 | (488) |
| | 028 Castle | 9,263 | 9,263 | 9,419 | 156 |
| | 029 Cowern | 9,692 | 9,692 | 9,087 | (605) |
| | 030 Eagle Point | 8,366 | 8,366 | 8,892 | 527 |
| | 033 Oakdale | 10,179 | 10,179 | 10,452 | 273 |
| | 034 Richardson | 9,009 | 9,009 | 9,380 | 371 |
| | 035 Weaver | 9,497 | 9,497 | 10,179 | 683 |
| | 036 Webster | 8,249 | 8,249 | 7,820 | (429) |
| | 037 Skyview Elem. | 11,427 | 11,427 | 11,739 | 312 |
| | 040 ALC | 2,255 | 2,255 | 2,255 | 0 |
| | 041 Harmony Learning Center | 2,633 | 2,633 | 2,338 | (295) |
| | 043 Next Step - Transition | 1,788 | 1,788 | 2,338 | 550 |
| | 054 Skyview M.S. | 22,303 | 22,303 | 22,440 | 138 |
| | 055 John Glenn | 21,175 | 21,175 | 20,158 | (1,018) |
| | 056 Maplewood | 19,168 | 19,168 | 18,233 | (935) |
| | 057 North | 51,673 | 51,673 | 48,950 | (2,723) |
| | 058 Tartan | 45,485 | 45,485 | 45,705 | 220 |
| | 057 North Athletics | 8,000 | 11,500 | 26,700 | 15,200 |
| | 058 Tartan Athletics | 8,000 | 11,500 | 24,930 | 13,430 |
| | 076 Prairie Care | - | 8,000 | - | (8,000) |
| SUB-TOTALS - SCHOOLS | | \$ 269,818 | \$ 284,818 | \$ 302,575 | \$ 25,757 |
| GRAND TOTAL EXPENSES | | \$ 2,253,308 | \$ 2,528,308 | \$ 3,140,619 | \$ 620,311 |
| TOTAL ESTIMATED CAPTIAL REVENUE | | \$ 2,683,516 | \$ 2,683,516 | \$ 2,640,619 | |
| BEGINNING FUND BALANCE | | \$ (389,305) | \$ - | \$ 155,208 | |
| ESTIMATED ENDING FUND BALANCE | | \$ 40,903 | \$ 155,208 | \$ (344,791) | |

**CAPITAL EXPENDITURE BUDGET
GENERAL FUND
2016-2017
SUMMARY SHEET**

| Description | Account Code | Original | Revised | Original | \$ |
|---|--------------------------|---------------------|---------------------|---------------------|-------------------|
| | | FY 2015-2016 | FY 2015-2016 | FY 2016-2017 | |
| | | Budget | Budget | Budget | CHANGE |
| OPERATING LEASES | | | | | |
| Gymnastics | 01 E 005 850 000 302 370 | \$ 8,600 | \$ 8,600 | \$ 8,600 | \$ - |
| Golf | 01 E 005 850 000 302 370 | \$ 2,070 | \$ 2,070 | \$ 2,070 | \$ - |
| Next Step Program | 01 E 005 850 000 302 370 | \$ 307,450 | \$ 307,450 | \$ 307,450 | \$ - |
| | | \$ 318,120 | \$ 318,120 | \$ 318,120 | \$ - |
| LEASES - INTERMEDIATE 916 | 01 E 005 850 000 302 370 | \$ 275,000 | \$ 275,000 | \$ 275,000 | \$ - |
| CAPITALIZED LEASES | | | | | |
| Cowern/Richardson/Eagle Point | 01 E 005 850 000 302 370 | \$ 585,000 | \$ 585,000 | \$ 585,000 | \$ - |
| Oakdale Wing Lease From 916 | 01 E 005 850 000 302 370 | \$ 58,720 | \$ 58,720 | \$ 58,720 | \$ - |
| Oakdale Addition | 01 E 005 850 000 302 370 | \$ 184,913 | \$ 184,913 | \$ 188,688 | \$ 3,775 |
| Bus Garage | 01 E 005 850 000 302 370 | | | \$ 222,710 | \$ 222,710 |
| | | \$ 828,633 | \$ 828,633 | \$ 1,055,118 | \$ 226,485 |
| ASSESSMENTS | | | | | |
| Woodbury - Lake Elmo Economic Developme | 01 E 005 850 000 302 896 | \$ 386,032 | \$ 386,032 | \$ 343,818 | \$ (42,214) |
| SUB-TOTAL - Leases & Assessments | | \$ 1,807,785 | \$ 1,807,785 | \$ 1,992,056 | \$ 184,270 |
| SUB-TOTAL - District Wide and Building Allocations | | \$ 2,253,308 | \$ 2,528,308 | \$ 3,140,619 | \$ 612,311 |
| TOTAL - Lease/Capital Expenditure | | \$ 4,061,093 | \$ 4,336,093 | \$ 5,132,675 | \$ 796,581 |



44

School Linked Mental Health



School District 622

NORTH ST. PAUL | MAPLEWOOD | OAKDALE

Ready for tomorrow

1. Need for Services

2. 622 Partners

3. Student Participation

4. Services and Outcomes

45

Presentation Overview



School District 622

NORTH ST. PAUL | MAPLEWOOD | OAKDALE

Ready for tomorrow

Mental Health Facts

CHILDREN & TEENS

Fact: 1 in 5 children ages 13-18 have, or will have a serious mental illness.

46



20% of youth ages 13-18 live with a mental health condition

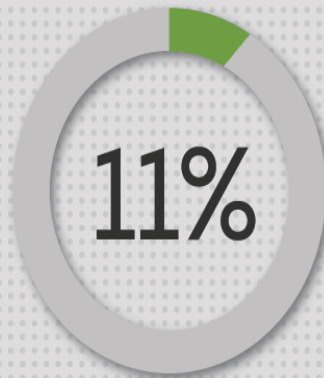

11% of youth have a mood disorder



10% of youth have a behavior or conduct disorder



8% of youth have an anxiety disorder

Mental Health Prevalence



School District 622

NORTH ST. PAUL | MAPLEWOOD | OAKDALE

Ready for tomorrow

During the past 12 months, have you had SIGNIFICANT problems with feeling very trapped, lonely, sad, blue, depressed, or hopeless about the future?

Percent of students responding "yes."

| Guide | | | | | |
|-------|----------|----|------------------------|----|--------------------------------|
| F | Female | NH | Not Hispanic | AI | American Indian/Alaskan Native |
| M | Male | A | Asian | ML | Multiple races |
| H | Hispanic | B | Black/African American | WO | White only |

| GRADE | GENDER* | HISPANIC* | BLACK | ASIAN* | MULTIPLE RACES* | OVERALL |
|------------------|---------|-----------|-------|--------|-----------------|------------|
| 5 th | | | | | | |
| 8 th | F | H | B | A | ML | 36% Yes |
| | M | NH | WO | WO | WO | |
| 9 th | F | H | B | A | ML | 29% Yes |
| | M | NH | WO | WO | WO | |
| 11 th | F | H | B | A | ML | 35% Yes |
| | M | NH | WO | WO | WO | |

ISD622 2013 MN Student Survey

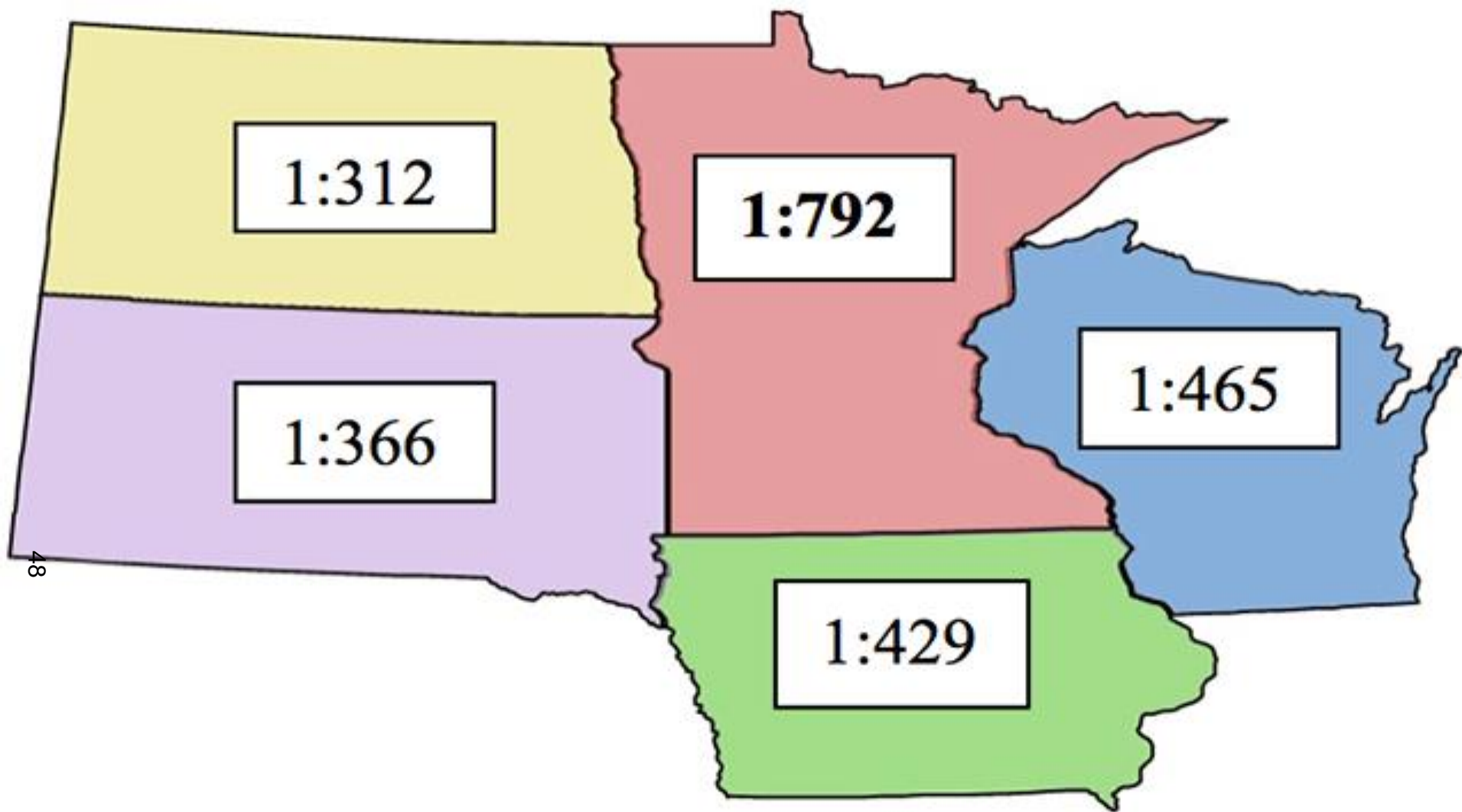

Regional School Counselor Ratios



School District 622

NORTH ST. PAUL | MAPLEWOOD | OAKDALE

Ready for tomorrow

School Counselors

- Rec Ratio = 1 to 250
- ISD 622 = 1 to 683

School Social Workers

- Rec Ratio = 1 to 250
- ISD 622 Ratio = 1 to 828

School Psychologists

- Rec. Ratio = 1 to 500
- ISD 622 Ratio = 1 to 1050

School Nurses

- Rec. Ratio = 1:750
- ISD Ratio = 1:1514

Student Need > Resources



School District 622

NORTH ST. PAUL | MAPLEWOOD | OAKDALE

Ready for tomorrow



50

School Linked Mental Health Program Partners



School District 622

NORTH ST. PAUL | MAPLEWOOD | OAKDALE

Ready for tomorrow

African American
Family Center for
Healing - 180
Degrees

CLUES
(Spanish for:
Comunidades Latinas
Unidas en Servicio)

Canvas Health**

People, Inc.

Family Means

Natilus

Northeast Youth and
Family Services

Resiliency Institute

Su Familia

Service Providers



School District 622

NORTH ST. PAUL | MAPLEWOOD | OAKDALE

Ready for tomorrow



- Tartan High
- Webster Elem
- Richardson Elem
- Weaver Elem
- Castle Elem



- North High
- John Glenn MS
- Skyview MS
- Oakdale Elem



- Tartan High
- Next Step
- John Glenn MS
- Maplewood MS
- Carver Elem
- Castle Elem

Buildings Served



School District 622

NORTH ST. PAUL | MAPLEWOOD | OAKDALE

Ready for tomorrow

Diagnostic
Assessment

Individual
Therapy

Family
Therapy

Parent
Consult

Teacher
Consult

53

Services Provided



School District 622

NORTH ST. PAUL | MAPLEWOOD | OAKDALE

Ready for tomorrow



110

Students
Served

1092

Therapy
Sessions

493

Parent
Contacts

2015 District Totals



School District 622

NORTH ST. PAUL | MAPLEWOOD | OAKDALE

Ready for tomorrow



60

Students
Served

418

Therapy
Hours

70%

Improved/
Stabilized

2015 District Totals



School District 622

NORTH ST. PAUL | MAPLEWOOD | OAKDALE

Ready for tomorrow

How are the Children?



Suburban Ramsey
Family Collaborative

86

Students Served

56

67%

Students of
Color

86%

Economically
at Risk

2015 District Totals



School District 622

NORTH ST. PAUL | MAPLEWOOD | OAKDALE

Ready for tomorrow

622 Staff Survey Results:

- *93% of staff reported students were benefitting from the services.*
- *“The opportunity for students who wouldn’t otherwise receive therapy services can access it in schools.”*

57

Stories From the Field



School District 622

NORTH ST. PAUL | MAPLEWOOD | OAKDALE

Ready for tomorrow

Parent Testimonials:

“I love that the therapist will come to the school. Helps so much rather than fighting with him to get the therapy”

“I really like the mental health provider as they work with the school staff. I am extremely happy with our progress.”

Stories From the Field



School District 622

NORTH ST. PAUL | MAPLEWOOD | OAKDALE

Ready for tomorrow

1. Growing Student Need
2. Strong Program Foundation
3. Evidence of Effectiveness
4. Future Expansion

59

Key Take Aways



School District 622

NORTH ST. PAUL | MAPLEWOOD | OAKDALE

Ready for tomorrow



69

Comments/Questions



School District 622

NORTH ST. PAUL | MAPLEWOOD | OAKDALE

Ready for tomorrow

North St. Paul/Maplewood/Oakdale School-linked Mental Health Services

| | | | | | | | | <i>District-Wide Services</i> | |
|---------------------------------|--------------------------------|--|--------------------------------|------------|------------------|------------------------|---------------------|----------------------------------|-----------------------------|
| <i>School</i> | <i>Agency</i> | <i>Provider</i> | <i>Building Contact Person</i> | <i>DHS</i> | <i>LSTS SLMH</i> | <i>District funded</i> | <i>Other funded</i> | <i>Enhance (Ramsey Co. only)</i> | <i>LCTS MH Case Manager</i> |
| Carver Elementary | Resiliency Institute | Molly Davis | Alison Scofield 702-8206 | | | | Yes | Yes | Yes |
| | CLUES | Micaela Cavuto | | Yes | | | | | |
| Castle Elementary | Natilus | Anna Crowley | Diane Peterson 748-6766 | | | | Yes | Yes | Yes |
| | Family Means | Libby Luecke | | Yes | | | | | |
| Cowern Elementary | Resiliency Institute | Lucy Steward | Carol Seidenkranz 748-6860 | | | | Yes | Yes | Yes |
| Eagle Point Elementary | Resiliency Institute | Lucy Stewart | Sari Malterud 702-8095 | | | | Yes | Yes | Yes |
| | Natilus | Vickie Wilhelm | | | | | Yes | Yes | Yes |
| Harmony Learning Center | People Inc. | Sara Benson Tom Staloch Rebecca Rustebakke | Sue Bartling 748-6210 | | Yes | Yes | District | Yes | Yes |
| John Glenn Middle School | Natilus | Aurthur Allen | Carol Seidenkranz 748-6332 | | | | Yes | Yes | Yes |
| | African American Family Center | Danny Hicks | | Yes | | | | | |
| | Su Familia/AAWI | Mary Ward | | Yes | | | | | |
| | Canvas | Beth Hopkins | | Yes | | | | | |
| | Clues | Whitney Nielsen-Perez | | Yes | | | | | |
| Maplewood Middle School | Resiliency Institute | Sarah Fuerst | Laura Kvamme 748-6631 | | | | Yes | Yes | Yes |
| | CLUES | Jesus Calvillo | | Yes | | | | | |
| North High School | Canvas | Torie? | Janice Yamamoto 748-6037 | Yes | | | | Yes | Yes |
| | Natilus | Lindsey? | | | | | Yes | Yes | Yes |

61

North St. Paul/Maplewood/Oakdale School-linked Mental Health Services

| | | | | | | | | | |
|--|---|-------------------------------|--------------------------------|------------|------------------|------------------------|---------------------|----------------------------------|-----------------------------|
| | | | | | | | | | |
| Oakdale Elementary | Canvas | Holly Richter | Jennie Kula 702-8506 | Yes | | | | Yes | Yes |
| Richardson Elementary | Family Means | Libby Luecke | Judy Aubrecht 748-6907 | Yes | | | Yes | Yes | Yes |
| School | Agency | Provider | Building Contact Person | DHS | LSTS SLMH | District funded | Other funded | Enhance (Ramsey Co. only) | LCTS MH Case Manager |
| Skyview Middle School | Resiliency Institute | Jocelyn Keller | Sari Malterud 702-8095 | | | | Yes | Yes | Yes |
| Tartan High School | African American Family Center | Danny Hicks Amanda Collier | Mike Hall 702-8696 | Yes | | | | Yes | Yes |
| | Family Means | Jamie Nupen | | Yes | | | | Yes | Yes |
| | Su Familia | Beatriz Carrillo | | Yes | | | Yes | Yes | Yes |
| Weaver Elementary | Family Means | Libby Luecke | Leah Trumper 748-7027 | Yes | | | | Yes | Yes |
| | Natalis | Hlee Lee | | Yes | | | | Yes | Yes |
| Webster Elementary | Family Means | Jessica Haas | Judy Aubrecht 748-7105 | Yes | | | | Yes | Yes |
| Next Step Transition Program | NE Counseling | Jael Were | Latoya Garrahan 621-1909 | | | | Yes | | |
| | Resiliency Institute | Nancy Jarrett | | | | | Yes | | |
| ISD 622 Mental Health Community Social Worker | Keystone Community Services Eric Jayne | Kendra Colon | Cory McIntyre 651-748-7452 | | | | | | Yes |

*to be determined if Natalis chooses to join the DHS grand and if approved by DHS.

Updated 3.3.16 CM/rn

ISD 622 Vetted Outside Therapists (as of 3.3.16)

| Company/Agency | Agreement Expires | Insurance Expires | Therapist / Intern | Background Check | License Expires | Working Under | Comment |
|----------------------|-------------------|-------------------|---------------------|------------------|-----------------|------------------------|---------------|
| Canvas Health | 10.5.16 | 11.1.15 | Rachel Freyberger | 9.12.14 | 7.31.15 | | |
| | | | Nick Widing | 10.25.16 | | Chemical Health | |
| | | | Sara Vogelpohl | 10.28.14 | Practitioner | Under Anne St. Martin | |
| | | | Amber Williams | 4.28.15 | Practitioner | Under Anne St. Martin | |
| | | | Megan Berling | 10.16.13 | Practitioner | Under Anne St. Martin | |
| | | | Rachel Milan | 5.1.15 | Practitioner | Under Anne St. Martin | |
| David Hoy & Assoc. | 9.3.15 | 7.1.16 | Samantha M. Schuman | 1.20.15 | Psych. Pract. | Under Todd Winkler | |
| Face to Face | 9.3.15 | 7.1.15 | Kate Pabst | 10.23.14 | Practitioner | Under Jennifer Hillman | |
| Family Innovations | 8.30.16 | 5.31.16 | Chong Maylee Chang | N/A | Practitioner | Under Kiley Krocak | CTSS Services |
| Note: Contract | | | Judith Hafner | N/A | Practitioner | Under Rebecca Mesman | |
| Under State | | | Brianna Maher | N/A | Practitioner | Under Meghan Swenson | |
| For CTSS Services | | | Sukay Polley | N/A | Practitioner | Under Kiley Krocak | |
| | | | Katherine Fleck | N/A | Practitioner | Under Lauren Moberg | |
| | | | Natassia Pavlov | N/A | Practitioner | Under Lauren Moberg | |
| | | | Tammy Janke | N/A | Practitioner | Under Meghan Swenson | |
| | | | Brittany Kiel | N/A | Practitioner | Under Pete Singer | |
| | | | Kerstin Gorham | N/A | Practitioner | Under Jordan Johnson | |
| | | | Zinaisha Lee | N/A | Practitioner | Under Jordan Johnson | |
| | | | Kristen Anderson | N/A | Practitioner | Under Pete Singer | |
| | | | Beth Nyenhuis | N/A | Practitioner | Under Pete Singer | |
| Lifeworks Counseling | 8.30.15 | 5.1.15 | Amy Wagener | 8.11.14 | 11.30.15 | | |
| | | | Sara Gogerty | 8.11.14 | 1.31.15 | | |
| | | | Sheila Dwyer | June, 2011 | 12.31.14 | | |
| Lisa Warner | Independent | 12.23.15 | SELF | Feb., 2015 | SSW | | |

| Company/Agency | Agreement Expires | Insurance Expires | Therapist/ Intern | Background Check | License Expires | Working Under | Comment |
|-----------------------|-------------------|-------------------|---|------------------|-----------------|---------------------------|-----------------------|
| Natalis Counseling | 6.30.15 | 1.1.15 | Arthur Allen | 11.13.14 | Resident Psych | Under Nicole Ward | |
| Northeast Counseling | 9.24.16 | 5.1.16 | Jael Were | 10.2.14 | 12.31.14 | | |
| | | | Deb Kratz | 10.2.14 | 12.31.15 | | |
| | | | Mike Hall | ISD 622 Employee | 6.30.16 | | |
| | | | Amy Brown | Feb., 2015 | 12.31.15 | | |
| | | | Tim Scott | 9.25.15 | 1.31.15 | | |
| | | | Amy Brown | 2.9.15 | 12.31.16 | | |
| | | | Sarah Lilja | ISD 622 Employee | 5.31.15 | | |
| Nystrom & Associates | 1.5.16 | 9.1.16 | Eileen Peterson | 9.16.15 | Practitioner | Under Nic Brave | |
| | | | Christine Wielgos | 10.8.13 | Practitioner | Under Nic Brave | |
| | | | Shia Vang | 11.7.14 | Practitioner | Under John Wolff | |
| People, Inc. | 6.13.15 | 4.1.16 | Sara Benson Tom Staloch Rebecca Rustebakke | | | | Located at Harmony |
| Resiliency and Health | 3.4.16 | 1.1.16 | Katherine Anderson | 3.9.15 | Practitioner | Under Sara Fuerst | |
| | | | Kimberly Swinson- Stafford | 12.31.16 | Practitioner | Under Sara Fuerst | |
| | | | Lucy Stewart | 8.13.15 | Practitioner | Jennifer Loewen Itskovich | |
| | | | Nancy Jarrett | 8.13.15 | Practitioner | Kimberly Swinson-Stafford | |
| | | | Molly Davis | 8.13.15 | Practitioner | Kate Rickford | |
| | | | Jocelyn Keller | 9.30.15 | Practitioner | Kate Rickford | |
| | | | Suzanne Barker | 2.3.16 | Practitioner | Under Kate Rickford | |
| Therapeutic Services | 12.14.16 | 6.8.16 | Amanda Hancock | 12.31.15 | Practitioner | Under Bruce O'Leary | |
| | | | | | | | |

Contact Student Services Office for vetting questions: Rhonda Nelson 748-7456 or email rnelson@isd622.org

VII. A. 1. ACKNOWLEDGEMENT OF CONTRIBUTIONS

Minnesota Statute 123B.02 permits school boards to "...receive, for the benefit of the district, bequests, donations, or gifts for any proper purpose and apply the same to the purpose designated. In that behalf, the board may act as trustee of any trust created for the benefit of the district, and for the benefit of pupils thereof."

Therefore, the Director of Business Services recommends the following resolution:

BE IT RESOLVED by the School Board of Independent School District No. 622 that the School Board accept with appreciation the following contributions and permit their use as designated by the donors.

| <u>Donor</u> | <u>Item and/or Amount</u> | <u>Purpose</u> |
|--|---|--------------------------------------|
| American Legion Post 39 | \$250.00 | 5 th Grade Ski Trip |
| NSPMO Rotary Club | 768 Dictionaries (valued at \$1,920.00) | All ISD 622 3 rd Graders |
| Susan Purvis | \$20.00 | Gladstone Meals on Wheels |
| Amie DuFresne | \$200.00 | North High "Festival of Culture" |
| The Polar Club (North High Girls Hockey) | \$1,000.00 | North High Girls Hockey Jerseys |
| Duke and Amy Coborn | \$200.00 | Cowern Elementary - Koo Koo Kangaroo |
| Emunah Rankin | 2002 Volkswagon Jetta (valued at \$500.00) | North High Industrial Tech |
| Anonymous | \$100.00 | Webster COMET registration |
| Truist | \$84.64 | Maplewood Meals on Wheels |
| Shirley Strum | \$15.00 | Gladstone Meals on Wheels |
| Estee Wang, DMD Lakes Orthodontics | \$300.00 | John Glenn Math Carnival |
| Christa Waymire | \$50.00 | Harmony Pilot Program |

MOTION:

SECOND:

Total fiscal year 2015-2016 monetary contributions: \$188,242.98

VII. A. 2. RESOLUTION FOR THE ADOPTION OF THE 2016-2017 CAPITAL EXPENDITURES BUDGET

Each year the school board approves the Capital Expenditure Budget for the upcoming budget year. Attached is the proposed Capital Expenditures Budget for 2016-2017.

THEREFORE the Director of Business Services recommends the following resolution:

BE IT RESOLVED that the School Board of Independent School District No. 622 approve and adopt the 2016-17 Capital Expenditure Budget as per the attached 2016-17 Capital Budget Plan.

MOTION:

SECOND:

VII. A. 3. DISSOLUTION OF JOINT VALLEY CROSSING COMMUNITY SCHOOL AGREEMENT

This letter of agreement is entered into between North St. Paul - Maplewood - Oakdale Schools, South Washington County Schools, Stillwater Area Schools and Northeast Metropolitan Intermediate School District 916. The agreement outlines the actions to be taken by the districts and the resources necessary, "tail costs", to plan for a successful transition to a new administration and owner of the Valley Crossing Community School.

Therefore, the Director of Business Services recommends the following resolution:

BE IT RESOLVED by the School Board of Independent School District 622 that the Letter of Agreement is approved as exhibited, and further, that the School Board Chair and Clerk are authorized to sign the document attesting the Agreement.

MOTION:

SECOND:

LETTER OF AGREEMENT

THIS AGREEMENT is entered into between Independent School District No. 622, North St. Paul-Maplewood-Oakdale Schools, Independent School District No. 833, South Washington County Schools, and Independent School District No. 834, Stillwater Area Schools (hereinafter referred to as “Collaborating School District(s)”), and Northeast Metropolitan Intermediate School District 916 (hereinafter referred to as the “Intermediate District”) as follows:

1. PURPOSE AND BACKGROUND.

- A. Operation: The Collaborating School Districts and the Intermediate District are parties to an Amended and Restated Joint Powers Agreement, dated July 13, 1995 (“Joint Powers Agreement”), which provides a framework to govern the administration, financing and operation of a joint elementary school for the Collaborating School Districts, located in the City of Woodbury, Minnesota, and hereinafter to be referred to as the “Joint Elementary School.”
- B. Termination: The Joint Powers Agreement provides, among other things, for written notice to be given to terminate the duties of the Intermediate District to operate, manage, control and administer the Joint Elementary School. The Collaborating School Districts have each provided proper notice of termination of the Intermediate District’s duties, effective June 30, 2016.
- C. Withdrawal: Minn. Stat. §123A.33 provides for the withdrawal (or removal of a district’s students from a program of instruction) from a cooperative; and the Joint Powers Agreement provides, among other things, for the withdrawal of one or more

of the Collaborating School Districts from the Agreement. All Collaborating School Districts have taken School Board action indicating their intent to withdraw from the Joint Powers Agreement, and to withdraw or remove their respective students from the cooperative, which shall cease to exist, effective June 30, 2016.

2. AUDIT AND DISBURSEMENTS DURING TRANSITION PERIOD.

- A. The Joint Powers Agreement obligates the Collaborating School Districts to take such actions and to devote such resources as may be necessary to plan for a successful transition to a new administration for the Joint Elementary School and to address all related and resulting personnel, fiscal and educational issues.
- B. From July 1, 2016 through no later than December 31, 2016, the Intermediate District shall utilize the remaining capital and operating fund balances of the Joint Elementary School to pay accounts receivable and all other obligations of the Joint Elementary School, including, but not limited to, separation payments totaling Eighty-Four Thousand Dollars (\$84,000) for teachers employed by the Intermediate District prior to July 1, 2002 and who worked continuously at the Joint Elementary School through June 30, 2016. This separation payment shall be made for the benefit of each such teacher, only if such teacher is ineligible for severance from the Collaborating School District which employs the teacher immediately following June 30, 2016. Any such separation payments shall be deposited into each eligible teacher's account for the Post-Retirement Health Care Savings Plan, established by the Intermediate District, and administered by the Minnesota State Retirement System under Minn. Stat. §352.98.

- C. The Intermediate District shall provide to the Collaborating School Districts an accounting of the expenses and payments referred to in the immediately preceding Paragraph B. If there is any disagreement as to whether an expense is attributable to the Joint Elementary School and its fund balance(s), the signatories to this Letter of Agreement shall meet to discuss and resolve any such disagreement.
- D. The Intermediate District, through its auditors, shall conduct the annual audit of the Joint Elementary School for fiscal year 2016, which audit shall be completed by December 31, 2016.

3. FINANCIAL RESPONSIBILITY OF COLLABORATING SCHOOL DISTRICTS AFTER FINAL DISBURSEMENTS.

- A. The Joint Powers Agreement provides that its termination shall not affect the continuing liability of the Collaborating Districts for indebtedness incurred prior to the termination, or for other continuing obligations, including but not limited to, severance payments, unemployment compensation, reemployment insurance or workers compensation claims.
- B. No later than December 31, 2016, any remaining capital or operating fund balances attributable to the Joint Elementary School shall be disbursed by the Intermediate District to the Collaborating School Districts according to the pro rata percentage agreed upon by the Collaborating School Districts, after which the Intermediate District shall have no further legal or financial responsibilities or liabilities relating to any personnel, fiscal and educational issues of the Joint Elementary School.
- C. In the unlikely event that the outstanding indebtedness attributable to the Joint Elementary School exceeds the remaining fund balance of the School, the

Intermediate District shall invoice each Collaborating School District, according to the pro rata percentage agreed upon by the Collaborating School Districts, for any such outstanding indebtedness of any kind, including but not limited to, severance payments, unemployment compensation, reemployment insurance or workers compensation claims.

D. The Collaborating School Districts hereby acknowledge that “tail” costs exist relating to the Joint Elementary School, that they are individually and collectively responsible for such costs, and that the Intermediate District has no financial obligation or liability with respect to any costs associated with the Joint Elementary School or its transition to new management. To the extent that any outstanding indebtedness attributable to the Joint Elementary School remains or becomes known after December 31, 2016, even after the distribution of the remaining fund balance, the Intermediate District shall invoice each Collaborating School District, according to the pro rata percentage agreed upon by the Collaborating School Districts, for any such outstanding indebtedness of any kind.

IN WITNESS WHEREOF, the parties hereto caused this Agreement to be signed by their authorized chief executive signatories, and their signatures to be placed hereon.

Approved at the regular meeting
of the School Board thereof held
on the ___ day of _____, 2016.

INDEPENDENT SCHOOL DISTRICT NO. 622

By _____

Chair

By _____
Clerk

Approved at the regular meeting
of the School Board thereof held
on the ___ day of _____, 2016.

INDEPENDENT SCHOOL DISTRICT NO. 833

By _____
Chair

By _____
Clerk

Approved at the regular meeting
of the School Board thereof held
on the ___ day of _____, 2016.

INDEPENDENT SCHOOL DISTRICT NO. 834

By _____
Chair

By _____
Clerk

Approved at the regular meeting
of the School Board thereof held
on the ___ day of _____, 2016.

**NORTHEAST METROPOLITAN INTERMEDIATE
SCHOOL DISTRICT 916**

By _____
Chair

By _____
Clerk

VII. A. 4. RESOLUTION FOR MEAL PRICES FOR THE 2016-2017 SCHOOL YEAR

A price increase is necessary to support the increasing cost of food, supplies and gas; as well as to maintain compliance of the requirements of the Healthy, Hunger-Free Kids Act of 2010.

The following is a comparison of current to proposed prices for breakfast and lunch. The last meal price increases for breakfast and lunch was effective September 2014.

| <u>Increase</u> | <u>Present</u> | <u>Proposed</u> | |
|--------------------------------|----------------|-----------------|-------|
| Elementary Lunch | \$2.55 | \$2.60 | \$.05 |
| Secondary Lunch | \$2.80 | \$2.85 | \$.05 |
| Elementary/Secondary Breakfast | \$1.60 | \$1.70 | \$.10 |
| Adult Breakfast | \$1.85 | \$2.00 | \$.15 |

THEREFORE the Director of Business Services recommends the following resolution:

BE IT RESOLVED by the School Board of Independent School District 622 that the following meal prices become effective September 2016.

| | |
|----------------------|--------|
| Elementary lunch | \$2.60 |
| Secondary lunch | \$2.85 |
| Adult lunch | \$4.00 |
| Milk | \$.40 |
| Elementary breakfast | \$1.70 |
| Secondary breakfast | \$1.70 |
| Adult breakfast | \$2.00 |

MOTION:

SECOND:

MEAL PRICE COMPARISON 2016-17

| DISTRICT | ELEMENTARY | | SECONDARY | | ADULT | | MILK |
|-----------------------|---------------|---------------|---------------|---------------|---------------|---------------|---------------|
| | Brkfst | Lunch | Brkfst | Lunch | Brkfst | Lunch | 1/2 Pint |
| Roseville | \$1.70 | \$2.45 | \$1.90 | \$2.80 | \$2.40 | \$3.95 | \$0.50 |
| Moundsview | \$1.50 | \$2.55 | \$1.50 | \$2.80 | \$1.75 | \$3.70 | \$0.45 |
| North St. Paul | \$1.70 | \$2.60 | \$1.70 | \$2.85 | \$2.00 | \$4.00 | \$0.40 |
| Centennial | \$2.20 | \$2.80 | \$2.20 | \$3.00 | \$2.60 | \$4.00 | \$0.60 |
| White Bear Lake | \$1.70 | \$2.65 | \$1.70 | \$2.95 | \$1.90 | \$4.00 | \$0.50 |
| Bloomington | \$1.40 | \$2.50 | \$1.55 | \$2.80 | \$2.25 | \$3.60 | \$0.45 |
| Average | \$1.70 | \$2.59 | \$1.76 | \$2.87 | \$2.15 | \$3.88 | \$0.48 |

MEAL PRICE COMPARISON 2015-16 (Current)

| DISTRICT | ELEMENTARY | | SECONDARY | | ADULT | | MILK |
|-----------------------|---------------|---------------|---------------|---------------|---------------|---------------|---------------|
| | Brkfst | Lunch | Brkfst | Lunch | Brkfst | Lunch | 1/2 Pint |
| Roseville | \$1.70 | \$2.45 | \$1.90 | \$2.80 | \$2.40 | \$3.95 | \$0.50 |
| Moundsview | \$1.40 | \$2.45 | \$1.40 | \$2.70 | \$1.65 | \$3.60 | \$0.45 |
| North St. Paul | \$1.60 | \$2.55 | \$1.60 | \$2.80 | \$1.85 | \$4.00 | \$0.40 |
| Centennial | \$2.10 | \$2.70 | \$2.10 | \$2.90 | \$2.50 | \$3.90 | \$0.55 |
| White Bear Lake | \$1.65 | \$2.55 | \$1.65 | \$2.90 | \$1.85 | \$3.90 | \$0.50 |
| Bloomington | \$1.40 | \$2.50 | \$1.55 | \$2.80 | \$2.25 | \$3.60 | \$0.45 |
| Average | \$1.64 | \$2.53 | \$1.70 | \$2.82 | \$2.08 | \$3.83 | \$0.48 |

VII. B. 1. SEVERANCE OF ADDED TEACHER AND EXTRACURRICULAR ASSIGNMENTS

It is customary each year to sever added work and extracurricular assignments from the basic teacher contract, effective at the end of the school year. The purpose of such action is to provide additional protection from the adverse effect of extracurricular assignments in the next school year when funding for these services remains uncertain.

Therefore, the Director of Human Resources recommends the following resolution:

BE IT RESOLVED by the School Board of Independent School District No. 622 that the additional work and extracurricular assignment portion of all teacher contracts, with the exception of drivers' education instructors, be terminated effective June 30, 2016.

MOTION:

SECOND:

VII. B. 2. ADOPT CRITERIA FOR DISCONTINUANCE OF LICENSED POSITIONS

Each year it is necessary that the School District review it's staffing for the coming year and potentially adjust its certificated staff through employee termination and placement on unrequested leave of those personnel not needed due to program reductions and curtailments, reductions in student enrollments at certain instructional levels, or lack of funding. The following resolution formally establishes these criteria as the legal basis for necessary staff reductions.

Therefore, the Director of Human Resources recommends the following resolution:

BE IT RESOLVED by the School Board of Independent School District No. 622 that the criteria for discontinuance of positions effective for the 2016-17 school year shall be lack of funding; program reductions and curtailments; and reductions in student enrollments in specific grade levels, subject, and programs.

MOTION:

SECOND:

VII. C. 1. 2016-2017 ACHIEVEMENT AND INTEGRATION BUDGET

As part of the Educational Equity Alliance, the collaboration between District 622 and District 832, member districts are eligible for integration revenue. District 622 is expected to receive \$2,299,995.50 for Achievement and Integration in 2016-2017. Plans for the use of these funds are described in "The Plan for Educational Equity, 2014-2017". District 622 is expected to submit a yearly budget around this Plan for Educational Equity.

Therefore, the Assistant Superintendent recommends the following resolution:

BE IT RESOLVED by the School Board of Independent School District No. 622 that the District 622 Budget Plan for Achievement and Integration for 2016-2017 be approved.

MOTION:

SECOND:

**Achievement and Integration Revenue
 FY 2017 Budget Worksheet**

Use the worksheets provided here to list your district's proposed expenditures of FY 2017 Achievement Integration (AI) revenue.

District Name: North Saint Paul - Maplewood - Oakdale
District ISD Number: 622
Superintendent: Christine Osorio
Collaborative: Educational Equity Alliance

Prepared by: Thomas Howley
Phone: 651-748-7463
E-mail: thowley@isd622.org

If you have been notified by MDE that your district has one or more *Racially Identifiable Schools*, please list those schools here:

| | |
|--|-----------------|
| Total Initial Revenue expenditures (FIN 313 expenditures) | \$ 2,183,132.50 |
| Total Incentive Revenue expenditures (FIN 318 expenditures) | \$ 116,863.00 |
| TOTAL AI REVENUE | \$ 2,299,995.50 |

CERTIFICATION STATEMENT

We certify that the budget information submitted for our school district to the Minnesota Department of Education (MDE) is an accurate and complete representation of the fiscal year 2017 Achievement & Integration budget as approved by the school board.

Board Approval Date _____

School Board Chair _____

Date _____

Superintendent _____

Date _____

Approved Initial Revenue: _____ Approved Incentive Revenue: _____

MDE Approval: _____ Date: _____