

BOE Meeting Template
Monday, March 9, 2015 7:00 PM

Mabelle Avery Middle School District Offices Board Room, 4 Vision Boulevard, Somers, CT 06071

1. CALL TO ORDER
 2. PLEDGE OF ALLEGIANCE
 3. EXECUTIVE SESSION - Legal Matter
- DISCUSSION AND POSSIBLE ACTION**

The possible resolution of a pending, 2011 federal lawsuit involving a former student and her parents. The Board may take action upon its return to public session.

4. APPROVAL OF MINUTES 3
5. AUDIENCE TO CITIZENS/STAFF/STUDENTS
6. CORRESPONDENCE
7. OPPORTUNITY TO ADD/DELETE AGENDA ITEMS
8. CONSENT AGENDA
1. Approval of Bills 8
9. NEW BUSINESS
1. Open Choice Enrollment 14
Annually we are required to review our availability of seats to expand the Choice program. We presently have 23 Choice students enrolled in our district, however, we have 25 seats allotted. My recommendation would be to maintain the current allotment of 25 seats for next year.
2. Second Warning/Adoption of DBS Code 9325 - Meeting Conduct 17
The Policy Committee has reviewed this policy and has first and second warned it as recommended by CABE.
3. Second Warning/Adoption of DBS Code 1331.1-Smoke Free Environment 19
The Policy Committee has reviewed this policy and has first and second warned it as recommended by CABE.
4. Second Warning/Adoption of DBS Code 4152.6/4252.6 - Personal Leaves 21
The Policy Committee has reviewed this policy and has first and second warned it as recommended by CABE.
5. Second Warning/Adoption of DBS Code: 5113 - Attendance and Excuses 22
The Policy Committee has reviewed this policy and has first and second warned it as recommended by CABE.
6. Second Warning/Adoption of DBS Code: 5131.6 - Drugs/Alcohol/Tobacco 25
The Policy Committee has reviewed this policy and has first and second warned it as recommended by CABE.
7. Second Warning/Adoption of DBS Code: 5141.3 - Health Examination and Immunizations 28
The Policy Committee has reviewed this policy and has first and second warned it as recommended by CABE.
8. Second Warning/Adoption of DBS Code: 5141.4 - Reporting Child Abuse 31
The Policy Committee has reviewed this policy and has first and second warned it as recommended by CABE.
9. Second Warning/Approval of DBS Code: 6146.2 - Statewide Proficiency/Mastery Examinations 34
The Policy Committee has reviewed this policy and has first and second warned it as recommended

by C.A.B.E.

10. Resignation Letter - Ann Levesque 36
Ann Levesque, SHS French Teacher, has submitted her resignation for the end of the 2014-2015 school year.
11. Letter of Resignation - B. Hull 37
Brian Hull, Technology Education teacher at MBA, has submitted his letter of resignation for the end of the 2014-2015 school year.
12. Somers High School Roof Project and Somers Elementary School Roof Project 38
Architect representatives from Silver/Petrucci & Associates will attend the BOE meeting to outline roof projects for both Somers High School and Somers Elementary School and respond to any questions that the board may have.

Representatives may include: Dean Petrucci, AIA, Principal; Steve Smith, AIA, Project Manager and/or Ken Linsley, Draftsman.

10. OLD BUSINESS

11. ADMINISTRATIVE REPORTS

1. Annual Scheduling - Class Size 48
Mr. Cotzin will explain the scheduling process and the information on the course tally for the 2015-2016 school year. He will be available to respond to any questions the board may have.

12. COMMITTEE REPORTS

1. Budget
2. Curriculum
3. Policy
4. Salary & Negotiations
5. Planning
6. Other Committees

13. OTHER

14. ADJOURNMENT

SOMERS BOARD OF EDUCATION

1 Vision Boulevard

Somers, CT 06071

www.somers.k12.ct.us

MINUTES OF THE MEETING – FEBRUARY 23, 2015

Members Present: B. Devlin, D. Palmer, R. Lees, Jr., S. Moynihan Bollinger (arrived at 7:02 p.m.), J. Formeister, A. Kirkpatrick, M. Marquardt, K. McLellan (arrived at 7:21 p.m.), M. Rockett

Members Absent:

Administrators Present: Dr. M. Suffredini, B. Boutwell, Dr. D. Messina, R. Wilson

Staff Present:

Citizens Present:

Students Present:

Others: R. Caso (Investment Advisor), L. Quinci (JI Reporter)

1.0 CALL TO ORDER

The regular meeting of the Board of Education was called to order at 7:01 p.m. by Chairman Devlin in the Mabelle B. Avery Middle School Board of Education meeting room.

2.0 PLEDGE OF ALLEGIANCE

Motion to Move Agenda Item 8.14 to Before Item 3.0

It was **MOVED** (M. Marquardt), **SECONDED** (M. Rockett) to move agenda item 8.14 – Pension Advisory Committee Update to before agenda item 3. **PASSED 7-0.**

8.14. Pension Advisory Committee Update

Mr. Roy Caso updated the Board on the District's SESA pension plan and the performance of the funds. A one-page summary sheet as well as a 12-page full report was presented to the Board by Mr. Caso.

3.0 APPROVAL OF MINUTES

December 8, 2014 – It was **MOVED** (R. Lees), **SECONDED** (M. Marquardt) to approve the December 8, 2014 Board of Education meeting minutes as presented. **PASSED 8-0.**

4.0 AUDIENCE TO CITIZENS/STAFF/STUDENTS

5.0 CORRESPONDENCE

- An email was addressed by the Board.
- The Board received a letter from the Department of Education.

6.0 OPPORTUNITY TO ADD/DELETE AGENDA ITEMS

7.0 CONSENT AGENDA

7.1. Approval of Bills

- **It was MOVED (D. Palmer), SECONDED (M. Marquardt) to approve the 1/12/15 bills in the amount of \$458,061.62 as presented. PASSED 9-0.**
- **It was MOVED (D. Palmer), SECONDED (M. Marquardt) to approve the 1/26/15 bills in the amount of \$225,472.36 as presented. PASSED 9-0.**
- **It was MOVED (D. Palmer), SECONDED (M. Marquardt) to approve the 2/9/15 bills in the amount of \$271,584.03 as presented. PASSED 9-0.**
- **It was MOVED (D. Palmer), SECONDED (M. Marquardt) to approve the 2/23/15 bills in the amount of \$178,976.00 as presented. PASSED 9-0.**

7.2. Maternity Leave – D. Senecal

It was MOVED (D. Palmer), SECONDED (M. Marquardt) to approve the request for unpaid child-rearing leave starting at the conclusion of FMLA leave with a return date to work of January 4, 2016. PASSED 9-0.

8.0 NEW BUSINESS

8.1. 2015-2016 District School Calendar

It was MOVED (J. Formeister), SECONDED (M. Rockett) to approve the 2015-2016 District School Calendar as presented by Dr. Suffredini. PASSED 7-2, OPPOSED 2 (J. Formeister, A. Kirkpatrick).

8.2. Retirement Letter – Melinda Ferry

It was MOVED (D. Palmer), SECONDED (S. Bollinger) to accept, with regret, the resignation of Ms. Melinda Ferry, Somers High School Special Education Teacher, at the end of the 2014-2015 school year. PASSED 9-0.

8.3. Retirement Letter – Cynthia A. Witkewicz

It was MOVED (D. Palmer), SECONDED (S. Bollinger) to accept, with regret, the resignation of Cynthia Witkewicz, Mabelle B. Avery Middle School Math Teacher, at the end of the 2014-2015 school year. PASSED 9-0.

8.4. Retirement Letter – M. Porter

It was MOVED (D. Palmer), SECONDED (S. Bollinger) to accept, with regret, the resignation of Ms. Marjorie Porter, Science Teacher at Mabelle B. Avery Middle School, at the end of the 2014-2015 school year. PASSED 9-0.

8.5. Retirement Letter – J. Kasche

It was MOVED (D. Palmer), SECONDED (S. Bollinger) to accept, with regret, the resignation of Joan Kasche, Somers High School Paraeducator, effective February 27, 2015. PASSED 9-0.

8.6. First Warning of DBS Code 9325 – Meeting Conduct

The Policy Committee has reviewed recommendations by CABE for policy and revisions and is presenting the revised policy for first warning to the board. Second warning/adoption will be included on the 3/9/15 agenda.

- 8.7. First Warning of DBS Code 1331.1 – Smoke-Free Environment**
The Policy Committee has reviewed recommendations by CABE for policy revisions and is presenting the revised policy for the first warning to the board. Second warning/adoption will be included on the 3/9/15 agenda.
- 8.8. First Warning of DBS Code 4152.6/4252.6 – Personal Leaves**
The Policy Committee has reviewed recommendations by CABE for policy revisions and is presenting the revised policy for first warning to the board. Second warning/adoption will be included on the 3/9/15 agenda.
- 8.9. First Warning DBS Code 5113 – Attendance and Excuses**
The Policy Committee has reviewed recommendations by CABE for policy revisions and is presenting the revised policy for first warning to the board. Second warning/adoption will be included on the 3/9/15 agenda.
- 8.10. First Warning of DBS Code 5131.6 – Drugs/Alcohol/Tobacco**
The Policy Committee has reviewed recommendations by CABE for policy revisions and is presenting the revised policy for first warning to the board. Second warning/adoption will be included on the 3/9/15.
- 8.11. First Warning of DBS Code 5141.3 – Health Examination and Immunizations**
The Policy Committee has reviewed recommendations by CABE for policy revisions and is presenting the revised policy for first warning to the board. Second warning/adoption will be included on the 3/9/15 agenda.
- 8.12. First Warning of DBS Code 5141.4 – Reporting Child Abuse**
The Policy Committee has reviewed recommendations by CABE for policy revisions and is presenting the revised policy for first warning to the board. Second warning/adoption will be included on the 3/9/15 agenda.
- 8.13. First Warning of DBS Code 6146.2 – Statewide Proficiency/Mastery Examinations**
The Policy Committee has reviewed recommendations by CABE for policy revisions and is presenting the revised policy for first warning to the board. Second warning/adoption will be included on the 3/9/15 agenda.
- 8.15. Ratification of SAA Contract**
It was **MOVED** (D. Palmer), **SECONDED** (M. Marquardt) to ratify the SAA’s three-year contract as presented. **PASSED 8-1, OPPOSED 1** (J. Formeister).
- 8.16. CSDE District Technology Upgrades to Support Transition to the New Standards 2014-15**
It was **MOVED** (D. Palmer), **SECONDED** (M. Rockett) to approve submitting a grant proposal to the CSDE for the project – “District Technology Upgrades to Support Transition to the New Standards” as presented by Mr. Robert Wilson, Director of Technology and Information Systems. Mr. Wilson is

focusing on using the reimbursements to expand technology in the district for lab and laptop components as well as updated technology for the Tech Ed group. PASSED 9-0.

8.17. Approval of Job-Sharing Agreements

- **It was MOVED (M. Marquardt), SECONDED (J. Formeister) to approve the request of a job-sharing agreement at SES between P. Clark/R. Leiphart for Information Literacy and Technology Integration. PASSED 9-0.**
- **It was MOVED (M. Marquardt), SECONDED (J. Formeister) to approve the request of a job-sharing agreement at SES between N. Dzicek/M. Shannon for Grade 3. PASSED 9-0.**
- **It was MOVED (M. Marquardt), SECONDED (J. Formeister), to approve the request of a job-sharing agreement at SES between M. Staunton/K. Doran for Grade 1. PASSED 9-0.**

9.0 OLD BUSINESS

10.0 ADMINISTRATIVE REPORTS

10.1. District Grants Update

Mr. Bill Boutwell, Director of Business Services, updated the board on district grants. A packet was provided to the Board.

10.2. Dr. Suffredini outlined the availability of new email addresses through our district server for all Board members. The new email addresses will provide for better archiving of Board communications.

11.0 COMMITTEE REPORTS

Minutes will be taken at all subcommittee meetings.

11.1. Budget

11.1.1. 2015-2016 Budget

It was MOVED (D. Palmer), SECONDED (M. Marquardt) to accept and bring forward to the public hearing the proposed 2015-2016 budget of \$21,463,926.00 as presented by Dr. Suffredini and Mr. Bill Boutwell, Director of Business Services. PASSED 9-0.

11.2. Curriculum – No report.

11.3. Policy – A. Kirkpatrick reported that the next policy committee meeting will be held on Monday, March 9, 2015 at 6 p.m. Notebooks were handed out to policy committee members.

11.4. Salary & Negotiations – No report.

11.5. Planning Committee – No report.

11.6. Other Committees – None.

12.0 OTHER

- **S. Bollinger attended a FOIA meeting regarding committee rules, regulations, recording meetings, etc. A packet will be distributed to the Board for the next meeting.**
- **A. Kirkpatrick attended the Legislative Breakfast and stated that Somers' two legislators were not in attendance and that the majority in attendance shared budget concerns.**

12.1. EXECUTIVE SESSION – Superintendent's Mid-Year Evaluation

It was MOVED (D. Palmer), SECONDED (S. Bollinger) to move into Executive Session for the Superintendent's Mid-Year Evaluation and invite Dr. Suffredini, Superintendent of Schools, into Executive Session at 8:25 p.m. PASSED 9-0.

The Board came out of Executive Session at 8:47 p.m.

13.0 ADJOURNMENT

It was MOVED (M. Marquardt), SECONDED (S. Bollinger) to adjourn the BOE meeting at 8:48 p.m. PASSED 9-0.

Respectfully submitted,

**Rick Lees, Jr., Secretary
Shannin Burns, Recording Secretary**

These minutes are not official until approved at a subsequent meeting.

Somers Board of Education General Budget Treasury Warrant

Report # 33187

Check Batch: 11998
 Check Header: (N / A)
 Check Numbers: (First) - (Last)
 Check Dates: (Earliest) - (Latest)
 Cash Account Numbers: (First) - (Last)
 Bank Account Code: (N/A)
 Check Authorization Code: AP GB
 Minimum Check Amount: \$0.00
 Sorted By:
 Include Payable Information: No
 Include Payable Dist Information: No
 Include Authorization Information: Yes

Batch #	Check #	Check Date	Vendor Code	Vendor Name	Electronic Amount	Check Amount
---------	---------	------------	-------------	-------------	----------------------	-----------------

Approved by:  Date: 3/5/15
William B. Boutwell, Director of Business Services

11998	9658	03/09/2015	V60790	Alternative Access Assistive Techology	0.00	140.00
	9659	03/09/2015	V52670	Amazon	0.00	1,608.54
	9661	03/09/2015	V52306	AmeriPride Services, Inc	0.00	287.28
	9662	03/09/2015	V60041	Anthem BCBS	0.00	172,064.12
	9663	03/09/2015	V60040	Anthem Life Insurance Company	0.00	2,335.59
	9664	03/09/2015	V61029	Anthem Sports	0.00	78.82
	9665	03/09/2015	V54164	Auto Tek LLC	0.00	459.19
	9666	03/09/2015	V52478	Bart Truck Equipment LLC.	0.00	1,751.90
	9667	03/09/2015	E00019	Blauvelt, Pam	0.00	3.08
	9668	03/09/2015	E00020	Tammy Bley-Gowash	0.00	25.20
	9669	03/09/2015	M54301	C&A Distributors, Inc.	0.00	635.00
	9670	03/09/2015	V60574	CLG Electric LLC	0.00	762.00
	9671	03/09/2015	V60882	Comtech Phones	0.00	665.00
	9672	03/09/2015	V60709	DBS Energy Inc.	0.00	14.63
	9673	03/09/2015	V60089	Dime Oil Company LLC	0.00	44,557.47
	9674	03/09/2015	V00243	Discount Magazine Subscription Service,	0.00	85.87
	9675	03/09/2015	V00605	Electrical Wholesalers	0.00	123.08
	9676	03/09/2015	V00159	Eversource Energy	0.00	21,073.75
	9677	03/09/2015	V54168	First Student, Inc	0.00	37,991.76
	9680	03/09/2015	V60968	Fletcher Sewer & Drain, Inc	0.00	170.00

Somers Board of Education General Budget Treasury Warrant

Batch #	Check #	Check Date	Vendor Code	Vendor Name	Electronic Amount	Check Amount
	9681	03/09/2015	V61017	Frontier Communications	0.00	39.33
	9682	03/09/2015	V60804	Granite City Electric Supply	0.00	640.93
	9683	03/09/2015	E00126	Grenier, Lisa	0.00	28.75
	9684	03/09/2015	V54174	GTM Sportwear	0.00	105.00
	9685	03/09/2015	V01790	Heinemann	0.00	2,042.28
	9686	03/09/2015	V54063	HSABank	0.00	270.00
	9687	03/09/2015	V52848	Intensive Education Academy, Inc.	0.00	4,218.72
	9688	03/09/2015	V00999	J.W. Pepper & Son, Inc.	0.00	280.14
	9689	03/09/2015	V00048	Johnson Controls	0.00	59.63
	9690	03/09/2015	E00159	Jones, Karen	0.00	41.29
	9691	03/09/2015	V02625	K & S Distributors	0.00	785.80
	9692	03/09/2015	E00163	Kapner, Rob	0.00	28.75
	9693	03/09/2015	E00166	Kelleher, Michelle	0.00	38.03
	9694	03/09/2015	V60883	McGill Hose & Coupling Inc	0.00	105.49
	9695	03/09/2015	V01370	McGraw-Hill School Education Holdings, L	0.00	218.16
	9696	03/09/2015	V54065	Mehl, Thomas R	0.00	780.00
	9697	03/09/2015	V60537	National Career Development Association	0.00	80.00
	9698	03/09/2015	V60568	Pediatric Services of America Inc	0.00	1,575.00
	9699	03/09/2015	V60712	Pershing, LLC	0.00	60,000.00
	9700	03/09/2015	V52686	Plimpton & Hills	0.00	155.17
	9701	03/09/2015	V53593	Poland Spring	0.00	59.89
	9702	03/09/2015	V53356	ProCom Telecommunications Corp	0.00	7,336.40
	9703	03/09/2015	V60864	Pullman & Comley, LLC	0.00	1,066.50
	9704	03/09/2015	V60925	ReadyNurse Staffing Services	0.00	5,562.00
	9705	03/09/2015	E00367	Karen Regan	0.00	21.25
	9706	03/09/2015	V00886	Somers Lunch Program	0.00	4.75
	9707	03/09/2015	V60809	Somers Mechanical Services, LLC	0.00	890.00
	9708	03/09/2015	V00548	Somers Sanitation Service, Inc.	0.00	1,189.70
	9709	03/09/2015	V01591	Town of Somers	0.00	22,372.61
	9710	03/09/2015	V60727	Starfall Education	0.00	181.97
	9711	03/09/2015	E00322	Suffredini, Dr. Maynard	0.00	43.70
	9712	03/09/2015	V60983	The OMNI Group	0.00	28.00
	9713	03/09/2015	V53945	Transcanda Power Marketing LTD	0.00	21,169.67
	9714	03/09/2015	M53099	Tull Brothers, Inc.	0.00	316.17
	9715	03/09/2015	V00051	USPS	0.00	677.95
	9716	03/09/2015	V00051	USPS	0.00	37.80
	9717	03/09/2015	V60875	Zones Inc	0.00	352.83

**Somers Board of Education
General Budget Treasury Warrant**

Batch #	Check #	Check Date	Vendor Code	Vendor Name	Electronic Amount	Check Amount
Totals:					0.00	\$417,635.94

57 Checks Listed.

Somers Board of Education General Journal Register

Report # 33186
Batch: 11969
Transaction: N/A
Show Summary Only: Yes

Batch #	Control Total	Status	Created By	Created On	Last Updated By	Last Updated On
11969	\$417,635.94	Posted	lbergamini	03/02/2015	lbergamini	03/05/2015

General Ledger Distribution Summary						
Period, Fiscal Year	Account Number	Account Description	DTF Base	Over Budget	Debits	Credits
March, 2015						
Generated Distributions						
	10-000-0-0-00-000-710-00-0-00000	ENCUMBRANCE CONTROL			404,240.64	0.00
	10-000-0-0-00-000-720-00-0-00000	RESERVE FOR ENCUMBRANCE			0.00	404,240.64
		Total Generated Distributions			\$404,240.64	\$404,240.64
User-Entered Distributions						
	10-000-0-0-00-000-241-00-0-00000	ACCOUNTS PAYABLE			88.41	0.00
	10-000-0-0-00-000-241-00-0-00000	ACCOUNTS PAYABLE			0.00	417,724.35
	10-100-2-2-20-242-611-01-5-00169	K-5 - MUSIC SUPPLIES			285.99	0.00
	10-100-2-2-20-242-611-01-5-00169	K-5 - MUSIC SUPPLIES			0.00	5.85
	10-100-2-2-26-220-641-01-5-00105	K-5 - LANGUAGE ARTS TEXTBOOK		Yes	2,042.28	0.00
	10-100-2-3-12-242-611-01-5-00182	MA - TECHNOLOGY ED SUPPLIES			0.00	82.56
	10-100-2-4-12-242-611-01-5-00183	HS - TECHNOLOGY ED SUPPLIES			316.48	0.00
	10-100-2-4-26-242-611-01-5-01070	HS - ENGLISH SUPPLIES			85.66	0.00
	10-100-2-4-28-242-611-01-5-00206	HS - SCIENCE SUPPLIES			38.03	0.00
	10-100-2-4-30-242-611-01-5-01644	HS - SOCIAL STUDIES SUPPLIES			83.63	0.00
	10-100-2-4-46-242-611-01-5-00229	HS - SCHOOL TO CAREER SUPPLIES			80.00	0.00
	10-100-2-4-48-243-611-01-5-00972	HS - HEALTH WORKBOOKS			25.20	0.00
	10-100-2-4-66-730-730-01-5-00616	HS - TECH ED REPLACEMENT			723.11	0.00
	10-120-9-9-98-243-611-01-5-01002	SP ED - TESTING			218.16	0.00
	10-120-9-9-98-955-330-02-5-01142	SPED - CONSULTANT FEES			140.00	0.00
	10-120-9-9-98-955-330-02-5-01674	SP ED - CONTRACTED SERVICES			1,575.00	0.00
	10-213-3-2-48-412-112-02-5-00316	K-5 - NURSE'S SALARY			4,806.00	0.00
	10-213-3-5-48-412-112-02-5-00319	SW - NURSE SUBSTITUTE		Yes	756.00	0.00
	10-221-1-2-50-251-580-05-5-00259	K-5 - TRAVEL/IN-SERVICE			41.29	0.00
	10-221-1-3-50-251-580-05-5-00264	MA - PRINCIPAL'S TRAVEL			28.75	0.00
	10-221-1-4-50-251-580-05-5-00267	HS - TRAVEL/IN-SERVICE			50.00	0.00
	10-222-2-3-52-231-642-03-5-00142	MA - NEWSPAPERS/MAGAZINES			85.87	0.00
	10-222-2-5-14-233-611-03-5-00150	SW - COMPUTER SOFTWARE		Yes	181.97	0.00
	10-231-1-5-74-134-330-10-5-00045	B.O.E. - OTHER PROF. SERVICES			1,094.50	0.00
	10-231-1-5-74-134-530-10-5-00048	B.O.E. - PUBLICATION POSTAGE			715.75	0.00
	10-231-1-5-74-134-690-10-5-00047	B.O.E. - SUPPLIES			4.75	0.00

Somers Board of Education General Journal Register

Report # 33186

Batch #	Control Total	Status	Created By	Created On	Last Updated By	Last Updated On	
11969	\$417,635.94	Posted	lbergamini	03/02/2015	lbergamini	03/05/2015	
					Total User-Entered Distributions	\$417,812.76	\$417,812.76
					Total for March, 2015	\$822,053.40	\$822,053.40
					Grand Total for Batch # 11969	\$822,053.40	\$822,053.40

258 Transactions Listed.

Original Submission? (X Here) Revision? (X Here)

Submission Date: _____

Hartford Region Open Choice Program: School District 2015-16 Seat Declaration Form**A. Open Choice Enrollment (as of October 1, 2014)**

In the GRAY highlighted row in the chart below, note the number of Open Choice students enrolled in your district for the 2014-15 school year as of the October 2014 PSIS filing. In the Projected Open Choice Maintained Seats row it is assumed that, with the exception of graduating Grade 12 students, all students will continue to the next grade in your district for 2015-16.

	School Year	PK4	Grade 1	Grade 2	Grade 3	Grade 4	Grade 5	Grade 6	Grade 7	Grade 8	Grade 9	Grade 10	Grade 11	Grade 12	Total
Open Choice Enrollment	2014-15			2	3	2	5	2	2	2	3	2			23
Projected Open Choice Maintained Seats	2015-16	0	0	0	2	3	2	5	2	2	2	3	2	0	23

B. Student Withdrawals AFTER the October 2014 PSIS Filing

If you are aware of any students who have withdrawn after your October 2014 PSIS filing and will not be returning for the 2015-16 school year, please list the Student's SASID, School Name, Grade, and Date of Withdrawal below. Please use a separate sheet to list additional withdrawals.

Student's SASID	School Name	Grade in Which Student is Currently Enrolled	Date of Withdrawal
Total Number (Total of Rows 18 through 22 + Any Additional Withdrawals) of Open Choice Students Withdrawn after October PSIS:			0

C. Projected Open Choice Maintained Seats for School Year 2015-16

Data Per Chart	Total
A. Projected Open Choice Maintained Seats	23
B. Less: Students Withdrawn After October 2014 PSIS Filing	0
C. Projected Open Choice Maintained Seats	23

E., Total Projected Seats (Maintained Seats Plus New Seats) 2015-16

Data Per Chart	Total
C. Projected Open Choice Maintained Seats	23
D. Proposed New Open Choice Seats	2
Total Projected Open Choice Seats for 2015-16	25

Dr. Maynard M. Suffredini, Jr

2/24/2015

Please reply electronically no later than Saturday, March 1, 2015.

Superintendent of Schools E-
Signature

Date

Please email the form no later than Saturday, March 1, 2015 to:

OCSeatDecs@ct.gov
Barbara Canzonetti and Shola Freeman
Education Consultants Monitoring This Inbox
State Department of Education
165 Capitol Avenue, Room 227
Hartford, CT 06106
860.713.6578 or 860.713.6598

BYLAWS OF THE BOARD:

Meeting Conduct:

Meetings of the Board of Education shall be conducted by the Chairman in a manner consistent with the adopted bylaws of the Board.

All Board meetings shall commence at the stated time and shall be guided by an agenda which will have been prepared and delivered in advance to all Board members and other designated persons.

The conduct of meetings shall, to the fullest possible extent, enable members of the Board to (1) consider problems to be solved, weigh evidence related thereto, and make wise decisions intended to solve the problems and (2) receive, consider and take any needed action with respect to reports of accomplishment, both as to students and as to school system operations.

~~Provisions for permitting any individual or group to address the Board concerning any subject that lies within its jurisdiction shall be as follows:~~

An individual or group may address the Board concerning any item on the agenda for the meeting subject to the following provisions:

- ~~1. Opportunity is given to any citizen to question or express concerns to the Board. Up to 20 minutes may be allowed for each subject under discussion. Board members may decide to extend this time if they so choose.~~
1. A three (3) minute time limit may be allowed to each speaker with a maximum of 20 minutes per meeting being allocated per meeting. The Board may, by a majority vote, decide to cancel or adjust these time limits
2. No disruptive conduct shall be permitted. If disruptive conduct is interfering with the conduct of the Board meeting, the Chairman may terminate the offending person's right of addressing the Board, or, if necessary, clear the room of all non-members so the Board may continue the meeting.
- ~~3. No oral presentation shall include charges or complaints against any employee of the Board of Education, regardless of whether or not the employee is identified in the presentation by name or by another reference which tends to identify. All charges or complaints against employees shall be submitted to the Board of Education under provisions of Board Policy No. 1312 (Complaints Concerning School Personnel).~~
3. If a member of the public makes an oral presentation about the performance of a Board member or employee, whether named or not, including charges or complaints, the Board shall not discuss such performance unless the topic is an explicit item on the agenda and the employee or Board member has been provided the requisite due process required by law. Members of the public who make such comments may be referred to Board Policy No. 1312 (Complaints Concerning School Personnel).

4. The Board is not obligated to take action on a citizen's concern at the meeting at which the concern is expressed. However, in certain instances, such as a recommendation of the Superintendent, the Board may vote to consider action immediately.

Cross Reference: 1120, 9321, 9322

Legal Reference: Connecticut General Statutes
1-200 Definitions
1-206 Denial of access of public records or meetings. Notice.
Appeal
1-210 Access to public records
1-225 Meetings of government agencies to be public
1-226 Recording, broadcasting or photographing meetings
19a-342 Smoking prohibited in certain places. Sign required.
Penalty
1-231 Executive sessions
1-232 Conduct of meetings (re disturbances)
10-224 Duties of the Secretary

Adopted: March 23, 1981
July 9, 2009

Community Relations

Smoke Free Environment

The Board of Education recognizes the deleterious health effects of smoking, both to the smoker and from second hand smoke. The Board also recognizes that adults should be providing positive role models for students. Therefore, in accordance with Connecticut Statute 19a-342, the Board of Education prohibits any student or adult from smoking on school property or at school-sponsored events at any time. Furthermore, use of tobacco products is prohibited on any school-related transportation or at any school-sponsored activity. Any person 16 or older can be subject to a fine if this policy is violated.

~~As used herein, “smoke” or “smoking” means the lighting or carrying of a lighted cigarette, cigar, pipe or similar device or use of chewing tobacco, or a nicotine delivery device, chemicals or devices that produce the same flavor or physical effect of nicotine substances; and any other tobacco or nicotine innovations.~~

Tobacco includes, but is not limited to, cigarettes, cigars, snuff, smoking tobacco, smokeless tobacco, nicotine delivering systems, vapor products, chemicals or devices that produce the same flavor or physical effect of nicotine substances; and any other tobacco or nicotine innovations.

Electronic nicotine delivery system means an electronic device that may be used to simulate smoking in the delivery of nicotine or other substance to a person inhaling from the device, and includes, but is not limited to, an electronic cigarette, electronic cigar, electronic cigarillo, electronic pipe or electronic hookah and any related device and any cartridge or other component of such device

Vapor product means any product that employs a heating element, power source, electronic circuit or other electronic, chemical or mechanical means, regardless of shape or size, to produce a vapor that may or may not include nicotine, that is inhaled by the user of such product

(cf. 1120 - Board of Education Meetings)

(cf. 1330 - Use of School Facilities)

(cf. 4118.231/4218.231 - Employee Smoking, Drinking, and Use of Drugs on School Premises)

(cf. 5131.6 - Drugs, Tobacco, and Alcohol)

Legal Reference: Connecticut General Statutes

19a-342 Smoking prohibited in certain places. Signs required. Penalties.

21a-242 Schedules of controlled substances.

20 U.S.C. 7181-7184 The Pro Children Act of 2001

14-76 An Act Concerning the Governor’s Recommendations Regarding Electronic Nicotine Delivery Systems and Youth Smoking Prevention.

Adopted: September 11, 1989

Revised: February 26, 1996
February 22, 1999
March 10, 2014

Personnel -- Certified/Non-Certified

Personal Leaves

Family, Medical and Pregnancy Leave Policy

Family and Medical leaves are provided by the Board as required by the federal Family and Medical Leave Act of 1993, as amended (FMLA) and the Family Medical Leave Act as part of the National Defense Authorization Acts of 2008 and for Fiscal Year 2010 (which expanded certain leave to military families and veterans for specific circumstances) and 2013 Final Rules. This policy and the corresponding regulations will be interpreted to comply with that law, as well as the Connecticut Fair Employment Practices Act (CFEPA) with respect to pregnancy-related disability leave and transfer. Employees should contact the Business Office of the Somers Public Schools if they have any questions regarding how the Board's FMLA policy and regulations apply to their situation, when and how they may take leave or any question regarding family, medical or pregnancy-related disability leave.

Paraprofessionals are also eligible to benefits equal to those under the federal FMLA if such paraprofessional was employed for at least one year and for at least 950 hours over the previous twelve month period preceding the commencement of the leave. A paraprofessional is defined as a school employee who performs duties that are instructional in nature or delivers either direct or indirect services to students and/or parents and serves in a position for which a teacher has ultimate responsibility for the design and implementation of educational programs and services.

(cf. 4118.14 - Disabilities)

(cf. 4151.2 - Family Illness)

(cf. 4152.3 - Maternity; Adoptive; Child Care)

Legal Reference: P.L. 103-3 and 29 CFR Part 825 - The Family and Medical Leave Act of 1993, as amended by H.R. 4986, the National Defense Authorization Act for Fiscal Year 2008, Section 585. 29 U.S.C. §2601 et seq. and the National Defense Authorization Act for Fiscal Year 2010, Public Law 111-84, section 565, Title V.
Final Rule - published in Federal Register, Vol. 60, Nov. 4, Friday, January 6, 1995, as amended on February 3, 1995, March 30, 1995, and on November 17, 2008. Rules and Regulations (29 CFR Part 825).
Connecticut General Statutes
46b-380o Applicability of statutes to civil unions and parties to a civil union.
PA 07-245 An Act Concerning Family and Medical Leave for Municipal Employees.
PA 12-43 An Act Concerning Family and Medical Leave Benefits for Certain Municipal Employees.

STUDENTS

Attendance and Excuses:

It has been well demonstrated that regular attendance is a key factor in the success a student achieves in school. Much of what a student learns and is graded on deals with facts, concepts, and theories which are presented and discussed in class. In addition, other learning processes take place in class which may not be measurable, but are most important to a student's overall growth and education.

The Board of Education discourages students from missing school when school is in session. Upon return to school it will be the student's responsibility to complete any work missed due to absence and the parent's responsibility to ensure the work is completed **within five school days**.

Connecticut State law requires parents to cause their children to attend school regularly during the hours and terms the public school is in session. A student, therefore, should not be absent from school without a parent's knowledge and consent.

Connecticut state law requires parents to cause their children, ages five through eighteen inclusive, to attend school regularly during the hours and terms the public school is in session. Parents or persons having control of a child five years of age have the option of not sending the child to school until ages six or seven. Mandatory attendance terminates upon graduation or withdrawal with written parent/guardian consent at age seventeen.

The Board of Education requires that accurate records be kept of the attendance of each child. It also requires that parents and students are provided with policies on attendance, including tardiness, for each school building.

A student is considered to be "in attendance" if present at his/her assigned school, or an activity sponsored by the school (e.g., field trip), for at least half of the regular school day. A student who is serving an out-of-school suspension or expulsion should always be considered absent. A student not meeting the definition of "in attendance" shall be considered absent.

A. For absences one through nine, a student's absences from school are considered "excused" when the student's parent/guardian approves such absence and submits appropriate documentation to school officials.

Such documentation includes a signed note from the student's parent/guardian, a signed note from a school official that spoke in person with the parent/guardian regarding the absence, or a note confirming the absence by the school nurse or by a licensed medical professional, as appropriate. Documentation should explain the nature of and the reason for the absence as well as the length of the absence. Separate documentation must be submitted for each incidence of absenteeism.

B. For the tenth absence and all absences thereafter, a student's absences from school are considered excused for the following reasons:

1. Student illness (must be verified by a licensed medical professional to be deemed excused, regardless of the length of the absence);

2. Student's observance of a religious holiday;
3. Death in the student's family or other emergency beyond the control of the student's family;
4. Mandated court appearances (documentation required);
5. The lack of transportation that is normally provided by a district other than the one the student attends (no parental documentation required);
6. Extraordinary educational opportunities pre-approved by District administration and to be in accordance with Connecticut State Department of Education guidance.

C. A student's absence from school shall be considered unexcused unless:

1. The absence meets the definition of an excused absence and meets the documentation requirements; or
2. The absence meets the definition of a disciplinary absence, which is the result of school or District disciplinary action and are excluded from these State Board of Education approved definitions.

When the school in which a child is enrolled receives no notification from a parent or other person having control of the child is aware of the child's absence, a reasonable effort shall be made by school personnel or volunteers under the direction of school personnel to notify by telephone and by mail such parent or other person having control of the child.

At Somers High School credit for courses taken is conditional on the satisfaction of attendance requirements specified in the relevant Administration Regulations approved by the Board of Education. The attendance requirements for credit will be affected by the total number of absences, excused and unexcused.

Excused Absences for Children of Service Members

An enrolled student, age five to eighteen, inclusive, whose parent or legal guardian is an active duty member of the armed forces, as defined in section 27-103, and has been called to duty for, is on leave from, or has immediately returned from deployment to a combat zone or combat support posting, shall be granted ten days of excused absences in any school year and, at the discretion of the Board of Education, additional excused absences to visit such child's parent or legal guardian with respect to such leave or deployment of the parent or legal guardian. In the case of such excused absences such child and parent or legal guardian shall be responsible for obtaining assignments from the student's teacher prior to any period of excused absence, and for ensuring that such assignments are completed by such child prior to his or her return to school from such period of excused absence.

Legal References: Connecticut General Statutes
 10-184 Duties of parents (as amended by PA 98-243 and PA 00-157)
 10-185 Penalty
 10-198a Policies and procedures concerning truants (as amended by P.A.11-136, An Act Concerning Minor Revisions to the Education Statutes.)
 10-199 through 10-202 Attendance, truancy – in general
PA 14-198, An Act Concerning Excused Absences from School for Children of Service Members.)

Adopted: March 10, 1986
Revised: July 11, 1988
September 13, 1993
June 28, 1999
July 9, 2009
September 9, 2013

STUDENTS:

Drugs/Alcohol/Tobacco:

Drugs and Alcohol

It is the policy of the Somers Board of Education to take positive actions to prevent drug and alcohol abuse. Recognizing the potential of each student that drug or alcohol abuse and dependency can seriously impair a student's ability to learn, these actions will be through education, early intervention, parental involvement, medical and/or assessment referral.

The Board of Education prohibits student possession, use, and/or distribution of any drugs, alcohol, or drug paraphernalia or being under the influence of any drug or alcohol on school premises or at any school-sponsored activity.

Definitions

Drugs are defined as any substance other than food or water that is intended to be taken or administered (ingested, injected, applied, implanted, inhaled, etc.) for the purpose of altering, sustaining, or controlling the recipient's physical, mental, or emotional state. Drugs may include, but not be limited to, alcoholic beverages; controlled substances such as marijuana, hallucinogens, cocaine, barbiturates, amphetamines, narcotics; and non-authorized prescription drugs.

Possessing, using, or transmitting any substance which is represented to be or looks like a narcotic drug, hallucinogenic drug, amphetamine, barbiturate, marijuana, alcoholic beverage, stimulant, depressant, or intoxicant of any kind, including such substances that contain chemicals which produce the same effect of illegal substances including but not limited to Spice and K2 and bath salts are addressed by this policy.

Controlled substances, for purposes of this policy shall include all controlled substances prohibited by federal and state law, look-alike drugs, alcoholic beverages, anabolic steroids, drug paraphernalia, any volatile solvents or inhalants, such as but not limited to glue and aerosol products, and prescription or patent drugs, except those for which permission for use in school has been granted pursuant to Board policy.

Electronic nicotine delivery system means an electronic device that may be used to simulate smoking in the delivery of nicotine or other substance to a person inhaling from the device, and includes, but is not limited to, an electronic cigarette, electronic cigar, electronic cigarillo, electronic pipe or electronic hookah and any related device and any cartridge or other component of such device.

Vapor product means any product that employs a heating element, power source, electronic circuit or other electronic, chemical or mechanical means, regardless of shape or size, to produce a vapor that may or may not include nicotine, that is inhaled by the user of such product.

Under the influence, for purposes of this policy shall include any consumption or ingestion of controlled substances by a student.

If a student is under the influence of a drug or alcohol, or engaged in the illegal activity of possessing or selling drugs and/or alcohol, the police will be notified, his/her parent(s)/guardian will be contacted and he/she will be suspended from school and considered for expulsion. If a student is arrested and is awaiting trial for possession of, or possession of with intent to sell drugs in or on school property or at a school-sponsored event, the student will not be allowed to attend school without the permission of the Superintendent.

Student athletes who violate this policy, participating in CIAC-controlled activities shall also be declared ineligible for such activities in accordance with CIAC policy and regulations. Any disciplinary actions imposed will ensure that similar violations will be treated consistently.

School properties may be inspected by school authorities in the interest of maintenance, health, and safety. Inspections for the location of drugs, narcotics, liquor, weapons, poisons and missing properties are matters relating to health and safety and may be regarded as reasonable purposes for inspection by school personnel (cf. 5145.12 - Search and Seizure)

Disciplinary procedures will be administered with the best interests of the student, school population, and community in mind. Personal privacy rights of students shall be protected as provided by law.

Tobacco

Smoking, possession of smoking materials, or other use of tobacco products by students of Somers Public Schools is prohibited.

1. in all school buildings;
Any student found to be in violation of the tobacco policy will be subject to disciplinary action. Additionally, each student found to be in violation of the tobacco policy will be referred to the Connecticut State Police for prosecution under Connecticut General Statute 1-21b.
2. on school grounds and recreational fields;
3. on transportation provided by the Board of Education, or at any time when the student is subject to the supervision of designated school personnel such as when the student is at any school function, extracurricular event, field trip, or school-related activity such as a work-study program.

Disciplinary action will be in accordance with regulations provided by the administration. An ongoing program of student support and counseling will be offered to provide support for students who wish to break the smoking habit.

Legal Reference: CT General Statutes
1-21b Smoking prohibited in certain places
10-220b Policy statement on drugs
21a-242 Schedules of controlled substances
10-221a Board of Education to prescribe rules
P.A. 11-73 An Act Regulating the Sale and Possession of Synthetic Marijuana and Salvia Divinorum.
P.A. 14-76 An Act Concerning the Governor's Recommendations Regarding Electronic Nicotine Delivery Systems and Youth Smoking Prevention.

Adopted: September 11, 1989
Revised: September 24, 1990
February 26, 1996
February 22, 1999
April 12, 2006
June 25, 2012

STUDENTS:

Health Examination and Immunizations:

1. All kindergarten and first entry school children must have a preschool physical examination and must have completed full immunization requirements, as specified by the current regulations of the State Department of Health, before school entry.
2. Physical exams are required for all students in grades 6 and 10. All starred items on the medical evaluation form (HAR-3) must be completed by the person doing the physical exam. Physical exams should be no more than one year old prior to the start of the new school year. This will be waived if a parent can show proof that an exam is scheduled during the current school year. No student will be allowed to enter grade 7 or grade 11 without state-mandated immunizations and proof of a physical exam being completed.
3. Students entering, both inter and intra-state, will be required to produce written documentation that all requirements have been met or present a certificate from their physician stating immunizations are medically contraindicated or provide a statement from a parent or guardian that immunizations are contrary to religious beliefs.
4. Students entering from out of state must show evidence of a physical examination done by a physician within one year prior to entrance or 30 days is given in which to get the physical. If health records from the student's previous school have not been received within 15 days, a parent will be requested to contact the school to have them sent.
5. Students entering from within the state must show evidence of a physical examination done by a physician in compliance with state requirements.
6. Health screenings shall be required for all students in the following schedule:

Physical screening to detect scoliosis will be done for females in Grades 5 and 7 and for males in Grades 8 or 9.

Vision screening will be done in Grades K, 1, 3, 4, 5 by the nurses.

Hearing will be screened in grades K, 1, 3, 4, 5 by the nurses.

The school system shall provide these screening to students at no cost to parents.

Parents shall be provided an annual written notification of screenings to be conducted. Parents wishing to have these screenings to be conducted by their private physician shall be required to report screening results to the school nurse.

(cont'd)

(Health assessments may be conducted by a licensed physician, advanced practice registered nurse, registered nurse, physician assistant or by the School Medical Advisor.)

7. Parents will be notified in writing via the student handbooks of the screening procedures. Parents will be notified regarding any defects found during the screenings.
8. School administration shall assure compliance with all Connecticut General Statutes pertaining to health examination and immunizations.
9. Expulsion procedures for those transfer students not complying with the above requirements will be covered in Administrative Regulations.

The school nurse who is required to verify the immunization status for children enrolled in District schools, pre-K to grade 12, inclusive, pursuant to C.G.S. 10-204a, shall be provided with sufficient information on the children living within his/her jurisdiction and is listed on the Department of Public Health's registry of immunization status. The school nurse is authorized to determine which children in their jurisdiction are overdue for scheduled immunizations and provide outreach to help get them vaccinated.

Legal References: Connecticut General Statutes
10-204a Required Immunizations
10-206 Health Assessments
10-214.4 Vision, audiometric and postural screenings
Notification of parents re defects; record of results, as amended by
P.A. 96-229,
14-230, An Act Concerning Minor Revisions to the Education
Statutes.
3a, 10-204a-4
Section 4 of P.A. 14-231

Cross Reference: Interscholastic competition 6145.2

Adopted: November 13, 1979
Revised: May 29, 1984
October 26, 1992
February 9, 1998
March 23, 1998
January 27, 2003

September 22, 2014

STUDENTS

Reporting of Child Abuse

The Board of Education recognizes that a student's mental and physical health will have an effect on the student's ability to obtain the most benefit from attending school. In order to increase the student's ability to learn while in school, the Board of Education realizes the importance of identifying students who may be suffering from abuse, neglect or placed in imminent danger of serious harm. Pursuant to Connecticut General Statutes 17a-101, as amended, all school employees, including the Superintendent of Schools, administrators, teachers, substitute teachers, guidance counselors, paraprofessionals, psychologists and social workers, coaches of intramural or interscholastic athletics, as well as school nurses, physicians, working in the school system, or any other person who, in the performance of his or her duties, has regular contact with students and who provides services to or on behalf of students enrolled in District schools, who suspects child abuse or neglect must first report it to the Department of Children and Families or to a law enforcement agency. When a school employee suspects child abuse, neglect or that a child has been placed in imminent risk of serious harm, he/she shall within twelve (12) hours make an oral report by telephone or in person to the Commissioner of Children and Families, or a law enforcement agency, followed within 48 hours with a written report. The Building Principal shall be notified immediately after the oral report has been made and the principal in turn will notify the Superintendent of Schools and the child's parents. The written report prepared and submitted by the mandated reporter shall also be submitted to the Principal.

Any school personnel who has reasonable cause to suspect that a district employee is abusing a student shall orally report that suspicion as soon as possible but no later than twelve (12) hours by telephone or in person to the Commissioner of Children and Families followed no later than 48 hours of making the oral report with a written report to the Department of Children and Families. The Superintendent of Schools or supervising agent may be notified immediately after the oral report has been made. The Commissioner of Children and Families or his/her designee, is required to notify the head of a school, except when that person is the alleged perpetrator. The Superintendent or supervising agent must: 1) immediately notify parent(s) of the alleged abuse that a report has been made; and 2) immediately notify the Police Department of the alleged abuse.

In addition, the Superintendent or supervising agent must submit a written report of suspected child abuse or neglect by a school employee who has been entrusted with the care of a child and who holds a certificate, permit or authorization issued by the State Board of Education, to the Commissioner of Education or his/her representative. The Commissioner of the Department of Children and Families has a similar obligation. The Superintendent shall suspend a certified staff employee when the investigation produces evidence that the employee abused a child. The Department of Children and Families is required to send to the State Department of Education a copy of the report. Within seventy-two (72) hours after such suspension the Superintendent shall notify the Board of Education and the Commissioner of Education or his/her representative of the reasons for and conditions of the suspension. If the contract of employment of a school employee who possesses a certificate, permit or authorization issued by the State Board of Education is terminated, or if such certified school employee resigns his/her employment, as a result of an investigation which reveals that child abuse has occurred, the Superintendent shall notify the Commissioner of Education within 72 hours of such termination or resignation.

If the report of abuse or neglect involves an employee of the District as the perpetrator, the District may conduct its own investigation into the allegation, provided that such investigation

shall not interfere with or impede any investigation conducted by the Department of Children and Families or of law enforcement agencies.

The Superintendent shall maintain records of allegations, investigations and reports that a child has been abused or neglected by a school employee. Such records will be maintained in the District's Central Office. The records shall include any reports made to the Department of Children and Families. Such Department is to have access to all such records.

The Board recognizes that the Department of Children and Families is required to disclose records to the Superintendent of Schools in response to a mandated reporter's written or oral report of abuse or neglect or if the Commissioner of Children and Families has reasonable belief that a school employee abused or neglected a student. Not later than five (5) working days after an investigation of child abuse or neglect by a school employee has been completed, DCF is required to notify the Superintendent and the State Department of Education of the investigation's results. If DCF has reasonable cause, and recommends the employee be placed on DCF's Child Abuse and Neglect Registry, the Superintendent shall suspend such employee.

The Board, recognizing its responsibilities to protect children and in compliance with its statutory obligations shall provide in-service regarding the requirements and obligations of mandated reporters. In addition, all District employees shall complete a training program pertaining to the accurate and prompt reporting of abuse and neglect, made available by the Commissioner of Children and Families. Also, all employees must complete a refresher program at least once every three years. ~~Employees hired before July 1, 2011 must complete the refresher training program by July 1, 2012 and must retake it once every three years thereafter.~~

This policy will be distributed annually to all employees. Documentation shall be maintained that all employees have, in fact, received the written policy and completed training related to mandated reporting of child abuse and neglect as required by law.

The Board shall not retaliate against any mandated reporter for his/her compliance with the law and Board policy pertaining to the reporting of suspected child abuse and neglect.

Legal Reference: Connecticut General Statutes

10-220a Inservice training. Professional development committees. Institutes for educators. Cooperating teacher program, regulations (as amended by PA 11-93)

10-221d Criminal history records check of school personnel. Fingerprinting. Termination or dismissal (as amended by PA 11-93)

17a-28 Definitions. Confidentiality of and access to records; exceptions. Procedure for aggrieved persons. Regulations (as amended by PA 11-93)

17a-101 Protection of children from abuse. Reports required of certain professional persons. When child may be removed from surroundings without court order. (as amended by PA 96-246, PA 00-220, PA 02-106, PA 03-168 PA 09-242 and PA 11-93)

17a-101a Report of abuse or neglect by mandated reports. (as amended by PA 02-106 and PA 11-93)

17a-102 Report of danger of abuse. (as amended by PA 02-106)

17a-106 Cooperation in relation to prevention, identification and treatment of child abuse/neglect.

10-151 Teacher Tenure Act

P.A. 11-93 An Act Concerning the Response of School Districts and the Departments of Education and Children and Families to Reports of Child Abuse and Neglect and the Identification of Foster Children in a School District

PA 14-186 An Act Concerning the Department of Children and Families and the Protection of Children

Adopted: June 25, 1984
September 24, 1990
April 7, 1997
November 24, 2003
November 23, 2009
February 13, 2012

INSTRUCTION

Statewide Proficiency/Mastery Examinations

Each student enrolled in grades three through eight inclusive and tenth or eleventh grades shall take a ~~statewide~~ mastery examination (measuring whether or not a student has mastered essential grade level skills in reading, language arts, mathematics ~~and science~~). The mastery examination shall be provided by and administered under the supervision of the State Board of Education.

Student scores on each component of the statewide tenth or eleventh grade state assessment ~~mastery test (CAPT)~~ may be included on the permanent record and transcripts of students. Students who meet or exceed the statewide mastery goal on any component of the statewide tenth or eleventh grade mastery examination, shall have a certification of such mastery made on the permanent record and transcript and be provided a certificate of mastery for each such component. A student who has not met the mastery goal level on each component of the mastery examination may annually take or retake each such component at its regular administration until the student scores at or above each goal level or until the student graduates or turns twenty-one (21).

The school district may not require achievement of a satisfactory score on the statewide proficiency examination or statewide mastery examination, or any subsequent retest on a component of such examinations as the sole criterion of promotion or graduation.

Special education students shall participate in mastery testing except in the rare case when their Planning and Placement Team determines that participation would be inappropriate and recommends the use of an alternative assessment as specified by the State Board of Education.

Limited English proficient (LEP) students, including those also identified as requiring special education, who are in their first year of enrollment in a U.S. school and have been in attendance for one school year or less may be permitted to be exempt from one administration of the reading/language arts portion of the mastery examination. ~~Connecticut Mastery Test (CMT) and the Connecticut Academic Progress Test (CAPT)~~. These students must take the Language Assessment Scales (LAS-Links). No such exemption is permitted, based on federal guidelines, from the mathematics and science assessments ~~of the CMT and CAPT~~. Accommodations, as provided in classroom instruction may be used.

Limited English proficient students eligible for special education due to significant cognitive impairment must be tested on a ~~the CMT/CAPT~~ Skills Checklist, regardless of the one school year exemption option.

Any alternate assessment, including a ~~the CMT/CAPT~~ Skills Checklist, of students enrolled in special education, shall be available only to those students with significant cognitive disabilities. In compliance with federal law, out-of-level testing is not an option for students enrolled in special education.

In compliance with federal legislation, a participation standard of 95 percent of the total school population, as well as for each subgroup (e.g. race/ethnicity, gender, special education, bilingual/ESL, eligibility for free and reduced lunch), will be the participation goal.

(cf. 5121 - Examination/Grading/Rating)

(cf. 5125 - Student Records; Confidentiality)

(cf. 6146 - Graduation Requirements)

Legal Reference: Connecticut General Statutes

10-14n Statewide mastery examination. Conditions for reexamination. Limitation on use of test results. (as amended by PA 03-174 and PA 03-168)

10-14o Compensatory education grant. Financial statement of expenditures.

10-14p Reports by local and regional boards re instructional improvement and student progress.

10-14q Exceptions (as amended by PA 01-205)

PL 107-110 – Title I, 34 CFR Part 200

34 CFR, Part 200 Regulations appearing in Federal Register, 9/13/06.

Adopted: November 10, 2003

Revised: July 13, 2009

March 3, 2015

Dear Gary,

Please be advised that I will not be returning to teach French during the 2015-2016 academic year at Somers High School.

Sincerely,



Ann Levesque



"Our commitment to the future"

Mabelle B. Avery Middle School Somers Public Schools

1 Vision Boulevard • Somers, Connecticut 06071 • 860-749-2270 • Fax 860-763-2073

Clay Krevolin
Principal

Rob Kapner
Assistant Principal

Clay Krevolin
Principal
Mabelle B. Avery Middle School
Somers, CT 06071

Bryan Hull
Technology Education
Mabelle B. Avery Middle School
Somers, CT 06071

February 26, 2015

Dear Mr. Krevolin,

Please accept this as formal notification that I am resigning from my position as a Technology Education Teacher at Mabelle B. Avery Middle School at the end of the 2014-2015 school year. Thank you for the opportunity to work in such an innovative and welcoming school community.

My time at Somers has been both eye-opening and rewarding working with wonderful students, staff and administrators. I will be leaving to travel the country and continue my education and career in the western United States. Please let me know if there is anything I can do to aid during the transition.

Thank you again and I hope to stay in touch in the future.

Sincerely,

Bryan Hull

Somers Elementary School Roof Replacement The Town Of Somers

Ninth District Road
Somers, Connecticut 06071



- DRAWING LIST:
- CS - COVER SHEET
 - A1 - Overall Roof Plan
 - A2 - Roof Plan Part "A"
 - A3 - Roof Plan Part "B"
 - A4 - Roof Details



SILVER / PETRUCELLI + ASSOCIATES
Architects / Engineers / Interior Designers

3190 Whitney Avenue, Hamden, CT 06518-2340
Tel. 203 230 9007 Fax. 203 230 8247
silverpetrucci.com

State Project # TMP-129-RRGH

Date, 3/2/2015

Somers Elementary School Roof Replacement Project

02-Mar-15

Ninth District Road Somers, CT

Owner: TOWN OF SOMERS

JOB NO: 14.315

OPINION OF PROBABLE CONSTRUCTION COST
49,719 (SQARE FEET)

EPDM 1/4" per Foot Tapered Insulation)

CT STATE PROJECT # TMP-129-RRGH

SECTION NUMBER	WORK CATEGORIES	QTY.	UNIT	MATERIAL COST		LABOR COST		ALLOWANCE	TOTAL \$	CT INELIGIBLE
				UNIT \$	TOTAL	UNIT \$	TOTAL			
OTHER COSTS										
	STATE PERMIT						26/\$1,000	\$500.00	\$500	\$500
	BONDS, INSURANCE & PERMIT PER STATE LAW	1	LS					\$5,000.00	\$5,000	\$5,000
OTHER SUB-TOTAL								\$5,500		TOTAL: \$5,500
DIVISION TWO										
	DUMPSTERS	10	EA	\$1,000.00	\$10,000				\$10,000	\$0
	EXISTING ROOF EPDM ROOF/ INSULATION	25,803	SF		\$0	\$0.80	\$20,642		\$20,642	\$0
	EXISTING BUILT UP ROOF SYSTEM	15,456	SF		\$0	\$1.20	\$18,547		\$18,547	\$0
	EXISTING ASPHALT SHINGLES	963	SF	\$0.00	\$0	\$1.20	\$1,156		\$1,156	\$0
	DEMO - WOOD BLOCKING	3500	LF	\$0.00	\$0	\$2.00	\$7,000		\$7,000	\$0
	DEMO - EXIST. MECH. CURBS	45	EA		\$0	\$100.00	\$4,500		\$4,500	\$0
	CRANE RENTAL (UNIT LIFTING)	1	LS					\$10,000	\$4,000	\$0
	DEMO - METAL FLASHING	3,812	LF			\$3.75	\$14,295		\$14,295	\$0
DIVISION TWO SUB-TOTAL								\$80,140		TOTAL: \$0
DIVISION FIVE										
	METAL FLASHING	3,812	LF	\$10.00	\$38,120	\$8.00	\$30,496		\$68,616	\$0
	METAL CONDUCTOR HEAD	36	EA	\$75.00	\$2,700	\$20.00	\$720		\$3,420	\$0
	METAL DOWNSPOUTS	36	EA	\$100.00	\$3,600	\$20.00	\$720		\$4,320	\$0
	METAL STAIR CASE	1	EA	\$5,000.00	\$5,000	\$2,500.00	\$2,500		\$7,500	\$7,500
	METAL CAP	195	LF	\$20.00	\$3,900	\$12.00	\$2,340		\$6,240	\$0
DIVISION FIVE SUB-TOTAL								\$90,096		TOTAL: \$7,500
DIVISION SIX										
	5% TOTAL DECK REPLACEMENT ALLOWANCE	2,485	SF	\$1.50	\$3,728	\$2.00	\$4,970		\$8,698	\$0
	PERIMETER WOOD BLOCKING	5,180	BF	\$1.25	\$6,475	\$1.00	\$5,180		\$11,655	\$0
	MECH. UNIT WOOD BLOCKING	3,000	BF	\$1.25	\$3,750	\$1.00	\$3,000		\$6,750	\$0
DIVISION SIX SUB-TOTAL								\$ 27,103		TOTAL: \$0
DIVISION SEVEN										
	TAPERED INSULATION (6" THICK)	48,756	SF	\$1.90	\$92,636	\$2.00	\$97,512		\$190,148	\$0
	COVERBOARD	48,756	SF	\$1.20	\$58,507	\$1.35	\$66,821		\$124,328	\$0
	EPDM ROOFING MEMBRANE	48,756	SF	\$1.50	\$73,134	\$1.50	\$73,134		\$146,268	\$0
	ASPHALT SHINGLES	10	SQ	\$250.00	\$2,500	\$350.00	\$3,500		\$6,000	\$0
	SAW CUTTING FOR REGRETS & METAL	946	LF	\$4.45	\$4,210	\$4.00	\$3,784		\$7,994	\$0
	VENT STACKS	23	EA	\$25.00	\$575	\$60.00	\$1,380		\$1,955	\$0
	PITCH POCKET	12	EA	\$100.00	\$1,200	\$120.00	\$1,440		\$2,640	\$0
	WALKWAY PADS	3,500	SF	\$2.00	\$7,000	\$4.00	\$14,000		\$21,000	\$0
	SEALANTS	1	LS					\$5,000	\$2,500	\$0
	MISC ROOF ACCESSORIES	1	LS					\$5,000	\$5,000	\$5,000
	ADHESIVES	1	LS					\$8,000	\$8,000	\$0
DIVISION SEVEN SUB-TOTAL								\$515,833		TOTAL: \$5,000
DIVISION SIXTEEN										
	CAST IRON PIPING	30	LF	\$15.00	\$450	\$10.00	\$300		\$15,600	\$0
	ROOF DRAIN & SUMP	8	EA	\$400.00	\$3,200	\$300.00	\$2,400		\$5,600	\$0
DIVISION SIXTEEN SUB-TOTAL								\$21,200		TOTAL: \$0
CONSTRUCTION COST PER SQUARE FOOT = \$18.60										
SUBTOTAL =								\$739,872		
GEN. CONDITIONS 10.00%									\$73,987	
OVERHEAD & PROFIT 15.00%									\$110,981	
Subtotal									\$924,840	
CONSTRUCTION TOTAL =								\$924,840	TOTAL: \$18,000	
Contingency 10%									\$92,484	
Environmental Test & Design Fees									\$5,464	
A/E FEES =									\$17,856	\$348
GRAND TOTAL								\$1,040,643	TOTAL \$18,348	
CONSTRUCTION COST ONLY FOR ALTERNATE ROOFING SYSTEMS										
	MODIFIED BIT. ROOFING SYSTEM	49,719	SF	\$20.00	\$994,380				\$994,380	
	TPO ROOFING SYSTEM	49,719	SF	\$19.00	\$944,661				\$944,661	

SILVER PETRUCCELLI ASSOCIATES
Architects & Engineers

390 Whitney Avenue
Hamden, CT 06518
Phone 203 210-9007 ext 203
Fax 203 210-8247
www.silverpetrucelli.com



Somers High School Roof Replacement The Town Of Somers

Ninth District Road
Somers, Connecticut 06071

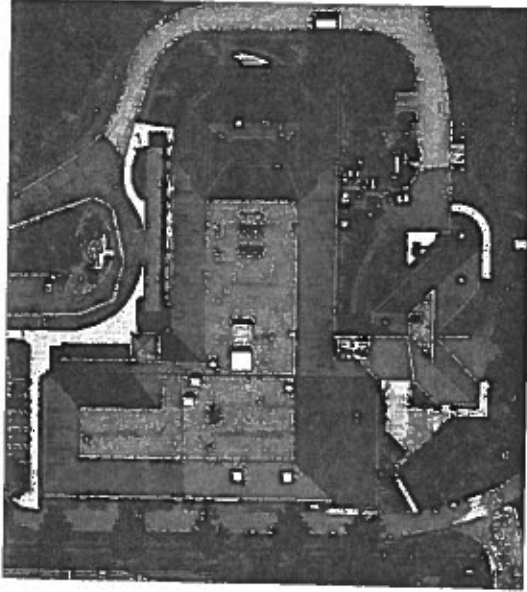

SILVER / PETRUCELLI + ASSOCIATES
Architects / Engineers / Interior Designers

3190 Whitney Avenue, Hamden, CT 06518-2140
Tel. 203 230 9007 Fax. 203 230 8247
silverpetrucci.com

DRAWING LIST:

- CS - COVER SHEET
- A1 - Overall Roof Plan
- A2 - Roof Details

State Project # TMP-129-DPVW

Date, 3/2/2015

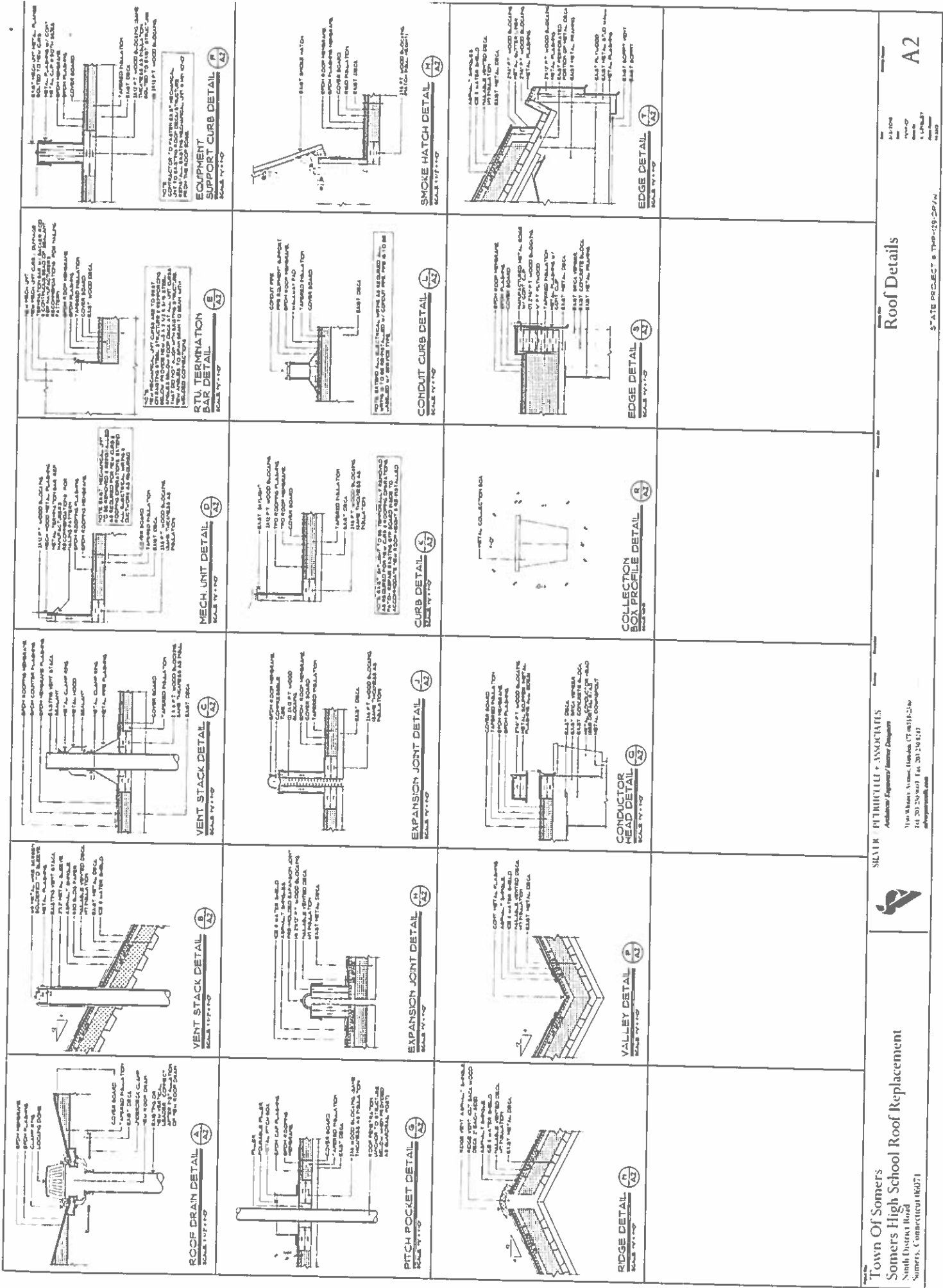

Town Of Somers
Somers High School Roof Replacement
South District Road
Somers, Connecticut 06071



SIXIR PIRICHILLI & ASSOCIATES
Architectural Engineers/Interior Designers
1145 Shennecossett Avenue, Hamden, CT 06517-2146
Tel: 203 339-6100 Fax: 203 339-6117
www.sixirarch.com

Roof Details

A2

STATE PROJECT # TRP-139-2074

Somers High School Roof Replacement Project

02-Mar-15

Ninth District Road Somers, CT

Owner: TOWN OF SOMERS

JOB NO: 14.330

OPINION OF PROBABLE CONSTRUCTION COST
79,138 (SQUARE FEET)

Asphalt Shingles & EPDM 1/4" per Foot Tapered Insulation)

CT STATE PROJECT # TMP-129-DP\VV

SECTION NUMBER	WORK CATEGORIES	QTY.	UNIT	MATERIAL COST		LABOR COST		ALLOWANCE	TOTAL \$	CT INELIGIBLE
				UNIT \$	TOTAL	UNIT \$	TOTAL			
OTHER COSTS										
	STATE PERMIT						.26/\$1,000	\$500.00	\$500	\$500
	BONDS, INSURANCE & PERMIT PER STATE LAW	1	LS					\$5,000.00	\$5,000	\$5,000
OTHER SUB-TOTAL								\$5,500		\$5,500
DIVISION TWO										
	DUMPSTERS	10	EA	\$1,000.00	\$10,000				\$10,000	\$0
	EXISTING ROOF EPDM ROOF/INSULATION	32,074	SF		\$0	\$0.80	\$25,659		\$25,659	\$0
	EXISTING ASPHALT SHINGLES	47,064	SF	\$0.00	\$0	\$1.20	\$56,477		\$56,477	\$0
	DEMO - WOOD BLOCKING	3500	LF	\$0.00	\$0	\$2.00	\$7,000		\$7,000	\$0
	DEMO - EXIST. MECH. CURBS	45	EA		\$0	\$100.00	\$4,500		\$4,500	\$0
	CRANE RENTAL (UNIT LIFTING)	1	LS					\$10,000	\$4,000	\$0
	DEMO - METAL FLASHING	3,454	LF			\$3.75	\$12,953		\$12,953	\$0
DIVISION TWO SUB-TOTAL								\$120,588		\$0
DIVISION FIVE										
	METAL FLASHING	3,454	LF	\$10.00	\$34,540	\$8.00	\$27,632		\$62,172	\$0
	METAL BUILT-IN GUTTER	1,447	LF	\$25.00	\$36,175	\$20.00	\$28,940		\$65,115	\$0
	METAL CONDUCTOR HEAD	14	EA	\$75.00	\$1,050	\$20.00	\$280		\$1,330	\$0
	METAL DOWNSPOUTS	36	EA	\$100.00	\$3,600	\$20.00	\$720		\$4,320	\$0
DIVISION FIVE SUB-TOTAL								\$132,937		\$0
DIVISION SIX										
	5% TOTAL DECK REPLACEMENT ALLOWANCE	3,956	SF	\$1.50	\$5,934	\$2.00	\$7,912		\$13,846	\$0
	PERIMETER WOOD BLOCKING	5,180	BF	\$1.25	\$6,475	\$1.00	\$5,180		\$11,655	\$0
	MECH. UNIT WOOD BLOCKING	3,000	BF	\$1.25	\$3,750	\$1.00	\$3,000		\$6,750	\$0
	BUILT-IN GUTTER WOOD BLOCKING	1,447	BF	\$5.00	\$7,235	\$4.00	\$5,788		\$13,023	\$0
	VENTED NAILABLE DECK	32,074	SF	\$4.00	\$128,296	\$2.00	\$64,148		\$192,444	\$0
DIVISION SIX SUB-TOTAL								\$237,718		\$0
DIVISION SEVEN										
	TAPERED INSULATION (6" THICK)	32,074	SF	\$1.90	\$60,941	\$2.00	\$64,148		\$125,089	\$0
	COVERBOARD	32,074	SF	\$1.20	\$38,489	\$1.35	\$43,300		\$81,789	\$0
	EPDM ROOFING MEMBRANE	32,074	SF	\$1.50	\$48,111	\$1.50	\$48,111		\$96,222	\$0
	ASPHALT SHINGLES	472	SQ	\$250.00	\$118,000	\$350.00	\$165,200		\$283,200	\$0
	ICE & WATER SHIELD	172	SQ	\$75.00	\$12,900	\$25.00	\$4,300		\$17,200	\$0
	#30 BUILDING PAPER	300	SQ	\$30.00	\$9,000	\$15.00	\$4,500		\$13,500	\$0
	SAW CUTTING FOR REGLETS & METAL	500	LF	\$4.45	\$2,225	\$4.00	\$2,000		\$4,225	\$0
	VENT STACKS	32	EA	\$25.00	\$800	\$60.00	\$1,920		\$2,720	\$0
	PITCH POCKET	16	EA	\$100.00	\$1,600	\$120.00	\$1,920		\$3,520	\$0
	WALKWAY PADS	3,500	SF	\$2.00	\$7,000	\$4.00	\$14,000		\$21,000	\$0
	SEALANTS	1	LS					\$5,000	\$2,500	\$0
	MISC ROOF ACCESSORIES	1	LS					\$5,000	\$5,000	\$5,000
	ADHESIVES	1	LS					\$8,000	\$8,000	\$0
DIVISION SEVEN SUB-TOTAL								\$863,884		\$5,000
DIVISION SIXTEEN										
	CAST IRON PIPING	50	LF	\$15.00	\$750	\$10.00	\$500		\$15,600	\$0
	ROOF DRAIN & SUMP	19	EA	\$400.00	\$7,600	\$300.00	\$5,700		\$13,300	\$0
DIVISION SIXTEEN SUB-TOTAL								\$28,900		\$0
CONSTRUCTION COST PER SQUARE FOOT = \$18.79								SUBTOTAL =	\$1,189,608	
								GEN. CONDITIONS 10.00%	\$118,961	
								OVERHEAD & PROFIT 15.00%	\$178,441	
								Subtotal	\$1,487,010	
								CONSTRUCTION TOTAL =	\$1,487,010	TOTAL \$10,500
								Contingency 10%	\$148,701	
								Environmental Test & Design Fees	\$5,464	
								A/E FEES =	\$27,844	\$2,048
GRAND TOTAL								\$1,669,019	TOTAL \$12,548	
CONSTRUCTION COST ONLY FOR ALTERNATE ROOFING SYSTEMS										
	MODIFIED BIT ROOFING SYSTEM	32,074	SF	\$20.00	\$641,480				\$641,480	
	TPO ROOFING SYSTEM	32,074	SF	\$19.00	\$609,406				\$609,406	

SILVER PETRUCELLI & ASSOCIATES
Architects & Engineers

1190 Whitney Avenue
Hamden, CT 06518
Phone 203 230 9007 ext 203
Fax 203 230 8247
www.silverpetrucci.com



GEN. CONDITIONS	10.00%	\$118,961	
OVERHEAD & PROFIT	15.00%	\$178,441	
Subtotal		\$1,487,010	
CONSTRUCTION TOTAL =		\$1,487,010	TOTAL \$10,500
Contingency 10%		\$148,701	
Environmental Test & Design Fees		\$5,464	
A/E FEES =		\$27,844	\$2,048
GRAND TOTAL		\$1,669,019	TOTAL \$12,548

	A	B	C	D	E	F	G	H	I	J					
1	Course Request Tally														
2	Build: 2015 - 2016 Catalog: 2015-2016														
3	<u>Course</u>	<u>Course Name</u>	<u>Primary</u>	<u>Sections</u>	<u>Class Size</u>		<u>Disipline</u>	<u>Sections Available</u>	<u>Sections Allocated</u>						
4	Each full time staff member teaches 5 sections (i.e. 3 Art Teachers=15 Art)														
5	101	Intro/Art (1)	108	6	18.00		Art	15	15						
6	110	Computer Animation (2)	21	1	21.00										
7	111	Computer Art (2)	29	1	29.00										
8	114	Printmaking (2)	35	2	17.50										
9	116	Adv. D. & P./Portfolio (3)	15	1	15.00										
10	134	Honors Art (4)*	11	1	11.00										
11	140	Ceramics 1 (2)	99	4	24.75										
12	141	Ceramics 2 (3)	51	2	25.50										
13	142	Drawing 1 (2)	79	4	19.75										
14	143	Drawing 2 (3)	28	1	28.00										
15	144	Sculpture 1 (2)	83	3	27.67										
16	145	Sculpture 2 (3)	33	2	16.50										
17	148	AP Art (4)*	2	1	2.00										
18	152	Fundamentals of Music/Theory (2)	7	1	7.00					Music	4	4			
19	156	Band (2)	55	1	55.00										
20	157	Chorus (2)	24	1	24.00										
21	158	Jazz Choir (3)	12	1	12.00										
22	159	Music in Society (2)	18	1	18.00										
23	201	A Intro. Business (2)	88	4	22.00		Business	10	10						
24	204	Computer Applications II (3)	45	2	22.50										
25	205	Computer Applications I (2)	125	4	31.25										
26	210	Entrepreneurship (3)	18	1	18.00										
27	211	Marketing (3)	26	1	26.00										
28	221	B Intro. Business (2)	82	4	20.50										
29	226	Accounting 1 (2)	28	1	28.00										
30	227	Accounting 2 (3)	3	0											
31	228	Effective Leadership	5	0		On-Line IS									
32	232	Business Law 1 (3)	24	1	24.00										
33	233	Business Law 2 (3)	8	0											
34	321	Hon. English 9 (4)	27	2	13.50		English	30	30						
35	322	Col. English 9 (3)	87	6	14.50										

	A	B	C	D	E	F	G	H	I	J
36	324	Hon. English 10 (4)	26	2	13.00		Wlang	12 Av/12 AI	8 Av /7 AI	
37	325	Col. English 10 (3)	90	5	18.00					
38	327	Hon. English 11 (4)	22	1	22.00					
39	328	Col. English 11 (3)	73	4	18.25					
40	329	Acad. English 11 (2)	9	1	9.00					
41	331	AP/UCONN ECE English 12 (4)	16	1	16.00					
42	332	Col. English 12 (3)	84	5	16.80					
43	333	Acad. English 12 (2)	8	1	8.00					
44	340	Speech and Debate (3)	14	1	14.00					
45	341	Crt Writ Poetry (3)**	3	1	3.00					
46	342	Fantasy (3)**	5							
47	343	SAT E Prep (1)	37	1	37.00					
48	344	Crt Writ Fiction (3)**	10							
49	345	Drama (3)	4	1	4.00					
50	352	Spanish 1A (2)	3							
51	353	Spanish 1B (2)	22	2	11.00					
52	354	Hon. Spanish 2 (4)	48	3	16.00					
53	355	Spanish 2 (3)	21	1	21.00					
54	356	Hon. Spanish 3 (4)	32	2	16.00					
55	357	Spanish 3 (3)	31	2	15.50					
56	358	Hon. Spanish 4 (4)	14	1	14.00					
57	359	Spanish 4 (3)	16	1	16.00					
58	361	French 1B (2)	3	0						
59	362	Hon. French 2 (4)	9	1	9.00					
60	363	French 2 (3)	9	1	9.00					
61	364	Hon. French 3 (4)	17	1	17.00					
62	365	French 3 (3)	12	1	12.00					
63	366	Hon. French 4 (4)	13	1	13.00					
64	367	French 4 (3)	8	1	8.00					
65	368	Hon. French 5 (4)	8	1	8.00					
66	389	Hon. Spanish 5 (4)	10	1	10.00					
67	412	Probability and Statistics (3)	30	2	15.00					
68	413	Trigonometry (3)***	25	3	8.33					
69	415	Calculus (4)	16	1	16.00					
70	425	Algebra 1 (3)	41	3	13.67					
71	426	Geometry (3)	53	3	17.67					

	A	B	C	D	E	F	G	H	I	J		
72	427	Honors Geometry (4)	38	3	12.67							
73	428	Algebra 2 (3)	68	4	17.00							
74	429	Hon. Algebra 2 (4)	38	2	19.00							
75	431	Consumer Math (2)	25	2	12.50							
76	432	Advanced Math (3)	63	3	21.00							
77	434	Elem. Functions (4)	20	1	20.00							
78	440	Topics in Geometry (2)	10	1	10.00							
79	443	SAT M Prep (1)	34	1	34.00							
80	447	Topics in Algebra II (1)	13	1	13.00							
81	456	AP/UCONN ECE Calculus (4)	6	1	6.00							
82	475	AP Statistics (4)	15	1	15.00							
83	502	Physical Ed: Team Games/Activit	189	8	23.63	PE/Health					10	10
84	503	P.E. 2 (1)	52	2	26.00							
85	506	Physical Education: Ind. Games/A	42	2	21.00							
86	513	Health 3&4 (1)	211	10	21.10							
87	600	Integrated Science (3)	114	6	19.00	Science					29	29
88	606	Anatomy/Physiology (4)	30	2	15.00							
89	607	Microbiology	14	1	14.00							
90	611	Botany (2)	49	3	16.33							
91	612	Marine Science (3)	37	2	18.50							
92	614	Science and Law (2)	4	0								
93	616	Survey in Forensics (2)	53	3	17.67							
94	623	Biology (3)	119	6	19.83							
95	625	Zoology, Exploring the Animal Ki	85	5	17.00							
96	626	AP/UCONN ECE Biology (4)	15	1	15.00							
97	627	Chemistry (3)	32	2	16.00							
98	628	Honors Chemistry (4)	58	3	19.33							
99	629	AP Chemistry (4)	5	1	5.00							
100	630	Col. Physics (4)	29	2	14.50							
101	702	World History (3)	114	6	19.00	SS					25	25
102	704	Current Affairs (2)	13	1	13.00							
103	705	World Between Wars (3)	26	1	26.00							
104	707	Anc. History (3)	20	1	20.00							
105	708	Med. History (3)	15	1	15.00							
106	712	AP/UCONN ECE U.S. Hist 1 (4)	28	2	14.00							
107	714	Gov./Pol. (3)	7	1	7.00							

	A	B	C	D	E	F	G	H	I	J	
108	716	Psychology (3)	77	4	19.25		Tech Ed Food	15	15		
109	717	Philosophy (3)	21	1	21.00						
110	718	Sociology (3)	21	1	21.00						
111	719	Principles of Law (3)	11	1	11.00						
112	720	US Hist./Civics 1 (3)	118	6	19.67						
113	721	US Hist./Civics 2 (3)	79	4	19.75						
114	728	Trial Techniques (3)	26	1	26.00						
115	907	Manufacturing Woodworking (2)	21	2	10.50						
116	908	Manufacturing Metalworking (2)	20	2	10.00						
117	909	Advanced Manufacturing (3)	10	1	10.00						
118	911	Sci. Prin. of Tech (3)	15	1	15.00						
119	912	Res. and Dev. (4)	12	1	12.00						
120	913	Welding (2)	20	2	10.00						
121	940	World of Technology (2)	36	3	12.00						
122	943	Engineering Graphics II w/CAM (3)	12	1	12.00						
123	944	Engin. Graphics I with Solidworks (3)	34	3	11.33						
124	945	Digital Photography (2)	57	4	14.25						
125	947	Robotics (2)	24	2	12.00						
126	953	Architectural Design (3)	17	1	17.00						
127	954	Graphic Design I (3)	87	6	14.50						
128	955	Graphic Design II (3)	31	2	15.50						
129	956	Graphic Design III (3)	6	1	6.00						
130	989	Food Service and Management I (3)	45	3	15.00						
131	994	Food Service and Management II (3)	17	2	8.50						
132											
133											
134											
135		* Combined Classes									
136		** Combined Classes									
137		*** We expect this number will increase thus allowing for three sections. If not, an additional Advanced Math will be added.									
138		Will only run if these meet the 10 mininum									

	K	L
1		
2		
3		
4	Section 1	
5		
6		
7		
8		
9		
10		
11		
12		
13		
14		
15		
16		
17		
18		
19		
20		
21		
22		
23		
24		
25		
26		
27		
28		
29		
30		
31		
32		
33		
34		
35		



From the desk of:
Gary M. Cotzin
Principal, Somers High School
Phone: 860.749.2270 x4103
Email: gary.cotzin@somers.k12.ct.us

“One School, One Voice, One Belief, One Outcome”

MEMORANDUM

To: Dr. Maynard Suffredini

Date: March 4, 2015

Re: Class Section Comparison

Below is a table that compares class sections from this year to projected class sections for the 2015/2016 school year. I have also attached a master schedule, based on student requests and expected sections/class size.

Discipline	2014/2015	2015/2016	Net Gain/Loss
English	32	32	0
Math	32	32	0
Social Studies	26	25	-1
Science	29	29	0
World Language	20	20	0
Art	13	15	+2
PE/Health	10	10	0
Business	10	10	0
Tech Ed	17	15	-2
Music	4	4	0

Computer Animation and Computer Art are being switched out of Tech Ed and added to Art.