

**SIOUX FALLS SCHOOL BOARD**  
**Monday, March 10, 2025 4:00 PM**

**Carly Reiter**  
**President**

**Instructional Planning Center**  
**201 East 38<sup>th</sup> Street, Sioux Falls**

**Cory Clasemann**  
**Southeast Tech President**

This agenda may also be viewed on the District and Southeast Tech's website: [www.sf.k12.sd.us](http://www.sf.k12.sd.us) and [www.southeasttech.edu](http://www.southeasttech.edu)

## **AGENDA**

- I. Call to Order
- II. Pledge of Allegiance
- III. Good News Report
- IV. Persons Wishing to Address School Board on Non-Agenda Items
- V. Persons Wishing to Address the School Board on Agenda items
- VI. Approval of Minutes of February 5, 2025.
- VII. Approval of Agenda
- VIII. Conflicts of Interest
- IX. Approval of Consent Agenda
  - A. Authorizations and Ratifications
    1. Approval of Contracts
  - B. Approval of Consolidated Report of Trust and Agency Funds
  - C. Approval of Personnel Report
- X. Reports of the President
  - A. Academic Program Update - Architectural Engineering, Civil Engineering, Land Surveying
  - B. Accessibility Services Update
- XI. Adjournment

SCHOOL BOARD MEETING

Wednesday, February 5, 2025

The School Board of the Sioux Falls School District 49-5 of Minnehaha County, South Dakota, was called into regular session, pursuant to due notice, on Wednesday, February 5, 2025, at 4:00 p.m. in the Instructional Planning Center, 201 East 38<sup>th</sup> Street. Sioux Falls, South Dakota, with the following members present: Dawn Marie Johnson, Nan Kelly, Marc Murren (arrived at 4:03 p.m.), Gail Swenson. Absent: President Carly Reiter.

Action ST00885

A motion was made by Nan Kelly and seconded by Gail Swenson, three (3) votes “yes” on roll call **approving the minutes of meetings** held on January 8, 2025, and which were furnished to the Sioux Falls Argus leader for publication, in unapproved form, all in accordance with SDCL §13-8-35.

Action ST00886

A motion was made by Gail Swanson and seconded by Nan Kelly, three (3) votes “yes” on roll call, **approving the agenda as presented.**

\* \* \* \* \*

Dawn Marie Johnson asked about any conflicts of interest. None were brought forward.

Action ST00887

A motion was made by Nan Kelly and seconded by Gail Swenson, three (3) votes “yes” on roll call, **approving Item A through C on the consent agenda** as follows:

A. **Approving the Authorizations and Ratifications**, as follows:

A.1. **Approval of Contracts**

Authorizing the President to enter into and execute contracts, for and on behalf of the Southeast Technical College, as follows:

Item No.	Contract Number	Contractor	Project	Cost
a.	25-009, CC	Minnehaha County Sheriff	Campus Security Services	\$100,000+/-

A.2. **Approval/Ratification of Purchase Orders**

Authorizing the Business Manager to issue Purchase Order(s) requiring additional approval of the School Board as follows:

Item	PO No.	Vendor	Description	Total Cost
a.	<b>S2503656</b>	Frontier Precision Inc.	11 Survey Drones	\$134,778.00
b.	<b>S2503658</b>	Elevate Healthcare Inc.	Nursing Apollo Simulator	\$59,354.61
c.	<b>S2503870</b>	Vrsin, Inc.	Paint Spray Simulator	\$36,770.00
d.	<b>S2503871</b>	Midwest Veterinary Supply Inc.	Companion Therapy Laser System	\$26,200.00
e.	<b>S2503951</b>	Canon Medical Systems	Ultrasound System	\$128,650.00
f.	<b>S2504111</b>	Philips Health Care	Epiq Elite Ultrasound	\$109,999.82
g.	<b>S2504186</b>	Transact Campus Inc	Transact Annual Renewal	\$59,386.00

**3. Acknowledgement of New Housing Foundation Board of Directors Member**

Acknowledging the appointment of Mike Gray to the Southeast Technical College Housing Foundation Board of Directors filling a vacant position.

B. Approving the **Consolidated Report of Trust and Agency Funds** of February 5, 2025, and stating for the record that as of December 31, 2024, receipts total \$29,029,444.83 and disbursements total \$20,298,703.70 (MRF #ST651).

C. Accepting the **Southeast Tech Personnel Report**, as follows:

**C1. Resignations**

Accepting the resignation of School District Personnel as of the effective date indicated, the personnel having been previously employed by Board Action, as follows:

<u>Name</u>	<u>Location/Position</u>	<u>Effective Date</u>
<b>Student Help, Part-Time</b> Dawson, Grace	Scarborough	01-10-25
<b>Other Help, Part-Time</b> Miller, Amy	Foundation	01-23-25

**C2. Employment Recommendations**

<u>Name</u>	<u>Location/Position</u>	<u>Effective Date</u>	<u>Amount</u>
<b>Student Help, Part-Time, Hourly</b> Tonge, Jessica	Tutor	01-09-25	\$15.00
Radke-Kiesz, Alexandra	Tutor	01-09-25	\$15.00
Pieretti, Chantasia	Tutor	01-09-25	\$15.00
Hartz, Kyler	Scarborough	01-13-25	\$15.00
Ananayo, Aguiraya	Scarborough	01-20-25	\$15.00
Olsen, Mackenzie	Scarborough	01-14-25	\$15.00

**C2. Employment Recommendations, continued**

<b><u>Name</u></b>	<b><u>Location/Position</u></b>	<b><u>Effective Date</u></b>	<b><u>Amount</u></b>
<b>Instructor, Adjunct, Part-Time, Per Credit Hour</b>			
Castello-Pagan, Jennifer	Spanish	01-02-25	\$890.40
Oelkers, Kayla	Law Enforcement	01-08-25	\$821.50
Hakeman, Brad	Mechanical Engineering	01-08-25	\$821.50
<b>Instructor, Adjunct, Part-Time, Clinical Per Hour</b>			
Blegen, Michael	Nursing & Health	01-20-25	\$46.00
Koch, Sarah	Nursing & Health	01-27-25	\$46.00
<b>Instructor, Full-Time, Annual</b>			
Lalley, Aaron	Engineering Instructor 206-Day, 1.0 FTE Level 8, Step 10 103 days prorated	01-06-25	\$44,054.50
<b>Other Help, Part-Time, Hourly</b>			
Pinkert-Wirt, Melissa	Tutor	01-09-25	\$25.00
Trautwein, Laurel	Tutor	01-09-25	\$25.00
<b>Employment Contract, Full-Time, Annual</b>			
Timm, Douglas	Student Life Coordinator: Housing 12-Month, 1.0 FTE Level 7, Step 3 128 days prorated	01-02-25	\$28,489.07

**C3. Spring 2025 Wage Rates  
Employee Student Club Advisors, Stipend**

<b><u>Name</u></b>	<b><u>Location/Position</u></b>	<b><u>Effective Date</u></b>	<b><u>Amount</u></b>
Vis, Ashley	Basketball	02-01-25	\$1,598.50
Rogotzke, Kelli	Basketball	02-01-25	\$1,598.50
Andersen, Alex	Cocurricular	02-01-25	\$1,400.00
Landhuis, Carmen	Cocurricular	02-01-25	\$1,400.00

**Action ST00888**

STC Instructor Benjamin Ringling provided the Academic Update – Horticulture and Sports Turf Program Report (MRF #ST652). The Horticulture Technology program at STC offers a comprehensive and dynamic path for individuals interested in a career in horticulture, preparing graduates for various specialized roles within the industry. This program provides students with a deep understanding of plant identification, pest/disease management, plant propagation, greenhouse operations, tree care, landscape design/construction, and even managing a horticultural business. Through hands-on learning and faculty support, students in the Horticulture Technology program are trained to critically analyze and solve problems that may

arise in horticultural settings. The curriculum emphasizes the importance of collaborative problem solving and applying corrective measures when necessary. In addition to technical skills, students also develop strong communication abilities, preparing them to professionally interact with customers and other professionals within the horticulture industry. Graduates of the program can pursue careers in parks and recreation, grounds maintenance, landscape design/construction, plant nurseries, garden centers, greenhouse production, or even establish their own horticultural business.

The Sports Turf Management program at STC equips students with the knowledge and hands-on experience necessary for a successful career in grounds maintenance and turf management. Over the course of two years, students are trained in the operation of specialized grounds maintenance equipment and gain in-depth understanding in key areas such as soils, irrigation, fertilization, landscape construction, plant identification, pest management, and arboriculture. The program prepares graduates for a variety of career opportunities in industries including school grounds, city parks and recreation departments, golf courses, sports fields, lawn care, and landscaping. As a Sports Turf Management Technician, you get to combine your love for the outdoors with maintaining sports facilities.

Following general discussion, a motion was made by Nan Kelly and seconded by Gail Swenson, four (4) votes “yes” on roll call **acknowledging the Academic Program Update – Horticulture and Sports Turf Program Report.**

Action ST00889

Kally Jorgenson provided the Student Engagement Report (MRF #653). Highlights of the report include 1 - Fall Student Engagement Survey results and how we are using the results to make decision and implement programming 2 - Introduce student engagement opportunities including intramurals, academic organizations, clubs and events for students as well as attendance numbers 3 - The spring semester will continue to include programming that focuses on the STC Wellness Wheel, and the results seen in the Fall Student Engagement Survey and 4 – Areas we will continue to evaluate and assess as our students’ needs and interests change.

Following general discussion, a motion was made by Gail Swenson and seconded by Marc Murren, four (4) votes “yes” on roll call **acknowledging the Student Engagement Report.**

Action ST00890

Marcella Prokop provided the Access and Workforce Opportunity Update Report (MRF #ST654). The English Language Access Coach program is in its second year of assisting multilingual students as they prepare to enter STC and the workforce. The Indigenous Access Coach program began in the Fall 2024 semester. The update highlighted the work that has been done to help high school students learn about career pathways and training at STC as well as goals for the Spring 2025 semester.

Following general discussion, a motion was made by Nan Kelly and seconded by Gail Swenson, four (4) votes “yes” on roll call **acknowledging the Access and Workforce Opportunity Update Report.**

Action ST00891

President Cory Clasemann presented the Campus Master Plan Report (MRF #ST655). A team from STC has been working with ISG to create a campus master plan to guide campus development and redevelopment over the next twenty years. The plan focuses on growth, walkability and accessibility, connecting with neighborhood development, wayfinding, and keeping open space. This proposal includes building renovations, space for additional student housing, and space for new development should it be needed as the College’s enrollment increases. Finally, the plan includes ideas for how to continue smooth traffic flow along Career Ave. while simultaneously increasing safety for pedestrians.

Following general discussion, a motion was made by Nan Kelly and seconded by Gail Swenson, four (4) votes “yes” on roll call **acknowledging the Campus Master Plan.**

Action ST00892

A motion was made by Nan Kelly and seconded by Gail Swenson, four (4) votes “yes” on roll call, **approving the review of and/or revision of policies and the accompanying regulations** (see MRF #ST656), as follows:

- DJ/STC Expenditures**
- ECE/STC – Seat Belt Use**
- JIH/STC – Student Interrogations, Searches, and Arrests**

Action ST00893

On motion by Marc Murren and seconded by Nan Kelly, four (4) votes “yes” on roll call, the School Board **adjourned** at 5:17 p.m.

DAWN MARIE JOHNSON  
Presiding Officer

TODD VIK  
Business Manager



**SIOUX FALLS SCHOOL BOARD**  
**Monday, March 10, 2025 4:00 p.m.**

**Carly Reiter**  
**President**

**Instructional Planning Center**  
**201 East 38<sup>th</sup> Street, Sioux Falls**

**Cory Clasemann**  
**Southeast Tech President**

This agenda may also be viewed on the District and Southeast Tech's website: [www.sf.k12.sd.us](http://www.sf.k12.sd.us) and [www.southeasttech.edu](http://www.southeasttech.edu)

## **AGENDA**

1. Call to Order
2. Pledge of Allegiance
3. Good News report
4. Approval of Minutes of Meeting Held on February 5, 2025
5. Persons Wishing to Address the School Board on Non-Agenda Items
6. Persons Wishing to Address the School Board on Agenda Items
7. Approval of Agenda
8. Conflicts of Interest
9. Approval of Consent Agenda
  - A. Authorizations and Ratifications
    1. Approval of Contracts
  - B. Approval of Consolidated Report of Trust and Agency Funds
  - C. Approval of Personnel Report
10. Reports of the President
  - A. Academic Program Update – Architectural Engineering Technology, Civil Engineering Technology, Land Surveying Science
  - B. Accessibility Services Update
11. Adjournment

**1. Approval of Contracts**

**Cory Clasemann 367-8355**

Authorizing the President to enter into and execute contracts, for and on behalf of the Southeast Technical College, as follows:

<b>Item No.</b>	<b>Contract Number</b>	<b>Contractor</b>	<b>Project</b>	<b>Cost</b>
a.	25-010, CC	EAB	EAB Navigate Software renewal agreement - 5 year contract	\$529,002

**2. Approval/Ratification of Purchase Orders**

**Cory Clasemann 367-8355**

Authorizing the Business Manager to issue Purchase Order(s) requiring additional approval of the School Board as follows:

<b>Item</b>	<b>PO No.</b>	<b>Vendor</b>	<b>Description</b>	<b>Total Cost</b>
a.	S2504602	Cengage Learning Inc	New Textbooks for Resale	100,000.00

SOUTHEAST TECHNICAL COLLEGE  
 2320 N. Career Ave.  
 Sioux Falls, SD 57107

**CONSOLIDATED REPORT OF TRUST AND AGENCY FUNDS**

	Balance 7/1/2024	Received to date	Disbursed to date	Balance 1/31/2025
STC Bookstore	\$ 34,241.55	\$ 1,020.43	\$ -	\$ 35,261.98
STC EFT	\$ 711,543.15	\$ 10,677,671.47	\$ 5,665,922.00	\$ 5,723,292.62
STC Tuition & Fees	\$ 1,814,579.07	\$ 35,574,923.58	\$ 26,999,373.57	\$ 10,390,129.08
STC T & A	\$ 105,673.19	\$ 36,424.46	\$ 18,403.97	\$ 123,693.68
STC ACH	\$ 4,850.45	\$ 91,294.32	\$ -	\$ 96,144.77
STC Blue Bucks	\$ 23,135.54	\$ 15,650.42	\$ 1,950.27	\$ 36,835.69
<b>TOTALS</b>	<u><u>\$ 2,694,022.95</u></u>	<u><u>\$ 46,396,984.68</u></u>	<u><u>\$ 32,685,649.81</u></u>	<u><u>\$ 16,405,357.82</u></u>

1. **Resignations.** Accepting the resignation of School District Personnel as of the effective date indicated, the personnel having been previously employed by Board Action, as follows:

<u>Name</u>	<u>Location/Position</u>	<u>Effective Date</u>
<b>Student Help, Part-Time</b>		
Retterath, Anna	Horticulture	01-16-25
Rand, Aspen	Scarborough	02-18-25
<b>Instructor, Adjunct, Part-Time</b>		
Blegen, Michael	Nursing & Health	01-28-25
<b>Employment Contract, Full-Time</b>		
Valdez, Benjamin	Academic Affairs	02-13-25
Johnson, Brent	Custodian	02-13-25

2. **Employment Recommendations**

<u>Name</u>	<u>Location/Position</u>	<u>Effective Date</u>	<u>Amount</u>
<b>Student Help, Part-Time, Hourly</b>			
Rask, Kael	IT Technician	01-29-25	\$15.00
Misar, Lorena	Housing	01-27-25	\$15.00
Whitesitt, Lilly	Housing	01-27-25	\$15.00
Williams, Emily	Scarborough	02-10-25	\$15.00
<b>Instructor, Adjunct, Part-Time, Clinical Per Hour</b>			
Bohnenkamp, Hanna	Nursing & Health	02-17-25	\$46.00
<b>Employment Contract, Full-Time, Hourly</b>			
Hamer, Debra	Custodian 12-Month, 1.0 FTE Level 1, Step 1	02-17-25	\$20.27

3. **Instructor, Adjunct, Spring Semester Stipend**

<u>Name</u>	<u>Location/Position</u>	<u>Effective Date</u>	<u>Amount</u>
Adamson, Heather	English	02-28-25	\$2,671.20
Albers, Diana	Nursing & Health	02-28-25	\$3,561.60
Allenstein, Keith	Law Enforcement	02-28-25	\$2,671.20
Atkins, Melissa	Early Childhood	02-28-25	\$2,671.20
Baker, Shelly	Business Administration	02-28-25	\$5,660.40
Barrow, Nathan	English	02-28-25	\$2,671.20
Becker, Luke	Business Administration	02-28-25	\$10,684.80
Blok, Kelly	Computer Applications	02-28-25	\$2,671.20
Borgen, Cory	Sports Turf Management	02-28-25	\$1,643.00
Brandt, Nicole	Nursing & Health	02-28-25	\$4,929.00
Bursheim, Erica	Nursing & Health	02-28-25	\$2,464.50
Byall, Jennifer	Mathematics	02-28-25	\$2,671.20
Carlson, Rebecca	Nursing & Health	02-28-25	\$1,643.00
Castello-Pagan, Jennifer	Spanish	02-28-25	\$2,671.20

**SOUTHEAST TECH PERSONNEL REPORT****Monday, March 10, 2025**

Cavin, Georgina	Business Administration	02-28-25	\$3,561.60
Conrad, Anthony	Media Design	02-28-25	\$821.50
Cox, Bryan	Mechatronics	02-28-25	\$2,176.00
Cruse, Laura	English	02-28-25	\$2,671.20
Davis, Chris	Accounting	02-28-25	\$3,561.60
Ekstrum, Jacqueline	Nursing & Health	02-28-25	\$7,547.20
Ellerbusch, Jenna	Nursing & Health	02-28-25	\$2,464.50
Erdman, Corliss	Nursing & Health	02-28-25	\$4,929.00
Frohwein, Jeffrey	Business Administration	02-28-25	\$8,013.60
Gacke, Bridgett	Nursing & Health	02-28-25	\$890.40
Gertsma, Leann	English	02-28-25	\$5,342.40
Hakeman, Bradley	Mechanical Engineering	02-28-25	\$2,671.20
Halfpop, Emily	Natural Science	02-28-25	\$3,561.60
Hansen, Blair	Nursing & Health	02-28-25	\$12,322.50
Heckenlaible, Justin	Computer Applications	02-28-25	\$2,671.20
Heppler, Jeffrey	Horticulture	02-28-25	\$3,956.80
Hogan, Stephanie	Environmental Science	02-28-25	\$5,342.40
Honey, Andrew	Computer Programming	02-28-25	\$1,780.80
Horan, Steven	Accounting	02-28-25	\$8,904.00
Ivarsen, McCade	Media	02-28-25	\$5,342.40
Jensen, Marcia	Nursing & Health	02-28-25	\$3,286.00
Jones, Suzanne	Early Childhood	02-28-25	\$8,013.60
Judeh, Huda	Computer Information Systems	02-28-25	\$8,013.60
Klinger, Brittany	Nursing & Health	02-28-25	\$2,464.50
Larsen, Kristin	Mathematics	02-28-25	\$2,671.20
Lemke, Sean	General Education	02-28-25	\$7,393.50
Letsche, Paul	Land Survey Science	02-28-25	\$2,464.50
Lindell, Mark	Speech	02-28-25	\$8,013.60
Livermont, Derek	Computer Information Systems	02-28-25	\$3,286.00
Lothrop, LeAnn	General Education	02-28-25	\$5,342.40
McGee, Patricia	Business Administration	02-28-25	\$5,660.40
McManus, Stacy	Business Administration	02-28-25	\$8,013.60
Mehlhaf, Samantha	Veterinary Technician	02-28-25	\$2,830.20
Mekelburg, Erin	Introduction to Computers	02-28-25	\$2,671.20
Melroe, Shelby	Sociology	02-28-25	\$10,684.80
Mills, Ann	Chemistry	02-28-25	\$7,123.20
Morris, Brandon	Computer Information Systems	02-28-25	\$2,671.20
Morris, Roger	Computer Information Systems	02-28-25	\$5,342.40
Nowell, Koree	Nursing & Health	02-28-25	\$6,816.50
Nussbaum, Sarah	Nursing & Health	02-28-25	\$3,561.60
Oelkers, Kayla	Law Enforcement	02-28-25	\$2,176.00
Olson, Margaret	Nursing & Health	02-28-25	\$821.50
Osborn, Michelle	Nursing & Health	02-28-25	\$2,671.20
Otto, Josette	Nursing & Health	02-28-25	\$2,464.50
Penning, Jolene	Nursing & Health	02-28-25	\$4,107.50
Pepper, Merrell	System Network Security	02-28-25	\$3,561.60
Perkins-Hicks, Debra	Natural Science	02-28-25	\$11,320.80
Peters, Dennis	Business Administration	02-28-25	\$2,671.20
Pierce, Steven	Media	02-28-25	\$3,561.60

**SOUTHEAST TECH PERSONNEL REPORT**

**Monday, March 10, 2025**

Price Lee, Julia	Psychology	02-28-25	\$8,490.60
Regan, Kelly	English	02-28-25	\$2,671.20
Reimnitz, Laura	Veterinary Technician	02-28-25	\$4,929.00
Rieck, Matthew	Mathematics	02-28-25	\$10,684.80
Ringling, Benjamin	Horticulture	02-28-25	\$1,780.80
Rose, Jean	Business Administration	02-28-25	\$8,490.60
Saeger, Amanda	Nursing & Health	02-28-25	\$2,830.20
Schnider, Nicole	Nursing & Health	02-28-25	\$5,462.00
Schoenfelder, Nicholas	Agribusiness	02-28-25	\$2,464.50
Schoenfelder, Tonya	Law Enforcement	02-28-25	\$5,440.00
Schwebach, Greg	Architectural Engineering	02-28-25	\$3,286.00
Stacey, Taylor	Mathematics	02-28-25	\$5,342.40
Stoltenburg, Nathan	Construction Management	02-28-25	\$2,464.50
Strouth, Gerard	Information Technology	02-28-25	\$3,561.60
Stueven, Rebecca	Nursing & Health	02-28-25	\$4,107.50
Talcott, Roberta	Marketing	02-28-25	\$2,830.20
Traylor, Michael	Computer Information Systems	02-28-25	\$3,286.00
Tschetter, Lisa	Nursing & Health	02-28-25	\$7,393.50
VanOverbeke, Jeffrey	Speech	02-28-25	\$2,671.20
Vettrus, Jill	Mathematics	02-28-25	\$3,561.60
Vockrodt, Mary	Nursing & Health	02-28-25	\$5,342.40
Wadhwa, Anju	Computer Information Systems	02-28-25	\$8,013.60
Walker, Allison	Nursing & Health	02-28-25	\$821.50
Walton, Evan	English	02-28-25	\$5,342.40
Walton, Tarah	Law Enforcement	02-28-25	\$1,780.80
Weber, Jessica	Accounting	02-28-25	\$3,561.60
Weihe, Kimberly	Marketing	02-28-25	\$2,671.20
Wellnitz, Kristin	Psychology	02-28-25	\$5,342.40
Wendell, John	Collision	02-28-25	\$890.40
Williams, Brian	Marketing	02-28-25	\$5,342.40
Wolff, Dana	Business Administration	02-28-25	\$6,603.80

**4. Instructor Spring Semester Stipends**

<u>Name</u>	<u>Location/Position</u>	<u>Effective Date</u>	<u>Amount</u>
Stelley, Lynard	AWS Certifications	02-28-25	\$1,000.00
Haynes, Matthew	Habitat for Humanity	02-28-25	\$2,000.00
Vettrus, Jill	Mileage Payment	02-28-25	\$500.00

**5. Employee Lump Sum Payment**

<u>Name</u>	<u>Location/Position</u>	<u>Effective Date</u>	<u>Amount</u>
Stephens, Michael	Accounting	01-31-25	\$4,849.09

**Southeast Technical College**  
Engineering Division Report  
**Executive Summary**

**Purpose of Report:** To inform the School Board about three academic programs in the Engineering Technology Division at Southeast Technical College.

---

The Engineering Division consists of Architectural Engineering Technology, Civil Engineering Technology, Land Surveying Technology, Mechanical Engineering Technology and Mechatronics Technology. The academic programs in the Engineering Division focus on the foundational skills required to produce construction documents from sketches and computations, helping to plan and design infrastructure projects or playing a key role in evolving and refining tools and manufacturing processes.

---

**Administrative Recommendation to School Board:** Acknowledge the Engineering Division report.



**SOUTHEAST**  
Technical College

# Engineering Technology Department Overview

Architectural Engineering Technology,  
Civil Engineering Technology, & Land Surveying Technology

A photograph of the Southeast Technical College building. The building is a modern, two-story structure with a prominent blue facade. Large glass windows and doors are visible. The words 'SOUTHEAST TECH' are mounted on the blue facade in white, bold, sans-serif capital letters. In the foreground, there are concrete steps leading up to the building, flanked by tall, dry grasses. The sky is clear and blue.

**SOUTHEAST  
TECH**

# ENGINEERING TECHNOLOGY PROGRAMS

- Architectural Engineering Technology
- Civil Engineering Technology
- Land Surveying Science

\*PRESENTING AT A LATER MEETING

- Mechanical Engineering Technology
- Mechatronics



# ARCHITECTURAL ENGINEERING TECHNOLOGY

# FACULTY

- Greg Schwebach
- Southeast Technical Institute
  - 2016
- Industry Experience
  - 2014-Present



# PROGRAM OVERVIEW

- Graduates will work with architects, engineers, and contractors to develop construction documents for vertical construction projects.

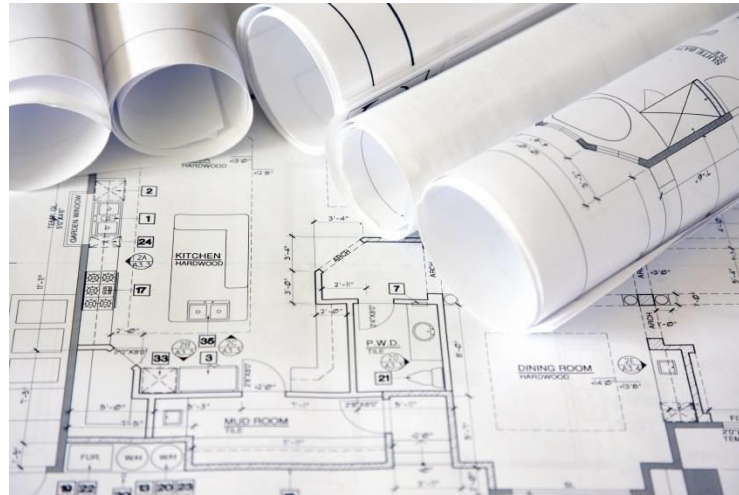
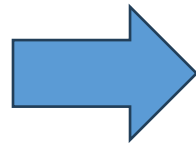
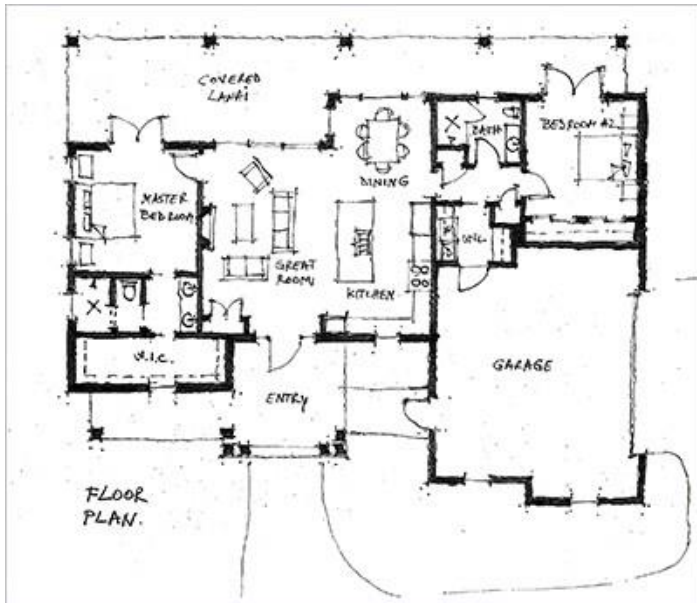

THE SMART WAY TO WHAT'S  
**NEXT**

# PROGRAM LEARNING OUTCOMES

## Technology

- Interpret construction documents.
- Differentiate the materials, construction techniques, and systems used in residential and commercial buildings as well as their cost impact on a project.
- Utilize Computer Assisted Design (CAD) to develop the components of construction plans including plan views, elevations, building sections, site plans and detail drawings.

## Problem Solving

- Recognize relationships between architectural designs, structural elements, mechanical, electrical, and plumbing systems and how various designs affect the building systems comprehensively.
- Analyze, interpret and calculate solutions for industry applied mathematical problems.
- Interpret and apply building code regulations to residential and commercial construction designs.

## Professionalism

- Interact and collaborate with stakeholders in the construction process in a professional manner.

## Communication

- Communicate in a clear and concise manner with stakeholders in the construction process through electronic correspondence, personal interaction, and construction documents.

# PROGRAM CURRICULUM

- 63 credit hours
- 1<sup>st</sup> Year – Residential Focus
  - Single family home design and construction
- 2<sup>nd</sup> Year – Commercial Focus

<b>First Semester</b>		<b>C.H.</b>
CSC 105	Intro to Computers	3
GEN ED MATHEMATICS REQUIREMENT		3
SSS 100	Student Success Seminar	2
ACT 102	Intro to Architectural Engineering	3
CAD 120	Computer Assisted Design I	3
		14
<b>Second Semester</b>		<b>C.H.</b>
GEN ED MATHEMATICS REQUIREMENT		3
GEN ED COMMUNICATIONS REQUIREMENT		3
ACT 120	Materials & Methods of Construction	3
ACT 121	Architectural Drawing I	3
CAD 211	Computer Assisted Design II	4
		16
<b>Third Semester</b>		<b>C.H.</b>
GEN ED SOCIAL SCIENCE REQUIREMENT		3
ACT 210	Commercial Construction Techniques	3
ACT 212	Architectural Drawing II	3
CET 213	Statics	3
CAD 221	Computer Assisted Design III/Arch	4
		16
<b>Fourth Semester</b>		<b>C.H.</b>
GEN ED COMMUNICATIONS REQUIREMENT		3
ACT 211	Mechanical/Electrical Systems	3
ACT 220	Construction Estimating	3
ACT 222	Strength of Materials	3
ACT 260	BIM Capstone	2
CAD 215	Computer Assisted Design Special Topics	3
		17

# PROGRAM DATA

- Anticipating 18 graduates in May 2025

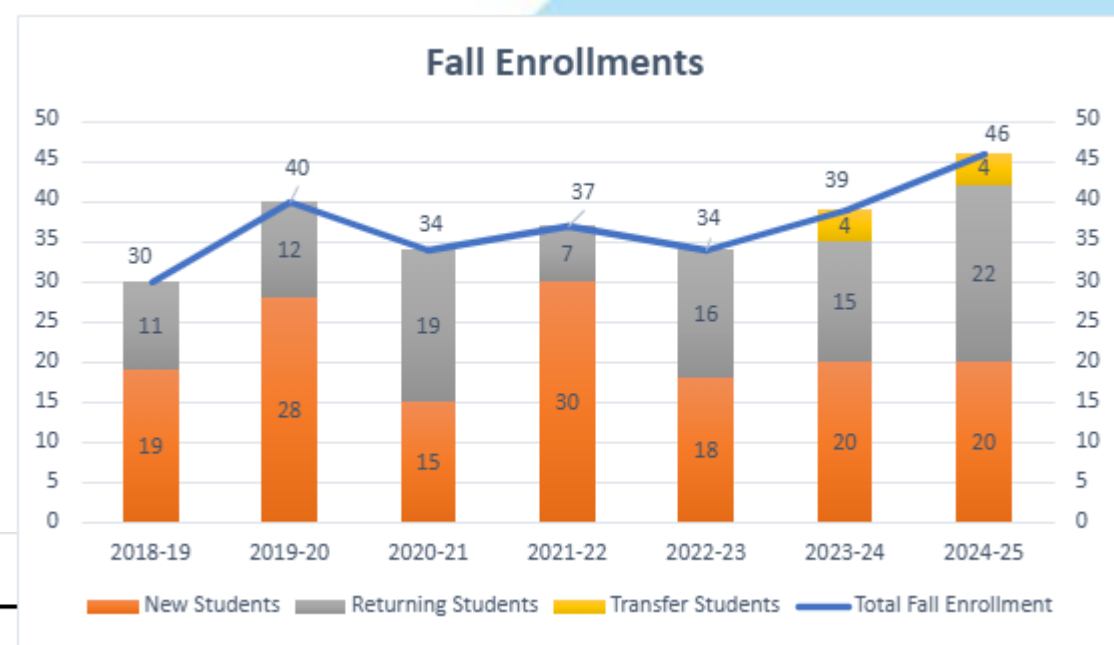

PROGRAM	Architectural Engineering						
Program Capacity for Incoming Cohort	2018-19	2019-20	2020-21	2021-22	2022-23	2023-24	2024-25
<b>Total Fall Enrollment</b>	30	40	34	37	34	39	46
<b>New Students</b>	19	28	15	30	18	20	20
<b>Returning Students</b>	11	12	19	7	16	15	22
<b>Transfer Students</b>						4	4
<b>Program Retention Rate</b>	81%	73%	78%	59%	65%	82%	82%
<i>SDBOTE Fall to Fall = Completion + Returning</i>							
<b># of Graduates</b>	12	13	13	5	13	13	
<i>Fall, Spring, Summer combined</i>							
<b>In-Field Placement Rate</b>	100%	100%	80%	85%	100%		
<i>SDBOTE Prior Academic Year</i>							

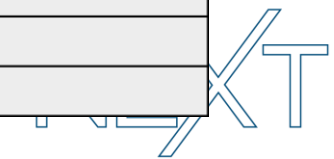

# PROGRAM HIGHLIGHTS

- Highlights and Accomplishments
  - Build Dakota Scholarship eligible
  - Knowledge to pass Revit certification exams
    - Industry standard design software
  - Home Builders Association Student Organization
    - Go to International Builders Show every year

# PARTNERSHIPS

- Advisory Board Member Companies:
  - Architecture Incorporated
  - Associated Consulting Engineering Inc
  - Canfield Business Interiors
  - CO-OP Architecture
  - ISG
  - Journey Group
  - RISE Inc
  - South Dakota State University
  - VanDeWalle Architects



# **CIVIL ENGINEERING TECHNOLOGY & LAND SURVEYING TECHNOLOGY**

# FACULTY



- Elizabeth Kassing, PE
  - BS South Dakota State University
  - MS South Dakota State University
  - Industry Experience



- Paul Letsche, RLS
  - Southeast Technical Institute
  - Industry Experience 2004-present

# PROGRAM OVERVIEW

- Graduates will work with engineers, registered land surveyors, architects and contractors to design and build dams, roads, bridges and key infrastructure in South Dakota and across the nation.

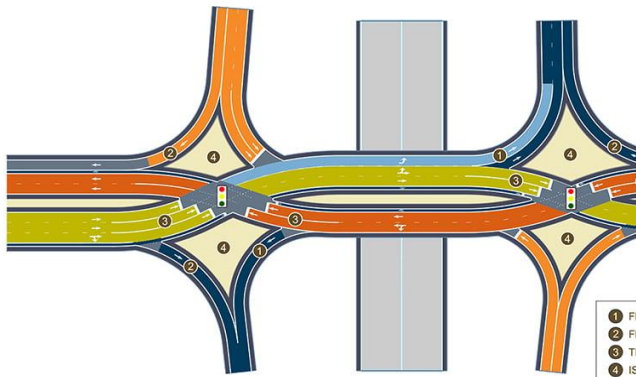

©2018 GAI Consultants

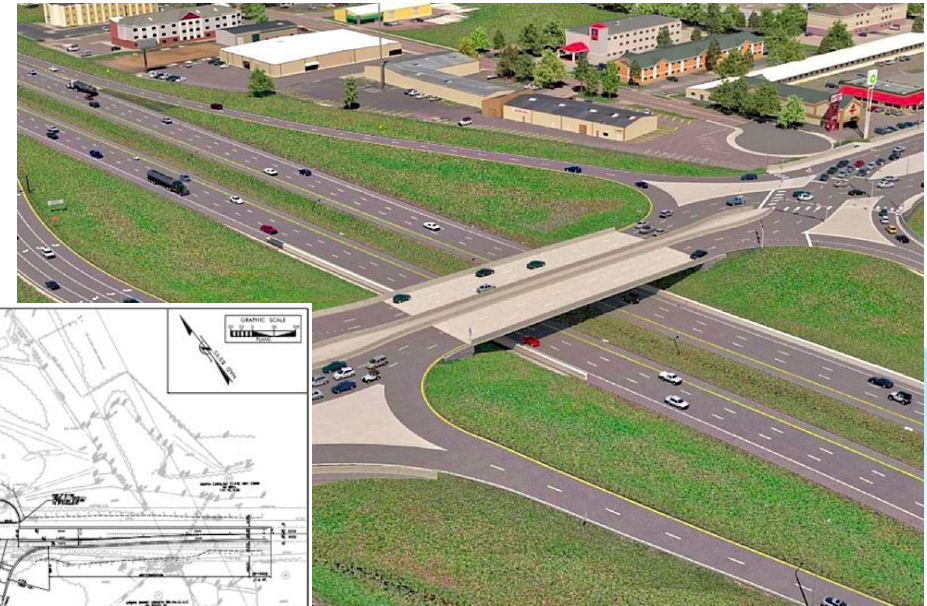
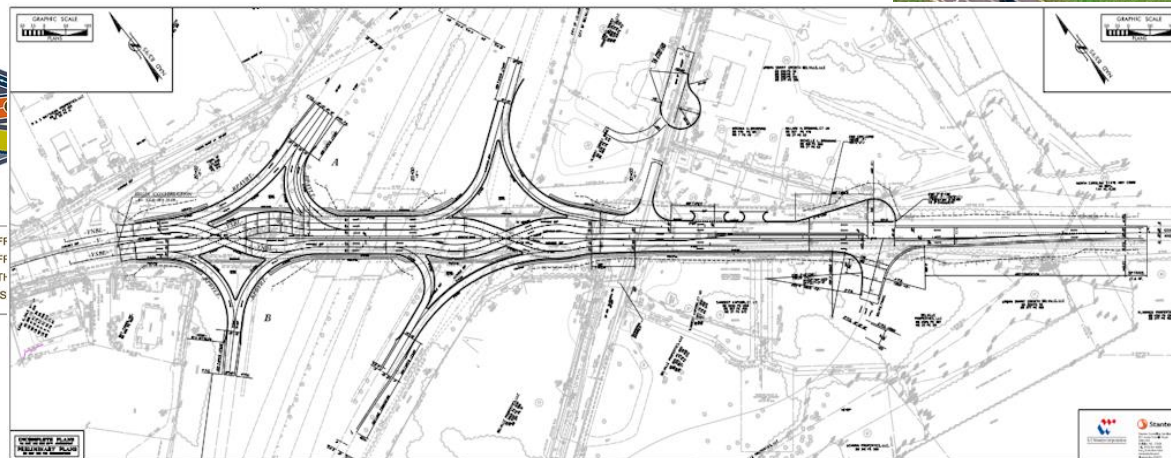

THE SMART WAY TO WHAT'S  
NEXT

# KEY CONCEPTS & TOPICS

## Both Degrees

- 4 Semesters of CAD Software
  - AutoCAD
  - Civil 3D
  - ArcGIS
  - Trimble Access
- 4 Semesters of Surveying
  - Survey I - Fundamentals
  - Survey II - Topo
  - Survey III-Advanced Survey Techniques
  - Survey IV – Route Layout and Design
  - \*Intro to Small Unmanned Aircraft

## Second Year

- Additional Required Course
  - Intro to Civil Engineering & Technical Professions
  - Soils
  - Construction Estimating

# 9 CREDIT DIFFERENCE

Civil

Construction  
Materials Testing

Statics

Water /  
Wastewater

Land Surveying

Intro To Geodetics

Research &  
Platting

Boundary Law

THE SMART WAY TO WHAT'S

NEXT

# PROGRAM CURRICULUM

- 67 credit hours each
- LSS optional 1 credit licensure review
- Common first year

-  Engineering Dept Course
-  Civil and LSS Course

<b>First Semester</b>		<b>C.H.</b>
CSC 105	Intro to Computers	3
GEN ED MATHEMATICS REQUIREMENT		3
SSS 100	Student Success Seminar	2
CAD 120	Computer Assisted Design I	3
CET 102	Intro to Civil Engineering & Technical Profes	2
CET 110	Survey I-Fundamentals	4
		17
<b>Second Semester</b>		<b>C.H.</b>
GEN ED MATHEMATICS REQUIREMENT		3
GEN ED COMMUNICATIONS REQUIREMENT		3
CET 120	Survey II- Topo	4
CET 121	Soils	3
CET 123	CAD II-Civil 3D	3
		16

# PROGRAM CURRICULUM

## Civil Engineering Tech

Third Semester		C.H.
GEN ED COMMUNICATIONS REQUIREMENT		3
CET 211	Construction Materials Testing	3
CET 215	Survey III- Advanced Survey Techniques	3
ACT 220	Construction Estimating	3
CET 226	CAD III-Roadway Corridors	3
LSS 235	Intro to Small Unmanned Aircraft Systems	2
		17
Fourth Semester		C.H.
GEN ED SOCIAL SCIENCE REQUIREMENT		3
CET 213	Statics	3
LSS 210	Intro to Geographical Information Systems	3
CET 224	Water & Waste Water	3
CET 225	Route Layout & Design	4
		16

## Land Survey Science

Third Semester		C.H.
GEN ED COMMUNICATIONS REQUIREMENT		3
LSS 205	Intro to Geodetic Surveying	3
CET 215	Survey III- Advanced Survey Techniques	3
ACT 220	Construction Estimating	3
CET 226	CAD III-Roadway Corridors	3
LSS 235	Intro to Small Unmanned Aircraft Systems	2
		17
Fourth Semester		C.H.
GEN ED SOCIAL SCIENCE REQUIREMENT		3
LSS 210	Intro to Geographical Information Systems	3
LSS 215	Research & Platting	3
LSS 220	Boundary Law	3
CET 225	Route Layout & Design	4
		16

- Engineering Dept Course
- Civil and LSS Course

# CIVIL PROGRAM LEARNING OUTCOMES

## Technology

- Conduct standard field and laboratory tests related to the civil engineering field and to analyze and interpret the results.
- Utilize survey equipment and proper methods appropriate for land measurement and/or construction layout.
- Utilize principles, hardware, and software that are appropriate to produce drawings, reports, quantity estimates, and other documents related to the civil engineering field.

## Problem Solving

- Design solutions for well-defined technical problems and assist with the engineering design of systems, components or processes appropriate to the discipline.
- Perform standard analysis and design within surveying/geomatics technology to the goals of land information systems, engineering project surveying, photogrammetry, mapping and geodesy.
- Analyze data for conformance with precision and accuracy requirements.

## Professionalism

- Function effectively as a member of a technical team.

## Communication

- Apply written, oral, and graphical communication in well-defined technical and non-technical environments; and an ability to identify and use appropriate technical literature.

# LSS PROGRAM LEARNING OUTCOMES

## Technology

- Apply and understand survey processes and methods.
- Employ industry-standard software to solve technical problems.
- Apply technical concepts to the design of measurement systems to meet project requirements.

## Problem Solving

- Design solutions for well-defined technical problems and assist with the engineering design of systems, components, or processes appropriate to the discipline.
- Perform standard analysis and design within surveying/geomatics technology to the goals of boundary, land information systems, engineering project surveying, photogrammetry, mapping and geodesy.
- Analyze data for conformance with precision and accuracy requirements.

## Professionalism

- Function effectively as a member of a technical team.

## Communication

- Apply written, oral, and graphical communication in well-defined technical and non-technical environments; identify and use appropriate technical literature.

# CIVIL PROGRAM DATA

Fall Enrollments

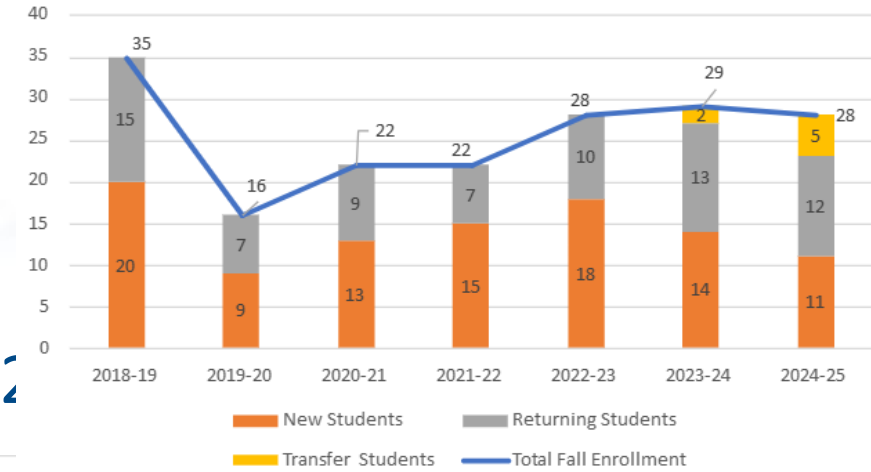

- Anticipating 26 combined graduates in May 2025

PROGRAM	Civil Engineering						
Program Capacity for Incoming Cohort with Land Survey Science							36
	2018-19	2019-20	2020-21	2021-22	2022-23	2023-24	2024-25
<b>Total Fall Enrollment</b>	35	16	22	22	28	29	28
<b>New Students</b>	20	9	13	15	18	14	11
<b>Returning Students</b>	15	7	9	7	10	13	12
<b>Transfer Students</b>						2	5
<b>Program Retention Rate</b>	85%	69%	81%	68%	86%	100%	79%
<i>SDBOTE Fall to Fall = Completion + Returning</i>							
<b># of Civil Engineering Graduates Fall, Spring, Summer combined (duplicated starting 2023-2024)</b>	18	8	8	13	15	19	
<b>In-Field Placement Rate</b>	100%	100%	100%	100%	100%		
<i>SDBOTE Prior Academic Year</i>							

# LSS PROGRAM DATA

- Anticipating 26 combined graduates

Fall Enrollments

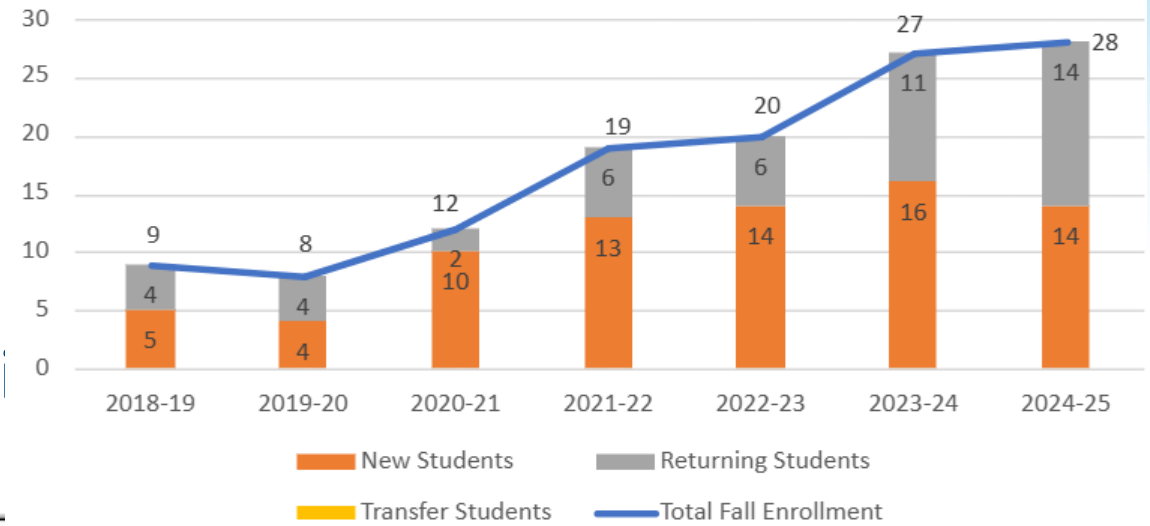

PROGRAM	Land Surveying						
	2018-19	2019-20	2020-21	2021-22	2022-23	2023-24	2024-25
Total Fall Enrollment	9	8	12	19	20	27	28
New Students	5	4	10	13	14	16	14
Returning Students	4	4	2	6	6	11	14
Transfer Students							
Program Retention Rate	92%	89%	100%	83%	68%	80%	89%
SDBOTE Fall to Fall = Completion + Returning							
# of Graduates	19	9	9	13	13	17	
Fall, Spring, Summer combined							
In-Field Placement Rate	100%	100%	100%	100%	100%	100%	
SDBOTE Prior Academic Year							

# COMBINED ENROLLMENT

Fall Enrollments

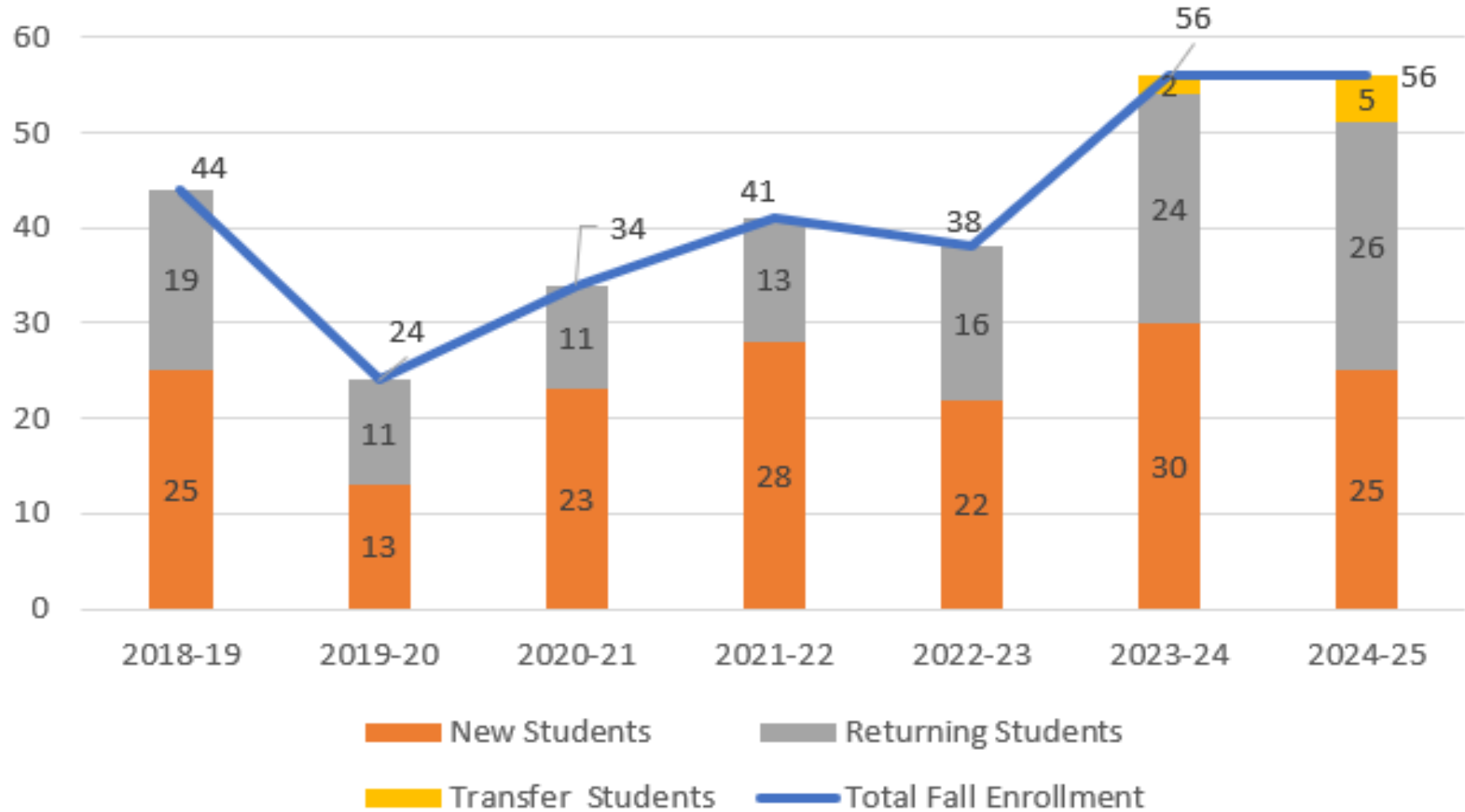

# EMPLOYMENT OPPORTUNITIES

- Materials Technician (testing on the construction site and in a lab)
- Surveyor
- CAD Technician
- Construction Observation
- Contractor
- Continue Education

# KEY EMPLOYERS

- Consulting Firms:

- DGR Engineering
- Stockwell Engineering
- Banner Associates
- GeoTek
- SPN Engineering
- Helmes & Associates
- Midwest Land Surveyors

- Government:

- SD DOT
- City of Sioux Falls Engineering Department
- MN Counties
- IA Counties

- Contractors:

- BX Civil & Construction
- Soukup Construction
- Double H Paving

# PROGRAM HIGHLIGHTS

- Partnerships
  - Civil Engineering articulation with SDSMT
  - Civil Engineering articulation with SDSU Construction Management
  - Land Surveying articulation with St. Cloud
- Highlights and Accomplishments
  - LSS FS Exam pass rate
  - Build Dakota Scholarship eligible

# ENGINEERING TECHNOLOGY PROGRAMS

- Architectural Engineering Technology
- Civil Engineering Technology
- Land Surveying Science
- Mechanical Engineering Technology
- Mechatronics



## ENGINEERING CAMP

**FREE! For students in grades 9-12!**

Learn about careers in Engineering Technology and Mechatronics at our Summer Engineering Camp. Students will have the opportunity to participate in hands-on activities and tour industry facilities. Snacks, lunch and transportation to industry sites are included!

**June 2-5, 2025**  
**9 a.m.-2:30 p.m.**

**REGISTER HERE**



 **SOUTHEAST**  
Technical College

 **NSPE-SD** SOUTH DAKOTA  
ENGINEERING SOCIETY

 **STOCKWELL**

 **ACEC**  
AMERICAN COLLEGE OF ENGINEERING TECHNOLOGISTS

 **DGR**  
ENGINEERING



**SOUTHEAST**  
Technical College

**Southeast Technical College**  
Accessibility Services Update  
**EXECUTIVE SUMMARY**

**Purpose:**

Provide the School Board with an update on Accessibility Services at Southeast Technical College.

---

**Accessibility Services Updates & Future Goals**

- In Fall 2024, the Accessibility Services Office saw an increased number of students when comparing numbers from fall to fall.
  - The Accessibility Services Office provided college-wide training on ADA and Accessibility Services to the new faculty.
  - The Accessibility Services Office provided qualifying individuals equal access to academic and co-curricular activities.
  - The Accessibility Services Office increased community outreach events to educate and encourage students to sign up for, renew, and utilize services.
  - Goals for 2024-2025:
    - Personnel of the Accessibility Services Office established goals to create and foster community partnerships, communicate processes and procedures to students (and their families via FERPA releases), and employees, and to provide holistic coordinated support across campus through a collaborative network, which is all integral components of the Accessibility Services Assessment Plan.
- 

**Administrative Recommendation to School Board:**

To acknowledge the Accessibility Services Update Report.



# Accessibility Services Spring 2025 Update

Elizabeth Harder, Accessibility Services Coordinator and Student Success Advisor



**SOUTHEAST**  
Technical College

# ACCESSIBILITY SERVICES OVERVIEW

- Purpose:
  - To ensure equal access for qualifying students with disabilities to all academic programs and co-curricular activities through the provision of reasonable accommodations.
- Our mission is for students to learn to navigate transitions, understand their disability, and self-advocate to be successful in life.
- Accessibility Services creates accommodation plans through ongoing dialogues with students and faculty, removing barriers for students in alignment with course and program learning objectives.
- Equal participation is ensured to comply with legal standards, promote inclusion, and respect students' dignity.
- An interactive process ensures comprehensive mitigating measures and problem-solving regarding any challenges students may encounter within the learning environment.

# FALL 2023 VS. 2024 STUDENT NUMBERS

Fall 2023	
Students who Renewed Accommodations	78
Students who Did not Renew	26
Students with ESAs in Housing	4
<b>Total Students Supported</b>	<b>108</b>

Fall 2024	
Students who Renewed Accommodations	118
Students who Did Not Renew Accommodations	44
Students with Emotional Support Animals (ESA) in Housing	9
<b>Total Students Supported</b>	<b>127</b>

18% increase in student registration from FA23 to FA24.

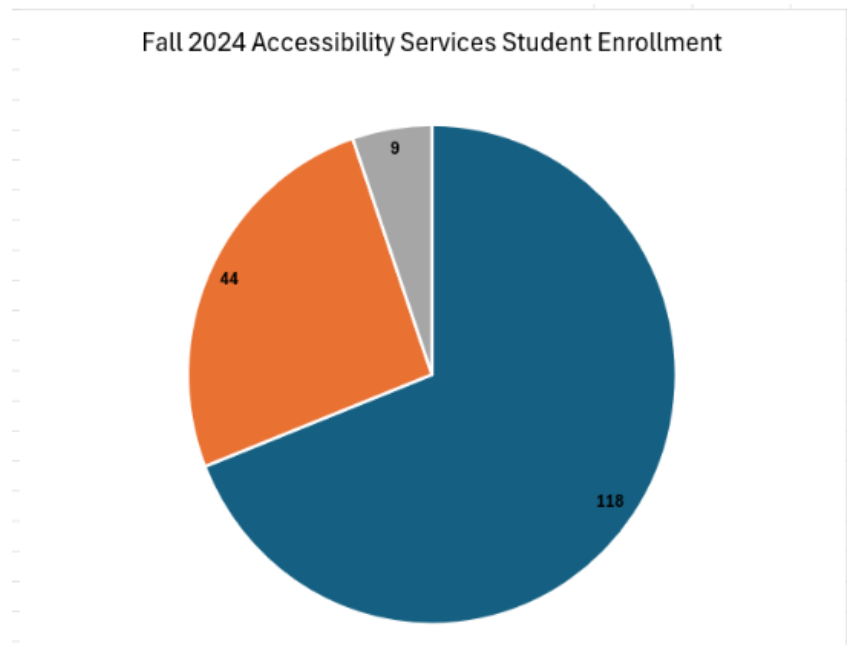
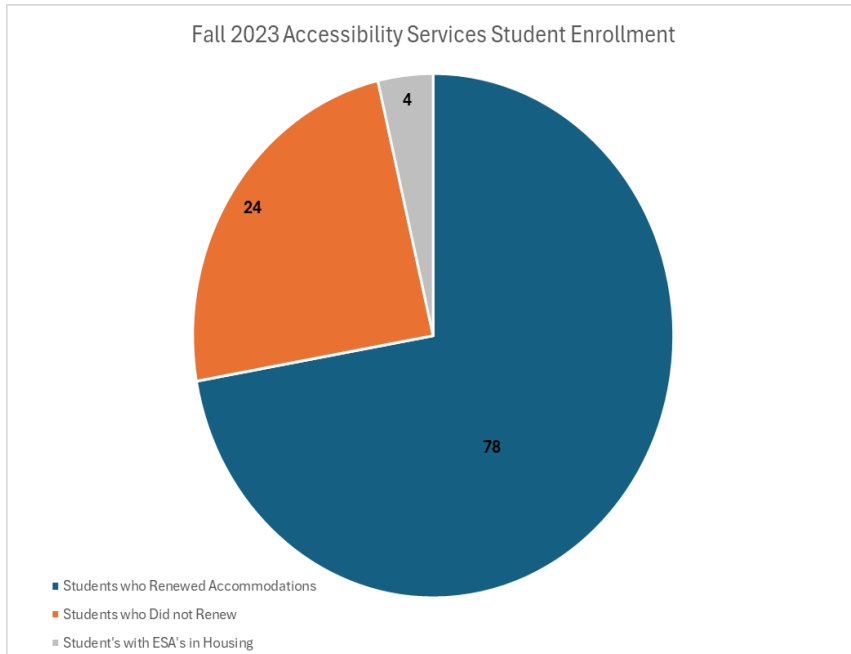

# TRENDING GROWTH

- Increase of students seeking post-secondary education from outreach partnerships
- Increase of Emotional Support Animals to assist with depression and anxiety
- New programs launched such as Behavioral and Mental Health Technician
- Increase of technology available to students through:
  - Vocational Rehabilitation
  - Dakota Link
- New AI Technology
- Opening of the SIM Center

# 2022-2025 CARE UNIT OUTCOMES

## OUTCOME 1: GROW PARTNERSHIPS

- Boys and Girls Scouts of America – Presented breakout sessions to educate Scouts on the accommodations process in college
- Boys and Girls Club (Teen Center) Brookings
  - Students who are on IEPS who may think post-secondary education is beyond their scope of ability
  - Educating parents with students who may be first generation or not fully understanding the options for their children
- Bobcats Plains Academy (BPA), Brookings
- Continue to work with STRIVE/TEACHWELL transitions from High School to College program
- Dakota Link and Technology in the college setting
- Continue to be part of *Catch The College Wave Conference* to target potential high school students with disabilities.

# 2022-2025 CARE UNIT OUTCOMES

## **OUTCOMES 2: PARTNERSHIPS WITHIN SOUTHEAST TECH**

- Academic Resource Center (ARC) – Collaboration with professional tutors who work effectively with students who qualify for accommodations
- Surgical Technology – Collaboration to determine student accommodations in the clinical and/or lab setting
- LPN Program – ATI Proctoring Certification to support LPN students with accommodations
- EMT working through national certification process
- Present to new faculty each semester about Accessibility Services
- Last year updated Emotional Support Animal Process



**SOUTHEAST**  
Technical College