

AGENDA

**SCHOOL DISTRICT OF NEW GLARUS
REGULAR SCHOOL BOARD MEETING**

MONDAY, FEBRUARY 23, 2026

**HIGH SCHOOL LIBRARY/MEDIA CENTER, ROOM 183 JOIN ZOOM MEETING USING
LINK**

**HTTPS://US02WEB.ZOOM.US/J/88234599238?PWD=OU7PAMSBH7KM4U6EOO
WGV6M2DEZHVH.1 BY PHONE USING 1-646-568-7788 MEETING ID 882 3459**

9238 & PASSWORD 714278

1701 2ND STREET

NEW GLARUS, WISCONSIN 53574

7:15 PM

I. CALL TO ORDER

- A. Agenda Published
- B. Roll Call
- C. Approval of Agenda and Revisions

II. INTRODUCTIONS-PRESENTATIONS

- A. Long Range Facility Concept Plan - Andrew Kerr, Jeff Tredo, and Kraemer Brothers 2



SITE PLAN

FEB. 23, 2025 SCHOOL BOARD INITIAL PRESENTATION
 NEW GLARUS MIDDLE & HIGH SCHOOL CAMPUS EXPANSION PLAN

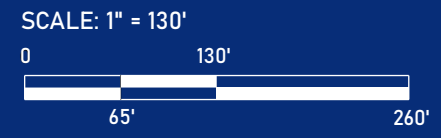

A1.0



BUILDING ZONES KEY

- REMODEL
- EXPANDED CIRCULATION
- NEW CIRCULATION
- ATHLETICS
- ACADEMICS
- PERFORMING ARTS
- NATATORIUM

AREA KEY



OVERALL FLOOR PLAN
FEB. 23, 2025 SCHOOL BOARD INITIAL PRESENTATION
 NEW GLARUS MIDDLE & HIGH SCHOOL CAMPUS EXPANSION PLAN

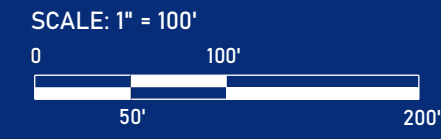

A2.0



BUILDING ZONES KEY

- REMODEL
- EXPANDED CIRCULATION
- NEW CIRCULATION
- ATHLETICS
- ACADEMICS
- PERFORMING ARTS
- NATATORIUM



ENLARGED FLOOR PLAN - AREA A
FEB. 23, 2025 SCHOOL BOARD INITIAL PRESENTATION
 NEW GLARUS MIDDLE & HIGH SCHOOL CAMPUS EXPANSION PLAN

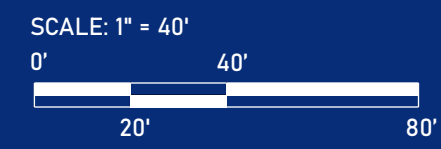

A2.1



BUILDING ZONES KEY

- REMODEL
- EXPANDED CIRCULATION
- NEW CIRCULATION
- ATHLETICS
- ACADEMICS
- PERFORMING ARTS
- NATATORIUM

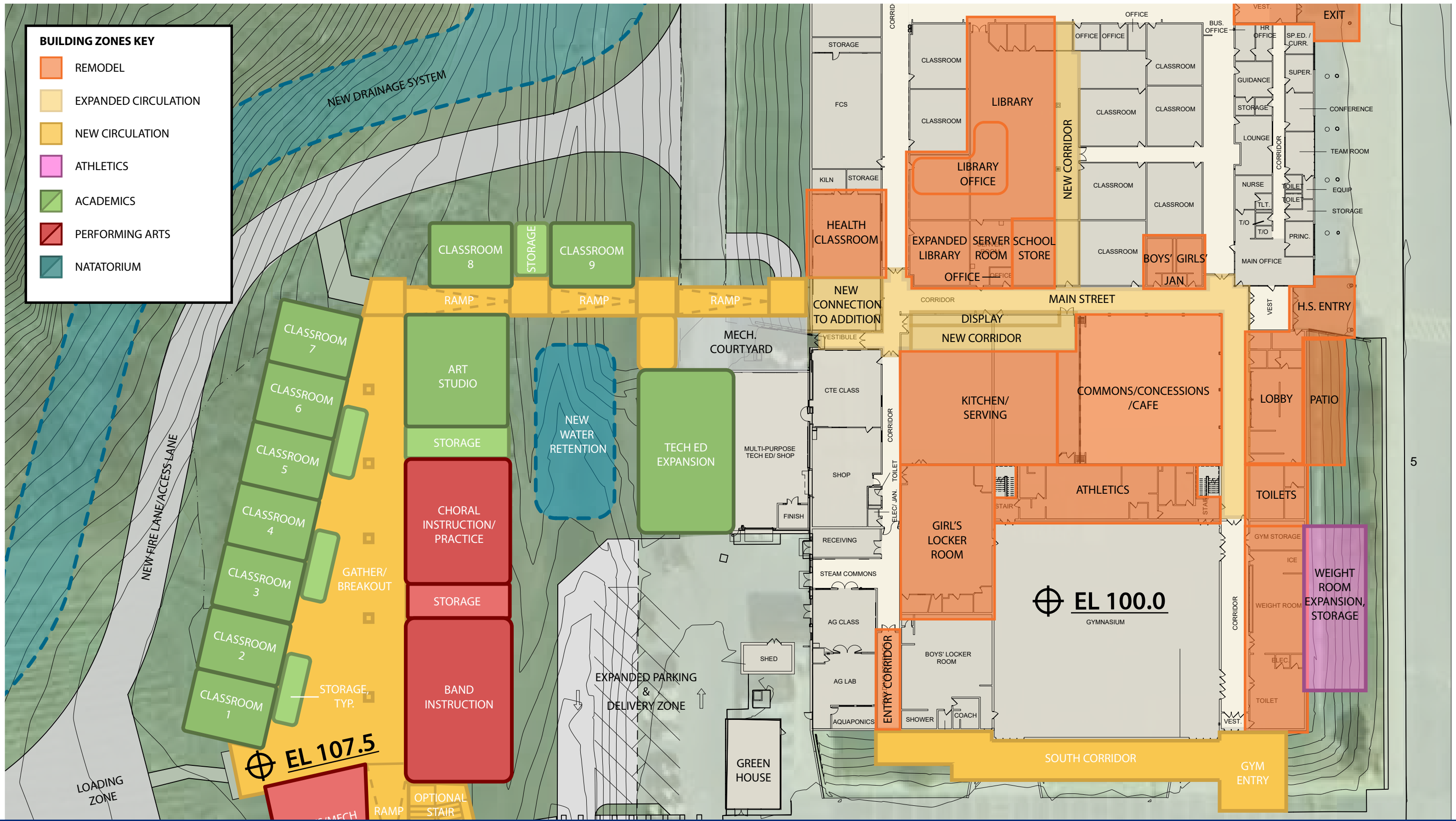

ENLARGED FLOOR PLAN - AREA B
FEB. 23, 2025 SCHOOL BOARD INITIAL PRESENTATION
 NEW GLARUS MIDDLE & HIGH SCHOOL CAMPUS EXPANSION PLAN

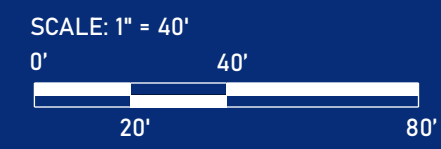

ANDREW KERR

A2.2

tredogroup

Copyright © 2026, Tredo Group LLC. All rights reserved. Project Number 25012

BUILDING ZONES KEY

- REMODEL
- EXPANDED CIRCULATION
- NEW CIRCULATION
- ATHLETICS
- ACADEMICS
- PERFORMING ARTS
- NATATORIUM

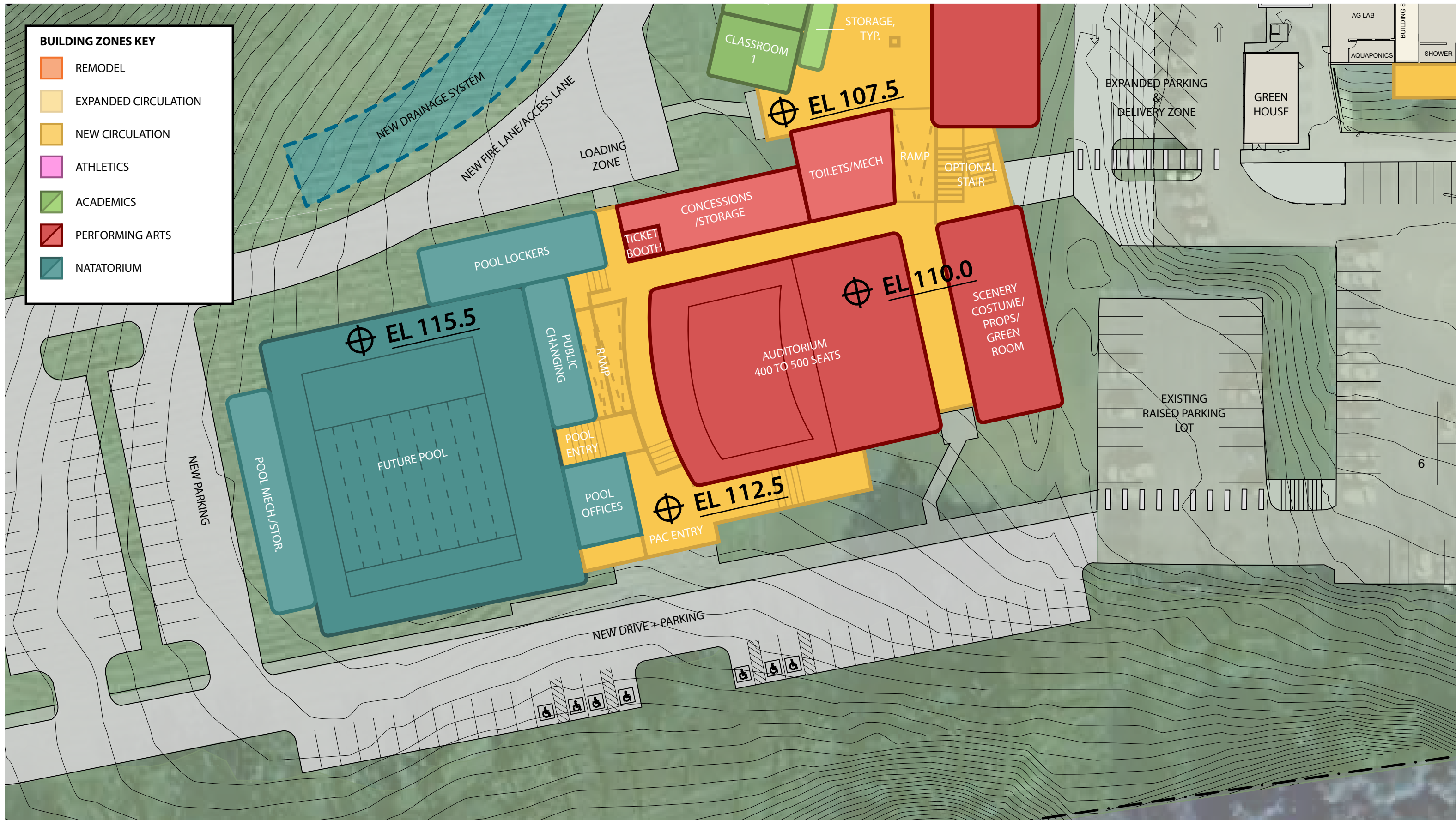

ENLARGED FLOOR PLAN - AREA C
FEB. 23, 2025 SCHOOL BOARD INITIAL PRESENTATION
NEW GLARUS MIDDLE & HIGH SCHOOL CAMPUS EXPANSION PLAN

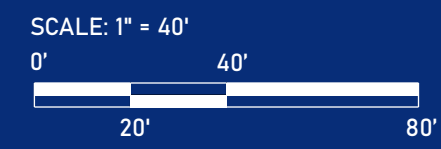

A2.3



Copyright © 2026, Tredo Group LLC. All rights reserved. Project Number 25012

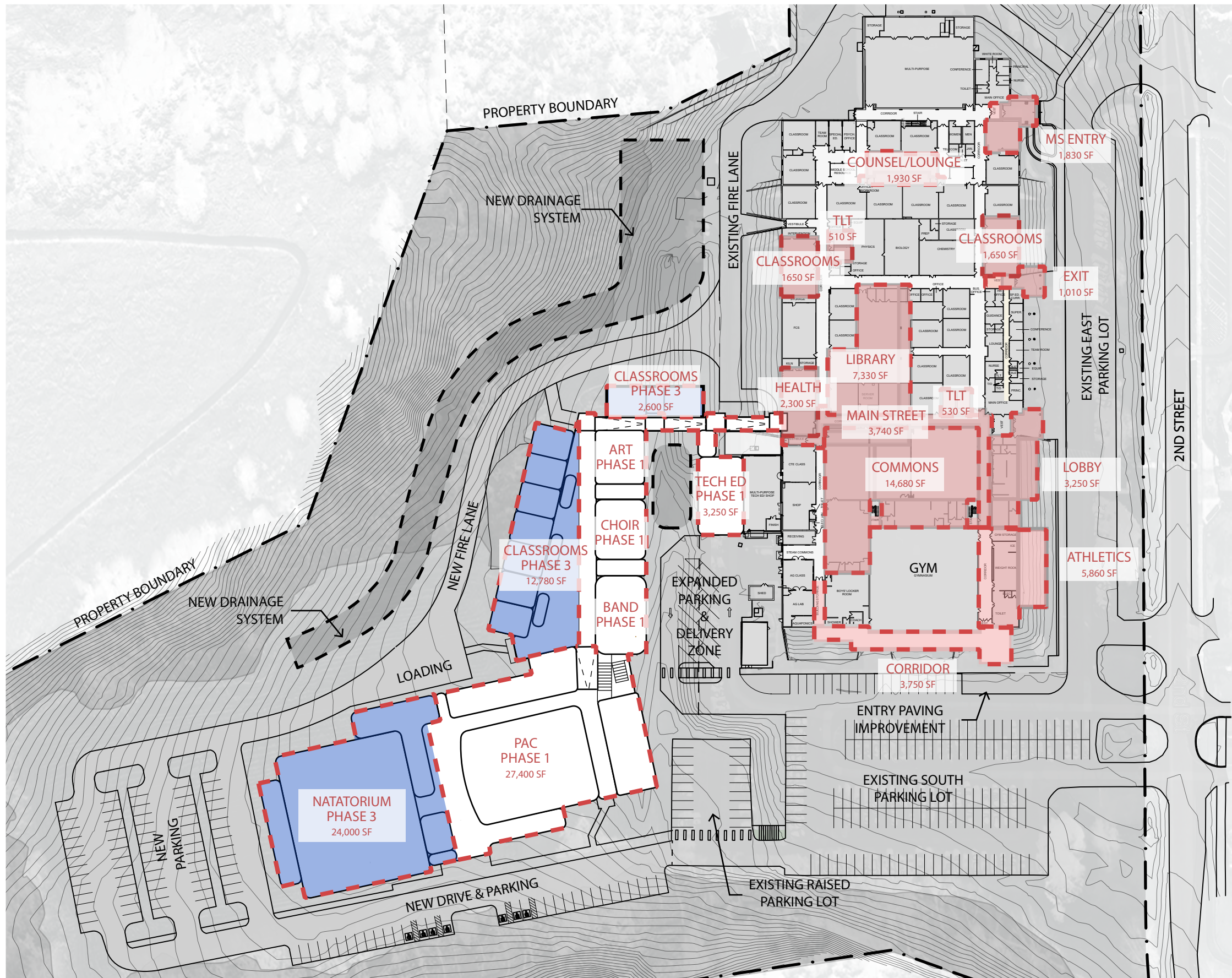

PHASE AREA TOTALS		
PHASE 1	TECH ED	3,250 SF
	PAC	27,400 SF
	ART, CHOIR, BAND	15,000 SF
	TOTAL PHASE 1	45,650 SF
PHASE 2	REMODELING	42,130 SF
	ATHLETICS	5,860 SF
	GYM ENTRY/CORR.	3,300 SF
	TOTAL PHASE 2	51,300 SF
PHASE 3	CLASSROOMS	15,380 SF
	NATATORIUM	24,000 SF
	TOTAL PHASE 3	39,380 SF
TOTAL, ALL PHASES		136,320 SF



PRELIMINARY/SUBJECT TO CHANGE PHASING PLAN
FEB. 23, 2025 SCHOOL BOARD INITIAL PRESENTATION
 NEW GLARUS MIDDLE & HIGH SCHOOL CAMPUS EXPANSION PLAN

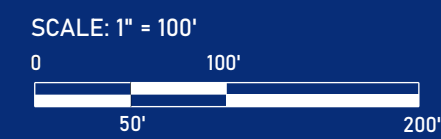

ANDREW KERR

A2.4

tredogroup

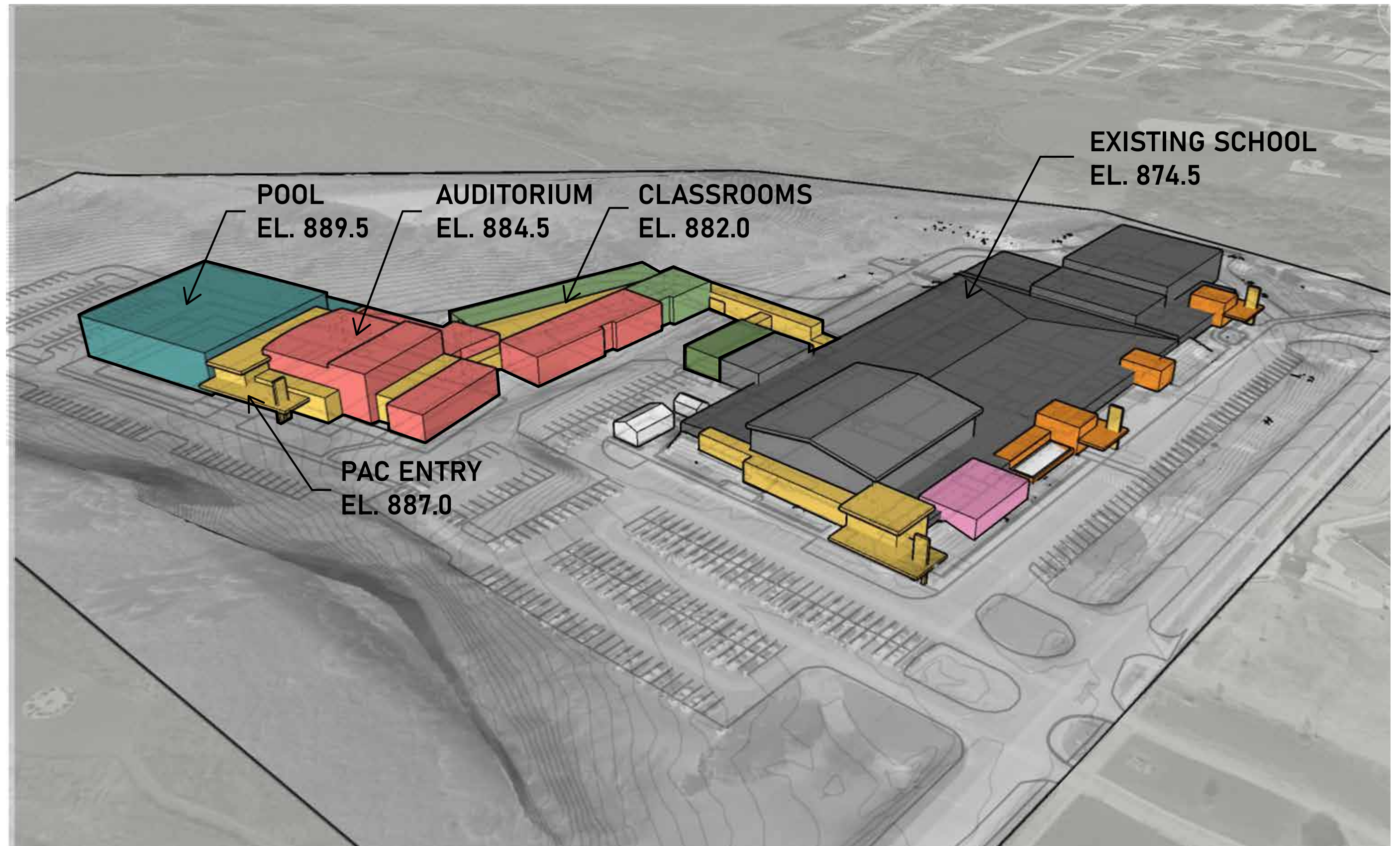

MASSING DIAGRAM

FEB. 23, 2025 SCHOOL BOARD INITIAL PRESENTATION

NEW GLARUS MIDDLE & HIGH SCHOOL CAMPUS EXPANSION PLAN

ANDREW KERR

A3.0



Copyright © 2026, Tredo Group LLC. All rights reserved. Project Number 25012 **tredogroup**

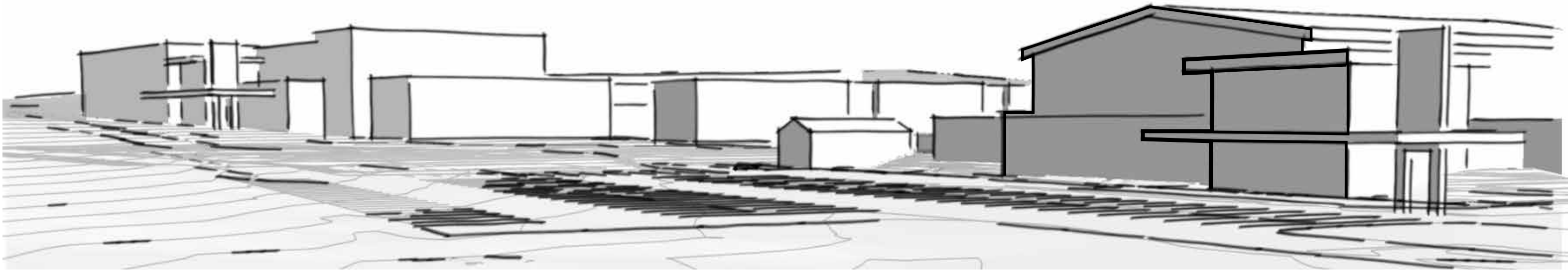

STREET VIEW



AERIAL VIEW FROM NW CORNER OF SITE

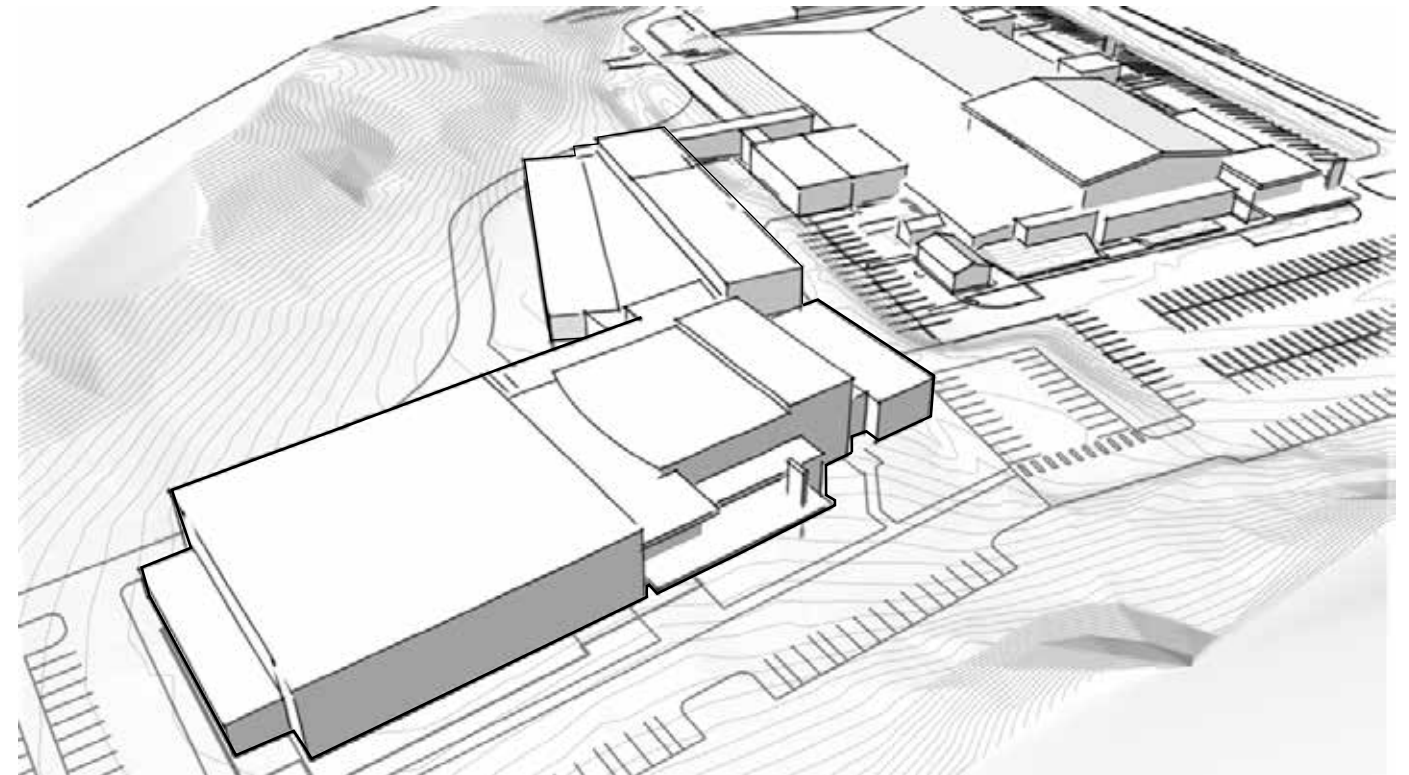

AERIAL VIEW FROM SW CORNER OF SITE



MASSING PERSPECTIVES

FEB. 23, 2025 SCHOOL BOARD INITIAL PRESENTATION

NEW GLARUS MIDDLE & HIGH SCHOOL CAMPUS EXPANSION PLAN

A3.1

ANDREW KERR



III. **PUBLIC COMMENT PERIOD**

IV. **APPROVAL OF CONSENT AGENDA**

A. Item(s) To Be Removed From Consent Agenda

1. Board Minutes

11

SCHOOL DISTRICT OF NEW GLARUS DISCUSSION AND REGULAR SCHOOL BOARD MEETING

Monday, February 9, 2026

CALL TO ORDER

The meeting was called to order at 7:15 p.m. by Board President Bill Oemichen. The agenda was posted at the New Glarus Elementary School, New Glarus Middle School, New Glarus High School, Bank of New Glarus, New Glarus Post Office, Lake Ridge Bank – New Glarus Branch, Woodford State Bank – New Glarus Branch, and the District Website.

ROLL CALL

Present: Bill Oemichen, Ron Roesslein, Travis Zimmerman, Cari Ann Muggenburg, Cassie Ballweg, Casey McCoy, and Heather Thornton

APPROVAL OF AGENDA AND REVISIONS

Motion by Ron Roesslein to approve the agenda as presented. Second by Cassie Ballweg. Motion carried 7-0.

INTRODUCTIONS –PRESENTATION

Peer Tutoring Center

HS Principal, Mr. Worzella, and several high school students shared a presentation about the Peer Tutoring Center.

Facilities Study – Kraemer Brothers

Kyle Kraemer from Kraemer Brothers shared details about the recent Facilities Study of the District buildings. .

PUBLIC COMMENT PERIOD

~None

APPROVAL CONSENT AGENDA

ITEM(S) TO BE REMOVED FROM CONSENT AGENDA

1. BOARD MINUTES & CLOSED SESSION MINUTES
2. APPROVAL OF BILLS
3. TREASURERS REPORT
4. STAFFING REPORT
5. DONATIONS

Motion by Travis Zimmerman to approve the Consent Agenda as presented. Second by Heather Thornton. Motion carried 7-0.

COMMITTEE UPDATES

POLICY, COMMUNICATION & ADVOCACY; Did not meet.

HANDBOOK AND PERSONNEL; Met. The Committee reviewed the proposed Teacher Salary Schedule for 2026-27, Support Staff Salary Schedule for 2026-27, and Exempt Staff Salary Schedule for 2026-27.

BUDGET; Met. The Committee reviewed the Audit Report. and the Summary of Debt Prepayment information.

CURRICULUM, SPORTS & CO-CURRICULAR; Did not meet.

FACILITIES, TRANSPORTATION, AND TECHNOLOGY; Did not meet.

AD HOC STRATEGIC PLANNING COMMITTEE; Did not meet.

DISCUSSION AND POSSIBLE ACTION ITEMS

A. RESIGNATIONS

~None

B. NEW HIRES

The Administration recommended hiring Cooper Dreyfus as Assistant HS Baseball Coach.

Motion by Travis Zimmerman to approve the hiring of Cooper Dreyfus as HS Assistant Baseball Coach as presented. Second by Ron Roesslein. Motion carried 7-0.

The Administration recommended hiring Corinna Anderson as MS Track Coach.

Motion by Travis Zimmerman to approve the hiring of Corinna Anderson as MS Track Coach as presented. Seconded by Casey McCoy. Motion carried 7-0.

DISCUSSION ITEMS

A. 2026-27 BUDGET ASSUMPTIONS

The Board reviewed the 2026-27 Budget Assumptions.

B. FUTURE BUDGET PROJECTIONS

The Board reviewed the future budget projections.

C. BUS SHELTER UPDATE

Dr. Thayer provided the Board with an update on the bus shelter.

ANNOUNCEMENTS

~None

SCHOOL BOARD AND COMMITTEE MEETINGS

- February 23, 2026 – Discussion & Regular Board Meeting – 7:15 p.m.
- March 16, 2026 – Discussion & Regular Board Meeting – 7:15 p.m.

ADJOURN

Motion by Ron Roesslein to adjourn the meeting at 8:06 p.m. Second by Cassie Ballweg. Motion carried 7-0.

Respectfully submitted by Cari Ann Muggenburg, Board Clerk, and Kris Anderson, District Executive Assistant

**SCHOOL DISTRICT OF NEW GLARUS
PURCHASING CARD ACTIVITY
JANUARY 31, 2026**

Vendor	Description	Amount
JOHNSON BLOCK CO INC	final audit biilling	7,950.00
"VSP*ZONAR SYSTEMS, INC"	BUS/VAN GPS SYSTEMS AND TRAINING	7,192.23
"RENNING, LEWIS LACY,"	Nov Serv	6,679.70
BSN SPORTS LLC	CC UNIFORMS	4,249.50
"MFAC, LLC"	TRACK AND FIELD EQUIPMENT	4,113.00
MONROE POWERSPORTS	UTV repairs	3,995.11
"AMZ*VEX ROBOTICS, IN"	HS Robotics materials	3,114.39
BSN SPORTS LLC	bbb team sweatshirts/coaching pullovers	3,069.00
E PRO STL	Nov PT services	3,001.10
DISCOVERY EDUCATION- INC	DREAM BOX	1,680.00
WILS	Books	1,559.09
ALPHAGRAPHICS MIDDLETON	FOLDERS	1,335.81
SAN-A-CARE	custodial supplies	1,136.37
BSN SPORTS LLC	GIRLS BB SUPPLIES	973.96
FINGER PUBLISHING	AGENDA/MINUTES/CC DAYS	916.55
CPP*DORIAN SUMMER MUSIC C	Dorian Festival	908.00
709 AUTO VALUE - NEW G	van/bus repair	857.97
SYMDON CHRYSLER DODGE JEE	Repairs to Van 11	815.45
WM.COM	January Services	747.55
ODP BUS SOL LLC# 106869	Staff Supplies	712.99
WEVIDEO.COM	WeVideo accounts	650.00
IN *NEW GLARUS CHAMBER OF	Visitors Guide	600.00
OVERDRIVE DIST	OverDrive Marketplace	575.75
BADGER POPCORN	Concessions supplies for athletics	562.10
AMAZON MKTPL*QP63X1WP3	Concessions supplies for athletics	536.41
MCGRAW-HILL HIGHER ED	T3 MATERIALS	535.62
PROJECT LEAD THE WAY INC	pltw pbs labs	529.50
AMAZON MKTPL*3V5VE42P3	HS art supplies	514.34
FIND IT PARTS	Filters for buses	504.68
FSP*RBS ACTIVEWEAR	Fall Awards	478.08
AMAZON MKTPL*890DV78R3	1/2 Knight Prizes	477.16
709 AUTO VALUE - NEW G	Batteries	446.97
WARD-BRODT MUSIC CO.	clarinet repair	425.00
WASBO FOUNDATION	Conference Registration	425.00
WISCONSIN SCHOOL SAFETY	School Safety Certification Program	400.00
BLAIN'S FARM & FLEET	Vehicles Consumables	388.54
"NOODLETOOLS, INC."	HS Curriculum application	375.00
WISTCA	Track conference registration fees	373.20
AMAZON MKTPL*9S6SL7XI3	Laser Consumables - Career Fair	365.95
WARD-BRODT MUSIC CO.	Reeds	346.99
JUSTAWARDMEDALS.COM	8th grade completion	336.75
WASBO FOUNDATION	WASBO FACILITIES CONFERENCE	330.00
GRAINGER	plumbing repair parts	329.86

**SCHOOL DISTRICT OF NEW GLARUS
PURCHASING CARD ACTIVITY
JANUARY 31, 2026**

FAIRFIELD INN & SUITES	conference lodging	329.00
PY *WI CESA5	Registration for 2026 CESA 5 SLP Institute	325.00
"IN *CAPITAL LOCK, INC"	REPAIR LOCKS ON MAIN DOOR	325.00
PY *WI CESA5	CE conference- CESA 5 SLP Institute	325.00
PY *WI CESA5	CESA Speech Conference Registration	325.00
AMAZON MKTPL*C401S5OQ3	MS art supplies	317.99
AMAZON.COM*T86384623	ap chem prep books	314.25
MCGRAW-HILL HIGHER ED	RECONCILE TO SPECIAL ED MATERIALS	312.44
AMAZON MKTPL*LL8A92JS3	Staff Supplies	301.36
COSTCO WHSE#1491	Basketball concessions purchase	300.43
"ATTAINMENT COMPANY, INC A"	Math Curriculum	298.25
TST*LUCKYS 1313 BREW PU	Boys Basketball - team dinner	286.86
WASBO FOUNDATION	conference fee	280.00
AMAZON.COM*5L1LS8MF3	Replacement monitor for principal	279.99
WARD-BRODT MUSIC CO.	bari sax repair	274.50
"RENNING, LEWIS LACY,"	DEC SERVICES	264.00
SPECTRUM	January services	258.95
AMAZON MKTPL*O945U7VO3	Calculators for math class	258.73
ASHA 3	ASHA dues to maintain CCC	250.00
J.W. PEPPER	music	243.99
AMAZON MKTPL*L300T4C93	MS art supplies	243.20
AMAZON MKTPL*ZR4TN0FK3	Sawstop Carts	234.26
USPS PO 5659000694	Stamps, Alumni reimbursing	234.00
ODP BUS SOL LLC# 106869	Lamination Film- Supplies	232.44
AMAZON MKTPL*1J6LC6DK3	Casters for Rotating Stage	229.29
BYU CONTINUING ED2	BYU class	215.00
BYU CONTINUING ED2	BYU class	215.00
BYU CONTINUING ED2	BYU class	215.00
BYU CONTINUING ED2	BYU class	215.00
SQ *SINGIN DOG/CLIP AND P	Bassoon Reeds	204.00
RHYME	toner	201.88
MUSICPLAYONLINE.COM	Musicplay curriculum online	200.00
NORTHERN TOOL	shelving unit HS art room	199.99
RBS ACTIVE* NEW GLARUS	Musical Staff Shirts	188.78
AMAZON MKTPL*PZ3OX20E3	office supplies	187.61
SP STUTTERINGTHERAPY	Stuttering assessment manual and protocols	186.22
AMAZON MKTPL*N72U16QR3	Cups for CTE Fair	183.80
J.W. PEPPER	choir music	181.77
J.W. PEPPER	Music	180.25
J.W. PEPPER	Music Purchase for High School Choir	171.60
WISCONSIN SCHOOL SAFETY	WSSCA Safety Conference Registration	170.00
AMAZON MKTPL*4A5S70O53	HS Robotics materials	162.39
USPS PO 5659000694	postage	156.00
WALMART.COM 8009256278	HS Food Lab Supplies	155.99
AMAZON MKTPL*AS5R14363	books	153.62

SCHOOL DISTRICT OF NEW GLARUS

PURCHASING CARD ACTIVITY

JANUARY 31, 2026

QUALITY INN & SUITES	HS Choir- Dorian Music Festival Hotel Room	150.20
QUALITY INN & SUITES	HS Choir- Dorian Music Festival Hotel Room	150.20
QUALITY INN & SUITES	HS Choir- Dorian Music Festival Hotel Room	150.20
QUALITY INN & SUITES	HS Choir- Dorian Music Festival Hotel Room	150.20
AMAZON MKTPL*G72RQ1TC3	PBIS Store Supplies	145.24
CUMMINS INC	Filters for Buses	143.97
AMAZON.COM*SS7WF2343	Ag Power Supplies	139.96
KALAHARI RESORT - WI	hotel conf lodging	139.00
WWW COSTCO COM	Staff Snacks Restock	138.67
AMAZON MKTPL*K54UM16V3	Pandiero for High School Band	135.57
LOCAL GOVERNMENT EDUCATIO	Continuing Ed Class - registration	135.00
MACGILL SCHOOL NURSE SUP	gloves	134.99
FA BCK	background checks	134.34
DISCOVERY EDUCATION	Classroom seats for physics softwar	122.00
WALMART.COM 8009256278	HS Food Lab Supplies	120.15
SPECTRUM	JANUARY SERVICES	120.00
AMAZON MKTPL*KT57S9193	Glue and Dado	115.28
CBI*COREL	License for CNC Class	115.00
HI STEVENS POINT CONVEN	Halftime Conference	111.23
HI STEVENS POINT CONVEN	Halftime Conference	111.23
HI STEVENS POINT CONVEN	Halftime Conference	111.23
AMAZON MKTPL*VK2QD7DI3	CTE Cups and Grease	110.84
AMAZON MKTPL*6W7JU60V3	EIE Grant Materials	110.54
AMAZON MKTPL*1M6G12163	Hockey Pucks and Kickballs	107.11
JL SMITH AND CO	Corks for instrument pad replacement	105.75
NEW GLARUS HARDWARE	Finishing Materials	105.45
IN *NEW GLARUS CHAMBER OF	Chamber Bucks for staff appreciation	100.00
SMORE.COM - EDUCATOR	Smore Renewal	99.00
NEW GLARUS HOMETOWN PH	office supplies	98.12
NEW GLARUS HARDWARE	Musical	95.13
AMAZON MKTPL*SU15H9QF3	stand up desk	94.99
AMAZON MKTPL*C04H851A3	Day 100 & Valentine supplies, mini iPad cover	94.58
AMAZON MKTPL*9C6VM1H83	Musical	94.21
AMAZON.COM*HV6691Y83	Replacment headphones	93.24
AMAZON MKTPL*U237C38I3	Vacuum purchase for classroom	89.98
DECKER EQUIP SCHOOL FIX	exit lite guard MPR	86.80
WWW COSTCO COM	Office supplies	86.05
AMAZON MKTPL*K86D75833	Classroom Lab supplies	85.92
WARD-BRODT MUSIC CO.	Horn Repairn	85.00
AMAZON MKTPL*OD8A686F3	Guitar Kit	84.99
AMAZON MKTPL*H32FE0D43	Bulk Gap Filler	81.99
AMAZON.COM*545VN4TD3	Staff Supplies Restock	81.98
USPS PO 5659000694	SPED mailings/stamps for office	80.17
AMAZON MKTPL*GH4ZG45M3	SEL supplies January-calming corners	79.98
AMAZON MKTPL*907WO1WD3	SD memory cards and reader	76.96

**SCHOOL DISTRICT OF NEW GLARUS
PURCHASING CARD ACTIVITY
JANUARY 31, 2026**

AMAZON MKTPL*YP68M3AW3	Woods Pool Table Acces	74.99
AMAZON MKTPL*AG02W78G3	Nightstand Hardware	73.90
AMAZON MKTPL*5E85D3D93	Play-Doh for Human Body Project	73.24
TEACH STARTER	Teach Starter Subscription - Standard-based activities	73.00
AMAZON MKTPL*7J40V36D3	Office supplies	71.42
AMAZON MKTPL*N592N0V13	Nails Cons	71.07
NEW GLARUS HARDWARE	Stage Project Hardware	69.61
AMAZON MKTPL*8G5C80VG3	Hanging Wall Files and Page Protectors	68.96
AMAZON.COM*QP1ZN4UC3	Paint & Tape	68.87
AMAZON MKTPL*VG1GV4BV3	3.5" to usb adapters for ES devices	68.70
TEACHERSPAYTEACHERS.COM	TPT--College Board AP Resources	68.49
ODP BUS SOL LLC# 106869	Staff Supplies Restock	67.96
AMAZON MKTPL*DN1R63XF3	MS art supplies	66.55
AMAZON.COM*UT78T1303	Staff Supplies Restock	66.08
AMAZON MKTPL*452VH4KU3	FOOD BOXES	65.96
GRAINGER	plumbing repair parts stock	65.79
WSTMA	organizatio dues	65.00
NEW GLARUS HARDWARE	hardware and softener salt	64.43
AMAZON MKTPL*IV6HX1FO3	HS Robotics materials	63.89
AMAZON RETA* I33HE1QA3	Student engagement incentive	61.90
GEMPELER'S SUPERMAR	HS Food Lab Supplies	61.07
AMAZON MKTPL*0M00598F3	Staff Supplies Restock	60.96
J.W. PEPPER	S&E Music	60.00
AMAZON MKTPL*DN0SZ7E43	EIE Grant	59.99
AMAZON MKTPL*JP94J9M23	Batteries for clocks	59.99
AMAZON MKTPL*3V7ME81C3	Phone component- PoE unit	59.00
AMAZON.COM*DR1EY0YN3	Vet Tech Supplies	58.55
AMAZON MKTPL*W80F29NP3	Classroom Supplies	58.33
BROKEN ARR* (1 OF 1 PA	GBB BANNER	58.00
AMAZON.COM*5O7KF8I33	Supplies	57.21
AMAZON MKTPL*M30YD00M3	Light Covers	56.97
AMAZON MKTPL*E65RT2M13	Concessions supplies for athletics	55.98
AMAZON RETA* IC2IR3XE3	Cymbal Setters for Percussion	55.98
AMAZON MKTPL*GT7865XZ3	book	54.99
AMAZON RETA* AD4YF83H3	books and board game	54.87
SOCIAL THINKING	We Thinkers Workshop	54.00
SOCIAL THINKING	Social Thinking Training-PBIS	54.00
SWEETWATER SOUND	Trumpet Mutes for HS Jazz Band	53.98
J.W. PEPPER	Music Purchase for HS	53.75
J.W. PEPPER	Music Purchase for HS	53.23
SP CESA 6	CESA 6 Visual Supprots course.pdf	52.75
AMAZON MKTPL*DT9794RZ3	Musical	52.70
SP MHS MULTI HEALTH	Assessment Score Reports	52.50
ODP BUS SOL LLC# 106869	Premium copy paper for welcome packets and flyers.	52.17
ODP BUS SOL LLC# 106869	Copy paper for welcome packets	52.17

SCHOOL DISTRICT OF NEW GLARUS

PURCHASING CARD ACTIVITY

JANUARY 31, 2026

AMAZON.COM*0K1VD5GB3	office supplies	51.30
AMAZON MKTPL*3Q5KE0AU3	Classroom supplies	50.80
CASEYS #3572	dinner between musical practice and pep band for stud	50.62
ODP BUS SOL LLC# 106869	Address stampers	50.36
AMAZON.COM*OO1CP4SC3	SNOWPANTS	50.00
AMAZON MKTPL*MB6VP7FN3	Classroom materials	49.99
AMAZON MKTPL*Q10QP47E3	Monitor	49.99
AMAZON MKTPL*VE2DO6HU3	folder cart	49.99
AMAZON.COM*JB2OA3VY3	Life Skills Phone	49.99
J.W. PEPPER	Music	49.99
AMAZON RETA* BH9J926I3	Music Purchase for High School Choir	49.89
AMAZON MKTPL*M689G4NH3	EIE Grant Materials	49.36
J.W. PEPPER	Music	48.70
J.W. PEPPER	Music	47.49
AMAZON MKTPL*NE7CJ5B23	Classroom Supplies	47.28
CREATIVEFABRICA.COM	stickers for promoting NGSD/NG Athletics	47.00
FTP*FINANCIAL TIMES	news	45.00
AMAZON MKTPL*LY17632K3	Classroom interest toy and laminating pouches	44.70
TARGET 00021063	Mock trial student organization snacks	44.56
SP AMERICAN CARNIVAL M	Oversized Frisbees	43.95
WAL-MART #0847	iReady Snacks	43.00
AMAZON MKTPL*M33OP7L53	Brad Nails	42.56
MCGRAW-HILL HIGHER ED	T3 CORRECTIVE READING	41.96
AMAZON MKTPL*UE2IX0J13	Ag Power Supplies	41.77
MAILCHIMP	Newsletter site; general athletics	41.67
TST* MO'S IRISH PUB - MIL	Dinner at WASB	41.10
BACKBLAZE INC	Monthly charge for cloud backup	41.09
AMAZON RETA* LX56E3XL3	Foam Roller Replacement	40.61
AMAZON MKTPL*9D5LI70M3	books	39.99
AMAZON MKTPL*U84PF55U3	Summer School Supplies	39.99
AMAZON MKTPL*WK2AG9WV3	Lamination Sheets	39.99
MONROE ENGRAVING	Spelling bee trophies	39.34
AMAZON.COM*O32FW85O3	ID badge holders/Expo Markers	38.91
"SQ *ACOUSTIMAC,LLC"	sound board mounting brackets for HS Band	38.64
AMAZON MKTPL*4Y77M6YX3	Drinking cups	38.64
ROYS MARKET	Jan meeting snacks	38.62
ODP BUS SOL LLC# 106869	Supplies	38.59
AMAZON MKTPL*CT0EL27X3	books	38.52
AMAZON RETA* 0L4MP7TH3	books	38.16
AMAZON MKTPL*G895D2BB3	office supplies	38.07
AMAZON MKTPL*A12TJ58N3	Purchase for Choir organization	37.99
AMAZON RETA* 0L6NA4B13	books	37.44
AMAZON MKTPL*FR9QM6O83	Concessions supplies for athletics	36.87
WARD-BRODT MUSIC CO.	Reeds	35.99
AMAZON RETA* 9O85E42G3	Thank you notes and Candy for Staff Lounge	35.93

**SCHOOL DISTRICT OF NEW GLARUS
PURCHASING CARD ACTIVITY
JANUARY 31, 2026**

CASEYS #3572	Lunch for state officer visit	35.86
AMAZON MKTPL*2O0MP2AJ3	magnetic blocks	35.82
AMAZON MKTPL*W68AC24D3	Calculator holder for math class	34.98
AMAZON MKTPL*814TP5P13	HS art supplies	34.65
GEMPELER'S SUPERMAR	HS Food Lab Supplies	34.42
AMAZON MKTPL*279W95EE3	Humpty Dumpty	34.00
AMAZON MKTPL*H61Y93OP3	Fuse Bead Kit- Makers Space	33.36
AMAZON MKTPL*QR14G5PS3	WINTER CLOTHES	33.22
"TABWRITE, LLC"	RevisionHistory Subscription	32.00
AMAZON MKTPL*Y13AP2LZ3	Sand Bags for Music Dept	31.98
TARGET 00021063	Check in check out prizes	31.61
J.W. PEPPER	music purchase for solo and ensemble	31.60
AMAZON RETA* 3D8HL1GC3	books	31.02
WSPRA	AI Communications Webinar	30.00
NEW GLARUS HARDWARE	Transportation: Fuel Additive	29.98
J.W. PEPPER	Baritone Solo for S and E	29.97
AMAZON MKTPL*KM1IJ7KX3	Sand Bags for Music Dept.	29.81
AMAZON MKTPL*BQ8IK1F01	Shelf for paper HS	29.61
J.W. PEPPER	Music Purchase for High School Choir	29.50
CULVERS OF NEW GLARUS	TAG	28.97
J.W. PEPPER	S&E Music	28.50
AMAZON MKTPL*ZD6FX7LQ3	labels	26.97
J.W. PEPPER	Music	26.50
AMAZON MKTPL*2481T49Y3	Disposable Cups and Plates	25.99
AMAZON MKTPL*7B2QD9EH3	ap chem lab demo supplies	25.39
AMAZON RETA* RV8ZQ42U3	book	24.95
AMAZON MKTPL*P899Z2OB3	Poster Board	24.91
AMERICAN HEART SHOPCPR	CPR Course for First Responders (RV)	24.27
GOOGLE YOUTUBEPREMIUM	Youtube Premium Jan 26	24.25
NYTIMES*	news	24.14
"ETSY, INC."	Guitar CNC File.pdf	23.27
AMAZON RETA* 0V53O0X63	Organizing materials for High School Music	22.90
AMAZON RETA* DG70M2513	books	22.62
AMAZON RETA* ZS2UN3S63	Containers for storing supplies	22.57
CENEX-BLANCHARDVILLE COO	birthday snacks	22.51
AMAZON.COM*RP5AC62F3	Spraypaint	22.26
AMAZON MKTPL*521HW6A63	Flyer Holder	21.98
709 AUTO VALUE - NEW G	Transportation: Tool for Fuel Filters	21.95
NEW GLARUS HARDWARE	custodiial	20.98
AMAZON MKTPL*J13JU7I63	Nightstand Hardware	20.97
AMAZON.COM*4770D8V13	ap chem prep flashcards	20.30
AMAZON MKTPL*QE3YW80R3	books	20.09
AMAZON MKTPL*PN44M7623	Laminator	19.98
AMAZON RETA* 0O2HI2DP3	Books	19.88
AMAZON MKTPL*0P2QF2FC3	Drinking cups 20	19.33

**SCHOOL DISTRICT OF NEW GLARUS
PURCHASING CARD ACTIVITY
JANUARY 31, 2026**

GRAINGER	custodial supplies	19.22
AMAZON MKTPL*L59O62OO3	modeling clay	18.99
WWW COSTCO COM	Office supplies	17.99
AMAZON.COM*3I5MO78Z3	Classroom supplies	17.04
AMAZON MKTPL*EB3IS3543	Magnetic Door Lock Down Strips	16.98
AMAZON MKTPL*V066I1383	journal and pens	16.94
GEMPELER'S SUPERMAR	HS Food Lab Supplies	16.56
PP*GOOGLE LLC GOOGLE WORK	Google licenses - Google Meet upgrades	16.00
AMAZON RETA* HE7LN01X3	book	15.99
PRIME VIDEO *114DQ22I3	Stop Motion Animation Movie	15.81
AUDIBLE*HB3TB7G53	Audible.com Jan 2026	15.77
AMAZON MKTPL*DT1XV6YS3	Ag Power Supplies	15.38
CASEYS #3572	Water testing TDS lab	15.34
PAYPAL *CANVA	Canva subscription for digital signage	15.00
AMAZON.COM*DG7TS0T93	Adapted measuring cups	15.00
AMAZON MKTPL*T70QL9RY3	Ink for stampers	14.90
AMAZON MKTPL*6P79R02J3	earth sci supplies	14.49
AMAZON RETA* AT84I76Q3	book	13.87
AMAZON MKTPL*719RS61V3	book	13.85
"ETSY, INC."	CNC FILES	13.72
AMAZON MKTPL*SI9U24Y43	Supplies for home basketball games	13.70
SPOTIFY USA	Spotify account for athletic events	12.65
AMAZON.COM*PN3074OB3	classroom supplies	12.50
KWIK TRIP #307	food purchase while at a choir festival	12.41
ROYS MARKET	HS FCS Lab Supplies	12.40
J.W. PEPPER	music purchase for Middle school	12.00
NIC*-WI DEPTOFREVENUEE	DOR RENEWAL	11.25
J.W. PEPPER	Purchase for solo and ensemble	11.25
KWIK STAR #1190	food purchase while at a choir festival	11.22
AMAZON MKTPL*3D7WU0P33	Batteries	10.99
PAYPAL *ITRESEARCHL	VPN for German class	10.99
AMAZON MKTPL*F80SW61C3	Clown Horn for MS Band	10.90
NEW GLARUS HARDWARE	chick feed for vet tech	10.54
AMAZON MKTPL*0Y8PW64C3	books	10.39
J.W. PEPPER	S&E Music	10.00
NEW GLARUS HARDWARE	drywall repair	9.99
AMAZON RETA* TR4TF58N3	book	9.85
AMAZON MKTPL*UA4N733H3	MS art supply	9.79
AUDIBLE*O785B60S3	Audible	9.48
AMAZON RETA* TT5UW2OW3	book	9.21
AMAZON RETA* BC6EA5123	book	8.52
AMAZON RETA* K07Y17TY3	book	7.99
AMAZON MKTPL*9C3ZY76I3	book	7.80
AMAZON MKTPL*5R1QR8283	Misc supplies - canned air	7.45
MEETENHANC* MEET ENHAN	Google Meet Enhancement	7.39

**SCHOOL DISTRICT OF NEW GLARUS
PURCHASING CARD ACTIVITY
JANUARY 31, 2026**

USPS PO 5659000694	Postage for envelope mailing	7.20
NEW GLARUS HARDWARE	hardware HS phy Ed.	7.18
DOJ EPAY RECORDS CHECK	BACK GROUND CHECK	7.00
TWP*SUB28538583	news	7.00
PP*GOOGLE LETTERSCHOOL	Letterschool for 4k classroom	5.26
WWW.CODEHUB2021.COM	tech	5.00
ROYS MARKET	MS Eggs	3.58
ROYS MARKET	HS Food Lab Supplies	2.49
USPS PO 5659000694	SPED Mailings	2.44
"ETSY, INC."	CNC Monopoly	2.10
AMAZON WEB SERVICES	Monthly AWS fee for CS classes	1.00
AMAZON MKTPLACE PMTS	game	-16.99
AMAZON MKTPLACE PMTS	Shelf for paper HS refund	-29.61
BADGER POPCORN	Tax exemption money back from Badger Popcorn	-34.28
709 AUTO VALUE - NEW G	refund	-857.97
TOTAL PURCHASING CARD ACTIVITIES		86,945.01

CHECK NUMBER	CHECK VENDOR	CHECK DATE	INVOICE NUMBER	INVOICE DESCRIPTION	AMOUNT
152	EMPLOYEE BENEFITS CO	02/13/2026	20260213AD	HSA EMPLOYEE CONTR	10,374.41
		02/13/2026	20260213AF	EMPLOYER CONTR	28,125.00
Totals for 152					38,499.41
341	WISCONSIN RETIREMENT	02/13/2026	20260213AD	Payroll accrual	48,169.19
		02/13/2026	20260213AF	Payroll accrual	48,169.19
Totals for 341					96,338.38
573	ELECTRONIC TAX FILIN	02/13/2026	20260213AD	Payroll accrual	7,572.92
		02/13/2026	20260213AD	Payroll accrual	9,899.63
		02/13/2026	20260213AD	Payroll accrual	42,806.21
		02/13/2026	20260213AD	Payroll accrual	42,329.11
		02/13/2026	20260213AF	Payroll accrual	9,899.63
		02/13/2026	20260213AF	Payroll accrual	42,329.11
Totals for 573					154,836.61
902	WI DEPARTMENT OF REV	02/13/2026	20260213AD	Payroll accrual	510.00
		02/13/2026	20260213AD	Payroll accrual	26,977.77
Totals for 902					27,487.77
1074	WEA TAX SHELTERED AN	02/13/2026	20260213AD	Payroll accrual	13,037.50
		02/13/2026	20260213AD	Payroll accrual	1,040.00
		02/13/2026	20260213AD	WEA ROTH \$	2,696.50
		02/13/2026	20260213AD	WEA ROTH %	1,734.69
		02/13/2026	20260213AF	Payroll accrual	1,833.38
Totals for 1074					20,342.07
1227	EMPLOYEE BENEFITS CO	02/13/2026	20260213AD	Payroll accrual	625.00
		02/13/2026	20260213AD	Payroll accrual	1,200.32
Totals for 1227					1,825.32
1529	DEAN HEALTH PLAN, IN	02/13/2026	20260213AD	Payroll accrual	2,086.88
		02/13/2026	20260213AD	Payroll accrual	1,361.04
		02/13/2026	20260213AD	Payroll accrual	12,521.28
		02/13/2026	20260213AD	Payroll accrual	453.68
		02/13/2026	20260213AD	Payroll accrual	782.58
		02/13/2026	20260213AD	Payroll accrual	2,086.88
		02/13/2026	20260213AD	Payroll accrual	0.00
		02/13/2026	20260213AF	Payroll accrual	11,825.76
		02/13/2026	20260213AF	Payroll accrual	4,434.66
		02/13/2026	20260213AF	Payroll accrual	2,570.80
		02/13/2026	20260213AF	Payroll accrual	11,825.76
		02/13/2026	20260213AF	Payroll accrual	7,712.40
		02/13/2026	20260213AF	Payroll accrual	70,954.56
		02/13/2026	20260213AF	Payroll accrual	0.00
Totals for 1529					128,616.28
1729	DELTA DENTAL OF WISC	02/13/2026	20260213AD	Payroll accrual	104.52
		02/13/2026	20260213AD	Payroll accrual	1,236.75
		02/13/2026	20260213AD	Payroll accrual	24.12
		02/13/2026	20260213AD	Payroll accrual	145.50
		02/13/2026	20260213AD	Payroll accrual	169.75
		02/13/2026	20260213AD	Payroll accrual	291.00
		02/13/2026	20260213AF	Payroll accrual	1,648.92
		02/13/2026	20260213AF	Payroll accrual	136.83
		02/13/2026	20260213AF	Payroll accrual	824.46

CHECK NUMBER	CHECK VENDOR	CHECK DATE	INVOICE NUMBER	INVOICE DESCRIPTION	AMOUNT
1729	DELTA DENTAL OF WISC	02/13/2026	20260213AF	Payroll accrual	961.87
		02/13/2026	20260213AF	Payroll accrual	7,007.91
		02/13/2026	20260213AF	Payroll accrual	592.93
				Totals for 1729	13,144.56
67699	BROWN, ROBERT	02/09/2026	02/09 bbb	ATHL OFFL	65.00
				Totals for 67699	65.00
67700	FULLERTON, JOHN	02/09/2026	02/09 bbb	ATHL OFFL	62.50
				Totals for 67700	62.50
67701	McCORMICK, ERICK	02/09/2026	02/09 bbb	ATHL OFFL	60.00
				Totals for 67701	60.00
67702	NEDS, NICHOLAS	02/09/2026	02/09 bbb	ATHL OFFL	85.00
				Totals for 67702	85.00
67703	RANGUETTE, NATHAN	02/09/2026	02/09 bbb	ATHL OFFL	85.00
				Totals for 67703	85.00
67704	SCHULTZ, ROBERT	02/09/2026	02/09 bbb	ATHL OFFL	85.00
				Totals for 67704	85.00
67705	TORDOFF, JERALD	02/09/2026	02/09 bbb	ATHL OFFL	60.00
				Totals for 67705	60.00
67706	AFLAC WORLDWIDE HEAD	02/13/2026	20260213AD	Payroll accrual	36.38
				Totals for 67706	36.38
67707	MADISON NATIONAL LIF	02/13/2026	20260213AD	Payroll accrual	717.62
		02/13/2026	20260213AF	Payroll accrual	2,030.95
		02/13/2026	02-13-26 a	ACCL ADJ	42.56
				Totals for 67707	2,791.13
67708	MINNESOTA MUTUAL LIF	02/13/2026	20260213AD	Payroll accrual	1,316.38
		02/13/2026	20260213AD	Payroll accrual	99.20
		02/13/2026	20260213AF	Payroll accrual	163.27
		02/13/2026	20260213AD	Payroll accrual	816.39
				Totals for 67708	2,395.24
67709	NEW GLARUS COMMUNITY	02/13/2026	20260213AD	Payroll accrual	185.00
				Totals for 67709	185.00
67710	UNITED WAY GREEN COU	02/13/2026	20260213AD	Payroll accrual	100.00
				Totals for 67710	100.00
67711	EASTERDAY, KURT	02/10/2026	02/10	GBB ATHL OFFL	55.00
				Totals for 67711	55.00
67712	HAAS, ADAM	02/10/2026	02/10	GBB ATHL OFFL	65.00
				Totals for 67712	65.00
67713	MCKY, BRYAN	02/10/2026	02/10	GBB ATHL OFFL	85.00
				Totals for 67713	85.00
67714	NICHOLSON, CHRISTOPH	02/10/2026	02/10	GBB ATHL OFFL	85.00

CHECK NUMBER	CHECK VENDOR	CHECK DATE	INVOICE NUMBER	INVOICE DESCRIPTION	AMOUNT
				Totals for 67714	85.00
67715	VITANYE, ALEX	02/10/2026	02/10	GBB ATHL OFFL	85.00
				Totals for 67715	85.00
67716	BORCHARDT, RYAN	02/13/2026	02/13	GBB ATHL OFFL	85.00
				Totals for 67716	85.00
67717	EASTERDAY, KURT	02/13/2026	02/13	GBB ATHL OFFL	55.00
				Totals for 67717	55.00
67718	HEGGE, JON	02/13/2026	02/13	GBB ATHL OFFL	85.00
				Totals for 67718	85.00
67719	LAWINGER, THEODORE	02/13/2026	02/13	GBB ATHL OFFL	65.00
				Totals for 67719	65.00
67720	PHILBIN, SEAN	02/13/2026	02/13	GBB ATHL OFFL	85.00
				Totals for 67720	85.00
67721	ALPINE AUTO ELECTRIC	02/17/2026	39235	BUS BATTERIES	475.83
				Totals for 67721	475.83
67722	BLANCHARDVILLE COOPE	02/17/2026	2007616	DEF	13.39
				Totals for 67722	13.39
67723	BUILDERS FIRST SOURC	02/17/2026	92744964	tech supplies	697.80
				Totals for 67723	697.80
67724	ENGEN PLUMBING SERVI	02/17/2026	2241	REPLACE WATER SOFTNER IN GS BOILER ROOM	1,450.00
				Totals for 67724	1,450.00
67725	GERBER LEISURE PRODU	02/17/2026	13039	PLAYGROUND EQUIPMENT REPAIRS	5,110.00
				Totals for 67725	5,110.00
67726	HAGERTY, MARK	02/17/2026	02/17 BBB	ATHL OFFL	85.00
				Totals for 67726	85.00
67727	JOSTENS INC	02/17/2026	38740163	DIPLOMAS	548.15
				Totals for 67727	548.15
67728	LEUZINGER, RICHARD	02/17/2026	02/17 BBB	ATHL OFFL	85.00
				Totals for 67728	85.00
67729	LILLY, SHANE	02/17/2026	02/17 BBB	ATHL OFFL	65.00
				Totals for 67729	65.00
67730	MCHS OCCUPATIONAL HE	02/17/2026	3764-48796	DOT LAB ANALYSIS	263.00
				Totals for 67730	263.00
67731	MONTGOMERY, JOSH	02/17/2026	02/17 BBB	ATHL OFFL	85.00
				Totals for 67731	85.00
67732	ORION FAMILY SERVICE	02/17/2026	28945	DEC SERV	984.05
				Totals for 67732	984.05

CHECK NUMBER	CHECK VENDOR	CHECK DATE	INVOICE NUMBER	INVOICE DESCRIPTION	AMOUNT
67733	TORDOFF, JERALD	02/17/2026	02/17 BBB	ATHL OFFL	65.00
				Totals for 67733	65.00
67734	VITAL SIGNS	02/17/2026	26035	PENNANT BANNERS	1,723.00
				Totals for 67734	1,723.00
67735	WE ENERGIES	02/17/2026	JAN 2026 G	MONTHLY SERV	7,985.10
		02/17/2026	JAN 2026 H	MONTHLY SERV	6,875.21
				Totals for 67735	14,860.31
67736	ZELLER, BEN	02/17/2026	02/17 BBB	ATHL OFFL	65.00
				Totals for 67736	65.00
67737	CLEARY BUILDING CORP	02/18/2026	TRUSSES	TRUSSES FOR BUS BARN	20,683.00
				Totals for 67737	20,683.00
67738	BEEN, SHANE	02/19/2026	02/19 BBB	ATHL OFFL	85.00
				Totals for 67738	85.00
67739	BETHKE, THOMAS	02/19/2026	02/19 BBB	ATHL OFFL	85.00
				Totals for 67739	85.00
67740	EASTERDAY, KURT	02/19/2026	02/19 BBB	ATHL OFFL	55.00
				Totals for 67740	55.00
67741	HAAS, ADAM	02/19/2026	02/19 BBB	ATHL OFFL	65.00
				Totals for 67741	65.00
67742	HAYES-ROBINSON, ANTO	02/19/2026	02/19 BBB	ATHL OFFL	85.00
				Totals for 67742	85.00
67743	McKeon, TYLER	02/19/2026	02/19 BBB	ATHL OFFL	60.00
				Totals for 67743	60.00
67744	PETERSON, KEVIN	02/19/2026	02/19 GBB	ATHL OFFL	77.50
				Totals for 67744	77.50
67745	SCHULTING, JASON	02/19/2026	02/19 BBB	ATHL OFFL	65.00
				Totals for 67745	65.00
				Totals for checks	535,686.68

<u>CHECK</u>	<u>CHECK</u>	<u>INVOICE</u>	<u>INVOICE</u>		
<u>NUMBER</u>	<u>VENDOR</u>	<u>DATE</u>	<u>NUMBER</u>	<u>DESCRIPTION</u>	<u>AMOUNT</u>
252600033	MARTY, TAMMY	02/17/2026	WASBO FEB	MILEAGE	90.63
				Totals for 252600033	90.63
252600034	SPANTON, ERIC	02/17/2026	02/11/2026	BASEBALL COACHES MEMBERSHIP/CLINIC	268.80
				Totals for 252600034	268.80
252600035	HAAK, DENNIS	02/19/2026	CC 2025	CC SUPPLIES	161.48
				Totals for 252600035	161.48
252600036	KRAEMER BROTHERS, LL	02/19/2026	202601	RAILINGS FOR ATHL COMPL	5,004.00
				Totals for 252600036	5,004.00
				Totals for checks	5,524.91

Budgetary Checks # 67699 - 67745
ACH Checks - #252600033 - 252600036
Direct Deposits - 900038622 - 38771

EFT - EBC - #152

EFTPS - Wisconsin Retirement System - #341

EFT - Electronic Tax Payment System - # 573

EFT - Dept of Revenue - #902

EFT - WEA Tax Sheltered Annuity - #1074

EFT - EBC - #1227

EFT - DEAN HEALTH - #1529

EFT - DELTA DENTAL - #1729

New Glarus School District

Treasurer's Report January 31, 2026



SCHOOL DISTRICT OF NEW GLARUS
FUND SUMMARY
JANUARY 31, 2026

	Fund Balance Audited 6/30/2025	+	FY2026 Revenues	-	FY2026 Expend.	+	Transfers Sources	=	Fund Balance 1/31/2026
General Fund	4,657,666.02		3,037,635.01		6,317,848.70		(517,411.15)		860,041.18
General Fund - nonspendable/unspent/as	34,042.60		0.00		0.00		0.00		34,042.60
TOTAL FUND 10	4,691,708.62		3,037,635.01		6,317,848.70		(517,411.15)		894,083.78
Special Revenue Trust (Fund 21)	428,878.84		407,573.64		79,160.11				757,292.37
Spec. Ed. Grants	0		8,920.14		100,761.78				-91,841.64
Special Education (Fund 27)	0		306,775.51		824,186.66		517,411.15		0.00
TOTAL FUND 27	0		315,695.65		924,948.44		517,411.15		-91,841.64
DEBT SERVICE (Fund 39)	401,067.23		2,774,236.71		311,600.00				2,863,703.94
LT CAPITAL (Fund 46)	791,013.67		16,988.44		0.00				808,002.11
OTHER CAPITAL DEBT (Fund 49)	1,208,656.13		18,557.84		544,526.67				682,687.30
FOOD SERVICE (Fund 50)	76,903.95		356,502.46		366,215.65				67,190.76
EMPLOYEE TRUST FUND (73)	545,320.43		48,516.93		5,525.39				588,311.97
COMMUNITY SERVICE FUND (80)	8,037.86		0.00		0.00				8,037.86

**SCHOOL DISTRICT OF NEW GLARUS
REVENUES
January 31, 2026**

GENERAL FUND - 10					
	ORIGINAL BUDGET REVENUES 2025 - 2026	MTD REVENUES	YTD REVENUES	25-26 YTD % RCVD	24-25 YTD % RCVD
Property Taxes	\$ 5,820,845.00			0.00%	13.52%
Mobile Home/DNR Tax	\$ 12,600.00	\$ 346.44	\$ 1,732.20	13.75%	14.85%
Interest	\$ 65,000.00	\$ 9,542.48	\$ 76,042.08	116.99%	88.38%
Local Revenue	\$ 121,550.00	\$ 6,803.00	\$ 94,621.35	77.85%	48.63%
Open Enrollment	\$ 1,338,270.00			0.00%	0.00%
Transportation Aid	\$ 15,565.00	\$ 13,980.00	\$ 13,980.00	89.82%	81.00%
Library Aid (Common School Fund)	\$ 54,000.00			0.00%	0.00%
Equalization Aid	\$ 6,500,887.00		\$ 2,600,355.00	40.00%	40.00%
Exempt - Computer/Personal Property A	\$ 57,417.00			0.00%	0.00%
Per Pupil Aid	\$ 626,248.00			0.00%	0.00%
Grants - State	\$ 7,248.00	\$ 3,010.00	\$ 18,056.46	249.12%	0.00%
Grants - Federal	\$ 82,054.00			0.00%	0.00%
Grants/Donations - Local	\$ 6,500.00	\$ 260.00	\$ 2,172.09	33.42%	18.46%
Other Federal Revenue Thru State	\$ -			0.00%	0.00%
Insurance Proceeds	\$ 229,000.00	\$ 600.00	\$ 230,675.83	100.73%	0.00%
Contracts tsf of Ownership	\$ -			0.00%	100.00%
Total General Fund Revenues	\$ 14,937,184.00	\$ 34,541.92	\$ 3,037,635.01	20.34%	27.91%

SPECIAL PROJECTS FUNDS - 21 & 27					
Fund 21 - Special Revenue	\$ 145,030.00	\$ 12,350.99	\$ 407,573.64	281.03%	65.93%
Fund 27 - Operating Transfer from Fund	\$ 1,336,529.00	\$ 59,240.28	\$ 517,411.15	38.71%	45.28%
Fund 27 - Special Ed.- Categorical	\$ 726,246.00	\$ 100,337.00	\$ 301,011.00	41.45%	42.89%
Fund 27 - Special Ed.- High Cost	\$ 45,000.00	\$ -	\$ -	0.00%	0.00%
Fund 27 - Special Ed. - Grant	\$ 218,137.00	\$ 4,520.15	\$ 8,920.14	4.09%	0.82%
Fund 27 - Special Ed. - Federal Thru Sta	\$ 20,000.00	\$ 2,752.06	\$ 5,764.51	28.82%	14.72%
Total Special Projects Revenues	\$ 2,490,942.00	\$ 179,200.48	\$ 1,240,680.44	49.81%	43.41%

DEBT SERVICE FUNDS & OTHER CAPITAL DEBT - 39, 46 & 49					
Fund 39 - Referendum Approved Debt	\$ 3,230,438.00	\$ 2,770,276.99	\$ 2,774,236.71	85.88%	99.69%
Fund 46 - Long Term Cap Maint Trust Fu	\$ 112,000.00	\$ 2,342.25	\$ 16,988.44	15.17%	0.39%
Fund 49 - Construction Fund	\$ 30,000.00	\$ 2,088.98	\$ 18,557.84	61.86%	86.95%
Total Debt Service Revenues	\$ 3,372,438.00	\$ 2,774,708.22	\$ 2,809,782.99	83.32%	86.76%

FOOD & COMMUNITY SERVICE FUNDS - 50 & 80					
Fund 50-Local Sources	\$ 530,934.00	\$ 55,685.00	\$ 289,173.12	54.46%	54.01%
Fund 50-State/Federal Sources	\$ 206,542.00	\$ 13,669.48	\$ 67,329.34	32.60%	31.41%
Fund 73 - OPEB	\$ 67,000.00	\$ 7,119.92	\$ 48,516.93	72.41%	31.31%
Fund 80 - Community Services	\$ -		\$ -	0.00%	0.00%
Total Fd & Community Service Revenues	\$ 804,476.00	\$ 76,474.40	\$ 405,019.39	50.35%	43.78%

Total Revenues	\$ 21,605,040.00	\$ 3,064,925.02	\$ 7,493,117.83	34.68%	40.79%
-----------------------	-------------------------	------------------------	------------------------	---------------	---------------

**SCHOOL DISTRICT OF NEW GLARUS
EXPENDITURES
January 31, 2026**

GENERAL FUND - 10					
Instruction	ORIGINAL BUDGET EXPENDITURES 2025-2026	MTD EXPENDITURES	YTD EXPENDITURES	25 - 26 YTD % EXPD	24 - 25 YTD % EXPD
Undifferentiated Curriculum	\$ 2,930,680.00	\$ 223,476.93	\$ 1,291,952.18	44.08%	42.81%
Regular Curriculum	\$ 3,451,173.00	\$ 275,303.24	\$ 1,464,970.72	42.45%	42.71%
Vocational Curriculum	\$ 436,139.00	\$ 37,413.13	\$ 190,202.29	43.61%	38.68%
Physical Curriculum	\$ 341,284.00	\$ 27,876.11	\$ 144,651.65	42.38%	42.42%
Co-Curricular Activity	\$ 281,718.00	\$ 19,331.62	\$ 111,843.01	39.70%	42.81%
Special Curriculum	\$ 6,000.00	\$ 138.31	\$ 1,586.31	26.44%	50.63%
Total Instruction	\$ 7,446,994.00	\$ 583,539.34	\$ 3,205,206.16	43.04%	42.50%
Support Services					
Pupil Services	\$ 342,357.00	\$ 29,383.78	\$ 140,472.44	41.03%	39.01%
Instructional Services	\$ 742,291.00	\$ 61,517.76	\$ 359,176.03	48.39%	44.37%
General Operations	\$ 464,754.00	\$ 46,445.75	\$ 248,711.36	53.51%	55.51%
School Building Operations	\$ 701,565.00	\$ 60,835.56	\$ 407,562.16	58.09%	56.21%
Business Services	\$ 261,501.00	\$ 21,231.70	\$ 156,345.84	59.79%	54.97%
Building Operations	\$ 817,606.00	\$ 86,211.33	\$ 438,879.19	53.68%	46.65%
Maintenance	\$ 292,379.00	\$ 25,023.31	\$ 199,309.27	68.17%	59.37%
Capital Maintenance Projects (Facilities)	\$ 502,990.00	\$ 28,327.00	\$ 291,073.85	57.87%	78.22%
Pupil Transportation	\$ 444,772.00	\$ 30,374.64	\$ 155,145.90	34.88%	83.17%
Central Services	\$ 86,606.00	\$ 1,915.29	\$ 42,534.56	49.11%	53.86%
Insurance	\$ 218,359.00	\$ -	\$ 215,436.00	98.66%	84.14%
Debt Services	\$ 134,878.00	\$ -	\$ 134,878.00	100.00%	100.00%
Other Support Services	\$ 418,954.00	\$ 45,111.43	\$ 316,092.25	75.45%	40.12%
Total Support Services	\$ 5,429,012.00	\$ 436,377.55	\$ 3,105,616.85	57.20%	61.45%
Non-Program Transactions					
Operating Transfers to another Fund	\$ 1,443,529.00	\$ 59,240.28	\$ 517,411.15	35.84%	34.06%
General Tuition/Non-Open enrollment	\$ 46,000.00	\$ 3,115.00	\$ 7,025.69	15.27%	13.68%
Co-Curricular Cooperative Programs	\$ 75,500.00	\$ -	\$ -	0.00%	40.24%
General Tuition/Open Enrollment	\$ 475,000.00	\$ -	\$ -	0.00%	0.00%
Special Needs Scholarship Program	\$ 16,049.00	\$ -	\$ -	0.00%	0.00%
Other Non-Program Transactions	\$ 5,100.00	\$ -	\$ -	0.00%	0.00%
Total Non-Program Transactions	\$ 2,061,178.00	\$ 62,355.28	\$ 524,436.84	25.44%	27.32%
TOTAL GENERAL FUNDS	\$ 14,937,184.00	\$ 1,082,272.17	\$ 6,835,259.85	45.76%	47.89%
Fund 21 - Special Revenue Fund					
Fund 21 - Special Revenue Fund	\$ 145,150.00	\$ 19,143.69	\$ 79,160.11	54.54%	54.78%
Fund 27 - Special Education Grants					
Fund 27 - Special Education Grants	\$ 218,137.00	\$ 11,289.08	\$ 100,761.78	46.19%	71.00%
Fund 27 - Special Education Regular					
Fund 27 - Special Education Regular	\$ 2,127,775.00	\$ 162,329.34	\$ 824,186.66	38.73%	43.00%
TOTAL SPECIAL PROJECTS FUNDS	\$ 2,491,062.00	\$ 192,762.11	\$ 1,004,108.55	40.31%	45.38%
DEBT SERVICE FUNDS & OTHER CAPITAL DEBT - 38, 39, 40 & 49					
Fund 39 - Referendum Approved Debt	\$ 3,305,125.00	\$ -	\$ 311,600.00	9.43%	11.07%
Fund 46 - Long Term Cap Maint Trust Fu	\$ -	\$ -	\$ -	0.00%	0.00%
Fund 49 - Construction Fund	\$ 1,223,541.00	\$ -	\$ 544,526.67	44.50%	94.19%
TOTAL DEBT SERVICE FUNDS	\$ 4,528,666.00	\$ -	\$ 856,126.67	18.90%	75.14%
FOOD & COMMUNITY SERVICE FUNDS - 50 & 80					
Fund 50 - Food Service	\$ 729,270.00	\$ 63,596.03	\$ 366,215.65	50.22%	67.63%
FUND 73 - OPEB	\$ 55,000.00	\$ 597.53	\$ 5,525.39	10.05%	23.76%
Fund 80 - Community Service	\$ -	\$ -	\$ -	0.00%	0.00%
TOTAL FOOD & COM. SRV. FUNDS	\$ 784,270.00	\$ 64,193.56	\$ 371,741.04	47.40%	63.32%
TOTAL EXPENDITURES-ALL FUNDS	\$ 22,741,182.00	\$ 1,339,227.84	\$ 9,067,236.11	39.87%	59.82%

**STAFFING REPORT
FEBRUARY 23, 2026**

HIRES / CHANGES	Position	Term of Employment	hours per day / % of empl	New Employee in Position	Reason for opening
	HS Track Assistant Coach	2026 Spring Season	varies	Ryan Carroll	new position - no co-op with Belleville

OPEN POSITIONS	Position	Term of Employment	hours per day / % of empl	Reason for opening
Teacher	Elem Phy Ed Teacher	2026-27 School year	100%	Gary Beutler retirement
Coach	MS Track Assistant Coach	2026 Spring Season	varies	Sadie Einbeck coaching resignation
Coach	HS Volleyball Assistant Coach	2026 Fall Season	varies	Theresa Martinson coaching resignation

Donations 2.23.26

2/9/2026	Marc Barnaby - Barnaby Construction	Check	School Lunch Balances	\$420.00
----------	-------------------------------------	-------	--------------------------	----------

- B. Discuss Item(s) Removed From Consent Agenda
- V. **COMMITTEE UPDATES**
 - A. Policy, Communication & Advocacy
 - B. Handbook and Personnel
 - C. Budget
 - D. Curriculum, Sports & Co-Curricular
 - E. Facilities, Transportation & Technology
- VI. **DISCUSSION AND POSSIBLE ACTION ITEMS**
 - A. Resolution Authorizing the Redemption of Certain of the General Obligation School Improvement Bonds, Dated March 5, 2012. 39

RESOLUTION NO. ____

RESOLUTION AUTHORIZING THE REDEMPTION OF CERTAIN OF THE
GENERAL OBLIGATION SCHOOL IMPROVEMENT BONDS, DATED MARCH 5, 2012

WHEREAS, the School District of New Glarus, Dane and Green Counties, Wisconsin (the "District") has outstanding its General Obligation School Improvement Bonds, dated March 5, 2012 (the "2012 Bonds");

WHEREAS, the School Board has determined that it is necessary and desirable to call a \$450,000 portion of the 2027 maturity and a \$405,000 portion of the 2028 maturity of the 2012 Bonds for redemption on April 1, 2026 with funds of the District on hand;

NOW, THEREFORE, BE IT RESOLVED by the School Board of the District, that a \$450,000 portion of the 2027 maturity and a \$405,000 portion of the 2028 maturity of the 2012 Bonds are called for prior payment on April 1, 2026 at the price of par plus accrued interest to the date of redemption.

The District hereby directs the District Clerk to work with Associated Trust Company, National Association to cause timely notice of redemption, in substantially the form attached hereto as Exhibit A and incorporated herein by this reference (the "Notice"), to be provided at the times, to the parties and in the manner set forth on the Notice. Further, the District Clerk shall cause the funds necessary to redeem the 2012 Bonds to be provided to The Depository Trust Company.

Adopted, approved and recorded February 23, 2026.

William Oemichen
District President

ATTEST:

Cari Ann Muggenburg
District Clerk

(SEAL)

EXHIBIT A

NOTICE OF PARTIAL CALL*

SCHOOL DISTRICT OF NEW GLARUS
DANE AND GREEN COUNTIES, WISCONSIN
GENERAL OBLIGATION SCHOOL IMPROVEMENT BONDS
DATED MARCH 5, 2012

NOTICE IS HEREBY GIVEN that the Bonds of the above-referenced issue which mature on the dates and in the amounts; bear interest at the rates; and have CUSIP Nos. as set forth below have been called for prior payment on April 1, 2026 at a redemption price equal to 100% of the principal amount thereof plus accrued interest to the date of prepayment:

<u>Maturity Date</u>	<u>Principal Amount</u>	<u>Interest Rate</u>	<u>CUSIP No.</u>
04/01/2027	\$450,000**	2.25%	644503DB7
04/01/2028	405,000**	2.50	644503DC5

Upon presentation and surrender of said Bonds to Associated Trust Company, National Association, the registrar and fiscal agent for said Bonds, the registered owners thereof will be paid the principal amount of the Bonds plus accrued interest to the date of prepayment.

Said Bonds will cease to bear interest on April 1, 2026.

By Order of the
School Board
School District of New Glarus
District Clerk

Dated _____

* To be provided to Associated Trust Company, National Association at least thirty-five (35) days prior to April 1, 2026. The registrar and fiscal agent shall be directed to give notice of such prepayment by registered or certified mail, overnight express delivery, facsimile transmission, electronic transmission or in any other manner required by The Depository Trust Company, to The Depository Trust Company, Attn: Supervisor, Call Notification Department, 570 Washington Blvd., Jersey City, NJ 07310, not less than thirty (30) days nor more than sixty (60) days prior to April 1, 2026 and to the MSRB electronically through the Electronic Municipal Market Access (EMMA) System website at www.emma.msrb.org.

**Represents a portion of the principal amount outstanding of this maturity.

New Glarus Teacher Salary Grid 2026-27 Preliminary

	Level	Lane		
		BA 1,250	MA 4,000	
Start 2026-27	6	57,450	61,450	\$950 to base add 1 level at end everyone \$2200
	7	58,700	62,700	
	8	59,950	63,950	
	9	61,200	65,200	
	10	62,450	66,450	
	11	63,700	67,700	
	12	64,950	68,950	
	13	66,200	70,200	
	14	67,450	71,450	
	15	68,700	72,700	
	16	69,950	73,950	
	17	71,200	75,200	
	18	72,450	76,450	
	19	73,700	77,700	
	20	74,950	78,950	
	21	76,200	80,200	

Salary Grid Permanent Add On's:

- \$ 1,000 Per completion of 24-40 hours of approved Project Lead the Way Course
- \$ 1,000 Wisconsin DPI Reading Certification (316 / 317)
- \$ 5,000 National Board Certification
- \$ 4,000 PhD

Other Teacher Compensation:

State or National Award One Time Bonus

\$ 1,000

Professional Development / Summer Curriculum Work

\$ 20.00 Hour

Summer School Teacher

\$ 30.00 Hour

\$ 40.00 Hour Credit Class / Credit Recovery Classes

After School Adventures Teacher

\$ 30.00 Hour

Homebound Tutoring

\$ 30.00 Hour

Teacher Class Coverage

\$ 25.00 Hour

Substitute Teacher Rates:

Short Term Teacher Substitute Rate

\$ 160.00 Day

Long Term Teacher Substitute Rate (> 20 day assignment)

\$ 302.37 Day

New Glarus Teacher Salary Grid 2025-26 - Final

	Level	Lane	
		BA 1,250	MA 4,000
Start 2025-26	6	56,500	60,500
	7	57,750	61,750
	8	59,000	63,000
	9	60,250	64,250
	10	61,500	65,500
	11	62,750	66,750
	12	64,000	68,000
	13	65,250	69,250
	14	66,500	70,500
	15	67,750	71,750
	16	69,000	73,000
	17	70,250	74,250
	18	71,500	75,500
	19	72,750	76,750
	20	74,000	78,000

Salary Grid Permanent Add On's:

- \$ 1,000 Per completion of 24-40 hours of approved Project Lead the Way Course
- \$ 1,000 Wisconsin DPI Reading Certification (316 / 317)
- \$ 5,000 National Board Certification
- \$ 4,000 PhD

Other Teacher Compensation:

State or National Award One Time Bonus

\$ 1,000

Professional Development / Summer Curriculum Work

\$ 20.00 Hour

Summer School Teacher

\$ 30.00 Hour

\$ 40.00 Hour Credit Class / Credit Recovery Classes

After School Adventures Teacher

\$ 30.00 Hour

Homebound Tutoring

\$ 30.00 Hour

Teacher Class Coverage

\$ 20.00 Hour

Substitute Teacher Rates:

Short Term Teacher Substitute Rate

\$ 150.00 Day

Long Term Teacher Substitute Rate (> 20 day assignment)

\$ 297.37 Day

HOURLY POSITIONS WAGE CHART FOR 2026-27 Preliminary

Step Incr Other adj overall incr
 \$ 0.30 \$ 0.60 3.00%

	Step 4	Step 5	Step 6	Step 7	Step 8
Secretary	\$ 22.60	\$ 22.90	\$ 23.20	\$ 23.50	\$ 23.80
Data Info Specialist	\$ 22.60	\$ 22.90	\$ 23.20	\$ 23.50	\$ 23.80
Administrative Asst Superintendent	\$ 22.82	\$ 23.12	\$ 23.42	\$ 23.72	\$ 24.02
Teaching Asst / 4K Asst	\$ 19.79	\$ 20.09	\$ 20.39	\$ 20.69	\$ 20.99
Spec Ed Asst/Title 1 Asst	\$ 20.14	\$ 20.44	\$ 20.74	\$ 21.04	\$ 21.34
Custodial **	\$ 21.13	\$ 21.43	\$ 21.73	\$ 22.03	\$ 22.33
Maintenance	\$ 23.73	\$ 24.03	\$ 24.33	\$ 24.63	\$ 24.93
Bus Route Hourly (AM/PM/Noon)	\$ 27.57				
Bus Hourly	\$ 24.00				
Van Driver Hourly	\$ 22.25				
Student Worker	\$ 13.60				
Substitute Spec Ed / Reg Ed Aides	\$ 19.00				

** Second shift differential pay of \$ 1.00 will be added to the Wage Chart hourly pay for Custodians with assignments that are "primarily" second shift for all hours worked.

HOURLY POSITIONS WAGE CHART FOR 2025-26 - FINAL

Step Incr Other adj overall incr
 \$ 0.30 \$ 1.00 5.00%

	Step 4	Step 5	Step 6	Step 7	Step 8
Secretary	\$ 22.00	\$ 22.30	\$ 22.60	\$ 22.90	\$ 23.20
Data Info Specialist	\$ 22.00	\$ 22.30	\$ 22.60	\$ 22.90	\$ 23.20
Administrative Asst Superintendent	\$ 22.22	\$ 22.52	\$ 22.82	\$ 23.12	\$ 23.42
Teaching Asst / 4K Asst	\$ 19.19	\$ 19.49	\$ 19.79	\$ 20.09	\$ 20.39
Spec Ed Asst/Title 1 Asst	\$ 19.54	\$ 19.84	\$ 20.14	\$ 20.44	\$ 20.74
Custodial **	\$ 20.53	\$ 20.83	\$ 21.13	\$ 21.43	\$ 21.73
Maintenance	\$ 23.13	\$ 23.43	\$ 23.73	\$ 24.03	\$ 24.33
Bus Route Hourly (AM/PM/Noon)	\$ 26.67				
Bus Hourly	\$ 23.40				
Van Driver Hourly	\$ 21.65				
Student Worker	\$ 13.00				
Substitute Spec Ed / Reg Ed Aides	\$ 18.50				

** Second shift differential pay of \$ 1.00 will be added to the Wage Chart hourly pay for Custodians with assignments that are "primarily" second shift for all hours worked.

- D. 2026-27 Exempt Staff Salary Increase
- E. Softball Co-op Renewal

48



Cooperative Team Sponsorship

2026-27 & 2027-28

Renewing Expiring

Section 11 of Article VI - The Board of Control has authority to approve cooperative team sponsorship (one team in a given sport involving two or more member schools) under the following conditions:

1. The schools involved must be in the same geographical area.
2. The agreement for a cooperative team must specify two school years, but that agreement may be terminated by the Board of Control for documented extenuating circumstances.
3. New and renewal cooperative team applications must include:
 - A. Approval of involved schools.
 - B. Approval of involved board(s) of education or governing bodies.
 - C. Approval of conference in which the cooperative team will participate.
 - D. The program will adhere to a no-cut policy.

Note: Board of Control and conference approval is not required for non-varsity cooperative teams.

4. Total enrollment of schools involved in a cooperative team will determine classification of competition in WIAA tournament series.
5. Requests for approval and to add a cooperative team into WIAA tournament competition must be received in the WIAA office by the following deadline dates to be included in the subsequent year's tournament program:

Fall Sports - Oct 1 - Winter Sports - Feb 1 - Spring Sports - May 1

Co-op Application ID	81434
Lead School	Monticello
Sport	Softball
Gender	Girls
Select Season:	Spring
Expired Spring Co-op	Monticello/New Glarus - Girls Softball

Our request for cooperative sponsorship is based on the following reasons:

1. Low participation numbers in both districts.
2. Cooping allows for both varsity and JV teams and opportunities.

Number of students participating in each school involved:

School	2023-24	2024-25	2025-26	2026-27
Monticello	8	10	10	-3
New Glarus	12	11	10	11

We have reviewed and considered the following items:

- Development of lead-up programs
- Attempt to create interest in our own program
- Attempt to solve existing problems in our own program
- We have agreed to application of academic code in the co-op
- We have agreed to application of athletic code in the co-op
- Realization that incoming athletes may displace some of our school's student athlete from starting positions
- Liability insurance coverage
- Coaching salaries
- Contest expenses
- Uniform expenses
- Transportation expenses
- Emergency medical treatment

The school districts involved in this cooperative program are sharing costs as follows:

Each school combines costs and after total is configured, each school district takes 10% of total cost off the overall expenses. The school district also configures the expenses by how many players are from each school district to finalize the bill.

HOSA State Leadership Conference

April 8 - 10, 2026

The HOSA State Leadership Conference is for all active HOSA members to participate in. We plan to bring seven regional competitors, six of who qualified for State in their respective events (HOSA Bowl, CPR/First Aid). The seventh member attending is our HOSA president. A full itinerary for the event is linked below and can be found by visiting wihosa.org. The event begins at 12pm on Wednesday, April 8th and ends at 12pm on Friday, April 10th.

Location: Kalahari Resort, Wisconsin Dells - 1305 Kalahari Drive, Wisconsin Dells, WI 53965

Number of students attending: 7

Number of chaperones: 1 (Rychia Bosman - HOSA Advisor)

Cost of Transportation: \$365 roundtrip with school van

Lodging Costs: \$930 total

- 1 chaperone room = $\$155 \times 2 \text{ nights} = \310
- 2 student rooms (3-4 students per room) = $\$155 \times 2 \text{ nights} \times 2 \text{ rooms} = \620

SLC Registration Fees: $\$86.50 \times 8 \text{ people} = \692

- Some meals are provided as part of the cost of registration for attendees.

Trip costs will be covered by HOSA funding.

[Link to HOSA SLC website](#)

February 17, 2026

Dr. Laura Eicher,

This letter is to inform you that after 34 years of teaching in the district I will be retiring at the end of the 2025-26 school year.

As a Physical Education Teacher I have had the unique opportunity to teach at all three levels, high school, middle school, and the elementary school. This opportunity has allowed me to work with nearly every student who has attended our district for the past three and a half decades. I have also worked with many wonderful administrators and school board members. I want to thank all of you for what you do everyday for our students, staff, and community. I will miss many aspects of working in the district. However, after tying thousands of shoes over the years I am looking forward to only tying my own in this next chapter of life.

I started school in New Glarus in the fall of 1973 and am retiring 53 years later. I guess it's true, Once a Knight, Always a Knight!

Sincerely,

A handwritten signature in black ink, appearing to read "Gary Beutler". The signature is stylized with a large initial "G" and a long horizontal stroke extending to the right.

Gary Beutler

From: **Theresa Martinson** <theresa.martinson@ngsd.k12.wi.us>

Date: Fri, Feb 6, 2026 at 3:23 PM

Subject: Resignation

To: Mitchell Cernek <mitchell.cernek@ngsd.k12.wi.us>

Mitch,

Please accept my resignation as the high school assistant volleyball coach.

Sincerely,

Theresa Martinson

**New Hire Board Approval
02/23/2026**

Name: Ryan Carroll
Position: HS Assistant Track Coach
Percentage of employment: varies
Term of employment: 2026 Spring Season
Pay rate: per schedule

- VII. **DISCUSSION ITEMS**
- VIII. **ANNOUNCEMENTS**
- IX. **FUTURE AGENDA ITEMS**
- X. **FUTURE SCHOOL BOARD AND COMMITTEE MEETINGS**
- XI. March 16, 2026 - Discussion & Regular Board Meeting - 7:15 p.m.
- XII. April 13, 2026 - Discussion & Regular Board Meeting - 7:15 p,m.
- XIII. **ADJOURN**

PURSUANT TO APPLICABLE LAW, NOTICE IS HEREBY GIVEN THAT A QUORUM OR A MAJORITY OF THE NEW GLARUS SCHOOL DISTRICT BOARD MEMBERS MAY ATTEND THIS MEETING. INFORMATION PRESENTED AT THIS MEETING MAY HELP FORM THE RATIONALE BEHIND FUTURE ACTIONS THAT MAY BE TAKEN BY THE NEW GLARUS SCHOOL DISTRICT BOARD.

UPON REQUEST TO THE DISTRICT OFFICE, SUBMITTED TWENTY-FOUR (24) HOURS IN ADVANCE, THE DISTRICT SHALL MAKE REASONABLE ACCOMMODATIONS INCLUDING THE PROVISION OF INFORMATIONAL MATERIAL IN AN ALTERNATIVE FORMAT FOR A DISABLED PERSON TO BE ABLE TO ATTEND THIS MEETING.