

TRENTON SPECIAL SCHOOL DISTRICT
Board of Education Regular Meeting
Central Office - 6:00 PM
June 30, 2020

1. **INVOCATION:**

2. **CALL TO ORDER:**

3. **APPROVE AGENDA:**

1. Approval of June 30th Agenda:

4. **APPROVE MINUTES:**

1. Approval of May 5th Minutes:

5. **CONSENT AGENDA:**

1. Approval of Central Office Financial Report:

1. April 2020:

2. May 2020:

2. Approval of Three Schools Financial Report:

1. April 2020:

2. May 2020:

3. Approval of General Purpose Budget Amendments:

4. Approval of CSH Budget Amendments:

5. Approval of Pre-K Budget Amendments:

6. Approval of Safe Schools Budget Amendments:

7. Approval of Title I Budget Amendments #2:

8. Approval of Title II Budget Amendments #2:

9. Approval of IDEA 901 Budget Amendment #2:

10. Approval of IDEA Pre-School 911 Budget Amendment #2:
11. Approval of CTE Amendment #1:
12. Approval of 21st Century Tutoring Budget Amendment #1:
13. Approval of School Nutrition Budget Amendment #1:
14. Approval of Bus Garage Budget Amendments:
15. Approval of Title VA Budget Amendments #2:
16. Approval of TRMS Special Education Kitchen Surplus:
17. Approval of TRMS Outstanding PO - Walsworth \$319.20:
18. Approval of TES Dehumidifier Surplus:

6. **REGULAR AGENDA:**

1. Approval of 2020-2021 Consolidated Funding Application:
2. Approval of Elementary and Secondary School Emergency Relief (ESSER) Budget:
3. Approval of IDEA Technology Partnership Budget:
4. Approval of TES 2020-2021 School Fees:
5. Approval of New General Purpose Budget Items:
6. Approval of 2020-2021 Differentiated Pay Plan:
7. Approval of Second Reading of Policy 1.8011 - Emergency Closings:
8. Approval of Second Reading of Policy 5.1151 - Telework During Emergencies:
9. Approval of Second Reading of Policy 5.3051 - FFCRA Leave:
10. Approval of First Reading of Policy 6.304 - Student Discrimination, Harassment, Bullying, Cyber-bullying, and Intimidation:
11. Approval of First Reading of Policy 6.3041 - Title IX and Sexual Harassment:
12. Approval of First Reading of Policy 6.305 - Student Concerns, Complaints, and Grievances:

13. Approval to Proceed with Indoor Athletic Practice Facility:

7. **DIRECTORS REPORT:**

1. Resignations - Kevin Doan, 8th Grade Social Studies:
2. New Hires - Tony Bufford, 8th Grade Social Studies; Malinda Ferrell, TRMS Special Education; and Hannah Milam, Third Grade:
3. TN State Fire Marshal's - Indoor Practice Facility:
4. TN Comptroller of the Treasury - Public Meetings:
5. 2020-2021 Regular School Board Meeting Schedule:
6. TSBA Fall District Meeting - Paris Special School District - September 29, 2020:
7. TSBA Leadership Conference and Annual Convention - Thurs, Nov 12th to Sun, Nov, 15th:

8. **ADJOURNMENT:**

TRENTON SPECIAL SCHOOL DISTRICT
Board of Education Regular Meeting
PHS Technology Lab - 6:00 PM
June 30, 2020

1. INVOCATION

2. CALL TO ORDER

3. APPROVE AGENDA

- 3.1. Approval of June 30th Agenda

4. APPROVE MINUTES

- 4.1. Approval of May 5th Minutes

5. CONSENT AGENDA

- 5.1. Approval of Central Office Financial Report
 - 5.1.1. April 2020
 - 5.1.2. May 2020
- 5.2. Approval of Three Schools Financial Report
 - 5.2.1. April 2020
 - 5.2.2. May 2020
- 5.3. Approval of General Purpose Budget Amendments
- 5.4. Approval of CSH Budget Amendments
- 5.5. Approval of Pre-K Budget Amendments
- 5.6. Approval of Safe Schools Budget Amendments
- 5.7. Approval of Title I Budget Amendments #2
- 5.8. Approval of Title II Budget Amendments #2
- 5.9. Approval of IDEA 901 Budget Amendment #2
- 5.10. Approval of IDEA Pre-School 911 Budget Amendment #2
- 5.11. Approval of CTE Amendment #1
- 5.12. Approval of 21st Century Tutoring Budget Amendment #1
- 5.13. Approval of School Nutrition Budget Amendment #1
- 5.14. Approval of Bus Garage Budget Amendments
- 5.15. Approval of Title VA Budget Amendments #2
- 5.16. Approval of TRMS Special Education Kitchen Surplus
- 5.17. Approval of TRMS Outstanding PO - Walsworth \$319.20
- 5.18. Approval of TES Dehumidifier Surplus

6. REGULAR AGENDA

- 6.1. Approval of 2020-2021 Consolidated Funding Application
- 6.2. Approval of Elementary and Secondary School Emergency Relief (ESSER) Budget
- 6.3. Approval of IDEA Technology Partnership Budget
- 6.4. Approval of TES 2020-2021 School Fees
- 6.5. Approval of New General Purpose Budget Items

- 6.6. Approval of 2020-2021 Differentiated Pay Plan
- 6.7. Approval of Second Reading of Policy 1.8011 - Emergency Closings
- 6.8. Approval of Second Reading of Policy 5.1151 - Telework During Emergencies
- 6.9. Approval of Second Reading of Policy 5.3051 - FFCRA Leave
- 6.10. Approval of First Reading of Policy 6.304 - Student Discrimination, Harassment, Bullying, Cyber-bullying, and Intimidation
- 6.11. Approval of First Reading of Policy 6.3041 - Title IX and Sexual Harassment
- 6.12. Approval of First Reading of Policy 6.305 - Student Concerns, Complaints, and Grievances
- 6.13. Approval to Proceed with Indoor Athletic Practice Facility

7. DIRECTORS REPORT

- 7.1. Resignations - Kevin Doan, 8th Grade Social Studies
- 7.2. New Hires - Tony Bufford, 8th Grade Social Studies; Malinda Ferrell, TRMS Special Education; and Hannah Milam, Third Grade
- 7.3. TN State Fire Marshal's - Indoor Practice Facility
- 7.4. TN Comptroller of the Treasury - Public Meetings
- 7.5. 2020-2021 Regular School Board Meeting Schedule
- 7.6. TSBA Fall District Meeting - Paris Special School District - September 29, 2020
- 7.7. TSBA Leadership Conference and Annual Convention - Thurs, Nov 12th to Sun, Nov, 15th

8. ADJOURNMENT

TRENTON SPECIAL SCHOOL DISTRICT
Board of Trustees' Regular Meeting
PHS Technology Lab - 6 p.m.
May 5, 2020

ROLL CALL: The Trenton Special School District Board of Trustees met in regular meeting on Tuesday, May 5, 2020, at 6 p.m., at PHS Technology Lab. In attendance were the following:

Mark Harper, Board Chairman
Clint Hickerson
Doug Smith

Tim Haney, Director of Schools
Dee Ann McEwen
Justin Weaver
Shannon Parra

CALL TO ORDER: Chairman Mark Harper called the meeting to order.

APPROVAL OF AGENDA: Chairman Harper presented the agenda for the May 5, 2020, Regular Meeting for approval. Clint Hickerson made a motion to approve the agenda with a second by Dee Ann McEwen. The motion carried unanimously.

APPROVAL OF MINUTES: Chairman Harper presented the minutes of the March 3rd Regular Meeting for approval. With no additions or corrections, Justin Weaver made a motion to approve with a second by Doug Smith. The motion carried unanimously.

RECOGNITIONS: Amy Allen shared about recent donations from Elite Dental (\$100), Leaders Credit Union (\$100), State Farm (\$100), and Tyson (\$200) for a Special Education Field Day. The Field Day was being planned for the Special Education students with the most significant disabilities prior to school shutdown. The funds will be put into a reserve account to hold the Field Day next school year.

Tammy Smith shared that Troy Sission with Alamo Painting, Sandblasting, and Repair donated his services of sandblasting and painting the Freed Field Sign that is now on display at TES.

REPORTS: Lisa Seiber-Garland reported that School Nutrition had received a \$5,000 grant from the No Kid Hungry Campaign. The funds will be used at TRMS to help increase student participation in the breakfast program.

Lisa Seiber-Garland reported that School Nutrition had received a grant from Meals to Go, Baylor University. This grant would allow students currently receiving free and reduced lunches the opportunity to receive weekly meals (seven breakfast and seven lunches each week). Parents have to enroll in the program. TSSD will provide information to eligible parents so that they can register.

CONSENT AGENDA: The following items appeared on the "Consent Agenda":

1. Approval of Central Office Financial Report
February 2020 Financials
March 2020 Financials

2. Approval of Three Schools Financial Report
February 2020 Financials
March 2020 Financials
3. Approval of General Purpose Budget Amendments
4. Approval to Surplus Bus 04-18
5. Approval of TRMS 8th Grade Science Lab Surplus

Justin Weaver made the motion to approve with a second by Dee Ann McEwen. The motion carried unanimously.

REGULAR AGENDA: The following items appeared on the “Regular Agenda”:

APPROVAL OF 2020-2021 ELA TEXTBOOK ADOPTION: Michele Elliott requested the English Language Arts Textbook Adoption List to be K-4 with Benchmark/Advance, 5-8 Learn Zillion/Guidebooks, and 9-12 Pearson/myPerspectives. Doug Smith made a motion to approve with a second by Dee Ann McEwen. The motion carried unanimously.

APPROVAL OF TENURE FOR TES TEACHERS: Cortnee Wilkes requested tenure for the following:

Marian Breeden, Second Grade - Clint Hickerson made a motion to approve with a second by Dee Ann McEwen. The motion carried unanimously.

Jamie Carr, First Grade - Justin Weaver made a motion to approve with a second by Dee Ann McEwen. The motion carried unanimously.

Ryan Crooks, Physical Education - Clint Hickerson made a motion to approve with a second by Doug Smith. The motion carried unanimously.

Holly Knott, Physical Education - Doug Smith made a motion to approve with a second by Justin Weaver. The motion carried unanimously.

APPROVAL OF TENURE FOR TRMS TEACHERS: Paul Pillow requested tenure for the following:

Amber Kennemore, 7th Grade Social Studies - Justin Weaver made a motion to approve with a second by Clint Hickerson. The motion carried unanimously.

Kim Laughlin, 6th Grade Math - Dee Ann McEwen made a motion to approve with a second by Doug Smith. The motion carried unanimously.

APPROVAL OF TENURE FOR PHS TEACHERS: Shane Jacobs requested tenure for the following:

Jill Bibb, 9th Grade English Clint Hickerson made a motion to approve with a second to by Dee Ann McEwen. The motion carried unanimously.

PHS GRADUATION UPDATE: Shane Jacobs shared that each student would receive six (6) color coded tickets and the family would sit together where they could see their graduate. There would be designated parking for students, faculty, board members, and guests. Paul Schulze will live stream the ceremony on the Peabody Facebook page. Frisbees had been purchased for the students to throw instead of their caps.

APPROVAL OF RESOLUTION 2020-05-05 COVID-19: Director Haney requested approval of Board Resolution 2020-05-05 COVID-19. The resolution is a waiver of policy for the 2019-2020 school year due to the COVID-19 pandemic causing school closure. No students grade

would be lower than it was on March 20, 2020. Seniors would be required to have 20 credits instead of 22 to graduate. The Civics exam, ACT/SAT, and EOC exams would be waived. There would be no TCAP testing. Educators would not receive LOE scores and no student data will negatively impact a teacher. Doug Smith made a motion to approve with a second by Dee Ann McEwen. The motion carried unanimously.

APPROVAL OF FIRST READING OF POLICY 1.8011 EMERGENCY CLOSINGS: Shane Jacobs requested approval of the first reading of policy 1.8011 Emergency Closings based on TSBA recommendations. Justin Weaver made a motion to approve with a second by Clint Hickerson. The motion carried unanimously.

APPROVAL OF FIRST READING OF POLICY 5.1151 TELEWORK DURING EMERGENCIES: Shane Jacobs requested approval of policy 5.1151 Telework During Emergencies. This policy came as a TSBA recommendation to be able to work from home during emergencies. Justin Weaver made a motion to approve with a second by Doug Smith. The motion carried unanimously.

APPROVAL OF FIRST READING OF POLICY 5.3051 FFCRA LEAVE: Shane Jacobs requested approval of policy 5.3051 FFCRA Leave. This policy came as a TSBA recommendation as a result of the COVID-19 pandemic. Clint Hickerson made a motion to approve with a second by Justin Weaver. The motion carried unanimously.

APPROVAL OF NEW GENERAL PURPOSE BUDGET AMENDMENTS: Tammy Smith requested approval to add \$600 to Contributions and Gifts and \$600 to Special Education Other Charges for the recent donations for the Special Education Field Day. Doug Smith made a motion to approve with a second by Clint Hickerson. The motion carried unanimously.

DIRECTORS REPORT: The following items were shared by Director Haney:

COVID-19 LEA Waiver Application was approved

Update on the Multipurpose Building - bids will be taken May 6th to June 11th with Bid Opening June 11th at PHS

Retirement - Joyce Brown, TES Teacher Assistant

Resignations - Hannah Bridges, TES Special Education Teacher Assistant and Elvie Patterson, 6th Grade ELA Teacher

Transfer - Paige Melville Hatchel First Grade to 6th Grade ELA

New Hires - Mike Adams, PHS Math Teacher and Ryan Matthews, ESL Teacher

TSBA Mandatory Training Requirement - Online Training Modules Available

TSBA Fall District Meeting - September 29th at Paris Special School District

TSBA Leadership Conference and Convention - Thursday, Nov 12th - Sunday, Nov 15th

ADJOURNMENT: With no further business Clint Hickerson made the motion to adjourn. Justin Weaver seconded the motion. The motion carried unanimously.

Chairman of the Board

Secretary to the Board

141 General Purpose School		Year-To-Date			Month-To-Date		
Account	Description	Budget Estimate	Actual	% of Budget	Estimate Avg/Mth	Actual	% of Avg
Revenues							
40210	Local Option Sales Tax	900,000.00	(778,434.50)	86.49 %	75,000.00	(65,235.18)	86.98 %
40350	Interstate Telecommunications Tax	5,000.00	(6,505.31)	130.11 %	416.67	(631.64)	151.59 %
40610	Current Property Tax	2,461,244.00	(2,371,712.06)	96.36 %	205,103.67	(96,335.34)	46.97 %
40620	Prior Year's Property Tax	100,000.00	(104,629.27)	104.63 %	8,333.33	(11,656.11)	139.87 %
40630	Interest And Penalty	10,000.00	(11,715.27)	117.15 %	833.33	(2,788.56)	334.63 %
40650	Payments In Lieu Of Taxes	2,500.00	(2,351.32)	94.05 %	208.33	(240.73)	115.55 %
41110	Marriage Licenses	300.00	(240.30)	80.10 %	25.00	(12.05)	48.20 %
43531	Transportation - Other State Systems	6,000.00	(635.40)	10.59 %	500.00	0.00	0.00 %
43570	Receipts From Individual Schools	30,000.00	(23,889.40)	79.63 %	2,500.00	(644.75)	25.79 %
43581	Community Service Fees - Children	2,000.00	0.00	0.00 %	166.67	0.00	0.00 %
43990	Other Charges For Services	22,000.00	(16,791.20)	76.32 %	1,833.33	(199.60)	10.89 %
44110	Investment Income	25,000.00	(47,240.53)	188.96 %	2,083.33	(2,218.06)	106.47 %
44120	Lease/Rentals	4,000.00	(14,925.00)	373.13 %	333.33	(800.00)	240.00 %
44170	Miscellaneous Refunds	0.00	(258.91)	0.00 %	0.00	0.00	0.00 %
44560	Damages Recovered From Individuals	0.00	(65.00)	0.00 %	0.00	0.00	0.00 %
44570	Contributions & Gifts	2,842.19	(3,442.19)	121.11 %	236.85	0.00	0.00 %
46511	Basic Education Program	8,130,000.00	(7,317,000.00)	90.00 %	677,500.00	(813,000.00)	120.00 %
46515	Early Childhood Education	407,958.00	(265,632.89)	65.11 %	33,996.50	0.00	0.00 %
46520	School Food Service	6,000.00	0.00	0.00 %	500.00	0.00	0.00 %
46590	Other State Education Funds	260,180.00	(215,686.19)	82.90 %	21,681.67	(9,682.94)	44.66 %
46610	Career Ladder Program	24,000.00	(11,488.24)	47.87 %	2,000.00	0.00	0.00 %
46850	Mixed Drink Tax	0.00	(183.46)	0.00 %	0.00	5.54	0.00 %
46980	Other State Grants	31,970.00	(27,217.24)	85.13 %	2,664.17	0.00	0.00 %
47715	Tax Credit Bond Rebate	220,174.00	(223,258.55)	101.40 %	18,347.83	(111,629.28)	608.41 %
49700	Insurance Recovery	109,415.74	(109,415.74)	100.00 %	9,117.98	0.00	0.00 %
49800	Transfers In	5,000.00	0.00	0.00 %	416.67	0.00	0.00 %
	Total Revenues	12,765,583.93	(11,552,717.97)	90.50 %	1,063,798.66	(1,115,068.70)	104.82 %
Expenditures							
71100	Regular Instruction Program	(5,258,397.19)	3,647,120.03	69.36 %	(438,199.77)	376,367.12	85.89 %
71150	Alternative Instruction Program	(255,279.00)	187,477.44	73.44 %	(21,273.25)	20,368.84	95.75 %
71200	Special Education Program	(433,311.00)	314,072.34	72.48 %	(36,109.25)	34,114.49	94.48 %
71300	Career and Technical Education	(262,511.00)	185,892.72	70.81 %	(21,875.92)	25,008.92	114.32 %
71400	Student Body Education Program	(39,435.00)	25,314.37	64.19 %	(3,286.25)	577.56	17.58 %
72110	Attendance	(136,447.00)	98,794.49	72.41 %	(11,370.58)	10,375.81	91.25 %
72120	Health Services	(165,909.00)	118,257.93	71.28 %	(13,825.75)	14,070.30	101.77 %
72130	Other Student Support	(430,479.89)	314,185.50	72.98 %	(35,873.32)	28,350.14	79.03 %
72210	Regular Instruction Program	(594,445.07)	421,515.37	70.91 %	(49,537.09)	40,448.99	81.65 %

141 General Purpose School		Year-To-Date			Month-To-Date		
Account	Description	Budget Estimate	Actual	% of Budget	Estimate Avg/Mth	Actual	% of Avg
72220	Special Education Program	(88,451.00)	83,767.40	94.70 %	(7,370.92)	5,735.31	77.81 %
72230	Career and Technical Education	(39,120.00)	31,950.32	81.67 %	(3,260.00)	3,510.17	107.67 %
72250	Instructional Technology	(307,132.00)	208,363.72	67.84 %	(25,594.33)	12,794.64	49.99 %
72310	Board Of Education	(180,001.00)	157,084.21	87.27 %	(15,000.08)	3,748.11	24.99 %
72320	Director Of Schools	(167,049.00)	132,180.35	79.13 %	(13,920.75)	12,620.11	90.66 %
72410	Office Of The Principal	(724,053.00)	567,784.24	78.42 %	(60,337.75)	57,416.13	95.16 %
72510	Fiscal Services	(72,655.00)	56,922.14	78.35 %	(6,054.58)	5,582.41	92.20 %
72520	Human Services/Personnel	(104,422.00)	85,419.33	81.80 %	(8,701.83)	7,973.32	91.63 %
72610	Operation Of Plant	(966,972.00)	762,012.74	78.80 %	(80,581.00)	76,591.24	95.05 %
72620	Maintenance Of Plant	(307,324.04)	238,631.96	77.65 %	(25,610.34)	19,439.36	75.90 %
72710	Transportation	(333,828.00)	243,300.40	72.88 %	(27,819.00)	15,719.84	56.51 %
72810	Central And Other	(42,500.00)	27,097.12	63.76 %	(3,541.67)	323.00	9.12 %
73300	Community Services	(3,180.00)	1,000.00	31.45 %	(265.00)	0.00	0.00 %
73400	Early Childhood Education	(407,958.00)	298,122.32	73.08 %	(33,996.50)	31,293.93	92.05 %
76100	Regular Capital Outlay	(1,571,227.74)	4,752,568.23	302.47 %	(130,935.65)	356,164.13	272.01 %
82130	Education	(507,038.00)	507,037.67	100.00 %	(42,253.17)	507,037.67	1,200.00 %
82230	Education	(988,469.00)	988,468.58	100.00 %	(82,372.42)	555,152.32	673.95 %
	Total Expenditures	(14,387,593.93)	14,454,340.92	100.46 %	(1,198,966.16)	2,220,783.86	185.22 %
Total	141 General Purpose School	(1,622,010.00)	2,901,622.95	178.89 %	(135,167.50)	1,105,715.16	818.03 %

142 School Federal Projects		Year-To-Date			Month-To-Date		
Account	Description	Budget Estimate	Actual	% of Budget	Estimate Avg/Mth	Actual	% of Avg
Revenues							
44110	Investment Income	0.00	(36.47)	0.00 %	0.00	(1.99)	0.00 %
46980	Other State Grants	240,975.00	(127,433.15)	52.88 %	20,081.25	(33,426.75)	166.46 %
47131	Vocational Educ - Basic Grants To	31,040.93	(19,178.36)	61.78 %	2,586.74	(620.00)	23.97 %
47141	Title 1 Grants To Local Educ Agencies	394,819.45	(269,433.11)	68.24 %	32,901.62	(56,902.16)	172.95 %
47143	Special Education - Grants To States	433,361.50	(283,597.65)	65.44 %	36,113.46	(55,607.88)	153.98 %
47145	Special Education Preschool Grants	19,534.92	(7,157.70)	36.64 %	1,627.91	(1,380.89)	84.83 %
47146	English Language Acquisition Grants	13,812.74	(6,221.38)	45.04 %	1,151.06	0.00	0.00 %
47148	Rural Education	26,675.98	(18,986.87)	71.18 %	2,223.00	(4,109.82)	184.88 %
47189	Eisenhower Prof Development State	43,900.93	(15,675.69)	35.71 %	3,658.41	(1,308.26)	35.76 %
47590	Other Federal Through State	9,697.72	(9,496.72)	97.93 %	808.14	0.00	0.00 %
	Total Revenues	1,213,819.17	(757,217.10)	62.38 %	101,151.60	(153,357.75)	151.61 %
Expenditures							
71100	Regular Instruction Program	(304,341.34)	219,590.01	72.15 %	(25,361.78)	22,302.38	87.94 %
71200	Special Education Program	(396,972.67)	258,720.28	65.17 %	(33,081.06)	24,650.02	74.51 %
71300	Career and Technical Education	(22,131.61)	15,622.69	70.59 %	(1,844.30)	0.00	0.00 %
72130	Other Student Support	(20,900.88)	8,735.99	41.80 %	(1,741.74)	1,804.32	103.59 %
72210	Regular Instruction Program	(160,802.92)	96,190.88	59.82 %	(13,400.24)	8,381.07	62.54 %
72220	Special Education Program	(55,922.75)	32,559.24	58.22 %	(4,660.23)	2,758.17	59.19 %
72230	Career and Technical Education	(1,252.00)	1,248.10	99.69 %	(104.33)	0.00	0.00 %
73300	Community Services	(240,975.00)	128,134.15	53.17 %	(20,081.25)	15,919.43	79.28 %
99100	Transfers Out	(10,520.00)	0.00	0.00 %	(876.67)	0.00	0.00 %
	Total Expenditures	(1,213,819.17)	760,801.34	62.68 %	(101,151.60)	75,815.39	74.95 %
Total	142 School Federal Projects	0.00	3,584.24	100.00 %	0.00	(77,542.36)	0.00 %

143 Central Cafeteria		Year-To-Date			Month-To-Date		
Account	Description	Budget Estimate	Actual	% of Budget	Estimate Avg/Mth	Actual	% of Avg
Revenues							
43521	Lunch Payments - Children	128,641.00	(80,280.82)	62.41 %	10,720.08	(159.04)	1.48 %
43522	Lunch Payments - Adults	30,000.00	(17,858.70)	59.53 %	2,500.00	(139.95)	5.60 %
43523	Income From Breakfast	748.00	(210.00)	28.07 %	62.33	(38.00)	60.96 %
44110	Investment Income	100.00	(317.44)	317.44 %	8.33	0.00	0.00 %
44570	Contributions & Gifts	0.00	(1,000.00)	0.00 %	0.00	0.00	0.00 %
46520	School Food Service	32,271.00	(11,088.31)	34.36 %	2,689.25	0.00	0.00 %
46980	Other State Grants	30,000.00	(16,000.00)	53.33 %	2,500.00	0.00	0.00 %
47111	USDA School Lunch Program	470,000.00	(321,013.82)	68.30 %	39,166.67	(47,935.46)	122.39 %
47112	Account No Longer In Use	73,766.00	0.00	0.00 %	6,147.17	0.00	0.00 %
47113	Breakfast	210,000.00	(194,452.41)	92.60 %	17,500.00	(30,182.53)	172.47 %
47114	USDA - Other	10,000.00	(51,873.87)	518.74 %	833.33	(11,612.26)	1,393.47 %
	Total Revenues	985,526.00	(694,095.37)	70.43 %	82,127.17	(90,067.24)	109.67 %
Expenditures							
73100	Food Service	(1,050,526.00)	871,066.61	82.92 %	(87,543.83)	37,286.64	42.59 %
	Total Expenditures	(1,050,526.00)	871,066.61	82.92 %	(87,543.83)	37,286.64	42.59 %
Total	143 Central Cafeteria	(65,000.00)	176,971.24	272.26 %	(5,416.67)	(52,780.60)	-974.41

144 School Transportation		Year-To-Date			Month-To-Date		
		Budget Estimate	Actual	% of Budget	Estimate Avg/Mth	Actual	% of Avg
Revenues							
43531	Transportation - Other State Systems	419,987.00	(308,447.22)	73.44 %	34,998.92	(23,300.10)	66.57 %
44990	Other Local Revenues	0.00	(165.00)	0.00 %	0.00	(15.00)	0.00 %
	Total Revenues	419,987.00	(308,612.22)	73.48 %	34,998.92	(23,315.10)	66.62 %
Expenditures							
72710	Transportation	(419,987.00)	328,442.22	78.20 %	(34,998.92)	23,300.10	66.57 %
	Total Expenditures	(419,987.00)	328,442.22	78.20 %	(34,998.92)	23,300.10	66.57 %
Total	144 School Transportation	0.00	19,830.00	100.00 %	0.00	(15.00)	0.00 %

141 General Purpose School		Year-To-Date			Month-To-Date		
Account	Description	Budget Estimate	Actual	% of Budget	Estimate Avg/Mth	Actual	% of Avg
Revenues							
40210	Local Option Sales Tax	900,000.00	(862,803.57)	95.87 %	75,000.00	(84,369.07)	112.49 %
40350	Interstate Telecommunications Tax	5,000.00	(7,127.51)	142.55 %	416.67	(622.20)	149.33 %
40610	Current Property Tax	2,461,244.00	(2,401,469.63)	97.57 %	205,103.67	(29,757.57)	14.51 %
40620	Prior Year's Property Tax	100,000.00	(104,629.27)	104.63 %	8,333.33	0.00	0.00 %
40630	Interest And Penalty	10,000.00	(12,594.35)	125.94 %	833.33	(879.08)	105.49 %
40650	Payments In Lieu Of Taxes	2,500.00	(2,592.05)	103.68 %	208.33	(240.73)	115.55 %
41110	Marriage Licenses	300.00	(256.50)	85.50 %	25.00	(16.20)	64.80 %
43531	Transportation - Other State Systems	6,000.00	(635.40)	10.59 %	500.00	0.00	0.00 %
43570	Receipts From Individual Schools	30,000.00	(25,995.36)	86.65 %	2,500.00	(2,105.96)	84.24 %
43581	Community Service Fees - Children	2,000.00	0.00	0.00 %	166.67	0.00	0.00 %
43990	Other Charges For Services	22,000.00	(16,791.20)	76.32 %	1,833.33	0.00	0.00 %
44110	Investment Income	25,000.00	(48,617.22)	194.47 %	2,083.33	(1,376.69)	66.08 %
44120	Lease/Rentals	4,000.00	(15,425.00)	385.63 %	333.33	(500.00)	150.00 %
44170	Miscellaneous Refunds	0.00	(258.91)	0.00 %	0.00	0.00	0.00 %
44560	Damages Recovered From Individuals	0.00	(65.00)	0.00 %	0.00	0.00	0.00 %
44570	Contributions & Gifts	3,442.19	(3,442.19)	100.00 %	286.85	0.00	0.00 %
46511	Basic Education Program	8,130,000.00	(7,317,000.00)	90.00 %	677,500.00	0.00	0.00 %
46515	Early Childhood Education	407,958.00	(296,471.17)	72.67 %	33,996.50	(30,838.28)	90.71 %
46520	School Food Service	6,000.00	0.00	0.00 %	500.00	0.00	0.00 %
46590	Other State Education Funds	260,180.00	(226,831.11)	87.18 %	21,681.67	(11,144.92)	51.40 %
46610	Career Ladder Program	24,000.00	(13,741.00)	57.25 %	2,000.00	(2,252.76)	112.64 %
46850	Mixed Drink Tax	0.00	(183.46)	0.00 %	0.00	0.00	0.00 %
46980	Other State Grants	31,970.00	(30,326.64)	94.86 %	2,664.17	(3,109.40)	116.71 %
47715	Tax Credit Bond Rebate	220,174.00	(223,258.55)	101.40 %	18,347.83	0.00	0.00 %
49700	Insurance Recovery	109,415.74	(109,415.74)	100.00 %	9,117.98	0.00	0.00 %
49800	Transfers In	5,000.00	0.00	0.00 %	416.67	0.00	0.00 %
	Total Revenues	12,766,183.93	(11,719,930.83)	91.80 %	1,063,848.66	(167,212.86)	15.72 %
Expenditures							
71100	Regular Instruction Program	(5,258,397.19)	4,052,961.42	77.08 %	(438,199.77)	405,841.39	92.62 %
71150	Alternative Instruction Program	(255,279.00)	207,981.30	81.47 %	(21,273.25)	20,503.86	96.38 %
71200	Special Education Program	(433,911.00)	350,190.40	80.71 %	(36,159.25)	36,118.06	99.89 %
71300	Career and Technical Education	(262,511.00)	205,504.15	78.28 %	(21,875.92)	19,611.43	89.65 %
71400	Student Body Education Program	(39,435.00)	25,487.47	64.63 %	(3,286.25)	173.10	5.27 %
72110	Attendance	(136,447.00)	109,414.18	80.19 %	(11,370.58)	10,619.69	93.40 %
72120	Health Services	(165,909.00)	137,048.28	82.60 %	(13,825.75)	18,790.35	135.91 %
72130	Other Student Support	(430,479.89)	339,163.56	78.79 %	(35,873.32)	24,978.06	69.63 %
72210	Regular Instruction Program	(594,445.07)	463,136.41	77.91 %	(49,537.09)	41,621.04	84.02 %

141 General Purpose School		Year-To-Date			Month-To-Date		
Account	Description	Budget Estimate	Actual	% of Budget	Estimate Avg/Mth	Actual	% of Avg
72220	Special Education Program	(88,451.00)	89,002.71	100.62 %	(7,370.92)	5,235.31	71.03 %
72230	Career and Technical Education	(39,120.00)	32,801.64	83.85 %	(3,260.00)	851.32	26.11 %
72250	Instructional Technology	(307,132.00)	239,702.21	78.05 %	(25,594.33)	31,338.49	122.44 %
72310	Board Of Education	(180,001.00)	160,121.36	88.96 %	(15,000.08)	3,037.15	20.25 %
72320	Director Of Schools	(167,049.00)	144,513.32	86.51 %	(13,920.75)	12,332.97	88.59 %
72410	Office Of The Principal	(724,053.00)	623,660.49	86.13 %	(60,337.75)	55,876.25	92.61 %
72510	Fiscal Services	(72,655.00)	62,708.20	86.31 %	(6,054.58)	5,786.06	95.56 %
72520	Human Services/Personnel	(104,422.00)	93,355.66	89.40 %	(8,701.83)	7,936.33	91.20 %
72610	Operation Of Plant	(966,972.00)	788,854.49	81.58 %	(80,581.00)	26,841.75	33.31 %
72620	Maintenance Of Plant	(307,324.04)	257,507.35	83.79 %	(25,610.34)	18,875.39	73.70 %
72710	Transportation	(333,828.00)	257,893.22	77.25 %	(27,819.00)	14,592.82	52.46 %
72810	Central And Other	(42,500.00)	27,134.83	63.85 %	(3,541.67)	37.71	1.06 %
73300	Community Services	(3,180.00)	1,000.00	31.45 %	(265.00)	0.00	0.00 %
73400	Early Childhood Education	(407,958.00)	344,610.78	84.47 %	(33,996.50)	46,488.46	136.74 %
76100	Regular Capital Outlay	(1,571,227.74)	4,647,703.10	295.80 %	(130,935.65)	(104,865.13)	-80.09 %
82130	Education	(507,038.00)	507,037.67	100.00 %	(42,253.17)	0.00	0.00 %
82230	Education	(988,469.00)	988,468.58	100.00 %	(82,372.42)	0.00	0.00 %
	Total Expenditures	(14,388,193.93)	15,156,962.78	105.34 %	(1,199,016.16)	702,621.86	58.60 %
Total	141 General Purpose School	(1,622,010.00)	3,437,031.95	211.90 %	(135,167.50)	535,409.00	396.11 %

142 School Federal Projects		Year-To-Date			Month-To-Date		
Account	Description	Budget Estimate	Actual	% of Budget	Estimate Avg/Mth	Actual	% of Avg
Revenues							
44110	Investment Income	0.00	(39.73)	0.00 %	0.00	(3.26)	0.00 %
46980	Other State Grants	240,975.00	(128,100.40)	53.16 %	20,081.25	(667.25)	3.32 %
47131	Vocational Educ - Basic Grants To	31,040.93	(19,178.36)	61.78 %	2,586.74	0.00	0.00 %
47141	Title 1 Grants To Local Educ Agencies	394,819.45	(269,433.11)	68.24 %	32,901.62	0.00	0.00 %
47143	Special Education - Grants To States	433,361.50	(283,597.65)	65.44 %	36,113.46	0.00	0.00 %
47145	Special Education Preschool Grants	19,534.92	(7,157.70)	36.64 %	1,627.91	0.00	0.00 %
47146	English Language Acquisition Grants	13,812.74	(6,221.38)	45.04 %	1,151.06	0.00	0.00 %
47148	Rural Education	26,675.98	(18,986.87)	71.18 %	2,223.00	0.00	0.00 %
47189	Eisenhower Prof Development State	43,900.93	(15,675.69)	35.71 %	3,658.41	0.00	0.00 %
47590	Other Federal Through State	9,697.72	(9,496.72)	97.93 %	808.14	0.00	0.00 %
	Total Revenues	1,213,819.17	(757,887.61)	62.44 %	101,151.60	(670.51)	0.66 %
Expenditures							
71100	Regular Instruction Program	(304,341.34)	241,725.47	79.43 %	(25,361.78)	22,135.46	87.28 %
71200	Special Education Program	(396,972.67)	283,497.73	71.41 %	(33,081.06)	24,777.45	74.90 %
71300	Career and Technical Education	(22,131.61)	20,539.24	92.80 %	(1,844.30)	4,916.55	266.58 %
72130	Other Student Support	(20,900.88)	8,735.99	41.80 %	(1,741.74)	0.00	0.00 %
72210	Regular Instruction Program	(160,802.92)	104,571.97	65.03 %	(13,400.24)	8,381.09	62.54 %
72220	Special Education Program	(55,922.75)	35,201.36	62.95 %	(4,660.23)	2,642.12	56.70 %
72230	Career and Technical Education	(1,252.00)	1,248.10	99.69 %	(104.33)	0.00	0.00 %
73300	Community Services	(240,975.00)	128,134.15	53.17 %	(20,081.25)	0.00	0.00 %
99100	Transfers Out	(10,520.00)	0.00	0.00 %	(876.67)	0.00	0.00 %
	Total Expenditures	(1,213,819.17)	823,654.01	67.86 %	(101,151.60)	62,852.67	62.14 %
Total	142 School Federal Projects	0.00	65,766.40	100.00 %	0.00	62,182.16	0.00 %

143 Central Cafeteria		Year-To-Date			Month-To-Date		
Account	Description	Budget Estimate	Actual	% of Budget	Estimate Avg/Mth	Actual	% of Avg
Revenues							
43521	Lunch Payments - Children	128,641.00	(81,278.56)	63.18 %	10,720.08	(997.74)	9.31 %
43522	Lunch Payments - Adults	30,000.00	(17,858.70)	59.53 %	2,500.00	0.00	0.00 %
43523	Income From Breakfast	748.00	(210.00)	28.07 %	62.33	0.00	0.00 %
44110	Investment Income	100.00	(342.84)	342.84 %	8.33	(25.40)	304.80 %
44570	Contributions & Gifts	0.00	(1,200.00)	0.00 %	0.00	(200.00)	0.00 %
46520	School Food Service	32,271.00	(11,088.31)	34.36 %	2,689.25	0.00	0.00 %
46980	Other State Grants	30,000.00	(16,000.00)	53.33 %	2,500.00	0.00	0.00 %
47111	USDA School Lunch Program	470,000.00	(363,827.34)	77.41 %	39,166.67	(42,813.52)	109.31 %
47112	Account No Longer In Use	73,766.00	0.00	0.00 %	6,147.17	0.00	0.00 %
47113	Breakfast	210,000.00	(221,259.36)	105.36 %	17,500.00	(26,806.95)	153.18 %
47114	USDA - Other	10,000.00	(56,235.47)	562.35 %	833.33	(4,361.60)	523.39 %
	Total Revenues	985,526.00	(769,300.58)	78.06 %	82,127.17	(75,205.21)	91.57 %
Expenditures							
73100	Food Service	(1,050,526.00)	990,016.34	94.24 %	(87,543.83)	118,949.73	135.87 %
	Total Expenditures	(1,050,526.00)	990,016.34	94.24 %	(87,543.83)	118,949.73	135.87 %
Total	143 Central Cafeteria	(65,000.00)	220,715.76	339.56 %	(5,416.67)	43,744.52	807.59 %

144 School Transportation		Year-To-Date			Month-To-Date		
Account	Description	Budget Estimate	Actual	% of Budget	Estimate Avg/Mth	Actual	% of Avg
Revenues							
43531	Transportation - Other State Systems	419,987.00	(327,012.53)	77.86 %	34,998.92	(18,565.31)	53.05 %
44990	Other Local Revenues	0.00	(559.00)	0.00 %	0.00	(394.00)	0.00 %
	Total Revenues	419,987.00	(327,571.53)	78.00 %	34,998.92	(18,959.31)	54.17 %
Expenditures							
72710	Transportation	(419,987.00)	347,007.57	82.62 %	(34,998.92)	18,565.35	53.05 %
	Total Expenditures	(419,987.00)	347,007.57	82.62 %	(34,998.92)	18,565.35	53.05 %
Total	144 School Transportation	0.00	19,436.04	100.00 %	0.00	(393.96)	0.00 %

Peabody High School

Run Date: 5/7/2020 1:34:00PM

Balance Sheet Report
Through 04/30/2020

Report Name: aaBalanceSheet.rpt

		General	Restricted	Food Service	Total
Assets					
11	Cash on hand	0.00	0.00	0.00	0.00
12	Cash in banks - checking	33,298.39	177,731.47	0.00	211,029.86
Total Assets		\$33,298.39	\$177,731.47	\$0.00	\$211,029.86
Liabilities					
91	General fund balance	-30,778.31	0.00	0.00	-30,778.31
Total Liabilities		-\$30,778.31	\$0.00	\$0.00	-\$30,778.31
Revenues					
304.2	School Pictures	-582.30	0.00	0.00	-582.30
304.3	Pepsi Machine	-3,640.00	0.00	0.00	-3,640.00
304.4	Tom's Machines	-2,121.52	0.00	0.00	-2,121.52
307	Donations	-564.90	0.00	0.00	-564.90
310	Locker fees	-55.00	0.00	0.00	-55.00
321	Board Allocations	-5,376.09	0.00	0.00	-5,376.09
330	Misc Income	-698.68	0.00	0.00	-698.68
333	Safety & Security	-1,005.00	0.00	0.00	-1,005.00
353	Materials and Supplies	-25.96	0.00	0.00	-25.96
Total Revenues		-\$14,069.45	\$0.00	\$0.00	-\$14,069.45
Expenditures					
411	Admin Supplies & Materials	1,292.43	0.00	0.00	1,292.43
420	Other Admin Expenditures	2,809.56	0.00	0.00	2,809.56
421	Instructional Supplies & Materials	49.90	0.00	0.00	49.90
426	Copy Machine	6,007.64	0.00	0.00	6,007.64
433	Safety & Security	274.64	0.00	0.00	274.64
452	Postage	1,115.20	0.00	0.00	1,115.20
Total Expenditures		\$11,549.37	\$0.00	\$0.00	\$11,549.37
Restricted Accounts					
601	All Athletics	0.00	-24,467.43	0.00	-24,467.43
701	Class of 2020	0.00	-18,890.65	0.00	-18,890.65
702	Class of 2021	0.00	0.00	0.00	0.00
801	Beta Club	0.00	-1,899.62	0.00	-1,899.62
802	FFA Club	0.00	-14,744.49	0.00	-14,744.49
807	FCCLA	0.00	-640.36	0.00	-640.36
811	Math Club	0.00	-9.65	0.00	-9.65
813	History Club	0.00	-1.60	0.00	-1.60
814	Pep Club	0.00	-570.87	0.00	-570.87
821	Junior Rotary	0.00	-744.27	0.00	-744.27
822	HOSA	0.00	-716.41	0.00	-716.41
824	Future Teachers of America	0.00	-702.76	0.00	-702.76
825	Girls & Boys State	0.00	-40,248.74	0.00	-40,248.74
827	Peabody Pais	0.00	-635.18	0.00	-635.18
828	STEM Club	0.00	-4,294.51	0.00	-4,294.51
829	21 Plus Club	0.00	-783.30	0.00	-783.30
831	School of Rock	0.00	-53.38	0.00	-53.38
832	AP - Advance Placement	0.00	-1,166.00	0.00	-1,166.00
833	SAT Exam	0.00	0.00	0.00	0.00
901	Library	0.00	-221.74	0.00	-221.74

Peabody High School

Run Date: 5/7/2020 1:34:00PM

Balance Sheet Report
Through 04/30/2020

Report Name: aaBalanceSheet.rpt

		General	Restricted	Food Service	Total
902	Cheerleaders	0.00	-317.48	0.00	-317.48
903	School Annuals	0.00	-14,041.21	0.00	-14,041.21
904	Band	0.00	-9,683.30	0.00	-9,683.30
906	Student Council	0.00	-1,552.21	0.00	-1,552.21
907	Art	0.00	-503.47	0.00	-503.47
908	Special Olympics	0.00	-344.68	0.00	-344.68
911	St. Jude	0.00	0.00	0.00	0.00
915	Project Inspire	0.00	-596.75	0.00	-596.75
916	Chromebook	0.00	-1,569.00	0.00	-1,569.00
931	Operating Account Donations	0.00	-3,585.40	0.00	-3,585.40
932	Football Donations	0.00	-8,568.80	0.00	-8,568.80
933	Girls Basketball Donations	0.00	-3,475.20	0.00	-3,475.20
934	Boys Basketball Donations	0.00	-3,844.50	0.00	-3,844.50
935	Baseball Donations	0.00	-6,950.81	0.00	-6,950.81
936	Golf Donations	0.00	-170.75	0.00	-170.75
937	Girls Soccer Donations	0.00	-1.77	0.00	-1.77
938	Boys Soccer Donations	0.00	-766.63	0.00	-766.63
939	Softball Donations	0.00	-3,257.67	0.00	-3,257.67
940	Tennis Donations	0.00	-649.25	0.00	-649.25
941	Volleyball Donations	0.00	-1,680.51	0.00	-1,680.51
942	Track & Field	0.00	-1,087.77	0.00	-1,087.77
950	Quarterback Club	0.00	-4,293.35	0.00	-4,293.35
Total Restricted Accounts		\$0.00	\$-177,731.47	\$0.00	\$-177,731.47
Grand Totals :		\$0.00	\$0.00	\$0.00	\$0.00

Trenton Elementary School

Run Date: 5/7/2020 1:15:43PM

Balance Sheet Report
Through 04/30/2020

Report Name: aaBalanceSheet.rpt

		General	Restricted	Food Service	Total
Assets					
11	Cash on hand	0.00	0.00	0.00	0.00
12	Cash in banks - checking	39,985.97	23,175.06	0.00	63,161.03
Total Assets		\$39,985.97	\$23,175.06	\$0.00	\$63,161.03
Liabilities					
91	General fund balance	-42,129.72	0.00	0.00	-42,129.72
Total Liabilities		\$-42,129.72	\$0.00	\$0.00	\$-42,129.72
Revenues					
304	Pictures	-1,947.50	0.00	0.00	-1,947.50
306	Fundraising	-4,889.35	0.00	0.00	-4,889.35
308	Planners	-100.00	0.00	0.00	-100.00
309	Copy Machines	1,106.27	0.00	0.00	1,106.27
310	Miscellaneous	-50.00	0.00	0.00	-50.00
311	Folders	-46.00	0.00	0.00	-46.00
313	Instructional Supplies	-1,099.90	0.00	0.00	-1,099.90
320	Interest	-246.36	0.00	0.00	-246.36
321	Board Allocations	-4,867.26	0.00	0.00	-4,867.26
323	Book Orders	-175.00	0.00	0.00	-175.00
Total Revenues		\$-12,315.10	\$0.00	\$0.00	\$-12,315.10
Expenditures					
408	Planners	537.79	0.00	0.00	537.79
411	Folders	1,441.00	0.00	0.00	1,441.00
412	Office Supplies	1,185.74	0.00	0.00	1,185.74
414	Equipment and Supplies	101.80	0.00	0.00	101.80
418	General Supplies	80.02	0.00	0.00	80.02
421	Instructional Supplies	4,423.81	0.00	0.00	4,423.81
423	Book Orders	27.00	0.00	0.00	27.00
424	Student of the Month	44.23	0.00	0.00	44.23
429	Copy Machines	6,370.28	0.00	0.00	6,370.28
499	Miscellaneous	247.18	0.00	0.00	247.18
Total Expenditures		\$14,458.85	\$0.00	\$0.00	\$14,458.85
Restricted Accounts					
804	Library	0.00	-3,501.82	0.00	-3,501.82
805	Accelerated Reader - AR	0.00	-17.78	0.00	-17.78
808	Second Grade	0.00	-15.77	0.00	-15.77
809	Third Grade	0.00	-7.00	0.00	-7.00
811	Fine Arts	0.00	-26.39	0.00	-26.39
814	Computer Lab	0.00	-2,102.54	0.00	-2,102.54
815	PATT	0.00	-1,005.45	0.00	-1,005.45
816	Physical Education	0.00	-1,232.73	0.00	-1,232.73
817	Guidance	0.00	-18.36	0.00	-18.36
818	K - 4 Families	0.00	-14.10	0.00	-14.10
819	Yearbook	0.00	-4,280.25	0.00	-4,280.25
820	Kindergarten Field Trips	0.00	-4.99	0.00	-4.99
821	First Grade Field Trips	0.00	-381.86	0.00	-381.86
822	Second Grade Field Trips	0.00	0.00	0.00	0.00
823	Third Grade Field Trips	0.00	-327.16	0.00	-327.16
824	Fourth Grade Field Trips	0.00	-100.19	0.00	-100.19
825	Destination Imagination (DI)	0.00	-404.03	0.00	-404.03
826	Student of the Month	0.00	-78.40	0.00	-78.40

Trenton Elementary School

Run Date: 5/7/2020 1:15:43PM

Balance Sheet Report
Through 04/30/2020

Report Name: aaBalanceSheet.rpt

		General	Restricted	Food Service	Total
827	Basketball	0.00	-2,662.38	0.00	-2,662.38
828	Read to Be Ready	0.00	-61.50	0.00	-61.50
829	Do Right	0.00	-6,514.21	0.00	-6,514.21
830	PreK SPED	0.00	-418.15	0.00	-418.15
	Total Restricted Accounts	\$0.00	\$-23,175.06	\$0.00	\$-23,175.06
	Grand Totals :	\$0.00	\$0.00	\$0.00	\$0.00

Trenton Rosenwald Middle School

Run Date: 5/7/2020 1:25:59PM

Balance Sheet Report
Through 04/30/2020

Report Name: aaBalanceSheet.rpt

		General	Restricted	Food Service	Total
Assets					
11	Cash on hand	0.00	0.00	0.00	0.00
12	Cash in banks - checking	8,091.33	44,934.20	0.00	53,025.53
21	CD#403819 - Security Bank	0.00	9,920.55	0.00	9,920.55
31	Accounts receivable	1,251.73	0.00	0.00	1,251.73
	Total Assets	\$9,343.06	\$54,854.75	\$0.00	\$64,197.81
Liabilities					
91	General fund balance	-1,344.01	0.00	0.00	-1,344.01
	Total Liabilities	\$-1,344.01	\$0.00	\$0.00	\$-1,344.01
Revenues					
300	House	-690.00	0.00	0.00	-690.00
307	Start Up Money	-11,500.00	0.00	0.00	-11,500.00
308	Vending Machines	-444.90	0.00	0.00	-444.90
318	Student Snacks	-8,231.30	0.00	0.00	-8,231.30
319	School-Wide Fundraisers	-12,337.00	0.00	0.00	-12,337.00
320	Interest	-188.37	0.00	0.00	-188.37
321	Miscellaneous	-137.00	0.00	0.00	-137.00
323	Student Incentive	-216.00	0.00	0.00	-216.00
325	Board Allocations	-16,280.65	0.00	0.00	-16,280.65
326	Pictures	-1,548.94	0.00	0.00	-1,548.94
	Total Revenues	\$-51,574.16	\$0.00	\$0.00	\$-51,574.16
Expenditures					
411	Start Up Money	11,300.00	0.00	0.00	11,300.00
412	Office Supplies	2,870.31	0.00	0.00	2,870.31
413	PBIS -ROAR STORE	3,174.17	0.00	0.00	3,174.17
414	Equipment & Repairs	5,868.13	0.00	0.00	5,868.13
415	School Wide Fundraiser Expenses	8,017.80	0.00	0.00	8,017.80
416	Concessions	0.00	0.00	0.00	0.00
419	Instructional Supplies	3,302.55	0.00	0.00	3,302.55
497	Literacy/Black History	143.87	0.00	0.00	143.87
498	Student Snacks	6,627.37	0.00	0.00	6,627.37
499	House	760.00	0.00	0.00	760.00
500	Miscellaneous	238.14	0.00	0.00	238.14
556	Student Incentive	1,272.77	0.00	0.00	1,272.77
	Total Expenditures	\$43,575.11	\$0.00	\$0.00	\$43,575.11
Restricted Accounts					
505	Team Leader 5	0.00	-81.41	0.00	-81.41
506	Team Leader 6	0.00	-254.76	0.00	-254.76
507	Team Leader 7	0.00	-410.53	0.00	-410.53
508	Team Leader 8	0.00	-36.01	0.00	-36.01
510	Student Council	0.00	-1,136.50	0.00	-1,136.50
511	Athletic Concessions	0.00	-1.12	0.00	-1.12
512	Book Damage Fees	0.00	-920.96	0.00	-920.96
514	Chromebook fees	0.00	-661.50	0.00	-661.50
555	FCA	0.00	-46.00	0.00	-46.00
557	Art	0.00	-153.28	0.00	-153.28
558	Scholastic Reading Club	0.00	-8.25	0.00	-8.25
559	Parent Volunteer Organization	0.00	-501.35	0.00	-501.35

Trenton Rosenwald Middle School

Run Date: 5/7/2020 1:25:59PM

Report Name: aaBalanceSheet.rpt

Balance Sheet Report
Through 04/30/2020

		General	Restricted	Food Service	Total
601	All Athletics	0.00	0.00	0.00	0.00
602	Cheerleader	0.00	-1,896.18	0.00	-1,896.18
610	Library	0.00	-823.21	0.00	-823.21
611	Accelerated Reader	0.00	-983.05	0.00	-983.05
613	All Athletics Interest	0.00	-76.27	0.00	-76.27
614	Baseball	0.00	-1,439.09	0.00	-1,439.09
615	Basketball	0.00	-712.47	0.00	-712.47
616	Football	0.00	-27,181.04	0.00	-27,181.04
617	Soccer	0.00	-657.04	0.00	-657.04
618	Softball	0.00	-3,612.04	0.00	-3,612.04
619	Volleyball	0.00	-4,855.70	0.00	-4,855.70
801	Beta Club	0.00	-2,797.13	0.00	-2,797.13
904	Band	0.00	-5,075.77	0.00	-5,075.77
906	Annual	0.00	-534.09	0.00	-534.09
	Total Restricted Accounts	\$0.00	\$-54,854.75	\$0.00	\$-54,854.75
	Grand Totals :	\$0.00	\$0.00	\$0.00	\$0.00

Peabody High SchoolBalance Sheet Report
Through 05/31/2020

		General	Restricted	Food Service	Total
Assets					
11	Cash on hand	0.00	0.00	0.00	0.00
12	Cash in banks - checking	33,997.50	165,068.44	0.00	199,065.94
Total Assets		\$33,997.50	\$165,068.44	\$0.00	\$199,065.94
Liabilities					
91	General fund balance	-30,778.31	0.00	0.00	-30,778.31
Total Liabilities		\$-30,778.31	\$0.00	\$0.00	\$-30,778.31
Revenues					
304.2	School Pictures	-582.30	0.00	0.00	-582.30
304.3	Pepsi Machine	-3,640.00	0.00	0.00	-3,640.00
304.4	Tom's Machines	-3,791.93	0.00	0.00	-3,791.93
307	Donations	-564.90	0.00	0.00	-564.90
310	Locker fees	-55.00	0.00	0.00	-55.00
321	Board Allocations	-5,376.09	0.00	0.00	-5,376.09
330	Misc Income	-698.68	0.00	0.00	-698.68
333	Safety & Security	-1,005.00	0.00	0.00	-1,005.00
353	Materials and Supplies	-25.96	0.00	0.00	-25.96
Total Revenues		\$-15,739.86	\$0.00	\$0.00	\$-15,739.86
Expenditures					
411	Admin Supplies & Materials	1,316.18	0.00	0.00	1,316.18
420	Other Admin Expenditures	3,164.55	0.00	0.00	3,164.55
421	Instructional Supplies & Materials	49.90	0.00	0.00	49.90
426	Copy Machine	6,600.20	0.00	0.00	6,600.20
433	Safety & Security	274.64	0.00	0.00	274.64
452	Postage	1,115.20	0.00	0.00	1,115.20
Total Expenditures		\$12,520.67	\$0.00	\$0.00	\$12,520.67
Restricted Accounts					
601	All Athletics	0.00	-21,411.85	0.00	-21,411.85
701	Class of 2020	0.00	-8,435.56	0.00	-8,435.56
702	Class of 2021	0.00	0.00	0.00	0.00
801	Beta Club	0.00	-2,169.62	0.00	-2,169.62
802	FFA Club	0.00	-19,077.15	0.00	-19,077.15
807	FCCLA	0.00	-640.36	0.00	-640.36
811	Math Club	0.00	-9.65	0.00	-9.65
813	History Club	0.00	-1.60	0.00	-1.60
814	Pep Club	0.00	-527.99	0.00	-527.99
821	Junior Rotary	0.00	-744.27	0.00	-744.27
822	HOSA	0.00	-716.41	0.00	-716.41
824	Future Teachers of America	0.00	-702.76	0.00	-702.76
825	Girls & Boys State	0.00	-40,248.74	0.00	-40,248.74
827	Peabody Pals	0.00	-635.18	0.00	-635.18
828	STEM Club	0.00	-3,962.46	0.00	-3,962.46
829	21 Plus Club	0.00	-783.30	0.00	-783.30
831	School of Rock	0.00	-53.38	0.00	-53.38
832	AP - Advance Placement	0.00	-1,226.00	0.00	-1,226.00
833	SAT Exam	0.00	0.00	0.00	0.00
901	Library	0.00	-224.08	0.00	-224.08

Peabody High School

Balance Sheet Report
Through 05/31/2020

		General	Restricted	Food Service	Total
902	Cheerleaders	0.00	-44.48	0.00	-44.48
903	School Annuals	0.00	-14,758.80	0.00	-14,758.80
904	Band	0.00	-8,957.69	0.00	-8,957.69
906	Student Council	0.00	-1,755.99	0.00	-1,755.99
907	Art	0.00	-503.47	0.00	-503.47
908	Special Olympics	0.00	-344.68	0.00	-344.68
911	St. Jude	0.00	0.00	0.00	0.00
915	Project Inspire	0.00	-596.75	0.00	-596.75
916	Chromebook	0.00	-43.00	0.00	-43.00
931	Operating Account	0.00	-3,585.40	0.00	-3,585.40
	Donations				
932	Football Donations	0.00	-6,949.68	0.00	-6,949.68
933	Girls Basketball	0.00	-3,475.20	0.00	-3,475.20
	Donations				
934	Boys Basketball	0.00	-3,844.50	0.00	-3,844.50
	Donations				
935	Baseball Donations	0.00	-6,522.74	0.00	-6,522.74
936	Golf Donations	0.00	-170.75	0.00	-170.75
937	Girls Soccer Donations	0.00	-1.77	0.00	-1.77
938	Boys Soccer Donations	0.00	-766.63	0.00	-766.63
939	Softball Donations	0.00	-3,465.67	0.00	-3,465.67
940	Tennis Donations	0.00	-649.25	0.00	-649.25
941	Volleyball Donations	0.00	-1,680.51	0.00	-1,680.51
942	Track & Field	0.00	-1,087.77	0.00	-1,087.77
950	Quarterback Club	0.00	-4,293.35	0.00	-4,293.35
	Total Restricted Accounts	\$0.00	\$-165,068.44	\$0.00	\$-165,068.44
	Grand Totals :	\$0.00	\$0.00	\$0.00	\$0.00

Trenton Elementary School

Balance Sheet Report
Through 05/31/2020

		General	Restricted	Food Service	Total
Assets					
11	Cash on hand	0.00	0.00	0.00	0.00
12	Cash in banks - checking	39,358.06	18,763.76	0.00	58,121.82
Total Assets		\$39,358.06	\$18,763.76	\$0.00	\$58,121.82
Liabilities					
91	General fund balance	-42,129.72	0.00	0.00	-42,129.72
Total Liabilities		\$-42,129.72	\$0.00	\$0.00	\$-42,129.72
Revenues					
304	Pictures	-1,947.50	0.00	0.00	-1,947.50
306	Fundraising	-4,889.35	0.00	0.00	-4,889.35
308	Planners	-100.00	0.00	0.00	-100.00
309	Copy Machines	1,106.27	0.00	0.00	1,106.27
310	Miscellaneous	-50.00	0.00	0.00	-50.00
311	Folders	-46.00	0.00	0.00	-46.00
313	Instructional Supplies	-1,099.90	0.00	0.00	-1,099.90
320	Interest	-257.80	0.00	0.00	-257.80
321	Board Allocations	-4,867.26	0.00	0.00	-4,867.26
323	Book Orders	-175.00	0.00	0.00	-175.00
Total Revenues		\$-12,326.54	\$0.00	\$0.00	\$-12,326.54
Expenditures					
408	Planners	537.79	0.00	0.00	537.79
411	Folders	1,441.00	0.00	0.00	1,441.00
412	Office Supplies	1,185.74	0.00	0.00	1,185.74
414	Equipment and Supplies	-47.64	0.00	0.00	-47.64
418	General Supplies	80.02	0.00	0.00	80.02
421	Instructional Supplies	4,453.81	0.00	0.00	4,453.81
423	Book Orders	27.00	0.00	0.00	27.00
424	Student of the Month	44.23	0.00	0.00	44.23
429	Copy Machines	7,127.07	0.00	0.00	7,127.07
499	Miscellaneous	249.18	0.00	0.00	249.18
Total Expenditures		\$15,098.20	\$0.00	\$0.00	\$15,098.20
Restricted Accounts					
804	Library	0.00	-3,363.19	0.00	-3,363.19
805	Accelerated Reader - AR	0.00	-17.78	0.00	-17.78
808	Second Grade	0.00	-15.77	0.00	-15.77
809	Third Grade	0.00	-7.00	0.00	-7.00
811	Fine Arts	0.00	-26.39	0.00	-26.39
814	Computer Lab	0.00	-2,102.54	0.00	-2,102.54
815	PATT	0.00	-280.66	0.00	-280.66
816	Physical Education	0.00	-1,232.73	0.00	-1,232.73
817	Guidance	0.00	-18.36	0.00	-18.36
818	K - 4 Families	0.00	-14.10	0.00	-14.10
819	Yearbook	0.00	-1,116.00	0.00	-1,116.00
820	Kindergarten Field Trips	0.00	-24.99	0.00	-24.99
821	First Grade Field Trips	0.00	-381.86	0.00	-381.86
822	Second Grade Field Trips	0.00	0.00	0.00	0.00
823	Third Grade Field Trips	0.00	-327.16	0.00	-327.16
824	Fourth Grade Field Trips	0.00	-100.19	0.00	-100.19
825	Destination Imagination (DI)	0.00	-404.03	0.00	-404.03
826	Student of the Month	0.00	-78.40	0.00	-78.40

Trenton Elementary School

Balance Sheet Report
Through 05/31/2020

		General	Restricted	Food Service	Total
827	Basketball	0.00	-2,662.38	0.00	-2,662.38
828	Read to Be Ready	0.00	-61.50	0.00	-61.50
829	Do Right	0.00	-6,110.58	0.00	-6,110.58
830	PreK SPED	0.00	-418.15	0.00	-418.15
	Total Restricted Accounts	\$0.00	\$-18,763.76	\$0.00	\$-18,763.76
	Grand Totals :	\$0.00	\$0.00	\$0.00	\$0.00

Trenton Rosenwald Middle School

Run Date: 6/3/2020 3:30:04PM

Report Name: aaBalanceSheet.rpt

Balance Sheet Report
Through 05/31/2020

		General	Restricted	Food Service	Total
Assets					
11	Cash on hand	0.00	0.00	0.00	0.00
12	Cash in banks - checking	8,912.79	44,055.69	0.00	52,968.48
21	CD#403819 - Security Bank	0.00	9,950.56	0.00	9,950.56
31	Accounts receivable	1,251.73	0.00	0.00	1,251.73
	Total Assets	\$10,164.52	\$54,006.25	\$0.00	\$64,170.77
Liabilities					
91	General fund balance	-1,344.01	0.00	0.00	-1,344.01
	Total Liabilities	\$-1,344.01	\$0.00	\$0.00	\$-1,344.01
Revenues					
300	House	-690.00	0.00	0.00	-690.00
307	Start Up Money	-11,500.00	0.00	0.00	-11,500.00
308	Vending Machines	-489.39	0.00	0.00	-489.39
318	Student Snacks	-8,231.30	0.00	0.00	-8,231.30
319	School-Wide Fundraisers	-12,337.00	0.00	0.00	-12,337.00
320	Interest	-198.55	0.00	0.00	-198.55
321	Miscellaneous	-137.00	0.00	0.00	-137.00
323	Student Incentive	-216.00	0.00	0.00	-216.00
325	Board Allocations	-17,496.80	0.00	0.00	-17,496.80
326	Pictures	-1,548.94	0.00	0.00	-1,548.94
	Total Revenues	\$-52,844.98	\$0.00	\$0.00	\$-52,844.98
Expenditures					
411	Start Up Money	11,500.00	0.00	0.00	11,500.00
412	Office Supplies	3,013.53	0.00	0.00	3,013.53
413	PBIS -ROAR STORE	3,174.17	0.00	0.00	3,174.17
414	Equipment & Repairs	5,868.13	0.00	0.00	5,868.13
415	School Wide Fundraiser Expenses	8,017.80	0.00	0.00	8,017.80
416	Concessions	0.00	0.00	0.00	0.00
419	Instructional Supplies	3,406.69	0.00	0.00	3,406.69
497	Literacy/Black History	143.87	0.00	0.00	143.87
498	Student Snacks	6,627.37	0.00	0.00	6,627.37
499	House	760.00	0.00	0.00	760.00
500	Miscellaneous	240.14	0.00	0.00	240.14
556	Student Incentive	1,272.77	0.00	0.00	1,272.77
	Total Expenditures	\$44,024.47	\$0.00	\$0.00	\$44,024.47
Restricted Accounts					
505	Team Leader 5	0.00	-81.41	0.00	-81.41
506	Team Leader 6	0.00	-254.76	0.00	-254.76
507	Team Leader 7	0.00	-410.53	0.00	-410.53
508	Team Leader 8	0.00	-36.01	0.00	-36.01
510	Student Council	0.00	-1,136.50	0.00	-1,136.50
511	Athletic Concessions	0.00	-1.12	0.00	-1.12
512	Book Damage Fees	0.00	-908.96	0.00	-908.96
514	Chromebook fees	0.00	0.00	0.00	0.00
555	FCA	0.00	-46.00	0.00	-46.00
557	Art	0.00	-153.28	0.00	-153.28
558	Scholastic Reading Club	0.00	-8.25	0.00	-8.25
559	Parent Volunteer Organization	0.00	-168.96	0.00	-168.96

Trenton Rosenwald Middle School

Run Date: 6/3/2020 3:30:04PM

Report Name: aaBalanceSheet.rpt

Balance Sheet Report
Through 05/31/2020

		General	Restricted	Food Service	Total
601	All Athletics	0.00	0.00	0.00	0.00
602	Cheerleader	0.00	-1,896.18	0.00	-1,896.18
610	Library	0.00	-823.21	0.00	-823.21
611	Accelerated Reader	0.00	-983.05	0.00	-983.05
613	All Athletics Interest	0.00	-106.28	0.00	-106.28
614	Baseball	0.00	-625.50	0.00	-625.50
615	Basketball	0.00	-904.47	0.00	-904.47
616	Football	0.00	-27,138.05	0.00	-27,138.05
617	Soccer	0.00	-1,065.04	0.00	-1,065.04
618	Softball	0.00	-3,612.04	0.00	-3,612.04
619	Volleyball	0.00	-4,855.70	0.00	-4,855.70
801	Beta Club	0.00	-2,798.13	0.00	-2,798.13
904	Band	0.00	-5,075.77	0.00	-5,075.77
906	Annual	0.00	-917.05	0.00	-917.05
	Total Restricted Accounts	\$0.00	\$-54,006.25	\$0.00	\$-54,006.25
	Grand Totals :	\$0.00	\$0.00	\$0.00	\$0.00

June 30,2020
New Budget Items

Vocational Educational Program

Battelle Education STEM Grant

Revenue

		Debit	Credit
46590-910	Other State Education Funds	<u>\$10,000.00</u>	
		\$10,000.00	

Expenditures

71300-429-910	Instructional Materials & Supplies		<u>\$10,000.00</u>
			\$10,000.00

Debt Service - Bonds

Money for Indoor Practice Facility - LGIP Building Fund

Revenue

141-49100	Bond Issued	<u>\$1,300,563.21</u>	
		\$1,300,563.21	

Expenditures

141-82330-606	Other Debt Issuance Charges		\$13,158.57
141-76100-706	Building Construction		<u>\$1,287,404.64</u>
			\$1,300,563.21

Bonds Refinanced

Revenue

141-49100	Bonds Issued	<u>\$19,677,100.60</u>	
		\$19,677,100.60	

Expenditures

141-82330-606	Other Debt Issuance Charges		\$229,841.43
141-82130-601	Principal on Bonds		<u>\$19,447,259.17</u>
			\$19,677,100.60

Budget Amendments GP

June 30, 2020

71100 Regular Instruction		Increase	Decrease
		Credit	Debit
Funds needed for Unemployment, Bound Textbooks, Other Charges, Regular Instruction Eq, Other Eq			
71100-210	Unemployment	4000	
71100-449	Bound Textbooks	40000	
71100-599	Other Charges	3000	
71100-722	Regular Instruction Eq.	4000	
71100-790-(005,010,015)	Other Equipment	18000	
71100-116	Teachers		69000
		<u>69000</u>	<u>69000</u>

71150 Alternative Instruction		Increase	Decrease
		Credit	Debit
Funds needed for Teachers, Other Fringe Benefits			
71150-116	Teachers	200	
71150-299	Other Fringe Benefits	40	
71150-201	Social Security		240
		<u>240</u>	<u>240</u>

71200 Special Education		Increase	Decrease
		Credit	Debit
Funds needed for Retirement-Hybrid Stabilization and Other Charges			
71200-217-010	Retirement-Hybrid Stabilization	1300	
71200-599	Other Charges	13100	
71200-116	Teachers		1423
71200-163	Educational Assistants		2092
71200-201	Social Security		1970
71200-204	Sate Retirement		2886
71200-207	Medical Insurance		5507
71200-212	Employer Medicare		400
71200-299	Other Fringe Benefits		122
		<u>14400</u>	<u>14400</u>

Budget Amendments GP
June 30, 2020

71300 Career and Technical Education		Increase	Decrease
		Credit	Debit
Funds needed for Teachers, Certified Subs, NonCertified Subs			
71300-116	Teachers		26
71300-195	Certified Subs		325
71300-198	Non-Certified Subs		340
71300-207	Medical Insurance		691
		<u>691</u>	<u>691</u>

71400 Student Body Education Program		Increase	Decrease
		Credit	Debit
Funds needed for Other Salaries, Social Security, State Retirement, Employer Medicare			
71400-189	Other Salaries & Wages	4300	
71400-201	Social Security	100	
71400-204	State Retirement	400	
71400-212	Employer Medicare	50	
71100 Regular Instruction Program			
71100-116	Teachers		4850
		<u>4850</u>	<u>4850</u>

72110 Attendance		Increase	Decrease
		Credit	Debit
Funds needed for Other Fringe Benefits			
72110-299	Other Fringe Benefits	36	
72110-355	Travel		36
		<u>36</u>	<u>36</u>

Budget Amendments GP

June 30, 2020

72120 Health Services		Increase	Decrease
		Credit	Debit
Funds needed for Retirement-Hybrid Stabilization, Drugs and Medical Supplies, Health Eq			
72120-217	Retirement-Hybrid Stabilization	700	
72120-413	Drugs and Medical Supplies	1300	
72120-735	Health Eq	1350	
72120-204	State Retirement		1350
72120-207	Medical Insurance		1300
72120-524	In Service/Staff Dev		700
		<u>3350</u>	<u>3350</u>

72130 Other Student Support		Increase	Decrease
		Credit	Credit
Funds needed for Guidance Personnel, Social Workers, Other Salaries, Other Fringes, Other Supplies			
72130-123	Guidance Personnel	2	
72130-130-805	Social Workers	1	
72130-189	Other Salaries & Wages	50	
72130-299	Other Finges Benefits	36	
72130-499-805	Other Supplies	70	
72130-309	Contracts with Government Agencies		159
		<u>159</u>	<u>159</u>

72210 Regular Instruction Program		Increase	Decrease
		Credit	Debit
Funds needed for Career Ladder Program, Instructional Computer Personnel, Other Finge Benefits			
72210-117	Career Ladder Program	1000	
72210-138	Instructional Computer Personnel	50	
72210-299	Other Finge Benefits	72	
72210-524	In Service		1122
		<u>1122</u>	<u>1122</u>

Budget Amendments GP
June 30, 2020

72220 Special Education Program		Increase Credit	Decrease Debit
Funds needed for Medical Insurance, Other Contracted Services			
72220-207	Medical Insurance	1600	
72220-399	Other Contracted Services	1800	
71100 Regular Instruction Program			
71100-116	Teachers		3400
		<u>3400</u>	<u>3400</u>
72250 Instructional Technology			
Funds needed for Other Charges		Increase Credit	Decrease Debit
72250-599	Other Charges	7100	
72250-790	Other Equipment		7100
		<u>7100</u>	<u>7100</u>
72310 Board of Education			
Funds needed for Travel, Liability Insurance, Trustee Commission, Other Charges		Increase Credit	Decrease Debit
72310-355	Travel	900	
72310-506	Liability Insurance	725	
72310-510	Trustee Commission	4000	
72310-599	Other Charges	400	
72310-320	Dues and Memberships		4000
72310-534	Refund from Criminal Investigation		2025
		<u>6025</u>	<u>6025</u>

Budget Amendments GP
June 30, 2020

72320 Director of Schools		Increase Credit	Decrease Debit
Funds needed for Career Ladder, Other Fringes, Administrative Eq			
72320-127	Career Ladder Extended Contracts	1000	
72320-299	Other Fringe Benefits	24	
72320-701	Adminstration Eq	1802	
72320-117	Career Ladder Extended Contracts		1000
72320-355	Travel		1826
		<u>2826</u>	<u>2826</u>

72410 Office of The Principal		Increase Credit	Decrease Debit
Funds needed for Accountants/Bookkeepers and Other Fringes			
72410-119	Accountants/Bookkeepers	1	
72410-299	Other Fringes	60	
72410-201	Social Security		61
		<u>61</u>	<u>61</u>

72510 Fiscal Services		Increase Credit	Decrease Debit
Funds needed for Supervisor/Director, Clerical Personnel, Other Fringes, Advertising			
72510-105	Accountants/Bookkeepers	1	
72510-162	Clerical Personnel	1	
72510-299	Other Fringes	17	
72510-302	Advertising	800	
72510-435	Office Supplies		819
		<u>819</u>	<u>819</u>

Budget Amendments GP
June 30, 2020

72520 Human Services/Personnel		Increase Credit	Decrease Debit
Funds needed for Other Fringes			
72520-299	Other Fringes		24
72520-320	Dues and Memberships		24
		<u>24</u>	<u>24</u>

72620 Maintenance of Plant		Increase Credit	Decrease Debit
Funds needed for Maintenance and Repair Eq, Water and Sewer			
72620-336	Maintenance and Repair Eq	4000	
72620-335	Maintenance and Repair Buildings		4000
		<u>4000</u>	<u>4000</u>

72710 Transportation		Increase Credit	Decrease Debit
Funds needed for Supervisor/Director, Mechanic(s), Vehicle and Eq Ins			
72710-105	Supervisor/Director	250	
72710-142	Mechanic(s)	1	
72710-511	Vehicle and Equipment Insurance	3000	
72710-189	Other Salaries & Wages		2880
72710-524	In Service		371
		<u>3251</u>	<u>3251</u>

73400 Early Childhood Education	Increase	Decrease
---------------------------------	----------	----------

Budget Amendments GP
June 30, 2020

	Credit	Debit
Funds needed for Instructional Supplies		
73400-429 Other Charges		1
71100 Regular Instruction Program		
71100-116 Teachers		<u>1</u>
	<u>1</u>	<u>1</u>
Total Amendments	121355	121355

Budget Amendments PreK

Early Childhood Education - PreK	Increase Credit	Decrease Debit
----------------------------------	--------------------	-------------------

Additional funds needed for Subs, State Retirement, Medical Insurance, and Other Contracted Services		
141-73400-198	Non-Certified Substitute Teachers	670
141-73400-204	State Retirement	388
141-73400-207	Medical Insurance	2,623
141-73400-399	Other Contracted Services	6,497
141-73400-105	Supervisor/Director	584
141-73400-116	Teachers	4800
141-73400-162	Clerical	253
141-73400-163	Educational Assistants	2072
141-73400-189	Other Salaries & Wages	74
141-73400-201	Social Security	928
141-73400-212	Employer Medicare	202
141-73400-355	Travel	1265
Total PreK Budget Amendments		10,178

Additional funds needed for Supervisor/Director and Other Contracted Services		
141-73400-105	Supervisor/Director	1
141-73400-399	Other Contracted Services	800
141-73400-201	Social Security	200
141-73400-204	State Retirement	601
Total PreK Budget Amendments		801

Budget Amendments Safe Schools

Safe Schools

Additional Funds needed for Contracts with Government Agencies

		Increase Credit	Decrease Debit
141-72130-309-055	Other Student Support - Contracts with Government Agencies	15000	
141-72130-790-055	Other Student Support - Other Equipment		15000
	Total Safe Schools Amendments	15000	15000

Budget Amendments CSH

CSH
 Additional Funds needed for Communication, Postage, and Other Supplies and Materials

		Increase Credit	Decrease Debit
141-72120-307-300	Communication	65	
141-72120-348-300	Postage	115	
141-72120-499-300	Other Supplies & Materials	2174	
141-72120-189-300	Other Salaries & Wages		6
141-72120-201-300	Social Security		340
141-72120-207-300	Medical Insurance		14
141-72120-212-300	Employer Medicare		80
141-72120-355-300	Travel		1293
141-72120-399-300	Other Contracted Services		621
	Total CSH Amendments	2354	2354

Bus Garage Budget Amendments

Bus Garage

Additional Funds needed for Supervisor/Director

		Increase Credit	Decrease Debit
144-72710-105	Supervisor/Director	61	
141-72120-201	Social Security		61
	Total Bus Garage Amendments	61	61

June 30,2020
New Budget Items

Vocational Educational Program

Battelle Education STEM Grant

Revenue

		Debit	Credit
46590-910	Other State Education Funds	<u>\$10,000.00</u>	
		\$10,000.00	

Expenditures

71300-429-910	Instructional Materials & Supplies		<u>\$10,000.00</u>
			\$10,000.00

Debt Service - Bonds

Money for Indoor Practice Facility - LGIP Building Fund

Revenue

141-49100	Bond Issued	<u>\$1,300,563.21</u>	
		\$1,300,563.21	

Expenditures

141-82330-606	Other Debt Issuance Charges		\$13,158.57
141-76100-706	Building Construction		<u>\$1,287,404.64</u>
			\$1,300,563.21

Bonds Refinanced

Revenue

141-49100	Bonds Issued	<u>\$19,677,100.60</u>	
		\$19,677,100.60	

Expenditures

141-82330-606	Other Debt Issuance Charges		\$229,841.43
141-82130-601	Principal on Bonds		<u>\$19,447,259.17</u>
			\$19,677,100.60

Budget Amendments GP

June 30, 2020

71100 Regular Instruction		Increase	Decrease
		Credit	Debit
Funds needed for Unemployment, Bound Textbooks, Other Charges, Regular Instruction Eq, Other Eq			
71100-210	Unemployment	4000	
71100-449	Bound Textbooks	40000	
71100-599	Other Charges	3000	
71100-722	Regular Instruction Eq.	4000	
71100-790-(005,010,015)	Other Equipment	18000	
71100-116	Teachers		69000
		<u>69000</u>	<u>69000</u>

71150 Alternative Instruction		Increase	Decrease
		Credit	Debit
Funds needed for Teachers, Other Fringe Benefits			
71150-116	Teachers	200	
71150-299	Other Fringe Benefits	40	
71150-201	Social Security		240
		<u>240</u>	<u>240</u>

71200 Special Education		Increase	Decrease
		Credit	Debit
Funds needed for Retirement-Hybrid Stabilization and Other Charges			
71200-217-010	Retirement-Hybrid Stabilization	1300	
71200-599	Other Charges	13100	
71200-116	Teachers		1423
71200-163	Educational Assistants		2092
71200-201	Social Security		1970
71200-204	Sate Retirement		2886
71200-207	Medical Insurance		5507
71200-212	Employer Medicare		400
71200-299	Other Fringe Benefits		122
		<u>14400</u>	<u>14400</u>

Budget Amendments GP
June 30, 2020

71300 Career and Technical Education		Increase	Decrease
		Credit	Debit
Funds needed for Teachers, Certified Subs, NonCertified Subs			
71300-116	Teachers	26	
71300-195	Certified Subs	325	
71300-198	Non-Certified Subs	340	
71300-207	Medical Insurance		691
		691	691

71400 Student Body Education Program		Increase	Decrease
		Credit	Debit
Funds needed for Other Salaries, Social Security, State Retirement, Employer Medicare			
71400-189	Other Salaries & Wages	4300	
71400-201	Social Security	100	
71400-204	State Retirement	400	
71400-212	Employer Medicare	50	
71100 Regular Instruction Program			
71100-116	Teachers		4850
		4850	4850

72110 Attendance		Increase	Decrease
		Credit	Debit
Funds needed for Other Fringe Benefits			
72110-299	Other Fringe Benefits	36	
72110-355	Travel		36
		36	36

Budget Amendments GP

June 30, 2020

72120 Health Services		Increase	Decrease
		Credit	Debit
Funds needed for Retirement-Hybrid Stabilization, Drugs and Medical Supplies, Health Eq			
72120-217	Retirement-Hybrid Stabilization	700	
72120-413	Drugs and Medical Supplies	1300	
72120-735	Health Eq	1350	
72120-204	State Retirement		1350
72120-207	Medical Insurance		1300
72120-524	In Service/Staff Dev		700
		<u>3350</u>	<u>3350</u>

72130 Other Student Support		Increase	Decrease
		Credit	Credit
Funds needed for Guidance Personnel, Social Workers, Other Salaries, Other Fringes, Other Supplies			
72130-123	Guidance Personnel	2	
72130-130-805	Social Workers	1	
72130-189	Other Salaries & Wages	50	
72130-299	Other Finges Benefits	36	
72130-499-805	Other Supplies	70	
72130-309	Contracts with Government Agencies		159
		<u>159</u>	<u>159</u>

72210 Regular Instruction Program		Increase	Decrease
		Credit	Debit
Funds needed for Career Ladder Program, Instructional Computer Personnel, Other Finge Benefits			
72210-117	Career Ladder Program	1000	
72210-138	Instructional Computer Personnel	50	
72210-299	Other Finge Benefits	72	
72210-524	In Service		1122
		<u>1122</u>	<u>1122</u>

Budget Amendments GP
June 30, 2020

		Increase Credit	Decrease Debit
72220 Special Education Program			
Funds needed for Medical Insurance, Other Contracted Services			
72220-207	Medical Insurance	1600	
72220-399	Other Contracted Services	1800	
71100 Regular Instruction Program			
71100-116	Teachers		3400
		<u>3400</u>	<u>3400</u>
72250 Instructional Technology			
Funds needed for Other Charges			
72250-599	Other Charges	7100	
72250-790	Other Equipment		7100
		<u>7100</u>	<u>7100</u>
72310 Board of Education			
Funds needed for Travel, Liability Insurance, Trustee Commission, Other Charges			
72310-355	Travel	900	
72310-506	Liability Insurance	725	
72310-510	Trustee Commission	4000	
72310-599	Other Charges	400	
72310-320	Dues and Memberships		4000
72310-534	Refund from Criminal Investigation		2025
		<u>6025</u>	<u>6025</u>

Budget Amendments GP
June 30, 2020

72320 Director of Schools		Increase Credit	Decrease Debit
Funds needed for Career Ladder, Other Fringes, Administrative Eq			
72320-127	Career Ladder Extended Contracts	1000	
72320-299	Other Fringe Benefits	24	
72320-701	Adminstration Eq	1802	
72320-117	Career Ladder Extended Contracts		1000
72320-355	Travel		1826
		<u>2826</u>	<u>2826</u>

72410 Office of The Principal		Increase Credit	Decrease Debit
Funds needed for Accountants/Bookkeepers and Other Fringes			
72410-119	Accountants/Bookkeepers	1	
72410-299	Other Fringes	60	
72410-201	Social Security		61
		<u>61</u>	<u>61</u>

72510 Fiscal Services		Increase Credit	Decrease Debit
Funds needed for Supervisor/Director, Clerical Personnel, Other Fringes, Advertising			
72510-105	Accountants/Bookkeepers	1	
72510-162	Clerical Personnel	1	
72510-299	Other Fringes	17	
72510-302	Advertising	800	
72510-435	Office Supplies		819
		<u>819</u>	<u>819</u>

Budget Amendments GP
June 30, 2020

72520 Human Services/Personnel		Increase	Decrease
		Credit	Debit
Funds needed for Other Fringes			
72520-299	Other Fringes		24
72520-320	Dues and Memberships		24
		<hr/>	<hr/>
		24	24

72620 Maintenance of Plant		Increase	Decrease
		Credit	Debit
Funds needed for Maintenance and Repair Eqt, Water and Sewer			
72620-336	Maintenance and Repair Eqt	4000	
72620-335	Maintenance and Repair Buildings		4000
		<hr/>	<hr/>
		4000	4000

72710 Transportation		Increase	Decrease
		Credit	Debit
Funds needed for Supervisor/Director, Mechanic(s), Vehicle and Eqt Ins			
72710-105	Supervisor/Director	250	
72710-142	Mechanic(s)	1	
72710-511	Vehicle and Equipment Insurance	3000	
72710-189	Other Salaries & Wages		2880
72710-524	In Service		371
		<hr/>	<hr/>
		3251	3251

73400 Early Childhood Education	Increase	Decrease
---------------------------------	----------	----------

Budget Amendments GP
June 30, 2020

	Credit	Debit
Funds needed for Instructional Supplies		
73400-429 Other Charges		1
71100 Regular Instruction Program		
71100-116 Teachers		<u>1</u>
	<u>1</u>	<u>1</u>
Total Amendments	121355	121355

Budget Amendments PreK

Early Childhood Education - PreK	Increase Credit	Decrease Debit
----------------------------------	--------------------	-------------------

Additional funds needed for Subs, State Retirement, Medical Insurance, and Other Contracted Services		
141-73400-198	Non-Certified Substitute Teachers	670
141-73400-204	State Retirement	388
141-73400-207	Medical Insurance	2,623
141-73400-399	Other Contracted Services	6,497
141-73400-105	Supervisor/Director	584
141-73400-116	Teachers	4800
141-73400-162	Clerical	253
141-73400-163	Educational Assistants	2072
141-73400-189	Other Salaries & Wages	74
141-73400-201	Social Security	928
141-73400-212	Employer Medicare	202
141-73400-355	Travel	1265
Total PreK Budget Amendments		10,178

Additional funds needed for Supervisor/Director and Other Contracted Services		
141-73400-105	Supervisor/Director	1
141-73400-399	Other Contracted Services	800
141-73400-201	Social Security	200
141-73400-204	State Retirement	601
Total PreK Budget Amendments		801

Budget Amendments Safe Schools

Safe Schools

Additional Funds needed for Contracts with Government Agencies

		Increase Credit	Decrease Debit
141-72130-309-055	Other Student Support - Contracts with Government Agencies	15000	
141-72130-790-055	Other Student Support - Other Equipment		15000
	Total Safe Schools Amendments	15000	15000

Budget Amendments CSH

CSH
 Additional Funds needed for Communication, Postage, and Other Supplies and Materials

	Increase Credit	Decrease Debit
141-72120-307-300 Communication	65	
141-72120-348-300 Postage	115	
141-72120-499-300 Other Supplies & Materials	2174	
141-72120-189-300 Other Salaries & Wages		6
141-72120-201-300 Social Security		340
141-72120-207-300 Medical Insurance		14
141-72120-212-300 Employer Medicare		80
141-72120-355-300 Travel		1293
141-72120-399-300 Other Contracted Services		621
Total CSH Amendments	2354	2354

Bus Garage Budget Amendments

Bus Garage

Additional Funds needed for Supervisor/Director

		Increase Credit	Decrease Debit
144-72710-105	Supervisor/Director	61	
141-72120-201	Social Security		61
	Total Bus Garage Amendments	61	61

June 30,2020
New Budget Items

Vocational Educational Program

Battelle Education STEM Grant

Revenue

		Debit	Credit
46590-910	Other State Education Funds	<u>\$10,000.00</u>	
		\$10,000.00	

Expenditures

71300-429-910	Instructional Materials & Supplies		<u>\$10,000.00</u>
			\$10,000.00

Debt Service - Bonds

Money for Indoor Practice Facility - LGIP Building Fund

Revenue

141-49100	Bond Issued	<u>\$1,300,563.21</u>	
		\$1,300,563.21	

Expenditures

141-82330-606	Other Debt Issuance Charges		\$13,158.57
141-76100-706	Building Construction		<u>\$1,287,404.64</u>
			\$1,300,563.21

Bonds Refinanced

Revenue

141-49100	Bonds Issued	<u>\$19,677,100.60</u>	
		\$19,677,100.60	

Expenditures

141-82330-606	Other Debt Issuance Charges		\$229,841.43
141-82130-601	Principal on Bonds		<u>\$19,447,259.17</u>
			\$19,677,100.60

Budget Amendments GP

June 30, 2020

71100 Regular Instruction		Increase	Decrease
		Credit	Debit
Funds needed for Unemployment, Bound Textbooks, Other Charges, Regular Instruction Eq, Other Eq			
71100-210	Unemployment	4000	
71100-449	Bound Textbooks	40000	
71100-599	Other Charges	3000	
71100-722	Regular Instruction Eq.	4000	
71100-790-(005,010,015)	Other Equipment	18000	
71100-116	Teachers		69000
		<u>69000</u>	<u>69000</u>

71150 Alternative Instruction		Increase	Decrease
		Credit	Debit
Funds needed for Teachers, Other Fringe Benefits			
71150-116	Teachers	200	
71150-299	Other Fringe Benefits	40	
71150-201	Social Security		240
		<u>240</u>	<u>240</u>

71200 Special Education		Increase	Decrease
		Credit	Debit
Funds needed for Retirement-Hybrid Stabilization and Other Charges			
71200-217-010	Retirement-Hybrid Stabilization	1300	
71200-599	Other Charges	13100	
71200-116	Teachers		1423
71200-163	Educational Assistants		2092
71200-201	Social Security		1970
71200-204	Sate Retirement		2886
71200-207	Medical Insurance		5507
71200-212	Employer Medicare		400
71200-299	Other Fringe Benefits		122
		<u>14400</u>	<u>14400</u>

Budget Amendments GP
June 30, 2020

71300 Career and Technical Education		Increase	Decrease
		Credit	Debit
Funds needed for Teachers, Certified Subs, NonCertified Subs			
71300-116	Teachers		26
71300-195	Certified Subs		325
71300-198	Non-Certified Subs		340
71300-207	Medical Insurance		691
		<u>691</u>	<u>691</u>

71400 Student Body Education Program		Increase	Decrease
		Credit	Debit
Funds needed for Other Salaries, Social Security, State Retirement, Employer Medicare			
71400-189	Other Salaries & Wages	4300	
71400-201	Social Security	100	
71400-204	State Retirement	400	
71400-212	Employer Medicare	50	
71100 Regular Instruction Program			
71100-116	Teachers		4850
		<u>4850</u>	<u>4850</u>

72110 Attendance		Increase	Decrease
		Credit	Debit
Funds needed for Other Fringe Benefits			
72110-299	Other Fringe Benefits	36	
72110-355	Travel		36
		<u>36</u>	<u>36</u>

Budget Amendments GP

June 30, 2020

72120 Health Services		Increase	Decrease
		Credit	Debit
Funds needed for Retirement-Hybrid Stabilization, Drugs and Medical Supplies, Health Eq			
72120-217	Retirement-Hybrid Stabilization	700	
72120-413	Drugs and Medical Supplies	1300	
72120-735	Health Eq	1350	
72120-204	State Retirement		1350
72120-207	Medical Insurance		1300
72120-524	In Service/Staff Dev		700
		<u>3350</u>	<u>3350</u>

72130 Other Student Support		Increase	Decrease
		Credit	Credit
Funds needed for Guidance Personnel, Social Workers, Other Salaries, Other Fringes, Other Supplies			
72130-123	Guidance Personnel	2	
72130-130-805	Social Workers	1	
72130-189	Other Salaries & Wages	50	
72130-299	Other Finges Benefits	36	
72130-499-805	Other Supplies	70	
72130-309	Contracts with Government Agencies		159
		<u>159</u>	<u>159</u>

72210 Regular Instruction Program		Increase	Decrease
		Credit	Debit
Funds needed for Career Ladder Program, Instructional Computer Personnel, Other Finge Benefits			
72210-117	Career Ladder Program	1000	
72210-138	Instructional Computer Personnel	50	
72210-299	Other Finge Benefits	72	
72210-524	In Service		1122
		<u>1122</u>	<u>1122</u>

Budget Amendments GP
June 30, 2020

		Increase	Decrease
		Credit	Debit
72220 Special Education Program			
Funds needed for Medical Insurance, Other Contracted Services			
72220-207	Medical Insurance	1600	
72220-399	Other Contracted Services	1800	
71100 Regular Instruction Program			
71100-116	Teachers		3400
		<u>3400</u>	<u>3400</u>
72250 Instructional Technology			
Funds needed for Other Charges			
72250-599	Other Charges	7100	
72250-790	Other Equipment		7100
		<u>7100</u>	<u>7100</u>
72310 Board of Education			
Funds needed for Travel, Liability Insurance, Trustee Commission, Other Charges			
72310-355	Travel	900	
72310-506	Liability Insurance	725	
72310-510	Trustee Commission	4000	
72310-599	Other Charges	400	
72310-320	Dues and Memberships		4000
72310-534	Refund from Criminal Investigation		2025
		<u>6025</u>	<u>6025</u>

Budget Amendments GP
June 30, 2020

72320 Director of Schools		Increase Credit	Decrease Debit
Funds needed for Career Ladder, Other Fringes, Administrative Eq			
72320-127	Career Ladder Extended Contracts	1000	
72320-299	Other Fringe Benefits	24	
72320-701	Adminstration Eq	1802	
72320-117	Career Ladder Extended Contracts		1000
72320-355	Travel		1826
		<u>2826</u>	<u>2826</u>

72410 Office of The Principal		Increase Credit	Decrease Debit
Funds needed for Accountants/Bookkeepers and Other Fringes			
72410-119	Accountants/Bookkeepers	1	
72410-299	Other Fringes	60	
72410-201	Social Security		61
		<u>61</u>	<u>61</u>

72510 Fiscal Services		Increase Credit	Decrease Debit
Funds needed for Supervisor/Director, Clerical Personnel, Other Fringes, Advertising			
72510-105	Accountants/Bookkeepers	1	
72510-162	Clerical Personnel	1	
72510-299	Other Fringes	17	
72510-302	Advertising	800	
72510-435	Office Supplies		819
		<u>819</u>	<u>819</u>

Budget Amendments GP
June 30, 2020

72520 Human Services/Personnel		Increase	Decrease
		Credit	Debit
Funds needed for Other Fringes			
72520-299	Other Fringes	24	
72520-320	Dues and Memberships		24
		<hr/>	<hr/>
		24	24

72620 Maintenance of Plant		Increase	Decrease
		Credit	Debit
Funds needed for Maintenance and Repair Eqt, Water and Sewer			
72620-336	Maintenance and Repair Eqt	4000	
72620-335	Maintenance and Repair Buildings		4000
		<hr/>	<hr/>
		4000	4000

72710 Transportation		Increase	Decrease
		Credit	Debit
Funds needed for Supervisor/Director, Mechanic(s), Vehicle and Eqt Ins			
72710-105	Supervisor/Director	250	
72710-142	Mechanic(s)	1	
72710-511	Vehicle and Equipment Insurance	3000	
72710-189	Other Salaries & Wages		2880
72710-524	In Service		371
		<hr/>	<hr/>
		3251	3251

73400 Early Childhood Education	Increase	Decrease
---------------------------------	----------	----------

Budget Amendments GP
June 30, 2020

	Credit	Debit
Funds needed for Instructional Supplies		
73400-429 Other Charges		1
71100 Regular Instruction Program		
71100-116 Teachers		<u>1</u>
	<u>1</u>	<u>1</u>
Total Amendments	121355	121355

Budget Amendments PreK

Early Childhood Education - PreK	Increase Credit	Decrease Debit
----------------------------------	--------------------	-------------------

Additional funds needed for Subs, State Retirement, Medical Insurance, and Other Contracted Services		
141-73400-198	Non-Certified Substitute Teachers	670
141-73400-204	State Retirement	388
141-73400-207	Medical Insurance	2,623
141-73400-399	Other Contracted Services	6,497
141-73400-105	Supervisor/Director	584
141-73400-116	Teachers	4800
141-73400-162	Clerical	253
141-73400-163	Educational Assistants	2072
141-73400-189	Other Salaries & Wages	74
141-73400-201	Social Security	928
141-73400-212	Employer Medicare	202
141-73400-355	Travel	1265
Total PreK Budget Amendments		10,178

Additional funds needed for Supervisor/Director and Other Contracted Services		
141-73400-105	Supervisor/Director	1
141-73400-399	Other Contracted Services	800
141-73400-201	Social Security	200
141-73400-204	State Retirement	601
Total PreK Budget Amendments		801

Budget Amendments Safe Schools

Safe Schools

Additional Funds needed for Contracts with Government Agencies

		Increase Credit	Decrease Debit
141-72130-309-055	Other Student Support - Contracts with Government Agencies	15000	
141-72130-790-055	Other Student Support - Other Equipment		15000
	Total Safe Schools Amendments	15000	15000

Budget Amendments CSH

CSH
 Additional Funds needed for Communication, Postage, and Other Supplies and Materials

	Increase Credit	Decrease Debit
141-72120-307-300 Communication	65	
141-72120-348-300 Postage	115	
141-72120-499-300 Other Supplies & Materials	2174	
141-72120-189-300 Other Salaries & Wages		6
141-72120-201-300 Social Security		340
141-72120-207-300 Medical Insurance		14
141-72120-212-300 Employer Medicare		80
141-72120-355-300 Travel		1293
141-72120-399-300 Other Contracted Services		621
Total CSH Amendments	2354	2354

Bus Garage Budget Amendments

Bus Garage

Additional Funds needed for Supervisor/Director

		Increase Credit	Decrease Debit
144-72710-105	Supervisor/Director	61	
141-72120-201	Social Security		61
	Total Bus Garage Amendments	61	61

June 30,2020
New Budget Items

Vocational Educational Program

Battelle Education STEM Grant

Revenue

		Debit	Credit
46590-910	Other State Education Funds	<u>\$10,000.00</u>	
		\$10,000.00	

Expenditures

71300-429-910	Instructional Materials & Supplies		<u>\$10,000.00</u>
			\$10,000.00

Debt Service - Bonds

Money for Indoor Practice Facility - LGIP Building Fund

Revenue

141-49100	Bond Issued	<u>\$1,300,563.21</u>	
		\$1,300,563.21	

Expenditures

141-82330-606	Other Debt Issuance Charges		\$13,158.57
141-76100-706	Building Construction		<u>\$1,287,404.64</u>
			\$1,300,563.21

Bonds Refinanced

Revenue

141-49100	Bonds Issued	<u>\$19,677,100.60</u>	
		\$19,677,100.60	

Expenditures

141-82330-606	Other Debt Issuance Charges		\$229,841.43
141-82130-601	Principal on Bonds		<u>\$19,447,259.17</u>
			\$19,677,100.60

Budget Amendments GP

June 30, 2020

71100 Regular Instruction		Increase	Decrease
		Credit	Debit
Funds needed for Unemployment, Bound Textbooks, Other Charges, Regular Instruction Eq, Other Eq			
71100-210	Unemployment	4000	
71100-449	Bound Textbooks	40000	
71100-599	Other Charges	3000	
71100-722	Regular Instruction Eq.	4000	
71100-790-(005,010,015)	Other Equipment	18000	
71100-116	Teachers		69000
		<u>69000</u>	<u>69000</u>

71150 Alternative Instruction		Increase	Decrease
		Credit	Debit
Funds needed for Teachers, Other Fringe Benefits			
71150-116	Teachers	200	
71150-299	Other Fringe Benefits	40	
71150-201	Social Security		240
		<u>240</u>	<u>240</u>

71200 Special Education		Increase	Decrease
		Credit	Debit
Funds needed for Retirement-Hybrid Stabilization and Other Charges			
71200-217-010	Retirement-Hybrid Stabilization	1300	
71200-599	Other Charges	13100	
71200-116	Teachers		1423
71200-163	Educational Assistants		2092
71200-201	Social Security		1970
71200-204	Sate Retirement		2886
71200-207	Medical Insurance		5507
71200-212	Employer Medicare		400
71200-299	Other Fringe Benefits		122
		<u>14400</u>	<u>14400</u>

Budget Amendments GP
June 30, 2020

71300 Career and Technical Education		Increase	Decrease
		Credit	Debit
Funds needed for Teachers, Certified Subs, NonCertified Subs			
71300-116	Teachers		26
71300-195	Certified Subs		325
71300-198	Non-Certified Subs		340
71300-207	Medical Insurance		691
		<u>691</u>	<u>691</u>

71400 Student Body Education Program		Increase	Decrease
		Credit	Debit
Funds needed for Other Salaries, Social Security, State Retirement, Employer Medicare			
71400-189	Other Salaries & Wages	4300	
71400-201	Social Security	100	
71400-204	State Retirement	400	
71400-212	Employer Medicare	50	
71100 Regular Instruction Program			
71100-116	Teachers		4850
		<u>4850</u>	<u>4850</u>

72110 Attendance		Increase	Decrease
		Credit	Debit
Funds needed for Other Fringe Benefits			
72110-299	Other Fringe Benefits	36	
72110-355	Travel		36
		<u>36</u>	<u>36</u>

Budget Amendments GP

June 30, 2020

72120 Health Services		Increase	Decrease
		Credit	Debit
Funds needed for Retirement-Hybrid Stabilization, Drugs and Medical Supplies, Health Eq			
72120-217	Retirement-Hybrid Stabilization	700	
72120-413	Drugs and Medical Supplies	1300	
72120-735	Health Eq	1350	
72120-204	State Retirement		1350
72120-207	Medical Insurance		1300
72120-524	In Service/Staff Dev		700
		<u>3350</u>	<u>3350</u>

72130 Other Student Support		Increase	Decrease
		Credit	Credit
Funds needed for Guidance Personnel, Social Workers, Other Salaries, Other Fringes, Other Supplies			
72130-123	Guidance Personnel	2	
72130-130-805	Social Workers	1	
72130-189	Other Salaries & Wages	50	
72130-299	Other Finges Benefits	36	
72130-499-805	Other Supplies	70	
72130-309	Contracts with Government Agencies		159
		<u>159</u>	<u>159</u>

72210 Regular Instruction Program		Increase	Decrease
		Credit	Debit
Funds needed for Career Ladder Program, Instructional Computer Personnel, Other Finge Benefits			
72210-117	Career Ladder Program	1000	
72210-138	Instructional Computer Personnel	50	
72210-299	Other Finge Benefits	72	
72210-524	In Service		1122
		<u>1122</u>	<u>1122</u>

Budget Amendments GP
June 30, 2020

72220 Special Education Program		Increase Credit	Decrease Debit
Funds needed for Medical Insurance, Other Contracted Services			
72220-207	Medical Insurance	1600	
72220-399	Other Contracted Services	1800	
71100 Regular Instruction Program			
71100-116	Teachers		3400
		<u>3400</u>	<u>3400</u>
72250 Instructional Technology			
Funds needed for Other Charges		Increase Credit	Decrease Debit
72250-599	Other Charges	7100	
72250-790	Other Equipment		7100
		<u>7100</u>	<u>7100</u>
72310 Board of Education			
Funds needed for Travel, Liability Insurance, Trustee Commission, Other Charges		Increase Credit	Decrease Debit
72310-355	Travel	900	
72310-506	Liability Insurance	725	
72310-510	Trustee Commission	4000	
72310-599	Other Charges	400	
72310-320	Dues and Memberships		4000
72310-534	Refund from Criminal Investigation		2025
		<u>6025</u>	<u>6025</u>

Budget Amendments GP
June 30, 2020

72320 Director of Schools		Increase Credit	Decrease Debit
Funds needed for Career Ladder, Other Fringes, Administrative Eq			
72320-127	Career Ladder Extended Contracts	1000	
72320-299	Other Fringe Benefits	24	
72320-701	Adminstration Eq	1802	
72320-117	Career Ladder Extended Contracts		1000
72320-355	Travel		1826
		<u>2826</u>	<u>2826</u>

72410 Office of The Principal		Increase Credit	Decrease Debit
Funds needed for Accountants/Bookkeepers and Other Fringes			
72410-119	Accountants/Bookkeepers	1	
72410-299	Other Fringes	60	
72410-201	Social Security		61
		<u>61</u>	<u>61</u>

72510 Fiscal Services		Increase Credit	Decrease Debit
Funds needed for Supervisor/Director, Clerical Personnel, Other Fringes, Advertising			
72510-105	Accountants/Bookkeepers	1	
72510-162	Clerical Personnel	1	
72510-299	Other Fringes	17	
72510-302	Advertising	800	
72510-435	Office Supplies		819
		<u>819</u>	<u>819</u>

Budget Amendments GP
June 30, 2020

72520 Human Services/Personnel		Increase	Decrease
		Credit	Debit
Funds needed for Other Fringes			
72520-299	Other Fringes	24	
72520-320	Dues and Memberships		24
		<hr/>	<hr/>
		24	24

72620 Maintenance of Plant		Increase	Decrease
		Credit	Debit
Funds needed for Maintenance and Repair Eqt, Water and Sewer			
72620-336	Maintenance and Repair Eqt	4000	
72620-335	Maintenance and Repair Buildings		4000
		<hr/>	<hr/>
		4000	4000

72710 Transportation		Increase	Decrease
		Credit	Debit
Funds needed for Supervisor/Director, Mechanic(s), Vehicle and Eqt Ins			
72710-105	Supervisor/Director	250	
72710-142	Mechanic(s)	1	
72710-511	Vehicle and Equipment Insurance	3000	
72710-189	Other Salaries & Wages		2880
72710-524	In Service		371
		<hr/>	<hr/>
		3251	3251

73400 Early Childhood Education	Increase	Decrease
---------------------------------	----------	----------

Budget Amendments GP
June 30, 2020

	Credit	Debit
Funds needed for Instructional Supplies		
73400-429 Other Charges		1
71100 Regular Instruction Program		
71100-116 Teachers		<u>1</u>
	<u>1</u>	<u>1</u>
Total Amendments	121355	121355

Budget Amendments PreK

Early Childhood Education - PreK	Increase Credit	Decrease Debit
----------------------------------	--------------------	-------------------

Additional funds needed for Subs, State Retirement, Medical Insurance, and Other Contracted Services		
141-73400-198	Non-Certified Substitute Teachers	670
141-73400-204	State Retirement	388
141-73400-207	Medical Insurance	2,623
141-73400-399	Other Contracted Services	6,497
141-73400-105	Supervisor/Director	584
141-73400-116	Teachers	4800
141-73400-162	Clerical	253
141-73400-163	Educational Assistants	2072
141-73400-189	Other Salaries & Wages	74
141-73400-201	Social Security	928
141-73400-212	Employer Medicare	202
141-73400-355	Travel	1265
Total PreK Budget Amendments		10,178

Additional funds needed for Supervisor/Director and Other Contracted Services		
141-73400-105	Supervisor/Director	1
141-73400-399	Other Contracted Services	800
141-73400-201	Social Security	200
141-73400-204	State Retirement	601
Total PreK Budget Amendments		801

Budget Amendments Safe Schools

Safe Schools

Additional Funds needed for Contracts with Government Agencies

		Increase Credit	Decrease Debit
141-72130-309-055	Other Student Support - Contracts with Government Agencies	15000	
141-72130-790-055	Other Student Support - Other Equipment		15000
	Total Safe Schools Amendments	15000	15000

Budget Amendments CSH

CSH
 Additional Funds needed for Communication, Postage, and Other Supplies and Materials

	Increase Credit	Decrease Debit
141-72120-307-300 Communication	65	
141-72120-348-300 Postage	115	
141-72120-499-300 Other Supplies & Materials	2174	
141-72120-189-300 Other Salaries & Wages		6
141-72120-201-300 Social Security		340
141-72120-207-300 Medical Insurance		14
141-72120-212-300 Employer Medicare		80
141-72120-355-300 Travel		1293
141-72120-399-300 Other Contracted Services		621
Total CSH Amendments	2354	2354

Bus Garage Budget Amendments

Bus Garage

Additional Funds needed for Supervisor/Director

		Increase Credit	Decrease Debit
144-72710-105	Supervisor/Director	61	
141-72120-201	Social Security		61
	Total Bus Garage Amendments	61	61

6/25/2020

Title II 201 Budget 20-01 Amendment #2

	<u>Original</u>	<u>Increase</u>	<u>Decrease</u>	<u>Amended</u>
<u>72210 - Support Services</u>				
189 Other Salaries and Wages	18,216.00	\$ 499.50		18,715.50
201 Social Security	1,129.00	\$ 0.62		1,129.62
204 State Retirement	1,936.00			1,936.00
207 Medical Insurance	630.00	395.71		1,025.71
212 Medicare 1.45%	264.00	0.22		264.22
299 Other Fringe Benefits .45%	71.00	17.84		88.84
524 In-Service Staff Development	20,145.93		1,007.63	19,138.30
Subtotal	42,391.93	913.89	1,007.63	42,298.19
99100 590 Indirect Cost	1,509.00	93.74		1,602.74
47189 Revenue Account				
Total	\$ 43,900.93	\$ 1,007.63	\$ 1,007.63	\$ 43,900.93

Justification: Amendment was made to match ytd expenditures.

IDEA 901 Budget Amendment #2

6/25/2020

	<u>19-01</u>	<u>Increase</u>	<u>Decrease</u>	Amended
<u>71200 - Special Education Program</u>				
116 Teachers	\$ 96,275.00			\$ 96,275.00
163 Educational Assistants	94,030.00			\$ 94,030.00
201 Social Security 6.2%	11,799.00			\$ 11,799.00
204 State Retirement	15,029.56			\$ 15,029.56
207 Medical Insurance	34,044.00			\$ 34,044.00
212 Medicare 1.45%	2,759.00			\$ 2,759.00
299 Other Fringe Benefits .45%	742.19	855.08		\$ 1,597.27
311 Contracts with other School Systems	4,559.00			\$ 4,559.00
499 Other Supplies and Materials	15,000.00		8,000.00	\$ 7,000.00
725 SPED Equipment	12,000.00		6,000.00	\$ 6,000.00
Subtotal	286,237.75	855.08	14,000.00	\$ 273,092.83
<u>72220 - Special Education Program Staff</u>				
105 Supervisor/Director	9,089.00			\$ 9,089.00
161 Secretary	6,296.00	0.06		\$ 6,296.06
189 Other Salaries & Wages	8,152.00			\$ 8,152.00
201 Social Security 6.2%	1,459.29			\$ 1,459.29
204 State Retirement	1,703.00			\$ 1,703.00
207 Medical Insurance	1,855.00	574.31		\$ 2,429.31
212 Medicare 1.45%	341.29			\$ 341.29
299 Other Fringe Benefits .45%	92.00	13.44		\$ 105.44
336 Maintenance & Repair Equipment	4,500.00			\$ 4,500.00
524-In Service/Staff Development	15,471.56		4,767.24	\$ 10,704.32
Subtotal	48,959.14	587.81	4,767.24	\$ 44,779.71
99100 590 Indirect Cost	1.00	17,324.35		\$ 17,325.35
47143 Revenue Account				
Total	\$ 335,197.89	\$ 18,767.24	\$ 18,767.24	\$ 335,197.89

Justification: Budget was amended to match ytd expenditures.

IDEA Pre-School 911 Budget Amendment #2

6/25/2020

	<u>19-01</u>	<u>Increase</u>	<u>Decrease</u>	Amended
<u>71200 - Special Education Program</u>				
163 Educational Assistants	6,450.00	\$ 0.01		\$ 6,450.01
201 Social Security	400.00			\$ 400.00
204 State Retirement	686.00			\$ 686.00
207 Medical Insurance	715.00			\$ 715.00
212 Medicare	94.00			\$ 94.00
299 Other Fringe Benefits	25.00	4.03		\$ 29.03
429 Inst. Materials and Supplies	<u>9,164.92</u>		4.04	<u>\$ 9,160.88</u>
Subtotal	17,534.92	4.04	4.04	\$ 17,534.92
	47145			
	17,534.92	4.04	4.04	\$ 17,534.92

Justification: To match year to date expenditures.

5/27/2020

CTE Amendment #1

	<u>Original</u>	<u>Increase</u>	<u>Decrease</u>	<u>Amended</u>
<u>71300</u>				
429 Instructional Supplies	9,131.61		\$ 755.89	8,375.72
730 Vocational Instruction Equipment	<u>7,000.00</u>	<u>3,764.77</u>		<u>10,764.77</u>
Subtotal	16,131.61	3,764.77	755.89	19,140.49
<u>72130</u>				
355 Travel	5,008.00		3,092.16	1,915.84
524 In-Service/Staff Development	<u>2,649.32</u>	<u>87.18</u>		<u>2,736.50</u>
	7,657.32	87.18	3,092.16	4,652.34
<u>72230</u>				
355 Travel	600.00		38.24	561.76
524 In-Service/Staff Development	<u>652.00</u>	<u>34.34</u>		<u>686.34</u>
	1,252.00	34.34	38.24	1,248.10
 Revenue Code 47131				
	25,040.93	3,886.29	3,886.29	25,040.93

Justification: Amend line item to allow for additional equipment needs.

6/22/2020

21st Century Grant #1

	<u>Original</u>	<u>Increase</u>	<u>Decrease</u>	<u>Amended</u>
<u>73300-Community Services</u>				
105 Supervisor/Director	14,980.00	\$ 1,960.00		16,940.00
116 Teachers	146,400.00		\$4,260.00	142,140.00
163 Educational Assistants	12,000.00			12,000.00
189 Other Salaries and Wages	3,600.00			3,600.00
201 Social Security 6.2%	10,975.00			10,975.00
204 State Retirement	15,250.00			15,250.00
212 Medicare 1.45%	2,565.00			2,565.00
299 Other Fringe Benefits	-			-
355 Travel	580.00	300.00		880.00
399 Other Contracted Services	10,600.00			10,600.00
422 Food Supplies	2,000.00			2,000.00
429 Inst. Materials and Supplies	15,325.00			15,325.00
524 In-Service Staff Development	2,750.00			2,750.00
599 Other Charges	2,750.00			2,750.00
790 Other Equipment	1,200.00			1,200.00
Subtotal	240,975.00	2,260.00	4260.00	238,975.00
<u>99100 - Transfers Out</u>				
590 Transfers to other funds	-	2,000.00		2,000.00
Subtotal	-	2,000.00	-	2,000.00
				-
47590 Revenue Account				
Total	\$ 240,975.00	\$ 4,260.00	\$ 4,260.00	\$ 240,975.00

Justification: Amendment was made to reflect actual budget needs

School Nutrition Budget Amendment 20-01 #1 6-25-20

73100 Title	Original	Increase	Decrease	Amended
105 Supervisor/Director	27,626.00	0.30		27,626.30
162 Clerical Personnel	2,917.00			2,917.00
165 Cafeteria Personnel	244,129.00		8,046.19	236,082.81
189 Other Salaries and Wages	5,000.00	8,046.19		13,046.19
201 Social Security	17,292.00			17,292.00
204 Retirement	14,224.00			14,224.00
207 Medical Insurance	36,872.00			36,872.00
210 Unemployment Compensation	1.00			1.00
212 Employer Medicare	4,044.00			4,044.00
299 Other Fringe Benefits	8,971.00			8,971.00
307 Communication	200.00			200.00
336 Maintenance & Repair Services-Equipment	8,000.00			8,000.00
354 Transportation-other than students	2,200.00	841.37		3,041.37
355 Travel	1,500.00			1,500.00
399 Other Contracted Services	6,300.00	7,490.00		13,790.00
422 Food Supplies	440,000.00			440,000.00
451 Uniforms	2,750.00			2,750.00
452 Utilities	25,500.00			25,500.00
469 Commodities	65,000.00			65,000.00
499 Other Supplies and Materials	45,000.00			45,000.00
524 In Service/Staff Development	8,000.00			8,000.00
599 Other Charges	20,000.00		8,331.67	11,668.33
710 Food Service Equipment	65,000.00			65,000.00
	<u>1,050,526.00</u>	<u>16,377.86</u>	<u>16,377.86</u>	<u>1,050,526.00</u>
SUDIA Grant 46980				
IPS Rebate 47114				
Total	1,050,526.00	16,377.86	16,377.86	1,050,526.00

Amendment: Line items were amended to match year end expenditures

June 30,2020
New Budget Items

Vocational Educational Program

Battelle Education STEM Grant

Revenue

		Debit	Credit
46590-910	Other State Education Funds	<u>\$10,000.00</u>	
		\$10,000.00	

Expenditures

71300-429-910	Instructional Materials & Supplies		<u>\$10,000.00</u>
			\$10,000.00

Debt Service - Bonds

Money for Indoor Practice Facility - LGIP Building Fund

Revenue

141-49100	Bond Issued	<u>\$1,300,563.21</u>	
		\$1,300,563.21	

Expenditures

141-82330-606	Other Debt Issuance Charges		\$13,158.57
141-76100-706	Building Construction		<u>\$1,287,404.64</u>
			\$1,300,563.21

Bonds Refinanced

Revenue

141-49100	Bonds Issued	<u>\$19,677,100.60</u>	
		\$19,677,100.60	

Expenditures

141-82330-606	Other Debt Issuance Charges		\$229,841.43
141-82130-601	Principal on Bonds		<u>\$19,447,259.17</u>
			\$19,677,100.60

Budget Amendments GP

June 30, 2020

71100 Regular Instruction		Increase	Decrease
		Credit	Debit
Funds needed for Unemployment, Bound Textbooks, Other Charges, Regular Instruction Eq, Other Eq			
71100-210	Unemployment	4000	
71100-449	Bound Textbooks	40000	
71100-599	Other Charges	3000	
71100-722	Regular Instruction Eq.	4000	
71100-790-(005,010,015)	Other Equipment	18000	
71100-116	Teachers		69000
		<u>69000</u>	<u>69000</u>

71150 Alternative Instruction		Increase	Decrease
		Credit	Debit
Funds needed for Teachers, Other Fringe Benefits			
71150-116	Teachers	200	
71150-299	Other Fringe Benefits	40	
71150-201	Social Security		240
		<u>240</u>	<u>240</u>

71200 Special Education		Increase	Decrease
		Credit	Debit
Funds needed for Retirement-Hybrid Stabilization and Other Charges			
71200-217-010	Retirement-Hybrid Stabilization	1300	
71200-599	Other Charges	13100	
71200-116	Teachers		1423
71200-163	Educational Assistants		2092
71200-201	Social Security		1970
71200-204	Sate Retirement		2886
71200-207	Medical Insurance		5507
71200-212	Employer Medicare		400
71200-299	Other Fringe Benefits		122
		<u>14400</u>	<u>14400</u>

Budget Amendments GP
June 30, 2020

71300 Career and Technical Education		Increase	Decrease
		Credit	Debit
Funds needed for Teachers, Certified Subs, NonCertified Subs			
71300-116	Teachers		26
71300-195	Certified Subs		325
71300-198	Non-Certified Subs		340
71300-207	Medical Insurance		691
		<u>691</u>	<u>691</u>

71400 Student Body Education Program		Increase	Decrease
		Credit	Debit
Funds needed for Other Salaries, Social Security, State Retirement, Employer Medicare			
71400-189	Other Salaries & Wages	4300	
71400-201	Social Security	100	
71400-204	State Retirement	400	
71400-212	Employer Medicare	50	
71100 Regular Instruction Program			
71100-116	Teachers		4850
		<u>4850</u>	<u>4850</u>

72110 Attendance		Increase	Decrease
		Credit	Debit
Funds needed for Other Fringe Benefits			
72110-299	Other Fringe Benefits	36	
72110-355	Travel		36
		<u>36</u>	<u>36</u>

Budget Amendments GP

June 30, 2020

72120 Health Services		Increase	Decrease
		Credit	Debit
Funds needed for Retirement-Hybrid Stabilization, Drugs and Medical Supplies, Health Eq			
72120-217	Retirement-Hybrid Stabilization	700	
72120-413	Drugs and Medical Supplies	1300	
72120-735	Health Eq	1350	
72120-204	State Retirement		1350
72120-207	Medical Insurance		1300
72120-524	In Service/Staff Dev		700
		<u>3350</u>	<u>3350</u>

72130 Other Student Support		Increase	Decrease
		Credit	Credit
Funds needed for Guidance Personnel, Social Workers, Other Salaries, Other Fringes, Other Supplies			
72130-123	Guidance Personnel	2	
72130-130-805	Social Workers	1	
72130-189	Other Salaries & Wages	50	
72130-299	Other Finges Benefits	36	
72130-499-805	Other Supplies	70	
72130-309	Contracts with Government Agencies		159
		<u>159</u>	<u>159</u>

72210 Regular Instruction Program		Increase	Decrease
		Credit	Debit
Funds needed for Career Ladder Program, Instructional Computer Personnel, Other Finge Benefits			
72210-117	Career Ladder Program	1000	
72210-138	Instructional Computer Personnel	50	
72210-299	Other Finge Benefits	72	
72210-524	In Service		1122
		<u>1122</u>	<u>1122</u>

Budget Amendments GP
June 30, 2020

		Increase Credit	Decrease Debit
72220 Special Education Program			
Funds needed for Medical Insurance, Other Contracted Services			
72220-207	Medical Insurance	1600	
72220-399	Other Contracted Services	1800	
71100 Regular Instruction Program			
71100-116	Teachers		3400
		<u>3400</u>	<u>3400</u>
72250 Instructional Technology			
Funds needed for Other Charges			
72250-599	Other Charges	7100	
72250-790	Other Equipment		7100
		<u>7100</u>	<u>7100</u>
72310 Board of Education			
Funds needed for Travel, Liability Insurance, Trustee Commission, Other Charges			
72310-355	Travel	900	
72310-506	Liability Insurance	725	
72310-510	Trustee Commission	4000	
72310-599	Other Charges	400	
72310-320	Dues and Memberships		4000
72310-534	Refund from Criminal Investigation		2025
		<u>6025</u>	<u>6025</u>

Budget Amendments GP
June 30, 2020

72320 Director of Schools		Increase Credit	Decrease Debit
Funds needed for Career Ladder, Other Fringes, Administrative Eq			
72320-127	Career Ladder Extended Contracts	1000	
72320-299	Other Fringe Benefits	24	
72320-701	Adminstration Eq	1802	
72320-117	Career Ladder Extended Contracts		1000
72320-355	Travel		1826
		<u>2826</u>	<u>2826</u>

72410 Office of The Principal		Increase Credit	Decrease Debit
Funds needed for Accountants/Bookkeepers and Other Fringes			
72410-119	Accountants/Bookkeepers	1	
72410-299	Other Fringes	60	
72410-201	Social Security		61
		<u>61</u>	<u>61</u>

72510 Fiscal Services		Increase Credit	Decrease Debit
Funds needed for Supervisor/Director, Clerical Personnel, Other Fringes, Advertising			
72510-105	Accountants/Bookkeepers	1	
72510-162	Clerical Personnel	1	
72510-299	Other Fringes	17	
72510-302	Advertising	800	
72510-435	Office Supplies		819
		<u>819</u>	<u>819</u>

Budget Amendments GP
June 30, 2020

72520 Human Services/Personnel		Increase Credit	Decrease Debit
Funds needed for Other Fringes			
72520-299	Other Fringes		24
72520-320	Dues and Memberships		24
		<u>24</u>	<u>24</u>

72620 Maintenance of Plant		Increase Credit	Decrease Debit
Funds needed for Maintenance and Repair Eqt, Water and Sewer			
72620-336	Maintenance and Repair Eqt	4000	
72620-335	Maintenance and Repair Buildings		4000
		<u>4000</u>	<u>4000</u>

72710 Transportation		Increase Credit	Decrease Debit
Funds needed for Supervisor/Director, Mechanic(s), Vehicle and Eqt Ins			
72710-105	Supervisor/Director	250	
72710-142	Mechanic(s)	1	
72710-511	Vehicle and Equipment Insurance	3000	
72710-189	Other Salaries & Wages		2880
72710-524	In Service		371
		<u>3251</u>	<u>3251</u>

73400 Early Childhood Education	Increase	Decrease
---------------------------------	----------	----------

Budget Amendments GP
June 30, 2020

	Credit	Debit
Funds needed for Instructional Supplies 73400-429 Other Charges		1
71100 Regular Instruction Program 71100-116 Teachers		<u>1</u>
	<u>1</u>	<u>1</u>
Total Amendments	121355	121355

Budget Amendments PreK

Early Childhood Education - PreK	Increase Credit	Decrease Debit
----------------------------------	--------------------	-------------------

Additional funds needed for Subs, State Retirement, Medical Insurance, and Other Contracted Services		
141-73400-198	Non-Certified Substitute Teachers	670
141-73400-204	State Retirement	388
141-73400-207	Medical Insurance	2,623
141-73400-399	Other Contracted Services	6,497
141-73400-105	Supervisor/Director	584
141-73400-116	Teachers	4800
141-73400-162	Clerical	253
141-73400-163	Educational Assistants	2072
141-73400-189	Other Salaries & Wages	74
141-73400-201	Social Security	928
141-73400-212	Employer Medicare	202
141-73400-355	Travel	1265
Total PreK Budget Amendments		10,178

Additional funds needed for Supervisor/Director and Other Contracted Services		
141-73400-105	Supervisor/Director	1
141-73400-399	Other Contracted Services	800
141-73400-201	Social Security	200
141-73400-204	State Retirement	601
Total PreK Budget Amendments		801

Budget Amendments Safe Schools

Safe Schools

Additional Funds needed for Contracts with Government Agencies

		Increase Credit	Decrease Debit
141-72130-309-055	Other Student Support - Contracts with Government Agencies	15000	
141-72130-790-055	Other Student Support - Other Equipment		15000
	Total Safe Schools Amendments	15000	15000

Budget Amendments CSH

CSH
 Additional Funds needed for Communication, Postage, and Other Supplies and Materials

	Increase Credit	Decrease Debit
141-72120-307-300 Communication	65	
141-72120-348-300 Postage	115	
141-72120-499-300 Other Supplies & Materials	2174	
141-72120-189-300 Other Salaries & Wages		6
141-72120-201-300 Social Security		340
141-72120-207-300 Medical Insurance		14
141-72120-212-300 Employer Medicare		80
141-72120-355-300 Travel		1293
141-72120-399-300 Other Contracted Services		621
Total CSH Amendments	2354	2354

Bus Garage Budget Amendments

Bus Garage

Additional Funds needed for Supervisor/Director

		Increase Credit	Decrease Debit
144-72710-105	Supervisor/Director	61	
141-72120-201	Social Security		61
	Total Bus Garage Amendments	61	61

6/25/2020

Title V A Budget 20-01 Amendment #2

	<u>Original</u>	<u>Increase</u>	<u>Decrease</u>	<u>Amended</u>
<u>72210 - Support Services</u>				
189 Other Salaries and Wages	19,976.00	23.37		19,999.37
201 Social Security 6.2%	1,283.51			1,283.51
204 State Retirement	2,123.45	2.51		2,125.96
207 Medical Insurance	2,018.88			2,018.88
212 Medicare 1.45%	289.65			289.65
299 Workers' Compensation	77.91	12.09		90.00
524 Staff Development	906.58		37.97	868.61
Subtotal				
47148 Revenue Code				
Total	\$ 26,675.98	\$ 37.97	\$ 37.97	\$ 26,675.98

Justification: Budget lines items were amended to match ytd expenditures

TRMS

6/23/2020

Invoice Number 1493183

Walsworth

Preliminary Invoice

Walsworth Publishing Company
306 N Kansas Ave.
Marceline, MO 64658
Phone: (800) 369-2646

Invoice #:	1493183
Date:	NA
PO #:	NA
Title:	NA
ISBN:	NA
Ship Date:	01/01/1970
Ship Via:	NA
Terms:	Due at Invoice

Bill To:

Trenton Rosenwald Middle Sch.
2065 45 Bypass
Trenton, TN 38382

Job Number	Program	Size	Copies	Pages	Customer Number	Sales Rep
9100	All American	08	125	80	20761	Johnny Cole
Quantity	Description	Unit Price	Amount			
	150 Copies with 80 Pages		\$6,319.13			
	98 pt. cover binders board		Included			
	25 fewer copies		-\$724.90			
	School designed 4-color printed cover		Included			
	Marketing Items		\$71.25			
	Online, iTag personalization (per line)		\$16.50			
	Online, Icons for iTag (up to 5)		\$10.50			
	Preferred Customer Discount - Per J. Cole		-\$500.00			
	Sales tax collected through Online Sales		-\$146.01			

Remit To:

Walsworth Publishing Company
PO BOX 310287
Des Moines, IA 50331-0287
Thank you for your business!

Subtotal:	\$5,046.47
Shipping and Handling:	\$0.00 200.00
Sales Tax:	\$0.00 492.03
Total Price:	\$5,046.47 5738.50
Advance Payment:	\$5,419.30
Interest Credit:	-\$8.64
Balance Due:	-\$381.47

Balance Due - **\$319.20**

Customer Name and Address:

Trenton Rosenwald Middle School
 2065 Highway 45 By-Pass
 Trenton, TN 38382

Purchase Order

PO Number: 006451
Order Date: 08/01/2019

To:

Walsworth Publishing Company
 P.O. Box 310287
 Des Moines, IA 50331-0287

Notes:**Delivery Date:** 05/20/2020

Yearbook for school year 2019-2020

Attn:**Placed By:** CaRae Tubbs

Item No	Account Number	Detail Code	Quantity	Unit Price	Item	Amount
1	906 - Annual		1	3,000.00000	Yearbook/Not to Exceed	6,000.00

Total: \$6,000.00



Authorized Signature



Authorized Signature

Financial Trenton Rosenwald Middle Sch.
Job: 9100A**Deposits due**

Deposit	Due	Amount
First	02/01/20	\$2,211.70
Second	05/01/20	2,843.60
Total deposits due*		\$5,055.30

*This amount is only a portion of the total cost of your yearbook order. Additional items will be billed upon delivery of your books.

Deposits received

Payment	Received	Method	Amount
Books sold online	-	-	\$1,431.00
Payment 1	05/28/19	Check	304.89
Payment 2	01/21/20	Check	1,906.81
Payment 3	03/23/20	Check	1,776.60
Total deposits received*			\$5,419.30

Deposit balance due	\$0.00
----------------------------	---------------

Trenton Rosenwald Middle School

GL Account Activity Fund Report
07/01/2019 Thru 06/23/2020

Restricted

906 - Annual

Date	Type	Number	Source	Payee / Received Of	Description	Debit	Credit	Balance
								Beginning Balance :
								\$-1,359.65
08/23/2019	CR	007306	Restricted	CaRae Tubbs	Yearbook sales		90.00	-1,449.65
10/29/2019	CR	007407	Restricted	CaRae Tubbs	Yearbook sales		135.00	-1,584.65
11/05/2019	CR	007420	Restricted	CaRae Tubbs	Yearbook		45.00	-1,629.65
11/12/2019	CR	007436	Restricted	CaRae Tubbs	Yearbook sales		180.00	-1,809.65
11/18/2019	CR	007443	Restricted	CaRae Tubbs	Yearbook Sales		90.00	-1,899.65
11/22/2019	CR	007460	Restricted	CaRae Tubbs	Yearbook Sales		405.00	-2,304.65
12/03/2019	CR	007463	Restricted	CaRae Tubbs	Yearbook Sales		140.00	-2,444.65
01/07/2020	CR	007497	Restricted	CaRae Tubbs	Yearbook sale		50.00	-2,494.65
01/07/2020	CR	007498	Restricted	CaRae Tubbs	Yearbook Ads		410.00	-2,904.65
01/14/2020	CR	007505	Restricted	CaRae Tubbs	Yearbook Ad		70.00	-2,974.65
01/15/2020	CD	013561	Restricted	Walsworth Publishing Company	2020 Yearbook - first deposit	1,906.81		-1,067.84
01/17/2020	CR	007511	Restricted	CaRae Tubbs	Yearbook ads		160.00	-1,227.84
01/29/2020	CR	007530	Restricted	C. Tubbs	Yearbook		150.00	-1,377.84
02/03/2020	CR	007543	Restricted	CaRae Tubbs	Yearbook sale		50.00	-1,427.84
02/04/2020	CR	007548	Restricted	CaRae Tubbs	Ad/On-line sales		102.85	-1,530.69
02/06/2020	CR	007550	Restricted	CaRae Tubbs	Yearbook Ad		90.00	-1,620.69
02/12/2020	CR	007565	Restricted	CaRae Tubbs	Yearbook sales		100.00	-1,720.69
02/21/2020	CR	007581	Restricted	CaRae Tubbs	Brady Barton/yearbook & Ad		95.00	-1,815.69
02/21/2020	CR	007582	Restricted	CaRae Tubbs	Jayda Jewell Yearbook ad		45.00	-1,860.69
02/24/2020	CR	007591	Restricted	CaRae Tubbs	Yearbook sale		50.00	-1,910.69
02/24/2020	CR	007592	Restricted	CaRae Tubbs	Yearbook sale		50.00	-1,960.69
02/28/2020	CR	007599	Restricted	CaRae Tubbs	Yearbook sale		50.00	-2,010.69

Trenton Rosenwald Middle School

GL Account Activity Fund Report
07/01/2019 Thru 06/23/2020

Restricted

906 - Annual

Date	Type	Number	Source	Payee / Received Of	Description	Debit	Credit	Balance
03/06/2020	CR	007613	Restricted	CaRae Tubbs	Yearbook Sale		50.00	-2,060.69
03/17/2020	CD	013659	Restricted	Walsworth Publishing Company	2020 Yearbook-Second Deposit	1,776.60		-284.09
03/18/2020	CR	007626	Restricted	CaRae Tubbs	Yearbook Ad		90.00	-374.09
04/16/2020	CR	007627	Restricted	CaRae Tubbs	Student Yearbook ad		160.00	-534.09
05/06/2020	CR	007636	Restricted	Walsworth	Collected sales tax for on-line sales		82.96	-617.05
05/14/2020	CR	007638	Restricted	CaRae Tubbs	Yearbook sales		300.00	-917.05
06/16/2020	CR	007642	Restricted	CaRae Tubbs	Yearbook sales		150.00	-1,067.05
							Ending Balance :	\$-1,067.05



Johnny Cole

Yearbook Sales Representative

johnny.cole@walsworth.com

901.351.8862 CELL

800.369.1530 COMPUTER SUPPORT

888.390.1711 CUSTOMER SERVICE

barb.tschannen@walsworth.com CUSTOMER SERVICE

www.walsworthyearbooks.com

Walsworth yearbooks

2020-21 Consolidated Funding Application

Consolidated Administration

Allocation - \$77,774.74

- \$75,045.63– from Title I (19%)
- \$2,477.24– from Title II A (4%)
- \$251.87– from Title V (1%)
- Provides funding for 50% of the Federal Director, 15% of the Federal Finance Director, and 20% of the Administrative Assistant to oversee all Title budgets.

Title I A (Michele)

Allocation - \$348,375.37 – (\$75,045.63 to Consolidated Admin)

Provides funding for

- 1.5 Educational Assistants for TES and TRMS
- 68% Instructional Facilitator for PHS
- 38% salary of a Literacy Leader for TES
- Interventionist for TES
- Interventionist for TRMS
- Instructional supplies, homeless supplies, and professional development opportunities
- \$28,444 from Title IV was added to the allocation.

Title II A (Michele)

Allocation - \$59,453.76 (\$2,477.24 to Consolidated Admin)

Provides funding for

- 12% salary of a Literacy Leader for TES
- Fund 3 Teacher Leader Positions
- Professional development opportunities

Title III A (Amy)

Allocation - \$3,416.96

The grant provides supplementary supplies for ELA students and professional development opportunities for ELA instructors and Directors.

Title IV

Allocation - \$28,444 – moved to Title I

Title V (formally Title VI) (Michele)

Allocation - \$24,935.58

Provides funding for

- 32% of salary of Instructional Facilitator for PHS

IDEA, Part B (Amy)

Allocation - \$288,861

Provides funding for

- 2 SPED Teachers
- 5 SPED educational assistants
- 11% of salary of Special Populations Director
- 18% of salary for Bookkeeper
- 19% of salary for Administrative Assistant
- Portion of PAES program
- Instructional supplies, copier needs, and professional development opportunities

IDEA Pre-K (Amy)

Allocation - \$8,863

Provides funding for

- 15% of salary for a SPED Pre-K classroom teacher (85% funded through GP SPED budget)

FY21 Consolidated Application Approval for IDEA/ESEA
School Year 2020-21

LEA # 273 LEA Name (Legal Name of Agency): Trenton Special School District

LEA # <u>273</u>	LEA Name (Legal Name of Agency): Trenton Special School District
LEA Legal Making Address	
Street Address <u>201 West 10th Street</u>	
City <u>Trenton</u>	State <u>TN</u> Zip <u>38382</u>

Consolidated Project begins 7/1/20 and ends 6/30/21

The facts, figures, and representations made in this application, including exhibits, attachments, and assurances herein, are true and correct to the best of my knowledge.

The Board of Education has reviewed and approved this project year application for filing.
This action is recorded in the official minutes of the Agency's Board meeting held on the date entered below:

6/30/2020
Board Meeting Date

Director of Schools (Signature)

Tim Haney
Director of Schools (Print Name)

06/30/2020
Date Signed

Board of Education Official (Signature)

Mark Harper
Board of Education Official (Print Name)

06/30/2020
Date Signed

Budget

Trenton (273) Public District - FY 2021 - Elementary and Secondary School Emergency Relief (ESSER) - Rev 0 - Elementary and Secondary School Emergency Relief (ESSER)

Indirect Cost	
Total Contributing to Indirect Cost	\$105,340.00
Indirect Cost Rate	16.97%
Maximum Allowed for Indirect Cost	\$15,282.72

Account Number	Total
71100 - Regular Instruction Program	\$82,725.04
71150 - Alternative Instruction Program	\$0.00
71200 - Special Education Program	\$0.00
71300 - Vocational Education Program	\$0.00
72110 - Attendance	\$0.00
72120 - Health Services	\$83,622.00
72130 - Other Student Support	\$0.00
72210 - Support Services/Regular Instruction Program	\$3,955.00
72215 - Support Services/Alternative Instruction Program	\$0.00
72220 - Support Services/Special Education Program	\$0.00
72230 - Support Services/Vocational Education Program	\$0.00
72250 - Education Technology	\$0.00
72410 - Office of the Principal	\$0.00

72610 - Operation of Plant		\$0.00
72620 - Maintenance of Plant		\$0.00
72710 - Transportation		\$104,406.00
73100 - Food Service		\$1,615.00
73300 - Community Services		\$0.00
73400 - Early Childhood Education		\$0.00
99100 - Transfers Out		\$0.00
	Total	\$276,323.04
	Adjusted Allocation	\$276,323.04
	Remaining	\$0.00

Budget Detail

Trenton (273) Public District - FY 2021 - Elementary and Secondary School Emergency Relief (ESSER) - Rev 0 - Elementary and Secondary School Emergency Relief (ESSER)

71100 - Regular Instruction Program - \$82,725.04 ▼

Budget Detail

Narrative Description

Account Number: 71100 - Regular Instruction Program

Line Item Number: 195 - Certified Substitute Teachers

Focus Area: Mental Health Supports

School Type: Traditional Public School

Optional Program Code:

Location Code: Trenton (273)

Quantity: 1.00

Cost: \$15,000.00

Line Item Total: \$15,000.00

Account Number: 71100 - Regular Instruction Program

Line Item: 201 - Social Security

To provide substitute teachers for employees' absences due to COVID 19.

Benefits for substitute salaries.

Number:	
Focus Area:	Mental Health Supports
School Type:	Traditional Public School
Optional Program Code:	
Location Code:	Trenton (273)
Quantity:	1.00
Cost:	\$930.00
Line Item Total:	\$930.00

Benefits for substitute salaries.

Account Number: 71100 - Regular Instruction Program
 Line Item Number: 212 - Employer Medicare
 Focus Area: Mental Health Supports
 School Type: Traditional Public School
 Optional Program Code:
 Location: Trenton (273)

Code:

Quantity:

Cost:

Line Item Total:

To purchase Chromebooks for 5th grade students and damaged Chromebooks as well as Chromebook cases to allow students to participate in distance learning. Also, to purchase additional 200 laptop cases to allow students to take home laptops for distance learning. Purchase cabling and technology needs for student one to one.

Account Number: 71100 - Regular Instruction Program

Line Item Number: 722 - Regular Instruction Equipment

Focus Area: Purchasing Education Technology

School Type: Traditional Public School

Optional Program Code:

Location Code: Trenton (273)

Quantity:

Cost:

Line Item Total:

Total for 71100 - Regular Instruction Program:

Total for all other Account Numbers:

Total for all Account Numbers: \$276,323.04

Adjusted Allocation: \$276,323.04

Remaining: \$0.00

Budget Detail

Trenton (273) Public District - FY 2021 - Elementary and Secondary School Emergency Relief (ESSER) - Rev 0 - Elementary and Secondary School Emergency Relief (ESSER)

72120 - Health Services - \$83,622.00 ▼

Budget Detail

Narrative Description

Account Number: 72120 - Health Services

Line Item Number: 499 - Other Supplies and Materials

Focus Area: Other Approved Activities

School Type: Traditional Public School

Optional Program Code:

Location Code: Trenton (273)

Quantity: 1.00

Cost: \$83,622.00

Line Item Total: \$83,622.00

To purchase 50 thermometers for the school district to allow teachers to have one per room (3203). To purchase 10,000 disposable face masks at .49 each (4,900). To purchase 31 hands free sanitizer dispenser and stand for each entrance (10,230- 330 each). To purchase 50 cases of sanitizer (11,010). To purchase Electrostatic Disinfectant Backpack for bus garage (4,195). To purchase 4 Electrostatic Disinfectant Mister Pull carts for the schools (16,780). To purchase 50 Gallon Facility plus cleaner - cases of 4 (8,124). To purchase 20 face shields for nurses (180). To purchase hand sanitizer pumps and wipes, cans of disinfectant (25,000)

Total for 72120 - Health Services: \$83,622.00

Total for all other Account Numbers: \$192,701.04

Total for all Account Numbers:	\$276,323.04
Adjusted Allocation:	\$276,323.04
Remaining:	\$0.00

Budget Detail

Trenton (273) Public District - FY 2021 - Elementary and Secondary School Emergency Relief (ESSER) - Rev 0 - Elementary and Secondary School Emergency Relief (ESSER)

72210 - Support Services/Regular Instruction Program - \$3,955.00 ▼

Budget Detail

Narrative Description

Account Number: 72210 - Support Services/Regular Instruction Program

Line Item Number: 524 - In-Service / Staff Development

Focus Area: Summer/Supplemental Learning

School Type: Traditional Public School

Optional Program Code:

Location Code: Trenton (273)

Quantity: 1.00

Cost: \$3,955.00

Line Item Total: \$3,955.00

To purchase Google Certification for all certified staff in the district.

Total for 72210 - Support Services/Regular Instruction Program:

\$3,955.00

Total for all other Account Numbers:

\$272,368.04

Total for all Account Numbers:

Adjusted Allocation:

Remaining:

Budget Detail

Trenton (273) Public District - FY 2021 - Elementary and Secondary School Emergency Relief (ESSER) - Rev 0 - Elementary and Secondary School Emergency Relief (ESSER)

72710 - Transportation - \$104,406.00

Budget Detail

Narrative Description

Account Number: 72710 - Transportation

Line Item Number: 729 - Transportation Equipment

Focus Area: Other Approved Activities

School Type: Traditional Public School

Optional Program Code:

Location Code: Trenton (273)

Quantity: 1.00

Cost: \$104,406.00

Line Item Total: \$104,406.00

Purchase a Blue Bird All American T3FE Type D 78 passenger bus to provide student spacing ability due to COVID 19 precautions.

Total for 72710 - Transportation: \$104,406.00

Total for all other Account Numbers: \$171,917.04

Total for all Account Numbers:

\$276,323.04

Adjusted Allocation:

\$276,323.04

Remaining:

\$0.00

Budget Detail

Trenton (273) Public District - FY 2021 - Elementary and Secondary School Emergency Relief (ESSER) - Rev 0 - Elementary and Secondary School Emergency Relief (ESSER)

73100 - Food Service - \$1,615.00

Budget Detail

Narrative Description

Account Number: 73100 - Food Service

To provide substitutes for employees with COVID

Line Item Number: 189 - Other Salaries & Wages

Focus Area: Mental Health Supports

School Type: Traditional Public School

Optional Program Code:

Location Code: Trenton (273)

Quantity: 1.00

Cost: \$1,500.00

Line Item Total: \$1,500.00

Account Number: 73100 - Food Service

Social Security benefits for subs.

Line Item: 201 - Social Security

Number:	
Focus Area:	Mental Health Supports
School Type:	Traditional Public School
Optional Program Code:	
Location Code:	Trenton (273)
Quantity:	1.00
Cost:	\$93.00
Line Item Total:	\$93.00

Account Number: 73100 - Food Service

Line Item Number: 212 - Employer Medicare

Focus Area: Mental Health Supports

School Type: Traditional Public School

Optional Program Code:

Location: Trenton (273)

Benefits for subs

Code:

Quantity:

Cost:

Line Item Total:

Total for 73100 - Food Service:

Total for all other Account Numbers:

Total for all Account Numbers:

Adjusted Allocation:

Remaining:

IDEA Technology Partnership

6/22/2020

19-01

71200 Special Education Program

429 Instructional Supplies and Materials	1,000.00
725 SPED Equipment	4,510.00
Subtotal	5,510.00
47145 Revenue Account	
Total	\$ 5,510.00



Trenton Elementary School

811 South College Street

Trenton, TN 38382

731.855.0971

Cortnee Wilkes, Principal

Lois Ellison, Assistant Principal

School Fees 2020-2021

Kindergarten \$2

Assignment/Homework Folder

First Grade \$7

Assignment/Homework Folder

2 Writing Tablets

Second Grade \$2

Assignment/Homework Folder

Third Grade \$2

Assignment/Homework Folder

Fourth Grade \$2

Assignment/Homework Folder

June 30,2020
New Budget Items

Vocational Educational Program

Battelle Education STEM Grant

Revenue

		Debit	Credit
46590-910	Other State Education Funds	<u>\$10,000.00</u>	
		\$10,000.00	

Expenditures

71300-429-910	Instructional Materials & Supplies		<u>\$10,000.00</u>
			\$10,000.00

Debt Service - Bonds

Money for Indoor Practice Facility - LGIP Building Fund

Revenue

141-49100	Bond Issued	<u>\$1,300,563.21</u>	
		\$1,300,563.21	

Expenditures

141-82330-606	Other Debt Issuance Charges		\$13,158.57
141-76100-706	Building Construction		<u>\$1,287,404.64</u>
			\$1,300,563.21

Bonds Refinanced

Revenue

141-49100	Bonds Issued	<u>\$19,677,100.60</u>	
		\$19,677,100.60	

Expenditures

141-82330-606	Other Debt Issuance Charges		\$229,841.43
141-82130-601	Principal on Bonds		<u>\$19,447,259.17</u>
			\$19,677,100.60

Budget Amendments GP

June 30, 2020

71100 Regular Instruction		Increase	Decrease
		Credit	Debit
Funds needed for Unemployment, Bound Textbooks, Other Charges, Regular Instruction Eq, Other Eq			
71100-210	Unemployment	4000	
71100-449	Bound Textbooks	40000	
71100-599	Other Charges	3000	
71100-722	Regular Instruction Eq.	4000	
71100-790-(005,010,015)	Other Equipment	18000	
71100-116	Teachers		69000
		<u>69000</u>	<u>69000</u>

71150 Alternative Instruction		Increase	Decrease
		Credit	Debit
Funds needed for Teachers, Other Fringe Benefits			
71150-116	Teachers	200	
71150-299	Other Fringe Benefits	40	
71150-201	Social Security		240
		<u>240</u>	<u>240</u>

71200 Special Education		Increase	Decrease
		Credit	Debit
Funds needed for Retirement-Hybrid Stabilization and Other Charges			
71200-217-010	Retirement-Hybrid Stabilization	1300	
71200-599	Other Charges	13100	
71200-116	Teachers		1423
71200-163	Educational Assistants		2092
71200-201	Social Security		1970
71200-204	Sate Retirement		2886
71200-207	Medical Insurance		5507
71200-212	Employer Medicare		400
71200-299	Other Fringe Benefits		122
		<u>14400</u>	<u>14400</u>

Budget Amendments GP
June 30, 2020

71300 Career and Technical Education		Increase	Decrease
		Credit	Debit
Funds needed for Teachers, Certified Subs, NonCertified Subs			
71300-116	Teachers		26
71300-195	Certified Subs		325
71300-198	Non-Certified Subs		340
71300-207	Medical Insurance		691
		<u>691</u>	<u>691</u>

71400 Student Body Education Program		Increase	Decrease
		Credit	Debit
Funds needed for Other Salaries, Social Security, State Retirement, Employer Medicare			
71400-189	Other Salaries & Wages	4300	
71400-201	Social Security	100	
71400-204	State Retirement	400	
71400-212	Employer Medicare	50	
71100 Regular Instruction Program			
71100-116	Teachers		4850
		<u>4850</u>	<u>4850</u>

72110 Attendance		Increase	Decrease
		Credit	Debit
Funds needed for Other Fringe Benefits			
72110-299	Other Fringe Benefits	36	
72110-355	Travel		36
		<u>36</u>	<u>36</u>

Budget Amendments GP

June 30, 2020

72120 Health Services		Increase	Decrease
		Credit	Debit
Funds needed for Retirement-Hybrid Stabilization, Drugs and Medical Supplies, Health Eq			
72120-217	Retirement-Hybrid Stabilization	700	
72120-413	Drugs and Medical Supplies	1300	
72120-735	Health Eq	1350	
72120-204	State Retirement		1350
72120-207	Medical Insurance		1300
72120-524	In Service/Staff Dev		700
		<u>3350</u>	<u>3350</u>

72130 Other Student Support		Increase	Decrease
		Credit	Credit
Funds needed for Guidance Personnel, Social Workers, Other Salaries, Other Fringes, Other Supplies			
72130-123	Guidance Personnel	2	
72130-130-805	Social Workers	1	
72130-189	Other Salaries & Wages	50	
72130-299	Other Finges Benefits	36	
72130-499-805	Other Supplies	70	
72130-309	Contracts with Government Agencies		159
		<u>159</u>	<u>159</u>

72210 Regular Instruction Program		Increase	Decrease
		Credit	Debit
Funds needed for Career Ladder Program, Instructional Computer Personnel, Other Finge Benefits			
72210-117	Career Ladder Program	1000	
72210-138	Instructional Computer Personnel	50	
72210-299	Other Finge Benefits	72	
72210-524	In Service		1122
		<u>1122</u>	<u>1122</u>

Budget Amendments GP
June 30, 2020

72220 Special Education Program		Increase Credit	Decrease Debit
Funds needed for Medical Insurance, Other Contracted Services			
72220-207	Medical Insurance	1600	
72220-399	Other Contracted Services	1800	
71100 Regular Instruction Program			
71100-116	Teachers		3400
		<u>3400</u>	<u>3400</u>
72250 Instructional Technology		Increase Credit	Decrease Debit
Funds needed for Other Charges			
72250-599	Other Charges	7100	
72250-790	Other Equipment		7100
		<u>7100</u>	<u>7100</u>
72310 Board of Education		Increase Credit	Decrease Debit
Funds needed for Travel, Liability Insurance, Trustee Commission, Other Charges			
72310-355	Travel	900	
72310-506	Liability Insurance	725	
72310-510	Trustee Commission	4000	
72310-599	Other Charges	400	
72310-320	Dues and Memberships		4000
72310-534	Refund from Criminal Investigation		2025
		<u>6025</u>	<u>6025</u>

Budget Amendments GP
June 30, 2020

72320 Director of Schools		Increase Credit	Decrease Debit
Funds needed for Career Ladder, Other Fringes, Administrative Eq			
72320-127	Career Ladder Extended Contracts	1000	
72320-299	Other Fringe Benefits	24	
72320-701	Adminstration Eq	1802	
72320-117	Career Ladder Extended Contracts		1000
72320-355	Travel		1826
		<u>2826</u>	<u>2826</u>

72410 Office of The Principal		Increase Credit	Decrease Debit
Funds needed for Accountants/Bookkeepers and Other Fringes			
72410-119	Accountants/Bookkeepers	1	
72410-299	Other Fringes	60	
72410-201	Social Security		61
		<u>61</u>	<u>61</u>

72510 Fiscal Services		Increase Credit	Decrease Debit
Funds needed for Supervisor/Director, Clerical Personnel, Other Fringes, Advertising			
72510-105	Accountants/Bookkeepers	1	
72510-162	Clerical Personnel	1	
72510-299	Other Fringes	17	
72510-302	Advertising	800	
72510-435	Office Supplies		819
		<u>819</u>	<u>819</u>

Budget Amendments GP
June 30, 2020

72520 Human Services/Personnel		Increase	Decrease
		Credit	Debit
Funds needed for Other Fringes			
72520-299	Other Fringes	24	
72520-320	Dues and Memberships		24
		<hr/>	<hr/>
		24	24

72620 Maintenance of Plant		Increase	Decrease
		Credit	Debit
Funds needed for Maintenance and Repair Eqt, Water and Sewer			
72620-336	Maintenance and Repair Eqt	4000	
72620-335	Maintenance and Repair Buildings		4000
		<hr/>	<hr/>
		4000	4000

72710 Transportation		Increase	Decrease
		Credit	Debit
Funds needed for Supervisor/Director, Mechanic(s), Vehicle and Eqt Ins			
72710-105	Supervisor/Director	250	
72710-142	Mechanic(s)	1	
72710-511	Vehicle and Equipment Insurance	3000	
72710-189	Other Salaries & Wages		2880
72710-524	In Service		371
		<hr/>	<hr/>
		3251	3251

73400 Early Childhood Education	Increase	Decrease
---------------------------------	----------	----------

Budget Amendments GP
June 30, 2020

	Credit	Debit
Funds needed for Instructional Supplies		
73400-429 Other Charges		1
71100 Regular Instruction Program		
71100-116 Teachers		<u>1</u>
	<u>1</u>	<u>1</u>
Total Amendments	121355	121355

Budget Amendments PreK

Early Childhood Education - PreK	Increase Credit	Decrease Debit
----------------------------------	--------------------	-------------------

Additional funds needed for Subs, State Retirement, Medical Insurance, and Other Contracted Services		
141-73400-198	Non-Certified Substitute Teachers	670
141-73400-204	State Retirement	388
141-73400-207	Medical Insurance	2,623
141-73400-399	Other Contracted Services	6,497
141-73400-105	Supervisor/Director	584
141-73400-116	Teachers	4800
141-73400-162	Clerical	253
141-73400-163	Educational Assistants	2072
141-73400-189	Other Salaries & Wages	74
141-73400-201	Social Security	928
141-73400-212	Employer Medicare	202
141-73400-355	Travel	1265
Total PreK Budget Amendments		10,178

Additional funds needed for Supervisor/Director and Other Contracted Services		
141-73400-105	Supervisor/Director	1
141-73400-399	Other Contracted Services	800
141-73400-201	Social Security	200
141-73400-204	State Retirement	601
Total PreK Budget Amendments		801

Budget Amendments Safe Schools

Safe Schools

Additional Funds needed for Contracts with Government Agencies

		Increase Credit	Decrease Debit
141-72130-309-055	Other Student Support - Contracts with Government Agencies	15000	
141-72130-790-055	Other Student Support - Other Equipment		15000
	Total Safe Schools Amendments	15000	15000

Budget Amendments CSH

CSH
 Additional Funds needed for Communication, Postage, and Other Supplies and Materials

	Increase Credit	Decrease Debit
141-72120-307-300 Communication	65	
141-72120-348-300 Postage	115	
141-72120-499-300 Other Supplies & Materials	2174	
141-72120-189-300 Other Salaries & Wages		6
141-72120-201-300 Social Security		340
141-72120-207-300 Medical Insurance		14
141-72120-212-300 Employer Medicare		80
141-72120-355-300 Travel		1293
141-72120-399-300 Other Contracted Services		621
Total CSH Amendments	2354	2354

Bus Garage Budget Amendments

Bus Garage

Additional Funds needed for Supervisor/Director

		Increase Credit	Decrease Debit
144-72710-105	Supervisor/Director	61	
141-72120-201	Social Security		61
	Total Bus Garage Amendments	61	61

2020-2021 Differentiated Pay Plan

Trenton Special School District will continue to pay based on years of experience and education level. The current salary schedule has 0 to 20 plus years of experience. Education is broken down in Bachelors, Masters, Masters Plus 45, EDS, and Doctorate.

Additional compensation will be paid for hard to staff positions. Hard to staff positions have been defined as secondary math, secondary science, and foreign language. New hires in these categories are eligible for a \$2,000 sign-on bonus. This bonus is recurring each year as a retention bonus. These teachers are also eligible for a \$2,000 performance bonus. An additional \$2,000 bonus may be earned when evidence of satisfactory evaluation results is available. Existing teachers in these areas would be eligible for the additional \$2,000 when satisfactory evaluation results are available.

TSSD will compensate teachers for performing additional roles which are annually identified based on district needs. Eligible teachers must score a 4 or above and meet attendance requirements. The compensation will be given annually in the form of a stipend. Three teachers have been identified through the Teacher Leader program to provide support in communication. The stipend is \$2,500. One teacher has been identified to provide additional support to the secondary Mathematics program.

Click here to choose a school board.

Monitoring: Review: Annually, in August	Descriptor Term: Emergency Closings	Descriptor Code: 1.8011	Issued Date:
		Rescinds:	Issued:

1 *General*

2 The Board authorizes the Director of Schools to close schools in the event of hazardous weather, a public
3 health emergency, or any other emergency which presents a threat to the safety of students, staff
4 members, or school property.¹

5 As soon as the decision to close schools is made, the Director of Schools will notify the public media
6 and request that an announcement be made.

7 If school is not in session or is dismissed early due to snow or inclement weather, the Director of Schools
8 in consultation with the principal(s) of the impacted school(s) shall determine if all scheduled activities
9 in which students are involved shall be postponed or cancelled.

10 **EMPLOYEE RESPONSIBILITIES**

11 In the event of an emergency that requires closure of a school building, group of schools, or the entire
12 district, the Director of Schools is authorized to continue to pay employees who are not able to physically
13 report for duty as a result. These employees shall receive their regular wages. Such payments shall not
14 exceed the number of days budgeted for each employee.

15 During such emergencies, the Director of Schools may designate certain employees as essential. Such
16 employees shall work as directed by the Director of Schools, whether that is by physical appearance at
17 work or teleworking under Policy 5.1151. Essential employees must use leave to be excused from work
18 absent special permission as determined by the Director of Schools/designee.

Legal References

1. TCA 49-6-3004(e)(1); TRR/MS 0520-01-03-.02(1)(b)

Cross References

Emergency Preparedness Plan 3.202
Telework During Emergencies 5.1151

Click here to choose a school board.

Monitoring: Review: Annually, in January	Descriptor Term: Telework During Emergencies	Descriptor Code: 5.1151	Issued Date:
		Rescinds:	Issued:

1 *General*

2 Teleworking is a work arrangement where designated employees are allowed to perform their normal
3 duties and responsibilities through the use of hardware and software at an alternate location from their
4 normal work site.

5 The Director of Schools may require an employee to telework if the duties and responsibilities of the
6 position are required during times of emergency. An employee's participation in the program will be
7 determined by the length and duration of the emergency and will be both initiated and ended at the
8 discretion of the supervisor and/or the Director of Schools.

9 **WORK ENVIRONMENT**

10 Employees approved for telework shall maintain a dedicated and safe work environment.

11 An employee who teleworks shall not allow anyone other than district employees to utilize district
12 provided services or equipment. Employees shall keep remote work and information confidential, in
13 accordance with district policies, procedures, and applicable privacy laws.
14

Cross References

Emergency Closings 1.8011

Click here to choose a school board.			
Monitoring: Review: Annually, in January	Descriptor Term: FFCRA LEAVE	Descriptor Code: 5.3051	Issued Date: Click here to enter a date.
		Rescinds:	Issued:

1 *General*¹

2 Under the Families First Coronavirus Response Act (FFCRA), this policy will be in effect from April 1,
3 2020 until December 31, 2020.

4 The Director of Schools/designee shall post notice of FFCRA requirements and create any necessary
5 administrative procedures. Employees should seek clarification from Trenton Special School District if
6 they have questions regarding the total amount of leave and pay available to them.

7 **PAID SICK LEAVE**

8 Employees are entitled to up to two (2) weeks of paid sick leave if they are unable to work or telework
9 because the employee:²

- 10 1. is subject to a Federal, State, or local quarantine or isolation order related to COVID-19;
- 11
- 12 2. has been advised by a health care provider to self-quarantine related to COVID-19;
- 13
- 14 3. is experiencing COVID-19 symptoms and is seeking a medical diagnosis;
- 15
- 16 4. is caring for an individual subject to or advised to quarantine or isolate due to COVID-19. The
- 17 individual must be someone with a personal relationship to the employee;
- 18
- 19 5. is caring for his/her son or daughter whose school or place of care is closed, or person who
- 20 regularly provides child care is unavailable, for reasons related to COVID-19 and no other
- 21 suitable person is available to care for the child during the requested period of leave. Son or
- 22 daughter is defined as a biological, adopted, or foster child, a stepchild, a legal ward, or a child
- 23 of a person standing *in loco parentis*, who is under 18 years of age; or 18 years of age or older
- 24 who is incapable of self-care because of a mental or physical disability; or
- 25
- 26 6. is experiencing any other substantially similar condition specified by the Secretary of Health
- 27 and Human Services, in consultation with the Secretaries of Labor and Treasury.

28 This paid leave may be taken if there is work available for the employee to complete and the employee
29 is unable to work or telework for one of the above reasons. Such leave is in addition to any paid leave
30 that an employee may already be entitled to (e.g. existing sick leave). Employees are not required to
31 exhaust any other paid leave benefit in order to utilize this new category of paid sick leave.

1 EXPANDED FMLA LEAVE

2 Full-time or part-time employees who have been on the payroll for thirty (30) calendar days prior to the
 3 beginning of the leave are eligible for expanded FMLA leave (EFMLEA). This includes employees who
 4 were laid off or terminated after March 1, 2020, who had worked for the district for at least thirty (30)
 5 of the prior sixty (60) calendar days and were subsequently rehired or otherwise employed by the
 6 district.³

7 Under the FFCRA, an employee qualifies for EFMLEA leave if the employee is unable to work or
 8 telework due the need to care for his/her son or daughter because of a school or child care facility closure
 9 or because the person who regularly provides child care (i.e. this could include a family member or a
 10 neighbor) is unavailable for reasons related to COVID-19.⁴ In these circumstances, a son or daughter is
 11 defined as a biological, adopted, or foster child, a stepchild, a legal ward, or a child of a person standing
 12 *in loco parentis*, who is under 18 years of age; or 18 years of age or older who is incapable of self-care
 13 because of a mental or physical disability.

14 Qualifying employees may take twelve (12) weeks of EFMLEA leave.⁵ The amount of leave available
 15 may be impacted by any prior use of FMLA.⁶

16 The first ten (10) days of EFMLEA leave shall be unpaid, however, an employee may choose to take
 17 any existing leave benefit during this time. After ten (10) days, EFMLEA leave is paid at two-thirds
 18 (2/3) the rate of the employee's regular rate of pay, unless he/she chooses to utilize accrued sick leave
 19 or annual leave to cover those days or the amount is capped per federal law.⁷

Legal References

1. Families First Coronavirus Response Act, Pub. L. No. 116-127, §§ 3102, 5101, et seq. (2020)
2. 29 CFR § 826.20(a); 29 CFR § 826.21; 29 CFR § 826.30(a)
3. 29 CFR § 826.30(b); Coronavirus Aid, Relief, and Economic Security Act (CARES Act), § 3605 (2020)
4. 29 CFR § 826.20(b)
5. 29 CFR § 826.23
6. 29 CFR § 826.23(b); 29 CFR § 826.70
7. 29 CFR § 826.24

Cross References

Sick Leave 5.302
 Family and Medical Leave 5.305

Trenton Special Board of Education

Monitoring: Review: Annually, in April	Descriptor Term: Student Concerns, Complaints, and Grievances	Descriptor Code: 6.305	Issued Date: 07/13/99
		Rescinds:	Issued:

1 STUDENT CONCERNS AND COMPLAINTS

2 Decisions made by school personnel — such as aides, teachers, or assistant principals — which
3 students believe are unfair or in violation of pertinent policies of the Board or individual school rules
4 may be appealed to the school principal or a designated representative. To appeal, students will contact
5 the principal's office in their school and provide their name, the issue and the reason for their appeal on
6 a printed form available at the school office within two days. The appeal will usually be decided
7 confidentially and promptly, preferably within five (5) school days.

8 However, if the principal does not make a decision within five (5) school days following the date of
9 complaint, students or parents may appeal at that time by contacting the director of schools/designee at
10 the central office. The information provided should include the student's name, the school and a
11 description of the problem.

12 An investigation and decision will be made within two (2) school days and communicated to the
13 school principal and student by telephone. A written copy of the decision also will be sent to the
14 student and the principal.

15 ~~DISCRIMINATION/HARASSMENT GRIEVANCE PROCEDURES~~

16 ~~*Filing a Complaint* — Any student of this school district who wishes to file a~~
17 ~~discrimination/harassment grievance against another student or an employee of the district may file a~~
18 ~~written or oral (recorded, if possible) complaint with a complaint manager.¹ Students may also report~~
19 ~~an allegation of discrimination/harassment to any teacher or other adult employed in the school who~~
20 ~~shall inform a complaint manager of the allegation. The complaint should include the following~~
21 ~~information:~~

- 22 _____ Identity of the alleged victim and person accused;
23 _____ Location, date, time and circumstances surrounding the alleged incident;
24 _____ Description of what happened;
25 _____ Identity of witnesses; and
26 _____ Any other evidence available.

27 ~~*Investigation* — Within twenty four hours of receiving the student's complaint, the complaint manager~~
28 ~~shall notify the complaining student's parent/guardian and the principal who shall inform the director~~
29 ~~of schools. The parent/guardian shall be given notice of the right to attend an interview of the student~~
30 ~~in a non-intimidating environment in order to elicit full disclosure of the student's allegations. This~~
31 ~~interview shall take place within five (5) days from the time the complaint was first made. If no~~

parent/guardian attends the interview, another adult, mutually agreed upon by the student and the complaint manager, shall attend and may serve as the student's advocate. After a complete investigation, if the allegations are substantiated, immediate and appropriate corrective or disciplinary action shall be initiated. The complaint and identity of the complainant will not be disclosed except (1) as required by law or this policy; or (2) as necessary to fully investigate the complaint; or (3) as authorized by the complainant. A school representative will meet with and advise the complainant regarding the findings, and whether corrective measures and/or disciplinary action were taken. The investigation and response to the complainant will be completed within thirty (30) school days. Copies of the report will be sent to the student, principal, Federal Rights Coordinator and the director of schools. One copy shall be kept in the complaint manager's file for one (1) year beyond the student's eighteenth (18th) birthday. The director of schools shall keep the Board informed of all complaints.

Decision and Appeal— If the complainant is not in agreement with the findings of fact as reported by the complaint manager, an appeal may be made, within five (5) work days to the director of schools. The director of schools will review the investigation, make any corrective action deemed necessary and provide a written response to the complainant. If the complainant is not in agreement with the director of schools' findings of fact, appeal may be made to the Board of Education within five (5) work days. The Board shall, within thirty (30) days from the date the appeal was received, review the investigation and the actions of the director of schools and may support, amend or overturn the actions based upon review and report their decision in writing to the complainant.

APPOINTING COMPLAINT MANAGERS

The director of schools shall appoint at least two complaint managers, one of each gender for each school. The Federal Rights Coordinator may serve as a complaint manager. The director of schools shall insert into this policy the names, addresses and telephone numbers of current complaint managers. *(see note)*

This policy shall be published in the parent/student handbook distributed annually to every student. Building administrators are responsible for educating and training their respective staff and students as to the definition and recognition of discrimination/harassment.

(Note: Title IX regulations require districts to identify the name, address and telephone number of the person who is responsible for coordinating the district's compliance efforts. A policy should not be adopted with a person's name in it; rather, the identifying information can be added and amended as necessary.

Legal References:

1. Title IX, Education Amendment of 1972, 20 U.S.C. §1681, et seq.

Cross References:

- Appeals To & Appearances Before the Board 1.404
- Section 504/ADA Grievance Procedures 1.802
- Discrimination/Harassment of Students 6.304
- Sexual Harassment Complaint—
- Notes to the Investigator 6.305.1 (AP)

Click here to choose a school board.

Monitoring: Review: Annually, in March	Descriptor Term: Student Concerns	Descriptor Code: 6.305	Issued Date:
		Rescinds:	Issued:

1 Decisions made by school personnel, such as aides, teachers, or assistant principals, which students
2 believe are unfair or in violation of pertinent policies of the Board or individual school rules may be
3 appealed to the school principal/designee. To appeal, students shall contact the principal's office in their
4 school and provide their name, the issue, and the reason for their appeal on a printed form available at
5 the school office within two (2) days. The appeal shall be decided confidentially and promptly, preferably
6 within 2 school days.

7 However, if the principal does not make a decision within 5 school days, students or
8 parent(s)/guardian(s) may appeal at that time by contacting the Director of Schools/designee at the
9 central office. The information provided should include the student's name, the school, and a description
10 of the problem.

11 An investigation and decision shall be made within two (2) school days and communicated to the school
12 principal and student by telephone. A written copy of the decision also shall be sent to the student and
13 the principal.

Cross References

Appeals To & Appearances Before the Board 1.404
Instructional Program 4.100
Student Discrimination, Harassment, Bullying, Cyber-
bullying, and Intimidation 6.304
Title IX & Sexual Harassment 6.3041

LASHLEE-RICH, INC.

GENERAL CONTRACTORS



CONSTRUCTION MANAGERS

P. O. BOX 483 • 1100 EAST MAIN STREET • (731) 784-2461 • HUMBOLDT, TENNESSEE 38343-0483

FAX NUMBER (731) 784-6483

June 18, 2020

Trenton Special School District
Attn: Mr. Tim Haney
Director of Schools
201 West 10th Street
Trenton, TN 38382

**RE: INDOOR ATHLETIC PRACTICE FACILITY
PEABODY HIGH SCHOOL
2069 U.S. HIGHWAY 45 BYPASS
TRENTON, TN**

Dear Mr. Haney:

We propose to furnish all labor, materials and equipment necessary to complete the project referenced above for the Guaranteed Maximum Price of \$2,068,669.00. → adjusted to \$1,899,000.

The Guaranteed Maximum Price is based on the Plans and Specifications as prepared by IDesign Architecture Group and the attached list of Assumptions and Clarifications.

Also, attached is a list of Value Engineering items to be considered. Decisions regarding these items would need to be made prior to beginning construction of the project.

pages 7 + 8 → all circled items are cuts that made the reduction possible.



Page 2
Trenton Special School District
June 18, 2020

In accordance with the proposal of September 30, 2019, we propose to complete the work as indicated on the basis of **Cost of the Work** plus the **Construction Management Fee** indicated. If the **Cost of the Work** plus the **Construction Manager's Fee** is greater than the **Guaranteed Maximum Price**, Trenton Special School District is only responsible for the **Guaranteed Maximum Price**.

If the **Cost of the Work** plus the **Construction Manager's Fee** is less than the **Guaranteed Maximum Price**, all savings accrue to Trenton Special School District.

Due to rapidly escalating prices, we can hold this price firm for thirty (30) days.

All of us at Lashlee-Rich, Inc. look forward to working with you on this project.

Yours truly,

LASHLEE-RICH, INC.

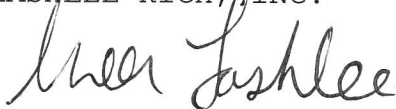

Greer Lashlee, President

GL:vh

greer.lashlee@gmail.com

(731-420-0503) cell

Tennessee License	#1148
License Issued:	January 7, 1943
License Expires:	January 31, 2022
Type of License:	BC-B (Commercial)
Limit of License:	Unlimited

**ASSUMPTIONS AND CLARIFICATIONS
INDOOR ATHLETIC PRACTICE FACILITY
PEABODY HIGH SCHOOL
TRENTON, TN
JUNE 18, 2020**

The Guaranteed Maximum Price (GMP) is based on the following Assumptions and Clarifications:

We have not included any work on Sheet L101, Landscaping.

We have included seeding and sodding in accordance with the attached drawings.

We have included baked enamel toilet compartments rather than solid plastic laminate.

We have not included any lettering, logos, or athletic figures for the outside of the building.

The Owner will provide the Builder's Risk Insurance.

We have assumed that there will be no charge for a City of Trenton Building Permit.

When the permanent utility meters are set, the Owner will be responsible for the utility charges.

Due to the size of the site, we do not believe that SWAPP is required; therefore, we have not included the cost of same or inspection and reporting in connection with erosion control.

Site grading is based on being able to spread the excess dirt on the site. Dirt will be spread evenly and seeded.

We have not included any bleachers.

The occupancy required signage will be by the Owner.

We have not included any painting of the ductwork inside the practice area.

The steel columns for the pre-engineered metal building will be shop primed only with no finish painting.

We have not included an underground storm drainage system for the downspouts.

The five (5) year color fading warranty for the metal building wall panels does not extend to the metal awnings.

We have not included any special floor covering in the weight area.

We have not included any data, communication systems or cameras.

We have included twelve (12) wall mounted fire extinguishers but no cabinets are included.

As no geotechnical work was completed for the site, we have assumed that proper soil bearing is achievable and no allowance for unsuitable soil is included.

We have not included any electrical cable trays.

The specifications for the synthetic turf flooring did not include the cost of a shock pad.

We have not included a radio booster system.

LANDSCAPE NOTES:

1. ALL PLANTING SHALL BE DONE IN ACCORDANCE WITH THE CITY OF TRENTON, NEW JERSEY, LANDSCAPE DESIGN AND INSTALLATION MANUAL.
2. ALL PLANTING SHALL BE DONE IN ACCORDANCE WITH THE CITY OF TRENTON, NEW JERSEY, LANDSCAPE DESIGN AND INSTALLATION MANUAL.
3. ALL PLANTING SHALL BE DONE IN ACCORDANCE WITH THE CITY OF TRENTON, NEW JERSEY, LANDSCAPE DESIGN AND INSTALLATION MANUAL.
4. ALL PLANTING SHALL BE DONE IN ACCORDANCE WITH THE CITY OF TRENTON, NEW JERSEY, LANDSCAPE DESIGN AND INSTALLATION MANUAL.
5. ALL PLANTING SHALL BE DONE IN ACCORDANCE WITH THE CITY OF TRENTON, NEW JERSEY, LANDSCAPE DESIGN AND INSTALLATION MANUAL.
6. ALL PLANTING SHALL BE DONE IN ACCORDANCE WITH THE CITY OF TRENTON, NEW JERSEY, LANDSCAPE DESIGN AND INSTALLATION MANUAL.
7. ALL PLANTING SHALL BE DONE IN ACCORDANCE WITH THE CITY OF TRENTON, NEW JERSEY, LANDSCAPE DESIGN AND INSTALLATION MANUAL.
8. ALL PLANTING SHALL BE DONE IN ACCORDANCE WITH THE CITY OF TRENTON, NEW JERSEY, LANDSCAPE DESIGN AND INSTALLATION MANUAL.
9. ALL PLANTING SHALL BE DONE IN ACCORDANCE WITH THE CITY OF TRENTON, NEW JERSEY, LANDSCAPE DESIGN AND INSTALLATION MANUAL.
10. ALL PLANTING SHALL BE DONE IN ACCORDANCE WITH THE CITY OF TRENTON, NEW JERSEY, LANDSCAPE DESIGN AND INSTALLATION MANUAL.
11. ALL PLANTING SHALL BE DONE IN ACCORDANCE WITH THE CITY OF TRENTON, NEW JERSEY, LANDSCAPE DESIGN AND INSTALLATION MANUAL.
12. ALL PLANTING SHALL BE DONE IN ACCORDANCE WITH THE CITY OF TRENTON, NEW JERSEY, LANDSCAPE DESIGN AND INSTALLATION MANUAL.
13. ALL PLANTING SHALL BE DONE IN ACCORDANCE WITH THE CITY OF TRENTON, NEW JERSEY, LANDSCAPE DESIGN AND INSTALLATION MANUAL.
14. ALL PLANTING SHALL BE DONE IN ACCORDANCE WITH THE CITY OF TRENTON, NEW JERSEY, LANDSCAPE DESIGN AND INSTALLATION MANUAL.
15. ALL PLANTING SHALL BE DONE IN ACCORDANCE WITH THE CITY OF TRENTON, NEW JERSEY, LANDSCAPE DESIGN AND INSTALLATION MANUAL.
16. ALL PLANTING SHALL BE DONE IN ACCORDANCE WITH THE CITY OF TRENTON, NEW JERSEY, LANDSCAPE DESIGN AND INSTALLATION MANUAL.
17. ALL PLANTING SHALL BE DONE IN ACCORDANCE WITH THE CITY OF TRENTON, NEW JERSEY, LANDSCAPE DESIGN AND INSTALLATION MANUAL.
18. ALL PLANTING SHALL BE DONE IN ACCORDANCE WITH THE CITY OF TRENTON, NEW JERSEY, LANDSCAPE DESIGN AND INSTALLATION MANUAL.
19. ALL PLANTING SHALL BE DONE IN ACCORDANCE WITH THE CITY OF TRENTON, NEW JERSEY, LANDSCAPE DESIGN AND INSTALLATION MANUAL.
20. ALL PLANTING SHALL BE DONE IN ACCORDANCE WITH THE CITY OF TRENTON, NEW JERSEY, LANDSCAPE DESIGN AND INSTALLATION MANUAL.

TREE STAKING DETAIL



SHRUB / GROUND COVER PLANTING

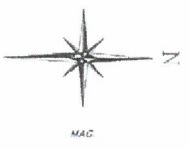
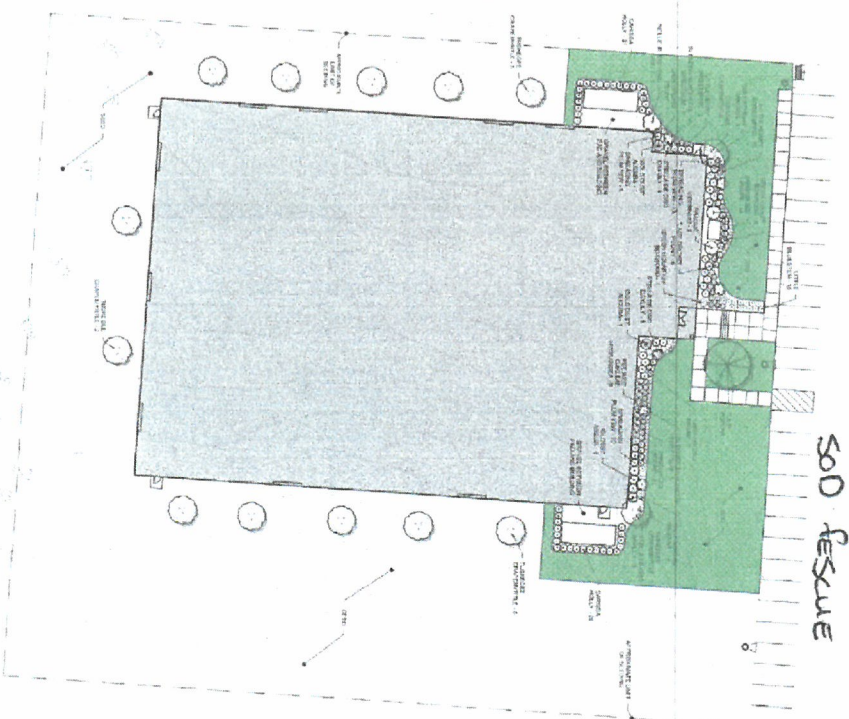

Kitta Design
2075 Main Street
Trenton, NJ 08611
609-972-1234

Kevin Scott, B.S.
Landscape Architect
2075 Main Street
Trenton, NJ 08611
609-972-1234

PLANT SCHEDULE

QTY	SYMBOL	COMMON NAME	HEIGHT (TYPICAL)	SPACING	COMMENTS
1	[Symbol]	Plant Name	6' - 8'	12' x 12'	Plant Name
2	[Symbol]	Plant Name	4' - 6'	12' x 12'	Plant Name
3	[Symbol]	Plant Name	2' - 4'	12' x 12'	Plant Name
4	[Symbol]	Plant Name	1' - 2'	12' x 12'	Plant Name
5	[Symbol]	Plant Name	1' - 2'	12' x 12'	Plant Name
6	[Symbol]	Plant Name	1' - 2'	12' x 12'	Plant Name
7	[Symbol]	Plant Name	1' - 2'	12' x 12'	Plant Name
8	[Symbol]	Plant Name	1' - 2'	12' x 12'	Plant Name
9	[Symbol]	Plant Name	1' - 2'	12' x 12'	Plant Name
10	[Symbol]	Plant Name	1' - 2'	12' x 12'	Plant Name
11	[Symbol]	Plant Name	1' - 2'	12' x 12'	Plant Name
12	[Symbol]	Plant Name	1' - 2'	12' x 12'	Plant Name
13	[Symbol]	Plant Name	1' - 2'	12' x 12'	Plant Name
14	[Symbol]	Plant Name	1' - 2'	12' x 12'	Plant Name
15	[Symbol]	Plant Name	1' - 2'	12' x 12'	Plant Name
16	[Symbol]	Plant Name	1' - 2'	12' x 12'	Plant Name
17	[Symbol]	Plant Name	1' - 2'	12' x 12'	Plant Name
18	[Symbol]	Plant Name	1' - 2'	12' x 12'	Plant Name
19	[Symbol]	Plant Name	1' - 2'	12' x 12'	Plant Name
20	[Symbol]	Plant Name	1' - 2'	12' x 12'	Plant Name

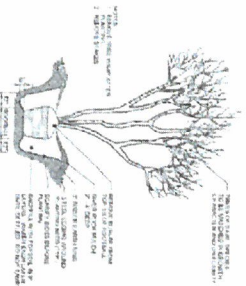

MULTI-TRUNK TREE PLANTING

TRENTON SCHOOL PROPERTY
DEED BOOK 916, PAGE 1764

iDesign
Architecture Group

808 North Star Drive
Trenton, NJ 08611
609-972-1234

Indoor Athletic Practice Facility
Trenton Peabody High School

2008 US HWY 10 Bypass
Trenton, TN 38192

Kevin Scott
5-8-20

Sheet Number
L101

**INDOOR ATHLETIC PRACTICE FACILITY
PEABODY HIGH SCHOOL
V.E. ITEMS**

- 1) OMIT (3) CMU WALLS AT THE STORAGE AREA. (STILL HAVE (1) LARGE STORAGE AREA)
DEDUCT \$7,950.00

- 2) OMIT THE 4" SPLIT FACED CMU VENEER AT THE FRONT OF THE BUILDING. (EXTERIOR WILL STILL HAVE CMU)
DEDUCT \$13,700.00

- 3) OMIT THE SOLID SURFACE VANITIES AND INSTALL WALL HUNG SINKS IN THE RESTROOMS.
DEDUCT \$7,707.00

- 4) CHANGE THE ALUMINUM STORE FRONT DOORS TO NARROW STILE IN LIEU OF MEDIUM STILE, USE STANDARD PIVOT HINGES IN LIEU OF CONTINUOUS HINGES, USE ¼" GLASS IN LIEU OF INSULATED GLASS AND OMIT THE LOCKING ON THE VESTIBULE DOORS.
DEDUCT \$3,000.00

- 5) OMIT (5) OVERHEAD DOORS AND CHANGE THE REMAINING (4) TO 20,000 CYCLE SPRINGS IN LIEU OF 75,000.
DEDUCT \$22,200.00

- 6) OMIT THE HVAC CHASES AND THE COLUMN WRAPS ON THE NORTH WALL OF THE PRACTICE AREA.
DEDUCT \$3,296.00

- 7) OMIT THE CERAMIC TILE ON THE WALLS OF THE RESTROOMS AND INSTALL EPOXY PAINT AND OMIT THE CERAMIC TILE FROM THE FLOORS IN THE RESTROOMS AND FRONT ENTRANCE AND SEAL WITH CLEAR SEALER.
DEDUCT \$12,390.00

- 8) OMIT THE PAINTED CONCRETE FLOORS AND SEAL WITH CLEAR SEALER IN THE PRACTICE AREA.
DEDUCT \$1,400.00

- 9) OMIT THE METAL AWNINGS ON THE EAST, SOUTH AND WEST WALLS.
DEDUCT \$36,075.00

- 10) CHANGE THE METAL LINER PANEL IN THE PRACTICE AREA TO 16' ABOVE FINISH FLOOR IN LIEU OF FULL HEIGHT.
DEDUCT \$33,500.00

11) CHANGE WALL HUNG TOILETS TO FLOOR TYPE TOILETS AT THE RESTROOMS.
DEDUCT \$1,100.00

12) OMIT (4) DRINKING FOUNTAINS IN THE PRACTICE AREA.
DEDUCT \$9,344.00

13) CHANGE METAL SPIRAL DUCT TO FABRIC DUCT IN THE PRACTICE AREA.
DEDUCT \$5,300.00

14) USE MC CABLE IN LIEU OF CONDUIT FOR LIGHTING CIRCUITS, USE ALUMINUM BUS IN LIEU OF COPPER AT THE PANELS, USE ALUMINUM WINDINGS IN LIEU OF COPPER IN THE TRANSFORMER, OMIT SURGE PROTECTION DEVICES IN PANELS, USE 1/2" CONDUIT IN LIEU OF 3/4" AND USE A DIFFERENT LIGHTING PACKAGE.
DEDUCT \$9,850.00

15) OMIT (2) HOLLOW METAL DOORS, FRAMES AND HARDWARE AT THE STORAGE AREA.
DEDUCT \$1,876.00

TOTAL SAVINGS \$168,688.00

SIGN OPTIONS

TO PAINT THE LETTERS, LOGOS AND SPORTS FIGURES ON THE METAL WALL PANELS SHOWN ON THE DRAWINGS.

ADD \$30,000.00

TO INSTALL THE 8' TIDE CIRCLE AND THE PEABODY GOLDEN TILE LETTERS ON THE NORTH CORNER.

ADD \$13,500.00 *move to middle of building*

TO INSTALL THE 8' TIDE CIRCLE AND THE PEABODY GOLDEN TIDE LETTERS ON THE WEST CORNER.

ADD \$13,500.00

TO INSTALL THE 4' TIDE CIRCLE AND THE GOLDEN TIDE LETTERS AT THE FRONT ENTRANCE.

ADD \$6,355.00

TO ADD SPORTS FIGURES WITH PERFORATION FILM GRAPHICS TO THE (2) OVERHEAD GLASS DOORS ON THE WEST SIDE AND TO THE (2) EXTERIOR WINDOWS ON THE NORTH SIDE.

ADD \$5,600.00



Date: 6-16-2020

To: Douglas Short
IDesign Architecture Group
86B North Star Drive
Jackson TN 38305

RE: Approval of Plans
Indoor Athletic Practice Facility
2069 US HWY 45 Bypass
Trenton TN 38382

TFM # 02052-A
Project # 2020-02-19-02
County: Gibson

Dear Doug,,

The construction documents submitted to our office for the above referenced project have been reviewed for compliance with the minimum standards for fire prevention, fire protection, and building construction safety of the *Rules of Tennessee Department of Commerce and Insurance, Division of Fire Prevention, Chapter 0780-02-02, Codes and Standards*.

This is a public building. Therefore, it is subject to Tenn. Code Ann. § 68-102-201, et seq., the Tennessee Public Building Accessibility Act. It has been reviewed for compliance with the 2010 ADA Standards for Accessible Design. It has not been reviewed for compliance with the Americans with Disabilities Act.

Plans are approved with the following stipulations

Stipulation 1:

Provide shop drawings for the pre-engineered steel structure. The drawings shall list the currently adopted codes and contain all details pertinent to the erection of the building's structural system. The design of pre-engineered steel structures, or structural components such as joists and trusses, must be prepared, sealed, signed, and dated by a Tennessee registrant. Rule 0780-02-03-.03(1)(a)
Note that stipulations must be satisfied by sealed construction documents before such work is performed. A Certificate of Occupancy (CO) will not be issued if stipulations are not satisfied.
Rule 0780-02-03-.10.

Stipulation 2:

Engineered wood truss Shop drawings must be submitted prior to installation. The engineer of record will document his or her review of the shop drawings using a review stamp. This is an engineer's acceptance of the shop drawings as meeting the provisions of the code and his or her design intent. Where required by the engineer of record, each individual truss design drawing shall bear the seal and

signature of the truss designer. 2303.4.1.4.

If this is a "phased construction" project, construction may not proceed past the approved stage.
Rule 0780-02-03-.02.

No approval of plans, or failure to review, plans, and specifications by the Division shall relieve the owner, developer, contractor, or designing architect or engineer of their respective responsibilities for compliance with applicable codes respecting fire prevention, fire protection, and building construction. Rule 0780-02-03-.05.

Approved plans are available electronically at <https://apps.tn.gov/tnsfmo/>. They must be printed with all markups and stamps and placed at the project site prior to construction. They shall be available to the State Fire Marshal's Office inspector and retained until a CO has been issued by the Division. Failure to have the plans at the site and available to the inspector may be grounds for a Stop Work Order to be issued. Rule 0780-02-03-.05.

All subsequent construction document revisions that impact the approved plan's fire prevention, fire protection, or building construction safety must be submitted to this office for review and approval.
Rule 0780-02-03-.02.

New buildings shall have approved radio coverage for emergency responders within the building based upon the existing coverage levels of the public safety communication systems of the jurisdiction at the exterior of the building. Emergency responder radio coverage must be verified in the field prior to the issuance of a CO. The test should be performed by the local fire department after interior and exterior walls and the roof are constructed.

The project's contractor must contact the Tennessee State Fire Marshal's Office inspector prior to construction to ensure that the proper inspections are performed. A CO will be issued after work is completed and all inspections are performed and satisfied. The building must have a CO before it may be occupied. Rule 0780-02-03-.10.

Sincerely,



James E. Snider, Plans Examiner II
Codes Enforcement Section

cc: Mark Sykes, DSFM
Attachment: Requirements for inspections of construction

Approval: A-4, 1 Story, 2B Construction, Unsprinklered



JUSTIN P. WILSON
Comptroller

JASON E. MUMPOWER
Deputy Comptroller

Memorandum

Date: June 23, 2020

To: Tennessee Local Government Officials, Leaders, and Legal Representatives

From: Office of the Tennessee Comptroller of the Treasury

Subject: Public Meetings by Electronic Means

Please be advised that Governor Bill Lee's Executive Order No. 34 granting local governing bodies the ability to conduct essential business by electronic means is set to expire on June 30, 2020. Governor Lee has indicated to our Office that he does not intend to extend this authority beyond that date.

Beginning July 1, 2020, Tennessee's local governing bodies must return to conducting public meetings in a method consistent with the requirements of the Tennessee Open Meetings Act (TOMA).

With few exceptions, members of local governing bodies must be physically present to participate and vote. Actions taken during a meeting that is in violation of TOMA are void and of no effect.

Please feel free to reach out to our Office of Open Records Counsel (OORC) if you have any questions related to open meetings. The OORC can be reached at open.records@cot.tn.gov.

Thank you for your attention to this important matter.

A handwritten signature in blue ink that reads "Justin P. Wilson".

Justin P. Wilson
Comptroller of the Treasury

A handwritten signature in blue ink that reads "Jason E. Mumpower".

Jason E. Mumpower
Deputy Comptroller

2020-2021
Trenton Special School District
Regular School Board Meetings

July 28, 2020

August – No Meeting

September 1, 2020

October 13, 2020

November 3, 2020

December 1, 2020

January 5, 2021 – If needed

February 9, 2021

March 2, 2021

April 6, 2021

May 4, 2021

June 29, 2021



Parra, Shannon <shannon.parra@trentonssd.org>

DETAILS: TSBA 2020 Leadership Conference & Annual Convention

1 message

TSBA <bmassey@tsba.net>
Reply-To: TSBA <bmassey@tsba.net>
To: shannon.parra@trentonssd.org

Thu, Apr 30, 2020 at 10:15 AM

DETAILS: TSBA 2020 Leadership Conference & Annual Convention

[View this email in your browser](#)



This year's Leadership Conference and Annual Convention will provide thought provoking general session speakers, informative breakout sessions on best school practices, award recognition for excellence in education and the opportunity to interact with a variety exhibitors that provide products and services for your schools. Please find details about this year's event below. We hope to see you there!

All of the below functions can be registered for by selecting the "Attendee Online Registration" button below. Registration for the Annual Convention is not required in order to register for the Leadership Conference or Pre-Convention Workshops.

Leadership Conference

Thursday, November 12 – Friday, November 13

Leadership Conference Registration Fee: \$175

This conference will fulfill the annual training requirement for Board Members. Superintendents will receive one (1) day of CEO credit for this conference.

[Agenda](#)

Pre-Convention Workshops

Friday, November 13

Pre-Convention Workshop Registration Fee: \$75

The Pre-Convention Legal and Legislative Advocacy Workshops will be held on Friday of this year's convention. You may only register for one of these workshops since they occur simultaneously.

[Pre-Convention Legal Workshop Agenda](#)

[Pre-Convention Legislative Advocacy Workshop Agenda](#)

Annual Convention

Friday, November 13 – Sunday, November 15

Annual Convention Registration Fee: \$325

Your registration for this year's Annual Convention includes admission to all general sessions, clinics, and the exhibit hall, as well as the following meals: Exhibit Hall Reception, Saturday Exhibit Hall Breakfast, the Awards Ceremony and Reception, and Sunday Convention Breakfast Buffet. Guests of convention attendees are invited to attend but must pre-purchase meal events.

[Full Convention Schedule](#)

Delegate Assembly

Saturday, November 14

Registration Fee: \$0

The Delegate Assembly is the official business meeting of TSBA. School Board Members must register as delegates prior to the convention.

[Delegate Assembly FAQ](#)

OTHER EVENTS

Board Chairman Roundtable

Thursday, November 12 from 10:00 a.m. – Noon

Registration Fee: \$0

Board Secretaries' Meeting

Saturday, November 14 from 2:30 p.m. – 4:00 p.m.

Registration Fee: \$0

Exhibit Hall (\$0)

Friday, November 13 & Saturday, November 14

Attendee Online Registration

Hotel Accommodations

TSBA has a room block at the Gaylord Opryland Resort & Convention Center. You must register for the convention before you will receive the reservation information. Once you register for the convention, the "Contact Email" address entered in the online form will receive an email with the group code for the hotel. The room rate at the Gaylord Opryland is \$224 per night, plus tax for a Standard Room and \$274 per night, plus tax for an Atrium Room. The deadline to make reservations is October 15, 2020.

All rooms will include the following:

- Resort Savings Card
- In-room wired and wireless high-speed internet access, and wireless high-speed access in public areas
- Fitness Center Access
- Designated Complimentary in-room beverages
- Schedule Complex Shuttle Service
- Online Access to the Wall Street Journal
- Local and toll free 800 telephone calls (20 minutes per call)

Attire

Casual dress is appropriate for all events except for the Awards Reception & Ceremony, in which case Sunday dress is appropriate. We are setting aside Saturday, November 14 as a day for boards to show their school system pride. If your board has matching shirts, please wear them throughout the day on Saturday.



Copyright © 2020 TSBA, All rights reserved.

You are receiving this email because you are a TSBA member, or have been added to our directory list.

Our mailing address is:

TSBA
525 Brick Church Park Dr
Nashville, TN 37207-3219

[Add us to your address book](#)

[unsubscribe from this list](#) [update subscription preferences](#)