

Regular Meeting
Thursday, February 16, 2023 5:30 PM

Elementary Building
600 Cedar St
New Berlin, IL 62670

Agenda

1. Call to Order
2. Parent Hearing 1.Call to Order/Roll Call
3. 2. Hearing
4. 3. Adjourn Parent Hearing
5. Discuss and/or Approve Action to Temporarily Ban Brandi Litherland from District Property per Board Policy 8:30
6. Pretzel Shoutouts
7. Public Comment (*Policy 2:230*)
8. Adjustments to Agenda
9. Reports and Recommendations
 - 9.a. Director Reports
 - 9.a.1. Transportation Director
 - 9.a.2. Food Services Director
 - 9.a.3. Elementary Facility Director
 - 9.a.4. JH/HS Facility Director
 - 9.b. Administrator(s)
 - 9.b.1. Mrs. Brandi Maxedon, Elementary Principal
 - 9.b.2. Mr. Tim Roberts, JH Principal
 - 9.b.3. Mrs. Hattie Llewellyn, High School Principal
 - 9.b.4. Mr. Blake Lucas, District Athletic and Activities Director
 - 9.c. Superintendent
 - 9.c.1. Mrs. Jill Larson, Superintendent
 - Calendar 2023-24
 - Summer School Dates
 - Pre-Bid Information
 - High School Math Recommendations back to Traditional Math Beginning with Class of 2027
 - School Meal Standards Comparison
 - Return to Learn-Six Month Review (required-no change)
 - Solar Update
 - Update on Design Development
10. Consent Agenda
 - 10.a. Financial Report(s)
 - 10.a.1. Bills Payable & Imprest Fund
 - 10.a.2. Student Activity Funds
 - 10.a.3. Payroll
 - 10.a.4. Treasurer's Report
 - 10.b. Open Session Minutes of January 18, 2023
11. New Business

- 11.a. Approve the construction documents for an early bid package for the New Berlin Jr/Sr High School Remodel & Addition project as submitted and authorize BLDD and CORE Construction to solicit bids on behalf of the New Berlin School District
- 11.b. Approve Application for Establishing a Student Activity Fund for JH PBIS
- 11.c. Approve Board Member Reimbursement for Stephanie Neuman
- 11.d. Approve Resolution to Dispose of Surplus Supplies or Equipment
- 11.e. Approve the FFA Overnight Trip for the 2023 Women Changing the Face of Agriculture career exploration event, Galesburg, IL on March 3, 2023
- 11.f. Discussion and/or Approval of Calendar for School Year 2023-24
- 11.g. Discussion and/or Approval of Summer School Plan
- 11.h. Discussion and/or Approval of Traditional Math Beginning with Class of 2027
- 11.i. Approve the updated Math addition to the NBHS Curriculum Guide for 23-24 School Year
- 11.j. Destroying of Executive Session Tapes for the Month(s) of July 2021 and prior
12. Executive Session - For the purpose of:
 - 12.a. *The appointment, employment compensation, discipline, performance, or dismissal of specific employees of the District or legal counsel for the District, including hearing testimony on a complaint lodged against an employee or against legal counsel for the District to determine validity. 5 ILCS 10/2(c).*
 - 12.b. *Security procedures, school building safety and security, and the use of personnel and equipment to respond to an actual, a threatened, or a reasonable potential danger to the safety of employees, students, staff, the public, or public property. 5ILCS 120/2(c)(8)*
13. *Personnel Consent Agenda (*Policy 5:280*)
 - 13.a. Olivia Killion as Junior High History Teacher
 - 13.b. Allison Jacobs as Special Education Paraprofessional
 - 13.c. Brooke Brummett as NBE Paraprofessional
 - 13.d. James Dambacher as High School Head Football Coach
 - 13.e. Melissa Dillon as Assistant High School Softball Coach
 - 13.f. Alexa Thomsen as Volunteer High School Track and Field Coach
 - 13.g. Dalton Dawdy as PT Cook
14. Resignations:
 - Rachel Crain-NBE Aide
 - Amy Ankrom-NBE Aide
 - Nicole Icenogle-HS Spec. Ed. Aide
 - Jessica Jackson-NBE Aide
15. Adjournment

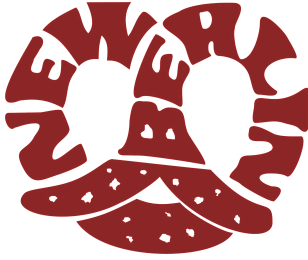

SETH HILL, TRANSPORTATION DIRECTOR
NEW BERLIN CUSD16
300 E. ELLIS ST.
NEW BERLIN, IL 62670
217-488-2040 EXT. 235

February Board Report

Transportation

- Utilization of Training Coordinator for new drivers.
- Continuation of positive culture with staff (Pizza Luncheon)
- Sent buses for general maintenance
- Sent buses for bi-yearly inspections
- Mechanic is working on installation of parts on buses that need work done.
- Installation of new camera system on white buses
- Utilization of routefinder
- Finished Professional Training on Wayfinder and GPS tracking of buses.
- Continued trial integration of the Wayfinder mapping and attendance program now on nine buses and use by Sub Drivers
- All annual queries ran on current driving staff.
- Discussed options for new bus barn and location.
- Exploring options for replacement of white buses eventually.
- Continued recertification of drivers
- Open positions
 - Bus Driver
 - Bus Monitor

- Pretzel positives

- Pizza Luncheon
- New Driver is finishing the training process to become a bus driver.
- Discipline Problems have been handled by all building administrators in a timely manner and with positive results.

Facilities Work Progress Report for New Berlin Elementary

Board Report for January 2023

Work to Begin or in Progress	Description	Update
Changed all classroom / hallway air filters	68 units	complete
repaired kitchen cooler	freon/ capacitor	complete
convert three outside wall lights to LED	converting when light fails	complete
repaired classroom lights	bad ballast	complete
rebuilt backflo valve in 516 mechanical room hot water supply	was leaking	complete
repaired geo valve leak in green hall	rebuilt valve	complete
rebuilt floor scrubber agitator pad, remove vac motor clean brushes	isolators broken/ replaced	complete
installed wall shelving in concession stand		complete
repaired outside door lock on kindergarten door		complete
repaired numerous toilet flush valves		ongoing
Remove and replace leaking pump seals on 15hp geo pump for rooftop units	replace seal, bypass pressure plumbing, guage	complete
serviced make up air units	filters, general service	completed
check PH levels in all system loops	good 5-6	completed
replaced water filters on mainly used drinking fountains		complete
clean and or replaced leaking vacuum breaks on toilet flush valves	local water limes them up and needs maintenance	most have 10+ years on them. as needed
repaired lock on district office	internal part broken, replaced	replaced
Had current bi/annual Fire Alarm testing done, Johnston Controls	all ok	complete
performed monthly exit light test, repaired 2		
Replaced 1 battery back up pack in emergency hallway lighting that had failed		complete
repaired broken light diffuser that was hit with a ball	replaced broken plastic diffuser hangers	complete
replaced worn out light duty carpet shampo unit [used for emergencies]		complete
have a communication issue with rooftop units in gym/mp. working to resolve	ECSI controls thinks it is a bad system controller	in progress

New Berlin CUSD #16

Facilities Work Progress Report for **New Berlin Jr/Sr High School**

Board Report for Jan-23/Feb23

Work to Begin or in Progress	Description	Update
Steam boiler	Drained bowls on boiler.	Done.1-17-23/1-25-23/2-2-23/2-6-23
Cafeteria	Take old thophies down.	Done.
Room 213	Fixed door handle.	Done.
All Jr/Sr high school	Inventoried old trophies and had photography take pictures of all off them and put them on the schools website.	Done.
Outside stuff	Shoveled and salted sidewalks	Done.1-25-23/1-30-23
All Jr/Sr high school	Fixed lockers	Done. This is a on going thing.
Cafeteria	Hung new dispenser up.	Done.
All Jr/Sr high school	Did are Co2 monthly inspection.	Done.
All Jr/Sr high school	Did are monthly fire extingusisher inspection.	Done.
All Jr/Sr high school	Did are monthly exit/emergency light inspection.	Done.
Dome	Put plaque up in gym.	Done.
Ag shop	Hung hose reel up and ran new hose to it.	Done.
By room 327	Water fountain wasn't drain so we had to eel it.	Done.
Elem conference room	Had a meeting about new bus barn	Done.
Room 222	Met with simplex so they could do there annual inspection.	Done.
HS conference room	Met with solar ppl to talk about project.	Done.1-13-23/1-25-23/2-9-23
HS conference room	Met with BLDD and Heart technology.	Done.1-17-23/1-25-23
HS conference room	Met with BLDD for preferred finshing.	Done.1-25-23/1-27-23
All Jr/Sr high school	Met with insurance saftey guy Andy	Done.
All Jr/Sr high school	Put new chemical dispensers in custodial closet. Switched over to RD McMillen product.	Done.
Custodian closet	Got drain unclogged.	Done.
Cafeteria	Fridge stop cooling. Put new part on fridge its cooling now.	Done.Bormida did this work.
Room 327	Put new shelf together.	Done.
Boiler room	Put new chemical in boiler system and put a new filter in feeding pot.	Done.
Boiler room	Oiled boiler pumps up.	Done.
Custodian closets	Oiled recirculating pumps.	Done.
Locker room	Eeled locker room drains.	Done.
Custodian closet	Eeled on drain.	Done.
Softball field	Drug field	Done.1-6-23/1-7-23
Room 210	Hung two new white boards for teacher	Done.
Outside stuff	Cut up old pallets and through them away.	Done.
All restrooms/locker rooms	Hung new soap dispenser trays in restrooms	Done.
Room 332	Glued down to loose tiles	Done.
Jr high boys restroom	Eeled tiolet to get it unclogged.	Done.
Room 331	Glued down to loose tiles	Done.

February 2023 Board Report

TO: NBCUSD #16 Board of Education, Mrs. Jill Larson, Superintendent

From: Brandi Maxedon, Elementary School Principal

Shelley Haas, Elementary Assistant Principal

SIP, Curriculum & Instruction, Assessment & Staff Professional Development

- Cathleen Weber met with 2nd-5th grade staff to discuss the Illinois Assessment of Readiness. She discussed teaching resources and testing resources to prepare students to navigate the testing platform.
- All grade-level staff and interventionists met on February 2nd to review assessments and student performance to determine new intervention groups.

Hires & Resignations

- Hiring
 - Brooke Brummett-Paraprofessional
- Resignations
 - Jessica Jackson-Paraprofessional

Pretzel Positives:

- The 4th grade spelling bee competitors were:
 - Owen Griffith
 - Avery Tomlin
 - Kye Shoopman
 - Brynlee Midiri
 - Noah Sanders
 - Laney Ostrem
 - Liam Reardon
 - Aidan Marshall
 - Sloan Walter
 - Liam Dennison
 - Taylon Hulcher
 - Lexi Vincent
- The 4th grade spelling winners were :Kye Shoopman and Laney Ostrem
- The 5th grade spelling bee competitors:
 - Cyrus Irani
 - Liam Harris
 - Kelsey Cowhick
 - Jaxon Streeval
 - Grayson Beckman
 - Charlie Sunley
 - Hunter Lehman
 - Addy Ayers
 - Sydney Lawless

- Nathalae Tayo
- Jack Crowder
- Emily Harris

- The 5th grade spelling bee winners were: Jaxon Streeval and Sydney Lawless
- Mrs. Danenberger for being available for staff to report absences and working to find substitutes during the day and at home in the early morning and evening.
- The interventionists, grade level teachers, and paraprofessionals that attended our data meeting to set new intervention groups at NBE to support our students.
- All the bus drivers and monitors for showing up each day to get our students to school and home.
- Mrs. Pecoraro and Mrs. Ward for starting a morning book club for our 3rd -5th grade students that wanted to join.
- Mrs. Marr has been keeping our PBIS rewards stocked for our daily Salty Dough winners!
- Kudos to the pre-k staff for planning a fun Valentine's Day party on February 8th.
- Kindergarten preview night is March 6th from 5:30-6:30pm.
- Pre-K Screening is March 16th and 17th during the school day.



Tim Roberts, Principal

New Berlin Junior High

300 E. Ellis St.

New Berlin, IL 62670

217-488-6012 ext. 240

Fax: 217-488-3107

February 2023 Board Report

TO: New Berlin CUSD #16 Board of Education, Jill Larson, Superintendent

From: Tim Roberts, Junior High Principal

School/Building Improvement:

- 3rd Week of CICO has been successful.
- Working on grade level leadership groups

Professional Development

- 2/1
 - WorldClassrooms presentation
 - Math curriculum round table
- 2.17
 - Crisis Management training

Assessment

- Selected for additional IAR field test (ELA)
- IAR testing April 11,12,13
- MAP testing May 15-19

Pretzel Positives

- Cheer IESA state- Gritty
- Volleyball 7th- 2nd. 8th-1st
- Launched Salty Apparel store to support PBIS, positive feedback
- 78 Students received the Prestigious Pretzel award from Q2 (No tardies, No unexcused absences, No referrals)

WorldClassrooms:

- Feb. 27, 2023: Launch the trip to the students with invitations and an informational video.
- March 7, 2023 at 6:00 PM Parent Meeting at NBJH
- They have locked in 05/31/24-06/03/24.



Hattie Llewellyn, Principal

New Berlin High School

300 E. Ellis St.

New Berlin, IL 62670

217-488-6012 ext. 225

Fax: 217-488-3207

February 2023 Board Report

TO: NBCUSD #16 Board of Education, Mrs. Jill Larson, Superintendent

From: Hattie Llewellyn, High Principal

School Improvement

- 5 Essentials Update - the HS students are at 93% completion; teachers 78% and parents 18%. We need a couple more parents to complete this so we can get the parent feedback report next year. We have met all of the other state targets.
- We have been awarded Bronze Honors from ISAC for our Financial Aid Application Completion for the Class of 2022. In order to receive this honor our school achieved a completion rate of 70%. This is ONLY for those students who completed a FAFSA application NOT the Opt-Outs. In order for us to receive the Silver Honors our school would need to achieve a completion rate of 75% or higher. we are currently at 73% completion for the class of 2023 and have 10 Seniors who still need to complete their FAFSA or Opt-out form.

Curriculum and Instruction

- We have a recommendation for the math program - Mrs. Euler has submitted the updated course description (see below under recommendations).

Assessment

- We are prepping for the IL SAT Suite of Assessments on April 12th! Students in grades 9-11 are working on PSAT/SAT Test Prep Skill Plans through IXL in Advisory each week.

Pretzel Positives

- Sadie's Dance
- NHS Induction is Wednesday, February 15th. Congratulations to the new members: Abby Finch, Christopher Bandy, Collin Featherston, Alexandra Frazier, Evan Reindl, Audrey Attig, Michael Biesenthal, Griffin Fuchs, Savannah Kramer, Braiden Mattheisesn, Eva Richie, Kendall Sims, and Dylan Walton!
- Mr. Bandy's Announcement Crew will be adding a segment called "Man on the Street" section to the morning announcements. Stay tuned!
- CACC Students of the Month for January: Brandt Crews in the Building Trades Program

Recommendations:

Allison Jacobs - HS Paraprofessional

Updated Math Department Course Description for Algebra I to the NBHS Curriculum Guide for 23-24 school year

FFA Overnight Trip - Since it is in Galesburg they are offering hotel rooms for schools who are 2 hrs or farther away. Below is some information about the conference, we have attended every year in the past just not stayed overnight because they were closer colleges.

The 2023 Women Changing the Face of Agriculture career exploration event will be held in person at Carl Sandburg College located in Galesburg, Illinois on March 3rd, 2023. This year's event will include a rotation through career panels - including hands on opportunities, networking with professionals, and a keynote speaker. In addition, WCFA will recognize scholarship recipients as well as other award winners. Our keynote speaker is Miriam Hoffman, 2020-2021 National FFA Eastern Region Vice-President and Senior at Southern Illinois University. We will have a professional development event on March 2nd, featuring Heather Hampton+Knodle, American Agri-Women President. This event will be an opportunity for professionals to network. Women Changing the Face of Agriculture is



Hattie Llewellyn, Principal

New Berlin High School

300 E. Ellis St.

New Berlin, IL 62670

217-488-6012 ext. 225

Fax: 217-488-3207

a project of Illinois Agri-Women (IAW) that showcases a career exploration event for young women interested in agriculture. This event strives to give women the opportunity to explore different career paths, interact with industry professionals, and receive accurate information firsthand from women in agriculture.



February Board Report

Updated February 13, 2023

Athletics

- **Approve Melissa Dillon as assistant HS softball coach**
- **Approve Alexa Thompsen as volunteer HS track & field coach**
- **Approve James Dambacher as head HS football coach**

- **Open coaching positions:**
 - **HS Head Football Cheerleading Coach**

- **Team Rules:**
 - None at this time

Pretzel Positives

- Best wishes to our HS Girls basketball program on their postseason tournament! The girls have had an outstanding year up to this point and we wish them the best on a strong finish.
- Congratulations to the JH girls cheer squad as they gear up for the IESA State Competition! We are all so proud of your hard work and dedication. The JH cheer squad also finished 2nd at the ICCA state tournament! Great job ladies!
- Congratulations to Tyler Hulett, Landon Hagerman, and Corren Watson for their scholastic bowl all-sectional team nomination. Well done!
- Congratulations to Jayden Perry for placing 4th at the HS wrestling sectional this past weekend! With this finish she has qualified for the state wrestling tournament!
- Best of luck to all of our spring athletic programs, coaches, and student athletes as they begin their preparations for the upcoming season. We are looking forward to some sunshine and cheering you on.



Blake Lucas, Athletic & Activities Director

New Berlin CUSD16

300 E. Ellis St.

New Berlin, IL 62670

217-488-6012



New Berlin CUSD #16
Superintendent Report
February 16, 2023



Calendar 2023 – 24

There were 10 NBEA representatives that served on the calendar committee in addition to the administrators. The calendar is set to accommodate the building project. The biggest changes are:

- Three (3) Teacher Institute Days at the beginning of the year, but administrators and teachers feel this will allow time for professional development, required trainings, and collaboration to occur.
- 1:00 pm dismissal monthly vs. Wednesday at one-hour dismissal. The change will allow teachers and staff to be more productive in getting curriculum and building initiatives accomplished.
- Graduation date tentatively set for May 12, 2024.

Summer School

See attached proposal.

Pre-Bid Information

- The scope of Work for the early bid package is Precast Architectural Concrete Wall Panels (material and installation) and main electrical gear (equipment only).
- The reason for the early bid package is due to long lead times in order to keep the construction schedule as previously presented.
- Bids will be due on Friday, March 10th at 10:00 AM
- Advertisement for Bids can go out the day after the board approves the motion.

High School Math Change

- The decision to go from Integrated math (Math 1, Math 2, Math 3) back to the traditional math (Algebra 1, Geometry, Algebra 2) was made beginning with freshman graduating in 2027.

School Meal Standards Comparison

- Attached you will see the recommended school meal standards by the USDA in comparison to what is currently approved. My plan is to communicate these out to parents and students once approved.

Return to Learn – 6 Month Review

This is a requirement. No changes at this time.

Solar Update

There have been two meetings with the building project engineers, facilities directors, and the solar company. The specific equipment has been scoped out for the building project as well as the equipment at NBE.

Update on Design Development

BLDD architect Kayla Peck will share the progress that has been made on the building project.

Facilities Update

2023





This Week:

- BOE Approval of Early Bid Package
Precast
Electrical Equipment
- 50% CDs to CORE for Budget Updates



Early Bid Package

- **Scope of Work:** Precast, Electrical Equipment
- **Purpose:** to account for lead times
- Advertisement to go out tomorrow (2/17/23)
- March 1st, 10am: Pre-Bid Meeting
- March 10th, 10am: Early Bids Submittal

First Floor

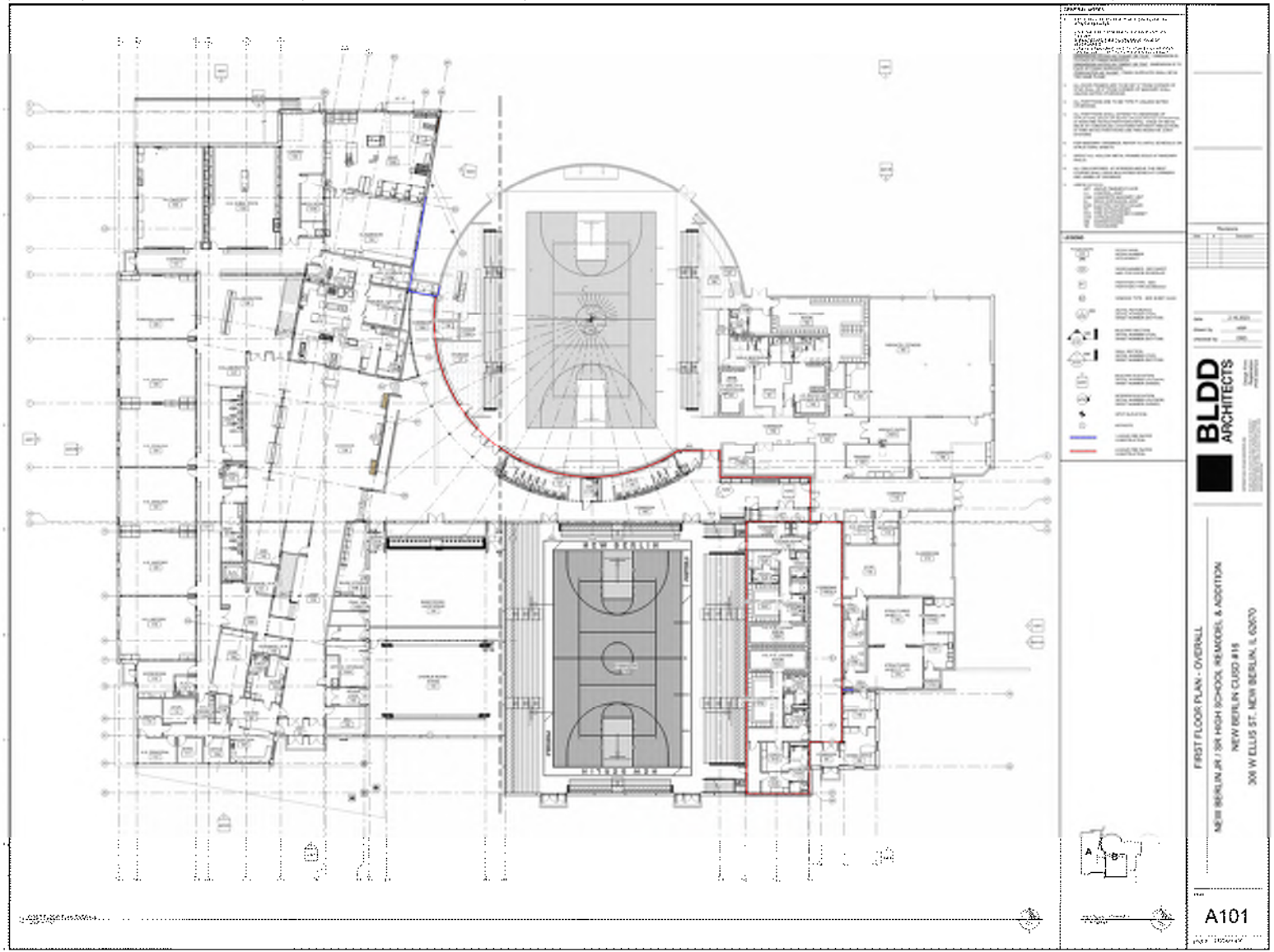

Second Floor







Total Seating: 1,586 Seats
Required Seating per IHSA
Regionals: 1,000 seats
Sectionals: 1,500 seats

Home Bleachers, Mezzanine:
566 Seats

Student Section, South Side
95 Seats

Home Bleachers, First Floor
384 Seats

Student Section, North Side
(Not Shown)
95 Seats

Visitor Bleachers
446 Seats







Upcoming:

- March Meeting:
Review of site logistics with CORE
Approval of Early Bid Package

VEN-KEY	VENDOR NAME	INVOICE #	PO NUMBER	BATCH	BANK	DESCRIPTION	LQ	S	INV DATE	DUE DATE	C	NET AMOUNT
ACH VOID DOWNLOAD	DISCOUNT DESCRIPTION	DISC AMT	ADJUSTMENT DESCRIPTION	FY	ADJ AMT	CHECK NBR	INVOICE AMOUNT					
REF	CATALOG	DESCRIPTION	LQ	QTY	LINE AMOUNT							
ACCOUNT NUMBER(S)	QUICK KEY	ACCOUNT LEVEL DESCRIPTION	1099									ACCT AMOUNT
AFASUP 000	AMERICAN FIDELITY ASSURANCE	20230215ADAF11	0000000000	P9	BNK5	Payroll accrual	B	02/15/2023	02/15/2023	W		\$115.77
							22-23				202200454	\$115.77
10L000 4581 0000 00 000000						AM FIDELITY SUPPLEMENTAL W/H						\$96.67
20L000 4581 0000 00 000000												\$19.10
AFASUP 000	AMERICAN FIDELITY ASSURANCE	20230215ADAF12	0000000000	P9	BNK5	Payroll accrual	B	02/15/2023	02/15/2023	W		\$29.95
							22-23				202200454	\$29.95
10L000 4581 0000 00 000000						AM FIDELITY SUPPLEMENTAL W/H						\$29.95
AFASUP 000	AMERICAN FIDELITY ASSURANCE	20230215ADAF2	0000000000	P9	BNK5	Payroll accrual	B	02/15/2023	02/15/2023	W		\$657.74
							22-23				202200454	\$657.74
10L000 4581 0000 00 000000						AM FIDELITY SUPPLEMENTAL W/H						\$465.94
20L000 4581 0000 00 000000												\$66.45
40L000 4581 0000 00 000000												\$125.35
AFASUP 000	AMERICAN FIDELITY ASSURANCE	20230215ADAF5	0000000000	P9	BNK5	Payroll accrual	B	02/15/2023	02/15/2023	W		\$227.84
							22-23				202200454	\$227.84
10L000 4581 0000 00 000000						AM FIDELITY SUPPLEMENTAL W/H						\$199.91
40L000 4581 0000 00 000000												\$27.93
AFASUP 000	AMERICAN FIDELITY ASSURANCE	20230215ADAF6	0000000000	P9	BNK5	Payroll accrual	B	02/15/2023	02/15/2023	W		\$77.34
							22-23				202200454	\$77.34
10L000 4581 0000 00 000000						AM FIDELITY SUPPLEMENTAL W/H						\$-1.83
40L000 4581 0000 00 000000												\$79.17
AFASUP 000	AMERICAN FIDELITY ASSURANCE	20230215ADAF7	0000000000	P9	BNK5	Payroll accrual	B	02/15/2023	02/15/2023	W		\$215.24
							22-23				202200454	\$215.24
10L000 4581 0000 00 000000						AM FIDELITY SUPPLEMENTAL W/H						\$106.97
20L000 4581 0000 00 000000												\$19.35
40L000 4581 0000 00 000000												\$88.92
AFASUP 000	AMERICAN FIDELITY ASSURANCE	20230215ADAF8	0000000000	P9	BNK5	Payroll accrual	B	02/15/2023	02/15/2023	W		\$378.05
							22-23				202200454	\$378.05
10L000 4581 0000 00 000000						AM FIDELITY SUPPLEMENTAL W/H						\$310.48

VEN-KEY	VENDOR NAME	INVOICE #	PO NUMBER	BATCH	BANK	DESCRIPTION	LQ	S	INV DATE	DUE DATE	C	NET AMOUNT
ACH VOID DOWNLOAD	DISCOUNT DESCRIPTION	DISC AMT	ADJUSTMENT DESCRIPTION	FY	ADJ AMT	CHECK NBR	INVOICE AMOUNT					
REF	CATALOG	DESCRIPTION	LQ	QTY	LINE AMOUNT							
ACCOUNT NUMBER(S)	QUICK KEY	ACCOUNT LEVEL DESCRIPTION	1099									ACCT AMOUNT
AFASUP 000	AMERICAN FIDELITY ASSURANCE	20230215ADAF8				*****CONTINUED*****						
20L000 4581 0000 00 000000												\$-15.09
40L000 4581 0000 00 000000												\$82.66
AFASUP 000	AMERICAN FIDELITY ASSURANCE	20230215ADAF9	0000000000	P9	BNK5	Payroll accrual	B	02/15/2023	02/15/2023	W		\$21.81
10L000 4581 0000 00 000000						AM FIDELITY SUPPLEMENTAL W/H	22-23				202200454	\$21.81
												\$21.81
						NUMBER OF INVOICES: 18						\$6,324.90
AFFOS 000	AFFORDABLE SHRED	0065611	0000000000	0223	BNK5	SHRED SERVICE DISTRICT	B	02/02/2023	02/16/2023	R		\$90.00
20E000 2542 3230 00 000000							22-23					\$90.00
20E103 2542 3230 00 000000						NBE CARE/UPKEEP REPAIR MAINT.						\$30.00
20E301 2542 3230 00 000000						NBHS CARE/UPKEEP REPAIR/MAINT.						\$30.00
						NUMBER OF INVOICES: 1						\$90.00
AFLAC 000	AMERICAN FAMILY LIFE ASSUR	20230201ADAF2	0000000000	P9	BNK5	Payroll accrual	B	02/01/2023	02/01/2023	W		\$42.58
10L000 4591 0000 00 000000							22-23				202200419	\$42.58
												\$42.58
AFLAC 000	AMERICAN FAMILY LIFE ASSUR	20230215ADAF2	0000000000	P9	BNK5	Payroll accrual	B	02/15/2023	02/15/2023	W		\$42.58
10L000 4591 0000 00 000000							22-23				202200446	\$42.58
												\$42.58
						NUMBER OF INVOICES: 2						\$85.16
AT&T MOB000	AT&T MOBILITY	28730168402032023	0000000000	0223	BNK5	STUDENT HOT SPOTS	B	01/25/2023	02/16/2023	W		\$206.20
10E000 2225 3400 00 000000							22-23				202200413	\$206.20
												\$206.20
						NUMBER OF INVOICES: 1						\$206.20
AXA EQUI000	AXA EQUITABLE LIFE INSURANCE COMPA	20230201ADAXA	0000000000	P1	BNK5	Payroll accrual	H	02/01/2023	02/01/2023	W		\$4,010.00

VEN-KEY	VENDOR NAME	INVOICE #	PO NUMBER	BATCH	BANK	DESCRIPTION	LQ	S	INV DATE	DUE DATE	C	NET AMOUNT
ACH VOID DOWNLOAD	DISCOUNT DESCRIPTION	DISC AMT	ADJUSTMENT DESCRIPTION	FY	ADJ AMT	CHECK NBR	INVOICE AMOUNT					
REF	CATALOG	DESCRIPTION	LQ	QTY	LINE AMOUNT							
ACCOUNT NUMBER(S)	QUICK KEY	ACCOUNT LEVEL DESCRIPTION	1099	ACCT AMOUNT								
AXA EQUI000	AXA EQUITABLE LIFE INSURANCE COMPA	20230201ADAXA				*****CONTINUED*****						
	10L000 4590 0000 00 000000						22-23			202200426		\$4,010.00
												\$4,010.00
AXA EQUI000	AXA EQUITABLE LIFE INSURANCE COMPA	20230201ADAXA%	0000000000	P1	BNK5	Payroll accrual	H		02/01/2023	02/01/2023	W	\$3,578.90
	10L000 4590 0000 00 000000						22-23			202200426		\$3,578.90
	20L000 4590 0000 00 000000											\$3,333.27
												\$245.63
AXA EQUI000	AXA EQUITABLE LIFE INSURANCE COMPA	20230215ADAXA	0000000000	P1	BNK5	Payroll accrual	B		02/15/2023	02/15/2023	W	\$4,140.00
	10L000 4590 0000 00 000000						22-23			202200453		\$4,140.00
	40L000 4590 0000 00 000000											\$4,010.00
												\$130.00
AXA EQUI000	AXA EQUITABLE LIFE INSURANCE COMPA	20230215ADAXA%	0000000000	P1	BNK5	Payroll accrual	B		02/15/2023	02/15/2023	W	\$3,570.69
	10L000 4590 0000 00 000000						22-23			202200453		\$3,570.69
	20L000 4590 0000 00 000000											\$3,325.06
												\$245.63
NUMBER OF INVOICES: 4												\$15,299.59
BLDD ARC000	BLDD ARCHITECTS	3937	0000000000	0223	BNK5	PROJECT 216EX21.400	B		01/31/2023	02/16/2023	A	\$171,452.58
	60E000 2535 5200 00 000000					CO BLDG CONSTRUCTION PROJECT	22-23					\$171,452.58
												\$171,452.58
NUMBER OF INVOICES: 1												\$171,452.58
BLICK 000	BLICK ART MATERIALS	228676	1032023279	0223	BNK5	RUPNIK- ART SUPPLIES	P	B	01/28/2023	02/16/2023	A	\$282.01
	100	RIPNIK-ART SUPPLIES					22-23					\$282.01
	10E103 1113 4100 00 000000					NBE SM GENERAL SUPPLIES				1.00		\$282.01
												\$282.01
NUMBER OF INVOICES: 1												\$282.01
BMO FINA000	BMO FINANCIAL GROUP	1923-0223-1	0000000000	BMO 0223	BNK5	SHEPPS-BLDD MEETING	B		01/19/2023	02/16/2023	W	\$67.36

VEN-KEY	VENDOR NAME	INVOICE #	PO NUMBER	BATCH	BANK	DESCRIPTION	LQ	S	INV DATE	DUE DATE	C	NET AMOUNT
ACH VOID DOWNLOAD	DISCOUNT DESCRIPTION	DISC AMT	ADJUSTMENT DESCRIPTION	FY	ADJ AMT	CHECK NBR	INVOICE AMOUNT					
REF	CATALOG	DESCRIPTION	LQ	QTY	LINE AMOUNT							
ACCOUNT NUMBER(S)	QUICK KEY	ACCOUNT LEVEL DESCRIPTION	1099									ACCT AMOUNT
BMO FINA000	BMO FINANCIAL GROUP	1923-0223-1				*****CONTINUED*****						
							22-23			202200418		\$67.36
10E000 2311 3900 00 000000						SCH BD OTHER PURCH. SERVICES						\$67.36
BMO FINA000	BMO FINANCIAL GROUP	2588-0223-7	0000000000	BMO 0223	BNK5	SEALS UNLIMITED-PUMP SEAL KIT	B		01/19/2023	02/16/2023	W	\$265.05
							22-23			202200418		\$265.05
20E103 2542 4100 00 000000						NBE CARE/UPKEEP GEN SUPPLIES						\$265.05
BMO FINA000	BMO FINANCIAL GROUP	3061-0223-4	1032023266	BMO 0223	BNK5	THERAPY SHOPPE	P B		01/19/2023	02/16/2023	W	\$116.58
							22-23			202200418		\$116.58
100		HICKS-OPEN P.O.						1.00				\$116.58
10E103 1200 4100 00 000000						NBE SP. ED. GEN SUPPLIES						\$116.58
BMO FINA000	BMO FINANCIAL GROUP	5568-0223-5	0000000000	BMO 0223	BNK5	9226-CAPONES-TEAM MEAL	B		01/19/2023	02/16/2023	W	\$212.93
							22-23			202200418		\$212.93
10A000 1200 0000 00 000000												\$212.93
BMO FINA000	BMO FINANCIAL GROUP	6815-0223-6	0012023030	BMO 0223	BNK5	BUREAU OF EDUCATION-HELPING CHILDREN BY INCREASING ATTENTION, AND MOTIVATION	P B		01/19/2023	02/16/2023	W	\$279.00
							22-23			202200418		\$279.00
100		PROFESSIONAL DEVELOPMENT ALLOCATION - 22-23 - KENNEDY						1.00				\$279.00
10E301 2210 3320 00 000000						HS PS PROF DEVELOPMENT						\$279.00
BMO FINA000	BMO FINANCIAL GROUP	6815-0223-7	0012023030	BMO 0223	BNK5	BUREAU OF EDUCATION-WORLD LANGUAGE TEACHERS	P B		01/19/2023	02/16/2023	W	\$279.00
							22-23			202200418		\$279.00
100		PROFESSIONAL DEVELOPMENT ALLOCATION - 22-23 - KENNEDY						1.00				\$279.00
10E301 2210 3320 00 000000						HS PS PROF DEVELOPMENT						\$279.00

VEN-KEY	VENDOR NAME	INVOICE #	PO NUMBER	BATCH	BANK	DESCRIPTION	LQ	S	INV DATE	DUE DATE	C	NET AMOUNT
ACH VOID DOWNLOAD	DISCOUNT DESCRIPTION	DISC AMT	ADJUSTMENT DESCRIPTION	FY	ADJ AMT	CHECK NBR	INVOICE AMOUNT					
REF	CATALOG	DESCRIPTION	LQ	QTY	LINE AMOUNT							
ACCOUNT NUMBER(S)	QUICK KEY	ACCOUNT LEVEL DESCRIPTION	1099	ACCT AMOUNT								
BMO FINA000	BMO FINANCIAL GROUP	7406-0223-14	7002023022	BMO 0223	BNK5	AMAZON-BACKPACK	P	B	01/19/2023	02/16/2023	W	\$23.49
							22-23			202200418		\$23.49
100		LUCAS-MISC. ATHLETIC EQUIPMENT						1.00				\$23.49
10E000 1500 5400 00 000000												\$23.49
BMO FINA000	BMO FINANCIAL GROUP	7406-0223-15	7002023012	BMO 0223	BNK5	AMAZON-WRITING PAD	P	B	01/19/2023	02/16/2023	W	\$16.14
							22-23			202200418		\$16.14
100		LUCAS- A.D. ATHLETIC SUPPLIES & AWARDS						1.00				\$16.14
10E000 1500 4100 00 000000		INTERSC PRGM GEN SUPP.										\$16.14
BMO FINA000	BMO FINANCIAL GROUP	7406-0223-16	7002023014	BMO 0223	BNK5	PERFORMANCE HEALTH SUPPLY	P	B	01/19/2023	02/16/2023	W	\$162.06
							22-23			202200418		\$162.06
100	SUPPLIES	ATHLETIC TRAINING SUPPLIES						1.00				\$162.06
10E000 1500 4112 00 000000		ATHLETIC TRAINING SUPPLIES										\$162.06
BMO FINA000	BMO FINANCIAL GROUP	9165-0223-26	2022023021	BMO 0223	BNK5	SAMS-CANDY	P	B	01/19/2023	02/16/2023	W	\$118.04
							22-23			202200418		\$118.04
100		JH CHARACTER ED/STUDENT PLANNERS/AGENDAS/YARD SIGNS						1.00				\$118.04
10E202 1115 4100 00 000000		NBJH GEN SUPPLIES										\$118.04
BMO FINA000	BMO FINANCIAL GROUP	9280-0223-1	0000000000	BMO 0223	BNK5	AMAZON-BLACK INK	B		01/19/2023	02/16/2023	W	\$95.96
							22-23			202200418		\$95.96
10E500 1125 4100 00 000000		PRE-K SM GENERAL										\$95.96
											NUMBER OF INVOICES: 11	\$1,635.61
BORMIDA 000	BORMIDA HEATING & COOLING	13136	0000000000	0223	BNK5	JH/HS BLDG-COMPRESSOR START RELAY WAS STUCK	B		01/30/2023	02/16/2023	A	\$296.13
							22-23					\$296.13
20E301 2542 3230 00 000000		NBHS CARE/UPKEEP REPAIR/MAINT.										\$296.13
											NUMBER OF INVOICES: 1	\$296.13
CACC	001 CAPITAL AREA CAREER CENTER	1081	0000000000	0223	BNK5	SEMESTER 2-TUITION AND OBM	B		01/20/2023	02/16/2023	R	\$43,486.30

VEN-KEY	VENDOR NAME	INVOICE #	PO NUMBER	BATCH	BANK	DESCRIPTION	LQ	S	INV DATE	DUE DATE	C	NET AMOUNT
ACH VOID DOWNLOAD	DISCOUNT DESCRIPTION	DISC AMT	ADJUSTMENT DESCRIPTION	FY	ADJ AMT	CHECK NBR	INVOICE AMOUNT					
REF	CATALOG	DESCRIPTION	LQ	QTY	LINE AMOUNT							
ACCOUNT NUMBER(S)	QUICK KEY	ACCOUNT LEVEL DESCRIPTION	1099	ACCT AMOUNT								
CACC	001 CAPITAL AREA CAREER CENTER	1081				*****CONTINUED*****						
						CHARGES						
							22-23					\$43,486.30
	10E000 4140 6000 00 000000					VOCATIONAL EDU TUITION						\$24,000.00
	20E000 4140 6900 00 000000					OPS MAINT VOC. EDU MISC						\$19,486.30
						NUMBER OF INVOICES: 1						\$43,486.30
CARBS	000 CAROLINA BIOLOGICAL SUPPLY	52042096 R	3012023023	0223	BNK5	HYDRA BUDDING, BLOKITS	C	B	01/31/2023	02/16/2023	A	\$113.60
	100	JOHNSON-SCIENCE CLASSROOM					22-23					\$113.60
	10E301 1117 4100 00 000000	SUPPLIES/WORKBOOKS						1.00				\$113.60
						NBHS GENERAL SUPPLIES						\$113.60
CARBS	000 CAROLINA BIOLOGICAL SUPPLY	52043408 R	3012023069	0223	BNK5	SUPPLIES FOR CLASSROOM	P	B	02/01/2023	02/16/2023	A	\$2,096.08
	100	JOHNSON-SCIENCE CLASSROOM					22-23					\$2,096.08
	10E301 1117 4100 00 000000	SUPPLIES/WORKBOOKS						1.00				\$2,096.08
						NBHS GENERAL SUPPLIES						\$2,096.08
CARBS	000 CAROLINA BIOLOGICAL SUPPLY	52045541 R	3012023069	0223	BNK5	PIG HEART	P	B	02/02/2023	02/16/2023	A	\$96.00
	100	JOHNSON-SCIENCE CLASSROOM					22-23					\$96.00
	10E301 1117 4100 00 000000	SUPPLIES/WORKBOOKS						1.00				\$96.00
						NBHS GENERAL SUPPLIES						\$96.00
CARBS	000 CAROLINA BIOLOGICAL SUPPLY	52048091 RM	3012023069	0223	BNK5	CREDIT-HYDRA, BUDDING	P	B	02/06/2023	02/16/2023	A	\$-13.75
	100	JOHNSON-SCIENCE CLASSROOM					22-23					\$-13.75
	10E301 1117 4100 00 000000	SUPPLIES/WORKBOOKS						1.00				\$-13.75
						NBHS GENERAL SUPPLIES						\$-13.75
CARBS	000 CAROLINA BIOLOGICAL SUPPLY	52048987 R	3012023069	0223	BNK5	SHEEP BRAIN	P	B	02/06/2023	02/16/2023	A	\$134.05
							22-23					\$134.05

VEN-KEY	VENDOR NAME	INVOICE #	PO NUMBER	BATCH	BANK	DESCRIPTION	LQ	S	INV DATE	DUE DATE	C	NET AMOUNT
ACH VOID	DOWNLOAD	DISCOUNT DESCRIPTION		DISC AMT	ADJUSTMENT DESCRIPTION	FY	ADJ AMT	CHECK NBR	INVOICE AMOUNT			
REF	CATALOG	DESCRIPTION				LQ	QTY		LINE AMOUNT			
ACCOUNT NUMBER(S)	QUICK KEY	ACCOUNT LEVEL DESCRIPTION	1099						ACCT AMOUNT			
CARBS 000	CAROLINA BIOLOGICAL SUPPLY	52048987 R										
100		*****CONTINUED*****										
		JOHNSON-SCIENCE CLASSROOM					1.00		\$134.05			
		SUPPLIES/WORKBOOKS										
10E301 1117 4100 00 000000		NBHS GENERAL SUPPLIES							\$134.05			
CARBS 000	CAROLINA BIOLOGICAL SUPPLY	52051850 R	3012023069	0223	BNK5	DIABLO HIGHWAY KIT	P	B	02/07/2023	02/16/2023	A	\$1,436.75
100		JOHNSON-SCIENCE CLASSROOM					22-23		\$1,436.75			
		SUPPLIES/WORKBOOKS						1.00	\$1,436.75			
10E301 1117 4100 00 000000		NBHS GENERAL SUPPLIES							\$1,436.75			
NUMBER OF INVOICES: 6												
\$3,862.73												
CARTESAR001	CARTER, SARAH	60.00	0000000000	0223	BNK5	REFUND OF SPORTS FEE	B		01/25/2023	02/16/2023	R	\$60.00
10R000 1720 0000 00 000000		ATH PARTICIPATION FEES					22-23		\$60.00			
NUMBER OF INVOICES: 1												
\$60.00												
CDWG 001	CDW GOVERNMENT, INC.	GH17561	0000000000	0223	BNK5	TRANS-GALAXY TAB	B		01/20/2023	02/16/2023	A	\$1,716.87
40E000 2552 5400 00 000000		TRANS CO EQUIPMENT					22-23		\$1,716.87			
									\$1,716.87			
CDWG 001	CDW GOVERNMENT, INC.	GM21093	0000000000	0223	BNK5	TRANS-SAMSARA LICENSE	B		01/31/2023	02/16/2023	A	\$1,244.24
40E000 2552 5400 00 000000		TRANS CO EQUIPMENT					22-23		\$1,244.24			
									\$1,244.24			
CDWG 001	CDW GOVERNMENT, INC.	GM21100	0000000000	0223	BNK5	TRANS-SAMSARA LICENSE f	B		01/31/2023	02/16/2023	A	\$7,402.50
40E000 2552 5400 00 000000		TRANS CO EQUIPMENT					22-23		\$7,402.50			
									\$7,402.50			
CDWG 001	CDW GOVERNMENT, INC.	GM53125	0000000000	0223	BNK5	TECH-GALAXY TAB	B		01/31/2023	02/16/2023	A	\$572.29
10E000 2225 5400 00 000000		TECH EQUIPMENT					22-23		\$572.29			
									\$572.29			

VEN-KEY	VENDOR NAME	INVOICE #	PO NUMBER	BATCH	BANK	DESCRIPTION	LQ	S	INV DATE	DUE DATE	C	NET AMOUNT
ACH VOID DOWNLOAD	DISCOUNT DESCRIPTION	DISC AMT	ADJUSTMENT DESCRIPTION	FY	ADJ AMT	CHECK NBR	INVOICE AMOUNT					
REF	CATALOG	DESCRIPTION	LQ	QTY	LINE AMOUNT							
ACCOUNT NUMBER(S)	QUICK KEY	ACCOUNT LEVEL DESCRIPTION	1099	ACCT AMOUNT								
CENTIP 000	CENTRAL ILLINOIS PRODUCE (JH/HS)	08579675	0000000000	0223	BNK5	JH/HS BLDG-RAW FOOD, DAIRY	B		01/30/2023	02/16/2023	A	\$601.55
							22-23					\$601.55
10E301 2562 4150 00 000000						NBHS FOOD RAW FOOD						\$206.35
10E301 2562 4151 00 000000						NBHS FOOD DAIRY PRODUCT						\$395.20
CENTIP 000	CENTRAL ILLINOIS PRODUCE (JH/HS)	08579683	0000000000	0223	BNK5	JH/HS BLDG-RAW FOOD AND DAIRY	B		02/01/2023	02/16/2023	A	\$375.60
							22-23					\$375.60
10E301 2562 4150 00 000000						NBHS FOOD RAW FOOD						\$156.00
10E301 2562 4151 00 000000						NBHS FOOD DAIRY PRODUCT						\$219.60
CENTIP 000	CENTRAL ILLINOIS PRODUCE (JH/HS)	08586460	0000000000	0223	BNK5	JH/HS BLDG-DAIRY	B		01/31/2023	02/16/2023	A	\$39.20
							22-23					\$39.20
10E301 2562 4151 00 000000						NBHS FOOD DAIRY PRODUCT						\$39.20
CENTIP 000	CENTRAL ILLINOIS PRODUCE (JH/HS)	08598820	0000000000	0223	BNK5	JH/HS BLDG-RAW FOOD AND DAIRY	B		02/03/2023	02/16/2023	A	\$291.20
							22-23					\$291.20
10E301 2562 4150 00 000000						NBHS FOOD RAW FOOD						\$231.45
10E301 2562 4151 00 000000						NBHS FOOD DAIRY PRODUCT						\$59.75
CENTIP 000	CENTRAL ILLINOIS PRODUCE (JH/HS)	08602517	0000000000	0223	BNK5	JH/HS BLDG-RAW FOOD AND DAIRY	B		02/06/2023	02/16/2023	A	\$917.30
							22-23					\$917.30
10E301 2562 4150 00 000000						NBHS FOOD RAW FOOD						\$736.90
10E301 2562 4151 00 000000						NBHS FOOD DAIRY PRODUCT						\$180.40
CENTIP 000	CENTRAL ILLINOIS PRODUCE (JH/HS)	08616022	0000000000	0223	BNK5	JH/HS BLDG-DAIRY	B		02/10/2023	02/16/2023	A	\$119.60
							22-23					\$119.60
10E301 2562 4151 00 000000						NBHS FOOD DAIRY PRODUCT						\$119.60
CENTIP 000	CENTRAL ILLINOIS PRODUCE (JH/HS)	08616025	0000000000	0223	BNK5	JH/HS BLDG-RAW FOOD AND DAIRY	B		02/13/2023	02/16/2023	A	\$937.70
							22-23					\$937.70

VEN-KEY	VENDOR NAME	INVOICE #	PO NUMBER	BATCH	BANK	DESCRIPTION	LQ	S	INV DATE	DUE DATE	C	NET AMOUNT
ACH VOID DOWNLOAD	DISCOUNT DESCRIPTION	DISC AMT	ADJUSTMENT DESCRIPTION	FY	ADJ AMT	CHECK NBR	INVOICE AMOUNT					
REF	CATALOG	DESCRIPTION	LQ	QTY	LINE AMOUNT							
ACCOUNT NUMBER(S)	QUICK KEY	ACCOUNT LEVEL DESCRIPTION	1099									ACCT AMOUNT
CENTIP 002	CENTRAL ILLINOIS PRODUCE (NBE)	08602510	0000000000	0223	BNK5	ELEM BLDG-DAIRY	B	02/08/2023	02/16/2023	A		\$240.20
							22-23					\$240.20
10E301 2562 4151 00 000000						NBHS FOOD DAIRY PRODUCT						\$240.20
CENTIP 002	CENTRAL ILLINOIS PRODUCE (NBE)	08602511	0000000000	0223	BNK5	ELEM BLDG-DAIRY	B	02/10/2023	02/16/2023	A		\$279.40
							22-23					\$279.40
10E103 2562 4151 00 000000						NBE FOOD PREP DAIRY PRODUCTS						\$279.40
CENTIP 002	CENTRAL ILLINOIS PRODUCE (NBE)	08602521	0000000000	0223	BNK5	JH/HS BLDG-DAIRY	B	02/08/2023	02/16/2023	A		\$159.80
							22-23					\$159.80
10E301 2562 4151 00 000000						NBHS FOOD DAIRY PRODUCT						\$159.80
CENTIP 002	CENTRAL ILLINOIS PRODUCE (NBE)	08602544	0000000000	0223	BNK5	PRE-K-DAIRY	B	02/10/2023	02/16/2023	A		\$78.40
							22-23					\$78.40
10E103 1125 4100 00 000000						NBE SM PK/EC SUPPLIES & SNACKS						\$19.60
10E500 2569 4100 00 000000						PRE-K OTH. FOOD SERV. GEN SUPP						\$58.80
CENTIP 002	CENTRAL ILLINOIS PRODUCE (NBE)	08616012	0000000000	0223	BNK5	ELEM BLDG-RAW FOOD AND DAIRY	B	02/13/2023	02/16/2023	A		\$417.70
							22-23					\$417.70
10E103 2562 4150 00 000000						NBE FOOD PREP RAW FOOD						\$301.30
10E103 2562 4151 00 000000						NBE FOOD PREP DAIRY PRODUCTS						\$116.40
NUMBER OF INVOICES: 19											\$4,651.90	
CERASH 000	CERAMIC SHOP (THE)	30733	3012023050	0223	BNK5	MISC CLASSROOM SUPPLIES	P B	02/06/2023	02/16/2023	A		\$893.93
							22-23					\$893.93
100						MANGIARACINA-ART CLASS & PHOTOGRAPHY			1.00			\$893.93
						CLASS SUPPLIES						
10E301 1117 4100 00 000000						NBHS GENERAL SUPPLIES						\$893.93
NUMBER OF INVOICES: 1											\$893.93	
COOPERAC000	COOPER, RACHEL	39.33	6032023057	0223	BNK5	MILAGE-BALANCED LITERACY	P B	02/06/2023	02/16/2023	A		\$39.30
							22-23					\$39.30

VEN-KEY	VENDOR NAME	INVOICE #	PO NUMBER	BATCH	BANK	DESCRIPTION	LQ	S	INV DATE	DUE DATE	C	NET AMOUNT
ACH VOID DOWNLOAD	DISCOUNT DESCRIPTION	DISC AMT	ADJUSTMENT DESCRIPTION	FY	ADJ AMT	CHECK NBR	INVOICE AMOUNT					
REF	CATALOG	DESCRIPTION	LQ	QTY	LINE AMOUNT							
ACCOUNT NUMBER(S)	QUICK KEY	ACCOUNT LEVEL DESCRIPTION	1099	ACCT AMOUNT								
GFI DIGI000	GFI DIGITAL	2454544				*****CONTINUED*****						
10E301 1117 3250 00 000000						NBHS RENTALS						\$120.01
10E305 2410 3250 00 000000						NBHS PRINCIPAL RENTALS						\$139.04
NUMBER OF INVOICES: 1											\$1,093.77	
GFS-JHHS000	GORDON FOOD SERVICE (JH/HS)	224827087	0000000000	0223	BNK5	JH/HS BLDG-FOOD DISP	B	01/24/2023	02/16/2023	W		\$2,047.78
							22-23				4070614	\$2,047.78
10E301 2562 4150 00 000000						NBHS FOOD RAW FOOD						\$1,919.94
10E301 2562 4160 00 000000						NBHS FOOD DISPOSABLE SUPP.						\$127.84
GFS-JHHS000	GORDON FOOD SERVICE (JH/HS)	225002647	0000000000	0223	BNK5	JH/HS BLDG-FOOD, DAIRY, DISP	B	01/31/2023	02/16/2023	W		\$3,740.88
							22-23				4070614	\$3,740.88
10E301 2562 4150 00 000000						NBHS FOOD RAW FOOD						\$3,134.36
10E301 2562 4151 00 000000						NBHS FOOD DAIRY PRODUCT						\$364.98
10E301 2562 4160 00 000000						NBHS FOOD DISPOSABLE SUPP.						\$241.54
GFS-JHHS000	GORDON FOOD SERVICE (JH/HS)	225169256	0000000000	0223	BNK5	JH/HS BLDG-RAW FOOD, DAIRY, DISP	B	02/07/2023	02/16/2023	W		\$2,600.10
							22-23				4070614	\$2,600.10
10E301 2562 4150 00 000000						NBHS FOOD RAW FOOD						\$1,854.55
10E301 2562 4151 00 000000						NBHS FOOD DAIRY PRODUCT						\$218.14
10E301 2562 4160 00 000000						NBHS FOOD DISPOSABLE SUPP.						\$481.55
10E301 2562 4170 00 000000						NBHS FOOD SMALLWARE						\$45.86
GFS-JHHS000	GORDON FOOD SERVICE (JH/HS)	225169267	0000000000	0223	BNK5	JH/HS BLDG-RAW FOOD	B	02/07/2023	02/16/2023	W		\$62.39
							22-23				4070614	\$62.39
10E301 2562 4150 00 000000						NBHS FOOD RAW FOOD						\$62.39
GFS-JHHS000	GORDON FOOD SERVICE (JH/HS)	841299511	0000000000	0223	BNK5	JH/HS BLDG-FOOD	B	02/06/2023	02/16/2023	W		\$142.45
							22-23				4070614	\$142.45
10E301 2562 4150 00 000000						NBHS FOOD RAW FOOD						\$142.45

VEN-KEY	VENDOR NAME	INVOICE #	PO NUMBER	BATCH	BANK	DESCRIPTION	LQ	S	INV DATE	DUE DATE	C	NET AMOUNT
ACH VOID DOWNLOAD	DISCOUNT DESCRIPTION	DISC AMT	ADJUSTMENT DESCRIPTION	FY	ADJ AMT	CHECK NBR	INVOICE AMOUNT					
REF	CATALOG	DESCRIPTION	LQ	QTY	LINE AMOUNT							
ACCOUNT NUMBER(S)	QUICK KEY	ACCOUNT LEVEL DESCRIPTION	1099									ACCT AMOUNT
NUMBER OF INVOICES: 5												\$8,593.60
GFS-NBE 000	GORDON FOOD SERVICE (NBE)	224827086	0000000000	0223	BNK5	PRE-K SNACKS	B		01/24/2023	02/16/2023	W	\$423.23
							22-23					\$423.23
	10E103 1125 4100 00 000000					NBE SM PK/EC SUPPLIES & SNACKS						\$103.56
	10E500 2569 4100 00 000000					PRE-K OTH. FOOD SERV. GEN SUPP						\$319.67
GFS-NBE 000	GORDON FOOD SERVICE (NBE)	224827098	0000000000	0223	BNK5	ELEM BLDG-RAW FOOD, DAIRY, DISP	B		01/24/2023	02/16/2023	W	\$2,055.65
							22-23					\$2,055.65
	10E103 2562 4150 00 000000					NBE FOOD PREP RAW FOOD						\$1,640.86
	10E103 2562 4151 00 000000					NBE FOOD PREP DAIRY PRODUCTS						\$116.26
	10E103 2562 4160 00 000000					NBE FOOD PREP DISP. SUPPLIES						\$298.53
GFS-NBE 000	GORDON FOOD SERVICE (NBE)	225002638	0000000000	0223	BNK5	ELEM BLDG-RAW FOOD, DAIRY, DISP	B		01/31/2023	02/16/2023	W	\$2,465.44
							22-23					\$2,465.44
	10E103 2562 4150 00 000000					NBE FOOD PREP RAW FOOD						\$2,069.65
	10E103 2562 4151 00 000000					NBE FOOD PREP DAIRY PRODUCTS						\$197.34
	10E103 2562 4160 00 000000					NBE FOOD PREP DISP. SUPPLIES						\$147.21
	10E103 2562 4170 00 000000					NBE FOOD PREP SMALLWARE						\$51.24
GFS-NBE 000	GORDON FOOD SERVICE (NBE)	225169266	0000000000	0223	BNK5	ELEM BLDG-RAW FOOD, DAIRY, DISP	B		02/07/2023	02/16/2023	W	\$1,873.95
							22-23					\$1,873.95
	10E103 2562 4150 00 000000					NBE FOOD PREP RAW FOOD						\$1,371.86
	10E103 2562 4151 00 000000					NBE FOOD PREP DAIRY PRODUCTS						\$165.18
	10E103 2562 4160 00 000000					NBE FOOD PREP DISP. SUPPLIES						\$306.65
	10E103 2562 4170 00 000000					NBE FOOD PREP SMALLWARE						\$30.26
GFS-NBE 000	GORDON FOOD SERVICE (NBE)	225169269	0000000000	0223	BNK5	ELEM BLDG-FOOD	B		02/07/2023	02/16/2023	W	\$49.46
							22-23					\$49.46
	10E103 2562 4150 00 000000					NBE FOOD PREP RAW FOOD						\$49.46

VEN-KEY	VENDOR NAME	INVOICE #	PO NUMBER	BATCH	BANK	DESCRIPTION	LQ	S	INV DATE	DUE DATE	C	NET AMOUNT
ACH VOID DOWNLOAD	DISCOUNT DESCRIPTION	DISC AMT	ADJUSTMENT DESCRIPTION	FY	ADJ AMT	CHECK NBR	INVOICE AMOUNT					
REF	CATALOG	DESCRIPTION	LQ	QTY	LINE AMOUNT							
ACCOUNT NUMBER(S)	QUICK KEY	ACCOUNT LEVEL DESCRIPTION	1099									ACCT AMOUNT
NUMBER OF INVOICES: 5												\$6,867.73
GRAPHIC 000	GRAPHIC EDGE	1657064	3012023042	0223	BNK5	RALLY TOWEL MR. SALTY	P	B	02/06/2023	02/16/2023	R	\$322.43
							22-23					\$322.43
100		LLEWELLYN-JH & HS READING & MATH INTERVENTION SUBSCRIPTION (MY PATH EDGENUITY)						1.00				\$322.43
10E301	1117 3900 00 000000					NBHS OTHER PURCHASED SERVICES						\$322.43
NUMBER OF INVOICES: 1												\$322.43
IACONCHR000	IACONO, CHRISTINA	75.00	6032023076	0223	BNK5	CI5513-PROFESSIONAL DEVELOPMENT ALLOCATION - 22-23 - IACONO	P	B	01/20/2023	02/16/2023	A	\$75.00
							22-23					\$75.00
100		PROFESSIONAL DEVELOPMENT ALLOCATION - 22-23 - IACONO						1.00				\$75.00
10E103	2213 3320 00 000000					NBE WRKSHOP TRAVEL						\$75.00
IACONCHR000	IACONO, CHRISTINA	750.00	6032023077	0223	BNK5	CI5513-TUITION REIMBURSEMENT ALLOCATION - 22-23 - IACONO	P	B	01/20/2023	02/16/2023	A	\$750.00
							22-23					\$750.00
100		TUITION REIMBURSEMENT ALLOCATION - 21-22 - IACONO						1.00				\$750.00
10E103	1113 2300 00 000000					NBE BEN TUITION REIMB						\$750.00
NUMBER OF INVOICES: 2												\$825.00
IDSIGNS 000	ID SIGNS	234750	3012023042	0223	BNK5	STUDENT OF CHARACTER LIVES HERE SIGN	P	B	01/30/2023	02/16/2023	A	\$487.50
							22-23					\$487.50
100		LLEWELLYN-JH & HS READING & MATH INTERVENTION SUBSCRIPTION (MY PATH EDGENUITY)						1.00				\$487.50

VEN-KEY	VENDOR NAME	INVOICE #	PO NUMBER	BATCH	BANK	DESCRIPTION	LQ	S	INV DATE	DUE DATE	C	NET AMOUNT
ACH VOID DOWNLOAD	DISCOUNT DESCRIPTION	DISC AMT	ADJUSTMENT DESCRIPTION	FY	ADJ AMT	CHECK NBR	INVOICE AMOUNT					
REF	CATALOG	DESCRIPTION	LQ	QTY	LINE AMOUNT							
ACCOUNT NUMBER(S)	QUICK KEY	ACCOUNT LEVEL DESCRIPTION	1099									ACCT AMOUNT
ILLDQ 001	ILLINOIS DEPT OF REVENUE	20230215ADSTX				*****CONTINUED*****						
	20L000 4530 0000 00 000000											\$736.78
	40L000 4530 0000 00 000000											\$1,229.75
NUMBER OF INVOICES: 6												\$27,252.75
ILLEA 001	ILLINOIS EDUCATION ASSN	20230201ADII	0000000000	P1	BNK5	Payroll accrual	H	02/01/2023	02/01/2023	R		\$2,906.90
	10L000 4593 0000 00 000000						22-23				59967	\$2,906.90
												\$2,906.90
ILLEA 001	ILLINOIS EDUCATION ASSN	20230215ADII	0000000000	P1	BNK5	Payroll accrual	B	02/15/2023	02/15/2023	R		\$2,906.90
	10L000 4593 0000 00 000000						22-23					\$2,906.90
												\$2,906.90
NUMBER OF INVOICES: 2												\$5,813.80
ILMLR 001	IL MUNICIPAL RETIREMENT	20230201ADIM	0000000000	P9	BNK5	Payroll accrual	B	02/01/2023	02/01/2023	W		\$5,043.50
	10L000 4540 0000 00 000000						22-23				202200421	\$5,043.50
	20L000 4540 0000 00 000000											\$3,230.77
	40L000 4540 0000 00 000000											\$735.50
												\$1,077.23
ILMLR 001	IL MUNICIPAL RETIREMENT	20230201ADIMV2	0000000000	P9	BNK5	Payroll accrual	B	02/01/2023	02/01/2023	W		\$702.38
	10L000 4540 0000 00 000000						22-23				202200421	\$702.38
	20L000 4540 0000 00 000000											\$174.08
	40L000 4540 0000 00 000000											\$149.06
												\$379.24
ILMLR 001	IL MUNICIPAL RETIREMENT	20230201ADTPDP1	0000000000	P9	BNK5	Payroll accrual	B	02/01/2023	02/01/2023	H		\$0.00
	10L000 4540 0000 00 000000						22-23					\$0.00
												\$0.00
ILMLR 001	IL MUNICIPAL RETIREMENT	20230201AFRM	0000000000	P9	BNK5	Payroll accrual	B	02/01/2023	02/01/2023	W		\$7,394.23
							22-23				202200421	\$7,394.23

VEN-KEY	VENDOR NAME	INVOICE #	PO NUMBER	BATCH	BANK	DESCRIPTION	LQ	S	INV DATE	DUE DATE	C	NET AMOUNT
ACH VOID DOWNLOAD	DISCOUNT DESCRIPTION	DISC AMT	ADJUSTMENT DESCRIPTION	FY	ADJ AMT	CHECK NBR	INVOICE AMOUNT					
REF	CATALOG	DESCRIPTION	LQ	QTY	LINE AMOUNT							
ACCOUNT NUMBER(S)	QUICK KEY	ACCOUNT LEVEL DESCRIPTION	1099	ACCT AMOUNT								
ILMLR 001	IL MUNICIPAL RETIREMENT	20230201AFRM										
50L000 4572 0000 00 000000		*****CONTINUED*****										\$7,394.23
ILMLR 001	IL MUNICIPAL RETIREMENT	20230201AFRMA	0000000000	P9	BNK5	Payroll accrual	B	02/01/2023	02/01/2023	W		\$0.00
50L000 4572 0000 00 000000							22-23			202200421		\$0.00
												\$0.00
ILMLR 001	IL MUNICIPAL RETIREMENT	20230215ADIM	0000000000	P9	BNK5	Payroll accrual	B	02/15/2023	02/15/2023	W		\$5,203.88
10L000 4540 0000 00 000000							22-23			202200448		\$5,203.88
20L000 4540 0000 00 000000												\$3,334.28
40L000 4540 0000 00 000000												\$743.88
												\$1,125.72
ILMLR 001	IL MUNICIPAL RETIREMENT	20230215ADIMV2	0000000000	P9	BNK5	Payroll accrual	B	02/15/2023	02/15/2023	W		\$794.09
10L000 4540 0000 00 000000							22-23			202200448		\$794.09
20L000 4540 0000 00 000000												\$249.40
40L000 4540 0000 00 000000												\$149.69
												\$395.00
ILMLR 001	IL MUNICIPAL RETIREMENT	20230215ADTPDP1	0000000000	P9	BNK5	Payroll accrual	B	02/15/2023	02/15/2023	H		\$0.00
10L000 4540 0000 00 000000							22-23					\$0.00
												\$0.00
ILMLR 001	IL MUNICIPAL RETIREMENT	20230215AFRM	0000000000	P9	BNK5	Payroll accrual	B	02/15/2023	02/15/2023	W		\$7,629.44
50L000 4572 0000 00 000000							22-23			202200448		\$7,629.44
												\$7,629.44
ILMLR 001	IL MUNICIPAL RETIREMENT	20230215AFRMA	0000000000	P9	BNK5	Payroll accrual	B	02/15/2023	02/15/2023	W		\$0.00
50L000 4572 0000 00 000000							22-23			202200448		\$0.00
												\$0.00
ILMLR 001	IL MUNICIPAL RETIREMENT	CUMMINGS	0000000000	LDN0123	BNK5	OMITTED EMPLOYEE CONTRIBUTIONS - CUMMINGS	H	01/31/2023	01/31/2023	R		\$1,403.70
							22-23			59969		\$1,403.70

VEN-KEY	VENDOR NAME	INVOICE #	PO NUMBER	BATCH	BANK	DESCRIPTION	LQ	S	INV DATE	DUE DATE	C	NET AMOUNT
ACH VOID	DOWNLOAD	DISCOUNT DESCRIPTION		DISC AMT		ADJUSTMENT DESCRIPTION	FY		ADJ AMT	CHECK NBR		INVOICE AMOUNT
REF	CATALOG	DESCRIPTION					LQ		QTY			LINE AMOUNT
ACCOUNT NUMBER(S)		QUICK KEY	ACCOUNT LEVEL	DESCRIPTION	1099							ACCT AMOUNT
						NUMBER OF INVOICES:	1					\$60.00
KOEHLWES000	KOEHLER, WESLEY	175.00	0000000000	0223	BNK5	WEBSITE SERVICES MONTHLY BILLING	B		02/02/2023	02/16/2023	R	\$175.00
10E000	2225 3900 00 000000					ADMIN OTHER PURCH. SERVICES NONEM	22-23					\$175.00
						NUMBER OF INVOICES:	1					\$175.00
LEVIRS 000	LEVI, RAY & SHOUP, INC	288437	0000000000	0223	BNK5	LICENSE TO BACKUP SERVERS	B		02/07/2023	02/16/2023	A	\$409.00
10E000	2225 3190 00 000000					TECH PS OTHER PROF SERVICES	22-23					\$409.00
						NUMBER OF INVOICES:	1					\$409.00
LINCPBHC000	LINCOLN PRAIRIE BHC	2021-17964	0000000000	0223	BNK5	HOSPITAL BOUND STUDENT	B		01/31/2023	02/16/2023	R	\$200.00
10E000	4120 8000 00 000000						22-23					\$200.00
						NUMBER OF INVOICES:	1					\$200.00
LOWSHC 000	LOWE'S HOME IMPROVEMENT	912707	0000000000	0223	BNK5	ELEM BLDG-WALL ANCHORS	B		02/02/2023	02/16/2023	W	\$73.65
20E103	2542 4100 00 000000					NBE CARE/UPKEEP GEN SUPPLIES	22-23			202200442		\$73.65
						NUMBER OF INVOICES:	1					\$73.65
MEDIACOM000	MEDIACOM	8384910760090109	0000000000	0223	BNK5	EXTRA BAN WIDTH FOR T-1 LINE 02/01/23-02/28/23	B		01/21/2023	02/16/2023	W	\$2,625.00
20E000	2542 3400 00 000000					OPS MAINT. UPKEEP BLDG COMMUN.	22-23			21623109		\$2,625.00
						NUMBER OF INVOICES:	1					\$2,625.00
MENAR 001	MENARDS	27357	0000000000	0223	BNK5	ELEM BLDG-SUPPLIES	B		01/27/2023	02/16/2023	R	\$108.45

VEN-KEY	VENDOR NAME	INVOICE #	PO NUMBER	BATCH	BANK	DESCRIPTION	LQ	S	INV DATE	DUE DATE	C	NET AMOUNT
REF	CATALOG	DISCOUNT DESCRIPTION		DISC AMT		ADJUSTMENT DESCRIPTION	FY		ADJ AMT	CHECK NBR		INVOICE AMOUNT
ACCOUNT NUMBER(S)		DESCRIPTION	QUICK KEY	ACCOUNT LEVEL	DESCRIPTION	1099	LQ		QTY			LINE AMOUNT
												ACCT AMOUNT
						NUMBER OF INVOICES: 2						\$32.00
NEWBE	001 NEW BERLIN EDUCATION ASSN.	20230201ADNB	0000000000	P1	BNK5	Payroll accrual	H		02/01/2023	02/01/2023	A	\$297.50
	10L000 4595 0000 00 000000						22-23			222300213		\$297.50
											\$297.50	
NEWBE	001 NEW BERLIN EDUCATION ASSN.	20230215ADNB	0000000000	P1	BNK5	Payroll accrual	B		02/15/2023	02/15/2023	A	\$297.50
	10L000 4595 0000 00 000000						22-23					\$297.50
											\$297.50	
						NUMBER OF INVOICES: 2						\$595.00
NEWBW	001 NEW BERLIN WATER & SEWER DPT	0010004900	0000000000	0223	BNK5	JH/HS BLDG- WATER AND SEWER CHARGE 12/27/22 TO 01/27/23	B		02/07/2023	02/16/2023	W	\$1,208.11
	20E301 2542 3700 00 000000					NBHS WATER SEWER SERVICES	22-23			202200445		\$1,208.11
											\$1,208.11	
NEWBW	001 NEW BERLIN WATER & SEWER DPT	0020049300	0000000000	0223	BNK5	NEW BERLIN ELEMENTARY WATER & SEWER 12/27/22-01/27/23	B		02/07/2023	02/16/2023	W	\$749.66
	20E103 2542 3700 00 000000					NBE CARE/UPKEEP WATER SEWER	22-23			202200445		\$749.66
											\$749.66	
						NUMBER OF INVOICES: 2						\$1,957.77
NIEMELOR000	NIEMEIER, LORI	23.58	0000000000	0223	BNK5	MILEAGE-WCIASBO MEETING	B		02/14/2023	02/16/2023	A	\$23.58
	10E000 2520 3320 00 000000					FS TRAVEL	22-23					\$23.58
											\$23.58	
NIEMELOR000	NIEMEIER, LORI	382.23	0000000000	0223	BNK5	BLACK BOX OF SPECIAL EDUCATION	B		01/24/2023	02/16/2023	A	\$382.23
	10E000 2520 3320 00 000000					FS TRAVEL	22-23					\$382.23
											\$382.23	

VEN-KEY	VENDOR NAME	INVOICE #	PO NUMBER	BATCH	BANK	DESCRIPTION	LQ	S	INV DATE	DUE DATE	C	NET AMOUNT	
ACH VOID DOWNLOAD	DISCOUNT DESCRIPTION	DISC AMT	ADJUSTMENT DESCRIPTION	FY	ADJ AMT	CHECK NBR	INVOICE AMOUNT	REF	CATALOG	DESCRIPTION	LQ	QTY	LINE AMOUNT
ACCOUNT NUMBER(S)	QUICK KEY	ACCOUNT LEVEL DESCRIPTION	1099									ACCT AMOUNT	
NUMBER OF INVOICES: 2												\$405.81	
O'BRIJOS000	O'BRIEN, JOSEPH	75.00	0000000000	021023	BNK2	GIRLS JH VOLLEYBALL 2-9-23	H		02/06/2023	02/10/2023	V	\$75.00	
10E000 1500 3190 00 000000						INTERSC PGRM OTHER PRO & TECH NONEM	22-23					104629	\$75.00
NUMBER OF INVOICES: 1												-\$75.00	
PEPPJW 001	J.W. PEPPER & SON, INC.	364992195	3012023047	0223	BNK5	LIVE WIRE P.O.D.	P	B	01/24/2023	02/16/2023	A	\$50.00	
100						MORIS & NEW BAND TEACHER -JH/HS BAND & CHOIR SUPPLIES/SUBSCRIPTION	22-23					1.00	\$50.00
10E301 1117 4100 00 000000						NBHS GENERAL SUPPLIES							\$50.00
PEPPJW 001	J.W. PEPPER & SON, INC.	365004236	3012023047	0223	BNK5	ROCK ISLAND EXPRESS SCORE	P	B	01/26/2023	02/16/2023	A	\$16.00	
100						MORIS & NEW BAND TEACHER -JH/HS BAND & CHOIR SUPPLIES/SUBSCRIPTION	22-23					1.00	\$16.00
10E301 1117 4100 00 000000						NBHS GENERAL SUPPLIES							\$16.00
NUMBER OF INVOICES: 2												\$66.00	
PETTYLEV000	PETTY, LEVI	75.00	0000000000	020223	BNK2	OFFICIAL FOR VARSITY SCHOLASTIC BOWL - 2-2-23	H		02/02/2023	02/02/2023	V	\$75.00	
10E000 1500 3190 00 000000						INTERSC PGRM OTHER PRO & TECH	22-23					104607	\$75.00
NUMBER OF INVOICES: 1												-\$75.00	
PORTA HI000	PORTA HIGH SCHOOL	200.00	7002023019	50	BNK2	PORTA SLAM	P	H	01/27/2023	02/16/2023	R	\$200.00	
100						LUCAS-ATHLETIC FEES/TOURNEY FEES/IESA DUES/SCHOLASTIC BOWL/CHEERLEADING FEES	22-23					104598	\$200.00
10E000 1500 6400 00 000000						INTERSC PRGM DUES AND FEES							\$200.00

VEN-KEY	VENDOR NAME	INVOICE #	PO NUMBER	BATCH	BANK	DESCRIPTION	LQ	S	INV DATE	DUE DATE	C	NET AMOUNT
ACH VOID DOWNLOAD	DISCOUNT DESCRIPTION	DISC AMT	ADJUSTMENT DESCRIPTION	FY	ADJ AMT	CHECK NBR	INVOICE AMOUNT					
REF	CATALOG	DESCRIPTION	LQ	QTY	LINE AMOUNT							
ACCOUNT NUMBER(S)	QUICK KEY	ACCOUNT LEVEL DESCRIPTION	1099									ACCT AMOUNT
NUMBER OF INVOICES: 2												\$543.16
PURT	001 PURITAN SPRING WATER	804035012	0000000000	0223	BNK5	DISTRICT OFFICE WATER	B		01/19/2023	02/16/2023	R	\$58.41
									22-23			\$58.41
	10E000 2321 4100 00 000000					SUPINT. OFFICE GEN SUPP						\$58.41
PURT	001 PURITAN SPRING WATER	804042862	0000000000	0223	BNK5	HS BLDG-WATER	B		02/02/2023	02/16/2023	R	\$237.63
									22-23			\$237.63
	10E301 2410 4100 00 000000											\$237.63
PURT	001 PURITAN SPRING WATER	804043023	0000000000	0223	BNK5	JH BLDG-WATER	B		02/02/2023	02/16/2023	R	\$104.70
									22-23			\$104.70
	10E202 2410 4100 00 000000					NBJH PRINCIPAL GEN SUPPLIES						\$104.70
NUMBER OF INVOICES: 3												\$400.74
REPUBLIC000	REPUBLIC SERVICES	0352-002842334	0000000000	0223	BNK5	GARBAGE-DISPOSAL SERVICE	B		01/31/2023	02/16/2023	R	\$1,150.88
									22-23			\$1,150.88
	20E103 2542 3210 00 000000					NBE CARE/UPKEEP SANITATION						\$460.35
	20E301 2542 3210 00 000000					NBHS CARE/UPKEEP SANITATION						\$460.35
	40E000 2552 3210 00 000000					TRANS PS SANITATION SERV						\$230.18
NUMBER OF INVOICES: 1												\$1,150.88
SANDS	001 SANGAMON DIESEL SERVICE	99119	0000000000	0223	BNK5	TRANS-BUS TESING 117,14,17,4	B		01/19/2023	02/16/2023	R	\$175.00
									22-23			\$175.00
	40E000 2552 3190 00 000000					TRANS PS OTHER PROF SERV						\$175.00
NUMBER OF INVOICES: 1												\$175.00
SANGMROE000	SANGAMON-MENARD CO. R O E	29-16-0123	0000000000	0223	BNK5	FINGERPRINT/BACKGROUND-MACHIN	B		02/03/2023	02/16/2023	R	\$92.00
									22-23			\$92.00
	10E000 2311 6400 00 000000					SCH BD DUES & FEES						\$92.00

VEN-KEY	VENDOR NAME	INVOICE #	PO NUMBER	BATCH	BANK	DESCRIPTION	LQ	S	INV DATE	DUE DATE	C	NET AMOUNT
ACH VOID DOWNLOAD	DISCOUNT DESCRIPTION	DISC AMT	ADJUSTMENT DESCRIPTION	FY	ADJ AMT	CHECK NBR	INVOICE AMOUNT					
REF	CATALOG	DESCRIPTION	LQ	QTY	LINE AMOUNT							
ACCOUNT NUMBER(S)	QUICK KEY	ACCOUNT LEVEL DESCRIPTION	1099									ACCT AMOUNT
NUMBER OF INVOICES: 1												\$92.00
SASED 001	SANGAMON AREA SPECIAL EDUCATION	179705.66	0000000000	0223	BNK5	SASED-3RD QUARTER	B		01/20/2023	02/16/2023	R	\$179,705.66
10E000 4120 6000 00 000000						SPECIAL PROGRAMS TUITION	22-23					\$179,705.66
												\$179,705.66
NUMBER OF INVOICES: 1												\$179,705.66
SASEDLF 000	SASED LUNCH FUND	LUNCH-JAN	0000000000	0223	BNK5	STUDENT LUNCH PROGRAM	B		02/06/2023	02/16/2023	R	\$93.50
10E301 2562 4150 00 000000						NBHS FOOD RAW FOOD	22-23					\$93.50
												\$93.50
NUMBER OF INVOICES: 1												\$93.50
SCHOOL S001	SCHOOL SPECIALTY LLC	308104223567	1032023303	0223	BNK5	MAXEDON -TEACHER SUPPLIES FOR ADDITIONAL NEEDS	P	B	01/19/2023	02/16/2023	R	\$592.67
100		MAXEDON-TEACHER SUPPLIES FOR ADDITIONAL NEEDS					22-23					\$592.67
10E103 1113 4100 00 000000						NBE SM GENERAL SUPPLIES			1.00			\$592.67
												\$592.67
NUMBER OF INVOICES: 1												\$592.67
SENIC 001	SENTINEL INSECT CONTROL	310272	0000000000	0223	BNK5	JH/HS BLDG-PEST CONTROL	B		02/01/2023	02/16/2023	R	\$76.00
20E301 2542 3210 00 000000						NBHS CARE/UPKEEP SANITATION	22-23					\$76.00
												\$76.00
SENIC 001	SENTINEL INSECT CONTROL	310273	0000000000	0223	BNK5	ELEM BLDG-PEST CONTROL	B		02/01/2023	02/16/2023	R	\$46.00
20E103 2542 3210 00 000000						NBE CARE/UPKEEP SANITATION	22-23					\$46.00
												\$46.00
NUMBER OF INVOICES: 2												\$122.00
SPRINT -000	SPRINT - TMOBILE	464593457-039	0000000000	0223	BNK5	COMMUNICATION FOR CAFE	B		01/30/2023	02/16/2023	W	\$18.77

VEN-KEY	VENDOR NAME	INVOICE #	PO NUMBER	BATCH	BANK	DESCRIPTION	LQ	S	INV DATE	DUE DATE	C	NET AMOUNT
ACH VOID DOWNLOAD	DISCOUNT DESCRIPTION	DISC AMT	ADJUSTMENT DESCRIPTION	FY	ADJ AMT	CHECK NBR	INVOICE AMOUNT					
REF	CATALOG	DESCRIPTION	LQ	QTY	LINE AMOUNT							
ACCOUNT NUMBER(S)	QUICK KEY	ACCOUNT LEVEL DESCRIPTION	1099									ACCT AMOUNT
SPRINT -000	SPRINT - TMOBILE	464593457-039				*****CONTINUED*****						
							22-23			202200440		\$18.77
20E000 2542 3400 00 000000						OPS MAINT. UPKEEP BLDG COMMUN.						\$18.77
						NUMBER OF INVOICES: 1						\$18.77
SUSZKGIN000	SUSZKO, GINA	75.00	0000000000	021023	BNK2	COED VARSITY SCHOLASTIC BOWL-2-2-23	H		02/02/2023	02/10/2023	V	\$75.00
							22-23			104610		\$75.00
10E000 1500 3190 00 000000						INTERSC PGRM OTHER PRO & TECH						\$75.00
						NUMBER OF INVOICES: 1						\$-75.00
T-MOBILE000	T-MOBILE	983463561-FEB	0000000000	0223	BNK5	SERVICE FOR 12-19-22 TO 1-18-23	B		02/10/2023	02/16/2023	R	\$60.00
							22-23					\$60.00
20E000 2542 3400 00 000000						OPS MAINT. UPKEEP BLDG COMMUN.						\$60.00
						NUMBER OF INVOICES: 1						\$60.00
TEXAS LI000	TEXAS LIFE INSURANCE CO.	20230201ADAF3	0000000000	P9	BNK5	Payroll accrual	B		02/01/2023	02/01/2023	W	\$244.65
							22-23			202200430		\$244.65
10L000 4581 0000 00 000000						AM FIDELITY SUPPLEMENTAL W/H						\$215.44
40L000 4581 0000 00 000000												\$29.21
TEXAS LI000	TEXAS LIFE INSURANCE CO.	20230215ADAF3	0000000000	P9	BNK5	Payroll accrual	B		02/15/2023	02/15/2023	W	\$244.65
							22-23			202200457		\$244.65
10L000 4581 0000 00 000000						AM FIDELITY SUPPLEMENTAL W/H						\$215.44
40L000 4581 0000 00 000000												\$29.21
						NUMBER OF INVOICES: 2						\$489.30
THIS 001 THIS		20230201ADT88EE	0000000000	P1	BNK5	Payroll accrual	H		02/01/2023	02/01/2023	W	\$1,573.79
							22-23			202200423		\$1,573.79

VEN-KEY	VENDOR NAME	INVOICE #	PO NUMBER	BATCH	BANK	DESCRIPTION	LQ	S	INV DATE	DUE DATE	C	NET AMOUNT
REF	CATALOG	DISCOUNT DESCRIPTION		DISC AMT		ADJUSTMENT DESCRIPTION	FY		ADJ AMT	CHECK NBR		INVOICE AMOUNT
ACCOUNT NUMBER(S)	QUICK KEY	ACCOUNT LEVEL DESCRIPTION	1099				LQ		QTY			LINE AMOUNT
												ACCT AMOUNT
TRS 001	TRS STATE OF ILLINOIS	20230201BFT58EE				*****CONTINUED*****						
	10L000 4510 0000 00 000000											\$-9.90
TRS 001	TRS STATE OF ILLINOIS	20230201BFT94EE	0000000000	P1	BNK5	Payroll accrual	H	02/01/2023	02/01/2023	W		\$-121.65
	10L000 4510 0000 00 000000						22-23			202200424		\$-121.65
												\$-121.65
TRS 001	TRS STATE OF ILLINOIS	20230201CFT58EE	0000000000	P1	BNK5	Payroll accrual	H	02/01/2023	02/01/2023	W		\$8.80
	10L000 4510 0000 00 000000						22-23			202200424		\$8.80
												\$8.80
TRS 001	TRS STATE OF ILLINOIS	20230201CFT94EE	0000000000	P1	BNK5	Payroll accrual	H	02/01/2023	02/01/2023	W		\$108.14
	10L000 4510 0000 00 000000						22-23			202200424		\$108.14
												\$108.14
TRS 001	TRS STATE OF ILLINOIS	20230215ADT94SB	0000000000	P1	BNK5	Payroll accrual	B	02/15/2023	02/15/2023	W		\$222.75
	10L000 4510 0000 00 000000						22-23			202200451		\$222.75
												\$222.75
TRS 001	TRS STATE OF ILLINOIS	20230215AFT58AJ	0000000000	P1	BNK5	Payroll accrual	B	02/15/2023	02/15/2023	W		\$0.00
	10L000 4510 0000 00 000000						22-23			202200451		\$0.00
												\$0.00
TRS 001	TRS STATE OF ILLINOIS	20230215AFT58EE	0000000000	P1	BNK5	Payroll accrual	B	02/15/2023	02/15/2023	W		\$1,095.45
	10L000 4510 0000 00 000000						22-23			202200451		\$1,095.45
	40L000 4510 0000 00 000000											\$1,095.34
												\$0.11
TRS 001	TRS STATE OF ILLINOIS	20230215AFT58SB	0000000000	P1	BNK5	Payroll accrual	B	02/15/2023	02/15/2023	W		\$15.37
	10L000 4510 0000 00 000000						22-23			202200451		\$15.37
												\$15.37
TRS 001	TRS STATE OF ILLINOIS	20230215AFT58SS	0000000000	P1	BNK5	Payroll accrual	B	02/15/2023	02/15/2023	W		\$48.65
							22-23			202200451		\$48.65

VEN-KEY	VENDOR NAME	INVOICE #	PO NUMBER	BATCH	BANK	DESCRIPTION	LQ	S	INV DATE	DUE DATE	C	NET AMOUNT
ACH VOID DOWNLOAD	DISCOUNT DESCRIPTION	DISC AMT	ADJUSTMENT DESCRIPTION	FY	ADJ AMT	CHECK NBR	INVOICE AMOUNT					
REF	CATALOG	DESCRIPTION	LQ	QTY	LINE AMOUNT							
ACCOUNT NUMBER(S)	QUICK KEY	ACCOUNT LEVEL DESCRIPTION	1099									ACCT AMOUNT
TRS 001	TRS STATE OF ILLINOIS	20230215AFT58SS				*****CONTINUED*****						\$48.65
	10L000 4510 0000 00 000000											
TRS 001	TRS STATE OF ILLINOIS	20230215AFT58SU	0000000000	P1	BNK5	Payroll accrual	B	02/15/2023	02/15/2023	W		\$68.81
	10L000 4510 0000 00 000000						22-23				202200451	\$68.81
												\$68.81
TRS 001	TRS STATE OF ILLINOIS	20230215AFT58TA	0000000000	P1	BNK5	Payroll accrual	B	02/15/2023	02/15/2023	W		\$87.63
	10L000 4510 0000 00 000000						22-23				202200451	\$87.63
												\$87.63
TRS 001	TRS STATE OF ILLINOIS	20230215AFT94AJ	0000000000	P1	BNK5	Payroll accrual	B	02/15/2023	02/15/2023	W		\$0.00
	10L000 4510 0000 00 000000						22-23				202200451	\$0.00
												\$0.00
TRS 001	TRS STATE OF ILLINOIS	20230215AFT94EE	0000000000	P1	BNK5	Payroll accrual	B	02/15/2023	02/15/2023	W		\$15,627.90
	10L000 4510 0000 00 000000						22-23				202200451	\$15,627.90
	40L000 4510 0000 00 000000											\$15,626.04
												\$1.86
TRS 001	TRS STATE OF ILLINOIS	20230215AFT94SS	0000000000	P1	BNK5	Payroll accrual	B	02/15/2023	02/15/2023	W		\$768.18
	10L000 4510 0000 00 000000						22-23				202200451	\$768.18
												\$768.18
TRS 001	TRS STATE OF ILLINOIS	20230215AFT94SU	0000000000	P1	BNK5	Payroll accrual	B	02/15/2023	02/15/2023	W		\$1,067.67
	10L000 4510 0000 00 000000						22-23				202200451	\$1,067.67
												\$1,067.67
TRS 001	TRS STATE OF ILLINOIS	20230215AFT94TA	0000000000	P1	BNK5	Payroll accrual	B	02/15/2023	02/15/2023	W		\$1,359.61
	10L000 4510 0000 00 000000						22-23				202200451	\$1,359.61
												\$1,359.61
TRS 001	TRS STATE OF ILLINOIS	20230215AFTFED	0000000000	P1	BNK5	Payroll accrual	B	02/15/2023	02/15/2023	W		\$600.81
							22-23				202200451	\$600.81

VEN-KEY	VENDOR NAME	INVOICE #	PO NUMBER	BATCH	BANK	DESCRIPTION	LQ	S	INV DATE	DUE DATE	C	NET AMOUNT
ACH VOID DOWNLOAD	DISCOUNT DESCRIPTION	DISC AMT	ADJUSTMENT DESCRIPTION	FY	ADJ AMT	CHECK NBR	INVOICE AMOUNT					
REF	CATALOG	DESCRIPTION	LQ	QTY	LINE AMOUNT							
ACCOUNT NUMBER(S)	QUICK KEY	ACCOUNT LEVEL DESCRIPTION	1099		ACCT AMOUNT							

WELLSF 000	WELLS FARGO VENDOR FIN SERV	5023593952	*****CONTINUED*****									
10E103 2410 3250 00 000000												\$114.82
10E202 1115 3250 00 000000												\$132.69
10E202 2410 3250 00 000000												\$114.82
10E301 1117 3250 00 000000												\$132.69
10E305 2410 3250 00 000000												\$132.65

NUMBER OF INVOICES: 1 \$1,113.00

TOTAL NUMBER OF BATCH INVOICES: 208 \$627,037.73
TOTAL NUMBER OF HISTORY INVOICES: 65 \$106,429.54

71 ACH CHECK INVOICES \$232,843.73

40 COMPUTER CHECK INVOICES \$251,825.45

3 VOID CHECK INVOICES \$-225.00

159 WIRE TRAN CHECK INVOICES \$249,023.09

TOTAL INVOICES: 273 \$733,467.27

BANK TOTALS:	BANK	BANK ACCOUNT #	INVOICE AMOUNT	NET AMOUNT
	BNK2	**A000 1050 0000 00 000000	\$-25.00	\$-25.00
	BNK5	**A000 1010 0000 00 000000	\$733,492.27	\$733,492.27

LIQUIDATION STATUS (LQ) CODE LEGEND:

L = LIQUIDATION PENDING C = CLOSED PO/NOT RECEIVING

P = PARTIAL LIQUIDATION F = FULL LIQUIDATION

BLANK = NO LIQUIDATION

***** End of report *****

Description: SBAA Entity 103 Acct. Receipt/Disbursement Summary Rpt - BOARD REPORT - MONTHLY

Account	Description	Jul. 1, 2022 Beginning Balance	Posted SBAA Receipts	Posted SBAA Disbursements	Jan. 31, 2023 Ending Balance
95L103 8101 0000 00 000000	NBE GENERAL FND/NONCATE/NBE GENERAL FUND	-3,033.49	-7,986.56	4,543.45	-6,476.60
95L103 8102 0000 00 000000	NBE CONSUMBABLE/NONCATE/NBE CONSUMABLES	-120.62	0.00	0.00	-120.62
95L103 8103 0000 00 000000	NBE SHOE DONAT/NONCATE/NBE SHOE DONATION	46.80	0.00	0.00	46.80
95L103 8104 0000 00 000000	NBE MKT DAY K-5/NONCATE/NBE MARKET DAY K-5	0.00	0.00	0.00	0.00
95L103 8105 0000 00 000000	NBE OFFICE/NONCATE/NBE OFFICE	-747.51	0.00	0.00	-747.51
95L103 8106 0000 00 000000	NBE MKT DAY LIB/NONCATE/NBE MARKET DAY LIBRARY	0.00	0.00	0.00	0.00
95L103 8107 0000 00 000000	NBE YEARBOOK/NONCATE/NBE YEARBOOK	-1,899.32	-207.90	904.00	-1,203.22
95L103 8108 0000 00 000000	NBE SANG AUDITO/NONCATE/NBE SANGAMON AUDITORIUM	-6.00	0.00	0.00	-6.00
95L103 8109 0000 00 000000	NBE PEPSI/NONCATE/NBE PEPSI	-326.83	-66.11	0.00	-392.94
95L103 8110 0000 00 000000	NBE FUND & GRNT/NONCATE/NBE FALL FUNDRAISER	-11,560.63	0.00	1,144.47	-10,416.16
95L103 8111 0000 00 000000	NBE LOST LIB BK/NONCATE/NBE LOST LIBRARY BOOK	134.96	0.00	0.00	134.96
95L103 8112 0000 00 000000	NBE AUTHOR VIST/NONCATE/NBE AUTHOR VISIT FUND	-738.07	0.00	0.00	-738.07
95L103 8113 0000 00 000000	NBE PBIS REW/BT/NONCATE/NBE PBIS REWARDS / BOX TO	-1,419.26	-1,309.00	1,408.26	-1,320.00
95L103 8114 0000 00 000000	NBE TEACH GRANT/NONCATE/NBE TEACHERS GRANT	0.00	0.00	0.00	0.00
95L103 8115 0000 00 000000	NBE BEHAV SUPPS/NONCATE/NBE STAFF BEHAVOIR SUPPLI	538.00	0.00	0.00	538.00
95L103 8116 0000 00 000000	NBE NURSE'S DON/NONCATE/NBE NURSE'S DONATION	-34.33	0.00	0.00	-34.33
95L103 8117 0000 00 000000	NBE SCHOOL INT/NONCATE/NBE WHOLD SCHOOL INT	-1,437.04	0.00	0.00	-1,437.04
95L103 8119 0000 00 000000	NBE MENTORING/NONCATE/NBE MENTORING	-336.41	0.00	0.00	-336.41
95L103 8120 0000 00 000000	NBE ART FUND/NONCATE/NBE ART FUND	-175.00	0.00	0.00	-175.00
95L103 8121 0000 00 000000	ART DONATION/NONCATE/NBE OFFICE	-4,046.66	0.00	0.00	-4,046.66
	Total Liability Accounts:	-25,161.41	-9,569.57	8,000.18	-26,730.80
	Total Liability Accounts:	-25,161.41	-9,569.57	8,000.18	-26,730.80
	Grand Total:	-25,161.41	-9,569.57	8,000.18	-26,730.80

***** End of report *****

Description: SBAA Entity 103 Account Activity Report - MONTHLY BOARD REPORT

Account: 95L103 8101 0000 00 000000 NBE GENERAL FND///NONCATE /NBE GENERAL FUND

Post Date	Type	Ck/JE/Rc#	Vendor/Payor	Description	Amount	Balance	Detail Account
				Beginning balance		6,817.15CR	
01/05/2023	Receipt	524	VARIOUS PAYORS	3S AND 3I FIELD TRIP	59.00CR	6,876.15CR	L 8101 0000 00 000000
01/05/2023	Receipt	525	NBE SOCIAL FUND	CHRISTMAS PARTY APPETIZERS	143.12CR	7,019.27CR	L 8101 0000 00 000000
01/06/2023	Receipt	528	VARIOUS PAYORS	3I GRADE FIELD TRIP	6.00CR	7,025.27CR	L 8101 0000 00 000000
01/09/2023	Receipt	529	VARIOUS PAYORS	3S FIELD TRIP UIS	2.00CR	7,027.27CR	L 8101 0000 00 000000
01/12/2023	Receipt	530	NBE SOCIAL FUND	CHECK REQUIRED 2 SIGNATURES	143.12	6,884.15CR	L 8101 0000 00 000000
01/12/2023	Receipt	531	NBE SOCIAL FUND	CHRISTMAS PARTY	143.12CR	7,027.27CR	L 8101 0000 00 000000
01/19/2023	Check	200488	NEW BERLIN CUSD #16	CHARGE CARD CREDIT FOR JANUARY	738.72	6,288.55CR	L 8101 0000 00 000000
01/19/2023	Receipt	532	VARIOUS PAYORS	3S FIELD TRIP	2.00CR	6,290.55CR	L 8101 0000 00 000000
01/24/2023	Receipt	533	VARIOUS PAYORS	4TH GRADE FIELD TRIP	107.05CR	6,397.60CR	L 8101 0000 00 000000
01/30/2023	Receipt	534	VARIOUS PAYORS	5 HERMES UIS FIELD TRIP	2.00CR	6,399.60CR	L 8101 0000 00 000000
01/30/2023	Receipt	535	VARIOUS PAYORS	5 HERMES UIS FIELD TRIP	35.00CR	6,434.60CR	L 8101 0000 00 000000
01/31/2023	Receipt	536	VARIOUS PAYORS	5W FIELD TRIP	42.00CR	6,476.60CR	L 8101 0000 00 000000
				Ending balance		6,476.60CR	

Account: 95L103 8102 0000 00 000000 NBE CONSUMABLE///NONCATE /NBE CONSUMABLES

Post Date	Type	Ck/JE/Rc#	Vendor/Payor	Description	Amount	Balance	Detail Account
				Beginning balance		120.62CR	
				Ending balance		120.62CR	

Account: 95L103 8103 0000 00 000000 NBE SHOE DONAT///NONCATE /NBE SHOE DONATION

Post Date	Type	Ck/JE/Rc#	Vendor/Payor	Description	Amount	Balance	Detail Account
				Beginning balance		46.80	
				Ending balance		46.80	

Account: 95L103 8104 0000 00 000000 NBE MKT DAY K-5///NONCATE /NBE MARKET DAY K-5

Post Date	Type	Ck/JE/Rc#	Vendor/Payor	Description	Amount	Balance	Detail Account
				Beginning balance		0.00	
				Ending balance		0.00	

Account: 95L103 8105 0000 00 000000 NBE OFFICE///NONCATE /NBE OFFICE

Post Date	Type	Ck/JE/Rc#	Vendor/Payor	Description	Amount	Balance	Detail Account
				Beginning balance		747.51CR	
				Ending balance		747.51CR	

Account: 95L103 8106 0000 00 000000 NBE MKT DAY LIB///NONCATE /NBE MARKET DAY LIBRARY

Post Date	Type	Ck/JE/Rc#	Vendor/Payor	Description	Amount	Balance	Detail Account
				Beginning balance		0.00	

Account: 95L103 8106 0000 00 000000 NBE MKT DAY LIB//NONCATE /NBE MARKET DAY LIBRARY							
Post Date	Type	Ck/JE/Rc#	Vendor/Payor	Description	Amount	Balance	Detail Account
				Ending balance		0.00	
Account: 95L103 8107 0000 00 000000 NBE YEARBOOK//NONCATE /NBE YEARBOOK							
Post Date	Type	Ck/JE/Rc#	Vendor/Payor	Description	Amount	Balance	Detail Account
				Beginning balance		1,203.22CR	
				Ending balance		1,203.22CR	
Account: 95L103 8108 0000 00 000000 NBE SANG AUDITO//NONCATE /NBE SANGAMON AUDITORIUM							
Post Date	Type	Ck/JE/Rc#	Vendor/Payor	Description	Amount	Balance	Detail Account
				Beginning balance		6.00CR	
				Ending balance		6.00CR	
Account: 95L103 8109 0000 00 000000 NBE PEPSI//NONCATE /NBE PEPSI							
Post Date	Type	Ck/JE/Rc#	Vendor/Payor	Description	Amount	Balance	Detail Account
				Beginning balance		363.94CR	
01/05/2023	Receipt		526 VARIOUS PAYORS	PEPSI SALES IN THE LOUNGE	29.00CR	392.94CR	L 8109 0000 00 000000
				Ending balance		392.94CR	
Account: 95L103 8110 0000 00 000000 NBE FUND & GRNT//NONCATE /NBE FALL FUNDRAISER							
Post Date	Type	Ck/JE/Rc#	Vendor/Payor	Description	Amount	Balance	Detail Account
				Beginning balance		10,416.16CR	
				Ending balance		10,416.16CR	
Account: 95L103 8111 0000 00 000000 NBE LOST LIB BK//NONCATE /NBE LOST LIBRARY BOOK							
Post Date	Type	Ck/JE/Rc#	Vendor/Payor	Description	Amount	Balance	Detail Account
				Beginning balance		134.96	
				Ending balance		134.96	
Account: 95L103 8112 0000 00 000000 NBE AUTHOR VIST//NONCATE /NBE AUTHOR VISIT FUND							
Post Date	Type	Ck/JE/Rc#	Vendor/Payor	Description	Amount	Balance	Detail Account
				Beginning balance		738.07CR	
				Ending balance		738.07CR	
Account: 95L103 8113 0000 00 000000 NBE PBIS REW/BT//NONCATE /NBE PBIS REWARDS / BOX TOPS							
Post Date	Type	Ck/JE/Rc#	Vendor/Payor	Description	Amount	Balance	Detail Account
				Beginning balance		1,590.95CR	
01/05/2023	Receipt		527 BOX TOPS FOR ED	BOX TOPS PROGRAM	39.00CR	1,629.95CR	L 8113 0000 00 000000
01/06/2023	Check		200487 MARR ANGELA M.	FIVE BELOW/\$ TREE PBIS REWARDS	122.00	1,507.95CR	L 8113 0000 00 000000
01/19/2023	Check		200488 NEW BERLIN CUSD #16	CHARGE CARD CREDIT FOR JANUARY	187.95	1,320.00CR	L 8113 0000 00 000000

Account: 95L103 8113 0000 00 000000 NBE PBIS REW/BT//NONCATE /NBE PBIS REWARDS / BOX TOPS

Post Date	Type	Ck/JE/Rc#	Vendor/Payor	Description	Amount	Balance	Detail Account
				Ending balance		1,320.00CR	

Account: 95L103 8114 0000 00 000000 NBE TEACH GRANT//NONCATE /NBE TEACHERS GRANT

Post Date	Type	Ck/JE/Rc#	Vendor/Payor	Description	Amount	Balance	Detail Account
				Beginning balance		0.00	
				Ending balance		0.00	

Account: 95L103 8115 0000 00 000000 NBE BEHAV SUPPS//NONCATE /NBE STAFF BEHAVOIR SUPPLIES

Post Date	Type	Ck/JE/Rc#	Vendor/Payor	Description	Amount	Balance	Detail Account
				Beginning balance		538.00	
				Ending balance		538.00	

Account: 95L103 8116 0000 00 000000 NBE NURSE'S DON//NONCATE /NBE NURSE'S DONATION

Post Date	Type	Ck/JE/Rc#	Vendor/Payor	Description	Amount	Balance	Detail Account
				Beginning balance		34.33CR	
				Ending balance		34.33CR	

Account: 95L103 8117 0000 00 000000 NBE SCHOOL INT//NONCATE /NBE WHOLD SCHOOL INT

Post Date	Type	Ck/JE/Rc#	Vendor/Payor	Description	Amount	Balance	Detail Account
				Beginning balance		1,437.04CR	
				Ending balance		1,437.04CR	

Account: 95L103 8118 0000 00 000000 NBE TECH FUNDRA//NONCATE /NBE TECH FUNDRAISER

Post Date	Type	Ck/JE/Rc#	Vendor/Payor	Description	Amount	Balance	Detail Account
				Beginning balance		0.00	
				Ending balance		0.00	

Account: 95L103 8119 0000 00 000000 NBE MENTORING//NONCATE /NBE MENTORING

Post Date	Type	Ck/JE/Rc#	Vendor/Payor	Description	Amount	Balance	Detail Account
				Beginning balance		336.41CR	
				Ending balance		336.41CR	

Account: 95L103 8120 0000 00 000000 NBE ART FUND//NONCATE /NBE ART FUND

Post Date	Type	Ck/JE/Rc#	Vendor/Payor	Description	Amount	Balance	Detail Account
				Beginning balance		175.00CR	
				Ending balance		175.00CR	

Account: 95L103 8121 0000 00 000000 ART DONATION//NONCATE /NBE OFFICE

<u>Post Date</u>	<u>Type</u>	<u>Ck/JE/Rc#</u>	<u>Vendor/Payor</u>	<u>Description</u>	<u>Amount</u>	<u>Balance</u>	<u>Detail Account</u>
				Beginning balance		4,046.66CR	
				Ending balance		4,046.66CR	

***** End of report *****

Description: SBAA Entity 400 Acct. Receipt/Disbursement Summary Rpt - MONTHLY BOARD REPORT

Account	Description	Jul. 1, 2022 Beginning Balance	Posted SBAA Receipts	Posted SBAA Disbursements	Jan. 31, 2023 Ending Balance
95L400 9101 0000 00 000000	JH GENERAL FUND/NONCATE/JH FUND	-1,075.21	-1,427.16	1,415.88	-1,086.49
95L400 9102 0000 00 000000	JH CHEER/NONCATE/JH CHEERLEADING	-355.29	-10,587.40	9,024.18	-1,918.51
95L400 9103 0000 00 000000	JH STUD COUNCIL/NONCATE/JH STUDENT COUNCIL	-12,437.33	-16,650.20	13,053.09	-16,034.44
95L400 9104 0000 00 000000	JH BOYS BASK/NONCATE/JH BOYS BASKETBALL	-2,079.41	-6,106.75	1,800.92	-6,385.24
95L400 9105 0000 00 000000	JH GIRLS BASKET/NONCATE/JH GIRLS BASKETBALL	-8,246.83	-3,178.00	11,094.12	-330.71
95L400 9106 0000 00 000000	JH VOLLEYBALL/NONCATE/JH VOLLEYBALL	-7,006.47	0.00	3,527.00	-3,479.47
95L400 9108 0000 00 000000	JH YEARBOOK/NONCATE/JH YEARBOOK	-4,185.08	-976.29	43.97	-5,117.40
95L400 9110 0000 00 000000	JH SOFTBALL/NONCATE/JH SOFTBALL	-1,901.62	-5,875.00	3,661.42	-4,115.20
95L400 9114 0000 00 000000	JH TRACK/NONCATE/JH TRACK	-1,529.43	-2,623.64	1,070.86	-3,082.21
95L400 9115 0000 00 000000	JH BOX TOPS/NONCATE/JH BOX TOPS	0.00	0.00	0.00	0.00
95L400 9116 0000 00 000000	JH BOYS BASE/NONCATE/JH BOYS BASEBALL	-3,409.08	-3,080.00	3,465.14	-3,023.94
95L400 9119 0000 00 000000	6TH GRADE FUNDR/NONCATE/6TH GRADE FUNDRAISING	0.00	0.00	0.00	0.00
95L400 9120 0000 00 000000	6TH BOYS BASKET/NONCATE/6TH BOYS BASKETBALL	-896.07	0.00	0.00	-896.07
95L400 9121 0000 00 000000	JH SCHOL BOWL/NONCATE/JH SCHOLASTIC BOWL	-421.89	0.00	281.00	-140.89
95L400 9122 0000 00 000000	JH SCIENCE CLUB/NONCATE/JH SCIENCE CLUB	0.00	0.00	0.00	0.00
95L400 9123 0000 00 000000	JH PE/NONCATE/JH PE	-522.20	0.00	0.00	-522.20
95L400 9124 0000 00 000000	JH FLOWER FUND/NONCATE/JH FLOWER FUND	-65.59	0.00	0.00	-65.59
95L400 9125 0000 00 000000	JH PBIS FUND/NONCATE	0.00	0.00	0.00	0.00
95L400 9201 0000 00 000000	HS YEARBOOK/NONCATE/HS YEARBOOK	-8,167.23	0.00	143.84	-8,023.39
95L400 9202 0000 00 000000	HS ART FUND/NONCATE/HS ART FUND	-667.97	0.00	173.78	-494.19
95L400 9203 0000 00 000000	HS BAND/NONCATE/HS BAND	-9,861.43	-509.50	9,849.63	-521.30
95L400 9204 0000 00 000000	HS BRICK FUND/NONCATE/HS BRICK FUND	0.00	0.00	0.00	0.00
95L400 9205 0000 00 000000	HS FLOWER/NONCATE/HS FLOWER	-69.11	0.00	0.00	-69.11
95L400 9206 0000 00 000000	HS CLASS 2001/NONCATE/HS CLASS OF 2001	0.00	0.00	0.00	0.00
95L400 9207 0000 00 000000	HS PEP CLUB/NONCATE/HS PEP CLUB	0.00	0.00	0.00	0.00
95L400 9208 0000 00 000000	HS SPANISH/NONCATE/HS SPANISH CLUB	-724.00	-110.00	37.86	-796.14
95L400 9210 0000 00 000000	HS CLASS 1999/NONCATE/HS CLASS OF 1999	0.00	0.00	0.00	0.00
95L400 9211 0000 00 000000	HS CLASS 2000/NONCATE/HS CLASS OF 2000	0.00	0.00	0.00	0.00
95L400 9212 0000 00 000000	HS CLASS 2002/NONCATE/HS CLASS OF 2002	-733.23	0.00	773.23	40.00
95L400 9213 0000 00 000000	HS CLASS 2003/NONCATE/HS CLASS OF 2003	292.12	0.00	0.00	292.12
95L400 9214 0000 00 000000	HS JOINT CONC/NONCATE/HS JOINT CONCESSION	16.31	0.00	0.00	16.31
95L400 9215 0000 00 000000	HS DRAMA CLUB/NONCATE/HS DRAMA CLUB	-1,724.01	0.00	0.00	-1,724.01
95L400 9216 0000 00 000000	HS FFA/NONCATE/HS FFA	-1,983.71	-9,114.41	8,694.85	-2,403.27
95L400 9217 0000 00 000000	HS HOMECOMING/NONCATE/HS HOMECOMING	-5,735.17	-2,440.00	2,817.10	-5,358.07
95L400 9218 0000 00 000000	HS FCCLA/NONCATE/HS FCCLA	-2,259.69	-2,710.00	2,148.98	-2,820.71
95L400 9219 0000 00 000000	HS CHARACT SCH/NONCATE/HS CHARACTER SCHOLARSHIP	0.00	0.00	0.00	0.00
95L400 9220 0000 00 000000	HS PE/NONCATE/HS PE	524.41	0.00	0.00	524.41
95L400 9223 0000 00 000000	HS BASEBALL/NONCATE/HS BASEBALL	-2,193.12	-3,775.00	5,974.07	5.95

Account	Description	Jul. 1, 2022 Beginning Balance	Posted SBAA Receipts	Posted SBAA Disbursements	Jan. 31, 2023 Ending Balance
95L400 9224 0000 00 000000	HS STUDENT COUN/NONCATE/HS STUDENT COUNCIL	-2,251.02	-127.48	154.57	-2,223.93
95L400 9226 0000 00 000000	HS BOYS BASKETB/NONCATE/HS BOYS BASKETBALL	-20,123.50	-26,952.28	11,983.54	-35,092.24
95L400 9227 0000 00 000000	HS FB CHEERLEAD/NONCATE/HS FOOTBALL CHEERLEADING	0.00	0.00	375.00	375.00
95L400 9228 0000 00 000000	HS BB CHEERLEAD/NONCATE/HS BASKETBALL CHEERLEADIN	867.48	-16,770.00	13,212.44	-2,690.08
95L400 9229 0000 00 000000	HS FOOTBALL/NONCATE/HS FOOTBALL	-29,766.37	-13,432.74	32,143.38	-11,055.73
95L400 9230 0000 00 000000	HS BOYS TRACK/NONCATE/HS BOYS TRACK	0.00	0.00	0.00	0.00
95L400 9231 0000 00 000000	HS VOLLEYBALL/NONCATE/HS VOLLEYBALL	-11,683.54	-12,122.90	9,122.61	-14,683.83
95L400 9232 0000 00 000000	HS GENERAL FUND/NONCATE/HS GENERAL FUND	-943.26	-1,776.91	1,702.35	-1,017.82
95L400 9233 0000 00 000000	HS GIRLS SOFTBA/NONCATE/HS GIRLS SOFTBALL	-6,679.49	-680.00	2,978.87	-4,380.62
95L400 9236 0000 00 000000	HS SADD/NONCATE/HS SADD	-3,292.49	-2,742.75	2,479.84	-3,555.40
95L400 9239 0000 00 000000	HS ROESCH TRUST/NONCATE/HS ROESCH TRUST	-120.64	0.00	0.00	-120.64
95L400 9241 0000 00 000000	HS TRACK/NONCATE/HS CO-ED TRACK	-6,860.72	-2,924.50	4,279.95	-5,505.27
95L400 9242 0000 00 000000	HS CHOIR/NONCATE/HS CHOIR	977.45	0.00	0.00	977.45
95L400 9246 0000 00 000000	HS KEY CLUB/NONCATE/HS KEY CLUB	-806.74	-600.00	528.00	-878.74
95L400 9249 0000 00 000000	HS SCHOL BOWL/NONCATE/HS SCHOLARSHIP BOWL	-3,156.52	-2,279.25	1,925.59	-3,510.18
95L400 9250 0000 00 000000	HS CLASS 2005/NONCATE/HS CLASS OF 2005	-271.88	0.00	0.00	-271.88
95L400 9251 0000 00 000000	HS TECH PREP/NONCATE/HS TECHNICAL PREP	-7.67	0.00	0.00	-7.67
95L400 9252 0000 00 000000	HS CLASS 2006/NONCATE/HS CLASS OF 2006	-259.00	0.00	0.00	-259.00
95L400 9255 0000 00 000000	HS DISCRETION/NONCATE/HS DISCRETIONARY	-219.69	0.00	0.00	-219.69
95L400 9258 0000 00 000000	HS SPORTS COMP/NONCATE/HS SPORTS COMPLEX	0.00	0.00	0.00	0.00
95L400 9260 0000 00 000000	HS CLASS 2009/NONCATE/HS CLASS OF 2009	-442.73	0.00	0.00	-442.73
95L400 9262 0000 00 000000	HS CLASS 2010/NONCATE/HS CLASS OF 2010	-269.91	0.00	0.00	-269.91
95L400 9263 0000 00 000000	HS LIBRARY FUND/NONCATE/HS LIBRARY FUND	-1,234.26	-977.09	1,041.80	-1,169.55
95L400 9264 0000 00 000000	HS PRETZL PRIDE/NONCATE/HS PRETZEL PRIDE	-24.21	0.00	0.00	-24.21
95L400 9265 0000 00 000000	HS CLASS 2011/NONCATE/HS CLASS OF 2011	-662.33	0.00	0.00	-662.33
95L400 9266 0000 00 000000	HS CLASS 2012/NONCATE/HS CLASS OF 2012	-768.55	0.00	0.00	-768.55
95L400 9267 0000 00 000000	HS CLASS 2013/NONCATE/HS CLASS OF 2013	-365.43	0.00	0.00	-365.43
95L400 9268 0000 00 000000	HS FLAGS/NONCATE/HS FLAGS	-748.80	0.00	0.00	-748.80
95L400 9269 0000 00 000000	HS CLASS 2014/NONCATE/HS CLASS OF 2014	0.00	0.00	0.00	0.00
95L400 9270 0000 00 000000	HS SAMSUNG GRNT/NONCATE/HS SAMSUNG GRANT	0.00	0.00	0.00	0.00
95L400 9271 0000 00 000000	POST SEASON ATH/NONCATE/POST SEASON ATHLETIC FUND	-40.00	0.00	-8.00	-48.00
95L400 9272 0000 00 000000	PRETZEL FESTIVA/NONCATE/PRETZEL FESTIVAL	-3,685.26	-6,060.00	7,023.04	-2,722.22
95L400 9273 0000 00 000000	HS CLASS 2015/NONCATE/HS CLASS OF 2015	0.00	0.00	0.00	0.00
95L400 9274 0000 00 000000	ATH GENERAL FND/NONCATE/ATHLETICS GENERAL FUND	-24,628.86	-13,280.77	23,312.79	-14,596.84
95L400 9278 0000 00 000000	ACT PREP ACCT/NONCATE/ACT PREP ACCOUNT	-8.58	0.00	0.00	-8.58
95L400 9279 0000 00 000000	HS CLASS 2016/NONCATE/HS CLASS OF 2016	-2,056.10	0.00	0.00	-2,056.10
95L400 9280 0000 00 000000	HS CLASS 2017/NONCATE/HS CLASS OF 2017	-3,144.37	0.00	0.00	-3,144.37
95L400 9281 0000 00 000000	SANGAMON CONF./NONCATE/SANGAMON CONFERENCE ACCOUN	0.00	0.00	0.00	0.00
95L400 9282 0000 00 000000	GREENHOUSE ACCT/NONCATE/GREENHOUSE ACCOUNT	-3,761.84	-946.00	0.00	-4,707.84

<u>Account</u>	<u>Description</u>	<u>Jul. 1, 2022 Beginning Balance</u>	<u>Posted SBAA Receipts</u>	<u>Posted SBAA Disbursements</u>	<u>Jan. 31, 2023 Ending Balance</u>
95L400 9283 0000 00 000000	HS CLASS 2018/NONCATE/HS CLASS OF 2018	-1,973.29	0.00	0.00	-1,973.29
95L400 9284 0000 00 000000	CREWS SCHOLARSH/NONCATE/DAMIEN CREWS SCHOLARSHIP	-4,176.72	0.00	0.00	-4,176.72
95L400 9285 0000 00 000000	ROYALTIES/NONCATE/ROYALTIES	-1,209.54	0.00	0.00	-1,209.54
95L400 9286 0000 00 000000	HS CLASS 2019/NONCATE/HS CLASS OF 2019	-11.59	0.00	0.00	-11.59
95L400 9287 0000 00 000000	HS WRESTLING/NONCATE/HS WRESTLING	-2,417.04	0.00	0.00	-2,417.04
95L400 9288 0000 00 000000	HS CLASS 2020/NONCATE/CLASS OF 2020	-6,281.53	0.00	0.00	-6,281.53
95L400 9289 0000 00 000000	HS CLASS 2021/NONCATE/HS CLASS OF 2021	1,134.80	0.00	0.00	1,134.80
95L400 9290 0000 00 000000	THORNTON AG SCH/NONCATE/THORNTON AG SCHOLARSHIP A	-982.93	0.00	0.00	-982.93
95L400 9291 0000 00 000000	HS CLASS 2022/NONCATE/HS CLASS OF 2022	-2,549.58	-60.00	0.00	-2,609.58
95L400 9292 0000 00 000000	HS CLASS 2023/NONCATE/HS CLASS OF 2023	-3,096.53	-1,669.50	0.00	-4,766.03
95L400 9293 0000 00 000000	HS CLASS 2024/NONCATE/HS CLASS OF 2024	-692.07	-711.74	950.00	-453.81
95L400 9294 0000 00 000000	CLASS OF 2025/NONCATE/HS CLASS OF 2025	-3,886.60	-3,161.00	3,226.50	-3,821.10
95L400 9295 0000 00 000000	MASCOT FUND/NONCATE/HS-MASCOT FUNDRAISER	-337.75	0.00	0.00	-337.75
95L400 9296 0000 00 000000	HS CLASS 2026/NONCATE/HS CLASS OF 2026	0.00	-70.00	0.00	-70.00
	Total Liability Accounts:	-230,336.53	-176,508.26	195,483.19	-211,361.60
	Total Liability Accounts:	-230,336.53	-176,508.26	195,483.19	-211,361.60
	Grand Total:	-230,336.53	-176,508.26	195,483.19	-211,361.60

***** End of report *****

Description: SBAA Entity 400 Account Activity Report - MONTHLY BOARD REPORT

Account: 95L400 9101 0000 00 000000

JH GENERAL FUND///NONCATE /JH FUND

Post Date	Type	Ck/JE/Rc#	Vendor/Payor	Description	Amount	Balance	Detail Account
				Beginning balance		1,086.49CR	
				Ending balance		1,086.49CR	

Account: 95L400 9102 0000 00 000000

JH CHEER///NONCATE /JH CHEERLEADING

Post Date	Type	Ck/JE/Rc#	Vendor/Payor	Description	Amount	Balance	Detail Account
				Beginning balance		1,262.53	
01/19/2023	Check	304920	NEW BERLIN CUSD #16	CHARGE CARD CREDIT JANUARY	612.36	1,874.89	L 9102 0000 00 000000
01/19/2023	JE	000004138		TRANSFER FUNDS FROM 9228 TO 9102-PIZZA FUNDRAISER	1,835.40CR	39.49	L 9102 0000 00 000000
01/27/2023	JE	000004149		TRANSFER INTO 9102	1,958.00CR	1,918.51CR	L 9102 0000 00 000000
				Ending balance		1,918.51CR	

Account: 95L400 9103 0000 00 000000

JH STUD COUNCIL///NONCATE /JH STUDENT COUNCIL

Post Date	Type	Ck/JE/Rc#	Vendor/Payor	Description	Amount	Balance	Detail Account
				Beginning balance		17,790.98CR	
01/19/2023	Check	304921	NEW BERLIN CUSD #16	CHARGE CARD CREDIT JANUARY	1,756.54	16,034.44CR	L 9103 0000 00 000000
				Ending balance		16,034.44CR	

Account: 95L400 9104 0000 00 000000

JH BOYS BASK///NONCATE /JH BOYS BASKETBALL

Post Date	Type	Ck/JE/Rc#	Vendor/Payor	Description	Amount	Balance	Detail Account
				Beginning balance		6,385.24CR	
				Ending balance		6,385.24CR	

Account: 95L400 9105 0000 00 000000

JH GIRLS BASKET///NONCATE /JH GIRLS BASKETBALL

Post Date	Type	Ck/JE/Rc#	Vendor/Payor	Description	Amount	Balance	Detail Account
				Beginning balance		410.69CR	
01/19/2023	Check	304920	NEW BERLIN CUSD #16	CHARGE CARD CREDIT JANUARY	79.98	330.71CR	L 9105 0000 00 000000
				Ending balance		330.71CR	

Account: 95L400 9106 0000 00 000000

JH VOLLEYBALL///NONCATE /JH VOLLEYBALL

Post Date	Type	Ck/JE/Rc#	Vendor/Payor	Description	Amount	Balance	Detail Account
				Beginning balance		6,982.48CR	
01/10/2023	Check	304909	PRIMO DESIGNS	TEAM T-SHIRT	444.00	6,538.48CR	L 9106 0000 00 000000
01/10/2023	Check	304910	MIDWEST VOLLEYBALL WAREHOUSE	JH VOLLEYBALL UNIFORMS	2,987.01	3,551.47CR	L 9106 0000 00 000000
01/30/2023	Check	304927	PRIMO DESIGNS	CREWNECK SWEATSHIRT	72.00	3,479.47CR	L 9106 0000 00 000000
				Ending balance		3,479.47CR	

Account: 95L400 9108 0000 00 000000 JH YEARBOOK//NONCATE /JH YEARBOOK

Post Date	Type	Ck/JE/Rc#	Vendor/Payor	Description	Amount	Balance	Detail Account
				Beginning balance		5,117.40CR	
				Ending balance		5,117.40CR	

Account: 95L400 9110 0000 00 000000 JH SOFTBALL//NONCATE /JH SOFTBALL

Post Date	Type	Ck/JE/Rc#	Vendor/Payor	Description	Amount	Balance	Detail Account
				Beginning balance		3,915.20CR	
01/19/2023	Receipt		1513 SMITH NATHAN	DONATION	200.00CR	4,115.20CR	L 9110 0000 00 000000
				Ending balance		4,115.20CR	

Account: 95L400 9114 0000 00 000000 JH TRACK//NONCATE /JH TRACK

Post Date	Type	Ck/JE/Rc#	Vendor/Payor	Description	Amount	Balance	Detail Account
				Beginning balance		3,082.21CR	
				Ending balance		3,082.21CR	

Account: 95L400 9115 0000 00 000000 JH BOX TOPS//NONCATE /JH BOX TOPS

Post Date	Type	Ck/JE/Rc#	Vendor/Payor	Description	Amount	Balance	Detail Account
				Beginning balance		0.00	
				Ending balance		0.00	

Account: 95L400 9116 0000 00 000000 JH BOYS BASE//NONCATE /JH BOYS BASEBALL

Post Date	Type	Ck/JE/Rc#	Vendor/Payor	Description	Amount	Balance	Detail Account
				Beginning balance		4,447.59CR	
01/19/2023	Check		304920 NEW BERLIN CUSD #16	CHARGE CARD CREDIT JANUARY	223.65	4,223.94CR	L 9116 0000 00 000000
01/20/2023	JE		000004143	TRANSFER FUNDS 9116 TO 9223-BASEBALL HATS	1,200.00	3,023.94CR	L 9116 0000 00 000000
				Ending balance		3,023.94CR	

Account: 95L400 9119 0000 00 000000 6TH GRADE FUNDR//NONCATE /6TH GRADE FUNDRAISING

Post Date	Type	Ck/JE/Rc#	Vendor/Payor	Description	Amount	Balance	Detail Account
				Beginning balance		0.00	
				Ending balance		0.00	

Account: 95L400 9120 0000 00 000000 6TH BOYS BASKET//NONCATE /6TH BOYS BASKETBALL

Post Date	Type	Ck/JE/Rc#	Vendor/Payor	Description	Amount	Balance	Detail Account
				Beginning balance		896.07CR	
				Ending balance		896.07CR	

Account: 95L400 9121 0000 00 000000 JH SCHOL BOWL//NONCATE /JH SCHOLASTIC BOWL

Post Date	Type	Ck/JE/Rc#	Vendor/Payor	Description	Amount	Balance	Detail Account
				Beginning balance		421.89CR	

Account: 95L400 9121 0000 00 000000 JH SCHOL BOWL//NONCATE /JH SCHOLASTIC BOWL

Post Date	Type	Ck/JE/Re#	Vendor/Payor	Description	Amount	Balance	Detail Account
01/19/2023	Check	304917	PRIMO DESIGNS	JERSEY POLO	176.00	245.89CR	L 9121 0000 00 000000
01/20/2023	Check	304923	AVERY ENTERPRISES, INC	MS SCH BOWL GAME	105.00	140.89CR	L 9121 0000 00 000000
				Ending balance		140.89CR	

Account: 95L400 9122 0000 00 000000 JH SCIENCE CLUB//NONCATE /JH SCIENCE CLUB

Post Date	Type	Ck/JE/Rc#	Vendor/Payor	Description	Amount	Balance	Detail Account
				Beginning balance		0.00	
				Ending balance		0.00	

Account: 95L400 9123 0000 00 000000 JH PE//NONCATE /JH PE

Post Date	Type	Ck/JE/Rc#	Vendor/Payor	Description	Amount	Balance	Detail Account
				Beginning balance		522.20CR	
				Ending balance		522.20CR	

Account: 95L400 9124 0000 00 000000 JH FLOWER FUND//NONCATE /JH FLOWER FUND

Post Date	Type	Ck/JE/Rc#	Vendor/Payor	Description	Amount	Balance	Detail Account
				Beginning balance		65.59CR	
				Ending balance		65.59CR	

Account: 95L400 9125 0000 00 000000 JH PBIS FUND//NONCATE

Post Date	Type	Ck/JE/Rc#	Vendor/Payor	Description	Amount	Balance	Detail Account
				Beginning balance		0.00	
				Ending balance		0.00	

Account: 95L400 9201 0000 00 000000 HS YEARBOOK//NONCATE /HS YEARBOOK

Post Date	Type	Ck/JE/Rc#	Vendor/Payor	Description	Amount	Balance	Detail Account
				Beginning balance		8,023.39CR	
				Ending balance		8,023.39CR	

Account: 95L400 9202 0000 00 000000 HS ART FUND//NONCATE /HS ART FUND

Post Date	Type	Ck/JE/Rc#	Vendor/Payor	Description	Amount	Balance	Detail Account
				Beginning balance		584.19CR	
01/10/2023	Check	304906	BUFFINGTON ROSEMARY	SCHOLASTIC ART AWARDS	90.00	494.19CR	L 9202 0000 00 000000
				Ending balance		494.19CR	

Account: 95L400 9203 0000 00 000000 HS BAND//NONCATE /HS BAND

Post Date	Type	Ck/JE/Rc#	Vendor/Payor	Description	Amount	Balance	Detail Account
				Beginning balance		2,337.37CR	
01/06/2023	Check	304905	ELMHURST UNIVERSITY BANDS	ELMHURST HONOR BAND FEE	105.00	2,232.37CR	L 9203 0000 00 000000

Account: 95L400 9203 0000 00 000000 HS BAND//NONCATE /HS BAND

Post Date	Type	Ck/JE/Re#	Vendor/Payor	Description	Amount	Balance	Detail Account
01/12/2023	Check	304913	POWELL HALL	40 TICKETS TO STAR WARS THE FORCE AWAKENS	1,600.00	632.37CR	L 9203 0000 00 000000
01/19/2023	Check	304921	NEW BERLIN CUSD #16	CHARGE CARD CREDIT JANUARY	111.07	521.30CR	L 9203 0000 00 000000
				Ending balance		521.30CR	

Account: 95L400 9204 0000 00 000000 HS BRICK FUND//NONCATE /HS BRICK FUND

Post Date	Type	Ck/JE/Rc#	Vendor/Payor	Description	Amount	Balance	Detail Account
				Beginning balance		0.00	
				Ending balance		0.00	

Account: 95L400 9205 0000 00 000000 HS FLOWER//NONCATE /HS FLOWER

Post Date	Type	Ck/JE/Rc#	Vendor/Payor	Description	Amount	Balance	Detail Account
				Beginning balance		69.11CR	
				Ending balance		69.11CR	

Account: 95L400 9206 0000 00 000000 HS CLASS 2001//NONCATE /HS CLASS OF 2001

Post Date	Type	Ck/JE/Rc#	Vendor/Payor	Description	Amount	Balance	Detail Account
				Beginning balance		0.00	
				Ending balance		0.00	

Account: 95L400 9207 0000 00 000000 HS PEP CLUB//NONCATE /HS PEP CLUB

Post Date	Type	Ck/JE/Rc#	Vendor/Payor	Description	Amount	Balance	Detail Account
				Beginning balance		0.00	
				Ending balance		0.00	

Account: 95L400 9208 0000 00 000000 HS SPANISH//NONCATE /HS SPANISH CLUB

Post Date	Type	Ck/JE/Rc#	Vendor/Payor	Description	Amount	Balance	Detail Account
				Beginning balance		796.14CR	
				Ending balance		796.14CR	

Account: 95L400 9210 0000 00 000000 HS CLASS 1999//NONCATE /HS CLASS OF 1999

Post Date	Type	Ck/JE/Rc#	Vendor/Payor	Description	Amount	Balance	Detail Account
				Beginning balance		0.00	
				Ending balance		0.00	

Account: 95L400 9211 0000 00 000000 HS CLASS 2000//NONCATE /HS CLASS OF 2000

Post Date	Type	Ck/JE/Rc#	Vendor/Payor	Description	Amount	Balance	Detail Account
				Beginning balance		0.00	
				Ending balance		0.00	

Account: 95L400 9212 0000 00 000000 HS CLASS 2002///NONCATE /HS CLASS OF 2002

Post Date	Type	Ck/JE/Rc#	Vendor/Payor	Description	Amount	Balance	Detail Account
				Beginning balance		40.00	
				Ending balance		40.00	

Account: 95L400 9213 0000 00 000000 HS CLASS 2003///NONCATE /HS CLASS OF 2003

Post Date	Type	Ck/JE/Rc#	Vendor/Payor	Description	Amount	Balance	Detail Account
				Beginning balance		292.12	
				Ending balance		292.12	

Account: 95L400 9214 0000 00 000000 HS JOINT CONC///NONCATE /HS JOINT CONCESSION

Post Date	Type	Ck/JE/Rc#	Vendor/Payor	Description	Amount	Balance	Detail Account
				Beginning balance		16.31	
				Ending balance		16.31	

Account: 95L400 9215 0000 00 000000 HS DRAMA CLUB///NONCATE /HS DRAMA CLUB

Post Date	Type	Ck/JE/Rc#	Vendor/Payor	Description	Amount	Balance	Detail Account
				Beginning balance		1,724.01CR	
				Ending balance		1,724.01CR	

Account: 95L400 9216 0000 00 000000 HS FFA///NONCATE /HS FFA

Post Date	Type	Ck/JE/Rc#	Vendor/Payor	Description	Amount	Balance	Detail Account
				Beginning balance		749.74CR	
01/11/2023	Receipt	1510	VARIOUS PAYORS	FFA	240.00CR	989.74CR	L 9216 0000 00 000000
01/23/2023	Check	304925	ILLINOIS FFA CENTER	GROUND ZERO CONFERENCE	132.00	857.74CR	L 9216 0000 00 000000
01/30/2023	Receipt	1517	VARIOUS PAYORS	FFA DEPOSIT	604.00CR	1,461.74CR	L 9216 0000 00 000000
01/31/2023	Receipt	1519	VARIOUS PAYORS	REFUND TO 9216 FOR DUPLICATION (41.53, 90.00, 810.00)	941.53CR	2,403.27CR	L 9216 0000 00 000000
				Ending balance		2,403.27CR	

Account: 95L400 9217 0000 00 000000 HS HOMECOMING///NONCATE /HS HOMECOMING

Post Date	Type	Ck/JE/Rc#	Vendor/Payor	Description	Amount	Balance	Detail Account
				Beginning balance		5,358.07CR	
				Ending balance		5,358.07CR	

Account: 95L400 9218 0000 00 000000 HS FCCLA///NONCATE /HS FCCLA

Post Date	Type	Ck/JE/Rc#	Vendor/Payor	Description	Amount	Balance	Detail Account
				Beginning balance		2,820.71CR	
				Ending balance		2,820.71CR	

Account: 95L400 9219 0000 00 000000 HS CHARACT SCH//NONCATE /HS CHARACTER SCHOLARSHIP

Post Date	Type	Ck/JE/Rc#	Vendor/Payor	Description	Amount	Balance	Detail Account
				Beginning balance		0.00	
				Ending balance		0.00	

Account: 95L400 9220 0000 00 000000 HS PE//NONCATE /HS PE

Post Date	Type	Ck/JE/Rc#	Vendor/Payor	Description	Amount	Balance	Detail Account
				Beginning balance		524.41	
				Ending balance		524.41	

Account: 95L400 9223 0000 00 000000 HS BASEBALL//NONCATE /HS BASEBALL

Post Date	Type	Ck/JE/Rc#	Vendor/Payor	Description	Amount	Balance	Detail Account
				Beginning balance		19.90	
01/19/2023	Check	304918	GRAPHIC EDGE	HATS	1,186.05	1,205.95	L 9223 0000 00 000000
01/20/2023	JE	000004143		TRANSFER FUNDS 9116 TO 9223-BASEBALL HATS	1,200.00CR	5.95	L 9223 0000 00 000000
				Ending balance		5.95	

Account: 95L400 9224 0000 00 000000 HS STUDENT COUN//NONCATE /HS STUDENT COUNCIL

Post Date	Type	Ck/JE/Rc#	Vendor/Payor	Description	Amount	Balance	Detail Account
				Beginning balance		2,096.45CR	
01/19/2023	Receipt	1511	VARIOUS PAYORS	SODA MACHINE	127.48CR	2,223.93CR	L 9224 0000 00 000000
				Ending balance		2,223.93CR	

Account: 95L400 9226 0000 00 000000 HS BOYS BASKETB//NONCATE /HS BOYS BASKETBALL

Post Date	Type	Ck/JE/Rc#	Vendor/Payor	Description	Amount	Balance	Detail Account
				Beginning balance		37,868.79CR	
01/06/2023	Receipt	1506	ABBOTT MIKE	HS BOYS BASKETBALL BANNER	40.00CR	37,908.79CR	L 9226 0000 00 000000
01/10/2023	Check	304907	BSN SPORTS INC	JACKETS	763.09	37,145.70CR	L 9226 0000 00 000000
01/19/2023	Check	304919	BSN SPORTS INC	JACKET,POLO, BEANIE,PANTS	1,182.66	35,963.04CR	L 9226 0000 00 000000
01/19/2023	Check	304920	NEW BERLIN CUSD #16	CHARGE CARD CREDIT JANUARY	870.80	35,092.24CR	L 9226 0000 00 000000
				Ending balance		35,092.24CR	

Account: 95L400 9227 0000 00 000000 HS FB CHEERLEAD//NONCATE /HS FOOTBALL CHEERLEADING

Post Date	Type	Ck/JE/Rc#	Vendor/Payor	Description	Amount	Balance	Detail Account
				Beginning balance		375.00	
				Ending balance		375.00	

Account: 95L400 9228 0000 00 000000 HS BB CHEERLEAD//NONCATE /HS BASKETBALL CHEERLEADING

Post Date	Type	Ck/JE/Rc#	Vendor/Payor	Description	Amount	Balance	Detail Account
				Beginning balance		7,149.84CR	
01/09/2023	Receipt	1508	VARIOUS PAYORS	CHEER UNIFORM	95.00CR	7,244.84CR	L 9228 0000 00 000000

Account: 95L400 9228 0000 00 000000 HS BB CHEERLEAD///NONCATE /HS BASKETBALL CHEERLEADING

Post Date	Type	Ck/JE/Re#	Vendor/Payor	Description	Amount	Balance	Detail Account
01/10/2023	Check	304908	PRIMO DESIGNS	WHITE TEAM HOODIES	28.00	7,216.84CR	L 9228 0000 00 000000
01/19/2023	Check	304920	NEW BERLIN CUSD #16	CHARGE CARD CREDIT JANUARY	114.36	7,102.48CR	L 9228 0000 00 000000
01/19/2023	Check	304922	NEW BERLIN CUSD #16	CHARGE CARD CREDIT JANUARY	300.00	6,802.48CR	L 9228 0000 00 000000
01/19/2023	JE	000004138		TRANSFER FUNDS FROM 9228 TO 9102-PIZZA FUNDRAISER	1,835.40	4,967.08CR	L 9228 0000 00 000000
01/26/2023	Check	304926	CONANT HIGH SCHOOL	2023 CHEER SECTIONAL SHIRTS	319.00	4,648.08CR	L 9228 0000 00 000000
01/27/2023	JE	000004149		TRANSFER FROM 9228 FOR CHEERLEADING UNIFORS-REBEL	1,958.00	2,690.08CR	L 9228 0000 00 000000
				Ending balance		2,690.08CR	

Account: 95L400 9229 0000 00 000000 HS FOOTBALL///NONCATE /HS FOOTBALL

Post Date	Type	Ck/JE/Rc#	Vendor/Payor	Description	Amount	Balance	Detail Account
				Beginning balance		11,337.03CR	
01/19/2023	Check	304916	GRAPHIC EDGE	PRETZEL HOODIES	263.60	11,073.43CR	L 9229 0000 00 000000
01/19/2023	Check	304921	NEW BERLIN CUSD #16	CHARGE CARD CREDIT JANUARY	17.70	11,055.73CR	L 9229 0000 00 000000
				Ending balance		11,055.73CR	

Account: 95L400 9230 0000 00 000000 HS BOYS TRACK///NONCATE /HS BOYS TRACK

Post Date	Type	Ck/JE/Rc#	Vendor/Payor	Description	Amount	Balance	Detail Account
				Beginning balance		0.00	
				Ending balance		0.00	

Account: 95L400 9231 0000 00 000000 HS VOLLEYBALL///NONCATE /HS VOLLEYBALL

Post Date	Type	Ck/JE/Rc#	Vendor/Payor	Description	Amount	Balance	Detail Account
				Beginning balance		14,683.83CR	
				Ending balance		14,683.83CR	

Account: 95L400 9232 0000 00 000000 HS GENERAL FUND///NONCATE /HS GENERAL FUND

Post Date	Type	Ck/JE/Rc#	Vendor/Payor	Description	Amount	Balance	Detail Account
				Beginning balance		1,051.64CR	
01/19/2023	Check	304921	NEW BERLIN CUSD #16	CHARGE CARD CREDIT JANUARY	63.55	988.09CR	L 9232 0000 00 000000
01/31/2023	JE	000004178		JANUARY 2023 INTEREST	29.73CR	1,017.82CR	L 9232 0000 00 000000
				Ending balance		1,017.82CR	

Account: 95L400 9233 0000 00 000000 HS GIRLS SOFTBA///NONCATE /HS GIRLS SOFTBALL

Post Date	Type	Ck/JE/Rc#	Vendor/Payor	Description	Amount	Balance	Detail Account
				Beginning balance		4,380.62CR	
				Ending balance		4,380.62CR	

Account: 95L400 9236 0000 00 000000 HS SADD//NONCATE /HS SADD

Post Date	Type	Ck/JE/Rc#	Vendor/Payor	Description	Amount	Balance	Detail Account
				Beginning balance		2,538.07CR	
01/11/2023	Check	304911	NEW BERLIN CUSD #16	SADD PAYING FOR GSF COOKIES	144.42	2,393.65CR	L 9236 0000 00 000000
01/23/2023	Receipt	1514	VARIOUS PAYORS	COOKIE SALES	113.00CR	2,506.65CR	L 9236 0000 00 000000
01/31/2023	Receipt	1518	VARIOUS PAYORS	COOKIE SALES	125.75CR	2,632.40CR	L 9236 0000 00 000000
01/31/2023	Receipt	1535	VARIOUS PAYORS	SADD TSHIRT SALES	923.00CR	3,555.40CR	L 9236 0000 00 000000
				Ending balance		3,555.40CR	

Account: 95L400 9239 0000 00 000000 HS ROESCH TRUST//NONCATE /HS ROESCH TRUST

Post Date	Type	Ck/JE/Rc#	Vendor/Payor	Description	Amount	Balance	Detail Account
				Beginning balance		120.64CR	
				Ending balance		120.64CR	

Account: 95L400 9241 0000 00 000000 HS TRACK//NONCATE /HS CO-ED TRACK

Post Date	Type	Ck/JE/Rc#	Vendor/Payor	Description	Amount	Balance	Detail Account
				Beginning balance		6,709.77CR	
01/19/2023	Check	304915	BOATHOUSE SPORTS	HS GIRLS TRACK UNIFORMS	1,204.50	5,505.27CR	L 9241 0000 00 000000
				Ending balance		5,505.27CR	

Account: 95L400 9242 0000 00 000000 HS CHOIR//NONCATE /HS CHOIR

Post Date	Type	Ck/JE/Rc#	Vendor/Payor	Description	Amount	Balance	Detail Account
				Beginning balance		977.45	
				Ending balance		977.45	

Account: 95L400 9246 0000 00 000000 HS KEY CLUB//NONCATE /HS KEY CLUB

Post Date	Type	Ck/JE/Rc#	Vendor/Payor	Description	Amount	Balance	Detail Account
				Beginning balance		1,406.74CR	
01/19/2023	Check	304921	NEW BERLIN CUSD #16	CHARGE CARD CREDIT JANUARY	528.00	878.74CR	L 9246 0000 00 000000
				Ending balance		878.74CR	

Account: 95L400 9249 0000 00 000000 HS SCHOL BOWL//NONCATE /HS SCHOLARSHIP BOWL

Post Date	Type	Ck/JE/Rc#	Vendor/Payor	Description	Amount	Balance	Detail Account
				Beginning balance		4,643.02CR	
01/06/2023	Check	304904	NAQT-NAT. ACADEMIC QUIZ TOUR	TOURNEY QUESTIONS	370.00	4,273.02CR	L 9249 0000 00 000000
01/19/2023	Check	304920	NEW BERLIN CUSD #16	CHARGE CARD CREDIT JANUARY	762.84	3,510.18CR	L 9249 0000 00 000000
				Ending balance		3,510.18CR	

Account: 95L400 9250 0000 00 000000 HS CLASS 2005//NONCATE /HS CLASS OF 2005

Post Date	Type	Ck/JE/Rc#	Vendor/Payor	Description	Amount	Balance	Detail Account
				Beginning balance		271.88CR	

Account: 95L400 9250 0000 00 000000							HS CLASS 2005//NONCATE	/HS CLASS OF 2005
<u>Post Date</u>	<u>Type</u>	<u>Ck/JE/Rc#</u>	<u>Vendor/Payor</u>	<u>Description</u>	<u>Amount</u>	<u>Balance</u>	<u>Detail Account</u>	
				Ending balance		271.88CR		
Account: 95L400 9251 0000 00 000000							HS TECH PREP//NONCATE	/HS TECHNICAL PREP
<u>Post Date</u>	<u>Type</u>	<u>Ck/JE/Rc#</u>	<u>Vendor/Payor</u>	<u>Description</u>	<u>Amount</u>	<u>Balance</u>	<u>Detail Account</u>	
				Beginning balance		7.67CR		
				Ending balance		7.67CR		
Account: 95L400 9252 0000 00 000000							HS CLASS 2006//NONCATE	/HS CLASS OF 2006
<u>Post Date</u>	<u>Type</u>	<u>Ck/JE/Rc#</u>	<u>Vendor/Payor</u>	<u>Description</u>	<u>Amount</u>	<u>Balance</u>	<u>Detail Account</u>	
				Beginning balance		259.00CR		
				Ending balance		259.00CR		
Account: 95L400 9255 0000 00 000000							HS DISCRETION//NONCATE	/HS DISCRETIONARY
<u>Post Date</u>	<u>Type</u>	<u>Ck/JE/Rc#</u>	<u>Vendor/Payor</u>	<u>Description</u>	<u>Amount</u>	<u>Balance</u>	<u>Detail Account</u>	
				Beginning balance		219.69CR		
				Ending balance		219.69CR		
Account: 95L400 9258 0000 00 000000							HS SPORTS COMP//NONCATE	/HS SPORTS COMPLEX
<u>Post Date</u>	<u>Type</u>	<u>Ck/JE/Rc#</u>	<u>Vendor/Payor</u>	<u>Description</u>	<u>Amount</u>	<u>Balance</u>	<u>Detail Account</u>	
				Beginning balance		0.00		
				Ending balance		0.00		
Account: 95L400 9260 0000 00 000000							HS CLASS 2009//NONCATE	/HS CLASS OF 2009
<u>Post Date</u>	<u>Type</u>	<u>Ck/JE/Rc#</u>	<u>Vendor/Payor</u>	<u>Description</u>	<u>Amount</u>	<u>Balance</u>	<u>Detail Account</u>	
				Beginning balance		442.73CR		
				Ending balance		442.73CR		
Account: 95L400 9262 0000 00 000000							HS CLASS 2010//NONCATE	/HS CLASS OF 2010
<u>Post Date</u>	<u>Type</u>	<u>Ck/JE/Rc#</u>	<u>Vendor/Payor</u>	<u>Description</u>	<u>Amount</u>	<u>Balance</u>	<u>Detail Account</u>	
				Beginning balance		269.91CR		
				Ending balance		269.91CR		
Account: 95L400 9263 0000 00 000000							HS LIBRARY FUND//NONCATE	/HS LIBRARY FUND
<u>Post Date</u>	<u>Type</u>	<u>Ck/JE/Rc#</u>	<u>Vendor/Payor</u>	<u>Description</u>	<u>Amount</u>	<u>Balance</u>	<u>Detail Account</u>	
				Beginning balance		1,169.55CR		
				Ending balance		1,169.55CR		

Account: 95L400 9264 0000 00 000000 HS PRETZL PRIDE///NONCATE /HS PRETZEL PRIDE

Post Date	Type	Ck/JE/Rc#	Vendor/Payor	Description	Amount	Balance	Detail Account
				Beginning balance		24.21CR	
				Ending balance		24.21CR	

Account: 95L400 9265 0000 00 000000 HS CLASS 2011///NONCATE /HS CLASS OF 2011

Post Date	Type	Ck/JE/Rc#	Vendor/Payor	Description	Amount	Balance	Detail Account
				Beginning balance		662.33CR	
				Ending balance		662.33CR	

Account: 95L400 9266 0000 00 000000 HS CLASS 2012///NONCATE /HS CLASS OF 2012

Post Date	Type	Ck/JE/Rc#	Vendor/Payor	Description	Amount	Balance	Detail Account
				Beginning balance		768.55CR	
				Ending balance		768.55CR	

Account: 95L400 9267 0000 00 000000 HS CLASS 2013///NONCATE /HS CLASS OF 2013

Post Date	Type	Ck/JE/Rc#	Vendor/Payor	Description	Amount	Balance	Detail Account
				Beginning balance		365.43CR	
				Ending balance		365.43CR	

Account: 95L400 9268 0000 00 000000 HS FLAGS///NONCATE /HS FLAGS

Post Date	Type	Ck/JE/Rc#	Vendor/Payor	Description	Amount	Balance	Detail Account
				Beginning balance		748.80CR	
				Ending balance		748.80CR	

Account: 95L400 9269 0000 00 000000 HS CLASS 2014///NONCATE /HS CLASS OF 2014

Post Date	Type	Ck/JE/Rc#	Vendor/Payor	Description	Amount	Balance	Detail Account
				Beginning balance		0.00	
				Ending balance		0.00	

Account: 95L400 9270 0000 00 000000 HS SAMSUNG GRNT///NONCATE /HS SAMSUNG GRANT

Post Date	Type	Ck/JE/Rc#	Vendor/Payor	Description	Amount	Balance	Detail Account
				Beginning balance		0.00	
				Ending balance		0.00	

Account: 95L400 9271 0000 00 000000 POST SEASON ATH///NONCATE /POST SEASON ATHLETIC FUND

Post Date	Type	Ck/JE/Rc#	Vendor/Payor	Description	Amount	Balance	Detail Account
				Beginning balance		48.00CR	
				Ending balance		48.00CR	

Account: 95L400 9272 0000 00 000000 PRETZEL FESTIVA//NONCATE /PRETZEL FESTIVAL

Post Date	Type	Ck/JE/Rc#	Vendor/Payor	Description	Amount	Balance	Detail Account
				Beginning balance		2,722.22CR	
				Ending balance		2,722.22CR	

Account: 95L400 9273 0000 00 000000 HS CLASS 2015//NONCATE /HS CLASS OF 2015

Post Date	Type	Ck/JE/Rc#	Vendor/Payor	Description	Amount	Balance	Detail Account
				Beginning balance		0.00	
				Ending balance		0.00	

Account: 95L400 9274 0000 00 000000 ATH GENERAL FND//NONCATE /ATHLETICS GENERAL FUND

Post Date	Type	Ck/JE/Rc#	Vendor/Payor	Description	Amount	Balance	Detail Account
				Beginning balance		12,030.08CR	
01/09/2023	Receipt	1507	LARSON JILINDA	MR SALTY SOCKS	60.00CR	12,090.08CR	L 9274 0000 00 000000
01/09/2023	Receipt	1509	ALL AMERICAN PUBLISHING	ATHLETIC FUND	392.00CR	12,482.08CR	L 9274 0000 00 000000
01/19/2023	Check	304920	NEW BERLIN CUSD #16	CHARGE CARD CREDIT JANUARY	630.24	11,851.84CR	L 9274 0000 00 000000
01/19/2023	Receipt	1512	NEW BERLIN SPORTS BOOSTERS	HUDL	3,000.00CR	14,851.84CR	L 9274 0000 00 000000
01/20/2023	Check	304924	ROYAL PUBLISHING	IESA 2023 CHEERLEADING CHAMPIONSHIP	255.00	14,596.84CR	L 9274 0000 00 000000
01/23/2023	Receipt	1515	VARIOUS PAYORS	NSF CHECK FOR VOLLEYBALL FEES	120.00	14,476.84CR	L 9274 0000 00 000000
01/23/2023	Receipt	1516	VARIOUS PAYORS	CREDITING ACCOUNT NSF APPLIED TO WRONG ACCOUNT	120.00CR	14,596.84CR	L 9274 0000 00 000000
				Ending balance		14,596.84CR	

Account: 95L400 9278 0000 00 000000 ACT PREP ACCT//NONCATE /ACT PREP ACCOUNT

Post Date	Type	Ck/JE/Rc#	Vendor/Payor	Description	Amount	Balance	Detail Account
				Beginning balance		8.58CR	
				Ending balance		8.58CR	

Account: 95L400 9279 0000 00 000000 HS CLASS 2016//NONCATE /HS CLASS OF 2016

Post Date	Type	Ck/JE/Rc#	Vendor/Payor	Description	Amount	Balance	Detail Account
				Beginning balance		2,056.10CR	
				Ending balance		2,056.10CR	

Account: 95L400 9280 0000 00 000000 HS CLASS 2017//NONCATE /HS CLASS OF 2017

Post Date	Type	Ck/JE/Rc#	Vendor/Payor	Description	Amount	Balance	Detail Account
				Beginning balance		3,144.37CR	
				Ending balance		3,144.37CR	

Account: 95L400 9281 0000 00 000000 SANGAMON CONF.//NONCATE /SANGAMON CONFERENCE ACCOUNT

Post Date	Type	Ck/JE/Rc#	Vendor/Payor	Description	Amount	Balance	Detail Account
				Beginning balance		0.00	

Account: 95L400 9281 0000 00 000000 SANGAMON CONF.//NONCATE /SANGAMON CONFERENCE ACCOUNT							
<u>Post Date</u>	<u>Type</u>	<u>Ck/JE/Rc#</u>	<u>Vendor/Payor</u>	<u>Description</u>	<u>Amount</u>	<u>Balance</u>	<u>Detail Account</u>
				Ending balance		0.00	
Account: 95L400 9282 0000 00 000000 GREENHOUSE ACCT//NONCATE /GREENHOUSE ACCOUNT							
<u>Post Date</u>	<u>Type</u>	<u>Ck/JE/Rc#</u>	<u>Vendor/Payor</u>	<u>Description</u>	<u>Amount</u>	<u>Balance</u>	<u>Detail Account</u>
				Beginning balance		4,707.84CR	
				Ending balance		4,707.84CR	
Account: 95L400 9283 0000 00 000000 HS CLASS 2018//NONCATE /HS CLASS OF 2018							
<u>Post Date</u>	<u>Type</u>	<u>Ck/JE/Rc#</u>	<u>Vendor/Payor</u>	<u>Description</u>	<u>Amount</u>	<u>Balance</u>	<u>Detail Account</u>
				Beginning balance		1,973.29CR	
				Ending balance		1,973.29CR	
Account: 95L400 9284 0000 00 000000 CREWS SCHOLARSH//NONCATE /DAMIEN CREWS SCHOLARSHIP FUND							
<u>Post Date</u>	<u>Type</u>	<u>Ck/JE/Rc#</u>	<u>Vendor/Payor</u>	<u>Description</u>	<u>Amount</u>	<u>Balance</u>	<u>Detail Account</u>
				Beginning balance		4,176.72CR	
				Ending balance		4,176.72CR	
Account: 95L400 9285 0000 00 000000 ROYALTIES//NONCATE /ROYALTIES							
<u>Post Date</u>	<u>Type</u>	<u>Ck/JE/Rc#</u>	<u>Vendor/Payor</u>	<u>Description</u>	<u>Amount</u>	<u>Balance</u>	<u>Detail Account</u>
				Beginning balance		1,209.54CR	
				Ending balance		1,209.54CR	
Account: 95L400 9286 0000 00 000000 HS CLASS 2019//NONCATE /HS CLASS OF 2019							
<u>Post Date</u>	<u>Type</u>	<u>Ck/JE/Rc#</u>	<u>Vendor/Payor</u>	<u>Description</u>	<u>Amount</u>	<u>Balance</u>	<u>Detail Account</u>
				Beginning balance		11.59CR	
				Ending balance		11.59CR	
Account: 95L400 9287 0000 00 000000 HS WRESTLING//NONCATE /HS WRESTLING							
<u>Post Date</u>	<u>Type</u>	<u>Ck/JE/Rc#</u>	<u>Vendor/Payor</u>	<u>Description</u>	<u>Amount</u>	<u>Balance</u>	<u>Detail Account</u>
				Beginning balance		2,417.04CR	
				Ending balance		2,417.04CR	
Account: 95L400 9288 0000 00 000000 HS CLASS 2020//NONCATE /CLASS OF 2020							
<u>Post Date</u>	<u>Type</u>	<u>Ck/JE/Rc#</u>	<u>Vendor/Payor</u>	<u>Description</u>	<u>Amount</u>	<u>Balance</u>	<u>Detail Account</u>
				Beginning balance		6,281.53CR	
				Ending balance		6,281.53CR	

Account: 95L400 9289 0000 00 000000 HS CLASS 2021//NONCATE /HS CLASS OF 2021

Post Date	Type	Ck/JE/Rc#	Vendor/Payor	Description	Amount	Balance	Detail Account
				Beginning balance		1,134.80	
				Ending balance		1,134.80	

Account: 95L400 9290 0000 00 000000 THORNTON AG SCH//NONCATE /THORNTON AG SCHOLARSHIP AWARD

Post Date	Type	Ck/JE/Rc#	Vendor/Payor	Description	Amount	Balance	Detail Account
				Beginning balance		982.93CR	
				Ending balance		982.93CR	

Account: 95L400 9291 0000 00 000000 HS CLASS 2022//NONCATE /HS CLASS OF 2022

Post Date	Type	Ck/JE/Rc#	Vendor/Payor	Description	Amount	Balance	Detail Account
				Beginning balance		2,609.58CR	
				Ending balance		2,609.58CR	

Account: 95L400 9292 0000 00 000000 HS CLASS 2023//NONCATE /HS CLASS OF 2023

Post Date	Type	Ck/JE/Rc#	Vendor/Payor	Description	Amount	Balance	Detail Account
				Beginning balance		4,766.03CR	
				Ending balance		4,766.03CR	

Account: 95L400 9293 0000 00 000000 HS CLASS 2024//NONCATE /HS CLASS OF 2024

Post Date	Type	Ck/JE/Rc#	Vendor/Payor	Description	Amount	Balance	Detail Account
				Beginning balance		1,403.81CR	
01/12/2023	Check	304912	WADE LARRY	PAYMENT FOR PROM DJ	650.00	753.81CR	L 9293 0000 00 000000
01/19/2023	Check	304914	WADE LARRY	SADIES DANCE DJ	300.00	453.81CR	L 9293 0000 00 000000
				Ending balance		453.81CR	

Account: 95L400 9294 0000 00 000000 CLASS OF 2025//NONCATE /HS CLASS OF 2025

Post Date	Type	Ck/JE/Rc#	Vendor/Payor	Description	Amount	Balance	Detail Account
				Beginning balance		3,821.10CR	
				Ending balance		3,821.10CR	

Account: 95L400 9295 0000 00 000000 MASCOT FUND//NONCATE /HS-MASCOT FUNDRAISER

Post Date	Type	Ck/JE/Rc#	Vendor/Payor	Description	Amount	Balance	Detail Account
				Beginning balance		337.75CR	
				Ending balance		337.75CR	

Account: 95L400 9296 0000 00 000000 HS CLASS 2026//NONCATE /HS CLASS OF 2026

Post Date	Type	Ck/JE/Rc#	Vendor/Payor	Description	Amount	Balance	Detail Account
				Beginning balance		70.00CR	
				Ending balance		70.00CR	

Check Dates 01/16/2023 through 02/16/2023 - Check Number

EMPLOYEE NAME	EMP	CHECK	CONTRACT	OTHER	TAXABLE	FED TAX	FED TAX	FEDERAL	STATE	SOC SEC	OTHER REIMBURSE	TAXABLE	NET		
	TYPE	NUMBER	T	PAY	+ PAY	+ BENS	- SHELTER	= GROSS	- TAX	- TAX	- TAX	- DEDS	+ DEDS	- BENS	= PAY
CHRISTOPHER CANSLER	CAF	000059959	R		496.86		22.36	474.50							474.50
JAMIE M HULETT	AIDE	000059961	R		1,139.22		74.41	1,064.81	53.42	45.49	85.38				880.52
LAUREN F HULETT	AIDE	000059962	R		1,013.83		68.84	944.99	66.18	46.78	75.78				756.25
ZACHARY J PEECHER	BLD	000059963	R	1,487.50	0.90		114.05	1,374.35	129.51	68.03	110.26	36.45			1,030.10
CHRISTOPHER CANSLER	CAF	000059971	R		553.54		24.91	528.63							528.63
JAMIE M HULETT	AIDE	000059973	R		1,265.69		80.11	1,185.58	66.38	51.47	95.06				972.67
LAUREN F HULETT	AIDE	000059974	R		1,207.31		78.96	1,128.35	88.18	55.85	90.59				893.73
ZACHARY J PEECHER	BLD	000059975	R	1,487.50	1.24		114.06	1,374.68	129.54	68.05	110.28	36.45			1,030.36
KENNETH HILL	TRN	900065229	R		1,008.14		45.37	962.77	19.33	47.66	77.12				818.66
DONALD R EDWARDS	SSO	900065230	R		577.50			577.50			44.18				533.32
AMY M ANKROM	AIDE	900065232	R		752.70		-94.20	846.90		34.70	67.38				744.82
ANDREW J BALL	BLD	900065233	R	1,226.67			91.77	1,134.90	57.77	50.76	91.05				935.32
RACHELLE M BANDELOW	AIDE	900065234	R		1,106.71		49.80	1,056.91	23.47	52.32	84.67				896.45
EMILY C BURGNER	AIDE	900065241	R		933.51		38.68	894.83	12.54	44.29	65.54				772.46
MICHAEL CHEEK	BLD	900065242	R	1,212.75	-1.10		54.52	1,157.13	16.31	57.28	92.69				990.85
RACHEL M CRAIN	AIDE	900065246	R		1,247.63		56.14	1,191.49		43.80	95.44	155.51			896.74
TRAVIS L CREASEY	BLD	900065247	R	1,312.50			92.53	1,219.97	67.98	60.39	97.85	55.40			938.35
JOELLEN DANENBERGER	SEC	900065249	R		1,180.47		111.57	1,068.90	117.85	52.91	85.84	22.00			790.30
THOMAS A HARTLEY	AIDE	900065254	R		1,089.14		194.13	895.01	12.56	22.65	72.22				787.58
JONELE D HINNEN	AIDE	900065258	R		1,123.39		105.50	1,017.89	19.57	50.39	81.73	27.12			839.08
JAMI R HUESING	NURSE	900065259	R		2,083.92		216.93	1,866.99	80.59	85.20	157.65				1,543.55
JESSICA L JACKSON	AIDE	900065261	R		929.57		107.67	821.90	46.35	40.68	66.07	6.31			662.49
ANGELA M JOHNSON	CAF	900065262	R		842.10		61.04	781.06		38.66	62.64				679.76
KIMBERLY S. JONES	AIDE	900065263	R		1,542.52		90.76	1,451.76	62.95	71.86	116.23	8.00			1,192.72
VINCENT E KING	BLD	900065266	R	1,334.17			96.61	1,237.56	62.09	61.26	99.27	12.00			1,002.94
KELSIE L KNOX	AIDE	900065268	R		1,054.77		27.55	1,027.22		36.41	45.51				945.30
TRUDY L KUNZ	CAF	900065269	R		447.85		20.15	427.70		21.17	34.26				372.27
MORGAN M LONERGAN	AIDE	900065271	R		946.77		200.50	746.27		36.94	60.35				648.98
ANGELA M. MARR	SEC	900065275	R		1,034.41		715.55	318.86		15.78	27.96				275.12
SAMANTHA MARTIN	AIDE	900065276	R		1,048.16		65.06	983.10	21.37	41.44	78.82	-17.89			859.36
DANIELLE R MENSER	AIDE	900065281	R		1,123.27		179.85	943.42	65.99	46.70	81.19	57.97			691.57
NICHOLAS R. MORRISON	AIDE	900065282	R		1,423.49		87.21	1,336.28	113.13	66.15	107.12	209.98			839.90
BRIAN K. NICKELSON	BLD	900065283	R	1,487.50	3.13		87.54	1,403.09	111.45	64.04	112.47	171.50			943.63
AMANDA J ROBINSON	AIDE	900065289	R		913.20		214.80	698.40		34.57	56.57				607.26
NICOLE R RUOT	AIDE	900065290	R		1,080.44		48.62	1,031.82	20.96	51.08	82.66				877.12

Check Dates 01/16/2023 through 02/16/2023 - Check Number

EMPLOYEE NAME	EMP TYPE	CHECK NUMBER	T	CONTRACT PAY	OTHER + PAY	TAXABLE + BENS	FED TAX - SHELTER	FED TAX = GROSS	FEDERAL - TAX	STATE - TAX	SOC SEC - TAX	OTHER REIMBURSE - DEDS	TAXABLE + DEDS	TAXABLE - BENS	NET = PAY
BRETT A RUPPEL	BLD	900065292	R	1,250.00	1.13		92.87	1,158.26	60.57	51.92	92.91				952.86
ANDREA L STONE	AIDE	900065297	R		1,167.08		52.52	1,114.56	34.51	55.17	89.28				935.60
WHITNEY R SUTERA	AIDE	900065298	R		1,095.76		241.90	853.86	3.16	42.27	69.10				739.33
ALEXANDRA THOMSEN	AIDE	900065300	R		947.40		42.63	904.77	13.53	44.79	72.48				773.97
McKENZIE WARD	AIDE	900065302	R		991.62		62.51	929.11	15.97	45.99	74.49	-6.38			799.04
ELYSE M COPELIN	AIDE	900065308	R		1,013.26		197.59	815.67	4.62	40.38	77.51				693.16
REBECCA CURRY	AIDE	900065309	R		1,114.30		158.08	956.22	13.40	47.33	76.98				818.51
DANIEL HIRST	BLD	900065315	R	1,312.50			91.69	1,220.81	68.08	55.02	97.91	8.03			991.77
KATHRYN L LOGSDON	SEC	900065316	R		1,017.60		94.55	923.05		45.69	74.12				803.24
LUANNE M. LOVING	AIDE	900065317	R		1,694.21		76.24	1,617.97	79.57	72.87	129.61				1,335.92
ZACH REUSCHEL	AIDE	900065321	R		1,004.26		84.56	919.70	15.02	45.52	73.81	-17.89			803.24
JENNIFER M SPANN	SEC	900065323	R		1,797.53		333.40	1,464.13	129.54	72.47	118.19	18.28			1,125.65
BREANNA L WOODS	AIDE	900065326	R		947.68		69.93	877.75		29.01	70.41				778.33
SHERRY V BEHL	CAF	900065329	R		674.44		30.35	644.09	11.35	31.88	51.60				549.26
HEATHER J BROWN	CAF	900065331	R		1,059.57		111.56	948.01	17.86	39.71	76.17				814.27
TASHA L CREASEY	BLD	900065334	R	1,216.20	0.32		210.84	1,005.68	42.86	49.78	81.13	23.40			808.51
CASSIE A. DORSEY	ATHTR	900065335	R	1,929.67	377.11		157.08	2,149.70	179.55	101.00	172.40	104.70			1,592.05
NICOLE M ICENOGLLE	AIDE	900065337	R		1,097.56		-95.74	1,193.30	59.16	59.07	95.07	38.79			941.21
STACEY R. KILLION	NURSE	900065340	R		3,105.38		730.93	2,374.45	59.67	88.66	199.99	20.00			2,006.13
BRITTANY L LANE	BLD	900065343	R	1,193.69	497.99		123.36	1,568.32	129.94	86.86	140.71	1035.20			175.61
JANICE A. McCANN	BLD	900065349	R	2,039.17			145.24	1,893.93	191.85	93.75	151.90				1,456.43
CATHERINE A. MILLS	SEC	900065352	R		1,273.62		231.97	1,041.65	77.78	51.56	84.07	26.84			801.40
DINA G PEECHER	SEC	900065353	R		1,024.16		138.91	885.25	11.58	43.82	71.24				758.61
LINDSEY PRATHER	AIDE	900065354	R	329.70	1,091.32		63.95	1,357.07		67.17	108.70				1,181.20
JAMES R SPIELMAN	BLD	900065359	R	1,334.17	10.32		109.34	1,235.15	112.80	61.14	99.12	217.16			744.93
DARRIN R. CUMMINGS	SSO	900065365	R		1,950.37		87.77	1,862.60	176.29	92.20	149.20	97.52			1,347.39
EARL GREEN	AIDE	900065366	R		963.00		43.40	919.60	15.02	45.52	61.58				797.48
LARRY R PIOTROWSKI	SSO	900065379	R		1,867.69		93.07	1,774.62	148.57	87.84	129.86				1,408.35
MARK A. BALLENGER	TRN	900065385	R		1,526.58		68.70	1,457.88	251.72	64.95	116.79				1,024.42
ROBERT BARTH	TRN	900065386	R		675.07		30.38	644.69	69.05	31.91	51.64				492.09
JASON E. CRAIN	TRN	900065387	R		497.15			497.15	10.00	44.61	38.03				404.51
EVA ELY	TRMON	900065388	R		764.66		34.41	730.25	95.64	36.15	58.50				539.96
BRIAN L FOX	TRN	900065389	R		1,339.03		60.26	1,278.77	106.23	63.30	102.44				1,006.80
RICHARD M GOMEZ	TRN	900065391	R		787.93		2.82	785.11	20.00		4.80				760.31
RYLEI HILL	TRMON	900065392	R		540.02		183.23	356.79		17.66	29.16				309.97

Check Dates 01/16/2023 through 02/16/2023 - Check Number

EMPLOYEE NAME	EMP	CHECK	CONTRACT	OTHER	TAXABLE	FED TAX	FED TAX	FEDERAL	STATE	SOC SEC	OTHER REIMBURSE	TAXABLE	NET		
	TYPE	NUMBER	T	PAY	+ PAY	+ BENS	- SHELTER	= GROSS	- TAX	- TAX	- TAX	- DEDS	+ DEDS	- BENS	= PAY
SHELLY M KAUFMAN	TRN	900065394	R		1,969.56		111.78	1,857.78	175.71	91.96	148.90	44.86			1,396.35
TECIA L KERR	TRN	900065395	R		1,220.80		171.41	1,049.39	27.99	44.73	84.48	26.20			865.99
REBECCA KAY MENDENHALL	TRN	900065396	R		1,259.91		56.70	1,203.21	97.16	59.56	96.38				950.11
RODGER R PERRY	TRN	900065397	R		667.69			667.69		18.61	51.08				598.00
RONALD E. SANDHAAS	TRN	900065398	R		772.14		34.75	737.39		36.50	59.07				641.82
TROY L SANSON	TRNM	900065399	R	2,296.67	193.47		196.11	2,294.03	241.87	133.55	184.07	29.21			1,705.33
WILLIAM R TALBERT	TRNFT	900065400	R		3,792.44		191.12	3,601.32	591.47	171.12	288.55	468.16			2,082.02
KENNETH HILL	TRN	900065401	R		987.43		44.43	943.00	17.36	46.68	75.54				803.42
DONALD R EDWARDS	SSO	900065402	R		1,026.00			1,026.00			78.49				947.51
AMY M ANKROM	AIDE	900065404	R		508.05		22.86	485.19		16.80	38.87				429.52
ANDREW J BALL	BLD	900065405	R	1,226.67			91.77	1,134.90	57.77	50.76	91.05				935.32
RACHELLE M BANDELOW	AIDE	900065406	R		1,003.59		45.16	958.43	13.62	47.44	76.77				820.60
EMILY C BURGNER	AIDE	900065413	R		1,120.29		50.41	1,069.88	30.04	52.96	85.70				901.18
MICHAEL CHEEK	BLD	900065414	R	1,212.75	0.47		54.59	1,158.63	16.49	57.35	92.81	78.65			913.33
TRAVIS L CREASEY	BLD	900065418	R	1,312.50			92.53	1,219.97	67.98	60.39	97.85	-72.60			1,066.35
JOELLEN DANENBERGER	SEC	900065420	R		1,272.73		115.72	1,157.01	128.42	57.27	92.90	22.00			856.42
THOMAS A HARTLEY	AIDE	900065425	R		1,041.14		95.61	945.53	17.61	25.15	75.92				826.85
JONELE D HINNEN	AIDE	900065429	R		1,249.77		111.19	1,138.58	31.64	56.36	91.40	27.12			932.06
JAMI R HUESING	NURSE	900065430	R		2,209.48		222.58	1,986.90	92.58	91.13	167.25				1,635.94
JESSICA L JACKSON	AIDE	900065432	R		1,159.67		118.03	1,041.64	72.72	51.56	83.68	6.31			827.37
ANGELA M JOHNSON	CAF	900065433	R		875.70		62.56	813.14		40.25	65.22				707.67
KIMBERLY S. JONES	AIDE	900065434	R		1,765.30		100.34	1,664.96	84.27	82.42	133.27	8.00			1,357.00
VINCENT E KING	BLD	900065437	R	1,334.17	12.97		97.19	1,249.95	63.33	61.87	100.26	12.00			1,012.49
KELSIE L KNOX	AIDE	900065439	R		599.29		25.06	574.23		13.99	42.48				517.76
TRUDY L KUNZ	CAF	900065440	R		417.04		18.77	398.27		19.71	31.91				346.65
MORGAN M LONERGAN	AIDE	900065442	R		987.12		202.32	784.80	1.54	38.85	63.43				680.98
ANGELA M. MARR	SEC	900065446	R		1,174.49		721.85	452.64		22.41	38.67				391.56
SAMANTHA MARTIN	AIDE	900065447	R		1,177.63		70.88	1,106.75	33.73	47.57	88.72	-17.89			954.62
DANIELLE R MENSER	AIDE	900065452	R		1,254.40		180.43	1,073.97	81.65	53.16	82.71	57.97			798.48
NICHOLAS R. MORRISON	AIDE	900065453	R		1,442.65		88.07	1,354.58	115.33	67.05	108.59	212.72			850.89
BRIAN K. NICKELSON	BLD	900065454	R	1,487.50	9.38		87.82	1,409.06	112.17	64.33	112.95	172.13			947.48
AMANDA J ROBINSON	AIDE	900065460	R		1,054.20		221.15	833.05		41.24	67.36				724.45
NICOLE R RUOT	AIDE	900065461	R		1,194.69		53.76	1,140.93	31.87	56.48	91.39				961.19
BRETT A RUPPEL	BLD	900065463	R	1,250.00	-2.25		92.72	1,155.03	60.19	51.76	92.65				950.43
ANDREA L STONE	AIDE	900065468	R		1,252.14		56.35	1,195.79	42.63	59.19	95.79				998.18

Check Dates 01/16/2023 through 02/16/2023 - Check Number

EMPLOYEE NAME	EMP	CHECK	CONTRACT	OTHER	TAXABLE	FED TAX	FED TAX	FEDERAL	STATE	SOC SEC	OTHER REIMBURSE	TAXABLE	NET		
	TYPE	NUMBER	T	PAY	+ PAY	+ BENS	- SHELTER	= GROSS	- TAX	- TAX	- TAX	- DEDS	+ DEDS	- BENS	= PAY
WHITNEY R SUTERA	AIDE	900065469	R		1,221.12		241.28	979.84	15.76	48.50	67.63				847.95
ALEXANDRA THOMSEN	AIDE	900065471	R		1,059.75		47.69	1,012.06	24.26	50.10	81.07				856.63
McKENZIE WARD	AIDE	900065473	R		1,079.66		66.47	1,013.19	24.37	50.15	81.23	-6.38			863.82
ELYSE M COPELIN	AIDE	900065479	R		961.06		187.41	773.65	0.42	38.30	73.53				661.40
REBECCA CURRY	AIDE	900065480	R		1,187.79		161.39	1,026.40	20.42	50.81	82.61				872.56
DANIEL HIRST	BLD	900065486	R	1,312.50			91.69	1,220.81	68.08	55.02	97.91	8.03			991.77
KATHRYN L LOGSDON	SEC	900065487	R		1,057.50		96.35	961.15		47.58	77.17				836.40
LUANNE M. LOVING	AIDE	900065488	R		1,813.52		81.61	1,731.91	90.97	78.51	138.74				1,423.69
ZACH REUSCHEL	AIDE	900065492	R		1,108.96		89.27	1,019.69	25.02	50.47	81.82	-17.89			880.27
JENNIFER M SPANN	SEC	900065494	R		1,864.49		336.41	1,528.08	138.14	75.64	123.31	18.28			1,172.71
BREANNA L WOODS	AIDE	900065497	R		1,168.34		79.86	1,088.48		39.44	87.30				961.74
SHERRY V BEHL	CAF	900065500	R		733.46		33.01	700.45	16.99	34.67	56.11				592.68
HEATHER J BROWN	CAF	900065502	R		1,156.05		115.90	1,040.15	27.07	44.27	83.55				885.26
TASHA L CREASEY	BLD	900065505	R	1,216.20			210.83	1,005.37	42.83	49.77	81.10	23.40			808.27
CASSIE A. DORSEY	ATHTR	900065506	R	1,929.67	128.68		145.90	1,912.45	151.08	89.25	153.38	104.70			1,414.04
NICOLE M ICENOGLLE	AIDE	900065508	R		1,152.80		85.28	1,067.52	45.09	52.84	85.63	38.79			845.17
STACEY R. KILLION	NURSE	900065511	R		3,213.16		735.78	2,477.38	69.96	93.75	208.23	20.00			2,085.44
BRITTANY L LANE	BLD	900065514	R	1,193.69	619.19		134.20	1,678.68	158.65	98.25	159.13	1035.20			227.45
JANICE A. McCANN	BLD	900065520	R	2,039.17			145.24	1,893.93	191.85	93.75	151.90				1,456.43
CATHERINE A. MILLS	SEC	900065523	R		1,558.69		244.80	1,313.89	110.44	65.04	105.88	26.84			1,005.69
DINA G PEECHER	SEC	900065524	R		1,133.51		143.83	989.68	22.02	48.99	79.61				839.06
LINDSEY PRATHER	AIDE	900065525	R	329.70	1,071.95		63.07	1,338.58		66.26	107.22				1,165.10
JAMES R SPIELMAN	BLD	900065530	R	1,334.17	0.72		108.91	1,225.98	111.70	60.69	98.39	217.16			738.04
DARRIN R. CUMMINGS	SSO	900065536	R		2,250.80		101.29	2,149.51	210.72	106.40	172.19	112.54			1,547.66
EARL GREEN	AIDE	900065538	R		1,110.90		42.13	1,068.77	29.93	52.90	59.88				926.06
LARRY R PIOTROWSKI	SSO	900065551	R		2,129.53		69.35	2,060.18	177.13	101.98	97.81				1,683.26
MARK A. BALLENGER	TRN	900065559	R		1,788.29		80.47	1,707.82	307.88	77.32	136.80				1,185.82
ROBERT BARTH	TRN	900065560	R		883.39		39.75	843.64	97.44	41.76	67.58				636.86
JASON E. CRAIN	TRN	900065561	R		856.60			856.60	10.00	62.40	65.53				718.67
EVA ELY	TRMON	900065562	R		882.70		39.72	842.98	108.75	41.73	67.53				624.97
BRIAN L FOX	TRN	900065563	R		1,328.53		59.78	1,268.75	105.03	62.80	101.63				999.29
RICHARD M GOMEZ	TRN	900065565	R		950.32		1.41	948.91	20.00		2.39				926.52
RYLEI HILL	TRMON	900065566	R		472.03		180.17	291.86		14.45	23.95				253.46
SHELLY M KAUFMAN	TRN	900065568	R		1,804.77		104.36	1,700.41	156.83	84.17	136.29	44.86			1,278.26
TECIA L KERR	TRN	900065569	R		1,428.72		180.76	1,247.96	47.85	54.56	100.39	26.20			1,018.96

Check Dates 01/16/2023 through 02/16/2023 - Check Number

EMPLOYEE NAME	EMP TYPE	CHECK NUMBER	T	CONTRACT PAY	OTHER + PAY	TAXABLE + BENS	FED TAX - SHELTER	FED TAX = GROSS	FEDERAL - TAX	STATE - TAX	SOC SEC - TAX	OTHER REIMBURSE - DEDS	TAXABLE + DEDS	TAXABLE - BENS	NET = PAY
REBECCA KAY MENDENHALL	TRN	900065570	R		1,767.39		79.53	1,687.86	155.32	83.55	135.21				1,313.78
KRIS C. NEUMAN	TRN	900065571	R		103.43			103.43		5.12	7.91				90.40
RODGER R PERRY	TRN	900065572	R		742.76			742.76		22.33	56.82				663.61
RONALD E. SANDHAAS	TRN	900065573	R		957.17		43.07	914.10	14.47	45.25	73.22				781.16
TROY L SANSON	TRNM	900065574	R	2,296.67	262.79		199.23	2,360.23	249.81	136.83	189.37	29.21			1,755.01
LORI L STEPHENS	TRN	900065575	R		349.25		204.85	144.40		7.15	22.20	101.51			13.54
WILLIAM R TALBERT	TRNFT	900065576	R		3,950.01		198.21	3,751.80	626.23	178.53	300.61	483.92			2,162.51
Summary Totals				\$41,925.72				\$170,110.35		\$7,923.17		\$5,687.66			
					\$145,064.56		\$16,879.93		\$9,670.01		\$13,358.65				\$133,470.86
8	Check(s) Reported														
139	Deposit(s) Reported														

***** End of report *****

**NEW BERLIN C.U.S.D. #16
TREASURER'S REPORT
January 31, 2023**

FUND	Beginning Cash Balance	Receipts	Disbursements		Misc. Transactions	Bank Balance
			Payroll	Accounts Payable		
10 Education	2,719,677.02	296,305.11	393,415.36	306,485.51	22.17	2,316,103.43
20 Building	2,168,083.71	712.89	22,943.67	64,164.54	885.55	2,082,573.94
30 Bond & Interest	(538,441.91)	-	-	-	119.03	(538,322.88)
40 Transportation	268,363.46	100,401.64	33,557.48	46,879.18	246.20	288,574.64
50 IMRF	268,767.32	191.76	-	37,420.27	54.10	231,592.91
60 Capital Projects Fund	32,305,962.66	28,504.06	-	122,265.01	3,836.72	32,216,038.43
61 Capital Projects Fund - Sales Tax	2,503,196.87	74,469.12	-	-	-	2,577,665.99
70 Working Cash Fund	2,407,912.49	351.02	-	-	0.30	2,408,263.81
80 Tort	(68,301.79)	-	-	12,732.27	-	(81,034.06)
90 Fire Prevention & Safety	502,287.83	52.93	-	-	455.83	502,796.59
TOTAL	\$ 42,537,507.66	\$ 500,988.53	\$ 449,916.51	\$ 589,946.78	\$ 5,619.90	\$ 42,004,252.80

FUND	CASH			INVESTMENTS					BONDS			TOTAL
	UCB - General Fund	UCB MM	WBSB MM	WBSB #1	WBSB #3	CSB #1	CSB #2	CSB #3	NB WC Bonds (2015)	NB WC Bonds (2018)	Griggsville-Perry Bonds	
	0.6000%	0.1500%	0.2500%	0.4000%	4.0000%	0.1500%	2.3000%	4.0000%	2.2500%	3.0200%	2.5000%	
10 Education	2,085,447.66	-	-	-	-	-	-	-	-	-	230,655.77	2,316,103.43
20 Operations & Maintenance	2,082,573.94	-	-	-	-	-	-	-	-	-	-	2,082,573.94
30 Bond & Interest	(538,322.88)	-	-	-	-	-	-	-	-	-	-	(538,322.88)
40 Transportation	288,574.64	-	-	-	-	-	-	-	-	-	-	288,574.64
50 IMRF / Social Security	231,592.91	-	-	-	-	-	-	-	-	-	-	231,592.91
60 Capital Projects Fund	17,663,933.56	100,547.30	1,191,484.30	500,000.00	5,000,000.00	-	2,756,236.56	5,003,836.71	-	-	-	32,216,038.43
61 Capital Projects Fund - Sales Tax	2,577,665.99	-	-	-	-	-	-	-	-	-	-	2,577,665.99
70 Working Cash	398,194.98	393.71	-	-	-	806,674.78	1,203,000.34	-	-	-	-	2,408,263.81
80 Tort	(81,034.06)	-	-	-	-	-	-	-	-	-	-	(81,034.06)
90 Fire Prevention & Safety	60,061.68	30,879.13	411,855.78	-	-	-	-	-	-	-	-	502,796.59
TOTAL	\$ 24,768,688.42	\$ 131,820.14	\$ 1,603,340.08	\$ 500,000.00	\$ 5,000,000.00	\$ 806,674.78	\$ 3,959,236.90	\$ 5,003,836.71	\$ -	\$ -	\$ 230,655.77	\$ 42,004,252.80
		\$26,503,848.64				\$11,310,511.49					\$230,655.77	\$ 38,045,015.90

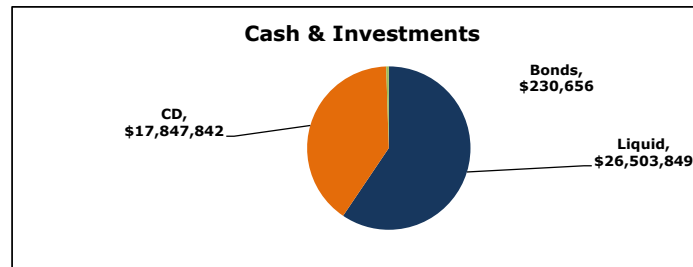

**COMMUNITY UNIT SCHOOL DISTRICT #16
NEW BERLIN, ILLINOIS
January 18, 2023**

MINUTES OF REGULAR BOARD MEETING

President Neuman opened the meeting with the Pledge of Allegiance.

President Neuman called the Board Meeting to order at 6:00 p.m. Members Kotner, Gordon, Marr, Beard, Mann and Williams were present.

Pretzel Shoutouts were shared with the Board.

There was no one for Public Comment.

President Neuman asked for any adjustments to the agenda, of which a request was made to remove Item 9F from the Personnel Consent to Item #10 and move adjournment to Item #11. There were no objections to the request.

There were no questions or comments regarding Director's Reports.

Administrators highlighted items in their reports.

The Superintendent brought up a conflict with the February Board Meeting date. There was discussion and the February Board meeting was moved to Wednesday, February 15 at 6:00 p.m. She also talked about the solar project, upcoming police training day at the elementary school on February 17, during the teacher institute day. The Superintendent made note to the insurance benefit review, indicating that New Berlin is comparative to other districts. She also reported on progress of the upcoming 23-24 school calendar and progress on providing speech services.

A motion was made by Member Gordon and seconded by Member Beard to approve the consent agenda. The motion passed on a roll call vote, 7-0. President Neuman, Member Kotner, Mann, Gordon, Marr, Beard and Williams voted yea.

A motion was made by Member Kotner and seconded by Member Marr to discuss and approve the design, development and scope package. A representative from BLDD provided updates and highlighted some changes. The construction manager from CORE explained and highlighted the budget and items in the budget. The motion passed on a roll call vote, 7-0. President Neuman, Member Kotner, Mann, Gordon, Marr, Beard and Williams voted yea.

A motion was made by Member Gordon and seconded by Member Mann to approve the Second Reading of Policy Press 110. The motion passed on a voice vote, 7-0. President Neuman, Member Kotner, Mann, Gordon, Marr, Beard and Williams voted yea.

A motion was made by Member Beard and seconded by Member Marr to approve the Bus Bid to purchase two (2) 71 passenger busses. The motion passed on a roll call vote, 7-0. President Neuman, Member Kotner, Mann, Gordon, Marr, Beard and Williams voted yea.

A motion was made by Member Kotner and seconded by Member Gordon to approve the letter of intent to pursue solar energy procurement project for New Berlin Elementary, Junior High and Senior High Schools with Clean Energy Design Group. The motion passed on a roll call vote, 7-0. President Neuman, Member Kotner, Mann, Gordon, Marr, Beard and Williams voted yea.

A motion was made by Member Marr and seconded by Member Mann to approve the overnight FFA trip February 3-4, 2023. The motion passed on a voice vote, 7-0. President Neuman, Member Kotner, Mann, Gordon, Marr, Beard and Williams voted yea.

A motion was made by Member Gordon and seconded by Member Beard to approve the destroying of executive session tapes for the Month(s) of June 2021 and prior. The motion passed on a voice vote, 6-1. President Neuman, Member Kotner, Mann, Gordon, Marr and Beard voted yea. Member Williams voted no.

The item to enter into executive session died for lack of motion.

A motion was made by Member Mann and seconded by Member Marr to approve the personnel consent agenda (Kaytee Grider-6th grade volleyball coach, Alyssa Hermes-5th Grade Teacher, Amy Machin-Permanent Substitute, Christopher Cansler-Part Time Cook). The motion passed on a roll call vote, 7-0. President Neuman, Member Kotner, Mann, Gordon, Marr, Beard and Williams voted yea.

A motion was made, at 7:02 p.m., by Member Beard and seconded by Member Gordon to adjourn the meeting. The motion passed on a voice vote, 7-0. President Neuman, Member Kotner, Mann, Gordon, Marr, Beard and Williams voted yea.

The meeting adjourned at 7:02 p.m.

Secretary

President

NEW BERLIN C.U.S.D. #16

Application for Establishing a Student Activity Account

ACCOUNT NAME: JH PBIS Fund

ACCOUNT NUMBER: 99 L 400 9125 (To be assigned by Fund Custodian)

FACULTY ADVISOR: Timothy ROBERTS [Signature]
NAME SIGNATURE

[Signature] [Signature]
NAME SIGNATURE

TREASURER: Mallory Wainman [Signature]
NAME SIGNATURE

PRINCIPAL APPROVED: [Signature] 2/14/23
SIGNATURE DATE

BOARD APPROVED: _____
DATE

New Berlin C.U.S.D. #16

PROFESSIONAL WORKSHOP PAYMENT REQUEST FORM

Employee Name: Stephanie Neuman Date Requested: 1/11/2023
 Name of Workshop: Joint Annual Conference Date(s) Attending: November 18-20, 2022
 Location of Workshop: Chicago, Illinois Reason to Attend: school board member pd

Estimated Expenses:		Total Amount	School Credit Card?
	Registration:	\$ -	N/A
220	Miles @ \$ 0.655	\$ 144.10	N/A
	Food:	\$ -	N/A
	Lodging:	\$ -	N/A
	Tuition Reimburse	\$ -	N/A
	Other:	\$ -	N/A
	Total Est. Expenses:	\$ 144.10	
	Total Requested Charge:	\$ 144.10	A

Final Expenses:		Total Amount	School Credit Card?
	Registration:	\$ -	N/A
220	Miles @ \$ 0.655	\$ 144.10	N/A
	Food:	\$ 40.08	N/A
	Lodging:	\$ -	N/A
	Tuition Reimburse	\$ -	N/A
	Other:	\$ -	N/A
	Total Final Expenses:	\$ 184.18	
	Total Requested Reimb:	\$ 184.18	

Are expenses to be shared with another Faculty member? (Final Expenses only) Yes No

If yes, please include additional faculty name(s): _____

Please select expenses to be shared: Mileage Lodging Other _____

Pre-Approval: _____
 Supervisor Signature / Date

Stephanie M. Neuman 1/11/2023
 Employee Signature / Date

Funds Available? _____
 Yes / No (A/P Initial/Date)

Final Approval: _____
 Supervisor Signature / Date

Dollar Amount Available: * _____
 * (If not enough to cover above request)

For Accounting Use Only:

Actual VISA Charges:			Reimb. Charge to:			Check # & Date
Payee:	Purpose	Amount	#	Amount		
			NBE Budget - #103-2213-3320			
			JH Budget - #202-2213-3320			
			HS Budget - #305-2213-3320			
			Pre-K Budget - #500-1125-3320			
			Pre-K PD - #500-2213-3320			
			Title I Budget - #000-1250-3900			
			Other - _____			
	Total:					
	Date Paid:					
	Budget #:					



Home (323 Liberty Ln) to Swissotel Chicago,
323 E Wacker Dr, Chicago, IL 60601

Drive 220 miles, 3 hr 21 min

323 Liberty Ln
New Berlin, IL 62670

Get on I-72 E from Old Rte 54

- 12 min (9.3 mi)
- ↑ 1. Head north on Liberty Ln toward Heritage Point Ave 390 ft
- ↪ 2. Turn right onto Heritage Point Ave 0.2 mi
- ↪ 3. Turn right onto Berlin Rd 0.3 mi
- ↶ 4. Turn left onto E Birch St 177 ft
- ↑ 5. Continue onto Old Rte 54 8.3 mi
- ↗ 6. Slight right onto the 72 E ramp to Decatur 0.4 mi

Follow I-55 N to US-41 N/S Dusable Lk Shr Dr/US Hwy 41 N in Chicago. Take the US-41 N/Lake Shore Drive exit from I-55 N

- 3 hr 5 min (208 mi)
- ↗ 7. Merge onto I-72 E 10.8 mi
- ↑ 8. Continue onto I-55 N 29.5 mi
- ↗ 9. Keep right at the fork to stay on I-55 N, follow signs for Interstate 55 N/Chicago 167 mi
- ↶ 10. Use the left 2 lanes to take the US-41 N/Lake Shore Drive exit 0.6 mi

Continue on S Dusable Lk Shr Dr. Drive to E Wacker Dr

- 8 min (2.9 mi)
- ↗ 11. Merge onto US-41 N/S Dusable Lk Shr Dr/US Hwy 41 N 2.1 mi
- ⓘ Continue to follow S Dusable Lk Shr Dr

- ↪ 12. Use the right 2 lanes to take the Randolph St exit toward Wacker Dr/I-290 0.2 mi
- ↶ 13. Keep left, follow signs for Wacker Dr 0.2 mi
- ↶ 14. Continue onto E Lower Wacker Dr 322 ft
- ↗ 15. Use the right lane to take the ramp to Upper Wacker 0.2 mi
- ↗ 16. Merge onto E Wacker Dr 262 ft
- ↶ 17. Sharp left onto Lk Shr Dr/E Wacker Dr
 - ⓘ Continue to follow E Wacker Dr
 - ⓘ Destination will be on the right
 0.1 mi

Swissotel Chicago

RESOLUTION TO SELL/DISPOSE OF SURPLUS OR OUTDATED EQUIPMENT/SUPPLIES

WHEREAS, certain equipment or supplies owned by New Berlin C.U.S.D. #16 are no longer necessary for its operation;

RESOLVED, to dispose of certain supplies or equipment described below:

6-lap belts for bus seats
2-Safety Vision video systems
Library Books (see attached listing)

The undersigned hereby certifies that he/she is the duly elected and qualified Secretary of New Berlin C.U.S.D. #16, a public school district formed pursuant to the laws of the state of Illinois, and that the foregoing is a true record of a resolution duly adopted at a meeting of the Board of Education and that said meeting was held in accordance with state law on February 16, 2023, and that said resolution is now in full force and effect without modification or rescission.

IN WITNESS WHEREOF, I have executed my name as Secretary this 16th day of February of 2023.

Secretary
Board of Education

February 16, 2023

Items to Discard 2/14/23

Asset Tag Number	Description	Acquisition Date (if known or approximate)	Acquisition Cost (if known or approximate)	Condition	Purchased with Federal Funds?	Method of Disposition
	Dork Diaries Tales from a Not So Happy Heartbreaker	10/13	14	Worn	no	Discarded
	My Dog, Buddy	12/08	4	Worn	?	Discarded
	Pets True or False	10/21	5	Damaged		Discarded
	Animal Safari: Polar Bears	1/12	16	Worn		Discarded
	Oceans Alive: Puffer Fish	9/09	16	Worn		Discarded
	Animal Safari: Gorillas	1/12	16	Worn		Discarded
	Oceans Alive: Clown Fish	3/09	15	Worn		Discarded
	Mighty Machines: Police Cars	5/10	16	Damaged		Discarded
	The Babysitters Club Graphic Novel: Kristy's Big Day	3/22	11	Damaged		Discarded
	Diary of a	11/11	14	Worn		Discarded

	Wimpy Kid: The Ugly Truth					
	Charlotte's Web	3/02		Worn		Discarded
	If You Plant A Seed	10/20	19	Damaged		Discarded



New Berlin CUSD #16 2023 - 24 School Calendar



August 2023					
Mon	Tue	Wed	Thu	Fri	Total
	1	2	3	4	0
7	8	9	TI	TI	0
TI	15*	16*	17*	18*	4
21	22	23	24	25	5
28	29	30	31		4
			Total		13

September 2023					
Mon	Tue	Wed	Thu	Fri	Total
				1	1
HOL	5	6	7	8	4
11	12	13	14	XHS	5
18	19	20	21	22	5
25	26	PT*	PT*	NIA/PT	5
					20
			Total		33

October 2023					
Mon	Tue	Wed	Thu	Fri	Total
2	3	4	5	6	5
HOL	10	11	12	13	4
16	17	18	19	20	5
23	24	25	26	27	5
30	31				2
					21
			Total		54

November 2023					
Mon	Tue	Wed	Thu	Fri	Total
		1	2	3	3
6	7	8	XHS	HOL	4
13	14	15	16	17	5
20	21*	NIA	HOL	NIA	2
27	28	30			3
					17
			Total		71

December 2023					
Mon	Tue	Wed	Thu	Fri	Total
				1	1
4	5	6	7	8	5
11	12	13	14	15	5
18	19	20	21*	NIA	4
NIA	NIA	NIA	NIA	NIA	0
					15
			Total		86

January 2024					
Mon	Tue	Wed	Thu	Fri	Total
NIA	NIA	TI	4	5	2
8	9	10	11	12	5
HOL	16	17	18	19	4
22	23	24	25	26	5
29	30	31			3
					19
			Total		105

February 2024					
Mon	Tue	Wed	Thu	Fri	Total
			1	2	2
5	6	7	8	9	5
12	13	14	15	XHS	5
HOL	20	21	22	23	4
26	27	28	29		4
					20
			Total		125

March 2024					
Mon	Tue	Wed	Thu	Fri	Total
				1	1
4	5	6	7	8	5
11	12	13	14	15	5
18	19	20	21	22	5
NIA	NIA	NIA	NIA	NIA	0
					16
			Total		141

April 2024					
Mon	Tue	Wed	Thu	Fri	Total
1	2	3	4	5	5
8	9	10	11	12	5
15	16	17	18	19	5
22	23	24	25	XHS	5
29	30				2
					22
			Total		163

May 2024					
Mon	Tue	Wed	Thu	Fri	Total
		1	2	3	3
6	7	8	9	10	5
13	14	15	16	17*	5
XED	XED	XED	XED	XED	0
HOL	28	29	30	31	0
					13
			Total		176

June 2024					
Mon	Tue	Wed	Thu	Fri	Total
3	4	5	6	7	0
10	11	12	13	14	0
17	18	19	20	21	0
24	25	26	27	28	0
					0
					176
			Total		176

School Holidays (HOL)	
Labor Day	Sept. 4, 2023
Columbus Day	Oct. 9, 2023
Veterans' Day	Nov. 10, 2023
Thanksgiving Day	Nov. 23, 2023
MLK Day	Jan. 15, 2024
President's Day	Feb. 19, 2024
Memorial Day	May 27, 2024

Codes:
 *=2:21 pm dismissal
 TI = Teacher Institute Day - No School for Students
 Monthly Professional Development/1:00 pm Dismissal
 NIA = Not in Attendance - School not in Session
 End of Quarter
 Parent-Teacher Conferences/Students dismissed at 2:21 pm
 HOL = Legal Public School Holiday -No School
 XHS = Half-day School Improvement-11:45 am
 XED = Emergency Days - 5 emergency days are built into the calendar. If any emergency/snow days are used, the school ending date will change.

School Begins/Teachers	
School Begins/Teachers	August 10, 2023
1st Student Attendance Day	August 16, 2023
End of 1st Quarter	October 16, 2023
End of 2nd Quarter	December 21, 2023
End of 3rd Quarter	March 6, 2024
School Ends (if no snow days)	May 17, 2024

Total Student Attendance Days	176
Emergency Days	5
Teacher Institute/Workshop	4
Total Calendar Days	185

Semester 1 Total Days	86
Semester 2 Total Days	90
	176



New Berlin CUSD #16



Summer Learning Opportunities 2023

If you are interested in summer employment (teachers, paraprofessionals, bus drivers, cafeteria, secretaries, and nurse) please keep reading all the options and e-mail Jill at jlanson@pretzelpride.com with your interest no later than Friday (03/10) by 4 pm.

Summer School – Grades 6 – 12 Credit Recovery on Edgenuity

Student Attendance Days – May 26 – June 23, 2023

Paraprofessional (1) - Administrators will oversee the progress of students in the month of June from 8:00 – 11:30 am. Student attendance day will begin at 8:10 am to 11:30 am.

Class Size: Depends on number of students who are failing courses

Curriculum Focus: Credit recovery and/or not being retained

Administration will work with the Director of Student Services to determine students who will be required to be in attendance to complete coursework on Edgenuity.

Snack will be provided.

Extended School Year July 17 – August 4

SASED Central, 8 am to Noon

- Will need bus driver(s)
- Paraprofessional Opportunities through SASED

Pretzel Jump Start for incoming grades 1- 5 @ NBE July 31 – August 4

Student Attendance Days: July 31 – August 4, 8:15 – 11:20 am (80 minutes of reading/80 minutes of math/25 minutes of physical activity and social emotional activity)

Teacher Work Day: 8:00 am – Noon (Prep time could be flexed differently) + 8 hours for teacher planning before summer school starts so 8 hours starting anywhere between July 24 - 28.

Paraprofessional Work Day: 8:00 am – 11:30 am – depending on number of students attending and staff applying, will try to staff equitably.

Cafeteria Staff: Will provide a snack.

Class Size: Keep them small with 10 or less students, but will depend on # of teachers interested as well as students who commit to attending.

Curriculum Focus: ELA, Math, and Social and Emotional Learning

Administration will work with grade level teams to identify students who are below

in reading and math that start off the school year behind or have a tough time transitioning back to a structured day and routine.

6th Grade and 9th Grade Pretzel Success Day - August 2023

Student Attendance Day: Friday, **August 4**, 8:15 am to 2:45 pm

Teacher Work Day: 8 hours for teacher planning before it starts in August.

Class Size: Small Groups - depending on # of students interested as well as teachers interested.

Curriculum Focus: Transition to Junior High or High School, organization, self-advocacy skills, study skills, leadership skills, technology, reading strategies, writing strategies, note taking, etc.

All incoming 6th graders and 9th graders would be eligible to attend.

Administrators will work with staff that are interested in developing the skills that need to be taught.

Snack and lunch will be provided on this day.

Please let me know if you are interested by March 10 at 4 pm by indicating which one:

1. JH/HS Summer School – Credit Recovery
2. Extended School Year - SASSED
3. Elementary Pretzel Jump Start
4. Pretzel Pride for Success Incoming 6th graders
5. Pretzel Success for Incoming 9th graders

If you have any questions, please let me know. It is important to know if we have staff to do this before moving forward and we can communicate dates and times to parents to see if there is student interest. Decisions on holding these opportunities will need to be made no later than March 10 for board approval on March 16.

All summer school staff will be approved at the May board meeting.

Rate of pay: Teachers- \$35/hour and Support Staff (paraprofessionals, bus drivers, secretary, nurse) – hourly rate; rate of pay will change for August based on the rate of pay set for the new fiscal year which begins July 1.

Class of 2026 and Earlier

MATHEMATICS

YEAR	COURSE
Freshman	Math 1
Sophomore	Math 2
Junior	Math 3
Senior	Statistics OR Trigonometry OR Pre-Calculus OR Calculus

MATH 1

College Prep/NCAA approved
SCED Code: 02062A000
Length of Course: 1 year
Prerequisite: None

****Required Course****
Recommended Grade Level: 9
Credit: 1 credit

In this course, students will simplify expressions and solve equations and inequalities. Students will identify and use functions. Linear and exponential functions will be emphasized. Students will interpret these functions in relevant, real-world situations, including statistical models. Students will also identify congruent and similar triangles. The connections between algebra and geometry will be emphasized.

Class of 2027 and Later

MATHEMATICS

YEAR	COURSE
Freshman	Algebra 1
Sophomore	Geometry
Junior	Algebra 2
Senior	Statistics OR Trigonometry OR Pre-Calculus OR Calculus

ALGEBRA 1

College Prep/NCAA PENDING
SCED Code:02052A000
Length of Course: 1 year
Prerequisite: None

****Required Course****
Recommended Grade Level: 9
Credit: 1 credit

Algebra 1 is a one year course of elementary algebra and prepares students for Geometry. Topics covered include the following: Solving Equations and Inequalities, Linear Functions, Linear Models, Systems of Linear Equations and Inequalities, Introduction to Nonlinear Functions, Exponents and Exponential Functions, Polynomials and Factoring, Quadratic Functions, Solving Quadratic Equations, Radical Functions, and Statistics.



REQUEST FOR PERSONNEL SERVICES

NEW BERLIN CUSD #16

Action Requested:	Replacement	Employee Category:	Certified	Employment Status:	Full Time
				If PT, No. of Hrs/Day:	
Certified Position:	Teacher	Subject/Grade:	6-8 Social Studies	ESP Position:	Choose an item.
NEW EMPLOYEE INFORMATION / PLACEMENT					
Name:	Olivia Killion			Hourly/Daily Rate of Pay:	Click or tap here to enter text.
Location:	JH School	Certified Degree:	Choose an item.	Additional Hours:	Click or tap here to enter text.
Salary Schedule Placement	MA+0.	Step:	0	Annual Rate of Pay:	\$45,291.04
Extra-curricular assignment:	Click or tap here to enter text.	Placement:	Click or tap here to enter text.	Salary:	Click or tap here to enter text.
Extra-curricular assignment:	Click or tap here to enter text.	Placement	Click or tap here to enter text.	Salary:	Click or tap here to enter text.
Extra-curricular assignment:	Click or tap here to enter text.	Placement	Click or tap here to enter text.	Salary:	Click or tap here to enter text.
Incumbent Name:	Jeff Harres	Desired Beginning Date:	8/1/2023		
Position Supervisor:	Timothy Roberts				
Action Requested by:	Timothy Roberts	Date:	2/6/2023		

(Placement – indicate the location of the employee on the extra-curricular salary schedule: i.e. 3yrs=col. 2; salary from Appendix C)

APPOINTMENT AUTHORIZATION SIGNATURES

Chief Financial Officer:		Superintendent:	
President:		Secretary	

Routing: Original to Chief Financial Officer – Attach resume/application/transcripts/certificates



REQUEST FOR PERSONNEL SERVICES

NEW BERLIN CUSD #16

Action Requested:	Replacement	Employee Category:	Educational Support Staff	Employment Status:	Full-time (FT)
Certified Position:	Choose an item.	Subject/Grade/Activity/Sport:	Click or tap here to enter text.	If PT, No. of Hrs/Day:	
				ESP Position:	Paraprofessional - Special Education

NEW EMPLOYEE INFORMATION / PLACEMENT

Name:	Jacobs, Allison			Hourly/Daily Rate of Pay:	\$15/hour
Location:	Senior High School	Certified Degree:	Choose an item.	Additional Hours:	Click or tap here to enter text.
Salary Schedule Placement	Choose an item.	Step:	Choose an item.	Annual Rate of Pay:	Click or tap here to enter text.
Extra-curricular assignment:	Click or tap here to enter text.	Placement:	Click or tap here to enter text.	Salary:	Click or tap here to enter text.
Extra-curricular assignment:	Click or tap here to enter text.	Placement	Click or tap here to enter text.	Salary:	Click or tap here to enter text.
Extra-curricular assignment:	Click or tap here to enter text.	Placement	Click or tap here to enter text.	Salary:	Click or tap here to enter text.
Incumbent Name:	Icenogle, Nicole	Desired Beginning Date:	2/3/2023		
Position Supervisor:	Hattie Llewellyn				
Action Requested by:	Hattie Llewellyn	Date:	1/30/2023		

(Placement – indicate the location of the employee on the extra-curricular salary schedule: i.e. 3yrs=col. 2; salary from Appendix C)

APPOINTMENT AUTHORIZATION SIGNATURES

Chief Financial Officer:		Superintendent:	
President:		Secretary	

Routing: Original to Chief Financial Officer – Attach resume/application/transcripts/certificates



REQUEST FOR PERSONNEL SERVICES

NEW BERLIN CUSD #16

Action Requested:	Replacement Amy Ihlenfeldt	Employee Category:	Educational Support Staff	Employment Status:	Full-Time (FT)
Certified Position:	Choose an item.	Subject/Grade:	Elementary	If PT, No. of Hrs/Day:	
				ESP Position:	Paraprofessional
NEW EMPLOYEE INFORMATION / PLACEMENT					
Name:	Brooke Brummert	Certified Degree:	Choose an item.	Hourly/Daily Rate of Pay:	\$15.00
Location:	New Berlin Elementary	Step:	Choose an item.	Additional Hours:	Click or tap here to enter text.
Salary Schedule Placement:	Choose an item.	Placement:	Click or tap here to enter text.	Annual Rate of Pay:	Click or tap here to enter text.
Extra-curricular assignment:	Click or tap here to enter text.	Placement:	Click or tap here to enter text.	Salary:	Click or tap here to enter text.
Extra-curricular assignment:	Click or tap here to enter text.	Placement:	Click or tap here to enter text.	Salary:	Click or tap here to enter text.
Extra-curricular assignment:	Click or tap here to enter text.	Placement:	Click or tap here to enter text.	Salary:	Click or tap here to enter text.
Incumbent Name:	Amy Ihlenfeldt Brooke Brummert	Desired Beginning Date:	February 13, 2023		
Position Supervisor:	Click or tap here to enter text.				
Action Requested by:	Haas	Date:	February 5, 2023		
(Placement – indicate the location of the employee on the extra-curricular salary schedule: i.e. 3yrs=col. 2; salary from Appendix C)					
APPOINTMENT AUTHORIZATION SIGNATURES					
Chief Financial Officer:		Superintendent:			
President:		Secretary			

Routing: Original to Chief Financial Officer – Attach resume/application/transcripts/certificates



REQUEST FOR PERSONNEL SERVICES

NEW BERLIN CUSD #16

Action Requested:	Replacement	Employee Category:	Certified	Employment Status:	Full-time (FT)
				If PT, No. of Hrs/Day:	
Certified Position:	Choose an item.	Subject/Grade:	Click or tap here to enter text.	ESP Position:	Choose an item.
NEW EMPLOYEE INFORMATION / PLACEMENT					
Name:	James Dambacher			Hourly/Daily Rate of Pay:	
Location:	High School	Certified Degree:	Choose an item.	Additional Hours:	Click or tap here to enter text.
Salary Schedule Placement	Choose an item.	Step:	8	Annual Rate of Pay:	\$7,620.00
Extra-curricular assignment:	Head HS Football Coach	Placement:	Click or tap here to enter text.	Salary:	Click or tap here to enter text.
Extra-curricular assignment:	Click or tap here to enter text.	Placement	Click or tap here to enter text.	Salary:	Click or tap here to enter text.
Extra-curricular assignment:	Click or tap here to enter text.	Placement	Click or tap here to enter text.	Salary:	Click or tap here to enter text.
Incumbent Name:		Desired Beginning Date:	July 1, 2023		
Position Supervisor:	Blake Lucas				
Action Requested by:	Blake Lucas	Date:	February 15, 2023		

(Placement – indicate the location of the employee on the extra-curricular salary schedule: i.e. 3yrs=col. 2; salary from Appendix C)

APPOINTMENT AUTHORIZATION SIGNATURES

Chief Financial Officer:		Superintendent:	
President:		Secretary	

Routing: Original to Chief Financial Officer – Attach resume/application/transcripts/certificates



REQUEST FOR PERSONNEL SERVICES

NEW BERLIN CUSD #16

Action Requested:	Replacement	Employee Category:	Certified	Employment Status:	Full-time (FT)
				If PT, No. of Hrs/Day:	
Certified Position:	Choose an item.	Subject/Grade:	Click or tap here to enter text.	ESP Position:	Choose an item.
NEW EMPLOYEE INFORMATION / PLACEMENT					
Name:	Mellissa Dillon			Hourly/Daily Rate of Pay:	
Location:	High School	Certified Degree:	Choose an item.	Additional Hours:	Click or tap here to enter text.
Salary Schedule Placement	Choose an item.	Step:	0	Annual Rate of Pay:	\$3,663.00
Extra-curricular assignment:	Asst. HS softball Coach	Placement:	Click or tap here to enter text.	Salary:	Click or tap here to enter text.
Extra-curricular assignment:	Click or tap here to enter text.	Placement	Click or tap here to enter text.	Salary:	Click or tap here to enter text.
Extra-curricular assignment:	Click or tap here to enter text.	Placement	Click or tap here to enter text.	Salary:	Click or tap here to enter text.
Incumbent Name:		Desired Beginning Date:	February 14, 2023		
Position Supervisor:	Blake Lucas				
Action Requested by:	Blake Lucas	Date:	February 13, 2023		

(Placement – indicate the location of the employee on the extra-curricular salary schedule: i.e. 3yrs=col. 2; salary from Appendix C)

APPOINTMENT AUTHORIZATION SIGNATURES

Chief Financial Officer:		Superintendent	
President:		Secretary	

Routing: Original to Chief Financial Officer – Attach resume/application/transcripts/certificates



REQUEST FOR PERSONNEL SERVICES

NEW BERLIN CUSD #16

Action Requested:	New Position	Employee Category:	Educational Support Staff	Employment Status:	Part-time (PT)
Certified Position:	Choose an item.	Subject/Grade:	NBE	If PT, No. of Hrs/Day:	5
NEW EMPLOYEE INFORMATION / PLACEMENT				ESP Position:	Cafeteria
Name:	Dalton Dawdy	Certified Degree:	Choose an item.	Hourly/Daily Rate of Pay:	\$13.00
Location:	Elementary School	Step:	Choose an item.	Additional Hours:	Click or tap here to enter text.
Salary Schedule Placement	Choose an item.	Placement:	Click or tap here to enter text.	Annual Rate of Pay:	Click or tap here to enter text.
Extra-curricular assignment:	Click or tap here to enter text.	Placement:	Click or tap here to enter text.	Salary:	Click or tap here to enter text.
Extra-curricular assignment:	Click or tap here to enter text.	Placement:	Click or tap here to enter text.	Salary:	Click or tap here to enter text.
Extra-curricular assignment:	Click or tap here to enter text.	Placement:	Click or tap here to enter text.	Salary:	Click or tap here to enter text.
Incumbent Name:		Desired Beginning Date:	2/13/2023		
Position Supervisor:	Heather Pidcock				
Action Requested by:	Heather Pidcock	Date:	2/10/2023		

(Placement – indicate the location of the employee on the extra-curricular salary schedule: i.e. 3yrs=col. 2; salary from Appendix C)

APPOINTMENT AUTHORIZATION SIGNATURES

Chief Financial Officer:		Superintendent:	
President:		Secretary	

Routing: Original to Chief Financial Officer – Attach resume/application/transcripts/certificates