



SAINT PETER SCHOOL BOARD
Regular Board Meeting
Monday, March 20, 2023
SPCC-Governor's Room, 600 S. 5th St., Saint Peter,
MN 56082
6:30 PM

I. Call Meeting to Order	
II. Pledge of Allegiance	
III. Consideration and Adoption of the Agenda	
IV. Consider Requests to Speak on the Agenda	
V. Approval of Consent Agenda Items	3
VI. Student Spotlight -Charlie Hagen and Maya Knutson, SPMS	
1. Student Council Report	
VII. Action Items	
1. Consider FY24 Budget Adjustments	22
2. Consider Approval of Second Reading of Revisions to the Policy Manual	42
VIII. Information Items	
1. Native American Advisory Committee Update	55
2. Facilities Update	58
IX. Reports	
1. Building Principals	
2. Superintendent of Schools	
3. Board Members	
a. Around the Table	
X. Upcoming Meetings of the School Board Business Committee	
Tuesday, March 21, 2023	
5:00 PM	
DO	
XI. Policy Committee	
Wednesday, March 29, 2023	
4:00 PM	
DO	
XII. HR Committee	
Thursday, March 30, 2023	
7:30 AM	
DO	
XIII. Education Committee	
Tuesday, April 11, 2023	
1:00 PM	
DO	

XIV. Business Committee
Wednesday, April 12, 2023
4:00 PM

DO

XV. Regular Board Meeting
Monday, April 17, 2023
6:30 PM

SPCC-Governor's Room

XVI. **Adjournment**



ADDENDUM

REGULAR BOARD MEETING March 20, 2023 SPCC-Governor's Room 6:30PM

V. CONSENT AGENDA

1. Approval of the Regular Board Meeting minutes of February 23, 2023.
2. Approval of the Study Session minutes of March 13, 2023.
3. Approval of Bills (\$1,763,011.10) and Wire Transfers (\$3,189,077.14) for February 2023.
4. Contracts
 - a. The approval of a contract with Diamond Tower Service to perform the annual maintenance and inspections on the district's cell tower.
5. Personnel
 - a. The acceptance of the retirement of a teacher (Carri Borchert) at South Elementary effective June 2, 2023.
 - b. The approval of the hiring of a paraprofessional (Hailie Wentworth) at Oshawa Learning Academy effective March 1, 2023.
 - c. The approval of the hiring of a full-time, long-term 7th/8th grade Special Education Substitute (Ashley Wills) at Saint Peter Middle School from February 24, 2023 through April 17, 2023.
 - d. The acceptance of the resignation of a 5th/6th grade science teacher (Jason Toupen) at Saint Peter Middle School at the end of the 2022-2023 school year.
 - e. The acceptance of the resignation of an Early Childhood and Targeted Services Program Assistant (Gina Evenson) effective February 28, 2023.
 - f. The approval of a FMLA request for a special education teacher (Hannah Struckman) at South Elementary from May 15, 2023 through September 29, 2023.

g. The acceptance of the resignation of a paraprofessional (Amber Roberts) at South Elementary effective March 9, 2023.

h. The approval of coaches for the spring 2023 season.

THE MINUTES OF THE MEETING HAVE NOT BEEN APPROVED

Minutes of Regular Board Meeting

The School Board

Saint Peter Public Schools

Members Present: Drew Dixon, Tim Lokensgard, Ben Leonard, Kate Martens, Charlie Potts, Tracy Stuewe & Bill Kautt

Principals: Annette Engeldinger, Jon Graff, Darin Doherty, Doreen Oelke, Ytive Prafke & Jana Sykora

Administrative Team members: Tim Regner

Others present: Superintendent Bill Gronseth, Administrative Assistant Sarah Janovsky and members of the public

5

A Regular Board Meeting of the School Board of Saint Peter Public Schools was held Thursday, February 23, 2023, beginning at 6:30 PM in the SPCC-Governor's Room.

I. Call Meeting to Order-6:30 PM, Potts

II. Pledge of Allegiance

III. Consideration and Adoption of the Agenda (Stuewe/Lokensgard, unanimous)

IV. Consider Requests to Speak on the Agenda

V. Approval of Consent Agenda Items (Lokensgard/Martens, unanimous)

1. Approval of the Regular Board Meeting minutes of January 19, 2023.
2. Approval of the Study Session minutes of February 6, 2023.
3. Approval of Bills (\$1,872,375.62) and Wire Transfers (\$5,644,247.26) for January 2023.
4. Gifts and Donations
 - a. The approval of a grant for \$11,580 from the St. Peter Good Neighbor Diversity Council. Funds from this grant will provide Chromebooks and hotspots for adult learners, bilingual picture dictionaries and remove transportation barriers for those who want to attend classes at the Community Center.
 - b. The approval of a donation from Ben and Amy Leonard for \$5,207.44. The intention of this donation is to help purchase additional equipment for the high school performing arts center.
5. Personnel
 - a. The approval of a Saints Overtime Assistant (Makaila Weingart) with Saint Peter Community & Family Education. This is a replacement position.

- b. The acceptance of the resignation of a paraprofessional (Brad Boyer) at Oshawa learning Academy effective January 26, 2023.
- c. The acceptance of the resignation of a paraprofessional (Jennifer Humphrey) at Saint Peter Early Childhood effective January 26, 2023.
- d. The approval of the hiring of a Saints Overtime Assistant (Amanda Hukee) with Saint Peter Community & Family Education. This is a replacement position.
- e. The approval of the hiring of a long-term substitute (Sarah Chambers) to cover a maternity leave at South Elementary from January 10, 2023 until March 30, 2023
- f. The approval of the hiring of a paraprofessional (Wallace Michels) at Saint Peter Middle School beginning February 2, 2023.
- g. The approval of the hiring of a part-time housekeeper (Isaiah Chambers) at Saint Peter High School beginning February 1, 2023.
- h. The approval of the hiring of a School Readiness Paraprofessional (Bridgette Haugdahl) at Saint Peter Early Childhood beginning February 13, 2023.
- i. The creation of a new position of Food Service Assistant who will report to the Food Service Director.
- j. The creation of a new position of Native American Student Support Liaison who will report to the Coordinator of the Office of Education.
- k. The reassignment of an Unassigned Inside Maintenance Worker (Nathan Hughes) to Head Custodian at South Elementary effective February 16, 2023.
- l. The approval of the hiring of substitute teachers and paraprofessionals for District 508.

6

VI. Student Spotlight-Azrii Alas, North Elementary

Azrii is a 4th grader at North Elementary in Mr. Noble’s class. Azrii enjoys reading and would like to be an actress. She is proud of her writing and spelling abilities. This year, Azrii would like to emcee the North Spelling Bee, she practiced her skills by quizzing the school board on the 5 more misspelled English words.

VII. Action Items

1. Budget Process Continuation to Identify Adjustments for a Balanced FY 24 Budget (Kautt/Lokensgard, unanimous)
Business Manager, Tim Regner, gave a brief, high-level overview of the FY 24 budget as best as is possible to predict at this point. These figures were discussed at the February Study Session and more questions and discussions were had at tonight’s meeting.
2. Consider Policies with MSBA Revisions or Annual Review Requirements for Approval with a Single Reading (Leonard/Martens, unanimous)

VIII. Information Items

1. Social Emotional Learning Curriculum Pilot
Mrs. Sykora has been working with district staff on social emotional curriculum that is aligned K-12 as a result of recent strategic planning. Character Strong is the

program that was recommended to bring forward. Counselors and Social Workers currently have access to this, teachers will soon. Admn. will be collecting feedback from staff on this curriculum.

2. First Reading of Revision to the Policy Manual

Two policies were reviewed and will be brought forward for a second reading in the future.

IX. Reports

1. Building Principal

Early Childhood

- Fall '23 planning has begun
- Online registration is available
- Spring conferences will be in March

South

- The 100th day of school was celebrated on Valentine's Day
- Another round of assessments has been completed
- Staff had a PD day last week, each site planned their own programs
- K-8 conferences have been rescheduled to Tuesday, February 28th
- March 9th will be the Kindergarten Open House

North

- The Kindness Retreat would have been today, that will be reschedule to April 6th
- March 16th-Arts & Academics Night at North
- I Love to Read month is happening
- Staff PD Day was a success at North
- 3rd & 4th Grade Kindness Crew (new this year) are doing great things for the students at North

SPMS

- History Day-16 projects
- Last Thursday SPMS had a "Parent Event" focused on adolescence
- Upcoming events:
All City Concert on the 27th, Lion King Jr. program, 7th & 8th grade band concerts

SPHS

- FFA week in 2 weeks
- Mock Trial is going to State
- Ian Gerstbauer is the Lions Club Student of the Month
- Discussions are happening at SPHS on which the 1-on-1 device is best for students

2. Superintendent of Schools

- Weather: We have now had 2 Snow Days and 3 Flex Learning Days, the State allows us up to 5 Flex Learning Days
- Mental Health will remain to be a focus
- Visited SPHS and was encouraged to see students engaged and learning skills they can use in their futures.

3. Board Members

Tracy Stuewe-Thanks the City for snow removal, SPHS elective credits

a. Around the Table

X. Upcoming Meetings of the School Board

Education Committee
Tuesday, March 7, 2023
1:00 PM
DO

Business Committee Meeting
Wednesday, March 8, 2023
4:00 PM
DO

Study Session
Monday, March 13, 2023
6:30 PM
SPMS-Media Center

Regular Board Meeting
Monday, March 20, 2023
6:30 PM
SPCC-Governor's Room

8

XI. Adjournment-8:04 PM (Leonard/Dixon, unanimous)

Dated: March 20, 2023

Kate Martens, Board Clerk

THE MINUTES OF THE MEETING HAVE NOT BEEN APPROVED

Minutes of Study Session

The School Board

Saint Peter Public Schools

Members Present: Drew Dixon, Tim Lokensgard, Ben Leonard, Charlie Potts, Tracy Stuewe & Bill Kautt

Members Absent: Kate Martens

Principals: Annette Engeldinger, Jon Graff, Darin Doherty, Ytive Prafke & Jana Sykora

Administrative Team members: Tim Regner, Sharon Petersen

Others present: Superintendent Bill Gronseth, Administrative Assistant Sarah Janovsky

A Study Session of the School Board of Saint Peter Public Schools was held Monday, March 13, 2023, beginning at 6:30 PM in the Saint Peter Middle School-Media Center.

9

I. Call Meeting to Order-6:30 PM, Potts

II. Adoption of the Agenda-(Dixon/Lokesngard, unanimous)

III. Budget Planning

Superintendent Gronseth and the administrative team recommended FY24 budget adjustments due to lower enrollment, Covid funding discontinuation, and inflation and underfunding over time.

IV. Upcoming Meetings of the School Board

Regular Board Meeting
Monday, March 20, 2023
6:30 PM
SPCC-Governor's Room

V. Adjournment-7:40 PM (Leonard/Stuewe, unanimous)

Dated: March 20, 2023

Kate Martens, Board Clerk

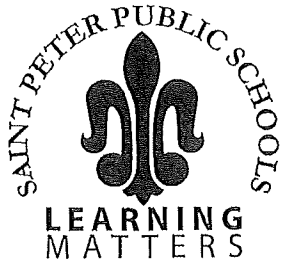

DISTRICT OFFICE
100 Lincoln Drive, Suite 229
Saint Peter, MN 56082-1351
507-934-5703 (Office)
507-934-2805 (Fax)
www.stpeterschools.org

Date: 3/10/2023

To: Dr. Bill Gronseth - Superintendent

From: Bee Ong - Finance Accountant

Re: **Monthly Board Bills, Payroll &
Student Activity Amounts:**

10

February 2023 - Board Bills	\$642,645.99
February 2023 - Payroll Account	\$1,103,388.20
February 2023 - Student Activity	\$16,976.91
	<hr/> <hr/>
	\$1,763,011.10

St. Peter Public Schools
Wire Transfer Report

Feb-23

MSDLAF to USBank

(Feb/Aug bond pymt)

MSDLAF to FNB payroll account ACH	2/15/2023	525,000.00
MSDLAF to FNB payroll account ACH	2/28/2023	560,000.00
MSDLAF-Max to FNB BO	2/1/2023	505,000.00
MSDLAF-Max to FNB BO	2/14/2023	405,000.00
MSDLAF-LA to CCF	2/15/2023	200,000.00
FNB-BO to BCBS - medicare health	2/21/23	14,584.50
Wire of federal payroll taxes	2/15/2023	169,442.55
Wire of federal payroll taxes	2/28/2023	176,068.42
Wire of state payroll taxes	2/1/2023	643.00
Wire of state payroll taxes	2/1/2023	28,699.32
Wire of state payroll taxes	2/10/2023	28,361.15
PERA payments	2/7/2023	26,348.68
PERA payments	2/21/2023	26,335.56
PERA payments	2/28/2023	26,181.52
TRA payments	2/7/2023	90,024.69
TRA payments	2/21/2023	89,493.48
Horace Mann	2/6/2023	2,359.00
Ameriprise/NBSGroup Bill	2/13/2023	1,600.00
Medsurety	February	9,938.92
Colonial Life	2/13/2023	487.09
Colonial Life	2/13/2023	6,795.38
Pioneer - Dental direct debits	2/6/2023	2,851.59
Pioneer - Dental direct debits	2/13/2023	244.00
Pioneer - Dental direct debits	2/13/2023	3,007.41
Pioneer - Dental direct debits	2/21/2023	2,970.15
Pioneer - Dental direct debits	2/22/2023	1,633.50
Pioneer - Dental direct debits	2/27/2023	4,898.34
CCF - BCBS debits	2/2/2023	124,619.68
CCF - BCBS debits	2/9/2023	57,314.20
CCF - BCBS debits	2/16/2023	32,276.91
CCF - BCBS debits	2/23/2023	66,858.15
Electronic Deposit Fees - Merch Billing	2/7/2023	39.95
	Total Wires	3,189,077.14



TO: Saint Peter School Board
FROM: Sharon Petersen
DATE: March 8, 2023
RE: Tower Maintenance Contract

I would like to recommend that we use Diamond Tower Service to perform the annual maintenance and inspections on our tower.

Tower Inspection and Maintenance

SPECIFICATIONS:

- Contract term to be effective March 1, 2023-December 31, 2024
School reserves the right to reject any or all quotations.
- School reserves the right to cancel agreement with contractor at any time.
- Hourly rate of of any work required
- Annual maintenance and inspection cost
- Any other costs or expenses associated such as travel that would be billed to the St Peter School District
Contractor must be licensed and bonded and be insured to do the work
- Contractor must follow all laws and regulations and the rules of the FCC and TIA-222-G.
- Contractor must include an example of an annual tower inspection report with your quote.

13

ANNUAL MAINTENANCE COST \$ 3,000.00

HOURLY RATE \$ 125.00 per hour

OTHER EXPENSES \$ Unknown

CONTRACTOR LICENSE NUMBER JR768856

Kelly Kuderling CEO/Owner
CONTRACTOR SIGNATURE AND TITLE

Diamond Tower Service, Inc.
COMPANY NAME

3316 5th St South
MAILING ADDRESS

Waite Park, MN 56387
CITY, STATE ZIP

Kelly_Kuderling@msn.com
EMAIL ADDRESS

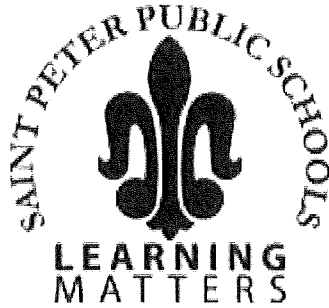

MEMO TO: Bill Gronseth
District 508 School Board

FROM: Doreen Oelke, South Elementary
Principal

DATE: February 27, 2023

SUBJECT: Borchert Teacher Retirement

I would like to recommend that you accept the resignation of Carri Borchert as a first grade teacher at South Elementary. This resignation will be effective at the conclusion of the 2022-2023 school year (June 2, 2023).

14

Mrs. Borchert has been a high impact instructor within our district for the past 33 years. Her dedication and expertise will be greatly missed and her influence will always be felt by the students she taught and the staff she worked with. Please join me in wishing her the best in her retirement.

CC: grp_hire_certified
Carri Borchert

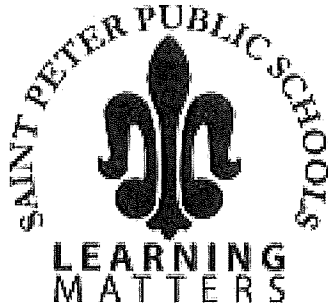

MEMO TO: Bill Gronseth, Superintendent
School Board

FROM: Jana Sykora

DATE: February 28, 2023

SUBJECT: Para Hire

Applications were received and interviews took place for a special education paraprofessional position. This is a replacement position.

I am pleased to recommend Hailie Wentworth for the position. Hailie has worked as a substitute paraprofessional at Oshawa Learning Academy several times and has been a good fit for the program.

15

EMPLOYEE SUMMARY

- **Hailie Wentworth**
 - 6.5 hours per student contact day
 - Step 1/A at a rate of \$15.25/hour
 - Start date: March 1, 2023

CC: Hailie Wentworth
grp_hire_para

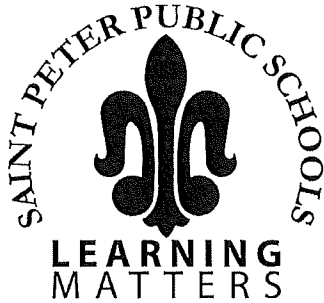

TO: Members of the School Board
Mr. Bill Gronseth

FROM: Jon Graff

DATE: February 28, 2023

RE: Personnel Recommendation
Long-term 7th/8th Grade Special
Education Substitute Teacher

16

I am happy to recommend the hiring of Ashley Wills for the position of full-time, long-term 7th/8th grade Special Education Substitute. The position is available due to planned maternity leave of Annemarie Clemenson. The position began on February 24 , 2023 and planned to extend through April 17, 2023

Per Article 34, Section 5 of the Teacher Master Agreement, “Teachers who substitute for the same classroom teacher for a period of thirty (30) consecutive days or longer shall be placed on the salary schedule retroactively at the beginning step of the appropriate lane.”

EMPLOYEE SUMMARY

- **Ashley Wills**
 - 1.0 FTE
 - Step 1/BA
 - Daily Rate: \$243.66
 - Start Date: February 24, 2022

cc: Ashley Wills
Grp_hire_certified

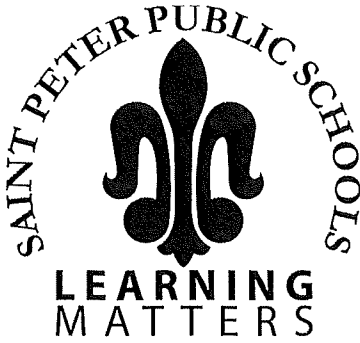

MEMO TO: Bill Gronseth, Superintendent
Saint Peter School Board

FROM: Jon Graff, Principal, SPMS

DATE: February 28, 2023

SUBJECT: Teacher Resignation Memo

Please accept the resignation of Jason Touvence in his role as 5th/6th grade science teacher at SPMS, effective at the end of the 2022-2023 school year.

We thank Jason for all that he has done for the students, staff, and community of Saint Peter. We wish him the best of luck as he begins the next phase of his career in school administration.

17

Please let me know if you have any questions.

Cc: Jason Touvence
grp_hire_certified



MEMO TO: Bill Gronseth, Superintendent
Saint Peter School Board

FROM: Ytve Prafke-Special Programs
Administrator/Early Childhood

DATE: March 6, 2023

SUBJECT: Early Childhood/Targeted Services
Program Assistant Resignation

I am writing to recommend that you accept the resignation of Gina Evenson, Early Childhood and Targeted Services Program Assistant effective February 28, 2023.

18

Gina's 22 years of work in the district as both a paraprofessional and program assistant has been invaluable and we wish her all the best.

Please let me know if you have any questions.

Cc: Gina Evenson



MEMO TO: Bill Gronseth, Superintendent
Saint Peter School Board

FROM: Doreen Oelke, Principal

DATE: March 7, 2023

SUBJECT: Struckman FMLA Request

I recommend that you accept the FMLA request of Hannah Struckman, special education teacher at South Elementary. Ms.Struckman's due date is May 15, 2023. Her intermittent FMLA leave will begin on the day her child is born and will extend through September 29, 2023. She will return full time to her teaching position on October 2, 2023.

19

Her written request, along with the FMLA paperwork, has been submitted to the district office. Please feel free to contact me with any questions.

Cc: Hannah Struckman
Grp_hire_certified

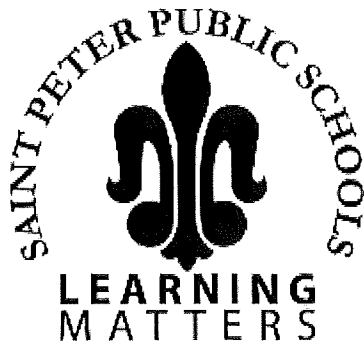

**MEMO TO: Bill Gronseth, Superintendent
Saint Peter School Board**

FROM: Doreen Oelke, Principal

DATE: March 10, 2023

**SUBJECT: Roberts - South SpEd Para
Resignation**

I am writing to recommend that you accept the resignation of Amber Robers as a SPED paraprofessional at South Elementary. Her last day of work was Thursday, March 9, 2023.

20

I would like to thank Ms. Roberts for her service and wish her the best.

Please let me know if you have any questions.

Cc:

Para Hire Group

2023 Spring Coaches				
Kris	Voeltz	Spring	Co-Head Coach	Adapted Bowling
Keith	Bense	Spring	Co-Head Coach	Adapted Bowling Coop w/LSH
Liz	Leibfried	Spring	Assistant	Adapted Bowling
Sue	Hagenmiller	Spring	Assistant	Adapted Bowling
Grace	Pehrson	Spring	Assistant	Adapted Bowling
Angela	Krueger	Spring	Assistant	Adapted Bowling
Lisa	Battcher	Spring	Assistant	Adapted Bowling
Kurt	Moelter	Spring	Head Coach	Baseball
Justin	Helget	Spring	Assistant Varsity Coach	Baseball
Dalton	Thelen	Spring	B Squad Coach	Baseball
Ryan	Timmerman	Spring	C Squad Coach	Baseball
Wyatt	Olson	Spring	MS Coach 8th	Baseball
Ethan	Volk	Spring	MS Coach 8th	Baseball
Ryan	Myhra	Spring	MS Coach 7th	Baseball
Kent	Bass	Spring	MS Coach 7th	Baseball
Aaron	Rothenberger	Spring	Head Coach	Boys Tennis
Bob	Messerli	Spring	Asst. Coach	Boys Tennis
Keith	Hanson	Spring	Head Coach	Boys Track
Jeff	Portugue	Spring	Head Coach	Girls Track
Bill	Stuewe	Spring	Asst. Coach	Boys Track
Marc	Bachman	Spring	Asst. Coach	Boys Track
George	Schoenborn	Spring	Asst. Coach	Girls Track
Bill	Braunger	Spring	Asst. Coach	Boys Track
Corey	Wiebusch	Spring	Volunteer	Boys/Girls Track
Brock	Hanson	Spring	MS Coach	MS Track
William	Bennet	Spring	MS Coach	MS Track
Melic	Thomas	Spring	MS Coach	MS Track
Neil	Doose	Spring	Head Boys' Coach	Golf
Pat	Klubben	Spring	Head Girls' Coach	Golf
Nancy	Hansen	Spring	Assistant Girls Coach	Golf
Kris	Voeltz	Spring	Assistant Boys Coach	Golf
Heidi	Niemeyer	Spring	Head Coach	Softball
Dani	Roehrkasse	Spring	Varsity Assistant	Softball
Jodi	Nixon	Spring	B Squad Coach	Softball
Kenna	West	Spring	C Squad Coach	Softball
		Spring	8th MS Coach	Softball
		Spring	7th MS Coach	Softball
Doug	Boyer	Spring	Strength Coach / Weight Rm Sup	
Robbie	Deering	Spring	Co-Director	Spring Play
Jennifer	Maldonado	Spring	Co-Director	Spring Play
Scott	Robinson	Spring	Tech Director	Spring Play



ADDENDUM

REGULAR BOARD MEETING March 20, 2023 SPCC-Governor's Room 6:30PM

VII. ACTION ITEMS

1. AGENDA ITEM #1

Subject: Consider FY24 Budget Adjustments

Action: Requires a Motion

Background: Over the past few months the school district has been in the process of planning for the FY24 budget. After completing projected enrollments, revenues, and expenditures, it has been determined that the district has a deficit of approximately \$1.5M for the coming year. Reductions are being recommended to balance the budget. The process for determining these recommendations have included administration, SPEA leadership, and school board committees. Throughout the process we have held our students and strategic plan as the focus of our work.

Presentation: Superintendent Gronseth, Administrative team

Options/Recommendation: I recommend approving the recommended reductions for the FY24 budget.



Recommendations for a Balanced FY24 Budget

23

Administrative Team
March 20, 2023

Why Do We Have a Deficit?

There are three main reasons we have a deficit:

1. Lower Enrollment
2. Covid funding has been discontinued
3. Inflation, and underfunding over time

Will the Results of the Legislative Session Help?

Yes, and assumptions have been built into the budget projection using the Governor's Budget as a guide.

There may be additional funds, but there may also be additional mandates. We will not know the results until after the legislative session ends which is scheduled for May 22.

Can't We Use the Fund Reserves to Cover the Deficit??

Using one time funds to address a deficit only delays and compounds reductions.

The district has a goal of having enough funds in reserve to operate the district for 60 days. This is important for the financial stability of the district. This is currently our approximate reserve amount.

How Were Reductions Identified?

- The administrative team worked together to review all areas of the budget.
- An enrollment study was conducted to provide updated information regarding future enrollment numbers.
- The Saint Peter Education Association was consulted for input and feedback.
- Meetings were held with School Board Committees.

Will There Be Staff Reductions?

Yes. Nearly 80% of the budget is dedicated to staff. The other 20% is for expenses such as utilities, gas, materials, and other items. While we can find some efficiencies, staff reductions will be unavoidable.

Recommended Adjustments

Department	Description	Reduction Estimate
District Office/District-wide	Elimination of positions: Community Outreach Coordinator (1) SRO (1) Facilities Use Coordinator (1) Instructional Coaches (2) MSU Fellowship/TOSA (1+) Extended Contracts for summer Transition to cell phone stipends	\$340,000
	Transportation: One Tier Route	\$105,000
	Technology: Software reductions	\$12,500
	Maintenance: Restructuring positions	\$10,000

Recommended Adjustments

Department	Description	Reduction Estimate
South Elementary	1 section 1st Grade 1 Office Support/Nurse	\$1,100,000
North Elementary	1 section 3rd Grade .5 Interventionist	
Middle School	Elimination of MS block schedule/reduction to 5 sections (8.33 FTE Teachers)	
High School	Reduction of 2.0 FTE Teachers	
Increase revenues	Activity fees, early childhood grants/donations	\$10,000

Total Estimated Adjustment

Department	Reduction Estimate
District Office/District-wide	\$340,000
Transportation	\$105,000
Technology	\$12,500
Maintenance	\$10,000
South Elementary	\$1,100,000
North Elementary	
Middle School	
High School	
Total Reductions	\$1,567,500
Increase revenues	\$10,000
Total Adjustments	\$1,577,500

Middle School Program Change Recommendations

In 2019, programmatic changes were made at the middle school level. This involved significant budget increases that are no longer sustainable.

Middle School Programming:

1. Teams
2. Advisory
3. Core Classes
4. Exploratory Classes

Student Numbers = Reduced Sections

Grade	Class Size w/6 Sections	Class Size w/5 sections
5	22	26
6	26	31.6
7	25	30
8	24	29

Current Schedule = 6 Sections

Student Schedule 75 minute Blocks (20 min Advisory + 45 minute Saints Time)

Advisory	Block 1	Block 2	Block 3	Block 4	Saints
Advisory	Core	Core	Elective/PE	Exploratory	Saints Time

Teacher Schedule

Advisory	Block 1	Block 2	Block 3	Block 4	Saints
Advisory	Class 7th ----- Class 8th	Class 7th ----- Class 8th	Class 7th ----- Class 8th	Prep	Saints Time
Advisory	Class 7th ----- Class 8th	Class 7th ----- Class 8th	Class 7th ----- Class 8th	Prep	Saints Time

5 Sections and the Block

Teacher Schedule Example:

	Block 1	Block 2	Block 3	Block 4	
Advisory	Class 7th ----- Class 8th	Class 7th ----- Class 8th	Class 7th ----- Class 8th	Prep	Saints Time
Advisory	Class 7th ----- Class 8th	Class 7th ----- Class 8th	?	Prep	Saints Time

Inefficiencies of the Block for Year Long Courses

Block 1	Block 2	Block 3	Block 4
Math 5	Math 5	Math 5	Prep
Math 5	Math 5	Math 5	Prep

Block 1	Block 2	Block 3	Block 4
PE 7/PE 8	PE 7/PE 8	PE 7/PE 8	Prep
PE 7/PE 8	PE 7/PE 8	PE 7/PE 8	Prep

Reductions

1. 1 section per grade level
2. Eliminate the block

6 Period Plus (53-ish minute periods)

Period 1	Period 2	Period 3	Period 4	Period 5	Period 6	(Plus)
Math	ELA	S.S.	Science	Exploratory Explore 1 ----- Explore 2 ----- Explore 3	PE/ Explore 4	Saints Time/ Advisory

Schedule Comparison

Student Schedule 75 minute Blocks + 20 min Advisory + 45 minute Saints Time

Advisory	Block 1	Block 2	Block 3	Block 4	Saints
Advisory	Math ----- S.S.	Sci ----- ELA	Elective/PE	Explore	Saints Time

Student Schedule 53 minute Periods + 45 minute and/or 20 minute Advisory

Period 1	Period 2	Period 3	Period 4	Period 5	Period 6	(Plus)
Math	ELA	S.S.	Science	Exploratory Explore 1 ----- Explore 2 ----- Explore 3	PE/ Explore 4	Saints Time/ Advisory



Recommendations for a Balanced FY24 Budget

41

Administrative Team
March 20, 2023



ADDENDUM

REGULAR BOARD MEETING March 20, 2023 SPCC-Governor's Room 6:30PM

VII. ACTION ITEMS

2. AGENDA ITEM #2

Subject: Consider Approval of Second Reading of Revisions to the Policy Manual

Action: Requires a Motion

Background: The following policies were reviewed by the Policy Committee and brought forward for a second reading:

613 Graduation Requirements
620 Credit for Learning

Presentation: Superintendent of Schools
Policy Committee

Options/Recommendation: I recommend approving these changes.

613 GRADUATION REQUIREMENTS

[Note: The requirements set forth in this policy govern the graduation standards that Minnesota public schools must require for a high school diploma for all students.]

I. PURPOSE

The purpose of this policy is to set forth requirements for graduation from the school district.

II. GENERAL STATEMENT OF POLICY

The policy of the school district is that all students must demonstrate, as determined by the school district, their satisfactory completion of the credit requirements and their understanding of academic standards. The school district must adopt graduation requirements that meet or exceed state graduation requirements established in law or rule.

III. DEFINITIONS

- A. "Academic standard" means: (1) a statewide adopted expectation for student learning in the content areas of language arts, mathematics, science, social studies, physical education, or the arts, or (2) a locally adopted expectation for student learning in health, the arts, career and technical education, or world languages.
- B. "Credit" means a student's successful completion of an academic year of study or a student's mastery of the applicable subject matter, as determined by the school district.
- C. "Section 504 Accommodation" means the defined appropriate accommodations or modifications that must be made in the school environment to address the needs of an individual student with disabilities.
- D. "Individualized Education Program" or "IEP" means a written statement developed for a student eligible by law for special education and services.
- E. "English language learners" or "ELL" student means an individual whose first language is not English and whose test performance may be negatively impacted by lack of English language proficiency.

IV. DISTRICT ASSESSMENT COORDINATOR

Darin Doherty shall be named the District Assessment Coordinator. Said person shall be in charge of all test procedures and shall bring recommendations to the school board annually for approval.

V. GRADUATION ASSESSMENT REQUIREMENTS

Students' state graduation requirements, based on a longitudinal, systematic approach to student education and career planning, assessment, instructional support, and evaluation, include the following:

- A. Achievement and career and college readiness in mathematics, reading, and writing, as measured against a continuum of empirically derived, clearly defined benchmarks focused on students' attainment of knowledge and skills so that students, their parents, and teachers know how well students must perform to have a reasonable chance to succeed in a career or college without the need for postsecondary remediation and which facilitates the monitoring of students' continuous development of and growth in requisite knowledge and skills; analysis of students' progress and performance levels, identification of students' academic strengths and diagnosis of areas where students require curriculum or instructional adjustments, targeted interventions, or remediation; and determination of students' learning and instructional needs and the instructional tools and best practices that support academic rigor for the student based on analysis of students' progress and performance data; and
- B. Consistent with this paragraph and Minn. Stat. § 120B.125 (*see Policy 604, Section II.H.*), age-appropriate exploration and planning activities and career assessments to encourage students to identify personally relevant career interests and aptitudes and help students and their families develop a regularly reexamined transition plan for postsecondary education or employment without need for postsecondary remediation.
- C. Based on appropriate state guidelines, students with an IEP may satisfy state graduation requirements by achieving an individual score on the state-identified alternative assessments.
- D. Students meeting the state graduation requirements under this section must receive targeted, relevant, academically rigorous, and resourced instruction which may include a targeted instruction and intervention plan focused on improving the student's knowledge and skills in core subjects so that the student has a reasonable chance to succeed in a career or college without need for postsecondary remediation.
- E. Students meeting the state graduation requirements under this section and who are students in grade 11 or 12 and who are identified as academically ready for a career or college are actively encouraged by the school district to participate in courses and programs awarding college credit to high school students. Students are not required to achieve a specified score or level of proficiency on an assessment to graduate from high school.
- F. A student's progress toward career and college readiness must be recorded on the student's high school transcript.

VI. GRADUATION CREDIT REQUIREMENTS

Students must successfully complete, as determined by the school district, the following high school level credits for graduation:

- A. Four ~~and a half~~ credits of language arts sufficient to satisfy all academic standards in English language arts;
- B. Four credits of mathematics, including an algebra II credit or its equivalent, sufficient to satisfy all of the academic standards in mathematics;
- C. An algebra I credit by the end of 8th grade sufficient to satisfy all of the 8th grade standards in mathematics;
- D. Four credits of science, including at least: (a) one credit of biology; (b) one credit of chemistry or physics; and (c) one elective credit of science. The combination of credits must be sufficient to satisfy (i) all of the academic standards in either chemistry or physics and (ii) all other academic standards in science;

- E. Three and one-half credits of social studies, encompassing at least United States history, geography, government and citizenship, world history, and economics sufficient to satisfy all of the academic standards in social studies;
- F. One credit in the arts sufficient to satisfy all of the state or local academic standards in the arts; ~~and~~
- G. ~~One and one-half credit of Physical Education sufficient to satisfy all of the state or local academic standards in Physical Education;~~
- H. ~~One-half credit of Health sufficient to satisfy all of the state or local academic standards in Health; and~~
- I. A minimum of ~~eight~~ ~~nine~~ elective credits.
- J. Credit equivalencies
 - 1. A one-half credit of economics taught in a school's agriculture education or business department may fulfill a one-half credit in social studies under Paragraph E., above, if the credit is sufficient to satisfy all of the academic standards in economics.
 - 2. An agriculture science or career and technical education credit may fulfill the elective science credit required under Paragraph D., above, if the credit meets the state physical science, life science, earth and space science, chemistry, or physics academic standards or a combination of these academic standards as approved by the school district. An agriculture or career and technical education credit may fulfill the credit in chemistry or physics required under Paragraph D., above, if the credit meets the state chemistry or physics academic standards as approved by the school district. A student must satisfy either all of the chemistry or physics academic standards prior to graduation. An agriculture science or career and technical education credit may not fulfill the required biology credit under Paragraph D., above.

VII. GRADUATION STANDARDS REQUIREMENTS

- A. All students must demonstrate their understanding of the following academic standards:
 - 1. School District Standards, Health (K-12);
 - 2. School District Standards, Career and Technical Education (K-12); and
 - 3. School District Standards, World Languages (K-12).
- B. Academic standards in health, world languages, and career and technical education will be reviewed on an annual basis.* A school district must use the current world languages standards developed by the American Council on the Teaching of Foreign Languages.

* Reviews are required to be conducted on a periodic basis. Therefore, this time period may be changed to accommodate individual school district needs.
- C. All students must satisfactorily complete the following required Graduation Standards in accordance with the standards developed by the Minnesota Department of Education (MDE):

1. Minnesota Academic Standards, English Language Arts K-12;
 2. Minnesota Academic Standards, Mathematics K-12;
 3. Minnesota Academic Standards, Science K-12;
 4. Minnesota Academic Standards, Social Studies K-12; and
 5. Minnesota Academic Standards, Physical Education K-12.
- D. State standards in the Arts K-12 are available, or school districts may choose to develop their own standards.
- E. The academic standards for language arts, mathematics, and science apply to all students except the very few students with extreme cognitive or physical impairments for whom an IEP team has determined that the required academic standards are inappropriate. An IEP team that makes this determination must establish alternative standards.

VIII. EARLY GRADUATION

Students may be considered for early graduation, as provided for within Minn. Stat. § 120B.07, upon meeting the following conditions:

- A. All course or standards and credit requirements must be met;
- B. The principal or designee shall conduct an interview with the student and parent or guardian, familiarize the parties with opportunities available in post-secondary education, and arrive at a timely decision; and
- C. The principal's decision shall be in writing and may be subject to review by the superintendent and school board.

Legal References: Minn. Stat. § 120B.02 (Educational Expectations for Minnesota's Students)
Minn. Stat. § 120B.018 (Definitions)
Minn. Stat. § 120B.021 (Required Academic Standards)
Minn. Stat. § 120B.023 (Benchmarks)
Minn. Stat. § 120B.024 (Graduation Requirements; Course Credits)
Minn. Stat. § 120B.07 (Early Graduation)
Minn. Stat. § 120B.11 (School District Process)
Minn. Stat. § 120B.125 (Planning for Students' Successful Transition to Postsecondary Education and Employment; Involuntary Career Tracking Prohibited)
Minn. Stat. § 120B.30 (Statewide Testing and Reporting System)
Minn. Rules Parts 3501.0640-3501.0655 (Academic Standards for Language Arts)
Minn. Rules Parts 3501.0700-3501.0745 (Academic Standards for Mathematics)
Minn. Rules Parts 3501.0800-3501.0815 (Academic Standards for the Arts)
Minn. Rules Parts 3501.0900-3501.0955 (Academic Standards in Science)
Minn. Rules Parts 3501.1300-3501.1345 (Academic Standards for Social Studies)
Minn. Rules Parts 3501.1400-3501.1410 (Academic Standards for Physical Education)
20 U.S.C. § 6301, *et seq.* (Every Student Succeeds Act)

Cross References: Policy 104 (School District Mission Statement)
Policy 601 (School District Curriculum and Instruction Goals)
Policy 614 (School District Testing Plan and Procedure)
Policy 615 (Testing Accommodations, Modifications, and Exemptions for IEPs,
Section 504 Plans, and LEP Students)
Policy 616 (School District System Accountability)

Adopted: _____

MSBA/MASA Model Policy 620

Orig. 1998

Revised: _____

Rev. 2022

620 CREDIT FOR LEARNING

~~*[Note: School districts statutorily are required to provide students with credit for approved post-secondary courses, as set forth in Section V.; online learning courses, as set forth in Section VI.; and accelerated or advanced academic courses offered by a higher education institution or nonprofit public agency, as set forth in Section VII. Additionally, school districts are required by statute to identify whether the school district offers weighted grades and, if it does, identify the courses for which a student may earn a weighted grade (Section VIII). Optional provisions related to awarding credit to students transferring from out-of-state, private, or home schools and the issuance of student grades for purposes of awarding certain honors, as set forth in Section IV., are not required by statute. Therefore, the language contained in Section IV. is suggested language, and a school district may or may not include this section or may modify this section at its discretion.]*~~

I. PURPOSE

The purpose of this policy is to recognize student achievement which occurs in Post-Secondary Enrollment Options and other advanced enrichment programs. The purpose of this policy also is to recognize student achievement which occurs in other schools, in alternative learning sites, and in out-of-school experiences such as community organizations, work-based learning, and other educational activities and opportunities. The purpose of this policy also is to address the transfer of student credit from out-of-state, private, or home schools and online learning programs and to address how the school district will recognize student achievement obtained outside of the school district.

II. GENERAL STATEMENT OF POLICY

The policy of the school district is to provide a process for awarding students credit toward graduation requirements for credits and grades students complete in other schools, post-secondary or higher education institutions, other learning environments, and online courses and programs.

III. DEFINITIONS

- A. "Accredited school" means a school that is accredited by an accrediting agency, recognized according to Minnesota Statutes section 123B.445 or recognized by the Commissioner of the Minnesota Department of Education (Commissioner).
- B. "Blended learning" is a form of digital learning that occurs when a student learns part time in a supervised physical setting and part time through digital delivery of instruction, or a student learns in a supervised physical setting where technology is used as a primary method to deliver instruction.
- C. "Commissioner" means the Commissioner of MDE.
- D. "Digital learning" is learning facilitated by technology that offers students an element of control over the time, place, path, or pace of their learning and includes blended and online learning.
- E. "Eligible institution" means a Minnesota public post-secondary institution, a private, nonprofit two-year trade and technical school granting associate degrees, an

opportunities industrialization center accredited by an accreditor recognized by the United States Department of Education, or a private, residential, two-year or four-year, liberal arts, degree-granting college or university located in Minnesota.

- F. "Nonpublic school" is a private school or home school in which a child is provided instruction in compliance with the Minnesota compulsory attendance laws.
- G. "Online learning" is a form of digital learning delivered by an approved online learning provider.
- H. "Online learning provider" is a school district, an intermediate school district, an organization of two or more school districts operating under a joint powers agreement, or a charter school located in Minnesota that provides online learning to students and is approved by MDE to provide online learning courses.
- I. "Weighted grade" is a letter or numerical grade that is assigned a numerical advantage when calculating the grade point average.

IV. TRANSFER OF CREDIT FROM OTHER SCHOOLS

A. Transfer of Academic Requirements from Other Minnesota Public Secondary Schools

- 1. The school district will accept and transfer secondary credits and grades awarded to a student from another Minnesota public secondary school upon presentation of a certified transcript from the transferring public secondary school evidencing the course taken and the grade and credit awarded.
- 2. Credits and grades awarded from another Minnesota public secondary school may be used to compute honor roll and/or class rank if a student has earned at least ~~[insert number]~~ three (3) credits from the school district.

B. Transfer of Academic Requirements from Other Schools

- 1. The school district will accept secondary credits and grades awarded to a student for courses successfully completed at a public school outside of Minnesota or an accredited nonpublic school upon presentation of a certified transcript from the transferring public school in another state or nonpublic school evidencing the course taken and the grade and credit awarded.
 - a. When a determination is made that the content of the course aligns directly with school district graduation requirements, the student will be awarded commensurate credits and grades.
 - b. Commensurate credits and grades awarded from an accredited nonpublic school or public school in another state may be used to compute honor roll and/or class rank if a student has earned at least ~~[insert number]~~ three (3) credits from the school district.
 - c. In the event the content of a course taken at an accredited nonpublic school or public school in another state does not fully align with the content of the school district's high school graduation requirements but is comparable to elective credits offered by the school district for graduation, the student may be provided elective credit applied toward graduation requirements. Credit that does not fully align with the school district's high school graduation requirements will not be used to compute honor roll and/or class rank.
 - ~~d. If no comparable course is offered by the school district for which high school graduation credit would be provided, no credit will be provided to the student.~~

2. Students transferring from a non-accredited, nonpublic school shall receive credit from the school district upon presentation of a transcript or other documentation evidencing the course taken and grade and credit awarded.
 - a. Students will be required to provide copies of course descriptions, syllabi, or work samples for determination of appropriate credit. In addition, students also may be asked to provide interviews/conferences with the student and/or student's parent and/or former administrator or teacher; review of a record of the student's entire curriculum at the nonpublic school; and review of the student's complete record of academic achievement.
 - b. Where the school district determines that a course completed by a student at a non-accredited, nonpublic school is commensurate with school district graduation requirements, credit shall be awarded, but the grade shall be "P" (pass).
 - c. In the event the content of a course taken at an non-accredited, nonpublic school does not fully align with the content of the school district's high school graduation requirements but is comparable to elective credits offered by the school district for graduation, the student may be provided elective credit applied toward graduation requirements.
 - d. If no comparable course is offered by the school district for which local high school graduation credit would be provided, no credit will be provided to the student.
 - e. Credit and grades earned from a non-accredited nonpublic school shall not be used to compute honor roll and/or class rank.

V. POST-SECONDARY ENROLLMENT CREDIT

- A. A student who satisfactorily completes a post-secondary enrollment options course or program under Minnesota Statutes section 124D.09 that has been approved as meeting the necessary requirements is not required to complete other requirements of the Minnesota Academic Standards content standards corresponding to that specific rigorous course of study.
- B. Secondary credits granted to a student through a post-secondary enrollment options course or program that meets or exceeds a graduation standard or requirement shall be counted toward the graduation and credit requirements of a student completing the Minnesota Academic Standards.
 1. Course credit will be considered by the school district only upon presentation of a certified transcript from an eligible institution evidencing the course taken and the grade and credit awarded.
 2. Seven quarter or four semester post-secondary credits shall equal at least one full year of high school credit. Fewer post-secondary credits may be prorated.
 3. When a determination is made that the content of the post-secondary course aligns directly with a required course for high school graduation, the commensurate credit and grade will be recorded on the student's transcript as a course credit applied toward graduation requirements.
 4. In the event the content of the post-secondary course does not fully align with the content of a high school course required for graduation but is comparable

to elective credits offered by the school district for graduation, the school district may provide elective credit and the grade will be recorded on the student's transcript as an elective course credit applied toward graduation requirements.

5. If no comparable course is offered by the school district for which high school graduation credit would be provided, the school district will notify the Commissioner, who shall determine the number of credits that shall be granted to a student.
6. When secondary credit is granted for post-secondary credits taken by a student, the school district will record those credits on the student's transcript as credits earned at a post-secondary institution.

~~C. A list of the courses or programs meeting the necessary requirements may be obtained from the school district.~~

VI. CREDIT FROM ONLINE LEARNING COURSES

- A. Secondary credits granted to a student through an online learning course or program that meets or exceeds a graduation standard or requirement shall be counted toward the graduation and credit requirements of a student completing the Minnesota Academic Standards.
- B. Course credit will be considered only upon official documentation from the online learning provider evidencing the course taken and the grade and credit awarded to the student.
- C. When a student provides documentation from an online learning provider, the course credit and course grade shall be recorded and counted toward graduation credit requirements for all courses or programs that meet or exceed the school district's graduation requirements in the same manner as credits are awarded for students transferring from another Minnesota public school as set forth in Section IV.A. above.

VII. ADVANCED ACADEMIC CREDIT

- A. The school district will grant academic credit to a student attending an accelerated or advanced academic course offered by a higher education institution or a nonprofit public agency, other than the school district.
- B. Course credit will be considered only upon official documentation from the higher education institution or nonprofit public agency that the student successfully completed the course attended and passed an examination approved by the school district.
- C. When a determination is made that the content of the advanced academic course aligns directly with a required course for high school graduation, the commensurate credit and grade will be recorded on the student's transcript as a course credit applied toward graduation requirements.
- D. In the event the content of the advanced academic course does not fully align with the content of a high school course required for graduation but is comparable to elective credits offered by the school district for graduation, the school district may provide elective credit and the grade will be recorded on the student's transcript as an elective course credit applied toward graduation requirements.
- E. If no comparable course is offered by the school district for which high school graduation credit would be provided, the school district will notify the Commissioner and request a determination of the number of credits that shall be granted to a student.

VIII. WEIGHTED GRADES

[Note: School districts must identify in policy whether they offer courses with weighted grades. Therefore, school districts must include one of the following options in their policies.]

~~A. The school district does not offer weighted grades.~~

[or]

~~A. The school district offers weighted grades for courses that are identified as more rigorous or academically challenging as follows:~~

[List the types of courses that will be awarded weighted grades and the multiplier, similar to the following examples.]

~~1. A grade awarded in an Advanced Placement course will be multiplied by a factor of _____ (i.e., 1.07).~~

~~2. A grade awarded in an Honors course will be multiplied by a factor of _____.~~

~~3. A grade awarded in a College In the Schools course will be multiplied by a factor of _____.~~

~~4. A grade awarded in a course taken through a Post-Secondary Enrollment Options program will be multiplied by a factor of _____.~~

~~5. A grade awarded in a course in a dual enrollment course will be multiplied by a factor of _____.~~

~~B. The school district will update its website prior to the beginning of each school year with a listing of the courses for which a student may earn a weighted grade.~~

~~A. Saint Peter High School awards grade points based on the 4.0 credit scale. In addition, Advanced Placement (AP) and concurrent enrollment courses taken at Saint Peter High School will have bonus grade points.~~

~~1. Grade points are awarded and calculated into the cumulative grade point average when credits are entered on the transcript.~~

~~2. Bonus points are not awarded for courses taken at other institutions.~~

<u>Earned Grade</u>	<u>Grade Points Awarded</u>	<u>Bonus Points</u> <u>_____ (AP & concurrent)</u>
<u>A</u>	<u>4.0</u>	<u>.03</u>
<u>A-</u>	<u>3.7</u>	<u>.0267</u>
<u>B+</u>	<u>3.3</u>	<u>.0233</u>
<u>B</u>	<u>3.0</u>	<u>.02</u>
<u>B-</u>	<u>2.7</u>	<u>.0167</u>
<u>C+</u>	<u>2.3</u>	<u>.0133</u>
<u>C</u>	<u>2.0</u>	<u>.01</u>

<u>C-</u>	<u>1.7</u>	
<u>D+</u>	<u>1.3</u>	
<u>D</u>	<u>1.0</u>	
<u>D-</u>	<u>.7</u>	
<u>F</u>	<u>0</u>	

IX. PROCESS FOR AWARDING CREDIT

- A. The building principal will be responsible for carrying out the process to award credits and grades pursuant to this policy. The building principal will notify students in writing of the decision as to how credits and grades will be awarded.
- B. A student or the student’s parent or guardian may seek reconsideration of the decision by the building principal as to credits and/or grades awarded upon request of a student or the student’s parent or guardian if the request is made in writing to the superintendent within five school days of the date of the building principal’s decision. The request should set forth the credit and/or grade requested and the reason(s) why credit(s)/grade(s) should be provided as requested. Any pertinent documentation in support of the request should be submitted.
- C. The decision of the superintendent as to the award of credits or grades shall be a final decision by the school district and shall not be appealable by the student or student’s parent or guardian except as set forth in Section IX.D. below.
- D. If a student disputes the number of credits granted by the school district for a particular post-secondary enrollment course, online learning course, or advanced academic credit course, the student may appeal the school district’s decision to the Commissioner. The decision of the Commissioner shall be final.
- E. At any time during the process, the building principal or superintendent may ask for course descriptions, syllabi, or work samples from a course where content of the course is in question for purposes of determining alignment with graduation requirements or the number of credits to be granted. Students will not be provided credit until requested documentation is available for review, if requested.

Legal References: Minn. Stat. § 120B.02 (Educational Expectations and Graduation Requirements for Minnesota’s Students)
Minn. Stat. § 120B.021 (Required Academic Standards)
Minn. Stat. § 120B.11 (School District Process for Reviewing Curriculum, Instruction, and Student Achievement; Striving for the World’s Best Workforce)
Minn. Stat. § 120B.14 (Advanced Academic Credit)
Minn. Stat. § 123B.02 (General Powers of Independent School Districts)
Minn. Stat. § 123B.445 (Nonpublic Education Council)
Minn. Stat. § 124D.03, Subd. 9 (Enrollment Options Program)
Minn. Stat. § 124D.09 (Postsecondary Enrollment Options Act)
Minn. Stat. § 124D.095 (Online Learning Option)
Minn. Rules Parts 3501.0640-3501.0655 (Academic Standards for Language Arts)
Minn. Rules Parts 3501.0700-3501.0745 (Academic Standards for

Mathematics)
Minn. Rules Parts 3501.0820 (Academic Standards for the Arts)
Minn. Rules Parts 3501.0900-3501.0960 (Academic Standards in Science)
Minn. Rules Parts 3501.1200-3501.1210 (Academic Standards for English Language Development)
Minn. Rules Parts 3501.1300-3501.1345 (Academic Standards for Social Studies)
Minn. Rules Parts 3501.1400-3501.1410 (Academic Standards for Physical Education)

Cross References: [MSBA/MASA Model Policy 104 \(School District Mission Statement\)](#)
[MSBA/MASA Model Policy 601 \(School District Curriculum and Instruction Goals\)](#)
[MSBA/MASA Model Policy 613 \(Graduation Requirements\)](#)
[MSBA/MASA Model Policy 614 \(School District Testing Plan and Procedure\)](#)
[MSBA/MASA Model Policy 615 \(Testing Accommodations, Modifications, and Exemptions for IEPs, Section 504 Plans, and LEP Students\)](#)
[MSBA/MASA Model Policy 616 \(School District System Accountability\)](#)
[MSBA/MASA Model Policy 618 \(Assessment of Student Achievement\)](#)
[MSBA/MASA Model Policy 624 \(Online Learning Options\)](#)

~~MSBA/MASA Model Policy 104 (School District Mission Statement)~~
~~MSBA/MASA Model Policy 601 (School District Curriculum and Instruction Goals)~~
~~MSBA/MASA Model Policy 613 (Graduation Requirements)~~
~~MSBA/MASA Model Policy 614 (School District Testing Plan and Procedure)~~
~~MSBA/MASA Model Policy 615 (Testing Accommodations, Modifications, and Exemptions for IEPs, Section 504 Plans, and LEP Students)~~
~~MSBA/MASA Model Policy 616 (School District System Accountability)~~
~~MSBA/MASA Model Policy 618 (Assessment of Student Achievement)~~
~~MSBA/MASA Model Policy 624 (Online Learning Options)~~



ADDENDUM

REGULAR BOARD MEETING March 20, 2023 SPCC-Governor's Room 6:30PM

VIII. INFORMATION ITEMS

1. AGENDA ITEM #1

Subject: Native American Advisory Committee Update

Background: Each year the Native American Parent Advisory (NAPAC) is required to submit a vote of concurrence or non-concurrence regarding the school districts efforts in supporting Native American students, and the goals of the Native American Education Grant. This year NAPAC voted in concurrence. A member of NAPAC will be present to share an update.

Presentation: Jon Graff, Middle School Principal
Charmayne Klah, NAPAC Chair

Annual Compliance/Vote of Concurrence or Nonconcurrence

District, Charter, or Tribal School Name: Saint Peter Public Schools

The American Indian Parent Advisory Committee Vote

The AIPAC Issued a Vote of Concurrence

Date of Concurrent Vote: 3/8/23

Date the AIPAC presented to the school board: 3/20/23

The AIPAC Issued a Vote of Nonconcurrence

A vote of nonconcurrence requires the AIPAC to provide specific written recommendations for improvement to the school board. The school board is required to respond in writing to each recommendation within 60 days of the recommendations being put forth. The school board must provide this written response to both the AIPAC and to the Office of Indian Education.

Date of Nonconcurrent vote: _____

Date the AIPAC presented to the school board: _____

Date the written response from the school board is due: _____

The District/School Does Not Have an AIPAC

The district has not yet formed an AIPAC, but recognizes the need to do so in order to remain compliant with Minnesota Statutes, section 124D.78. By signing below, the district/school leadership commits to working with the Office of American Indian Education on committee formation.

Required signatures

**Digital signatures are accepted*

School Board Chairperson Date

Superintendent or Charter/Tribal School Director Date

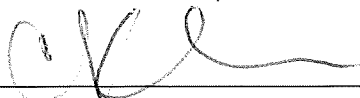
AIPAC Chairperson Date 3/8/2023



ADDENDUM

REGULAR BOARD MEETING March 20, 2023 SPCC-Governor's Room 6:30PM

VIII. INFORMATION ITEMS

2. AGENDA ITEM #2

Subject: Facilities Update

Background: The school district is required to complete Radon testing on a regular schedule. This testing has been completed with no areas of concern. Planning is also underway for summer projects. Sharon Petersen will provide an overview of the upcoming projects.

Presentation: Sharon Petersen, Operations and Maintenance Supervisor

School Radon Testing Reporting Form

According to Minnesota Statute 123B.571 subd. 3, a school district that has tested its school buildings for the presence of radon shall report the results of its tests to the Department of Health. Please use this form to submit information about the most recent round or cycle of testing conducted for each building.

Instructions

1. Complete one form for each building tested. In this case, a building is defined as an occupied facility with a unique address. This includes administrative buildings.
2. Include this form, raw data (e.g. laboratory report) and a building map.
3. Submit this form when all work is completed for a round of testing. This includes reporting to the school board, and follow-up testing and post-mitigation testing, if applicable.
4. Email information to health.indoorair@state.mn.us.

Contact Information

Name:	
Mailing Address:	
Phone:	Email:

Initial Radon Testing Information

School Building Name:	
School District & District Number:	
Building Address:	
Test Kit Manufacturer:	Device Name:
Date of Kit Retrieval (DD/MM/YY):	Length of Test (days):
How many rooms were tested?	
Does the test period include weekends? <input type="checkbox"/> Yes <input type="checkbox"/> No	
Does the test period include school breaks or holidays? <input type="checkbox"/> Yes <input type="checkbox"/> No	

SCHOOL RADON TESTING REPORTING FORM

Were all frequently-occupied ground contact rooms tested? ¹ <input type="checkbox"/> Yes <input type="checkbox"/> No If no, did you attempt to test all frequently occupied ground contact rooms, meaning test kits were placed in all these rooms? <input type="checkbox"/> Yes <input type="checkbox"/> No
How many rooms had results ≥ 4 pCi/L?:
Were the results reported at a school board meeting? <input type="checkbox"/> Yes <input type="checkbox"/> No

Follow-up Testing, Mitigation, & Post-Mitigation Testing

If one or more rooms tested ≥ 4 pCi/L, please answer the questions below:

How many rooms had follow-up testing?:		
Number of rooms with follow-up results	≥ 4 pCi/L:	< 4 pCi/L:
Of the rooms that had test results ≥ 4 pCi/L, how many rooms were:		
mitigated by HVAC balancing or operational changes? :		
mitigated by installation of active soil depressurization?:		
addressed through other corrective measures? ² :		
What was the cost of the installation and/or HVAC service work, to mitigate radon? \$		
What is the known or anticipated annual operating cost of mitigation (estimate)? \$		
After radon mitigation, how many rooms were retested?:		
Post mitigation results (# of rooms)	≥ 4 pCi/L:	< 4 pCi/L:

¹ This includes classrooms, offices, break rooms, laboratories, cafeterias, libraries, auditoriums, gymnasiums, etc. It includes rooms on grade and rooms above unoccupied spaces that are in contact with the ground, such as rooms above storage rooms, crawl spaces, tunnels, and boiler rooms. If only a sample or portion of rooms were tested, then respond with 'no'.

² 'Other corrective measures' could include moving staff out of a room and making a room unoccupied or trying to seal radon entry points.

School Radon Testing Reporting Form

According to Minnesota Statute 123B.571 subd. 3, a school district that has tested its school buildings for the presence of radon shall report the results of its tests to the Department of Health. Please use this form to submit information about the most recent round or cycle of testing conducted for each building.

Instructions

1. Complete one form for each building tested. In this case, a building is defined as an occupied facility with a unique address. This includes administrative buildings.
2. Include this form, raw data (e.g. laboratory report) and a building map.
3. Submit this form when all work is completed for a round of testing. This includes reporting to the school board, and follow-up testing and post-mitigation testing, if applicable.
4. Email information to health.indoorair@state.mn.us.

Contact Information

Name:	
Mailing Address:	
Phone:	Email:

Initial Radon Testing Information

School Building Name:	
School District & District Number:	
Building Address:	
Test Kit Manufacturer:	Device Name:
Date of Kit Retrieval (DD/MM/YY):	Length of Test (days):
How many rooms were tested?	
Does the test period include weekends? <input type="checkbox"/> Yes <input type="checkbox"/> No	
Does the test period include school breaks or holidays? <input type="checkbox"/> Yes <input type="checkbox"/> No	

SCHOOL RADON TESTING REPORTING FORM

<p>Were all frequently-occupied ground contact rooms tested?¹ <input type="checkbox"/> Yes <input type="checkbox"/> No</p> <p>If no, did you attempt to test all frequently occupied ground contact rooms, meaning test kits were placed in all these rooms? <input type="checkbox"/> Yes <input type="checkbox"/> No</p>
<p>How many rooms had results ≥ 4 pCi/L?:</p>
<p>Were the results reported at a school board meeting? <input type="checkbox"/> Yes <input type="checkbox"/> No</p>

Follow-up Testing, Mitigation, & Post-Mitigation Testing

If one or more rooms tested ≥ 4 pCi/L, please answer the questions below:

<p>How many rooms had follow-up testing?:</p>		
<p>Number of rooms with follow-up results</p>	<p>≥ 4 pCi/L:</p>	<p>< 4 pCi/L:</p>
<p>Of the rooms that had test results ≥ 4 pCi/L, how many rooms were:</p>		
<p>mitigated by HVAC balancing or operational changes? :</p>		
<p>mitigated by installation of active soil depressurization?:</p>		
<p>addressed through other corrective measures?²:</p>		
<p>What was the cost of the installation and/or HVAC service work, to mitigate radon? \$</p>		
<p>What is the known or anticipated annual operating cost of mitigation (estimate)? \$</p>		
<p>After radon mitigation, how many rooms were retested?:</p>		
<p>Post mitigation results (# of rooms)</p>	<p>≥ 4 pCi/L:</p>	<p>< 4 pCi/L:</p>

¹ This includes classrooms, offices, break rooms, laboratories, cafeterias, libraries, auditoriums, gymnasiums, etc. It includes rooms on grade and rooms above unoccupied spaces that are in contact with the ground, such as rooms above storage rooms, crawl spaces, tunnels, and boiler rooms. If only a sample or portion of rooms were tested, then respond with 'no'.

² 'Other corrective measures' could include moving staff out of a room and making a room unoccupied or trying to seal radon entry points.

School Radon Testing Reporting Form

According to Minnesota Statute 123B.571 subd. 3, a school district that has tested its school buildings for the presence of radon shall report the results of its tests to the Department of Health. Please use this form to submit information about the most recent round or cycle of testing conducted for each building.

Instructions

1. Complete one form for each building tested. In this case, a building is defined as an occupied facility with a unique address. This includes administrative buildings.
2. Include this form, raw data (e.g. laboratory report) and a building map.
3. Submit this form when all work is completed for a round of testing. This includes reporting to the school board, and follow-up testing and post-mitigation testing, if applicable.
4. Email information to health.indoorair@state.mn.us.

Contact Information

Name:	
Mailing Address:	
Phone:	Email:

Initial Radon Testing Information

School Building Name:	
School District & District Number:	
Building Address:	
Test Kit Manufacturer:	Device Name:
Date of Kit Retrieval (DD/MM/YY):	Length of Test (days):
How many rooms were tested?	
Does the test period include weekends? <input type="checkbox"/> Yes <input type="checkbox"/> No	
Does the test period include school breaks or holidays? <input type="checkbox"/> Yes <input type="checkbox"/> No	

SCHOOL RADON TESTING REPORTING FORM

Were all frequently-occupied ground contact rooms tested? ¹ <input type="checkbox"/> Yes <input type="checkbox"/> No If no, did you attempt to test all frequently occupied ground contact rooms, meaning test kits were placed in all these rooms? <input type="checkbox"/> Yes <input type="checkbox"/> No
How many rooms had results ≥ 4 pCi/L?:
Were the results reported at a school board meeting? <input type="checkbox"/> Yes <input type="checkbox"/> No

Follow-up Testing, Mitigation, & Post-Mitigation Testing

If one or more rooms tested ≥ 4 pCi/L, please answer the questions below:

How many rooms had follow-up testing?:		
Number of rooms with follow-up results	≥ 4 pCi/L:	< 4 pCi/L:
Of the rooms that had test results ≥ 4 pCi/L, how many rooms were:		
mitigated by HVAC balancing or operational changes? :		
mitigated by installation of active soil depressurization?:		
addressed through other corrective measures? ² :		
What was the cost of the installation and/or HVAC service work, to mitigate radon? \$		
What is the known or anticipated annual operating cost of mitigation (estimate)? \$		
After radon mitigation, how many rooms were retested?:		
Post mitigation results (# of rooms)	≥ 4 pCi/L:	< 4 pCi/L:

¹ This includes classrooms, offices, break rooms, laboratories, cafeterias, libraries, auditoriums, gymnasiums, etc. It includes rooms on grade and rooms above unoccupied spaces that are in contact with the ground, such as rooms above storage rooms, crawl spaces, tunnels, and boiler rooms. If only a sample or portion of rooms were tested, then respond with 'no'.

² 'Other corrective measures' could include moving staff out of a room and making a room unoccupied or trying to seal radon entry points.

School Radon Testing Reporting Form

According to Minnesota Statute 123B.571 subd. 3, a school district that has tested its school buildings for the presence of radon shall report the results of its tests to the Department of Health. Please use this form to submit information about the most recent round or cycle of testing conducted for each building.

Instructions

1. Complete one form for each building tested. In this case, a building is defined as an occupied facility with a unique address. This includes administrative buildings.
2. Include this form, raw data (e.g. laboratory report) and a building map.
3. Submit this form when all work is completed for a round of testing. This includes reporting to the school board, and follow-up testing and post-mitigation testing, if applicable.
4. Email information to health.indoorair@state.mn.us.

Contact Information

Name:	
Mailing Address:	
Phone:	Email:

Initial Radon Testing Information

School Building Name:	
School District & District Number:	
Building Address:	
Test Kit Manufacturer:	Device Name:
Date of Kit Retrieval (DD/MM/YY):	Length of Test (days):
How many rooms were tested?	
Does the test period include weekends? <input type="checkbox"/> Yes <input type="checkbox"/> No	
Does the test period include school breaks or holidays? <input type="checkbox"/> Yes <input type="checkbox"/> No	

SCHOOL RADON TESTING REPORTING FORM

<p>Were all frequently-occupied ground contact rooms tested?¹ <input type="checkbox"/> Yes <input type="checkbox"/> No</p> <p>If no, did you attempt to test all frequently occupied ground contact rooms, meaning test kits were placed in all these rooms? <input type="checkbox"/> Yes <input type="checkbox"/> No</p>
<p>How many rooms had results ≥ 4 pCi/L?:</p>
<p>Were the results reported at a school board meeting? <input type="checkbox"/> Yes <input type="checkbox"/> No</p>

Follow-up Testing, Mitigation, & Post-Mitigation Testing

If one or more rooms tested ≥ 4 pCi/L, please answer the questions below:

<p>How many rooms had follow-up testing?:</p>		
<p>Number of rooms with follow-up results</p>	<p>≥ 4 pCi/L:</p>	<p>< 4 pCi/L:</p>
<p>Of the rooms that had test results ≥ 4 pCi/L, how many rooms were:</p>		
<p>mitigated by HVAC balancing or operational changes? :</p>		
<p>mitigated by installation of active soil depressurization?:</p>		
<p>addressed through other corrective measures?²:</p>		
<p>What was the cost of the installation and/or HVAC service work, to mitigate radon? \$</p>		
<p>What is the known or anticipated annual operating cost of mitigation (estimate)? \$</p>		
<p>After radon mitigation, how many rooms were retested?:</p>		
<p>Post mitigation results (# of rooms)</p>	<p>≥ 4 pCi/L:</p>	<p>< 4 pCi/L:</p>

¹ This includes classrooms, offices, break rooms, laboratories, cafeterias, libraries, auditoriums, gymnasiums, etc. It includes rooms on grade and rooms above unoccupied spaces that are in contact with the ground, such as rooms above storage rooms, crawl spaces, tunnels, and boiler rooms. If only a sample or portion of rooms were tested, then respond with 'no'.

² 'Other corrective measures' could include moving staff out of a room and making a room unoccupied or trying to seal radon entry points.

School Radon Testing Reporting Form

According to Minnesota Statute 123B.571 subd. 3, a school district that has tested its school buildings for the presence of radon shall report the results of its tests to the Department of Health. Please use this form to submit information about the most recent round or cycle of testing conducted for each building.

Instructions

1. Complete one form for each building tested. In this case, a building is defined as an occupied facility with a unique address. This includes administrative buildings.
2. Include this form, raw data (e.g. laboratory report) and a building map.
3. Submit this form when all work is completed for a round of testing. This includes reporting to the school board, and follow-up testing and post-mitigation testing, if applicable.
4. Email information to health.indoorair@state.mn.us.

Contact Information

Name:	
Mailing Address:	
Phone:	Email:

Initial Radon Testing Information

School Building Name:	
School District & District Number:	
Building Address:	
Test Kit Manufacturer:	Device Name:
Date of Kit Retrieval (DD/MM/YY):	Length of Test (days):
How many rooms were tested?	
Does the test period include weekends? <input type="checkbox"/> Yes <input type="checkbox"/> No	
Does the test period include school breaks or holidays? <input type="checkbox"/> Yes <input type="checkbox"/> No	

SCHOOL RADON TESTING REPORTING FORM

<p>Were all frequently-occupied ground contact rooms tested?¹ <input type="checkbox"/> Yes <input type="checkbox"/> No</p> <p>If no, did you attempt to test all frequently occupied ground contact rooms, meaning test kits were placed in all these rooms? <input type="checkbox"/> Yes <input type="checkbox"/> No</p>
<p>How many rooms had results ≥ 4 pCi/L?:</p>
<p>Were the results reported at a school board meeting? <input type="checkbox"/> Yes <input type="checkbox"/> No</p>

Follow-up Testing, Mitigation, & Post-Mitigation Testing

If one or more rooms tested ≥ 4 pCi/L, please answer the questions below:

<p>How many rooms had follow-up testing?:</p>		
<p>Number of rooms with follow-up results</p>	<p>≥ 4 pCi/L:</p>	<p>< 4 pCi/L:</p>
<p>Of the rooms that had test results ≥ 4 pCi/L, how many rooms were:</p>		
<p>mitigated by HVAC balancing or operational changes? :</p>		
<p>mitigated by installation of active soil depressurization?:</p>		
<p>addressed through other corrective measures?²:</p>		
<p>What was the cost of the installation and/or HVAC service work, to mitigate radon? \$</p>		
<p>What is the known or anticipated annual operating cost of mitigation (estimate)? \$</p>		
<p>After radon mitigation, how many rooms were retested?:</p>		
<p>Post mitigation results (# of rooms)</p>	<p>≥ 4 pCi/L:</p>	<p>< 4 pCi/L:</p>

¹ This includes classrooms, offices, break rooms, laboratories, cafeterias, libraries, auditoriums, gymnasiums, etc. It includes rooms on grade and rooms above unoccupied spaces that are in contact with the ground, such as rooms above storage rooms, crawl spaces, tunnels, and boiler rooms. If only a sample or portion of rooms were tested, then respond with 'no'.

² 'Other corrective measures' could include moving staff out of a room and making a room unoccupied or trying to seal radon entry points.

School Radon Testing Reporting Form

According to Minnesota Statute 123B.571 subd. 3, a school district that has tested its school buildings for the presence of radon shall report the results of its tests to the Department of Health. Please use this form to submit information about the most recent round or cycle of testing conducted for each building.

Instructions

1. Complete one form for each building tested. In this case, a building is defined as an occupied facility with a unique address. This includes administrative buildings.
2. Include this form, raw data (e.g. laboratory report) and a building map.
3. Submit this form when all work is completed for a round of testing. This includes reporting to the school board, and follow-up testing and post-mitigation testing, if applicable.
4. Email information to health.indoorair@state.mn.us.

Contact Information

Name:	
Mailing Address:	
Phone:	Email:

Initial Radon Testing Information

School Building Name:	
School District & District Number:	
Building Address:	
Test Kit Manufacturer:	Device Name:
Date of Kit Retrieval (DD/MM/YY):	Length of Test (days):
How many rooms were tested?	
Does the test period include weekends? <input type="checkbox"/> Yes <input type="checkbox"/> No	
Does the test period include school breaks or holidays? <input type="checkbox"/> Yes <input type="checkbox"/> No	

SCHOOL RADON TESTING REPORTING FORM

Were all frequently-occupied ground contact rooms tested? ¹ <input type="checkbox"/> Yes <input type="checkbox"/> No If no, did you attempt to test all frequently occupied ground contact rooms, meaning test kits were placed in all these rooms? <input type="checkbox"/> Yes <input type="checkbox"/> No
How many rooms had results ≥ 4 pCi/L?:
Were the results reported at a school board meeting? <input type="checkbox"/> Yes <input type="checkbox"/> No

Follow-up Testing, Mitigation, & Post-Mitigation Testing

If one or more rooms tested ≥ 4 pCi/L, please answer the questions below:

How many rooms had follow-up testing?:		
Number of rooms with follow-up results	≥ 4 pCi/L:	< 4 pCi/L:
Of the rooms that had test results ≥ 4 pCi/L, how many rooms were:		
mitigated by HVAC balancing or operational changes? :		
mitigated by installation of active soil depressurization?:		
addressed through other corrective measures? ² :		
What was the cost of the installation and/or HVAC service work, to mitigate radon? \$		
What is the known or anticipated annual operating cost of mitigation (estimate)? \$		
After radon mitigation, how many rooms were retested?:		
Post mitigation results (# of rooms)	≥ 4 pCi/L:	< 4 pCi/L:

¹ This includes classrooms, offices, break rooms, laboratories, cafeterias, libraries, auditoriums, gymnasiums, etc. It includes rooms on grade and rooms above unoccupied spaces that are in contact with the ground, such as rooms above storage rooms, crawl spaces, tunnels, and boiler rooms. If only a sample or portion of rooms were tested, then respond with 'no'.

² 'Other corrective measures' could include moving staff out of a room and making a room unoccupied or trying to seal radon entry points.

Radon test result report for:**ST PETER HIGH SCHOOL**

Kit #	Room Id	Started	Ended	pCi/L	Analyzed
11602910	A102	2023-01-31 @ 12:00 pm	2023-02-03 @ 11:00 am	1.4 ± 0.6	2023-02-09
11602912	A102 AD OFFICE	2023-01-31 @ 12:00 pm	2023-02-03 @ 11:00 am	0.8 ± 0.5	2023-02-09
11602906	A111	2023-01-31 @ 11:00 am	2023-02-03 @ 11:00 am	1.2 ± 0.5	2023-02-09
11602909	A125 TRAINERS ROOM	2023-01-31 @ 11:00 am	2023-02-03 @ 11:00 am	1.2 ± 0.6	2023-02-09
11602902	A137 OFFICE	2023-01-31 @ 11:00 am	2023-02-03 @ 10:00 am	< 0.3	2023-02-09
11129995	A141 FACULTY LOUNGE	2023-01-31 @ 11:00 am	2023-02-03 @ 10:00 am	1.1 ± 0.5	2023-02-09
11602917	AG SHOP EAST	2023-01-31 @ 12:00 pm	2023-02-03 @ 11:00 am	1.0 ± 0.5	2023-02-09
11602918	AG SHOP WEST	2023-01-31 @ 12:00 pm	2023-02-03 @ 11:00 am	0.9 ± 0.5	2023-02-09
11602949	AUDITORIUM N	2023-01-31 @ 1:00 pm	2023-02-03 @ 11:00 am	< 0.3	2023-02-09
11602948	AUDITORIUM NE	2023-01-31 @ 1:00 pm	2023-02-03 @ 11:00 am	0.9 ± 0.5	2023-02-09
11602950	AUDITORIUM NW	2023-01-31 @ 1:00 pm	2023-02-03 @ 11:00 am	< 0.3	2023-02-09
11602947	AUDITORIUM SE	2023-01-31 @ 1:00 pm	2023-02-03 @ 11:00 am	1.3 ± 0.6	2023-02-09
11602951	AUDITORIUM SW	2023-01-31 @ 1:00 pm	2023-02-03 @ 11:00 am	0.9 ± 0.5	2023-02-09
11602919	B120	2023-01-31 @ 12:00 pm	2023-02-03 @ 11:00 am	< 0.3	2023-02-09
11602921	B121 EAST	2023-01-31 @ 12:00 pm	2023-02-03 @ 11:00 am	< 0.3	2023-02-09
11602922	B121 WEST	2023-01-31 @ 12:00 pm	2023-02-03 @ 11:00 am	< 0.3	2023-02-09
11602923	B124	2023-01-31 @ 12:00 pm	2023-02-03 @ 11:00 am	< 0.3	2023-02-09
11602920	B125	2023-01-31 @ 12:00 pm	2023-02-03 @ 11:00 am	< 0.3	2023-02-09
11602916	B130	2023-01-31 @ 12:00 pm	2023-02-03 @ 11:00 am	0.8 ± 0.5	2023-02-09
11602915	B131	2023-01-31 @ 12:00 pm	2023-02-03 @ 11:00 am	< 0.3	2023-02-09
11602939	C129 BAND	2023-01-31 @ 12:00 pm	2023-02-03 @ 11:00 am	1.7 ± 0.6	2023-02-09
11602940	C130 BAND OFFICE	2023-01-31 @ 12:00 pm	2023-02-03 @ 11:00 am	1.8 ± 0.6	2023-02-09
11602935	C132 VOCAL LAB	2023-01-31 @ 12:00 pm	2023-02-03 @ 11:00 am	1.3 ± 0.5	2023-02-09
11602936	C133	2023-01-31 @ 12:00 pm	2023-02-03 @ 11:00 am	1.6 ± 0.6	2023-02-09
11602932	C134	2023-01-31 @ 12:00 pm	2023-02-03 @ 11:00 am	< 0.3	2023-02-09
11602911	CONCESSIONS	2023-01-31 @ 12:00 pm	2023-02-03 @ 11:00 am	< 0.3	2023-02-09
11602952	D-BOX OFFICE-1	2023-01-31 @ 1:00 pm	2023-02-03 @ 11:00 am	< 0.3	2023-02-09
11602953	D-BOX OFFICE-2	2023-01-31 @ 1:00 pm	2023-02-03 @ 11:00 am	< 0.3	2023-02-09
11129988	D-CUSTODIAL OFFICE-1	2023-01-31 @ 11:00 am	2023-02-03 @ 10:00 am	< 0.3	2023-02-09
11129989	D-CUSTODIAL OFFICE-2	2023-01-31 @ 11:00 am	2023-02-03 @ 10:00 am	< 0.3	2023-02-09
11129942	D-D103-1 CONFERENCE 3	2023-01-31 @ 9:00 am	2023-02-03 @ 10:00 am	0.8 ± 0.5	2023-02-09
11129944	D-D103-2 CONFERENCE ROOM	2023-01-31 @ 9:00 am	2023-02-03 @ 10:00 am	0.6 ± 0.5	2023-02-09
11602937	D-INSTRUMENTS-1	2023-01-31 @ 12:00 pm	2023-02-03 @ 11:00 am	0.8 ± 0.5	2023-02-09
11602938	D-INSTRUMENTS-2	2023-01-31 @ 12:00 pm	2023-02-03 @ 11:00 am	1.4 ± 0.5	2023-02-09
11602941	D-MAKE UP ROOM-1	2023-01-31 @ 12:00 pm	2023-02-03 @ 11:00 am	1.4 ± 0.6	2023-02-09
11602944	D-MAKE UP ROOM-2	2023-01-31 @ 12:00 pm	2023-02-03 @ 11:00 am	1.1 ± 0.5	2023-02-09
11129945	D105	2023-01-31 @ 9:00 am	2023-02-03 @ 10:00 am	0.8 ± 0.5	2023-02-09

Radon test result report for:**ST PETER HIGH SCHOOL**

Kit #	Room Id	Started	Ended	pCi/L	Analyzed
11129946	D106 WORK ROOM	2023-01-31 @ 9:00 am	2023-02-03 @ 10:00 am	< 0.3	2023-02-09
11129947	D107	2023-01-31 @ 9:00 am	2023-02-03 @ 10:00 am	< 0.3	2023-02-09
11129948	D109	2023-01-31 @ 9:00 am	2023-02-03 @ 10:00 am	< 0.3	2023-02-09
11129951	D113 MIDDLE OFFICE	2023-01-31 @ 9:00 am	2023-02-03 @ 10:00 am	0.7 ± 0.5	2023-02-09
11129950	D113 NURSE	2023-01-31 @ 9:00 am	2023-02-03 @ 10:00 am	< 0.3	2023-02-09
11129952	D113 SICK ROOM	2023-01-31 @ 9:00 am	2023-02-03 @ 10:00 am	0.9 ± 0.5	2023-02-09
11129956	D117 STUDENT SERVICES	2023-01-31 @ 10:00 am	2023-02-03 @ 10:00 am	< 0.3	2023-02-09
11129957	D118 SOCIAL WORKER	2023-01-31 @ 10:00 am	2023-02-03 @ 10:00 am	1.2 ± 0.5	2023-02-09
11129958	D119 COUNSELOR	2023-01-31 @ 10:00 am	2023-02-03 @ 10:00 am	< 0.3	2023-02-09
11129959	D120 COUNSELOR	2023-01-31 @ 10:00 am	2023-02-03 @ 10:00 am	< 0.3	2023-02-09
11129955	D123	2023-01-31 @ 10:00 am	2023-02-03 @ 10:00 am	< 0.3	2023-02-09
11129953	D127 CONFERENCE ROOM	2023-01-31 @ 9:00 am	2023-02-03 @ 10:00 am	< 0.3	2023-02-09
11129949	D128	2023-01-31 @ 9:00 am	2023-02-03 @ 10:00 am	< 0.3	2023-02-09
11129954	D129 FACS	2023-01-31 @ 10:00 am	2023-02-03 @ 10:00 am	0.8 ± 0.5	2023-02-09
11602954	D213	2023-01-31 @ 1:00 pm	2023-02-03 @ 11:00 am	< 0.3	2023-02-09
11602955	D216	2023-01-31 @ 1:00 pm	2023-02-03 @ 11:00 am	0.9 ± 0.5	2023-02-09
11602914	DB128-1	2023-01-31 @ 12:00 pm	2023-02-03 @ 11:00 am	< 0.3	2023-02-09
11602913	DB128-2	2023-01-31 @ 12:00 pm	2023-02-03 @ 11:00 am	< 0.3	2023-02-09
11602933	DC135-1	2023-01-31 @ 12:00 pm	2023-02-03 @ 11:00 am	0.9 ± 0.5	2023-02-09
11602934	DC135-2	2023-01-31 @ 12:00 pm	2023-02-03 @ 11:00 am	< 0.3	2023-02-09
11129982	DE RESOURCE-1	2023-01-31 @ 10:00 am	2023-02-03 @ 10:00 am	< 0.3	2023-02-09
11129983	DE RESOURCE-2	2023-01-31 @ 10:00 am	2023-02-03 @ 10:00 am	< 0.3	2023-02-09
11129965	DE136-1	2023-01-31 @ 10:00 am	2023-02-03 @ 10:00 am	< 0.3	2023-02-09
11129967	DE136-2	2023-01-31 @ 10:00 am	2023-02-03 @ 10:00 am	< 0.3	2023-02-09
11129961	DE138-1	2023-01-31 @ 10:00 am	2023-02-03 @ 10:00 am	1.5 ± 0.6	2023-02-09
11129962	DE138-2	2023-01-31 @ 10:00 am	2023-02-03 @ 10:00 am	1.5 ± 0.6	2023-02-09
11602929	DPRACTICE 4-1	2023-01-31 @ 12:00 pm	2023-02-03 @ 11:00 am	1.3 ± 0.5	2023-02-09
11602930	DPRACTICE 4-2	2023-01-31 @ 12:00 pm	2023-02-03 @ 11:00 am	1.2 ± 0.5	2023-02-09
11129964	DW RESOURCE-1	2023-01-31 @ 10:00 am	2023-02-03 @ 10:00 am	< 0.3	2023-02-09
11129968	DW RESOURCE-2	2023-01-31 @ 10:00 am	2023-02-03 @ 10:00 am	0.8 ± 0.5	2023-02-09
11129974	E COMMONS EAST	2023-01-31 @ 10:00 am	2023-02-03 @ 10:00 am	0.6 ± 0.5	2023-02-09
11129980	E106	2023-01-31 @ 10:00 am	2023-02-03 @ 10:00 am	0.9 ± 0.5	2023-02-09
11129977	E107 PREP	2023-01-31 @ 10:00 am	2023-02-03 @ 10:00 am	< 0.3	2023-02-09
11129987	E108	2023-01-31 @ 10:00 am	2023-02-03 @ 10:00 am	< 0.3	2023-02-09
11129985	E111	2023-01-31 @ 10:00 am	2023-02-03 @ 10:00 am	1.2 ± 0.5	2023-02-09
11129984	E112	2023-01-31 @ 10:00 am	2023-02-03 @ 10:00 am	1.2 ± 0.5	2023-02-09
11129986	E114	2023-01-31 @ 10:00 am	2023-02-03 @ 10:00 am	1.0 ± 0.5	2023-02-09

Radon test result report for:**ST PETER HIGH SCHOOL**

Kit #	Room Id	Started	Ended	pCi/L	Analyzed
11129981	E115	2023-01-31 @ 10:00 am	2023-02-03 @ 10:00 am	0.8 ± 0.5	2023-02-09
11129975	E116	2023-01-31 @ 10:00 am	2023-02-03 @ 10:00 am	< 0.3	2023-02-09
11129976	E117	2023-01-31 @ 10:00 am	2023-02-03 @ 10:00 am	1.0 ± 0.5	2023-02-09
11129979	E118	2023-01-31 @ 10:00 am	2023-02-03 @ 10:00 am	1.2 ± 0.5	2023-02-09
11129960	E126	2023-01-31 @ 10:00 am	2023-02-03 @ 10:00 am	0.9 ± 0.5	2023-02-09
11129969	E127	2023-01-31 @ 10:00 am	2023-02-03 @ 10:00 am	< 0.3	2023-02-09
11129978	E128	2023-01-31 @ 10:00 am	2023-02-03 @ 10:00 am	0.8 ± 0.5	2023-02-09
11129973	E129	2023-01-31 @ 10:00 am	2023-02-03 @ 10:00 am	< 0.3	2023-02-09
11129970	E130	2023-01-31 @ 10:00 am	2023-02-03 @ 10:00 am	< 0.3	2023-02-09
11129971	E132	2023-01-31 @ 10:00 am	2023-02-03 @ 10:00 am	1.2 ± 0.5	2023-02-09
11129972	E133	2023-01-31 @ 10:00 am	2023-02-03 @ 10:00 am	1.0 ± 0.5	2023-02-09
11129966	E134	2023-01-31 @ 10:00 am	2023-02-03 @ 10:00 am	< 0.3	2023-02-09
11602956	E216	2023-01-31 @ 1:00 pm	2023-02-03 @ 11:00 am	< 0.3	2023-02-09
11602957	E233	2023-01-31 @ 1:00 pm	2023-02-03 @ 11:00 am	< 0.3	2023-02-09
11602905	FITNESS CENTER	2023-01-31 @ 11:00 am	2023-02-03 @ 11:00 am	1.6 ± 0.6	2023-02-09
11129996	GYM 1	2023-01-31 @ 11:00 am	2023-02-03 @ 10:00 am	< 0.3	2023-02-09
11129997	GYM 2	2023-01-31 @ 11:00 am	2023-02-03 @ 10:00 am	1.3 ± 0.6	2023-02-09
11129998	GYM 3	2023-01-31 @ 11:00 am	2023-02-03 @ 10:00 am	1.2 ± 0.5	2023-02-09
11130000	GYM 4	2023-01-31 @ 11:00 am	2023-02-03 @ 10:00 am	1.5 ± 0.5	2023-02-09
11602903	GYM 5	2023-01-31 @ 11:00 am	2023-02-03 @ 11:00 am	< 0.3	2023-02-09
11602904	GYM 6	2023-01-31 @ 11:00 am	2023-02-03 @ 11:00 am	0.9 ± 0.5	2023-02-09
11129990	KITCHEN OFFICES	2023-01-31 @ 11:00 am	2023-02-03 @ 10:00 am	< 0.3	2023-02-09
11129994	LUNCH COMMONS 1	2023-01-31 @ 11:00 am	2023-02-03 @ 10:00 am	0.9 ± 0.5	2023-02-09
11129993	LUNCH COMMONS 2	2023-01-31 @ 11:00 am	2023-02-03 @ 10:00 am	< 0.3	2023-02-09
11129992	LUNCH COMMONS 3	2023-01-31 @ 11:00 am	2023-02-03 @ 10:00 am	< 0.3	2023-02-09
11129991	LUNCH COMMONS 4	2023-01-31 @ 11:00 am	2023-02-03 @ 10:00 am	1.0 ± 0.5	2023-02-09
11129943	MAIN OFFICE	2023-01-31 @ 9:00 am	2023-02-03 @ 10:00 am	0.9 ± 0.5	2023-02-09
11602942	MEN'S DRESSING ROOM	2023-01-31 @ 12:00 pm	2023-02-03 @ 11:00 am	1.0 ± 0.5	2023-02-09
11602931	MUSIC LIBRARY	2023-01-31 @ 12:00 pm	2023-02-03 @ 11:00 am	1.2 ± 0.5	2023-02-09
11602926	PRACTICE 1	2023-01-31 @ 12:00 pm	2023-02-03 @ 11:00 am	< 0.3	2023-02-09
11602927	PRACTICE 2	2023-01-31 @ 12:00 pm	2023-02-03 @ 11:00 am	0.7 ± 0.5	2023-02-09
11602928	PRACTICE 3	2023-01-31 @ 12:00 pm	2023-02-03 @ 11:00 am	1.1 ± 0.5	2023-02-09
11602945	SET BUILDING	2023-01-31 @ 12:00 pm	2023-02-03 @ 11:00 am	0.9 ± 0.5	2023-02-09
11602946	STAGE	2023-01-31 @ 12:00 pm	2023-02-03 @ 11:00 am	< 0.3	2023-02-09
11602908	VARSITY BOYS LOCKER ROOM OFFICE	2023-01-31 @ 11:00 am	2023-02-03 @ 11:00 am	1.2 ± 0.5	2023-02-09
11602907	VARSITY GIRLS LOCKER ROOM OFFICE	2023-01-31 @ 11:00 am	2023-02-03 @ 11:00 am	1.3 ± 0.5	2023-02-09
11602943	WOMEN'S DRRESSING ROOM	2023-01-31 @ 12:00 pm	2023-02-03 @ 11:00 am	1.6 ± 0.5	2023-02-09

February 9, 2023

**** LABORATORY ANALYSIS REPORT ****

Radon test result report for:

ST PETER HIGH SCHOOL

Kit #	Room Id	Started	Ended	pCi/L	Analyzed
11602925	WOOD SHOP EAST	2023-01-31 @ 12:00 pm	2023-02-03 @ 11:00 am	1.2 ± 0.5	2023-02-09
11602924	WOOD SHOP WEST	2023-01-31 @ 12:00 pm	2023-02-03 @ 11:00 am	0.8 ± 0.5	2023-02-09
11602901	WRESTLING ROOM 1	2023-01-31 @ 11:00 am	2023-02-03 @ 10:00 am	1.0 ± 0.5	2023-02-09
11129999	WRESTLING ROOM 2	2023-01-31 @ 11:00 am	2023-02-03 @ 10:00 am	1.5 ± 0.5	2023-02-09

Air Chek 1936 Butler Bridge Rd, Mills River, NC 28759-3892 Phone: (828) 684-0893 Fax: (828) 684-8498

Radon test result report for:

**ST. PETER PUBLIC SCHOOLS
ST. PETER MIDDLE SCHOOL**

Kit #	Room Id	Started	Ended	pCi/L	Analyzed
11609845	102A	2023-01-31 @ 9:00 am	2023-02-03 @ 1:00 pm	1.3 ± 0.5	2023-02-09
11609835	104 OFFICE	2023-01-31 @ 9:00 am	2023-02-03 @ 12:00 pm	1.8 ± 0.6	2023-02-09
11609834	108A	2023-01-31 @ 9:00 am	2023-02-03 @ 12:00 pm	< 0.3	2023-02-09
11609831	109	2023-01-31 @ 9:00 am	2023-02-03 @ 12:00 pm	1.3 ± 0.5	2023-02-09
11609857	116	2023-01-31 @ 10:00 am	2023-02-03 @ 1:00 pm	< 0.3	2023-02-09
11609858	116 STORAGE	2023-01-31 @ 10:00 am	2023-02-03 @ 1:00 pm	2.2 ± 0.5	2023-02-09
11609866	118 SW	2023-01-31 @ 10:00 am	2023-02-03 @ 1:00 pm	< 0.3	2023-02-09
11609859	119	2023-01-31 @ 10:00 am	2023-02-03 @ 1:00 pm	< 0.3	2023-02-09
11609870	120 KITCHEN	2023-01-31 @ 10:00 am	2023-02-03 @ 1:00 pm	0.7 ± 0.5	2023-02-09
11609863	121	2023-01-31 @ 10:00 am	2023-02-03 @ 1:00 pm	< 0.3	2023-02-09
11609862	121A	2023-01-31 @ 10:00 am	2023-02-03 @ 1:00 pm	< 0.3	2023-02-09
11609873	122	2023-01-31 @ 10:00 am	2023-02-03 @ 1:00 pm	1.1 ± 0.5	2023-02-09
11609868	123 EAST	2023-01-31 @ 10:00 am	2023-02-03 @ 1:00 pm	0.9 ± 0.5	2023-02-09
11609867	123 WEST	2023-01-31 @ 10:00 am	2023-02-03 @ 1:00 pm	< 0.3	2023-02-09
11609869	123B	2023-01-31 @ 10:00 am	2023-02-03 @ 1:00 pm	1.6 ± 0.5	2023-02-09
11609874	124	2023-01-31 @ 10:00 am	2023-02-03 @ 1:00 pm	1.1 ± 0.5	2023-02-09
11606732	125	2023-01-31 @ 12:00 pm	2023-02-03 @ 12:00 pm	< 0.3	2023-02-09
11606731	125 OFFICE	2023-01-31 @ 12:00 pm	2023-02-03 @ 12:00 pm	< 0.3	2023-02-09
11606723	200	2023-01-31 @ 12:00 pm	2023-02-03 @ 1:00 pm	< 0.3	2023-02-09
11606724	200A	2023-01-31 @ 12:00 pm	2023-02-03 @ 1:00 pm	< 0.3	2023-02-09
11606720	201	2023-01-31 @ 11:00 am	2023-02-03 @ 1:00 pm	< 0.3	2023-02-09
11606722	202A	2023-01-31 @ 12:00 pm	2023-02-03 @ 1:00 pm	< 0.3	2023-02-09
11606717	205	2023-01-31 @ 11:00 am	2023-02-03 @ 1:00 pm	1.2 ± 0.5	2023-02-09
11606712	205A	2023-01-31 @ 11:00 am	2023-02-03 @ 1:00 pm	< 0.3	2023-02-09
11609890	206	2023-01-31 @ 11:00 am	2023-02-03 @ 1:00 pm	0.7 ± 0.5	2023-02-09
11609889	206A	2023-01-31 @ 11:00 am	2023-02-03 @ 1:00 pm	< 0.3	2023-02-09
11609888	206B	2023-01-31 @ 11:00 am	2023-02-03 @ 1:00 pm	< 0.3	2023-02-09
11606714	207A	2023-01-31 @ 11:00 am	2023-02-03 @ 1:00 pm	< 0.3	2023-02-09
11606715	207C	2023-01-31 @ 11:00 am	2023-02-03 @ 1:00 pm	< 0.3	2023-02-09
11606716	207D	2023-01-31 @ 11:00 am	2023-02-03 @ 1:00 pm	< 0.3	2023-02-09
11609886	210	2023-01-31 @ 11:00 am	2023-02-03 @ 1:00 pm	< 0.3	2023-02-09
11609887	213B	2023-01-31 @ 11:00 am	2023-02-03 @ 1:00 pm	< 0.3	2023-02-09
11609891	213B	2023-01-31 @ 11:00 am	2023-02-03 @ 1:00 pm	< 0.3	2023-02-09
11609892	213C	2023-01-31 @ 11:00 am	2023-02-03 @ 1:00 pm	< 0.3	2023-02-09
11609893	213D	2023-01-31 @ 11:00 am	2023-02-03 @ 1:00 pm	< 0.3	2023-02-09
11609883	214	2023-01-31 @ 10:00 am	2023-02-03 @ 1:00 pm	< 0.3	2023-02-09
11609885	215	2023-01-31 @ 11:00 am	2023-02-03 @ 1:00 pm	0.8 ± 0.5	2023-02-09

Radon test result report for:**ST. PETER PUBLIC SCHOOLS
ST. PETER MIDDLE SCHOOL**

Kit #	Room Id	Started	Ended	pCi/L	Analyzed
11609881	215C	2023-01-31 @ 10:00 am	2023-02-03 @ 1:00 pm	< 0.3	2023-02-09
11609880	217	2023-01-31 @ 10:00 am	2023-02-03 @ 1:00 pm	< 0.3	2023-02-09
11609879	218	2023-01-31 @ 10:00 am	2023-02-03 @ 1:00 pm	< 0.3	2023-02-09
11609878	219	2023-01-31 @ 10:00 am	2023-02-03 @ 1:00 pm	< 0.3	2023-02-09
11609875	219B	2023-01-31 @ 10:00 am	2023-02-03 @ 1:00 pm	< 0.3	2023-02-09
11606728	301	2023-01-31 @ 12:00 pm	2023-02-03 @ 1:00 pm	< 0.3	2023-02-09
11606730	308	2023-01-31 @ 12:00 pm	2023-02-03 @ 1:00 pm	< 0.3	2023-02-09
11606729	323	2023-01-31 @ 12:00 pm	2023-02-03 @ 1:00 pm	< 0.3	2023-02-09
11609850	AUDITORIUM NORTH	2023-01-31 @ 9:00 am	2023-02-03 @ 1:00 pm	1.0 ± 0.5	2023-02-09
11609851	AUDITORIUM SOUTH	2023-01-31 @ 10:00 am	2023-02-03 @ 1:00 pm	0.9 ± 0.5	2023-02-09
11609846	AUDITORIUM STAGE	2023-01-31 @ 9:00 am	2023-02-03 @ 1:00 pm	1.2 ± 0.5	2023-02-09
11606721	BAND	2023-01-31 @ 12:00 pm	2023-02-03 @ 1:00 pm	< 0.3	2023-02-09
11609843	BOYS LOCKER ROOM EAST OFFICE	2023-01-31 @ 9:00 am	2023-02-03 @ 12:00 pm	< 0.3	2023-02-09
11609844	BOYS LOCKER ROOM WEST OFFICE	2023-01-31 @ 9:00 am	2023-02-03 @ 12:00 pm	< 0.3	2023-02-09
11609852	CAFETERIA NORTH	2023-01-31 @ 10:00 am	2023-02-03 @ 1:00 pm	< 0.3	2023-02-09
11606703	CONFERENCE B	2023-01-31 @ 11:00 am	2023-02-03 @ 1:00 pm	0.8 ± 0.5	2023-02-09
11606702	CONFERENCE C	2023-01-31 @ 11:00 am	2023-02-03 @ 1:00 pm	< 0.3	2023-02-09
11609899	CONFERENCE D	2023-01-31 @ 11:00 am	2023-02-03 @ 1:00 pm	< 0.3	2023-02-09
11609898	CONFERENCE E	2023-01-31 @ 11:00 am	2023-02-03 @ 1:00 pm	< 0.3	2023-02-09
11609897	CONFERENCE F	2023-01-31 @ 11:00 am	2023-02-03 @ 1:00 pm	< 0.3	2023-02-09
11606711	COT ROOM	2023-01-31 @ 11:00 am	2023-02-03 @ 1:00 pm	< 0.3	2023-02-09
11609829	D111-1	2023-01-31 @ 9:00 am	2023-02-03 @ 12:00 pm	0.6 ± 0.5	2023-02-09
11609830	D111-2	2023-01-31 @ 9:00 am	2023-02-03 @ 12:00 pm	0.9 ± 0.5	2023-02-09
11609864	D118-1	2023-01-31 @ 10:00 am	2023-02-03 @ 1:00 pm	1.6 ± 0.5	2023-02-09
11609865	D118-2	2023-01-31 @ 10:00 am	2023-02-03 @ 1:00 pm	0.9 ± 0.5	2023-02-09
11609860	D119A-1	2023-01-31 @ 10:00 am	2023-02-03 @ 1:00 pm	< 0.3	2023-02-09
11609861	D119A-2	2023-01-31 @ 10:00 am	2023-02-03 @ 1:00 pm	0.9 ± 0.5	2023-02-09
11609871	D120-1	2023-01-31 @ 10:00 am	2023-02-03 @ 1:00 pm	1.1 ± 0.5	2023-02-09
11609872	D120-2	2023-01-31 @ 10:00 am	2023-02-03 @ 1:00 pm	1.2 ± 0.5	2023-02-09
11606718	D203-1	2023-01-31 @ 11:00 am	2023-02-03 @ 1:00 pm	0.7 ± 0.5	2023-02-09
11606719	D203-2	2023-01-31 @ 11:00 am	2023-02-03 @ 1:00 pm	< 0.3	2023-02-09
11606707	D211A-1	2023-01-31 @ 11:00 am	2023-02-03 @ 1:00 pm	< 0.3	2023-02-09
11606708	D211A-2	2023-01-31 @ 11:00 am	2023-02-03 @ 1:00 pm	1.1 ± 0.5	2023-02-09
11609882	D215B-1	2023-01-31 @ 10:00 am	2023-02-03 @ 1:00 pm	< 0.3	2023-02-09
11609884	D215B-2	2023-01-31 @ 10:00 am	2023-02-03 @ 1:00 pm	0.7 ± 0.5	2023-02-09
11609876	D219C-1	2023-01-31 @ 10:00 am	2023-02-03 @ 1:00 pm	< 0.3	2023-02-09
11609877	D219C-2	2023-01-31 @ 10:00 am	2023-02-03 @ 1:00 pm	< 0.3	2023-02-09

Radon test result report for:

**ST. PETER PUBLIC SCHOOLS
ST. PETER MIDDLE SCHOOL**

Kit #	Room Id	Started	Ended	pCi/L	Analyzed
11606705	DCOMPUTER LAB-1	2023-01-31 @ 11:00 am	2023-02-03 @ 1:00 pm	< 0.3	2023-02-09
11606706	DCOMPUTER LAB-2	2023-01-31 @ 11:00 am	2023-02-03 @ 1:00 pm	< 0.3	2023-02-09
11609854	DLOUNGE-1	2023-01-31 @ 10:00 am	2023-02-03 @ 1:00 pm	< 0.3	2023-02-09
11609855	DLOUNGE-2	2023-01-31 @ 10:00 am	2023-02-03 @ 1:00 pm	< 0.3	2023-02-09
11609847	DRESSING ROOM EAST	2023-01-31 @ 9:00 am	2023-02-03 @ 1:00 pm	1.4 ± 0.5	2023-02-09
11609848	DRESSING ROOM WEST	2023-01-31 @ 9:00 am	2023-02-03 @ 1:00 pm	1.2 ± 0.5	2023-02-09
11606733	FSTORAGE ROOM A	2023-01-31 @ 12:00 pm	2023-02-03 @ 2:00 pm	< 0.3	2023-02-09
11606734	FSTORAGE ROOM B	2023-01-31 @ 12:00 pm	2023-02-03 @ 2:00 pm	< 0.3	2023-02-09
11606735	FSTORAGE ROOM C	2023-01-31 @ 12:00 pm	2023-02-03 @ 2:00 pm	< 0.3	2023-02-09
11606736	FSTORAGE ROOM D	2023-01-31 @ 12:00 pm	2023-02-03 @ 2:00 pm	< 0.3	2023-02-09
11606737	FSTORAGE ROOM E	2023-01-31 @ 12:00 pm	2023-02-03 @ 2:00 pm	< 0.3	2023-02-09
11606738	FSTORAGE ROOM F	2023-01-31 @ 12:00 pm	2023-02-03 @ 2:00 pm	< 0.3	2023-02-09
11609837	GIRLS LOCKER ROOM OFFICE	2023-01-31 @ 9:00 am	2023-02-03 @ 12:00 pm	1.0 ± 0.5	2023-02-09
11609832	GYM B NORTH	2023-01-31 @ 9:00 am	2023-02-03 @ 12:00 pm	0.9 ± 0.5	2023-02-09
11609833	GYM B SOUTH	2023-01-31 @ 9:00 am	2023-02-03 @ 12:00 pm	1.0 ± 0.5	2023-02-09
11609840	GYM NE	2023-01-31 @ 9:00 am	2023-02-03 @ 12:00 pm	2.0 ± 0.6	2023-02-09
11609841	GYM NW	2023-01-31 @ 9:00 am	2023-02-03 @ 12:00 pm	2.4 ± 0.6	2023-02-09
11609839	GYM SE	2023-01-31 @ 9:00 am	2023-02-03 @ 12:00 pm	2.5 ± 0.6	2023-02-09
11609838	GYM STAGE	2023-01-31 @ 9:00 am	2023-02-03 @ 12:00 pm	2.4 ± 0.6	2023-02-09
11609842	GYM SW	2023-01-31 @ 9:00 am	2023-02-03 @ 12:00 pm	1.8 ± 0.6	2023-02-09
11609856	KITCHEN OFFICE	2023-01-31 @ 10:00 am	2023-02-03 @ 1:00 pm	< 0.3	2023-02-09
11606713	MAIN OFFICE	2023-01-31 @ 11:00 am	2023-02-03 @ 1:00 pm	< 0.3	2023-02-09
11609900	MEDIA CENTER NORTH	2023-01-31 @ 11:00 am	2023-02-03 @ 1:00 pm	1.1 ± 0.5	2023-02-09
11606704	MEDIA CENTER SOUTH	2023-01-31 @ 11:00 am	2023-02-03 @ 1:00 pm	< 0.3	2023-02-09
11609896	MEDIA CENTER SOUTH	2023-01-31 @ 11:00 am	2023-02-03 @ 1:00 pm	< 0.3	2023-02-09
11606701	MEDIA CENTER WEST ROOM	2023-01-31 @ 11:00 am	2023-02-03 @ 1:00 pm	< 0.3	2023-02-09
11609894	N MEDIA OFFICE	2023-01-31 @ 11:00 am	2023-02-03 @ 1:00 pm	< 0.3	2023-02-09
11606709	NURSE NORTH	2023-01-31 @ 11:00 am	2023-02-03 @ 1:00 pm	< 0.3	2023-02-09
11606710	NURSE SOUTH	2023-01-31 @ 11:00 am	2023-02-03 @ 1:00 pm	< 0.3	2023-02-09
11609812	OSTORAGE ROOM A	2023-01-31 @ 2:00 pm	2023-02-03 @ 3:00 pm	< 0.3	2023-02-09
11609813	OSTORAGE ROOM B	2023-01-31 @ 2:00 pm	2023-02-03 @ 3:00 pm	< 0.3	2023-02-09
11609836	POOL OFFICE	2023-01-31 @ 9:00 am	2023-02-03 @ 12:00 pm	< 0.3	2023-02-09
11606725	PRACTICE 1	2023-01-31 @ 12:00 pm	2023-02-03 @ 1:00 pm	< 0.3	2023-02-09
11606726	PRACTICE 2	2023-01-31 @ 12:00 pm	2023-02-03 @ 1:00 pm	< 0.3	2023-02-09
11606727	PRACTICE 3	2023-01-31 @ 12:00 pm	2023-02-03 @ 1:00 pm	< 0.3	2023-02-09
11609849	PROP ROOM	2023-01-31 @ 9:00 am	2023-02-03 @ 1:00 pm	1.2 ± 0.5	2023-02-09
11609895	S MEDIA OFFICE	2023-01-31 @ 11:00 am	2023-02-03 @ 1:00 pm	< 0.3	2023-02-09

Radon test result report for:

**ST. PETER PUBLIC SCHOOLS
NORTH ELEMENTARY**

Kit #	Room Id	Started	Ended	pCi/L	Analyzed
11623287	101	2023-01-30 @ 11:00 am	2023-02-03 @ 9:00 am	< 0.3	2023-02-09
11623267	103	2023-01-30 @ 11:00 am	2023-02-03 @ 9:00 am	< 0.3	2023-02-09
11623299	108	2023-01-30 @ 11:00 am	2023-02-03 @ 9:00 am	< 0.3	2023-02-09
11604395	110	2023-01-30 @ 11:00 am	2023-02-03 @ 9:00 am	1.2 ± 0.5	2023-02-09
11604399	114	2023-01-30 @ 11:00 am	2023-02-03 @ 9:00 am	0.9 ± 0.5	2023-02-09
11604400	116	2023-01-30 @ 11:00 am	2023-02-03 @ 9:00 am	1.5 ± 0.5	2023-02-09
11604392	118	2023-01-30 @ 11:00 am	2023-02-03 @ 9:00 am	< 0.3	2023-02-09
11604386	120	2023-01-30 @ 11:00 am	2023-02-03 @ 9:00 am	1.2 ± 0.5	2023-02-09
11604387	122	2023-01-30 @ 11:00 am	2023-02-03 @ 9:00 am	0.9 ± 0.5	2023-02-09
11623288	123	2023-01-30 @ 11:00 am	2023-02-03 @ 9:00 am	1.3 ± 0.5	2023-02-09
11623272	124	2023-01-30 @ 11:00 am	2023-02-03 @ 9:00 am	1.3 ± 0.5	2023-02-09
11623297	125 NORTH	2023-01-30 @ 11:00 am	2023-02-03 @ 9:00 am	2.3 ± 0.5	2023-02-09
11623296	125 WEST	2023-01-30 @ 11:00 am	2023-02-03 @ 9:00 am	2.0 ± 0.6	2023-02-09
11623283	125A	2023-01-30 @ 11:00 am	2023-02-03 @ 9:00 am	0.8 ± 0.5	2023-02-09
11623298	125B	2023-01-30 @ 11:00 am	2023-02-03 @ 9:00 am	1.2 ± 0.5	2023-02-09
11623271	125C	2023-01-30 @ 11:00 am	2023-02-03 @ 9:00 am	1.6 ± 0.5	2023-02-09
11604391	126	2023-01-30 @ 11:00 am	2023-02-03 @ 9:00 am	0.8 ± 0.5	2023-02-09
11604396	126A	2023-01-30 @ 11:00 am	2023-02-03 @ 9:00 am	1.3 ± 0.5	2023-02-09
11623284	126B	2023-01-30 @ 11:00 am	2023-02-03 @ 9:00 am	1.0 ± 0.5	2023-02-09
11623280	127	2023-01-30 @ 11:00 am	2023-02-03 @ 9:00 am	1.4 ± 0.5	2023-02-09
11604385	131	2023-01-30 @ 11:00 am	2023-02-03 @ 9:00 am	< 0.3	2023-02-09
11604373	131B	2023-01-30 @ 11:00 am	2023-02-03 @ 9:00 am	1.2 ± 0.5	2023-02-09
11604375	200	2023-01-30 @ 11:00 am	2023-02-03 @ 9:00 am	1.1 ± 0.5	2023-02-09
11604378	201B	2023-01-30 @ 12:00 pm	2023-02-03 @ 9:00 am	0.6 ± 0.4	2023-02-09
11604376	201C	2023-01-30 @ 12:00 pm	2023-02-03 @ 9:00 am	0.9 ± 0.5	2023-02-09
11604368	209	2023-01-30 @ 12:00 pm	2023-02-03 @ 9:00 am	< 0.3	2023-02-09
11604381	211	2023-01-30 @ 12:00 pm	2023-02-03 @ 9:00 am	0.8 ± 0.5	2023-02-09
11604382	213	2023-01-30 @ 12:00 pm	2023-02-03 @ 9:00 am	1.0 ± 0.5	2023-02-09
11604369	215	2023-01-30 @ 12:00 pm	2023-02-03 @ 9:00 am	< 0.3	2023-02-09
11604383	217	2023-01-30 @ 12:00 pm	2023-02-03 @ 9:00 am	0.8 ± 0.5	2023-02-09
11623253	CAFETERIA EAST	2023-01-30 @ 11:00 am	2023-02-03 @ 9:00 am	< 0.3	2023-02-09
11623254	CAFETERIA WEST	2023-01-30 @ 11:00 am	2023-02-03 @ 9:00 am	1.1 ± 0.5	2023-02-09
11625125	D105-1	2023-01-30 @ 10:00 am	2023-02-03 @ 8:00 am	1.2 ± 0.5	2023-02-09
11623273	D105-2	2023-01-30 @ 10:00 am	2023-02-03 @ 8:00 am	< 0.3	2023-02-09
11623290	D112-1	2023-01-30 @ 11:00 am	2023-02-03 @ 9:00 am	1.4 ± 0.5	2023-02-09
11604398	D112-2	2023-01-30 @ 11:00 am	2023-02-03 @ 9:00 am	0.9 ± 0.5	2023-02-09
11604394	D121-1	2023-01-30 @ 11:00 am	2023-02-03 @ 9:00 am	1.0 ± 0.5	2023-02-09

Radon test result report for:

**ST. PETER PUBLIC SCHOOLS
NORTH ELEMENTARY**

Kit #	Room Id	Started	Ended	pCi/L	Analyzed
11604397	D121-2	2023-01-30 @ 11:00 am	2023-02-03 @ 9:00 am	1.4 ± 0.5	2023-02-09
11623300	D121-2	2023-01-30 @ 11:00 am	2023-02-03 @ 9:00 am	< 0.3	2023-02-09
11604393	D129-1	2023-01-30 @ 11:00 am	2023-02-03 @ 9:00 am	1.8 ± 0.5	2023-02-09
11604379	D203-1	2023-01-30 @ 12:00 pm	2023-02-03 @ 9:00 am	1.2 ± 0.5	2023-02-09
11604367	D203-2	2023-01-30 @ 12:00 pm	2023-02-03 @ 9:00 am	1.1 ± 0.5	2023-02-09
11604377	GYM NORTH	2023-01-30 @ 12:00 pm	2023-02-03 @ 9:00 am	0.6 ± 0.5	2023-02-09
11604364	GYM SOUTH	2023-01-30 @ 12:00 pm	2023-02-03 @ 9:00 am	1.0 ± 0.5	2023-02-09
11623268	KITCHEN OFFICE	2023-01-30 @ 11:00 am	2023-02-03 @ 9:00 am	1.5 ± 0.5	2023-02-09
11604390	NURSE'S OFFICE	2023-01-30 @ 11:00 am	2023-02-03 @ 9:00 am	1.1 ± 0.5	2023-02-09
11604388	OFFICE	2023-01-30 @ 11:00 am	2023-02-03 @ 9:00 am	< 0.3	2023-02-09
11604374	OFFICE CONFERENCE ROOM	2023-01-30 @ 11:00 am	2023-02-03 @ 9:00 am	0.9 ± 0.5	2023-02-09
11604389	OFFICE NORTH OF NURSE'S OFFICE	2023-01-30 @ 11:00 am	2023-02-03 @ 9:00 am	< 0.3	2023-02-09
11604380	RECEPTION	2023-01-30 @ 12:00 pm	2023-02-03 @ 8:00 am	1.1 ± 0.5	2023-02-09
11604365	SOUTH OF RECEPTION	2023-01-30 @ 12:00 pm	2023-02-03 @ 9:00 am	1.0 ± 0.5	2023-02-09
11604363	STAGE	2023-01-30 @ 12:00 pm	2023-02-03 @ 9:00 am	0.8 ± 0.5	2023-02-09

Radon test result report for:

**ST. PETER PUBLIC SCHOOLS
SOUTH ELEMENTARY**

Kit #	Room Id	Started	Ended	pCi/L	Analyzed
11604122	004	2023-01-30 @ 1:00 pm	2023-02-03 @ 11:00 am	1.0 ± 0.4	2023-02-09
11604126	016	2023-01-30 @ 1:00 pm	2023-02-03 @ 11:00 am	2.3 ± 0.5	2023-02-09
11604156	102	2023-01-30 @ 2:00 pm	2023-02-03 @ 11:00 am	1.4 ± 0.5	2023-02-09
11604155	103	2023-01-30 @ 2:00 pm	2023-02-03 @ 11:00 am	< 0.3	2023-02-09
11604149	104	2023-01-30 @ 2:00 pm	2023-02-03 @ 11:00 am	1.1 ± 0.5	2023-02-09
11604141	107	2023-01-30 @ 2:00 pm	2023-02-03 @ 11:00 am	< 0.3	2023-02-09
11604148	109	2023-01-30 @ 2:00 pm	2023-02-03 @ 11:00 am	0.9 ± 0.5	2023-02-09
11604143	110	2023-01-30 @ 2:00 pm	2023-02-03 @ 11:00 am	1.3 ± 0.5	2023-02-09
11604133	111	2023-01-30 @ 2:00 pm	2023-02-03 @ 11:00 am	1.1 ± 0.5	2023-02-09
11604129	112	2023-01-30 @ 2:00 pm	2023-02-03 @ 11:00 am	1.2 ± 0.5	2023-02-09
11604130	113	2023-01-30 @ 2:00 pm	2023-02-03 @ 11:00 am	1.1 ± 0.5	2023-02-09
11604134	114	2023-01-30 @ 2:00 pm	2023-02-03 @ 11:00 am	1.1 ± 0.5	2023-02-09
11604119	116	2023-01-30 @ 1:00 pm	2023-02-03 @ 10:00 am	0.9 ± 0.5	2023-02-09
11604116	118	2023-01-30 @ 1:00 pm	2023-02-03 @ 10:00 am	1.3 ± 0.5	2023-02-09
11604115	119	2023-01-30 @ 1:00 pm	2023-02-03 @ 10:00 am	0.9 ± 0.5	2023-02-09
11604108	121	2023-01-30 @ 1:00 pm	2023-02-03 @ 10:00 am	0.9 ± 0.5	2023-02-09
11604105	122	2023-01-30 @ 1:00 pm	2023-02-03 @ 10:00 am	< 0.3	2023-02-09
11604107	123	2023-01-30 @ 1:00 pm	2023-02-03 @ 10:00 am	1.0 ± 0.5	2023-02-09
11604164	125	2023-01-30 @ 2:00 pm	2023-02-03 @ 11:00 am	< 0.3	2023-02-09
11604163	126	2023-01-30 @ 2:00 pm	2023-02-03 @ 11:00 am	0.8 ± 0.5	2023-02-09
11604161	127	2023-01-30 @ 2:00 pm	2023-02-03 @ 11:00 am	1.1 ± 0.5	2023-02-09
11604114	132	2023-01-30 @ 1:00 pm	2023-02-03 @ 10:00 am	1.7 ± 0.5	2023-02-09
11604106	149	2023-01-30 @ 1:00 pm	2023-02-03 @ 10:00 am	1.0 ± 0.5	2023-02-09
11604123	150	2023-01-30 @ 1:00 pm	2023-02-03 @ 11:00 am	1.6 ± 0.5	2023-02-09
11604132	151	2023-01-30 @ 2:00 pm	2023-02-03 @ 11:00 am	1.1 ± 0.5	2023-02-09
11604136	152	2023-01-30 @ 2:00 pm	2023-02-03 @ 11:00 am	1.7 ± 0.5	2023-02-09
11604137	153	2023-01-30 @ 2:00 pm	2023-02-03 @ 11:00 am	1.0 ± 0.4	2023-02-09
11604131	157	2023-01-30 @ 2:00 pm	2023-02-03 @ 11:00 am	0.8 ± 0.5	2023-02-09
11604142	159	2023-01-30 @ 2:00 pm	2023-02-03 @ 11:00 am	1.2 ± 0.5	2023-02-09
11604147	159A	2023-01-30 @ 2:00 pm	2023-02-03 @ 11:00 am	0.7 ± 0.5	2023-02-09
11604140	164	2023-01-30 @ 2:00 pm	2023-02-03 @ 11:00 am	1.5 ± 0.5	2023-02-09
11604138	165	2023-01-30 @ 2:00 pm	2023-02-03 @ 11:00 am	0.7 ± 0.4	2023-02-09
11604127	167	2023-01-30 @ 2:00 pm	2023-02-03 @ 11:00 am	1.2 ± 0.5	2023-02-09
11604144	167 BACK ROOM	2023-01-30 @ 2:00 pm	2023-02-03 @ 11:00 am	1.1 ± 0.5	2023-02-09
11604145	169	2023-01-30 @ 2:00 pm	2023-02-03 @ 11:00 am	1.5 ± 0.5	2023-02-09
11604151	170A	2023-01-30 @ 2:00 pm	2023-02-03 @ 11:00 am	1.2 ± 0.5	2023-02-09
11604152	170B	2023-01-30 @ 2:00 pm	2023-02-03 @ 11:00 am	0.9 ± 0.5	2023-02-09

Radon test result report for:

**ST. PETER PUBLIC SCHOOLS
SOUTH ELEMENTARY**

Kit #	Room Id	Started	Ended	pCi/L	Analyzed
11604153	171A	2023-01-30 @ 2:00 pm	2023-02-03 @ 11:00 am	0.9 ± 0.5	2023-02-09
11604154	171B	2023-01-30 @ 2:00 pm	2023-02-03 @ 11:00 am	< 0.3	2023-02-09
11604150	171C	2023-01-30 @ 2:00 pm	2023-02-03 @ 11:00 am	0.8 ± 0.5	2023-02-09
11604158	180	2023-01-30 @ 2:00 pm	2023-02-03 @ 11:00 am	< 0.3	2023-02-09
11604157	180A	2023-01-30 @ 2:00 pm	2023-02-03 @ 11:00 am	< 0.3	2023-02-09
11604162	181	2023-01-30 @ 2:00 pm	2023-02-03 @ 11:00 am	< 0.3	2023-02-09
11604165	182	2023-01-30 @ 2:00 pm	2023-02-03 @ 11:00 am	0.6 ± 0.4	2023-02-09
11604166	184	2023-01-30 @ 2:00 pm	2023-02-03 @ 10:00 am	1.0 ± 0.5	2023-02-09
11604104	29	2023-01-30 @ 1:00 pm	2023-02-03 @ 10:00 am	0.9 ± 0.5	2023-02-09
11604112	CAFETERIA SOUTH	2023-01-30 @ 1:00 pm	2023-02-03 @ 11:00 am	0.7 ± 0.5	2023-02-09
11604113	CAFETERIA WEST	2023-01-30 @ 1:00 pm	2023-02-03 @ 11:00 am	< 0.3	2023-02-09
11604102	CHANGING ROOM	2023-01-30 @ 12:00 pm	2023-02-03 @ 10:00 am	< 0.3	2023-02-09
11604124	D018-1	2023-01-30 @ 1:00 pm	2023-02-03 @ 11:00 am	2.1 ± 0.5	2023-02-09
11604125	D018-2	2023-01-30 @ 1:00 pm	2023-02-03 @ 11:00 am	1.9 ± 0.5	2023-02-09
11604139	D108-1	2023-01-30 @ 2:00 pm	2023-02-03 @ 11:00 am	1.3 ± 0.5	2023-02-09
11604146	D108-2	2023-01-30 @ 2:00 pm	2023-02-03 @ 11:00 am	0.8 ± 0.4	2023-02-09
11604118	D117-1	2023-01-30 @ 1:00 pm	2023-02-03 @ 10:00 am	1.3 ± 0.5	2023-02-09
11604117	D117-2	2023-01-30 @ 1:00 pm	2023-02-03 @ 10:00 am	0.8 ± 0.5	2023-02-09
11604109	D120-1	2023-01-30 @ 1:00 pm	2023-02-03 @ 10:00 am	1.3 ± 0.5	2023-02-09
11604110	D120-2	2023-01-30 @ 1:00 pm	2023-02-03 @ 10:00 am	1.0 ± 0.5	2023-02-09
11604159	D128-1	2023-01-30 @ 2:00 pm	2023-02-03 @ 11:00 am	1.0 ± 0.5	2023-02-09
11604160	D128-2	2023-01-30 @ 2:00 pm	2023-02-03 @ 11:00 am	0.6 ± 0.5	2023-02-09
11604120	D130-1	2023-01-30 @ 1:00 pm	2023-02-03 @ 11:00 am	1.1 ± 0.5	2023-02-09
11604121	D130-2	2023-01-30 @ 1:00 pm	2023-02-03 @ 11:00 am	1.2 ± 0.5	2023-02-09
11604371	DC116-1	2023-01-30 @ 12:00 pm	2023-02-03 @ 10:00 am	< 0.3	2023-02-09
11604384	DC116-2	2023-01-30 @ 12:00 pm	2023-02-03 @ 10:00 am	0.8 ± 0.4	2023-02-09
11604103	GYM EAST	2023-01-30 @ 12:00 pm	2023-02-03 @ 10:00 am	< 0.3	2023-02-09
11604101	GYM OFFICE	2023-01-30 @ 12:00 pm	2023-02-03 @ 10:00 am	< 0.3	2023-02-09
11604372	GYM WEST	2023-01-30 @ 12:00 pm	2023-02-03 @ 10:00 am	< 0.3	2023-02-09
11604111	KITCHEN OFFICE	2023-01-30 @ 1:00 pm	2023-02-03 @ 10:00 am	0.9 ± 0.5	2023-02-09
11604135	MAIN OFFICE	2023-01-30 @ 2:00 pm	2023-02-03 @ 11:00 am	< 0.3	2023-02-09
11604128	OFFICE CONFERENCE ROOM	2023-01-30 @ 2:00 pm	2023-02-03 @ 11:00 am	< 0.3	2023-02-09
11604167	PRINCIPAL'S OFFICE	2023-01-30 @ 2:00 pm	2023-02-03 @ 11:00 am	< 0.3	2023-02-09

Radon test result report for:

**ST. PETER PUBLIC SCHOOLS
HOFFMAN BUILDING**

Kit #	Room Id	Started	Ended	pCi/L	Analyzed
11609827	102	2023-01-31 @ 8:00 am	2023-02-03 @ 12:00 pm	1.1 ± 0.5	2023-02-09
11609825	104	2023-01-31 @ 8:00 am	2023-02-03 @ 12:00 pm	< 0.3	2023-02-09
11609819	108	2023-01-31 @ 8:00 am	2023-02-03 @ 12:00 pm	1.4 ± 0.5	2023-02-09
11609823	108	2023-01-31 @ 8:00 am	2023-02-03 @ 12:00 pm	< 0.3	2023-02-09
11609820	110A	2023-01-31 @ 8:00 am	2023-02-03 @ 12:00 pm	1.4 ± 0.5	2023-02-09
11609816	111	2023-01-31 @ 8:00 am	2023-02-03 @ 12:00 pm	< 0.3	2023-02-09
11609824	113	2023-01-31 @ 8:00 am	2023-02-03 @ 12:00 pm	1.8 ± 0.6	2023-02-09
11609815	114	2023-01-31 @ 8:00 am	2023-02-03 @ 12:00 pm	< 0.3	2023-02-09
11609814	115	2023-01-31 @ 8:00 am	2023-02-03 @ 12:00 pm	< 0.3	2023-02-09
11609828	119	2023-01-31 @ 8:00 am	2023-02-03 @ 12:00 pm	0.8 ± 0.5	2023-02-09
11609826	131	2023-01-31 @ 8:00 am	2023-02-03 @ 12:00 pm	1.0 ± 0.5	2023-02-09
11609822	D109-1	2023-01-31 @ 8:00 am	2023-02-03 @ 12:00 pm	0.9 ± 0.5	2023-02-09
11609821	D109-2	2023-01-31 @ 8:00 am	2023-02-03 @ 12:00 pm	1.2 ± 0.5	2023-02-09
11609817	D112-1	2023-01-31 @ 8:00 am	2023-02-03 @ 12:00 pm	1.1 ± 0.5	2023-02-09
11609818	D112-2	2023-01-31 @ 8:00 am	2023-02-03 @ 12:00 pm	1.0 ± 0.5	2023-02-09

Radon test result report for:

**ST. PETER PUBLIC SCHOOLS
MVED BUILDING**

Kit #	Room Id	Started	Ended	pCi/L	Analyzed
11604175	102	2023-01-30 @ 3:00 pm	2023-02-03 @ 7:00 am	< 0.3	2023-02-09
11604179	106	2023-01-30 @ 3:00 pm	2023-02-03 @ 7:00 am	< 0.3	2023-02-09
11604180	107	2023-01-30 @ 3:00 pm	2023-02-03 @ 8:00 am	< 0.3	2023-02-09
11604181	110	2023-01-30 @ 3:00 pm	2023-02-03 @ 8:00 am	0.8 ± 0.5	2023-02-09
11604182	112	2023-01-30 @ 3:00 pm	2023-02-03 @ 2:00 pm	< 0.3	2023-02-09
11604183	114	2023-01-30 @ 3:00 pm	2023-02-03 @ 8:00 am	< 0.3	2023-02-09
11604188	116	2023-01-30 @ 3:00 pm	2023-02-03 @ 8:00 am	< 0.3	2023-02-09
11604193	117	2023-01-30 @ 3:00 pm	2023-02-03 @ 8:00 am	1.0 ± 0.5	2023-02-09
11604194	117 CALM ROOM	2023-01-30 @ 3:00 pm	2023-02-03 @ 8:00 am	< 0.3	2023-02-09
11604187	118	2023-01-30 @ 3:00 pm	2023-02-03 @ 8:00 am	0.7 ± 0.5	2023-02-09
11604171	201	2023-01-30 @ 3:00 pm	2023-02-03 @ 7:00 am	1.0 ± 0.5	2023-02-09
11604176	202	2023-01-30 @ 3:00 pm	2023-02-03 @ 7:00 am	< 0.3	2023-02-09
11604172	203	2023-01-30 @ 3:00 pm	2023-02-03 @ 8:00 am	< 0.3	2023-02-09
11604168	204	2023-01-30 @ 3:00 pm	2023-02-03 @ 7:00 am	< 0.3	2023-02-09
11604173	205	2023-01-30 @ 3:00 pm	2023-02-03 @ 7:00 am	0.8 ± 0.5	2023-02-09
11604174	207	2023-01-30 @ 3:00 pm	2023-02-03 @ 7:00 am	< 0.3	2023-02-09
11609802	300	2023-01-30 @ 4:00 pm	2023-02-03 @ 8:00 am	< 0.3	2023-02-09
11609804	401	2023-01-30 @ 4:00 pm	2023-02-03 @ 8:00 am	< 0.3	2023-02-09
11604192	402	2023-01-30 @ 3:00 pm	2023-02-03 @ 8:00 am	< 0.3	2023-02-09
11609803	404	2023-01-30 @ 4:00 pm	2023-02-03 @ 8:00 am	0.7 ± 0.5	2023-02-09
11604185	500	2023-01-30 @ 3:00 pm	2023-02-03 @ 8:00 am	< 0.3	2023-02-09
11604191	501	2023-01-30 @ 3:00 pm	2023-02-03 @ 8:00 am	1.1 ± 0.5	2023-02-09
11604186	502	2023-01-30 @ 3:00 pm	2023-02-03 @ 8:00 am	< 0.3	2023-02-09
11604190	503	2023-01-30 @ 3:00 pm	2023-02-03 @ 8:00 am	< 0.3	2023-02-09
11604177	D104-1	2023-01-30 @ 3:00 pm	2023-02-03 @ 7:00 am	< 0.3	2023-02-09
11604178	D104-2	2023-01-30 @ 3:00 pm	2023-02-03 @ 7:00 am	< 0.3	2023-02-09
11604189	D118 OFFICE-1	2023-01-30 @ 3:00 pm	2023-02-03 @ 8:00 am	< 0.3	2023-02-09
11604184	D118 OFFICE-2	2023-01-30 @ 3:00 pm	2023-02-03 @ 8:00 am	< 0.3	2023-02-09
11604169	D206-1	2023-01-30 @ 3:00 pm	2023-02-03 @ 7:00 am	< 0.3	2023-02-09
11604170	D206-2	2023-01-30 @ 3:00 pm	2023-02-03 @ 7:00 am	< 0.3	2023-02-09
11604196	DOFFICE BREAK ROOM-1	2023-01-30 @ 4:00 pm	2023-02-03 @ 7:00 am	< 0.3	2023-02-09
11604197	DOFFICE BREAK ROOM-2	2023-01-30 @ 4:00 pm	2023-02-03 @ 7:00 am	0.9 ± 0.5	2023-02-09
11609805	FSTORAGE ROOM A	2023-01-30 @ 4:00 pm	2023-02-03 @ 7:00 am	< 0.3	2023-02-09
11609806	FSTORAGE ROOM B	2023-01-30 @ 4:00 pm	2023-02-03 @ 7:00 am	< 0.3	2023-02-09
11609807	FSTORAGE ROOM C	2023-01-30 @ 4:00 pm	2023-02-03 @ 7:00 am	< 0.3	2023-02-09
11609808	FSTORAGE ROOM D	2023-01-30 @ 4:00 pm	2023-02-03 @ 7:00 am	< 0.3	2023-02-09
11609809	FSTORAGE ROOM E	2023-01-30 @ 4:00 pm	2023-02-03 @ 7:00 am	< 0.3	2023-02-09

Radon test result report for:**ST. PETER PUBLIC SCHOOLS
MVED BUILDING**

Kit #	Room Id	Started	Ended	pCi/L	Analyzed
11604195	MAIN OFFICE	2023-01-30 @ 3:00 pm	2023-02-03 @ 7:00 am	< 0.3	2023-02-09
11604198	NORTH OFFICE	2023-01-30 @ 4:00 pm	2023-02-03 @ 7:00 am	< 0.3	2023-02-09
11604199	NW OFFICE	2023-01-30 @ 4:00 pm	2023-02-03 @ 7:00 am	< 0.3	2023-02-09
11609810	OSTORAGE ROOM A	2023-01-30 @ 4:00 pm	2023-02-03 @ 3:00 pm	< 0.3	2023-02-09
11609811	OSTORAGE ROOM B	2023-01-30 @ 4:00 pm	2023-02-03 @ 3:00 pm	< 0.3	2023-02-09
11609801	SW OFFICE	2023-01-30 @ 4:00 pm	2023-02-03 @ 7:00 am	0.6 ± 0.4	2023-02-09
11604200	WEST OFFICE	2023-01-30 @ 4:00 pm	2023-02-03 @ 7:00 am	< 0.3	2023-02-09

Air Chek 1936 Butler Bridge Rd, Mills River, NC 28759-3892 Phone: (828) 684-0893 Fax: (828) 684-8498

Hoffmann Learning Center

2001 Sheppard Drive

(507) 934-9820

- Detectors
- Duplicates

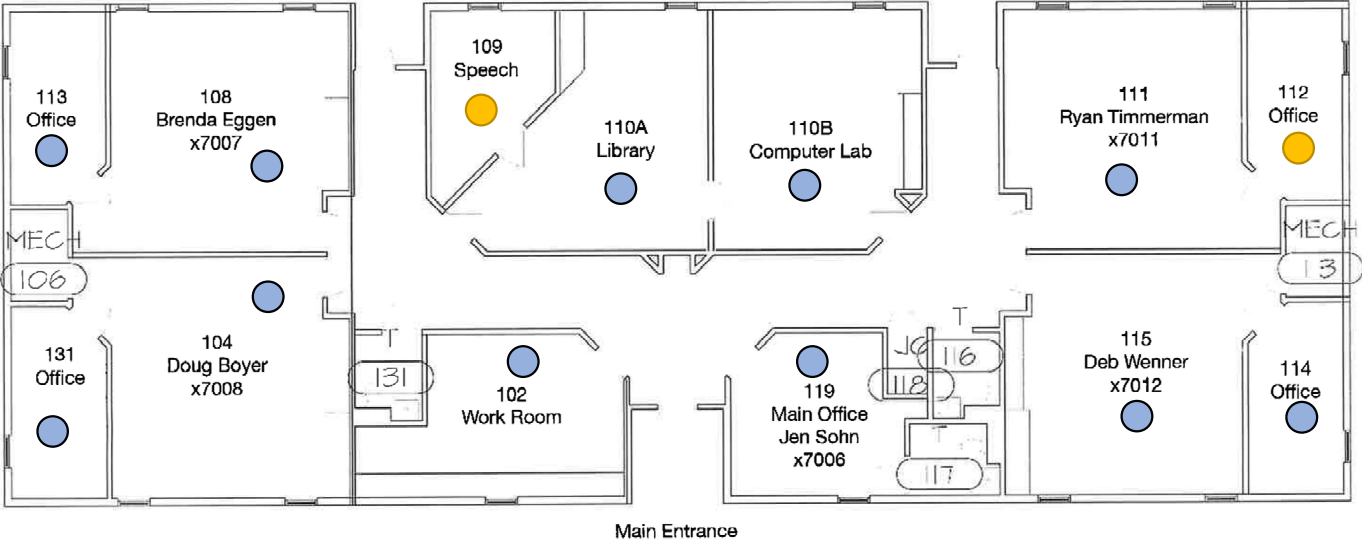

North Elementary 1st Floor

815 N 9th Street

507-934-3260

- Detectors
- Duplicates

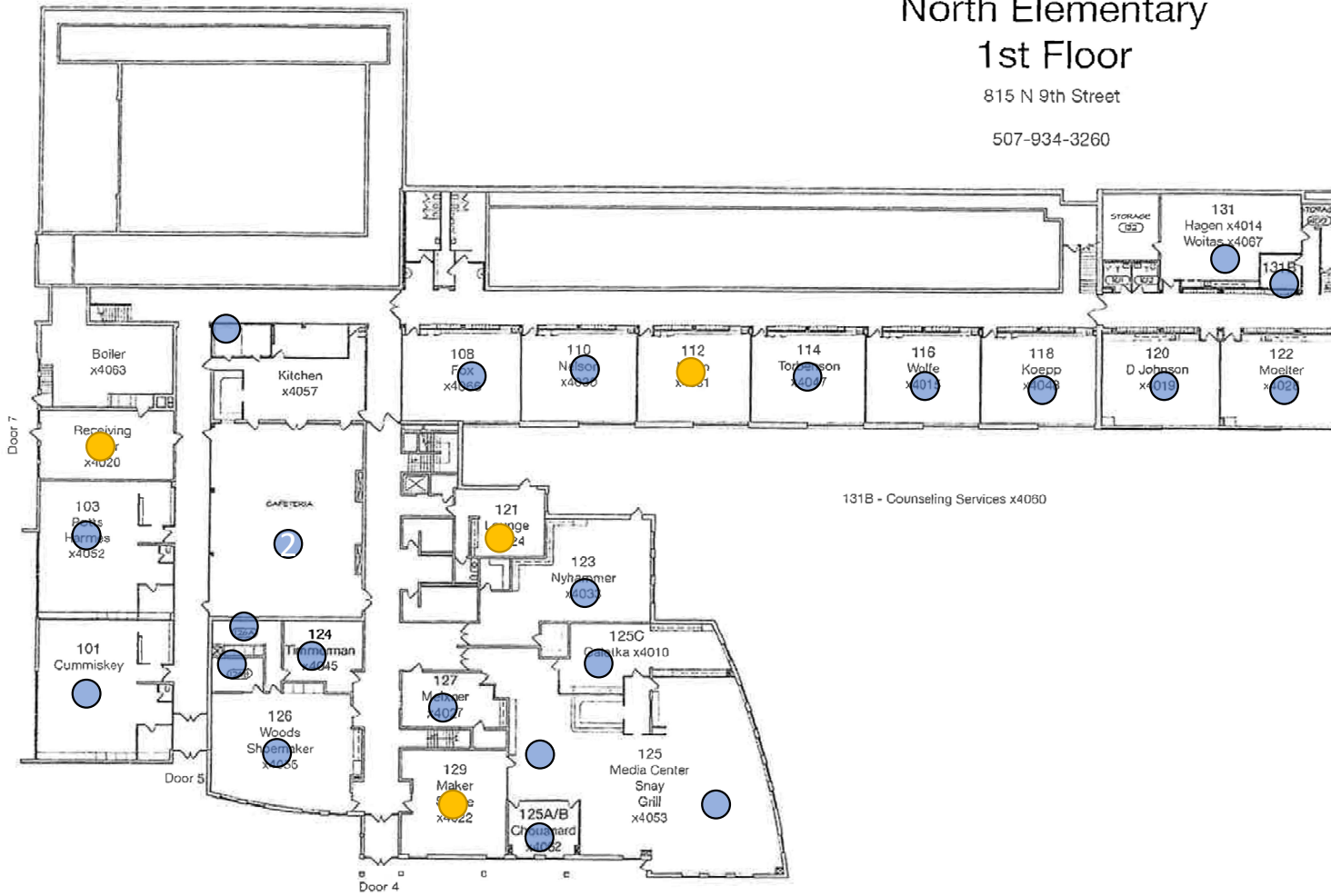

North Elementary 2nd Floor

815 N 9th Street

507-934-3260

- Detectors
- Duplicates



- Principal - Darin Doherty x4006
- Office - Barb Berg x4005
- Reception - Erica Walters x4038
- Conference Room x4058
- Nurse - Mary Powers x4008
- Health Office - Marcia Wenner x4008
- 200 - Maren Kind x4002
- 208 - Melissa Engel x4054
- 210 - Dave Ribar x4036
- 201C - Madison Bergren x4012
- 201C - Jordyn Jarr x4012
- 201C - Christi Maloney x4012

FLOOR PLAN

FIRST FLOOR

- Detectors
- Duplicates

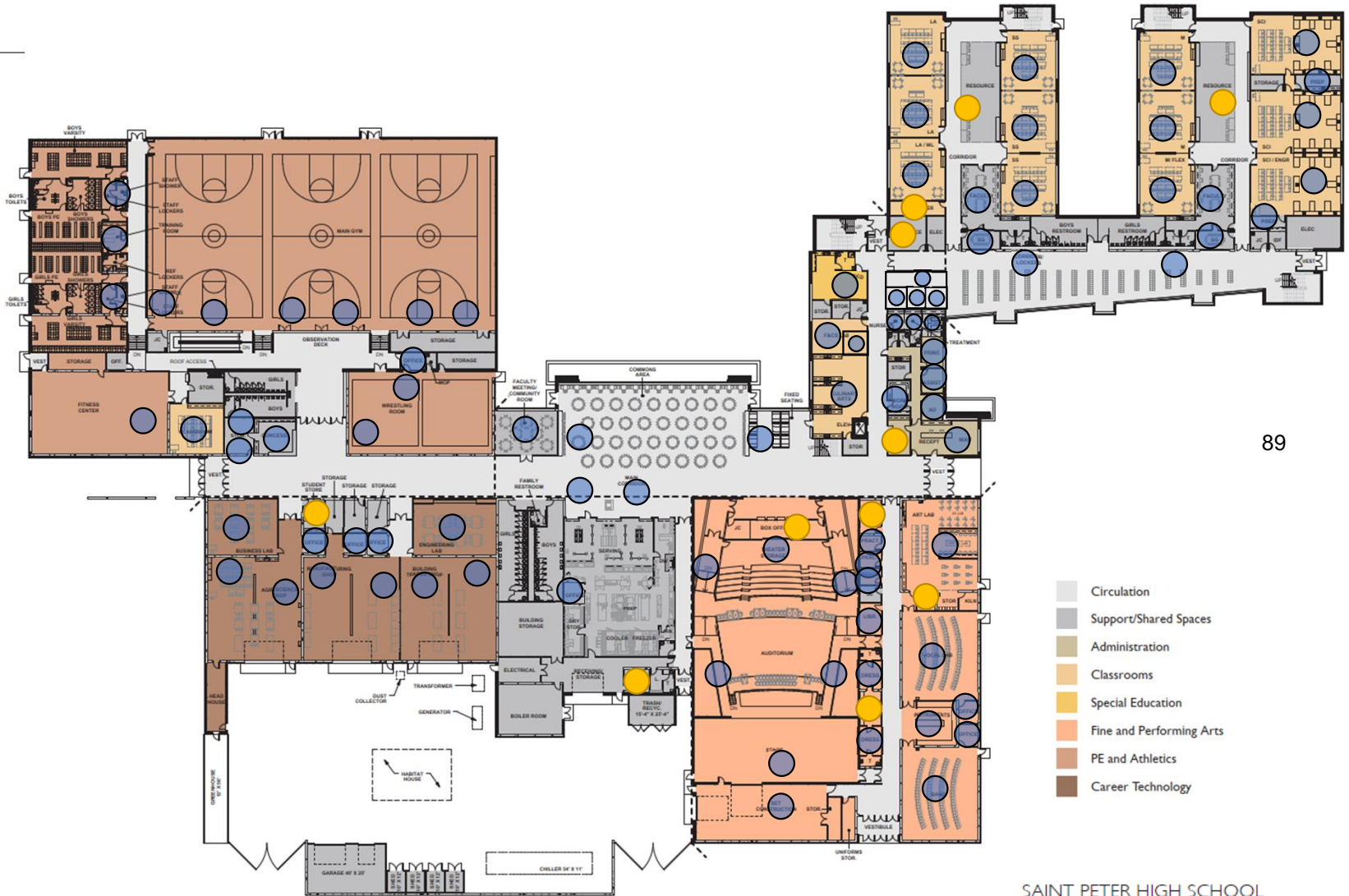

- Circulation
- Support/Shared Spaces
- Administration
- Classrooms
- Special Education
- Fine and Performing Arts
- PE and Athletics
- Career Technology

FLOOR PLAN

SECOND FLOOR

- Detectors
- Duplicates

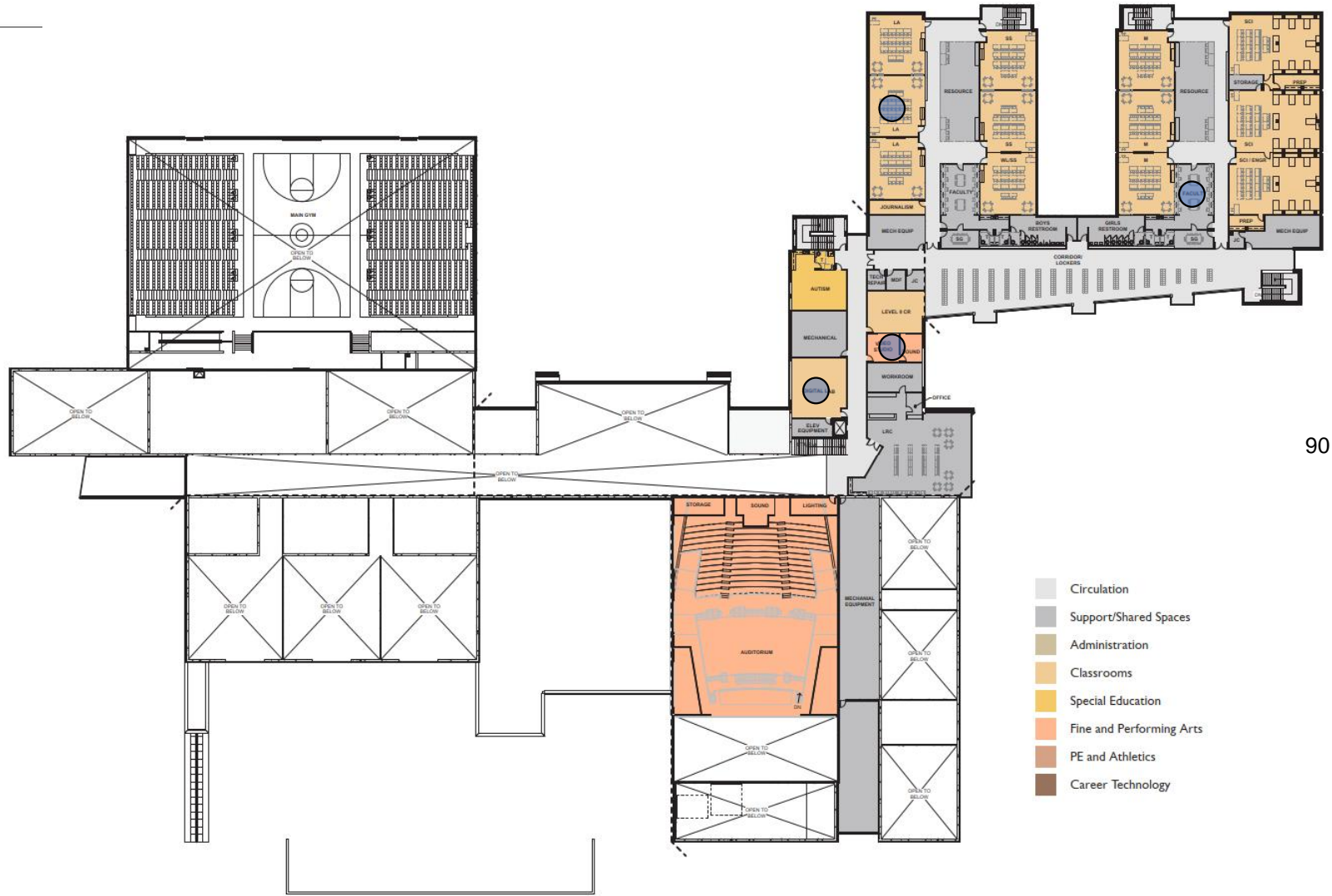

Middle School Floor 1

Address: 100 Lincoln Drive

District Office Main: 507-934-5073
 Early Childhood Main: 507-934-4211
 Middle School Main: 507-934-4210

- Detectors
- Duplicates

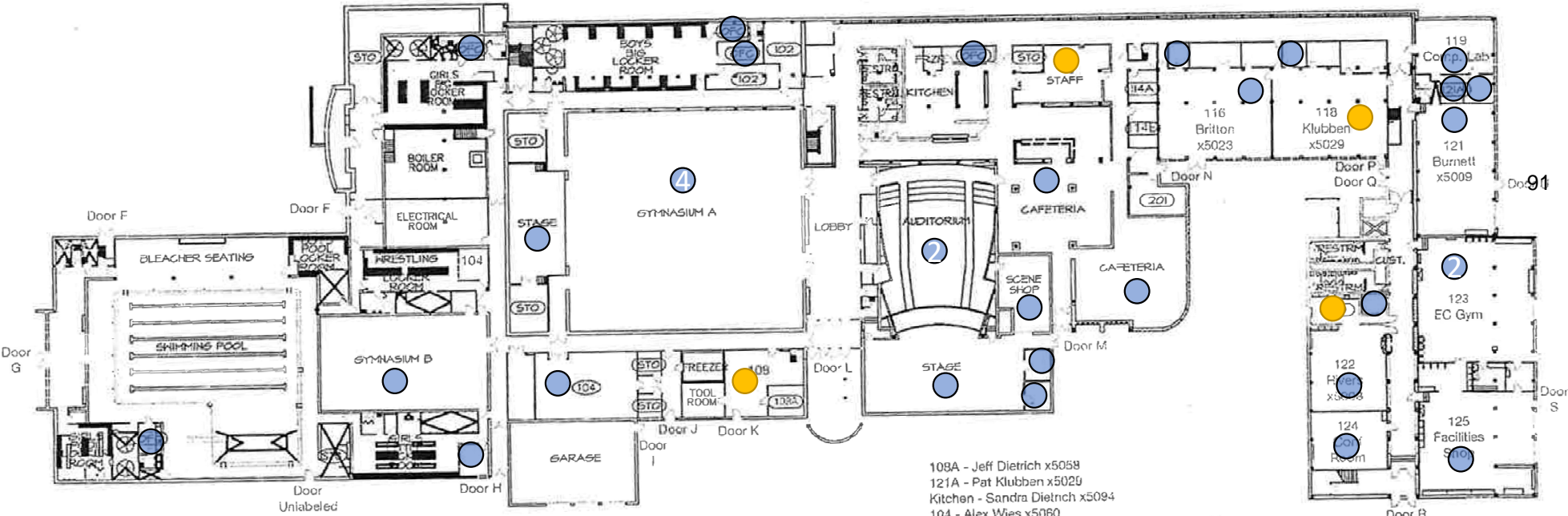

- 108A - Jeff Dietrich x5058
- 121A - Pat Klubben x5029
- Kitchen - Sandra Dietrich x5094
- 104 - Alex Wies x5060
- Big Boys Locker Room Office - Bill Stuewe x5059
- Big Girls Locker Room Office - Abby Moore x5012
- Small Girls Locker Room Office - Kris Sandborg x5062

Middle School
Floor 3

Address: 100 Lincoln Drive
District Office Main: 507-934-5073
Early Childhood Main: 507-934-4211
Middle School Main: 507-934-4210

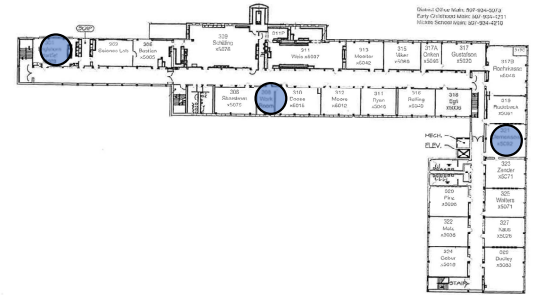

Middle School
Floor 2

Address: 100 Lincoln Drive

District Office Main: 507-934-5073
Early Childhood Main: 507-934-4211
Middle School Main: 507-934-4210

Middle School

- 207A - Jon Graff x5018
- 207 - Kim Deming x5011
- 207 - Jean Baca x5072
- 207D - Ashley Hughes x5025
- 207C - Jen Maldonado x5086
- 230E - Steve Alger x5099
- 230C - Michelle Doose x5014
- 230B - Sarah Mages x5024
- 230D - Missy Terpstra x5095
- 230A - Cheryl Tinnemke x5080
- Nurse - Rachel Fitch x5093
- Nurse - Angela Bruns x5021
- 205A - Jon Hughes x5101
- Media Center - Karen Gray x1012
- Media Center - Michel Freeman x5068

- 202A - Abels x5097
- 202A - Haugh x6103
- 202A - Shoemaker x5053

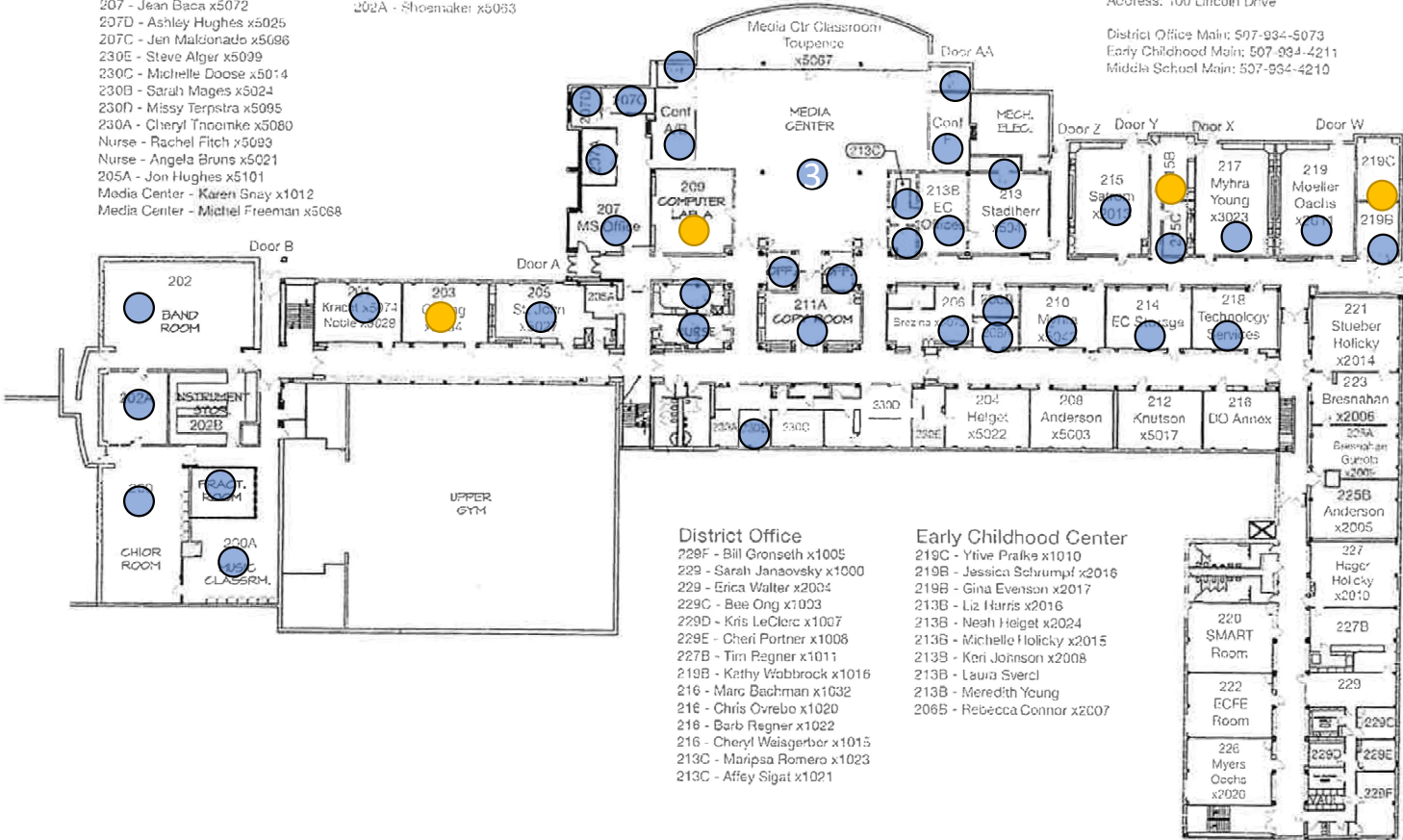

District Office

- 229F - Bill Gronseth x1005
- 229 - Sarah Janaovsky x1000
- 229 - Erica Walter x2004
- 229C - Bee Ong x1003
- 229D - Kris LeClerc x1007
- 229E - Cheryl Portner x1006
- 227B - Tim Regner x1011
- 219B - Kathy Wabbrock x1016
- 216 - Marc Bachman x1032
- 216 - Chris Ovrebo x1020
- 216 - Barb Regner x1022
- 216 - Cheryl Weisgerber x1015
- 213C - Maripisa Romero x1023
- 213C - Afey Sigat x1021

Early Childhood Center

- 219C - Yvive Pralke x1010
- 219B - Jessica Schruppf x2016
- 219B - Gina Evenson x2017
- 213B - Liz Harris x2016
- 213B - Neah Helgot x2024
- 213B - Michelle Holicky x2015
- 213B - Keri Johnson x2008
- 213B - Laura Svercl
- 213B - Meredith Young
- 2065 - Rebecca Connor x2007

- Detectors ⁹²
- Duplicates

South Elementary 20-21

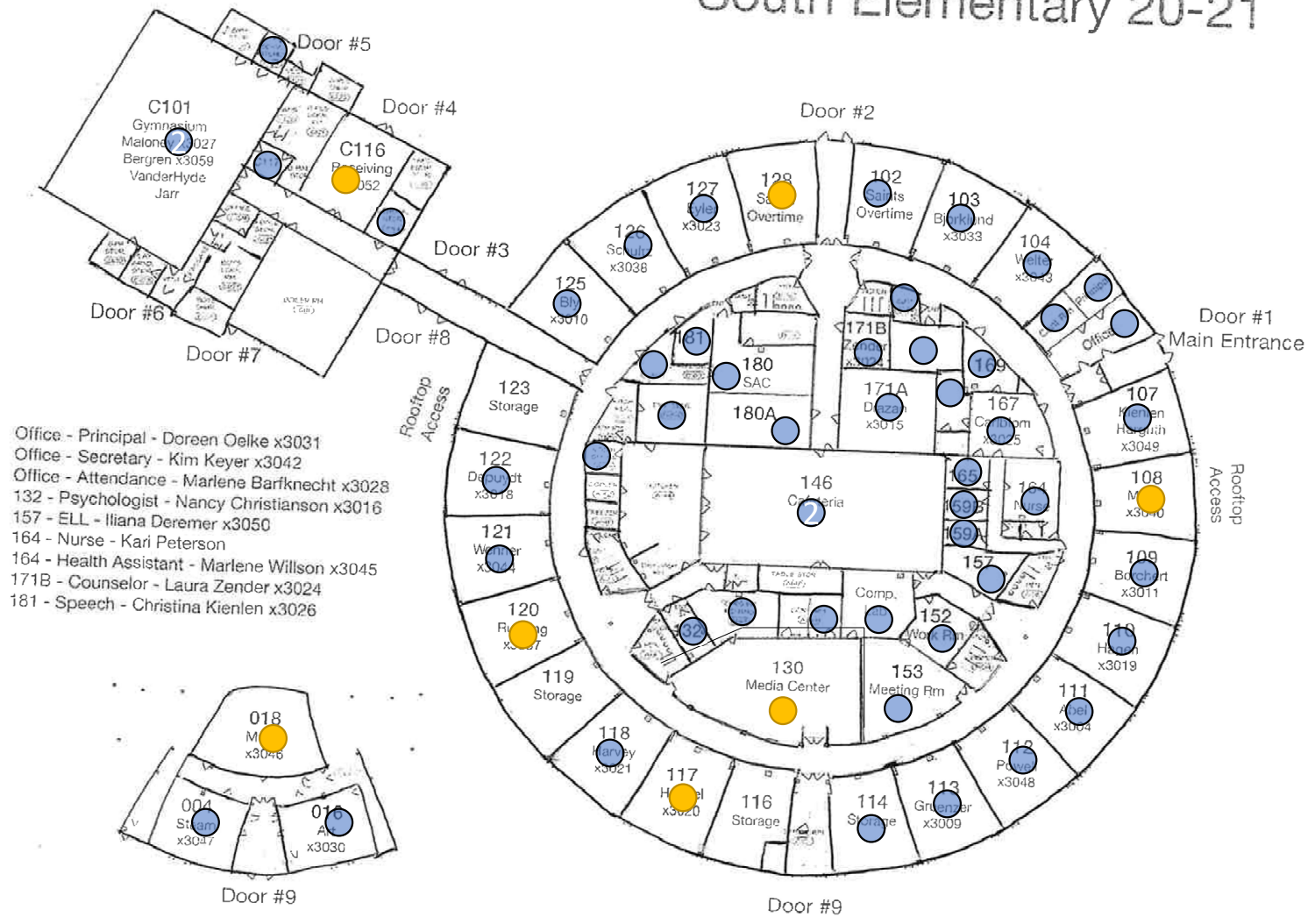

- Office - Principal - Doreen Oelke x3031
- Office - Secretary - Kim Keyer x3042
- Office - Attendance - Marlene Barfknecht x3028
- 132 - Psychologist - Nancy Christianson x3016
- 157 - ELL - Iliana Deremer x3050
- 164 - Nurse - Kari Peterson
- 164 - Health Assistant - Marlene Willson x3045
- 171B - Counselor - Laura Zender x3024
- 181 - Speech - Christina Kienlen x3026

- Detectors
- Duplicates