

Agenda of Regular Meeting

The Board of Trustees Ector County Independent School District

A Regular Meeting of the Board of Trustees of Ector County Independent School District will be held April 16, 2024, beginning at 6:00 PM.

The subjects to be discussed or considered are listed below. Items do not have to be taken in the same order as shown on this meeting notice.

1. Call to Order - Roll Call
2. Verification of Compliance with Open Meeting Law - this is to certify that the provisions of Section 551.001 of the Texas Government code have been met in connection with public notice of this meeting.
3. Pledge Allegiance to US and Texas Flags:
ECISD Transition Learning Center Students Josue Rodriguez and Jaden Walker
4. Invocation: Pastor Joshua Zuniga, Kingdom Church
5. Special Presentations:
Presentation of 2024 CoSN Chief Technology Officer of the Year Award to Dr. Kellie Wilks
Recognition of Permian High School Students who Qualified for International Thespian Contest
Recognition of CTE State Qualifiers
Presentation of Spirit Scholarship Winners from Odessa High School and Permian High School
6. Opening Remarks by Superintendent
7. Public Comment
8. Bond 2023
 - A. Bond 2023 Update 3
9. Action Items
 - A. Discussion of and Request for Approval of Purchases over \$50,000 17
 - B. Discussion of and Request for Approval for the Superintendent to Negotiate and Enter into a Lease Agreement with Sunset Golf & Country Club, LLC. Concerning the Property Located at 9301 Andrews Hwy., Odessa, Texas 79768 21
10. Consent Agenda 22
 - A. Request for Approval of Minutes of Meetings 23
 - B. Request for Approval of Bills for Payment 36
 - C. Request for Approval of Acceptance of Donations Over \$10,000 53
 - D. Request for Approval of Odessa HS Business Professionals of America Students Out-of-State Travel to Chicago, IL 63

| | |
|--|-----|
| E. Request for Approval of Odessa HS Texas Association of Future Educators' Students Out-of-State Travel to Washington, DC | 66 |
| F. Request for Approval of Permian HS Texas Business Professionals of America Students Out-of-State Travel to Chicago, Illinois | 69 |
| G. Request for Approval of Instructional Materials Allotment Certification of Provisions of Instructional Materials Survey 2024-2025 | 72 |
| H. Request for Approval of Low Attendance Waiver | 97 |
| 11. Report/Discussion Items | |
| A. Presentation of the Fine Arts Program | 98 |
| B. Budget Update Discussion | 115 |
| C. Board of Trustees' Continuing Education Report | 116 |
| 12. Possible Request for Approval to Move to Closed Meeting - Personnel Matters - Section 551.074 of the Texas Government Code [Board will deliberate the appointment, employment, evaluation, reassignment, duties, discipline, or dismissal of public employees of the District or hear a complaint or charge against an officer or employee.] (Discussion of 2024-2025 Employment Contract Renewals for Administrators, Teachers, and Professional Support Employees); and (The Board of Trustees will deliberate the hiring of the Principal at Buice Elementary School; Principal at Cavazos Elementary School; Executive Director of Leadership; and an Executive Director of Guidance and Counseling.) Consultations with Attorney - Section 551.071 of the Texas Open Meetings Act [The Board will meet in Closed Session in Consultation with the Board's Attorney Regarding all Matters as Authorized by Law.] | |
| A. Request for Approval of the 2024-2025 Employment Contract Renewals for Administrators, Teachers, and Other Professional Support Employees. | 117 |
| B. Request for Approval of Recommendation to Hire Principal at Buice Elementary School. | 118 |
| C. Request for Approval of Recommendation to Hire an Executive Director of Leadership | 119 |
| D. Request for Approval of Recommendation to Hire Executive Director of Guidance, Counseling and Wellness | 120 |
| 13. Information Items | 121 |
| A. Acknowledgement of Quarterly Donations | 122 |
| B. Financials | 124 |
| C. Purchases over \$50,000 Informational Report | 129 |
| D. March Routine Personnel Report | 131 |
| 14. Closing Remarks by Superintendent | |
| 15. Adjournment | |



BOND 2023 UPDATE

Superintendent and Board of Trustees will discuss various aspects of the 2023 Bond.



BOND 2023

School Board Update

April 16, 2024



An architectural rendering of a modern school hallway. The ceiling features a mix of wood slat and dark grey acoustic panels with recessed linear lighting. The walls are a combination of light grey brick and wood paneling. A large blue graphic with white lines and dots is visible on the right wall. People are shown sitting on grey and blue modular seating, walking, and talking. The overall atmosphere is bright and contemporary.

PROJECT IMPLEMENTATION

CTE High School

- Planning Committee Meetings
 - February 1, 2024
 - February 29, 2024
 - March 28, 2024
- Site Visits to CTE Centers (Hobbs & Abilene)



Planning Committee Meeting with PBK

CTECH Site Visit

CTECH, Hobbs, New Mexico

Square Footage: 86,500

Students Usage: 750



Abilene Leadership & Innovation in Future Technologies (LIFT) Center

LIFT Center, Abilene, Texas

Square Footage: 125,000

Students: 400 Fulltime Students (1,000 Traveling)

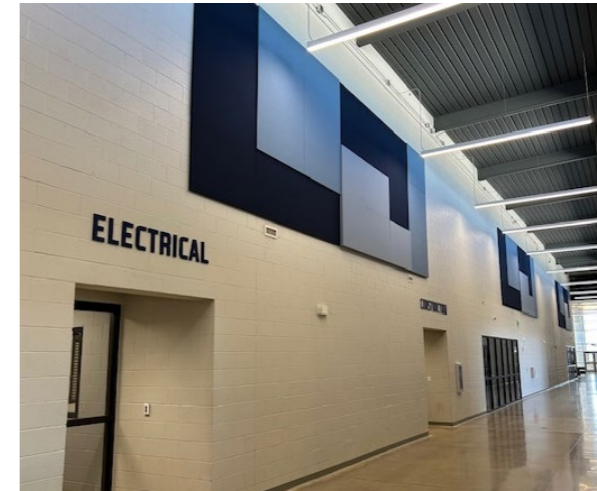

Middle School

- Planning Committee Meetings
 - March 22, 2024
 - April 19, 2024
- Site Visit to Griffin MS (Lewisville) – May 3

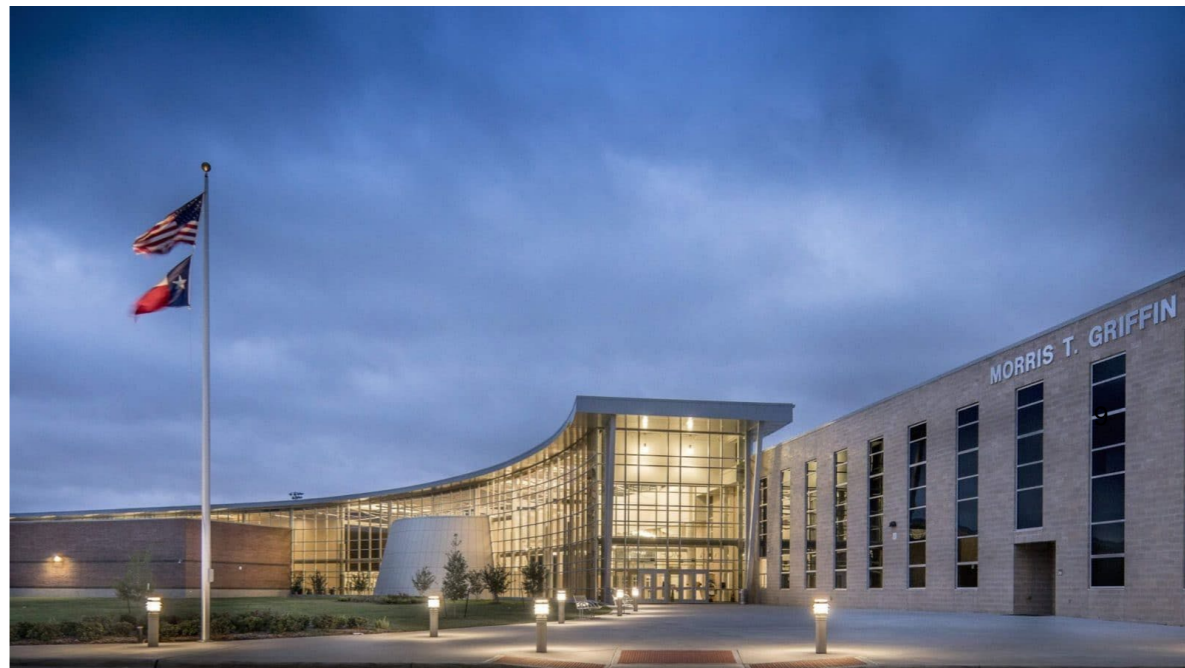

Morris T. Griffin MS in Lewisville ISD

Upcoming Project Planning Sessions

- Transportation Center Initial Meeting with Parkhill – April 19
- PHS Auditorium Initial Meeting with Parkhill - April 19
- JROTC Project Initial Meeting with Parkhill – April 19
- Middle School Follow -up Meeting with PBK – April 19

10

FINANCE



**ECISD
Bond 2023
Costs by Project
as of 4/11/2024**



| Project Name | Budget | Encumbrance | Actual | Available |
|------------------------------------|-----------------------|----------------------|---------------------|-----------------------|
| MIDDLE SCHOOL | 120,000,000 | 5,625,000 | | 114,375,000 |
| PRIORITY 1&2 ITEMS | 117,783,000 | 5,003,580 | | 112,779,420 |
| HS/CTE CENTER | 80,000,000 | 3,750,000 | 217 | 76,249,783 |
| TRANSPORTATION FACILITY | 35,000,000 | | | 35,000,000 |
| AUDITORIUM RENO-PHS | 12,500,000 | | | 12,500,000 |
| TECHNOLOGY-PA, BELL, CLOCK, FA SYS | 10,000,000 | | | 10,000,000 |
| LAND PURCHASE | 9,000,000 | 3,255,598 | 31,700 | 5,712,702 |
| TRANSITION LEARNING CENTER | 8,000,000 | | | 8,000,000 |
| AG FARM BUILDINGS-CTE | 7,500,000 | | | 7,500,000 |
| TECHNOLOGY ITEMS-SURVEILLANCE | 6,000,000 | | | 6,000,000 |
| FINE ARTS INSTRUMENTS | 3,665,000 | 297,289 | 31,426 | 3,336,285 |
| TECH ITEMS-FLT PNL BDS,AV EQP | 3,500,000 | 203,750 | 3,218,762 | 77,488 |
| TECHNOLOGY - PHONE SYS | 2,500,000 | | | 2,500,000 |
| TRANSPORTATION BUSES | 2,450,000 | | | 2,450,000 |
| JROTC FACILITY | 1,500,000 | | | 1,500,000 |
| TECHNOLOGY ITEMS - AV EQUIP | 1,500,000 | | | 1,500,000 |
| ATH-MS TENNIS COURT RESURFACE | 480,000 | 207,417 | | 272,583 |
| MS UNIF-BAND&MARIACHI | 685,000 | | | 685,000 |
| ATH-BB & TENNIS LIGHTS-OHS | 650,000 | 600,000 | | 50,000 |
| ATH-MS GYM BLEACHERS | 1,000,000 | 845,158 | | 154,842 |
| ATH-BASEBALL LIGHTING-PHS | 400,000 | 399,999 | | 1 |
| MS PERFORMANCE RISERS | 150,000 | 30,948 | | 119,052 |
| Totals | \$ 424,263,000 | \$ 20,218,739 | \$ 3,282,105 | \$ 400,762,156 |
| Percent | 100% | 5% | 1% | 94% |



FUTURE ACTIONS

13



RFQs Currently Advertised

- Geotechnical & Special Testing
- Construction Manager at Risk

Contracts with Architects

- Contract with DLR for new Transition Learning Center – May 2024
- Contract with JSA for new Agricultural Farm – May 2024

THANK YOU





Ector County Independent School District

Action Page

TO: Board of Trustees

FROM: Deborah Ottmers, Chief Financial Officer

SUBJECT: DISCUSSION OF AND REQUEST FOR APPROVAL OF PURCHASES OVER \$50,000

DATE: April 16, 2024

As Required by Board Policy CH (Local), following is a list to consider and take possible action to authorize, negotiate, and enter into term agreements with recommended vendors to be awarded by purchase orders once approved.

Administrative Recommendation:
Approval of Purchases over \$50,000

ECISD
 Request for purchases over \$50,000
 April 2024

| Item | Vendor(s) | Estimated Contract Price | Funding | Requestor/ Department | Reference | Service/ Product | Service/Product Summary | Contract Term |
|------|----------------------|---|--------------------------------|--|----------------------------|------------------|---|---------------|
| 1R | Grande Communication | \$158,040 - Approved 03/26/2024 \$ 7,299 - Additional needed that was not eligible for eRate \$165,339 - New Total Amount | General Funds 199 E-Rate | Dr. Kellie Wilks Information Technology | ECISD AWARDED RFP 24-15 | Internet Access | The vendor will supply internet connectivity throughout the district with the necessary specifications for continuous operations. | FY 2024-2025 |

RFP #24-15 – CI Service Specifications for Internet Access

- **Purpose:** Continue and maintain internet connectivity throughout the district.
- **Background Info:** The vendor will supply internet connectivity throughout the district with the necessary specifications for continuous operations.
- **Cost:** \$158,040 – Approved 03/26/2024
 \$ 7,299 – Additional needed that was not eligible for eRate
 \$165,339 – New Total Amount
- **Funding Source:** 199 - Local funds / E-Rate
- **Recommended Supplier/Service Provider:** Grande (Astound)

Board Approval

Date

Assessment Worksheet

Entity: Ector County ISD - 142077
 Funding Year: 2024-2025
 Form 470#: 240007328
 Close Date: Wednesday, February 28, 2024

Products/Services Assessed: _____
 Evaluator Name and Title: Consolidated
 Date Evaluation Completed: Thursday, March 7, 2024

Lowest E-rate Eligible Cost: \$84,636.00
 Lowest E-rate Ineligible Cost: \$0.00

Vendor Scoring

| Selection Criteria | Weight | 143001192 AT&T | | 143034904 FiberLight | | 143024443 Grande (Astound) | | 143010484 Sparklight | | SPIN Unite | | | |
|---|-------------|-------------------|---------------|-------------------------|----------------|-------------------------------|----------------|-------------------------|----------------|---------------|----------------|-----------|----------------|
| | | Eligible \$ | Ineligible \$ | Raw Score | Weighted Score | Raw Score | Weighted Score | Raw Score | Weighted Score | Raw Score | Weighted Score | Raw Score | Weighted Score |
| Cost of E-rate Eligible Products/Services* | 30% | \$529,745.76 | \$0.00 | 1.60 | 4.79% | 10.00 | 30.00% | 5.36 | 16.07% | 3.47 | 10.40% | 6.02 | 18.07% |
| Cost of E-rate Ineligible Products/Services | 0% | | | | 0.00% | | 0.00% | | 0.00% | | 0.00% | | 0.00% |
| The reputation of the Vendor and Vendors goods or services | 10% | | | 5.00 | 5.00% | 8.00 | 7.75% | 10.00 | 9.25% | 9.00 | 8.00% | 7.00 | 7.00% |
| The quality of the Vendors goods or services | 15% | | | 5.00 | 7.50% | 8.00 | 11.25% | 10.00 | 14.25% | 9.00 | 11.63% | 7.00 | 10.50% |
| The extent to which the goods or services meet the district's needs | 15% | | | 6.00 | 9.75% | 8.00 | 11.25% | 10.00 | 15.00% | 8.00 | 11.25% | 7.00 | 10.88% |
| The vendor's past relationship with the district | 10% | | | 5.00 | 5.00% | 8.00 | 7.50% | 10.00 | 9.50% | 8.00 | 7.00% | 6.00 | 6.00% |
| The impact on the ability of the district to comply with the laws and rules relating to | 0% | | | | 0.00% | | 0.00% | | 0.00% | | 0.00% | | 0.00% |
| The total long-term cost to the district to acquire the vendor's goods and services | 10% | | | 5.00 | 6.00% | 9.00 | 8.50% | 10.00 | 9.75% | 8.00 | 7.00% | 9.00 | 8.25% |
| Any other relevant factor specifically listed in this RFP | 10% | | | 5.00 | 5.50% | 5.00 | 6.00% | 10.00 | 10.00% | 5.00 | 6.25% | 5.00 | 5.75% |
| Overall Ranking | 100% | | | | 43.54% | | 82.25% | | 83.82% | | 61.53% | | 66.44% |



Ector County Independent School District

Action Page

TO: Board of Trustees

FROM: Dr. Scott Muri, Superintendent of Schools

SUBJECT: **DISCUSSION OF AND REQUEST FOR APPROVAL FOR THE SUPERINTENDENT TO NEGOTIATE AND ENTER INTO A LEASE AGREEMENT WITH SUNSET GOLF & COUNTRY CLUB, LLC. CONCERNING THE PROPERTY LOCATED AT 9301 ANDREWS HWY., ODESSA, TEXAS 79768**

DATE: April 16, 2024

The Board will be asked to approve the Superintendent to negotiate and enter into a lease agreement with Sunset Golf & Country Club, LLC. Concerning the property located at 9301 Andrews Hwy., Odessa, Texas 79768.

Administrative Recommendation:

It is recommended that the Board of Trustees approve the Superintendent to negotiate and enter into a lease agreement with Sunset Golf & Country Club, LLC. Concerning the property located at 9301 Andrews Hwy., Odessa, Texas 79768 as presented.



BOARD OF TRUSTEES

SUBJECT: Consent Agenda

PRESENTED BY: Dr. Scott R. Muri

BACKGROUND INFORMATION:

Ector County ISD adopted the use of the consent agenda as a means of expediting regular meetings. Consent agenda items consist of typical or routine matters in nature and typically have been discussed in a prior Board Work Study session. As such, the Board can consider all items included in the Consent Agenda with one motion. Should the Board choose to consider any item on the Consent Agenda separately, that item can be removed from the Consent Agenda, discussed, and voted on separately.

ADMINISTRATIVE RECOMMENDATION:

Approval of the Consent Agenda.



REQUEST FOR APPROVAL OF MINUTES OF MEETINGS

Attached you will find minutes of meetings of the Board of Trustees for:

- March 04, 2024 – Special Board Meeting
- March 19, 2024 – Board Workshop Meeting
- March 26, 2024 – Regular Board Meeting

AT A SPECIAL MEETING OF THE BOARD OF TRUSTEES OF THE ECTOR COUNTY INDEPENDENT SCHOOL DISTRICT HELD AT THE ADMINISTRATION BOARD ROOM, 802 NORTH SAM HOUSTON, ODESSA, ECTOR COUNTY, TEXAS, AT 5:30 P.M., March 4, 2024, WITH THE FOLLOWING MEMBERS:

Present:

Delma Abalos
Steve Brown
Tammy Hawkins
Christopher Stanley
Robert Thayer
Wayne Woodall

Virtual:

Dawn Miller

Absent:

School Officials: Dr. Scott Muri, Mike Adkins, Dr. Keeley Boyer, Deborah Ottmers, Dr. Anthony Sorola, Alicia Syverson

Others: Ruth Campbell, Rita Lopez, Mary Franco

26633 **Meeting Called to Order:** Christopher Stanley, Board President, called the Board of Trustees Meeting to order at 5:30 p.m.

26634 **Verification of Compliance with Open Meeting Law – this is to certify that the provisions of Section 551.001 of the Texas Government Code have been met in connection with the public notice of this meeting:** Board President Christopher Stanley, verified that the provisions of Section 551.001 of the Texas Government Code have been met in connection with public notice of this meeting.

26635 **Opening Remarks by Superintendent:** In his opening comments, Superintendent Dr. Scott Muri reminded everyone that Spring Break is next week (March 11-15) and all ECISD schools and offices will be closed.

26636 **Public Comment:** Individuals who wish to participate during the portion of the meeting designated for public comment shall sign up with the presiding officer or designee before the meeting begins as specified in the Board's procedures on public comment and shall indicate the agenda item on which they wish to address the Board. *BED(LOCAL)*

There were no public comments.

Action Items

26637 **Discussion of and Request for Approval of the 2024-2025 K-5 Zavala Elementary Attendance Boundary:** Moved by Brown, seconded by Hawkins to approve the 2024-2025 K-5 Zavala Elementary Attendance Boundary as presented.

This action results in several things: it dissolves the affiliation between Zavala Elementary and Travis Elementary that began in 2018 for accountability reasons; it means, beginning in August 2024, all students in the new attendance zone will attend Zavala throughout their elementary school years; and it means Travis Elementary ~~will~~ be repurposed.

The determining factor in this decision is very low enrollment at Travis. Data shows only 180 students live in that attendance area. Combining the two schools into one will create cost savings of approximately \$566,000 next year.

As a result of the recent school board actions both Travis and Burleson Elementary will be repurposed, and the District's Choice Schools Application period will be re-opened to allow families from those two schools to apply for a Choice School, if they want to. This decision means the timeline for the Choice School Lottery will be moved back to March 25, and eligible families will be notified on March 27.

Motion unanimously approved.

26638 **Closing Remarks by the Superintendent:** There were no closing remarks.

26639 **Adjournment:** Christopher Stanley, Board President, adjourned the Board meeting at 5:36 p.m.

Board President
Christopher Stanley

Board Secretary
Tammy Hawkins

AT A BOARD WORKSHOP MEETING OF THE BOARD OF TRUSTEES OF THE ECTOR COUNTY INDEPENDENT SCHOOL DISTRICT HELD AT THE ADMINISTRATION BOARD ROOM, 802 NORTH SAM HOUSTON, ODESSA, ECTOR COUNTY, TEXAS, AT 6:00 P.M., MARCH 19, 2024, WITH THE FOLLOWING MEMBERS:

Present:

Delma Abalos
Dr. Steve Brown
Tammy Hawkins
Wayne Woodall

Virtual:

Dawn Miller
Christopher Stanley

Absent:

Robert Thayer

School Officials: Dr. Scott Muri, Dr. Keeley Boyer, Dr. Lilia Náñez, Deborah Ottmers, Dr. Anthony Sorola, Alicia Syverson, Dr. Kellie Wilks

Others: Tatiana Dennis, Jessica Gore, Aaron Hawley, Virginia Hunt, Berta Saldivar, Betsabe Salcido, Jaime Miller, Lisa Wills, Mitchel Davis, Tracey Borchardt, Frances Franco, Nory Leachon, Mark Gabrylczyk, Matthew Spivey, Sam Magallan, Ryan Merritt, Melissa Skinner, Ruth Campbell, Rita Lopez, Mary Franco

26640 Meeting Called to Order: Christopher Stanley, Board President, called the Board of Trustees Meeting to order at 6:00 p.m.

26641 Verification of Compliance with Open Meeting Law – this is to certify that the provisions of Section 551.001 of the Texas Government Code have been met in connection with the public notice of this meeting: Board President Christopher Stanley, verified that the provisions of Section 551.001 of the Texas Government Code have been met in connection with public notice of this meeting.

26642 Opening Remarks by Superintendent: There were no opening comments.

26643 Public Comment: Individuals who wish to participate during the portion of the meeting designated for public comment shall sign up with the presiding officer or designee before the meeting begins as specified in the Board’s procedures on public comment and shall indicate the agenda item on which they wish to address the Board. *BED(LOCAL)*

There were no public comments.

Report/Discussion Items

26644 Results Driven Accountability Presentation: Dr. Jessica Gore, Executive Director of Research, Evaluation, and Accountability alongside Mark Gabrylczyk, Executive Director of Special Education and Leticia Bernal, Lead Social Worker presented the Results Driven Accountability report, including the strategic support plans developed to address areas of focus identified in the 2023 Results Driven Accountability report from the Texas Education Agency.

Results-Driven Accountability (RDA) monitors three groups of students – Emergent Bilingual, Other Special Populations (such as homeless, foster and military), and Special Education. Under RDA, a lower score is better, and the goal for each *performance level* is to earn a 0 and *determination level* is a 1 (meets requirements). The performance levels equate to the final determination level. The Other Special Populations earned a determination level of 3 (needs intervention), in part due to low performance on STAAR Social Studies assessments. Special Education earned a determination level of 2 (needs assistance), in part due to low performance on STAAR Social Studies and Science. Bilingual earned a determination level of 1 (meets requirements). Data show growth across the board for the three student groups when compared to 2022. Before the pandemic, results tracked toward 3s and 4s and now the numbers are moving toward 1s and 2s. This means Emergent Bilingual, Other Special Populations and Special Education students are performing more like their peers across this state in the metrics measured on RDA.

After the RDA presentation, Trustees received an update from Special Education. Referrals are a primary focus, as more than 700 of them carried over from last year into this year, and another 700 have been requested this year. The District is working overtime to catch up on those referrals investing more than \$2 million to contract for diagnosticians and licensed specialists in school psychology services to help staff members evaluate students. District leaders are meeting with the Texas Education Agency regularly to monitor the progress.

No action required.

26645 **Winter 2024 MAP Assessment Presentation**: Dr. Lilia Nanez, Associate Superintendent of Curriculum & Instruction presented this item for discussion. ECISD students engaged in the second round (Middle of Year) Winter MAP assessment during the month of January, 2024. The data received measures the amount of growth our students made between Fall 2023 and Winter 2024. The Measure of Academic Progress (MAP) assessment is given to ECISD students in grades 3-12 three times each year to measure each child's individual growth from the beginning of the year to the spring semester. This presentation highlighted Middle of Year data from January 2024 compared to the January 2023 tests. Key points:

1. Kindergarten students continue to show improvement year over year in the Math section.
2. 2nd grade students took a more rigorous 2-5 grade MAP Reading test in 2024 compared to the K-2 MAP Reading test they took in 2023. Despite the increased difficulty, the 2nd grade students showed higher growth rates in January 2024 compared to January 2023.

3. Data for Algebra 2 and Geometry was shared for the first time, indicating a broader scope of assessment or curriculum coverage.
4. The new NWEA Instructional Report is being utilized to target specific skills that require adjustments to instruction, suggesting a data-driven approach to improve teaching strategies and student learning outcomes.

No action required.

26646 **Possible Request for Approval to Move to Closed Meeting - Personnel Matters - Section 551.074 of the Texas Government Code - [Board will deliberate the appointment, employment, evaluation, reassignment, duties, discipline, or dismissal of public employees of the District or hear a complaint or charge against an officer or employee.] Consultations with Attorney – Section 551.071 of the Texas Open Meetings Act [The Board will meet in Closed Session in Consultation with the Board’s Attorney Regarding all Matters as Authorized by Law.]**

There was no closed session.

26647 **Closing Remarks by Superintendent:** There were no closing remarks.

26648 **Adjournment:** Christopher Stanley Board President, adjourned the Board meeting at 8:11 p.m.

Board President
Christopher Stanley

Board Secretary
Tammy Hawkins

AT A REGULAR MEETING OF THE BOARD OF TRUSTEES OF ECTOR COUNTY INDEPENDENT SCHOOL DISTRICT HELD ON MARCH 26, 2024, BEGINNING AT 6:00 P.M. IN THE ADMINISTRATION BUILDING BOARD ROOM, 802 NORTH SAM HOUSTON, ODESSA, ECTOR COUNTY, TEXAS, WITH THE FOLLOWING MEMBERS:

Present:

Delma Abalos
Tammy Hawkins
Dawn Miller
Christopher Stanley
Robert Thayer
Wayne Woodall

Absent:

Dr. Steve Brown

School Officials: Dr. Scott Muri, Dr. Lilia Nanez, Deborah Ottmers, Dr. Keeley Boyer, Dr. Anthony Sorola, Alicia Syverson, Dr. Kellie Wilks

Others: Tatiana Dennis, Ali Hernandez, Rohan Reed, Georgina Figueroa, Alexandra Becerra-Nieto, Betsy Rhodes, Melissa Roth, Adrian Rodriguez, Kevin Enriquez, Ashley Nevarez, Anthony Reed, Rebecca Tolbert, Mitchel Davis, Stacey Nunez, Joel Ramos, Jessica Gore, Rayce Wright, Kristen Vesely, Rev. Michael K. Shelton, Martha Cirrincione, Rebecca Rhodes, Ashton Lujan, Rexana Hughes, Abigail Agdipa, Damian Gaytan, Mikal Crowder, Todd Cason, Vanessa Green, Betsabe Salcido, Lisa Wills, Caitlin Couch, Baden Seigman, Glauben Assante, Lydia Roundtree, Samantha Anchondo, Jennifer Valencia, Xiara DeLeon, Amy Russell, Sheena Salcido, Mark Gabrylczyk, Ruth Campbell, Nory Leachon, Rita Lopez, Mary Franco

26649 **Meeting Called to Order:** Christopher Stanley, Board President, called the Board of Trustees Meeting to order at 6:00 p.m.

26650 **Verification of Compliance with Open Meeting Law:** Christopher Stanley, Board President, verified that the provisions of Section 551.001 of the Texas Government Code have been met in connection with public notice of this meeting.

26651 **Pledge of Allegiance to United States and Texas Flags:** The United States and Texas flag pledges were led by Sam Houston Elementary School Students Spencer Dugie (3rd Grade) and Noah Natividad (5th Grade).

26652 **Invocation:** The Invocation was led by Reverend Michael K. Shelton, Sr., Pilgrim Rest Baptist Church.

26653 **Special Presentations:**

Recognition of New Tech Odessa and Odessa Collegiate Academy State Decathlon Qualifiers: The Academic Decathlon Teams from New Tech Odessa and Odessa Collegiate Academy were recognized for competing for a state title at the Thomas E. Mosley Academic Decathlon Meet in February 2024.

New Tech Odessa finished 3rd at the State Meet after winning the Regional Championship.

Student/Team Members:

- Adrian Rodriguez
- Joel Ramos
- Alexandra Becerra-Nieto
- Kevin Enriquez
- Eva Herrera
- Yadiel Hernandez Rodriguez
- Michael Nunez
- Christopher Salcido
- Quinn Hernandez
- Rohan Reed (won the Scholastic Gold Medal at State)

Coaches:

- Damian Gaytan
- Georgina Figueroa

Odessa Collegiate Academy finished 6th at the State Meet after a 2nd Place finish at the Regional Meet.

Student/Team Members:

- Betanya Hailu
- Daniel Oyebanji
- Baden Seigman
- Priscilla Carlile
- Samantha Anchondo
- Ashton Lujan
- Esmeralda Martinez
- Glauben Assante
- Rayce Wright (won the Varsity Gold Medal at State; won the Gold in all 10 Competitions and won the Regional's Individual Championship)

Coaches:

- Mikal Crowder
- Lydia Roundtree
- Brandon Cook
- Travis Cooper
- Annelise Espinoza

Announcement of Small School Decathlon Coach of the Year: Mr. Damian Gaytan, who serves as the Algebra 2 Facilitator at New Tech Odessa was recognized for being named the Small School Decathlon Coach of the Year. Mr. Gaytan has served as the decathlon coach for seven years.

Announcement of Appointment to Southwest Board for College Board: ECISD's Advanced Academic Services Director Dr. Kristen Vesely has been elected to a three-year term to serve as a member of the College Board Southwestern Regional Council. Her term began this month. This is an important advisory role for the Southwest Region in which Dr. Vesely serves as the

communication link between the College Board and member institutions, bringing suggestions, issues and concerns about College Board programs to the council.

Recognition of 2 Bowie Middle School Qualifiers for State Science Fair: Bowie Middle School 8th Graders Abigail Agdipa and Ashley Nevarez were recognized for placing 2nd in their respective divisions at the Regional Science Fair at UTPB, and qualifying for the Texas Science & Engineering Fair in College Station.

Abigail's Physics project focused on audio deep fakes, attempting to distinguish the difference between synthetic voice and authentic voice.

Ashley's Life Science project focused on the effects of various drinks on seed development.

Announcement of Odessa High School's Anika Gunlapalli as National Merit Finalist: Odessa High School's Anika Gunlapalli was recognized for being named a National Merit Finalist – meaning she ranks among the top ½ percent of the more than 1.3 million high school seniors who entered the 2024 National Merit Scholarship Program by taking the 2022 Preliminary SAT/National Merit Scholarship Qualifying Test (PSAT/NMSQT), last fall.

26654 **Opening Remarks by Superintendent:** In his opening remarks, Superintendent Dr. Scott Muri reminded everyone that we would be off on Friday and Monday. Dr. Muri also shared that he had participated recently in the UTPB Press Conference, during which the establishment of a direct enrollment program was announced. A total of 795 ECISD students have been identified. Students with a 2.75 GPA will be granted automatic admission, while those with a 3.0 GPA will be eligible for additional merit scholarship funds.

26655 **Public Comment:** Individuals who wish to participate during the portion of the meeting designated for public comment shall sign up with the presiding officer or designee before the meeting begins as specified in the Board's procedures on public comment and shall indicate the agenda item on which they wish to address the Board. *BED(LOCAL)*

In public comment, Michael Nunez from New Tech Odessa and Baden Seigman from Odessa Collegiate Academy, both State Decathlon Qualifiers shared their experiences as Decathlon competitors. Michael expressed gratitude to the District for supporting Academic Decathlon and to his teammates and coaches. He said Decathlon taught him hard work, perseverance, and the power of unity. Baden echoed those sentiments about hard work and dedication. She said Decathlon challenged her in ways athletics and other classes have not, adding it made her a better student and a better person.

Action Items

26656 **Discussion of and Request for Approval of Purchases over \$50,000:** Moved by Abalos, seconded by Woodall to approve Purchases over \$50,000 as presented.

Motion unanimously approved.

26657 **Discussion of and Request for Approval of 2023-2024 Budget Amendment #7:** Moved by Hawkins, seconded by Abalos to approve to 2023-2024 Budget Amendment #7 as presented.

Motion unanimously approved.

26658 **Discussion of and Request for Approval of Science K-12 Textbook Adoption:** Moved by Abalos, seconded by Woodall to approve the Science K-12 Textbook Adoption as presented.

Motion unanimously approved.

26659 **Discussion of and Request for Approval of Educational Specifications, Method of Compliance, and Level of Flexibility in Facility Design:** Moved by Thayer, seconded by Hawkins to approve the Educational Specifications, Method of Compliance, and Level of Flexibility in Facility Design as presented.

Motion unanimously approved.

26660 **Discussion of and Request for Approval of Resolution to Nominate Dr. Scott Muri for 2024 Superintendent of the Year:** Moved by Abalos, seconded by Miller to approve Resolution to Nominate Dr. Scott Muri for 2024 Superintendent of the Year as presented.

Motion unanimously approved.

26661 **Consent Agenda:** Moved by Miller, seconded by Hawkins to approve Consent Agenda as presented.

- A. Request for Approval of Minutes of Meetings
- B. Request for Approval of Bills for Payment
- C. Request for Approval of Acceptance of Donations Over \$10,000
- D. Request for Approval of Permian High School Theatre Students Out-of-State Travel to London and Paris

Motion unanimously approved.

26662 **Possible Request for Approval to Move to Closed Meeting - Personnel Matters - Section 551.074 of the Texas Government Code [Board will deliberate the appointment, employment, evaluation, reassignment, duties, discipline, or dismissal of public employees of the District; or hear a complaint or charge against an officer or employee.] Consultations with Attorney – Section 551.071 of the Texas Open Meetings Act [The Board will meet in Closed Session in Consultation with the Board’s Attorney Regarding all Matters as Authorized by Law.]:** (The Board will receive its Attorney’s advice regarding the negotiated contracts with architect firms for Bond Program Construction projects.)

Board President Christopher Stanley convened the Board of Trustees to closed session at 7:07 p.m.

Board President Christopher Stanley reconvened the Board of Trustees to closed session at 7:34 p.m.

26663 **Discussion of and Request for Approval of Architect-Owner Contracts for Bond Program Construction between ECISD and Parkhill:** Moved by Woodall, seconded by Hawkins to approve the Architect-Owner Contracts for Bond Program Construction between ECISD and Parkhill as presented.

Motion unanimously approved.

26664 **Discussion of and Request for Approval of Architect-Owner Contracts for Bond Program Construction between ECISD and PBK:** Moved by Hawkins, seconded by Woodall to approve the Architect-Owner Contracts for Bond Program Construction between ECISD and PBK as presented.

Motion unanimously approved.

Bond 2023

26665 **Bond 2023 Update:** Deborah Ottmers, Chief Financial Officer and Dr. Anthony Sorola, Associate Superintendent of Operations provided the Board of Trustees with a Bond 2023 update. Trustees were provided with an overview of the updated budget spreadsheet showing encumbrances and dollars spent so far. The District is still finalizing land purchases and has not closed on those properties yet; some fine arts instruments have already been ordered and received; installation of interactive flat panels is continuing; and the Athletics Department is working quickly to get quotes and vetting vendors for its bond projects. ECISD will issue Requests for Qualifications (RFQ) Geotechnical & Special Testing for the land purchases, and for Construction Manager at Risk for the several projects utilizing that method of construction.

No action required.

26666 **Discussion of and Request for Approval of School District Facilities Construction Delivery Method by Bond 2023 Project and Delegate to the Superintendent Authority to Negotiate and Execute an Agreement with Gordian:** Moved by Miller, seconded by Woodall to approve the School District Facilities Construction Delivery Method by Bond 2023 Project and Delegate to the Superintendent Authority to Negotiate and Execute an Agreement with Gordian as presented.

Motion unanimously approved.

26667 **Discussion and Possible Action to Approve Bond 2023 Purchases over \$50,000:** Moved by Miller, seconded by Woodall to approve Bond 2023 Purchases over \$50,000 as presented.

Motion unanimously approved.

- 26668** **Discussion of and Request for Approval of Updated Bond Financial Advisory Services Agreement:** Moved by Miller, seconded by Woodall to approve the Updated Bond Financial Advisory Services Agreement as presented.

Motion unanimously approved.

- 26669** **Discussion of Preliminary 2023 Bonds Financing Plan:** Deborah Ottmers, Chief Financial Officer and Josh McLaughlin, Financial Advisor, from BOK Financial Securities, Inc. presented this item for discussion. The Board was provided with a look at the preliminary Bond 2023 financing plan with guidance from the District's financial advisors, BOK Financial Securities. BOK lauded ECISD's active management of its outstanding debt; since 2007 more than \$50 million of direct savings for tax payers has been achieved with prepayments and refinancing. ECISD maintains independent bond ratings of "Aa3" by Moody's Investors Service and "A+" by S&P Global Ratings both very attractive to investors. An initial sale is planned for May 2024 using fixed interest rates (Series 2024-A), with a second sale in June 2024 using variable interest rates (Series 2024-B) and then a third in August 2025 (Series 2025). This work is part of a plan for long-term financial stability for ECISD and the community. A sales announcement will be put together to be publicized for opportunity for local investors to purchase them first.

No action required.

- 26670** **Discuss and Consider Adoption of an Order Authorizing the Issuance of up to \$196,230,000 Ector County Independent School District Unlimited Tax School Building Bonds, Series 2024-A; Establishing Sale Parameters; Authorizing the Execution of a Bond Purchase Agreement and a Paying Agent/Registrar Agreement; Approving an Official Statement; Levying Annual Ad Valorem Taxes in Payment of Said Bonds; and Enacting other Provisions Relating to the Subject:** Moved by Miller, seconded by Abalos to approve the Adoption of an Order Authorizing the Issuance of up to \$196,230,000 Ector County Independent School District Unlimited Tax School Building Bonds, Series 2024-A; Establishing Sale Parameters; Authorizing the Execution of a Bond Purchase Agreement and a Paying Agent/Registrar Agreement; Approving an Official Statement; Levying Annual Ad Valorem Taxes in Payment of Said Bonds; and Enacting other Provisions Relating to the Subject as presented.

Motion unanimously approved.

- 26671** **Discuss and Consider Adoption of an Order Authorizing the Issuance of up to \$100,000,000 Ector County Independent School District Variable Rate Unlimited Tax School Building Bonds, Series 2024-B; Establishing Sale Parameters; Authorizing the Execution of Agreements with a Paying Agent/Registrar, a Remarketing Agent and a Tender Agent with Respect to the Bonds; Approving a Remarketing Memorandum; Levying Annual Ad Valorem Taxes in Payment of Said Bonds; and Enacting Other Provisions Relating to the Subject:** Moved by Miller, seconded by Abalos to approve the

Adoption of an Order Authorizing the Issuance of up to \$100,000,000 Ector County Independent School District Variable Rate Unlimited Tax School Building Bonds, Series 2024-B; Establishing Sale Parameters; Authorizing the Execution of Agreements with a Paying Agent/Registrar, a Remarketing Agent and a Tender Agent with Respect to the Bonds; Approving a Remarketing Memorandum; Levying Annual Ad Valorem Taxes in Payment of Said Bonds; and Enacting Other Provisions Relating to the Subject as presented.

Motion unanimously approved.

Report/Discussion Items

26672 **Budget Update Discussion:** Chief Financial Officer Deborah Ottmers presented this item. The Board of Trustees continued their discussion of budget priorities for the 2024-25 school year. ECISD is in the same position as school district across Texas, cutting budgets due to the Texas Legislature's inaction regarding school funding during the last legislative session. The state has not increased the basic allotment for public education since 2019 while costs have risen dramatically. Money is available and set aside for public education but it has not been distributed. Legislators will not meet again until January 2025, so Trustees must consider that it looks like schools will wait until next summer to learn if public education will receive new funding. The District is anticipating a budget deficit of about \$24 million for next year, that is with mostly the same expenses without any additional revenue expected. Operational costs continue to rise, and fund balance must be kept at recommended guidelines so significant cuts will need to be made. District leaders and Trustees will continue these discussions through June, when a new budget is adopted.

No action required.

26673 **Information Items:** The Board of Trustees were provided with the following information items: Financials, Purchasing Report, February 2024 Routine Personnel Report, and Added Administrative Memorandum March 2024.

26674 **Closing Remarks by the Superintendent:** In his closing remarks, Superintendent Dr. Scott Muri

26675 **Adjournment:** Board President Christopher Stanley adjourned the Board meeting at 9:07 p.m.

Board President
Christopher Stanley

Board Secretary
Tammy Hawkins



REQUEST FOR APPROVAL OF BILLS FOR PAYMENT

Attached you will find a list of disbursements for the previous month for your approval.

TO: BOARD OF TRUSTEES
ECTOR COUNTY INDEPENDENT SCHOOL DISTRICT

FROM: ACCOUNTS PAYABLE

RE: CHECK REGISTER

The following check amounts for the operations, materials and supplies for the maintenance of the School District are presented for your approval.

For the period 3/21/2024 to 4/10/2024

| ANALYSIS RECAPITULATION | AMOUNT |
|-------------------------|------------------|
| Operating Fund: | \$ 11,997,239.23 |

ECTOR COUNTY ISD
CHECK REGISTER
03/21/2024 - 04/10/2024

| DATE | PAYEE | AMOUNT |
|-------------|--|---------------|
| 3/27 | ALL ABOARD AMERICA! | \$ 35,013.16 |
| 3/27 | ALL ABOUT HEARING | 88.00 |
| 3/27 | ALLDATA LLC | 975.00 |
| 3/27 | B-LINE FILTER & SUPPLY INC | 748.28 |
| 3/27 | BSN SPORTS INC | 1,127.31 |
| 3/27 | COMPUDATA SOLUTIONS LLC | 610.00 |
| 3/27 | DEMCO INC | 989.32 |
| 3/27 | GANDY INK | 1,057.91 |
| 3/27 | VITAL SIGNS | 746.50 |
| 3/27 | VITAL SIGNS | 2,145.83 |
| 3/27 | LAKESHORE LEARNING MATERIALS | 52,890.86 |
| 3/27 | LOU'S CLINICAL LAB INC | 1,224.00 |
| 3/27 | MARK'S PLUMBING PARTS | 609.26 |
| 3/27 | MATHWARM-UPS.COM | 13,415.00 |
| 3/27 | MIDLAND SAFETY & HEALTH SALES | 200.00 |
| 3/27 | ODESSA WINLECTRIC | 25,140.95 |
| 3/27 | O REILLY AUTO ENTERPRISES LLC | 1,746.31 |
| 3/27 | POSITIVE PROMOTIONS | 2,137.18 |
| 3/27 | REGION IV SERVICE CENTER | 450.00 |
| 3/27 | SCHOLASTIC BOOK FAIRS | 11,362.40 |
| 3/27 | SCHOLASTIC BOOK FAIR INC. | 3,299.13 |
| 3/27 | SECURED DOCUMENT SHREDDING INC | 343.65 |
| 3/27 | SIMS PLASTIC INC | 8,231.54 |
| 3/27 | TEXAS ASSOCIATION OF SCHOOL BUSINESS OFFICIALS | 290.00 |
| 3/27 | THE BOSWORTH LTD | 172,500.00 |
| 3/27 | THE BOSWORTH LTD | 320.00 |
| 3/27 | ULINE INC. | 1,172.72 |
| 3/27 | WEST MUSIC CO | 2,541.85 |
| 3/27 | WOODWIND & BRASSWIND INC | 140.50 |
| 3/27 | BROADWAY MOTORS INC | 6,356.62 |
| 3/27 | GALLS LLC | 895.33 |
| 3/27 | NAPA AUTO PARTS | 1,604.12 |
| 3/27 | DATA RECOGNITION COPORATION | 577.50 |
| 3/27 | N J MALIN & ASSOCIATES LLC | 678.00 |
| 3/27 | ARAMARK UNIFORM & CAREER APPAREL GROUP INC. | 1,649.40 |
| 3/27 | BEST CHOICE RESTAURANTS LLC | 4,580.20 |
| 3/27 | BEST CHOICE COFFEE SERVICES LLC | 245.83 |
| 3/27 | BEST CHOICE COFFEE SERVICES LLC | 100.91 |
| 3/27 | SCHOOL SPECIALTY LLC | 3,232.62 |
| 3/27 | SCHOOL SPECIALTY LLC | 85.78 |
| 4/3 | 4IMPRINT INC | 3,723.92 |
| 4/3 | ALL ABOARD AMERICA! | 14,795.00 |
| 4/3 | AMERIPRIDE SERVICES INC. | 581.38 |
| 4/3 | BUCK'S WHEEL & EQUIPMENT COMPANY | 674.59 |
| 4/3 | CENTERS FOR CHILDREN & FAMILIES | 2,250.00 |

| | | |
|------|---|-----------|
| 4/3 | COMPUTATA SOLUTIONS LLC | 19,839.00 |
| 4/3 | DIAMOND BUSINESS SERVICES INC | 569.91 |
| 4/3 | FLINN SCIENTIFIC INC | 288.68 |
| 4/3 | HENRY SCHEIN INC | 8,954.00 |
| 4/3 | HYDROTEX PARTNERS LTD | 11,330.83 |
| 4/3 | J W PEPPER & SON INC | 45.00 |
| 4/3 | LAKESHORE LEARNING MATERIALS | 26,653.08 |
| 4/3 | LAWSON PRODUCTS INC | 1,294.00 |
| 4/3 | NATIONAL ASSOCIATION OF | 336.49 |
| 4/3 | O REILLY AUTO ENTERPRISES LLC | 1,443.28 |
| 4/3 | SCHOLASTIC BOOK FAIR INC. | 4,195.24 |
| 4/3 | SCHOLASTIC INC | 181.60 |
| 4/3 | TEXAS ART EDUCATION ASSOCIATION (TAEA) | 220.00 |
| 4/3 | TEXAS ELEMENTARY PRINCIPALS & SUPERVISORS ASSOC | 439.00 |
| 4/3 | WEST MUSIC CO | 939.61 |
| 4/3 | FOLLETT SCHOOL SOLUTIONS INC | 699.57 |
| 4/3 | NAPA AUTO PARTS | 284.43 |
| 4/3 | TRANSMISSION SERVICE & SUPPLY INC | 534.68 |
| 4/3 | N J MALIN & ASSOCIATES LLC | 1,191.23 |
| 4/3 | ARAMARK UNIFORM & CAREER APPAREL GROUP INC. | 1,837.09 |
| 4/3 | BEST CHOICE COFFEE SERVICES LLC | 263.16 |
| 4/3 | SCHOOL SPECIALTY LLC | 13,511.23 |
| 4/3 | SCHOOL SPECIALTY LLC | 3,715.48 |
| 4/10 | 4IMPRINT INC | 513.28 |
| 4/10 | ACADEMIC LEARNING COMPANY LLC | 1,708.85 |
| 4/10 | ALL ABOARD AMERICA! | 14,768.26 |
| 4/10 | ALL ABOUT HEARING | 550.00 |
| 4/10 | AMERIPRIDE SERVICES INC. | 702.38 |
| 4/10 | B-LINE FILTER & SUPPLY INC | 2,790.00 |
| 4/10 | BSN SPORTS INC | 8,051.23 |
| 4/10 | AUTOMATIC ICE MACHINE | 377.00 |
| 4/10 | COMPUTATA SOLUTIONS LLC | 1,138.00 |
| 4/10 | COOLE SCHOOL | 5,562.00 |
| 4/10 | DEMCO INC | 50.25 |
| 4/10 | DIAMOND BUSINESS SERVICES INC | 286.44 |
| 4/10 | HENRY SCHEIN INC | 76.06 |
| 4/10 | HENRY SCHEIN INC | 6,763.25 |
| 4/10 | J W PEPPER & SON INC | 3,015.08 |
| 4/10 | VITAL SIGNS | 4,834.25 |
| 4/10 | LAKESHORE LEARNING MATERIALS | 6,324.59 |
| 4/10 | LEGO BRAND RETAIL | 2,059.25 |
| 4/10 | MIDLAND SAFETY & HEALTH SALES | 300.00 |
| 4/10 | AIM MEDIA TEXAS OPERATING LLC | 1,382.50 |
| 4/10 | ODESSA WINLECTRIC | 115.85 |
| 4/10 | O REILLY AUTO ENTERPRISES LLC | 1,983.21 |
| 4/10 | ORIENTAL TRADING COMPANY INC | 3,869.87 |
| 4/10 | PIONEER DRAMA SERVICE | 78.75 |
| 4/10 | SCHOLASTIC INC | 2,441.60 |
| 4/10 | SECURED DOCUMENT SHREDDING INC | 926.28 |
| 4/10 | SHAR PRODUCTS CO | 578.46 |

| | | |
|------|--|------------|
| 4/10 | SIMS PLASTIC INC | 155.52 |
| 4/10 | TEXAS ART EDUCATION ASSOCIATION (TAEA) | 1,865.00 |
| 4/10 | TEACHER CREATED MATERIALS INC | 191,241.77 |
| 4/10 | TEXAS ASSOCIATION OF SCHOOL BUSINESS OFFICIALS | 125.00 |
| 4/10 | THE BOSWORTH LTD | 29,922.97 |
| 4/10 | TRANE U.S. INC. | 11,590.20 |
| 4/10 | VWR INTERNATIONAL LLC (WARD'S SCIENCE) | 68.20 |
| 4/10 | WEST MUSIC CO | 1,215.80 |
| 4/10 | WOODBURN PRESS | 108.13 |
| 4/10 | BROADWAY MOTORS INC | 3,389.80 |
| 4/10 | GALLS LLC | 152.48 |
| 4/10 | NAPA AUTO PARTS | 105.47 |
| 4/10 | MULTICARE PLUS | 225.00 |
| 4/10 | STONE TOWER GRAFIX | 469.25 |
| 4/10 | STONE TOWER GRAFIX | 2,314.82 |
| 4/10 | COLOR BLAZE SUPPLY, INC. | 931.18 |
| 4/10 | ARAMARK UNIFORM & CAREER APPAREL GROUP INC. | 3,153.69 |
| 4/10 | BEST CHOICE RESTAURANTS LLC | 394.53 |
| 4/10 | BEST CHOICE COFFEE SERVICES LLC | 27.87 |
| 4/10 | SCHOOL SPECIALTY LLC | 15,149.00 |
| 4/10 | SCHOOL SPECIALTY LLC | 25,457.91 |
| 3/27 | ABECEDARIAN | 155.10 |
| 3/27 | ADT PIZZA LLC | 209.79 |
| 3/27 | AIR TUTORS LLC | 336,900.00 |
| 3/27 | AMAZON CAPITAL SERVICES | 54,682.33 |
| 3/27 | AMAZON CAPITAL SERVICES | 135.91 |
| 3/27 | AMERICAN FAMILY LIFE & CANCER | 41.50 |
| 3/27 | AMERICAN FAMILY LIFE & CANCER | 6.00 |
| 3/27 | ANGELO STATE UNIVERSITY | 10,987.85 |
| 3/27 | ASHLEY SELLERS | 74.97 |
| 3/27 | ASSOCIATION OF TEXAS | 2,775.81 |
| 3/27 | ATHLETIC SUPPLY INC | 16,315.50 |
| 3/27 | AUDRIE LUJAN | 88.50 |
| 3/27 | BALS DURHAM LP | 6,240.00 |
| 3/27 | BEATRIS MATA | 139.00 |
| 3/27 | BECKY RAMIREZ | 67.20 |
| 3/27 | BERKSHIRE PRODUCTION SUPPLY LLC | 4,553.44 |
| 3/27 | BERNARD HOOPER | 2,534.41 |
| 3/27 | BETSABE GONZALEZ SALCIDO | 1,626.86 |
| 3/27 | BIG BEND TELECOM LTD | 3,900.00 |
| 3/27 | BIMBO BAKERIES USA | 2,212.63 |
| 3/27 | BLAIR LAWSON | 44.25 |
| 3/27 | BLAIR LAWSON | 44.25 |
| 3/27 | BLUE STAR BUS SALES LTD | 188,049.43 |
| 3/27 | BOOKBINDING & LAMINATING INC | 480.00 |
| 3/27 | BRIANNA MCDOWELL | 44.25 |
| 3/27 | BRIANNA MCDOWELL | 44.25 |
| 3/27 | BRIANNA MCDOWELL | 44.25 |
| 3/27 | BRIANNA MCDOWELL | 88.50 |
| 3/27 | BWI COMPANIES INC | 5,226.61 |

| | | |
|------|---|-----------|
| 3/27 | CAITLIN COUCH | 85.29 |
| 3/27 | CDW-G | 232.47 |
| 3/27 | CHERYL HINESLY | 37.05 |
| 3/27 | CHERYL WILSON | 84.63 |
| 3/27 | MAKE CHICKEN INC | 905.25 |
| 3/27 | NBCEC INC | 531.38 |
| 3/27 | CHRISTINA ACOSTA | 5,346.50 |
| 3/27 | CHRISTINA LORRAINE BUTLER | 44.25 |
| 3/27 | CHRISTINA LORRAINE BUTLER | 88.50 |
| 3/27 | CHRISTINE MATTA | 23.84 |
| 3/27 | CITY OF ODESSA | 4,543.33 |
| 3/27 | COMMERCIAL FOOD SERVICE | 1,507.80 |
| 3/27 | CONTROL TECHNOLOGIES INC | 30,567.80 |
| 3/27 | COSTA THERAPY INSTITUTE LLC | 13,500.00 |
| 3/27 | CULLIGAN WATER CONDITIONING OF WEST TEXAS | 263.00 |
| 3/27 | DANA SAFETY SUPPLY | 220.00 |
| 3/27 | DAVID CUPP | 79.93 |
| 3/27 | DAVID HERNANDEZ | 604.76 |
| 3/27 | DAVID MOLINAR | 1,665.50 |
| 3/27 | DAXWELL | 21,200.64 |
| 3/27 | DEANN WEEKLY | 704.76 |
| 3/27 | DOMTECH ELECTRICAL AND CONTROLS LLC | 2,697.54 |
| 3/27 | DONNA TAYLOR | 100.00 |
| 3/27 | ECISD CULINARY ARTS | 6,000.00 |
| 3/27 | ELLEN SMITH | 80.00 |
| 3/27 | E OFFICIAL ENTERPRISES, INC. | 4,947.26 |
| 3/27 | EPALLET INC | 35,838.60 |
| 3/27 | EXALANDER S MAGALLAN | 1,440.30 |
| 3/27 | FAMILY & CONSUMER SCIENCES | 26.88 |
| 3/27 | FAMILY SUPPORT PAYMENT CENTER | 300.00 |
| 3/27 | FERGUSON FACILITIES SUPPLY | 292.42 |
| 3/27 | FERL GILES | 828.00 |
| 3/27 | FOCUS CARE INC | 17,500.00 |
| 3/27 | FIRST FINANCIAL ADMINISTRATORS | 31,952.73 |
| 3/27 | FIRST FINANCIAL ADMINISTRATORS | 18,600.00 |
| 3/27 | FIRST FINANCIAL ADMINISTRATORS | 84,708.00 |
| 3/27 | FIRST FINANCIAL ADMINISTRATORS | 4,075.00 |
| 3/27 | FIRST FINANCIAL ADMINISTRATORS | 100.00 |
| 3/27 | FIRST FINANCIAL ADMINISTRATORS | 200.00 |
| 3/27 | FIRST FINANCIAL ADMINISTRATORS | 18,065.50 |
| 3/27 | FIRST FINANCIAL ADMINISTRATORS | 716.64 |
| 3/27 | FIRST FINANCIAL ADMINISTRATORS | 1,214.49 |
| 3/27 | FIRST FINANCIAL ADMINISTRATORS | 6,055.26 |
| 3/27 | FIRST FINANCIAL ADMINISTRATORS | 2,551.96 |
| 3/27 | FLORIDA STATE DISBURSEMENT UNIT | 330.00 |
| 3/27 | FRANCESCA FLORANCE | 8.58 |
| 3/27 | G H DAIRY | 31,110.90 |
| 3/27 | GARDENDALE WATER CO | 1,034.00 |
| 3/27 | GARY MCMILLAN | 77.12 |
| 3/27 | GOODSON SERVICE COMPANY | 779.30 |

| | | |
|------|---|------------|
| 3/27 | GRAINGER | 5,271.97 |
| 3/27 | GRANULAR INSURANCE COMPANY | 105,778.91 |
| 3/27 | HAYNES & BOONE LLP | 495.00 |
| 3/27 | HEALTH SERVICES ADMINISTRATION | 333.56 |
| 3/27 | HEALTH SERVICES ADMINISTRATION | 23,990.88 |
| 3/27 | HEATHER DOLLOFF | 33.77 |
| 3/27 | HEATHER DOLLOFF | 8.84 |
| 3/27 | HEIDI L HELFERICH | 13.20 |
| 3/27 | HENRY R CANAS | 3,451.20 |
| 3/27 | HOME DEPOT USA INC - STORE #562 | 4,697.15 |
| 3/27 | HUGHES SERVICES FLOORING, LP | 17,985.00 |
| 3/27 | HUMBERTO HERNANDEZ JR | 3,055.00 |
| 3/27 | INTERBORO PACKAGING CORP. | 1,821.12 |
| 3/27 | ISPHERE INNOVATION PARTNERS LLC | 11,422.00 |
| 3/27 | ISTATION | 3,500.00 |
| 3/27 | ISTOSVISIO INC | 30,000.00 |
| 3/27 | JANELLE OTT | 472.50 |
| 3/27 | JANELLE OTT | 90.00 |
| 3/27 | JANELLE OTT | 45.00 |
| 3/27 | JAYNE TILLERY | 138.15 |
| 3/27 | JNT RESOURCES PARTNERS, LP | 2,513.60 |
| 3/27 | JNT RESOURCES PARTNERS, LP | 28,951.20 |
| 3/27 | JNT RESOURCES PARTNERS LP | 35,392.66 |
| 3/27 | JOHNNA ROSSON | 33.64 |
| 3/27 | JOSE CAMPOS JR | 3,439.31 |
| 3/27 | JOSE MINJAREZ | 80.27 |
| 3/27 | JOSE VALDEZ | 100.00 |
| 3/27 | JUAN FUENTES | 36.92 |
| 3/27 | KELLIE THOMAS | 87.17 |
| 3/27 | KELLIE WILKS | 1,710.50 |
| 3/27 | KENNER PRINTING | 198.88 |
| 3/27 | KRISTI EICHER | 674.29 |
| 3/27 | KRONOS INC. | 16,091.04 |
| 3/27 | LABATT FOOD SERVICE | 62,830.18 |
| 3/27 | LAND O'LAKE | 8,154.25 |
| 3/27 | LEAD4WARD LLC | 10,000.00 |
| 3/27 | LINDE GAS & EQUIPMENT INC | 722.72 |
| 3/27 | LORENZO R MASONSONG | 12.00 |
| 3/27 | LOVING GUIDANCE INC | 296.70 |
| 3/27 | LOWE'S HOME IMPROVEMENT | 724.20 |
| 3/27 | LUISANA MAURICIO | 13.27 |
| 3/27 | LYNETA MENDOZA | 29.15 |
| 3/27 | MAGRYM CONSULTING INC | 4,600.00 |
| 3/27 | MANSFIELD OIL COMPANY OF GAINESVILLE, INC | 20,292.99 |
| 3/27 | MANUELA ESCAJEDA | 43.35 |
| 3/27 | MARIA COSTILLA | 12.93 |
| 3/27 | MARK BENNETT | 680.71 |
| 3/27 | MARK BENNETT | 15.00 |
| 3/27 | MDT ALLSTAR CLEANERS | 113.66 |
| 3/27 | MEAGAN CAMPBELL | 48.71 |

| | | |
|------|-----------------------------------|------------|
| 3/27 | MELINDA VEGA | 87.84 |
| 3/27 | MELINDA VEGA | 29.55 |
| 3/27 | MICHAEL FLAX | 1,120.00 |
| 3/27 | MOBILE COMMUNICATION AMERICA INC | 3,805.00 |
| 3/27 | MONK HOLDINGS LLC | 48.00 |
| 3/27 | MOTIVATIONAL SERVICES | 8,000.00 |
| 3/27 | MOTOROLA SOLUTIONS, INC. | 8,116.92 |
| 3/27 | MSB CONSULTING GROUP LLC | 11,257.49 |
| 3/27 | N-TUNE MUSIC & SOUND INC | 12,116.84 |
| 3/27 | NATALIE FITZGERALD | 88.50 |
| 3/27 | NATIONAL CENTER FOR GROW YOUR OWN | 150,000.00 |
| 3/27 | NATIONAL TRAVEL SYSTEMS | 651.90 |
| 3/27 | NCS PEARSON INC | 2,750.00 |
| 3/27 | STATE OF NEW MEXICO | 300.00 |
| 3/27 | STATE OF NEW MEXICO | 659.00 |
| 3/27 | NIMBUS DRINKING WATER SYSTEMS | 25.00 |
| 3/27 | ODESSA CHAMBER OF COMMERCE | 1,625.00 |
| 3/27 | ODESSA COLLEGE | 2,212.50 |
| 3/27 | SEWCO INC | 21,000.62 |
| 3/27 | ALMA CASAS | 600.00 |
| 3/27 | AMBER SILVA | 435.00 |
| 3/27 | ASHLEY PEARCE | 600.00 |
| 3/27 | AUDRIANA HARTWIG | 855.00 |
| 3/27 | AYISHA MARTINEZ | 1,155.00 |
| 3/27 | BERLINDA CERVANTES | 1,350.00 |
| 3/27 | BROOKE FIERRO | 255.00 |
| 3/27 | DAISY TALAMANTES | 300.00 |
| 3/27 | DANIELA MARTINEZ | 1,140.00 |
| 3/27 | DESTINY RIVAS | 1,455.00 |
| 3/27 | ELIZABETH RODRIGUEZ | 255.00 |
| 3/27 | EMILIA DE LA ROSA | 600.00 |
| 3/27 | EMILY FINDLEY | 480.00 |
| 3/27 | EMILY LARA | 2,235.00 |
| 3/27 | HANNAH STRINGER | 855.00 |
| 3/27 | JACQUELINE BALDERAS | 600.00 |
| 3/27 | JAZMINE LEYVA | 255.00 |
| 3/27 | KARLA MATIAS | 2,655.00 |
| 3/27 | KEYLA FELGADO | 480.00 |
| 3/27 | LESLIE RAMIREZ | 1,050.00 |
| 3/27 | LUCILLE PINO | 2,325.00 |
| 3/27 | MADALYN DOMINGUEZ | 300.00 |
| 3/27 | MARIA HERNANDEZ | 180.00 |
| 3/27 | MARIBEL ROJAS | 165.00 |
| 3/27 | MICHELLE HERNANDEZ | 195.00 |
| 3/27 | NATALIE LEVA | 855.00 |
| 3/27 | NORA BARRERA | 480.00 |
| 3/27 | REBEKAH PATRICK | 2,100.00 |
| 3/27 | RICHELYN PARADA | 1,500.00 |
| 3/27 | ROCELYN LOUD | 1,500.00 |
| 3/27 | RYAN CARRASCO | 600.00 |

| | | |
|------|--|------------|
| 3/27 | SABRINA NIETO | 750.00 |
| 3/27 | SUSANA ESPINOZA | 480.00 |
| 3/27 | YARITZA HOLGUIN | 300.00 |
| 3/27 | ZAIRA VAZQUEZ | 255.00 |
| 3/27 | OTIS ELEVATOR COMPANY INC | 610.00 |
| 3/27 | PERMIAN MOVERS, INC. | 181.50 |
| 3/27 | PRISCILLA TORRES | 73.23 |
| 3/27 | PROFORCE MARKETING | 5,003.75 |
| 3/27 | R WATER LLC | 1,447.50 |
| 3/27 | REGION 13 EDUCATION SERVICE CENTER | 390.00 |
| 3/27 | REGION 18 EDUCATION SERVICE CENTER | 250.00 |
| 3/27 | REGION 18 EDUCATION SERVICE CENTER | 150.00 |
| 3/27 | REYMUNDO REYES | 285.50 |
| 3/27 | ROB RANKIN | 48.00 |
| 3/27 | ROSALITA GARCIA | 36.72 |
| 3/27 | ROSAS CAFE / BOBBY COX Co. | 113.53 |
| 3/27 | SALLY POOL | 69.41 |
| 3/27 | SALLY POOL | 63.71 |
| 3/27 | SYNCHRONY BANK | 110.00 |
| 3/27 | SHANE EIDSON | 56.00 |
| 3/27 | SHERWIN WILLIAMS | 152.34 |
| 3/27 | SHOPPA'S MATERIAL HANDLING | 150.00 |
| 3/27 | SIRIUS EDUCATION SOLUTIONS LLC | 6,237.00 |
| 3/27 | SKILLSUSA TEXAS | 4,390.00 |
| 3/27 | SONIA ROCHA | 1,626.86 |
| 3/27 | SOUTHERN MAID DONUTS | 70.50 |
| 3/27 | STAR TECH GROUP | 10,000.00 |
| 3/27 | STEPHANIE VILLAVICENCIO GARCIA | 37.45 |
| 3/27 | SYN-TECH SYSTEMS INC | 587.52 |
| 3/27 | SYSCO USA, INC | 76,841.37 |
| 3/27 | TAMMY HAWKINS | 876.24 |
| 3/27 | FRANK E GOMEZ | 6,000.00 |
| 3/27 | TDC INC | 8,000.00 |
| 3/27 | TEXAS AFT AMP | 277.50 |
| 3/27 | TEXAS ASSOCIATION OF SECONDARY SCHOOL PRINCIPALS | 54.00 |
| 3/27 | TEXAS DEPARTMENT OF INFORMATION RESOURCES | 395.48 |
| 3/27 | TEXAS ELEMENTARY PRINCIPALS & SUPERVISORS ASSOC | 413.81 |
| 3/27 | TEXAS INDUSTRIAL VOCATIONAL ASSOCIATION | 63.00 |
| 3/27 | TEXAS LIFE INSURANCE CO | 149,241.55 |
| 3/27 | THE CINCINNATI LIFE INS. CO | 20.04 |
| 3/27 | THE CINCINNATI LIFE INS. CO | 224.48 |
| 3/27 | THE LINCOLN ELECTRIC COMPANY | 300.00 |
| 3/27 | THIRD FUTURE SCHOOLS TEXAS | 88,720.24 |
| 3/27 | TORI HENDERSON | 44.25 |
| 3/27 | TORI HENDERSON | 44.25 |
| 3/27 | TPR EDUCATION LLC | 3,960.00 |
| 3/27 | TYSON PREPARED FOOD, INC. | 40,502.88 |
| 3/27 | UIL MUSIC REGION 6 | 2,000.00 |
| 3/27 | UNITED PARCEL SERVICE INC | 245.90 |
| 3/27 | UNITED REFRIGERATION | 480.00 |

| | | |
|------|---|------------|
| 3/27 | UNITED WAY OF ODESSA | 4,952.50 |
| 3/27 | VALERIE HELITON | 67.80 |
| 3/27 | IMPERIAL BAG & PAPER LLC | 29,749.11 |
| 3/27 | WEST TEXAS EDUCATORS | 3,304.50 |
| 3/27 | WEST TEXAS EDUCATORS | 228,187.84 |
| 3/27 | XEROX CORPORATION | 45,543.12 |
| 4/3 | AIR TUTORS LLC | 19,575.00 |
| 4/3 | AMANDA VESELY | 20.00 |
| 4/3 | AMAZON CAPITAL SERVICES | 14,782.03 |
| 4/3 | AMERICAN EXPRESS | 4,491.55 |
| 4/3 | AMERICAN EXPRESS | 250.00 |
| 4/3 | ATHLETIC SUPPLY INC | 30,417.00 |
| 4/3 | AUDIO ACOUSTICS HEARING CENTERS | 1,685.00 |
| 4/3 | BIMBO BAKERIES USA | 2,455.05 |
| 4/3 | BLAIR LAWSON | 44.25 |
| 4/3 | DICK BLICK COMPANY | 2,621.77 |
| 4/3 | BLUE STAR BUS SALES LTD | 312.96 |
| 4/3 | BOOKBINDING & LAMINATING INC | 199.50 |
| 4/3 | BRAZOS DOOR & HARDWARE | 15,030.00 |
| 4/3 | BRIANNA MCDOWELL | 88.50 |
| 4/3 | BRUNSON FAMILY BBQ | 972.03 |
| 4/3 | BUSINESS PROFESSIONALS AMERICA | 1,350.00 |
| 4/3 | CAVALLO ENERGY TEXAS LLC | 135,052.53 |
| 4/3 | CANDI HERNANDEZ | 350.00 |
| 4/3 | CDW-G | 431,908.55 |
| 4/3 | CELESTE POTTER | 717.07 |
| 4/3 | CHANTAL HERNANDEZ | 34.91 |
| 4/3 | CHARTER WASTE INC. | 151.16 |
| 4/3 | DUNN RESTAURANT GROUP INC | 366.75 |
| 4/3 | NBCEC INC | 29.34 |
| 4/3 | CHRIS MUNOZ | 16.79 |
| 4/3 | COMMUNITIES IN SCHOOLS OF THE PERMIAN BASIN INC | 127,500.00 |
| 4/3 | CORRAL ENVIRONMENTAL CONSULTING, LLC | 1,800.00 |
| 4/3 | CORRAL ENVIRONMENTAL CONSULTING, LLC | 1,800.00 |
| 4/3 | CULLIGAN WATER CONDITIONING OF WEST TEXAS | 58.00 |
| 4/3 | CUSTOM WHOLESALE SUPPLY INC | 455.40 |
| 4/3 | DALE'S ALIGNMENT & BRAKE SERVICE INC | 668.52 |
| 4/3 | DAWN HERNANDEZ | 1,697.45 |
| 4/3 | ECISD EDUCATION FOUNDATION | 417.00 |
| 4/3 | ELUMA LLC | 130,238.00 |
| 4/3 | EMPIRE PAPER CO | 203.80 |
| 4/3 | ETC MONTESSORI | 280.00 |
| 4/3 | FERGUSON FACILITIES SUPPLY | 2,524.66 |
| 4/3 | FIRST FINANCIAL ADMINISTRATORS | 218,425.33 |
| 4/3 | FIRST FINANCIAL ADMINISTRATORS | 9,638.48 |
| 4/3 | FIRST FINANCIAL ADMINISTRATORS | 6,873.58 |
| 4/3 | FIRST FINANCIAL ADMINISTRATORS | 6,185.42 |
| 4/3 | FIRST FINANCIAL ADMINISTRATORS | 5,484.29 |
| 4/3 | FIRST FINANCIAL ADMINISTRATORS | 72,458.09 |
| 4/3 | FOLLETT CONTENT SOLUTIONS LLC | 307.97 |

| | | |
|-----|---------------------------------|-----------|
| 4/3 | G H DAIRY | 35,619.90 |
| 4/3 | G T DISTRIBUTORS INC | 419.00 |
| 4/3 | GOANIMATE, INC. | 299.00 |
| 4/3 | GOPHER SPORT | 460.65 |
| 4/3 | GRACIELA GARCIA MACHUCA | 229.22 |
| 4/3 | GRAINGER | 952.40 |
| 4/3 | GRANICUS LLC | 695.00 |
| 4/3 | HAPPY GRINGO LLC | 220.00 |
| 4/3 | HOME DEPOT USA INC - STORE #562 | 1,866.21 |
| 4/3 | HURT EXTERMINATING | 82,984.20 |
| 4/3 | INSOURCE INSURANCE GROUP, LLC | 171.00 |
| 4/3 | ISTATION | 36.82 |
| 4/3 | JACKSON VINES | 34.46 |
| 4/3 | JENNIFER DOUGLAS | 1,087.50 |
| 4/3 | JONN SIBLEY | 215.14 |
| 4/3 | KIM CHANCELLOR | 125.56 |
| 4/3 | KIMBERLY BRYER | 44.42 |
| 4/3 | L WALLACE CONSTRUCTION CO INC | 47,463.70 |
| 4/3 | LABATT FOOD SERVICE | 40,139.75 |
| 4/3 | LAURA SIKES | 261.81 |
| 4/3 | LEAD4WARD LLC | 4,500.00 |
| 4/3 | LOCKFAST LLC | 1,216.60 |
| 4/3 | MARIA T. RUBIO | 112.15 |
| 4/3 | MARK BENNETT | 497.26 |
| 4/3 | MARK BENNETT | 755.95 |
| 4/3 | MELANA MOSS | 20.00 |
| 4/3 | MICAH PETTIGREW | 9.31 |
| 4/3 | MOTOROLA SOLUTIONS, INC. | 78,407.16 |
| 4/3 | N-TUNE MUSIC & SOUND INC | 2,159.70 |
| 4/3 | NATIONAL TRAVEL SYSTEMS | 10,654.68 |
| 4/3 | SEWCO INC | 22,747.89 |
| 4/3 | OHS GRAPHIC DESIGN | 60.00 |
| 4/3 | ANDREW LAWSON | 300.00 |
| 4/3 | APRIL TORRES | 2,655.00 |
| 4/3 | ASHLEY RAMOS | 500.00 |
| 4/3 | BIKAL KOIRALA | 400.00 |
| 4/3 | BRIANNA URQUIDI | 255.00 |
| 4/3 | CODY BLACK | 350.00 |
| 4/3 | DANIEL SORENSEN | 300.00 |
| 4/3 | GWENDOLYN DAVIES | 300.00 |
| 4/3 | JACQUELINE GARCIA | 360.00 |
| 4/3 | KARLA LEYVA | 200.00 |
| 4/3 | KENZI GARCIA | 360.00 |
| 4/3 | MA. DEL CARMEN MALAGON | 570.00 |
| 4/3 | MARY STROKES | 770.00 |
| 4/3 | MIRANDA LOVE | 1,350.00 |
| 4/3 | SIERRA ALVARADO -ACOSTA | 570.00 |
| 4/3 | STEVEN REGISTER | 300.00 |
| 4/3 | TANIA BARRINGER | 555.00 |
| 4/3 | TANYA ALVARADO | 370.00 |

| | | |
|------|---|------------|
| 4/3 | PACY GOMEZ | 100.00 |
| 4/3 | PETER C GORMAN | 2,500.00 |
| 4/3 | PIRAINO CONSULTING, INC | 48,811.94 |
| 4/3 | POINT TO POINT CONSULTING INC | 4,361.75 |
| 4/3 | PROJECT LEAD THE WAY INC | 6,235.00 |
| 4/3 | REGION 18 EDUCATION SERVICE CENTER | 46,250.00 |
| 4/3 | RIGO NUNEZ | 20.50 |
| 4/3 | ROSAS CAFE / BOBBY COX Co. | 439.89 |
| 4/3 | SAVANNAH SOTO | 20.00 |
| 4/3 | SCHOOL BUS SAFETY COMPANY, INC. | 750.00 |
| 4/3 | THE SEWELL FAMILY OR COMPANIES INC | 43,890.00 |
| 4/3 | SHERWIN WILLIAMS | 21.57 |
| 4/3 | CENTERING ON CHILDREN | 350.00 |
| 4/3 | SKILLSUSA TEXAS | 2,115.00 |
| 4/3 | SOCORRO RODRIGUEZ | 58.96 |
| 4/3 | SOUTH PLAINS AREA TRACK OFFICIALS INC | 1,500.00 |
| 4/3 | SYSCO USA, INC | 56,567.76 |
| 4/3 | TESS DONNER | 6,000.00 |
| 4/3 | TEXAS ACADEMIC DECATHLON FOUNDATION | 486.00 |
| 4/3 | TEXAS DEPARTMENT OF PUBLIC SAFETY | 454.00 |
| 4/3 | TEXAS EXCAVATION SAFETY SYSTEM, INC. | 8.05 |
| 4/3 | TEXAS STATE TEACHERS ASSOCIATION | 37,954.42 |
| 4/3 | THE MCCRELESS COMPANY | 1,009.00 |
| 4/3 | TIDEWATER DISTRIBUTORS LLC | 1,823.05 |
| 4/3 | TIMOTHY DE LA VEGA | 252.00 |
| 4/3 | TORI HENDERSON | 44.25 |
| 4/3 | UNITED REFRIGERATION | 623.89 |
| 4/3 | UNIVERSE TECHNICAL TRANSLATION INC | 21.85 |
| 4/3 | VANESSA ALONZO | 350.00 |
| 4/3 | VERIZON WIRELESS SERVICES LLC | 5,171.98 |
| 4/3 | VERNIER SOFTWARE & TECHNOLOGY | 4,350.00 |
| 4/3 | WEIDNER & PHILLIPS LTD BY F & B OPERATORS | 2,200.00 |
| 4/4 | BASIN ABSTRACT & TITLE | 2,500.00 |
| 4/10 | AARON ALEX MOLINA | 38.99 |
| 4/10 | ACCELERATION ACADEMIES | 102,025.00 |
| 4/10 | ADRIAN GARCIA | 598.77 |
| 4/10 | AIDE EMILIANO | 51.93 |
| 4/10 | AIR TUTORS LLC | 1,282.50 |
| 4/10 | ALAN WILLIAMS | 196.51 |
| 4/10 | ALBERT J VALENCIA | 99.69 |
| 4/10 | ALEX NUNEZ | 70.01 |
| 4/10 | ALISHA SLIDER | 49.04 |
| 4/10 | AMANDA PADILLA | 53.60 |
| 4/10 | AMANDA PARSONS | 196.38 |
| 4/10 | AMAZON CAPITAL SERVICES | 39,864.72 |
| 4/10 | AMY A MILLER | 236.88 |
| 4/10 | ANGELA JOHNSON | 64.19 |
| 4/10 | ANGELA JOHNSON | 9.72 |
| 4/10 | ANNIE NELSON | 117.72 |
| 4/10 | ANTHONY SCOTT | 49.31 |

| | | |
|------|---------------------------------|--------------|
| 4/10 | ANTONIO R GONZALEZ | 800.00 |
| 4/10 | APPLE, INC | 718.00 |
| 4/10 | ASHLI SATTERWHITE | 52.19 |
| 4/10 | ASHLI SATTERWHITE | 52.46 |
| 4/10 | ASSOCIATED SUPPLY CO INC | 696.00 |
| 4/10 | AT&T | 76.63 |
| 4/10 | AT&T | 1,282.31 |
| 4/10 | AT&T | 132.66 |
| 4/10 | ATHLETIC SUPPLY INC | 8,690.50 |
| 4/10 | ATKINS HOLLMAN JONES PEACOCK | 28,500.64 |
| 4/10 | AUDIO ACOUSTICS HEARING CENTERS | 170.00 |
| 4/10 | AUDRIE LUJAN | 88.50 |
| 4/10 | AUDRIE LUJAN | 88.50 |
| 4/10 | AUDRIE LUJAN | 22.45 |
| 4/10 | AUSTIN CLASSICAL GUITAR | 250.00 |
| 4/10 | BATTERSHELL VETERINARY SERVICES | 525.00 |
| 4/10 | BEATRIS MATA | 455.00 |
| 4/10 | BECKY QUIROZ | 51.32 |
| 4/10 | BECKY RAMIREZ | 35.64 |
| 4/10 | BIANCA SALMON | 193.59 |
| 4/10 | BIMBO BAKERIES USA | 2,412.99 |
| 4/10 | BLAIR LAWSON | 184.25 |
| 4/10 | BLANCA LUJAN | 66.40 |
| 4/10 | BLUE STAR BUS SALES LTD | 74.60 |
| 4/10 | BLUEFIN LLC | 59,600.77 |
| 4/10 | BOOKBINDING & LAMINATING INC | 2,995.00 |
| 4/10 | BOZEMANSCIENCE.COM INC | 568.00 |
| 4/10 | BRIANNA MCDOWELL | 184.25 |
| 4/10 | BRIANNA MCDOWELL | 368.50 |
| 4/10 | BRIANNA MCDOWELL | 368.50 |
| 4/10 | BRIDGETTE CASAS | 45.49 |
| 4/10 | BRITTANY MOLINAR | 31.69 |
| 4/10 | BUSINESS PROFESSIONALS AMERICA | 1,330.00 |
| 4/10 | SPARKLIGHT | 173.76 |
| 4/10 | SPARKLIGHT | 541.86 |
| 4/10 | CAVALLO ENERGY TEXAS LLC | 80.78 |
| 4/10 | CASIE GRANADO | 807.00 |
| 4/10 | CDW-G | 3,092,908.93 |
| 4/10 | NBCEC INC | 264.41 |
| 4/10 | CHRIS MUNOZ | 129.19 |
| 4/10 | CHRISTINA SIFUENTEZ | 19.77 |
| 4/10 | CHRISTINE MASON CONSULTING | 2,000.00 |
| 4/10 | CHRISTOPHER MILLS | 40.87 |
| 4/10 | CITY OF ODESSA WATER DEPT | 143,608.30 |
| 4/10 | CLARISA ARRAS | 157.72 |
| 4/10 | CLINT STOWE | 163.08 |
| 4/10 | CODY GULLETT | 142.44 |
| 4/10 | COMMERCIAL FOOD SERVICE | 1,228.74 |
| 4/10 | COMPETITIVE OUTCOMES LLC | 3,600.00 |
| 4/10 | CONNIE COOTS | 614.39 |

| | | |
|------|---|------------|
| 4/10 | CONTRACT PAPER GROUP INC | 24,393.60 |
| 4/10 | CRISTA MITCHEL | 100.10 |
| 4/10 | CULLIGAN WATER CONDITIONING OF WEST TEXAS | 758.54 |
| 4/10 | CUSTOMINK, LLC | 3,188.33 |
| 4/10 | DANIEL BUSTAMANTE | 141.44 |
| 4/10 | DANIEL P TIMMONS | 61.04 |
| 4/10 | DARRYL WILLIAMS | 13,370.00 |
| 4/10 | DAVID CORRAL | 58.87 |
| 4/10 | DELMA ABALOS | 126.81 |
| 4/10 | ECTOR COUNTY ABSTRACT & TITLE | 5,000.00 |
| 4/10 | EDLIN ROMAN | 2,985.15 |
| 4/10 | ED PRICE | 731.23 |
| 4/10 | EFREN ZUNIGA | 90.72 |
| 4/10 | ELIZABETH MARJASON | 42.88 |
| 4/10 | ELUMA LLC | 140,673.20 |
| 4/10 | ELVIA RAMIREZ | 31.89 |
| 4/10 | EMILEE TRAMMEL | 23.52 |
| 4/10 | EMILY JO ROBERTS | 225.86 |
| 4/10 | TCASE SERVICES INC | 1,500.00 |
| 4/10 | EPALLET INC | 35,838.60 |
| 4/10 | ERIKA NATIVIDAD | 112.60 |
| 4/10 | FIDENCIA GUTIERREZ | 6.83 |
| 4/10 | G H DAIRY | 21,913.37 |
| 4/10 | GABRIELA BARRY | 81.74 |
| 4/10 | LET'S GAB PLLC | 3,750.00 |
| 4/10 | GARDENDALE WATER CO | 62.00 |
| 4/10 | GOODSON SERVICE COMPANY | 235.81 |
| 4/10 | GOPHER SPORT | 840.08 |
| 4/10 | GRAINGER | 10,499.20 |
| 4/10 | GUADALUPE NINO | 11.52 |
| 4/10 | HORTENCIA DEL BOSQUE | 22.09 |
| 4/10 | INNOVATIVE REHAB SYSTEMS | 1,700.00 |
| 4/10 | INSOURCE INSURANCE GROUP, LLC | 50.00 |
| 4/10 | KEVIN D BALLARD INC | 562.50 |
| 4/10 | JACQUELINE FRANCO | 46.63 |
| 4/10 | JANA AVERY | 52.13 |
| 4/10 | JENNIFER WIMBERLEY | 43.48 |
| 4/10 | JESSICA DENNEY | 66.50 |
| 4/10 | JESSICA DOMINGUEZ | 38.00 |
| 4/10 | JESUS VALERIANO | 346.50 |
| 4/10 | JOHN BENTON | 500.00 |
| 4/10 | JOIE SEATON | 9.92 |
| 4/10 | JOSEPH DUESLER | 240.10 |
| 4/10 | JUDY RAMIREZ | 48.31 |
| 4/10 | JULIA KELTON | 92.06 |
| 4/10 | JULIA PAREDEZ | 9.98 |
| 4/10 | JULIE SORUM | 269.31 |
| 4/10 | JULIETTE BAYLESS | 840.28 |
| 4/10 | KARIME MELENDEZ | 36.25 |
| 4/10 | KELLIE COLLINS | 82.08 |

| | | |
|------|---|------------|
| 4/10 | KENNY D COWAN | 343.00 |
| 4/10 | KNOWSYS EDUCATIONAL SERVICES LLC | 3,153.60 |
| 4/10 | KRISTA BRADDOCK | 49.58 |
| 4/10 | L WALLACE CONSTRUCTION CO INC | 560,499.52 |
| 4/10 | LAUREN TAVAREZ | 1,187.59 |
| 4/10 | LIBERTY PAPER | 24,536.40 |
| 4/10 | LILIA NANEZ | 98.92 |
| 4/10 | LINDE GAS & EQUIPMENT INC | 665.00 |
| 4/10 | LISA DONAHO | 29.41 |
| 4/10 | LISA HULSEY | 36.18 |
| 4/10 | LOCKFAST LLC | 121.66 |
| 4/10 | LORENZO R MASONSONG | 12.00 |
| 4/10 | LUNCH MONY INC | 70.42 |
| 4/10 | LYNDSAY FREEMAN | 57.42 |
| 4/10 | MAGALY NIETO | 123.74 |
| 4/10 | MAHIRA SALINAS | 93.60 |
| 4/10 | MAHIRA SALINAS | 81.74 |
| 4/10 | MANDY HINOJOS | 46.00 |
| 4/10 | MANSFIELD OIL COMPANY OF GAINESVILLE, INC | 20,240.57 |
| 4/10 | MANUELA ESCAJEDA | 80.60 |
| 4/10 | MARIA ZUBIATE | 73.15 |
| 4/10 | MARISSA LOPEZ | 23.65 |
| 4/10 | MARIVEL CORRALES | 81.07 |
| 4/10 | MARK BENNETT | 150.00 |
| 4/10 | MARK BENNETT | 658.61 |
| 4/10 | MARK KNOX FLOWERS | 235.00 |
| 4/10 | MARLA HOPPINS | 49.85 |
| 4/10 | MASTERYPREP LLC | 24,908.00 |
| 4/10 | MAYRA LEYVA | 280.07 |
| 4/10 | MCI FOODS INC | 26,396.16 |
| 4/10 | MDT ALLSTAR CLEANERS | 324.75 |
| 4/10 | MEAGAN CAMPBELL | 31.49 |
| 4/10 | MICAH PETTIGREW | 1,129.04 |
| 4/10 | MICAH PETTIGREW | 3,590.34 |
| 4/10 | MICHAEL JOE WILLIAMSON | 28.21 |
| 4/10 | MICHELLE MADRID | 59.50 |
| 4/10 | MIGHTY WASH OPERATIONS LLC | 1,525.00 |
| 4/10 | MITCH DAVIS | 227.15 |
| 4/10 | MONK HOLDINGS LLC | 36.00 |
| 4/10 | MSB CONSULTING GROUP LLC | 1,321.65 |
| 4/10 | N-TUNE MUSIC & SOUND INC | 21,212.33 |
| 4/10 | NATALIE BERRIDGE | 48.31 |
| 4/10 | NATALIE FITZGERALD | 88.50 |
| 4/10 | NATALIE GUARA | 108.54 |
| 4/10 | NATIONAL TRAVEL SYSTEMS | 5,615.55 |
| 4/10 | NAYELI OLIVAREZ | 122.75 |
| 4/10 | NIMBUS DRINKING WATER SYSTEMS | 261.00 |
| 4/10 | NOBUYUKI SHIRAISHI | 179.63 |
| 4/10 | NOHEMI YBARRA | 25.13 |
| 4/10 | NORA ISELA CRUZ | 97.88 |

| | | |
|------|---|------------|
| 4/10 | NUNEZ FENCE | 9,300.00 |
| 4/10 | ODESSA FAMILY YMCA | 61,820.00 |
| 4/10 | SEWCO INC | 13,621.17 |
| 4/10 | OLIVIA PORRAS | 65.26 |
| 4/10 | ABILENE ISD | 557.66 |
| 4/10 | ALEXA MULLEN | 20.00 |
| 4/10 | DEMI MILLSAP | 200.00 |
| 4/10 | JUSTIN JAMIERSON | 200.00 |
| 4/10 | KAITLYN BOWMAN | 200.00 |
| 4/10 | KAREN COLLINS | 18.00 |
| 4/10 | LINDSEY LAMKIN | 200.00 |
| 4/10 | REBECCA LOPEZ | 200.00 |
| 4/10 | ORLANDO BONNEY | 41.47 |
| 4/10 | PACY GOMEZ | 200.00 |
| 4/10 | PATHWAYZ COMMUNICATIONS INC | 5,388.07 |
| 4/10 | PAULINA FOWLER | 38.86 |
| 4/10 | PBK ARCHITECTS, INC | 36,000.00 |
| 4/10 | PENSKE COMMERCIAL VEHICLES US LLC | 7,825.84 |
| 4/10 | PERMIAN MOVERS, INC. | 400.00 |
| 4/10 | PETROPLEX OFFICE SUPPLY, INC. | 781.43 |
| 4/10 | PIRAINO CONSULTING, INC | 315,350.00 |
| 4/10 | PITSCO EDUCATION LLC | 1,565.88 |
| 4/10 | PRECISION BUSINESS MACHINES INC (PBM) | 1,928.80 |
| 4/10 | PRESENCE LEARNING INC | 15,022.06 |
| 4/10 | PROFORCE MARKETING | 3,863.85 |
| 4/10 | PROJECT LEAD THE WAY INC | 14,397.25 |
| 4/10 | RACHEL GALVAN | 43.42 |
| 4/10 | RAKIA MUSA | 616.14 |
| 4/10 | REGION 18 EDUCATION SERVICE CENTER | 7,250.00 |
| 4/10 | RHITHM INC | 35,851.32 |
| 4/10 | RHONDA LONG | 37.19 |
| 4/10 | RILEY COFFMAN | 207.90 |
| 4/10 | ROBERTS TRUCK CENTER OF TEXAS | 2,976.59 |
| 4/10 | RONALD WELLS | 24.99 |
| 4/10 | ROSAS CAFE / BOBBY COX Co. | 834.77 |
| 4/10 | ROSAS CAFE / BOBBY COX Co. | 413.55 |
| 4/10 | RS521 LLC | 19,990.00 |
| 4/10 | SYNCHRONY BANK | 10,816.12 |
| 4/10 | SANDY EMMERSON | 700.00 |
| 4/10 | SCHOOL NUTRITION ASSOCIATION SERVICE CENTER | 1,722.00 |
| 4/10 | SCOTT WALKER | 197.99 |
| 4/10 | SHAVEDRIA RAY | 1,134.85 |
| 4/10 | SHELLEY WRIGHT | 69.68 |
| 4/10 | SHERWIN WILLIAMS | 695.83 |
| 4/10 | SIRIA DUTCHOVER | 20.10 |
| 4/10 | SOUTHEASTERN PERFORMANCE | 1,718.42 |
| 4/10 | STEMARCO DESIGN LLC | 15.90 |
| 4/10 | STEVE BROWN | 80.79 |
| 4/10 | SWEET PIZZA LLC | 436.99 |
| 4/10 | SYSCO USA, INC | 5,054.40 |

| | | |
|------|---|------------------|
| 4/10 | FRANK E GOMEZ | 1,200.00 |
| 4/10 | TEXAS STATE UNIVERSITY | 2,100.00 |
| 4/10 | TEXAS TECH UNIVERSITY | 22,042.00 |
| 4/10 | THIRD FUTURE SCHOOLS TEXAS | 14,344.48 |
| 4/10 | TIM GILLEY | 40.28 |
| 4/10 | TNTP. INC. | 66,667.00 |
| 4/10 | TOM M. CARRIZALES | 969.50 |
| 4/10 | TONIA CHANCE | 1,264.76 |
| 4/10 | TORI HENDERSON | 101.84 |
| 4/10 | TRACI AVILA | 17.69 |
| 4/10 | TRUE NORTH CONSULTING GROUP LLC | 984.80 |
| 4/10 | ERS - TEXAS SOCIAL SECURITY PROGRAM | 35.00 |
| 4/10 | UNITED PARCEL SERVICE INC | 8.03 |
| 4/10 | UNITED REFRIGERATION | 4,078.80 |
| 4/10 | VALERIE HELITON | 46.97 |
| 4/10 | VERNIER SOFTWARE & TECHNOLOGY | 1,956.69 |
| 4/10 | VICTORIA NORENA | 67.27 |
| 4/10 | VIKTORIA R HENDERSON | 47.97 |
| 4/10 | IMPERIAL BAG & PAPER LLC | 9,856.00 |
| 4/10 | WAWONA FROZEN FOOD I | 26,109.07 |
| 4/10 | WEIDNER & PHILLIPS LTD BY F & B OPERATORS | 1,277.00 |
| 4/10 | WEST TEXAS CHAPTER TASO | 100.00 |
| 4/10 | WEST TEXAS CHAPTER TASO | 100.00 |
| 4/10 | WEST TEXAS EDUCATORS | 3,304.50 |
| 4/10 | WEST TEXAS POWER SPORTS DEVELOPMENT | 1,658.44 |
| 4/10 | WHITNEY CREEKMORE | 101.81 |
| 4/10 | WILLIAM KENT MCCORD | 98.29 |
| 4/10 | XEROX CORPORATION | 30,469.59 |
| 4/10 | XEROX CORPORATION | 808.21 |
| 4/10 | YVONNE FRANCO | 19.43 |
| 4/10 | ZULEMA PALOMINO | 31.89 |
| 3/21 | PCARX LLC | 98,500.32 |
| 3/21 | AETNA LIFE INSURANCE COMPANY | 309,386.89 |
| 3/21 | AETNA LIFE INSURANCE COMPANY | 113,095.36 |
| 3/25 | AETNA LIFE INSURANCE COMPANY | 395,402.26 |
| 3/25 | PCARX LLC | 153,562.07 |
| 4/1 | AETNA LIFE INSURANCE COMPANY | 351,529.17 |
| 4/1 | PCARX LLC | 151,704.82 |
| 4/4 | PCARX LLC | 55,387.87 |
| 4/4 | CAREATC INC | 7,904.00 |
| 4/4 | WELLSPRING TELEHEALTH | 11,085.00 |
| 4/4 | CAREATC INC | 7,222.22 |
| 4/4 | CAREATC INC | 5,556.46 |
| | TOTAL NUMBER OF CHECKS WRITTEN FOR DISTRICT | 739 |
| | TOTAL AMOUNT WRITTEN FOR DISTRICT | \$ 11,997,239.23 |



REQUEST FOR APPROVAL OF ACCEPTANCE OF DONATIONS OVER \$10,000

In accordance with policy CDC (local), Ector County ISD is requesting approval to receive the following donations greater than \$10,000.

| Amount | Fund | From | Description |
|---------------|-------------|---------------------------------|--|
| \$100,000 | 494 | Education Foundation | SKYOP (drone robotics program) |
| \$75,000 | 199 | Education Partnership of the PB | Energy Program equipment, curriculum, training |

**Drone & Robotics Technology Program (Implementation) /Project Lead the Way (Sustainability)
Ector County ISD Proposal**

Identifying the Need

Many energy companies in the Permian Basin use automation and digitalization to improve well productivity, operational efficiency, and safety in oil and gas operations. Two of the most in-demand tool and skillsets are drones and robotics. Both tools can be used to enhance leak detection and surveillance activities in shale operations. Surveillance drones can detect oil and gas leaks, corrosion, abnormal heat sources, presence of wildlife, and road conditions. Drones provide field operations better insight into the overall condition of the assets and how the conditions change over time. Operators in the Permian Basin travel hundreds of miles to conduct surveillance tasks. Drones will reduce the number of operators on the roads, increasing the efficiency of the workforce, and reducing road safety-related risks. Drones have the potential to provide unmatched reach across the Permian Basin and superior visibility over our operated and non-operated wells. Drones are also being used in other industry sectors to include agriculture, mining, and emergency services.

The Energy industry and other high demand industry sectors in the Permian Basin need skilled employees with education and experience in robotics, programming, and engineering that comprise the field of automation. Odessa College has recently started a Bachelor's degree program in Automation to help fill this need. The Odessa College program is competitive, with a selective entry process. UTPB also has align pathways in engineering disciplines. Therefore, in order to prepare our students for continuing education and careers in the burgeoning field of automation, ECISD is proposing the implementation of a Drone and Robotics Technology CTE program of study.

55

Occupation

Each Career & Technical Education program of study is built upon in-demand and high wage occupations. The Drone & Robotics program will use the occupational skills and requirements for Electro-Mechanical and Mechatronics Technologists & Technicians (SOC 17-3024). O*Net Online defines Electro-Mechanical and Mechatronics Technologists & Technicians (SOC 17-3024) as follows: *Operate, test, maintain, or adjust unmanned, automated, servomechanical, or electromechanical equipment. May operate unmanned submarines, aircraft, or other equipment to observe or record visual information at sites such as oil rigs, crop fields, buildings, or for similar infrastructure, deep ocean exploration, or hazardous waste removal. May assist engineers in testing and designing robotics equipment. More information about this occupation can be found here: <https://www.onetonline.org/link/summary/17-3024.00>*

Request

This request includes a robotics module and the teacher training to empower our teachers to be able to effectively provide automation knowledge and skills to our students. In addition, having a pathway to higher education will enable at-risk students to create a vision for their future that includes graduating from high school with a high-demand skill and a foundation for further training. Teacher training, curriculum, and pre-made lessons will help teachers get the most from the system and maximize benefits for the students. This request also includes purchasing two Industrial Drones with cameras and sensors, curriculum, and classroom drones. This request also includes funding for teacher training required by Project Lead the Way in order to continue the middle and high school programs.

Budget

| Item | Quantity | Cost |
|---|----------|-----------------|
| Industrial Drone | 2 | \$20,000 |
| Classroom Curriculum & Drones | 10 | \$15,000 |
| Robotics Equipment | 1 | \$48,500 |
| Teacher Training (Drones, Robotics, & PLTW) | 1 | \$16,500 |
| Total | | \$100,00 |

Deborah Ottmers

From: Ryan Merritt
Sent: Thursday, April 11, 2024 3:30 PM
To: Deborah Ottmers; Celeste Potter
Cc: Charletta Washington; Dusty Baumann
Subject: RE: Signature Required - Donation for SKYOP
Attachments: Ector County ISD Quote 1480.pdf; Permian HS Drone Training Budgetary Pricing Estimate - 2-Year Essential v2.pdf; Drone_Proposal_ECISD.docx; Drone_Proposal_ECISD.docx

Hi Deborah,

I have attached three documents for supporting information.

1. Drone Proposal: This was the initial proposal to Chevron for their donation to support drones and robotics in ECISD.
2. Ector County ISD Quote from SkyOps for drones, equipment, and training. 56
3. PHS pricing estimate for year one and two.

The SkyOps order is the initial purchase with more to follow.

From: Deborah Ottmers <Deborah.Ottmers@ectorcountysd.org>
Sent: Thursday, April 11, 2024 3:13 PM
To: Celeste Potter <Celeste.Potter@ectorcountysd.org>; Ryan Merritt <Bradley.Merritt@ectorcountysd.org>
Cc: Charletta Washington <Charletta.Washington@ectorcountysd.org>; Dusty Baumann <Dusty.Baumann@ectorcountysd.org>; Deborah Ottmers <Deborah.Ottmers@ectorcountysd.org>
Subject: RE: Signature Required - Donation for SKYOP

Hello

I need some support for this \$100k
What is it exactly
Is this some kind of supplies
Details pls

Thanks

Deborah P. Ottmers, CPA, RTSBA
Ector County ISD CFO
802 N. Sam Houston
Odessa, TX 79761
deborah.ottmers@ectorcountysd.org
432-456-9491 office



SkyOp LLC
 5297 Parkside Dr, Suite 435
 Canandaigua, NY 14424
 (585) 598-4737
 accounting@skyop.com
 www.skyop.com



Quote

ADDRESS

Ector County ISD
 Permian HS
 Attn: Juan Correa
 1800 East 42nd Street
 Odessa, TX 79762

QUOTE # 1480

DATE 04/08/2024

EXPIRATION DATE 05/08/2024

57

| QTY | ITEM | DESCRIPTION | UNIT COST | EXTENDED COST |
|-----|--|--|-----------|---------------|
| 1 | Essential Program License Fee | Essential Drone Training Curriculum License Fee for up to 25 students per year, per school | 7,500.00 | 7,500.00 |
| 1 | Instructor Training Program - Level 2 | Instructor training for Essential Drone Training Program - Level 2 | 5,495.00 | 5,495.00 |
| 1 | Instructor Materials Kit | Instructor materials kit for Essential and Integrated Drone Training Program | 240.00 | 240.00 |
| 1 | Essential Program Kit Add-Ons | Additional materials for Essential Drone Training Program | 58.00 | 58.00 |
| 13 | Student Syma X5 Series Kit | Syma X5 Series student materials kit for Integrated or Essential Drone Training Program | 93.00 | 1,209.00 |
| 24 | Student FAA Test Prep Kit | FAA Test Prep student materials kit for Integrated or Essential Drone Training Program | 24.00 | 576.00 |
| 24 | Zephyr Flight Simulator License - Base | Student license for Zephyr Flight Simulator - Base Version | 80.00 | 1,920.00 |
| 24 | Orqa FPV.Ctrl Controller | Orqa FPV.Ctrl flight simulator controller for Zephyr | 117.00 | 2,808.00 |
| 2 | Flight Training Obstacles | Indoor flight training obstacle set (including shipping) | 470.00 | 940.00 |
| 6 | Syma X5 Series Battery Charger | Battery charger for Syma X5 Series | 75.00 | 450.00 |
| 12 | Ryze Tello Kit - EDU Version | Ryze Tello Kit - EDU Version | 300.00 | 3,600.00 |
| 1 | DJI Mini 4 Pro Kit | DJI Mini 4 Pro Kit | 1,730.00 | 1,730.00 |
| 1 | DJI Mavic 3 Enterprise Kit | DJI Mavic 3 Enterprise Kit | 5,204.00 | 5,204.00 |
| 1 | Pix4Dmapper Educational Classroom | Perpetual license for Pix4Dmapper Educational Classroom, use on up to 25 simultaneous devices, includes 3 years of support and updates | 4,000.00 | 4,000.00 |

| | |
|--------------|--------------------|
| SUBTOTAL | 35,730.00 |
| TAX | 0.00 |
| TOTAL | \$35,730.00 |

Accepted By

Accepted Date



| Item Description | Year 1 Unit Cost | Year 1 Quantity | Year 1 Total Cost | Year 2 Unit Cost | Year 2 Quantity | Year 2 Total Cost |
|---|------------------|-----------------|-------------------|------------------|-----------------|-------------------|
| Essential Program Courseware License (Up to 25 students) | \$7,500 | 1 | \$7,500 | \$2,500 | 1 | \$2,500 |
| Essential Program Additional Student License | \$150 | 0 | \$0 | \$75 | 12 | \$900 |
| Instructor Training | \$5,495 | 1 | \$5,495 | \$5,495 | 0 | \$0 |
| Instructor Materials Kit | \$249 | 1 | \$249 | \$249 | 0 | \$0 |
| Student Syma X5 Series Kit | \$93 | 13 | \$1,209 | \$93 | 7 | \$651 |
| Student FAA Test Prep Kit | \$23 | 24 | \$552 | \$23 | 24 | \$552 |
| Student Essential Program Kit Add-Ons | \$50 | 0 | \$0 | \$50 | 2 | \$100 |
| Student Zephyr Flight Simulator License | \$71 | 24 | \$1,704 | \$71 | 24 | \$1,704 |
| Student FlySky FS-i6S Flight Simulator Controller | \$83 | 24 | \$1,992 | \$83 | 0 | \$0 |
| Indoor Flight Training Obstacle Set (Including shipping) | \$470 | 2 | \$940 | \$470 | 0 | \$0 |
| Syma X5 Series Battery Charger | \$75 | 6 | \$450 | \$75 | 0 | \$0 |
| Ryze Tello Kit - EDU Version | \$300 | 12 | \$3,600 | \$300 | 0 | \$0 |
| DJI Mini 4 Pro Kit | \$1,720 | 1 | \$1,720 | \$300 | 1 | \$300 |
| DJI Mavic 3 Classic Kit | \$3,060 | 0 | \$0 | \$500 | 0 | \$0 |
| DJI Mavic 3 Enterprise Kit | \$5,184 | 0 | \$0 | \$5,184 | 1 | \$5,184 |
| DJI Mavic 3 Thermal Kit | \$6,345 | 0 | \$0 | \$500 | 0 | \$0 |
| DJI Mavic 3 Multispectral Kit | \$5,465 | 0 | \$0 | \$500 | 0 | \$0 |
| Pix4D Classroom License | \$4,000 | 0 | \$0 | \$4,000 | 1 | \$4,000 |
| Total Year 1: | | | \$25,411 | | | \$15,891 |
| Additional Expenses | | | | | | |
| FAA Knowledge Test Fee | \$175 | TBD | TBD | \$175 | TBD | TBD |
| Computer | TBD | TBD | TBD | TBD | TBD | TBD |
| Autonomous Flight Apps | \$50 | TBD | TBD | \$50 | TBD | TBD |
| Adobe Creative Cloud Student License | TBD | TBD | TBD | TBD | TBD | TBD |
| Travel To Victor NY For Hands-On Training (5 Training Days) | TBD | 1 | TBD | TBD | 0 | TBD |

Pricing subject to change.

Deborah Ottmers

From: Ryan Merritt
Sent: Thursday, April 11, 2024 2:33 PM
To: Deborah Ottmers
Cc: Lilia Nanez
Subject: RE: Energy Program \$75k grant
Attachments: CDC_Exhibit_A_-_Other_Revenues_-_Grants_from_Private_Source_-_Donation_Form_CTE.pdf

I have attached the completed donation form. Does it need a signature from Celeste Potter?

From: Deborah Ottmers <Deborah.Ottmers@ectorcountysd.org>
Sent: Thursday, April 11, 2024 9:35 AM
To: Ryan Merritt <Bradley.Merritt@ectorcountysd.org>
Cc: Lilia Nanez <Lilia.Nanez@ectorcountysd.org>; Deborah Ottmers <Deborah.Ottmers@ectorcountysd.org>
Subject: RE: Energy Program \$75k grant

61

Perfect

Pls fill out the donation form so we can take to the board
Today pls – cut off tomorrow for board items
<https://www.ectorcountysd.org/Page/512>

Thanks

Deborah P. Ottmers, CPA, RTSBA
Ector County ISD CFO
802 N. Sam Houston
Odessa, TX 79761
deborah.ottmers@ectorcountysd.org
432-456-9491 office



From: Ryan Merritt <Bradley.Merritt@ectorcountysd.org>
Sent: Thursday, April 11, 2024 7:55 AM
To: Deborah Ottmers <Deborah.Ottmers@ectorcountysd.org>
Cc: Lilia Nanez <Lilia.Nanez@ectorcountysd.org>
Subject: RE: Energy Program \$75k grant

We received the shipment of equipment and curriculum on Tuesday of this week and the vendor is providing set up and training with teachers today. Below is a summary of the donation we received from EPPB via PSP funding. We did not

receive funding (\$75K) directly. The purchase was made by EPPB and the equipment was donated. We are also expecting another donation of equipment for the Oil and Gas program of study of \$62,500 from the EPPB in the coming months. Below is what we received:



Advanced Technologies Consultants
 110 W. Main St. | Northville, MI 48167
 Office Phone: (800) 348-8447
 Office Fax: (248) 348-3040

PRICE QUOTATION
 Prices valid for 60 days
 Prices and packages are subject to
 change without notice

Presented to: Adrian Vega - EPPB Team - Ector County ISD
 Ector County ISD
 802 N. Sam Houston
 Odessa, TX 79761
 (432) 456-0000

12/14/2023
 Jath Candy
 (915) 356-4016
jathcandy@atctrain.com

| Terms | Project Name | Delivery | FOB Point |
|--------|---|-------------------|-----------|
| Net 30 | Energy Natural Resource Management Course 1 Starter | est. 120 Days ARO | Lab-Volt |

| Item# | Description | Courses | Sub-Total |
|--------------------|---------------------------------------|----------------|--------------|
| 1 | Mechanical Drives Training System | 1, 2, 3, and 4 | \$23,724.00 |
| 2 | Fluid Power (Hydraulics & Pneumatics) | 1, 2 and 3 | \$23,771.00 |
| 3 | Industrial Pumps | 2, 3, and 4 | \$31,201.00 |
| 4 | Curriculum, Training and Service | 1, 2, 3, and 4 | \$2,975.00 |
| Total | | | \$81,671.00 |
| Discount | | | (\$6,671.00) |
| Grand Total | | | \$75,000.00 |

62

From: Deborah Ottmers <Deborah.Ottmers@ectorcountysd.org>
Sent: Wednesday, April 10, 2024 7:39 PM
To: Ryan Merritt <Bradley.Merritt@ectorcountysd.org>
Cc: Deborah Ottmers <Deborah.Ottmers@ectorcountysd.org>
Subject: FW: Energy Program \$75k grant

Hi
 You mentioned this the other day

Can you provide info pls

Thanks

Deborah P. Ottmers, CPA, RTSBA
 Ector County ISD CFO
 802 N. Sam Houston
 Odessa, TX 79761
deborah.ottmers@ectorcountysd.org
 432-456-9491 office



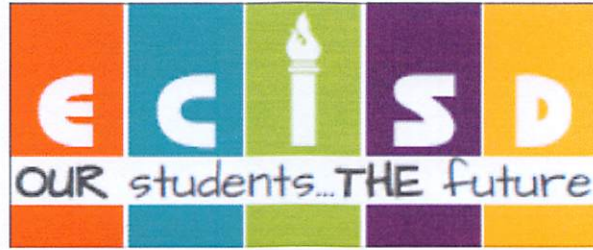

**REQUEST FOR APPROVAL OF ODESSA HS
BUSINESS PROFESSIONALS OF AMERICA STUDENT
OUT-OF-STATE TRAVEL TO CHICAGO, IL**

The Odessa High School's BPA (Business Professionals of America) student participants and teachers are requesting to travel to Chicago, IL on May 10th – May 14nd, 2024. The purpose of the trip is to allow State BPA qualifiers to compete in the National competition. The cost of the trip will cover all transportation, activities, housing expenses, and a majority of the meals.

Exhibit A—Request for Trip Approval

Date of request: 03/06/2024
Date/time of departure: 05/10/2024-6:30 AM a.m. or p.m. (circle one)
Date/time of return: 05/14/2024-6:00 PM a.m. or p.m. (circle one)
Destination of trip: Chicago

Purpose of trip, i.e., event to be attended, instructional value of the trip:
BPA-National Competition - Students will compete in Business and Finance competitions based on their qualification at the Texas State Competition as well as participate in leadership and citizenship activities.

Estimate of any permissible fees associated with the trip: \$ 5,000

District employee sponsor and organization: Alicia Dominguez

Number of students participating: 3

Number of chaperones participating: _____

| Name of Chaperone | Criminal History Check Requested (circle one) |
|-------------------|---|
| <u>N/A</u> | Yes No |
| <u>A</u> | Yes No |
| | Yes No |

Signature of District employee sponsor: 

STUDENT ACTIVITIES
TRAVEL

For Office Use Only

School-sponsored trip:

Approved

Denied

Reason, if denied:

Chaperone approval or denial:

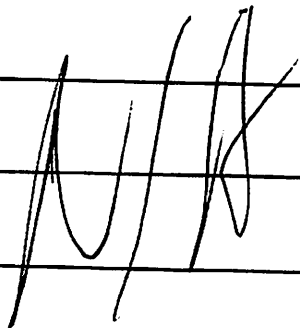
| Name of Chaperone | Criminal History Check Completed (circle one) | Decision (circle one) |
|--|---|-----------------------|
|  | Yes | Approved |
| | No | Denied |
| | Yes | Approved |
| | No | Denied |
| | Yes | Approved |
| | No | Denied |

Principal's Approval:  3-6-24
(Signature) (Date)

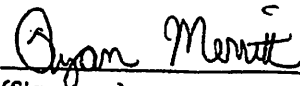
Superintendent or Designee Approval:  3/7/2024
(Signature) (Date)

Board Approval: _____
(Signature -Required for Out-of-State Travel) (Date)



**REQUEST FOR APPROVAL OF ODESSA HS TEXAS ASSOCIATION OF
FUTURE EDUCATORS' STUDENTS OUT-OF-STATE TRAVEL TO
WASHINGTON, DC**

Career and Technical Education's Texas Association of Future Educators (TAFE) student participant and teacher are requesting to travel to Washington DC on June 27th-July 2nd, 2024. The purpose of the trip is to allow State TAFE qualifiers to compete in the National competition. The cost of the trip will cover all transportation, activities, housing expenses, and a majority of the meals.

Exhibit A—Request for Trip Approval

Date of request: March 6, 2024

Date/time of departure: June 27, 2024 at 7:00 AM a.m. or p.m. (circle one)

Date/time of return: July 2, 2024 at 11:00 PM a.m. or p.m. (circle one)

Destination of trip: Washington DC

Purpose of trip, i.e., event to be attended, instructional value of the trip:
National competition for our TAFE qualifying student and sponsor. It provides Grow Your Own programming through the Educators Rising curriculum, & allows students to participate in leadership activities

Estimate of any permissible fees associated with the trip: \$5000

District employee sponsor and organization: Cheryl Cunningham

Number of students participating: 1

Number of chaperones participating: none

| Name of Chaperone | Criminal History Check Requested (circle one) |
|-------------------|---|
| NA | Yes No |
| NA | Yes No |
| NA | Yes No |

Signature of District employee sponsor: 

STUDENT ACTIVITIES
TRAVEL

FMG
(EXHIBIT)

For Office Use Only

School-sponsored trip:

- Approved
- Denied

Reason, if denied:

Chaperone approval or denial:

| Name of Chaperone | Criminal History Check Completed (circle one) | Decision (circle one) |
|-------------------|---|-----------------------|
| NA | Yes No | Approved Denied |
| NA | Yes No | Approved Denied |
| NA | Yes No | Approved Denied |

Principal's Approval: Cyrtia Jell 3-7-24
(Signature) (Date)

Superintendent or Designee Approval: Ayan Menon 3-7-2024
(Signature) (Date)

Board Approval: _____
(Signature - Required for Out-of-State Travel) (Date)



REQUEST FOR APPROVAL OF PERMIAN HS TEXAS BUSINESS PROFESSIONALS OF AMERICA STUDENTS OUT-OF-STATE TRAVEL TO CHICAGO, ILLINOIS

The Permian High School BPA (Business Professionals of America) student participants and teachers are requesting to travel to Chicago, Illinois on May 10-14, 2024. The purpose of the trip is to allow State BPA qualifiers to compete in the National competition and allow students to participate in National Business Leadership conferences. The cost of the trip will cover all registration fees, transportation, housing expenses, and meals.

Ector County ISD
068901

STUDENT ACTIVITIES
TRAVEL

FMG
(EXHIBIT)

Exhibit A—Request for Trip Approval

Date of request: 03/04/2024

Date/time of departure: 05/10/24 12pm a.m. or p.m. (circle one)

Date/time of return: 05/14/24 8pm a.m. or p.m. (circle one)

Destination of trip: Chicago, IL

Purpose of trip, i.e., event to be attended, instructional value of the trip:

Business Professionals of America National Leadership Conference. Students will compete
in Business, Finance, and Entrepreneurship competitions as well as participate in
leadership and citizenship conferences.

Estimate of any permissible fees associated with the trip: 9690.00

District employee sponsor and organization: Jessica Denney, Permian HS BPA Sponsor

Number of students participating: 3

Number of chaperones participating: 0

| Name of Chaperone | Criminal History Check Requested (circle one) |
|-------------------|---|
| <i>N/A</i> | Yes |
| | No |
| | Yes |
| | No |
| | Yes |
| | No |

Signature of District employee sponsor: *Jessica Denney*

Ector County ISD
068901

STUDENT ACTIVITIES
TRAVEL

FMG
(EXHIBIT)

For Office Use Only

School-sponsored trip:

- Approved
- Denied

Reason, if denied:

Chaperone approval or denial:

| Name of Chaperone | Criminal History Check Completed (circle one) | Decision (circle one) |
|-------------------|---|-----------------------|
| N/A | Yes | Approved |
| | No | Denied |
| N/A | Yes | Approved |
| | No | Denied |
| N/A | Yes | Approved |
| | No | Denied |

Principal's Approval: Dolosa Styles 3-4-24
(Signature) (Date)

Superintendent or Designee Approval: Ann Mendel 3/7/2024
(Signature) (Date)

Board Approval: _____
(Signature -Required for Out-of-State Travel) (Date)



**REQUEST FOR APPROVAL OF INSTRUCTIONAL MATERIALS
ALLOTMENT CERTIFICATION OF PROVISION OF INSTRUCTIONAL
MATERIALS SURVEY 2024-2025**

Attached is a copy of the Certification of Provision of Instructional Materials Survey 2024-2025. Texas Education Code §31.0211, 82nd Texas Legislature, requires each year the Board of Trustees of each district notify the State Board of Education that the instructional materials selected have been approved by the Board of Trustees for use in the school district.



Certification of Provision of Instructional Materials Survey 2024–25

Table of Contents

| | |
|--|--------|
| Table of Contents | - 2 - |
| Survey Pre-Work | - 4 - |
| 2024–25 Certification of Provision of Instructional Materials | - 4 - |
| Instructions to Complete the Certification Process for 2024–25 | - 5 - |
| Additional Supports | - 5 - |
| Review Terminology | - 5 - |
| About the Qualtrics Survey | - 5 - |
| Certification 2024–25 Survey | - 6 - |
| Background Information | - 6 - |
| LEA Information | - 6 - |
| Reading Language Arts Certification | - 7 - |
| Scope and Sequence - All Grade Levels RLA | - 7 - |
| English Reading Language Arts K–5 TEKS Coverage Certification | - 7 - |
| English Reading Language Arts K–5 Instructional Materials | - 7 - |
| Spanish Reading Language Arts K–5 TEKS Coverage Certification | - 8 - |
| Spanish Reading Language Arts K–5 Instructional Materials | - 8 - |
| English Reading Language Arts 6–8 TEKS Coverage Certification | - 9 - |
| English Reading Language Arts 6–8 Instructional Materials | - 9 - |
| English Reading Language Arts 9–12 TEKS Coverage Certification | - 10 - |
| English Reading Language Arts 9–12 Instructional Materials | - 10 - |
| Mathematics Certification | - 11 - |
| Scope and Sequence - All Grade Levels Mathematics | - 11 - |
| Mathematics K–5 TEKS Coverage Certification | - 11 - |
| Mathematics K–5 Instructional Materials | - 12 - |
| Mathematics 6–8 TEKS Coverage Certification | - 12 - |
| Mathematics 6–8 Instructional Materials | - 12 - |
| Mathematics 9–12 TEKS Coverage Certification | - 13 - |
| Mathematics 9–12 Instructional Materials | - 13 - |
| Social Studies Certification | - 14 - |
| Scope and Sequence - All Grade Levels Social Studies | - 14 - |
| Social Studies K–5 TEKS Coverage Certification | - 14 - |
| | - 2 - |

| | |
|--|--------|
| Social Studies K-5 Instructional Materials | - 14 - |
| Social Studies 6-8 TEKS Coverage Certification..... | - 15 - |
| Social Studies 6-8 Instructional Materials | - 15 - |
| Social Studies 9-12 TEKS Coverage Certification | - 16 - |
| Social Studies 9-12 Instructional Materials | - 16 - |
| Science Certification | - 17 - |
| Scope and Sequence - All Grade Levels Science | - 17 - |
| Science K-5 TEKS Coverage Certification | - 17 - |
| Science K-5 Instructional Materials..... | - 17 - |
| Science 6-8 TEKS Coverage Certification | - 18 - |
| Science 6-8 Instructional Materials..... | - 18 - |
| Science 9-12 TEKS Coverage Certification | - 19 - |
| Science 9-12 Instructional Materials..... | - 19 - |
| Children's Internet Protection Act | - 20 - |
| The Children's Internet Protection Act..... | - 20 - |
| Additional Informational Questions (Optional)*..... | - 21 - |
| Certification 2024-25 Survey Ratification [Printed and uploaded PDF] | - 23 - |
| Other Certified Subject Areas | - 24 - |

Survey Pre-Work

2024–25 Certification of Provision of Instructional Materials

In accordance with [Texas Education Code 31.1011](#), local educational agencies (LEAs) are required to certify annually to the State Board of Education (SBOE) and the commissioner that students have access to instructional materials covering all Texas Essential Knowledge and Skills (TEKS) for all required subjects, except physical education.

Additionally, LEAs are required to certify that they protect against access to obscene or harmful content in compliance with the requirements for certification under (i) the Children's Internet Protection Act (Pub. L. No. 106-554); (ii) Section [28.0022](#); (iii) Section [43.22](#), Penal Code; and (iv) any other law or regulation that protects students from obscene or harmful content. The TEKS Certification 2024–25 Survey includes a section to allow LEAs to certify they meet this requirement.

Like last year's process, the agency will utilize the following tools:

Certification 2024–25 Form:

Printable, hard copy of the survey to be completed offline and presented to the board of trustees or governing body for ratification and signatures.

Certification 2024–25 Survey:

Web-based application where LEAs will submit their responses collected on the TEKS Certification 2024–25 Form, and where LEAs will upload the signature page of the Form.

This year's Certification Process requires:

- The completion of the Certification 2024–25 Form;
- Ratification by the LEA's board of trustees or governing body in an open, public-noticed meeting; and
- Submission of the Certification 2024–25 Survey and upload of the ratified Certification 2024–25 Form.

TEA recommends that LEAs complete these steps by May 1, 2024. The Certification 2024–25 Form can be accessed at the following link on the [Instructional Materials webpage](#).

The state online instructional materials ordering system, EMAT, will close for annual maintenance on March 29, 2024, and is scheduled to reopen on May 15, 2024. Completion of the Certification Process is required to regain access to allotment funds when EMAT reopens in May of 2024.

Certification 2024–25 Survey submissions received after May 15, 2024, will typically be processed within five business days, then access to EMAT provided.

- 4 -

Instructions to Complete the Certification Process for 2024–25

1. Review the Certification 2024–25 Form: Print the fillable TEKS Certification 2024–25 Form found on the [Instructional Materials website](#).
2. Gather information: The form may require consultation with content area leads or other LEA staff.
3. Complete Certification 2024–25 Form: Complete the TEKS Certification 2024–25 Form by hand or digitally.
4. Obtain needed signatures: Ratify the Certification 2024–25 Form by the LEA's board of trustees or governing body in an upcoming, open board meeting.
5. Submit Certification 2024–25 Survey: Complete the online Certification 2024–25 Survey by answering the questions. Inside the survey you will upload the signed Allotment and Certification 2024–25 Form from Step 4. The survey will be open for submissions beginning Monday, March 18, 2024, and will be located on the [Instructional Materials website](#).

Additional Supports

- TEA will be hosting a webinar to review the Certification 2024–25 Process on *Monday, March 18th, at 2:00 p.m. CDT*. [Registration](#) is required.
- TEA will host office hours on *Monday, March 25, at 11:00 a.m. CDT and Thursday, March 28, at 11:00 a.m. CDT*. [Registration](#) is required.
- To facilitate completion of this year's submission, LEAs may request a copy of their previous year's submission by submitting a [Help Desk Ticket](#).
- For questions about the Certification 2024–25 Form, Survey, or Process, please submit a [Help Desk Ticket](#).

Review Terminology

Additional Supports

- **Scope and Sequence:** A document that provides a brief outline of the standards and a recommended teaching order for a particular course/grade-level over the course of a school year.
- **Full-subject materials** (often referred to as Tier 1 or core materials): instructional material designed to, if implemented as designed, provide a student with mastery of the essential knowledge and skills for a certain subject and grade level without the need for supplementation.
- **Supplemental materials** (may be used in Tier 1, Tier 2, or Tier 3 settings): instructional material designed to assist in the instruction of one or more of the essential knowledge and skills

About the Qualtrics Survey

Within the Qualtrics survey you will be given a list of commonly known publishers and products. Should your LEA use a LEA-developed product, or the product is not listed, you will be asked to write in the name of the publisher and product.

Certification 2024–25 Survey

Background Information

QUESTION 1.0: Name of person completing this form

Amy Miller

QUESTION 1.1: Your email address

Amy.miller@ectorcountyisd.org

QUESTION 1.2:

Select the role that best describes your position at your district or charter: [Single Select]

- Instructional Materials Coordinator
- Curriculum Director
- Principal
- Administrative Assistant
- Superintendent
- Other

LEA Information

QUESTION 2.0: Region #

18

QUESTION 2.1: LEA Name and Number

Ector County ISD 068901

QUESTION 2.2: Superintendent's Name

Dr. Scott Muri

QUESTION 2.3: Superintendent's email address

Scott.muri@ectorcountyisd.org

QUESTION 2.4: School board president's or governing body's name

Chris Stanley

QUESTION 2.5: School board president's or governing body's email address

Chris.stanley@ectorcountyisd.org

QUESTION 2.6: Date of the school board meeting at which the Certification Form was presented and approved?

April 16, 2024

Reading Language Arts Certification

Scope and Sequence - All Grade Levels RLA

QUESTION 3.0:

How is reading language arts content implemented in your LEA

Please indicate your LEA's approach to managing the implementation of reading language arts content in each of the following grade bands. [Single select for each grade band]

| | | The full-subject resources and scope and sequence are generally consistent across all classrooms | The full-subject resources being utilized are generally consistent across all classrooms, but there is variation in the scope and sequence between classrooms/campuses | The scope and sequence is generally consistent across all classrooms, but there is variation in which full-subject resources are being utilized between classrooms/campuses | Do not manage full-subject resources and scope and sequence at the LEA level | N/A |
|---------------|-------------|--|--|---|--|--------------------------|
| QUESTION 3.1: | Grades K-2 | <input checked="" type="checkbox"/> | <input type="checkbox"/> | <input type="checkbox"/> | <input type="checkbox"/> | <input type="checkbox"/> |
| QUESTION 3.2: | Grades 3-5 | <input checked="" type="checkbox"/> | <input type="checkbox"/> | <input type="checkbox"/> | <input type="checkbox"/> | <input type="checkbox"/> |
| QUESTION 3.3: | Grades 6-8 | <input checked="" type="checkbox"/> | <input type="checkbox"/> | <input type="checkbox"/> | <input type="checkbox"/> | <input type="checkbox"/> |
| QUESTION 3.4: | Grades 9-12 | <input checked="" type="checkbox"/> | <input type="checkbox"/> | <input type="checkbox"/> | <input type="checkbox"/> | <input type="checkbox"/> |

English Reading Language Arts K-5 TEKS Coverage Certification

QUESTION 4.0:

For school year 2024-25, will your LEA provide materials to cover 100% of the English RLA TEKS grades K-5? (This includes teacher- or LEA-developed materials. You may select "yes" even if not all classrooms use the same materials). [Single Select]

Yes

No

English Reading Language Arts K-5 Instructional Materials

QUESTION 5.0:

Share the full-subject and/or supplemental publisher(s)/ product(s) that teachers in your district will use regularly (once a week or more, on average) for English RLA grades K-5 instruction to ensure coverage of 100% of the TEKS.

Full-subject instructional materials (often referred to as Tier 1 or core materials): Instructional materials designed to, if implemented as designed, provide a student with mastery of the essential knowledge and skills for a certain subject and grade level without the need for supplementation.

- 7 -

Supplemental Materials (may be used in Tier 1, Tier 2, or Tier 3 settings): instructional materials designed to assist in the instruction of one or more essential knowledge and skill.

English RLA grades K-2 full-subject and/or supplemental publisher(s)/ product(s) used:

HMH School Publishers – Into Reading
Heinemann – Leveled Literacy Intervention Kits
Istation – Istation Reading
HMH School Publishers - Saxon Phonics

English RLA grades 3-5 full-subject and/or supplemental publisher(s)/ product(s) used:

HMH School Publishers – Into Reading
Heinemann – Leveled Literacy Intervention Kits
Istation – Istation Reading
TCM – Leveled Readers

Spanish Reading Language Arts K-5 TEKS Coverage Certification

QUESTION 6.0:

For school year 2024-25, will your LEA provide materials to cover 100% of the Spanish RLA TEKS grades K-5? (This includes teacher- or LEA-developed materials. You may select "yes" even if not all classrooms use the same materials) [Single select]

Yes

No

Spanish Reading Language Arts K-5 Instructional Materials

QUESTION 7.0:

Share the full subject and/or supplemental publisher(s)/ product(s) that teachers in your district will use regularly (once a week or more, on average) for Spanish RLA grades K-5 instruction to ensure coverage of 100% of the TEKS. [Single select for each grade band]

Full-subject instructional materials (often referred to as Tier 1 or core materials): Instructional materials designed to, if implemented as designed, provide a student with mastery of the essential knowledge and skills for a certain subject and grade level without the need for supplementation.

Supplemental Materials (may be used in Tier 1, Tier 2, or Tier 3 settings): Instructional materials designed to assist in the instruction of one or more essential knowledge and skill.

Spanish RLA grades K-2 full-subject and/or supplemental publisher(s)/ product(s) used:

HMH School Publishers- Arriba La Lectura
Estrellita – Estrellita – Sonidos, Silabas, Cuentos
Istation – Istation Español
Benchmark - Soluciones

Spanish RLA grades 3-5 full-subject and/or supplemental publisher(s)/ product(s) used:

HMH School Publishers – Arriba La Lectura
Istation – Istation Español
Benchmark - Soluciones

English Reading Language Arts 6-8 TEKS Coverage Certification

QUESTION 8.0:

For school year 2024-25, will your LEA provide materials to cover 100% of the English RLA TEKS grades 6-8? (This includes teacher- or LEA-developed materials. You may select "yes" even if not all classrooms use the same materials) [Single select]

- Yes
 No

English Reading Language Arts 6-8 Instructional Materials

QUESTION 9.0:

Share the full subject and/or supplemental publisher(s)/ product(s) that teachers in your LEA will use regularly (once a week or more, on average) for English RLA grades 6-8 instruction to ensure coverage of 100% of the TEKS.

Full-subject instructional materials (often referred to as Tier 1 or core materials): Instructional materials designed to, if implemented as designed, provide a student with mastery of the essential knowledge and skills for a certain subject and grade level without the need for supplementation.

Supplemental Materials (may be used in Tier 1, Tier 2, or Tier 3 settings): instructional materials designed to assist in the instruction of one or more essential knowledge and skill.

English RLA grades 6-8 full-subject and/or supplemental publisher(s)/ product(s) used:

- 9 -

SAVVAS – My Perspectives
SAVVAS – iLit
SIRIUS Reading, Writing, and Zingers
Heinemann – Leveled Literacy Intervention Kits

English Reading Language Arts 9–12 TEKS Coverage Certification

QUESTION 10.0:

For school year 2024–25, will your LEA provide materials to cover 100% of the English RLA TEKS grades 9–12? (This includes teacher- or LEA-developed materials. You may select "yes" even if not all classrooms use the same materials.)

- Yes
 No

English Reading Language Arts 9–12 Instructional Materials

QUESTION 11.0:

Are the full-subject and/or supplemental publisher(s)/ product(s) that teachers in your LEA will use regularly (once a week or more, on average) for English RLA grades 9–12 instruction to ensure coverage of 100% of the TEKS.

Full-subject instructional materials (often referred to as Tier 1 or core materials): Instructional materials designed to, if implemented as designed, provide a student with mastery of the essential knowledge and skills for a certain subject and grade level without the need for supplementation.

Supplemental Materials (may be used in Tier 1, Tier 2, or Tier 3 settings): instructional materials designed to assist in the instruction of one or more essential knowledge and skill.

English RLA grades 9–12 full-subject and/or supplemental publisher(s)/ product(s) used:

McGraw Hill – Study Sync
Perfection Learning – Connections
SIRIUS Zingers
SIRIUS Reading & Writing

Mathematics Certification

Scope and Sequence - All Grade Levels Mathematics

QUESTION 12.0:

How is mathematics content implemented in your LEA?

Please indicate your LEA's approach to managing the implementation of mathematics content in each of the following grade band. [Single select for each grade band]

| | | The full-subject resources and scope and sequence are generally consistent across all classrooms | The full-subject resources being utilized are generally consistent across all classrooms, but there is variation in the scope and sequence between classrooms/campuses | The scope and sequence is generally consistent across all classrooms, but there is variation in which full-subject resources are being utilized between classrooms/campuses | Do not manage full-subject resources and scope and sequence at the LEA level | N/A |
|---------------|-------------|--|--|---|--|--------------------------|
| QUESTION 3.1: | Grades K-2 | <input checked="" type="checkbox"/> | <input type="checkbox"/> | <input type="checkbox"/> | <input type="checkbox"/> | <input type="checkbox"/> |
| QUESTION 3.2: | Grades 3-5 | <input checked="" type="checkbox"/> | <input type="checkbox"/> | <input type="checkbox"/> | <input type="checkbox"/> | <input type="checkbox"/> |
| QUESTION 3.3: | Grades 6-8 | <input checked="" type="checkbox"/> | <input type="checkbox"/> | <input type="checkbox"/> | <input type="checkbox"/> | <input type="checkbox"/> |
| QUESTION 3.4: | Grades 9-12 | <input checked="" type="checkbox"/> | <input type="checkbox"/> | <input type="checkbox"/> | <input type="checkbox"/> | <input type="checkbox"/> |

Mathematics K-5 TEKS Coverage Certification

QUESTION 13.0:

For school year 2024-25, will your LEA provide materials to cover 100% of the mathematics TEKS grades K-5? (This includes teacher- or LEA-developed materials. You may select "yes" even if not all classrooms use the same materials). [Single Select]

Yes

No

Mathematics K–5 Instructional Materials

QUESTION 14.0:

Share the full-subject and/or supplemental publisher(s)/ product(s) that teachers in your LEA will use regularly (once a week or more, on average) for mathematics grades K–5 instruction to ensure coverage of 100% of the TEKS.

Full-subject instructional materials (often referred to as Tier 1 or core materials): Instructional materials designed to, if implemented as designed, provide a student with mastery of the essential knowledge and skills for a certain subject and grade level without the need for supplementation.

Supplemental Materials (may be used in Tier 1, Tier 2, or Tier 3 settings): instructional materials designed to assist in the instruction of one or more essential knowledge and skill.

Mathematics grades K–5 full-subject and/or supplemental publisher(s)/ product(s) used:

SAVVAS – enVision Math
HMH School Publishers – Do the Math
Lonestar – Lonestar Math

Mathematics 6–8 TEKS Coverage Certification

QUESTION 15.0

For school year 2024–25, will your LEA provide materials to cover 100% of the mathematics TEKS grades 6–8? (This includes teacher- or LEA-developed materials. You may select “yes” even if not all classrooms use the same materials). [Single Select]

Yes

No

Mathematics 6–8 Instructional Materials

QUESTION 16.0:

Share the full-subject and/or supplemental publisher(s)/ product(s) that teachers in your LEA or charter will regularly use (once a week or more, on average) for mathematics grades 6–8 instruction to ensure coverage of 100% of the TEKS.

Full-subject instructional materials (often referred to as Tier 1 or core materials): Instructional materials designed to, if implemented as designed, provide a student with mastery of the essential knowledge and skills for a certain subject and grade level without the need for supplementation.

Supplemental Materials (may be used in Tier 1, Tier 2, or Tier 3 settings): instructional materials designed to assist in the instruction of one or more essential knowledge and skill.

- 12 -

Mathematics grades 6–8 full-subject and/or supplemental publisher(s)/ product(s) used:

HMH School Publishers – Go Math, Algebra 1
Maneuvering the Middle
SIRIUS Math STAAR Review
All Things Algebra -All Things Algebra
College Board - Springboard

Mathematics 9–12 TEKS Coverage Certification

QUESTION 17.0:

For School Year 2024–25, will your LEA provide materials to cover 100% of the mathematics TEKS grades 9–12? (This includes teacher- or LEA-developed materials. You may select "yes" even if not all classrooms use the same materials). [Single Select]

- Yes
 No

Mathematics 9–12 Instructional Materials

QUESTION 18.0:

Share the full-subject and/or supplemental publisher(s)/ product(s) that teachers in your LEA or charter will regularly use (once a week or more, on average) for mathematics grades 9–12 instruction to ensure coverage of 100% of the TEKS.

Full-subject instructional materials (often referred to as Tier 1 or core materials): Instructional materials designed to, if implemented as designed, provide a student with mastery of the essential knowledge and skills for a certain subject and grade level without the need for supplementation.

Supplemental Materials (may be used in Tier 1, Tier 2, or Tier 3 settings): instructional materials designed to assist in the instruction of one or more essential knowledge and skill.

Mathematics grades 9–12 full-subject and/or supplemental publisher(s)/ product(s) used:

HMH School Publisher – Algebra 1, Algebra 2, and Texas Geometry
All Things Algebra – All Things Algebra
College Board – Springboard
All Things Geometry – All Things Geometry
IXL Math Digital Resource for Algebra
SIRIUS Math STAAR Review
McGraw-Hill- Pre-Calculus

Social Studies Certification

Scope and Sequence - All Grade Levels Social Studies

QUESTION 19.0:

How is social studies content implemented in your LEA?

Please indicate your LEA's approach to managing the implementation of social studies content in each of the following grade band. [Single select for each grade band]

| | | The full-subject resources and scope and sequence are generally consistent across all classrooms | The full-subject resources being utilized are generally consistent across all classrooms, but there is variation in the scope and sequence between classrooms/campuses | The scope and sequence is generally consistent across all classrooms, but there is variation in which full-subject resources are being utilized between classrooms/campuses | Do not manage full-subject resources and scope and sequence at the LEA level | N/A |
|---------------|-------------|--|--|---|--|--------------------------|
| QUESTION 3.1: | Grades K-2 | <input checked="" type="checkbox"/> | <input type="checkbox"/> | <input type="checkbox"/> | <input type="checkbox"/> | <input type="checkbox"/> |
| QUESTION 3.2: | Grades 3-5 | <input checked="" type="checkbox"/> | <input type="checkbox"/> | <input type="checkbox"/> | <input type="checkbox"/> | <input type="checkbox"/> |
| QUESTION 3.3: | Grades 6-8 | <input checked="" type="checkbox"/> | <input type="checkbox"/> | <input type="checkbox"/> | <input type="checkbox"/> | <input type="checkbox"/> |
| QUESTION 3.4: | Grades 9-12 | <input checked="" type="checkbox"/> | <input type="checkbox"/> | <input type="checkbox"/> | <input type="checkbox"/> | <input type="checkbox"/> |

Social Studies K-5 TEKS Coverage Certification

QUESTION 20.0:

For school year 2024-25, will your LEA provide materials to cover 100% of the social studies TEKS grades K-5? (This includes teacher- or LEA-developed materials. You may select "yes" even if not all classrooms use the same materials)

Yes

No

Social Studies K-5 Instructional Materials

QUESTION 21.0:

Share the full-subject and/or supplemental publisher(s)/ product(s) that teachers in your LEA or charter will regularly use (once a week or more, on average) for social studies grades K-5 instruction to ensure coverage of 100% of the TEKS.

Full-subject instructional materials (often referred to as Tier 1 or core materials): Instructional materials designed to, if implemented as designed, provide a student with mastery of the essential knowledge and skills for a certain subject and grade level without the need for supplementation.

Supplemental Materials (may be used in Tier 1, Tier 2, or Tier 3 settings): instructional materials designed to assist in the instruction of one or more essential knowledge and skill.

Social Studies grades K-5 full-subject and/or supplemental publisher(s)/ product(s) used:

| |
|--|
| <p>SAVVAS – My World Social Studies: Discovery Education Streaming</p> |
|--|

Social Studies 6–8 TEKS Coverage Certification

QUESTION 22.0:

For school year 2024–25, will your LEA provide materials to cover 100% of the social studies TEKS grades 6–8? (This includes teacher- or LEA-developed materials. You may select "yes" even if not all classrooms use the same materials)

Yes

No

Social Studies 6–8 Instructional Materials

QUESTION 23.0:

Select full-subject and/or supplemental publisher(s)/ product(s) that teachers in your LEA or charter will regularly use (once a week or more, on average) for social studies grades 6–8 instruction to ensure coverage of 100% of the TEKS.

Full-subject instructional materials (often referred to as Tier 1 or core materials): Instructional materials designed to, if implemented as designed, provide a student with mastery of the essential knowledge and skills for a certain subject and grade level without the need for supplementation.

Supplemental Materials (may be used in Tier 1, Tier 2, or Tier 3 settings): instructional materials designed to assist in the instruction of one or more essential knowledge and skill.

Social Studies grades 6–8 full-subject and/or supplemental publisher(s)/ product(s) used:

Discover Education Streaming 6-8
Jarrett Materials Mastering the TEKS- 8
Discovery Education: TECHBOOK 6-8
Document Based Questions (DBQ) Online 6-8
SIRIUS Education: 8th

Social Studies 9–12 TEKS Coverage Certification

QUESTION 24.0:

For school year 2024–25, will your LEA provide materials to cover 100% of the social studies TEKS grades 9–12? (This includes teacher- or LEA-developed materials. You may select “yes” even if not all classrooms use the same materials)

- Yes
 No

Social Studies 9–12 Instructional Materials

QUESTION 25.0:

Share the full-subject and/or supplemental publisher(s)/ product(s) that teachers in your LEA or charter will regularly use (once a week or more, on average) for social studies grades 9–12 instruction to ensure coverage of 100% of the TEKS.

Full-subject instructional materials (often referred to as Tier 1 or core materials): Instructional materials designed to, if implemented as designed, provide a student with mastery of the essential knowledge and skills for a certain subject and grade level without the need for supplementation.

Supplemental Materials (may be used in Tier 1, Tier 2, or Tier 3 settings): instructional materials designed to assist in the instruction of one or more essential knowledge and skill.

Social Studies grades 9–12 full-subject and/or supplemental publisher(s)/ product(s) used:

Jarrett Materials Mastering the TEKS – 11
Discovery Education Streaming 9-12
Discovery Education TECHBOOK 9-12
Document Based Questions (DBQ) Online 9-12
SIRIUS Education - 11

Science Certification

Scope and Sequence - All Grade Levels Science

QUESTION 26.0:

How is science content implemented in your LEA?

Please indicate your LEA's approach to managing the implementation of science content in each of the following grade bands. [Single select for each grade band]

| | | The full-subject resources and scope and sequence are generally consistent across all classrooms | The full-subject resources being utilized are generally consistent across all classrooms, but there is variation in the scope and sequence between classrooms/campuses | The scope and sequence is generally consistent across all classrooms, but there is variation in which full-subject resources are being utilized between classrooms/campuses | Do not manage full-subject resources and scope and sequence at the LEA level | N/A |
|---------------|-------------|--|--|---|--|--------------------------|
| QUESTION 3.1: | Grades K-2 | <input checked="" type="checkbox"/> | <input type="checkbox"/> | <input type="checkbox"/> | <input type="checkbox"/> | <input type="checkbox"/> |
| QUESTION 3.2: | Grades 3-5 | <input checked="" type="checkbox"/> | <input type="checkbox"/> | <input type="checkbox"/> | <input type="checkbox"/> | <input type="checkbox"/> |
| QUESTION 3.3: | Grades 6-8 | <input checked="" type="checkbox"/> | <input type="checkbox"/> | <input type="checkbox"/> | <input type="checkbox"/> | <input type="checkbox"/> |
| QUESTION 3.4: | Grades 9-12 | <input checked="" type="checkbox"/> | <input type="checkbox"/> | <input type="checkbox"/> | <input type="checkbox"/> | <input type="checkbox"/> |

Science K-5 TEKS Coverage Certification

QUESTION 27.0:

For school year 2024-25, will your LEA provide materials to cover 100% of the science TEKS grades K-5? (This includes teacher- or LEA-developed materials. You may select "yes" even if not all classrooms use the same materials)

Yes

No

Science K-5 Instructional Materials

QUESTION 28.0:

Share the full-subject and/or supplemental publisher(s)/ product(s) that teachers in your LEA or charter will regularly use (once a week or more, on average) for science grades K-5 instruction to ensure coverage of 100% of the TEKS.

Full-subject instructional materials (often referred to as Tier 1 or core materials): Instructional materials designed to, if implemented as designed, provide a student with mastery of the essential knowledge and skills for a certain subject and grade level without the need for supplementation.

Supplemental Materials (may be used in Tier 1, Tier 2, or Tier 3 settings): instructional materials designed to assist in the instruction of one or more essential knowledge and skill.

Science grades K-5 full-subject and/or supplemental publisher(s)/ product(s) used:

McGraw Hill – Texas Science K-5
Discovery Education: Mystery Science K-5
Discovery Education: Streaming K-5
SIRIUS Education - 5

Science 6-8 TEKS Coverage Certification

QUESTION 29.0:

For school year 2024-25, will your LEA provide materials to cover 100% of the science TEKS grades 6-8? (This includes teacher- or LEA-developed materials. You may select "yes" even if not all classrooms use the same materials)

- Yes
 No

Science 6-8 Instructional Materials

QUESTION 30.0:

Share the full-subject and/or supplemental publisher(s)/ product(s) that teachers in your LEA or charter will regularly use (once a week or more, on average) for science grades 6-8 instruction to ensure coverage of 100% of the TEKS.

Full-subject instructional materials (often referred to as Tier 1 or core materials): Instructional materials designed to, if implemented as designed, provide a student with mastery of the essential knowledge and skills for a certain subject and grade level without the need for supplementation.

Supplemental Materials (may be used in Tier 1, Tier 2, or Tier 3 settings): instructional materials designed to assist in the instruction of one or more essential knowledge and skill.

Science grades 6-8 full-subject and/or supplemental publisher(s)/ product(s) used:

- 18 -

SIRIUS Education – 8
Discovery Education: Steaming 6-8
SAVVAS – Realize 6-8
Brainpop Science

Science 9–12 TEKS Coverage Certification

QUESTION 31.0:

For school year 2024–25, will your LEA provide materials to cover 100% of the science TEKS grades 9–12? (This includes teacher- or LEA-developed materials. You may select "yes" even if not all classrooms use the same materials)

- Yes
 No

Science 9–12 Instructional Materials

QUESTION 32.0:

Share the full-subject and/or supplemental publisher(s)/ product(s) that teachers in your district or charter will regularly use (once a week or more, on average) for science grades 9–12 instruction to ensure coverage of 100% of the TEKS.

Full-subject instructional materials (often referred to as Tier 1 or core materials): Instructional materials designed to, if implemented as designed, provide a student with mastery of the essential knowledge and skills for a certain subject and grade level without the need for supplementation.

Supplemental Materials (may be used in Tier 1, Tier 2, or Tier 3 settings): instructional materials designed to assist in the instruction of one or more essential knowledge and skill.

Science grades 9–12 full-subject and/or supplemental publisher(s)/ product(s) used:

McGraw-Hill – Biology, Chemistry, Physics, Aquatic, Anatomy & Physiology, Astronomy, Environmental Science
Cengage Learning – Forensics
Explore Learning – Gizmos 9-12
Discovery Education Streaming – 9-12
Vernier Connections 9-12
SIRIUS Education - Biology

Children's Internet Protection Act

The Children's Internet Protection Act

The Children's internet protection Act (CIPA) was enacted by Congress in 2000 to address concerns about children's access to obscene or harmful content over the Internet. (You may find more information on the FCC website.)

In accordance with Texas Administrative Code 19 TAC §66.105, school districts or charter schools are required to certify that they protect against access to obscene or harmful content in compliance with the requirements for certification under the Children's Internet Protection Act, 47 USC §254(h)(5)(B) and (C), Section [28.0022](#), [Section 43.22](#), Penal Code, and any other law or regulation that protects students from obscene or harmful content.

QUESTION 34.0: Does your district or charter school protect against access to obscene or harmful content in compliance with the requirements for certification under the Children's Internet Protection Act, 47 USC §254(h)(5)(B) and (C), Section 28.0022, Penal Code, and any other law or regulation that protects students from obscene or harmful content?

- Yes
 No

Additional Informational Questions (Optional)*

QUESTION 35.0:

Has your LEA used, or do you plan to use, the Texas Resource Review (TRR) to inform local decisions related to instructional materials adoption?

Yes

No

QUESTION 35.1:

If "Yes" is selected: In which subject area(s) have you used the TRR to obtain information about the quality of products? *

English Reading Language Arts

Spanish Reading Language Arts

Prekindergarten

English Phonics

Spanish Phonics

Science

QUESTION 36.0:

How likely is it you would recommend TRR to other educators? 0 (Not at all likely) to 10 (Extremely Likely)*

1.

2.

3.

4.

5.

6.

7.

8.

9.

10.

Commented [FD1]: the question #s for this section appear to be off/out of order

QUESTION 37.0:

Assessment Platform: Select the assessment platform (if any) your LEA leverages for unit/module, diagnostic, or interim, and for which type of assessments.

| Product | Interim | Diagnostic | Unit/Module Formatives |
|--|--------------------------|-------------------------------------|-------------------------------------|
| Eduphoria | <input type="checkbox"/> | <input checked="" type="checkbox"/> | <input checked="" type="checkbox"/> |
| DMCA | <input type="checkbox"/> | <input type="checkbox"/> | <input type="checkbox"/> |
| Texas Formative Assessment Resource | <input type="checkbox"/> | <input type="checkbox"/> | <input type="checkbox"/> |
| STAAR Interim | <input type="checkbox"/> | <input type="checkbox"/> | <input type="checkbox"/> |
| Other: | <input type="checkbox"/> | <input type="checkbox"/> | <input type="checkbox"/> |
| <input type="text" value="NWEA MAP"/> | | | |
| Other: | <input type="checkbox"/> | <input checked="" type="checkbox"/> | <input checked="" type="checkbox"/> |
| <input type="text" value="Insert here"/> | | | |
| Other: | <input type="checkbox"/> | <input type="checkbox"/> | <input type="checkbox"/> |
| <input type="text" value="Insert here"/> | | | |

QUESTION 38.0:

Is your LEA planning on using the SBOE-Approved Instructional Materials Allotment?

SBOE-Approved Instructional Materials Allotment - An annual entitlement of \$40 per enrolled student credited to a district's Instructional Materials and Technology Account to procure instructional materials placed on the approved list maintained by the SBOE under TEC §31.022. See TEC, §48.307

- Yes, we are.
- No, we do not have a need for it.
- Unsure, we need more information.

QUESTION 39.0:

Is your LEA planning on using the Open Education Resource Funding Allotment?

Open Education Resource Printing Allotment - An annual entitlement of up to \$20 per enrolled student credited to a district's Instructional Materials and Technology Account for expenses incurred in the printing and shipping of SBOE-approved open education resources. See TEC, §48.308

- Yes, we are.
- No, we do not have a need for it.
- Unsure, we need more information.

Certification 2024-25 Survey Ratification [Printed and uploaded PDF]

In accordance with [Texas Education Code §31.1011](#), school districts and open-enrollment charter schools are required to certify annually to the State Board of Education and the commissioner that, for each subject in the required curriculum other than physical education, students have access to instructional materials that cover all the Texas Essential Knowledge and Skills (TEKS) for the coming school year. Additionally, in accordance with Texas Administrative Code [19 TAC §66.105](#), school districts or charter schools are required to certify that they protect against access to obscene or harmful content in compliance with the requirements for certification under the Children's Internet Protection Act, 47 USC §254(h)(5)(B) and (C).

These certifications must be ratified by local school boards of trustees or governing bodies in public, noticed meetings. Districts and open-enrollment charter schools will be unable to order instructional materials through EMAT until the certifications have been received by the Texas Education Agency (TEA).



REQUEST FOR APPROVAL OF LOW ATTENDANCE WAIVER

Low Attendance Waiver

The T.E.A. allows districts/campuses to submit a Low Attendance waiver application that any instructional days with attendance at least ten (10) percentage points below the last school year's average attendance due to weather, health or safety issues be excluded from ADA calculations for the current school year.

ECISD met this qualification on January 16 due to weather conditions.

Chart below outlines the specific information.

| | 2023-2024 | | | | | |
|----------------|--------------------------------|-------|-------|----------|----------|------------|
| | DATES OF HIGHEST # OF ABSENCES | # ABS | # MBR | CY ADA % | LY ADA % | PLUS/MINUS |
| ECISD District | 1/16/2024 | 7794 | 31350 | 75.10% | 91.6% | -16.5% |
| | | | | | | |
| | | | | | | |

Administrative Recommendation:

Approval of the Low Attendance Waiver



PRESENTATION OF THE FINE ARTS PROGRAM

Dr. Aaron Hawley, Executive Director of Fine Arts from Curriculum and Instruction will present a program overview. The Fine Arts update will include information on the impact of Fine Arts on student achievement, the fifth-grade strings program & community support of the program, the plans for middle school Fine Arts next year, and an update on the Fine Arts portions of the bond.

ECISD Fine Arts School Board Presentation



ECISD Fine Arts

100

The mission of the ECISD Fine Arts department is to prepare our students for the future by fostering their creativity, self-expression, and excellence.

Fine Arts District Personnel



THELMA CHAPA
Administrative Assistant



DR. AARON HAWLEY
Executive Director



SHARI RILEY
Elementary Coordinator

Fine Arts Campus Personnel

Head Directors

- Band - Sonia Campos & Jeff Whitaker
- Choir - Ginger Storey & Laurie Wash
- Dance - Kristina Rios & Kristin Carter
- Guitar - Jose Campos
- Harp - Francesca Florance
- JROTC - Col. Henry Canas & Col. David Edson
- Mariachi - Jerimie Hernandez
- Orchestra - John Benton & Todd Berridge
- Theatre - Chyree LeMaster & Micaela Grenier
- Visual Arts - Baldo Valeriano & Laree Morris

Teachers

- 42 Elementary Teachers
- 90 Secondary Fine Arts Teachers
- 4 JROTC Instructors



ECISD Teacher Art Show at OC
Fall 2023

Fine Arts Quick Facts

- Total Fine Arts Enrollment: 25,978 (79% of ECISD students)
- Elementary Music at All Campuses
- 15 Elementary Campuses have 5th Grade Strings
- Two STEAM Campuses (Science, Technology, Engineering, Art, Math) at Gale Pond Alamo & Hays
- Milam Fine Arts Academy - Offers Elementary Music, Dance, Harp, Suzuki Orchestra, Theatre, Visual Arts
- Secondary Programs - Band, Choir, Dance, Guitar, Harp, Mariachi, Orchestra, Theatre, Visual Arts



Permian Theatre - Fall 2023

ECISD Fine Arts Presentation Topics

IMPACT ON STUDENT
ACHIEVEMENT

FIFTH GRADE STRINGS
PROGRAM
& COMMUNITY SUPPORT

PLANS FOR MIDDLE SCHOOL
FINE ARTS PROGRAMS

BOND UPDATE

Impact on Student Achievement

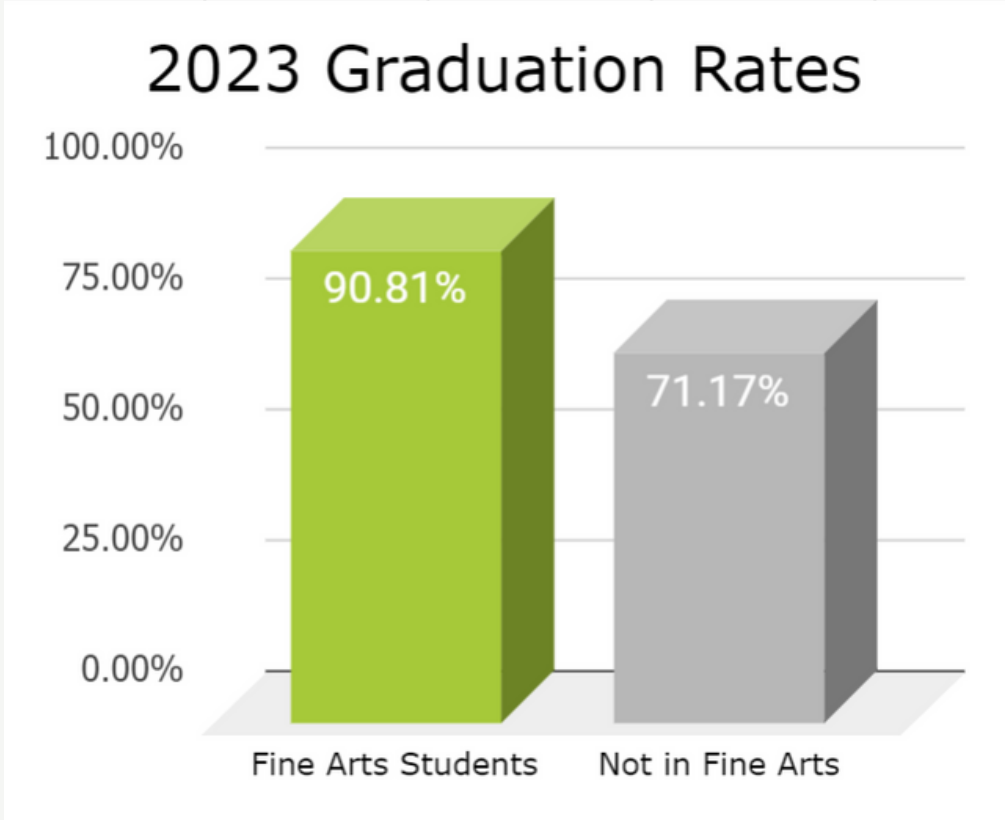

105

Impact on Student Achievement

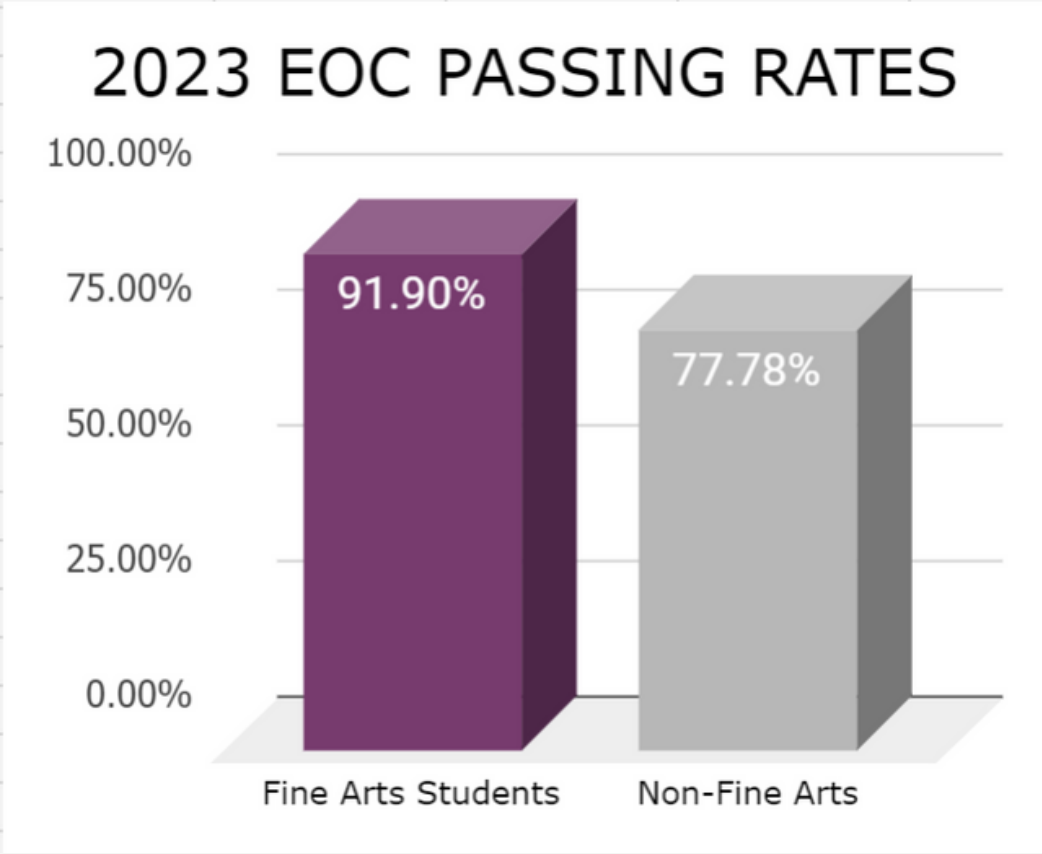

106



5th Grade Strings Program

Two years ago, the Fine Arts department was approved to restart the Strings Program at all ECISD elementary campuses. This decision was made due to the very low enrollment in our Orchestra programs across the district.

107

- All ECISD Orchestra teachers are now assigned to teach elementary strings for a portion of their day.
- 5th Grade Strings has been added to 15 campuses, and we plan to expand as staffing allows.
- There are already over 400 elementary students involved in the program!
- One new itinerant strings position was added in 2023, and Ms. Sally Pool was able to return to ECISD to fill this position. She teaches at 5 campuses and helps mentor our young orchestra teachers.
- Programs began performing last spring, and many campuses had their students perform at a Winter Concert this past season!

09

Community Support

A very special thank you to the Education Foundation, Celeste Potter, and Dr. Susan Lara for helping us secure special funding for Fine Arts. The fifth-grade strings program would not have come to fruition without the generosity of local foundations and the coordination of the Education Foundation to secure these grants!



FMH
FOUNDATION

The Rea Charitable Trust



109







FMH FOUNDATION

We would like to highlight the generosity of the FMH Foundation. Their philanthropy continues to bless the students of ECISD and the entire Permian Basin. Over the past four years, they have provided new uniforms for both Odessa HS and Permian HS, installed a new sound booth and updated the AV equipment in the Permian Auditorium, supported our 5th-grade strings program, and purchased 4 amazing Steinway grand pianos. This spring, they awarded our Fine Arts department \$200,000 for new upright pianos!

Plan for Middle School Fine Arts

We are very pleased that all six of our ECISD Middle School campuses will have Fine Arts programs next year. Here are the planned course offerings:

110

| Bonham MS | Bowie MS | Crockett MS | Nimitz MS | Wilson & Young MS | Ector MS |
|---|--|--|--|--|--|
|  |  |  |  |  |  |
| Band | Band | Band | Band | Band | Band |
| Choir | Choir | Choir | Choir | Choir | Choir * |
| Orchestra | Orchestra | Orchestra | Orchestra | Orchestra | Orchestra * |
| Theatre | Theatre * | Theatre * | Theatre | Dance | Dance |
| Visual Arts | Visual Arts | Visual Arts | Visual Arts | Visual Arts | Visual Arts |
| | Harp - Transfer | Mariachi - Transfer | | | Mariachi – Transfer * |

** Availability of these courses is based upon course requests and staffing*



2023 ECISD Bond

18.5 Million for Fine Arts & JROTC

- **12.5 Million** - Complete renovation of the Permian High School Auditorium/Theater
 - Permian HS auditorium is original to the building, built in 1959.
 - The original seats were replaced in 1995, with used seats purchased from another school district.
 - Recent upgrades to light and sound will be integrated into the renovation
- **3.5 Million** - Replace outdated instruments 111
 - Over 3,200 instruments are owned by the district
 - 1,000 instruments are older than 15 years old & 375 instruments are 30 years or older
 - Estimated replacement cost of approximately 1000 instruments = \$3.5 million
- **1.5 Million** - JROTC Facility Needs
- **\$685,000** - Uniforms for middle school bands and mariachi
 - Lifespan of a marching band uniform is 8-10 years. Last replaced with 2012 bond
 - We have replaced the High School Marching Band uniforms over the past two years with generous donations from the FMH Foundation totaling \$390,000
- **\$165,000** - Classroom instruments for elementary campuses
- **\$150,000** - Performance risers for all middle school choirs



Bond Update – Fine Arts Initiatives

Permian Performing Spaces Renovation Project & JRTOC Facilities

- PSC selected as the Architect for both Projects
- Next Steps - Create committees to meet with the Architect
- Over the next year, we will work with the Architect to design plans. Anticipated construction beginning in June 2025.

112

Capital Purchases - Risers, Instruments, Uniforms

- Approved - recommended timeline of purchases
- Ongoing - Updating quotes from vendors
- Ongoing - Updating lists of instruments to replace
- Currently- Purchasing instruments

We already have purchase orders for 128 new instruments - valued at \$302,227!

Instrument Replacements

Three years ago, we adopted a new inventory management system. Each spring, we have been evaluating/inventorying our instruments to determine their working condition.

The Fine Arts department has created a list of standards for each type of instrument.

The distribution of new instruments will be determined according to:

- Condition of the instruments
- Standards taking into the socio-economic status of the students at the campus
- The specific requests from the directors.



Thank You!

QUESTIONS?

EMAIL ADDRESS

Michael.Hawley@ectorcountyisd.org

PHONE NUMBER

(432) 456-8615





BUDGET UPDATE DISCUSSION

Discussion with the Board regarding 2024-2025 budget.



BOARD OF TRUSTEES' CONTINUING EDUCATION REPORT

The State Legislature requires school districts to provide the public with a record of school board member continuing education credit hours. Under separate cover you will receive the Continuing Education Credit Hours Report for all Board members, as recorded by the Texas Association of School Boards.



Ector County Independent School District

Action Page

TO: Board of Trustees

FROM: Dr. Anthony Sorola, Associate Superintendent of Athletics, Human Capital, and Operations

SUBJECT: DISCUSSION AND REQUEST FOR APPROVAL OF THE 2024-2025 ECISD EMPLOYEMENT CONTRACT RENEWALS FOR ADMINISTRATORS, TEACHERS, AND OTHER PROFESSIONAL SUPPORT EMPLOYEES

DATE: April 16, 2024

In an effort to retain the skilled instructional leadership of ECISD Administrators, Teachers, and other professional support employees, we strive to be able to recommend approval of their contracts to secure their employment as early in advance of the 2024-2025 school year as possible.

Administrative Recommendation:
Request for Approval of the 2024-2025 Employment Contract Renewals for Administrators, Teachers, and Other Professional Support Employees



Ector County Independent School District

Action Page

TO: Board of Trustees
FROM: Dr. Keeley Boyer, Chief of Schools
SUBJECT: REQUEST FOR APPROVAL OF RECOMMENDATION TO HIRE
PRINCIPAL AT BUICE ELEMENTARY SCHOOL
DATE: April 16, 2024

Recommendation to Hire Principal at Buice Elementary School.

Administrative Recommendation:

Approval of Personnel Recommendation to Hire Principal at Buice Elementary School.



Ector County Independent School District

Action Page

TO: Board of Trustees
FROM: Dr. Keeley Boyer, Chief of Schools
SUBJECT: REQUEST FOR APPROVAL OF RECOMMENDATION TO HIRE EXECUTIVE DIRECTOR OF LEADERSHIP
DATE: April 16, 2024

Recommendation to Hire Executive Director of Leadership.

Administrative Recommendation:

Approval of Personnel Recommendation to Hire Executive Director of Leadership.



TO: Board of Trustees

FROM: Dr. Anthony Sorola, Associate Superintendent of Athletics, Human Capital and Operations and Alicia Syverson, Associate Superintendent of Student and School Support

SUBJECT: REQUEST FOR APPROVAL OF PERSONNEL RECOMMENDATION FOR THE EXECUTIVE DIRECTOR OF GUIDANCE, COUNSELING AND WELLNESS

DATE: April 16, 2024

Recommendation to hire Executive Director of Guidance, Counseling and Wellness.

Administrative Recommendation:
Approval of Personnel Recommendation.



INFORMATION ITEMS

- Acknowledgement of Quarterly Donations
- Financials
- Purchases over \$50,000 Informational Report
- March Routine Personnel Report

TO: Board of Trustees
Ector County ISD

FROM: Deborah Ottmers, Chief Financial Officer

SUBJECT: Acknowledgement of Donations
January through March 2024

DATE: April 16, 2024



\$ 642,287.38

| Donor | Donation Description | Campus/Dept Name | Org # | Value | Total |
|----------------------------|--|----------------------------------|------------|---------------|----------------------|
| Silva Law Office | Prom 2024 | Odessa High School | 002 | \$ 3,000.00 | |
| Various | Student Council State Trip | Odessa High School | 002 | \$ 2,800.00 | |
| B-Line Filter & Supply | Mariachi Performance | Odessa High School | 002 | \$ 1,500.00 | |
| OHS Gymnastic Booster Cl | Velcro strips for gymnastics floor | Odessa High School | 002 | \$ 106.92 | |
| Armando Lopez | Broncho polo | Odessa High School | 002 | \$ 150.00 | |
| Lauren Hayslip | benches - TLC | Odessa High School | 002 | \$ 700.00 | |
| | | Odessa High School | 002 | | \$ 8,256.92 |
| PHS Football Boosters | indoor practice facility turf | Permian High School | 003 | \$ 160,500.00 | |
| PHS Baseball Boosters | shade over home and visitor stands | Permian High School | 003 | \$ 41,350.00 | |
| PHS Theatre Boosters | Theatre cargo trailer | Permian High School | 003 | \$ 7,200.00 | |
| J Ruise Trust Account | Track Supplies | Permian High School | 003 | \$ 3,959.20 | |
| Sewell Ford | PHS Debate | Permian High School | 003 | \$ 1,000.00 | |
| Various | Jr. Board | Permian High School | 003 | \$ 1,750.00 | |
| PHS Baseball Boosters | Fence Cap replacement | Permian High School | 003 | \$ 1,619.76 | |
| Various | Track Supplies | Permian High School | 003 | \$ 750.00 | |
| | | Permian High School | 003 | | \$ 218,128.96 |
| Sewell Ford | Involve leadership training for student council | Odessa CTE ECHS | 014 | \$ 1,500.00 | |
| OCTECHS Spirit Club | Trunk or Treat Haunted House | Odessa CTE ECHS | 014 | \$ 642.00 | |
| Ricardo Barreno | speaker fee | Odessa CTE ECHS | 014 | \$ 500.00 | |
| OCTECHS Spirit Club | Trunk or Treat Haunted House | Odessa CTE ECHS | 014 | \$ 234.00 | |
| OCTECHS Spirit Club | books | Odessa CTE ECHS | 014 | \$ 195.00 | |
| OCTECHS Spirit Club | Trunk or Treat Haunted House | Odessa CTE ECHS | 014 | \$ 127.00 | |
| Moreno Transportation | books | Odessa CTE ECHS | 014 | \$ 100.00 | |
| | | Odessa CTE ECHS | 014 | | \$ 3,298.00 |
| PTA | locker repairs | Austin Elementary School | 102 | \$ 4,000.00 | |
| PTA | 230 headphones | Austin Elementary School | 102 | \$ 4,000.00 | |
| PTA | outdoor sensory path | Austin Elementary School | 102 | \$ 2,000.00 | |
| PTA | refrigerator for faculty lounge | Austin Elementary School | 102 | \$ 750.00 | |
| PTA | dryer | Austin Elementary School | 102 | \$ 500.00 | |
| Heritage Real Estate | luncheon | Austin Elementary School | 102 | \$ 200.00 | |
| Highlands Residential Mor | luncheon | Austin Elementary School | 102 | \$ 200.00 | |
| | | Austin Elementary School | 102 | | \$ 11,650.00 |
| HEB Literacy Program | library items | Johnson Elementary School | 128 | \$ 1,000.00 | |
| Simplec Post Boutique | students in need | Johnson Elementary School | 128 | \$ 500.00 | |
| Garden Chick GFC Ntl Ad F | students in need | Johnson Elementary School | 128 | \$ 444.00 | |
| | | Johnson Elementary School | 128 | | \$ 1,944.00 |
| Education Foundation | Director STEAM Initiatives salary remainder of 23 24 | Development Department | 705 | \$ 36,987.00 | |
| Sewell Family of Dealershi | Signing Day donation | Development Department | 705 | \$ 15,250.00 | |
| SIW Pipe | Awards for Excellence sponsorship | Development Department | 705 | \$ 5,000.00 | |
| JumBurrito | Awards for Excellence sponsorship | Development Department | 705 | \$ 1,000.00 | |
| Complex Community FCU | Awards for Excellence sponsorship | Development Department | 705 | \$ 1,000.00 | |
| Investment Corp of Am | Awards for Excellence sponsorship | Development Department | 705 | \$ 1,000.00 | |
| JSA Architects | Awards for Excellence sponsorship | Development Department | 705 | \$ 250.00 | |
| CMC Business Systems | Awards for Excellence sponsorship | Development Department | 705 | \$ 250.00 | |
| Education Foundation | Awards for Excellence sponsorship | Development Department | 705 | \$ 250.00 | |
| PB Workforce Developme | Recognition Award | Day Care Department | 811 | \$ 500.00 | |
| Jr League | Supplies for students in need | Community Outreach Department | 856 | \$ 5,000.00 | |
| All Brite (Sewell Ford) | Supplies for students in need | Community Outreach Department | 856 | \$ 3,000.00 | |
| Sams Club | Grad lab food | Community Outreach Department | 856 | \$ 1,250.00 | |
| Walmart - West | food for MV groups | Community Outreach Department | 856 | \$ 1,250.00 | |
| Walmart - East | Supplies for students in need | Community Outreach Department | 856 | \$ 1,000.00 | |
| HEB | Supplies for students in need | Community Outreach Department | 856 | \$ 150.00 | |
| Ed Foundaiton/FMH Foun | 21 pianos | Fine Arts Department | 861 | \$ 197,750.00 | |
| CDW | 220 Chromebooks | 1402 Department | 864 | \$ 110,906.40 | |

TO: Board of Trustees
Ector County ISD

FROM: Deborah Ottmers, Chief Financial Officer

SUBJECT: Acknowledgement of Donations
January through March 2024

DATE: April 16, 2024



\$ 642,287.38

| Donor | Donation Description | Campus/Dept Name | | Org # | Value | Total |
|----------------------|---|--------------------------|------------|-------|--------------|----------------------|
| Education Foundation | field trip | Adanced Academics | Department | 881 | \$ 129.10 | |
| Education Foundation | field trip | Adanced Academics | Department | 881 | \$ 80.00 | |
| Education Foundation | Project Lead the Way teaching materials | CTE | Department | 891 | \$ 17,007.00 | |
| | | Total Departments | | | | \$ 399,009.50 |



FINANCIALS

The financial statements for the three required adopted budgets for the most recently closed month for the current fiscal year follow.

GENERAL FUND (199) YTD BUDGET REPORT
FEBRUARY 29, 2024

FOR 2024 08

| | ORIGINAL APPROP | TRANFRS/ ADJSTMTS | REVISED BUDGET | YTD ACTUAL | ENCUMBRANCES | AVAILABLE BUDGET | PCT USE/COL |
|-----------------------------------|--------------------|----------------------|-------------------|-----------------------|-----------------------|-----------------------|----------------|
| 199 GENERAL FUND | | | | | | | |
| 00 GENERAL LEDGER AND REVENUE | -331,728,451 | -4,465,416 | -336,193,867 | -222,889,656.30 | .00 | -113,304,210.70 | 66.3% |
| 11 INSTRUCTION | 202,095,977 | 3,283,145 | 205,379,122 | 113,929,236.82 | 58,021,181.51 | 33,428,703.67 | 83.7% |
| 12 INSTRUCTIONAL RES & MEDIA SERV | 2,159,943 | 17,760 | 2,177,703 | 1,087,840.91 | 557,358.70 | 532,503.39 | 75.5% |
| 13 CURRICULUM & STAFF DEVELOPMENT | 8,719,086 | -888,984 | 7,830,102 | 4,281,248.23 | 1,500,334.98 | 2,048,518.79 | 73.8% |
| 21 INSTRUCTIONAL LEADERSHIP | 5,656,651 | -122,483 | 5,534,168 | 3,478,754.64 | 1,280,546.90 | 774,866.46 | 86.0% |
| 23 SCHOOL LEADERSHIP | 21,539,711 | 210,110 | 21,749,821 | 12,361,499.51 | 5,775,617.42 | 3,612,704.07 | 83.4% |
| 31 GUID, COUNS & EVALUATION SERVS | 13,981,624 | 368,307 | 14,349,931 | 8,896,618.97 | 4,570,969.53 | 882,342.50 | 93.9% |
| 32 SOCIAL WORK SERVICES | 1,811,527 | 960 | 1,812,487 | 938,180.04 | 426,584.96 | 447,722.00 | 75.3% |
| 33 HEALTH SERVICES | 3,254,406 | 34,000 | 3,288,406 | 1,906,670.27 | 978,303.72 | 403,432.01 | 87.7% |
| 34 STUDENT TRANSPORTATION | 10,125,228 | 1,732,696 | 11,857,924 | 6,646,099.09 | 2,523,719.81 | 2,688,105.10 | 77.3% |
| 36 CO/EXTRACURRICULAR ACTIVITIES | 8,162,823 | -13,512 | 8,149,311 | 4,481,006.26 | 1,726,231.31 | 1,942,073.43 | 76.2% |
| 41 GENERAL ADMINISTRATION | 9,030,571 | 209,009 | 9,239,580 | 5,439,273.64 | 2,690,178.24 | 1,110,128.12 | 88.0% |
| 51 FACILITIES MAINT & OPERATIONS | 38,015,291 | 3,114,406 | 41,129,697 | 24,297,061.62 | 9,827,180.51 | 7,005,454.87 | 83.0% |
| 52 SECURITY & MONITORING SERVICES | 3,787,609 | 2,379,312 | 6,166,921 | 3,563,516.65 | 1,821,865.97 | 781,538.38 | 87.3% |
| 53 DATA PROCESSING SERVICES | 10,822,562 | -1,305,639 | 9,516,923 | 5,793,862.25 | 3,297,580.19 | 425,480.56 | 95.5% |
| 61 COMMUNITY SERVICES | 1,558,309 | 129,183 | 1,687,492 | 1,032,706.59 | 452,696.23 | 202,089.18 | 88.0% |
| 71 DEBT SERVICE | 1,294,300 | 91,000 | 1,385,300 | 688,563.51 | 406,449.20 | 290,287.29 | 79.0% |
| 81 FACILITIES ACQUISITION & CONST | 1,500,000 | 10,538,653 | 12,038,653 | 3,488,821.81 | 3,083,898.23 | 5,465,932.96 | 54.6% |
| 99 INTERGOVERNMENTAL CHARGES | 2,132,882 | 0 | 2,132,882 | 1,026,827.50 | 1,106,054.50 | .00 | 100.0% |
| TOTAL GENERAL FUND | 13,920,049 | 15,312,507 | 29,232,556 | -19,551,867.99 | 100,046,751.91 | -51,262,327.92 | 275.4% |
| TOTAL REVENUES | -332,253,451 | -4,465,416 | -336,718,867 | -222,889,656.30 | .00 | -113,829,210.70 | |
| TOTAL EXPENSES | 346,173,500 | 19,777,923 | 365,951,423 | 203,337,788.31 | 100,046,751.91 | 62,566,882.78 | |
| GRAND TOTAL | 13,920,049 | 15,312,507 | 29,232,556 | -19,551,867.99 | 100,046,751.91 | -51,262,327.92 | 275.4% |

125

** END OF REPORT - Generated by BAUMANN, DUSTY **

SCHOOL NUTRITION (240) YTD BUDGET REPORT
 FEBRUARY 29, 2024

FOR 2024 08

| | ORIGINAL APPROP | TRANFRS/ ADJSTMTS | REVISED BUDGET | YTD ACTUAL | ENCUMBRANCES | AVAILABLE BUDGET | PCT USE/COL |
|---|--------------------|----------------------|-------------------|----------------|--------------|---------------------|----------------|
| 240 SCHOOL NUTRITION | | | | | | | |
| 00 GENERAL LEDGER AND REVENUE | -18,064,278 | -2,092,080 | -20,156,358 | -15,962,093.75 | .00 | -4,194,264.25 | 79.2% |
| 35 FOOD SERVICE | 18,064,278 | 5,448,921 | 23,513,199 | 13,807,769.16 | 4,823,440.68 | 4,881,989.16 | 79.2% |
| TOTAL SCHOOL NUTRITION | 0 | 3,356,841 | 3,356,841 | -2,154,324.59 | 4,823,440.68 | 687,724.91 | 79.5% |
| TOTAL REVENUES | -18,064,278 | -2,092,080 | -20,156,358 | -15,962,093.75 | .00 | -4,194,264.25 | |
| TOTAL EXPENSES | 18,064,278 | 5,448,921 | 23,513,199 | 13,807,769.16 | 4,823,440.68 | 4,881,989.16 | |
| GRAND TOTAL | 0 | 3,356,841 | 3,356,841 | -2,154,324.59 | 4,823,440.68 | 687,724.91 | 79.5% |
| ** END OF REPORT - Generated by BAUMANN, DUSTY ** | | | | | | | |

DEBT SERVICES (599) YTD BUDGET REPORT
 FEBRUARY 29, 2024

FOR 2024 08

| | ORIGINAL APPROP | TRANFRS/ ADJSTMTS | REVISED BUDGET | YTD ACTUAL | ENCUMBRANCES | AVAILABLE BUDGET | PCT USE/COL |
|-------------------------------|--------------------|----------------------|-------------------|----------------|---------------|---------------------|----------------|
| 599 DEBT SERVICE FUND | | | | | | | |
| 00 GENERAL LEDGER AND REVENUE | -46,520,000 | -1,720,268 | -48,240,268 | -45,320,551.27 | .00 | -2,919,716.73 | 93.9% |
| 71 DEBT SERVICE | 46,520,000 | 3,606,250 | 50,126,250 | 47,664,195.61 | -2,459,125.00 | 4,921,179.39 | 90.2% |
| TOTAL DEBT SERVICE FUND | 0 | 1,885,982 | 1,885,982 | 2,343,644.34 | -2,459,125.00 | 2,001,462.66 | -6.1% |
| TOTAL REVENUES | -46,520,000 | -27,085,268 | -73,605,268 | -70,681,801.27 | .00 | -2,923,466.73 | |
| TOTAL EXPENSES | 46,520,000 | 28,971,250 | 75,491,250 | 73,025,445.61 | -2,459,125.00 | 4,924,929.39 | |
| GRAND TOTAL | 0 | 1,885,982 | 1,885,982 | 2,343,644.34 | -2,459,125.00 | 2,001,462.66 | -6.1% |

** END OF REPORT - Generated by BAUMANN, DUSTY **

ECTOR COUNTY INDEPENDENT SCHOOL DISTRICT
 MONTHLY REPORT OF TAX COLLECTIONS
 FOR THE PERIOD OF JULY 1, 2023 THRU FEBRUARY 29, 2024

| YEAR CURRENT TAX | OUTSTANDING COLLECTIBLE AS OF 2022 TAX ROLL | CUMULATIVE ADJUSTMENT | ADJUSTED ROLL | PRIOR MONTH'S COLLECTION CURRENT YEAR | CURRENT MONTH'S COLLECTION | UNCOLLECTED BALANCE | PERCENT UNCOLLECTED | |
|--------------------------------------|--|--------------------------|------------------|--|----------------------------------|------------------------|------------------------|---------------|
| | | | | | | | OVERALL | CURRENT |
| 2023 | 179,212,242.35 | 1,721,388.28 | 180,933,630.63 | 119,448,681.46 | 45,442,461.12 | 16,042,488.05 | 8.95% | 8.87% |
| DELINQUENT TAX | | | | | | | | |
| 2022 | 6,846,545.92 | (359,695.98) | 6,486,849.94 | 1,772,305.16 | 277,480.18 | 4,437,064.60 | 64.81% | 68.40% |
| 2021 | 2,740,462.78 | (246,294.49) | 2,494,168.29 | 334,745.09 | 64,789.25 | 2,094,633.95 | 76.43% | 83.98% |
| 2020 | 1,978,234.15 | 58,208.37 | 2,036,442.52 | 351,893.49 | 28,556.94 | 1,655,992.09 | 83.71% | 81.32% |
| 2019 | 1,534,201.72 | (25,798.28) | 1,508,403.44 | 141,023.46 | 14,376.27 | 1,353,003.71 | 88.19% | 89.70% |
| 2018 | 1,095,116.83 | (1,087.80) | 1,094,029.03 | 76,649.02 | 7,254.30 | 1,010,125.71 | 92.24% | 92.33% |
| 2017 | 874,696.28 | (0.01) | 874,696.27 | 43,344.44 | 2,952.74 | 828,399.09 | 94.71% | 94.71% |
| 2016 | 923,303.15 | (0.01) | 923,303.14 | 35,005.27 | 4,175.91 | 884,121.96 | 95.76% | 95.76% |
| 2015 | 809,976.13 | (0.46) | 809,975.67 | 16,927.11 | 2,323.63 | 790,724.93 | 97.62% | 97.62% |
| 2014 | 809,661.76 | (283.52) | 809,378.24 | 11,713.08 | 2,340.22 | 795,324.94 | 98.23% | 98.26% |
| 2013 | 550,296.95 | (276.98) | 550,019.97 | 8,634.98 | 973.64 | 540,411.35 | 98.20% | 98.25% |
| 2012 | 404,184.63 | (35,929.18) | 368,255.45 | 4,366.92 | 1,053.50 | 362,835.03 | 89.77% | 98.53% |
| 2011 | 377,883.54 | (2,559.99) | 375,323.55 | 2,854.31 | 475.05 | 371,994.19 | 98.44% | 99.11% |
| 2010+ | 2,189,559.75 | (17,418.21) | 2,172,141.54 | 8,959.30 | 1,137.83 | 2,162,044.41 | 98.74% | 99.54% |
| | | | 0.00 | | | | | |
| TOTAL DELINQUENT TAX | 21,134,123.59 | (631,136.54) | 20,502,987.05 | 2,808,421.63 | 407,889.46 | 17,286,675.96 | 11.77 | 11.98 |
| CED # 24 SII TAXES | 46,682.69 | 0.00 | 46,682.69 | 108.65 | 0.00 | 46,574.04 | 99.77% | 99.77% |
| TOTAL ALL TAXES | 200,393,048.63 | 1,090,251.74 | 201,483,300.37 | 122,257,211.74 | 45,850,350.58 | 33,375,738.05 | | |
| PENALTY / INTEREST / DISCOUNT | | | | | | YEAR TO DATE | | |
| | | | | | 0.00 | 0.00 | 0.00 | |
| | | | | | 0.00 | 0.00 | 0.00 | |
| | | | | | 929,664.95 | 323,826.15 | 1,253,491.10 | |
| TOTAL PENALTY / INTEREST / DISCOUNT | | | | | 929,664.95 | 323,826.15 | 1,253,491.10 | |
| OTHER COLLECTIONS | | | | | | | | |
| | | | | | 0.00 | 0.00 | 0.00 | |
| | | | | | 976.74 | 331.63 | 1,308.37 | |
| | | | | | 258,703.69 | 145,780.58 | 404,484.27 | |
| | | | | | 0.00 | 0.00 | 0.00 | |
| | | | | | 5.09 | 0.00 | 5.09 | |
| | | | | | 0.00 | 0.00 | 0.00 | |
| | | | | | 0.00 | 0.00 | 0.00 | |
| | | | | | 0.00 | 0.00 | 0.00 | |
| TOTAL OTHER | | | | | 259,685.52 | 146,112.21 | 405,797.73 | |
| TOTAL SCHOOL | | | | | 123,446,562.21 | 46,320,288.94 | 169,766,851.15 | |
| GENERAL FUND | | | | | | | | |
| DEBT SERVICE | | | | | | | | |
| TOTAL | | | | TAXES PAID | P + I + C | TAXES PAID | P + I + C | TOTAL |
| | | | | 34,346,497.61 | 352,030.83 | 11,503,852.97 | 117,907.53 | 46,320,288.94 |



PURCHASES OVER \$50,000 INFORMATIONAL REPORT

The purchases over \$50,000 for the previous month of the current fiscal year follow. The report includes all such large purchases, regardless of required previous board approval.

As per Board Policy CH (local), the Superintendent is not required to obtain Board approval for the following types of budgeted purchases, regardless of cost:

1. A purchase made pursuant to a Board-approved interlocal contract or a cooperative purchasing program, in accordance with law;
2. A purchase made through a state purchasing program that satisfies the District's obligation for competitive purchasing [see CH(LLEGAL) or CBB(LLEGAL)]; or
3. A continuing or periodic purchase under a Board-approved bid or contract.

ECISD New Purchase Orders Over \$50,000 Report for March 2024

| Item | PO Date | PO# | Vendor Name | Amount | General Comments | Approval Process | 1st GL Account | Requestor | Department |
|------|------------|----------|-------------------------|------------|--|---|--|--------------------|-------------------------------|
| 1 | 03/22/2024 | 24010685 | LONE STAR FURNISHINGS | \$ 845,158 | MIDDLE SCHOOL INDOOR BLEACHERS BOWIE MIDDLE SCHOOL CROCKETT MIDDLE SCHOOL NIMITZ MIDDLE SCHOOL BONHAM MIDDLE SCHOOL ECTOR MIDDLE SCHOOL WILSON & YOUNG MIDDLE SCHOOL | BUYBOARD 667-22 | 693-11-6639-00-043-91-80424 693-11-6639-00-044-91-80424 693-11-6639-00-046-91-80424 693-11-6639-00-042-91-80424 693-11-6639-00-047-91-80424 693-11-6639-00-045-91-80424 | VALERIE APODACA | ATHLETICS |
| 2 | 03/04/2024 | 24010303 | HELLAS CONSTRUCTION INC | \$ 600,000 | ODESSA HIGH BASEBALL AND TENNIS LIGHTS | TEXBUY 021-A | 693-81-6639-00-002-91-80124 | VALERIE APODACA | ATHLETICS |
| 3 | 03/04/2024 | 24010304 | HELLAS CONSTRUCTION INC | \$ 399,999 | PERMIAN BASEBALL LIGHTS | TEXBUY 021-A | 693-81-6639-00-003-91-80224 | VALERIE APODACA | ATHLETICS |
| 4 | 03/19/2024 | 24010538 | HELLAS CONSTRUCTION INC | \$ 207,417 | ECISD TENNIS COURTS SURFACING NIMITZ MIDDLE SCHOOL BONHAM MIDDLE SCHOOL WILSON YOUNG MIDDLE SCHOOL BOWIE MIDDLE SCHOOL CROCKETT MIDDLE SCHOOL ECTOR MIDDLE SCHOOL | TEXBUY 021-A | 693-81-6629-00-046-91-80324 693-81-6629-00-042-91-80324 693-81-6629-00-045-91-80324 693-81-6629-00-043-91-80324 693-81-6629-00-044-91-80324 693-81-6629-00-047-91-80324 | VALERIE APODACA | ATHLETICS |
| 5 | 03/01/2024 | 24010195 | TNTP. INC. | \$ 200,000 | CONTINUED SERVICE PO 22002367, 23006652, YR 3 COACHING SUPPORT AND FACILITATION PROPOSALS TO UTILIZE PROFESSIONAL LEARNING FOR INSTRUCTIONAL LEADERS | ECISD AWARDED 21-34 | 282-13-6299-00-850-24-28222 | SARAH HARRISON | 130 TALENT DEVELOPMENT |
| 6 | 03/07/2024 | 24010402 | CAMBIAR EDUCATION | \$ 150,000 | CONSULTING SERVICES Contigo ED Works with distract on CCMR that drives action and leads to greater student achievement and success in CCMR | ECISD AWARDED REBID 22-30 | 282-31-6299-00-893-30-28222 | NORMA LEACHON | STUDENT AND SCHOOL SUPPORT |
| 7 | 03/26/2024 | 24010925 | THE BOSWORTH LTD | \$ 148,800 | OHS MAIN BUILDING HEATING & COOLING PUMPS FOR PARTS AND LABOR TO INSTALL 3 - BELL & GOSSETT HW PUMPS 3 - BELL & GOSSETT CW PUMPS | ECISD AWARDED RFP 21-28 | 199-81-6639-00-002-99 | KENT CLARK | MAINTENANCE SERVICES |
| 8 | 03/20/2024 | 24010672 | DANA SAFETY SUPPLY | \$ 96,582 | AUTOMOTIVE ACCESSORIES FOR POLICE DEPARTMENT VEHICLES | BUYBOARD 698-23 | 199-52-6631-00-952-99 | KIMBERLEY JONES | DISTRICT POLICE DEPARTMENT |
| 9 | 03/07/2024 | 24010399 | GUNN & SCOGGINS INC | \$ 55,209 | WEED CONTROL FOR DISTRICT GROUNDS | ECISD AWARDED 22-08SI | 199-51-6316-00-955-99 | KENT CLARK | MAINTENANCE SERVICES |
| 10 | 03/08/2024 | 24010410 | FOCUS CARE INC | \$ 52,500 | VIRTUAL TUTORING FOR BOWIE MS 2730 - SESSIONS | ECISD BOARD APPROVED TEA TX TUTOR CORPS | 282-11-6299-46-851-30-28222 | LILIA NANEZ | CURRICULUM & INSTRUCTION |

ECTOR COUNTY INDEPENDENT SCHOOL DISTRICT
ODESSA, TX

MEMORANDUM

TO: DR. SCOTT MURI, SUPERINTENDENT OF SCHOOLS

FROM: DR. MATTHEW SPIVY, EXECUTIVE DIRECTOR OF HUMAN RESOURCES

RE: ROUTINE PERSONNEL REPORT FOR MARCH 2024

DATE: 3/28/2024

Elementary Level Recommendations

| NAME | JOB CLASS | CAMPUS | EFFECTIVE DATE |
|------|-----------|--------|----------------|
| NONE | | | |

Secondary Level Recommendations

| NAME | JOB CLASS | CAMPUS | EFFECTIVE DATE |
|----------------|-----------|----------------------|----------------|
| KWABENA GYAMFI | SCIENCE | ODESSA HIGH SCHOOL | 3/4/2024 |
| JAMES MAGNESS | ELAR | NIMITZ MIDDLE SCHOOL | 3/19/2024 |

Administrative Level Recommendations

| NAME | JOB CLASS | CAMPUS/DEPARTMENT | EFFECTIVE DATE |
|------------------|--------------------------|---------------------------|----------------|
| CARLOS GALVAN | DEAN OF CAREER & TECH ED | ADVANCED TECHNICAL CENTER | 3/18/2024 |
| MERCEDES CRAYTON | SAS COUNSELOR | GUIDANCE & COUNSELING | 3/19/2024 |
| RICKY HERRING | POLICE OFFICER | POLICE DEPARTMENT | 3/18/2024 |
| RAUL HURTADO | POLICE OFFICER | POLICE DEPARTMENT | 3/18/2024 |

Elementary Level Resignations

| NAME | JOB CLASS | CAMPUS | EFFECTIVE DATE |
|-------------------|-----------------------|----------------------------|----------------|
| ABRIL CERECERES | FOURTH GRADE (REG) | GOLIAD ELEMENTARY SCHOOL | 3/6/2024 |
| PATSY REY SANCHEZ | FIFTH GRADE BILINGUAL | BURLESON ELEMENTARY SCHOOL | 3/20/2024 |

Secondary Level Resignations

| NAME | JOB CLASS | CAMPUS | EFFECTIVE DATE |
|---------------------|-------------------------------|--------------------------------|----------------|
| JAZMINE ARENIVAS | SCIENCE | ODESSA HIGH SCHOOL | 3/7/2024 |
| CRISTA JACOBO DRAKE | SPANISH | ODESSA HIGH SCHOOL | 3/29/2024 |
| ASHLEY MENDOZA | ENGLISH/LANGUAGE ARTS/READING | BONHAM MIDDLE SCHOOL | 3/28/2024 |
| MICHAEL PERKINS | ENGLISH | ODESSA HIGH SCHOOL | 3/7/2024 |
| SERGIO VILLALOBOS | SCIENCE-COACH | BOWIE MIDDLE SCHOOL | 3/19/2024 |
| DUSTIN WINKLER | MATH | GEORGE HW BUSH NEW TECH ODESSA | 3/1/2024 |
| JOSE TREJO FUENTES | MATH | PERMIAN HIGH SCHOOL | 3/20/2024 |
| CONNIE ANDRES | MASTER TEAM REACH | CROCKETT MIDDLE SCHOOL | 3/22/2024 |

Administrative Level Resignations

| NAME | JOB CLASS | CAMPUS/DEPARTMENT | EFFECTIVE DATE |
|---------------|--------------------------------|----------------------------|----------------|
| AMY HOSICK | EXE DIR CHO SCHOOLS ACCESS SUP | STUDENT AND SCHOOL SUPPORT | 3/29/2024 |
| IRIS JIMENEZ | DIR PLANNING & SCHOOL CHOICE | STUDENT AND SCHOOL SUPPORT | 3/1/2024 |
| EMILY ROBERTS | TALENT DEVELOPMENT COACH | TALENT DEVELOPMENT | 3/2/2024 |
| ANA TARANGO | PARENT COM ENGAGEMENT SPCLST | ECISD DEVELOPMENT OFFICE | 3/22/2024 |