

GOODMAN FENCE, INC.

RESIDENTIAL, COMMERCIAL & INDUSTRIAL

www.goodmanfence.com
Goodmanfence@gmail.com



5898 NORTH WALNUT STREET ROAD
SPRINGFIELD, ILLINOIS 62707
217-487-7205

DATE 6-9-26

SOLD TO New Berlin Tr./High School EMAIL _____

ADDRESS 300 W Ellis St. Zone _____ TELEPHONE NO. _____

LOCATION New Berlin, IL 62670 Attr (Mett) WORK NO. _____

Total Height 5' tall

Post Spaced 10' or less

Style Fence Black

Gauge 8 ga. 11 1/2 ga.

8 ga
All Posts Set In Concrete

Top Rail 1 5/8 O.D.

Line Post 2" O.D.

End Post 2 1/2" O.D.

Corner Post _____ O.D.

Walk Gate Post 3" O.D.

Drive Gate Post _____ O.D.

Gate Frames _____ O.D.

TERMS

Cash Upon Completion

30 Days
After 30 days, a Service Charge of 1.5% will be charged on the unpaid balance each month. Annual percentage rate of 18%.

Add _____ to all card transaction.

QUANTITY	
75'	5' tall Black vinyl system 8 gauge w/ bottom wire
1	8' Double drive 5' tall w/ Hardware
1	5' wide walk gate 5' tall w/ Hardware
6	2 1/2 x 7' Terminal Posts
	(Black) (Galvz.)
	\$ 5,493 / \$ 4668

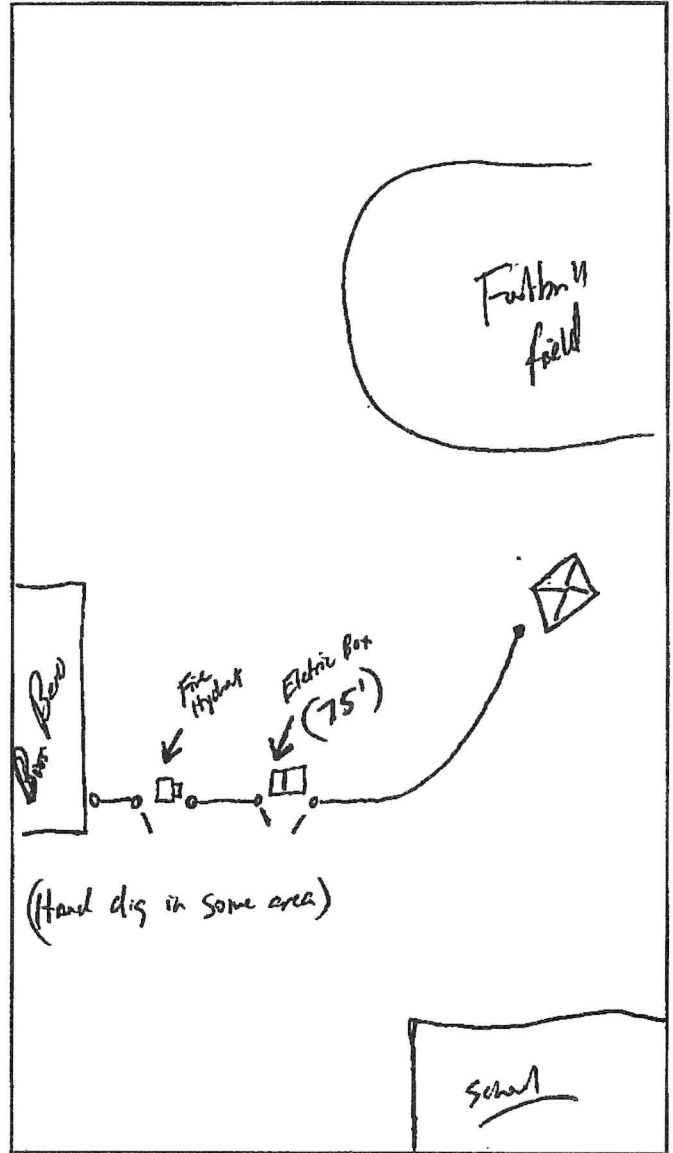

CONTRACT CONDITIONS

GOODMAN FENCE, INC. will warrant our workmanship for above fence for one year.

I, Individually and on behalf of the undersigned business, if any (collectively, "Customer"), agree to be responsible for the payment to Goodman Fence, Inc. ("Goodman") for any and all materials and/or services furnished to me and/or the undersigned business, if any, by Goodman. I have read the terms and conditions which appear on the reverse side of this agreement (the "Agreement") and I agree to the same.

FOR YOUR PROTECTION

On payments to us, use check or money order payable to company as shown on heading of this sales contract.

Total _____

Down _____

Total _____

Salesman Bred Crumpton

ACCEPTED _____

TERMS AND CONDITIONS

1. All accounts are due and payable at the remittance address shown on the Agreement at the time specified on the face of this Agreement; provided however, that if the face of this Agreement does not provide a time for remittance of payment, all accounts are due and payable immediately upon Goodman's delivery of materials and/or completion of services. In the event the account becomes past due, a charge of 1 1/2% per month (18% per annum) shall be due and payable on all past due amounts.
2. Customer agrees to pay all costs of collection, including attorneys fees and court costs, in addition to all other sums due.
3. Customer is solely responsible for complying with local zoning rules and regulations and obtaining any permits required under such rules and regulations.
4. Customer acknowledges that Goodman is not responsible under any circumstance for determining property lineage and Customer further acknowledges that, in the event that property pins cannot be located, Goodman has advised Customer to obtain a survey of the property.
5. Customer is responsible for locating and marking buried lines or objects that are not marked as public utilities (e.g., unmarked sprinkler lines, drain extensions, sump pump drains, etc.) and Customer assumes absolute liability for any and all damages in the event Goodman strikes any such unmarked or buried lines or objects.
6. In the event Customer directs Goodman to dig in the immediate vicinity of marked utilities, Customer assumes absolute liability for any and all damages in the event that Goodman strikes such utilities.
7. Customer expressly agrees that Goodman retains title to all materials furnished by Goodman until final payment is made by Customer. If final payment is not made promptly when due pursuant to the terms hereof, Goodman is authorized to remove any said materials; provided, however, that Goodman's removal of materials shall not be considered liquidated damages and Goodman will continue to have all remedies available at law to Goodman to recover any amounts remaining due to Goodman. Customer waives Customer's right to recover from Goodman for any damages which may result from said removal.
8. This Agreement shall be governed by the laws of the State of Illinois, and Customer voluntarily and freely submits to a court of competent jurisdiction in Sangamon County, Illinois, should any dispute arise out of the course of business between Customer and Goodman. To the extent permissible under Illinois law, Customer waives any right to trial by jury in any civil action arising out of, or based upon this agreement.
9. Customer grants Goodman the right to obtain credit and financial information concerning Customer at any time and from any available source.
10. Goodman is not a manufacturer, and therefore extends no warranties, express or implied, with regard to materials sold by Goodman. Warranties with respect to materials sold by Goodman are limited to any warranties which may be extended by the manufacturer or supplier. All services performed by Goodman are warranted for one (1) year. Goodman EXPRESSLY DISCLAIMS ANY AND ALL IMPLIED WARRANTIES, INCLUDING ANY IMPLIED WARRANTY OF MERCHANTABILITY OR FITNESS FOR A PARTICULAR PURPOSE. No agent or representative of Goodman, other than the President of Goodman, is authorized to make any warranty with terms which differ from the terms stated herein. If Customer is purchasing products and/or services from Goodman for resale, Customer agrees to hold Goodman harmless from any warranty given by Customer which differs from, or is more extensive than, Goodman's warranty with regard to services or the manufacturer's or supplier's warranty with regard to products. In the spirit of fairness and in keeping with its policy of providing quality materials and services Goodman pledges to Customer to assist Customer in obtaining the full value of any manufacturer's or supplier's warranty.
11. All returns must have prior approval along with proof of purchase. Restocking, reconditioning and freight charges may apply.
12. Customer's assent to these terms and conditions shall be conclusively presumed from Customer's acceptance of the delivery of materials and/or services from Goodman without prompt written objection. No terms or conditions contained in Customer's purchase order, shipping release, or elsewhere, shall be binding upon Goodman. These terms and conditions may not be altered by anyone other than a Vice President or the President of Goodman.
13. This is a continuing agreement between Customer and Goodman and will remain in full force and effect until revoked in writing and received and accepted by Goodman.

GOODMAN FENCE, INC.

RESIDENTIAL, COMMERCIAL & INDUSTRIAL

www.goodmanfence.com
Goodmanfence@gmail.com



5898 NORTH WALNUT STREET ROAD
SPRINGFIELD, ILLINOIS 62707
217-487-7205

DATE 6-9-26

SOLD TO New Berlin Jr / High School

EMAIL _____

ADDRESS 300 W Ellis St. Zone _____

TELEPHONE NO. _____

LOCATION NEW Berlin 7 IL 62670 Abu (Matt)

WORK NO. 217-361-7997 (matt)

Total Height 5' tall

Post Spaced 10' or less

Style Fence Black / Galv.

Gauge 9 ga. 11 1/2 ga.

8 ga
All Posts Set in Concrete

Top Rail _____ 1 5/8" O.D.

Line Post _____ O.D.

End Post _____ 2 1/2" O.D.

Corner Post _____ O.D.

Walk Gate Post _____ O.D.

Drive Gate Post _____ O.D.

Gate Frames _____ O.D.

TERMS

Cash Upon Completion

30 Days
After 30 days, a Service Charge of 1.5% will be charged on the unpaid balance each month. Annual percentage rate of 18%.

Add _____ to all card transaction.

QUANTITY	
<u>101'</u>	<u>5' tall Black Vinyl system</u>
	<u>8 ga Chainlink</u>
<u>2</u>	<u>5' wide gates 5' tall w/ Hardware</u>
<u>1</u>	<u>10' double drive gate 5' tall</u>
	<u>w/ Hardware</u>
<u>6</u>	<u>2 1/2 x 7' Terminal Posts</u>
<u>1</u>	<u>2 1/2 Tie on to existing Fence</u>

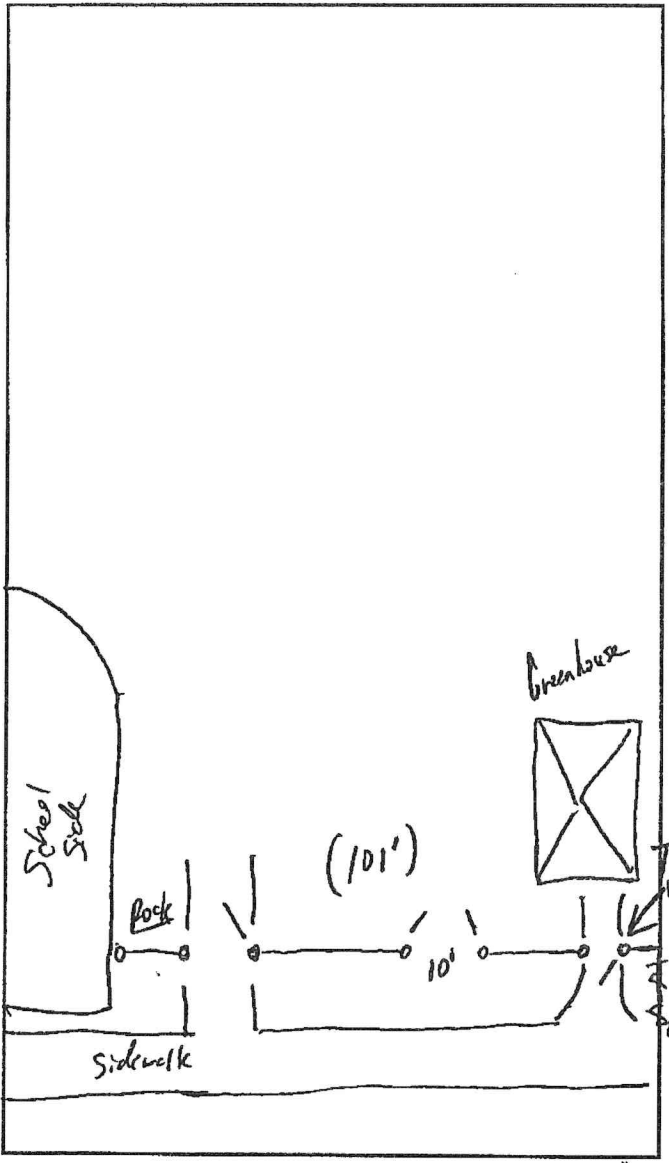

CONTRACT CONDITIONS

GOODMAN FENCE, INC. will warrant our workmanship for above fence for one year.

I, individually and on behalf of the undersigned business, if any (collectively, "Customer"), agree to be responsible for the payment to Goodman Fence, Inc. ("Goodman") for any and all materials and/or services furnished to me and/or the undersigned business, if any, by Goodman. I have read the terms and conditions which appear on the reverse side of this agreement (the "Agreement") and I agree to the same.

FOR YOUR PROTECTION

On payments to us, use check or money order payable to company as shown on heading of this sales contract.

Total \$ 6,356.00

Down _____

Total _____

Salesman Bruce Cunningham

ACCEPTED _____

TERMS AND CONDITIONS

1. All accounts are due and payable at the remittance address shown on the Agreement at the time specified on the face of this Agreement; provided however, that if the face of this Agreement does not provide a time for remittance of payment, all accounts are due and payable immediately upon Goodman's delivery of materials and/or completion of services. In the event the account becomes past due, a charge of 1 1/2% per month (18% per annum) shall be due and payable on all past due amounts.
2. Customer agrees to pay all costs of collection, including attorneys fees and court costs, in addition to all other sums due.
3. Customer is solely responsible for complying with local zoning rules and regulations and obtaining any permits required under such rules and regulations.
4. Customer acknowledges that Goodman is not responsible under any circumstance for determining property lineage and Customer further acknowledges that, in the event that property pins cannot be located, Goodman has advised Customer to obtain a survey of the property.
5. Customer is responsible for locating and marking buried lines or objects that are not marked as public utilities (e.g., unmarked sprinkler lines, drain extensions, sump pump drains, etc.) and Customer assumes absolute liability for any and all damages in the event Goodman strikes any such unmarked or buried lines or objects.
6. In the event Customer directs Goodman to dig in the immediate vicinity of marked utilities, Customer assumes absolute liability for any and all damages in the event that Goodman strikes such utilities.
7. Customer expressly agrees that Goodman retains title to all materials furnished by Goodman until final payment is made by Customer. If final payment is not made promptly when due pursuant to the terms hereof, Goodman is authorized to remove any said materials; provided, however, that Goodman's removal of materials shall not be considered liquidated damages and Goodman will continue to have all remedies available at law to Goodman to recover any amounts remaining due to Goodman. Customer waives Customer's right to recover from Goodman for any damages which may result from said removal.
8. This Agreement shall be governed by the laws of the State of Illinois, and Customer voluntarily and freely submits to a court of competent jurisdiction in Sangamon County, Illinois, should any dispute arise out of the course of business between Customer and Goodman. To the extent permissible under Illinois law, Customer waives any right to trial by jury in any civil action arising out of, or based upon this agreement.
9. Customer grants Goodman the right to obtain credit and financial information concerning Customer at any time and from any available source.
10. Goodman is not a manufacturer, and therefore extends no warranties, express or implied, with regard to materials sold by Goodman. Warranties with respect to materials sold by Goodman are limited to any warranties which may be extended by the manufacturer or supplier. All services performed by Goodman are warranted for one (1) year. Goodman EXPRESSLY DISCLAIMS ANY AND ALL IMPLIED WARRANTIES, INCLUDING ANY IMPLIED WARRANTY OF MERCHANTABILITY OR FITNESS FOR A PARTICULAR PURPOSE. No agent or representative of Goodman, other than the President of Goodman, is authorized to make any warranty with terms which differ from the terms stated herein. If Customer is purchasing products and/or services from Goodman for resale, Customer agrees to hold Goodman harmless from any warranty given by Customer which differs from, or is more extensive than, Goodman's warranty with regard to services or the manufacturer's or supplier's warranty with regard to products. In the spirit of fairness and in keeping with its policy of providing quality materials and services Goodman pledges to Customer to assist Customer in obtaining the full value of any manufacturer's or supplier's warranty.
11. All returns must have prior approval along with proof of purchase. Restocking, reconditioning and freight charges may apply.
12. Customer's assent to these terms and conditions shall be conclusively presumed from Customer's acceptance of the delivery of materials and/or services from Goodman without prompt written objection. No terms or conditions contained in Customer's purchase order, shipping release, or elsewhere, shall be binding upon Goodman. These terms and conditions may not be altered by anyone other than a Vice President or the President of Goodman.
13. This is a continuing agreement between Customer and Goodman and will remain in full force and effect until revoked in writing and received and accepted by Goodman.

Jan

GOODMAN FENCE, INC.

RESIDENTIAL, COMMERCIAL & INDUSTRIAL

www.goodmanfence.com
Goodmanfence@gmail.com



5898 NORTH WALNUT STREET ROAD
SPRINGFIELD, ILLINOIS 62707
217-487-7205

DATE 6-9-26

SOLD TO New Berlin / JR. High School

EMAIL mbrown@pretzelpride.com

ADDRESS 300 W ellis St. Zone _____

TELEPHONE NO. _____

LOCATION NEW Berlin, IL 62670 MTN (Mett)

WORK NO. 217-361-7957 (Mett)

Total Height _____	Top Rail _____ O.D.
Post Spaced _____	Line Post _____ O.D.
Style Fence _____	End Post _____ O.D.
Gauge <input type="checkbox"/> 9 ga. <input type="checkbox"/> 11 1/2 ga.	Corner Post _____ O.D.
All Posts Set in Concrete	Walk Gate Post _____ O.D.
	Drive Gate Post _____ O.D.
	Gate Frames _____ O.D.

TERMS

- Cash Upon Completion
- 30 Days
After 30 days, a Service Charge of 1.5% will be charged on the unpaid balance each month. Annual percentage rate of 18%.
- Add _____ to all card transaction.

QUANTITY	
540'	5' tall 1/2 9 gauge Chain-link w/ bottom rail
1	5' wide walkgate 5' tall w/ hardware
1	12' double drive 5' tall w/ hardware
3	3" x 7' tall Terminals
3	2 1/2" x 7' tall Terminals
2	4" x 8' Terminals
1	16' - Catcher gate w/ rollers

Total \$ 16,478.00

FOR YOUR PROTECTION

On payments to us, use check or money order payable to company as shown on heading of this sales contract.

Down _____

Total _____

Salesman Bruce Combs

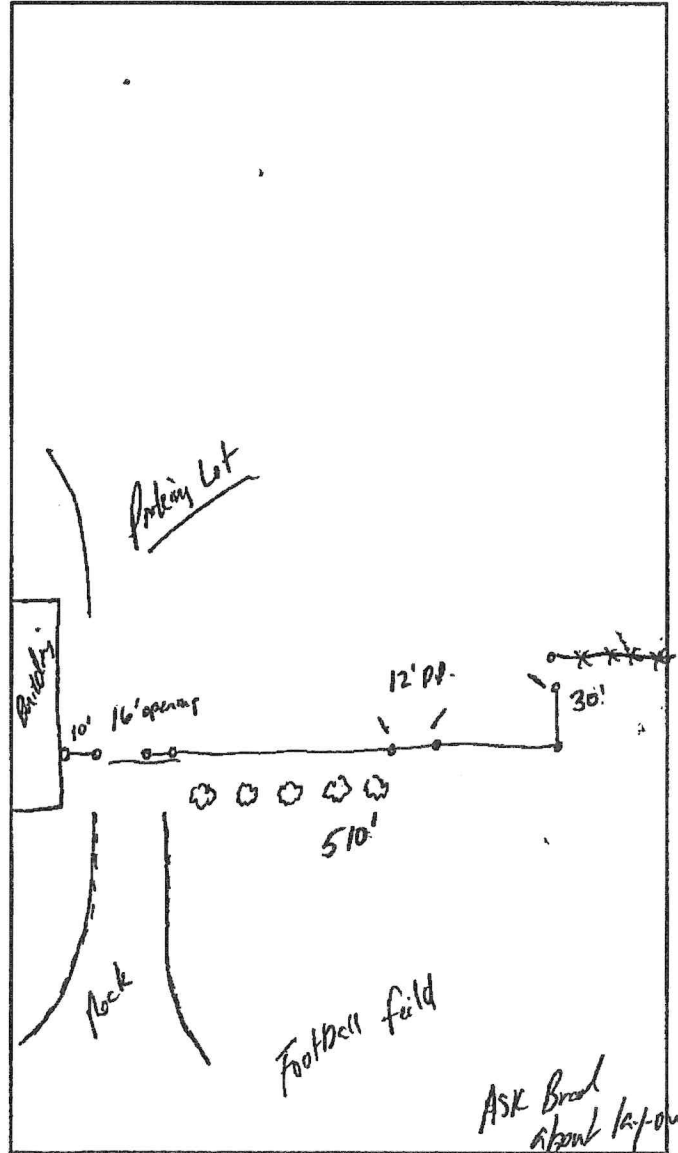

CONTRACT CONDITIONS

GOODMAN FENCE, INC. will warrant our workmanship for above fence for one year.

I, individually and on behalf of the undersigned business, if any (collectively, "Customer"), agree to be responsible for the payment to Goodman Fence, Inc. ("Goodman") for any and all materials and/or services furnished to me and/or the undersigned business, if any, by Goodman. I have read the terms and conditions which appear on the reverse side of this agreement (the "Agreement") and I agree to the same.

Transportation

ACCEPTED _____

TERMS AND CONDITIONS

1. All accounts are due and payable at the remittance address shown on the Agreement at the time specified on the face of this Agreement; provided however, that if the face of this Agreement does not provide a time for remittance of payment, all accounts are due and payable immediately upon Goodman's delivery of materials and/or completion of services. In the event the account becomes past due, a charge of 1 1/2% per month (18% per annum) shall be due and payable on all past due amounts.
2. Customer agrees to pay all costs of collection, including attorneys fees and court costs, in addition to all other sums due.
3. Customer is solely responsible for complying with local zoning rules and regulations and obtaining any permits required under such rules and regulations.
4. Customer acknowledges that Goodman is not responsible under any circumstance for determining property lineage and Customer further acknowledges that, in the event that property pins cannot be located, Goodman has advised Customer to obtain a survey of the property.
5. Customer is responsible for locating and marking buried lines or objects that are not marked as public utilities (e.g., unmarked sprinkler lines, drain extensions, sump pump drains, etc.) and Customer assumes absolute liability for any and all damages in the event Goodman strikes any such unmarked or buried lines or objects.
6. In the event Customer directs Goodman to dig in the immediate vicinity of marked utilities, Customer assumes absolute liability for any and all damages in the event that Goodman strikes such utilities.
7. Customer expressly agrees that Goodman retains title to all materials furnished by Goodman until final payment is made by Customer. If final payment is not made promptly when due pursuant to the terms hereof, Goodman is authorized to remove any said materials; provided, however, that Goodman's removal of materials shall not be considered liquidated damages and Goodman will continue to have all remedies available at law to Goodman to recover any amounts remaining due to Goodman. Customer waives Customer's right to recover from Goodman for any damages which may result from said removal.
8. This Agreement shall be governed by the laws of the State of Illinois, and Customer voluntarily and freely submits to a court of competent jurisdiction in Sangamon County, Illinois, should any dispute arise out of the course of business between Customer and Goodman. To the extent permissible under Illinois law, Customer waives any right to trial by jury in any civil action arising out of, or based upon this agreement.
9. Customer grants Goodman the right to obtain credit and financial information concerning Customer at any time and from any available source.
10. Goodman is not a manufacturer, and therefore extends no warranties, express or implied, with regard to materials sold by Goodman. Warranties with respect to materials sold by Goodman are limited to any warranties which may be extended by the manufacturer or supplier. All services performed by Goodman are warranted for one (1) year. Goodman EXPRESSLY DISCLAIMS ANY AND ALL IMPLIED WARRANTIES, INCLUDING ANY IMPLIED WARRANTY OF MERCHANTABILITY OR FITNESS FOR A PARTICULAR PURPOSE. No agent or representative of Goodman, other than the President of Goodman, is authorized to make any warranty with terms which differ from the terms stated herein. If Customer is purchasing products and/or services from Goodman for resale, Customer agrees to hold Goodman harmless from any warranty given by Customer which differs from, or is more extensive than, Goodman's warranty with regard to services or the manufacturer's or supplier's warranty with regard to products. In the spirit of fairness and in keeping with its policy of providing quality materials and services Goodman pledges to Customer to assist Customer in obtaining the full value of any manufacturer's or supplier's warranty.
11. All returns must have prior approval along with proof of purchase. Restocking, reconditioning and freight charges may apply.
12. Customer's assent to these terms and conditions shall be conclusively presumed from Customer's acceptance of the delivery of materials and/or services from Goodman without prompt written objection. No terms or conditions contained in Customer's purchase order, shipping release, or elsewhere, shall be binding upon Goodman. These terms and conditions may not be altered by anyone other than a Vice President or the President of Goodman.
13. This is a continuing agreement between Customer and Goodman and will remain in full force and effect until revoked in writing and received and accepted by Goodman.