

Windstream LOCATION MAP E 24TH ST

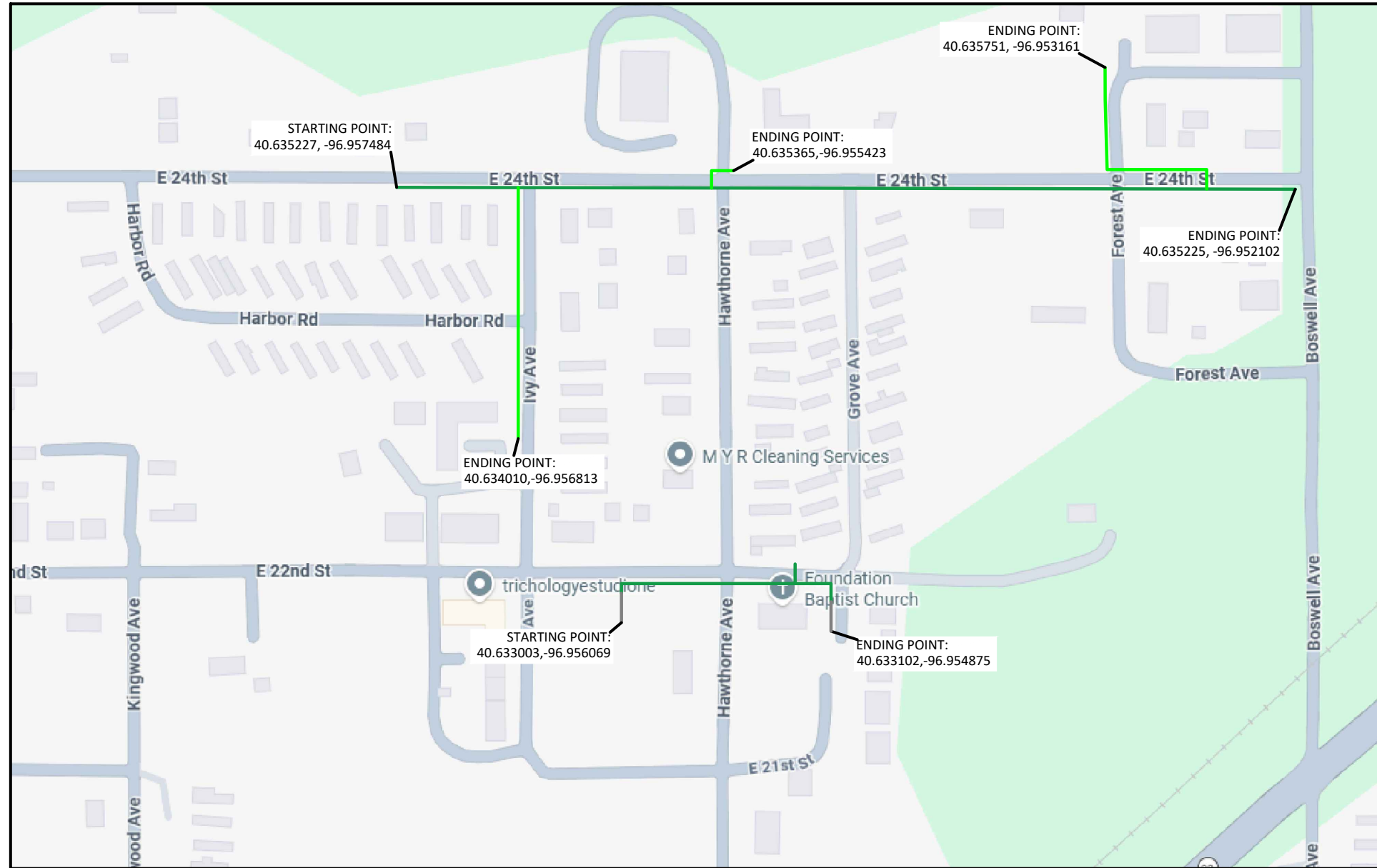

WINDSTREAM PROPOSES FIBER OPTIC CABLE PLACEMENT:

| BURIED | 12 FOC | 24 FOC | 48 FOC | 144 FOC |
|------------------|--------|--------|--------|---------|
| DIRECT BURIED | 0' | 0' | 0' | 0' |
| DIRECTIONAL BORE | 0' | 0' | 616' | 0' |
| RESI PLOW | 230' | 0' | 0' | 0' |
| DRY BORE | 0' | 0' | 0' | 0' |
| AERIAL | 12 FOC | 24 FOC | 48 FOC | 144 FOC |
| LASH TO EXISTING | 0' | 0' | 0' | 0' |
| NEW ATTACHMENT | 0' | 0' | 1771' | 210' |

TOTAL PROPOSED CABLE=2827'

LEGEND

- AERIAL PROPOSED FIBER WITH NEW STRAND
- PROPOSED BURIED FIBER
- PROPOSED CONDUIT
- ROW
- EOP
- CENTER LINE
- BACK OF CURB
- EXISTING WS PEDESTAL
- PROPOSED WS PEDESTAL
- REMOVED WS PEDESTAL
- BORE PIT
- POWER POLE
- PROPOSED ANCHOR & GUY
- PROPOSED HAND HOLE



DATE CREATED: 4/9/26

DATE REVISED:

DRAWN BY: RAMTeCH

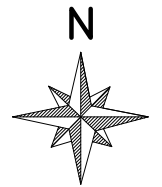

SCALE: NTS

COMPANY:
Windstream

SYSTEM:
CRETE, NE

PROJECT NUMBER:
715062332

DESCRIPTION:
FTTP GPON PERMIT

MAP:
LOCATION MAP

RAMTeCH

CITY PERMIT E 24TH ST

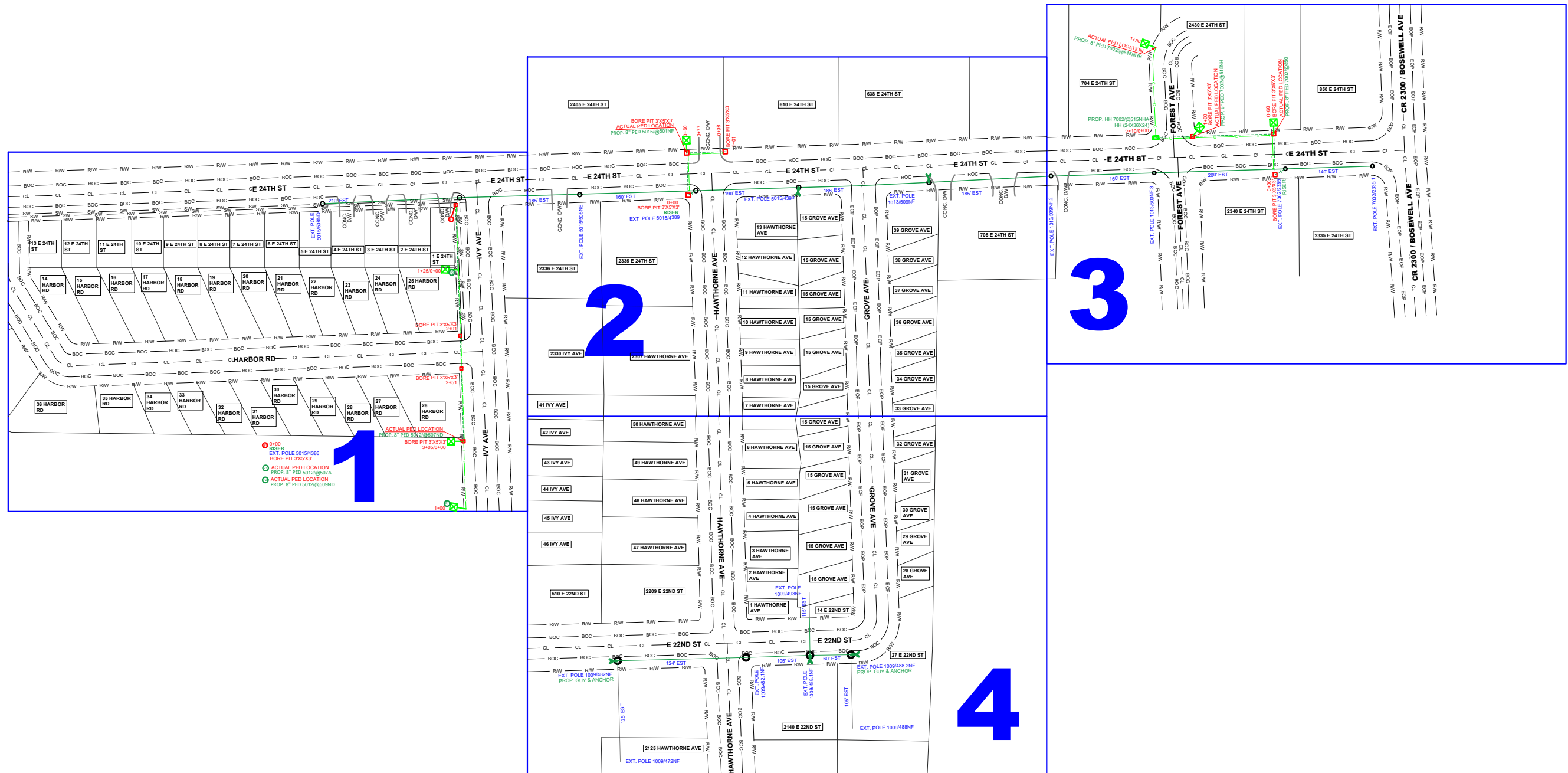

LEGEND

- AERIAL PROPOSED FIBER WITH NEW STRAND
- PROPOSED BURIED FIBER
- PROPOSED CONDUIT
- ROW
- EOP
- CENTER LINE
- BACK OF CURB
- EXISTING WS PEDESTAL
- PROPOSED WS PEDESTAL
- REMOVED WS PEDESTAL
- BORE PIT
- POWER POLE
- PROPOSED ANCHOR & GUY
- PROPOSED HAND HOLE



DATE CREATED: 4/9/26

DATE REVISED:

DRAWN BY: RAMTECH

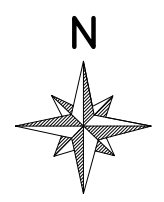

SCALE: NTS

COMPANY:
Windstream

SYSTEM:
CRETE, NE

PROJECT NUMBER:
715062332

DESCRIPTION:
FTTP GPON PERMIT

MAP:

KEY MAP

RAMTECH

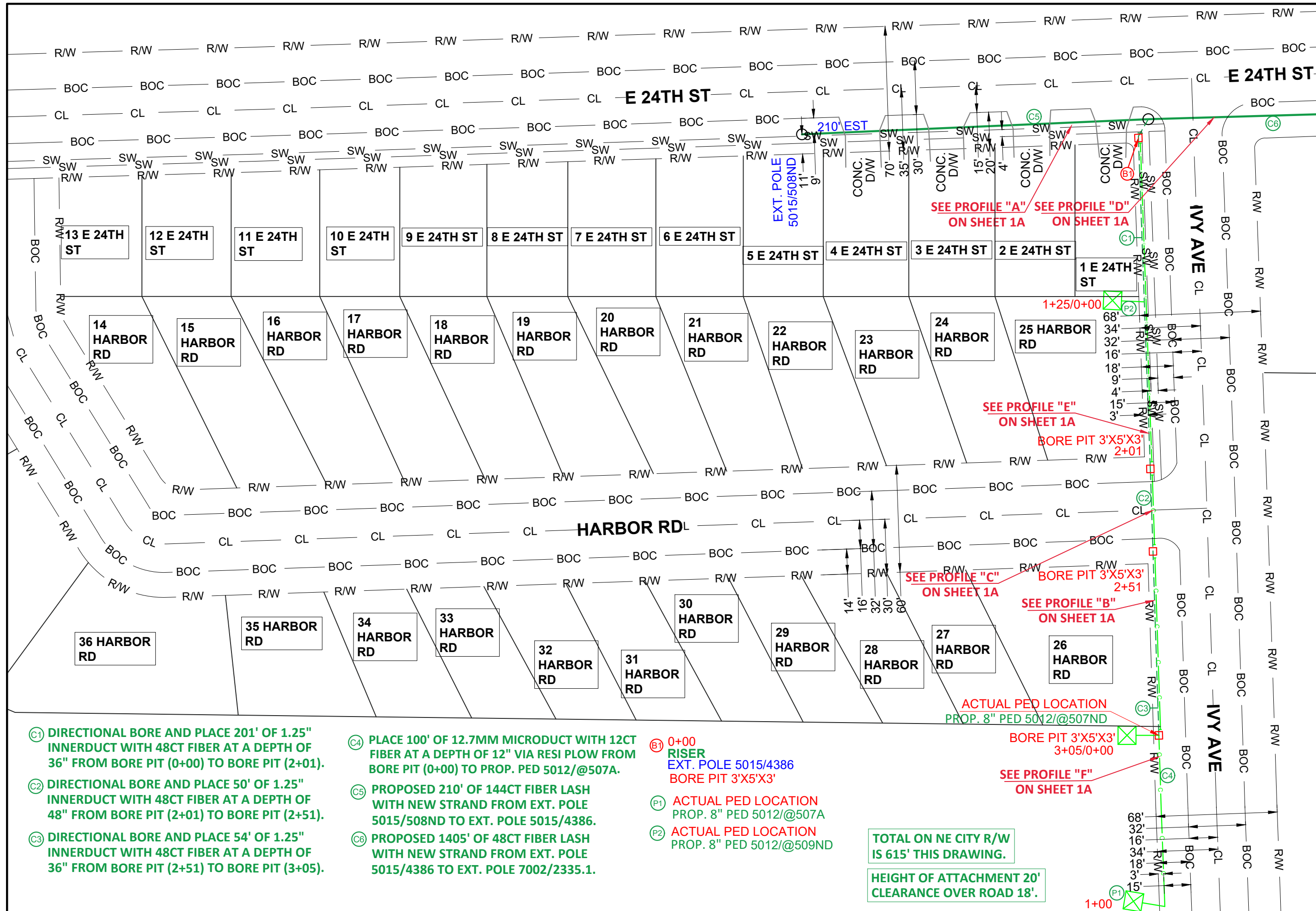

| LEGEND | |
|--------|---------------------------------------|
| | AERIAL PROPOSED FIBER WITH NEW STRAND |
| | PROPOSED BURIED FIBER |
| | PROPOSED CONDUIT |
| | R/W |
| | EOP |
| | CENTER LINE |
| | BACK OF CURB |
| | EXISTING WS PEDESTAL |
| | PROPOSED WS PEDESTAL |
| | REMOVED WS PEDESTAL |
| | BORE PIT |
| | POWER POLE |
| | PROPOSED ANCHOR & GUY |
| | PROPOSED HAND HOLE |



DATE CREATED: 4/9/26
 DATE REVISED:
 DRAWN BY: RAMTeCH

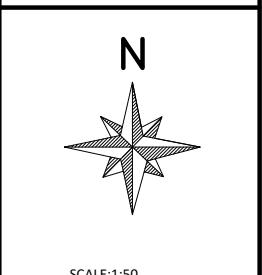

COMPANY: Windstream
 SYSTEM: CRETE, NE
 PROJECT NUMBER: 715062332
 DESCRIPTION: FTTP GPON PERMIT
 MAP:

- C1 DIRECTIONAL BORE AND PLACE 201' OF 1.25" INNERDUCT WITH 48CT FIBER AT A DEPTH OF 36" FROM BORE PIT (0+00) TO BORE PIT (2+01).
- C2 DIRECTIONAL BORE AND PLACE 50' OF 1.25" INNERDUCT WITH 48CT FIBER AT A DEPTH OF 48" FROM BORE PIT (2+01) TO BORE PIT (2+51).
- C3 DIRECTIONAL BORE AND PLACE 54' OF 1.25" INNERDUCT WITH 48CT FIBER AT A DEPTH OF 36" FROM BORE PIT (2+51) TO BORE PIT (3+05).

- C4 PLACE 100' OF 12.7MM MICRODUCT WITH 12CT FIBER AT A DEPTH OF 12" VIA RESI PLOW FROM BORE PIT (0+00) TO PROP. PED 5012/@507A.
- C5 PROPOSED 210' OF 144CT FIBER LASH WITH NEW STRAND FROM EXT. POLE 5015/508ND TO EXT. POLE 5015/4386.
- C6 PROPOSED 1405' OF 48CT FIBER LASH WITH NEW STRAND FROM EXT. POLE 5015/4386 TO EXT. POLE 7002/2335.1.

- E1 0+00 RISER EXT. POLE 5015/4386 BORE PIT 3'X5'X3'
- P1 ACTUAL PED LOCATION PROP. 8" PED 5012/@507A
- P2 ACTUAL PED LOCATION PROP. 8" PED 5012/@509ND

TOTAL ON NE CITY R/W IS 615' THIS DRAWING.
 HEIGHT OF ATTACHMENT 20' CLEARANCE OVER ROAD 18'.

PROFILE "A" IS FROM SHEET 1

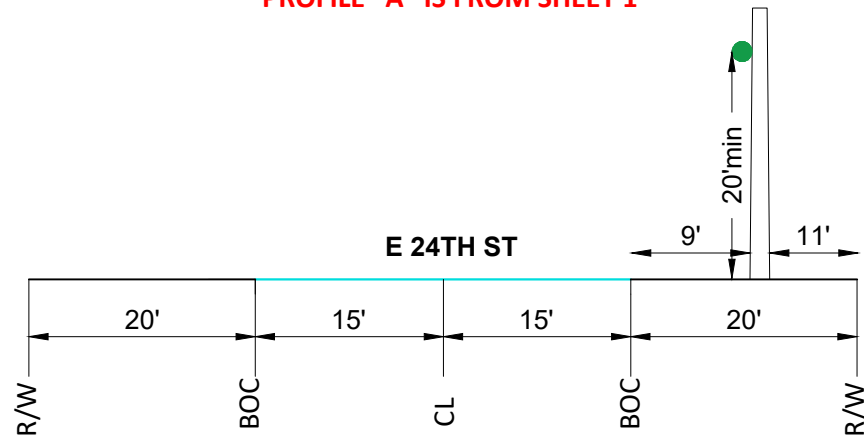

PARALLELING E 24TH ST
LOOKING EAST
NTS

PROFILE "D" IS FROM SHEET 1

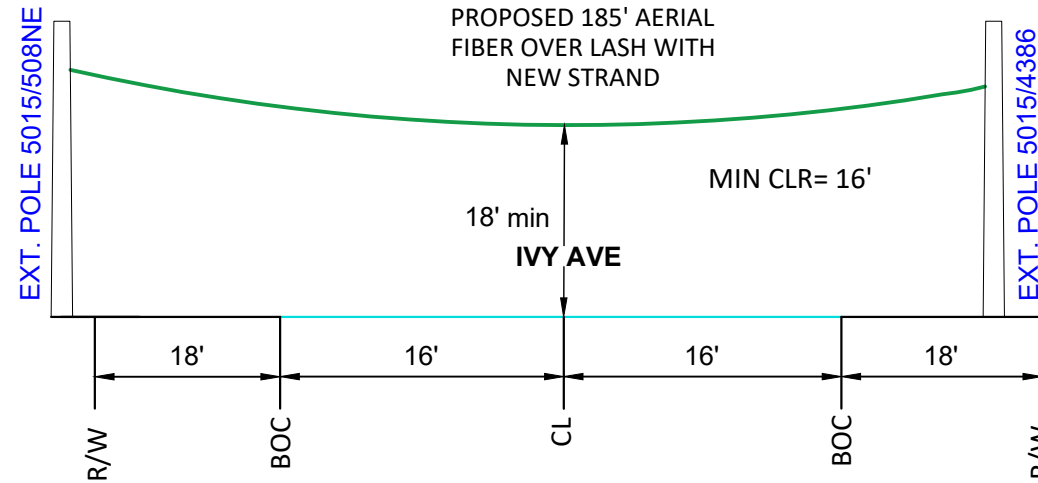

STREET CROSSING AERIAL CLEARANCE
IVY AVE
LOOKING SOUTH
NTS

VARIABLE SPAN LENGTH

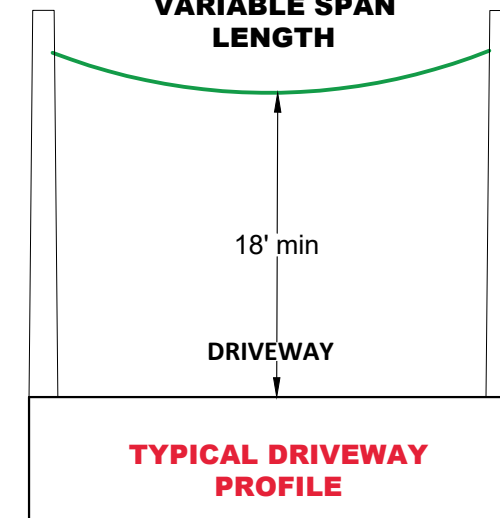

TYPICAL DRIVEWAY
PROFILE

PROFILE "B" IS FROM SHEET 1

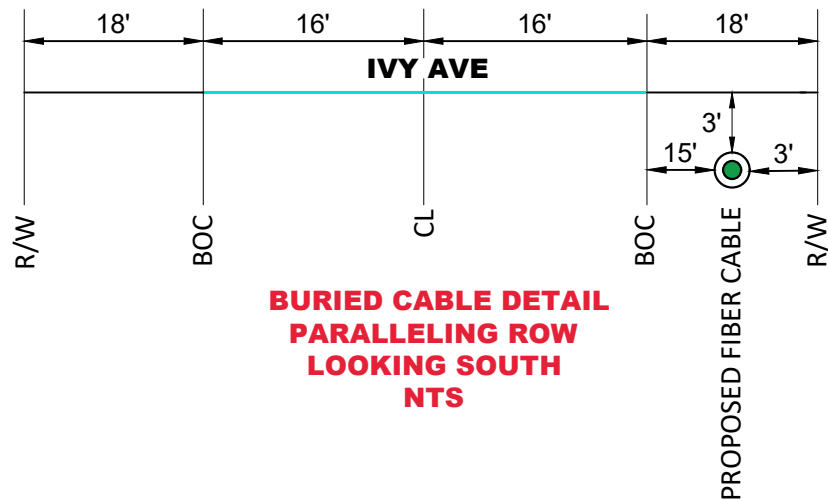

BURIED CABLE DETAIL
PARALLELING ROW
LOOKING SOUTH
NTS

PROFILE "E" IS FROM SHEET 1

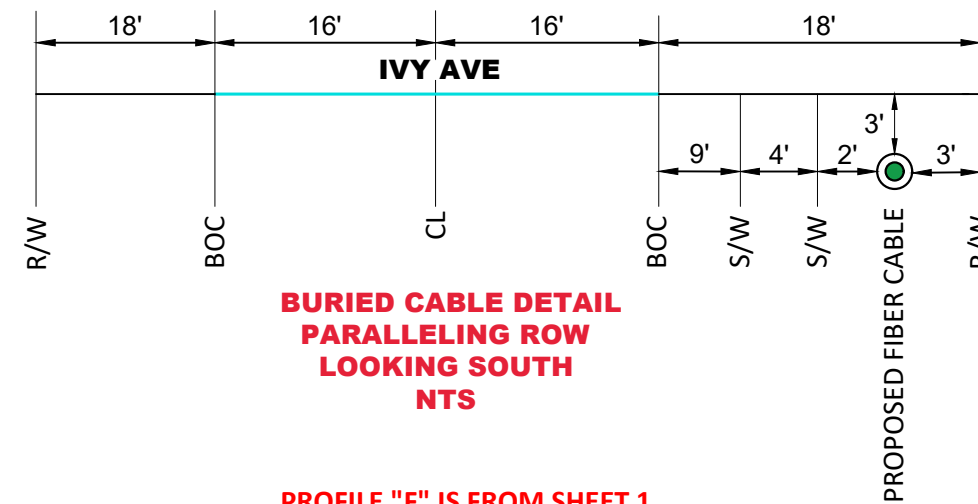

BURIED CABLE DETAIL
PARALLELING ROW
LOOKING SOUTH
NTS

PROFILE "C" IS FROM SHEET 1

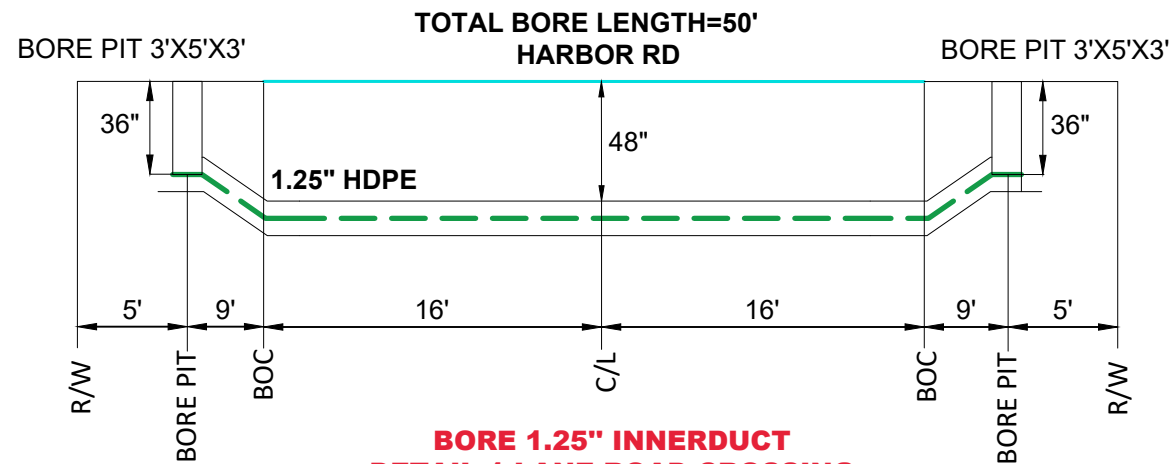

BORE 1.25" INNERDUCT
DETAIL 1 LANE ROAD CROSSING
LOOKING WEST
NTS

PROFILE "F" IS FROM SHEET 1

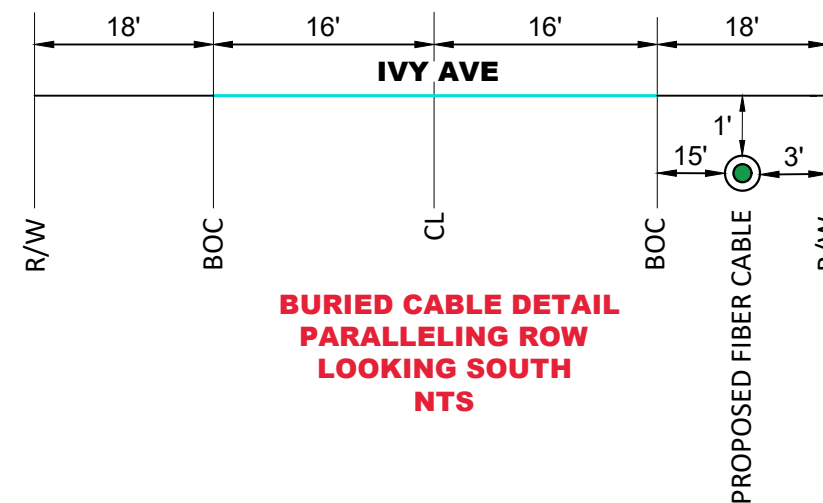

BURIED CABLE DETAIL
PARALLELING ROW
LOOKING SOUTH
NTS

LEGEND

- AERIAL PROPOSED FIBER WITH NEW STRAND
- PROPOSED BURIED FIBER
- PROPOSED CONDUIT
- ROW
- EOP
- CENTER LINE
- BACK OF CURB
- EXISTING WS PEDESTAL
- PROPOSED WS PEDESTAL
- REMOVED WS PEDESTAL
- BORE PIT
- POWER POLE
- PROPOSED ANCHOR & GUY
- PROPOSED HAND HOLE



DATE CREATED: 4/9/26

DATE REVISED:

DRAWN BY: RAMTeCH

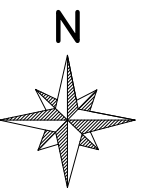

SCALE:1:50

COMPANY:
Windstream

SYSTEM:
CRETE, NE

PROJECT NUMBER:
715062332

DESCRIPTION:
FTTP GPON PERMIT

MAP:

1A OF 4

RAMTeCH

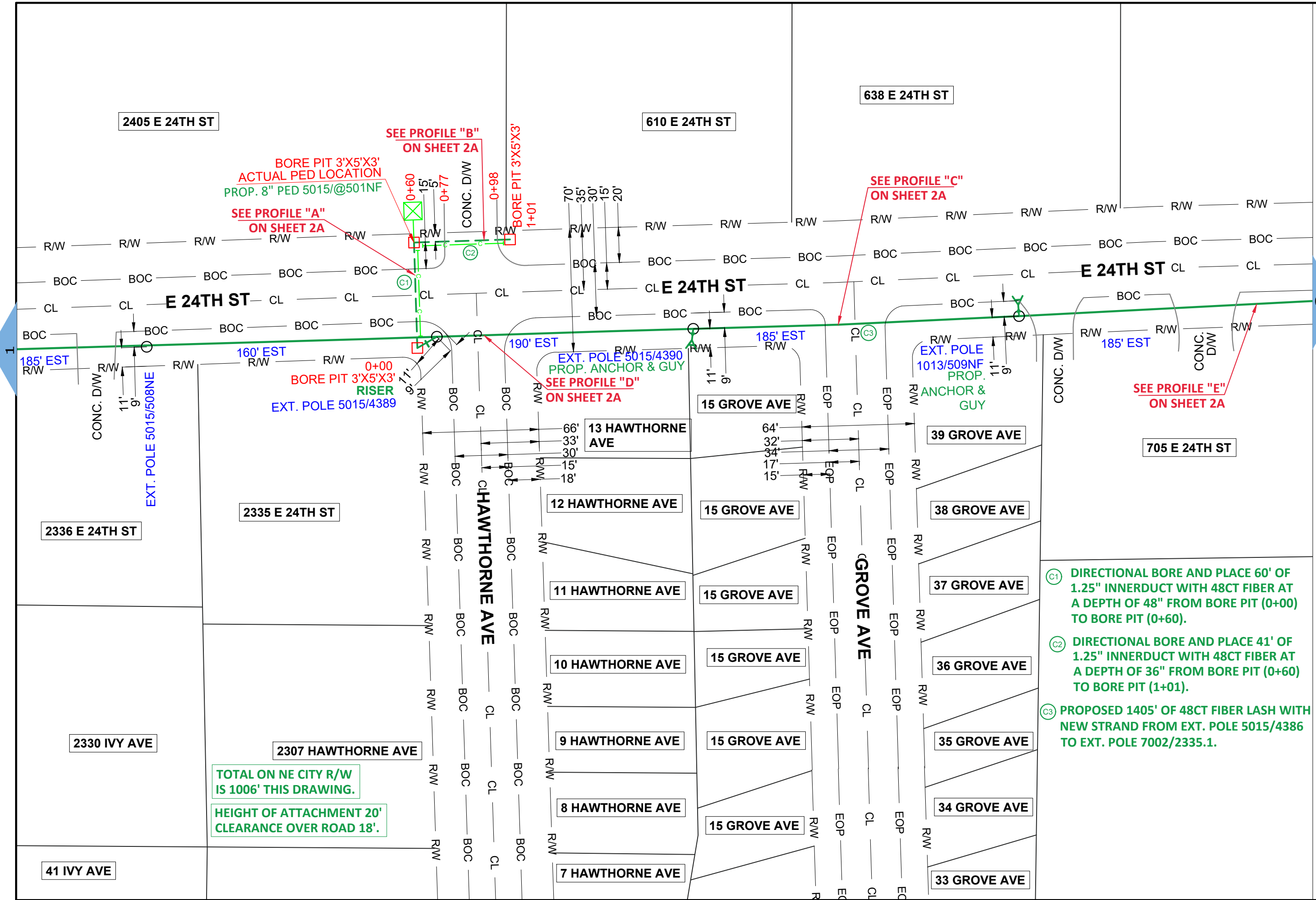

| LEGEND | |
|--------|---------------------------------------|
| | AERIAL PROPOSED FIBER WITH NEW STRAND |
| | PROPOSED BURIED FIBER |
| | PROPOSED CONDUIT |
| | R/W |
| | EOP |
| | CENTER LINE |
| | BACK OF CURB |
| | EXISTING WS PEDESTAL |
| | PROPOSED WS PEDESTAL |
| | REMOVED WS PEDESTAL |
| | BORE PIT |
| | POWER POLE |
| | PROPOSED ANCHOR & GUY |
| | PROPOSED HAND HOLE |



DATE CREATED: 4/9/26
 DATE REVISED:
 DRAWN BY: RAMTeCH

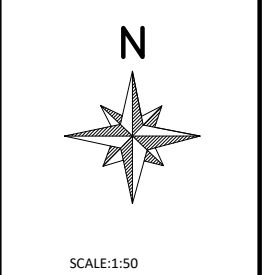

COMPANY: Windstream
 SYSTEM: CRETE, NE
 PROJECT NUMBER: 715062332
 DESCRIPTION: FTTP GPON PERMIT
 MAP:

- C1** DIRECTIONAL BORE AND PLACE 60' OF 1.25" INNERDUCT WITH 48CT FIBER AT A DEPTH OF 48" FROM BORE PIT (0+00) TO BORE PIT (0+60).
- C2** DIRECTIONAL BORE AND PLACE 41' OF 1.25" INNERDUCT WITH 48CT FIBER AT A DEPTH OF 36" FROM BORE PIT (0+60) TO BORE PIT (1+01).
- C3** PROPOSED 1405' OF 48CT FIBER LASH WITH NEW STRAND FROM EXT. POLE 5015/4386 TO EXT. POLE 7002/2335.1.

TOTAL ON NE CITY R/W IS 1006' THIS DRAWING.
 HEIGHT OF ATTACHMENT 20' CLEARANCE OVER ROAD 18'.

PROFILE "A" IS FROM SHEET 2

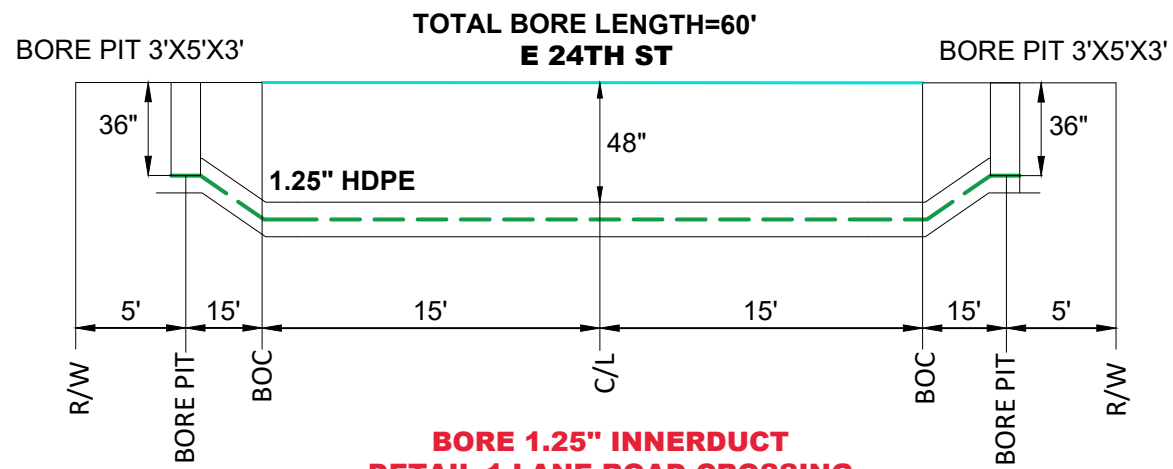

**BORE 1.25" INNERDUCT
DETAIL 1 LANE ROAD CROSSING
LOOKING EAST
NTS**

PROFILE "B" IS FROM SHEET 2

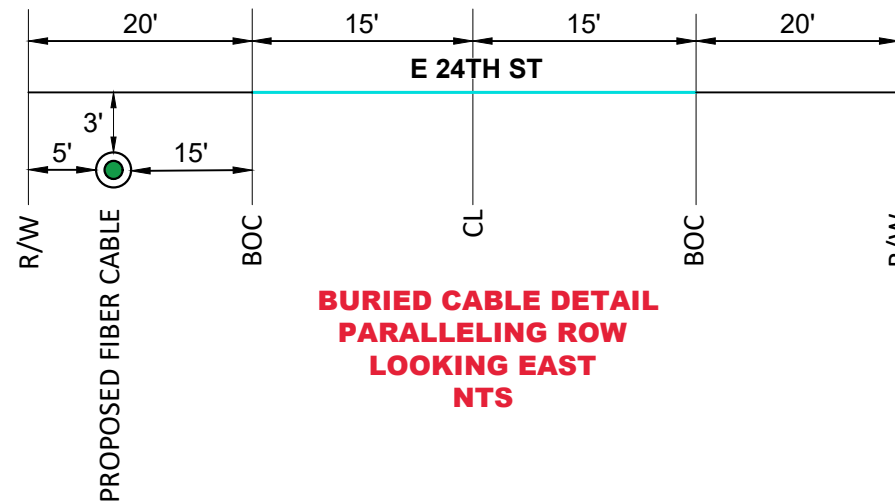

**BURIED CABLE DETAIL
PARALLELING ROW
LOOKING EAST
NTS**

PROFILE "C" IS FROM SHEET 2

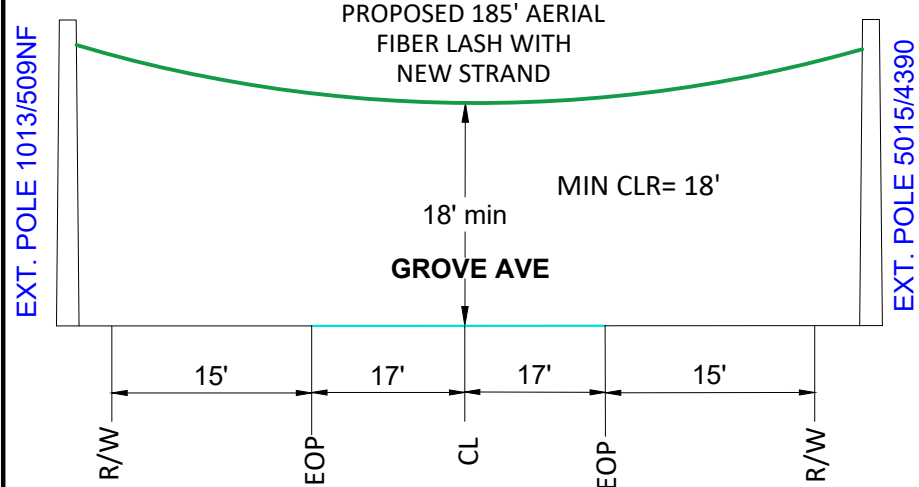

**STREET CROSSING AERIAL CLEARANCE
(GROVE AVE)
LOOKING SOUTH
NTS**

PROFILE "D" IS FROM SHEET 2

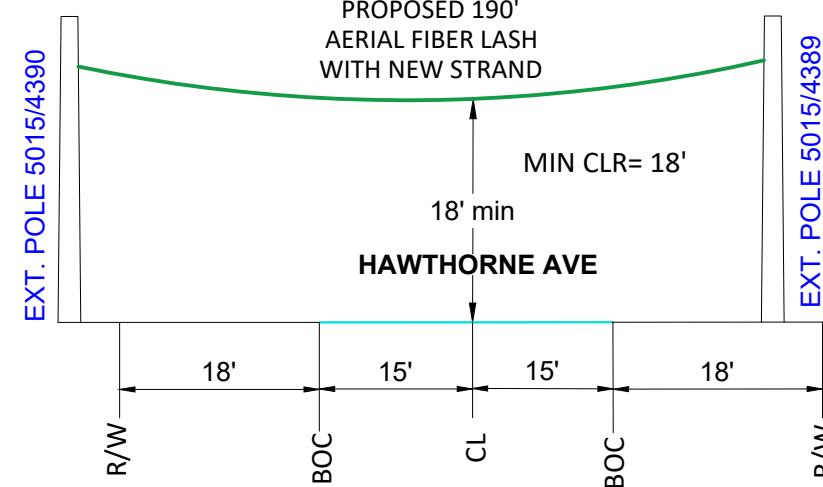

**STREET CROSSING AERIAL CLEARANCE
(HAWTHORNE AVE)
LOOKING SOUTH
NTS**

PROFILE "E" IS FROM SHEET 2

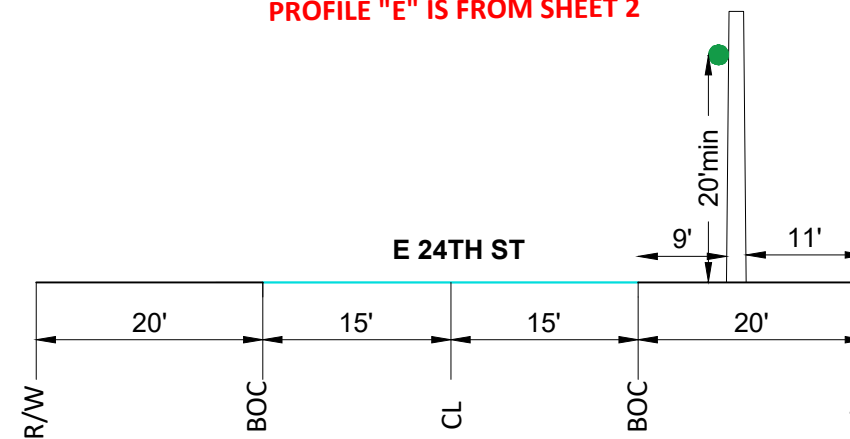

**PARALLELING E 24TH ST
LOOKING WEST
NTS**

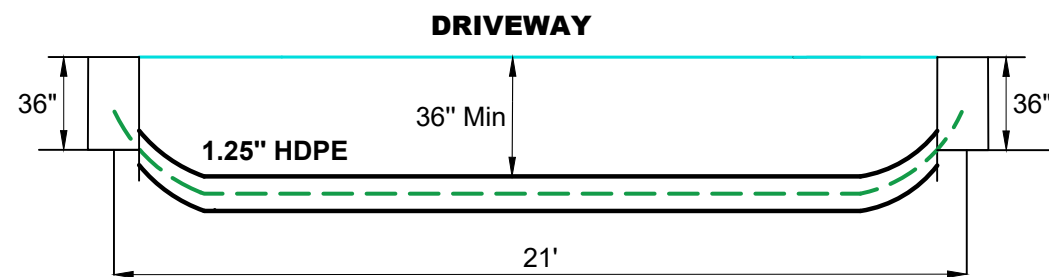

**BORE DETAIL
DRIVEWAY CROSSING
NTS**

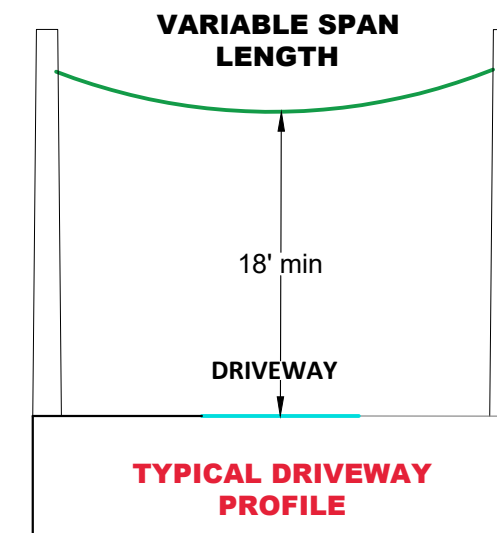

**TYPICAL DRIVEWAY
PROFILE**

LEGEND

- AERIAL PROPOSED FIBER WITH NEW STRAND
- PROPOSED BURIED FIBER
- PROPOSED CONDUIT
- ROW
- EOP
- CENTER LINE
- BACK OF CURB
- EXISTING WS PEDESTAL
- PROPOSED WS PEDESTAL
- REMOVED WS PEDESTAL
- BORE PIT
- POWER POLE
- PROPOSED ANCHOR & GUY
- PROPOSED HAND HOLE



DATE CREATED: 4/9/26
 DATE REVISED:
 DRAWN BY: RAMTeCH

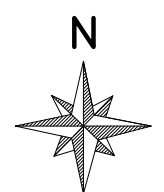

SCALE:1:50
 COMPANY: Windstream
 SYSTEM: CRETE, NE
 PROJECT NUMBER: 715062332
 DESCRIPTION: FTTP GPON PERMIT
 MAP:

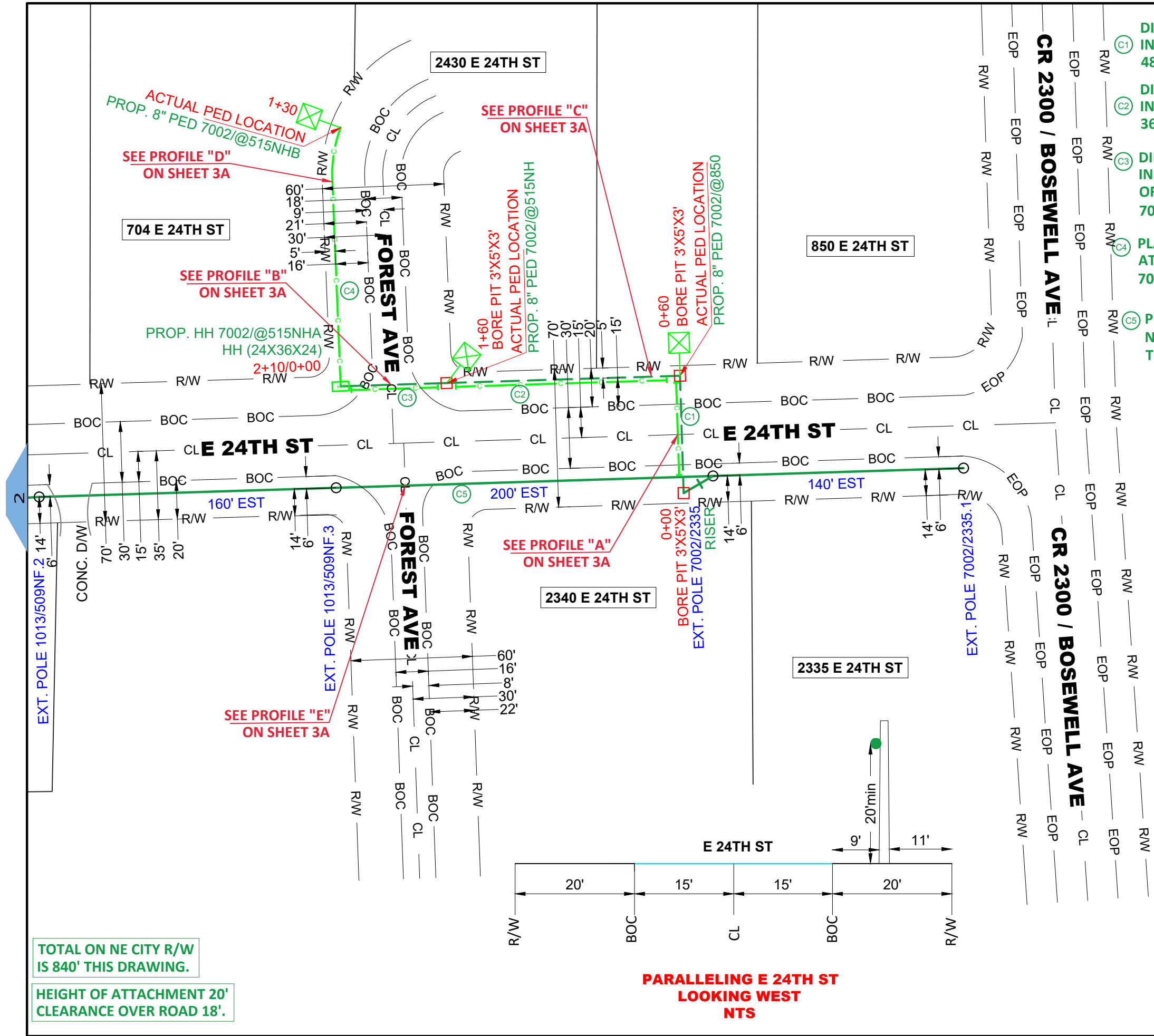

- (C1) DIRECTIONAL BORE AND PLACE 60' OF 1.25" INNERDUCT WITH 48CT FIBER AT A DEPTH OF 48" FROM BORE PIT (0+00) TO BORE PIT (0+60).
- (C2) DIRECTIONAL BORE AND PLACE 100' OF 1.25" INNERDUCT WITH 48CT FIBER AT A DEPTH OF 36" FROM BORE PIT (0+60) TO BORE PIT (1+60).
- (C3) DIRECTIONAL BORE AND PLACE 50' OF 1.25" INNERDUCT WITH 48CT FIBER AT A DEPTH OF 48" FROM BORE PIT (1+60) TO PROP. HH 7002/@515NHA.
- (C4) PLACE 130' OF 12.7MM MICRODUCT WITH 12CT FIBER AT A DEPTH OF 12" VIA RESI PLOW FROM PROP.HH 7002/@515NHA TO PROP. PED 7002/@515NHB.
- (C5) PROPOSED 1405' OF 48CT FIBER LASH WITH NEW STRAND FROM EXT. POLE 5015/4386 TO EXT. POLE 7002/2335.1.

TOTAL ON NE CITY R/W IS 840' THIS DRAWING.

HEIGHT OF ATTACHMENT 20' CLEARANCE OVER ROAD 18'.

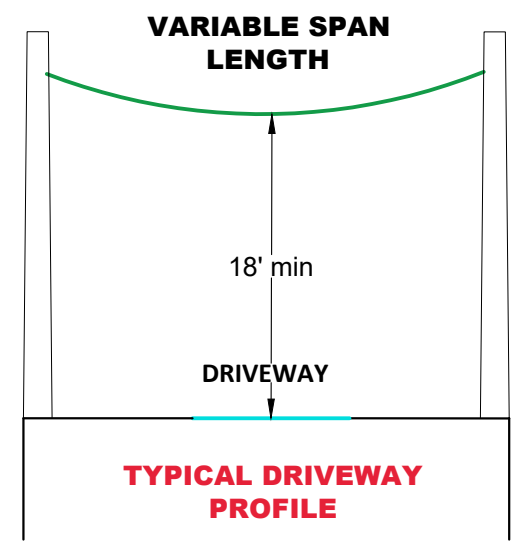
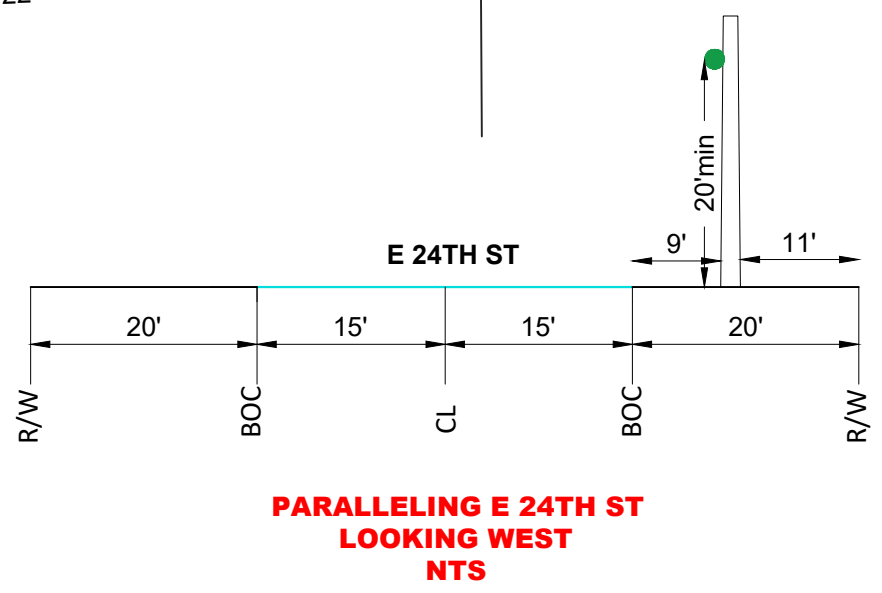

| LEGEND | |
|--------|---------------------------------------|
| | AERIAL PROPOSED FIBER WITH NEW STRAND |
| | PROPOSED BURIED FIBER |
| | PROPOSED CONDUIT |
| | R/W |
| | EOP |
| | CENTER LINE |
| | BACK OF CURB |
| | EXISTING WS PEDESTAL |
| | PROPOSED WS PEDESTAL |
| | REMOVED WS PEDESTAL |
| | BORE PIT |
| | POWER POLE |
| | PROPOSED ANCHOR & GUY |
| | PROPOSED HAND HOLE |

windstream™

DATE CREATED: 4/9/26

DATE REVISED:

DRAWN BY: RAMTECH

N

SCALE:1:50

COMPANY: Windstream

SYSTEM: CRETE, NE

PROJECT NUMBER: 715062332

DESCRIPTION: FTTP GPON PERMIT

MAP:

3 OF 4

RAMTECH

PROFILE "A" IS FROM SHEET 3

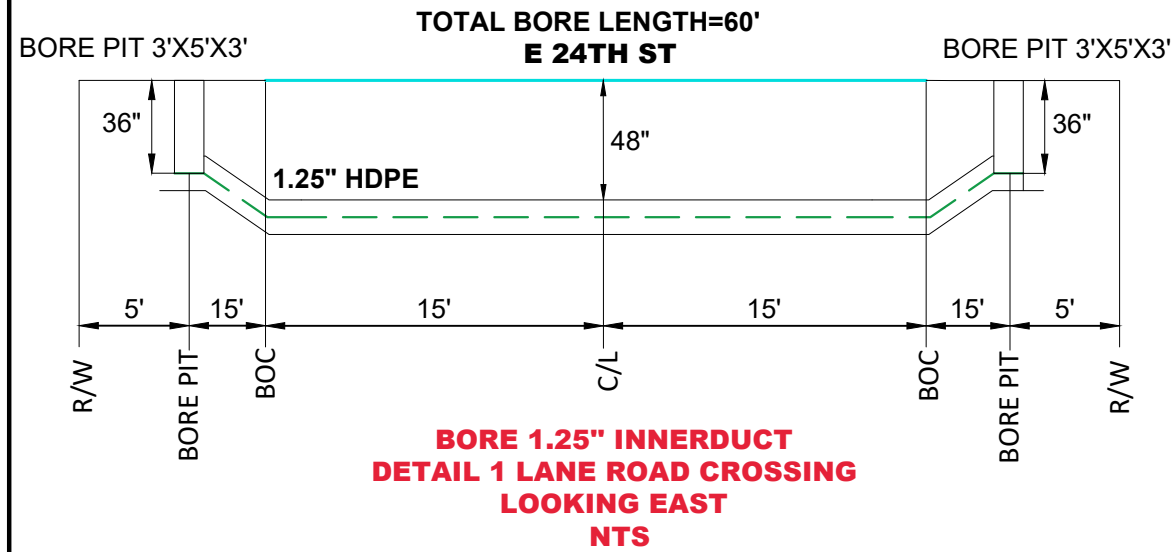

PROFILE "B" IS FROM SHEET 3

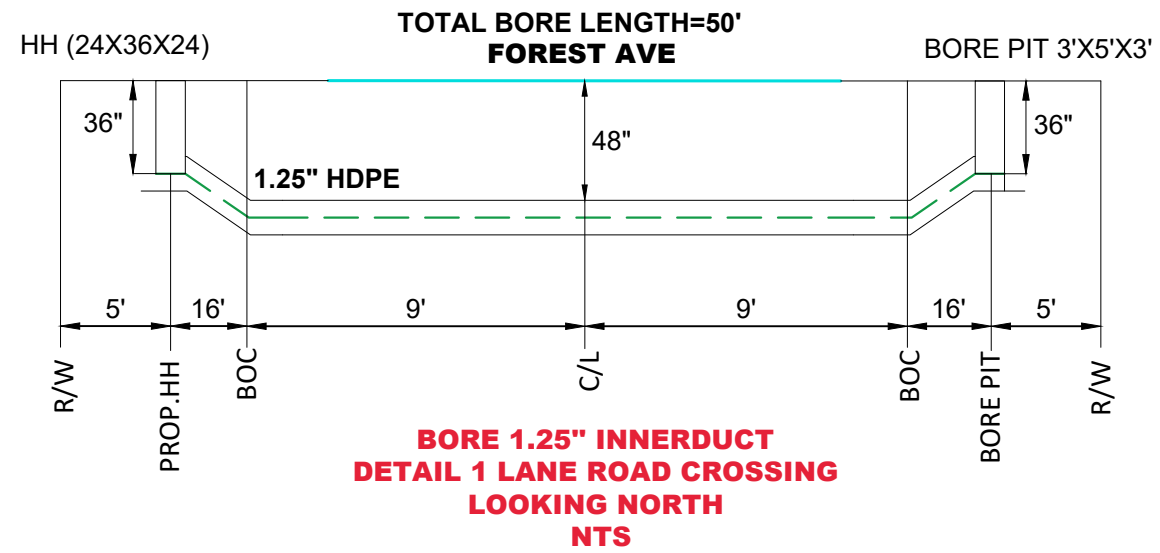

PROFILE "C" IS FROM SHEET 3

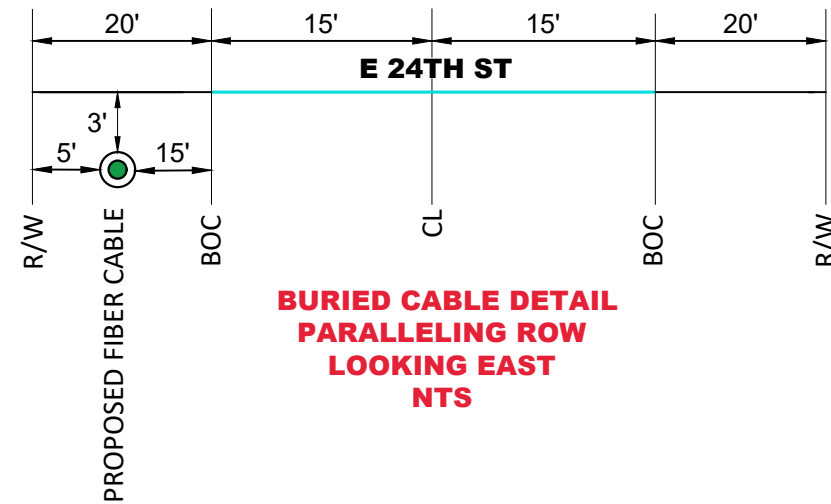

PROFILE "D" IS FROM SHEET 3

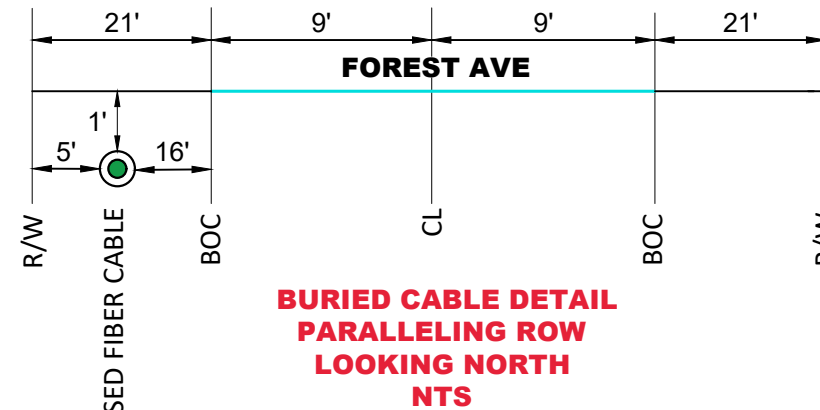

PROFILE "E" IS FROM SHEET 3

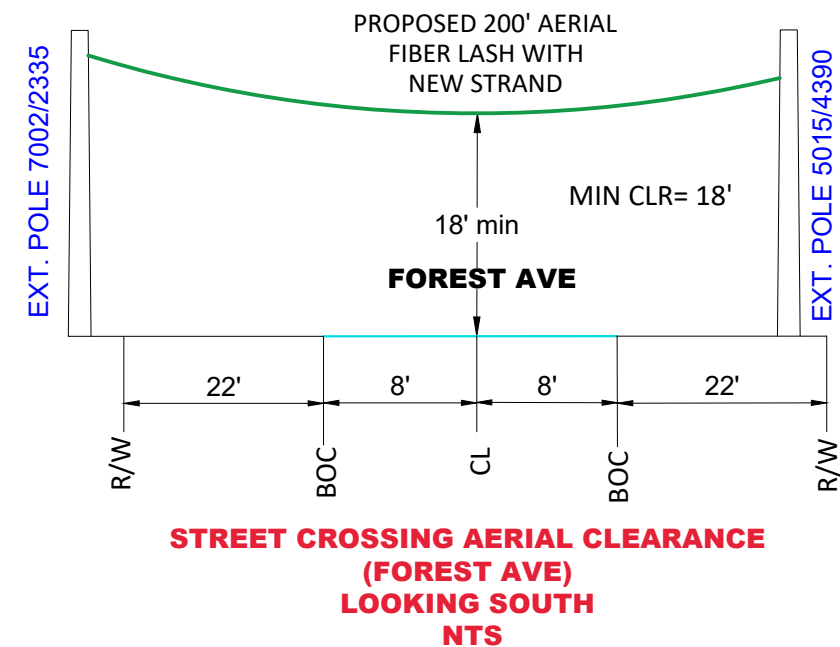

LEGEND

- AERIAL PROPOSED FIBER WITH NEW STRAND
- PROPOSED BURIED FIBER
- PROPOSED CONDUIT
- ROW
- EOP
- CENTER LINE
- BACK OF CURB
- EXISTING WS PEDESTAL
- PROPOSED WS PEDESTAL
- REMOVED WS PEDESTAL
- BORE PIT
- POWER POLE
- PROPOSED ANCHOR & GUY
- PROPOSED HAND HOLE



DATE CREATED: 4/9/26

DATE REVISED:

DRAWN BY: RAMTeCH

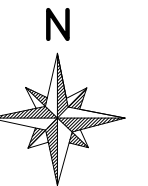

SCALE:1:50

COMPANY:
Windstream

SYSTEM:
CRETE, NE

PROJECT NUMBER:
715062332

DESCRIPTION:
FTTP GPON PERMIT

MAP:

3A OF 4

RAMTeCH

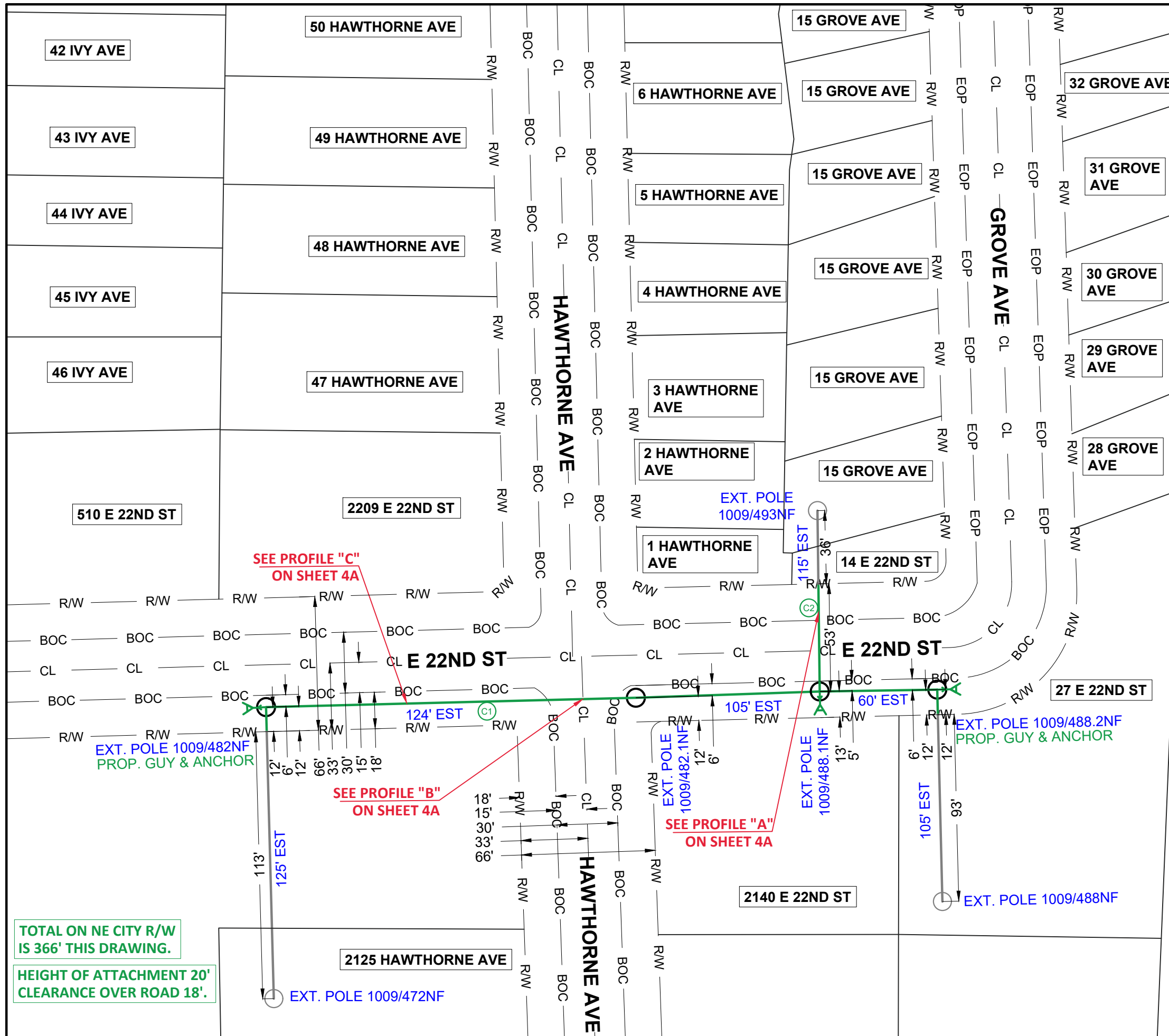

- C1 PROPOSED 313' OF 48CT FIBER LASH WITH NEW STRAND FROM EXT. POLE 1009/472NF TO EXT. POLE 1009/488NF.
- C2 PROPOSED 53' OF 48CT FIBER LASH WITH NEW STRAND FROM EXT. POLE 1009/488.1NF TO EXT. POLE 1009/493NF.

TOTAL ON NE CITY R/W IS 366' THIS DRAWING.

HEIGHT OF ATTACHMENT 20' CLEARANCE OVER ROAD 18'.

| LEGEND | |
|--------|---------------------------------------|
| | AERIAL PROPOSED FIBER WITH NEW STRAND |
| | PROPOSED BURIED FIBER |
| | PROPOSED CONDUIT |
| | R/W |
| | EOP |
| | CL |
| | BOC |
| | BACK OF CURB |
| | EXISTING WS PEDESTAL |
| | PROPOSED WS PEDESTAL |
| | REMOVED WS PEDESTAL |
| | BORE PIT |
| | POWER POLE |
| | PROPOSED ANCHOR & GUY |
| | PROPOSED HAND HOLE |



DATE CREATED: 4/9/26

DATE REVISED:

DRAWN BY: RAMTeCH

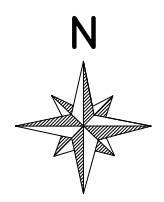

SCALE:1:50

COMPANY:
Windstream

SYSTEM:
CRETE, NE

PROJECT NUMBER:
715062332

DESCRIPTION:
FTTP GPON PERMIT

MAP:

4 OF 4

RAMTeCH

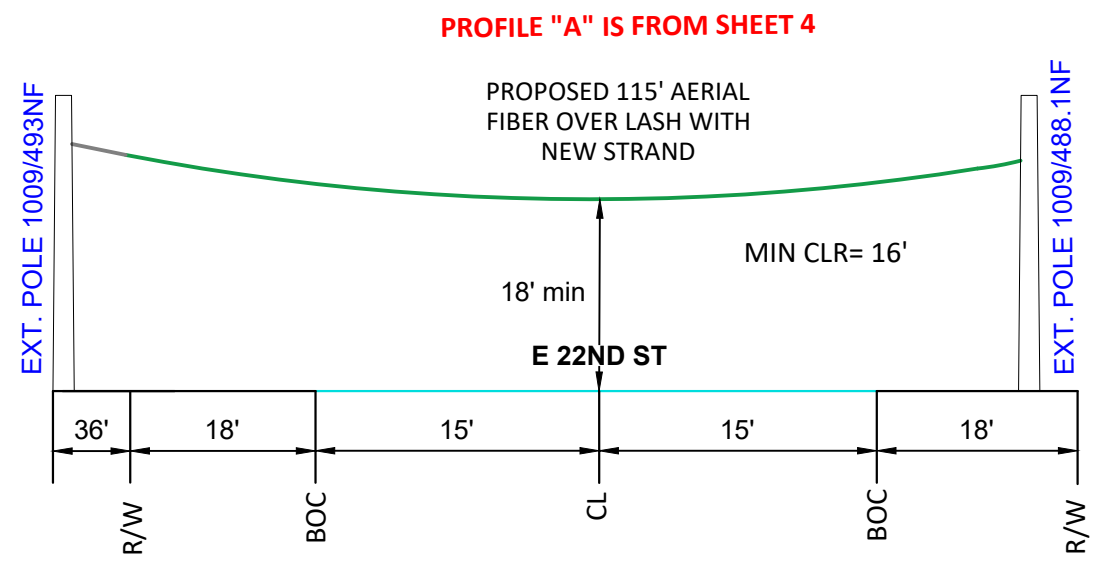

**STREET CROSSING AERIAL CLEARANCE
E 22ND ST
LOOKING EAST
NTS**

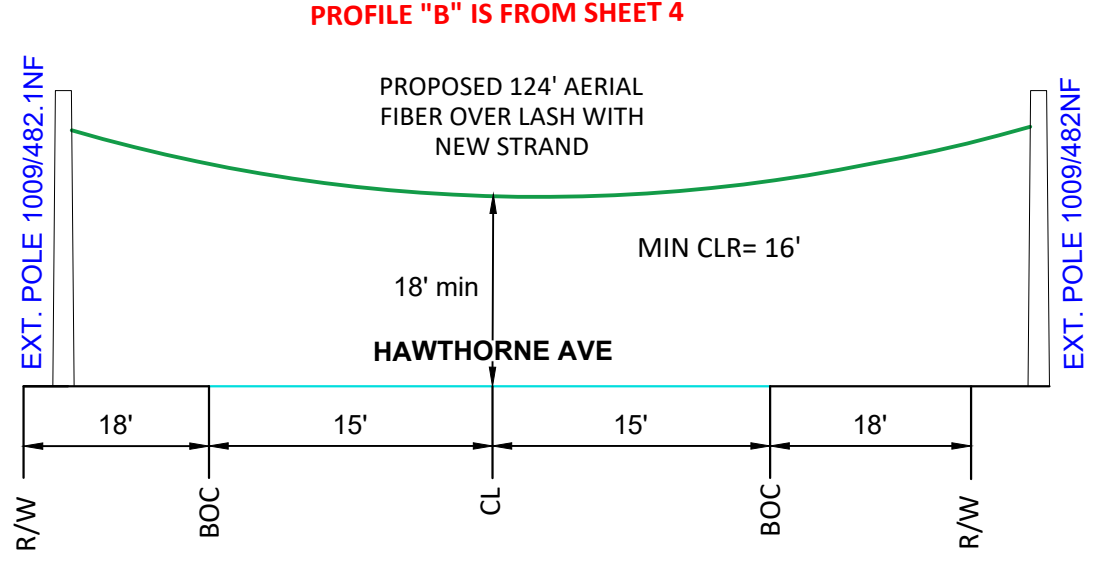

**STREET CROSSING AERIAL CLEARANCE
HAWTHORNE AVE
LOOKING SOUTHEAST
NTS**

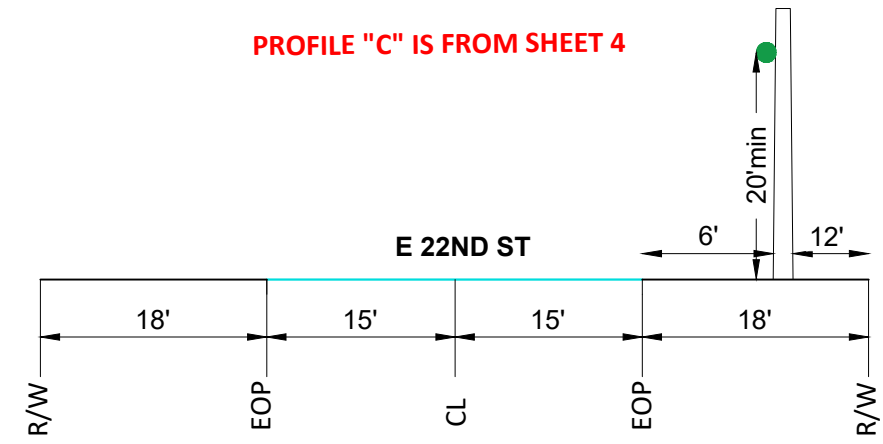

**PARALLELING E 22ND ST
LOOKING EAST
NTS**

LEGEND

- AERIAL PROPOSED FIBER WITH NEW STRAND
- PROPOSED BURIED FIBER
- PROPOSED CONDUIT
- EOW
- EOP
- CENTER LINE
- BACK OF CURB
- EXISTING WS PEDESTAL
- PROPOSED WS PEDESTAL
- REMOVED WS PEDESTAL
- BORE PIT
- POWER POLE
- PROPOSED ANCHOR & GUY
- PROPOSED HAND HOLE



DATE CREATED: 4/9/26

DATE REVISED:

DRAWN BY: RAMTeCH

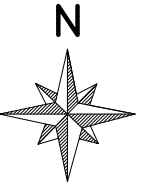

SCALE:1:50

COMPANY:
Windstream

SYSTEM:
CRETE, NE

PROJECT NUMBER:
715062332

DESCRIPTION:
FTTP GPON PERMIT

MAP:

4A OF 4

RAMTeCH