

Windstream LOCATION MAP E 2ND ST

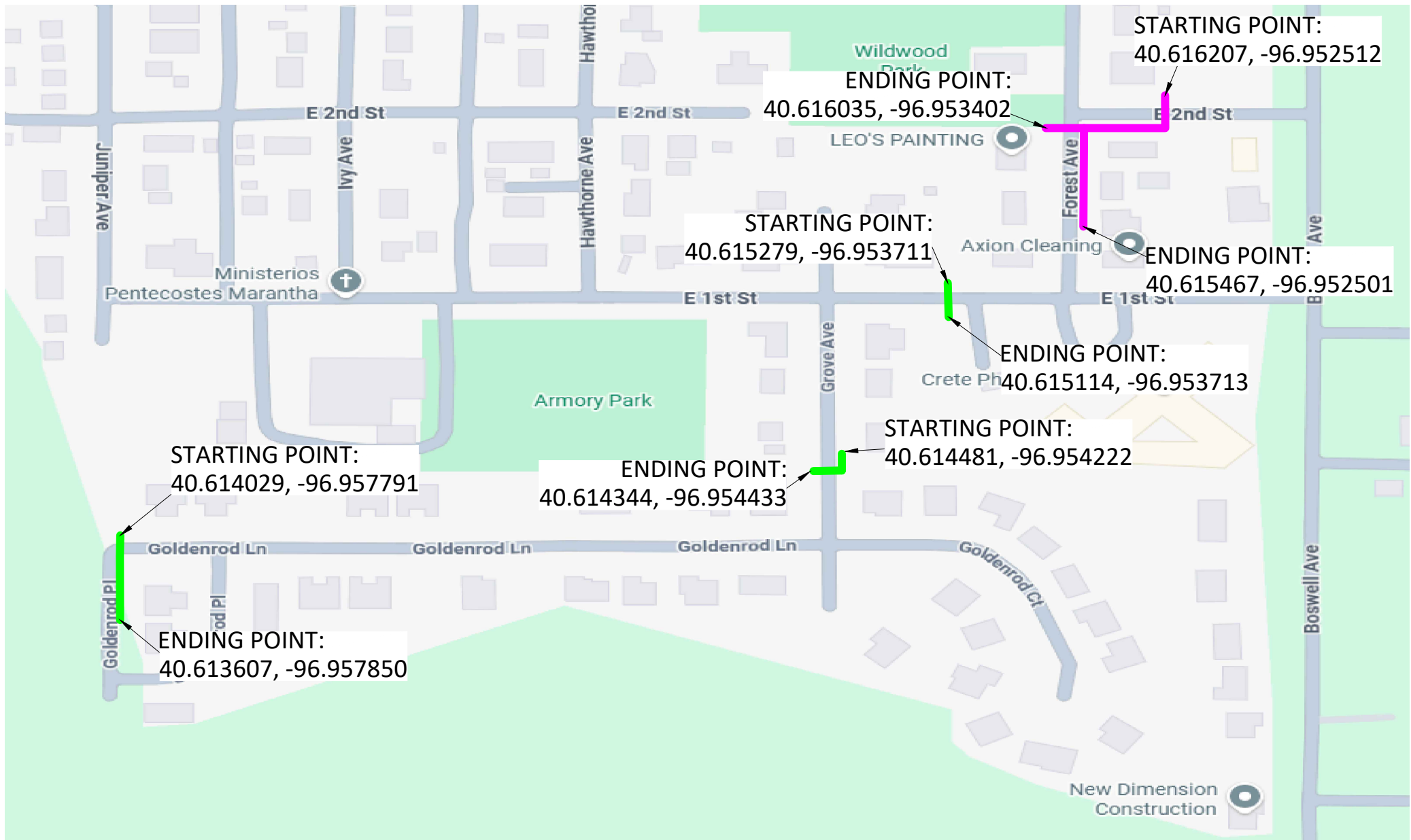

LEGEND	
	PROPOSED CONDUIT
	PROPOSED BURIED FIBER
	AERIAL PROPOSED FIBER WITH NEW STRAND
	AERIAL PROPOSED FIBER WITH EXISTING STRAND
	SIDEWALK
	ROW
	EOP
	BOC
	CENTER LINE
	POLE
	POWER POLE
	JOINT POLE
	EXT WS PED
	NEW WS PED
	BORE PIT
	NEW FDH



DATE CREATED: 4/10/26
DATE REVISED:
DRAWN BY: RAMTeCH



SCALE: NTS

COMPANY:
Windstream
SYSTEM:
CRETE, NE
PROJECT NUMBER:
715062326
DESCRIPTION:
FTTP GPON PERMIT
MAP:
LOCATION MAP

RAMTeCH

WINDSTREAM PROPOSES FIBER OPTIC CABLE PLACEMENT:

	12 FOC	24 FOC	48 FOC	144 FOC
BURIED	12 FOC	24 FOC	48 FOC	144 FOC
DIRECT BURIED	0'	0'	0'	40'
DRY BORE	0'	0'	0'	0'
DIRECTIONAL BORE	0'	160'	60'	0'
12.7MM MICRODUCT	0'	150'	0'	0'
AERIAL	12 FOC	24 FOC	48 FOC	144 FOC
LASH TO EXISTING	85'	350'	0'	0'
NEW ATTACHMENT	0'	0'	0'	0'

TOTAL PROPOSED CABLE= 845'

CITY PERMIT E 2ND ST

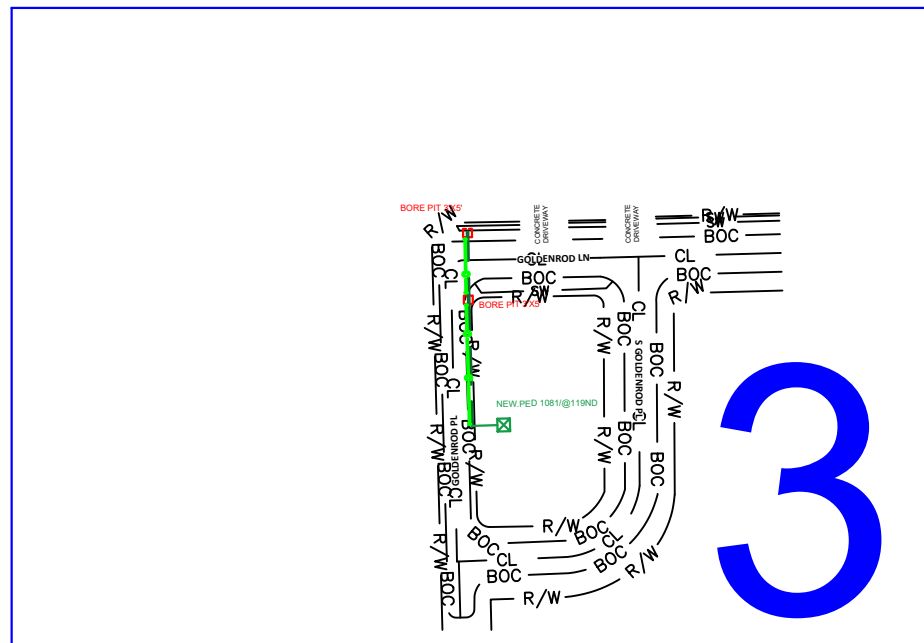
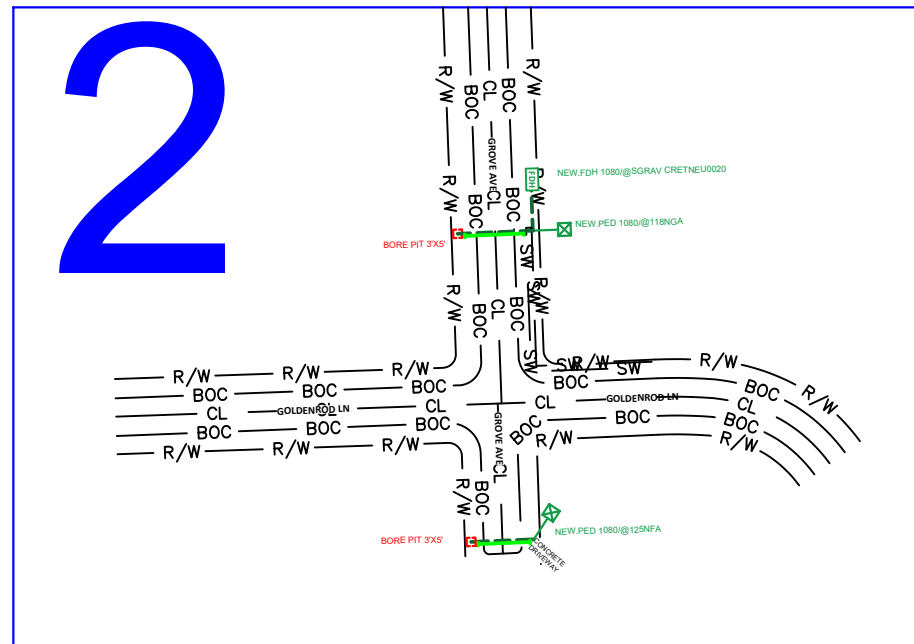
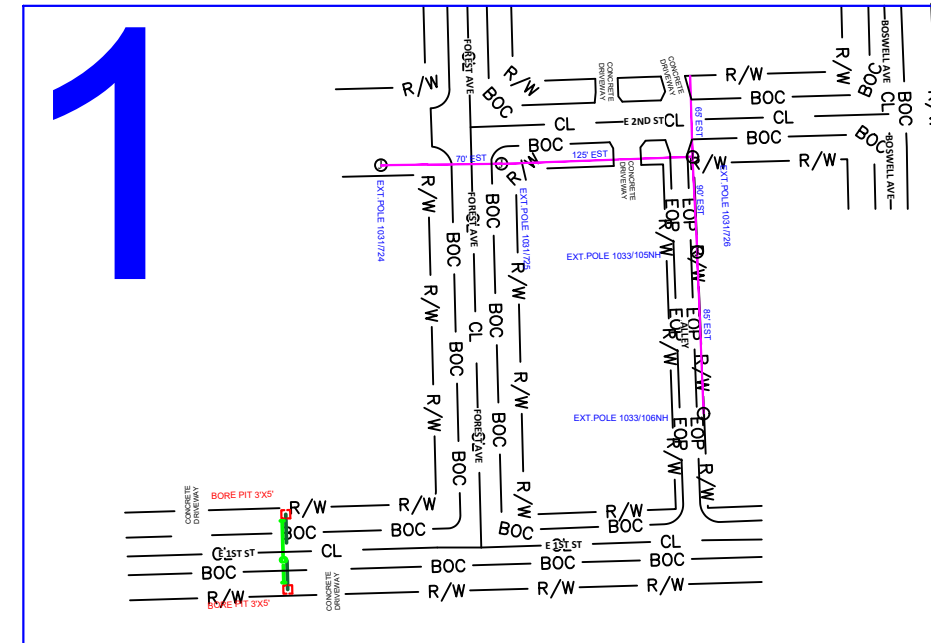

LEGEND

- PROPOSED BURIED FIBER
- AERIAL PROPOSED FIBER WITH NEW STRAND
- AERIAL PROPOSED FIBER WITH EXISTING STRAND
- SW SIDEWALK
- R/W ROW
- EOP EOP
- BOC BOC
- CL CENTER LINE
- POLE
- POWER POLE
- ⊙ JOINT POLE
- ⊠ EXT WS PED
- ⊠ NEW WS PED
- ⊠ BORE PIT
- ⊠ NEW FDH



DATE CREATED: 4/10/26

DATE REVISED:

DRAWN BY: RAMTeCH

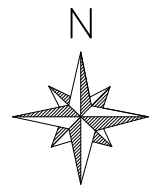

SCALE: NTS

COMPANY:
Windstream

SYSTEM:
CRETE, NE

PROJECT NUMBER:
715062326

DESCRIPTION:
FTTP GPON PERMIT

MAP:
KEY MAP

RAMTeCH

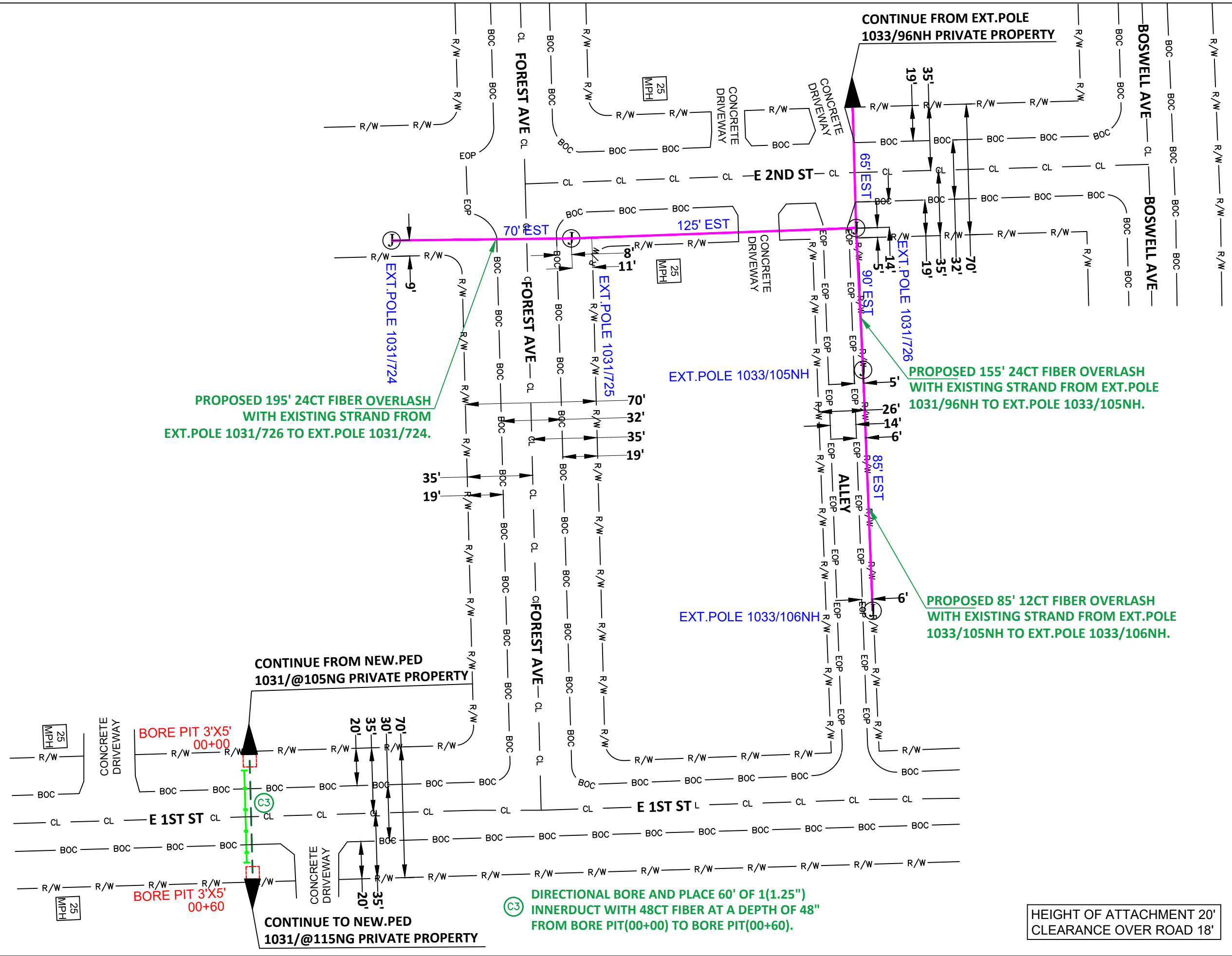

PROPOSED 195' 24CT FIBER OVERLASH WITH EXISTING STRAND FROM EXT. POLE 1031/726 TO EXT. POLE 1031/724.

EXT. POLE 1033/105NH

PROPOSED 155' 24CT FIBER OVERLASH WITH EXISTING STRAND FROM EXT. POLE 1031/96NH TO EXT. POLE 1033/105NH.

EXT. POLE 1033/106NH

PROPOSED 85' 12CT FIBER OVERLASH WITH EXISTING STRAND FROM EXT. POLE 1033/105NH TO EXT. POLE 1033/106NH.

(C3) DIRECTIONAL BORE AND PLACE 60' OF 1(1.25") INNERDUCT WITH 48CT FIBER AT A DEPTH OF 48" FROM BORE PIT(00+00) TO BORE PIT(00+60).

HEIGHT OF ATTACHMENT 20' CLEARANCE OVER ROAD 18'

LEGEND

- PROPOSED BURIED FIBER
- AERIAL PROPOSED FIBER WITH NEW STRAND
- AERIAL PROPOSED FIBER WITH EXISTING STRAND
- SIDEWALK
- ROW
- EOP
- BOC
- CENTER LINE
- POLE
- POWER POLE
- JOINT POLE
- EXT WS PED
- NEW WS PED
- BORE PIT
- NEW FDH



DATE CREATED: 4/10/26
 DATE REVISED:
 DRAWN BY: RAMTeCH



SCALE: 1:50

COMPANY:
Windstream

SYSTEM:
CRETE, NE

PROJECT NUMBER:
715062326

DESCRIPTION:
FTTP GPON PERMIT

MAP:
1 OF 3

RAMTeCH

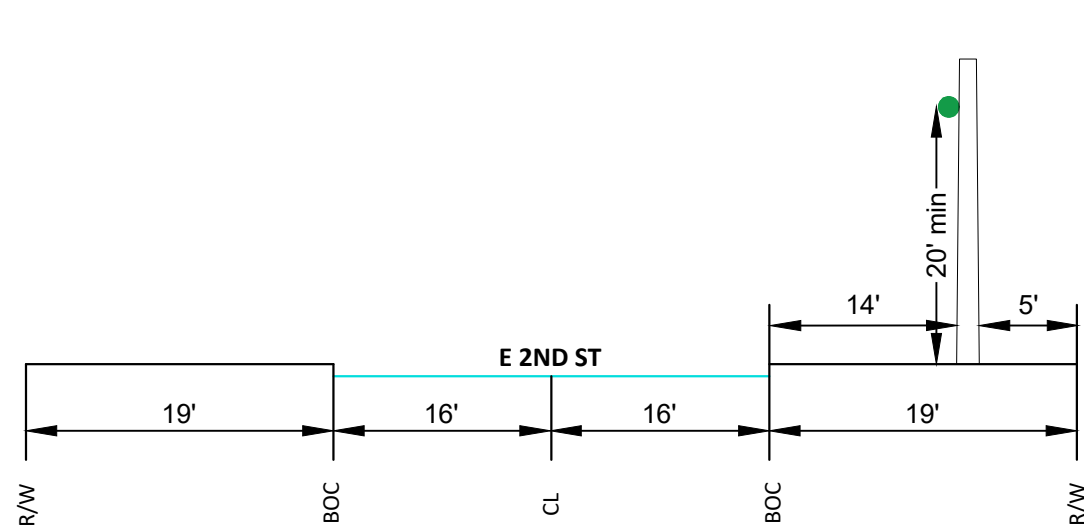

**TYPICAL
PARALLELING E 2ND ST
LOOKING EAST
NTS**

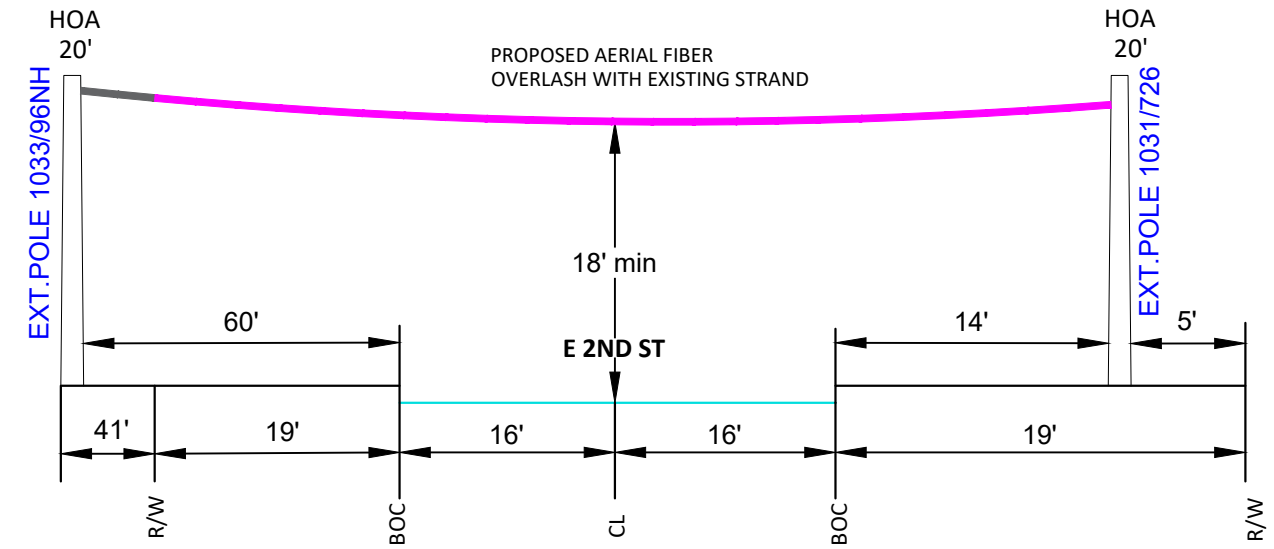

**STREET CROSSING
AERIAL CLEARANCE
LOOKING EAST
NTS**

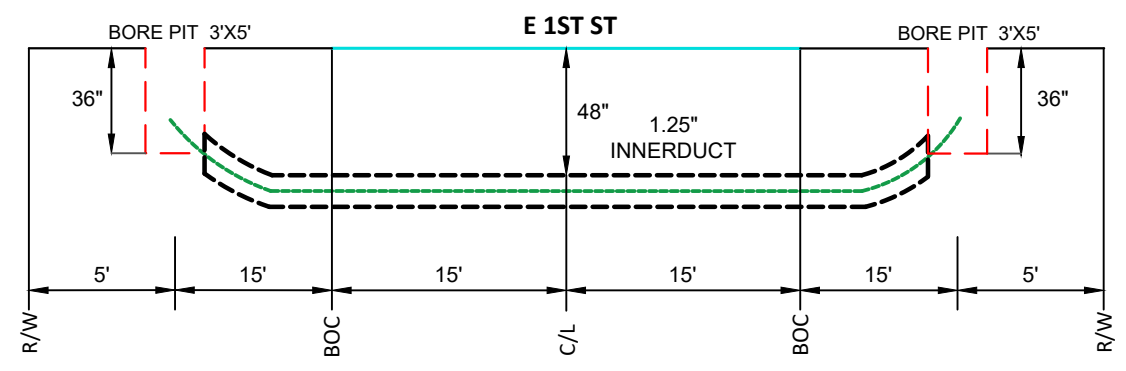

**BORE DETAIL
2 LANE ROAD CROSSING
LOOKING EAST
NTS**



**STREET CROSSING
AERIAL CLEARANCE
LOOKING NORTH
NTS**

LEGEND

- PROPOSED CONDUIT
- - - PROPOSED BURIED FIBER
- AERIAL PROPOSED FIBER WITH NEW STRAND
- AERIAL PROPOSED FIBER WITH EXISTING STRAND
- SW SIDEWALK
- R/W ROW
- EOP EOP
- BOC BOC
- CL CENTER LINE
- POLE
- POWER POLE
- ⊙ JOINT POLE
- ⊗ EXT WS PED
- ⊗ NEW WS PED
- ⊗ BORE PIT
- ⊗ NEW FDH



DATE CREATED: 4/10/26
DATE REVISED:
DRAWN BY: RAMTeCH

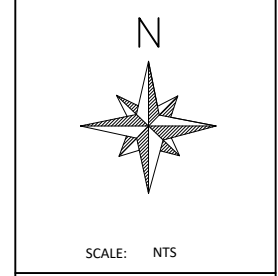

COMPANY:
Windstream
SYSTEM:
CRETE, NE
PROJECT NUMBER:
715062326
DESCRIPTION:
FTTP GPON PERMIT
MAP:

1A OF 3

RAMTeCH

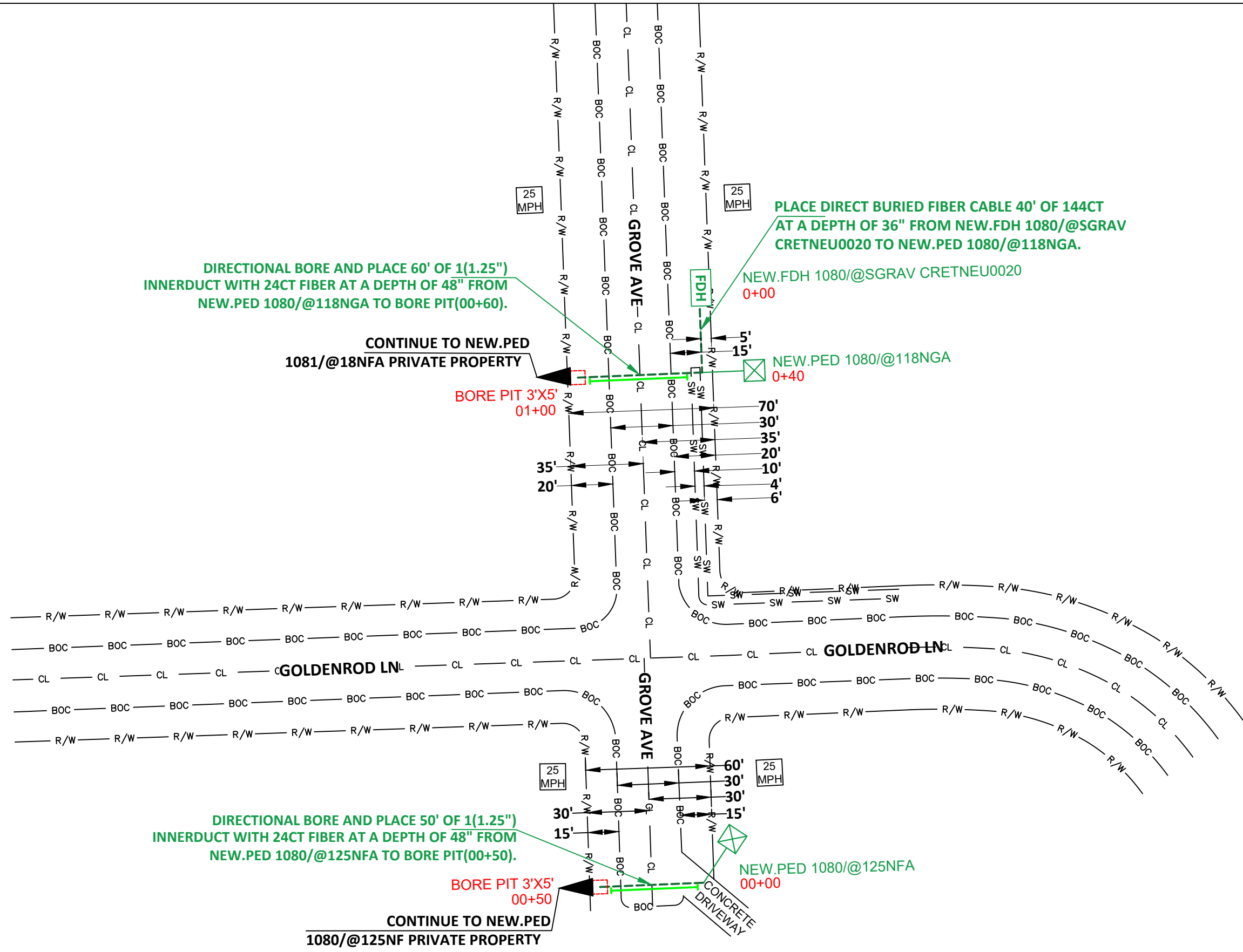

LEGEND

	PROPOSED CONDUIT
	PROPOSED BURIED FIBER
	AERIAL PROPOSED FIBER WITH NEW STRAND
	AERIAL PROPOSED FIBER WITH EXISTING STRAND
	SW SIDEWALK
	R/W ROW
	EOP EOP
	BOC BOC
	CL CENTER LINE
	POLE
	POWER POLE
	JOINT POLE
	EXT WS PED
	NEW WS PED
	BORE PIT
	NEW FDH



DATE CREATED: 4/10/26
 DATE REVISED:
 DRAWN BY: RAMTeCH



SCALE: 1:50

COMPANY:
Windstream

SYSTEM:
CRETE, NE

PROJECT NUMBER:
715062326

DESCRIPTION:
FTTP GPON PERMIT

MAP:
2 OF 3

RAMTeCH

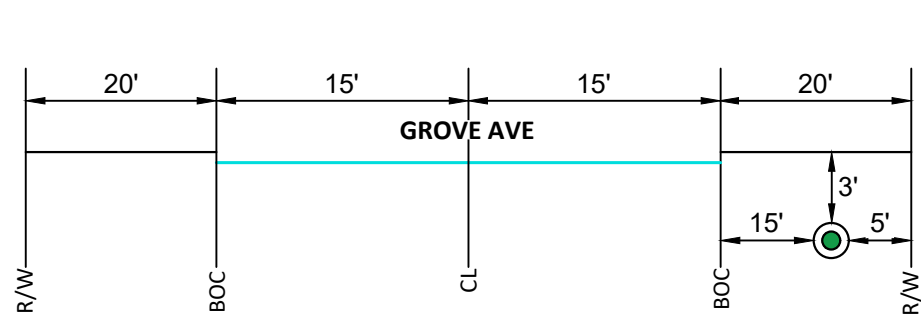

**TYPICAL DIRECT BURIED
CABLE DETAIL
PARALLELING ROW
LOOKING NORTHWEST
NTS**

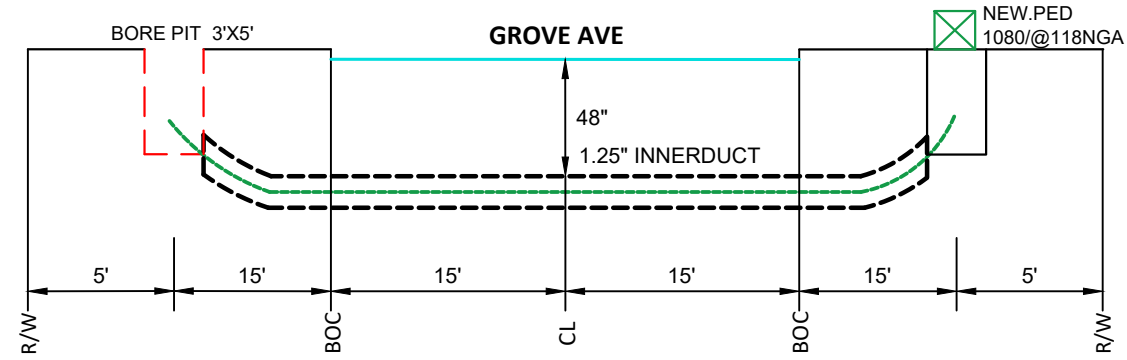

**DIRECTIONAL BORE DETAIL
2 LANE ROAD CROSSING
LOOKING NORTHWEST
NTS**

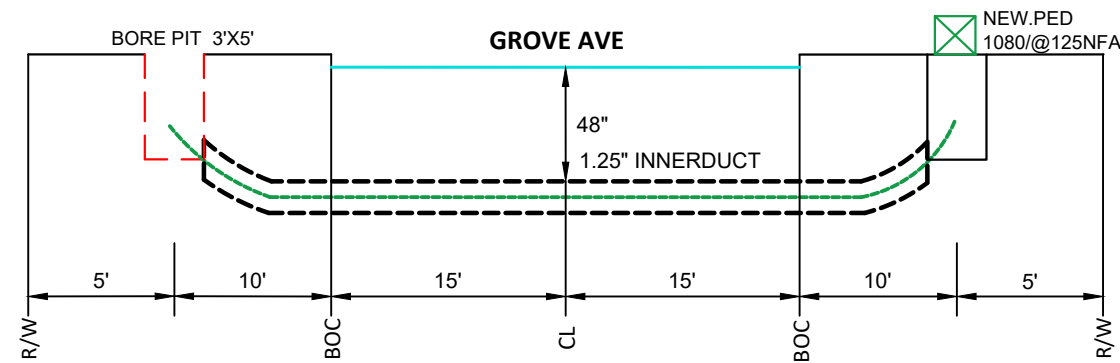

**DIRECTIONAL BORE DETAIL
2 LANE ROAD CROSSING
LOOKING NORTHWEST
NTS**

LEGEND

- PROPOSED CONDUIT
- - - PROPOSED BURIED FIBER
- AERIAL PROPOSED FIBER WITH NEW STRAND
- AERIAL PROPOSED FIBER WITH EXISTING STRAND
- SW SIDEWALK
- R/W ROW
- EOP EOP
- BOC BOC
- CL CENTER LINE
- POLE
- POWER POLE
- JOINT POLE
- ⊠ EXT WS PED
- ⊠ NEW WS PED
- ⊠ BORE PIT
- ⊠ NEW FDH



DATE CREATED: 4/10/26

DATE REVISED:

DRAWN BY: RAMTeCH



SCALE: NTS

COMPANY:
Windstream

SYSTEM:
CRETE, NE

PROJECT NUMBER:
715062326

DESCRIPTION:
FTTP GPON PERMIT

MAP:

2A OF 3

RAMTeCH

- C1 DIRECTIONAL BORE AND PLACE 50' OF 1(1.25") INNERDUCT WITH 24CT FIBER AT A DEPTH OF 48" FROM BORE PIT(0+00) TO BORE PIT(0+50).
- C2 PLACE 150' OF 12.7MM MICRODUCT WITH 24CT FIBER AT A DEPTH OF 12" FROM BORE PIT(0+50) TO NEW.PED 1081/@119ND.

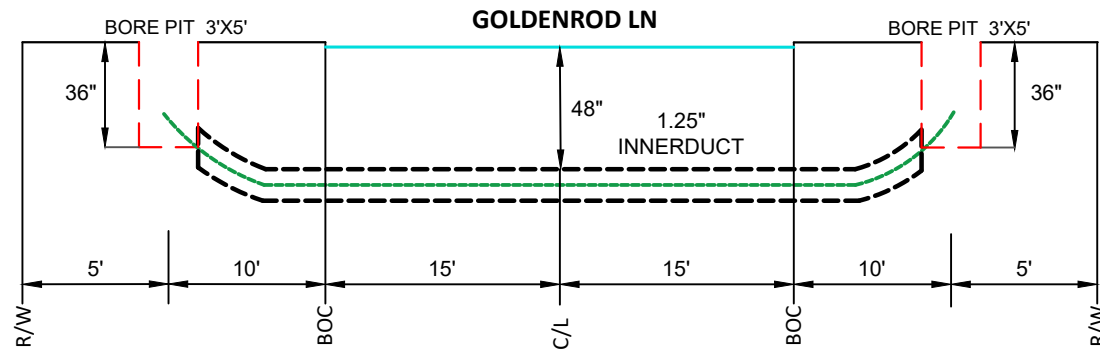

**BORE DETAIL
2 LANE ROAD CROSSING
LOOKING EAST
NTS**

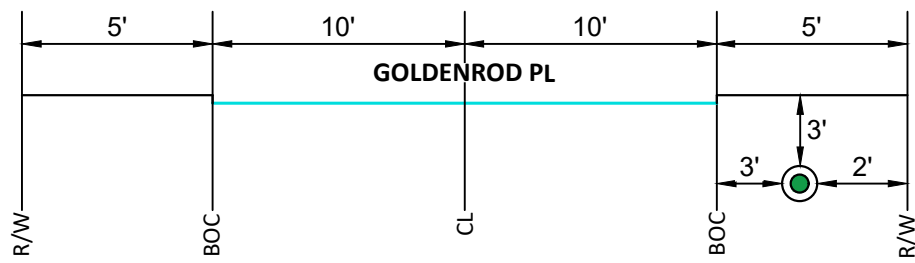

**TYPICAL DIRECT BURIED
CABLE DETAIL PARALLELING
ROW LOOKING NORTH
NTS**

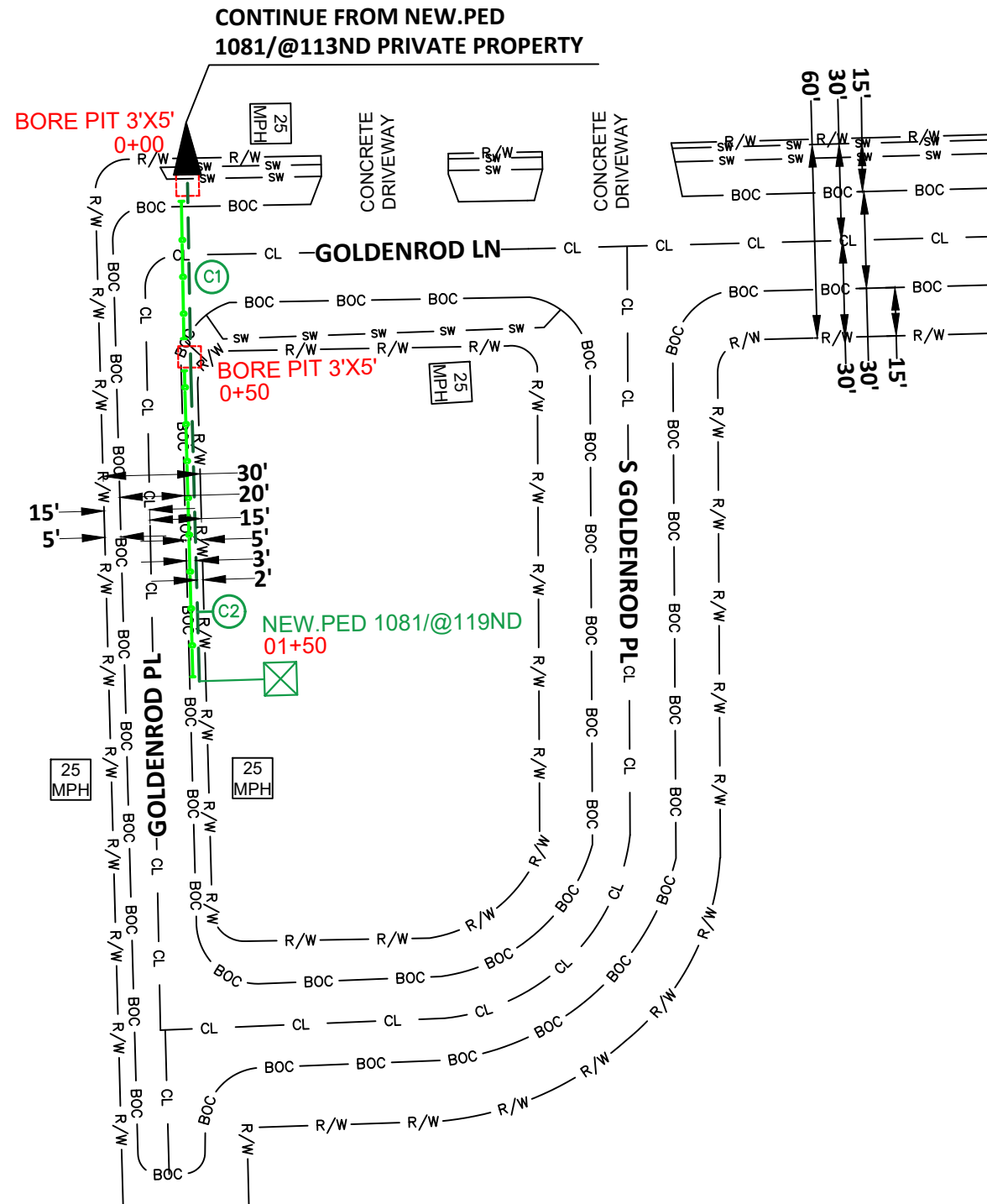

LEGEND

- PROPOSED CONDUIT
- PROPOSED BURIED FIBER
- AERIAL PROPOSED FIBER WITH NEW STRAND
- AERIAL PROPOSED FIBER WITH EXISTING STRAND
- SW SIDEWALK
- R/W ROW
- EOP EOP
- BOC BOC
- CL CENTER LINE
- POLE
- POWER POLE
- JOINT POLE
- ⊗ EXT WS PED
- ⊗ NEW WS PED
- ⊗ BORE PIT
- ⊗ NEW FDH



DATE CREATED: 4/10/26
 DATE REVISED:
 DRAWN BY: RAMTeCH



SCALE: 1:50

COMPANY:
Windstream

SYSTEM:
CRETE, NE

PROJECT NUMBER:
715062326

DESCRIPTION:
FTTP GPON PERMIT

MAP:
3 OF 3

RAMTeCH